

Addendum

| | |
|--------------|-----------------------------------|
| DATE: | June 1, 2026 |
| ADDENDUM NO: | 02 |
| PROJECT: | LVSD Elementary Security Upgrades |
| T0: | 2602.6 |

The following Addendum forms part of and modifies the Bidding and Contract Documents for this project. Contractor shall acknowledge receipt of this Addendum on the Bid Form.

| ITEM | SHEET/SECTION NO. | DESCRIPTION |
|------|-------------------|---|
| 01 | Bidding Q/A | <p>Q: Can construction work be done on Saturday?</p> <p>A: Work should be conducted Monday through Friday during normal business hours?</p> |
| 02 | Bidding Q/A | <p>Q: Have you considered a wireless system? It will potentially be less expensive than a wired system?</p> <p>A: Yes, we will consider a wireless system. This is what is used in the other schools across the district.</p> |
| 03 | Bidding Q/A | <p>Q: Can the network closets be identified for the bidders?</p> <p>A: Yes, we have added the network closet location to the school plans. See Attachment-B.</p> |
| 04 | Bidding Q/A | <p>Q: Can we reuse the existing “Best” cylinder cores?</p> <p>A: Yes, please do.</p> |
| 05 | Clarification | <p>All new raceways at any of the elementary schools are to be EMT conduit when routing indoors and RGS when routing outdoors. All exposed conduit in public spaces shall be painted to match the existing color of the surface being routed along (ceiling, wall, etc.).</p> |

END OF ADDENDUM

Attachments: Attachment-B -Plans

Attachment – B

Following is a compilation of the elementary school floor plans indicating the location of the network closets. There is a total of (12) pages not including this page. The locations are highlighted and indicated by the following abbreviations:

MDF = Main Distribution Frame

IDF = Intermediate Distribution Frame

**Columbia Valley Gardens
Elementary School
2644 30th Ave.
Prefix 575
Voice VLAN 18
Data VLAN 218**

**7655
Room 27**
**Room 26
7654**

IDF

**7653
Room 25**
**Room 24
7652**

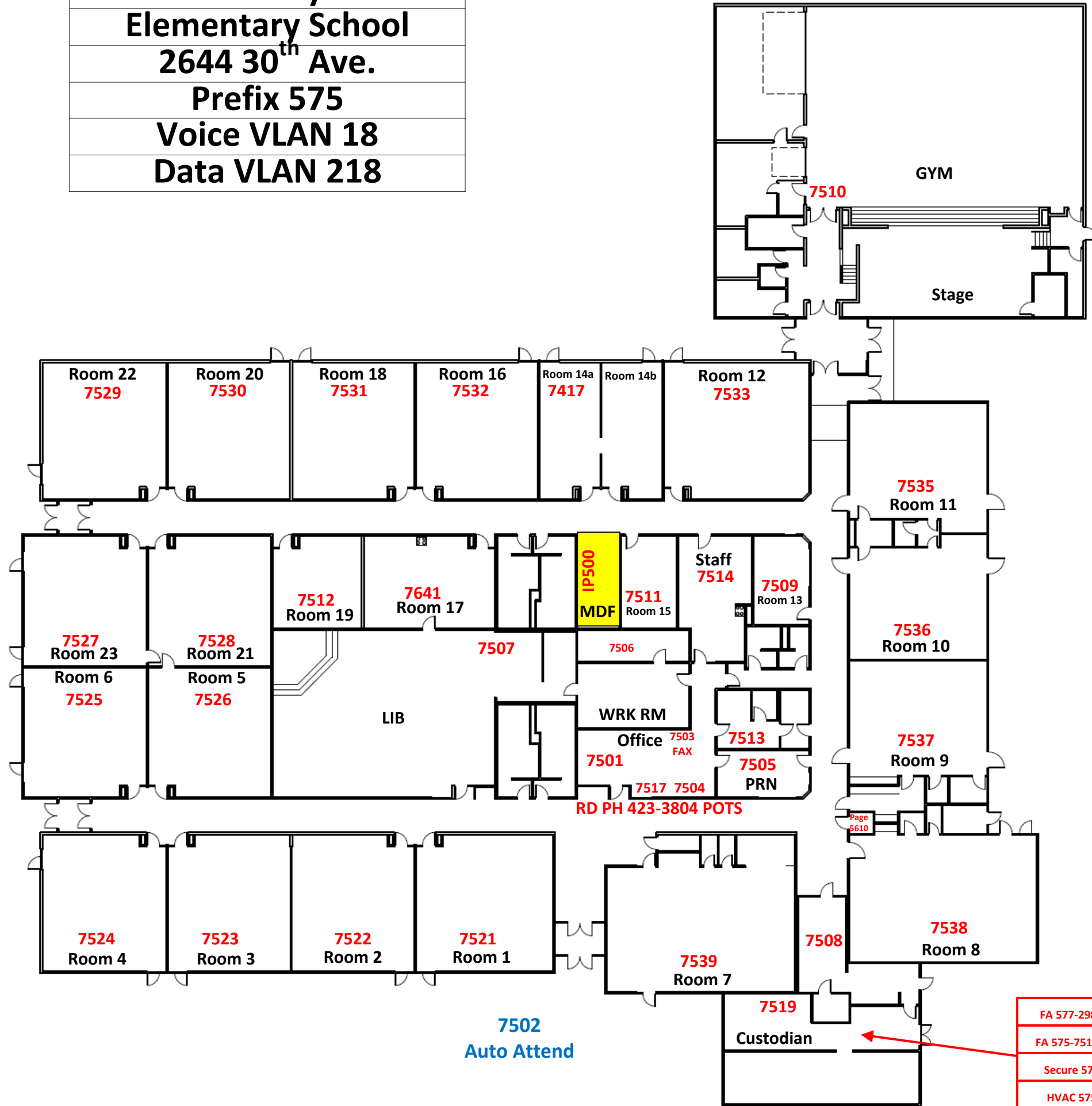

| |
|--------------------|
| FA 577-2989 POTS |
| FA 575-7516 Analog |
| Secure 575-7517 |
| HVAC 575-7520 |

Page 5610

RD PH 423-3804 POTS

**7502
Auto Attend**

**Kessler Elementary
School**
1902 Kessler Blvd
Prefix 575
Voice VLAN 32
Data VLAN 132

HVAC 575-7560
 Security 575-7561

Page 5610
 IP500

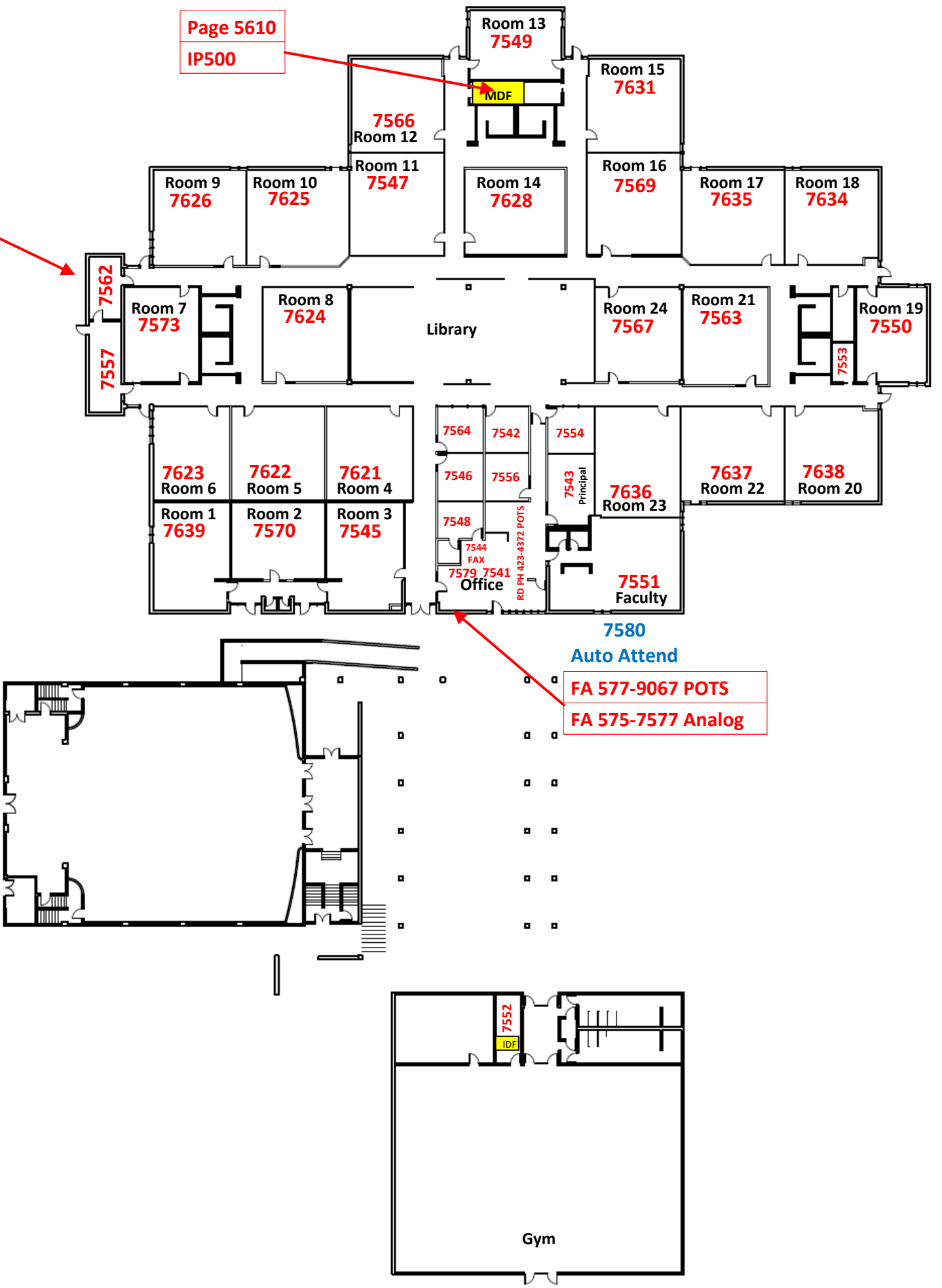

Auditorium Basement

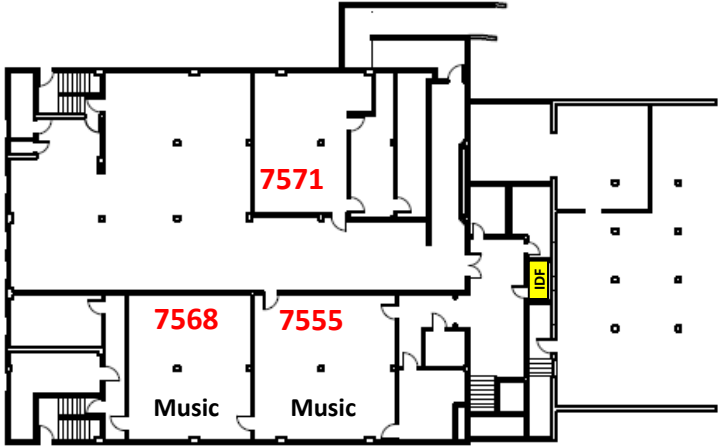

7580
 Auto Attend
 FA 577-9067 POTS
 FA 575-7577 Analog

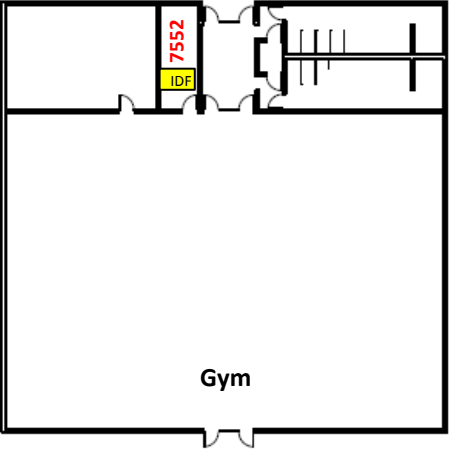

**Mint Valley
Elementary
2745 38th Ave
Prefix 575
Voice VLAN 36
Data VLAN 136**

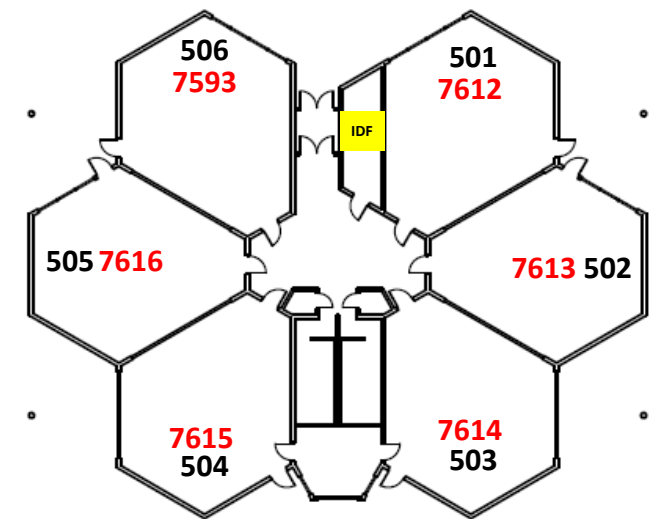
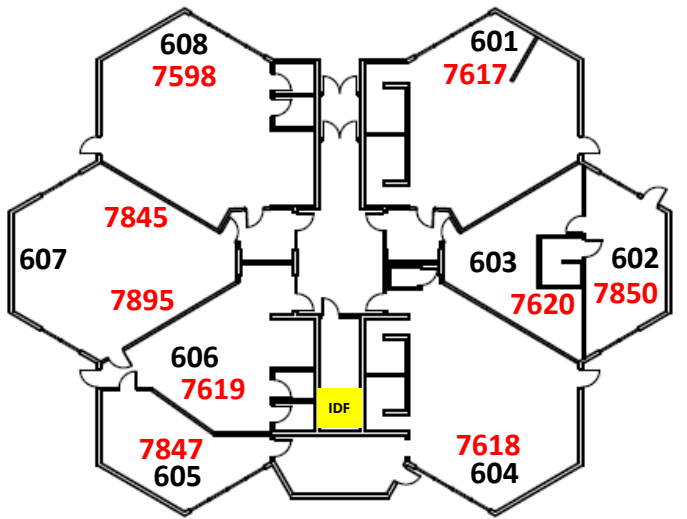
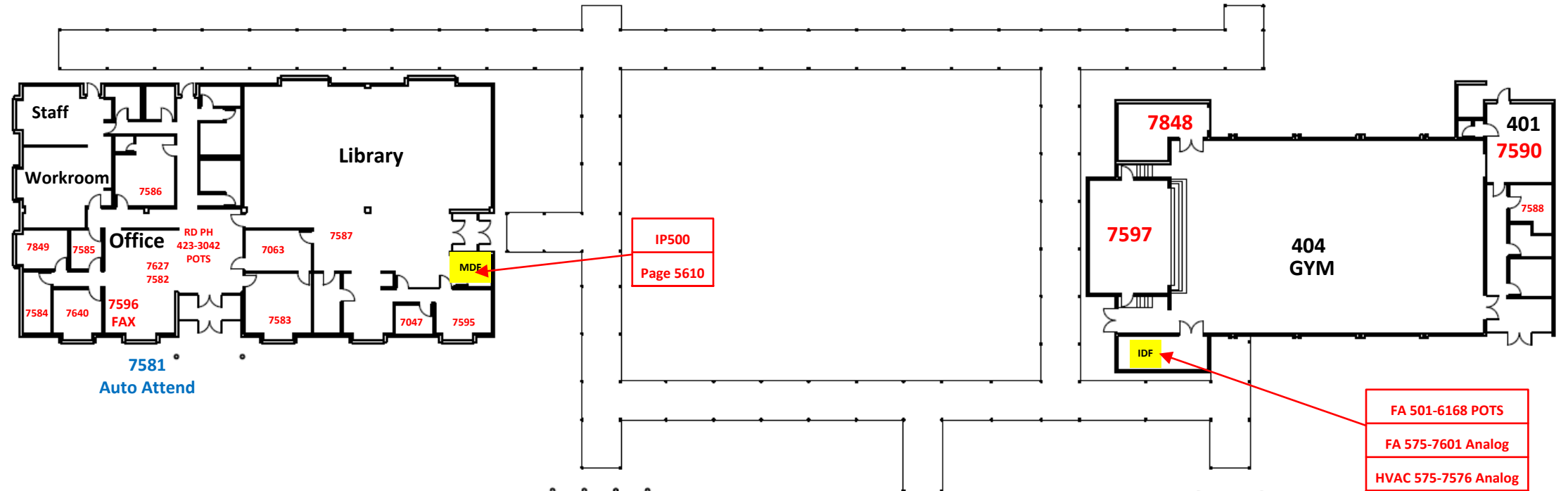
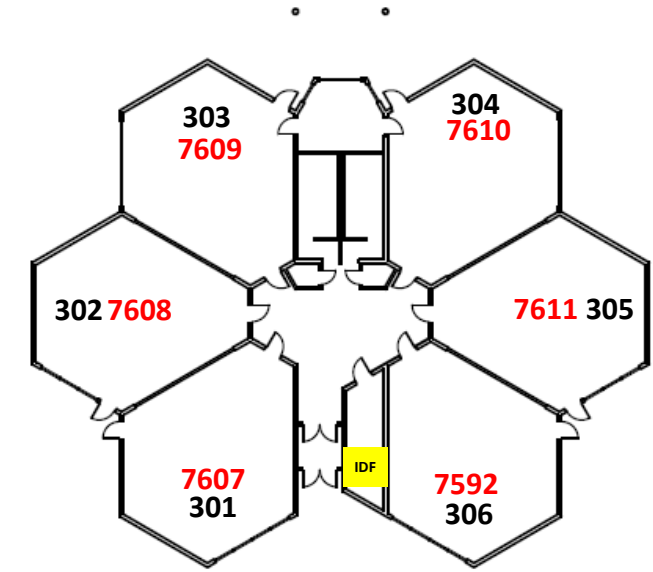
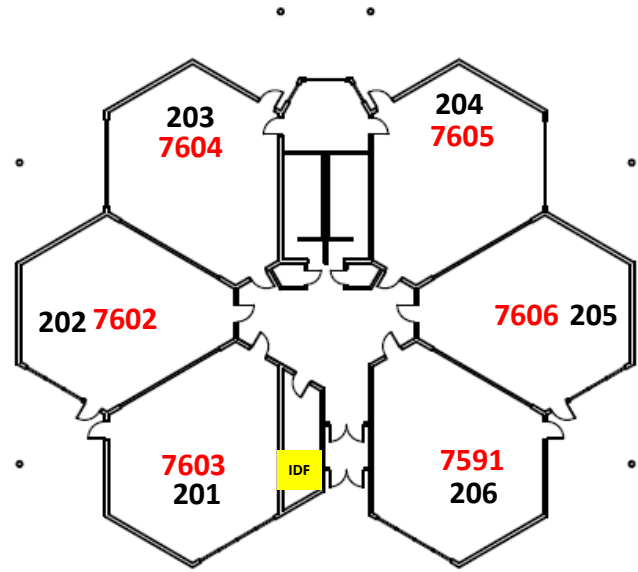
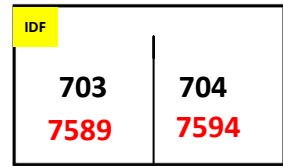
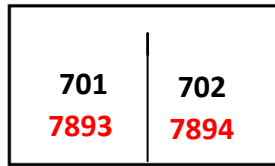

| |
|-------------------------|
| Northlake |
| Elementary |
| 2210 Olympia Way |
| Main |
| Prefix 501 |
| Voice VLAN 38 |
| Data VLAN 138 |

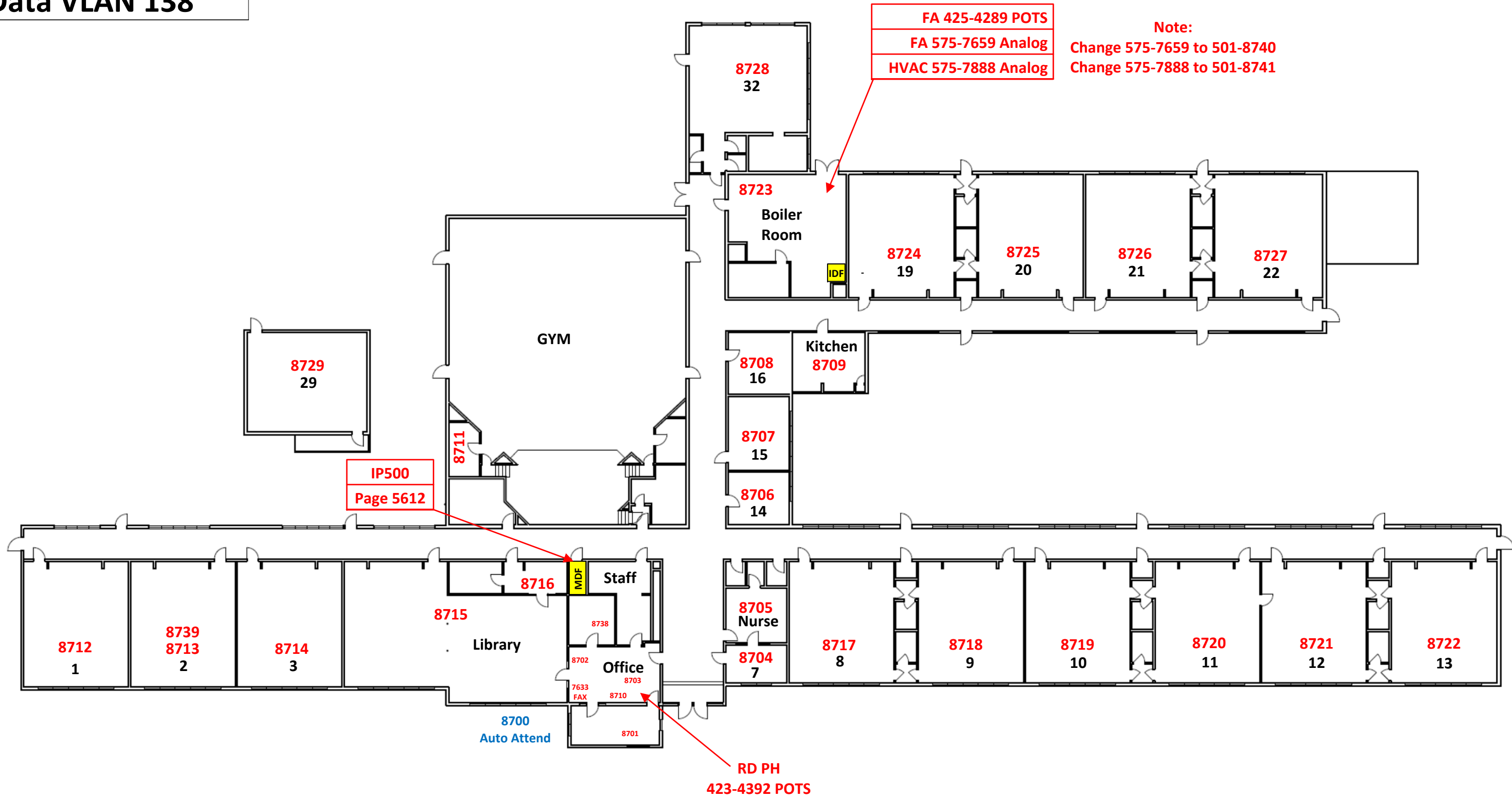

| |
|------------------|
| Northlake |
| Elementary |
| 2210 Olympia Way |
| Portables |
| Prefix 501 |

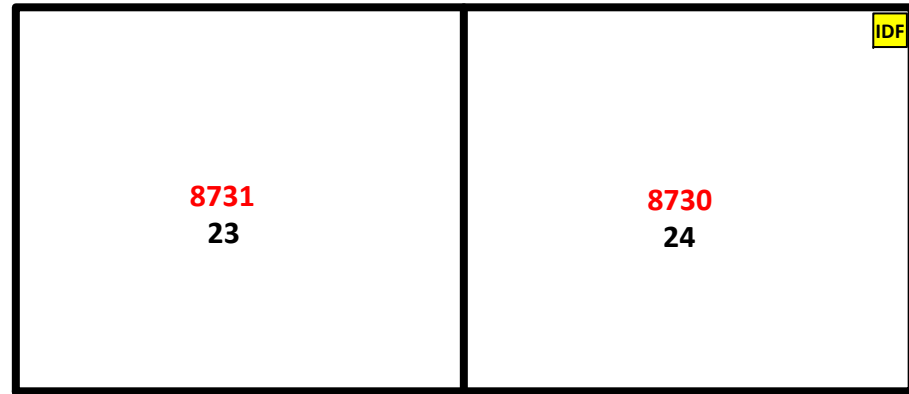
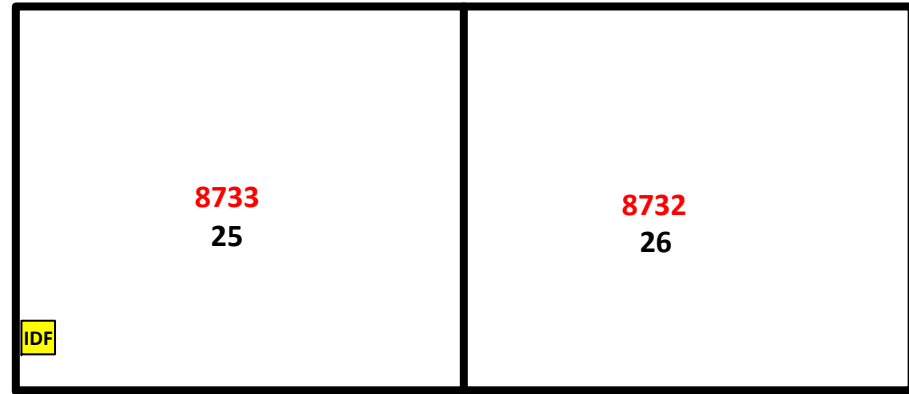
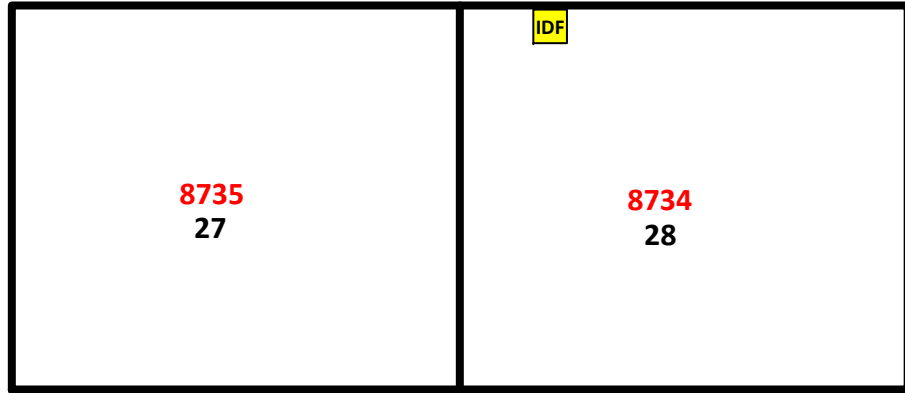
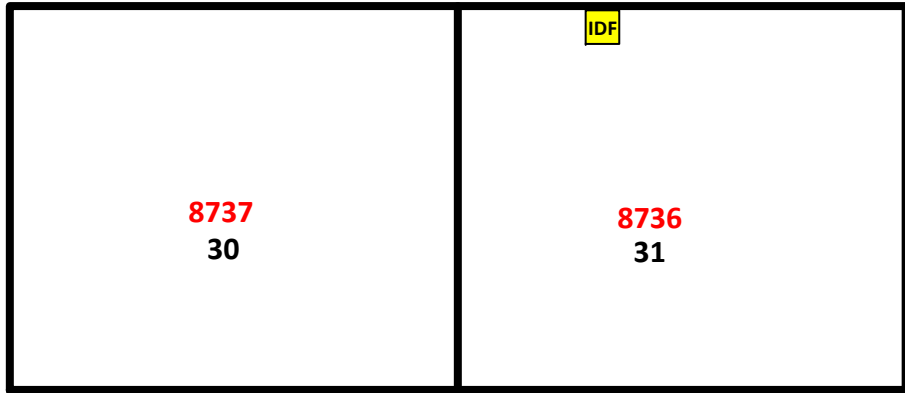

| |
|---------------------------------|
| Olympic Elementary |
| 1324 30th Ave |
| Main |
| Prefix 575 |
| Voice VLAN 23 |
| Data VLAN 123 |

| |
|-----------------------------|
| FA 425-5207 POTS |
| FA 575-7201 Analog |
| HVAC 575-7985 Analog |

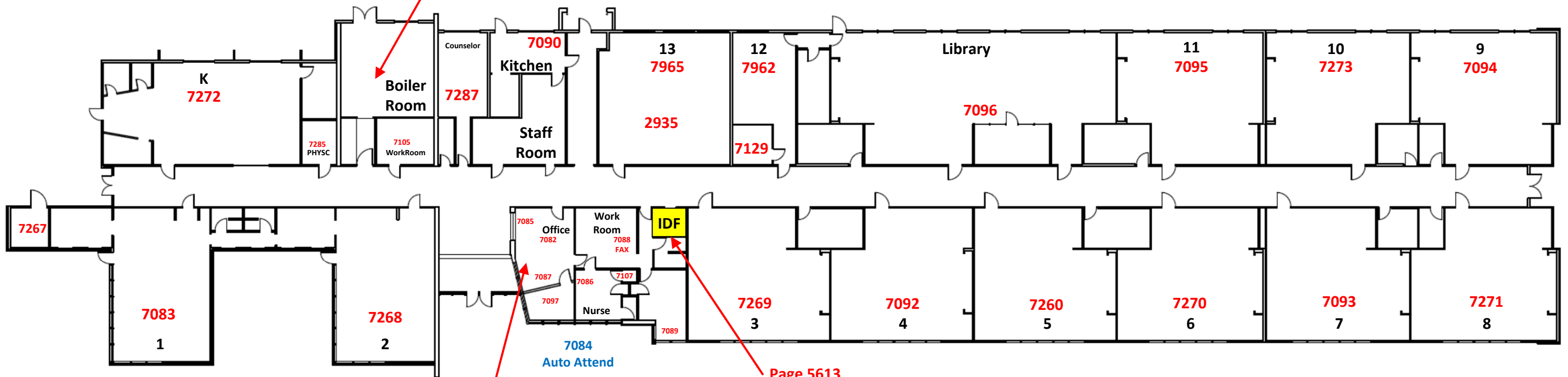

**RD PH
423-4575
POTS**

Page 5613

Olympic Elementary
1324 30th Ave
Annex
Prefix 575

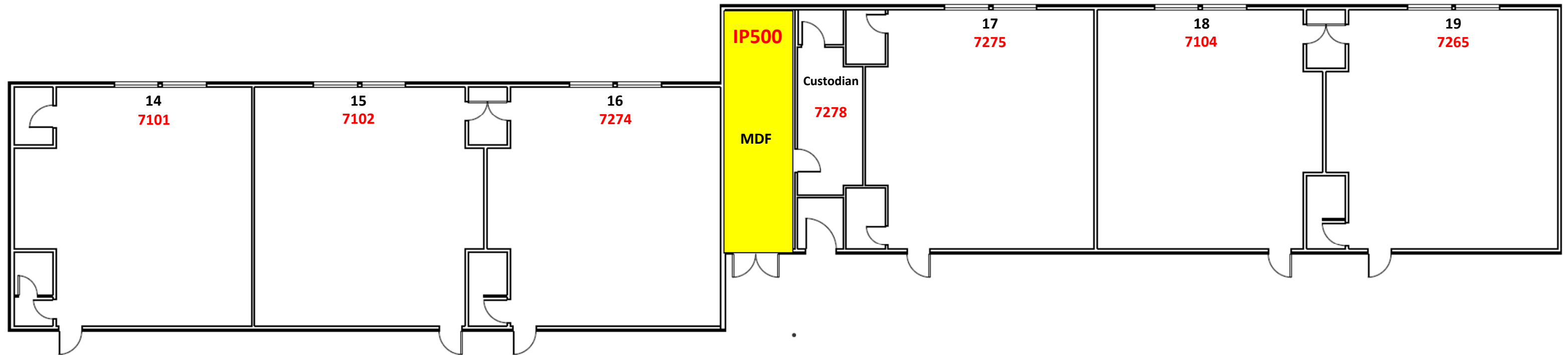

Olympic Elementary
1324 30th Ave
Gym
Prefix 575

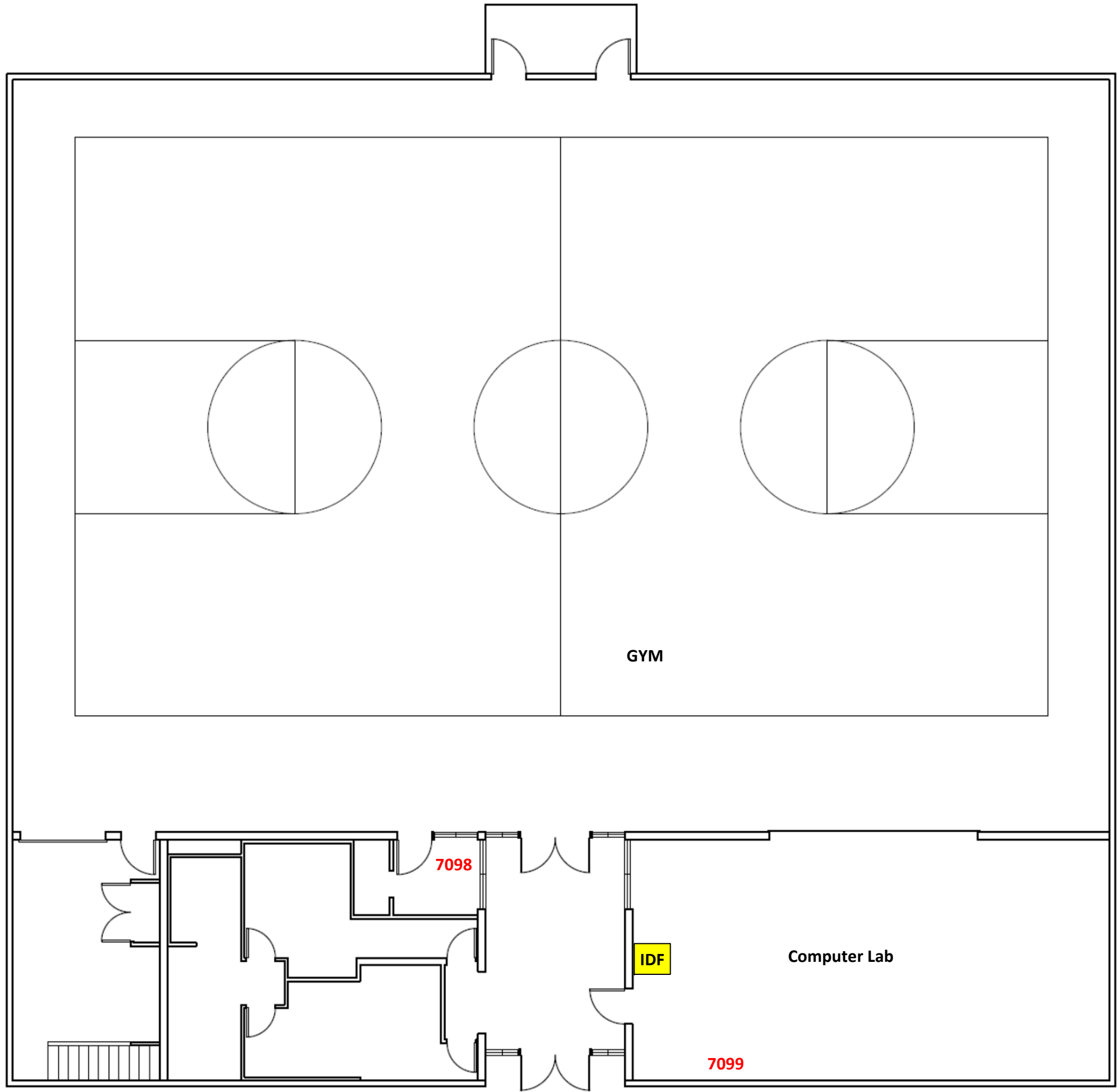

| |
|---------------------------------|
| Olympic Elementary |
| 1324 30th Ave |
| Portables |
| Prefix 575 |

7277
22

IDF

7103
21

7100
23

| |
|----------------------|
| Robert Gray |
| Elementary |
| 4622 Ohio |
| Prefix 575 |
| Voice VLAN 24 |
| Data VLAN 224 |

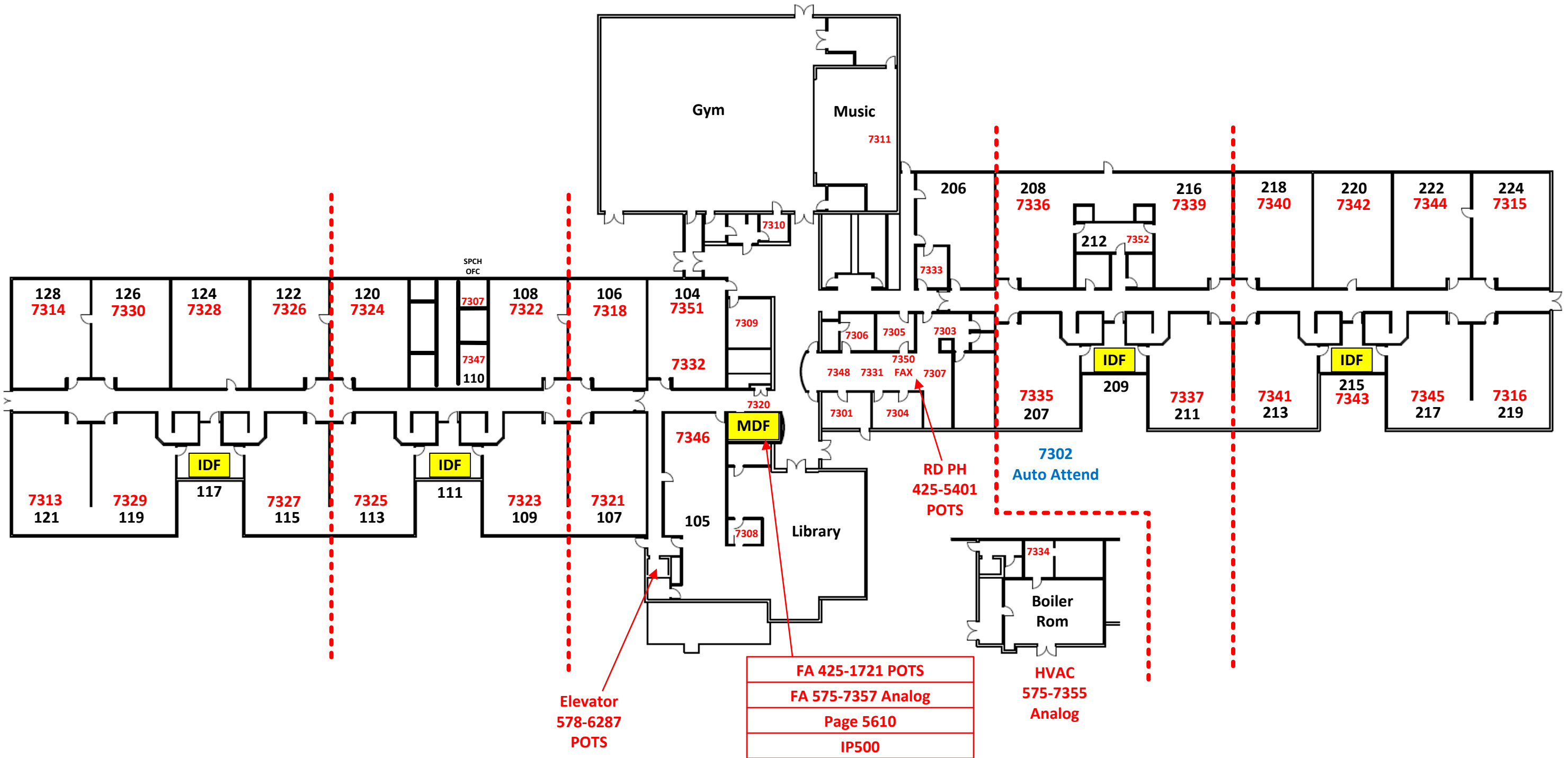

| |
|--------------------------------|
| St Helens |
| Elementary School |
| 431 27th Ave |
| Main |
| Prefix 575 |
| Voice VLAN 48 |
| Data VLAN 148 |

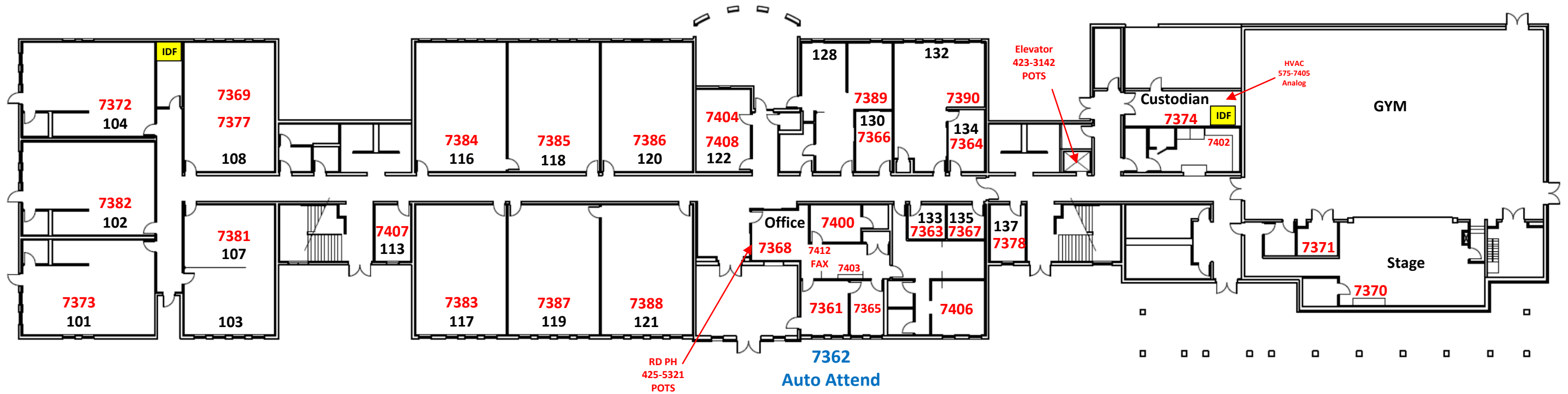

| |
|--------------------------|
| St Helens |
| Elementary School |
| 431 27 th Ave |
| Main 2 |
| Prefix 575 |

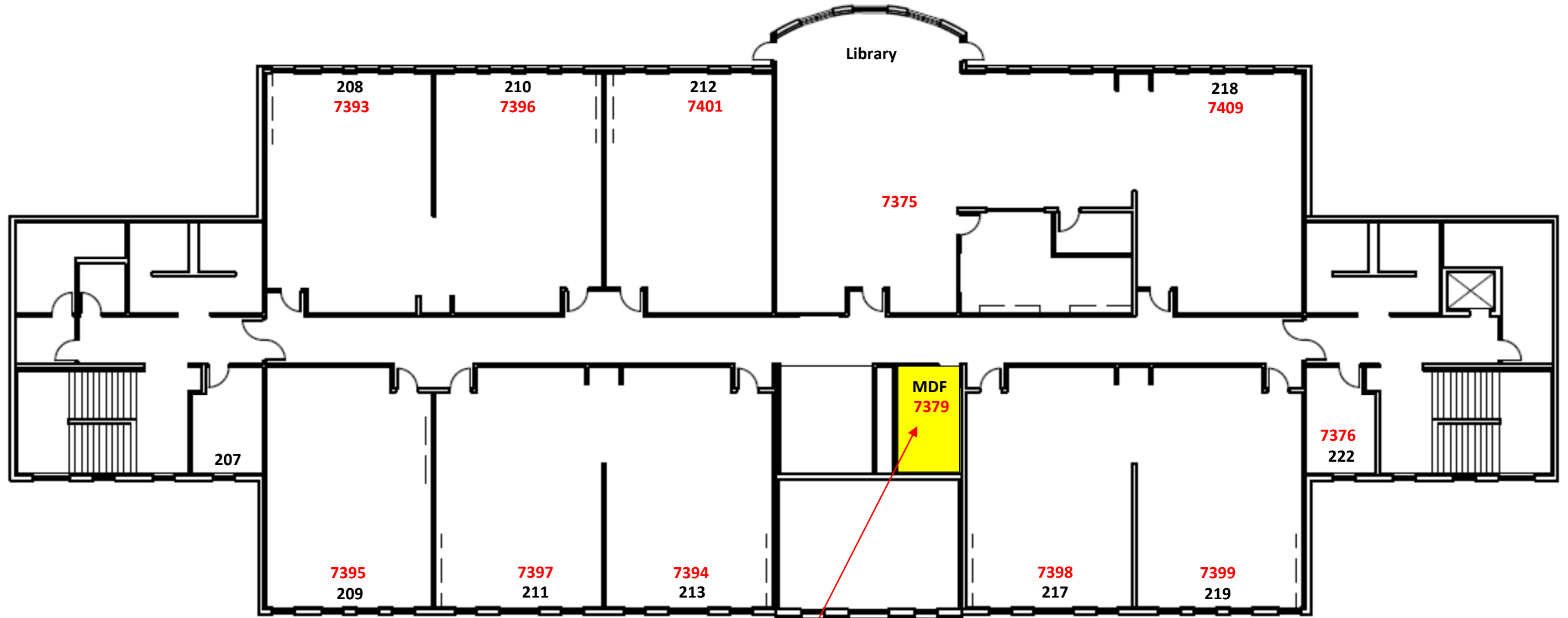

| |
|--------------------|
| IP500 |
| Page 5610 |
| FA 575-6796 POTS |
| FA 575-7914 Analog |