

FLOOR PLAN GENERAL NOTES

1. REFER TO 1/A-621-1/A-623 FOR WALL ASSEMBLY TYPES.
2. REFER TO ROOM FINISH SCHEDULE AND INTERIOR ELEVATIONS FOR WALL FINISHES.
3. REFER TO 1/G-202 FLOOR PLANS FOR LOCATIONS OF FIRE-RATED WALL CONSTRUCTION.
4. REFER TO A-201 - A-203 FOR EXTERIOR WINDOW CALLOUTS.
5. REFER TO MECHANICAL DRAWINGS FOR SIZING AND CONFIGURATION OF ALL DUCTS AND PIPES PENETRATING FLOOR ASSEMBLIES.
6. PROVIDE FIRESTOPPING AT ALL ELECTRICAL AND MECHANICAL (CONDUIT, PIPING AND DUCT) PENETRATIONS THROUGH FIRE-RATED FLOOR/CEILING/ROOF ASSEMBLIES.
7. REFER TO ENLARGED FLOOR PLANS FOR ADDITIONAL INFORMATION.

FLOOR PLAN LEGEND

- NOTE:** NOT ALL LEGEND ITEMS MAY BE PRESENT ON THIS SHEET
- 6W1 WALL ASSEMBLY; REFER TO SHEETS A-621, A-622, AND A-623
 - EXISTING DOOR TO REMAIN
 - EXISTING WALL TO REMAIN
 - EXISTING RELITE / WINDOW TO REMAIN
 - EXTERIOR FRAMED WALL - REFER ALSO TO STRUCTURAL
 - INTERIOR FRAMED WALL - STOP WALL AT 6" ABOVE HIGHEST CEILING UNLESS NOTED OTHERWISE BRACE TO STRUCTURE ABOVE AS SHOWN ON A-551.
 - WALL-MOUNTED ITEM - REFER TO INTERIOR ELEVATIONS
 - RELITE / WINDOW
 - DOOR
 - ACUSTIC INTERIOR WALL - CONTINUE TO STRUCTURE ABOVE
 - CONTINUE INTERIOR WALL TO STRUCTURE ABOVE
 - 1 HOUR CONSTRUCTION - CONTINUE TO RATED ASSEMBLY ABOVE
 - 2 HOUR CONSTRUCTION - CONTINUE TO RATED ASSEMBLY ABOVE
 - STRUCTURE ABOVE / EDGE OF ROOF ABOVE
 - FEC FIRE EXTINGUISHER IN CABINET
 - FEB FIRE EXTINGUISHER WITH BRACKET
 - DS DOWNSPOUT - PVC PIPE
 - FD FLOOR DRAIN PER MECHANICAL; DEPRESS DRAIN BODY 1/4" WARP ADJACENT SLAB 6" FROM DRAIN BODY
 - FD FLOOR DRAIN PER MECHANICAL DRAWINGS; DEPRESS DRAIN BODY; SLOPE SHOWER FLOOR TO DRAIN
 - 4" TB TACK BOARD - WIDTH AS INDICATED BY 4'-0" HIGH
 - 4" WB WHITEBOARD - WIDTH AS INDICATED BY 4'-0" HIGH
 - RECESSED WALK OFF MAT
 - NO WORK AREA

FLOOR PLAN SHEET NOTES

KEY PLAN

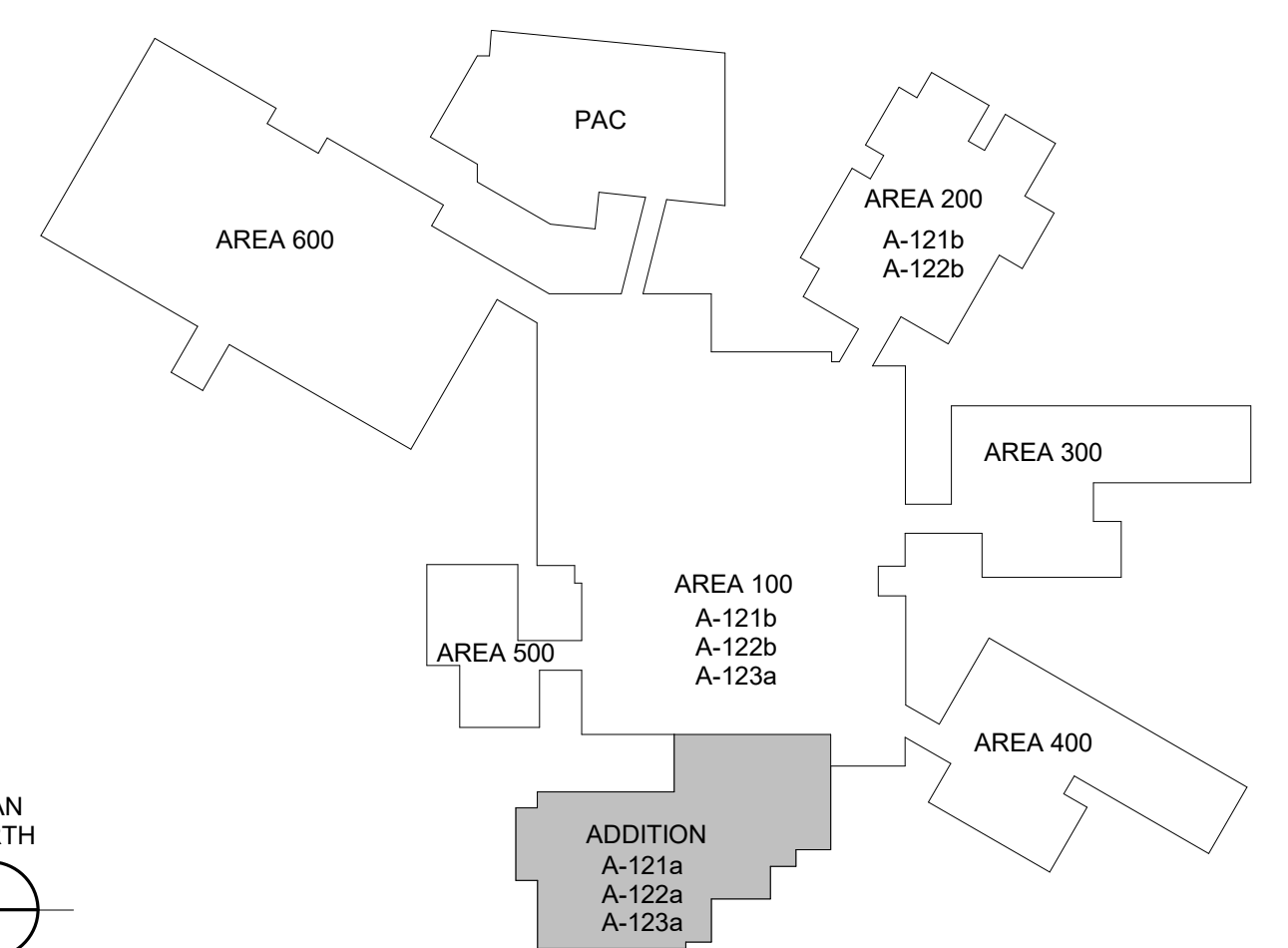

1 FIRST FLOOR PLAN - ADDITION
1/8" = 1'-0"

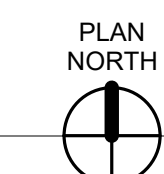
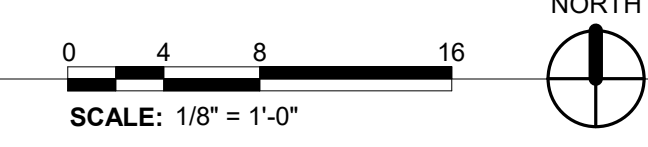

REVISIONS

NO.	DATE	DESCRIPTION

DATE: 3.2.2026
BCR NO: 24143
DRAWN BY: NBN, MD, RTV, JD
CHECKED BY: NBN
DESIGNED BY: NBN
FIRST FLOOR PLAN - ADDITION

IF SHEET MEASURES LESS THAN 30"x42", IT IS A REDUCED PRINT. REDUCE SCALE ACCORDINGLY

FLOOR PLAN GENERAL NOTES

1. REFER TO 1/A-621, 1/A-623 FOR WALL ASSEMBLY TYPES.
2. REFER TO ROOM FINISH SCHEDULE AND INTERIOR ELEVATIONS FOR WALL FINISHES.
3. REFER TO 1/G-202 FLOOR PLANS FOR LOCATIONS OF FIRE-RATED WALL CONSTRUCTION.
4. REFER TO A-201 - A-203 FOR EXTERIOR WINDOW CALLOUTS.
5. REFER TO MECHANICAL DRAWINGS FOR SIZING AND CONFIGURATION OF ALL DUCTS AND PIPES PENETRATING FLOOR ASSEMBLIES.
6. PROVIDE FIRESTOPPING AT ALL ELECTRICAL AND MECHANICAL (CONDUIT, PIPING AND DUCT) PENETRATIONS THROUGH FIRE-RATED FLOOR/CEILING/ROOF ASSEMBLIES.
7. REFER TO ENLARGED FLOOR PLANS FOR ADDITIONAL INFORMATION.

FLOOR PLAN LEGEND

- NOTE:** NOT ALL LEGEND ITEMS MAY BE PRESENT ON THIS SHEET
- GW1 WALL ASSEMBLY; REFER TO SHEETS A-621, A-622, AND A-623
 - EXISTING DOOR TO REMAIN
 - EXISTING WALL TO REMAIN
 - EXISTING RELITE / WINDOW TO REMAIN
 - EXTERIOR FRAMED WALL - REFER ALSO TO STRUCTURAL
 - INTERIOR FRAMED WALL - STOP WALL AT 6" ABOVE HIGHEST CEILING UNLESS NOTED OTHERWISE. BRACE TO STRUCTURE ABOVE AS SHOWN ON A-551.
 - WALL-MOUNTED ITEM - REFER TO INTERIOR ELEVATIONS
 - RELITE / WINDOW
 - DOOR
 - ACUSTIC INTERIOR WALL - CONTINUE TO STRUCTURE ABOVE
 - CONTINUE INTERIOR WALL TO STRUCTURE ABOVE
 - 1 HOUR CONSTRUCTION - CONTINUE TO RATED ASSEMBLY ABOVE
 - 2 HOUR CONSTRUCTION - CONTINUE TO RATED ASSEMBLY ABOVE
 - STRUCTURE ABOVE / EDGE OF ROOF ABOVE
 - FIRE EXTINGUISHER IN CABINET
 - FIRE EXTINGUISHER WITH BRACKET
 - DOWNSPOUT - PVC PIPE
 - FLOOR DRAIN PER MECHANICAL; DEPRESS DRAIN BODY 1/4"; WARP ADJACENT SLAB 6" FROM DRAIN BODY
 - FLOOR DRAIN PER MECHANICAL DRAWINGS; DEPRESS DRAIN BODY; SLOPE SHOWER FLOOR TO DRAIN
 - TACK BOARD - WIDTH AS INDICATED BY 4'-0" HIGH
 - WHITEBOARD - WIDTH AS INDICATED BY 4'-0" HIGH
 - RECESSED WALK OFF MAT
 - NO WORK AREA

FLOOR PLAN SHEET NOTES

KEY PLAN

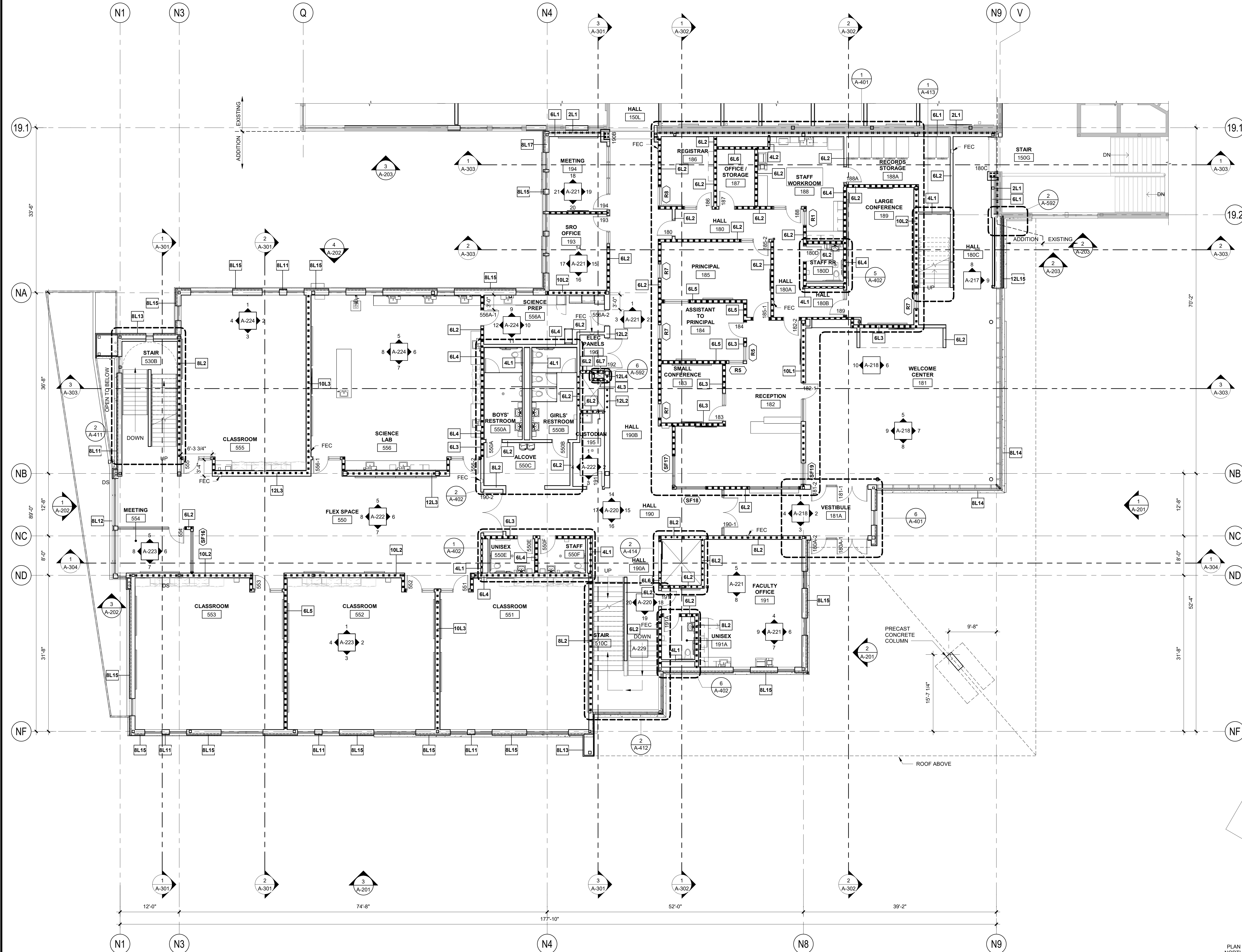
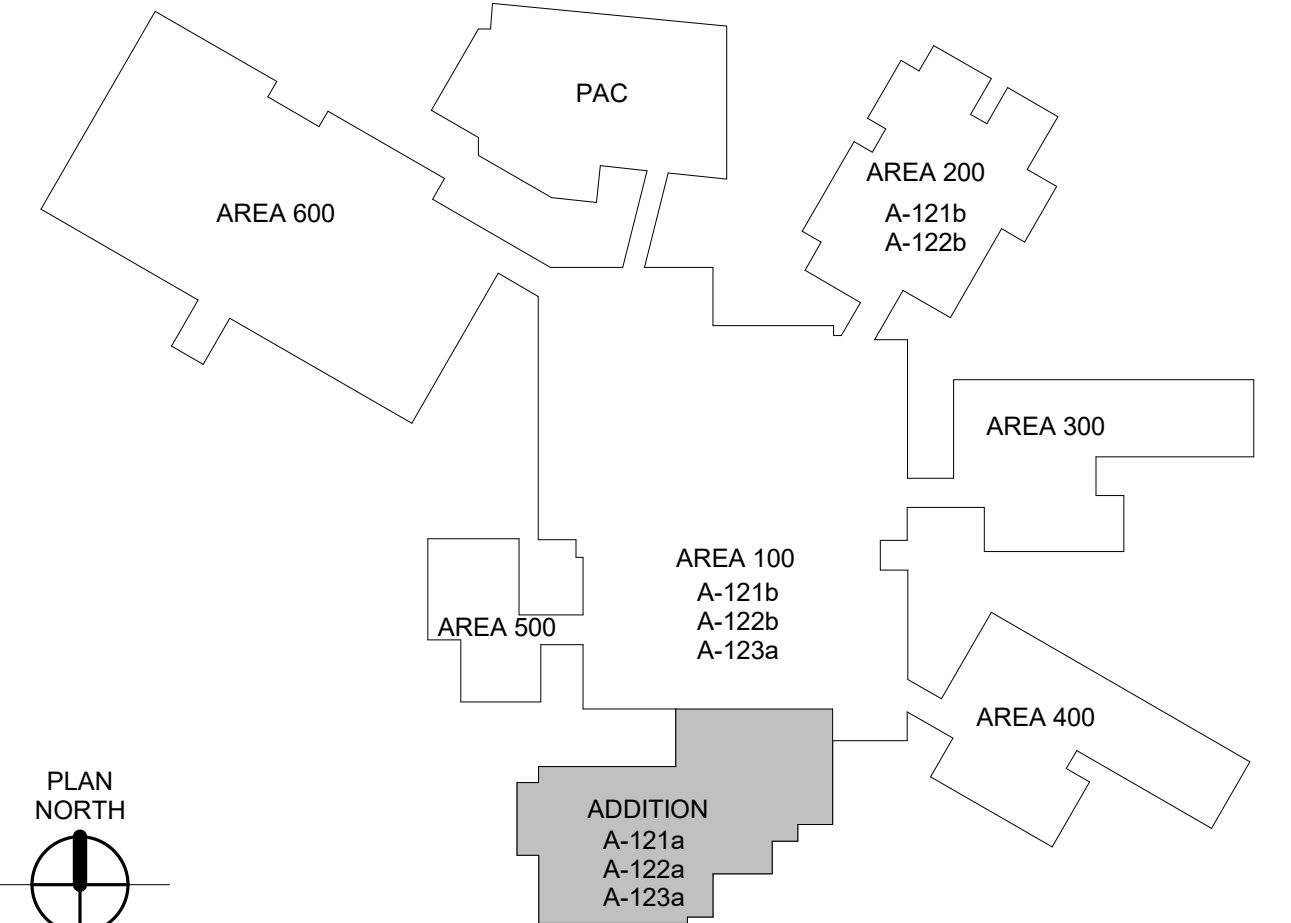

1 SECOND FLOOR PLAN - ADDITION
 1/8" = 1'-0"

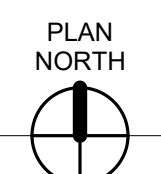
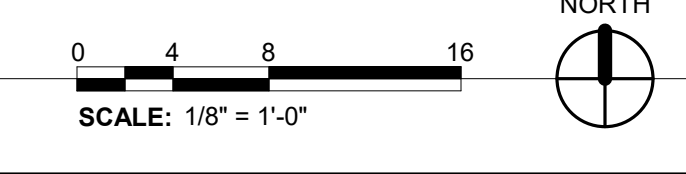

PROJECT:
 SUMNER-BONNEY LAKE SCHOOL DISTRICT
BONNEY LAKE HIGH SCHOOL EXPANSION
 10920 199TH AVE CTE
 BONNEY LAKE, WA 98391

REVISIONS

NO.	DATE	DESCRIPTION

IF SHEET MEASURES LESS THAN 30"x42", IT IS A REDUCED PRINT. REDUCE SCALE ACCORDINGLY

