

KIPPY MITCHELL SPORTS PARK SKATE PARK

MAP-LOT R059 LOT 024
11 MUNICIPAL DRIVE, SCARBOROUGH, MAINE 04074

LEGEND

EXISTING

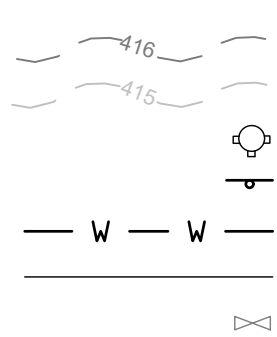

PROPOSED BUILDING
MINOR CONTOURS (1 FT)
MAJOR CONTOURS (5 FT)
HYDRANT SIGN
UNDERGROUND WATER LINE
EDGE OF EX. PAVEMENT
WATER VALVE

PROPOSED

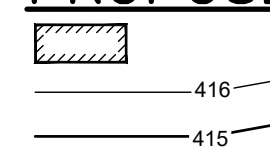

PROJECT TEAM

APPLICANT/OWNER:

TOWN OF SCARBOROUGH
PO BOX 360
SCARBOROUGH, MAINE 04074
CONTACT: NICK CLICHE, CPRP
(207) 730-4151

CIVIL ENGINEER:

ACORN ENGINEERING, INC.
16 MIDDLE ST., STE 302
PORTLAND, MAINE 04101
CONTACT: CRAIG BURGESS, P.E.
(207) 775-2655



SURVEYOR:

ACORN ENGINEERING, INC.
16 MIDDLE ST., STE 302
PORTLAND, MAINE 04101
CONTACT: DANE SHERMAN, PLS, CFS
(207) 595-3197



LANDSCAPE ARCHITECT:

ACORN ENGINEERING, INC.
16 MIDDLE ST., STE 302
PORTLAND, MAINE 04101
CONTACT: MATTHEW A. PHILLIPS, PLA
(207) 775-2655



ABBREVIATIONS

PARTIAL LIST OF ABBREVIATIONS AND THEIR CORRESPONDING MEANING. PLEASE CONTACT THE ENGINEER FOR ANY CLARIFICATION

APPROX.	APPROXIMATE
BC	BOTTOM OF CURB
BMP	BEST MANAGEMENT PRACTICE
BOT.	BOTTOM
CAD	COMPUTER AIDED DESIGN
CB	CATCH BASIN
CF	CUBIC FOOT
CIP	CAST IN PLACE
CM	CONSTRUCTION MANAGER
CONC.	CONCRETE
CUBIC YARD	CY
DIA.	DIAMETER
DIM.	DIMENSION
EA.	EACH
ELEC.	ELECTRICAL
ELEV.	ELEVATION
EQUIV.	EQUIVALENT
EST.	ESTIMATE
EX.	EXISTING
FFE	FINISH FLOOR ELEVATION
FT.	FEET
GAL.	GALVANIZED
GW.	GROUNDWATER
ID	INNER DIAMETER
IN.	INCH
INV.	INVERT
L	LENGTH
MAX.	MAXIMUM
MDEP	MAINE DEPARTMENT OF ENVIRONMENTAL PROTECTION
MDOT	MAINE DEPARTMENT OF TRANSPORTATION
MFG.	MANUFACTURED
MH	MANHOLE
MIN.	MINIMUM
OD	OUTSIDE DIAMETER
OHE/T/C	OVERHEAD ELECTRIC/TELEPHONE/CABLE
PC	PRECAST
PE	PROFESSIONAL ENGINEER
PL	PROPERTY LINE
PLS	PROFESSIONAL LAND SURVEYOR
PROP.	PROPOSED
PSI	POUNDS PER SQUARE INCH
PVC	POLYVINYL CHLORIDE
R	RADIUS
RD	ROOF DRAIN
RET.	RETAINING
ROW	RIGHT OF WAY
S	SLOPE
SD	STORM DRAIN
SDR	STANDARD DIMENSION RATIO
SF	SQUARE FEET
SMH	SEWER MANHOLE
SPEC.	SPECIFICATION
TW	TOP OF WALL
TYP.	TYPICAL
UD	UNDERDRAIN

INDEX

C-01	COVER SHEET & LEGEND
C30.2	WENTWORTH INTERMEDIATE SCHOOL SITE GRADING AND EROSION CONTROL PLAN
EX-1	EXISTING CONDITIONS PLAN
C-10	SITE PLAN

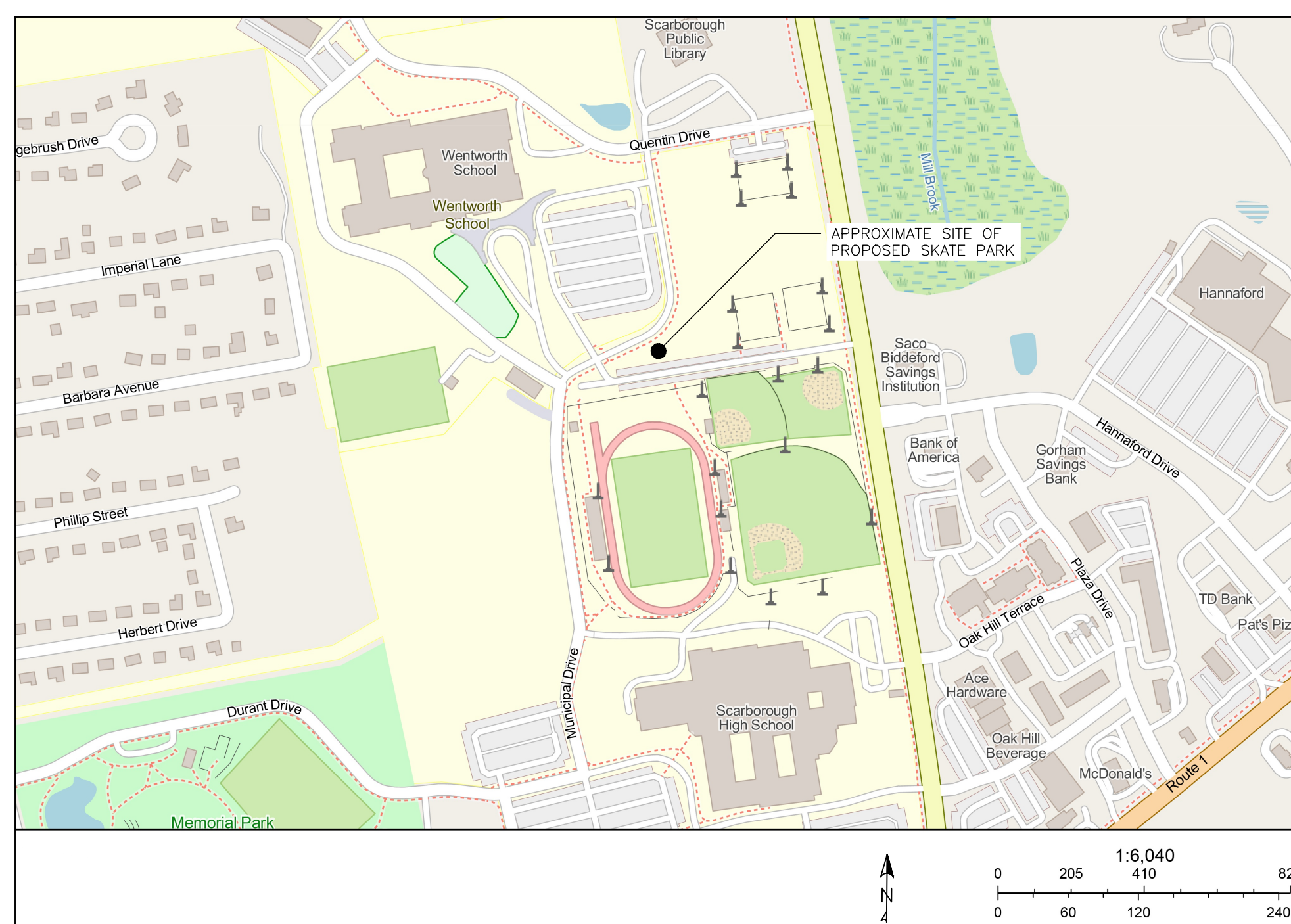

VICINITY MAP

CALL BEFORE YOU DIG
1-888-DIG-SAFE
1-888-344-7233

DRAFT
NOT ISSUED FOR
CONSTRUCTION

ISSUED FOR	BY
TOWN SKETCH PLAN	CBS
	5/20/24

COVER SHEET & LEGEND

KIPPY MITCHELL SPORTS COMPLEX SKATE PARK

TOWN OF SCARBOROUGH, MAINE
259 U.S. ROUTE 1, SCARBOROUGH, MAINE 04070

ACORN ENGINEERING, INC.
16 MIDDLE ST., STE 302
PORTLAND, MAINE 04104
(207) 775-2655

THIS PLAN SHALL NOT BE MODIFIED WITHOUT WRITTEN PERMISSION OF THE ENGINEER. ANY CHANGES OR ADDITIONS SHALL BE AT THE USER'S SOLE RISK AND WITHOUT LIABILITY TO ACORN ENGINEERING, INC.

FILE: 1187.4_CIVIL
JN: 1187.4
SCALE: AS NOTED
DESIGNED BY: CAB
DRAWN BY: HLM
CHECKED BY: CAB

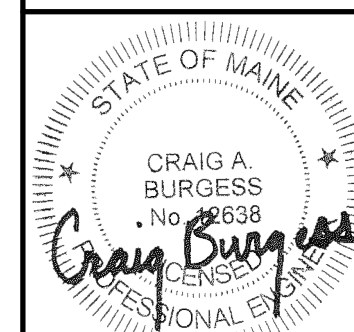

05/20/2026

DRAWING NO.

C-01

- NOTES:**
- EXISTING CONDITIONS SURVEY PREPARED BY OWEN HASKELL, INC., REVISED 12-30-2011.
 - WETLAND DELINEATION PROVIDED BY STANTEC.
 - SOIL GEOTECHNICAL INVESTIGATION BY R.W. GILLESPIE AND ASSOCIATES, INC. ON OCTOBER 20, 2006, UPDATED JULY 2012.
 - TRAFFIC HAS BEEN STUDIED BY CORRILL-PALMER OF GRAY, MAINE

07-23-12	ISSUED FOR BID	
05-23-12	SANITARY DISTRICT REVIEW	
04-23-12	PROGRESS REVIEW	
03-16-12	PLANNING BOARD REVIEW	
03-08-12	DEP REVIEW	
01-26-12	PREAPPLICATION REVIEW	
Rev.	Date	Description
Issue Dates		

Drawing Status

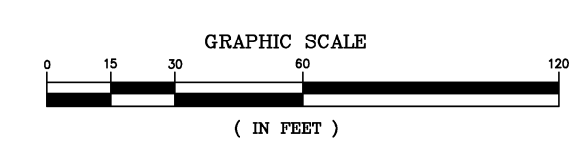
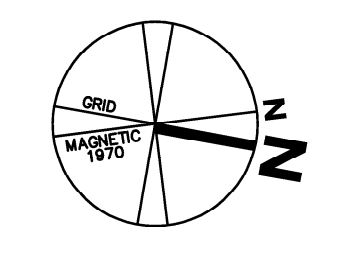
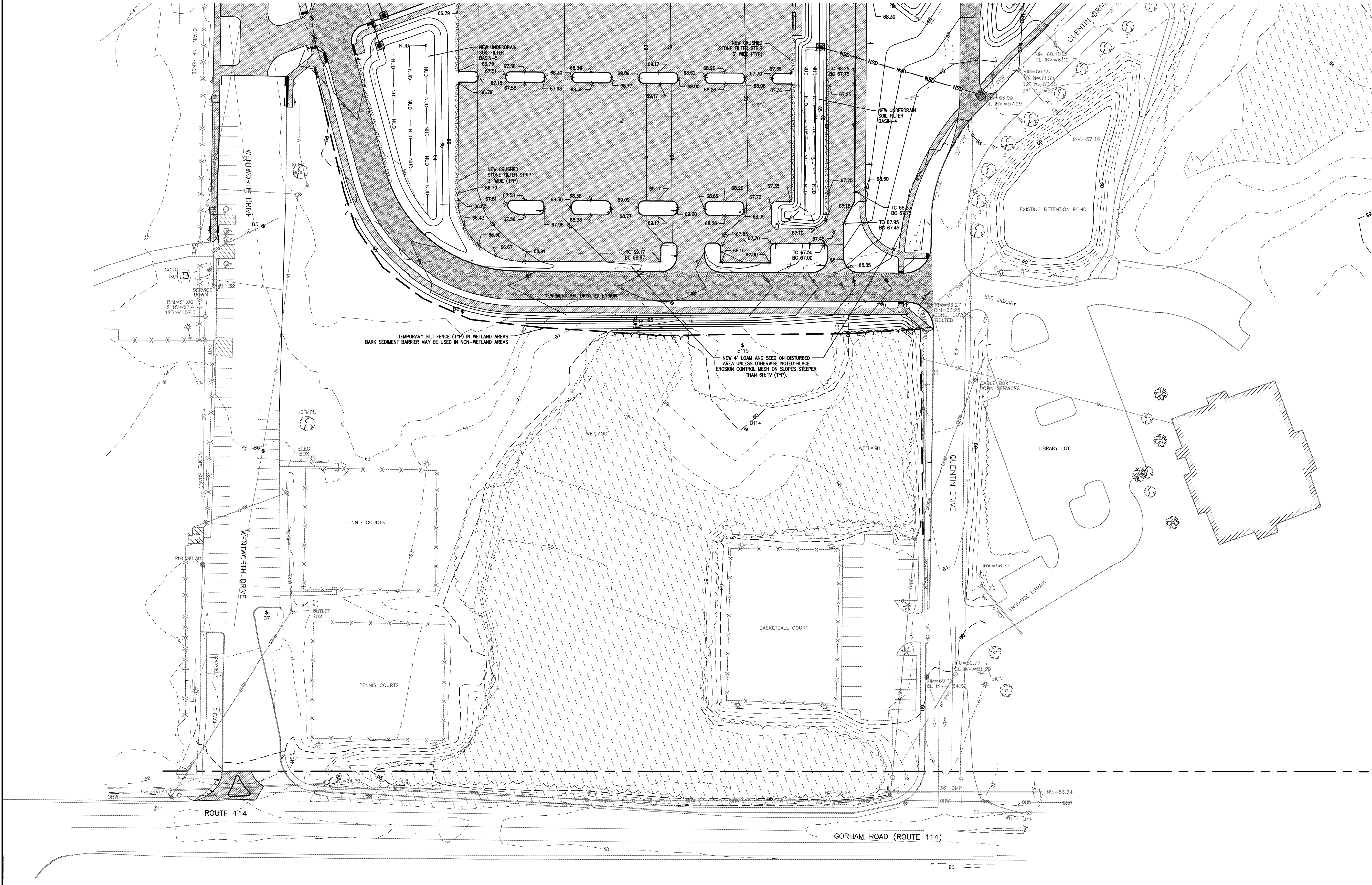

SKATE PARK DIMENSIONS PER AMERICAN RAMP COMPANY

- NOTES:
 1. THE ILLUSTRATION BELOW IS NOT TO SCALE AND IS PROVIDED FOR SKATE PARK DIMENSION REFERENCE ONLY.
 2. SKATE PARK DIMENSIONS, FEATURE DETAILS, AND FEATURE PLACEMENT SHOWN HEREON HAVE BEEN PROVIDED BY AMERICAN RAMP COMPANY.
 3. THE ASPHALT SKATE PARK PAD IS TO HAVE A 1% GRADE IN ONE DIRECTION.
 4. SKATE PARK PAD SURFACE SHALL BE ASPHALT WITH ACRYLIC RESURFACER.

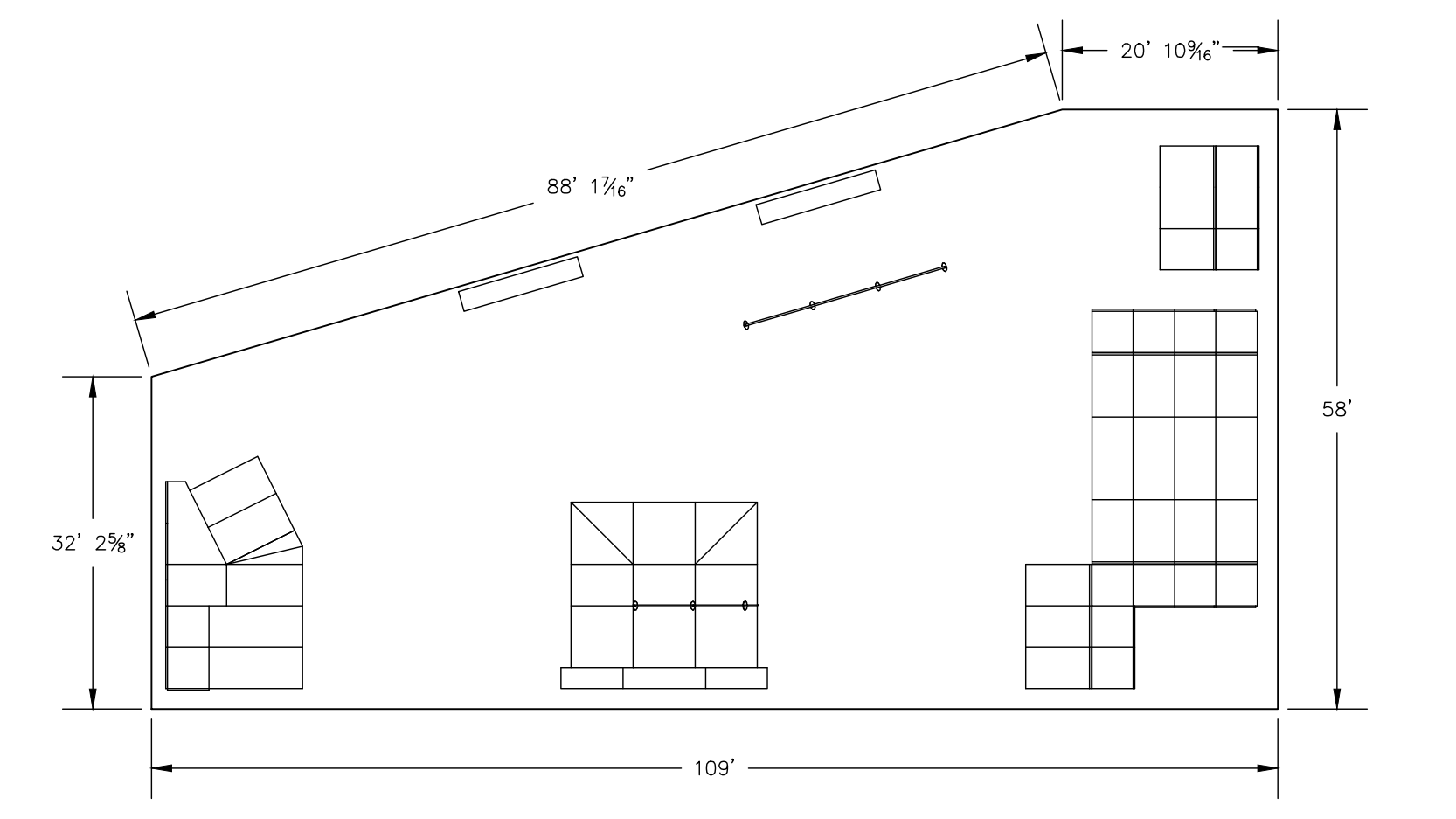

- GENERAL NOTES:**
- OWNER OF RECORD:
TOWN OF SCARBOROUGH
PO BOX 360
SCARBOROUGH, ME 04104
MAP R059, LOT 024; BOOK 1928, PAGE 181, DATED 11/12/1952
 - PLAN REFERENCE:
EXISTING FEATURES SHOWN HEREON ARE BASED UPON FIELDWORK PERFORMED BY ACORN ENGINEERING, INC. IN APRIL 2026.
 - DEED REFERENCE:
ADDIE H. WENTWORTH, F. HERBERT WENTWORTH, EMMA F. PHILLIPS, AURELIA E. TRIPP, AND ADA W. STUART TO MAINE SCHOOL BUILDING AUTHORITY, DATED OCTOBER 27, 1952, AND RECORDED AT THE CUMBERLAND COUNTY REGISTRY OF DEEDS IN BOOK 19249, PAGE 143.
 - AERIAL IMAGERY INCLUDED HEREON WAS DEVELOPED BY MICAH WARNOCK, GISP, RP, OF THE TOWN OF SCARBOROUGH USING A DJI MAVIC ENTERPRISE MULTISPECTRAL WITH RTK CAPABILITIES.
 - TOPOGRAPHIC INFORMATION SHOWN HEREON IS BASED UPON FIELDWORK PERFORMED BY ACORN ENGINEERING, INC. IN APRIL 2026.
 - THE WATER MAIN LOCATION SHOWN HERE WAS OBTAINED FROM THE SITE GRADING AND EROSION CONTROL PLAN FOR WENTWORTH INTERMEDIATE SCHOOL, DATED JANUARY 26, 2012 (SEE S-01).
 - THE PROJECT PARCEL IS LOCATED WITHIN THE TOWN AND VILLAGE CENTERS TRANSITION (TV2) ZONING DISTRICT PER THE TOWN OF SCARBOROUGH, MAINE ZONING AND OVERLAYS LAYER WITHIN THE TOWN OF SCARBOROUGH'S ONLINE GEOGRAPHIC INFORMATION SYSTEM (URL: [HTTPS://WWW.SCARBOROUGHMAINE.ORG/DEPARTMENTS/ENGINEERING-TECHNICAL-SERVICES/GIS](https://www.scarboroughmaine.org/departments/engineering-technical-services/gis))
 - THE PROJECT PARCEL AS DEPICTED HEREON FALLS WITHIN AN AREA OF MINIMAL FLOOD HAZARD AS DELINEATED ON FLOOD INSURANCE RATE MAP COMMUNITY-PANEL NUMBER 23005C0804F DATED JUNE 20, 2024, PUBLISHED BY THE FEDERAL EMERGENCY MANAGEMENT AGENCY (FEMA).

TREE SCHEDULE				
QTY	SYMBOL	BOTANICAL NAME	COMMON NAME	SIZE
3	AC	AMELANCHIER CANADENSIS	SHADBUSH	8-10' HT / MULTI-STEM
2	AR	ACER RUBRUM 'BOWHALL'	RED MAPLE	2.5-3" CALIPER
1	UA	ULMUS AMERICANA 'PRINCETON'	AMERICAN ELM	2.5-3" CALIPER



DRAFT
NOT ISSUED FOR
CONSTRUCTION

ISSUED FOR	BY
TOWN SKETCH PLAN	CAB
	07/20/24

SKATE PARK SITE PLAN
 PROJECT NAME: **KIPPY MITCHELL SPORTS COMPLEX SKATE PARK**
 TOWN OF SCARBOROUGH, MAINE
 259 U.S. ROUTE 1, SCARBOROUGH, MAINE 04070

ACORN ENGINEERING, INC.

THIS PLAN SHALL NOT BE MODIFIED WITHOUT WRITTEN PERMISSION FROM ACORN ENGINEERING, INC. ANY ALTERATIONS AUTHORIZED WITHOUT LIABILITY TO ACORN ENGINEERING, INC.

ACORN ENGINEERING, INC.
 FROM ACORN ENGINEERING, INC. ANY ALTERATIONS AUTHORIZED WITHOUT LIABILITY TO ACORN ENGINEERING, INC.
 PO BOX 3372, PORTLAND MAINE 04104
 (207) 775-2655

FILE: 1187.4_CIVIL
 JN: 1187.4
 SCALE: AS NOTED
 DESIGNED BY: CAB
 DRAWN BY: HLM
 CHECKED BY: CAB

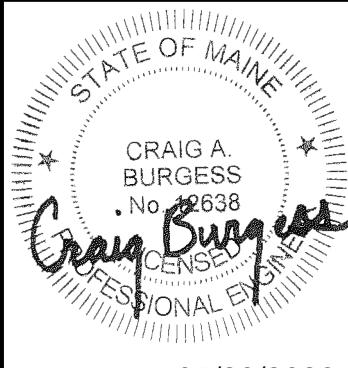

05/20/2026

DRAWING NO.
C-10