



# Strath Haven High School Renovation

## Facilities Committee Update

March 17, 2026





# Introductions

## CHA Solutions

- Jamie Lynch and Henry Guarriello



## KCBA Architects

- Mike Kelly, Ryan Orr, Stacy Thomas,  
and Miranda Esposito





# Progress to Date

- Regular design team meetings
  - Dr. Johnston, Mr. Maloney, & Mr. Benzing
- Gathered input from teachers & students on existing conditions
- Listening sessions and building tour with community



# Community Conversation

- Project priorities
- Building capacity analysis
- Community, staff, and student feedback
- Preliminary design concepts

# *Tonight, let's review our priorities?*



## Setting Priorities:

- Critical Priorities
- Major Priorities
- Desired Priorities
- Next time...



# Project Priorities

- **Safe, warm, dry infrastructure**
- **Permanent educational space to replace modular classrooms**
- **Key interior renovations that benefit students and teachers**

# Areas of Focus...



## Building Infrastructure:

- ✓ Roof replacement
- ✓ Replace existing boilers
- ✓ Replace existing chillers
- ✓ Replace classroom HVAC
- ✓ All plumbing comply w/ ADA
- ✓ Extend sprinklers throughout
- ✓ Replace most electrical
- ✓ New LED lighting throughout

# Areas of Focus...



## Educational Environments:

- ✓ Replace modular classrooms
- ✓ Enlarge science labs
- ✓ Create collaborative spaces
- ✓ More STEM opportunities located in heart of the school
- ✓ Enhance Life Skills & Special Education programs
- ✓ Enlarge music and art spaces
- ✓ Physical education spaces



MODEL OF EXISTING CAMPUS

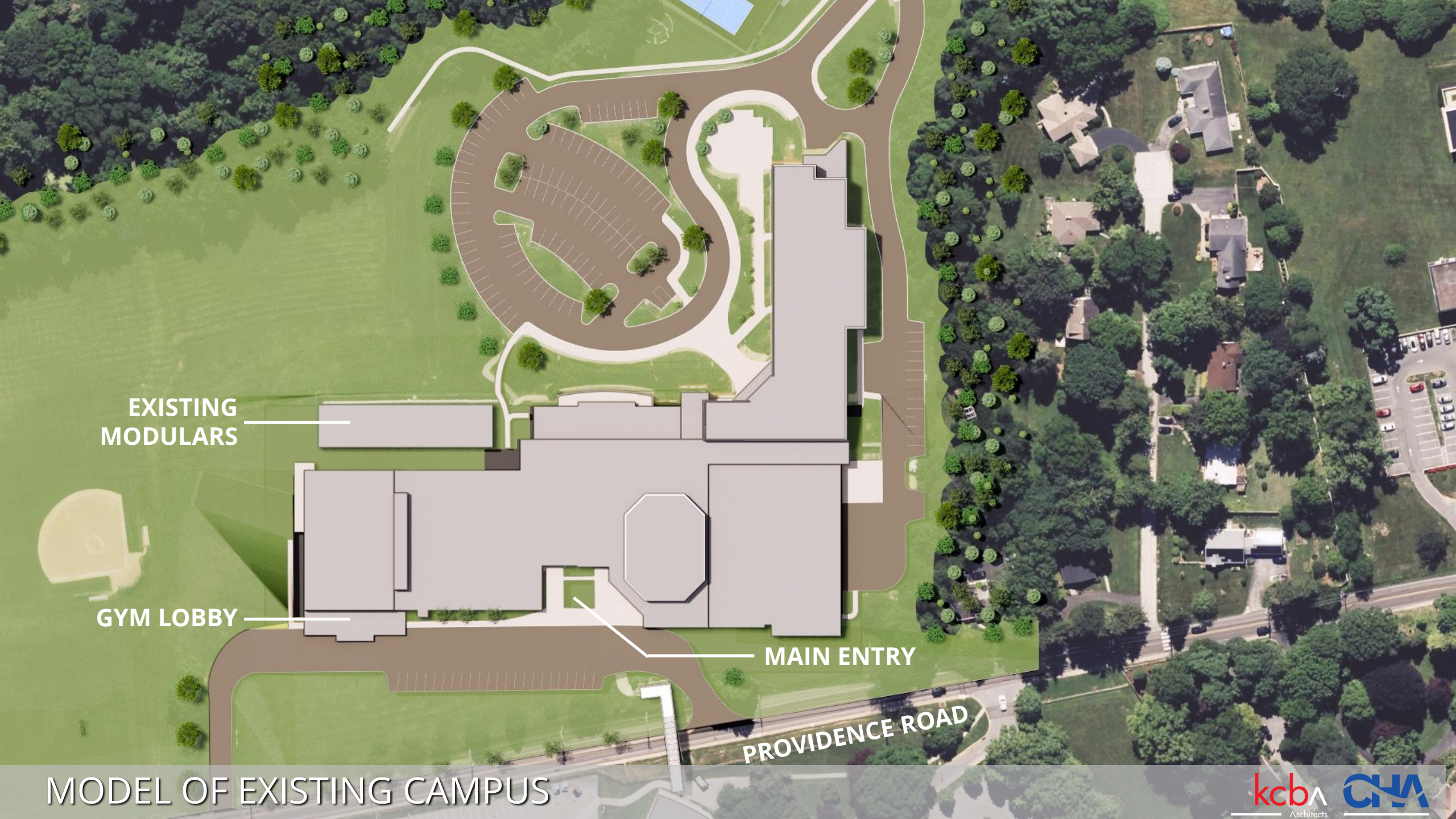

EXISTING  
MODULARS

GYM LOBBY

MAIN ENTRY

PROVIDENCE ROAD

MODEL OF EXISTING CAMPUS

ADDITIONAL PARKING

SEPARATE BUS LOOP

ATHLETIC  
ADDITION  
(PHASE TWO)

ACADEMIC  
ADDITION  
(PHASE ONE)

PROPOSED DROP-OFF  
PLAZA

RELOCATED PARKING

PROVIDENCE ROAD

# MODEL OF PROPOSED CAMPUS

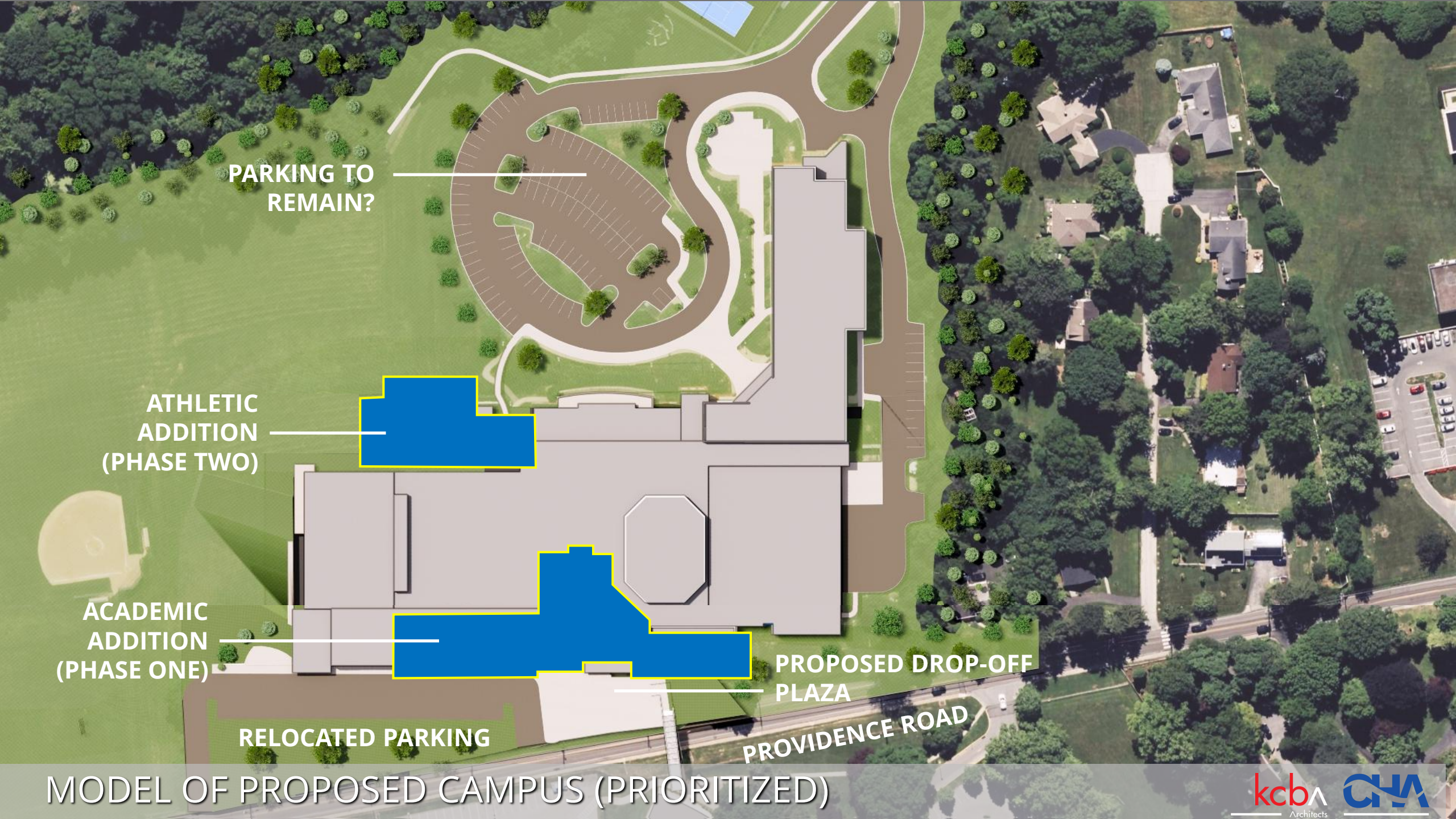

PARKING TO  
REMAIN?

ATHLETIC  
ADDITION  
(PHASE TWO)

ACADEMIC  
ADDITION  
(PHASE ONE)

PROPOSED DROP-OFF  
PLAZA

RELOCATED PARKING

PROVIDENCE ROAD

MODEL OF PROPOSED CAMPUS (PRIORITIZED)



**SELECT RENOVATION**

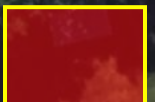

**ENHANCED RENOVATION**

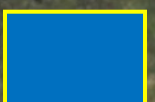

**NEW CONSTRUCTION**

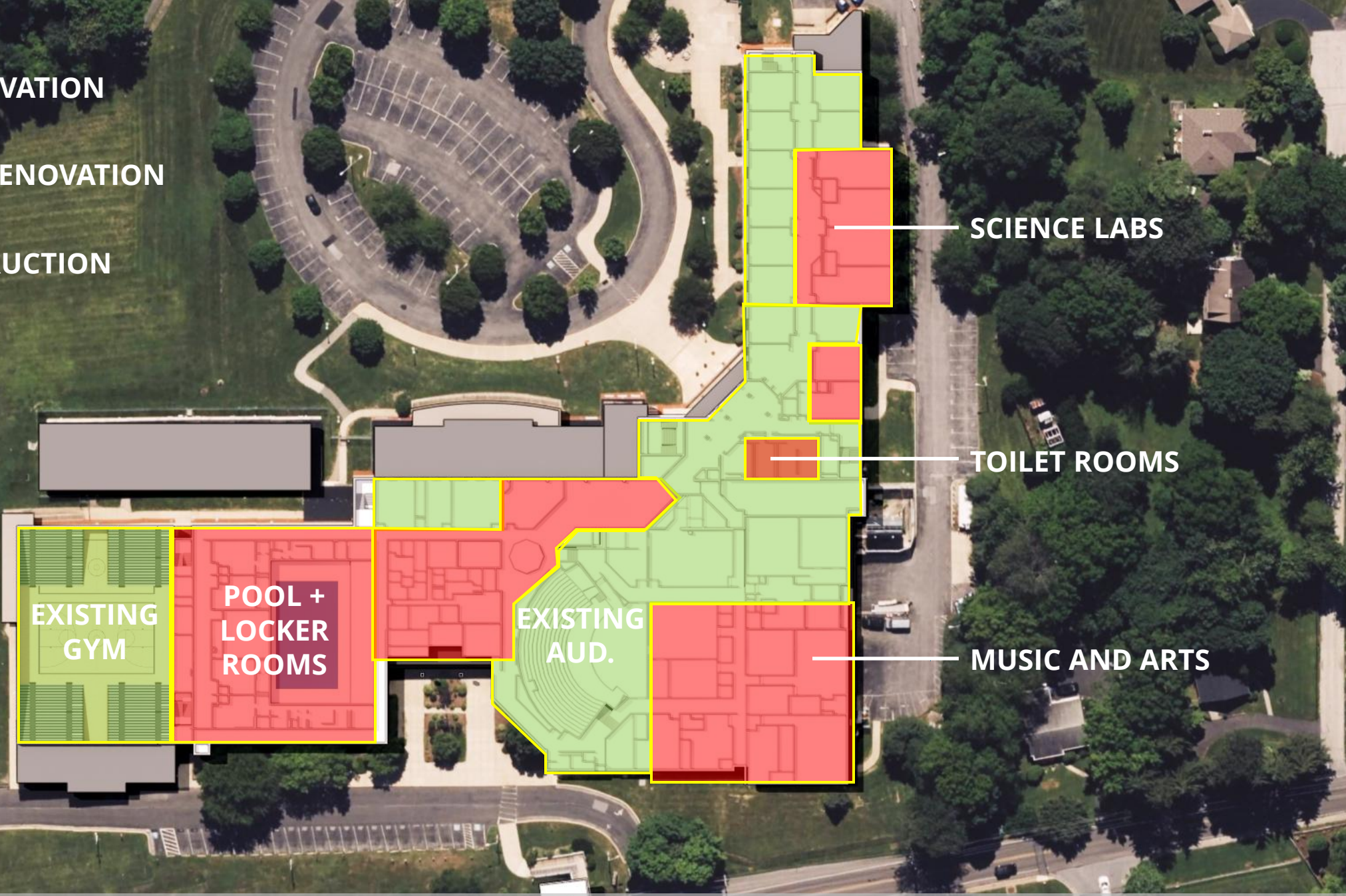

**MODEL OF EXISTING 3<sup>rd</sup> FLOOR PLAN**



**SELECT RENOVATION**



**ENHANCED RENOVATION**



**NEW CONSTRUCTION**

**BIDDING ALTERNATE?**

**ATHLETIC ADDITION (PHASE TWO)**

**EXISTING GYM**

**POOL + LOCKER ROOMS**

**EXISTING AUD.**

**ACADEMIC ADDITION (PHASE ONE)**

**LOBBY TO REMAIN**

**LEARNING COMMONS**

**ENLARGE LIFE SKILLS CLASSROOM**

**TOILET ROOMS**

**MUSIC AND ARTS**

**MODEL OF PROPOSED 3<sup>rd</sup> FLOOR PLAN**



# Critical Priorities

- Safe, warm, dry infrastructure
- Permanent educational space to replace modular classrooms

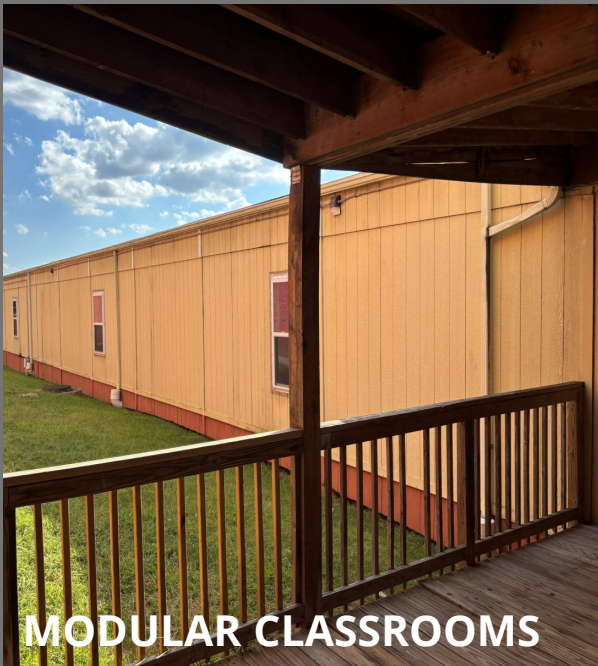
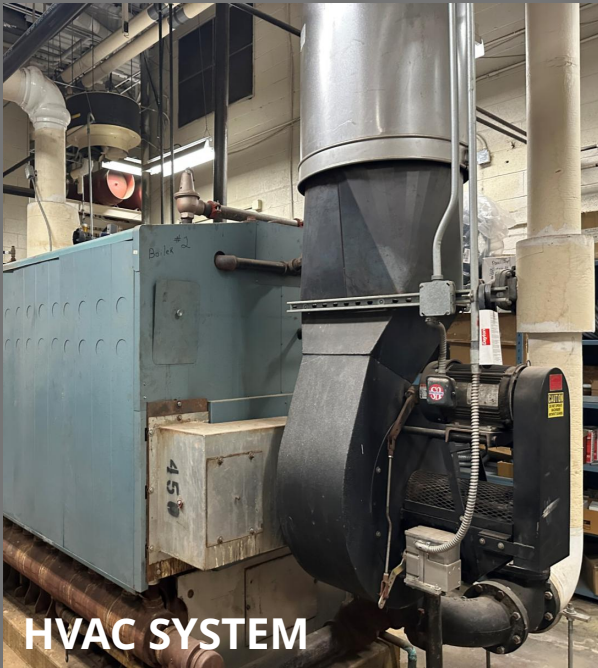



# Major Priorities



## Academics:

- Right sizing academic spaces
  - Science Labs
  - Life-skills and special education spaces
- Create shared learning labs, maker-spaces, and collaborative areas
- More natural light & collaborative areas
- Re-imagine media center as an active student space





LIFE SKILLS

T

CLASSROOM

FOCUS AREA – LIFE SKILLS EXISTING PLAN VIEW



LAUNDRY

TOILET

CLASSROOM

KITCHEN

APARTMENT

FOCUS AREA – LIFE SKILLS NEW PLAN VIEW



GYM  
ENTRY

PREP

MAIN  
ENTRY

FOCUS AREA – ACADEMIC ADDITION – EXISTING



FOCUS AREA – ACADEMIC ADDITION PLAN VIEW (FLOOR 3)

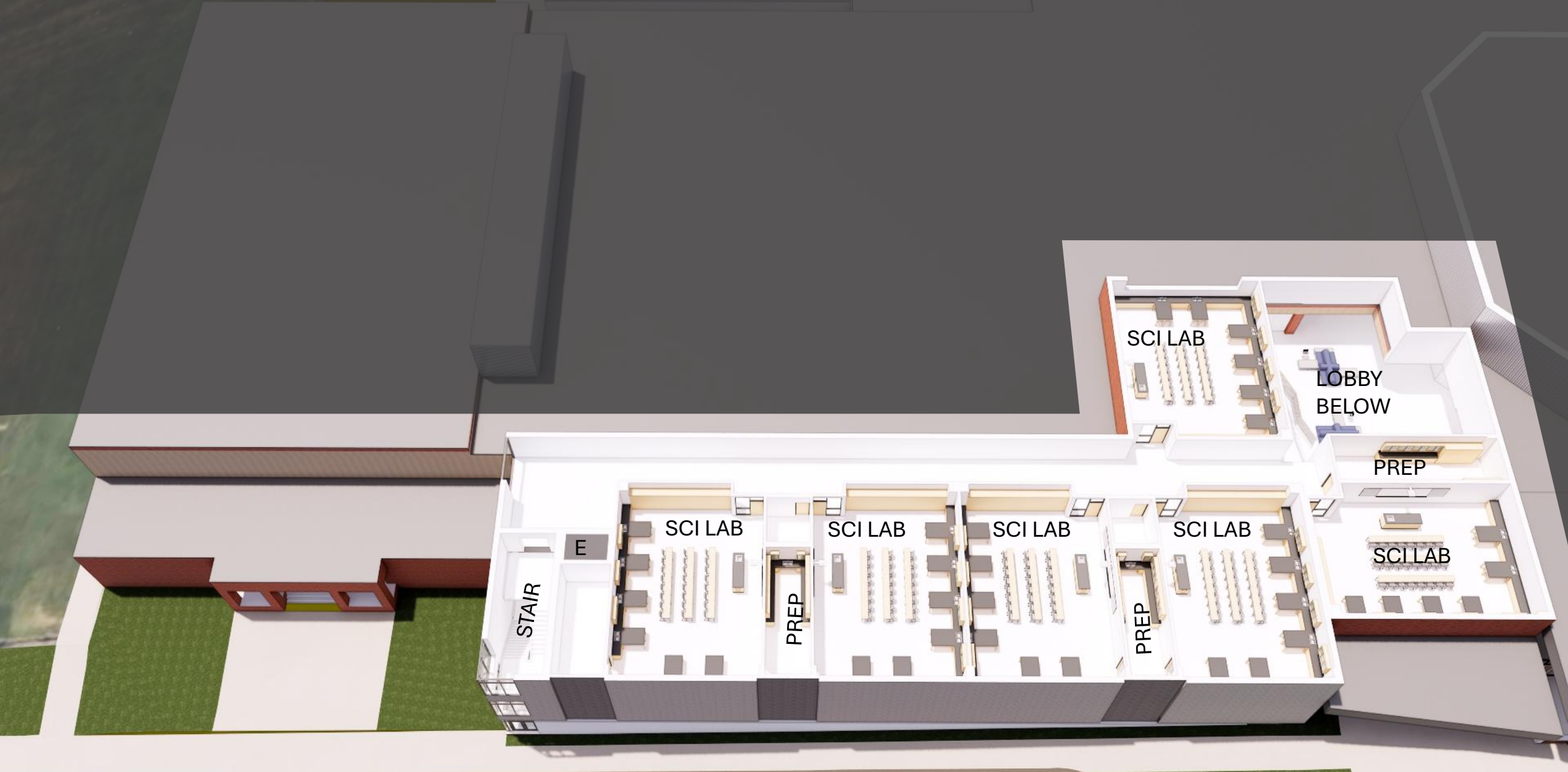

FOCUS AREA – ACADEMIC ADDITION PLAN VIEW (FLOOR 4)

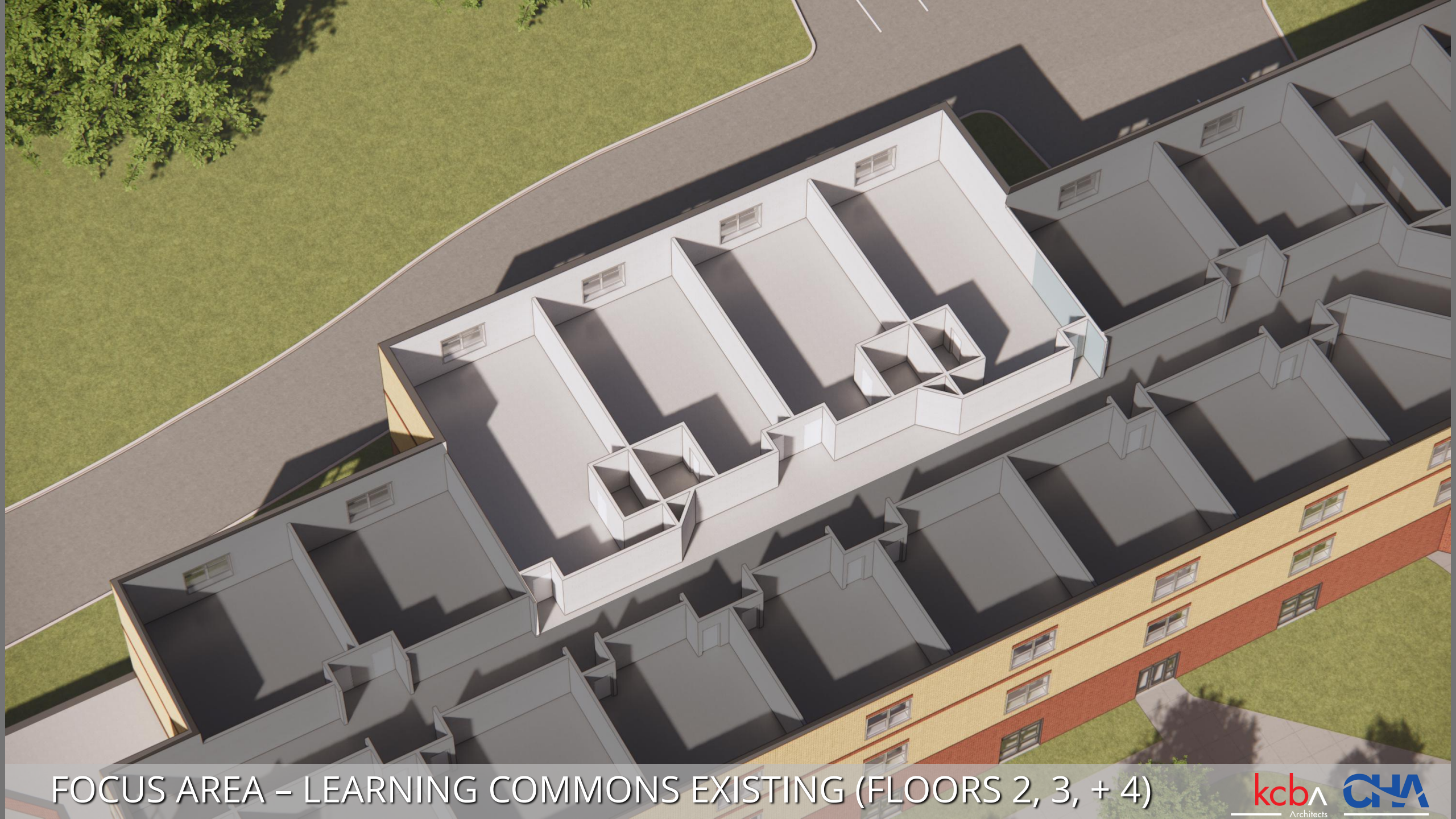

FOCUS AREA – LEARNING COMMONS EXISTING (FLOORS 2, 3, + 4)



FOCUS AREA – LEARNING COMMONS NEW (FLOORS 2, 3, + 4)



BEFORE



AFTER



AUDITORIUM



CHORUS



# Major Priorities

## Performing Arts:

- Upgrade sound equipment and lighting in the Auditorium
- Address acoustical separation between Auditorium and existing Chorus room
- Increase storage



FOCUS AREA – PERFORMING & VISUAL ARTS EXISTING PLAN VIEW

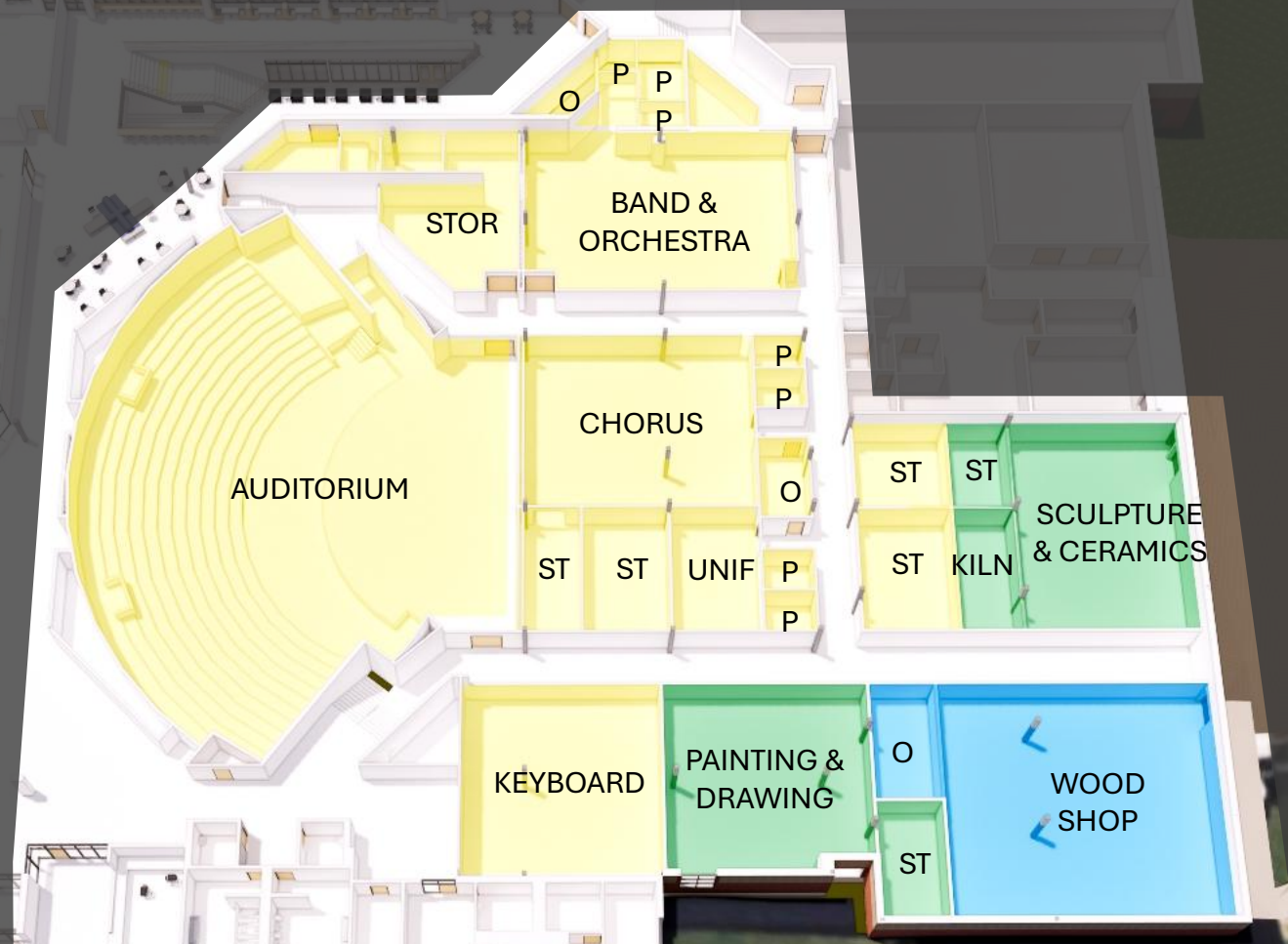

FOCUS AREA – PERFORMING & VISUAL ARTS NEW PLAN VIEW



# Major Priorities

## Athletics:

- Provide an auxiliary gym
- Additional physical education space needed
- Improve fitness/weight room facilities
- Address pool deferred maintenance items
- Increase storage



# Major Priorities



**NATATORIUM**

## Natatorium:

- Feasibility of facility upgrade confirmed
- Address deferred maintenance items
- Update perimeter overflow system for improved performance & safe pool access
- Upgrade filtration system for better water quality and safer chemical management



**SPECTATOR SEATING**



# Desired Priorities



- Expanded athletics addition
- Reconfigure parking for more spots and alternative bus drop off
- Outdoor learning area and expanded cafeteria seating





MODULAR CLASSROOMS

FOCUS AREA – ATHLETICS ADDITION - EXISTING PLAN VIEW

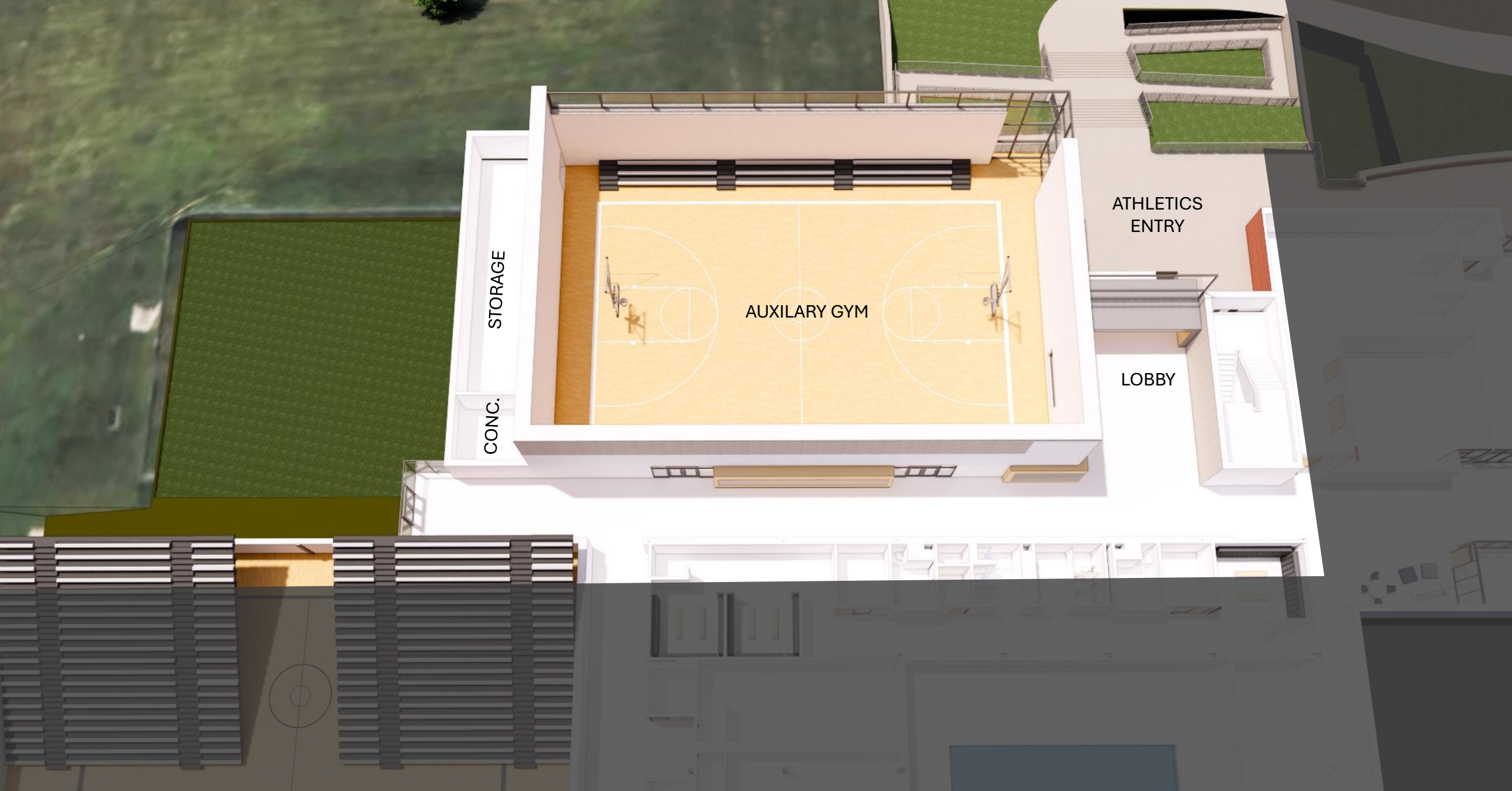

FOCUS AREA – ATHLETICS ADDITION PLAN VIEW



FOCUS AREA – EXPANDED ATHLETICS ADDITION - PLAN VIEW



# Next Steps

- Continued design committee meetings
- April 21<sup>st</sup> Facilities Committee Presentation
- April 27<sup>th</sup> School Board Consideration