



MINNEAPOLIS PUBLIC SCHOOLS  
Urban Education. Global Citizens.

MINNEAPOLIS PUBLIC SCHOOLS

MPS FY18 HENRY HIGH SCHOOL RENOVATIONS

4320 N NEWTON AVE  
MINNEAPOLIS, MN 55412

CONFORMED "AS-BID" DOCUMENTS



ARCHITECTURE  
PLANNING  
INTERIOR DESIGN

401 N. 2nd Avenue, Ste. 205  
Minneapolis, MN 55401  
www.wendelconsulting.com  
p:612.332.1401

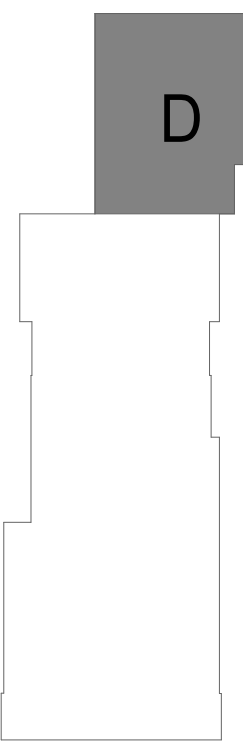

NOTES  
THIS DOCUMENT AND THE DESIGN AND CONSTRUCTION THEREOF ARE THE PROPERTY OF WENDEL CONSULTING, INC. AND WILL BE KEPT IN CONFIDENTIALITY BY THE USER.

REVISION	DATE	ADDENDUM NO.
1/09/2018	ADDENDUM NO. 1	
1/16/2018	ADDENDUM NO. 2	

DWG.

**BASEMENT/TUNNEL FLOOR PLAN - AREA D**

DATE	1/23/2018
SCALE	NTS
DWN	Author
CHK	DJG
PROJ. No.	100312
DWG. No.	

**AR-1104**

**1 BASEMENT/TUNNEL PLAN - AREA D**  
1/8" = 1'-0"