



BACH Associates, PC
ENGINEERS • ARCHITECTS • PLANNERS

304 White Horse Pike
Haddon Heights, New Jersey 08035
Tel: 856-546-8611
Fax: 856-546-8612
www.BachDesignGroup.com

SEALS:

STEVEN M. BACH, PE, RA, PP, PLS, CME
NJ PROFESSIONAL ENGINEER No. GE 41507
NJ REGISTERED ARCHITECT No. AI 14872
NJ PROFESSIONAL PLANNER No. LI 05557
NJ PROFESSIONAL SURVEYOR No. No. 43504

ALL DIMENSIONS MUST BE VERIFIED BY CONTRACTOR AND OWNER MUST BE NOTIFIED OF ANY DISCREPANCIES BEFORE PROCEEDING WITH THE WORK.

PROJECT:

AUDUBON FAMILY PARK
ALL INCLUSIVE PLAYGROUND
600 HAMPSHIRE AVENUE
AUDUBON, NEW JERSEY 08106
CAMDEN COUNTY, NEW JERSEY

ALL DOCUMENTS PREPARED BY BACH ASSOCIATES, PC ARE INSTRUMENTS OF SERVICE IN RESPECT OF THE PROJECT. THEY ARE NOT INTENDED OR REPRESENTED TO BE SUITABLE FOR REUSE BY OWNER OR OTHERS ON EXTENSIONS OF THE PROJECT OR ON ANY OTHER PROJECT. ANY REUSE WITHOUT WRITTEN VERIFICATION OR ADAPTATION BY BACH ASSOCIATES, PC FOR THE SPECIFIC PURPOSE INTENDED WILL BE AT OWNERS' SOLE RISK AND WITHOUT LIABILITY OR LOSS. EXPOSURE TO BACH ASSOCIATES, PC AND OWNER SHALL INDEMNIFY AND HOLD HARMLESS BACH ASSOCIATES, PC FROM ALL CLAIMS, DAMAGES, LOSSES AND EXPENSES ARISING OUT OF OR RESULTING THEREFROM.

REVISIONS		
NO.	DESCRIPTION	DATE

DRAWING TITLE:
ALL INCLUSIVE PLAYGROUND SITE PLAN

JOB NO: AB2025-01	DESIGNED BY: DM3
DATE: JANUARY XXXXXXX, 2026	DRAWN BY: DM3
SCALE: AS SHOWN	CHECKED BY: SMB
DRAWING NUMBER:	

SP-1

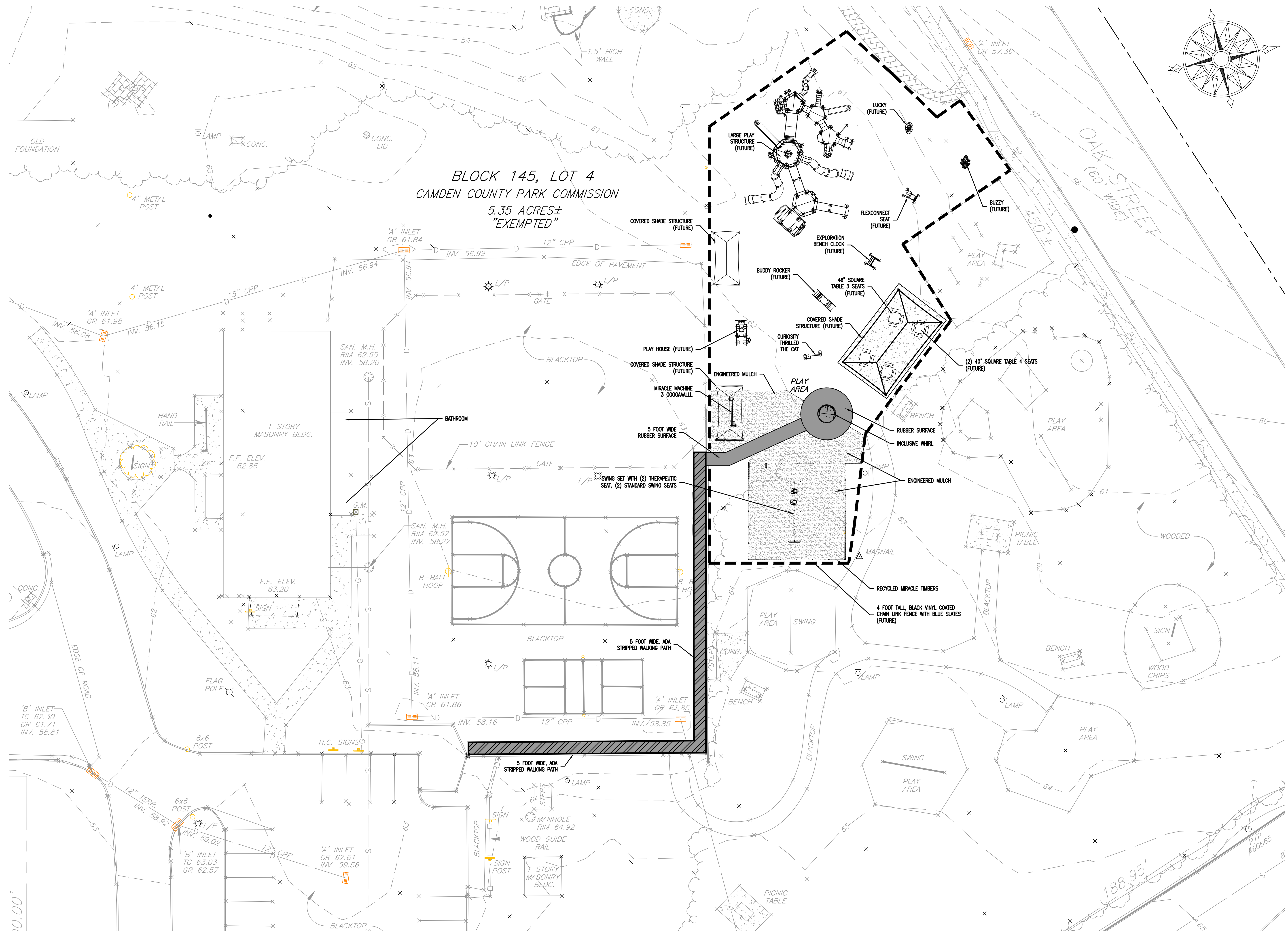

1 ALL INCLUSIVE PLAYGROUND SITE PLAN
SCALE: 1" = 16'