

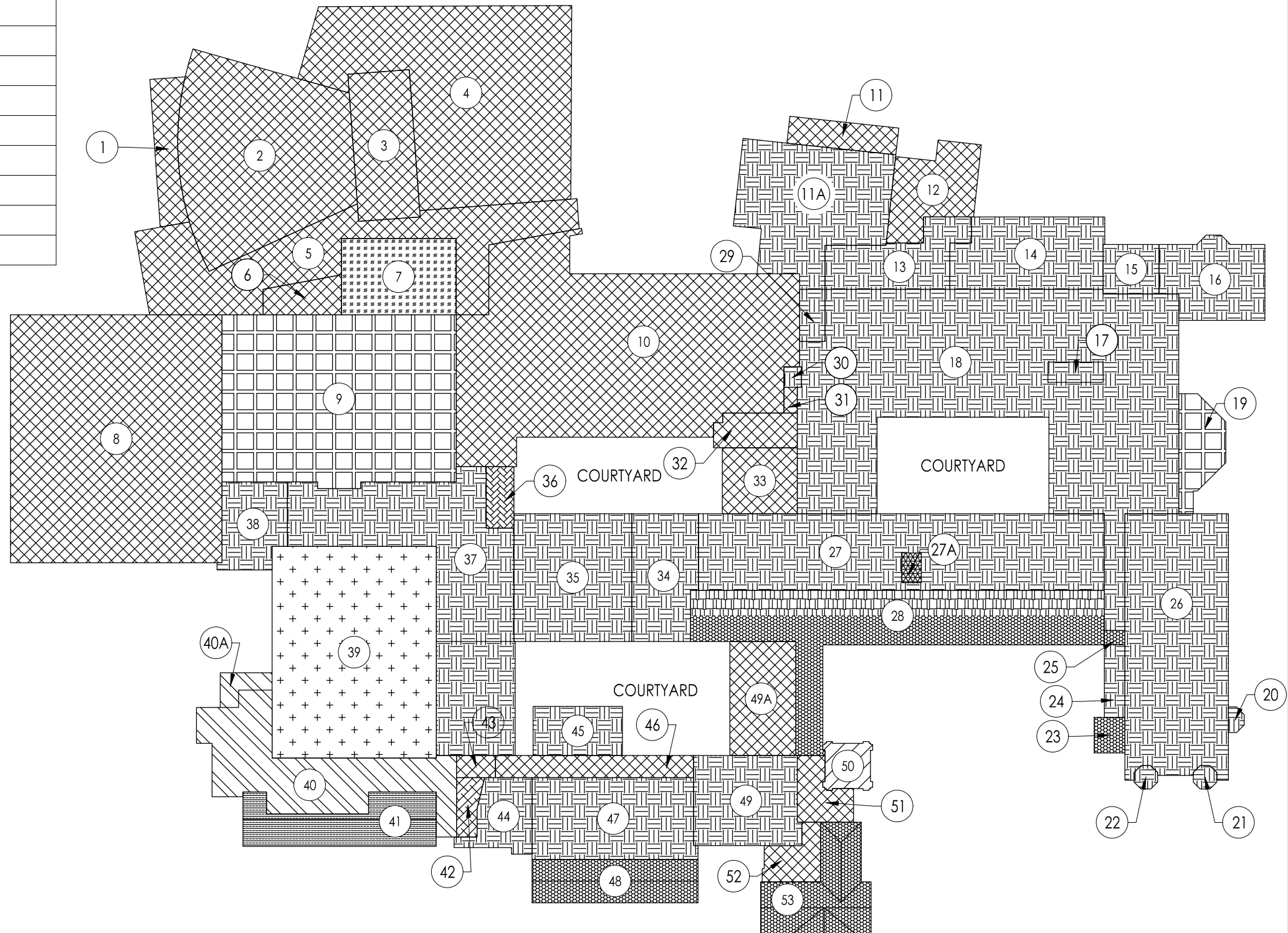



	PRJ. #	AREA	MANUFACTURER/ WARRANTY #	ROOFING SYSTEM	DATE INSTALLED	WARRANTY EXPIRATION	RECOMMENDED REPLACEMENT YEAR
	N/A	9,000 S.F. +/-	CARLISLE / 1151803	EPDM	07/14/2014	12/14/2034	2034
	N/A	4,917 S.F. +/-	VERSICO / 1586388	EPDM	08/31/2022	12/29/2042	2042
	N/A	11,169 S.F. +/-	CARLISLE / 1589122	EPDM	11/14/2022	02/12/2043	2043
	N/A	11,370 S.F. +/- BASED ON 1/2 SLOPE (ESTIMATED)	UNKNOWN	SLATE	UNKNOWN	UNKNOWN	TBD
	N/A	76,536 S.F. +/-	GARLAND? / 24-1271-US	RESTORATION	2024 ?	2044 ?	2044 ?
	N/A	68,315 S.F. +/-	CARLISLE ? / 1661653	EPDM	2024 ?	2044 ?	2044 ?
	N/A	342 S.F. +/-	UNKNOWN	EPDM	UNKNOWN	UNKNOWN	TBD
	N/A	434 S.F. +/-	ATRIUM STYLE GLAZING	UNKNOWN	UNKNOWN	UNKNOWN	TBD
	N/A	3,837 S.F. +/-	UNKNOWN	ASPHALT SHINGLES	2021	2051 ?	TBD
	N/A	150 S.F. +/-	METAL	UNKNOWN	UNKNOWN	UNKNOWN	TBD
	N/A	2,995 S.F. +/- BASED ON 1/2 SLOPE (ESTIMATED)	UNKNOWN	SYNTHETIC SLATE	UNKNOWN	UNKNOWN	TBD
	N/A	3,173 S.F. +/- BASED ON 1/2 SLOPE (ESTIMATED)	UNKNOWN	ASPHALT SHINGLES	2004 ?	2034 ?	TBD



Solar PV system may only be installed on the following roof areas available:
Areas: 1, 2, 3, 4, 5, 6, 8, 9, 10, 11,, 11A, 12, 13, 14, 15, 16, 17, 18, 19, 20, 21, 22, 24, 26, 27, 29, 30, 31, 32, 33, 34, 35, 37, 38, 40, 40A, 43, 44, 45, 46, 47, 49, 49A, 51, 52

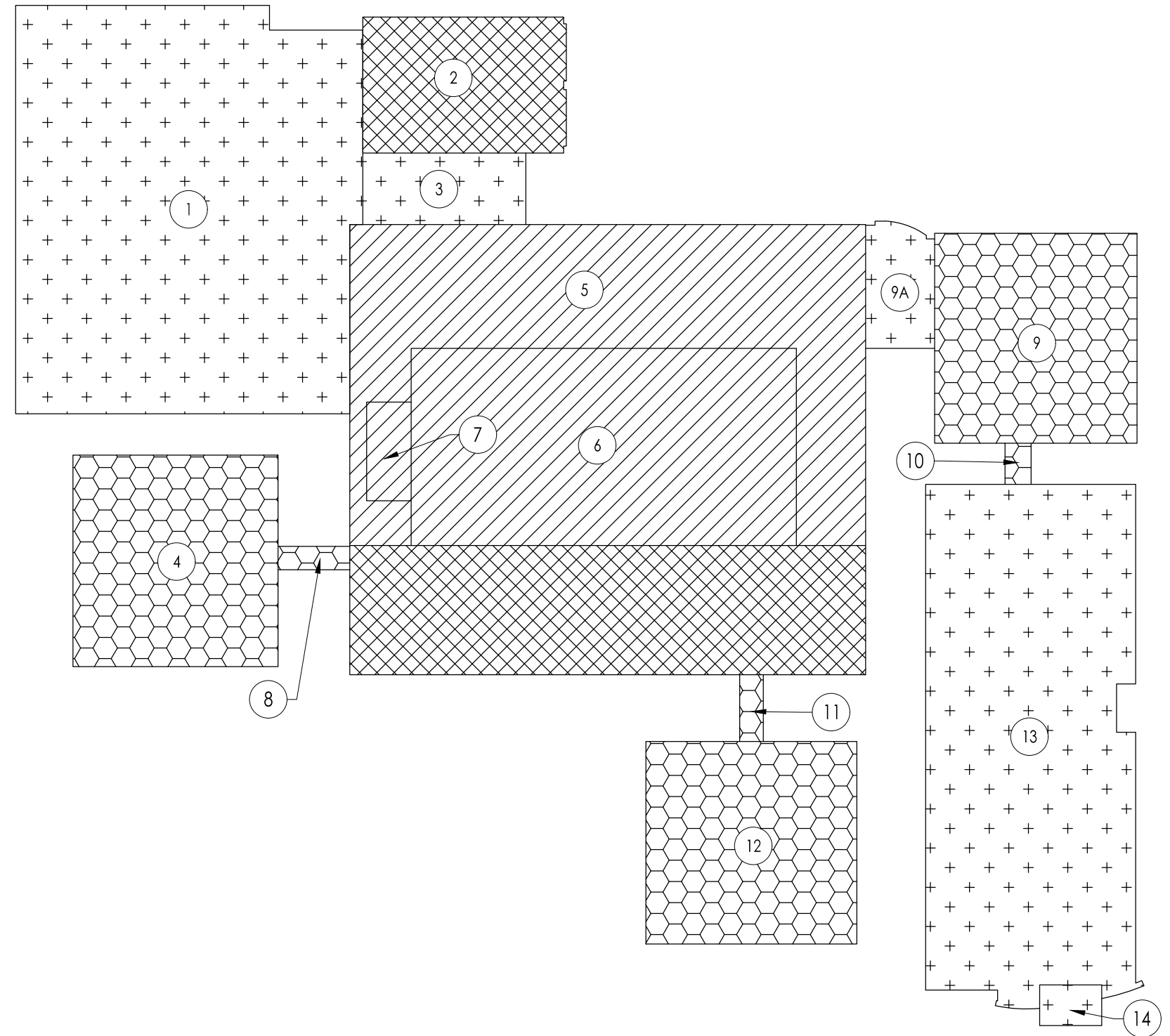

	PRJ. #	AREA	MANUFACTURER/ WARRANTY #	ROOFING SYSTEM	DATE INSTALLED	WARRANTY EXPIRATION	RECOMMENDED REPLACEMENT YEAR
	N/A	11,988 S.F. +/-	CARLISLE / 1017622	EPDM	09/14/2007	09/16/2027	2027
	N/A	23,991 +/- S.F.	CARLISLE / 1040923	EPDM	08/26/2008	08/26/2028	2028
	N/A	29,889 S.F. +/-	CARLISLE / 1129174	EPDM	08/27/2013	01/07/2034	2034
	N/A	47,882 S.F. +/-	GARLAND / 24-1277-US	LIQUITEC W/ FABRIC OVER AN EXPIRED FLEX TPO ROOF SYSTEM	10/31/2023	10/31/2043	2043

**Solar PV system may only be installed on the following roof areas available:
 Areas: 1, 3, 9A, 13, 14**

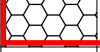

	PRJ. #	AREA	MANUFACTURER/ WARRANTY #	ROOFING SYSTEM	DATE INSTALLED	WARRANTY EXPIRATION	RECOMMENDED REPLACEMENT YEAR
	N/A	4,000 S.F. +/-	CARLISLE / 1115410	EPDM	08/29/2012	09/03/2032	2032
	N/A	3,707 S.F. +/-	CARLISLE / 1151815	EPDM	07/18/2014	12/14/2034	2044
	N/A	36,000 S.F. +/-	CARLISLE / 1589120	EPDM	11/14/2022	01/30/2043	2043

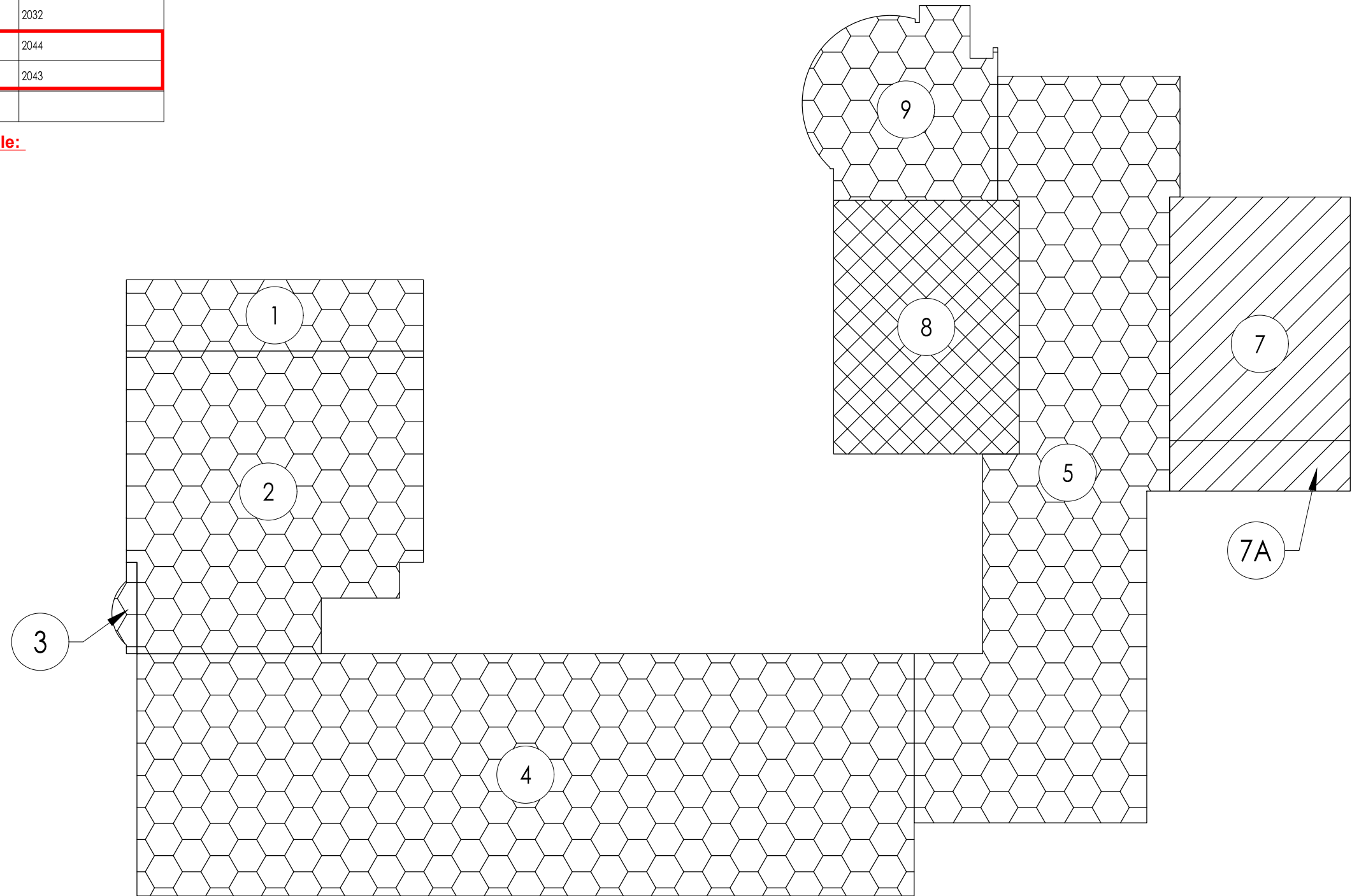

**Solar PV system may only be installed on the following roof areas available:
 Areas: 1, 2, 3, 4, 5, 8, 9**



	PRJ. #	AREA	MANUFACTURER/ WARRANTY #	ROOFING SYSTEM	DATE INSTALLED	WARRANTY EXPIRATION	RECOMMENDED REPLACEMENT YEAR
+	N/A	39,616 S.F.	CARLISLE / 1151813	EPDM	10/30/2014	12/14/2034	2034
+	N/A	6,443 S.F.	CARLISLE / 1653080	EPDM	09/13/2024	09/24/2044	2044
+	N/A	7,148 S.F.	GARLAND / LIQUITEC / 24-0807-US	RESTORATION	08/28/2024	08/28/2044	2044

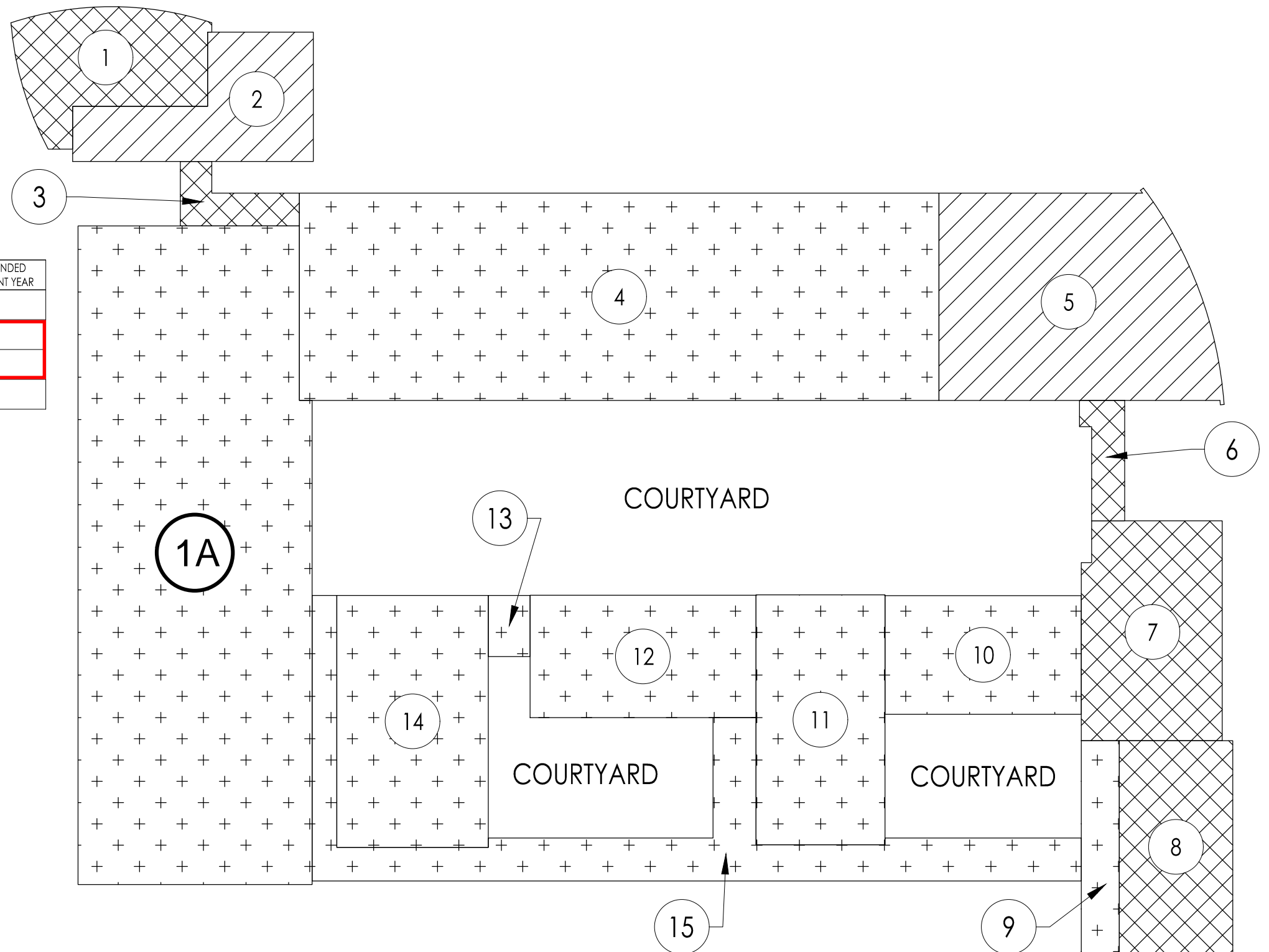

Solar PV system may only be installed on the following roof areas available:
Areas: 1, 2, 3, 5, 6, 7, 8

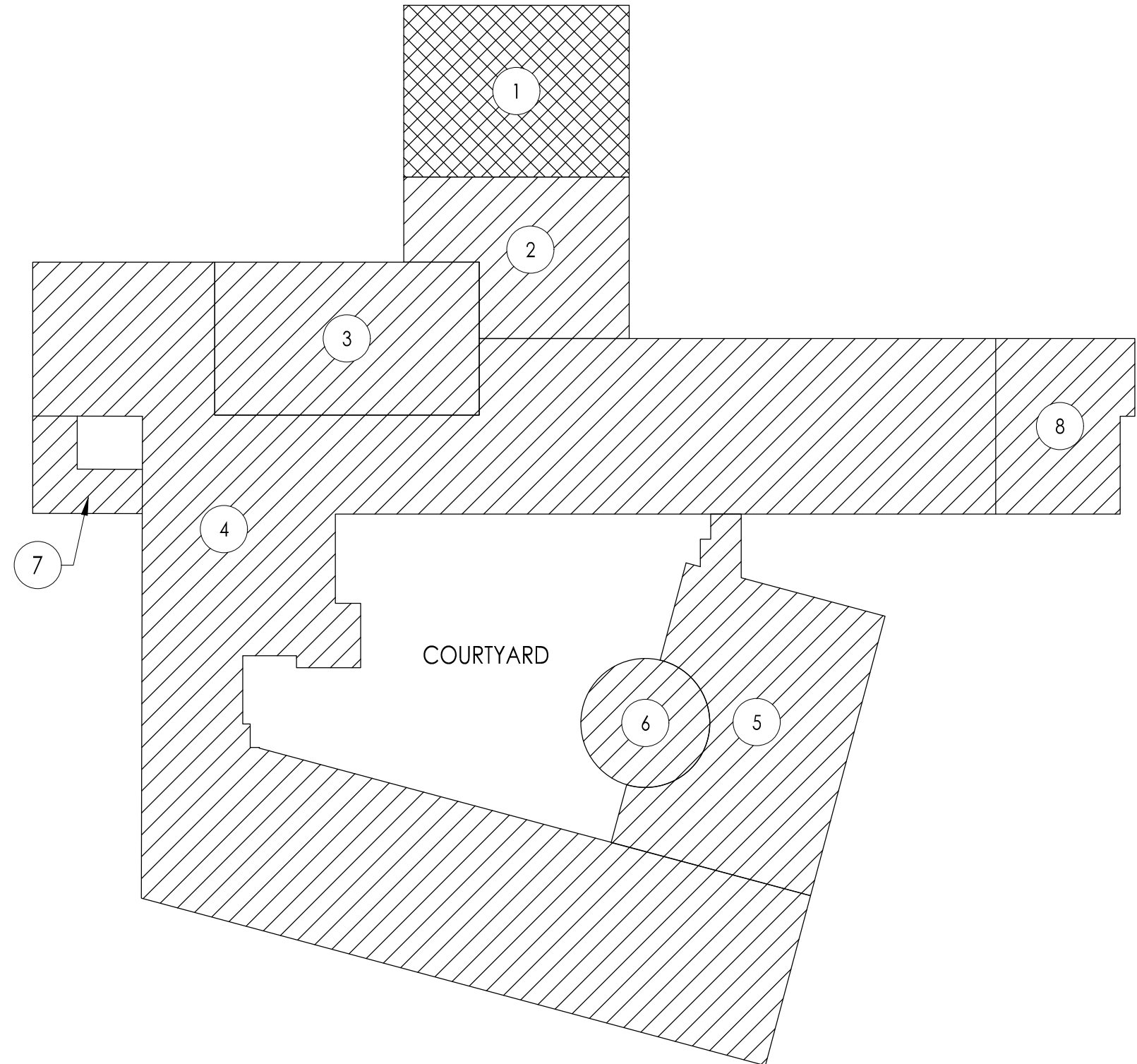

	PRJ. #	AREA	MANUFACTURER/ WARRANTY #	ROOFING SYSTEM	DATE INSTALLED	WARRANTY EXPIRATION	RECOMMENDED REPLACEMENT YEAR
	N/A	54,470 S.F. +/-	VERSICO / 1592181	EPDM	11/14/2022	02/12/2043	2043
	N/A	4,423 S.F. +/-	GARLAND/ 22-0655-US	TPO/ LIQUITEC	11/07/2022	11/07/2042	2042

**Solar PV system may only be installed on the following roof areas available:
 Areas: 1, 2, 3, 4, 5, 6, 7, 8**

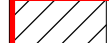

	PRJ. #	AREA	MANUFACTURER/ WARRANTY #	ROOFING SYSTEM	DATE INSTALLED	WARRANTY EXPIRATION	RECOMMENDED REPLACEMENT YEAR
	N/A	20,190 S.F. +/-	UNKNOWN	METAL	1991	UNKNOWN	TBD
	N/A	18,719 S.F. +/-	CARLISLE / 1653227	EPDM	09/13/2024	09/24/2044	2044
	N/A	26,887 S.F. +/-	GARLAND / LIQUITEC / 24-0807-US	RESTORATION	08/28/2024	08/28/2044	2044

Solar PV system may only be installed on the following roof areas available:
Areas: 9, 13, 14, 15, 16, 17, 18, 19, 20, 21, 22

