



FACILITIES ADVISORY COMMITTEE

January 29, 2026 | 6:00 PM | Lakes Elementary Library

AGENDA



-
- | | |
|-----------------------------------------------|-----------------|
| 1. Welcome | Sean Dotson |
| 2. Overview of Ongoing Projects | Tony Matiatos |
| 3. Capital Projects Planning & Prioritization | Sean Dotson |
| 4. Tour of Lakes Elementary | Taylor Swedberg |

Next meeting: March 12, 2026 | 6:00 – 7:00 PM | RMAC

JANUARY 2026

FACILITY
ADVISORY
COMMITTEE



River Ridge HS Modernization



River Ridge High School Schedule



PHASE 2 – Recently Completed (Winter Break)

- New music spaces
- New administration area
- Initial Phase – CTE building
- New student parking and Hoh Street connection

PHASE 3 – Started January 2026

- Renovation of theater
- Renovation Continues at CTE building
- Demolition of Houses B, C, &, D
- New football and softball fields



River Ridge High School

Nisqually Basin



RRHS New Admin Area





RRHS New Counseling Center

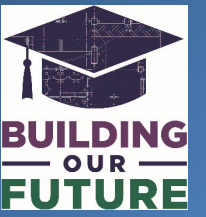

RRHS CTE Classroom & Career Center

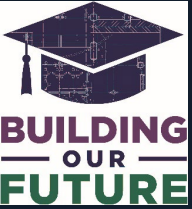

Bower Learning Center Voice Program

New Office Space

New Paint

New Toilets

New Life Skills room



BLC VOICE Program

Life Skills



BLC – Voice Assembly Area Vocational Opportunities Independent Community Employment Program



Bower Learning Center Summit Virtual Academy





IGNITE FAMILY ACADEMY
FAMILY & YOUTH RESOURCE CENTER
STUDENT RECORDS & ARCHIVES
SOUTH SOUND READING FOUNDATION

Welcome to
Ignite Family
Academy!

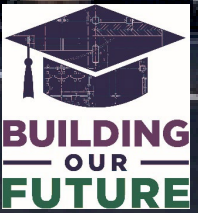

RMAC South Project Ignite Family Academy Classroom & Commons





RMAC South Project Ignite Family Academy – Family Area

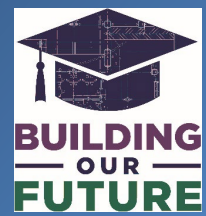



RMAC South Project
Ignite Family Academy Main Lobby

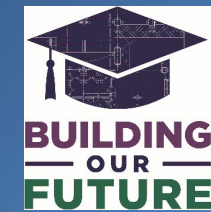

RMAC South Project South Sound Reading Foundation



RMAC South Project Family Resource Center

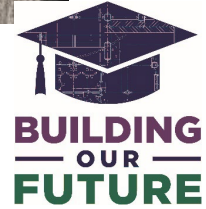

RMAC South Project – FYR Center New Kids Closet



RMAC South Project

New Archives Center



LEAF Center

Bid opening for sub-
contractors – Jan 28th- 29th

Finalizing permits

Construction starting March
2026

Opening Sept 2027





Nisqually MS

- Chiller Piping Improvements

Lacey ES
New dishwasher

Lydia Hawk ES
New dishwasher
and disposal



Thank you!



Facilities Advisory Committee

January 29, 2026



Facilities Advisory Committee

Advise the district in developing an updated Six-Year Capital Facilities Plan by reviewing the following:

- School district enrollment history and projections
- Present and future educational program needs
- City/County population data and growth projections
- Community development information
- Existing school capacity information
- Review of school district property available for development
- Existing school facility needs assessment data
- Capital funding options and information
- Input from students, parents, citizens, and staff
- Available Survey/Polling information



Capital Projects Planning & Prioritization

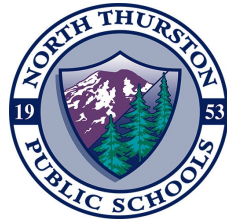

Current Projects List

Includes over 200 Projects

Cost Range: \$15,000 to over \$50M



Prioritization of Capital Projects

Regular meetings to prioritize projects considering:

- Commitments to voters
- Urgency
- Time and cost efficiency
- Evolving long-term plans
- Pace and types of funding available
- Other Practical Considerations



Prioritization of Capital Projects

Commitments to voters

- Identified in bond or levy resolutions
- Shared with patrons in presentations



Prioritization of Capital Projects

Urgency

- Student/Staff Safety
- Warm & Dry



Prioritization of Capital Projects

Time and Cost Efficiency

- Can we obtain efficiency by combining multiple projects?
- Will we save money by timing a project in a particular way?
- Is one project reliant on another?
- What is the timeframe to complete a project?



Prioritization of Capital Projects



Evolving long-term plans

- Do we anticipate other projects at the same site that would make the planned project an inefficient use of funds?
- Have enrollment projections or program needs changed since the project was proposed?
- Will inflation impact our ability to complete all proposed projects?



Prioritization of Capital Projects

Pace and types of funding available

- Bond Funds
- Impact Fees
- Capital Levy



Prioritization of Capital Projects

Other Practical Considerations

- Can we get necessary permits in time?
- Will students/programs need to be moved?
- Can it be completed over a summer?



Prioritization of Capital Projects

Inflation

We factor for inflation when planning, but when costs escalate higher than expected, we have to adjust the scope of work we can complete.



Feedback?



Study & Survey

Long-range educational facilities planning process that identifies projected needs and facilities priorities based upon a variety of factors (enrollment projections, current facilities conditions, need to modernize and/or replace facilities, etc).

WAC 329-341-025



Lakes Elementary

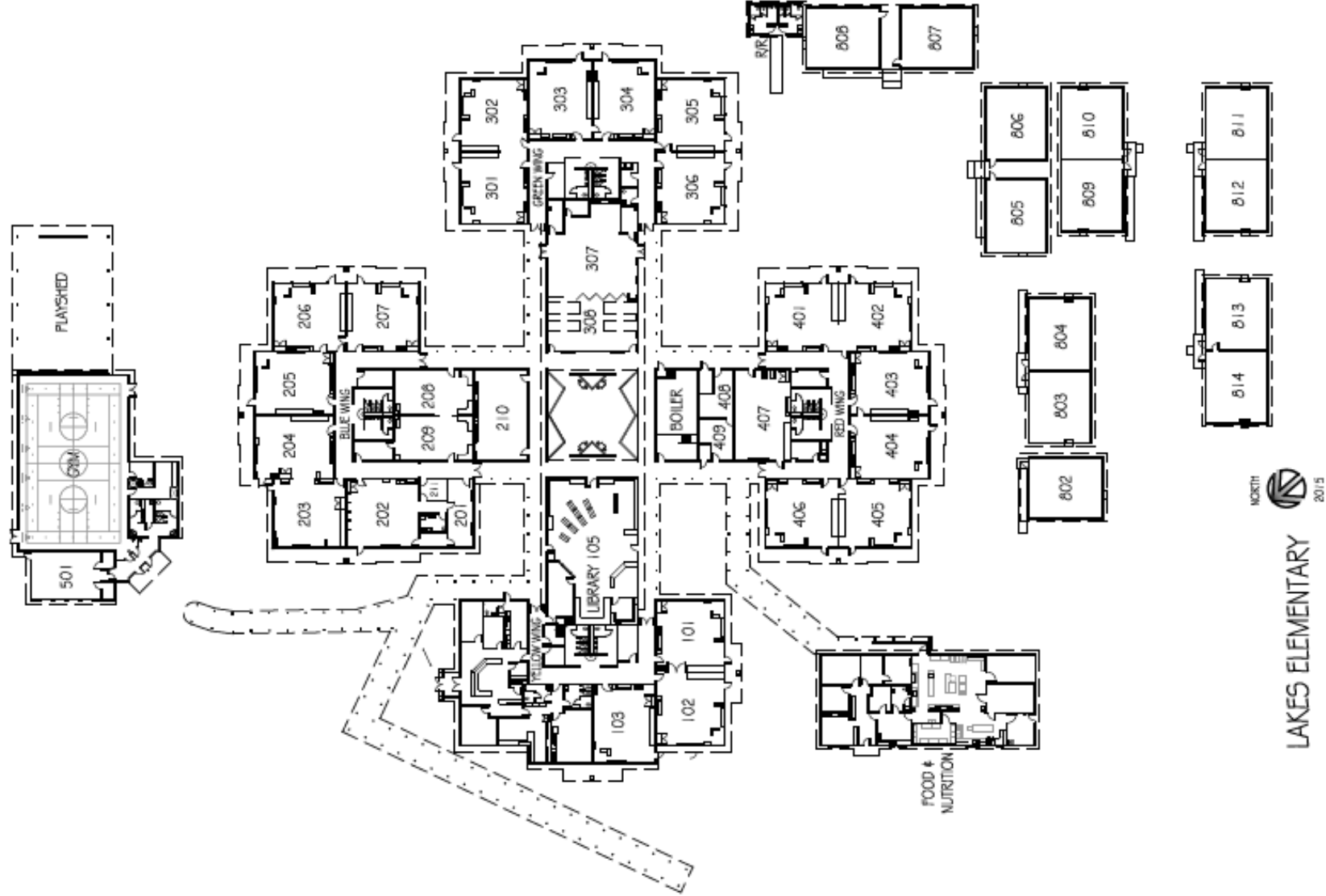

LAKES ELEMENTARY



EXPECT GREAT THINGS!



Facilities Advisory Committee Meeting Notes

January 29, 2026

Lakes Elementary School

6:00 PM

Attendees: Amy Blondin, Casey Crawford, Sean Dotson, Karen Edwards, Jason Greer, Jennifer Hancock, Heather Larson, Gretchen Maliska, Tony Matiatos, Scott McCormick, James Murray, Troy Oliver, Lynley Olson, Cyrus Overbey, James Stanton, Sarah Tracy.

Welcome: Sean Dotson, Assistant Superintendent of Operations welcomed attendees.

Overview of Ongoing Projects

Tony Matiatos, Director of Construction and Design shared a presentation reflecting the following construction updates:

- River Ridge High School - Modernization project review
- Bower Learning Center & VOICE Program - New office spaces
- RMAC South Project Completion:
 - Ignite Family Academy
 - South Sound Reading Foundation
 - Family & Youth Resource Center
 - Student Records & Archives
- Lacey Education And Family (LEAF) Center - Key dates
- Nisqually Middle School - Chiller piping improvements
- Lacey Elementary – New dishwasher
- Lydia Hawk Elementary – New dishwasher and disposal

Capital Projects Planning and Prioritization

Sean Dotson presented an overview of the district's Capital Projects Planning and Prioritization process, including the methodology used to develop an updated Six-Year Capital Facilities Plan. The presentation outlined the data sources and inputs reviewed as part of this work, including enrollment history and projections; current and future educational program needs; city and county population data and growth projections; community development information; existing school capacity; district-owned property

available for development; facility needs assessment data; capital funding options; and input gathered from students, parents, community members, and staff, as well as available survey and polling data.

Tour of Lakes Elementary

Taylor Swedberg, Principal of Lakes Elementary led the committee on a tour of Lakes.

The meeting adjourned at 7:05 PM