

J.C. Broderick & Associates, Inc.

Environmental / Construction Consulting & Testing



December 26, 2025

Mr. Severino Fasulo
Syosset Central School District
99 Pell Lane
Syosset, New York 11791

Re: Perform Professional Consulting and Environmental Sampling and Testing for Radon in Air at:

**Site: Baylis Elementary School
580 Woodbury Road
Plainview, New York 11803
Site Visits: December 16 & 19, 2025**

JCB#: 25-62202

Dear Mr. Fasulo:

J.C. Broderick and Associates, Inc. (JCB) was retained by the Syosset Central School District (SCSD) to perform environmental sampling for indoor radon gas within the above referenced school building. The radon sampling was performed by experienced JCB representatives on the above referenced dates following the American National Standards Institute (ANSI)/American Association of Radon Scientists and Technologists (AARST) *Protocol for Conducting Measurements of Radon and Radon Decay Products in Multifamily, School, Commercial and Mixed-Use Buildings* MA-MFLB-2023, effective date December 1, 2023, guidance document. The site visits consisted of the following:

- Collection of radon in air samples from 42 locations within occupied rooms in contact with the ground at the above referenced school building.
- Submission of designated samples to an independent New York State Department of Health (NYSDOH) Environmental Laboratory Approval Program (ELAP) certified laboratory for radon in air analysis.
- Review and compare the laboratory results to the ANSI/AARST *Protocol for Conducting Measurements of Radon and Radon Decay Products in Multifamily, School, Commercial and Mixed-Use Buildings* MA-MFLB-2023, effective date December 1, 2023.

Summary of Sample Collection, Field Screening and Sample Submission

The following section summarizes the environmental sampling performed. Please refer to attachments located at the end of this report for additional details.

- On December 16, 2025, a total of 49 short-term radon test kits were deployed in 42 strategic occupied spaces located throughout the above referenced school building. It should be noted that a sample and sample blank was not deployed in AHERA space 1055, the guard booth. The test kits remained within

December 26, 2025

Mr. Severino Fasulo of Syosset CSD

Perform Professional Consulting and Environmental Sampling and Testing for Radon in Air at:

Baylis Elementary School

580 Woodbury Rd., Plainview, NY 11803

Site Visits: December 16 & 19, 2025

JCB#: 25-62202

the given space for a period of three (3) days. A select number of samples served as a duplicate or remained closed as a field blank for QA/QC compliance.

- The area around each test kit location was field screened for the presence of total volatile organic compounds utilizing a MiniRAE 3000 Portable photo-ionization detector (PID). Technical data pertaining to the MiniRAE 3000 Portable PID is available upon request.
- On December 19, 2025, a total of 48 short-term radon test kits were retrieved, sealed and assigned individual identification numbers. It should be noted that the sample in classroom C9 was not retrieved. Chain of custody documents were prepared, and the samples were then delivered to an independent New York State Department of Health (NYSDOH) Environmental Laboratory Approval Program (ELAP) accredited radon laboratory for analysis. Prior to sample retrieval, temperature and humidity were recorded utilizing an OXV Thermo-Hygrometer meter.

Quality Assurance and Quality Control (QA/QC) Procedures

To ensure that measurement results are reliable, JCB performed duplicate and laboratory blank sampling in eight (8) selected spaces. JCB representatives maintained a radon sampling chain of custody used to track samples from sampling point to analysis which summarized the following:

- Sample identification;
- Test Kit ID number;
- Device ID number;
- Sampling beginning date and time;
- Sampling ending date and time;
- Temperature, °F;
- Humidity, %.

Summary of Laboratory Analysis

Please refer to the tables located in Attachment #1 for a summary of submitted samples and laboratory analysis results.

- The laboratory analytical results for the radon in air samples were reviewed and compared to the ANSI/AARST *Protocol for Conducting Measurements of Radon and Radon Decay Products in Multifamily, School, Commercial and Mixed-Use Buildings* MA-MFLB-2023, effective date December 1, 2023, which establishes a radon in air action concentration level of 4.0 pCi/L.
 - The laboratory analysis results from the Radon in Air samples submitted **did not** reveal any elevated concentrations of radon exceeding 4.0 pCi/L, the referenced action level. The highest recorded radon concentration was in space 2035 at a concentration of 1.9 pCi/L, well below the 4.0 pCi/L action level.
- EMSL Analytical Inc. (EMSL) of Cinnaminson, New Jersey provided laboratory analytical services. Copies of EMSL's NYSDOH certifications are available upon request.

December 26, 2025

Mr. Severino Fasulo of Syosset CSD

Perform Professional Consulting and Environmental Sampling and Testing for Radon in Air at:

Baylis Elementary School

580 Woodbury Rd., Plainview, NY 11803

Site Visits: December 16 & 19, 2025

JCB#: 25-62202

Conclusions and Recommendations

Based upon the results of the laboratory analysis, the USEPA decision matrix does not recommend any additional investigation pertaining to radon in air associated with the above referenced school building.

The ANSI/AARST guidance document recommends that responsible care requires repeating initial testing procedures for all building(s) at least every 5 years and in conjunction with any sale of a building.

Radon testing should also be conducted when any of the following circumstances occur:

- a new addition is constructed or alterations for building reconfiguration or rehabilitation occur;
- a ground contact area not previously tested is occupied, or a building is newly occupied;
- heating or cooling systems are significantly altered, resulting in changes to air pressures or pressure relationships;
- ventilation is significantly altered by extensive weatherization, changes to mechanical systems or comparable procedures;
- significant openings to soil occur due to:
 - groundwater or slab surface water control systems that are altered or added (e.g., sumps, perimeter drain tile, shower/tub retrofits, etc.) or,
 - natural settlement causing major cracks to develop;
- earthquakes or construction blasting, fracking or formation of sink holes nearby; or
- a mitigation system is altered, modified, or repaired.

Should testing indicate concentrations that meet or exceed the action level, conduct evaluations, corrections and further testing until radon concentrations have been mitigated to below the action level.

However, to monitor for possible changes in indoor quality, JCB does recommend that the current annual testing schedule for radon in air within the school building continue.

Please refer to the attached laboratory reports to be included in the District's Radon Measurement Plan.

1. Tables
2. Figures
3. Field Photograph Logs
4. Laboratory Analysis Reports

If there are any questions or if more information is needed, please feel free to contact our office.

Sincerely,

J. C. Broderick & Associates, Inc.



Steven Muller, P.G.

Director, Subsurface Division

Attachment #1 Tables

**Table No. 1:
Summary of Radon Samples Submitted for Laboratory Analysis**

Sample ID#	AHERA Space ID	Sample Start Date	Sample End Date	Description of Sample	Analysis Method
596127	2005	12/16/2025	12/19/2025	File Cabinet	Radon in Air
596120 (Dup)		12/16/2025	12/19/2025		Radon in Air
596076	2007	12/16/2025	12/19/2025	File Cabinet	Radon in Air
596096	2006	12/16/2025	12/19/2025	Cabinet	Radon in Air
596004	2008	12/16/2025	12/19/2025	Cabinet	Not Tested
596039 (B)		12/16/2025	12/19/2025		Not Tested
596175	2009	12/16/2025	12/19/2025	Cabinet	Radon in Air
596092	2011	12/16/2025	12/19/2025	File Cabinet	Radon in Air
596048	2010	12/16/2025	12/19/2025	Cabinet	Radon in Air
596024	2012	12/16/2025	12/19/2025	Bookshelf	Radon in Air
596044	2013	12/16/2025	12/19/2025	Speaker	Radon in Air
596091	2015	12/16/2025	12/19/2025	Bookshelf	Radon in Air
596317	2020	12/16/2025	12/19/2025	Cabinet	Radon in Air
596170	2021	12/16/2025	12/19/2025	Shelf	Radon in Air
596307	2022	12/16/2025	12/19/2025	Electrical Box	Radon in Air
596003	2026	12/16/2025	12/19/2025	Speaker	Radon in Air
596212 (Dup)		12/16/2025	12/19/2025		Radon in Air
596016	2029	12/16/2025	12/19/2025	Speaker	Radon in Air
596168 (B)		12/16/2025	12/19/2025		Radon in Air
596040	2032	12/16/2025	12/19/2025	Speaker	Radon in Air
596143	2035	12/16/2025	12/19/2025	Bookshelf	Radon in Air
596263	B6	12/16/2025	12/19/2025	Cabinet	Radon in Air
596072 (B)		12/16/2025	12/19/2025		Radon in Air
596210	B9	12/16/2025	12/19/2025	Bookshelf	Radon in Air
596069	2038	12/16/2025	12/19/2025	Bookshelf	Radon in Air
596228	2041	12/16/2025	12/19/2025	Vending Machine	Radon in Air
596176	2044	12/16/2025	12/19/2025	Bookshelf	Radon in Air
NS	1055			Cabinet	
NS					
596038	2050	12/16/2025	12/19/2025	Cabinet	Radon in Air
596153	2053	12/16/2025	12/19/2025	Cabinet	Radon in Air
596053	2046	12/16/2025	12/19/2025	Bookshelf	Radon in Air
596121	2047	12/16/2025	12/19/2025	TV Stand	Radon in Air
596106	2048	12/16/2025	12/19/2025	Bookshelf	Radon in Air
596022	2049	12/16/2025	12/19/2025	Bookshelf	Radon in Air
596271	2049A	12/16/2025	12/19/2025	Bookshelf	Radon in Air
596052 (Dup)		12/16/2025	12/19/2025		Radon in Air
595751	2077	12/16/2025	12/19/2025	Shelf	Radon in Air
595751 (Dup)		12/16/2025	12/19/2025		Radon in Air
596095	2061	12/16/2025	12/19/2025	Speaker	Radon in Air
596073	2063	12/16/2025	12/19/2025	Speaker	Radon in Air
596131	2065	12/16/2025	12/19/2025	Cabinet	Radon in Air
595605	2068	12/16/2025	12/19/2025	Speaker	Radon in Air
596108	C7	12/16/2025	12/19/2025	Speaker	Radon in Air
596067	C7A	12/16/2025	12/19/2025	Speaker	Radon in Air
Not Retrieved	C9	12/16/2025		Bookshelf	
596185	C10	12/16/2025	12/19/2025	Cabinet	Radon in Air
595534	C12	12/16/2025	12/19/2025	Cabinet	Radon in Air
595592	2070	12/16/2025	12/19/2025	Speaker	Radon in Air
595553	2071	12/16/2025	12/19/2025	Cabinet	Radon in Air
596059	2073	12/16/2025	12/19/2025	Cabinet	Radon in Air

Notes:

NT = Not Sampled

B = Blank

Dup = Duplicate

**Table No. 2:
Summary of Radon Laboratory Results**

AHERA Space ID	12/16/25-12/19/25 (pCi/L)	12/16/24-12/19/24 (pCi/L)	2/6/24-2/9/24 (pCi/L)	1/10/23 - 1/13/23 (pCi/L)
2005	0.9	0.5	0.8	0.7
2005 (Dup)	0.9	0.9	0.5	0.9
2007	0.9	0.5	0.8	0.6
2008	0.7	0.8	Not Retrived	0.70
2008 (B)	-0.1	0.1	Not Retrived	-0.10
2006	0.8	0.6	0.7	0.9
2009	0.9	0.5	0.6	0.2
2011	0.7	0.9	0.5	0.7
2010	0.8	0.4	0.3	0.4
2012	0.8	0.6	0.6	0.7
2013	0.9	0.9	0.7	0.6
2015	0.7	0.6	0.4	0.6
2020	0.8	0.5	0.6	0.8
2021	0.9	0.6	0.5	0.7
2022	0.6	1.0	0.6	0.7
2026	0.8	0.8	0.6	0.7
2026 (Dup)	0.7	0.7	0.5	1.5
2029	1.0	1.1	0.7	1.0
2029 (B)	0.1	0.3	-0.1	0.0
2032	1.0	0.9	0.3	1.1
2035	1.1	1.6	0.4	1.1
B6	0.7	0.4	0.6	1.0
B6 (B)	0.1	0.2	-0.1	NS
B9	0.7	0.7	0.2	0.5
2038	1.0	0.9	0.8	0.7
2041	0.9	0.4	0.5	0.8
2044	0.9	0.6	0.4	0.9
1055	NS	0.8	0.7	0.3
1055 (B)	NS	0.1	0.1	0.2
2050	0.7	0.7	1.0	0.9
2050B	0.1	NS	NS	NS
2053	0.9	0.6	0.8	0.4
2046	1.0	0.4	0.5	0.9
2047	1.0	0.8	0.6	0.8
2048	1.0	0.5	0.5	0.6
2049	0.9	0.6	0.1	1.0
2049A	1.1	0.5	0.9	0.6
2049A (Dup)	1.1	0.6	0.4	0.4
2077	0.5	0.6	0.8	0.5
2077 (D)	0.7	0.1	0.4	0.6
2061	0.9	0.7	0.6	0.7
2063	0.7	0.7	0.5	0.7
2065	1.1	0.9	0.8	0.5
2068	1.2	0.5	0.5	1.0
C7	1.7	1.2	1.0	1.5
C7A	1.3	New Space from C7		
C9	Not Retrieved	1.1	0.6	1.1
C10	1.9	0.9	1.1	1.6
C12	1.6	0.3	0.5	0.8
2070	0.9	0.7	0.8	0.5
2071	0.9	0.7	0.4	0.6
2073	0.7	0.9	0.7	0.5

Notes:

NS = Not Sampled

B = Blank

Dup = Duplicate

Attachment #2

Figures

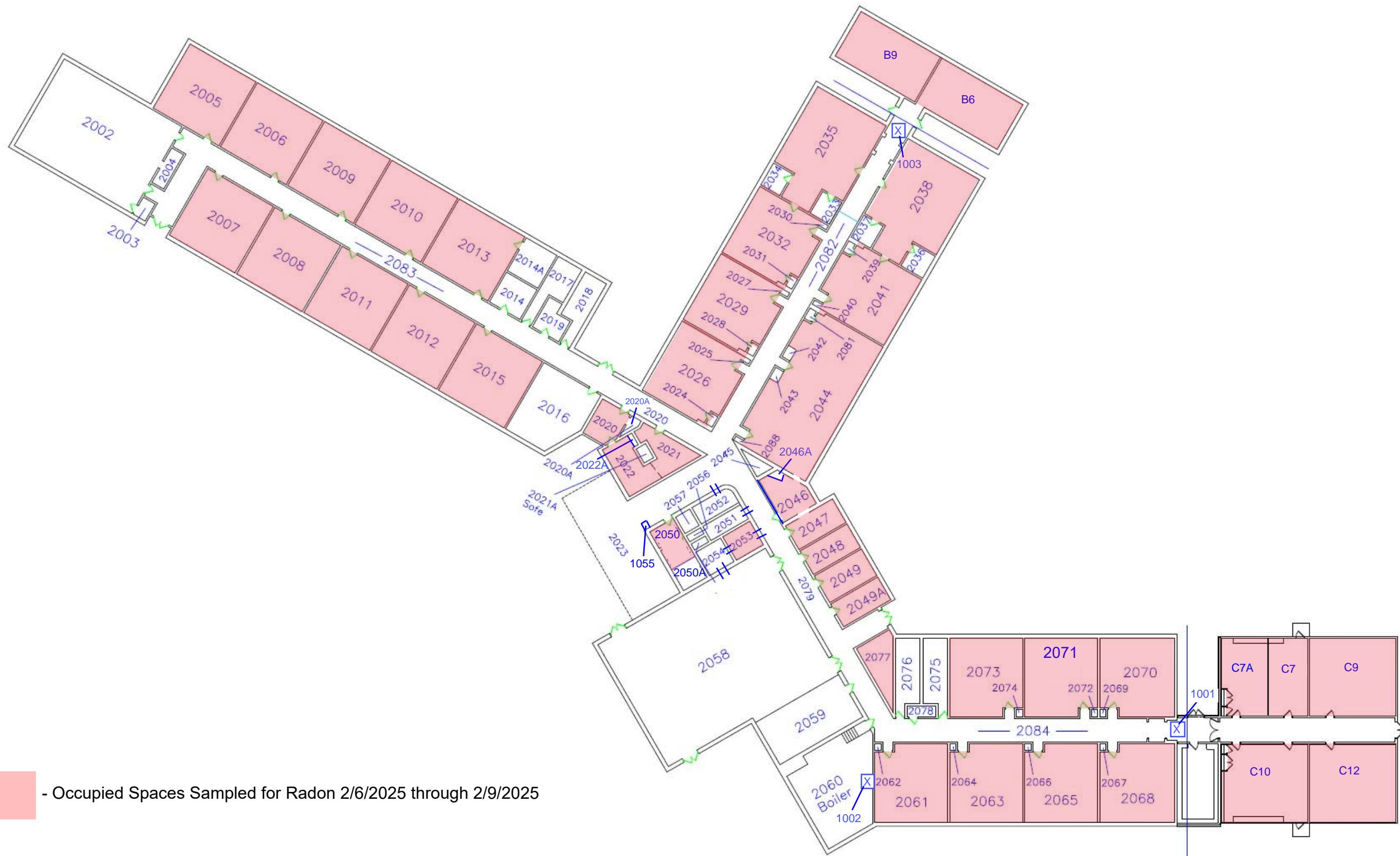

- Occupied Spaces Sampled for Radon 2/6/2025 through 2/9/2025



J.C. Broderick & Associates
 Environmental Consulting & Testing
 1775 Expressway Dr. North
 Hauppauge, New York 11788
 Phone: 631.584.5492 Fax: 631.584.5913

JCB #: 25-62202
SYOSSET CENTRAL SCHOOL DISTRICT
 Baylis Elementary School
 580 Woodbury Road, Plainview, NY 11803

Attachment #3
Field Photograph Logs

Typical Radon Sample



Field Photograph Log

Indoor Radon Investigation at:

Baylis Elementary School
580 Woodbury Road
Plainview, New York 11803

Photo No. 01

JCB#: 25-62202

Typical Radon Sample with Blank



Field Photograph Log

Indoor Radon Investigation at:

Baylis Elementary School
580 Woodbury Road
Plainview, New York 11803

Photo No. 02

JCB#: 25-62202

Typical Radon Sample with Duplicate



Field Photograph Log

Indoor Radon Investigation at:

Baylis Elementary School
580 Woodbury Road
Plainview, New York 11803

Photo No. 03

JCB#: 25-62202

Attachment #4
Laboratory Analysis Reports



EMSL Analytical, Inc.

200 Route 130 North, Cinnaminson, NJ 08077
Phone/Fax: (800) 220-3675 / (856) 786-0327
<http://www.EMSL.com> cinnaminsonradonlab@emsl.com

EMSL Order: 382505678
CustomerID: JCBR50
CustomerPO:
ProjectID:

Attn: **Steven Muller**
J.C. Broderick & Associates
1775 Expressway Drive North, Suite 1
Hauppauge, NY 11788

Phone: (631) 584-5492
Fax:
Received: 12/23/2025 12:56 PM
Analysis Date: 12/24/2025
Collected: 12/16/2025

Project: **Baylis Elementary School / 580 Woodbury Road**

Test **Baylis Elementary School**
Site: **580 Woodbury Road**
Plainview, NY 11803

Test Report: Radon in Air Test Results

Liquid Scintillation ID	Location	Radon Activity (pCi/L)	Start	Stop	Temperature F	Humidity %	Sample Type
596127 382505678-0001	2005	0.9	12/16/2025 6:31:00 AM	12/19/2025 3:55:00 PM	72	35	Customer
Sample Notes:							
596120 382505678-0002	2005 D	0.9	12/16/2025 6:31:00 AM	12/19/2025 3:55:00 PM	72	35	Duplicate
Sample Notes: Duplicate's Customer Sample:382505678-0001							
Duplicate RPD = 0.0%							
596096 382505678-0003	2006	0.8	12/16/2025 6:33:00 AM	12/19/2025 3:58:00 PM	73	35	Customer
Sample Notes:							
596076 382505678-0004	2007	0.9	12/16/2025 6:33:00 AM	12/19/2025 3:57:00 PM	73	36	Customer
Sample Notes:							
596004 382505678-0005	2008	0.7	12/16/2025 6:35:00 AM	12/19/2025 4:00:00 PM	73	35	Customer
Sample Notes:							
596039 382505678-0006	2008 B	-0.1	12/16/2025 6:35:00 AM	12/19/2025 4:00:00 PM	73	35	Blank
Sample Notes:							
596175 382505678-0007	2009	0.9	12/16/2025 6:35:00 AM	12/19/2025 4:00:00 PM	74	35	Customer
Sample Notes:							
596092 382505678-0008	2011	0.7	12/16/2025 6:36:00 AM	12/19/2025 4:01:00 PM	74	35	Customer
Sample Notes:							
596048 382505678-0009	2010	0.8	12/16/2025 6:38:00 AM	12/19/2025 4:03:00 PM	74	35	Customer
Sample Notes:							
596024 382505678-0010	2012	0.8	12/16/2025 6:41:00 AM	12/19/2025 4:03:00 PM	74	31	Customer
Sample Notes:							



EMSL Analytical, Inc.

200 Route 130 North, Cinnaminson, NJ 08077

Phone/Fax: (800) 220-3675 / (856) 786-0327

<http://www.EMSL.com>

cinnaminsonradonlab@emsl.com

EMSL Order: 382505678

CustomerID: JCBR50

CustomerPO:

ProjectID:

Test Report: Radon in Air Test Results

Liquid Scintillation ID	Location	Radon Activity (pCi/L)	Start	Stop	Temperature F	Humidity %	Sample Type
596044 382505678-0011	2013	0.9	12/16/2025 6:42:00 AM	12/19/2025 4:04:00 PM	73	34	Customer
Sample Notes:							
596091 382505678-0012	2015	0.7	12/16/2025 6:42:00 AM	12/19/2025 4:05:00 PM	74	33	Customer
Sample Notes:							
596317 382505678-0013	2020	0.8	12/16/2025 6:44:00 AM	12/19/2025 4:07:00 PM	75	31	Customer
Sample Notes:							
596170 382505678-0014	2021	0.9	12/16/2025 6:45:00 AM	12/19/2025 4:10:00 PM	77	30	Customer
Sample Notes:							
596307 382505678-0015	2022	0.6	12/16/2025 6:46:00 AM	12/19/2025 4:08:00 PM	77	30	Customer
Sample Notes:							
596038 382505678-0016	2050	0.7	12/16/2025 6:48:00 AM	12/19/2025 4:10:00 PM	77	29	Customer
Sample Notes:							
595554 382505678-0017	2050B	0.1	12/16/2025 6:48:00 AM	12/19/2025 4:10:00 PM	77	29	Customer
Sample Notes:							
596003 382505678-0018	2026	0.8	12/16/2025 6:49:00 AM	12/19/2025 4:17:00 PM	75	30	Customer
Sample Notes:							
596212 382505678-0019	2026 D	0.7	12/16/2025 6:49:00 AM	12/19/2025 4:17:00 PM	75	30	Duplicate
Sample Notes: Duplicate's Customer Sample:382505678-0018					Duplicate RPD = 13.3%		
596016 382505678-0020	2029	1	12/16/2025 6:50:00 AM	12/19/2025 4:18:00 PM	75	31	Customer
Sample Notes:							
596168 382505678-0021	2029 B	0.1	12/16/2025 6:50:00 AM	12/19/2025 4:18:00 PM	75	31	Blank
Sample Notes:							
596040 382505678-0022	2032	1	12/16/2025 6:51:00 AM	12/19/2025 4:20:00 PM	74	31	Customer
Sample Notes:							
596143 382505678-0023	2035	1.1	12/16/2025 6:51:00 AM	12/19/2025 4:21:00 PM	75	30	Customer
Sample Notes:							

Please visit www.radontestinglab.com



EMSL Analytical, Inc.

200 Route 130 North, Cinnaminson, NJ 08077

Phone/Fax: (800) 220-3675 / (856) 786-0327

<http://www.EMSL.com>

cinnaminsonradonlab@emsl.com

EMSL Order:	382505678
CustomerID:	JCBR50
CustomerPO:	
ProjectID:	

Test Report: Radon in Air Test Results

Liquid Scintillation ID	Location	Radon Activity (pCi/L)	Start	Stop	Temperature F	Humidity %	Sample Type
596210 382505678-0024	B9	0.7	12/16/2025 6:53:00 AM	12/19/2025 4:22:00 PM	74	34	Customer
Sample Notes:							
596263 382505678-0025	B6	0.7	12/16/2025 6:53:00 AM	12/19/2025 4:23:00 PM	73	37	Customer
Sample Notes:							
596072 382505678-0026	B6 B	0.1	12/16/2025 6:53:00 AM	12/19/2025 4:23:00 PM	73	37	Customer
Sample Notes:							
596069 382505678-0027	2038	1	12/16/2025 6:55:00 AM	12/19/2025 4:24:00 PM	75	29	Customer
Sample Notes:							
596228 382505678-0028	2041	0.9	12/16/2025 6:55:00 AM	12/19/2025 4:25:00 PM	75	30	Customer
Sample Notes:							
596176 382505678-0029	2044	0.9	12/16/2025 6:56:00 AM	12/19/2025 4:15:00 PM	75	32	Customer
Sample Notes:							
596053 382505678-0030	2046	1	12/16/2025 6:57:00 AM	12/19/2025 4:16:00 PM	74	31	Customer
Sample Notes:							
596153 382505678-0031	2053	0.9	12/16/2025 7:00:00 AM	12/19/2025 4:12:00 PM	76	29	Customer
Sample Notes:							
596121 382505678-0032	2046	1	12/16/2025 7:03:00 AM	12/19/2025 4:27:00 PM	75	28	Customer
Sample Notes:							
596106 382505678-0033	2048	1	12/16/2025 7:04:00 AM	12/19/2025 4:28:00 PM	75	27	Customer
Sample Notes:							
596022 382505678-0034	2049	0.9	12/16/2025 7:04:00 AM	12/19/2025 4:29:00 PM	75	28	Customer
Sample Notes:							
596271 382505678-0035	2049A	1.1	12/16/2025 7:06:00 AM	12/19/2025 4:30:00 PM	76	28	Customer
Sample Notes:							
596052 382505678-0036	2049A D	1.1	12/16/2025 7:06:00 AM	12/19/2025 4:30:00 PM	76	28	Duplicate
Sample Notes: Duplicate's Customer Sample:382505678-0035							
						Duplicate RPD = 0.0%	

Please visit www.radontestinglab.com



EMSL Analytical, Inc.

200 Route 130 North, Cinnaminson, NJ 08077

Phone/Fax: (800) 220-3675 / (856) 786-0327

<http://www.EMSL.com>

cinnaminsonradonlab@emsl.com

EMSL Order: 382505678

CustomerID: JCBR50

CustomerPO:

ProjectID:

Test Report: Radon in Air Test Results

Liquid Scintillation ID	Location	Radon Activity (pCi/L)	Start	Stop	Temperature F	Humidity %	Sample Type
595751 382505678-0037	2077	0.5	12/16/2025 7:07:00 AM	12/19/2025 4:32:00 PM	76	29	Customer
Sample Notes:							
595608 382505678-0038	2077 D	0.7	12/16/2025 7:07:00 AM	12/19/2025 4:32:00 PM	76	29	Duplicate
Sample Notes: Duplicate's Customer Sample:382505678-0037						Duplicate RPD = 33.3%	
596095 382505678-0039	2061	0.9	12/16/2025 7:08:00 AM	12/19/2025 4:34:00 PM	76	29	Customer
Sample Notes:							
596073 382505678-0040	2063	0.7	12/16/2025 7:11:00 AM	12/19/2025 4:35:00 PM	74	30	Customer
Sample Notes:							
596131 382505678-0041	2065	1.1	12/16/2025 7:12:00 AM	12/19/2025 4:36:00 PM	74	29	Customer
Sample Notes:							
595605 382505678-0042	2068	1.2	12/16/2025 7:12:00 AM	12/19/2025 4:37:00 PM	74	30	Customer
Sample Notes:							
596185 382505678-0043	C10	1.9	12/16/2025 7:14:00 AM	12/19/2025 4:38:00 PM	72	35	Customer
Sample Notes:							
595534 382505678-0044	C12	1.6	12/16/2025 7:15:00 AM	12/19/2025 4:41:00 PM	71	40	Customer
Sample Notes:							
596108 382505678-0045	C7	1.7	12/16/2025 7:18:00 AM	12/19/2025 4:49:00 PM	74	34	Customer
Sample Notes:							
596067 382505678-0046	C7A	1.3	12/16/2025 7:18:00 AM	12/19/2025 4:50:00 PM	74	32	Customer
Sample Notes:							
595592 382505678-0047	2070	0.9	12/16/2025 7:20:00 AM	12/19/2025 4:50:00 PM	73	30	Customer
Sample Notes:							
595553 382505678-0048	2071	0.9	12/16/2025 7:20:00 AM	12/19/2025 4:52:00 PM	73	31	Customer
Sample Notes:							
596059 382505678-0049	2073	0.7	12/16/2025 7:21:00 AM	12/19/2025 4:53:00 PM	74	30	Customer
Sample Notes:							

Report Notes

Please visit www.radontestinglab.com



EMSL Analytical, Inc.

200 Route 130 North, Cinnaminson, NJ 08077

Phone/Fax: (800) 220-3675 / (856) 786-0327

<http://www.EMSL.com>

cinnaminsonradonlab@emsl.com

EMSL Order:	382505678
CustomerID:	JCBR50
CustomerPO:	
ProjectID:	

Test Report: Radon in Air Test Results

Liquid Scintillation ID	Location	Radon Activity (pCi/L)	Start	Stop	Temperature F	Humidity %	Sample Type
-------------------------	----------	------------------------	-------	------	---------------	------------	-------------

The United States Environmental Protection Agency (EPA) has established a radon action level of 4.0pCi/L. EPA recommends mitigation of a structure if the confirmed radon level is equal to or greater than 4.0pCi/L.

The radon tests were performed using liquid scintillation radon detectors and counted on a liquid scintillation counter following EPA Method # 402-R-92-004 testing protocol for Radon in Air testing. EPA recommends retesting every two years.

Please contact EMSL Analytical, Inc. or your State Health Department for further information.

All procedures used for generating this report are in complete accordance with the current EPA protocols for the analysis of Radon in Air.

Analyst(s)

Jeanel Zoll (49)

Dominic Gehret, Radiochemistry Laboratory Manager, 10872

In no event shall EMSL be liable for indirect, special, consequential, or incidental damages, including, but not limited to, damages for loss of profit or goodwill regardless of the negligence (either sole or concurrent) of EMSL and whether EMSL has been informed of the possibility of such damages, arising out of or in connection with EMSL's services thereunder or the delivery, use, reliance upon or interpretation of test results by client or any third party. We accept no legal responsibility for the purposes for which the client uses the test results. In no event shall EMSL be liable to a client or any third party, whether based upon theories of tort, contract or any other legal or equitable theory, in excess of the amount paid to EMSL by client thereunder. The test results meets all NELAC requirements unless otherwise specified.

Samples analyzed by EMSL Analytical, Inc. Cinnaminson, NJ FL RB2034/R2687,IL RNL2008202,IN RTL00935,IA RNLAB10005,KS KS-LB-0005/KS-MS-0482,ME SPC202,MN RL-0005,NE 474/RMB-1083,NJ 03036/MEB92525/MES13910,NY 10872,OH RL39,OK D9952,PA 2573/3393/68-00367,RI RMB-108/RI00179,WV RL000220,NRSB-ARL6006,NRPP

Initial report from 12/26/2025 11:16:28



Radon Testing Chain of Custody

EMSL Order Number / Lab Use Only

EMSL Analytical, Inc.
200 Route 130 North
Cinnaminson, NJ 08077

EMSL ANALYTICAL, INC.
TESTING LABS • PRODUCTS • TRAINING

382505678

(800) 220-3675

RadLab@emsl.com

If Bill-To is the same as Report-To leave this section blank. Third-party billing requires written authorization.

Customer Information	Customer ID: JCBR50	Billing Information	Billing ID: Same
	Company Name: JC Braderick Associates		Company Name: RECEIVED
	Contact Name: Steven Muller		Billing Contact: EMSL ANALYTICAL, INC.
	Street Address: 1775 Express Dr. North		Street Address: Carle Place, NY
	City, State, Zip: Hempstead, New York 11788 Country:		City, State, Zip: DEC 19 25, PM 05:19 Country:
	Phone: 631-581-5913		Phone:
Email(s) for Report: Smuller@jcbraderick	Email(s) for Invoice:		

Project Name/No: Baylis Elementary School		Purchase Order: 25-62202
EMSL LIMS Project ID: (If applicable, EMSL will provide)	US State where samples collected: NY	State of Connecticut (CT) must select project location: <input type="checkbox"/> Commercial (Taxable) <input type="checkbox"/> Residential (Non-Taxable)
Technician Name: Steven Muller	Technician Cert#:	Technician Signature: <i>[Signature]</i>

Property Tested Information

1) Radon Test being conducted for the purpose of: Real Estate Transaction Homeowner Other

2) Test Conditions Observed: Closed House Open House

3) Building Type: Residential Commercial Daycare/School

4) Building Foundation: Basement Crawlspace Slab on Grade Other

5) If School Testing, please enter School Code:

6) Is this a Post Mitigation Test? YES NO

Box Number	Device Number	Location / Floor	Exposure Period Beginning Date and Time	Exposure Period Ending Date and Time	Temperature °F	Humidity %
S	596127	2005	12/16/25 6:31am	12/19/25 3:55pm	71.6	35.0
D	596120	2005D	12/16/25 6:31am	12/19/25 3:55pm	71.6	35.0
S	596096	2006	12/16/25 6:33am	12/19/25 3:58pm	72.6	34.6
S	596076	2007	12/16/25 6:33am	12/19/25 3:57pm	72.6	35.9
S	596004	2008	12/16/25 6:35am	12/19/25 4:00pm	73.4	35.4
B	596039	2008B	12/16/25 6:35am	12/19/25 4:00pm	73.4	35.4
S	596175	2009	12/16/25 6:35am	12/19/25 4:00pm	73.5	34.6
S	596092	2011	12/16/25 6:36am	12/19/25 4:01pm	73.7	34.6
S	596048	2010	12/16/25 6:38am	12/19/25 4:03pm	74.1	34.7
S	596024	2012	12/16/25 6:41am	12/19/25 4:03pm	73.7	30.8
S	596044	2013	12/16/25 6:42am	12/19/25 4:04pm	73.4	33.7
S	596091	2015	12/16/25 6:42am	12/19/25 4:05pm	73.5	32.6
S	596317	2020	12/16/25 6:44am	12/19/25 4:07pm	75.0	30.7

*Comments/Special Instructions: **NI 2 day T&T**

Client Sample #(s): **49 devices** Total # of Samples:

Method of Shipment:	Sample Condition Upon Receipt:
Relinquished by: <i>[Signature]</i> Date/Time: 12/19/25	Received by: A. Minnifield A. Muller Date/Time: 12/19/25 5:19pm
Relinquished by:	Received by: Jeanell & Zolt Jeanell Zolt Date/Time: 12/23/25 12:56pm

Controlled Document - COC-56 Radon R2 04/15/2021

AGREE TO ELECTRONIC SIGNATURE (By checking, I consent to signing this Chain of Custody document by electronic signature.)



EMSL Analytical, Inc.'s Laboratory Terms and Conditions are incorporated into this Chain of Custody by reference in their entirety. Submission of samples to EMSL Analytical, Inc. constitutes acceptance and acknowledgment of all terms and conditions by Customer.



Radon Testing Chain of Custody

EMSL Order Number / Lab Use Only

EMSL Analytical, Inc.
200 Route 130 North
Cinnaminson, NJ 08077

EMSL ANALYTICAL, INC.
TESTING LABS • PRODUCTS • TRAINING

382505678

(800) 220-3675
RadLab@emsl.com

Additional Pages of the Chain of Custody are only necessary if needed for additional sample information

Box Number	Device Number	Location	Exposure Period Beginning Date and Time	Exposure Period Ending Date and Time	Temperature °F	Humidity %
S	596170	2021	12/16/25 6:45am	12/19/25 4:00pm	77.1	29.9
S	696307	2022	12/16/25 6:46am	12/19/25 4:08pm	77.1	30.2
S	596038	2050	12/16/25 6:48am	12/19/25 4:10pm	77.0	28.7
B	595554	2050B	12/16/25 6:48am	12/19/25 4:10pm	77.0	28.7
S	596003	2026	12/16/25 6:49am	12/19/25 4:17pm	75.0	30.0
D	596212	2026D	12/16/25 6:49am	12/19/25 4:17pm	75.0	30.0
S	596016	2029	12/16/25 6:50am	12/19/25 4:18pm	74.6	30.8
B	596168	2029B	12/16/25 6:50am	12/19/25 4:18pm	74.6	30.8
S	596040	2032	12/16/25 6:51am	12/19/25 4:20pm	74.4	30.7
S	596143	2035	12/16/25 6:51am	12/19/25 4:21pm	74.8	29.7
S	596210	B9	12/16/25 6:53am	12/19/25 4:22pm	73.5	33.6
S	596263	B6	12/16/25 6:53am	12/19/25 4:23pm	73.2	36.6
B	596072	B6B	12/16/25 6:53am	12/19/25 4:23pm	73.2	36.6
S	596069	2038	12/16/25 6:55am	12/19/25 4:24pm	74.6	29.4
S	596228	2041	12/16/25 6:55am	12/19/25 4:25pm	75.3	29.7
S	596176	2044	12/16/25 6:56am	12/19/25 4:15pm	74.8	31.7
S	596053	2046	12/16/25 6:57am	12/19/25 4:16pm	74.4	31.0
S	596153	2053	12/16/25 7:00am	12/19/25 4:12pm	75.7	28.8
S	596121	2046	12/16/25 7:03am	12/19/25 4:27pm	75.0	27.7
S	596106	2048	12/16/25 7:04am	12/19/25 4:28pm	75.0	26.7
S	596022	2049	12/16/25 7:04am	12/19/25 4:29pm	75.3	28.4
S	596271	2049A	12/16/25 7:06am	12/19/25 4:30pm	75.5	28.4
D	596052	2049AD	12/16/25 7:06am	12/19/25 4:30pm	75.5	28.4
S	595751	2077	12/16/25 7:07am	12/19/25 4:32pm	75.7	27.8
D	595608	2077D	12/16/25 7:07am	12/19/25 4:32pm	75.7	27.8
S	596095	2061	12/16/25 7:08am	12/19/25 4:34pm	75.7	27.8

*Comments/Special Instructions:

Relinquished by:	Date/Time:	Received by: <i>A. Minnifield</i>	Date/Time: <i>12/19/25 5:19pm</i>
Relinquished by:	Date/Time:	Received by:	Date/Time:

Controlled Document - COC-56 Radon R2 04/15/2021

AGREE TO ELECTRONIC SIGNATURE (By checking, I consent to signing this Chain of Custody document by electronic signature.)

EMSL Analytical, Inc.'s Laboratory Terms and Conditions are incorporated into this Chain of Custody by reference in their entirety. Submission of samples to EMSL Analytical, Inc. constitutes acceptance and acknowledgment of all terms and conditions by Customer.



EMSL ANALYTICAL, INC.
TESTING LABS • PRODUCTS • TRAINING

Radon Testing Chain of Custody

EMSL Order Number / Lab Use Only

EMSL Analytical, Inc.
200 Route 130 North
Cinnaminson, NJ 08077

(800) 220-3675
RadLab@emsl.com

382505678

Additional Pages of the Chain of Custody are only necessary if needed for additional sample information

Box Number	Device Number	Location	Exposure Period Beginning Date and Time		Exposure Period Ending Date and Time		Temperature °F	Humidity %
S	596073	2063	12/16/25	7:11am	12/19/25	4:35pm	74.1	29.7
S	596131	2065	12/16/25	7:12am	12/19/25	4:36pm	73.7	25.6
S	595605	2068	12/16/25	7:12am	12/19/25	4:37pm	74.4	29.7
S	596185	C10	12/16/25	7:14am	12/19/25	4:38pm	72.3	34.5
S	595534	C12	12/16/25	7:15am	12/19/25	4:41pm	70.7	39.4
X S	595532	C9	12/16/25	7:16am	12/19/25	4:44pm	Not Recovered	
S	596108	C7	12/16/25	7:18am	12/19/25	4:49pm	74.3	33.7
S	596067	C7A	12/16/25	7:18am	12/19/25	4:50pm	73.7	31.8
S	595592	2070	12/16/25	7:20am	12/19/25	4:50pm	72.5	29.9
S	595553	2071	12/16/25	7:20am	12/19/25	4:52pm	72.6	30.6
S	596059	2073	12/16/25	7:21am	12/19/25	4:53pm	74.3	29.7

RECEIVED
 EMSL ANALYTICAL, INC.
 Carle Place, NY
 DEC 19 25, PM 05:20

25 DEC 33 PM 12:56
 CINNAMINSON, NJ
 RECEIVED
 EMSL

*Comments/Special Instructions:

Relinquished by:	Date/Time:	Received by: <i>A. Miller</i>	Date/Time: 12/19/25 5:20 pm
Relinquished by:	Date/Time:	Received by:	Date/Time:

Controlled Document - COC-56 Radon R2 04/15/2021

AGREE TO ELECTRONIC SIGNATURE (By checking, I consent to signing this Chain of Custody document by electronic signature.)

EMSL Analytical, Inc.'s Laboratory Terms and Conditions are incorporated into this Chain of Custody by reference in their entirety. Submission of samples to EMSL Analytical, Inc. constitutes acceptance and acknowledgment of all terms and conditions by Customer.