

# SV IHS BUILDING PROJECT AND PERFORMING ARTS CENTER

The Seneca Valley School District is collaborating with CannonDesign, a global architectural firm, on the Seneca Valley Intermediate High School (IHS) and Performing Arts Center/Auditorium project. The building project has been developed through a multi-year public process. Planned with community input and stakeholder groups, the project is an investment in our students' future and in the community. Please review the infographic regarding details about this project.

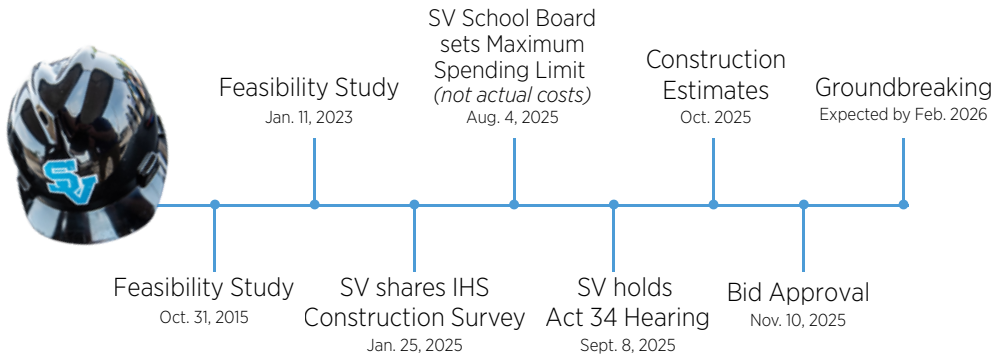

## Funding Plan

- Phased borrowing
- Gradual, inflation-limited tax increases
- Borrowing added gradually to minimize interest

## Tax Increase Overview

- Property tax increases are limited by PA Law
- Legal limitation is 3.5% for the 2026-27 budget year

## 4-5 YEAR Construction Timeline

### \$20 MILLION

In startup funds from capital reserve\* to reduce borrowing & interest costs

\*Capital Reserve funds can only be used for capital improvements

## 2-3 BOND ISSUES

Stabilizes annual dept payments and avoids large fluctuations

\*Bonds repaid over 20-30 years to maintain manageable long-term costs

## Feasibility Study Findings

- Building needs to adapt to 21<sup>st</sup> century learning environments
- Classrooms limit collaboration
- Science and Technology (STEM) rooms are outdated
- Mechanical, electrical and plumbing systems exceeded useful life, requiring extensive replacement

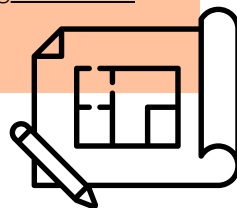

**For a home valued at \$406,500 (district median), the projected increase is ≈ \$11 per month in each of the next three years**

Estimated Home Value	2025-26 Taxes	2026-27 Taxes	Monthly Increase	2027-28 Taxes	Monthly Increase	2028-29 Taxes	Monthly Increase
\$100,000	\$921	\$953	\$2.66	\$985	\$2.66	\$1,017	\$2.66
\$250,000	\$2,302	\$2,382	\$6.75	\$2,463	\$6.75	\$2,542	\$6.58
\$406,500	\$3,741	\$3,872	\$10.91	\$4,003	\$11.00	\$4,131	\$10.66
\$500,000	\$4,603	\$4,764	\$13.41	\$4,926	\$13.50	\$5,084	\$13.16

There is a direct correlation to great schools and home value. Our school district is rapidly growing, consistently ranked as one of the best in the area and is a desirable destination in the entire region for people looking into a great community with an excellent school system.

## SV Taxes Compared with Value

- Largest student body in Butler County (7,500+ students)
- 'A' ratings in academics, clubs & activities and college prep (*Niche.com*)
- Fifth-lowest overall property tax in comparison to similarly sized districts across multiple counties (2025-26)
- Regional home values have risen
- Home values throughout much of the district have increased faster than property taxes

The **Performing Arts Center/Auditorium** represents **only 18% of the total cost** yet plays a vital role in both student learning and community engagement.

### The Performing Arts Center/Auditorium will:

- Allow for dedicated instructional space for performing arts
- Serve as a community hub for events and performances for which the district can charge a rental fee
- Reaffirm our commitment to artistic & academic excellence

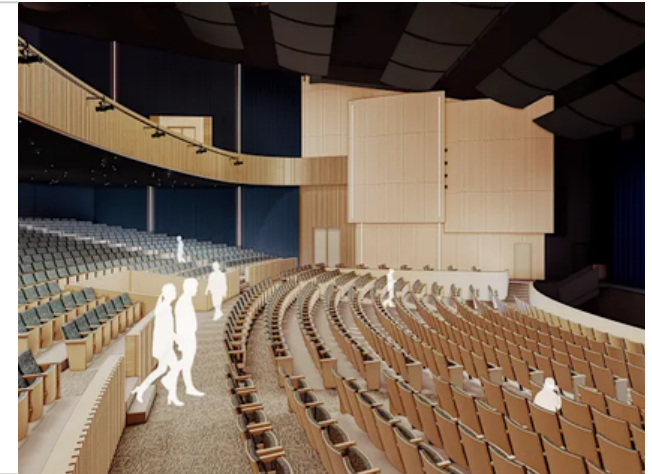

**200,000 sq. ft.**  
New Learning Spaces

**43 Classrooms**

**Three-story**  
Classroom wing

**12 Labs**  
Science & Biotechnology

**Flexible**  
Collaboration Areas

**Expanded Facilities**  
Special Education &  
Life Skills Programs

**Renovated**  
Gymnasiums, Cafeteria  
and Auditorium

**New & Improved**  
Outdoor Classrooms &  
Campus Accessibility

**Enhanced**  
Safety & Security

**Energy-Efficient**  
Systems & Design Features

## Benefits of Music & Performing Arts

### Academic Benefits

- Higher Test Scores: Research shows that students in performing arts often score higher on standardized tests, including SAT and ACT
- Increased Engagement: Arts involvement boosts attendance and GPA and reduces dropout rates
- Cognitive Growth: Performing arts enhance math, memory, problem-solving and executive-functioning skills

### Personal & Social Benefits

- Confidence & Communication: Builds self-assurance and public-speaking skills
- Teamwork & Leadership: Fosters collaboration skills and leadership through ensemble work

