

**Districtwide Lead in Drinking Water  
Sampling and Remediation Plan**

**2023-2025**

**Somers Central School District**

**January 2025**

**Enviroscience Project # 25987**



2150 Smithtown Ave., Suite 3, Ronkonkoma, NY 11779

**T:** 631.580.3191 • **F:** 631.580.3195 • **W:** [envirohealth.org](http://envirohealth.org)

DISTRICTWIDE LEAD IN DRINKING WATER SAMPLING AND REMEDIATION PLAN

2023-2025

January 2025

(updated March 6, 2025)

ENVIROSCIENCE PROJECT #25987

Prepared for: SOMERS CENTRAL SCHOOL DISTRICT  
250 Route 202  
Somers, NY. 10589

Prepared by: ENVIROSCIENCE CONSULTANTS, LLC  
2150 Smithtown Avenue  
Ronkonkoma, New York 11779  
(631) 580-3191

Project Manager: *Susan Richter*

## TABLE OF CONTENTS

<u>Section</u>	<u>Title</u>
1.0	Executive Summary
2.0	Sampling Methodology
3.0	Initial Results

### Appendices

Appendix A	Somers Intermediate School
Appendix B	Somers Middle School
Appendix C	Primrose Elementary School
Appendix D	Somers High School

## 1.0 EXECUTIVE SUMMARY

The Somers Central School District has developed their 2023-2025 Lead in Drinking Water Sampling and Remediation Plan, as required by the New York State Department of Health (Public Health Law Sections 1370-a and 1110, Subpart 67-4 Lead Testing in School Drinking Water).

In accordance with the regulation, this Lead Remediation Plan is prepared to identify locations deemed as Applicable Drinking Water Sources and report first draw sample results, to mitigate locations where sample results exceed 5 parts per billion, to identify locations deemed as Non-Applicable Water Sources, communicate this designation to building occupants, and to develop strategies for monitoring locations deemed Non-Applicable Water Sources to insure building occupants do not consume water from these locations.

The following locations within the Somers Central School District buildings have been deemed Applicable Drinking Water Sources by the administration:

- 1) Water fountains and bottle filling stations;
- 2) Kitchen water faucets and pot fillers used in food preparation;
- 3) Ice machines
- 4) Home Economics classroom sinks
- 5) Elementary classroom bathroom sinks
- 6) Nurse's Office and Faculty Room sinks

First draw samples were collected from each of these locations within the district and analyzed by a New York State Department of Health ELAP certified laboratory. The chains of custody are available upon request. For results at or below 5 ppb, no further action is required until 2025. For locations above 5 ppb, options include: second and third draw sample collection to determine source of lead, designation of the location as Non-applicable Water Source, or permanent removal of the fixture from the location. In either case, the result was communicated by Enviroscience Consultants, and the fixture was shut off by the district immediately upon receipt of results.

Three sinks used in food preparation in the Somers Middle School Kitchen tested over the limit. An additional initial sample, 15 and 60 second draws were collected. The initial samples tested over the limit again, but the 15 and 60 second draw samples did not exceed the limit. The

fixtures were replaced, and the initial samples exceeded the limit again. It was observed by Enviroscience staff and building staff, that hot water initially comes out of the faucet because the supply lines are adjacent to steam pipes, so it is not possible to get a cold first draw. Hot water tends to leach lead from fixtures, where cold water may not. As the 15 and 60 second draws tested below the limit, the district has established a daily flushing protocol in the Somers Middle School kitchen as a course of remediation. A sign has been posted in the kitchen and it has been communicated to kitchen staff.

The following locations within the Somers Central School District buildings were deemed Non-Applicable Water Sources by the administration:

- 1) Science Laboratory sinks
- 2) Art Room sinks
- 3) Technical Classroom sinks
- 4) Other Classroom sinks
- 5) Bathroom sinks
- 6) Outside spigots
- 7) Custodial Closet sinks
- 8) Mixed Valve sinks (or hot only)

In these cases, the Somers Central School District staff have placed signs adjacent to the fixture to notify occupants that the water is not intended for consumption. To further support this protocol, the following management of the locations is required:

- 1) Science Laboratory sinks - communicate in writing with students that these locations are for science experiments and hand washing only, not for consumption. This is most easily accomplished by including this language in the laboratory safety paperwork distributed to students at the beginning of the school year. This program should be monitored by the respective science teachers, and any deficiencies reported for assessment and revision, if necessary, by the Facilities Department.
- 2) Art Room sinks - communicate in writing to students that these locations are for cleaning of art supplies and hand washing only, not for consumption. This is most easily accomplished by including this language in the course paperwork distributed to students at the beginning of the school year. This program should be monitored by the

respective art teachers, and any deficiencies reported for assessment and revision, if necessary, by the Facilities Department.

- 3) Technical Classroom sinks - classrooms in this category often include wood shop or auto mechanics classrooms, where students are to hand wash after bathroom usage or activities as part of a regular hygiene program. This program should be monitored by teachers and staff to ensure consumption is not taking place, and any deficiencies reported for assessment and revision, if necessary, by the Facilities Department.
- 4) Other classroom sinks - classrooms in this category often include elementary classrooms, where students are to hand wash after bathroom usage or activities as part of a regular hygiene program. This program should be monitored by teachers and staff to ensure consumption is not taking place, and any deficiencies reported for assessment and revision, if necessary, by the Facilities Department.
- 5) Bathroom sinks - in intermediate buildings, signage should be sufficient for communicating the concept of hand washing only. In elementary schools, personal hygiene should be integrated into curriculum to ensure students understand bathroom sinks are for hand washing only, and not consumption. Further, show what the signage looks like in bathrooms, so they learn to recognize its meaning. This program should be monitored by teachers and staff to ensure consumption is not taking place, and any deficiencies reported for assessment and revision, if necessary, by the Facilities Department.
- 6) Outside spigots - all-weather signage will be installed at each location. Further, spigots will have a special key maintained by the custodial staff to ensure that non-authorized persons do not fill sports coolers or use hoses for consumption. This program should be monitored by custodial staff to ensure consumption is not taking place, and any deficiencies reported for assessment and revision, if necessary, by the Facilities Department.
- 7) Custodial Closet sinks - these locations should be accessed by custodial personnel only and locked when not in use. Access to others should be restricted. This program should be monitored by custodial staff to ensure consumption is not taking place, and any deficiencies reported for assessment and revision, if necessary, by the Facilities Department.

- 8) Mixed Valve sinks (or hot only) – per Public Health Law Sections 1370-a and 1110, Subpart 67-4 Lead Testing in School Drinking Water mixed valve or hot water only sources are not required to be sampled. Signage is required for these sources. Signage should be sufficient for communicating the concept of hand washing only. In elementary schools, personal hygiene should be integrated into curriculum to ensure students understand bathroom sinks are for hand washing only, and not consumption. Further, show what the signage looks like so they learn to recognize its meaning. This program should be monitored by teachers and staff to ensure consumption is not taking place, and any deficiencies reported for assessment and revision, if necessary, by the Facilities Department.

All locations deemed non-applicable, but do not have signs, should be taken offline until signs have been posted. Signs are suggested to have pictures that instruct for handwashing only, do not drink.

## **2.0 SAMPLING METHODOLOGY**

In accordance with the regulation, Enviroscience Consultants, LLC performed initial water sampling at the Somers Intermediate School and Somers Middle School on January 22, 2025. Somers Elementary School and Somers High School will be sampled during phase 2. Samples were collected in wide-mouth 250 milliliter containers and were collected in the morning hours before the facilities opened. The water sources were not used for at least 8 hours and not more than 18 hours prior to sampling. Unique source numbers and designations were assigned to each source location. Unique sample identification numbers were assigned to each sample taken. The key to fixture type codes, source designations, and the sampling location schematics are shown below:

## Code Key for Lead in Water

### Fixture Type Codes

BF	Bottle Filler	SK	Sink	SS	Slop Sink
HB	Hose Bib	SL	Supply Line	V	Valve
IM	Ice Machine	SP	Spigot	WC	Water Cooler
OS	Other Source	SPY	Spray	WF	Water Fountain
PF	Pot Filler				

### Source Designations

App	Applicable	N/A	Non-applicable
-----	------------	-----	----------------

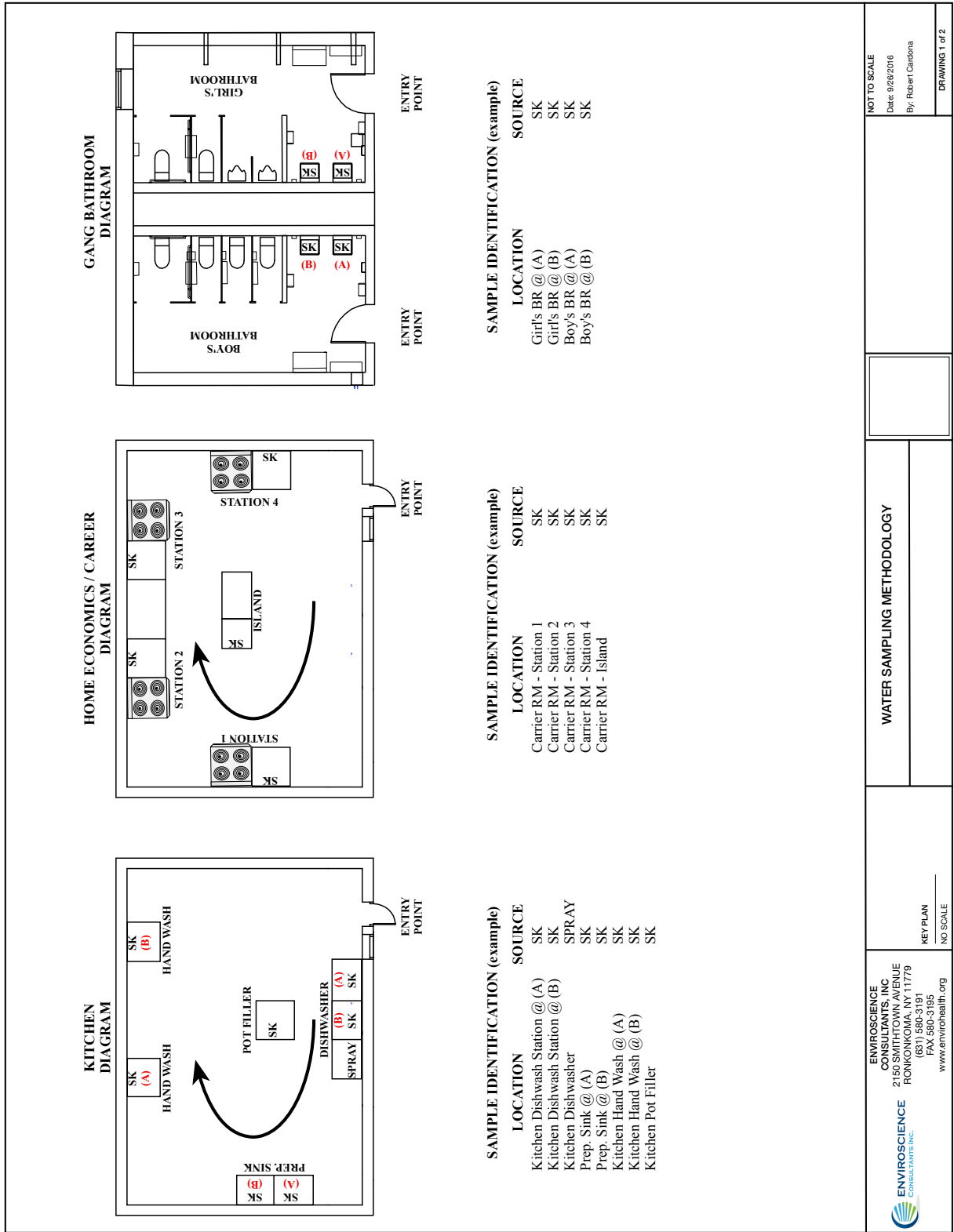

<p>NOT TO SCALE</p> <p>Date: 9/29/2016</p> <p>By: Robert Cardona</p>	<p>WATER SAMPLING METHODOLOGY</p>	<p>ENVIROSCIENCE CONSULTANTS, INC.</p> <p>2150 SMITHTOWN AVENUE</p> <p>RONKONKOMA, NY 11779</p> <p>(81) 580-3181</p> <p>FAX 580-3195</p> <p>www.envirohealth.org</p> <p>KEY PLAN</p> <p>NO SCALE</p>
--	-----------------------------------	--

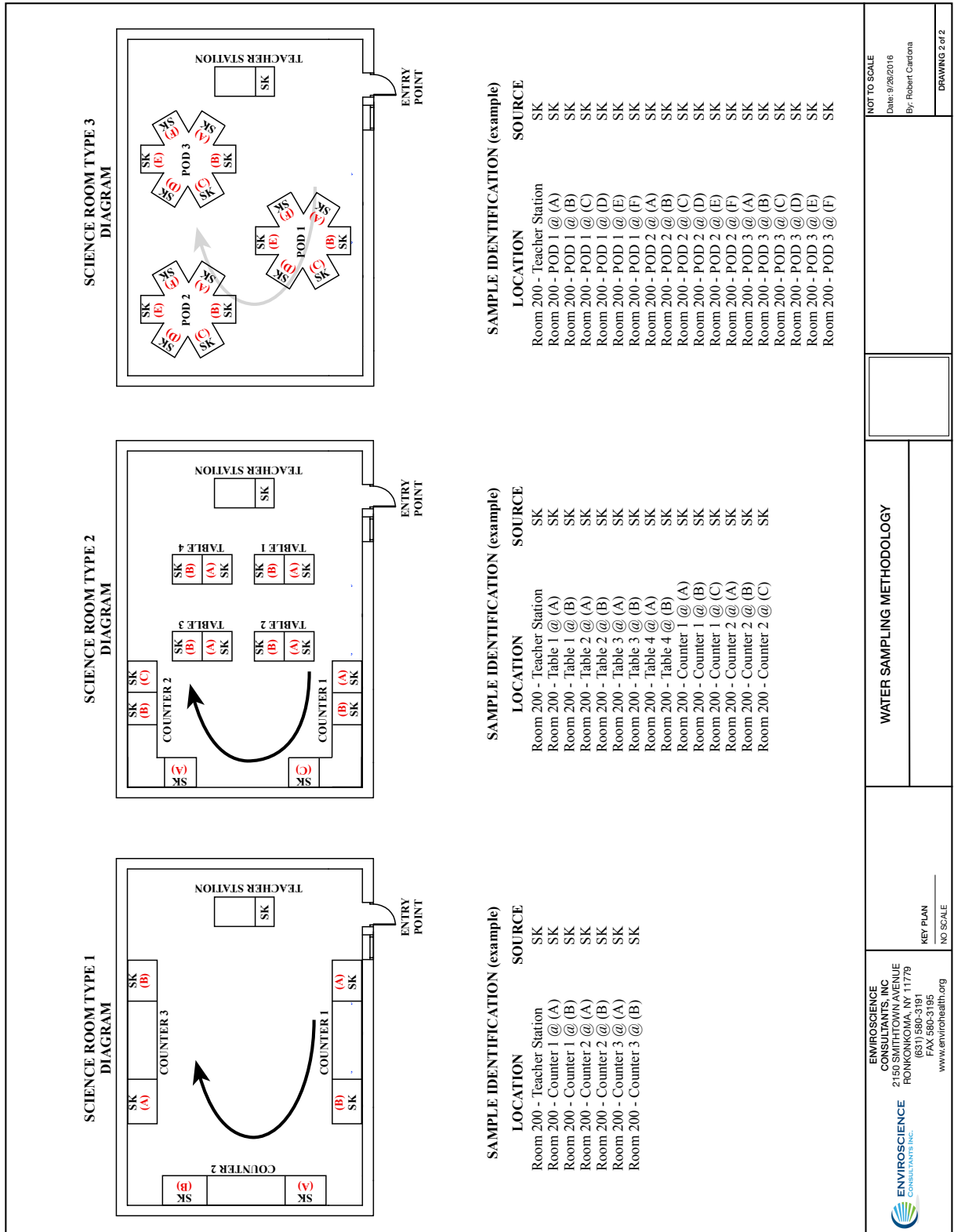

<b>WATER SAMPLING METHODOLOGY</b>	<b>NOT TO SCALE</b> Date: 9/26/2016 By: Robert Castano	DRAWING 2 of 2
 <b>ENVIROSCIENCE</b> CONSULTANTS, INC 2150 SMITHTOWN AVENUE RONKONKOMA, NY 11779 (631) 580-3181 FAX 580-3185 www.envirohealth.org	KEY PLAN NO SCALE	

### 3.0 Initial Results

All water source locations in each of the school buildings were assessed. Water source locations identified as drinking water sources were considered Applicable, and first draw samples were collected. Water source locations identified as non-drinking water sources were considered non-applicable and these locations were documented.

The results of the initial sampling and the use of signs warning against water use at non-applicable sources is documented in the School Water Outlet Inventory for each building.

All elevated locations should be taken off line until the remediation is completed. Any other drinking water sources in these buildings that were not functional at the time of initial sampling and have not been tested should be tested before returning to service. All locations deemed non-applicable, but do not have signs, should be taken offline until signs have been posted. Signs are suggested to have pictures that instruct for handwashing only, do not drink.

The following is a summary of results in parts per billion (ppb) of locations in the Somers Central School District where sample results were found above 5 ppb:

Somers Intermediate School			
SAMPLE LOCATION	RESULT	SAMPLE DATE	REMARKS
No Exceedances			

Somers Middle School			
SAMPLE LOCATION	RESULT	SAMPLE DATE	REMARKS
Kitchen, 3-Bay (left)	10.0	1/22/2025	Flushing protocol established
Kitchen, 3-Bay (right)	6.0	1/22/2025	Flushing protocol established
Kitchen, Prep Sink	11.0	1/22/2025	Flushing protocol established
Kitchen, Hot Table (left)	12.0	1/22/2025	Sign posted, non-potable source

Somers Middle School			
SAMPLE LOCATION	RESULT	SAMPLE DATE	REMARKS
Kitchen, Hot Table (right)	78.0	1/22/2025	Sign posted, non-potable source
Band Room 2	19.0	1/22/2025	Sign posted
Hallway between 209 & 211	16.0	1/22/2025	Fixture replaced with water fountain bottle filling station
Room 311 Wall Opposite Window	23.0	1/22/2025	Sign posted
Room 311 Wall w/ Window	17.0	1/22/2025	Sign posted
Hallway, Outside Room 302	9.0	1/22/2025	Fixture replaced with water fountain bottle filling station
Nurse's Office	6.0	1/28/2025	Fixture replacement pending

Primrose Elementary School			
SAMPLE LOCATION	RESULT	SAMPLE DATE	REMARKS
Kitchen 3-Bay-left sink	16.0	2/25/25	Removed from Service; Pending remediation
Kitchen 3-Bay-center sink	6.0	2/25/25	Removed from Service; Pending remediation
Classroom C4 Bathroom sink	18.0	2/25/25	Removed from Service; Pending remediation
Classroom C3 Bathroom sink	6.0	2/25/25	Removed from Service; Pending remediation
Classroom C1 sink	6.0	2/25/25	Sign posted
Classroom B3 sink	9.0	2/25/25	Sign posted
Classroom B2 sink	7.0	2/25/25	Sign posted
Classroom A6 sink	6.0	2/25/25	Sign posted
Classroom A15-left sink	9.0	2/25/25	Sign posted

### Primrose Elementary School

SAMPLE LOCATION	RESULT	SAMPLE DATE	REMARKS
Classroom A15-center sink	14.0	2/25/25	Sign posted
Classroom A15-right sink	28.0	2/25/25	Sign posted
Classroom F3 sink	6.0	2/25/25	Sign posted
Classroom E1B sink	13.0	2/25/25	Sign posted
Classroom E3 sink	10.0	2/25/25	Sign posted
Classroom E1 sink	37.0	2/25/25	Sign posted
Classroom D3 sink	6.0	2/25/25	Sign posted

### Somers High School

SAMPLE LOCATION	RESULT	SAMPLE DATE	REMARKS
Kitchen 67 Island Single Prep	8.0	2/25/2025	Removed from service; pending remediation
Kitchen 67 Groen Kettle	29.0	2/25/2025	Removed from service; pending remediation
Kitchen 67 Stove	27.0	2/25/2025	Fixture removed
Hall by Main Office (ceramic)	20.0	2/25/2025	Fixture removed, pending replacement
Girl's Locker Room	11.0	2/25/2025	Fixture removed, pending replacement
Social Studies Office 250A-10	13.0	2/25/2025	Sign posted

**Appendix A**  
**Somers Intermediate School**

Fixture #	Sample Location	Fixture Type	App or N/A	Latest 1 <sup>st</sup> Draw Results (ppb)	Latest 1st Draw Sampling Date	15 Second Draw Results (ppb)	60 Second Draw Results (ppb)	Flush Sampling Date	Remarks
SIS-1	Kitchen 3-Bay (left)	SK	App	3.0	1/22/2025				-
SIS-2	Kitchen 3-Bay (left)	Spray	App	3.0	1/22/2025				-
SIS-3	Kitchen 3-Bay (right)	SK	App	4.0	1/22/2025				-
SIS-4	All Gender Bathroom (right)	SK	N/A		1/22/2025				Sign
SIS-5	All Gender Bathroom (left)	SK	N/A		1/22/2025				Sign
SIS-6	Art Room - right counter	SK	N/A		1/22/2025				Sign
SIS-7	Art Room - unit @A	SK	N/A		1/22/2025				Sign
SIS-8	Art Room - unit @B	SK	N/A		1/22/2025				Sign
SIS-9	Hall by Art Room	WF	App	<1.0	1/22/2025				-
SIS-10	Hall by Art Room	BF	App	<1.0	1/22/2025				-
SIS-11	Boy's Bathroom 140	SK	N/A		1/22/2025				Sign
SIS-12	Boy's Bathroom 140	SK	N/A		1/22/2025				Sign
SIS-13	Boy's Bathroom 140	SK	N/A		1/22/2025				Sign
SIS-14	Boy's Bathroom 140	SK	N/A		1/22/2025				Sign
SIS-15	Boy's Bathroom 140	SK	N/A		1/22/2025				Sign
SIS-16	Boy's Bathroom 140	SK	N/A		1/22/2025				Sign
SIS-17	Custodial Closet 139	SS	N/A		1/22/2025				Sign
SIS-18	Girl's Bathroom 122	SK	N/A		1/22/2025				Sign

Fixture #	Sample Location	Fixture Type	App or N/A	Latest 1 <sup>st</sup> Draw Results (ppb)	Latest 1st Draw Sampling Date	15 Second Draw Results (ppb)	60 Second Draw Results (ppb)	Flush Sampling Date	Remarks
SIS-19	Girl's Bathroom 122	SK	N/A		1/22/2025				Sign
SIS-20	Girl's Bathroom 122	SK	N/A		1/22/2025				Sign
SIS-21	Girl's Bathroom 122	SK	N/A		1/22/2025				Sign
SIS-22	Library Office	SK	App	4.0	1/22/2025				-
SIS-23	Faculty Bathroom	SK	N/A		1/22/2025				Sign
SIS-24	Faculty Bathroom	SK	N/A		1/22/2025				Sign
SIS-25	Hall by Faculty Room (left)	BF	App		1/22/2025				Non-functional at time of sampling, sampling required before returning to service
SIS-26	Hall by Faculty Room (left)	WF	App	<1.0	1/22/2025				-
SIS-27	Hall by Faculty Room (right)	WF	App	4.0	1/22/2025				-
SIS-28	Fourth Grade Great Room	SK	N/A		1/22/2025				Sign
SIS-29	Fourth Grade Great Room Counter (left)	SK	App	2.0	1/22/2025				-
SIS-30	Fourth Grade Great Room Counter (right)	SK	App	4.0	1/22/2025				-
SIS-32	Fourth Grade Girl's Bathroom	SK	N/A		1/22/2025				Sign
SIS-33	Fourth Grade Girl's Bathroom	SK	N/A		1/22/2025				Sign
SIS-34	Hall by Room C14	WF	App	<1.0	1/22/2025				-
SIS-35	Hall by Room C14	BF	App	<1.0	1/22/2025				-
SIS-36	Girl's Bathroom by C14	SK	N/A		1/22/2025				Sign
SIS-37	Girl's Bathroom by C14	SK	N/A		1/22/2025				Sign

Fixture #	Sample Location	Fixture Type	App or N/A	Latest 1 <sup>st</sup> Draw Results (ppb)	Latest 1st Draw Sampling Date	15 Second Draw Results (ppb)	60 Second Draw Results (ppb)	Flush Sampling Date	Remarks
SIS-38	Boy's Bathroom by C 14	SK	N/A		1/22/2025				Sign
SIS-39	Boy's Bathroom by C 14	SK	N/A		1/22/2025				Sign
SIS-40	Fifth Grade Great Room	SK	N/A		1/22/2025				Sign
SIS-41	Fifth Grade Great Room Counter (left)	SK	App	3.0	1/22/2025				-
SIS-42	Fifth Grade Great Room Counter (right)	SK	App	5.0	1/22/2025				-
SIS-43	Fifth Grade Boy's Bathroom	SK	N/A		1/22/2025				Sign
SIS-44	Fifth Grade Girl's Bathroom	SK	N/A		1/22/2025				Sign
SIS-45	Fifth Grade Girl's Bathroom	SK	N/A		1/22/2025				Sign
SIS-46	Custodial Closet 130	SS	N/A		1/22/2025				Sign
SIS-47	Hall by Room 103A	BF	App	<1.0	1/22/2025				-
SIS-48	Hall by Room 103A	WF	App	<1.0	1/22/2025				-
SIS-49	Men's Bathroom 130A	SK	N/A		1/22/2025				Sign
SIS-50	Third Grade Great Room	SK	N/A		1/22/2025				Sign
SIS-51	Third Grade Great Room Counter (left)	SK	App	2.0	1/22/2025				-
SIS-52	Third Grade Great Room Counter (right)	SK	App	3.0	1/22/2025				-
SIS-53	Third Grade Boy's Bathroom	SK	N/A		1/22/2025				Sign
SIS-54	Third Grade Girl's Bathroom	SK	N/A		1/22/2025				Sign
SIS-55	Third Grade Girl's Bathroom	SK	N/A		1/22/2025				Sign

Fixture #	Sample Location	Fixture Type	App or N/A	Latest 1 <sup>st</sup> Draw Results (ppb)	Latest 1st Draw Sampling Date	15 Second Draw Results (ppb)	60 Second Draw Results (ppb)	Flush Sampling Date	Remarks
SIS-56	Hall by Room 106 (left)	WF	App	<1.0	1/22/2025				-
SIS-57	Hall by Room 106 (left)	BF	App	<1.0	1/22/2025				-
SIS-58	Hall by Room 106 (right)	WF	App	<1.0	1/22/2025				-
SIS-59	Teacher's Lounge	SK	App	2.0	1/22/2025				-
SIS-60	Teacher's Lounge Bathroom	SK	N/A		1/22/2025				Sign
SIS-61	Custodial Closet 107	SS	N/A		1/22/2025				Sign
SIS-62	Nurse's Office	SK	App	1.0	1/22/2025				
SIS-63	Nurse's Office Bathroom	SK	N/A		1/22/2025				Sign
SIS-64	Girl's Bathroom by Nurse's Office	SK	N/A		1/22/2025				Sign
SIS-65	Girl's Bathroom by Nurse's Office	SK	N/A		1/22/2025				Sign
SIS-67	All Gender Bathroom by Nurse's Office (left)	SK	N/A		1/22/2025				Sign
SIS-68	Hall by Room 114	BF	App	<1.0	1/22/2025				-

## Laboratory Report

NYE Report #: 2500187-32149

January 23, 2025

Project Manager  
Enviroscience Consultants, Inc.  
2150 Smithtown Avenue  
Ronkonkoma, NY 11779

Project: Somers CSD; Somers Intermediate School

Dear Project Manager,

Enclosed is the Laboratory Analytical Report for potable water sample(s) received on January 22, 2025. New York Environmental analyzed the samples on January 23, 2025 for Lead (Pb) by EPA Method 200.9 Rev. 2.2.

If there are any questions regarding the analyses, please feel free to contact us at your convenience. New York Environmental is a NELAP accredited laboratory. Attached reported results meet the requirements of the NELAP standards unless otherwise noted.

Samples' analytical results relate only to the samples tested, in the condition received by the laboratory. This report shall not be reproduced except in its entirety without written approval of the laboratory.

We sincerely thank you for your business, and look forward to being of service for your future environmental testing needs.

Sincerely,



---

Li Tsang, Laboratory Director

Date Collected:	22 Jan 2025
Date Received:	22 Jan 2025
Date Analyzed:	23 Jan 2025

Analytical Method:	EPA 200.9 Rev. 2.2
Analyte, Matrix:	Lead, Potable Water

Lab ID	CID	Sample Location/Description	LOQ	Result	Units	Flag
250122L001	1	Kitchen 3-Bay (left)-SK, Initial	0.001	0.003	mg/L	
250122L002	2	Kitchen 3-Bay (left)-Spray, Initial	0.001	0.003	mg/L	
250122L003	3	Kitchen 3-Bay (right)-SK, Initial	0.001	0.004	mg/L	
250122L004	4	Hall by Art Room-WF, Initial	0.001	<0.001	mg/L	
250122L005	5	Hall by Art Room-BF, Initial	0.001	<0.001	mg/L	
250122L006	6	Library Office-SK, Initial	0.001	0.004	mg/L	
250122L007	7	Hall by Faculty Room (left)-WF, Initial	0.001	<0.001	mg/L	
250122L008	8	Hall by Faculty Room (right)-WF, Initial	0.001	0.004	mg/L	
250122L009	9	Fourth Grade Great Room Counter (left)-SK, Initial	0.001	0.002	mg/L	
250122L010	10	Fourth Grade Great Room Counter (right)-SK, Initial	0.001	0.004	mg/L	
250122L011	11	Hall by Room C14-WF, Initial	0.001	<0.001	mg/L	
250122L012	12	Hall by Room C14-BF, Initial	0.001	<0.001	mg/L	
250122L013	13	Fifth Grade Great Room Counter (left)-SK, Initial	0.001	0.003	mg/L	
250122L014	14	Fifth Grade Great Room Counter (right)-SK, Initial	0.001	0.005	mg/L	
2501230615	15	Hall by Room 103A-BF, Initial	0.001	<0.001	mg/L	
250123061A	16	Hall by Room 103A-WF, Initial	0.001	<0.001	mg/L	
250123061B	17	Third Grade Great Room Counter (left)-SK, Initial	0.001	0.002	mg/L	
250123061C	18	Third Grade Great Room Counter (right)-SK, Initial	0.001	0.003	mg/L	
250123061D	19	Hall by Room 106 (left)-WF, Initial	0.001	<0.001	mg/L	
250123061E	20	Hall by Room 106 (left)-BF, Initial	0.001	<0.001	mg/L	
250123061F	21	Hall by Room 106 (right)-WF, Initial	0.001	<0.001	mg/L	
250123061G	22	Teacher's Lounge-SK, Initial	0.001	0.002	mg/L	
250123061H	23	Nurse's Office-SK, Initial	0.001	0.001	mg/L	
250123061I	24	Hall by Room 114-BF, Initial	0.001	<0.001	mg/L	

Comment:

CID: Client ID LOQ: Limit of Quantitation



**Appendix B**  
**Somers Middle School**

Fixture #	Sample Location	Fixture Type	App or N/A	Latest 1 <sup>st</sup> Draw Results (ppb)	Latest 1st Draw Sampling Date	15 Second Draw Results (ppb)	60 Second Draw Results (ppb)	Flush Sampling Date	Remarks
SMS-1	Kitchen, 3-Bay (left)	SK	App	36.0	2/25/2025				Water supply lines adjacent to steam pipes. Daily flushing protocol established.
				11.0	1/28/2025	4.0	5.0	1/28/2025	Fixture replacement recommended
				10.0	1/22/2025				Removed from Service: pending remediation
SMS-2	Kitchen, 3-Bay (right)	SK	App	23.0	2/25/2025				Water supply lines adjacent to steam pipes. Daily flushing protocol established.
				6.0	1/28/2025	4.0	4.0	1/28/2025	Fixture replacement recommended
				6.0	1/22/2025				Removed from Service: pending remediation
SMS-3	Kitchen, Prep Sink	SK	App	15.0	2/25/2025				Water supply lines adjacent to steam pipes. Daily flushing protocol established.
				9.0	1/28/2025	5.0	5.0	1/28/2025	Fixture replacement recommended
				11.0	1/22/2025				Removed from Service: pending remediation
SMS-4	Kitchen, Hot Table (left)	SK	App	12.0	1/22/2025				Sign
SMS-5	Kitchen, Hot Table (right)	SK	App	78.0	1/22/2025				Sign
SMS-6	Kitchen, Bathroom 106F	SK	N/A		1/22/2025				Sign
SMS-7	All Gender Bathroom 106H	SK	N/A		1/22/2025				Sign
SMS-8	Room 109 Faculty Room	SK	N/A		1/22/2025				Sign
SMS-9	Custodial Closet 112C	SS	N/A		1/22/2025				Sign
SMS-10	Music Bathroom 1A	SK	N/A		1/22/2025				Sign
SMS-11	Band Room 2	SK	App	19.0	1/22/2025				
SMS-12	Hallway outside Gym	BF	App	<1.0	1/22/2025				

Fixture #	Sample Location	Fixture Type	App or N/A	Latest 1 <sup>st</sup> Draw Results (ppb)	Latest 1st Draw Sampling Date	15 Second Draw Results (ppb)	60 Second Draw Results (ppb)	Flush Sampling Date	Remarks
SMS-13	Hallway outside Gym	WF	App	<1.0	1/22/2025				
SMS-14	Girls Locker Room Bathroom 113D (left)	SK	N/A		1/22/2025				Sign
SMS-15	Girls Locker Room Bathroom 113D (right)	SK	N/A		1/22/2025				Sign
SMS-16	Girls Locker Room P.E Office Bathroom 113B	SK	N/A		1/22/2025				Sign
SMS-17	Girls Bathroom 113N, Outside Gym (left)	SK	N/A		1/22/2025				Sign
SMS-18	Girls Bathroom 113N, Outside Gym (right)	SK	N/A		1/22/2025				Sign
SMS-19	Boys Bathroom 113M, Outside Gym (left)	SK	N/A		1/22/2025				Sign
SMS-20	Boys Bathroom, 113M, Outside Gym (right)	SK	N/A		1/22/2025				Sign
SMS-21	Hallway outside Boys Locker Room	WF	App	1.0	1/22/2025				
SMS-22	Boys Locker Room P.E. Office Bathroom	SK	N/A		1/22/2025				Sign
SMS-23	Boys Locker Room Bathroom (left)	SK	N/A		1/22/2025				Sign
SMS-24	Boys Locker Room Bathroom (right)	SK	N/A		1/22/2025				Sign
SMS-25	Girls Bathroom 127F (left)	SK	N/A		1/22/2025				Sign
SMS-26	Girls Bathroom 127F (right)	SK	N/A		1/22/2025				Sign
SMS-27	Between 127F & 127E	BF	App	<1.0	1/22/2025				
SMS-28	Between 127F & 127E	WF	App	<1.0	1/22/2025				
SMS-29	Boys Bathroom 127E (left)	SK	N/A		1/22/2025				Sign
SMS-30	Boys Bathroom 127E (right)	SK	N/A		1/22/2025				Sign

Fixture #	Sample Location	Fixture Type	App or N/A	Latest 1 <sup>st</sup> Draw Results (ppb)	Latest 1st Draw Sampling Date	15 Second Draw Results (ppb)	60 Second Draw Results (ppb)	Flush Sampling Date	Remarks
SMS-32	Bathroom 127A	SK	N/A		1/22/2025				Sign
SMS-33	Boiler Room 103G (left)	SK	N/A		1/22/2025				Sign
SMS-34	Boiler Room 103G (center)	SK	N/A		1/22/2025				Sign
SMS-35	Boiler Room 103G (right)	SK	N/A		1/22/2025				Sign
SMS-36	Room 105 by Door, Front of Room	SK	N/A		1/22/2025				Sign
SMS-37	Room 105 by Door, Rear of Room	SK	N/A		1/22/2025				Sign
SMS-38	Room 105 by Window, Front of Room	SK	N/A		1/22/2025				Sign
SMS-39	Room 105 by Window, Rear of Room	SK	N/A		1/22/2025				Sign
SMS-40	Cafeteria 115	BF	App	<1.0	1/22/2025				
SMS-41	Cafeteria 115	WF	App	<1.0	1/22/2025				
SMS-42	Room 107 by Door, Front of Room	SK	N/A		1/22/2025				Sign
SMS-43	Room 107 by Door, Rear of Room	SK	N/A		1/22/2025				Sign
SMS-44	Room 107 by Window, Front of Room	SK	N/A		1/22/2025				Sign
SMS-45	Room 107 by Window, Rear of Room	SK	N/A		1/22/2025				Sign
SMS-46	Custodial Closet 108C	SS	N/A		1/22/2025				Sign
SMS-47	Room 108 Music (left)	SK	N/A		1/22/2025				Sign
SMS-48	Room 108 Music (center)	SK	N/A		1/22/2025				Sign
SMS-49	Room 108 Music (right)	SK	N/A		1/22/2025				Sign

Fixture #	Sample Location	Fixture Type	App or N/A	Latest 1 <sup>st</sup> Draw Results (ppb)	Latest 1st Draw Sampling Date	15 Second Draw Results (ppb)	60 Second Draw Results (ppb)	Flush Sampling Date	Remarks
SMS-50	Room 108B	SK	N/A		1/22/2025				Sign
SMS-51	Boiler Room 103F	SK	N/A		1/22/2025				Sign
SMS-52	Room 101	SK	N/A		1/22/2025				Sign
SMS-53	Room 102	SK	N/A		1/22/2025				Sign
SMS-54	Room 211 2-Bay Sink	SK	N/A		1/22/2025				Sign
SMS-55	Hallway between 209 & 211	BF	App	<1.0	2/25/2025				
	Hallway between 209 & 211	WF	App	<1.0	2/25/2025				
	Hallway between 209 & 211	WF	App	16.0	1/22/2025				Fixture replacement
SMS-56	Room 209 (left)	SK	N/A		1/22/2025				Sign
SMS-57	Room 209 (right)	SK	N/A		1/22/2025				Sign
SMS-58	Women's Bathroom 200B (left)	SK	N/A		1/22/2025				Sign
SMS-59	Women's Bathroom 200B (right)	SK	N/A		1/22/2025				Sign
SMS-60	Men's Bathroom 200A (left)	SK	N/A		1/22/2025				Sign
SMS-61	Men's Bathroom 200A (right)	SK	N/A		1/22/2025				Sign
SMS-62	Room 205C Kitchen	SK	App	3.0	1/22/2025				
SMS-63	Room 203B Custodial	SS	N/A		1/22/2025				Sign
SMS-64	Room 201C, Bathroom in Main Office	SK	N/A		1/22/2025				Sign
SMS-65	Boys Bathroom 220B (left)	SK	N/A		1/22/2025				Sign

Fixture #	Sample Location	Fixture Type	App or N/A	Latest 1 <sup>st</sup> Draw Results (ppb)	Latest 1st Draw Sampling Date	15 Second Draw Results (ppb)	60 Second Draw Results (ppb)	Flush Sampling Date	Remarks
SMS-67	Room 220C	SK	N/A		1/22/2025				Sign
SMS-68	Hallway Between 220B & 220E	BF	App	<1.0	1/22/2025				
SMS-69	Hallway Between 220B & 220E (w/ BF)	WF	App	<1.0	1/22/2025				
SMS-70	Hallway Between 220B & 220E	WF	App	2.0	1/22/2025				
SMS-71	Girls Bathroom 220E (left)	SK	N/A		1/22/2025				Sign
SMS-72	Girls Bathroom 220E (right)	SK	N/A		1/22/2025				Sign
SMS-73	Room 231 (left)	SK	N/A		1/22/2025				Sign
SMS-74	Room 231 (center)	SK	N/A		1/22/2025				Sign
SMS-75	Room 231 (right)	SK	N/A		1/22/2025				Sign
SMS-76	Room 231 (island)	SK	N/A		1/22/2025				Sign
SMS-77	Women's Bathroom 220G (left)	SK	N/A		1/22/2025				Sign
SMS-78	Women's Bathroom 220G (right)	SK	N/A		1/22/2025				Sign
SMS-79	Custodial 220H	SS	N/A		1/22/2025				Sign
SMS-80	Boys Bathroom 220I (left)	SK	N/A		1/22/2025				Sign
SMS-81	Boys Bathroom 220I (right)	SK	N/A		1/22/2025				Sign
SMS-82	Hallway, Across from 220I	BF	App	<1.0	1/22/2025				
SMS-83	Hallway, Across from 220I	WF	App	<1.0	1/22/2025				
SMS-84	Women's Bathroom 220J (left)	SK	N/A		1/22/2025				Sign

Fixture #	Sample Location	Fixture Type	App or N/A	Latest 1 <sup>st</sup> Draw Results (ppb)	Latest 1st Draw Sampling Date	15 Second Draw Results (ppb)	60 Second Draw Results (ppb)	Flush Sampling Date	Remarks
SMS-85	Women's Bathroom 220J (right)	SK	N/A		1/22/2025				Sign
SMS-86	Hallway Next to 220J	BF	App	<1.0	1/22/2025				
SMS-87	Hallway Next to 220J	WF	App	<1.0	1/22/2025				
SMS-88	Nurse's Office Room 219	SK	App	2.0	9/4/2025				Filter installed, remediation complete
				8.0	7/31/2025				Sign Posted
				6.0	2/25/2025				Signed pending fixture replacement
SMS-88	Nurse's Office Refrigerator Ice Machine	IM	App	4.0	2/25/2025				
SMS-89	Nurse's Office Bathroom 219B	SK	App	2.0	1/28/2025				
SMS-90	Hallway Next to Room 313	BF	App	<1.0	1/22/2025				
SMS-91	Hallway Next to Room 313	WF	App	<1.0	1/22/2025				
SMS-92	Room 313	SK	N/A		1/22/2025				Sign
SMS-93	Custodial 300B	SS	N/A		1/22/2025				Sign
SMS-94	Boys Bathroom 300C (left)	SK	N/A		1/22/2025				Sign
SMS-95	Boys Bathroom 300C (center)	SK	N/A		1/22/2025				Sign
SMS-96	Boys Bathroom 200C (right)	SK	N/A		1/22/2025				Sign
SMS-97	Room 311 Wall Opposite Window	SK	App	23.0	1/22/2025				Sign
SMS-98	Room 311 Wall w/ Window	SK	App	17.0	1/22/2025				Sign
SMS-99	Bathroom 307	SK	N/A		1/22/2025				Sign

Fixture #	Sample Location	Fixture Type	App or N/A	Latest 1 <sup>st</sup> Draw Results (ppb)	Latest 1st Draw Sampling Date	15 Second Draw Results (ppb)	60 Second Draw Results (ppb)	Flush Sampling Date	Remarks
SMS-100	Bathroom 300E	SK	N/A		1/22/2025				Sign
SMS-101	Room 303 (closest to door)	SK	N/A		1/22/2025				Sign
SMS-102	Room 303 (to the right)	SK	N/A		1/22/2025				Sign
SMS-103	Room 303 (front of room left)	SK	N/A		1/22/2025				Sign
SMS-104	Room 303 (front of room right)	SK	N/A		1/22/2025				Sign
SMS-105	Room 303 (front)	SK	N/A		1/22/2025				Sign
SMS-106	Room 303 (back)	SK	N/A		1/22/2025				Sign
SMS-107	Hallway, Outside Room 302	BF	App	<1.0	2/25/2025				
	Hallway, Outside Room 302	WF	App	<1.0	2/25/2025				
	Hallway, Outside Room 302	WF	App	9.0	1/22/2025				Fixture replacement
SMS-108	Room 315 (front, window side)	SK	N/A		1/22/2025				Sign
SMS-109	Room 315 (rear, window side)	SK	N/A		1/22/2025				Sign
SMS-110	Room 315 (front, door side)	SK	N/A		1/22/2025				Sign
SMS-111	Room 315 (rear, door side)	SK	N/A		1/22/2025				Sign
SMS-112	Girls Bathroom 319 (left)	SK	N/A		1/22/2025				Sign
SMS-113	Girls Bathroom 319 (right)	SK	N/A		1/22/2025				Sign
SMS-114	Hallway, Between 319 & 317	BF	App	<1.0	1/22/2025				
SMS-115	Hallway, Between 319 & 317	WF	App	<1.0	1/22/2025				

Fixture #	Sample Location	Fixture Type	App or N/A	Latest 1 <sup>st</sup> Draw Results (ppb)	Latest 1st Draw Sampling Date	15 Second Draw Results (ppb)	60 Second Draw Results (ppb)	Flush Sampling Date	Remarks
SMS-116	Room 316 (front, door side)	SK	N/A		1/22/2025				Sign
SMS-117	Room 316 (center, door side)	SK	N/A		1/22/2025				Sign
SMS-118	Room 316 (rear, door side)	SK	N/A		1/22/2025				Sign
SMS-119	Room 316 (front, window side)	SK	N/A		1/22/2025				Sign
SMS-120	Room 316 (rear, window side)	SK	N/A		1/22/2025				Sign
SMS-121	Room 316A Prep	SK	N/A		1/22/2025				Sign
SMS-122	Hallway by Room 204	BF	App	<1.0	2/25/2025				
SMS-123	Hallway by Room 204	WF	App	<1.0	2/25/2025				
SMS-124	Hallway by Special Services	BF	App	<1.0	7/31/2025				New fixture installed summer 2025
SMS-125	Hallway by Special Services	WF	App	<1.0	7/31/2025				New fixture installed summer 2025

## Laboratory Report

NYE Report #: 2500188-32150

January 24, 2025

Project Manager  
Enviroscience Consultants, Inc.  
2150 Smithtown Avenue  
Ronkonkoma, NY 11779

Project: Somers CSD; Somers Middle School

Dear Project Manager,

Enclosed is the Laboratory Analytical Report for potable water sample(s) received on January 22, 2025. New York Environmental analyzed the samples on January 23, 2025 for Lead (Pb) by EPA Method 200.9 Rev. 2.2.

If there are any questions regarding the analyses, please feel free to contact us at your convenience. New York Environmental is a NELAP accredited laboratory. Attached reported results meet the requirements of the NELAP standards unless otherwise noted.

Samples' analytical results relate only to the samples tested, in the condition received by the laboratory. This report shall not be reproduced except in its entirety without written approval of the laboratory.

We sincerely thank you for your business, and look forward to being of service for your future environmental testing needs.

Sincerely,

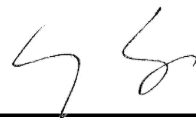

---

Li Tsang, Laboratory Director

Date Collected:	22 Jan 2025
Date Received:	22 Jan 2025
Date Analyzed:	23 Jan 2025

Analytical Method:	EPA 200.9 Rev. 2.2
Analyte, Matrix:	Lead, Potable Water

Lab ID	CID	Sample Location/Description	LOQ	Result	Units	Flag
250122L015	1	Kitchen, 3-Bay (left)-SK, Initial	0.001	0.010	mg/L	H
250122L016	2	Kitchen, 3-Bay (right)-SK, Initial	0.001	0.006	mg/L	H
250122L017	3	Kitchen, Prep Sink-SK, Initial	0.001	0.011	mg/L	H
250122L018	4	Kitchen, Hot Table (left)-SK, Initial	0.001	0.012	mg/L	H
250122L019	5	Kitchen, Hot Table (right)-SK, Initial	0.001	0.078	mg/L	E,H
250122L020	6	Band Room 2-SK, Initial	0.001	0.019	mg/L	H
250122L021	7	Hallway outside Gym-BF, Initial	0.001	<0.001	mg/L	
250122L022	8	Hallway outside Gym-WF, Initial	0.001	<0.001	mg/L	
250122L023	9	Hallway outside Boys Locker Room-WF, Initial	0.001	0.001	mg/L	
250122L024	10	Between 127F & 127E-BF, Initial	0.001	<0.001	mg/L	
250122L025	11	Between 127F & 127E-WF, Initial	0.001	<0.001	mg/L	
250122L026	12	Boys Bathroom 127E (left)-SK, Initial	0.001	0.002	mg/L	
250122L027	13	Cafeteria 115-BF, Initial	0.001	<0.001	mg/L	
250122L028	14	Cafeteria 115-WF, Initial	0.001	<0.001	mg/L	
250122L029	15	Hallway between 209 & 211-WF, Initial	0.001	0.016	mg/L	H
250122L030	16	Room 205C Kitchen-SK, Initial	0.001	0.003	mg/L	
250122L031	17	Hallway, Between 220B & 220E-BF, Initial	0.001	<0.001	mg/L	
250122L032	18	Hallway, Between 220B & 220E (w/ BF)-WF, Initial	0.001	<0.001	mg/L	
250122L033	19	Hallway, Between 220B & 220E-WF, Initial	0.001	0.002	mg/L	
250122L034	20	Hallway, Across from 220I-BF, Initial	0.001	<0.001	mg/L	
250122L035	21	Hallway, Across from 220I-WF, Initial	0.001	<0.001	mg/L	
250122L036	22	Hallway, Next to 220J-BF, Initial	0.001	<0.001	mg/L	
250122L037	23	Hallway, Next to 220J-WF, Initial	0.001	<0.001	mg/L	
250122L038	24	Hallway, Next to Room 313-BF, Initial	0.001	<0.001	mg/L	
250122L039	25	Hallway, Next to Room 313-WF, Initial	0.001	<0.001	mg/L	
250122L040	26	Room 311 Wall Opposite Window-SK, Initial	0.001	0.023	mg/L	H



Date Collected:	22 Jan 2025
Date Received:	22 Jan 2025
Date Analyzed:	23 Jan 2025

Analytical Method:	EPA 200.9 Rev. 2.2
Analyte, Matrix:	Lead, Potable Water

<u>Lab ID</u>	<u>CID</u>	<u>Sample Location/Description</u>	<u>LOQ</u>	<u>Result</u>	<u>Units</u>	<u>Flag</u>
250122L041	27	Room 311 Wall w/ Window-SK, Initial	0.001	0.017	mg/L	H
250122L042	28	Hallway, Outside Room 302-WF, Initial	0.001	0.009	mg/L	H
250122L043	29	Hallway, Between 319 & 317-BF, Initial	0.001	<0.001	mg/L	
250122L044	30	Hallway, Between 319 & 317-WF, Initial	0.001	<0.001	mg/L	

Comment:

CID: Client ID LOQ: Limit of Quantitation

E: Sample result exceeds instrument calibration, value is estimated.

H: Sample result exceeds applicable regulatory limit.

## Laboratory Report

NYE Report #: 2500349-32210

January 30, 2025

Project Manager  
Enviroscience Consultants, Inc.  
2150 Smithtown Avenue  
Ronkonkoma, NY 11779

Project: Somers CSD; Somers Middle School

Dear Project Manager,

Enclosed is the Laboratory Analytical Report for potable water sample(s) received on January 29, 2025. New York Environmental analyzed the samples on January 30, 2025 for Lead (Pb) by EPA Method 200.9 Rev. 2.2.

If there are any questions regarding the analyses, please feel free to contact us at your convenience. New York Environmental is a NELAP accredited laboratory. Attached reported results meet the requirements of the NELAP standards unless otherwise noted.

Samples' analytical results relate only to the samples tested, in the condition received by the laboratory. This report shall not be reproduced except in its entirety without written approval of the laboratory.

We sincerely thank you for your business, and look forward to being of service for your future environmental testing needs.

Sincerely,



---

Li Tsang, Laboratory Director

Date Collected:	28 Jan 2025
Date Received:	29 Jan 2025
Date Analyzed:	30 Jan 2025

Analytical Method:	EPA 200.9 Rev. 2.2
Analyte, Matrix:	Lead, Potable Water

Lab ID	CID	Sample Location/Description	LOQ	Result	Units	Flag
250129K007	1A	Kitchen 3-Bay (Left)-SK, Initial	0.001	0.011	mg/L	H
250129K008	1B	Kitchen 3-Bay (Left)-SK, 15 Sec Flush	0.001	0.004	mg/L	
250129K009	1C	Kitchen 3-Bay (Left)-SK, 60 Sec Flush	0.001	0.005	mg/L	
250129K010	2A	Kitchen 3-Bay (Right)-SK, Initial	0.001	0.006	mg/L	H
250129K011	2B	Kitchen 3-Bay (Right)-SK, 15 Sec Flush	0.001	0.004	mg/L	
250129K012	2C	Kitchen 3-Bay (Right)-SK, 60 Sec Flush	0.001	0.004	mg/L	
250129K013	3A	Kitchen Prep Sink-SK, Initial	0.001	0.009	mg/L	H
250129K014	3B	Kitchen Prep Sink-SK, 15 Sec Flush	0.001	0.005	mg/L	
250129K015	3C	Kitchen Prep Sink-SK, 60 Sec Flush	0.001	0.005	mg/L	
250129K016	4	Nurse's Office-SK, Initial	0.001	0.006	mg/L	H
250129K017	5	Nurse's Office Bathroom-SK, Initial	0.001	0.002	mg/L	

Comment:

CID: Client ID LOQ: Limit of Quantitation

H: Sample result exceeds applicable regulatory limit.

## Laboratory Report

NYE Report #: 2500725-32469

February 27, 2025

Project Manager  
Enviroscience Consultants, Inc.  
2150 Smithtown Avenue  
Ronkonkoma, NY 11779

Project: Somers CSD; Somers Middle School

Dear Project Manager,

Enclosed is the Laboratory Analytical Report for potable water sample(s) received on February 26, 2025. New York Environmental analyzed the samples on February 27, 2025 for Lead (Pb) by EPA Method 200.9 Rev. 2.2.

If there are any questions regarding the analyses, please feel free to contact us at your convenience. New York Environmental is a NELAP accredited laboratory. Attached reported results meet the requirements of the NELAP standards unless otherwise noted.

Samples' analytical results relate only to the samples tested, in the condition received by the laboratory. This report shall not be reproduced except in its entirety without written approval of the laboratory.

We sincerely thank you for your business, and look forward to being of service for your future environmental testing needs.

Sincerely,

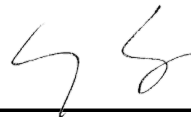

---

Li Tsang, Laboratory Director

Date Collected:	25 Feb 2025
Date Received:	26 Feb 2025
Date Analyzed:	27 Feb 2025

Analytical Method:	EPA 200.9 Rev. 2.2
Analyte, Matrix:	Lead, Potable Water

Lab ID	CID	Sample Location/Description	LOQ	Result	Units	Flag
250226R185	1	Kitchen 3-Bay(Left) - SK, Initial	0.001	0.036	mg/L	H
250226R186	2	Kitchen 3-Bay(Reft) - SK, Initial	0.001	0.023	mg/L	H
250226R187	3	Kitchen Prep Skink - SK, Initial	0.001	0.015	mg/L	H
250226R188	4	Hallway btw 209 & 2011- BF, Initial	0.001	<0.001	mg/L	
250226R189	5	Hallway btw 209 & 2011- WF, Initial	0.001	<0.001	mg/L	
250226R190	6	Hallway by Room 204 - BF, Initial	0.001	<0.001	mg/L	
250226R191	7	Hallway by Room 204 - WF, Initial	0.001	<0.001	mg/L	
250226R192	8	Hallway by Room 302 - BF, Initial	0.001	<0.001	mg/L	
250226R193	9	Hallway by Room 302 - WF, Initial	0.001	<0.001	mg/L	
250226R194	10A	Nurses Office Sink - SK, Initial	0.001	0.009	mg/L	H
250226R195	10B	Nurses Office Sink - BF, Initial	0.001	<0.001	mg/L	
250226R196	10C	Nurses Office Sink - WF, Initial	0.001	<0.001	mg/L	
250226R197	11	Nurses Office Ice Machine - IM, Initial	0.001	0.004	mg/L	

Comment:

CID: Client ID LOQ: Limit of Quantitation

H: Sample result exceeds applicable regulatory limit.

## Laboratory Report

August 1, 2025

John Driscoll  
Enviroscience Consultants, Inc.  
2150 Smithtown Ave.  
Ronkonkoma, NY, 11779

Project: Somers CSD - Somers Middle School (Enviroscience - 25987)  
Project Address: Somers Middle School  
Report ID: 250731011  
Sample IDs: 250731011-058 - 250731011-060

New York Environmental is a NELAC accredited laboratory. Attached reported results meet the requirements of the NELAC standard unless otherwise noted.

Samples' analytical results relate only to the parameters tested for the samples received in the condition received by the laboratory, as noted on the Chain of Custody. This report shall not be reproduced except in its entirety without written approval of the laboratory.

We sincerely thank you for your business, and look forward to being of service for your future environmental testing needs.

Sincerely,



---

Li Tsang, Laboratory Director

Date Collected:	31-Jul-25
Date Received:	31-Jul-25
Date Analyzed:	1-Aug-25

Analytical Method:	EPA 200.9
Analyte, Matrix:	Lead, Potable Water

Lab ID	CID	Sample Location/Description	LOQ	Result	Units	Flag
250731011-058	1	Nurses Office - SK; Initial	0.001	0.008	mg/L	H
250731011-059	2	Hallway by Special Services - BF; Initial	0.001	<0.001	mg/L	
250731011-060	3	Hallway by Special Services - WF; Initial	0.001	<0.001	mg/L	

**Comment(s):**

LOQ: Limit of Quantitation

CID: Client ID

H: Sample result exceeds applicable regulatory limit.



## Laboratory Report

September 8, 2025

Project Manager  
Enviroscience Consultants, Inc.  
2150 Smithtown Ave.  
Ronkonkoma, NY, 11779

Project: Somers CSD Middle School  
Project Address: 250 US-202  
Report ID: 250908001  
Sample IDs: 250908001-002 - 250908001-002

New York Environmental is a NELAC accredited laboratory. Attached reported results meet the requirements of the NELAC standard unless otherwise noted.

Samples' analytical results relate only to the parameters tested for the samples received in the condition received by the laboratory, as noted on the Chain of Custody. This report shall not be reproduced except in its entirety without written approval of the laboratory.

We sincerely thank you for your business, and look forward to being of service for your future environmental testing needs.

Sincerely,

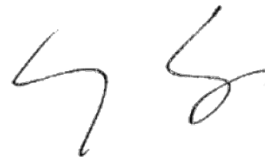

---

Li Tsang, Laboratory Director

Date Collected:	4-Sep-25
Date Received:	6-Sep-25
Date Analyzed:	8-Sep-25

Analytical Method:	EPA 200.9
Analyte, Matrix:	Lead, Potable Water

Lab ID	CID	Sample Location/Description	LOQ	Result	Units	Flag
250908001-002	1	Nurses Office Sink; initial	0.001	0.002	mg/L	

**Comment(s):**

LOQ: Limit of Quantitation  
CID: Client ID



**Appendix C**  
**Primrose Elementary School**

Fixture #	Sample Location	Fixture Type	App or N/A	Latest 1 <sup>st</sup> Draw Results (ppb)	Latest 1st Draw Sampling Date	15 Second Draw Results (ppb)	60 Second Draw Results (ppb)	Flush Sampling Date	Remarks
PES-1	Kitchen 2-Bay - Left	SK	App	<1.0	2/25/2025				
PES-2	Kitchen 2-Bay - Right	SK	App	1.0	2/25/2025				
PES-3	Kitchen Prep	SK	App	2.0	2/25/2025				
PES-4	Kitchen 3-Bay - Left	SK	App	16.0	2/25/2025				Dishwash Station-sign posted
PES-5	Kitchen 3-Bay - Center	SK	App	6.0	2/25/2025				Dishwash Station-sign posted
PES-6	Kitchen 3-Bay - Right	SK	App	2.0	2/25/2025				
PES-7	Kitchen Stove, Pot Filler	PF	App	5.0	2/25/2025				
PES-8	Kitchen Serving Line - Left	PF	N/A		2/25/2025				Sign
PES-9	Kitchen Serving Line - Right	PF	N/A		2/25/2025				Sign
PES-10	Kitchen, Standalone Pot Filler	PF	N/A		2/25/2025				Removed fro service
PES-11	Cafeteria	BF	App	<1.0	2/25/2025				
PES-12	Cafeteria	WF	App	<1.0	2/25/2025				
PES-13	Classroom C4	SK	App	<1.0	2/25/2025				
PES-14	Classroom C4 Bathroom	SK	App	18.0	2/25/2025				Removed from service; pending remediation
PES-15	Classroom C3	SK	App	3.0	2/25/2025				
PES-16	Classroom C3 Bathroom	SK	App	6.0	2/25/2025				Removed from service; pending remediation
PES-17	Hall C Wing	BF	App	<1.0	2/25/2025				
PES-18	Hall C Wing	WF	App	<1.0	2/25/2025				

Fixture #	Sample Location	Fixture Type	App or N/A	Latest 1 <sup>st</sup> Draw Results (ppb)	Latest 1st Draw Sampling Date	15 Second Draw Results (ppb)	60 Second Draw Results (ppb)	Flush Sampling Date	Remarks
PES-19	Classroom C2	SK	App	2.0	2/25/2025				
PES-20	Classroom C2 Bathroom	SK	App	4.0	2/25/2025				
PES-21	Classroom C1	SK	App	6.0	2/25/2025				Sign posted
PES-22	Classroom C1 Bathroom	SK	App	3.0	2/25/2025				
PES-23	Classroom B7	SK	App	<1.0	2/25/2025				
PES-24	Classroom B8	SK	App	<1.0	2/25/2025				
PES-25	Classroom B3	SK	App	9.0	2/25/2025				Sign posted
PES-26	Classroom B3 Bathroom	SK	App	2.0	2/25/2025				
PES-27	Classroom B2	SK	App	7.0	2/25/2025				Sign posted
PES-28	Classroom B2 Bathroom	SK	App	4.0	2/25/2025				
PES-29	Hall B Wing	BF	App	<1.0	2/25/2025				
PES-30	Hall B Wing	WF	App	<1.0	2/25/2025				
PES-31	Classroom B4 Bathroom	SK	App	4.0	2/25/2025				
PES-32	Classroom B4 Bathroom	SK	App	3.0	2/25/2025				
PES-33	Classroom B1	SK	App	2.0	2/25/2025				
PES-34	Classroom B1 Bathroom	SK	App	2.0	2/25/2025				
PES-35	Classroom A4	SK	App	<1.0	2/25/2025				
PES-36	Classroom A4 Bathroom	SK	App	1.0	2/25/2025				

Fixture #	Sample Location	Fixture Type	App or N/A	Latest 1 <sup>st</sup> Draw Results (ppb)	Latest 1st Draw Sampling Date	15 Second Draw Results (ppb)	60 Second Draw Results (ppb)	Flush Sampling Date	Remarks
PES-37	Classroom A1	SK	App	<1.0	2/25/2025				
PES-38	Classroom A1 Bathroom	SK	App	2.0	2/25/2025				
PES-39	Hall A Wing	BF	App	<1.0	2/25/2025				
PES-40	Hall A Wing	WF	App	<1.0	2/25/2025				
PES-41	Classroom A2	SK	App	<1.0	2/25/2025				
PES-42	Classroom A2 Bathroom	SK	App	2.0	2/25/2025				
PES-43	Classroom A3	SK	App	5.0	2/25/2025				
PES-44	Classroom A3 Bathroom	SK	App	3.0	2/25/2025				
PES-45	Classroom A5	SK	App	4.0	2/25/2025				
PES-46	Classroom A6	SK	App	6.0	2/25/2025				Sign posted
PES-47	Classroom A6 Bathroom	SK	App	1.0	2/25/2025				
PES-48	Classroom A9	SK	App	<1.0	2/25/2025				
PES-49	Classroom A9 Bathroom	SK	App	1.0	2/25/2025				
PES-50	Classroom A8	SK	App	2.0	2/25/2025				
PES-51	Classroom A8 Bathroom	SK	App	2.0	2/25/2025				
PES-52	Classroom A11	SK	App	<1.0	2/25/2025				
PES-53	Classroom A11 Bathroom	SK	App	<1.0	2/25/2025				
PES-54	Classroom A10	SK	App	1.0	2/25/2025				

Fixture #	Sample Location	Fixture Type	App or N/A	Latest 1 <sup>st</sup> Draw Results (ppb)	Latest 1st Draw Sampling Date	15 Second Draw Results (ppb)	60 Second Draw Results (ppb)	Flush Sampling Date	Remarks
PES-55	Classroom A10 Bathroom	SK	App	1.0	2/25/2025				
PES-56	Classroom A13	SK	App	<1.0	2/25/2025				
PES-57	Classroom A13 Bathroom	SK	App	<1.0	2/25/2025				
PES-58	Classroom A12	SK	App	5.0	2/25/2025				
PES-59	Classroom A12 Bathroom	SK	App	<1.0	2/25/2025				
PES-60	Classroom A14	SK	App	<1.0	2/25/2025				
PES-61	Classroom A14 Bathroom	SK	App	2.0	2/25/2025				
PES-62	Classroom A15 - Left	SK	App	9.0	2/25/2025				Sign posted
PES-63	Classroom A15 - Center	SK	App	14.0	2/25/2025				Sign posted
PES-64	Classroom A15 - Right	SK	App	28.0	2/25/2025				Sign posted
PES-65	Classroom A15 Bathroom	SK	App	2.0	2/25/2025				
PES-67	Hall A Wing	WF	App	<1.0	2/25/2025				
PES-68	Room 8	SK	App	<1.0	2/25/2025				
PES-69	Room 6 Nurse	SK	App	<1.0	2/25/2025				
PES-70	Room 6 Nurse Bathroom	SK	App	2.0	2/25/2025				
PES-71	Room 6 Nurse Freezer Ice Maker	IM	App	<1.0	2/25/2025				
PES-72	Classroom K4	SK	App	<1.0	2/25/2025				
PES-73	Classroom K4 Bathroom - Left	SK	App	3.0	2/25/2025				

Fixture #	Sample Location	Fixture Type	App or N/A	Latest 1 <sup>st</sup> Draw Results (ppb)	Latest 1st Draw Sampling Date	15 Second Draw Results (ppb)	60 Second Draw Results (ppb)	Flush Sampling Date	Remarks
PES-74	Classroom K4 Bathroom - Right	SK	App	1.0	2/25/2025				
PES-75	Classroom K3	SK	App	<1.0	2/25/2025				
PES-76	Classroom K3 Bathroom - Left	SK	App	4.0	2/25/2025				
PES-77	Classroom K3 Bathroom - Right	SK	App	3.0	2/25/2025				
PES-78	Classroom K2	SK	App	1.0	2/25/2025				
PES-79	Classroom K2 Bathroom	SK	App	2.0	2/25/2025				
PES-80	Classroom K1	SK	App	2.0	2/25/2025				
PES-81	Classroom K1 Bathroom - Left	SK	App	5.0	2/25/2025				
PES-82	Classroom K1 Bathroom - Right	SK	App	2.0	2/25/2025				
PES-83	Conference Room Bathroom	SK	App	1.0	2/25/2025				
PES-84	Front Hall	BF	App	<1.0	2/25/2025				
PES-85	Front Hall	WF	App	<1.0	2/25/2025				
PES-86	Library Office	SK	App	2.0	2/25/2025				
PES-87	Outside Cafeteria	BF	App	<1.0	2/25/2025				
PES-88	Outside Cafeteria	WF	App	<1.0	2/25/2025				
PES-89	Gym Hall	BF	App	<1.0	2/25/2025				
PES-90	Gym Hall	WF	App	<1.0	2/25/2025				
PES-91	Gym Far Side	WF	App	<1.0	2/25/2025				

Fixture #	Sample Location	Fixture Type	App or N/A	Latest 1 <sup>st</sup> Draw Results (ppb)	Latest 1st Draw Sampling Date	15 Second Draw Results (ppb)	60 Second Draw Results (ppb)	Flush Sampling Date	Remarks
PES-92	Classroom F3	SK	App	6.0	2/25/2025				Sign posted
PES-93	Classroom F4	SK	App	5.0	2/25/2025				
PES-94	Hall F Wing	BF	App	<1.0	2/25/2025				
PES-95	Hall F Wing	WF	App	<1.0	2/25/2025				
PES-96	Classroom F2	SK	App	4.0	2/25/2025				
PES-97	Classroom E1B	SK	App	13.0	2/25/2025				Sign posted
PES-98	Classroom E4	SK	App	2.0	2/25/2025				
PES-99	Classroom E3	SK	App	10.0	2/25/2025				Sign posted
PES-100	Classroom E2	SK	App	3.0	2/25/2025				
PES-101	Classroom E1	SK	App	37.0	2/25/2025				Sign posted
PES-102	Classroom D8	SK	App	1.0	2/25/2025				
PES-103	Classroom D7	SK	App	<1.0	2/25/2025				
PES-104	Classroom D3	SK	App	6.0	2/25/2025				Sign posted
PES-105	Classroom D4	SK	App	2.0	2/25/2025				
PES-106	Classroom D2	SK	App	2.0	2/25/2025				
PES-107	Classroom D1	SK	App	2.0	2/25/2025				
PES-108	Pre-K Wing	WF	App	<1.0	7/31/2025				New Fixture Summer 2025
PES-109	Pre-K Wing	BF	App	<1.0	7/31/2025				New Fixture Summer 2025

Fixture #	Sample Location	Fixture Type	App or N/A	Latest 1 <sup>st</sup> Draw Results (ppb)	Latest 1st Draw Sampling Date	15 Second Draw Results (ppb)	60 Second Draw Results (ppb)	Flush Sampling Date	Remarks
PES-110	Cafeteria-2	WF	App	<1.0	7/31/2025				New Fixture Summer 2025
PES-111	Cafeteria-2	BF	App	<1.0	7/31/2025				New Fixture Summer 2025

## Laboratory Report

NYE Report #: 2500721-32465

February 28, 2025

Project Manager  
Enviroscience Consultants, Inc.  
2150 Smithtown Avenue  
Ronkonkoma, NY 11779

Project: Somers CSD; Primrose Elementary School

Dear Project Manager,

Enclosed is the Laboratory Analytical Report for potable water sample(s) received on February 26, 2025. New York Environmental analyzed the samples on February 27, 2025 for Lead (Pb) by EPA Method 200.9 Rev. 2.2.

If there are any questions regarding the analyses, please feel free to contact us at your convenience. New York Environmental is a NELAP accredited laboratory. Attached reported results meet the requirements of the NELAP standards unless otherwise noted.

Samples' analytical results relate only to the samples tested, in the condition received by the laboratory. This report shall not be reproduced except in its entirety without written approval of the laboratory.

We sincerely thank you for your business, and look forward to being of service for your future environmental testing needs.

Sincerely,

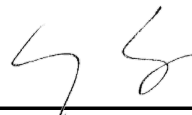

---

Li Tsang, Laboratory Director

Date Collected:	25 Feb 2025
Date Received:	26 Feb 2025
Date Analyzed:	27 Feb 2025

Analytical Method:	EPA 200.9 Rev. 2.2
Analyte, Matrix:	Lead, Potable Water

Lab ID	CID	Sample Location/Description	LOQ	Result	Units	Flag
250226R020	1	Kitchen, 2-Bay- Left - SK, Initial	0.001	<0.001	mg/L	
250226R021	2	Kitchen, 2-Bay- Right - SK, Initial	0.001	0.001	mg/L	
250226R022	3	Kitchen Prep - SK, Initial	0.001	0.002	mg/L	
250226R023	4	Kitchen, 3-Bay- Left - SK, Initial	0.001	0.016	mg/L	H
250226R024	5	Kitchen, 3-Bay- Center - SK, Initial	0.001	0.006	mg/L	H
250226R025	6	Kitchen, 3-Bay- Right - SK, Initial	0.001	0.002	mg/L	
250226R026	7	Kitchen, Stove, Pot Filler - PF, Initial	0.001	0.005	mg/L	
250226R027	8	Cafeteria - BF, Initial	0.001	<0.001	mg/L	
250226R028	9	Cafeteria - WF, Initial	0.001	<0.001	mg/L	
250226R029	10	Classroom C4 - SK, Initial	0.001	<0.001	mg/L	
250226R030	11	Classroom C4 Bathroom - SK, Initial	0.001	0.018	mg/L	H
250226R031	12	Classroom C3 - SK, Initial	0.001	0.003	mg/L	
250226R032	13	Classroom C3 Bathroom - SK, Initial	0.001	0.006	mg/L	H
250226R033	14	Hall C Wing - BF, Initial	0.001	<0.001	mg/L	
250226R034	15	Hall C Wing - WF, Initial	0.001	<0.001	mg/L	
250226R035	16	Classroom C2 - SK, Initial	0.001	0.002	mg/L	
250226R036	17	Classroom C2 Bathroom - SK, Initial	0.001	0.004	mg/L	
250226R037	18	Classroom C1 - SK, Initial	0.001	0.006	mg/L	H
250226R038	19	Classroom C1 Bathroom - SK, Initial	0.001	0.003	mg/L	
250226R039	20	Classroom B7 - SK, Initial	0.001	<0.001	mg/L	
250226R040	21	Classroom B8 - SK, Initial	0.001	<0.001	mg/L	
250226R041	22	Classroom B3 - SK, Initial	0.001	0.009	mg/L	H
250226R042	23	Classroom B3 Bathroom - SK, Initial	0.001	0.002	mg/L	
250226R043	24	Classroom B2 - SK, Initial	0.001	0.007	mg/L	H
250226R044	25	Classroom B2 Bathroom - SK, Initial	0.001	0.004	mg/L	
250226R045	26	Hall B Wing - BF, Initial	0.001	<0.001	mg/L	



Date Collected:	25 Feb 2025
Date Received:	26 Feb 2025
Date Analyzed:	27 Feb 2025

Analytical Method:	EPA 200.9 Rev. 2.2
Analyte, Matrix:	Lead, Potable Water

Lab ID	CID	Sample Location/Description	LOQ	Result	Units	Flag
250226R046	27	Hall B Wing - WF, Initial	0.001	<0.001	mg/L	
250226R047	28	Classroom B4 - SK, Initial	0.001	0.004	mg/L	
250226R048	29	Classroom B4 Bathroom - SK, Initial	0.001	0.003	mg/L	
250226R049	30	Classroom B1 - SK, Initial	0.001	0.002	mg/L	
250226R050	31	Classroom B1 Bathroom - SK, Initial	0.001	0.002	mg/L	
250226R051	32	Classroom A4 - SK, Initial	0.001	<0.001	mg/L	
250226R052	33	Classroom A4 Bathroom - SK, Initial	0.001	0.001	mg/L	
250226R053	34	Classroom A1 - SK, Initial	0.001	<0.001	mg/L	
250226R054	35	Classroom A1 Bathroom - SK, Initial	0.001	0.002	mg/L	
250226R055	36	Hall A Wing - BF, Initial	0.001	<0.001	mg/L	
250226R056	37	Hall A Wing - WF, Initial	0.001	<0.001	mg/L	
250226R057	38	Classroom A2 - SK, Initial	0.001	<0.001	mg/L	
250226R058	39	Classroom A2 Bathroom - SK, Initial	0.001	0.002	mg/L	
250226R059	40	Classroom A3 - SK, Initial	0.001	0.005	mg/L	
250226R060	41	Classroom A3 Bathroom - SK, Initial	0.001	0.003	mg/L	
250226R061	42	Classroom A5 - SK, Initial	0.001	0.004	mg/L	
250226R062	43	Classroom A6 - SK, Initial	0.001	0.006	mg/L	H
250226R063	44	Classroom A6 Bathroom - SK, Initial	0.001	0.001	mg/L	
250226R064	45	Classroom A9 - SK, Initial	0.001	<0.001	mg/L	
250226R065	46	Classroom A9 Bathroom - SK, Initial	0.001	0.001	mg/L	
250226R066	47	Classroom A8 - SK, Initial	0.001	0.002	mg/L	
250226R067	48	Classroom A8 Bathroom - SK, Initial	0.001	0.002	mg/L	
250226R068	49	Classroom A11 - SK, Initial	0.001	<0.001	mg/L	
250226R069	50	Classroom A11 Bathroom - SK, Initial	0.001	<0.001	mg/L	
250226R070	51	Classroom A10 - SK, Initial	0.001	0.001	mg/L	
250226R071	52	Classroom A10 Bathroom - SK, Initial	0.001	0.001	mg/L	
250226R072	53	Classroom A13 - SK, Initial	0.001	<0.001	mg/L	



Date Collected:	25 Feb 2025
Date Received:	26 Feb 2025
Date Analyzed:	27 Feb 2025

Analytical Method:	EPA 200.9 Rev. 2.2
Analyte, Matrix:	Lead, Potable Water

Lab ID	CID	Sample Location/Description	LOQ	Result	Units	Flag
250226R073	54	Classroom A13 Bathroom - SK, Initial	0.001	<0.001	mg/L	
250226R074	55	Classroom A12 - SK, Initial	0.001	0.005	mg/L	
250226R075	56	Classroom A12 Bathroom - SK, Initial	0.001	<0.001	mg/L	
250226R076	57	Classroom A14 - SK, Initial	0.001	<0.001	mg/L	
250226R077	58	Classroom A14 Bathroom - SK, Initial	0.001	0.002	mg/L	
250226R078	59	Classroom A15 - Left - SK, Initial	0.001	0.009	mg/L	H
250226R079	60	Classroom A15 - Center - SK, Initial	0.001	0.014	mg/L	H
250226R080	61	Classroom A15 - Right - SK, Initial	0.001	0.028	mg/L	H
250226R081	62	Classroom A15 Bathroom - SK, Initial	0.001	0.002	mg/L	
250226R082	63	Hall A Wing - BF, Initial	0.001	<0.001	mg/L	
250226R083	64	Hall A Wing - WF, Initial	0.001	<0.001	mg/L	
250226R084	65	Room 8 - SK, Initial	0.001	<0.001	mg/L	
250226R085	66	Room 6 Nurse - SK, Initial	0.001	<0.001	mg/L	
250226R086	67	Room 6 Nurse Bathroom - SK, Initial	0.001	0.002	mg/L	
250226R087	68	Room 6 Nurse Freezer Ice Maker - SK, Initial	0.001	<0.001	mg/L	
250226R088	69	Classroom K4 - SK, Initial	0.001	<0.001	mg/L	
250226R089	70	Classroom K4 Bathroom- Left - SK, Initial	0.001	0.003	mg/L	
250226R090	71	Classroom K4 Bathroom- Right - SK, Initial	0.001	0.001	mg/L	
250226R091	72	Classroom K3 - SK, Initial	0.001	<0.001	mg/L	
250226R092	73	Classroom K3 Bathroom- Left - SK, Initial	0.001	0.004	mg/L	
250226R093	74	Classroom K3 Bathroom- Right - SK, Initial	0.001	0.003	mg/L	
250226R094	75	Classroom K2 - SK, Initial	0.001	0.001	mg/L	
250226R095	76	Classroom K2 Bathroom - SK, Initial	0.001	0.002	mg/L	
250226R096	77	Classroom K1 - SK, Initial	0.001	0.002	mg/L	
250226R097	78	Classroom K1 Bathroom- Left - SK, Initial	0.001	0.005	mg/L	
250226R098	79	Classroom K1 Bathroom- Right - SK, Initial	0.001	0.002	mg/L	
250226R099	80	Conference Room Bathroom - SK, Initial	0.001	0.001	mg/L	



Date Collected:	25 Feb 2025
Date Received:	26 Feb 2025
Date Analyzed:	27 Feb 2025

Analytical Method:	EPA 200.9 Rev. 2.2
Analyte, Matrix:	Lead, Potable Water

Lab ID	CID	Sample Location/Description	LOQ	Result	Units	Flag
250226R100	81	Front Hall - BF, Initial	0.001	<0.001	mg/L	
250226R101	82	Front Hall - WF, Initial	0.001	<0.001	mg/L	
250226R102	83	Library Office - SK, Initial	0.001	0.002	mg/L	
250226R103	84	Outside Cafeteria -BF, Initial	0.001	<0.001	mg/L	
250226R104	85	Outside Cafeteria -WF, Initial	0.001	<0.001	mg/L	
250226R105	86	Gym Hall - BF, Initial	0.001	<0.001	mg/L	
250226R106	87	Gym Hall - WF, Initial	0.001	<0.001	mg/L	
250226R107	88	Gym Far Side - WF, Initial	0.001	<0.001	mg/L	
250226R108	89	Classroom F3 - SK, Initial	0.001	0.006	mg/L	H
250226R109	90	Classroom F4 - SK, Initial	0.001	0.005	mg/L	
250226R110	91	Hall F Wing - BF, Initial	0.001	<0.001	mg/L	
250226R111	92	Hall F Wing - WF, Initial	0.001	<0.001	mg/L	
250226R112	93	Classroom F2 - SK, Initial	0.001	0.004	mg/L	
250226R113	94	Classroom E1B - SK, Initial	0.001	0.013	mg/L	H
250226R114	95	Classroom E4 - SK, Initial	0.001	0.002	mg/L	
250226R115	96	Classroom E3 - SK, Initial	0.001	0.010	mg/L	H
250226R116	97	Classroom E2 - SK, Initial	0.001	0.003	mg/L	
250226R117	98	Classroom E1 - SK, Initial	0.001	0.037	mg/L	H
250226R118	99	Classroom D8 - SK, Initial	0.001	0.001	mg/L	
250226R119	100	Classroom D7 - SK, Initial	0.001	<0.001	mg/L	
250226R120	101	Classroom D3 - SK, Initial	0.001	0.006	mg/L	H
250226R121	102	Classroom D4 - SK, Initial	0.001	0.002	mg/L	
250226R122	103	Classroom D2 - SK, Initial	0.001	0.002	mg/L	
250226R123	104	Classroom D1 - SK, Initial	0.001	0.002	mg/L	

Comment:

CID: Client ID LOQ: Limit of Quantitation

H: Sample result exceeds applicable regulatory limit.



## Laboratory Report

NYE Report #: 2503635-33986

August 1, 2025

Project Manager  
Enviroscience Consultants, Inc.  
2150 Smithtown Avenue  
Ronkonkoma, NY 11779

Project: Somers Csd; Primrose Elementary School

Dear Project Manager,

Enclosed is the Laboratory Analytical Report for potable water sample(s) received on July 31, 2025. New York Environmental analyzed the samples on August 01, 2025 for Lead (Pb) by EPA Method 200.9 Rev. 2.2.

If there are any questions regarding the analyses, please feel free to contact us at your convenience. New York Environmental is a NELAP accredited laboratory. Attached reported results meet the requirements of the NELAP standards unless otherwise noted.

Samples' analytical results relate only to the samples tested, in the condition received by the laboratory. This report shall not be reproduced except in its entirety without written approval of the laboratory.

We sincerely thank you for your business, and look forward to being of service for your future environmental testing needs.

Sincerely,



---

Li Tsang, Laboratory Director

Date Collected:	31 Jul 2025
Date Received:	31 Jul 2025
Date Analyzed:	01 Aug 2025

Analytical Method:	EPA 200.9 Rev. 2.2
Analyte, Matrix:	Lead, Potable Water

<u>Lab ID</u>	<u>CID</u>	<u>Sample Location/Description</u>	<u>LOQ</u>	<u>Result</u>	<u>Units</u>	<u>Flag</u>
250731M001	1	Cafeteria - BF, Initial	0.001	<0.001	mg/L	
250731M002	2	Cafeteria - WF, Initial	0.001	<0.001	mg/L	
250731M003	3	Pre-K Wing - BF, Initial	0.001	<0.001	mg/L	
250731M004	4	Pre-K Wing - WF, Initial	0.001	<0.001	mg/L	

Comment:

CID: Client ID LOQ: Limit of Quantitation

**Appendix D**  
**Somers High School**

Fixture #	Sample Location	Fixture Type	App or N/A	Latest 1 <sup>st</sup> Draw Results (ppb)	Latest 1st Draw Sampling Date	15 Second Draw Results (ppb)	60 Second Draw Results (ppb)	Flush Sampling Date	Remarks
SHS-1	Custodial Breakroom Bathroom	SK	N/A		2/25/2025				Sign
SHS-2	Custodial Workshop	SS	N/A		2/25/2025				Sign
SHS-3	Science Room 122 A	SK	N/A		2/25/2025				Sign
SHS-4	Science Room 121A	SK	N/A		2/25/2025				Sign
SHS-5	Science Room 118 A	SK	N/A		2/25/2025				Sign
SHS-6	Science Room 112A	SK	N/A		2/25/2025				Sign
SHS-7	Science Room 116A	SK	N/A		2/25/2025				Sign
SHS-8	Cafeteria 67	BF	App	<1.0	2/25/2025				
SHS-9	Cafeteria 67	WF	App	<1.0	2/25/2025				
SHS-10	Kitchen 67 Prep	SK	App	1.0	2/25/2025				
SHS-11a	Kitchen 67 3-Bay Dishwash Station	SK	N/A		2/25/2025				Sign
SHS-11b	Kitchen 67 Island 2-Bay Prep	SK	App	1.0	2/25/2025				
SHS-12	Kitchen 67 Island Single Prep near stoves	SK	App	2.0	7/31/2025				Remediation Complete
				8.0	2/25/2025				Removed from service; pending remediation
SHS-13	Kitchen 67 Groen Kettle-Pot Filler	PF	App	11.0	8/14/2025	9.0	6.0	8/14/2025	Removed from service; pending remediation
				105.0	7/31/2025				Fixture replaced
				29.0	2/25/2025				Removed from service; pending remediation

Fixture #	Sample Location	Fixture Type	App or N/A	Latest 1 <sup>st</sup> Draw Results (ppb)	Latest 1st Draw Sampling Date	15 Second Draw Results (ppb)	60 Second Draw Results (ppb)	Flush Sampling Date	Remarks
SHS-14	Kitchen 67 Stove-Pot Filler	PF	App	54.0	8/14/2025	44.0	18.0	8/14/2025	Removed from service; pending remediation
				7.0	7/31/2025				Fixtrue replaced
				27.0	2/25/2025				Removed from Service
SHS-15	Kitchen 67 Bathroom	SK	N/A		2/25/2025				Sign
SHS-16	Hall by Main Office	BF	App	<1.0	7/31/2025				New Bottle Filler Installed
		WF	App	20.0	2/25/2025				Fixture Removed; pending replacement
SHS-17	All Gender Bthroom by Main Office-left	SK	N/A		2/25/2025				Sign
SHS-18	All Gender Bthroom by Main Office-right	SK	N/A		2/25/2025				Sign
SHS-19	D Wing Girls Bathroom-left	SK	N/A		2/25/2025				Sign
SHS-20	D Wing Girls Bathroom-right	SK	N/A		2/25/2025				Sign
SHS-21	D Wing Boys Bathroom-left	SK	N/A		2/25/2025				Sign
SHS-22	D Wing Boys Bathroom-right	SK	N/A		2/25/2025				Sign
SHS-23	D Wing Hall	BF	App	<1.0	2/25/2025				
SHS-24	D Wing Hall	WF	App	<1.0	2/25/2025				
SHS-25	D Wing Custodial Closet	SS	N/A		2/25/2025				Sign
SHS-26	Science Room 109D	SK	N/A		2/25/2025				Sign
SHS-27	Science Room 108D	SK	N/A		2/25/2025				Sign
SHS-28	Science Room 107D	SK	N/A		2/25/2025				Sign
SHS-29	Science Room 106D	SK	N/A		2/25/2025				Sign

Fixture #	Sample Location	Fixture Type	App or N/A	Latest 1 <sup>st</sup> Draw Results (ppb)	Latest 1st Draw Sampling Date	15 Second Draw Results (ppb)	60 Second Draw Results (ppb)	Flush Sampling Date	Remarks
SHS-30	Science Room 105D	SK	N/A		2/25/2025				Sign
SHS-32	Main Office Break Room	SK	App	4.0	2/25/2025				
SHS-33	Main Office Bathroom	SK	N/A		2/25/2025				Sign
SHS-34	Hall by General Office	BF	App	<1.0	2/25/2025				
SHS-35	Hall by General Office	WF	App	<1.0	2/25/2025				
SHS-36	Nurse's Office	SK	App	<1.0	2/25/2025				
SHS-37	Nurse's Office Bathroom	SK	N/A		2/25/2025				Sign
SHS-38	Teacher's Lounge	SK	App	1.0	2/25/2025				
SHS-39	Room 135A Tots	SK	N/A		2/25/2025				Sign
SHS-40	Room 136A Sewing	SK	N/A		2/25/2025				Sign
SHS-41	Hall by 160C Copy Room	BF	App	<1.0	2/25/2025				
SHS-42	Hall by 160C Copy Room	WF	App	<1.0	2/25/2025				
SHS-43	Room 160C Copy Room	SK	N/A		2/25/2025				Sign
SHS-44	Lower B Hall	BF	App	<1.0	2/25/2025				
SHS-45	Lower B Hall	WF	App	<1.0	2/25/2025				
SHS-46	Science Room 140D	SK	N/A		2/25/2025				Sign
SHS-47	Science Room 141D	SK	N/A		2/25/2025				Sign
SHS-48	Science Room 142D	SK	N/A		2/25/2025				Sign
SHS-49	Art Room 143B	SK	N/A		2/25/2025				Sign

Fixture #	Sample Location	Fixture Type	App or N/A	Latest 1 <sup>st</sup> Draw Results (ppb)	Latest 1st Draw Sampling Date	15 Second Draw Results (ppb)	60 Second Draw Results (ppb)	Flush Sampling Date	Remarks
SHS-50	Art Room 146C	SK	N/A		2/25/2025				Sign
SHS-51	Bathroom by 147C	SK	N/A		2/25/2025				Sign
SHS-52	Art Room 147C	SK	N/A		2/25/2025				Sign
SHS-53	Art Room 145C	SK	N/A		2/25/2025				Sign
SHS-54	Hall by Room 158C	BF	App	<1.0	2/25/2025				
SHS-55	Tech Room 158C	SK	N/A		2/25/2025				Sign
SHS-56	Tech Room 157C-7	SK	App	<1.0	2/25/2025				
SHS-57	C Wing Custodial Closet	SS	N/A		2/25/2025				Sign
SHS-58	Men's Bathroom 100C-6 -left	SK	N/A		2/25/2025				Sign
SHS-59	Men's Bathroom 100C-6 -right	SK	N/A		2/25/2025				Sign
SHS-60	Women's Bathroom 100C-6-left	SK	N/A		2/25/2025				Sign
SHS-61	Women's Bathroom 100C-6-right	SK	N/A		2/25/2025				Sign
SHS-62	Men's Bathroom by 159C-left	SK	N/A		2/25/2025				Sign
SHS-63	Men's Bathroom by 159C-right	SK	N/A		2/25/2025				Sign
SHS-64	Women's Bathroom 100C-2 -left	SK	N/A		2/25/2025				Sign
SHS-65	Women's Bathroom 100C-2 -right	SK	N/A		2/25/2025				Sign
SHS-67	Custodial Closet 9-2 by elevator	SS	N/A		2/25/2025				Sign
SHS-68	Hall by BR13	WF	App		2/25/2025				Non-functional, sampling required before returning to service
SHS-69	Men's Bathroom BR13-left	SK	N/A		2/25/2025				Sign

Fixture #	Sample Location	Fixture Type	App or N/A	Latest 1 <sup>st</sup> Draw Results (ppb)	Latest 1st Draw Sampling Date	15 Second Draw Results (ppb)	60 Second Draw Results (ppb)	Flush Sampling Date	Remarks
SHS-70	Men's Bathroom BR13-middle	SK	N/A		2/25/2025				Sign
SHS-71	Men's Bathroom BR13-right	SK	N/A		2/25/2025				Sign
SHS-72	Staff Bathroom by BR13-left	SK	N/A		2/25/2025				Sign
SHS-73	Staff Bathroom by BR13-right	SK	N/A		2/25/2025				Sign
SHS-74	Girl's Locker Room	BF	App	<1.0	7/31/2025				
		WF	App	11.0	2/25/2025				Fixture Removed; pending replacement
SHS-75	Girl's Locker Room Bathroom-left	SK	N/A		2/25/2025				Sign
SHS-76	Girl's Locker Room Bathroom-right	SK	N/A		2/25/2025				Sign
SHS-77	Girl's Coach's Office Bathroom	SK	N/A		2/25/2025				Sign
SHS-78	Athletic Office Bathroom	SK	N/A		2/25/2025				Sign
SHS-79	Boy's Locker Room Bathroom	SK	N/A		2/25/2025				Sign
SHS-80	Commons Kitchen Dishwash 3 Bay-left	SK	N/A		2/25/2025				Sign
SHS-81	Commons Kitchen Dishwash 3 Bay-right	SK	N/A		2/25/2025				Sign
SHS-82	Commons Kitchen Island Prep	SK	App	3.0	2/25/2025				
SHS-83	Commons Kitchen Handwash	SK	N/A		2/25/2025				Sign
SHS-84	Upper Commons Custodial Closet	SS	N/A		2/25/2025				Sign
SHS-85	Commons Boys Bathroom-left	SK	N/A		2/25/2025				Sign
SHS-86	Commons Boys Bathroom-right	SK	N/A		2/25/2025				Sign
SHS-87	Commons Girls Bathroom-left	SK	N/A		2/25/2025				Sign

Fixture #	Sample Location	Fixture Type	App or N/A	Latest 1 <sup>st</sup> Draw Results (ppb)	Latest 1st Draw Sampling Date	15 Second Draw Results (ppb)	60 Second Draw Results (ppb)	Flush Sampling Date	Remarks
SHS-88	Commons Girls Bathroom-left	SK	N/A		2/25/2025				Sign
SHS-89	Commons	BF	App	<1.0	2/25/2025				
SHS-90	Commons	WF	App	<1.0	2/25/2025				
SHS-91	Commons-left fountain	WF	N/A		2/25/2025				Non-functional, sampling required before returning to service
SHS-92	Trainer's Room Office Bathroom	SK	N/A		2/25/2025				Sign
SHS-93	Weight Room Vestibule Ice Machine	IM	App	<1.0	2/25/2025				
SHS-94	Maintenance Shop	SS	N/A		2/25/2025				Sign
SHS-95	Concession Stand Ice Machine	IM	App	<1.0	2/25/2025				
SHS-96	Concession Stand Women's Bathroom-left	SK	N/A		2/25/2025				Sign
SHS-97	Concession Stand Women's Bathroom-right	SK	N/A		2/25/2025				Sign
SHS-98	Concession Stand Sink	SK	App	2.0	2/25/2025				
SHS-99	Lower Level Girls Bathroom-left	SK	N/A		2/25/2025				Sign
SHS-100	Lower Level Girls Bathroom-right	SK	N/A		2/25/2025				Sign
SHS-101	Lower Level Boys Bathroom-left	SK	N/A		2/25/2025				Sign
SHS-102	Lower Level Boys Bathroom-right	SK	N/A		2/25/2025				Sign
SHS-103	Lower Level Coach's Office Bathroom	SK	N/A		2/25/2025				Sign
SHS-104	Lower Level Custodial Closet	SS	N/A		2/25/2025				Sign
SHS-105	Upper A Wing by Elevator	BF	App	<1.0	2/25/2025				
SHS-106	Upper A Wing by Elevator	WF	App	<1.0	2/25/2025				

Fixture #	Sample Location	Fixture Type	App or N/A	Latest 1 <sup>st</sup> Draw Results (ppb)	Latest 1st Draw Sampling Date	15 Second Draw Results (ppb)	60 Second Draw Results (ppb)	Flush Sampling Date	Remarks
SHS-107	Bathroom 250A-7	SK	N/A		2/25/2025				Sign
SHS-108	Custodial Closet 250A-8	SS	N/A		2/25/2025				Sign
SHS-109	Women's Faculty Bathroom 250A-7	SK	N/A		2/25/2025				Sign
SHS-110	Hall by Room 235	BF	App	<1.0	2/25/2025				
SHS-111	Hall by Room 235	WF	App	<1.0	2/25/2025				
SHS-112	Room 236A	SK	N/A		2/25/2025				Sign
SHS-113	Faculty Men's Bathroom-left	SK	N/A		2/25/2025				Sign
SHS-114	Faculty Men's Bathroom-center	SK	N/A		2/25/2025				Sign
SHS-115	Faculty Men's Bathroom-right	SK	N/A		2/25/2025				Sign
SHS-116	Faculty Women's Bathroom-left	SK	N/A		2/25/2025				Sign
SHS-117	Faculty Women's Bathroom-center	SK	N/A		2/25/2025				Sign
SHS-118	Faculty Women's Bathroom-right	SK	N/A		2/25/2025				Sign
SHS-119	Custodial Closet 250A-3	SS	N/A		2/25/2025				Sign
SHS-120	Ceramic Fountain by 250A-1	WF	N/A		2/25/2025				Non-functional; Sampling Required
SHS-121	Room 209A Life Skills	SK	App	3.0	2/25/2025				
SHS-122	Room 209A Life Skills	Spray	N/A		2/25/2025				Non-functional; Sampling Required
SHS-123	Boy's Bathroom by 207B-left	SK	N/A		2/25/2025				Sign
SHS-124	Boy's Bathroom by 207B-right	SK	N/A		2/25/2025				Sign
SHS-125	Girl's Bathroom by 207B-left	SK	N/A		2/25/2025				Sign

Fixture #	Sample Location	Fixture Type	App or N/A	Latest 1 <sup>st</sup> Draw Results (ppb)	Latest 1st Draw Sampling Date	15 Second Draw Results (ppb)	60 Second Draw Results (ppb)	Flush Sampling Date	Remarks
SHS-126	Girl's Bathroom by 207B-right	SK	N/A		2/25/2025				Sign
SHS-127	Hall by 207B	BF	App	<1.0	2/25/2025				
SHS-128	Hall by 207B	WF	App	<1.0	2/25/2025				
SHS-129	Hall Across from Room 219	BF	App	<1.0	2/25/2025				
SHS-130	Social Studies Office 250A-10	SK	N/A	13.0	2/25/2025				Sign Posted
SHS-131	Academic Support Center 221A Handwash	SK	N/A		2/25/2025				Sign
SHS-132	Concession Stand Exterior Spigot	SP	N/A	20.0	8/26/2025				Sign Posted
SHS-133	Concession Stand Exterior Elkay	BF	App	<1.0	9/10/2025				Remediation Complete
				6.0	9/4/2025				Removed from service, pending remediation

## Laboratory Report

NYE Report #: 2500724-32468

February 28, 2025

Project Manager  
Enviroscience Consultants, Inc.  
2150 Smithtown Avenue  
Ronkonkoma, NY 11779

Project: Somers CSD; Somers High School

Dear Project Manager,

Enclosed is the Laboratory Analytical Report for potable water sample(s) received on February 26, 2025. New York Environmental analyzed the samples on February 27, 2025 for Lead (Pb) by EPA Method 200.9 Rev. 2.2.

If there are any questions regarding the analyses, please feel free to contact us at your convenience. New York Environmental is a NELAP accredited laboratory. Attached reported results meet the requirements of the NELAP standards unless otherwise noted.

Samples' analytical results relate only to the samples tested, in the condition received by the laboratory. This report shall not be reproduced except in its entirety without written approval of the laboratory.

We sincerely thank you for your business, and look forward to being of service for your future environmental testing needs.

Sincerely,



---

Li Tsang, Laboratory Director

Date Collected:	25 Feb 2025
Date Received:	26 Feb 2025
Date Analyzed:	27 Feb 2025

Analytical Method:	EPA 200.9 Rev. 2.2
Analyte, Matrix:	Lead, Potable Water

Lab ID	CID	Sample Location/Description	LOQ	Result	Units	Flag
250226R148	1	Cafeteria 67-BF, Initial	0.001	<0.001	mg/L	
250226R149	2	Cafeteria 67-WF, Initial	0.001	<0.001	mg/L	
250226R150	3	Kitchen 67 Prep-SK, Initial	0.001	0.001	mg/L	
250226R151	4	Kitchen 67 Island 2-Bay Prep-SK, Initial	0.001	0.001	mg/L	
250226R152	5	Kitchen 67 Island SinglePrep-SK, Initial	0.001	0.008	mg/L	H
250226R153	6	Kitchen 67 Groen Kettle-Pot Filler-PF, Initial	0.001	0.029	mg/L	H
250226R154	7	Kitchen 67 Stove-Pot Filler-PF, Initial	0.001	0.027	mg/L	H
250226R155	8	Hall by Main Office-WF, Initial	0.001	0.020	mg/L	H
250226R156	9	D Wing Hall-BF, Initial	0.001	<0.001	mg/L	
250226R157	10	D Wing Hall-WF, Initial	0.001	<0.001	mg/L	
250226R158	11	Main Office Break Room -SK, Initial	0.001	0.004	mg/L	
250226R159	12	Hall by General Office-BF, Initial	0.001	<0.001	mg/L	
250226R160	13	Hall by General Office-WF, Initial	0.001	<0.001	mg/L	
250226R161	14	Nurse's Office-SK, Initial	0.001	<0.001	mg/L	
250226R162	15	Teacher's Lounge-SK, Initial	0.001	0.001	mg/L	
250226R163	16	Hall by 160C Copy Room-BF, Initial	0.001	<0.001	mg/L	
250226R164	17	Hall by 160C Copy Room-WF, Initial	0.001	<0.001	mg/L	
250226R165	18	Lower B Hall-BF, Initial	0.001	<0.001	mg/L	
250226R166	19	Lower B Hall-WF, Initial	0.001	<0.001	mg/L	
250226R167	20	Hall by Room 158C-BF, Initial	0.001	<0.001	mg/L	
250226R168	21	Tech Room 157C-7-SK, Initial	0.001	<0.001	mg/L	
250226R169	22	Girl's Locker Room-WF, Initial	0.001	0.011	mg/L	H
250226R170	23	Commons Kitchen Island Prep-SK, Initial	0.001	0.003	mg/L	
250226R171	24	Commons-BF, Initial	0.001	<0.001	mg/L	
250226R172	25	Commons-WF, Initial	0.001	<0.001	mg/L	
250226R173	26	Weight Room Vestibule Ice Machine-IM, Initial	0.001	<0.001	mg/L	



Date Collected:	25 Feb 2025
Date Received:	26 Feb 2025
Date Analyzed:	27 Feb 2025

Analytical Method:	EPA 200.9 Rev. 2.2
Analyte, Matrix:	Lead, Potable Water

<u>Lab ID</u>	<u>CID</u>	<u>Sample Location/Description</u>	<u>LOQ</u>	<u>Result</u>	<u>Units</u>	<u>Flag</u>
250226R174	27	Concession Stand Ice Machine-IM, Initial	0.001	<0.001	mg/L	
250226R175	28	Concession Stand Sink-SK, Initial	0.001	0.002	mg/L	
250226R176	29	Upper A Wing by Elevator-BF, Initial	0.001	<0.001	mg/L	
250226R177	30	Upper A Wing by Elevator-WF, Initial	0.001	<0.001	mg/L	
250226R178	31	Hall by Room 235-BF, Initial	0.001	<0.001	mg/L	
250226R179	32	Hall by Room 235-WF, Initial	0.001	<0.001	mg/L	
250226R180	33	Room 209A Life Skills-SK, Initial	0.001	0.003	mg/L	
250226R181	34	Hall by 207B-BF, Initial	0.001	<0.001	mg/L	
250226R182	35	Hall by 207B-WF, Initial	0.001	<0.001	mg/L	
250226R183	36	Hall Across from Room 219-BF, Initial	0.001	<0.001	mg/L	
250226R184	37	Social Studies Office 250A-10-SK, Initial	0.001	0.013	mg/L	H

Comment:

CID: Client ID LOQ: Limit of Quantitation

H: Sample result exceeds applicable regulatory limit.

## Laboratory Report

NYE Report #: 2503636-33987

August 1, 2025

Project Manager  
Enviroscience Consultants, Inc.  
2150 Smithtown Avenue  
Ronkonkoma, NY 11779

Project: Somers Csd; Somers High School

Dear Project Manager,

Enclosed is the Laboratory Analytical Report for potable water sample(s) received on July 31, 2025. New York Environmental analyzed the samples on August 01, 2025 for Lead (Pb) by EPA Method 200.9 Rev. 2.2.

If there are any questions regarding the analyses, please feel free to contact us at your convenience. New York Environmental is a NELAP accredited laboratory. Attached reported results meet the requirements of the NELAP standards unless otherwise noted.

Samples' analytical results relate only to the samples tested, in the condition received by the laboratory. This report shall not be reproduced except in its entirety without written approval of the laboratory.

We sincerely thank you for your business, and look forward to being of service for your future environmental testing needs.

Sincerely,

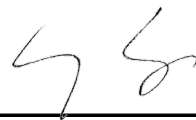

---

Li Tsang, Laboratory Director

Date Collected:	31 Jul 2025
Date Received:	31 Jul 2025
Date Analyzed:	01 Aug 2025

Analytical Method:	EPA 200.9 Rev. 2.2
Analyte, Matrix:	Lead, Potable Water

Lab ID	CID	Sample Location/Description	LOQ	Result	Units	Flag
250731M005	1	Kitchen 67 Island Single Prep - SK, Initial	0.001	0.002	mg/L	
250731M006	2	Kitchen 67 Groen Kettle - PF, Initial	0.001	0.105	mg/L	E,H
250731M007	3	Kitchen 67 Stove - PF, Initial	0.001	0.007	mg/L	H
250731M008	4	Hall By Main Office (Ceramic) - BF, Intial	0.001	<0.001	mg/L	
250731M009	5	Girls Locker Room - BF, Initial	0.001	<0.001	mg/L	

Comment:

CID: Client ID LOQ: Limit of Quantitation

E: Sample result exceeds instrument calibration, value is estimated.

H: Sample result exceeds applicable regulatory limit.

## Laboratory Report

August 20, 2025

Susan Richter  
Enviroscience Consultants, Inc.  
2150 Smithtown Ave.  
Ronkonkoma, NY, 11779

Project: Somers CSD  
Project Address: Somers High School  
Report ID: 250819007  
Sample IDs: 250819007-043 - 250819007-048

New York Environmental is a NELAC accredited laboratory. Attached reported results meet the requirements of the NELAC standard unless otherwise noted.

Samples' analytical results relate only to the parameters tested for the samples received in the condition received by the laboratory, as noted on the Chain of Custody. This report shall not be reproduced except in its entirety without written approval of the laboratory.

We sincerely thank you for your business, and look forward to being of service for your future environmental testing needs.

Sincerely,



---

Li Tsang, Laboratory Director

Date Collected:	14-Aug-25
Date Received:	19-Aug-25
Date Analyzed:	20-Aug-25

Analytical Method:	EPA 200.9
Analyte, Matrix:	Lead, Potable Water

Lab ID	CID	Sample Location/Description	LOQ	Result	Units	Flag
250819007-043	01	Stove Pot Filler - Kitchen 67 - PF, initial	0.001	0.054	mg/L	H
250819007-044	02	Stove Pot Filler - Kitchen 67 - PF, 15 Second Flush	0.001	0.044	mg/L	H
250819007-045	03	Stove Pot Filler- Kitchen 67 - PF, 2 Minute Flush	0.001	0.018	mg/L	H
250819007-046	04	Pot Filler - Kitchen 67 - PF, initial	0.001	0.011	mg/L	H
250819007-047	05	Pot Filler - Kitchen 67 - PF, 15 Second Flush	0.001	0.009	mg/L	H
250819007-048	06	Pot Filler - Kitchen 67 - PF, 2 Minute Flush	0.001	0.006	mg/L	H

**Comment(s):**

LOQ: Limit of Quantitation

CID: Client ID

H: Sample result exceeds applicable regulatory limit.



## Laboratory Report

August 27, 2025

Project Manager  
Enviroscience Consultants, Inc.  
2150 Smithtown Ave.  
Ronkonkoma, NY, 11779

Project: Potable Water Testing  
Project Address: Somers CSD, Somers High School  
Report ID: 250826005  
Sample IDs: 250826005-013 - 250826005-013

New York Environmental is a NELAC accredited laboratory. Attached reported results meet the requirements of the NELAC standard unless otherwise noted.

Samples' analytical results relate only to the parameters tested for the samples received in the condition received by the laboratory, as noted on the Chain of Custody. This report shall not be reproduced except in its entirety without written approval of the laboratory.

We sincerely thank you for your business, and look forward to being of service for your future environmental testing needs.

Sincerely,



---

Li Tsang, Laboratory Director

Date Collected:	26-Aug-25
Date Received:	26-Aug-25
Date Analyzed:	26-Aug-25

Analytical Method:	EPA 200.9
Analyte, Matrix:	Lead, Potable Water

Lab ID	CID	Sample Location/Description	LOQ	Result	Units	Flag
250826005-013	1	Concession Stand Spigot/ Exterior Hose Bib	0.001	0.020	mg/L	H

**Comment(s):**

LOQ: Limit of Quantitation

CID: Client ID

H: Sample result exceeds applicable regulatory limit.



## Laboratory Report

September 8, 2025

Project Manager  
Enviroscience Consultants, Inc.  
2150 Smithtown Ave.  
Ronkonkoma, NY, 11779

Project: Somers CSD High School  
Project Address: 120 Primrose St  
Report ID: 250908002  
Sample IDs: 250908002-004 - 250908002-004

New York Environmental is a NELAC accredited laboratory. Attached reported results meet the requirements of the NELAC standard unless otherwise noted.

Samples' analytical results relate only to the parameters tested for the samples received in the condition received by the laboratory, as noted on the Chain of Custody. This report shall not be reproduced except in its entirety without written approval of the laboratory.

We sincerely thank you for your business, and look forward to being of service for your future environmental testing needs.

Sincerely,



---

Li Tsang, Laboratory Director

Date Collected:	4-Sep-25
Date Received:	6-Sep-25
Date Analyzed:	8-Sep-25

Analytical Method:	EPA 200.9
Analyte, Matrix:	Lead, Potable Water

Lab ID	CID	Sample Location/Description	LOQ	Result	Units	Flag
250908002-004	1	Concession Stand Exterior Bottle Fill; initial	0.001	0.006	mg/L	H

**Comment(s):**

LOQ: Limit of Quantitation

CID: Client ID

H: Sample result exceeds applicable regulatory limit.



## Laboratory Report

September 12, 2025

Project Manager  
Enviroscience Consultants, Inc.  
2150 Smithtown Ave.  
Ronkonkoma, NY, 11779

Project: Somers CSD  
Project Address: Somers High School  
Report ID: 250911003  
Sample IDs: 250911003-462 - 250911003-464

New York Environmental is a NELAC accredited laboratory. Attached reported results meet the requirements of the NELAC standard unless otherwise noted.

Samples' analytical results relate only to the parameters tested for the samples received in the condition received by the laboratory, as noted on the Chain of Custody. This report shall not be reproduced except in its entirety without written approval of the laboratory.

We sincerely thank you for your business, and look forward to being of service for your future environmental testing needs.

Sincerely,



---

Li Tsang, Laboratory Director

Date Collected:	10-Sep-25
Date Received:	11-Sep-25
Date Analyzed:	12-Sep-25

Analytical Method:	EPA 200.9
Analyte, Matrix:	Lead, Potable Water

Lab ID	CID	Sample Location/Description	LOQ	Result	Units	Flag
250911003-462	1	Concession Stand Exterior Bottle Filler; initial	0.001	<0.001	mg/L	
250911003-463	2	Concession Stand Exterior Bottle Filler; 15 sec flush	0.001	NA	mg/L	
250911003-464	3	Concession Stand Exterior Bottle Filler; 30 sec flush	0.001	NA	mg/L	

**Comment(s):**

LOQ: Limit of Quantitation

CID: Client ID

