

# Kenmore Elementary Modernization

LEWIS | MITHUN  
**COMMUNITY MEETING**  
October 20, 2025







# Conversation Agenda—

**:05 Welcome & Opening**

**:15 Presentation**

**:60 Break-out Sessions**

**:10 Wrap-up & Closing**



# Focus Topic Areas—

- ❖ **Building Use: Before and After**
- ❖ **Historical Art**
- ❖ **Future Art**
- ❖ **Playground**

# Building Use Before and After—





# Before Construction—

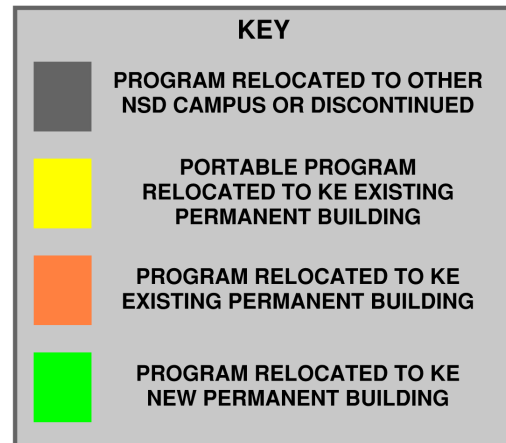



# After Construction—

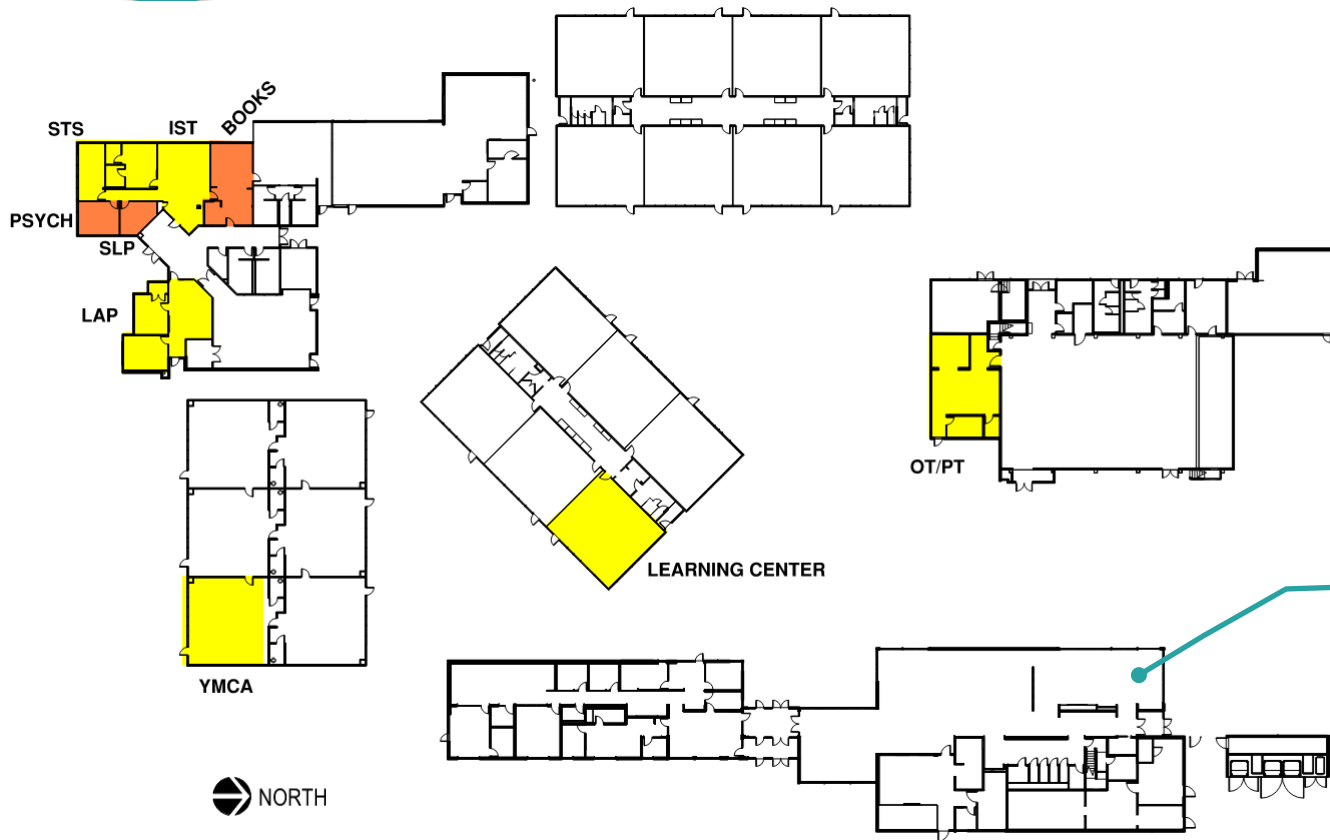

## KEY

 PROGRAM RELOCATED FROM KE PORTABLES

 PROGRAM RELOCATED AROUND CAMPUS

## MULTIPURPOSE ROOM

- ★ Student Program Enrichment
- ★ Before & After School Instruction/Activity
  - ★ STEM4Good
- ★ Student & Staff Presentations
- ★ Indoor recess when necessary
  - ★ Faculty Meetings
  - ★ PTA Meetings
- ★ Professional Development



# New Commons—







# New Commons—





# New Commons—



# Historical Art—

Honoring School Spirit Through Time





# Storytelling by Book—

Digital  
Book

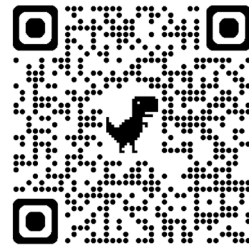

<https://kenmoreheritagesociety.com/>

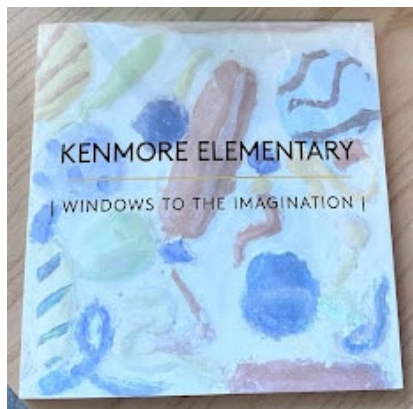



# Storytelling as a Living ARTchive—

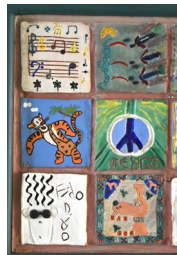





# Storytelling as a Digital ARTchive—

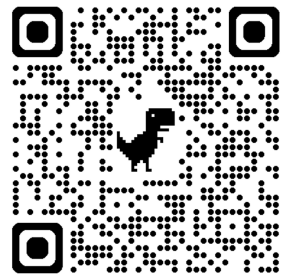

*KE history page*





Future Art—



# Campus Art Location Options—

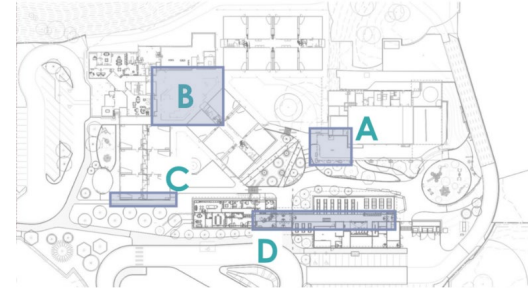

**A\_Cub Community  
Space at the Heart**



(PLACE YOUR DOT HERE!)

**B\_Immersive Courtyard  
Embedded in Learning**



(PLACE YOUR DOT HERE!)

**C\_Outward Facing  
Moment at Arrival**



(PLACE YOUR DOT HERE!)

**D\_Welcoming  
Signature at Reception**

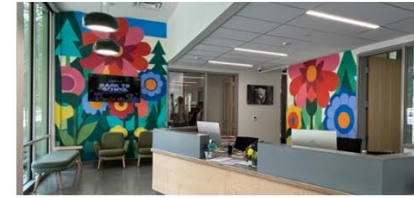

(PLACE YOUR DOT HERE!)



## Inspired by Cubs



## Artist-Led, Student Made







# Student Engagement—

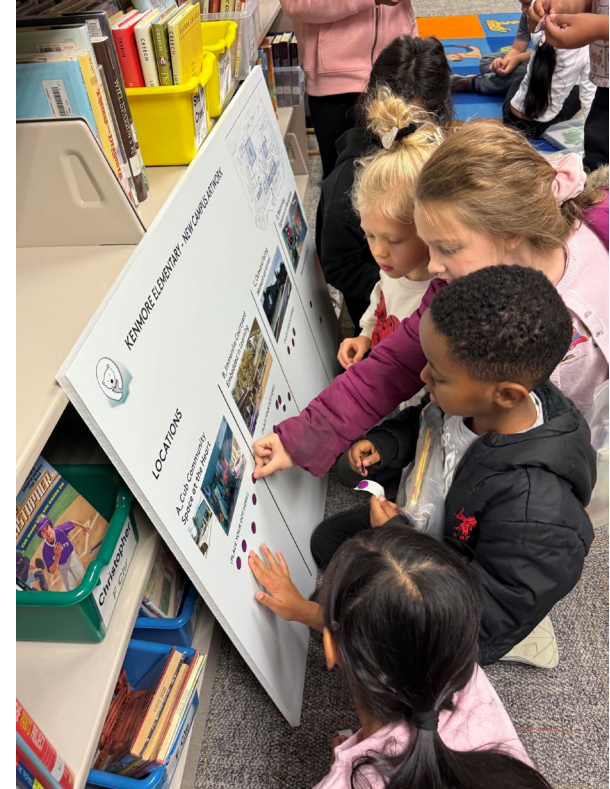
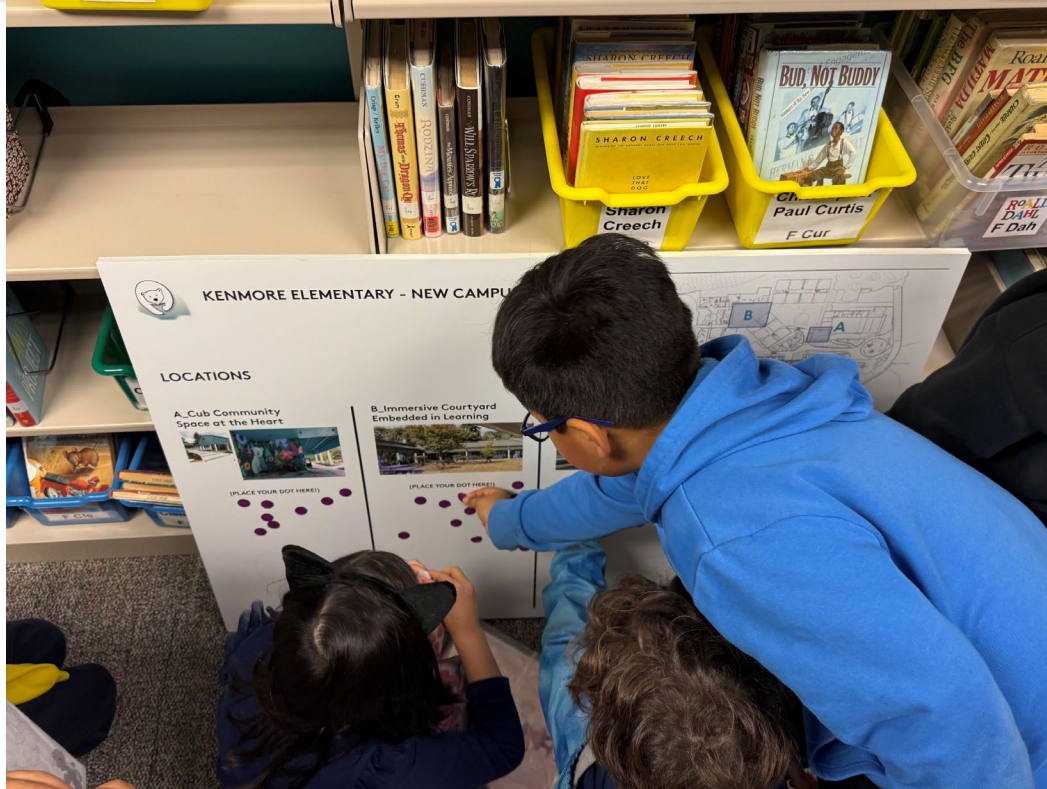

Playground—



# New Primary Play Space

**~71,000 SF of usable surfacing, including  
field and lawn areas**

= capacity >946 kids @ 75sf

**~24,500 SF of usable surfacing, not  
including field**

= capacity 326-612 @ 40-75sf

**~5,300 SF of covered play**

= capacity 70-132 @ 40-75sf

**~4,500 SF of safety surfacing**

**The play structures have a specific capacity\*  
of 80+ as designed by Northwest  
Playground Design.**

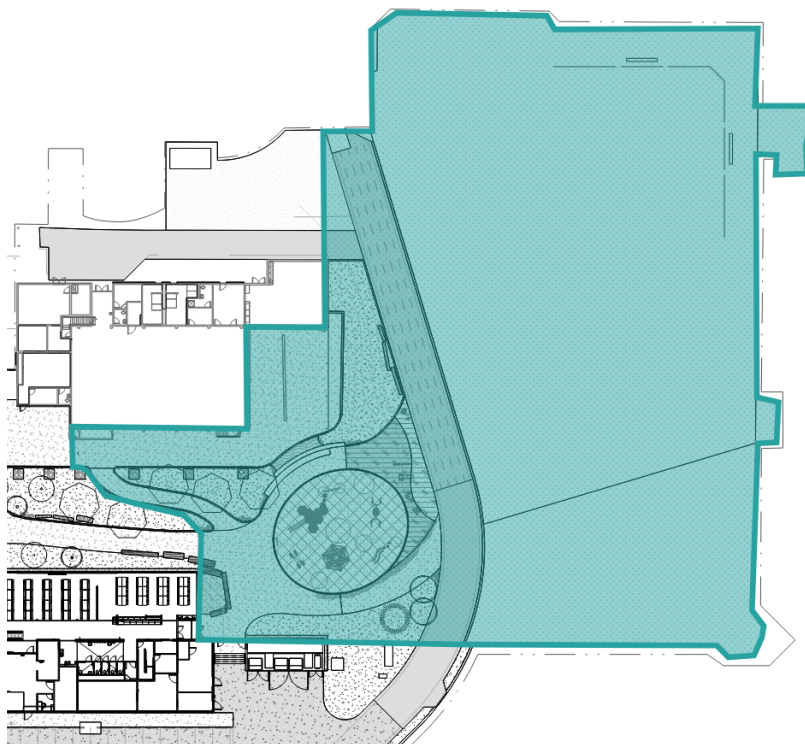

\*capacity not entirely determined by SF/student and is tied to play structures provided



# New Primary Play Space

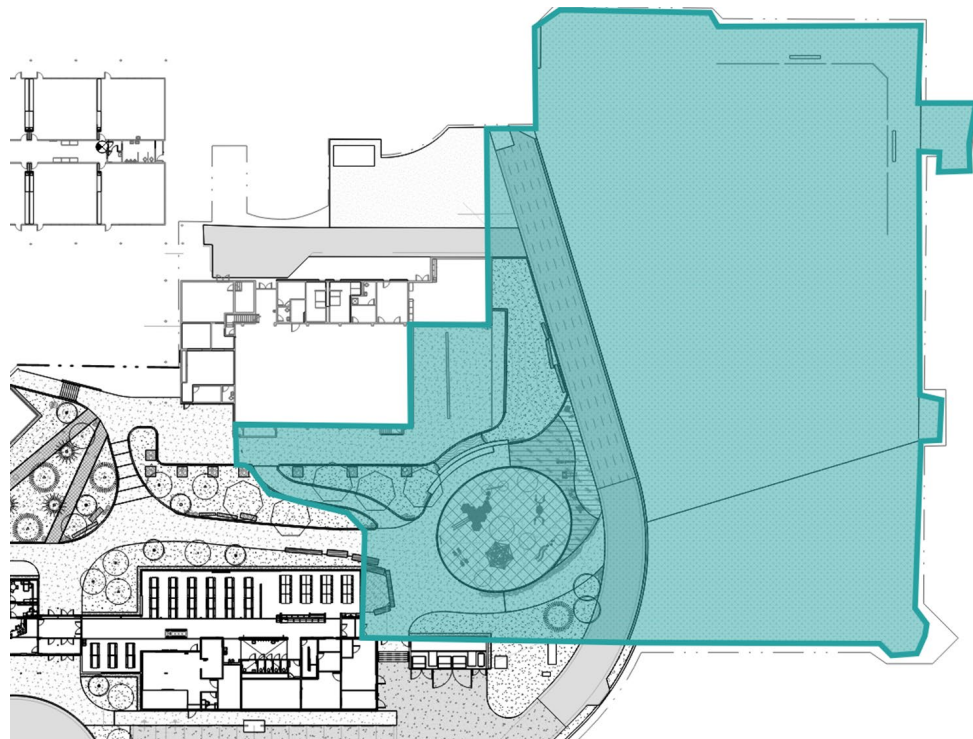

**RECESS AREA**

**~71,000 SF  
CAPACITY  
>946**





# Primary Play Space



**RECESS AREA**

**~71,000 SF  
CAPACITY  
>946**

**NEAR TERM  
IMPROVEMENTS  
SCHOOL YEAR  
2025-2026**



# Near Term Improvements

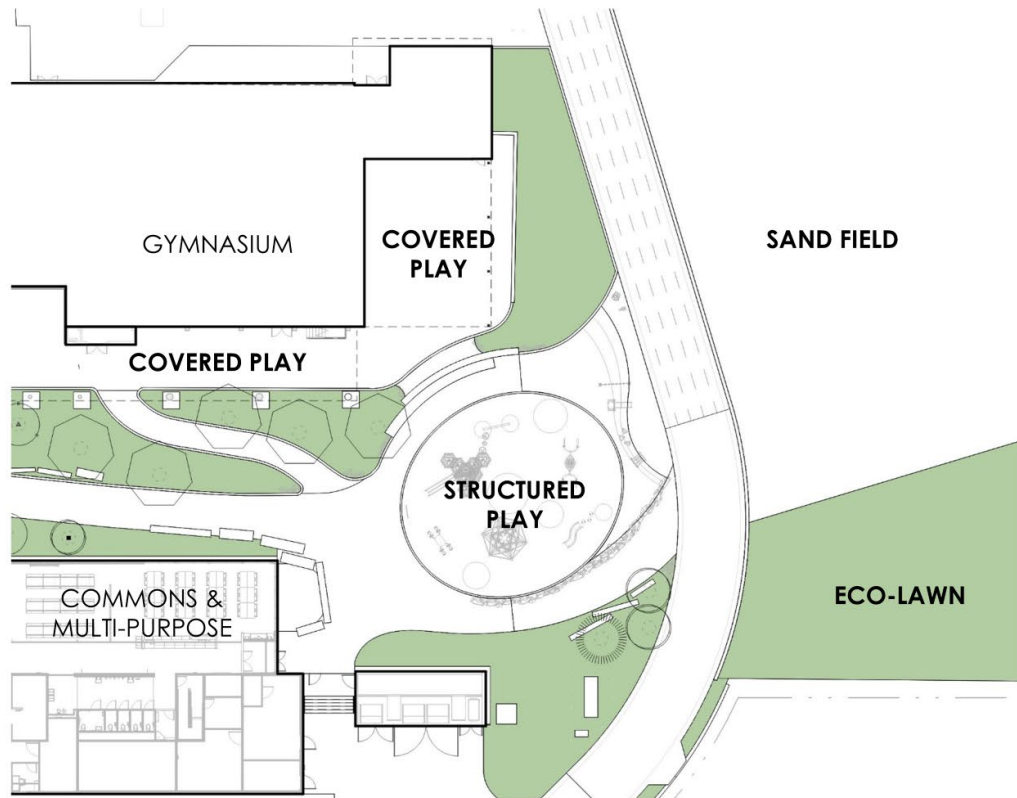

**NEAR TERM  
IMPROVEMENTS,**  
School year  
2025-2026



# Near Term Improvements

Option A: Opportunities to add play equipment where play surfacing is already installed.







# Near Term Improvements

Option B: Opportunities to add sensory play equipment  
outside of structured play and utilities.







# Near Term Improvements

Option C: Activate the paving with games / themes.

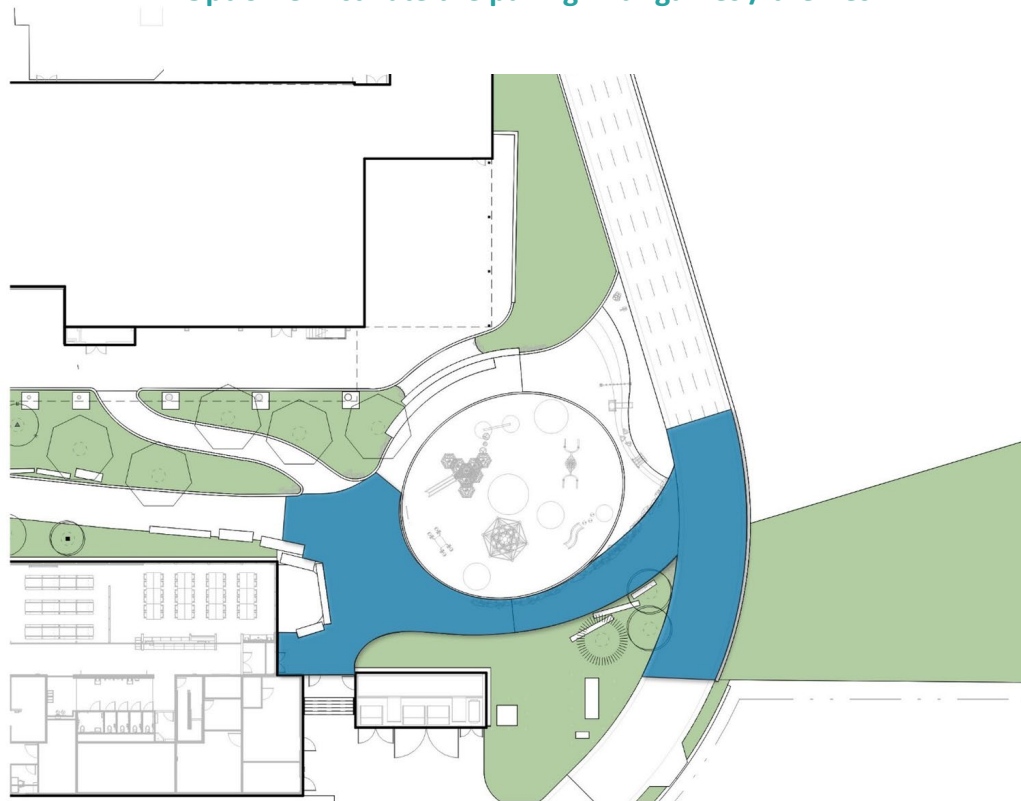



# Summer 2026 Improvements – Areas Studied



**LONG TERM  
IMPROVEMENTS,**  
Summer 2026



# Summer 2026 Improvement Opportunities

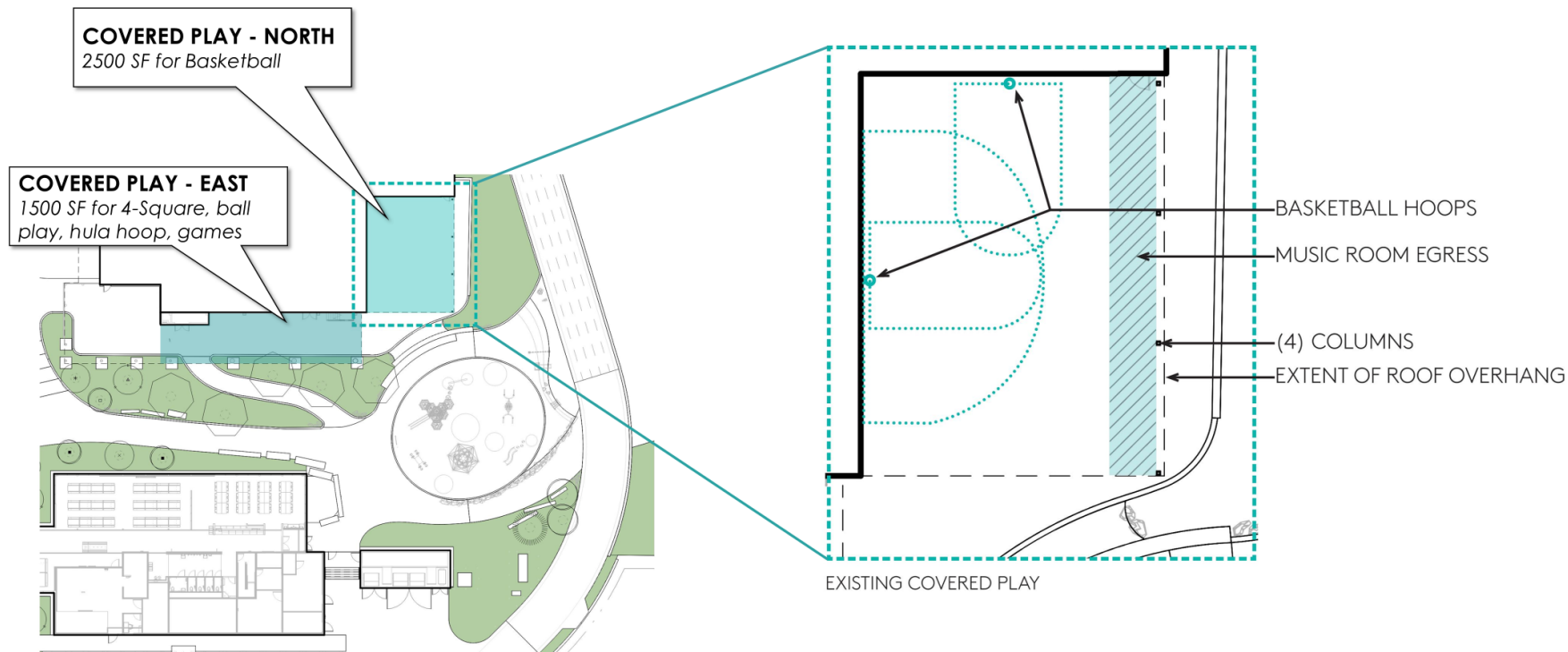





# Summer 2026 Improvements – Option A

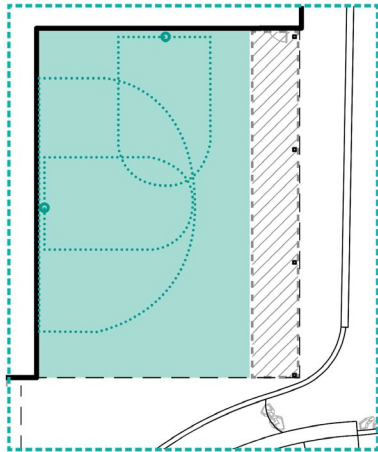

EXISTING COVERED PLAY

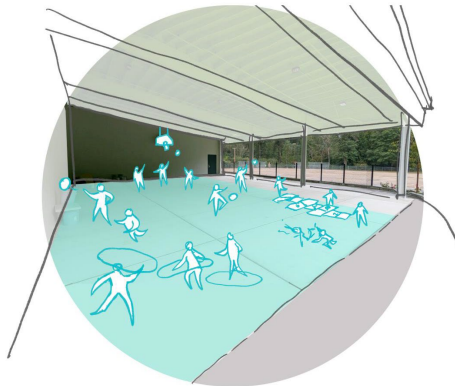

**Covered Play Transformation:  
Leave both basketball nets?**







# Summer 2026 Improvements – Option B

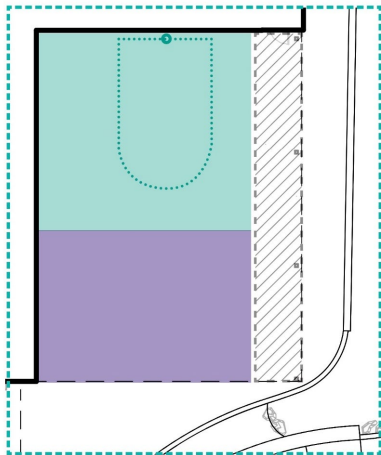

TRANSFORM + SMALL PLAY

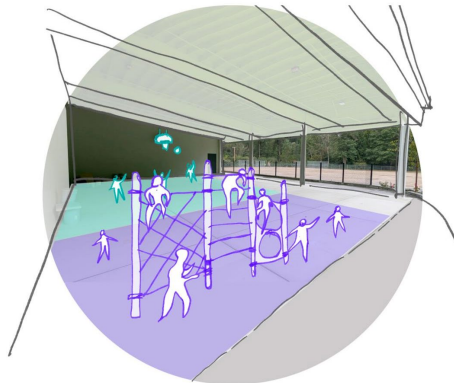

**Covered Play Transformation:**  
Leave one basketball net and add a  
small piece of play equipment?





# Summer 2026 Improvements – Option C

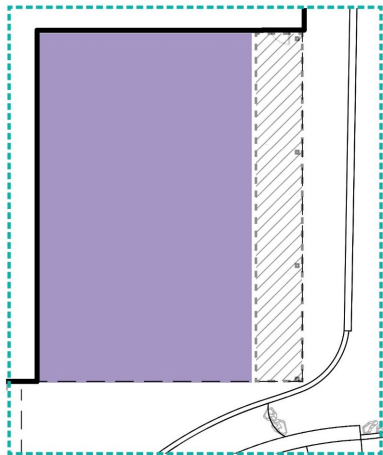

TRANSFORM + BIG PLAY

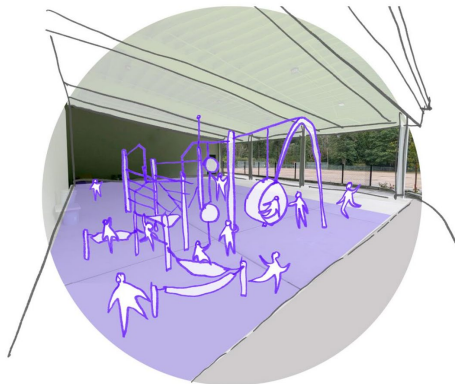

**Covered Play Transformation:**  
Remove basketball and install one  
big piece of play equipment?





# Summer 2026 Improvements – Option D

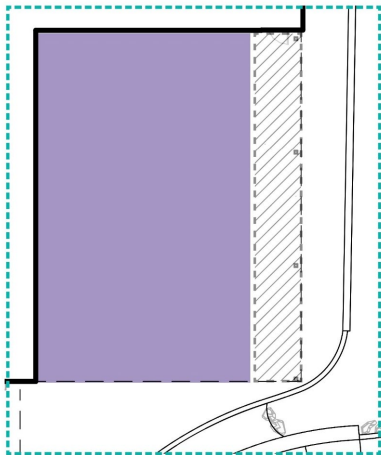

TRANSFORM + MULTI PLAY

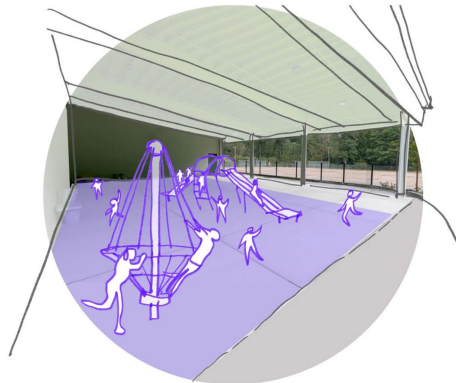

**Covered Play Transformation:**  
Remove basketball and install 2 to 3  
pieces of play equipment?







# Summer 2026 Improvements

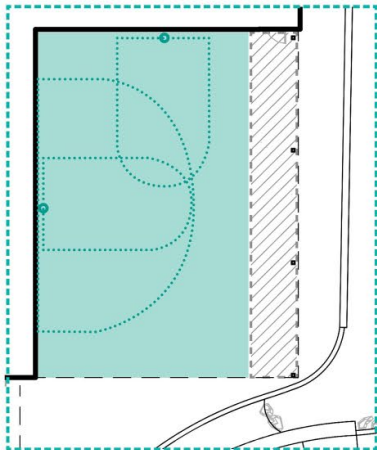

EXISTING COVERED PLAY

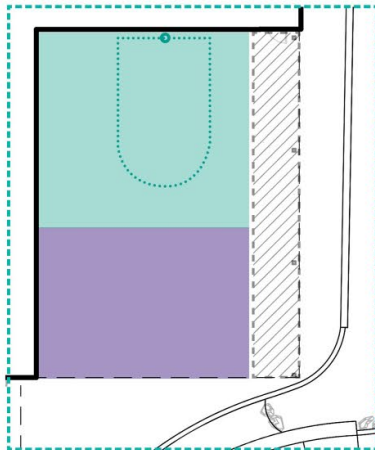

TRANSFORM + SMALL PLAY

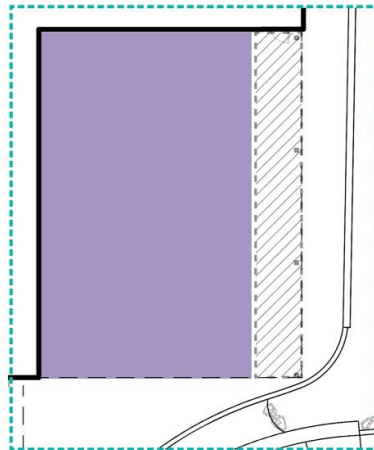

TRANSFORM + BIG PLAY

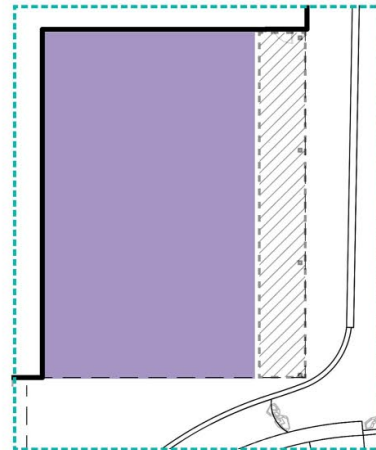

TRANSFORM + MULTI PLAY

## OPTION A

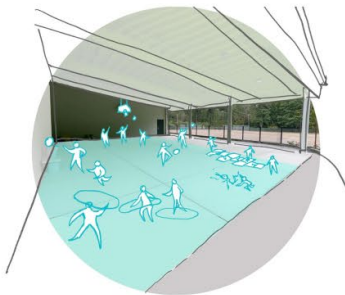

## OPTION B

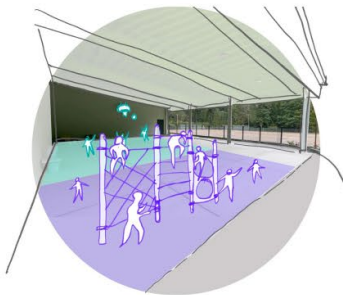

## OPTION C

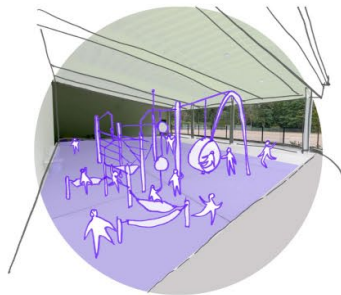

## OPTION D

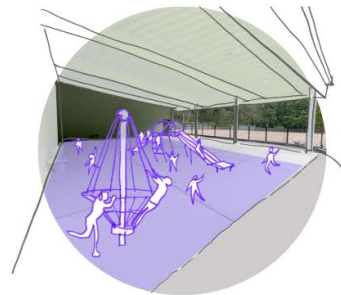



# Break-out Sessions

# Wrap-up & Closing