



BOLLES PLANNER

2025-26
Middle School
Bartram Campus

SEMESTER 2

BOLLES KEY CALENDAR DATES 2025-26

~2025~

New and All Grade 6 Middle School Orientation/New and All Grade 9 Upper School Orientation/	
Meet Your Teacher Day Lower School.....	August 13
First Day of School.....	August 14
Labor Day, School Closed.....	September 1
Middle and Upper School Quarter 1 End of Interim	September 12
Middle and Upper School Quarter 1 Ends	October 3
Upper School Spark Day.....	October 9
Lower, Middle and Upper School Conference Days, No Classes.....	October 16 & 17
Fall Break, School Closed	October 20
Middle and Upper School Quarter 2 End of Interim	November 6
Lower School Trimester 1 Ends/ Lower School Writing Day, No Classes/	
Middle and Upper School Classes in Session.....	November 7
Middle, Upper and Lower School Professional Development Day, No Classes	November 21
Thanksgiving Break, School Closed	November 24-28
Upper School Quarter 2 Ends.....	December 12
Upper School Reading Day, No Classes.....	December 15
Middle School, Classes in Session	December 15-16
Middle School Quarter 2 Ends.....	December 16
Upper School Exams	December 16-19
Middle School Reading Day, No Classes.....	December 17
Middle School Exams	December 18-19
Winter Break, School Closed.....	December 22-31

~2026~

Winter Break, School Closed.....	January 1-2
Professional Development Day, No Classes	January 5
Classes Resume	January 6
Martin Luther King Day, School Closed.....	January 19
Middle and Upper School Quarter 3 End of Interim	February 4
Lower, Middle and Upper School Parent Conference Day, No Classes/	
Lower School End of Trimester 2	February 13
Presidents' Day, School Closed	February 16
Spring Break, School Closed	March 9-13
Lower, Middle and Upper School Professional Development Day, No Classes	March 16
Middle and Upper School Quarter 3 End	March 17
Spring Holiday, School Closed.....	April 3 & 6
Middle and Upper School Quarter 4 End of Interim.....	April 17
Last Day of Classes for Middle and Upper School/ Quarter 4 Ends	May 15
Middle and Upper School Exam Week.....	May 18-22
Last Day of Classes for Lower School	May 21
Graduation.....	May 23
Memorial Day, School Closed.....	May 25

NAME: _____ GRADE: _____

STUDENT NUMBER: _____

ADVISOR: _____

BUS #: _____

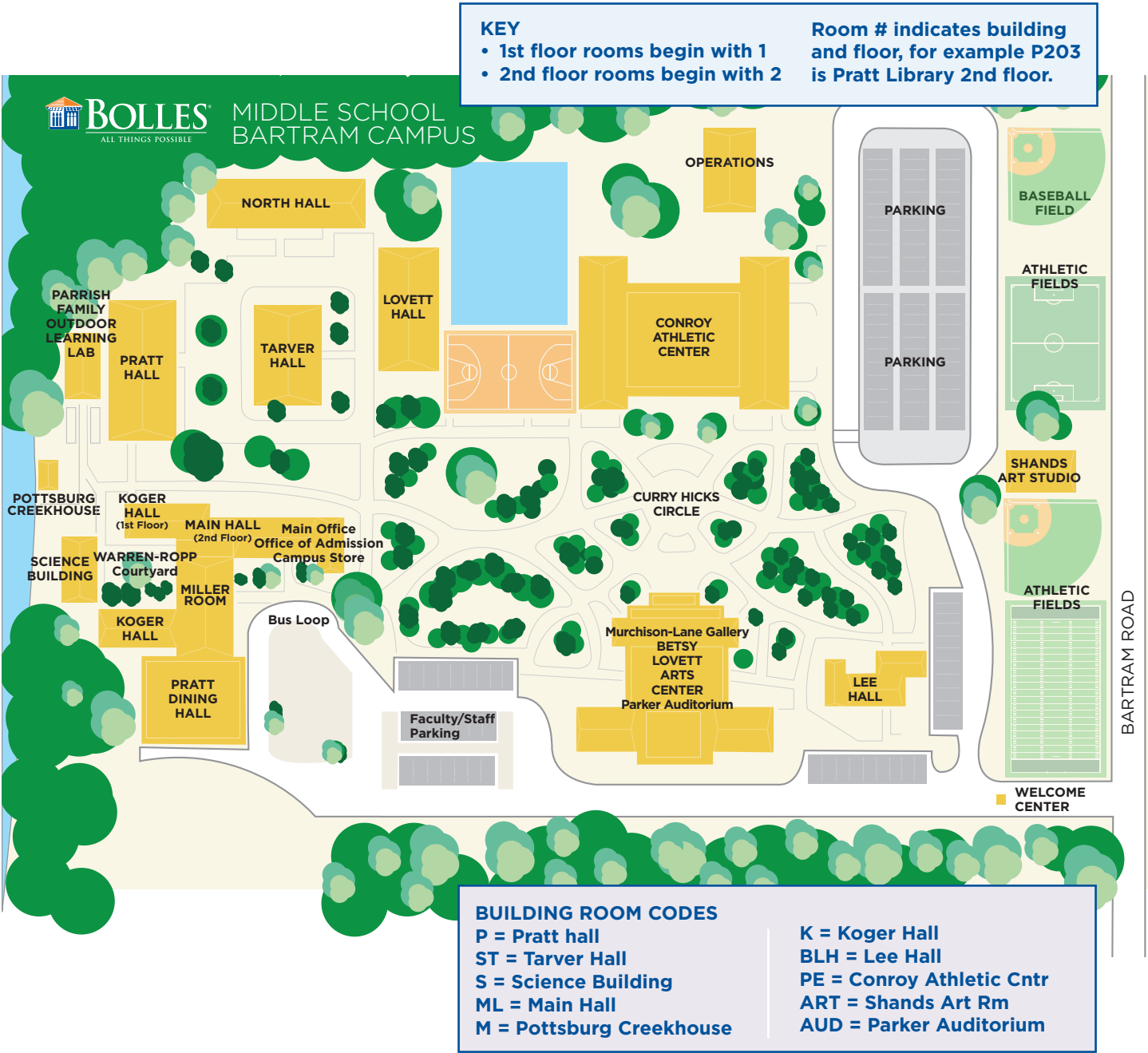

NOTES

Bartram Middle School Campus Expectations

- If you arrive at school before 8 a.m., you are to report directly to the cafeteria.
- Phones and smart watches are to be turned off and put away (in your backpack or locker) from 8 a.m. to 3 p.m. If you need to speak to your parent, you may ask to come to the main office to call them. If your parent needs to speak to you, they should call the front office at (904) 732-5700.
- Devices are to be used for academic purposes only, not gaming, listening to music, or watching videos. Any device usage should be directed by a teacher.
- No student should be in a classroom, the Miller room, gym, auditorium, etc., if there is not a faculty member present for supervision.
- P.E. clothes and locks for your locker are sold in the campus store.
- No gum is allowed on campus.
- No foul language is allowed on campus.
- Clean up after yourself.
- Treat others with kindness and respect.
- Be a person of courage.
- Be a person of integrity.
- Be a person of compassion.

Mindfulness

Everybody gets stressed. When you get stressed or feel overwhelmed, or just need to take a break for your brain, what can you do? Here are a few suggestions:

- Talk to a trusted teacher or friend
- Take a short walk
- Take a minute to think about how you feel



Try this 1-minute exercise that will help calm you and collect your thoughts...

1-minute grounding exercise:

1. Take a seat with your feet on the ground (in a chair, on a bench, etc.).
2. Take a deep breath in. Notice your body as you inhale.
3. Take a long breath out. Notice your body as you exhale.
4. Follow your breath in and out.
5. Rest your mind on your belly or your chest or at your nostrils.
6. Be aware as you breathe in and out.

Middle School Dress Code

(Monday through Friday)
Starred items (*) are considered “Regulation,” meaning the clothing is required and must be purchased from the Bolles Lands’ End (www.landsend.com) store or the Bolles campus store. If you are given uniform pieces from a previous student, please ensure they meet the current dress code requirements.

BOTTOMS*: Khaki or navy-blue pants, skorts, and shorts purchased from the Bolles Lands’ End store of an appropriate fit and length. The Bolles logo will be embroidered on all uniform bottoms. Skorts are the “top of the knee” style, unaltered with a Bolles logo at the hem. Please allow for growth; skorts and shorts must reach or extend beyond the fingertips when at a normal stance.

SHIRTS*: Oxford button down or polo-style shirts with the Bolles logo purchased from the Bolles Lands’ End store or the campus store. Bolles polo-style team shirts (sports, band, robotics, etc.) are also acceptable. They should be the correct size for the student, not oversized, and always tucked in neatly with the belt/waistband visible.

SWEATERS: Solid color cardigan, V-neck, or crew neck sweaters or sweater vest of the student’s choice. They should be the correct size for the student, not oversized. Options are available from the Bolles Lands’ End store.

SWEATSHIRTS: Bolles School sweatshirts may be worn. They should be the correct size for the student, not oversized.

BELTS: Bottoms (pants, shorts, and skorts) with belt loops must be worn with a belt.

SHOES: Shoes must have a closed toe and heel with a flat heel. Examples – athletic shoes, ballet flats, boat shoes.

OUTERWEAR: In cold weather, students may wear jackets and coats with no large logos, advertising, or denim. Hoodies/sweatshirts are not considered jackets. Options are available from the Bolles Lands’ End store.

ACCESSORIES: Hair and makeup must be neat, and not in a radical style or color. Hair should be well-groomed and out of the eyes. Hats and sunglasses are not permitted. Jewelry and accessories must be simple and understated.

DESIGNATED SPIRIT DRESS DAYS: On designated Spirit Days, students may wear a Bolles polo shirt or a Bolles t-shirt, with uniform bottoms or long jeans with no rips, tears, or holes.





Middle School Sports Go Bulldogs!

Coaches will announce start dates in global emails for all winter and spring sports.
Winter sports generally begin in October/November and spring sports in January.

Sport	Coach	Contact
Fall Sports		
Cheerleading	Amanda Kieck	akieck.cheer@gmail.com
Boys' Cross Country	Steven Stam '00	StamS@Bolles.org
Girls' Cross Country	Tony Ryan	RyanT@Bolles.org
Boys' Crew (Fall Season)	Chris Register	RegisterC@Bolles.org
Girls' Crew (Fall Season)	Conny Kirsch	KirschC@Bolles.org
Football	Joey Hudson	HudsonJ@Bolles.org
Boys' Golf	Trey Leonard	LeonardT@Bolles.org
Girls' Golf	Michael McGrath	McGrathM@Bolles.org
Swimming and Diving	Dale Porter	PorterD@Bolles.org
Volleyball	Natalie Blackwell	BlackwellN@Bolles.org
Winter Sports		
Boys' Basketball	Sean Mullings	MullingsS@Bolles.org
Girls' Basketball	Rachel Freeman	FreemanR@bolles.org
Boys' Soccer	Mike Akabekjan	AkabekjanM@Bolles.org
Girls' Soccer	Abby Lieftring	abbylieftring@gmail.com
Wrestling	Billy Regan	william.regan.01@gmail.com
Spring Sports		
Baseball	Matt Denmark	DenmarkM@Bolles.org
Boys' Crew (Spring Season)	Chris Register	RegisterC@Bolles.org
Girls' Crew (Spring Season)	Conny Kirsch	KirschC@Bolles.org
Boys' Lacrosse	Mark Hoey	HoeyM@Bolles.org
Girls' Lacrosse	Abby Lieftring	LieftringA@Bolles.org
Softball	Joey Hudson	HudsonJ@Bolles.org
Boys' Tennis	Matt Lichtenstein	mlichtenstein@jtcc.org
Girls' Tennis	Francesca Fusinato	fusinatofrancesca@gmail.com
Track and Field	Alicia Henderson	HendersonA@Bolles.org

MAIN CONTACT
Athletic Director — Matt Denmark (DenmarkM@Bolles.org)
Phone: (904) 732-5710



JANUARY 2026



NOTES	MON	TUE
	29	30
	Winter Break	Winter Break
	5	A 6
	Professional Development Day, No Classes	Classes Resume after Winter Break
	E 12	F 13
	19	C 20
	Martin Luther King Jr. Holiday, No School	
	G 26	A 27

WED	THU	FRI	SAT	SUN
31	1	2	3	4
Winter Break	Winter Break New Year's Day	Winter Break		
B 7	C 8	D 9	10	11
G 14	A 15	B 16	17	18
D 21	E 22	F 23	24	25
B 28	C 29	D 30	31	1

WEEK OF JAN 5-9, 2026

Mon5	TueA6	WedB7
Professional Development - No Classes	Zero Hour 8-8:30 a.m.	
	Advisory 8:30-8:40 a.m.	
	1 8:45-9:40 a.m.12.1	Late Start Wednesday
		6 8:55-9:50 a.m.12.1
	2 9:45-10:40 a.m.12.1	
		7 9:55-10:50 a.m.12.1
	Activities — 10:40-11:10 a.m.	
		Break — 10:50-11:10 a.m.
	3 11:10 a.m.-12:05 p.m.12.1	1 11:10 a.m.-12:05 p.m.12.2
	12:05-12:25 p.m. — Grade 8 Lunch	12:05-12:25 p.m. — Grade 8 Lunch
	12:25-12:40 p.m. — Grade 6 Lunch	12:25-12:40 p.m. — Grade 6 Lunch
	12:40-1 p.m. — Grade 7 Lunch	12:40-1 p.m. — Grade 7 Lunch
	4 1:05-2 p.m.12.1	2 1:05-2 p.m.12.2
	5 2:05-3 p.m.12.1	3 2:05-3 p.m.12.2
	After School	After School

ThuC8	FriD9	Saturday
Zero Hour 8-8:30 a.m.	Zero Hour 8-8:30 a.m.	
4 8:30-9:25 a.m.12.2	Advisory 8:30-8:40 a.m.	
	2 8:45-9:40 a.m.12.3	
5 9:30-10:25 a.m.12.2		
	3 9:45-10:40 a.m.12.3	
Advisory - 10:25-11:05 a.m.	Activities - 10:40-11:10 a.m.	Sunday
6 11:10 a.m.-12:05 p.m.12.2	4 11:10 a.m.-12:05 p.m.12.3	
12:05-12:25 p.m. — Grade 8 Lunch	12:05-12:25 p.m. — Grade 8 Lunch	
12:25-12:40 p.m. — Grade 6 Lunch	12:25-12:40 p.m. — Grade 6 Lunch	
12:40-1 p.m. — Grade 7 Lunch	12:40-1 p.m. — Grade 7 Lunch	
7 1:05-2 p.m.12.2	5 1:05-2 p.m.12.3	Notes
1 2:05-3 p.m.12.3	6 2:05-3 p.m.12.3	
After School	After School	

WEEK OF JAN 12-16, 2026

Mon	E	12	Tue	F	13	Wed	G	14
Zero Hour 8-8:30 a.m.			Zero Hour 8-8:30 a.m.					
Advisory 8:30–8:40 a.m.			Advisory 8:30–8:40 a.m.					
7 8:45-9:40 a.m.12.3			5 8:45-9:40 a.m.12.4			Late Start Wednesday		
						3 8:55-9:50 a.m.12.5		
1 9:45-10:40 a.m.12.4			6 9:45-10:40 a.m.12.4					
						4 9:55-10:50 a.m.12.5		
Convocation — 10:40-11:10 a.m.			Activities — 10:40-11:10 a.m.					
						Break — 10:50-11:10 a.m.		
2 11:10 a.m.-12:05 p.m.12.4			7 11:10 a.m.-12:05 p.m.12.4			5 11:10 a.m.-12:05 p.m.12.5		
12:05-12:25 p.m. — Grade 8 Lunch			12:05-12:25 p.m. — Grade 8 Lunch			12:05-12:25 p.m. — Grade 8 Lunch		
12:25-12:40 p.m. — Grade 6 Lunch			12:25-12:40 p.m. — Grade 6 Lunch			12:25-12:40 p.m. — Grade 6 Lunch		
12:40-1 p.m. — Grade 7 Lunch			12:40-1 p.m. — Grade 7 Lunch			12:40-1 p.m. — Grade 7 Lunch		
3 1:05–2 p.m.12.4			1 1:05–2 p.m.12.5			6 1:05–2 p.m.12.5		
4 2:05–3 p.m.12.4			2 2:05–3 p.m.12.5			7 2:05–3 p.m.12.5		
After School			After School			After School		

Thu	A	15	Fri	B	16	Saturday
Zero Hour 8-8:30 a.m.			Zero Hour 8-8:30 a.m.			
1 8:30-9:25 a.m. 13.1			Advisory 8:30–8:40 a.m.			
			6 8:45-9:40 a.m. 13.1			
2 9:30-10:25 a.m. 13.1						
			7 9:45-10:40 a.m. 13.1			
Advisory – 10:25-11:05 a.m.						Sunday
			Activities – 10:40-11:10 a.m.			
3 11:10 a.m.-12:05 p.m. 13.1			1 11:10 a.m.-12:05 p.m. 13.2			
12:05-12:25 p.m. — Grade 8 Lunch			12:05-12:25 p.m. — Grade 8 Lunch			
12:25-12:40 p.m. — Grade 6 Lunch			12:25-12:40 p.m. — Grade 6 Lunch			
12:40-1 p.m. — Grade 7 Lunch			12:40-1 p.m. — Grade 7 Lunch			Notes
4 1:05–2 p.m. 13.1			2 1:05–2 p.m. 13.2			
5 2:05–3 p.m. 13.1			3 2:05–3 p.m. 13.2			
After School			After School			

WEEK OF JAN 19-23, 2026

Mon19	TueC20	WedD21
Martin Luther King Jr. Holiday, No School	Zero Hour 8-8:30 a.m.	
	Advisory 8:30–8:40 a.m.	
	4 8:45-9:40 a.m.13.2	Late Start Wednesday
		2 8:55-9:50 a.m.13.3
	5 9:45-10:40 a.m.13.2	
		3 9:55-10:50 a.m.13.3
	Activities — 10:40-11:10 a.m.	
		Break — 10:50-11:10 a.m.
	6 11:10 a.m.-12:05 p.m.13.2	4 11:10 a.m.-12:05 p.m.13.3
	12:05-12:25 p.m. — Grade 8 Lunch	12:05-12:25 p.m. — Grade 8 Lunch
	12:25-12:40 p.m. — Grade 6 Lunch	12:25-12:40 p.m. — Grade 6 Lunch
	12:40-1 p.m. — Grade 7 Lunch	12:40-1 p.m. — Grade 7 Lunch
	7 1:05–2 p.m.13.2	5 1:05–2 p.m.13.3
	1 2:05–3 p.m.13.3	6 2:05–3 p.m.13.3
	After School	After School

ThuE22	FriF23	Saturday
Zero Hour 8-8:30 a.m.	Zero Hour 8-8:30 a.m.	
7 8:30-9:25 a.m.13.3	Advisory 8:30–8:40 a.m.	
	5 8:45-9:40 a.m.13.4	
1 9:30-10:25 a.m.13.4		
	6 9:45-10:40 a.m.13.4	
Advisory – 10:25-11:05 a.m.		Sunday
	Activities – 10:40-11:10 a.m.	
2 11:10 a.m.-12:05 p.m.13.4	7 11:10 a.m.-12:05 p.m.13.4	
12:05-12:25 p.m. — Grade 8 Lunch	12:05-12:25 p.m. — Grade 8 Lunch	
12:25-12:40 p.m. — Grade 6 Lunch	12:25-12:40 p.m. — Grade 6 Lunch	
12:40-1 p.m. — Grade 7 Lunch	12:40-1 p.m. — Grade 7 Lunch	Notes
3 1:05–2 p.m.13.4	1 1:05–2 p.m.13.5	
4 2:05–3 p.m.13.4	2 2:05–3 p.m.13.5	
After School	After School	

WEEK OF JAN 26-30, 2026

Mon	G	26	Tue	A	27	Wed	B	28
Zero Hour 8-8:30 a.m.			Zero Hour 8-8:30 a.m.					
Advisory 8:30–8:40 a.m.			Advisory 8:30–8:40 a.m.					
3 8:45-9:40 a.m.13.5			1 8:45-9:40 a.m.14.1			Late Start Wednesday		
						6 8:55-9:50 a.m.14.1		
4 9:45-10:40 a.m.13.5			2 9:45-10:40 a.m.14.1					
						7 9:55-10:50 a.m.14.1		
Convocation — 10:40-11:10 a.m.			Activities - 10:40-11:10 a.m.					
						Break — 10:50-11:10 a.m.		
5 11:10 a.m.-12:05 p.m.13.5			3 11:10 a.m.-12:05 p.m.14.1			1 11:10 a.m.-12:05 p.m.14.2		
12:05-12:25 p.m. — Grade 8 Lunch			12:05-12:25 p.m. — Grade 8 Lunch			12:05-12:25 p.m. — Grade 8 Lunch		
12:25-12:40 p.m. — Grade 6 Lunch			12:25-12:40 p.m. — Grade 6 Lunch			12:25-12:40 p.m. — Grade 6 Lunch		
12:40-1 p.m. — Grade 7 Lunch			12:40-1 p.m. — Grade 7 Lunch			12:40-1 p.m. — Grade 7 Lunch		
6 1:05–2 p.m.13.5			4 1:05–2 p.m.14.1			2 1:05–2 p.m.14.2		
7 2:05–3 p.m.13.5			5 2:05–3 p.m.14.1			3 2:05–3 p.m.14.2		
After School			After School			After School		

Thu	C	29	Fri	D	30	Saturday
Zero Hour 8-8:30 a.m.			Zero Hour 8-8:30 a.m.			
4 8:30-9:25 a.m. 14.2			Advisory 8:30–8:40 a.m.			
			2 8:45-9:40 a.m. 14.3			
5 9:30-10:25 a.m. 14.2						
			3 9:45-10:40 a.m. 14.3			
						Sunday
Advisory – 10:25-11:05 a.m.						
			Activities – 10:40-11:10 a.m.			
6 11:10 a.m.-12:05 p.m. 14.2			4 11:10 a.m.-12:05 p.m. 14.3			
12:05-12:25 p.m. — Grade 8 Lunch			12:05-12:25 p.m. — Grade 8 Lunch			Notes
12:25-12:40 p.m. — Grade 6 Lunch			12:25-12:40 p.m. — Grade 6 Lunch			
12:40-1 p.m. — Grade 7 Lunch			12:40-1 p.m. — Grade 7 Lunch			
7 1:05–2 p.m. 14.2			5 1:05–2 p.m. 14.3			
1 2:05–3 p.m. 14.3			6 2:05–3 p.m. 14.3			
After School			After School			

FEBRUARY 2026



NOTES	MON	TUE
	26	27
	E 2	F 3
	C 9	D 10
	16	G 17
	Presidents' Day, School Closed	
	D 23	E 24

WED	THU	FRI	SAT	SUN
28	29	30	31	1
G 4	A 5	B 6	7	8
Quarter 3 End of Interim				
E 11	F 12	13	14	15
		Conference Day, No Classes		
A 18	B 19	C 20	21	22
F 25	G 26	A 27	28	1

WEEK OF FEB 2-6, 2026

Q3 End of Interim																				
Mon			E		2	Tue		F		3	Wed		G		4					
Zero Hour 8-8:30 a.m.					Zero Hour 8-8:30 a.m.															
Advisory 8:30–8:40 a.m.					Advisory 8:30–8:40 a.m.															
7 8:45-9:40 a.m.					14.3		5 8:45-9:40 a.m.					14.4		Late Start Wednesday						
														3 8:55-9:50 a.m.					14.5	
1 9:45-10:40 a.m.					14.4		6 9:45-10:40 a.m.					14.4								
														4 9:55-10:50 a.m.					14.5	
Convocation — 10:40-11:10 a.m.							Activities — 10:40-11:10 a.m.													
														Break — 10:50-11:10 a.m.						
2 11:10 a.m.-12:05 p.m.					14.4		7 11:10 a.m.-12:05 p.m.					14.4		5 11:10 a.m.-12:05 p.m.					14.5	
12:05-12:25 p.m. — Grade 8 Lunch							12:05-12:25 p.m. — Grade 8 Lunch							12:05-12:25 p.m. — Grade 8 Lunch						
12:25-12:40 p.m. — Grade 6 Lunch							12:25-12:40 p.m. — Grade 6 Lunch							12:25-12:40 p.m. — Grade 6 Lunch						
12:40-1 p.m. — Grade 7 Lunch							12:40-1 p.m. — Grade 7 Lunch							12:40-1 p.m. — Grade 7 Lunch						
3 1:05-2 p.m.					14.4		1 1:05-2 p.m.					14.5		6 1:05-2 p.m.					14.5	
4 2:05-3 p.m.					14.4		2 2:05-3 p.m.					14.5		7 2:05-3 p.m.					14.5	
After School							After School							After School						

Thu	A	5	Fri	B	6	Saturday
Zero Hour 8-8:30 a.m.			Zero Hour 8-8:30 a.m.			
1 8:30-9:25 a.m. 15.1			Advisory 8:30–8:40 a.m.			
			6 8:45-9:40 a.m. 15.1			
2 9:30-10:25 a.m. 15.1						
			7 9:45-10:40 a.m. 15.1			
						Sunday
Advisory – 10:25-11:05 a.m.						
			Activities – 10:40-11:10 a.m.			
3 11:10 a.m.-12:05 p.m. 15.1			1 11:10 a.m.-12:05 p.m. 15.2			
						Notes
12:05-12:25 p.m. — Grade 8 Lunch			12:05-12:25 p.m. — Grade 8 Lunch			
12:25-12:40 p.m. — Grade 6 Lunch			12:25-12:40 p.m. — Grade 6 Lunch			
12:40-1 p.m. — Grade 7 Lunch			12:40-1 p.m. — Grade 7 Lunch			
4 1:05–2 p.m. 15.1			2 1:05–2 p.m. 15.2			
5 2:05–3 p.m. 15.1			3 2:05–3 p.m. 15.2			
After School			After School			

WEEK OF FEB 9-13, 2026

MonC9	TueD10	WedE11
Zero Hour 8-8:30 a.m.	Zero Hour 8-8:30 a.m.	
Advisory 8:30-8:40 a.m.	Advisory 8:30-8:40 a.m.	
4 8:45-9:40 a.m.15.2	2 8:45-9:40 a.m.15.3	Late Start Wednesday
		7 8:55-9:50 a.m.15.3
5 9:45-10:40 a.m.15.2	3 9:45-10:40 a.m.15.3	
		1 9:55-10:50 a.m.15.4
Convocation — 10:40-11:10 a.m.	Activities — 10:40-11:10 a.m.	
		Break — 10:50-11:10 a.m.
6 11:10 a.m.-12:05 p.m.15.2	4 11:10 a.m.-12:05 p.m.15.3	2 11:10 a.m.-12:05 p.m.15.4
12:05-12:25 p.m. — Grade 8 Lunch	12:05-12:25 p.m. — Grade 8 Lunch	12:05-12:25 p.m. — Grade 8 Lunch
12:25-12:40 p.m. — Grade 6 Lunch	12:25-12:40 p.m. — Grade 6 Lunch	12:25-12:40 p.m. — Grade 6 Lunch
12:40-1 p.m. — Grade 7 Lunch	12:40-1 p.m. — Grade 7 Lunch	12:40-1 p.m. — Grade 7 Lunch
7 1:05-2 p.m.15.2	5 1:05-2 p.m.15.3	3 1:05-2 p.m.15.4
1 2:05-3 p.m.15.3	6 2:05-3 p.m.15.3	4 2:05-3 p.m.15.4
After School	After School	After School

ThuF12	Fri13	Saturday
Zero Hour 8-8:30 a.m.	Conference Day, No Classes	
5 8:30-9:25 a.m.15.4		
6 9:30-10:25 a.m.15.4		
Advisory - 10:25-11:05 a.m.		
7 11:10 a.m.-12:05 p.m.15.4		
12:05-12:25 p.m. — Grade 8 Lunch		
12:25-12:40 p.m. — Grade 6 Lunch		
12:40-1 p.m. — Grade 7 Lunch		
1 1:05-2 p.m.15.5		
2 2:05-3 p.m.15.5		
After School		

WEEK OF FEB 16-20, 2026

Mon16	TueG17	WedA18
Presidents' Day, No School	Zero Hour 8-8:30 a.m.	
	Advisory 8:30-8:40 a.m.	
	3 8:45-9:40 a.m.15.5	Late Start Wednesday
		1 8:55-9:50 a.m.16.1
	4 9:45-10:40 a.m.15.5	
		2 9:55-10:50 a.m.16.1
	Activities — 10:40-11:10 a.m.	
		Break — 10:50-11:10 a.m.
	5 11:10 a.m.-12:05 p.m.15.5	3 11:10 a.m.-12:05 p.m.16.1
	12:05-12:25 p.m. — Grade 8 Lunch	12:05-12:25 p.m. — Grade 8 Lunch
	12:25-12:40 p.m. — Grade 6 Lunch	12:25-12:40 p.m. — Grade 6 Lunch
	12:40-1 p.m. — Grade 7 Lunch	12:40-1 p.m. — Grade 7 Lunch
	6 1:05-2 p.m.15.5	4 1:05-2 p.m.16.1
	7 2:05-3 p.m.15.5	5 2:05-3 p.m.16.1
	After School	After School

ThuB19	FriC20	Saturday
Zero Hour 8-8:30 a.m.	Zero Hour 8-8:30 a.m.	
6 8:30-9:25 a.m.16.1	Advisory 8:30-8:40 a.m.	
	4 8:45-9:40 a.m.16.2	
7 9:30-10:25 a.m.16.1		
	5 9:45-10:40 a.m.16.2	
Advisory - 10:25-11:05 a.m.		Sunday
	Activities - 10:40-11:10 a.m.	
1 11:10 a.m.-12:05 p.m.16.2	6 11:10 a.m.-12:05 p.m.16.2	
12:05-12:25 p.m. — Grade 8 Lunch	12:05-12:25 p.m. — Grade 8 Lunch	
12:25-12:40 p.m. — Grade 6 Lunch	12:25-12:40 p.m. — Grade 6 Lunch	
12:40-1 p.m. — Grade 7 Lunch	12:40-1 p.m. — Grade 7 Lunch	Notes
2 1:05-2 p.m.16.2	7 1:05-2 p.m.16.2	
3 2:05-3 p.m.16.2	1 2:05-3 p.m.16.3	
After School	After School	

WEEK OF FEB 23-27, 2026

Mon	D	23	Tue	E	24	Wed	F	25
Zero Hour 8-8:30 a.m.			Zero Hour 8-8:30 a.m.					
Advisory 8:30–8:40 a.m.			Advisory 8:30–8:40 a.m.					
2 8:45-9:40 a.m.16.3			7 8:45-9:40 a.m.16.3			Late Start Wednesday		
						5 8:55-9:50 a.m.16.4		
3 9:45-10:40 a.m.16.3			1 9:45-10:40 a.m.16.4					
						6 9:55-10:50 a.m.16.4		
Convocation — 10:40-11:10 a.m.			Activities — 10:40-11:10 a.m.					
						Break — 10:50-11:10 a.m.		
4 11:10 a.m.-12:05 p.m.16.3			2 11:10 a.m.-12:05 p.m.16.4			7 11:10 a.m.-12:05 p.m.16.4		
12:05-12:25 p.m. — Grade 8 Lunch			12:05-12:25 p.m. — Grade 8 Lunch			12:05-12:25 p.m. — Grade 8 Lunch		
12:25-12:40 p.m. — Grade 6 Lunch			12:25-12:40 p.m. — Grade 6 Lunch			12:25-12:40 p.m. — Grade 6 Lunch		
12:40-1 p.m. — Grade 7 Lunch			12:40-1 p.m. — Grade 7 Lunch			12:40-1 p.m. — Grade 7 Lunch		
5 1:05–2 p.m.16.3			3 1:05–2 p.m.16.4			1 1:05–2 p.m.16.5		
6 2:05–3 p.m.16.3			4 2:05–3 p.m.16.4			2 2:05–3 p.m.16.5		
After School			After School			After School		

Thu	G	26	Fri	A	27	Saturday	
Zero Hour 8-8:30 a.m.			Zero Hour 8-8:30 a.m.				
3 8:30-9:25 a.m. 16.5			Advisory 8:30–8:40 a.m.				
			1 8:45-9:40 a.m. 17.1				
4 9:30-10:25 a.m. 16.5							
			2 9:45-10:40 a.m. 17.1				
						Sunday	
Advisory – 10:25-11:05 a.m.							
			Activities – 10:40-11:10 a.m.				
5 11:10 a.m.-12:05 p.m. 16.5			3 11:10 a.m.-12:05 p.m. 17.1				
						Notes	
12:05-12:25 p.m. — Grade 8 Lunch			12:05-12:25 p.m. — Grade 8 Lunch				
12:25-12:40 p.m. — Grade 6 Lunch			12:25-12:40 p.m. — Grade 6 Lunch				
12:40-1 p.m. — Grade 7 Lunch			12:40-1 p.m. — Grade 7 Lunch				
6 1:05–2 p.m. 16.5			4 1:05–2 p.m. 17.1				
7 2:05–3 p.m. 16.5			5 2:05–3 p.m. 17.1				
After School			After School				

MARCH 2026



NOTES	MON	TUE
	B2	C3
	9	10
	Spring Break	Spring Break
	16	G17
	Faculty Work Day, No Classes	End Quarter 3 ERB Testing
	D23	E24
	ERB Testing	
	B30	C31

WED	THU	FRI	SAT	SUN
D4	E5	F6	7	8
	ERB Testing Demo Day			
11	12	13	14	15
Spring Break	Spring Break	Spring Break		
A18	B19	C20	21	22
ERB Testing	ERB Testing	Eid al-Fitr, No quizzes or tests		
F25	G26	A27	28	29
1	2	3	4	5

WEEK OF MAR 2-6, 2026

Mon	B	2	Tue	C	3	Wed	D	4
Zero Hour 8-8:30 a.m.			Zero Hour 8-8:30 a.m.					
Advisory 8:30–8:40 a.m.			Advisory 8:30–8:40 a.m.					
6 8:45-9:40 a.m. 17.1			4 8:45-9:40 a.m. 17.2			Late Start Wednesday		
						2 8:55-9:50 a.m. 17.3		
7 9:45-10:40 a.m. 17.1			5 9:45-10:40 a.m. 17.2					
						3 9:55-10:50 a.m. 17.3		
Convocation – 10:40-11:10 a.m.			Activities — 10:40-11:10 a.m.					
						Break — 10:50-11:10 a.m.		
1 11:10 a.m.-12:05 p.m. 17.2			6 11:10 a.m.-12:05 p.m. 17.2			4 11:10 a.m.-12:05 p.m. 17.3		
12:05-12:25 p.m. — Grade 8 Lunch			12:05-12:25 p.m. — Grade 8 Lunch			12:05-12:25 p.m. — Grade 8 Lunch		
12:25-12:40 p.m. — Grade 6 Lunch			12:25-12:40 p.m. — Grade 6 Lunch			12:25-12:40 p.m. — Grade 6 Lunch		
12:40-1 p.m. — Grade 7 Lunch			12:40-1 p.m. — Grade 7 Lunch			12:40-1 p.m. — Grade 7 Lunch		
2 1:05–2 p.m. 17.2			7 1:05–2 p.m. 17.2			5 1:05–2 p.m. 17.3		
3 2:05–3 p.m. 17.2			1 2:05–3 p.m. 17.3			6 2:05–3 p.m. 17.3		
After School			After School			After School		

ERB Testing Demo Day			Spring Break Begins End of Day Classes Resume Tuesday, March 17			
Thu	E	5	Fri	F	6	Saturday
Zero Hour 8-8:30 a.m.			Zero Hour 8-8:30 a.m.			
7 8:30-9:25 a.m. 17.3			Advisory 8:30–8:40 a.m.			
			5 8:45-9:40 a.m. 17.4			
1 9:30-10:25 a.m. 17.4						
			6 9:45-10:40 a.m. 17.4			
Advisory – 10:25-11:05 a.m.						Sunday
ERB Testing Demo			Activities – 10:40-11:10 a.m.			
2 11:10 a.m.-12:05 p.m. 17.4			7 11:10 a.m.-12:05 p.m. 17.4			
12:05-12:25 p.m. — Grade 8 Lunch			12:05-12:25 p.m. — Grade 8 Lunch			
12:25-12:40 p.m. — Grade 6 Lunch			12:25-12:40 p.m. — Grade 6 Lunch			
12:40-1 p.m. — Grade 7 Lunch			12:40-1 p.m. — Grade 7 Lunch			Notes
3 1:05–2 p.m. 17.4			1 1:05–2 p.m. 17.5			
4 2:05–3 p.m. 17.4			2 2:05–3 p.m. 17.5			
After School			After School			

WEEK OF MAR 16-20, 2026

Classes Resume After Spring Break End Quarter 3, ERB Testing		ERB Testing	
Mon16	TueG17	WedA18	
Spring Break, School Closed	Zero Hour 8-8:30 a.m.		
	Advisory 8:30–8:40 a.m.		
	3 8:45-9:40 a.m.17.5	Late Start Wednesday	
		1 8:55-9:50 a.m.18.1	
	10-10:40 a.m.		
	ERB Testing — Reading Comp.	10:10-10:52 a.m.	
		ERB Testing — W. Concepts	
	Activities — 10:40-11:10 a.m.		
		Activities — 10:52-11:15 a.m.	
	11:25 a.m.-12:04 p.m.	11:30 a.m.-12 p.m.	
	ERB Testing —Math 1	ERB Testing — W. Mechanics	
	12:05-12:25 p.m. — Grade 8 Lunch	12:05-12:25 p.m. — Grade 8 Lunch	
	12:25-12:40 p.m. — Grade 6 Lunch	12:25-12:40 p.m. — Grade 6 Lunch	
	12:40-1 p.m. — Grade 7 Lunch	12:40-1 p.m. — Grade 7 Lunch	
	6 1:05–2 p.m.17.5	4 1:05–2 p.m.18.1	
	7 2:05–3 p.m.17.5	5 2:05–3 p.m.18.1	
	After School	After School	

ERB Testing		Eid al-Fitr, No quizzes or tests	
ThuB19	FriC20	Saturday	
Zero Hour 8-8:30 a.m.	Zero Hour 8-8:30 a.m.		
6 8:30-9:25 a.m.18.1	Advisory 8:30–8:40 a.m.		
	4 8:45-9:40 a.m.18.2		
9:45-10:30 a.m.			
ERB Testing — Quant. Reas.	5 9:45-10:40 a.m.18.2		
Activities – 10:35-11:05 a.m.		Sunday	
	Activities – 10:40-11:10 a.m.		
11:25 a.m.-12 p.m.	6 11:10 a.m.-12:05 p.m.18.2		
ERB Testing — Verbal Reas.			
12:05-12:25 p.m. — Grade 8 Lunch	12:05-12:25 p.m. — Grade 8 Lunch		
12:25-12:40 p.m. — Grade 6 Lunch	12:25-12:40 p.m. — Grade 6 Lunch		
12:40-1 p.m. — Grade 7 Lunch	12:40-1 p.m. — Grade 7 Lunch		
2 1:05–2 p.m.18.2	7 1:05–2 p.m.18.2	Notes	
3 2:05–3 p.m.18.2	1 2:05–3 p.m.18.3		
After School	After School		

WEEK OF MAR 23-27, 2026

ERB Testing

Mon	D	23	Tue	E	24	Wed	F	25
Zero Hour 8-8:30 a.m.			Zero Hour 8-8:30 a.m.					
Advisory 8:30–8:40 a.m.			Advisory 8:30–8:40 a.m.					
2 8:45-9:40 a.m.18.3			7 8:45-9:40 a.m.18.3			Late Start Wednesday		
						5 8:55-9:50 a.m.18.4		
3 9:45-10:40 a.m.18.3			1 9:45-10:40 a.m.18.4					
						6 9:55-10:50 a.m.18.4		
11-11:40 a.m.			Activities — 10:40-11:10 a.m.					
ERB Testing — Math 2						Break — 10:50-11:10 a.m.		
11:45 a.m.-12:05 p.m.			2 11:10 a.m.-12:05 p.m.18.4			7 11:10 a.m.-12:05 p.m.18.4		
ERB Testing — Vocab								
12:05-12:25 p.m. — Grade 8 Lunch			12:05-12:25 p.m. — Grade 8 Lunch			12:05-12:25 p.m. — Grade 8 Lunch		
12:25-12:40 p.m. — Grade 6 Lunch			12:25-12:40 p.m. — Grade 6 Lunch			12:25-12:40 p.m. — Grade 6 Lunch		
12:40-1 p.m. — Grade 7 Lunch			12:40-1 p.m. — Grade 7 Lunch			12:40-1 p.m. — Grade 7 Lunch		
5 1:05–2 p.m.18.3			3 1:05–2 p.m.18.4			1 1:05–2 p.m.18.5		
6 2:05–3 p.m.18.3			4 2:05–3 p.m.18.4			2 2:05–3 p.m.18.5		
After School			After School			After School		

Thu	G	26	Fri	A	27	Saturday
Zero Hour 8-8:30 a.m.			Zero Hour 8-8:30 a.m.			
3 8:30-9:25 a.m. 18.5			Advisory 8:30–8:40 a.m.			
			1 8:45-9:40 a.m. 19.1			
4 9:30-10:25 a.m. 18.5						
			2 9:45-10:40 a.m. 19.1			
						Sunday
Advisory – 10:25-11:05 a.m.						
			Activities – 10:40-11:10 a.m.			
5 11:10 a.m.-12:05 p.m. 18.5			3 11:10 a.m.-12:05 p.m. 19.1			
						Notes
12:05-12:25 p.m. — Grade 8 Lunch			12:05-12:25 p.m. — Grade 8 Lunch			
12:25-12:40 p.m. — Grade 6 Lunch			12:25-12:40 p.m. — Grade 6 Lunch			
12:40-1 p.m. — Grade 7 Lunch			12:40-1 p.m. — Grade 7 Lunch			
6 1:05–2 p.m. 18.5			4 1:05–2 p.m. 19.1			
7 2:05–3 p.m. 18.5			5 2:05–3 p.m. 19.1			
After School			After School			

WEEK OF MAR 30-APR 3, 2026

MonB30	TueC31	WedD1
Zero Hour 8-8:30 a.m.	Zero Hour 8-8:30 a.m.	
Advisory 8:30–8:40 a.m.	Advisory 8:30–8:40 a.m.	
6 8:45-9:40 a.m.19.1	4 8:45-9:40 a.m.19.2	Late Start Wednesday
7 9:45-10:40 a.m.19.1	5 9:45-10:40 a.m.19.2	
		3 9:55-10:50 a.m.19.3
Convocation - 10:40-11:10 a.m.	Activities — 10:40-11:10 a.m.	
		Break — 10:50-11:10 a.m.
1 11:10 a.m.-12:05 p.m.19.2	6 11:10 a.m.-12:05 p.m.19.2	4 11:10 a.m.-12:05 p.m.19.3
12:05-12:25 p.m. — Grade 8 Lunch	12:05-12:25 p.m. — Grade 8 Lunch	12:05-12:25 p.m. — Grade 8 Lunch
12:25-12:40 p.m. — Grade 6 Lunch	12:25-12:40 p.m. — Grade 6 Lunch	12:25-12:40 p.m. — Grade 6 Lunch
12:40-1 p.m. — Grade 7 Lunch	12:40-1 p.m. — Grade 7 Lunch	12:40-1 p.m. — Grade 7 Lunch
2 1:05–2 p.m.19.2	7 1:05–2 p.m.19.2	5 1:05–2 p.m.19.3
3 2:05–3 p.m.19.2	1 2:05–3 p.m.19.3	6 2:05–3 p.m.19.3
After School	After School	After School

ThuE2	Fri3	Saturday
Zero Hour 8-8:30 a.m.	Good Friday Spring Holiday, School Closed	
7 8:30-9:25 a.m.19.3		
1 9:30-10:25 a.m.19.4		
Advisory - 10:25-11:05 a.m.		Sunday
2 11:10 a.m.-12:05 p.m.19.4		
12:05-12:25 p.m. — Grade 8 Lunch		Notes
12:25-12:40 p.m. — Grade 6 Lunch		
12:40-1 p.m. — Grade 7 Lunch		
3 1:05–2 p.m.19.4		
4 2:05–3 p.m.19.4		
After School		

APRIL 2026



NOTES	MON	TUE
	30	31
	6	F 7
	Break, No School	
	C 13	D 14
	A 20	B 21
	F 27	G 28
		Grade 8 Class Trip

WED	THU	FRI	SAT	SUN
D 1	E 2	3	4	5
		Good Friday Break, No School		Easter
G 8	A 9	B 10	11	12
E 15	F 16	G 17	18	19
		Quarter 4 End of Interim		
C 22	D 23	E 24	25	26
A 29	B 30	1	2	3
Grade 8 Class Trip	Grade 8 Class Trip			

WEEK OF APR 6-10, 2026

Mon6	TueF7	WedG8
Spring Holiday, School Closed	Zero Hour 8-8:30 a.m.	
	Advisory 8:30-8:40 a.m.	
	5 8:45-9:40 a.m.19.4	Late Start Wednesday
		3 8:55-9:50 a.m.19.5
	6 9:45-10:40 a.m.19.4	
		4 9:55-10:50 a.m.19.5
	Activities — 10:40-11:10 a.m.	
		Break — 10:50-11:10 a.m.
	7 11:10 a.m.-12:05 p.m.19.4	5 11:10 a.m.-12:05 p.m.119.5
	12:05-12:25 p.m. — Grade 8 Lunch	12:05-12:25 p.m. — Grade 8 Lunch
	12:25-12:40 p.m. — Grade 6 Lunch	12:25-12:40 p.m. — Grade 6 Lunch
	12:40-1 p.m. — Grade 7 Lunch	12:40-1 p.m. — Grade 7 Lunch
	1 1:05-2 p.m.19.5	6 1:05-2 p.m.19.5
	2 2:05-3 p.m.19.5	7 2:05-3 p.m.19.5
	After School	After School

ThuA9	FriB10	Saturday
Zero Hour 8-8:30 a.m.	Zero Hour 8-8:30 a.m.	
1 8:30-9:25 a.m.20.1	Advisory 8:30-8:40 a.m.	
	6 8:45-9:40 a.m.20.1	
2 9:30-10:25 a.m.20.1		
	7 9:45-10:40 a.m.20.1	
Advisory - 10:25-11:05 a.m.		Sunday
	Activities - 10:40-11:10 a.m.	
3 11:10 a.m.-12:05 p.m.20.1	1 11:10 a.m.-12:05 p.m.20.2	
		Notes
12:05-12:25 p.m. — Grade 8 Lunch	12:05-12:25 p.m. — Grade 8 Lunch	
12:25-12:40 p.m. — Grade 6 Lunch	12:25-12:40 p.m. — Grade 6 Lunch	
12:40-1 p.m. — Grade 7 Lunch	12:40-1 p.m. — Grade 7 Lunch	
4 1:05-2 p.m.20.1	2 1:05-2 p.m.20.2	
5 2:05-3 p.m.20.1	3 2:05-3 p.m.20.2	
After School	After School	

WEEK OF APR 13-17, 2026

Mon	C	13	Tue	D	14	Wed	E	15
Zero Hour 8-8:30 a.m.			Zero Hour 8-8:30 a.m.					
Advisory 8:30–8:40 a.m.			Advisory 8:30–8:40 a.m.					
4 8:45-9:40 a.m. 20.2			2 8:45-9:40 a.m. 20.3			Late Start Wednesday		
						7 8:55-9:50 a.m. 20.3		
5 9:45-10:40 a.m. 20.2			3 9:45-10:40 a.m. 20.3					
						1 9:55-10:50 a.m. 20.4		
Convocation — 10:40-11:10 a.m.			Activities — 10:40-11:10 a.m.					
						Break — 10:50-11:10 a.m.		
6 11:10 a.m.-12:05 p.m. 20.2			4 11:10 a.m.-12:05 p.m. 20.3			2 11:10 a.m.-12:05 p.m. 20.4		
12:05-12:25 p.m. — Grade 8 Lunch			12:05-12:25 p.m. — Grade 8 Lunch			12:05-12:25 p.m. — Grade 8 Lunch		
12:25-12:40 p.m. — Grade 6 Lunch			12:25-12:40 p.m. — Grade 6 Lunch			12:25-12:40 p.m. — Grade 6 Lunch		
12:40-1 p.m. — Grade 7 Lunch			12:40-1 p.m. — Grade 7 Lunch			12:40-1 p.m. — Grade 7 Lunch		
7 1:05–2 p.m. 20.2			5 1:05–2 p.m. 20.3			3 1:05–2 p.m. 20.4		
1 2:05–3 p.m. 20.3			6 2:05–3 p.m. 20.3			4 2:05–3 p.m. 20.4		
After School			After School			After School		

Quarter 4 End of Interim						
Thu	F	16	Fri	G	17	Saturday
Zero Hour 8-8:30 a.m.			Zero Hour 8-8:30 a.m.			
5 8:30-9:25 a.m. 20.4			Advisory 8:30–8:40 a.m.			
			3 8:45-9:40 a.m. 20.5			
6 9:30-10:25 a.m. 20.4						
			4 9:45-10:40 a.m. 20.5			
Advisory - 10:25-11:05 a.m.						Sunday
			Activities — 10:40-11:10 a.m.			
7 11:10 a.m.-12:05 p.m. 20.4			5 11:10 a.m.-12:05 p.m. 20.5			
12:05-12:25 p.m. — Grade 8 Lunch			12:05-12:25 p.m. — Grade 8 Lunch			
12:25-12:40 p.m. — Grade 6 Lunch			12:25-12:40 p.m. — Grade 6 Lunch			
12:40-1 p.m. — Grade 7 Lunch			12:40-1 p.m. — Grade 7 Lunch			
1 1:05–2 p.m. 20.5			6 1:05–2 p.m. 20.5			Notes
2 2:05–3 p.m. 20.5			7 2:05–3 p.m. 20.5			
After School			After School			

WEEK OF APR 20-24, 2026

Mon	A	20	Tue	B	21	Wed	C	22
Zero Hour 8-8:30 a.m.			Zero Hour 8-8:30 a.m.					
Advisory 8:30–8:40 a.m.			Advisory 8:30–8:40 a.m.					
1 8:45-9:40 a.m. 21.1			6 8:45-9:40 a.m. 21.1			Late Start Wednesday		
						4 8:55-9:50 a.m. 21.2		
2 9:45-10:40 a.m. 21.1			7 9:45-10:40 a.m. 21.1					
						5 9:55-10:50 a.m. 21.2		
Convocation — 10:40-11:10 a.m.			Activities — 10:40-11:10 a.m.					
						Break — 10:50-11:10 a.m.		
3 11:10 a.m.-12:05 p.m. 21.1			1 11:10 a.m.-12:05 p.m. 21.2			6 11:10 a.m.-12:05 p.m. 21.2		
12:05-12:25 p.m. — Grade 8 Lunch			12:05-12:25 p.m. — Grade 8 Lunch			12:05-12:25 p.m. — Grade 8 Lunch		
12:25-12:40 p.m. — Grade 6 Lunch			12:25-12:40 p.m. — Grade 6 Lunch			12:25-12:40 p.m. — Grade 6 Lunch		
12:40-1 p.m. — Grade 7 Lunch			12:40-1 p.m. — Grade 7 Lunch			12:40-1 p.m. — Grade 7 Lunch		
4 1:05-2 p.m. 21.1			2 1:05-2 p.m. 21.2			7 1:05-2 p.m. 21.2		
5 2:05-3 p.m. 21.1			3 2:05-3 p.m. 21.2			1 2:05-3 p.m. 21.3		
After School			After School			After School		

Thu	D	23	Fri	E	24	Saturday
Zero Hour 8-8:30 a.m.			Zero Hour 8-8:30 a.m.			
2 8:30-9:25 a.m. 21.3			Advisory 8:30–8:40 a.m.			
			7 8:45-9:40 a.m. 21.3			
3 9:30-10:25 a.m. 21.3						
			1 9:45-10:40 a.m. 21.4			
Advisory – 10:25-11:05 a.m.						Sunday
			Activities – 10:40-11:10 a.m.			
4 11:10 a.m.-12:05 p.m. 21.3			2 11:10 a.m.-12:05 p.m. 21.4			
12:05-12:25 p.m. — Grade 8 Lunch			12:05-12:25 p.m. — Grade 8 Lunch			
12:25-12:40 p.m. — Grade 6 Lunch			12:25-12:40 p.m. — Grade 6 Lunch			
12:40-1 p.m. — Grade 7 Lunch			12:40-1 p.m. — Grade 7 Lunch			Notes
5 1:05–2 p.m. 21.3			3 1:05–2 p.m. 21.4			
6 2:05–3 p.m. 21.3			4 2:05–3 p.m. 21.4			
After School			After School			

WEEK OF APR 27-MAY 1, 2026

Grade 8 Class Trip			Grade 8 Class Trip					
Mon	F	27	Tue	G	28	Wed	A	29
Zero Hour 8-8:30 a.m.			Zero Hour 8-8:30 a.m.					
Advisory 8:30–8:40 a.m.			Advisory 8:30–8:40 a.m.					
5 8:45-9:40 a.m. 21.4			3 8:45-9:40 a.m. 21.5			Late Start Wednesday		
						1 8:55-9:50 a.m. 22.1		
6 9:45-10:40 a.m. 21.4			4 9:45-10:40 a.m. 21.5					
						2 9:55-10:50 a.m. 22.1		
Convocation — 10:40-11:10 a.m.			Activities — 10:40-11:10 a.m.					
						Break — 10:50-11:10 a.m.		
7 11:10 a.m.-12:05 p.m. 21.4			5 11:10 a.m.-12:05 p.m. 21.5			3 11:10 a.m.-12:05 p.m. 22.1		
12:05-12:25 p.m. — Grade 8 Lunch			12:05-12:25 p.m. — Grade 8 Lunch			12:05-12:25 p.m. — Grade 8 Lunch		
12:25-12:40 p.m. — Grade 6 Lunch			12:25-12:40 p.m. — Grade 6 Lunch			12:25-12:40 p.m. — Grade 6 Lunch		
12:40-1 p.m. — Grade 7 Lunch			12:40-1 p.m. — Grade 7 Lunch			12:40-1 p.m. — Grade 7 Lunch		
1 1:05–2 p.m. 21.5			6 1:05–2 p.m. 21.5			4 1:05–2 p.m. 22.1		
2 2:05–3 p.m. 21.5			7 2:05–3 p.m. 21.5			5 2:05–3 p.m. 22.1		
After School			After School			After School		

Grade 8 Class Trip			Grade 8 Class Trip		
Thu	B	30	Fri	C	1
Zero Hour 8-8:30 a.m.			Zero Hour 8-8:30 a.m.		
6 8:30-9:25 a.m. 22.1			Advisory 8:30–8:40 a.m.		
			4 8:45-9:40 a.m. 22.2		
7 9:30-10:25 a.m. 22.1					
			5 9:45-10:40 a.m. 22.2		
Advisory – 10:25-11:05 a.m.					
			Activities – 10:40-11:10 a.m.		
1 11:10 a.m.-12:05 p.m. 22.2			6 11:10 a.m.-12:05 p.m. 22.2		
12:05-12:25 p.m. — Grade 8 Lunch			12:05-12:25 p.m. — Grade 8 Lunch		
12:25-12:40 p.m. — Grade 6 Lunch			12:25-12:40 p.m. — Grade 6 Lunch		
12:40-1 p.m. — Grade 7 Lunch			12:40-1 p.m. — Grade 7 Lunch		
2 1:05–2 p.m. 22.2			7 1:05–2 p.m. 22.2		
3 2:05–3 p.m. 22.2			1 2:05–3 p.m. 22.3		
After School			After School		

NOTES	MON	TUE
	27	28
	D 4	E 5
	B 11	C 12
	18	19
	Reading Day No Classes	MS/US Exams
	25	26
	Memorial Day Holiday, School Closed	Make-up Exams Post-planning for Faculty/Staff

WED	THU	FRI	SAT	SUN
29	30	C 1	2	3
		Grade 8 Class Trip		
F 6	G 7	A 8	9	10
		Middle School Madness		
D 13	E 14	F 15	16	17
		End Quarter 4		
20	21	22	23	24
MS/US Exams	MS/US Exams Grade 8 Recognition	MS/US Exams	Commencement Congratulations Class of 2026!	
27	28	29	30	31
Post-planning for Faculty/Staff	Post-planning for Faculty/Staff	Post-planning for Faculty/Staff		

WEEK OF MAY 4-8, 2026

Mon	D	4	Tue	E	5	Wed	F	6
Zero Hour 8-8:30 a.m.			Zero Hour 8-8:30 a.m.					
Advisory 8:30–8:40 a.m.			Advisory 8:30–8:40 a.m.					
2 8:45-9:40 a.m. 22.3			7 8:45-9:40 a.m. 22.3			Late Start Wednesday		
						5 8:55-9:50 a.m. 22.4		
3 9:45-10:40 a.m. 22.3			1 9:45-10:40 a.m. 22.4					
						6 9:55-10:50 a.m. 22.4		
Convocation — 10:40-11:10 a.m.			Activities — 10:40-11:10 a.m.					
						Break — 10:50-11:10 a.m.		
4 11:10 a.m.-12:05 p.m. 22.3			2 11:10 a.m.-12:05 p.m. 22.4			7 11:10 a.m.-12:05 p.m. 22.4		
12:05-12:25 p.m. — Grade 8 Lunch			12:05-12:25 p.m. — Grade 8 Lunch			12:05-12:25 p.m. — Grade 8 Lunch		
12:25-12:40 p.m. — Grade 6 Lunch			12:25-12:40 p.m. — Grade 6 Lunch			12:25-12:40 p.m. — Grade 6 Lunch		
12:40-1 p.m. — Grade 7 Lunch			12:40-1 p.m. — Grade 7 Lunch			12:40-1 p.m. — Grade 7 Lunch		
5 1:05–2 p.m. 22.3			3 1:05–2 p.m. 22.4			1 1:05–2 p.m. 22.5		
6 2:05–3 p.m. 22.3			4 2:05–3 p.m. 22.4			2 2:05–3 p.m. 22.5		
After School			After School			After School		

Middle School Madness						
Thu	G	7	Fri	A	8	Saturday
Zero Hour 8-8:30 a.m.			Zero Hour 8-8:30 a.m.			
3 8:30-9:25 a.m. 22.5			Advisory 8:30–8:40 a.m.			
			1 8:45-9:40 a.m. 23.1			
4 9:30-10:25 a.m. 22.5						
			2 9:45-10:40 a.m. 23.1			
						Sunday
Advisory – 10:25-11:05 a.m.						
			Activities – 10:40-11:10 a.m.			
5 11:10 a.m.-12:05 p.m. 22.5			3 11:10 a.m.-12:05 p.m. 23.1			
12:05-12:25 p.m. — Grade 8 Lunch			12:05-12:25 p.m. — Grade 8 Lunch			Notes
12:25-12:40 p.m. — Grade 6 Lunch			12:25-12:40 p.m. — Grade 6 Lunch			
12:40-1 p.m. — Grade 7 Lunch			12:40-1 p.m. — Grade 7 Lunch			
6 1:05–2 p.m. 22.5			4 1:05–2 p.m. 23.1			
7 2:05–3 p.m. 22.5			5 2:05–3 p.m. 23.1			
After School			After School			

WEEK OF MAY 11-15, 2026

Mon	B	11	Tue	C	12	Wed	D	13
Zero Hour 8-8:30 a.m.			Zero Hour 8-8:30 a.m.					
Advisory 8:30-8:40 a.m.			Advisory 8:30-8:40 a.m.					
6	8:45-9:40 a.m.	23.1	4	8:45-9:40 a.m.	23.2	Late Start Wednesday		
						2	8:55-9:50 a.m.	23.3
7	9:45-10:40 a.m.	23.1	5	9:45-10:40 a.m.	23.2			
						3	9:55-10:50 a.m.	23.3
Convocation - 10:40-11:10 a.m.			Activities — 10:40-11:10 a.m.					
						Break — 10:50-11:10 a.m.		
1	11:10 a.m.-12:05 p.m.	23.2	6	11:10 a.m.-12:05 p.m.	23.2	4	11:10 a.m.-12:05 p.m.	23.3
12:05-12:25 p.m. — Grade 8 Lunch			12:05-12:25 p.m. — Grade 8 Lunch			12:05-12:25 p.m. — Grade 8 Lunch		
12:25-12:40 p.m. — Grade 6 Lunch			12:25-12:40 p.m. — Grade 6 Lunch			12:25-12:40 p.m. — Grade 6 Lunch		
12:40-1 p.m. — Grade 7 Lunch			12:40-1 p.m. — Grade 7 Lunch			12:40-1 p.m. — Grade 7 Lunch		
2	1:05-2 p.m.	23.2	7	1:05-2 p.m.	23.2	5	1:05-2 p.m.	23.3
3	2:05-3 p.m.	23.2	1	2:05-3 p.m.	23.3	6	2:05-3 p.m.	23.3
After School			After School			After School		

End Quarter 4						
Thu	E	14	Fri	F	15	Saturday
Zero Hour 8-8:30 a.m.			Zero Hour 8-8:30 a.m.			
7 8:30-9:25 a.m. 23.3			Advisory 8:30-8:40 a.m.			
			5 8:45-9:40 a.m. 23.4			
1 9:30-10:25 a.m. 23.4						
			6 9:45-10:40 a.m. 23.4			
Advisory – 10:25-11:05 a.m.						Sunday
			Activities — 10:40-11:10 a.m.			
2 11:10 a.m.-12:05 p.m. 23.4			7 11:10 a.m.-12:05 p.m. 23.4			
12:05-12:25 p.m. — Grade 8 Lunch			12:05-12:25 p.m. — Grade 8 Lunch			Notes
12:25-12:40 p.m. — Grade 6 Lunch			12:25-12:40 p.m. — Grade 6 Lunch			
12:40-1 p.m. — Grade 7 Lunch			12:40-1 p.m. — Grade 7 Lunch			
3 1:05-2 p.m. 23.4			1 1:05-2 p.m. 23.5			
4 2:05-3 p.m. 23.4			2 2:05-3 p.m. 23.5			
After School			After School			

WEEK OF MAY 18-22, 2026

[illegible]

Grade 8 Recognition Day

Summer Break Begins after Final Exam

[illegible]

WEEK OF MAY 25-29, 2026

[illegible][illegible]

NOTES

This image shows a full page of white paper with horizontal grey ruling lines. The lines are evenly spaced and run across the width of the page, providing a template for handwriting practice or general writing. There are no margins, text, or other markings on the page.



MISSION STATEMENT

The Bolles School prepares students for college and life by inspiring excellence, courage, integrity and compassion in an academic community dedicated to nurturing mind, body and soul.

THE BOLLES WAY

Pursuing excellence through courage, integrity and compassion.

HONOR CODE

**I will maintain my self-respect and respect others.
I will not lie, cheat, steal or tolerate those who do.**

CORE VALUES

EXCELLENCE | COURAGE | INTEGRITY | COMPASSION

ATHLETIC MOTTO

HUMBLE IN VICTORY, GRACIOUS IN DEFEAT