



# TRAILBLAZER NEWS

October 2025

## MARCUS WHITMAN MIDDLE SCHOOL

### Impact Aid Federal Grant Program

#### Impact Aid Survey = Big Impact for Our Schools!

Starting October 1, all SK families will receive the annual Impact Aid Survey.

✓ If you're active-duty military or work on federal property, your response brings federal dollars into our schools.

✓ Even if you don't qualify, checking "NO" still counts!

🕒 It only takes a minute in Skyward or hard copies are also available

💡 Every form completed = more resources for SK students.

#### COMPLETING THE IMPACT AID SURVEY

##### COMPLETE THE DESKTOP VERSION OF THE IMPACT AID SURVEY

1. Login to Skyward Family Access at [Q.skschools.org](https://www.skschools.org).
  - If you need help with your Login ID or password, contact your student's school office.
2. On your home screen, select the **Impact Aid Program Survey** tile.
3. Click **Start** at the top of the screen to begin the survey.
4. Complete all **required** areas of the survey (marked with a red asterisk \*).
5. When finished, click **Complete & Review** at the top of the screen.
6. Review your answers and make any necessary changes. Once you've verified the information is correct, **check the box** at the bottom of the screen that says: *"I confirm that all of the above information is correct to the best of my ability."*
7. Click **Submit Form** at the top of the screen.

##### COMPLETE THE IMPACT AID SURVEY IN THE SKYWARD APP

1. Open the **Skyward Family Access App**.
  - Make sure your Skyward Family Access app is up to date. Update instructions can be found in the Resource Guide library via the Qmlativ link at the top of the SKSD home page ([www.skschools.org](https://www.skschools.org)).
2. Login with your Skyward Family Access Login ID and password.
  - If you don't know or have forgotten your Login ID or password, please contact your student's school's main office.
3. On the home screen, tap the **Impact Aid Program Survey** tile.
4. Tap **Start** at the top of the screen to begin the survey.
5. Complete all required areas of the survey (marked with a red asterisk \*).
6. When finished, tap **Complete** at the top of the screen.
7. Review your answers and make any necessary changes. Once you've verified the information is correct, check the box at the bottom of the screen that says: *"I confirm that all of the above information is correct to the best of my ability."*
8. Tap **Submit Form** at the top of the screen.

## MWMS Launches School-Wide Think Tanks to Support Students and Community

This fall, Marcus Whitman Middle School launched several school-wide Think Tanks, where teachers have volunteered their time to strengthen systems that support student learning, behavior, and engagement. These teams are part of our Multi-Tiered System of Supports (MTSS), a framework that uses data to improve student achievement and well-being through early intervention, research-based practices, and consistent monitoring.

### MTSS A & B Teams

- **MTSS A** focuses on academic systems, coordinating interventions for students who need additional support and designing enrichment opportunities for advanced learners. The team also develops protocols for staff professional development and data-driven instructional planning.
- **MTSS B** focuses on behavior, creating a schoolwide Positive Behavior and Intervention Support (PBIS) framework, monitoring behavior data, and developing recognition and support systems that promote a positive school culture and sense of belonging.

### Other Think Tanks

- **Family & Community Engagement** strengthens partnerships with families and the broader community through communication, events, and feedback to support student success.
- **Marketing & Rebranding** works to highlight academic growth, promote positive school culture, and strengthen community trust through a unified brand identity and visible celebrations of student and staff achievements.
- **Attendance** develops proactive strategies to encourage consistent, on-time attendance and ensure all students feel connected and expected at school.

Through these volunteer-led teams, MWMS is creating stronger systems, fostering equity, and building a culture where every student feels seen, supported, and valued. Parents, guardians, and students may also be invited to participate in Think Tank design to provide input and strengthen our community partnerships.

## Fall STAR Reading & Math Results

Our students take the **STAR Reading and Math benchmark assessments** three times each year—in the fall, winter, and spring. These assessments provide valuable information about where students are starting, how they are growing, and what supports they may need to be successful.

This fall, we had **strong participation rates**:

6th Grade: 95%                      7th Grade: 96%                      8th Grade: 95%

High participation matters because it gives us a more complete picture of student learning across the school. It also highlights the importance of regular attendance—when students are present, they can engage in learning, show what they know, and benefit from the support we provide.

Here is the percentage of students who scored **at or above grade-level benchmark** this fall. This means they demonstrated the skills and knowledge expected for their grade level at this point in the year:

- 6th Grade:** Reading 55%, Math 53%
- 7th Grade:** Reading 59%, Math 47%
- 8th Grade:** Reading 56%, Math 53%

For example, in 6th grade reading, 55% of students scored at or above the benchmark, showing they are on track for success in grade-level reading. The remaining students scored below the benchmark, which helps us identify who may need additional support to reach grade-level expectations.

These results give us a clear starting point for the year. We also know we have a lot of work to do—ultimately, we want **100% of students at or above benchmark**. Our focus will remain on supporting growth for every student and celebrating progress along the way.

If you have questions about your child’s scores or want to learn more about their progress in **Skyward**, please reach out to their teacher. Teachers are happy to share insights about student learning, suggest ways to support at home, and answer any questions you may have.

Thank you for partnering with us to support your child’s learning!



**2026 Annual Acknowledgement**

We want to thank those who have completed the annual forms on your student’s skyward account. We still don’t have 100% entry yet.

It is important to update information yearly, you may have changes in your emergency contacts, phone numbers or change of address that we would need to know.

Please take a few minutes to complete these forms. Thank you.



## Skyward Qmlativ Mobile App

Qmlativ uses the same mobile app that users downloaded for the previous version of Skyward. The app needs to be removed and then reinstalled in order to pull the most up-to-date version that runs Skyward Qmlativ.

1. If you already have the Skyward Mobile App **please delete the app from your phone**

*Press and hold the Skyward app icon and then select "Remove App" from the menu that appears*

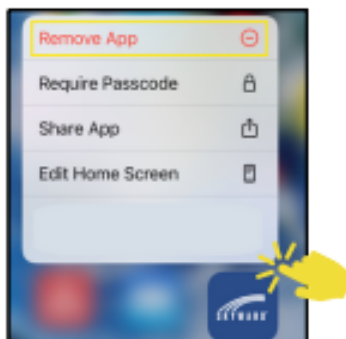

2. Visit your App Store and search for "Skyward Mobile Access", click the button to install

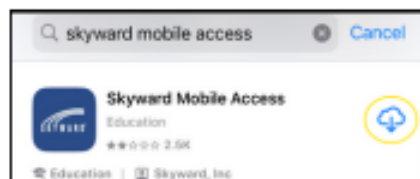

3. Once the Skyward Mobile App has finished installing, log in using the same credentials you've used to login in the past and follow the prompts to finalize adding your account (Parents who are also employees will use their network username/password to log in)
4. Do you need help with your username/password? Call your school's office for a reset
5. These brief videos demonstrate the process of installing the app and highlight some cool features:

📺 [Mobile App - \\*Family Access](#) \*Some features shown may not be available for your students/school

📺 [Mobile App - Employee Access](#)

**SOUTH KITSAP**  
SCHOOL DISTRICT

Information Technology Services • 2689 Hoover Ave, Port Orchard, WA 98366 • (360) 874-7047 • <https://www.skschools.org>



**Girls  
Soccer  
Camp**

---

**October 22<sup>nd</sup> &  
23<sup>rd</sup> 3PM-5PM**

**Drills &  
Games!**

---



# **Marcus Whitman Girls Soccer**

**Check us out!**

**Interested girls' soccer  
athletes, please join us  
for an exciting few days  
of soccer camp @ MW!**

**Skill development!  
Ball control!  
Passing, dribbling  
& fun!**

**Attention military families!** We are starting to build our Veteran's Day slideshow and we are looking for submissions from you. If you have a family member who has served or is serving we would like to recognize them with a slide in our slideshow. To get your family member recognized please send the information to Mrs. Bates at [batesb@skschools.org](mailto:batesb@skschools.org). The due date is Sunday, October 19<sup>th</sup>. Please include the following in your request:

Name of service member

Branch of service

Student name(s) that are connected to at Marcus Whitman Picture(s) of the service member



Students – if you are planning to attend the SKHS home football games here is some important information:

1. All middle school students must be accompanied by a parent – your parent must pay and come in and stay at the game with you.
2. All students who enter must have a student ID to get in – no ID no entry (with or without ASB)
3. No bags/backpacks will be allowed in and there will be nowhere to store these items.

There will be no re-entry back into the game – if you leave, you may not come back in



## 7TH HOUR

Calling all MW Students!

Do you need a quiet place to study, complete homework, and/or get help with an assignment?

Come to 7th Hour every Tuesday and Thursday from 2:50-4pm in the library.

No transportation provided.  
Pack a snack to enjoy while you work.





**Marcus GSA Club:** The Marcus GSA Club is a group where students can connect, share their experiences, support one another, and be great allies for members of the Marcus LGBTQ+ community. Whether you are an LGBTQ+ student, a friend, or member of a queer family, you will find a welcoming home here. GSA meets every Thursday after school until 3:50. A permission slip signed by student and parent must be submitted before participation. You can get a permission slip from the Main Office.

**Weight Lifting Club** will be meeting Tuesday and Thursday in the Weight Room. Time is from 2:50 pm to 3:50. This club is for students interested in learning how to lift weights for personal fitness or maybe getting ready for a sport. Permission slips are at the main office. Advisors Mr. Zappey and Mr. Dan

**Unified Club!** Get ready for another year of fun events, engaging activities, and inspiring inclusion school community **Unified Club**. We will meet in room #203 Mrs. Schroeder's room, from 2:45PM-3:45PM. First day will be Wednesday, Sept 24<sup>th</sup>. This club is a space for students of all backgrounds to come together and feel like they have a voice and belonging, We offer unified robotics competitions (2<sup>nd</sup> year) and sport activities. Please fill out an application and turn it into ASB. See you there!

**STEM Club**—TSA is the perfect club for middle school students who love to explore, build, and compete! In TSA, you learn hands-on skills in areas like robotics, engineering, and design, while also developing teamwork and leadership abilities. TSA meets Thursday in Room 112 (Woodshop) from 2:45—3:45. Permission slips are at the main office.

**POKEMON Club** - If you love Pokemon, this is the club for you. We talk Pokemon, trade Pokemon and catch them all. Meet Wednesdays from 2:50—3:50. Be sure you have submitted your permission slip before you attend.

**DRAMA TEAM** - Drama Team meets Thursday from 2:45 – 3:45 in the theater. Be sure you have your permission slip turned in. Everyone is welcome!

**Culinary Clubs** meets Thursday in Room 101 from 2:50 – 4pm.

## **Varsity Baseball Game Schedule**

**All games start at 3:30 pm**

<b>DATE</b>	<b>OPPONENT</b>	<b>PLACE</b>
Tue 10-7	Hawkins	SKHS
Thurs 10-9	Mt. View	Mt. View
Tue 10-14	Curtis	Curtis
Thurs 10-16	Sedgwick	Marcus
Tue 10-21	Cedar	SKHS



## **Varsity Fastpitch Game Schedule**

**All games start at 3:30 pm**

<b>Date</b>	<b>Opponent</b>	<b>Place</b>
Mon 10-6	Curtis	Curtis
Wed 10-15	Ridgetop	Marcus
Mon 10-20	Mt. View	Mt. View
Wed 10-22	Klahowya	Marcus



## **Track Meet Schedule**

**All games start at 3:30**

<b>DATE</b>	<b>OPPONENT</b>	<b>PLACE</b>
Wed 10-8	Ridgetop	Marcus
Wed 10-15	Poulsbo	Marcus
Mon 10-17	Futurist Meet	SKHS
Thurs 10-21	Championship	Bremerton High School

# WINTER 1 SPORTS

## BOYS BASKETBALL

Tryouts will start Monday, Nov. 3rd. Be sure you have register on Final Forms and have a current sports physical. Games start Nov 17 and end Dec 17. Any questions you can contact Coach Mackie.

## GIRLS SOCCER

Soccer will be starting Monday Nov 3rd. Be sure you have register on Final forms and have a current sports physical. Games start Nov 17 and end Dec 17. All paperwork must be completed before the first day of practice.

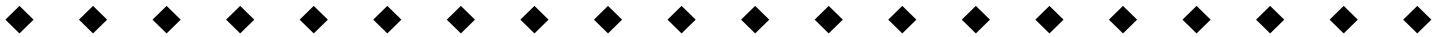

### Non-Discrimination Statement

The South Kitsap School District provides equal educational and employment opportunity without regard to race, creed, religion, color, national origin, age, honorably-discharged veteran or military status, sex, sexual orientation – including gender expression or identity, marital status, or the presence of any sensory, mental, or physical disability, the use of a trained dog guide or service animal by a person with a disability. Equal access to activities, facilities and program is provided to the Boy Scouts of America and other designated youth groups. District procedure complies with all applicable state and federal laws.

The Title IX Officer, Section 504 Coordinator, and Gender Inclusivity Officer with the responsibility for monitoring, auditing and ensuring compliance with this policy are:

Compliance/ADA/Title IX Coordinator:

Will Sarett,

Executive Director of Human Resources

2689 Hoover Avenue SE, Port Orchard, WA 98366

360-874-7071

[sarett@skschools.org](mailto:sarett@skschools.org)

Section 504 Coordinator:

Cristin Blaskowitz,

Director of Special Services

2689 Hoover Avenue SE, Port Orchard, WA 98366

360-443-3627

[blaskowitz@skschools.org](mailto:blaskowitz@skschools.org)

Gender Inclusivity Compliance Officer:

Monica Zuber,

Assistant Superintendent for School Leadership

2689 Hoover Ave SE, Port Orchard, WA 98366

360-874-7003

[zuber@skschools.org](mailto:zuber@skschools.org)

