

Sumner County Schools Conventional Special Education School Bus Specifications				
	Quantity: 3			
Notes to Bidder:				
	1. Bidder must have a fully licensed in-state sales and service facility. State Dealer License # is _____			
	2. Salesman's dealer license # is _____			
	3. You must return a copy of these specs with your bid response noting all exceptions and deviations.			
	4. Factory direct deliveries are not acceptable, product must have a pre-delivery inspection at in-state facility.			
	5. Please state earliest delivery date:			
Equipment	Description	YES	NO	List Exception
Bus Type	Conventional w/ Lift			
TN Specifications	Must meet all state and federal school bus requirements			
Engine location	Front			
Year Model	New model 2026 or newer			
Seating Capacity	30 + 4 wheel Chairs with continous track- see attached floor plan tie downs and Safeguard Safety Seats - See Attached Floor Plan			
Delivery	1500 Airport Rd, Gallatin, TN 37066			
Manuals	Include owners manual			
Service Training	Provide a minimum of 12 hours product service training at no charge for body and chassis components @ SCS			
Warranty-Body	Please Specify Warranty			
CHASSIS	CHASSIS			
Axle Ratio	5.29 or greater			
Air Compressor	18.7 CFM, minimum			
Air dryer	Merator Wabco SS 1200 - parts # 5400850-7010 or Bendix AD-9 w/ heater			
Air tanks	3,790 or greater cubic inch capacity, Bendix DV-2 with Heater			
Alternator	275 or greater amp, Delco or Leece Neville equivalent			
Axle , front	12,000 lbs. minimum with oil bath with synthetic lube			
Axle, rear	23,000 minimum lbs. with synthetic lube			
Batteries	3- 1950 cca 31 Series			
Battery Emgcy Disconnect	Factory Installed in Battery Department			
Block Heater	750 watt with bumper mounted recepticle			
Brakes	Outboard drum type w/ auto slack adjusters			
Brakes	ABS with diagnostic light in dash			
Brakes, front	16.5" x 6" minimum			
Brakes, rear	16.5" x 8 5/8" minimum			
Bumper 3/16" steel, front	12" with crossing control arm and stowage bracket			
Bumper 3/16" steel, rear	Concave design			
Cooling system	Radiator to have at least 620 square inches			
Driveline	Guards around each shaft			
Engine Rating	220 HP. Minimum			
Engine Type	Inline 6 cylinder diesel, Cummins ISB, no exceptions			
Exhaust	Below rear bumper or left side bumper with exhaust mitigator			
Frame	50,000 lbs. psi with rear mounted tow hooks			
Fuel filter	Fuel Water Separartor/ Cartridge type at the engine			
Fuel / Water separator	Davco 382-C with heater or Fleetgurad			
Fuel Tank	60 gal. between frame rails, fuel door with thumb latch			
Fuel Tank	Include fuel fill door & sender access plate at interior floor			

Sumner County Schools Conventional Special Education School Bus Specifications				
	Quantity: 3			
High/low Idle Throttle	Electronic			
Instruments	Speedometer, Voltmeter, Oil pressure, Dual air gauges			
Instruments	Transmission temperature gauge, fast idle switch			
Instruments	Air filter restriction indicator, cruise control			
Wheel Chair Lift	Braun Lift, Millennium 2, 800 lb or greater capacity			
Lift Location	Rear			
Lift Specifications	Automatic Positioning at Floor Level with single door			
Shocks	Front and Rear			
Springs, front	3 leaf parabolic front springs comenserate with GVWR			
Suspension	Comfort trac 52" rear springs with 21,000 lbs. rating			
Starting aid	Grid heater			
Steering wheel	Tilt and telescopic steering column			
Tires	Seven (7) 11R22.5 16 ply, Michelin, mounted spare			
Tow hooks	Front and rear mounted			
Transmission	Allison 2500 Seriesn or greater 5 speed, transynd fluid & fuel sense			
Wheel Base	252" or greater (list exact wheelbase)			
Wheels	Disc hub piloted, 22.5 X 8.25 powder coated black			
Wiring	Color & number coded-full multiplex body and chassis			
Warranty-Engine/Trans	5 year engine and transmission warranties or better			
BODY	BODY			
Air Conditioning System	Min. 16,000 BTU. Must be able to keep bus cool w/ copy of complete list of A/C parts			
Body Mounts	Meet state and federal specifications			
Child Reminder	Passenger advisory system (not in side panel)			
Crossarm	Electric Operated polycarbonate			
Defroster fans	Dual 6" dash mounted fans			
Door, emergency	upper & lower tinted glass			
Door, entrance	Three position air outward opening with vandaloock			
Directional Front	LED Lights in Turn signals; integrated into headlights if applicable			
Driver Arm Rests	Dual folding			
Emergency exits	4 - push out windows w/ buzzers			
Emergency exits	2 - roof hatches, to be Specialty Pro Lo 9000 or Spheros equivalent			
Flooring	BLUE (TAN if BLUE not available) floor covering and Koroseal pebble entrance steps			
Flooring	1/2" or greater plywood with metal aisle trim			
Flooring	Rubber over wheelhousings			
Header Storage	Safety Compartment in front header			
Headroom	77 inches, minimum			
Headlining	Acoustic headlining full length of bus			
Heaters	190,000 BTU front & rear combination w/ removable filter driver heater under seat			
Heaters	Booster pump and stepwell heater 30,000 BTU's min.			
Heaters	Heater cut off valve(s)			
Identification	6" Black letters, both sides/6" numbers-four sides			
Identification	3/4" x 3" yellow right side rear bumper showing year model			
Insulation	Insulation in roof, front, rear, and side walls. R value = 5.7			
Insulation	1/2" sound absorbing foam installed under driver toeboard			
Lights	LED Dome lights to have dual rows with driver dome light			
Lights	LED headlights with daytime runing light feature			

Sumner County Schools Conventional Special Education School Bus Specifications				
	Quantity: 3			
Lights	Warning lights to be LED with sun visor			
Lights	Stepwell, entrance, marker, stop, tail, turn, front and rear side directional, rear side flood reverse by back tires, reverse, side lights to be LED			
Lights	Headlights (wig-wag) when red lights are activated			
Mirrors	Interior - 10" X 30" non-glare with visor, heated crossview			
Mirrors	Roscoe accustyle - remote & heated with 15 minute timer			
Mud Flaps	Front and Rear			
Paint	Yellow body with white roof, black rub rails and black or yellow pilasters			
Parts Report	Copy of complete Bus Parts printout "on-line" no charge			
Reflective Tape	SCHOOL BUS front and rear caps to be reflective			
Reflective Tape	Side pushout windows and 2" rear of bus, 2" sides			
Reflectors	To be mechanically attached			
Roof Bows	One piece			
Rub rails	Provide four rubrails, painted black			
Radio	AM/FM/CD or MP3/Page/ 6 int. speakers, 1 exterior speaker			
Radio Speakers	8 Coaxial Speakers TBB-152991 or equivalent			
Safety	Fire Ext, Body Fluid kit, Flares, First Aid Kit, Seat Belt Cutter			
Safety Compartment	*FE, FAK, BFK to be mounted on wall and floor beside entrance door*			
Seat Frames	Frames to be powder coated, black			
Seat Space	24" minimum knee space, include seat plan drawing			
Seat Barriers	Blue fire block, kick panel-right side, storage pouch-left side			
Seats / Driver	Air ride, pedistal cover, 2 shocks, fabric insert, driver's seat pouch attached to seatback			
Seats / Driver	Lap/shoulder belt (orange) with warning indicator, adjustable back			
Seats / Passenger	Seats 5 - 39" Tract MTD and 10 - 30" 6 Tract MTD (see attached floor plan)			
Seats and Belts	Safeguard Safety Seats W/ 3 Point Seat Belts (FE200868-4) and Child Restraint			
Seats and Belts	Seating capacity should consist of 30 ambulatory, 4 w/c, 4 continuous tracks in space in middle of bus including tie down systems and occupant restraints			
Seats and Belts	All seats to have 2 lap/shoulder belts per seat (30 total)			
Seats and Belts	Seating should include 20 integrated seats			
Seat Upholstry	Blue			
Securement Systems	Sure-Lok retractable Type FE200855S (4 Sets) w/ storage pouches FF612-4C			
Side Panels	Interior - Aluminized steel side walls			
Solenoid	Disconnect all body circuits, 100 amp minimum			
Strobe	Roof mounted Specialty 515-400 with guard or equal, "wired to key"			
Stop arm	First Light Safety Products Fully Illuminated Stop Arm, Electric Drive Operated			
Storage	Clipboard Holder, metal or plastic type, see Director for specific mounting location			
System Floor Track	Wheelchair Track 4 rows continuous in floor on driver side of bus from rear wheel well to back of bus - See attached floor plan			
Track	1 continuous w/c track over windows on driver side that coincides with floor track			
System Floor Track	Recessed in Plywood			
Vents	2 - driver's fresh air & static roof vent			
Windows, Passenger	Black frames with 12" openings, tinted glass			
Windows Driver	Double sliding, aluminum sash, tempered			
Windshield	tinted, bonded in place			
Windshield	2 grip handles beside windshield and cowl steps			
Wipers	Intermittent feature on turn signal lever			
Wiring	Color & number coded			
Customer Fuse block	Allows electrical access without using multiplex wiring			
Backing Alarm	112 db required			

	Sumner County Schools Conventional Special Education School Bus Specifications			
	Quantity: 3			
Document Holder	To meet State specs			
Switch	Noise suppression switch to be provided			
Lettering	Sumner County Schools #'s supplied to successful bidder			
Grille	Chrome grille, hood intake plenum, and headlight bezels			
Camera system	AngelTrax 12 Cameras - Please see attachment - Rep. Laci Hatley for quotes - Director for proper installation locations			
Camera system	Prior to installation, Transportation Director or designee will visit dealer to mark location of installation			
Camera GPS antenna	Please see attachment			
Fenders	Rubber or metal fenders around rear wheel opening			
GPS UNITS	To be installed at Sumner County Bus Garage by Davis Electronics 615-666-2450			
GPS UNITS	The selling bus dealer will be responsible for all labor costs to install customer owned GPS units on new buses			
GPS UNITS	GPS to be supplied by Sumner County Schools			
Trash Can	Trash Can mounted - see Transportation Director for specifics			
Keys	All units to have common key			
Battery Box	Shall be frame mounted with battery cut off switch in box			
Lights	All lights to be LED type			
Seat Numbers	Seats to be numbered , see Transportation Director for location of numbers			
Radio-two way model	Kenwood NX-5800K-SCPKG-25 Phase I and Phase II and all accessories Contact @ 615-889-4756 for installation and price			

SEATING CAPACITY: 30 + 4 WC + DRIVER

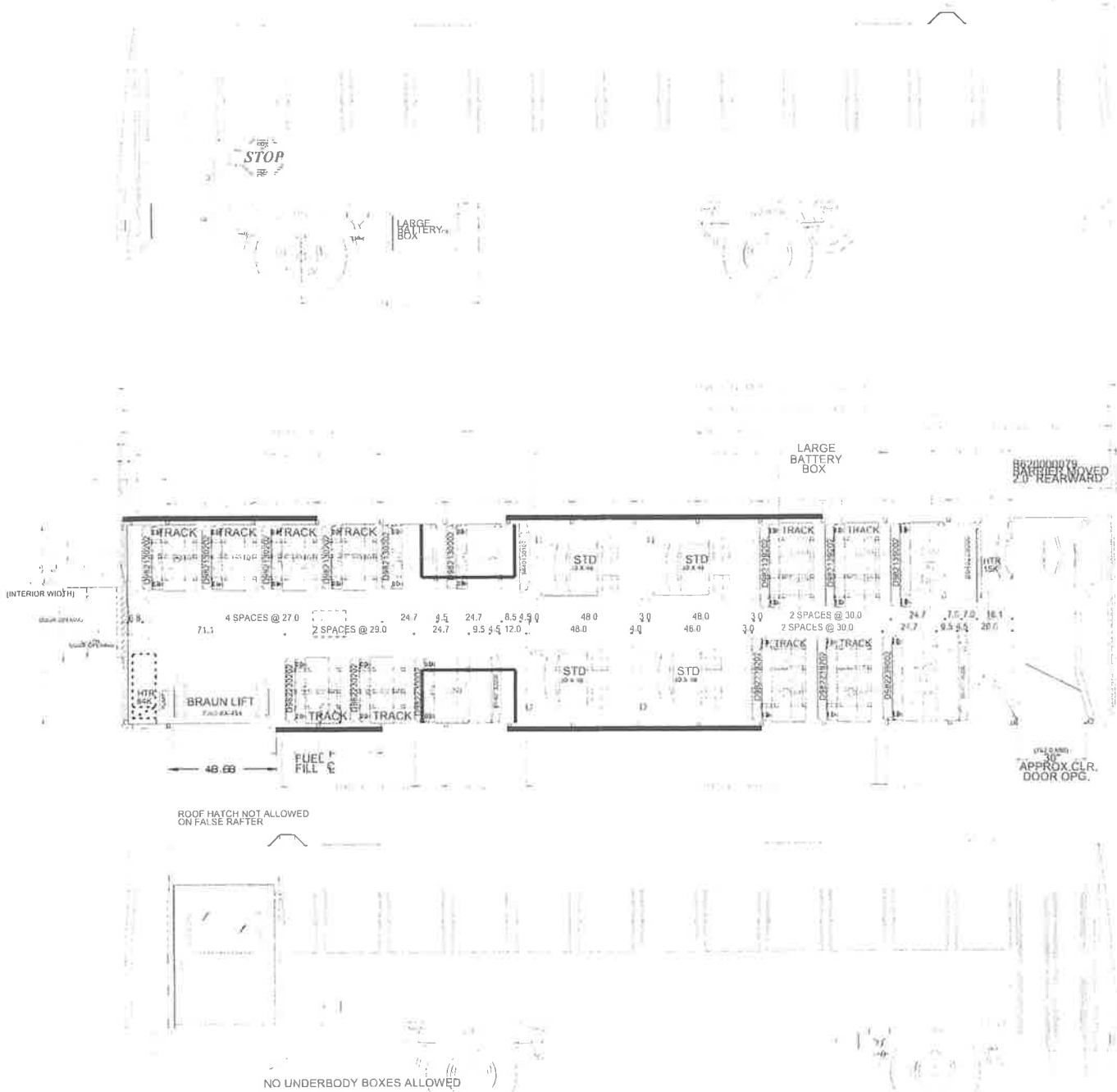

CAUTION! - LEFT SIDE BARRIER IS NOT IN STANDARD LOCATION, SEE SEATING PLAN.
 CAUTION! - RIGHT SIDE BARRIER IS NOT IN STANDARD LOCATION, SEE SEATING PLAN.

MAXIMUM HEIGHT (SEE NOTE 6)
 NOMINAL HEIGHT (SEE NOTE 5)

NOTES:
 UNIT EQUIPPED WITH OVERHEAD TRACK REINFORCEMENT
 UNIT EQUIPPED WITH PLYWOOD FLOOR
 EFX UNIT

ALL DIMENSIONS ARE FOR REFERENCE ONLY

GENERAL NOTES

1. SEAT TRACKS, SUCH AS CY BARRIERS, ROOF LUGGAGE RACKS AND OTHER ITEMS ARE SHOWN IN ONE VIEW ONLY FOR CLARITY.
2. THIS DRAWING IS A REPRESENTATION ONLY AND MAY NOT HAVE ALL ITEMS RECORDED. PLEASE REFER TO ORDER.
3. THE CLEARANCE BETWEEN BOTTOM OF BUS OR BODY FROM TOP OF UNDERBODY COMPONENTS AND DRIVING WELL SHALL ACCORDING TO THE SIZE, BUS LOADS AND SUSPENSION TYPE.
4. THE MINIMUM WIDTH AT BOLT LINE OVER GUARD RAILS IS 20".
5. THE MINIMUM BUS HEIGHT IS BASED ON A STANDARD BODY AND LARGEST SIZE TRF.
6. THE MINIMUM BUS HEIGHT IS BASED ON BODY WITH OPTIONS SUCH AS AC UNITS, STROBE LIGHT, LARGE ST SUSPENSION, ETC.
7. OVER BUSHING OVERHEADS DO NOT TAKE INTO ACCOUNT OPTIONS THAT MAY ADD TO THE OVER LENGTH OF THE BUS, SUCH AS MIRRORS, LIGHTS AND CROSSBARS/RAILS.

Model: MVP-EF
 Quote Number: 384491
 Locality: TN

SIDE	NO.	SPACING	INCHES
LEFT	1.0	30.0	28.7
LEFT	2.0	27.0	25.7
RIGHT	1.0	30.0	28.7
RIGHT	2.0	28.0	27.7

TITLE: PLAN AND ELEVATION BODY 1318S
 DRW: 02-03-07 RY E. Dym | SIZ: DWG. NO. 854075
 SCALE: 3/8"=12" S

NO UNDERBODY BOXES ALLOWED

AngelTrax VULCANV12 Mobile Digital Video Recording System

12 CAMERA SYSTEM FOR NEW SUMNER SCHOOL BUS SPEC

(System Contents and Product Descriptions Listed Below)

VULCANV12 1

Vulcan Series 12-Channel HD/IP Mobile Digital Video Recorder

- 12 Channels with 8 Channels D1, WD1, 720P, or up to 1080P + 4 Channels IP up to 1080P
- 1TB Platter Hard Drive
- 64GB SD Card for Redundant Recording
- Built-in Wi-Fi Module
- Built-in G-Force Sensor
- Vandal-Resistant Locking Front Cover
- Panic Button
- H.264 Compression

SD64GB 1

64GB SD Solid-State Memory Card

We recommend the use of storage media provided only by AngelTrax for our recording devices. AngelTrax hard drives and SD cards are optimized for around-the-clock video surveillance and are designed to withstand extreme temperatures. Standard hard drives and SD cards purchased through consumer resellers are not made for surveillance devices and have been known to stop functioning at any time without warning, causing a loss of video.

VULPBH 1

Vulcan Series Panic Button Housing

PC color

DMB100-V12 1

L-Shaped Vertical Mounting Bracket for Vulcan V12 MDVR

HD1700V 8

(8) Vulcan Series 170-Degree HD 1080P Low Profile Camera - driver, mid, mid, mid, mid, rear, front bulkhead, rear bulkhead

- 1.7mm Lens with Fully Articulating Lens Casing, Adjustable Vertically and Horizontally at Installation
- IP68 Rated Waterproof Interior/Exterior Camera
- 1080P HD
- 2.12 Megapixels
- Noise-Gated Microphone
- Vandal-Resistant Casing
- Scratch-Resistant, Anti-Glare Glass Lens Cover

- Infrared

HD3600V 2

(2) Vulcan Series 3600 HD Low Profile Camera - windshield w/ bracket and overview of stop arm cams

- 3.6mm Lens with Fully Articulating Lens Casing, Adjustable Vertically and Horizontally at Installation
- IP68 Rated Waterproof Interior/Exterior Camera
- 1080P HD
- 3 Megapixels
- Noise-Gated Microphone
- Vandal-Resistant Casing
- Scratch-Resistant, Anti-Glare Glass Lens Cover
- Infrared
- For use in school bus SAV applications as overview camera when equipped with YELHS1 yellow housing

HDLP5MP-L 1

Vulcan Series HD 5MP SAV Camera for Driver's Side Facing Front of Bus

- 16mm Lens
- IP68 Rated Waterproof Exterior Camera
- 1080P HD
- 5 Megapixels
- Super Infrared
- Anti-Vibration, Vandal-Resistant Casing
- Scratch-Resistant, Anti-Glare Polarized Glass Lens Cover
- Designed to Capture License Plates as Vehicles Pass By
- Mounted on the Driver's Side Exterior and Faces the Front of the Bus

HDLP5MP-R 1

Vulcan Series HD 5MP SAV Camera for Driver's Side Facing Rear of Bus

- 16mm Lens
- IP68 Rated Waterproof Exterior Camera
- 1080P HD
- 5 Megapixels
- Super Infrared
- Anti-Vibration, Vandal-Resistant Casing
- Scratch-Resistant, Anti-Glare Polarized Glass Lens Cover
- Designed to Capture License Plates as Vehicles Pass By
- Mounted on the Driver's Side Exterior and Faces the Rear of the Bus

HD4CBL

13.12 ft. HD Camera Cable

HD9CBL

29.53 ft. HD Camera Cable

HD12CBL

39.37 ft. HD Camera Cable

HD18CBL

59.06 ft. HD Camera Cable

ADJBR100 1

Adjustable Mounting Bracket for Vulcan Series HD-V Camera Capturing Windshield View

IBR650LP4 1

3G/4G Cellular Modem

-Built-in air card

-Provides connectivity through cellular towers and mobile networks

-External module attached via RJ45 cable to the RJ45 port

-INCLUDES POWL058 POWER CABLE

-INCLUDES CAT5CABLE

-INCLUDES SIMCARD

WC4G 1

Vulcan Series Wi-Fi Cellular GPS Tri-Mode Antenna

- Wi-Fi, Cellular and Passive GPS Antenna

- Interior-mounted

V12SECKEY 5

Security Key USB 3.0 for Vulcan V12 MDVR