

JUNE 2025

REVIEW AND COMMENT SUBMITTAL

Submitted to the Minnesota Department of Education



HOPKINS
PUBLIC SCHOOLS

Dr. Rhoda Mhiripiri-Reed, Superintendent
Hopkins Public School District #270
Submission: June, 2025

Review and Comment Checklist

Proposal	4
Key Contact Information	4
MS 123B.71: Review and Comment Checklist	5
1. Geographic Area and Population to be Served.....	5
<i>PK-12 Enrollment – Historical and Projected</i>	5
<i>Population to be Served</i>	6
<i>Geographic Area to be Served</i>	7
2. Existing Facilities and Their Utilization.....	8
<i>Year Constructed and Square Footage</i>	8
<i>Building Uses</i>	8
<i>Available Alternative Facilities</i>	8
3. Deficiencies of the School District’s Facilities	9
<i>Building Asset Conditions</i>	9
<i>Playgrounds, Athletic Facilities, and Parking Lot Evaluations</i>	16
<i>Safety and Security Findings</i>	19
<i>District and Community Engagement</i>	20
<i>Community Engagement</i>	20
<i>Community Survey</i>	22
<i>Staff, Administration, Community and Student Ideation</i>	23
<i>Pathfinder Projects Process</i>	24
<i>Benefits to Students, Teachers, and Community Users</i>	26
<i>Deficiencies Not Addressed by the Proposed Projects</i>	27
<i>Summary</i>	27
<i>Capital Project Levy Narrative</i>	28
4. Description of Proposed Project	29
<i>Katherine Curren Elementary</i>	29
<i>Hopkins East</i>	30
<i>Harley Hopkins Early Childhood</i>	30
<i>Alice Smith Elementary</i>	31
<i>Eisenhower Elementary</i>	32
<i>Gateway Elementary</i>	33
<i>Glen Lake Elementary</i>	34
<i>Meadowbrook Elementary</i>	35
<i>L.H. Tanglen Elementary</i>	37
<i>Hopkins North Middle School</i>	38
<i>Hopkins West Middle School</i>	41
<i>Hopkins High School</i>	44
<i>Bus Depot</i>	48
<i>Project Budget</i>	48
<i>Capital Project Levy Question:</i>	67
<i>Operating Costs</i>	68
<i>Construction Schedule</i>	68
5. Project Plans for Gender-Neutral Spaces & Privacy Features	69
6. Funding Source(s)	70
<i>Section 6 Submittal Content</i>	70
7. Certification of Architects and Engineers	75
<i>Sustainability</i>	75
<i>Sound Attenuation</i>	76
<i>State Fire Code</i>	76
<i>Chapter 326B – Governing Building Codes</i>	76
<i>Provision of Infrastructure to Serve School</i>	76

Ballot Language77

Appendix78

Appendix Index..... 79

Proposal

Hopkins Public School District, ISD #270, proposes to obtain financing from the sale of General Obligation Bonds. The School District will seek voter approval of one ballot question on November 4, 2025. In a separate question, the District will also be asking the community to renew their Capital Project Levy.

The Administration and School Board agree that this proposal, from a financial, programing, and facility standpoint, is in the best interest of the District, the Community, and current and future learners attending ISD # 270.

Key Contact Information

Address	Dr. Rhoda Mhiripiri-Reed, Superintendent of Schools Hopkins Public School District, ISD # 270 1001 Highway 7, Hopkins, MN 55305 Phone: 952-988-4000 Email: Rhoda.M-Reed@hopkinsschools.org
Engineer/Architect	Roxanne Cortinas, Vice President of Development and Design SitelogIQ, Inc. 7900 West 78 th Street, Suite 300 Edina, MN 55439 Phone: 630-957-7127
Municipal Advisor	Shelby McQuay, Senior Municipal Advisor, Managing Director Ehlers 3060 Centre Pointe Dr. Roseville, MN 55113 Phone: 651-697-8548 Email: smcquay@ehlers-inc.com

MS 123B.71: Review and Comment Checklist

1. Geographic Area and Population to be Served

The geographic area and population to be served, pre-kindergarten through grade 12 student enrollments for the past five years, and student enrollment projections for the next five years.

PK-12 Enrollment – Historical and Projected

Current Enrollment:

Grade	2015-2016	2016-2017	2017-2018	2018-2019	2019-2020	2020-2021	2021-2022	2022-2023	2023-2024	2024-2025
K	584	518	540	533	590	560	633	584	620	550
1	556	576	512	523	550	599	591	630	584	609
2	595	533	542	514	518	543	585	575	619	552
3	539	568	523	533	524	512	532	558	557	584
4	518	521	550	518	513	510	505	498	560	530
5	529	490	510	541	509	502	499	494	508	535
6	532	515	489	506	536	499	491	483	507	519
7	597	552	570	532	553	598	549	519	497	497
8	535	580	564	563	540	542	592	515	510	482
9	623	520	567	563	564	528	569	552	565	529
10	585	620	523	565	587	560	545	535	557	541
11	541	572	594	515	555	568	580	519	516	534
12	615	578	596	647	562	573	630	561	517	529
Elem. Totals	3,853	3,721	3,666	3,668	3,740	3,725	3,836	3,822	3,448	3,360
Middle Totals	1,755	1,652	1,701	1,658	1,657	1,668	1,710	1,586	1,514	1,498
High Total	1,741	1,770	1,713	1,727	1,704	1,701	1,755	1,615	2,155	2,133
Total K - 12	7,349	7,143	7,080	7,053	7,101	7,094	7,301	7,023	7,117	6,991

Old Grade Configuration

Current Year

Projected Enrollment:

Grade	2025-2026	2026-2027	2027-2028	2028-2029	2029-2030	2030-2031	2031-2032	2032-2033	2033-2034	2034-2035
K	562	568	571	550	563	560	561	560	560	559
1	557	569	576	578	556	570	567	568	567	568
2	599	544	557	564	565	542	557	554	554	554
3	530	578	522	535	542	542	520	535	532	532
4	568	516	564	508	522	528	528	506	520	517
5	526	563	513	562	506	520	525	526	502	518
6	552	539	580	530	579	524	537	542	544	522
7	509	541	529	568	519	568	514	527	532	534
8	482	494	525	513	552	504	551	499	511	516
9	495	495	507	539	527	567	517	566	512	525
10	507	474	474	486	516	504	543	495	542	491
11	529	495	463	463	475	505	493	531	484	530
12	544	538	506	476	475	486	515	504	539	495
Elem. Totals	3,341	3,337	3,303	3,297	3,254	3,262	3,257	3,248	3,237	3,248
Middle Totals	1,543	1,574	1,634	1,611	1,650	1,596	1,602	1,568	1,587	1,572
High Total	2,074	2,002	1,951	1,964	1,993	2,062	2,068	2,095	2,078	2,040
Total K - 12	6,958	6,913	6,888	6,872	6,897	6,920	6,927	6,911	6,901	6,860

Source- Provided by: TeamWorks4Ed

Population to be Served

Area Population Projections¹

TABLE 2: POPULATION & AGE DEMOGRAPHICS BY DISTRICT BOUNDARY

Age Range	2010		2024		2029		2024-2029 % Change
	Number	Percent	Number	Percent	Number	Percent	
0 - 4	3,334	5.4%	3,500	5.1%	3,571	5.0%	2.0%
5 - 9	3,255	5.2%	3,351	4.9%	3,406	4.7%	1.6%
10 - 14	3,367	5.4%	3,082	4.5%	3,533	4.9%	14.6%
15 - 19	3,209	5.2%	2,947	4.3%	3,284	4.6%	11.4%
20 - 24	3,451	5.6%	3,667	5.4%	3,732	5.2%	1.8%
25 - 34	9,980	16.1%	12,190	17.9%	10,669	14.8%	-12.5%
35 - 44	7,238	11.7%	9,364	13.8%	11,122	15.5%	18.8%
45 - 54	9,459	15.3%	7,118	10.5%	8,129	11.3%	14.2%
55 - 64	8,645	13.9%	8,200	12.0%	7,642	10.6%	-6.8%
65 - 74	4,625	7.5%	8,003	11.8%	8,577	11.9%	7.2%
75 - 84	3,490	5.6%	4,557	6.7%	5,832	8.1%	28.0%
85+	1,951	3.1%	2,099	3.1%	2,489	3.5%	18.6%
Median Age	41.3		40.4		41.7		3.2%
Totals	62,004	100.0%	68,078	100.0%	71,986	100.0%	5.7%

5-Year Age Increments
10-Year Age Increments

TABLE 3: POPULATION & GENERATIONAL AGE DEMOGRAPHICS BY DISTRICT BONDARY

Generation Name	2024		2029		2024-2029 % Change
	Number	Percent	Number	Percent	
Generation Alpha (Ages 0 - 6)	5,562	8.2%	9,094	12.6%	63.5%
Generation Z (Ages 7 - 24)	12,097	17.8%	14,570	20.2%	20.4%
Millennials (Ages 25 - 42)	19,631	28.8%	19,208	26.7%	-2.2%
Generation X (Ages 43 - 58)	11,787	17.3%	12,215	17.0%	3.6%
Baby Boomers (Ages 59 - 77)	14,579	21.4%	13,934	19.4%	-4.4%
Silent & Greatest Generation (Ages 78+)	4,422	6.5%	2,965	4.1%	-32.9%
Totals	68,078	100.0%	71,986	100.0%	5.7%

County-Wide Population Projections – School Age Children²

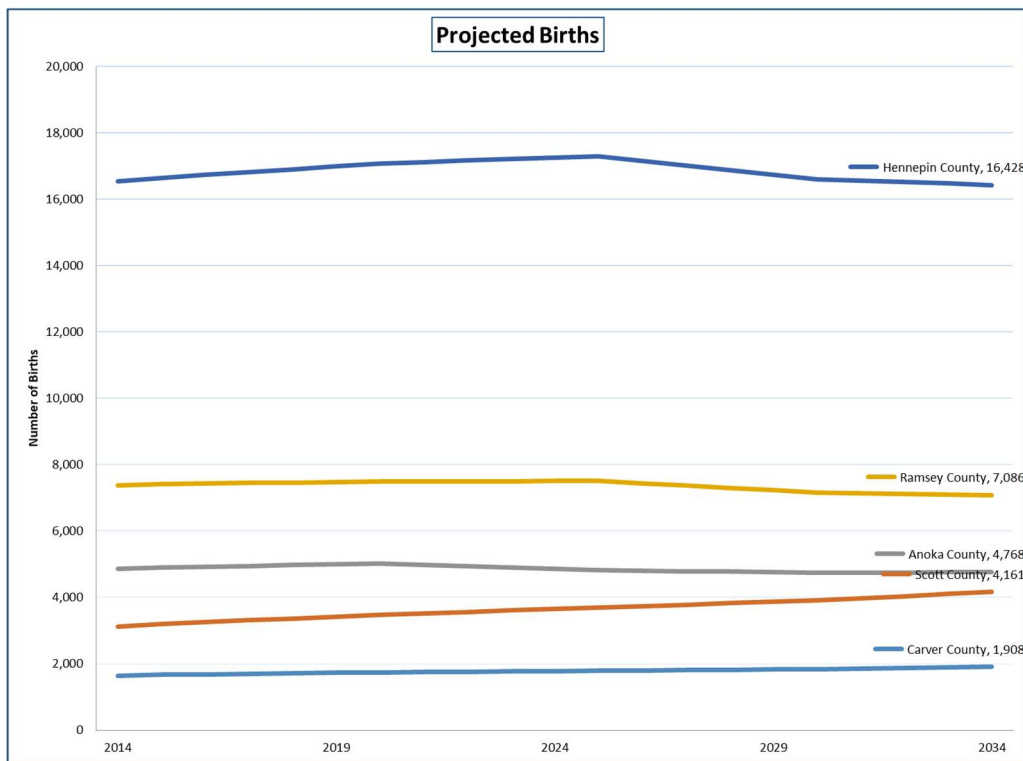

¹ Source: Provided by: TeamWorks4Ed

Geographic Area to be Served

District Boundaries- Neighboring school districts with contiguous borders include:

- Wayzata
- Minnetonka
- Eden Prairie
- Edina
- St. Louis Park
- Minneapolis
- Robbinsdale

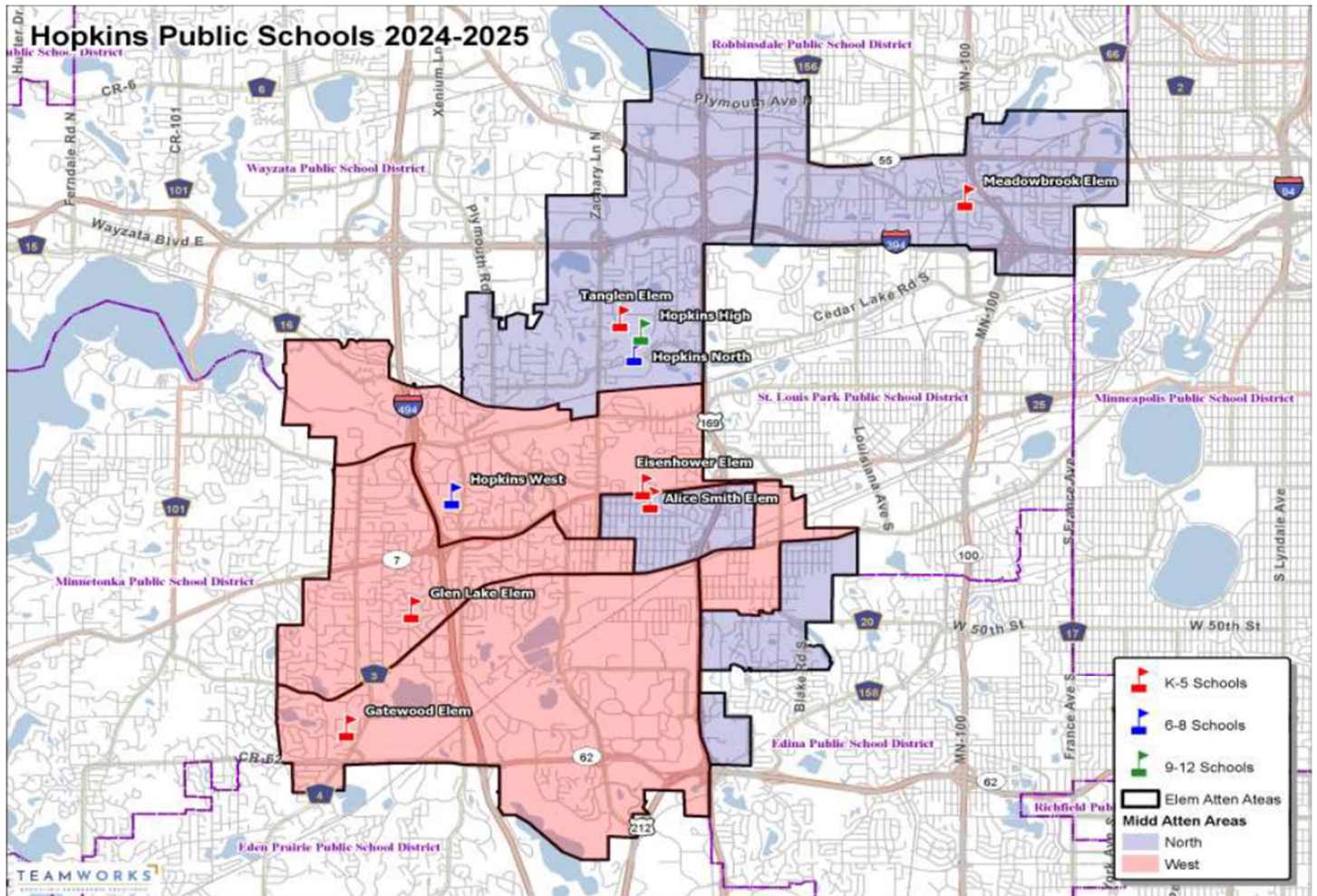

2. Existing Facilities and Their Utilization

List of existing facilities by year constructed, their uses, and an assessment of the extent to which alternate facilities are available within the school district boundaries and in adjacent school districts.



Year Constructed and Square Footage

The District currently operates 12 facilities, which are listed below:

K-12 School Facilities

Facility	Address	City	Zip Code	Year	Sq Ft
Gatewood Elementary	14900 Gatewood Drive	Minnetonka	55345	1958	76,363
Glen Lake Elementary	4801 Woodridge Road	Minnetonka	55345	1956	87,816
L.H. Tanglen Elementary	10901 Hillside Lane	Minnetonka	55343	1966	87,369
Meadowbrook Elementary & Community Center	5430 Glenwood Avenue	Golden Valley	55422	1919	164,741
Katherine Curren Elementary	1600 Mainstreet	Hopkins	55343	1948	65,791
North Junior High	10700 Cedar Lake Road	Minnetonka	55343	1958	197,671
West Junior High	3830 Baker Road	Minnetonka	55343	1959	205,258
Hopkins High School	2400 Lindbergh Drive	Minnetonka	55343	1970	490,284
Eisenhower Elementary & Community Center	1001 Highway 7	Hopkins	55343	1954	281,484
Alice Smith Elementary	801 Minnetonka Mills Road	Hopkins	55343	1951	84,998
Harley Hopkins Family Center	125 Monroe Ave. S	Hopkins	55343	1990	41,907
Bus Depot	835 Decatur Ave	Golden Valley	55442	1977	87,040

Building Uses

Educational Learning Spaces PK-12 Schools

Hopkins School District's grade configurations align with MN Academic Standards, allowing students to learn in and age and developmentally appropriate spaces. This includes seven elementary schools, two middle schools, one high school, a community center, an early childhood and family center and a bus depot.

Available Alternative Facilities

Hopkins East was acquired in the last 3 years to support virtual learning opportunities for the students in the district. Otherwise, there are no other alternate facilities under Hopkins Public School District's management in their attendance boundaries or in adjacent school districts.

3. Deficiencies of the School District's Facilities

A list of the specific deficiencies of the facility that demonstrate the need for a renovated facility to be provided, the process used to determine the deficiencies, a list of those deficiencies that will and will not be addressed by the proposed project, and a list of the specific benefits that the new or renovated facility will provide to the students, teachers, and community users served by the facility.



Building Asset Conditions

Important Facility Assets and Systems Background

Overview of Facility Improvements

Hopkins Public Schools has taken a strategic and long-term approach to upgrading its facilities. Over the last two decades, they have systematically transitioned their facilities from outdated and inefficient steam heating systems to state of the art hot water heating systems, addressing interconnected infrastructure needs like ventilation systems, ceiling grids, lighting systems, and information technology upgrades. This approach has been cost-effective as it eliminates the inflationary pressure on both labor and materials and prevents costly “re-work” due to ineffective planning.

Strategic Planning and Execution

The district developed a long-term facility maintenance plan for each building, prioritizing projects based on a myriad of factors, including current condition, impact on learning environment, financial impact, and life safety. The long-term facility maintenance plan is based on a 10-year planning cycle, with annual assessments, updates, and submissions to the Minnesota Department of Education. With over 1.7 million sq. ft. of facility space to manage, and an average facility age of 55 years, it'd be impossible to address all facility needs at one time. Instead, they plan comprehensive projects that incorporate multiple interconnected upgrades, such as the upcoming work at Alice Smith in 2026, which includes upgrading kindergarten classroom ventilation systems, converting heating systems from steam to hot water, replacing electrical infrastructure, and updating information technology systems.

Financial Stewardship

Hopkins has paired its long-term facilities maintenance plan with financial strategies that provide consistent and predictable outcomes for their community, avoiding the unpredictable spikes and valleys in facilities spending. They've utilized state-provided long-term facilities maintenance (LTFM) funding, supplemented by board-authorized levies and bonds as needed. Taking a proactive rather than a reactive approach to managing facilities ensures the most cost-effective approach to maintaining these vital community assets. This proactive approach prevents tax spikes, providing stability for taxpayers, particularly those on fixed incomes. Over the years, this has saved significant costs by addressing deferred maintenance early, avoiding price escalations.

Deferred Maintenance Management

The district has been proactive in reducing its deferred maintenance backlog through consistent investments. By tackling issues early, they've saved considerable funds; for example, replacing a boiler in 2010 cost significantly less than it would today.

Recognition for Strategic Vision is in Alignment with This Referendum

Hopkins’ facilities strategy reflects a long history of sound leadership and stewardship. While much of the vision was driven by past business services directors and building grounds staff, the school board’s consistent approval and annual reassessment of the 10-year capital plan have been pivotal. Each year, the plan is updated to address evolving priorities. Below we will highlight how objective data has been used to prioritize facility improvements. This process and data are used annually to develop Hopkin’s 10-year LTFM plan, ensuring:

- **Dry, safe and comfortable schools district-wide**
- **Priorities are based on data and to avoid urgent/unplanned repairs which can be costly and disrupt learning**
- **Valuable resources of time, space, money, and people are optimized to the fullest**

While we are seeking a referendum to improve our facilities (buildings and grounds). **The majority of facility improvement measures that are rated alarm or alert in graphs below are already accounted for in our 10-Year LTFM Plan.** This allows the district to focus efforts on future-forward programming projects, safety updates, and necessary infrastructure improvements.

Facility Assessments

From physical assets to space utilization, a Facility Condition Assessment will measure the condition and functionality of the building and its assets. A good assessment will determine the needs for renewal or replacement of building systems and guide the process to capital planning.

For Hopkins Schools, there are 14 buildings in inventory totaling 1,773,954 sq ft. Most notable is the average age of the facilities range from 35 years to 68 years old. Maintaining older facilities presents a unique set of challenges, primarily due to the need to address aging infrastructure, outdated systems, and compliance with updated regulations. These challenges can lead to increased maintenance costs, energy inefficiencies, and difficulty in adapting to new technologies.

As you will see in upcoming graphs, Hopkins Public School District has done a great job planning, prioritizing, and implementing their long-term facility maintenance.

Assessment Overview

The colors in the summary chart below represent the relative replacement cost of the assets that were assessed. Assets assessed in the BLUE still have useful life. Assets assessed in the ORANGE may need replacement or will have increased operational cost.

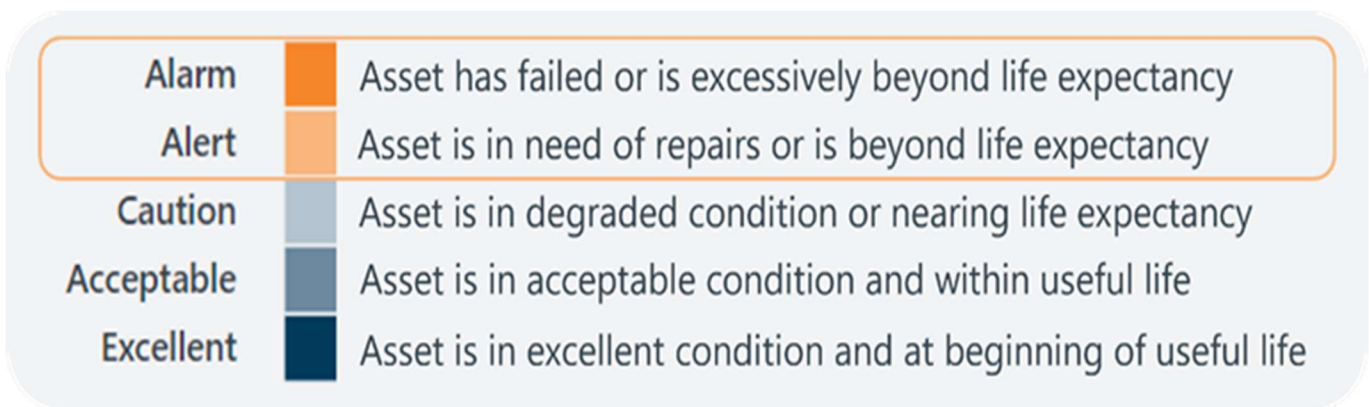

For Hopkins, the summary of the facility assessments is represented in the chart below. The magnitude or size of each colored bar represents the relative replacement costs for those respective asset conditions.

Facility Condition Assessment - Summary

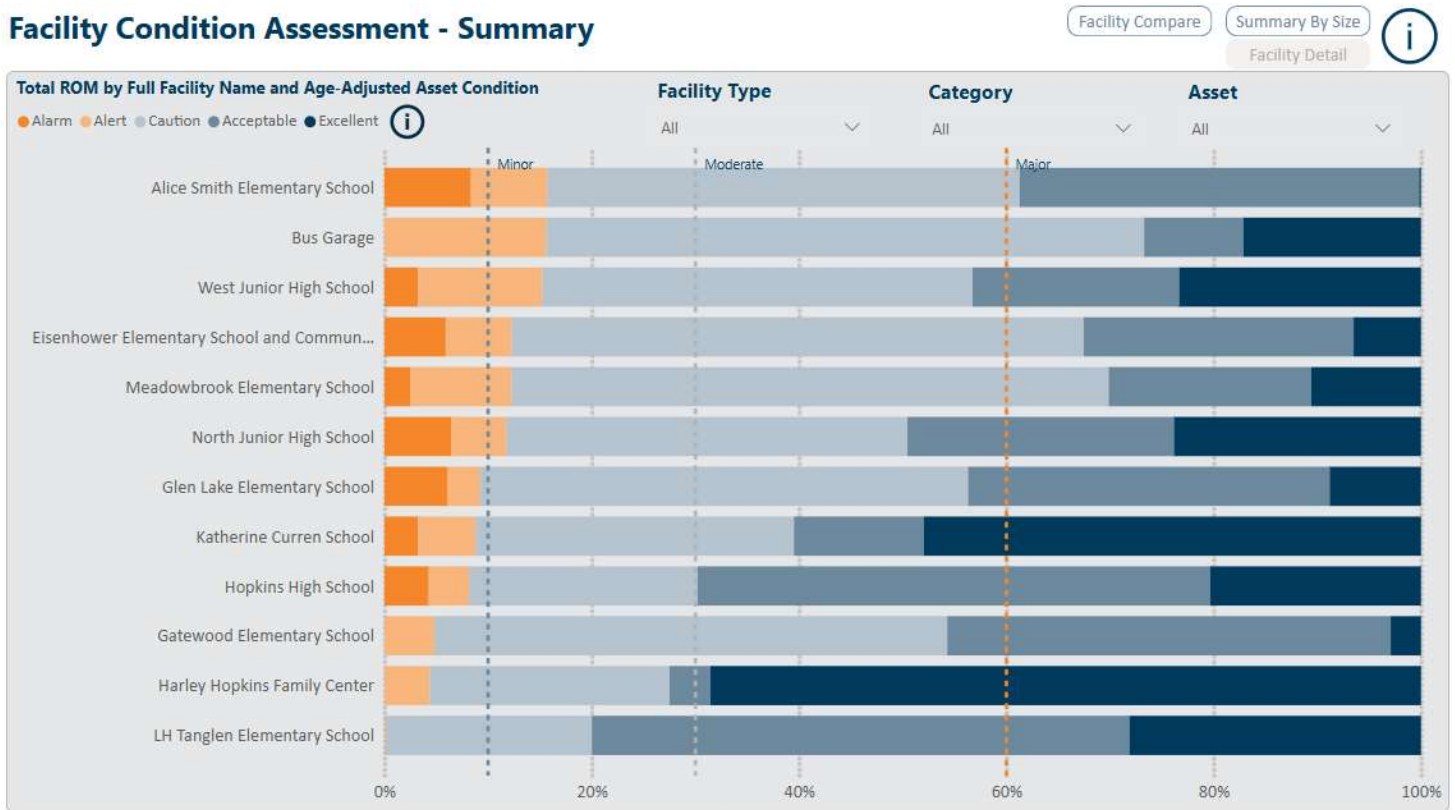

The scale below provides guidance relative to the number of renovations needed, based on assets in the Alarm & Alert condition (in Orange).

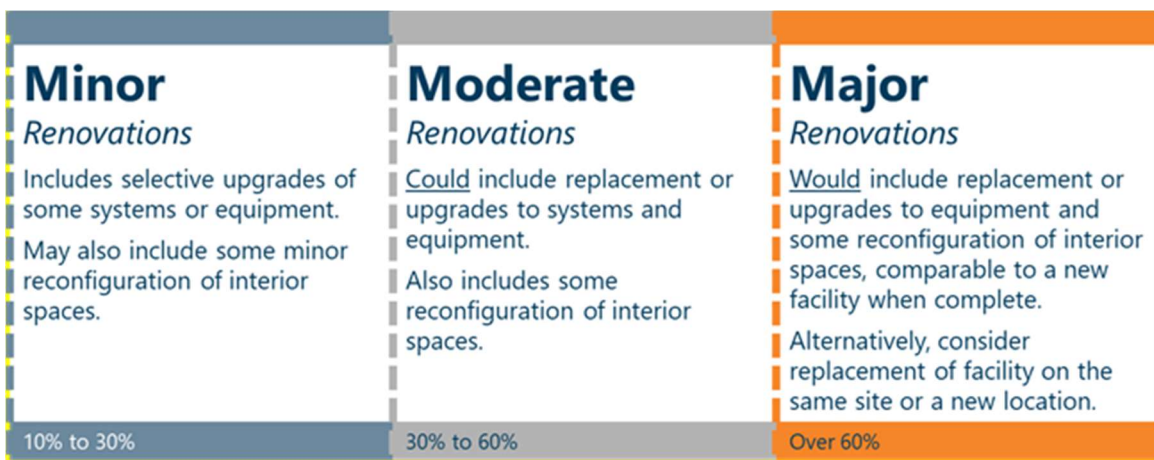

The following report pages go a little deeper into each facility by breaking down the asset conditions by Asset Categories.

Hopkins High School Asset Conditions

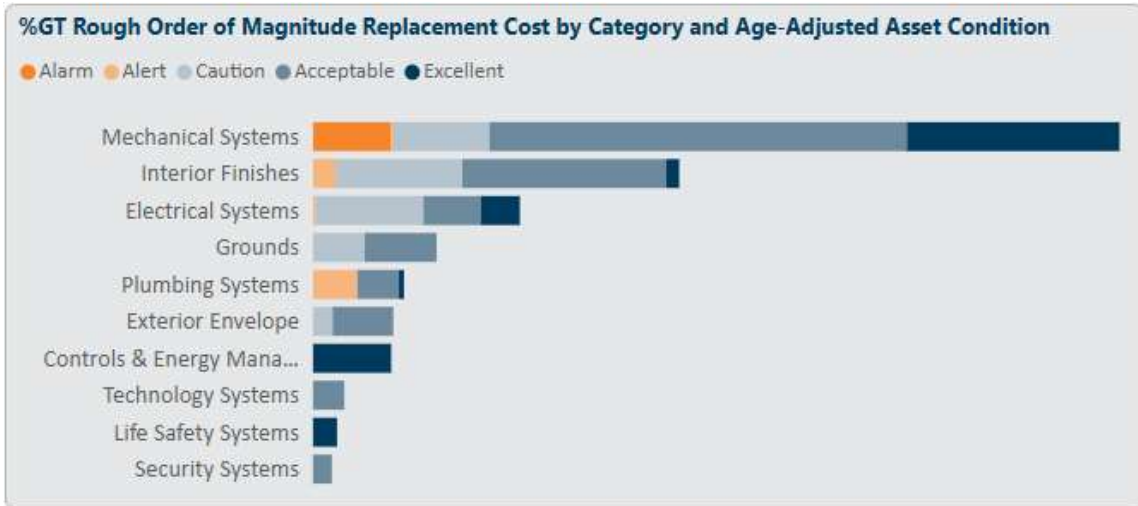

West Middle School Asset Conditions

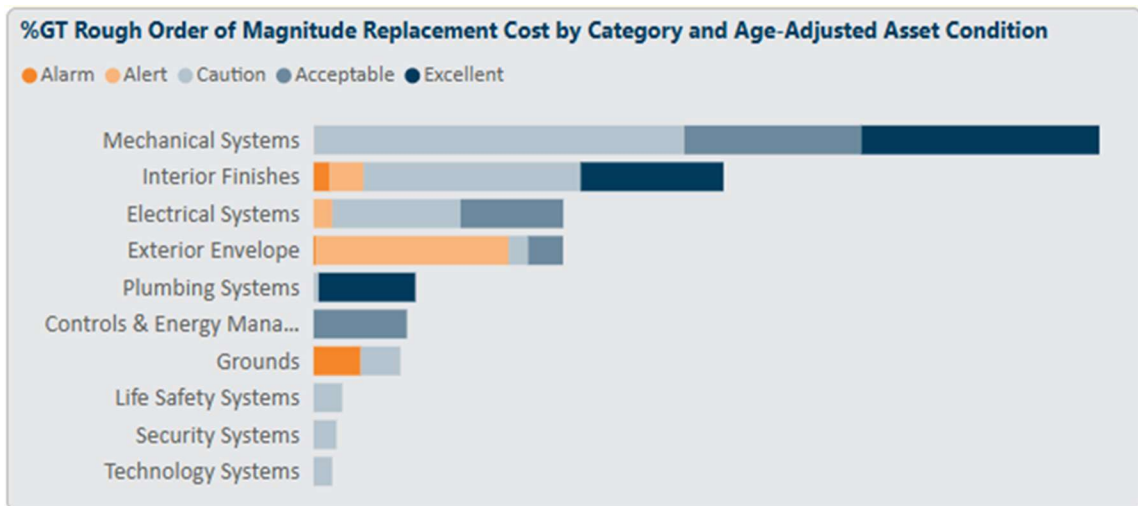

North Middle School Asset Conditions

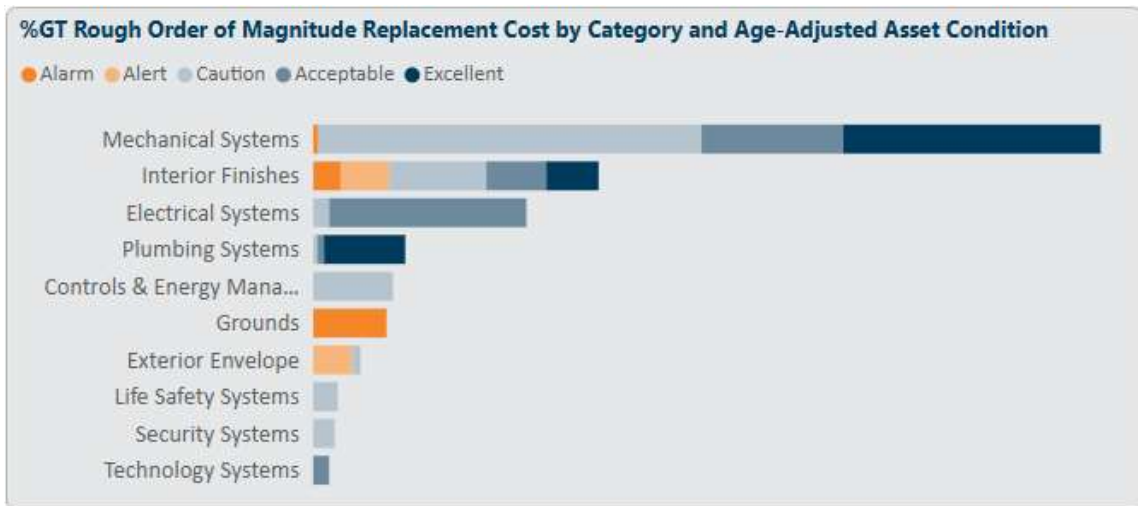

Alice Smith Elementary Asset Conditions

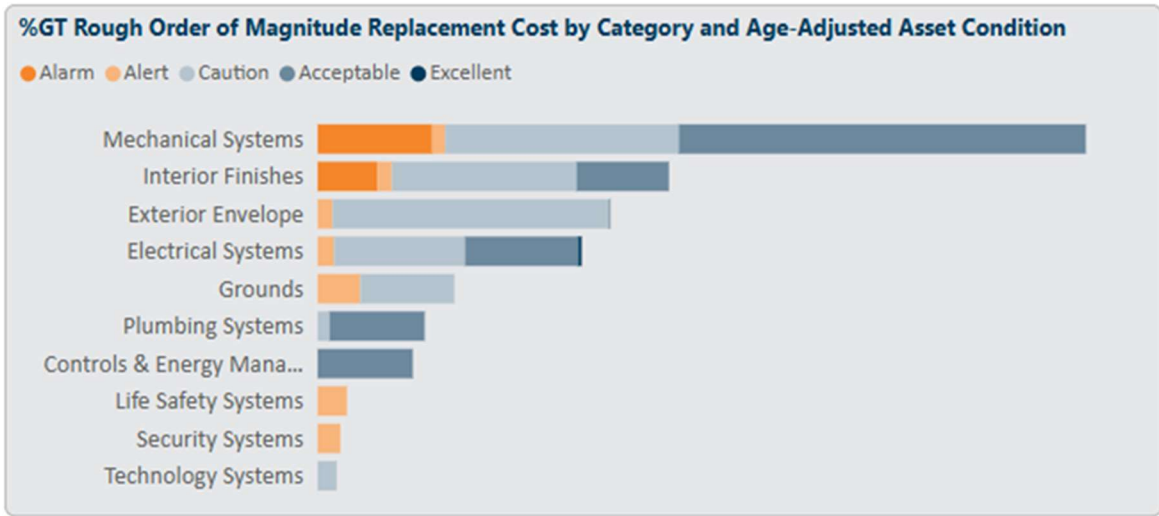

Eisenhower Elementary & Community Center Asset Conditions

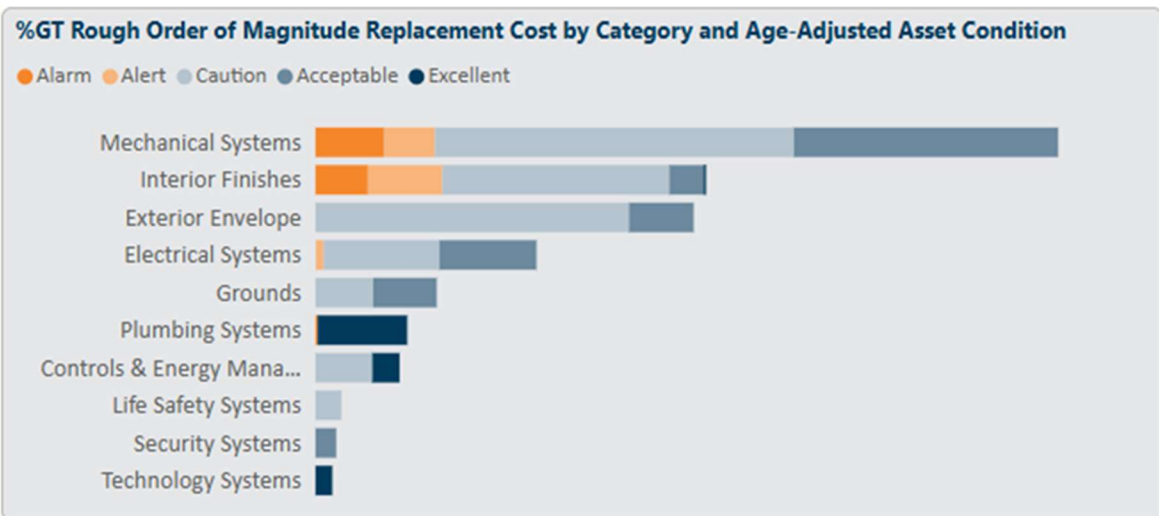

Gatewood Elementary Asset Conditions

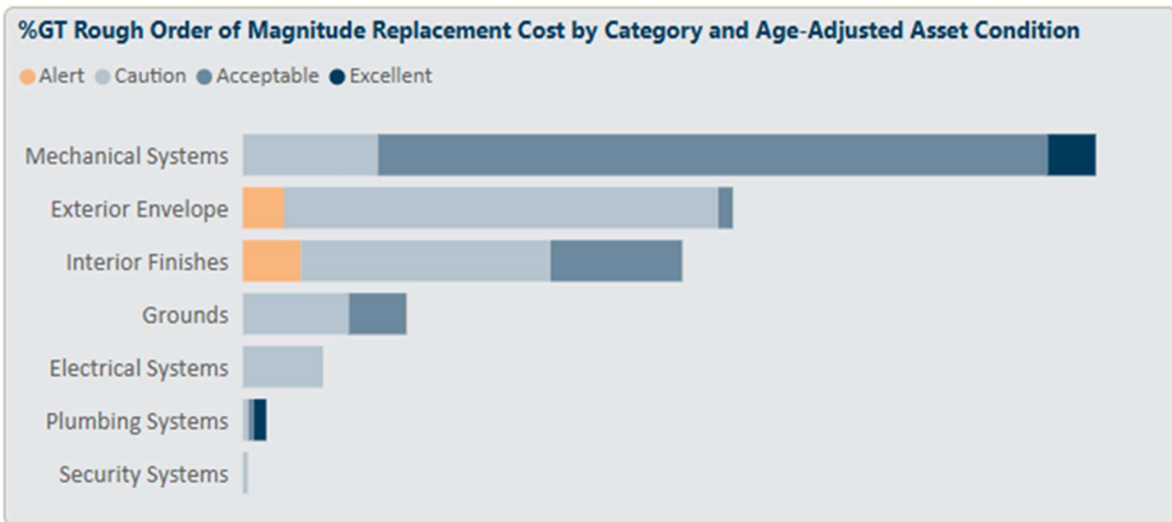

Glen Lake Elementary Asset Conditions

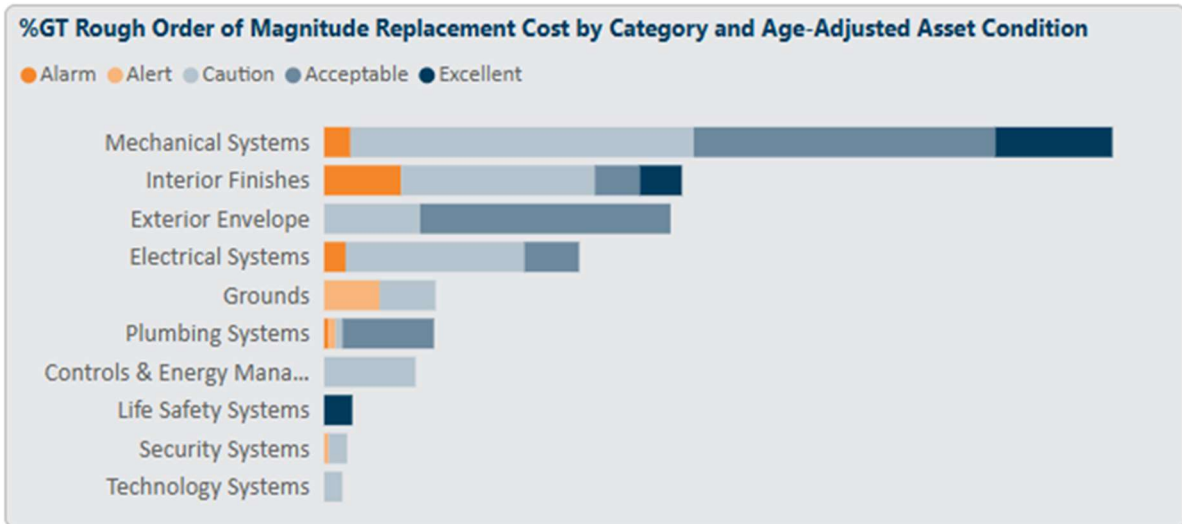

Harley Hopkins Family Center Asset Conditions

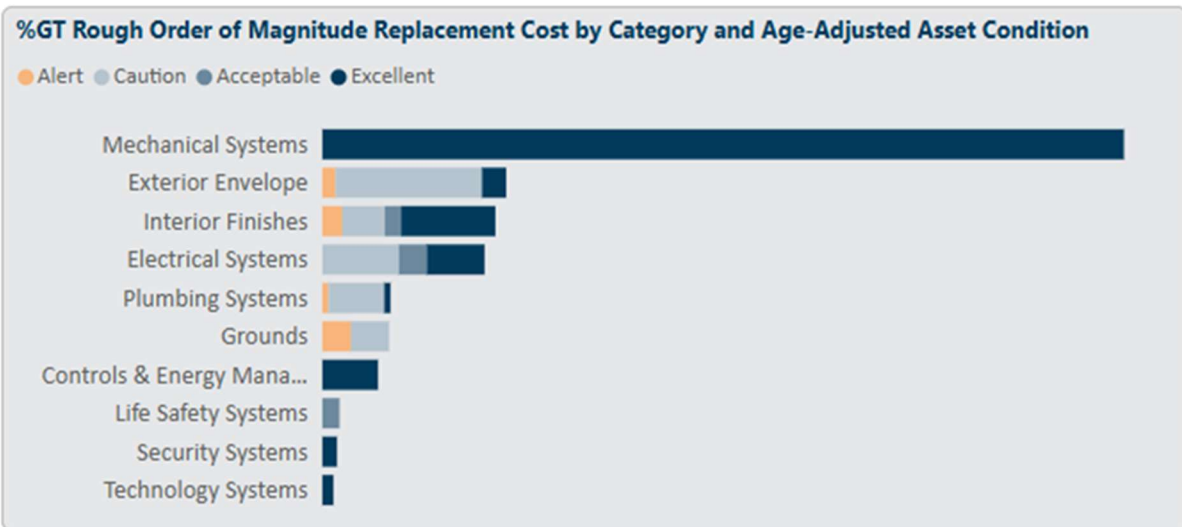

Katherine Curren School Asset Conditions

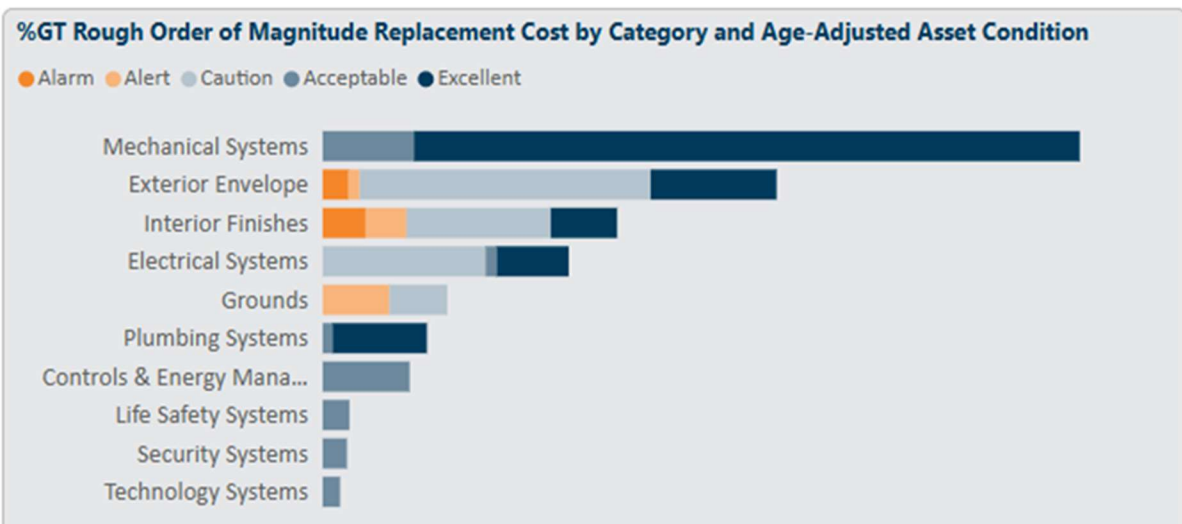

LH Tanglen Elementary Asset Conditions

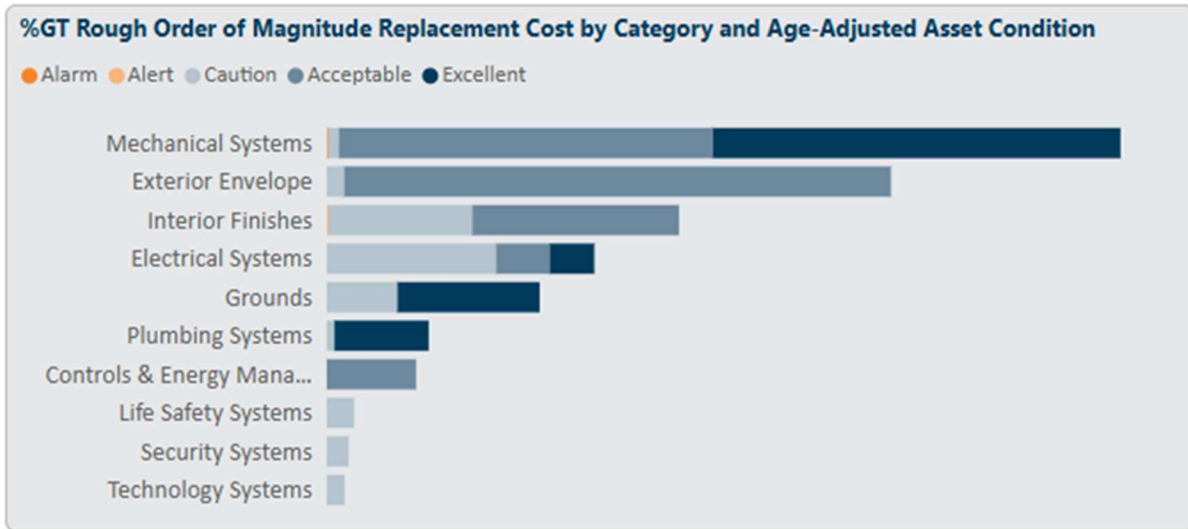

Meadowbrook Elementary

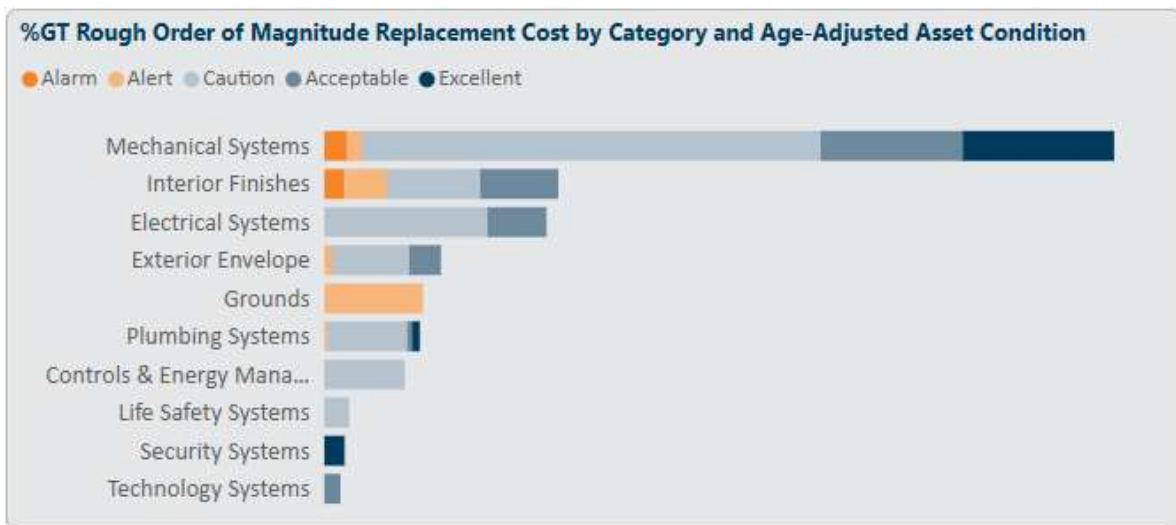

Bus Garage Asset Conditions

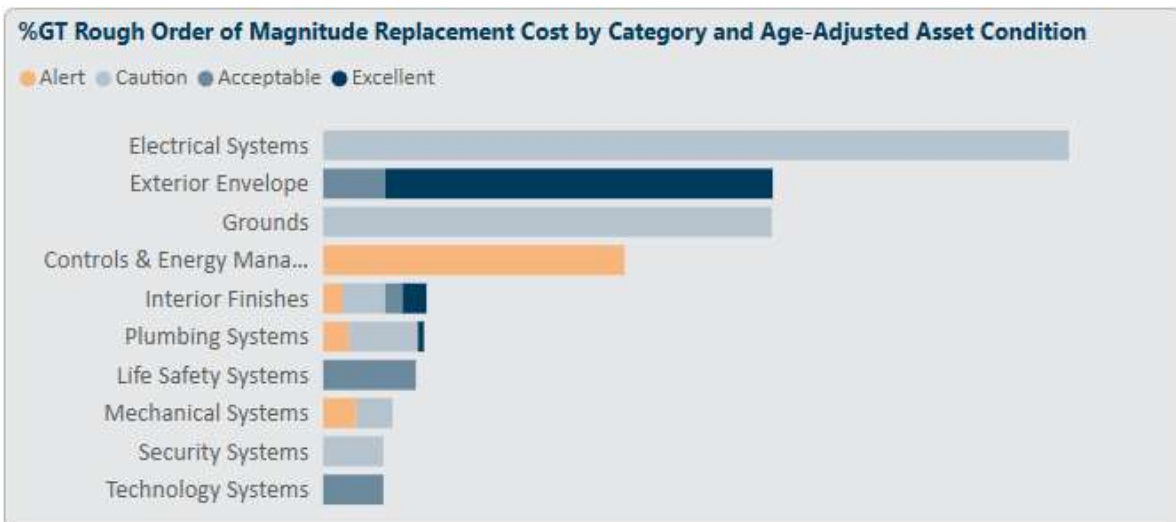

Playgrounds, Athletic Facilities, and Parking Lot Evaluations

The evaluations of the parking lots, playgrounds and athletic facilities for the sites within ISD #270 Hopkins Public Schools, were performed by SAFEngineering, PLLC. SAFEngineering has been the civil engineering consultant for the school district since 2012 and prior to that with another consulting firm since 2008. The evaluations were prepared based on over 35 years of experience in the civil engineering field and construction of numerous similar projects within the state of Minnesota and upper Midwest region. The evaluations of the parking lots were utilized with the PACER, Pavement Surface Evaluation Rating manual, developed by the University of Wisconsin. A copy of the PACER manual, the updated Pavement Management Program spreadsheet, Athletic Facilities and Playgrounds Evaluation and 2025 Referendum spreadsheet are attached for your review.

Playgrounds:

SCHOOL	Condition	Evaluation
Alice Smith Elementary School		
West Playground	Poor	Needs complete replacement
Eisenhower CC/ES		
West Playground	Good	Could use a new flat rubber surface
North Playground - concrete	Fair	Further evaluation required for the needs of the students
Gatewood Elementary School		
North Playground	Poor	Needs complete replacement
Glen Lake Elementary School		
East Playground	Excellent	Condition based on final completion of the project in 2024
South Playground	Poor	Needs complete replacement
Katherine Curren Elementary School		
South Playground	Good	Further evaluation required for the needs of the school district
L. H. Tanglen Elementary School		
West Playground	Good	Routine maintenance required
Meadowbrook Elementary School		
Northeast Playground	Poor	Needs complete replacement
Harley Hopkins Family Center		
West Playground	Fair	Perform rehabilitation with the addition of the Northwest playground
Northwest Playground	NA	New playground addition
North Middle School		
Natural Grass Ball Fields	Fair	Needs further evaluation by the school district. They may be reorientated with the addition of the new perimeter entrance drive
West Middle School		
Natural grass ball fields	Good	Routine maintenance required
Tennis Courts	Poor	Reconstruction required. Convert one tennis court into a playground
High School		
Athletic Track	Excellent	Routine maintenance required
Stadium Field- Synthetic Turf	Excellent	Routine maintenance required
South Field- Synthetic Turf	Excellent	Routine maintenance required
Baseball/Softball/Soccer/ Fields - Synthetic Turf	Good	Replacement required between 2027 and 2029
Softball Complex - Natural Grass	Good	Routine maintenance required
Football/Soccer Northeast Fields - Natural Grass	Good	Routine maintenance required
Tennis Courts	Fair	Possible conversion to synthetic turf Reconstruction required between 2027 and 2029

PASER RATING SCALE:

Rating system

<i>Surface rating</i>	<i>Visible distress*</i>	<i>General condition/ treatment measures</i>
10 Excellent	None.	New construction.
9 Excellent	None.	Recent overlay. Like new.
8 Very Good	No longitudinal cracks except reflection of paving joints. Occasional transverse cracks, widely spaced (40' or greater). All cracks sealed or tight (open less than 1/4").	Recent sealcoat or new cold mix. Little or no maintenance required.
7 Good	Very slight or no raveling, surface shows some traffic wear. Longitudinal cracks (open 1/4") due to reflection or paving joints. Transverse cracks (open 1/4") spaced 10' or more apart, little or slight crack raveling. No patching or very few patches in excellent condition.	First signs of aging. Maintain with routine crack filling.
6 Good	Slight raveling (loss of fines) and traffic wear. Longitudinal cracks (open 1/4"–1/2"), some spaced less than 10'. First sign of block cracking. Slight to moderate flushing or polishing. Occasional patching in good condition.	Shows signs of aging. Sound structural condition. Could extend life with sealcoat.
5 Fair	Moderate to severe raveling (loss of fine and coarse aggregate). Longitudinal and transverse cracks (open 1/2") show first signs of slight raveling and secondary cracks. First signs of longitudinal cracks near pavement edge. Block cracking up to 50% of surface. Extensive to severe flushing or polishing. Some patching or edge wedging in good condition.	Surface aging. Sound structural condition. Needs sealcoat or thin non-structural overlay (less than 2")
4 Fair	Severe surface raveling. Multiple longitudinal and transverse cracking with slight raveling. Longitudinal cracking in wheel path. Block cracking (over 50% of surface). Patching in fair condition. Slight rutting or distortions (1/2" deep or less).	Significant aging and first signs of need for strengthening. Would benefit from a structural overlay (2" or more).
3 Poor	Closely spaced longitudinal and transverse cracks often showing raveling and crack erosion. Severe block cracking. Some alligator cracking (less than 25% of surface). Patches in fair to poor condition. Moderate rutting or distortion (1" or 2" deep). Occasional potholes.	Needs patching and repair prior to major overlay. Milling and removal of deterioration extends the life of overlay.
2 Very Poor	Alligator cracking (over 25% of surface). Severe distortions (over 2" deep) Extensive patching in poor condition. Potholes.	Severe deterioration. Needs reconstruction with extensive base repair. Pulverization of old pavement is effective.
1 Failed	Severe distress with extensive loss of surface integrity.	Failed. Needs total reconstruction.

SCHOOL	PASER SCORE
Alice Smith Elementary School	
South Parking Lot and Drive	5
West Parking Lot	5
North Bus Lot and Playground	9
Eisenhower CC/ES	
East Parking Lot	5
Northeast Parking Lot	6
Southeast Parking Lot	5
Southwest Parking Lot	6
North Bus Parking Lot	2
West Parking Lot	5
Gatewood Elementary School	
East Parking Lot	3
Bus Parking Lot	5
South Parking Lot	5
Loading Dock	5
Glen Lake Elementary School	
North Parking Lot	8
West Bus Parking Lot	10
South Parking Lot	10
South Drive	10
East Loading Dock	10
West Playground	10
Katherine Curran Elementary School	
Loading Dock	3
East Drive	5
East Parking Lot	4
South Playground	4

SCHOOL	PASER SCORE
L. H. Tanglen Elementary School	
North Parking Lot	7
East Parking Lot	5
South Bus and Staff Parking Lot	4
South Playground	6
Meadowbrook Elementary School	
North Bus Parking Lot	4
West Parking Lot	4
Northeast Parking Lot	3
Early Childhood Parking Lot	5
North Playground	5
East Campus Parking Lots	9
Harley Hopkins Family Center	
North Parking Lot	7
North Middle School	
North Bus Parking Lot	4
West Parking Lot	2
South Parking Lot	4
North Playground	9
West Middle School	
North Parking Lot	4
East Bus Parking Lot	4
High School	
North Parking Lot	9
East Parking Lot	4
Southeast Parking Lot	4
South Central Parking Lot	4
Southwest Parking Lot	4
Bus Depot	
East Parking Lot	3
Bus Parking Lots	1

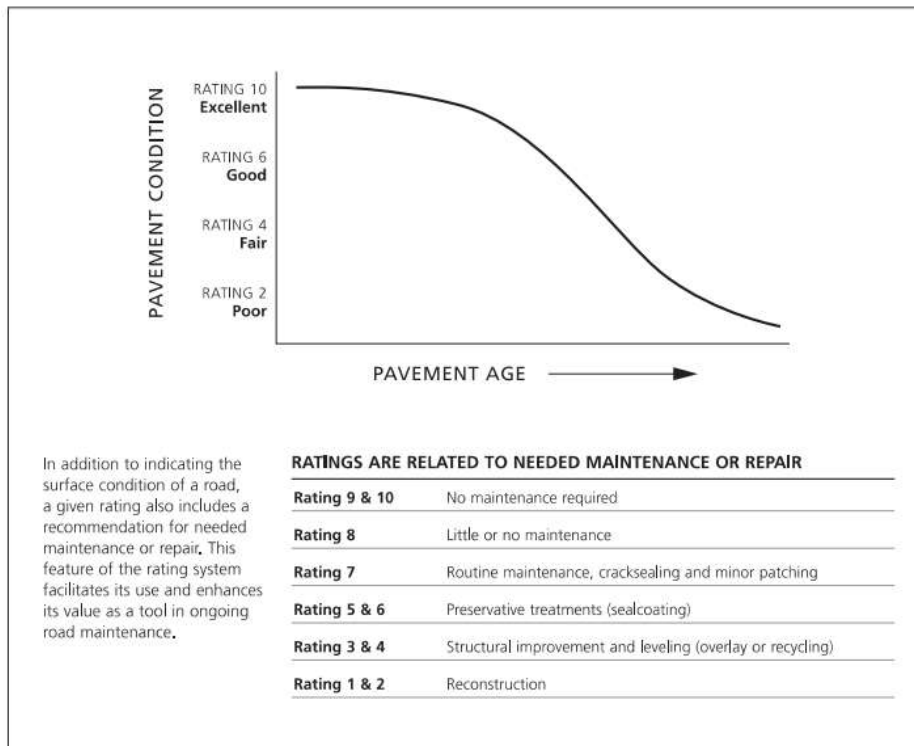

Safety and Security Findings

Rozin Security conducted a comprehensive Security Risk Assessment for the Hopkins Public School District (HPSD) for the purpose of enhancing the overall safety and security of students, faculty and staff, and visitors to all district facilities. These assessments, which occurred from 12/03/2018 - 12/06/2018, included in-depth interviews with key personnel at the district level as well as at the individual facility level, followed by a walkthrough of each facility.

The focus of this survey was to assess HPSD's current state of preparedness for dealing with man-made threats and natural hazards, to identify gaps where security activities fall short, and to propose measures to improve the organization's preparedness and abilities to thwart harmful acts targeting HPSD schools and personnel. Rozin Security's Assessment will provide HPSD a strategic and prioritized safety and security plan, allowing the district to implement effective changes that fit within HPSD's culture and budget.

Throughout the course of this assessment Rozin Security determined the levels of risk that various threats both violent and non-violent, pose to HPSD's most important assets. Rozin Security conducted an in-depth threat assessment on HPSD campuses, looking at threats to schools nationwide, threats to HPSD schools, and threats specific to the area in which HPSD facilities currently operate. Rozin Security then identified security deficiencies that affected each asset's level of exposure to relevant threats. Risk scores were derived from the products of asset prioritization ratings, threat ratings, and vulnerability ratings. Rozin Security used this data to develop prioritized, cost-effective, and security-efficient recommendations



Over the last seven years, Hopkins School District has addressed many of the recommendations from this safety assessment. As Rozin Security Consulting shared in their report, it takes a considerable amount of time and resources to implement all of the recommendations. The District has used these recommendations from this report to prioritize consistent and district-wide safety and security enhancements.

Due to the confidential nature of this report, we have not included specific assessments and findings in this review and comment.

District and Community Engagement

Below is a visual that reflects the intentional school community engagement process Hopkins Public School District used to gather feedback from the community, staff, administration and students. Feedback was gathered through listening and ideation sessions and a comprehensive community survey.

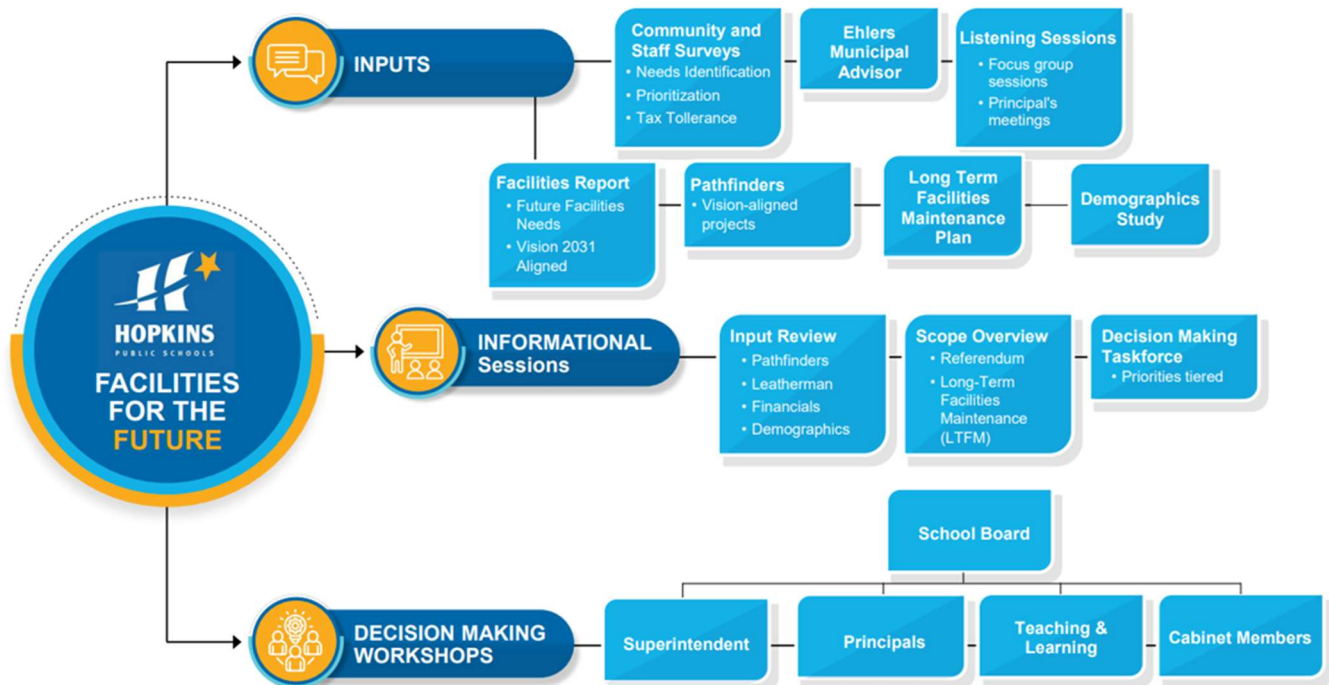

Community Engagement

Community Engagement

Overview

Hopkins Public Schools conducted a series of interactive listening sessions to engage students, staff, families, and community members. These sessions were designed to share information about the district's strategic, long-term approach to upgrading its facilities and to gather input that would guide the school board and district leadership in making informed decisions aligned with a shared vision. While the district has already developed a long-term maintenance plan for each building—prioritizing projects based on factors such as current condition, impact on the learning environment, financial implications, and safety—these sessions provided an opportunity to align that plan with community values and expectations.

Session Dates and Attending Groups

- **March 18, 2025** – Holistic Safety Committee (Virtual)
- **March 26, 2025** – Nutritional Services Leadership (Virtual)
- **March 27, 2025** – LGBTQ+ Staff Affinity Group and Families of LGBTQ+ and Gender Expansive Kids (In-Person)
- **April 7, 2025** – All Community Session #1 (In-Person and Virtual)

- **April 10, 2025** – IDL Staff Group (Virtual)
- **April 15, 2025** – All Community Session #2 (Virtual)
- **April 22, 2025** – High School Students (In-Person)



Activities During Listening Sessions

Each session included:

- A presentation on the district’s facilities strategy.
- Sharing of community survey results and updates on educator-led Pathfinder proposals.
- An interactive “Brag, Worry, Wonder, Bet” exercise to surface hopes, concerns, and predictions.
- Facilitated group discussions on facility priorities, challenges, and ideas for improvement.

School Community Engagement Conclusions

- **Inclusivity & Accessibility:** Strong emphasis on inclusive design, especially single stall restrooms, ADA compliance, and sensory-friendly spaces.
- **Safety & Security:** Concerns about building access, bathroom safety, and consistent security measures across sites.
- **Modernization & Flexibility:** Desire for updated, student-friendly, and adaptable learning environments with natural light and modern technology.
- **Community Connection:** Facilities should support community use, foster partnerships, and reflect shared values.

- **Financial Stewardship:** Participants expressed both concern and optimism about funding, with many betting on the district's resilience and values to guide future success.

Community Survey

Community Survey Results and Prioritization

Hopkins School District collaborated with the Morris Leatherman Company to survey the community on important topics related to this referendum. Below is a summary of their findings.

- **Positive Perceptions and Key Strengths:**
 - A significant majority view Hopkins as a "destination" district (65%), showing strong community pride and belief in the district's quality.
 - Academics, variety in programs, and teacher quality are valued, positioning these as compelling points in the referendum messaging.
- **Most Pressing Issues:**
 - Funding shortages are cited as a major issue (18%), and concerns about large class sizes, drugs/alcohol, and discipline also stand out.
 - Addressing how funds from the referendum would alleviate these concerns can be persuasive, particularly around class sizes and safety.
- **Fiscal Credibility:**
 - High levels of agreement (above 70%) on responsible spending and fiscal transparency enhance the district's credibility, which is essential for gaining trust in a new tax request.
 - Emphasize fiscal responsibility to reassure voters that the district uses funds judiciously.
- **Community Trust and Decision-Making:**
 - Strong ratings (79%) for trust in district leaders, and high satisfaction with the decision-making process (72%) suggests that residents may be open to supporting district-led initiatives.
 - Highlighting the inclusive nature of district decisions could appeal to those who value community involvement.
- **Tax Sensitivity:**
 - While taxes are a concern, only 26% are opposed to any tax increases, with 46% open to supporting an increase under specific conditions.
 - Clear, transparent communication about the exact benefits and need for additional funds will be crucial.
- **Bond Referendum Willingness:**
 - The median resident supports a \$6/month increase, with safety and security enhancements, and flexible learning spaces among the most supported uses.
 - Focus the proposal around popular options like safety, modern learning spaces, and transportation efficiency to garner wider support.
- **Communication Channels:**
 - Mailed and electronic newsletters, district website, and local newspapers are the most trusted sources, so prioritize these for campaign information.
 - Leverage "Update," the school district newsletter, and community discussions to enhance reach and impact.
- **Demographics and Target Audiences:**

- Younger residents, parents, Community Education users, and liberal/moderate voters may be more likely to support the referendum. Mobilizing these groups through grassroots campaigns could be effective.
- Tailor messaging to appeal to specific demographic concerns, like addressing financial strain for fiscally stressed households and emphasizing investment in community value.

In summary, a campaign emphasizing Hopkins Public Schools' reputation for academic quality, financial responsibility, and commitment to enhancing educational environments—backed by transparent plans for targeted funding—can resonate with the community. Focused outreach through trusted channels and mobilizing key demographic groups will help build support.

Staff, Administration, Community and Student Ideation

Educational and Programing Ideation Sessions

SitelogIQ's and Fielding International's team of architects and educational planners engaged in a series of collaborative sessions with Hopkins Public Schools scholars and each of the building principals to review facility data and to gain a deeper understanding of each school's unique programming needs. These strategic meetings were designed to foster open dialogue, ensuring that the voices of students and educational leaders were central to the planning process.

The sessions focused on three key areas: the current educational environment, evolving programming requirements, and the future readiness of school facilities and their alignment to Vision 2031. By analyzing existing data and listening closely to insights shared, the team was able to align architectural planning with the districts educational vision.

Through this collaborative approach, SitelogIQ and Fielding International are helping to shape the learning environments that are not only functional but also inspiring and adaptable – spaces that support student success today and into the future.

Pathfinder Development & Process

In alignment with Vision 2031, Hopkins Public Schools identified the need to modernize learning environments to better support learner-centered education. While existing school facilities were in good condition, they largely reflected traditional models of teaching and learning that limited flexibility, collaboration, and student agency. To address this, the district partnered with Fielding International to design a process for developing prototype learning environments, referred to as Pathfinders, that would serve as models for future renovations and new construction.

The development process began with a district-wide Spatial Audit conducted by Fielding. This included walkthroughs, observational studies, and stakeholder engagement at each school site. Focus groups with students, teachers, and staff provided insight into how current spaces were supporting or hindering teaching and learning. The audit identified areas where existing environments fell short of the district's values, particularly in the areas of collaboration, adaptability, wellness, and inclusion.

Following the audit, every school in the district was invited to participate in a proposal process. Educator teams were encouraged to submit ideas for Pathfinder projects that could demonstrate innovative, student-centered learning environments aligned with the district's goals. These proposals needed to address both instructional intent and spatial design, therefore reflecting direct input from educators and, in many cases, students.

A total of 47 Pathfinder proposals were submitted by teacher teams across the district. These proposals were evaluated by Fielding and district leaders using criteria such as alignment with Vision 2031, potential for impact on student learning, scalability, and current building needs.

Each selected team participated in a design charrette, a collaborative workshop led by Fielding designers and architects. These sessions translated each team’s vision into conceptual design plans while preserving the core instructional goals behind each project. Educators remained closely involved throughout the process to ensure design decisions were responsive to program needs and day-to-day instructional practices.

In summary, the Pathfinder process was structured, collaborative, and rooted in local context. It provided a framework for educators to shape their learning environments and created four model spaces that reflect both the values of Vision 2031 and the practical needs of students and staff. These four spaces will be discussed and highlighted in the next section. Outside of the “Pathfinders” other programming priorities were discussed and ultimately selected to be part of this referendum. Ideation findings for facility improvement measures from staff, administration, community and students are listed below.

Ideation Findings



Pathfinder Projects Process

Across four distinct school sites (Meadowbrook Elementary, West Middle School, North Middle School, and Hopkins High School), the Hopkins Pathfinder Projects exemplify how physical spaces can powerfully align with the district’s educational vision to benefit the entire school community. Taken together, the Pathfinders demonstrate how holistic school safety can be a living system that elevates students, supports educators, and welcomes the community.

These environments have been designed to strongly align with the district’s deeply held values—authentic inclusivity, intentionally adventurous learning, love, optimistic innovation, and humility of heart—making them vibrant, learner-centered models for what’s possible when space is designed not just for instruction, but for connection, curiosity, and care.



A System of Safety and Empowerment

At the heart of each Pathfinder project is a broad, human-centered definition of safety—one that includes physical, social-emotional, and intellectual dimensions. The environments are crafted to protect students not only from physical harm but from the isolation, stress, and rigidity that too often stifle well-being and engagement.

Across each site, consistent design strategies include:

- **Inclusive restrooms and calming spaces** that affirm student dignity and accommodate diverse needs.
- **Nest and cave zones** that offer physical and psychological refuge, ensuring students can self-regulate and recharge as needed.
- **Flexible commons and maker-style studios** that support active, collaborative, and cross-disciplinary learning.
- **Outdoor learning environments** that encourage exploration, movement, and a deepened connection to nature.

Rather than relying on “hardening” strategies that create a fortress mentality, the Pathfinders apply CPTED (Crime Prevention Through Environmental Design) principles with care and creativity. Features like open sightlines, intuitive wayfinding, and visible staff spaces build trust and transparency while maintaining a warm, welcoming environment. As a result, the spaces are not just protected, but alive with energy, purpose, and joy.

Elevating the Student Experience

Each Pathfinder is thoughtfully tailored to the developmental and emotional needs of the learners it serves. These aren’t one-size-fits-all solutions; they are age-responsive environments that provide the right balance of support and independence.

- **At Meadowbrook Elementary**, a full renovation prioritizes students who receive special education services. Calming zones, motor skill development areas, and rooms bathed in natural light communicate a clear message: every child deserves beauty, belonging, and a place that feels just right.
- **At West Middle School**, the eighth-grade learning environment is reimagined as a bridge to high school. A crow’s nest planning space, co-designed with teachers, anchors the project, while the adjacent Active Lab, flexible commons, and scenic views offer students multiple ways to express independence, collaborate with peers, and reflect meaningfully.
- **At North Middle School**, sixth graders are welcomed into adolescence with spaces that support their evolving identities. A central theater common encourages performance and gathering, while restorative spaces and an inviting courtyard make room for reflection and play. The building’s transparency and spatial flow foster a sense of safety and shared ownership.
- **At Hopkins High School**, a dynamic two-story addition creates a beacon of future-ready learning. Home to the HPPL (an alternative pathways program) and a central learning hub, the space features gathering stairs, a restorative studio, and fluid connections between indoors and outdoors. It promotes autonomy, trust, and creativity, helping students navigate high school with purpose and confidence.

In all these settings, the spaces don’t simply accommodate student needs; they anticipate and elevate them. By offering variety, flexibility, and beauty, the Pathfinders reduce stress and increase engagement. They validate students’ presence, foster their agency, and make learning feel like an invitation rather than a demand.

Supporting Educators and Community

The benefits of these projects extend well beyond students. Educators are treated as co-designers and active agents in the learning environment. Each Pathfinder includes thoughtfully located collaboration suites where teachers can meet, plan, and reflect while remaining close to student activity. The open sightlines and flexible layouts encourage a teaching model rooted in facilitation, observation, and partnership.



For the wider community, these schools offer welcoming, multifunctional spaces that blur the lines between civic and educational life. Gathering stairs can host performances and public events. Outdoor courtyards and plazas provide space for connection beyond the school day. In some sites, creative elements like the Corner Market concept invite neighbors in, subtly embedding the school in the daily rhythms of the community.

These are not schools that close themselves off once the bell rings. They are community nodes, places where shared ownership and civic engagement flourish, reinforcing the idea that schools are for everyone.

Benefits to Students, Teachers, and Community Users

While the benefits from this process and referendum are many, below reflects some of the most impactful benefits to students, teachers, and community users should the referendum pass:

Enhanced Safety and Security

Accessible Playgrounds and Improvements to Activity Spaces

ICC 500 Storm Shelters

Parking Lot and Drainage Improvements

Collaborative, Future-Focused & Flexible Learning Environments

ADA Space Updates and Single User Bathrooms

Deficiencies Not Addressed by the Proposed Projects

Like other school districts, Hopkins has more wants and needs than resources can support. As a result, important decisions were made to prioritize the greatest needs aligning with this process and with Vision 2031. The following priorities **will not** be addressed in this referendum.



Summary

Hopkins Public School District committed to a comprehensive process to determine their greatest facility and programming priorities. In doing so, they used data to make informed decisions, the process and data has taken over 7 years and includes the following intentional steps:

- Creation of Vision 2031
- A comprehensive asset conditions assessment for all facilities
- Civil work study on parking lots, playgrounds, and athletic fields
- A district-wide safety and security assessment
- Community survey to understand citizen priorities, demographics, and financial boundaries
- Community listening sessions
- Ideation with community, staff, administration, and students
- Pathfinder discovery for future-focused learning spaces to inspire learning

This extensive and inclusive process has produced data and has supported the district in making decisions to improve Hopkins School District's facilities with an intentional and prioritized focus, these priorities include:

- Measures to improve school safety and security
- Necessary improvements to buildings and grounds
- Enhancing programming by reimagining learning spaces
- Inclusive and accessible spaces for all students
- Opportunities for community use
- Fiscal responsibility

Capital Project Levy Narrative

Capital Projects Levy:

The Hopkins School District is seeking a renewal of their Capital Projects Levy (CPL). The capital projects levy currently provides funds for classroom and building technology, installation and maintenance of software, curriculum, instructional equipment and improved technology and technology systems in various school district facilities. The renewal of these dollars will ensure our students and staff will continue to have the technology and equipment to maintain learning experiences reflected in vision 2031.

Additionally, the district has increased needs for musical instruments and school related transportation vehicles that will be addressed by funds from the capital projects levy Below is greater detail regarding the specific needs for these areas.

Band Instruments:

Hopkins Public Schools take great pride in the programming opportunities we offer to our students during the school day and co-curricular activities that occur before and after the student contact day. The Arts are just one of the many areas Hopkins scholars can explore their interest and pursue their passions. Within the Arts, Band is one of the most popular offerings. Our program starts in the elementary and continues through the high school. Many instruments in band are expensive and beyond what many families can afford. It is our belief that every student should have access to equipment, in this case band instruments, that supports their learning experience, without it being a financial burden. In our Capital Projects Levy, we will be allocating funds for the purchase and acquisition of band instruments that can be loaned to students who are unable to purchase this equipment. Reducing financial barriers is key to this priority, with that said, there are also some band equipment that cannot be transported to and from school. Examples include but are not limited to Tuba's and various Percussion Instruments. Purchasing this equipment to be onsite, in each of our band rooms, is critical to the program's success.

Transportation:

While Hopkins Public Schools contracts out the majority of our transportation services, we maintain a small fleet of district vehicles (vans and busses) to accommodate student needs that occur throughout the school year. These vehicles allow for greater flexibility and cost savings that are not subject to our contracted service pricing. We use this fleet to support student transportation for the following:

- Student Internships
- Special programming (transitions plus)
- Fieldtrips
- Sports and activities

Our current fleet has exceeded its useful life and is in need of replacement. We will be using Capital Projects Levy dollars for the purchase and acquisition of vehicles to ensure the ongoing transportation needs of our students that fall outside of our contracted transportation services are met. The fleet being replaced includes:

- 6 WC Lift small busses
- 1 Type 3 Minibus
- 2 Chevrolet Suburbans

4. Description of Proposed Project

A description of the projects, including the specification of site and outdoor space acreage and square footage allocations for classrooms, laboratories, and support spaces; estimated expenditures for the major portions of the project; and the dates the project will begin and be completed.



Katherine Curren Elementary

Project Descriptions

Infrastructure Improvements

- **Kitchen Remodel:** Update finishes and kitchen equipment to support current programming needs.

Safety & Security Improvements

- **Security Improvements:** Provide an allowance to address facility wide security improvements including additional interior and exterior security cameras, and a dry fire suppression system in the data room to increase building safety and security.

Proposed Plans

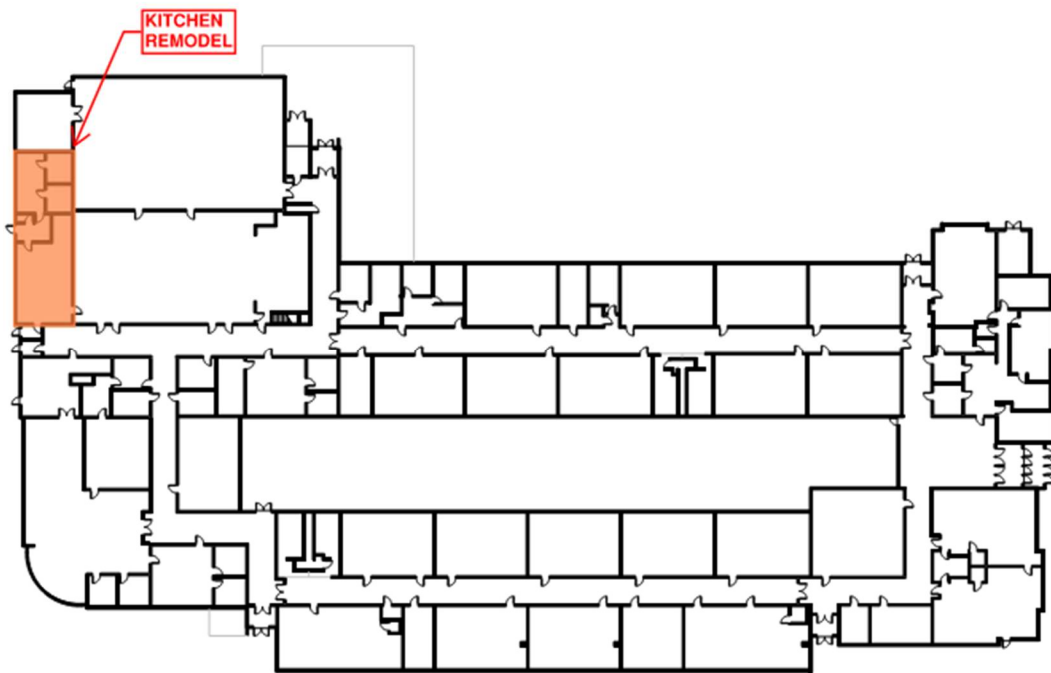

Project Description

Programming Improvements

1. **Improve Learning Environment Acoustics:** Allowance to improve acoustics in learning spaces.

Harley Hopkins Early Childhood

Project Description

Programming Improvements

- **Building Addition:** Addition to provide dedicated staff collaboration and workspace, this addition frees up space in existing building for additional learning space. Scope includes partial remodel of existing to make connection, additional office space, and furniture allowance.
- **ADA Restroom Upgrades:** Upgrade outdated restrooms to be ADA compliant. Scope includes update fixtures, finishes and partitions.

Civil & Grounds Improvements

- **South & West Playground:** Replace the existing playgrounds with new ADA compliant playground equipment. Install new rubber surface fall protection. Construct new underground stormwater retention and infiltration systems.
- **Parking Lot:** Construct a new addition to the North Parking Lot with a new bituminous pavement section.

Safety & Security Improvements

- **Security Improvements:** Provide an allowance to address facility wide security improvements including additional interior and exterior security cameras, exit door alarms, locking interior door hardware, and a dry fire suppression system in the data room to increase building safety and security.

Proposed Plans

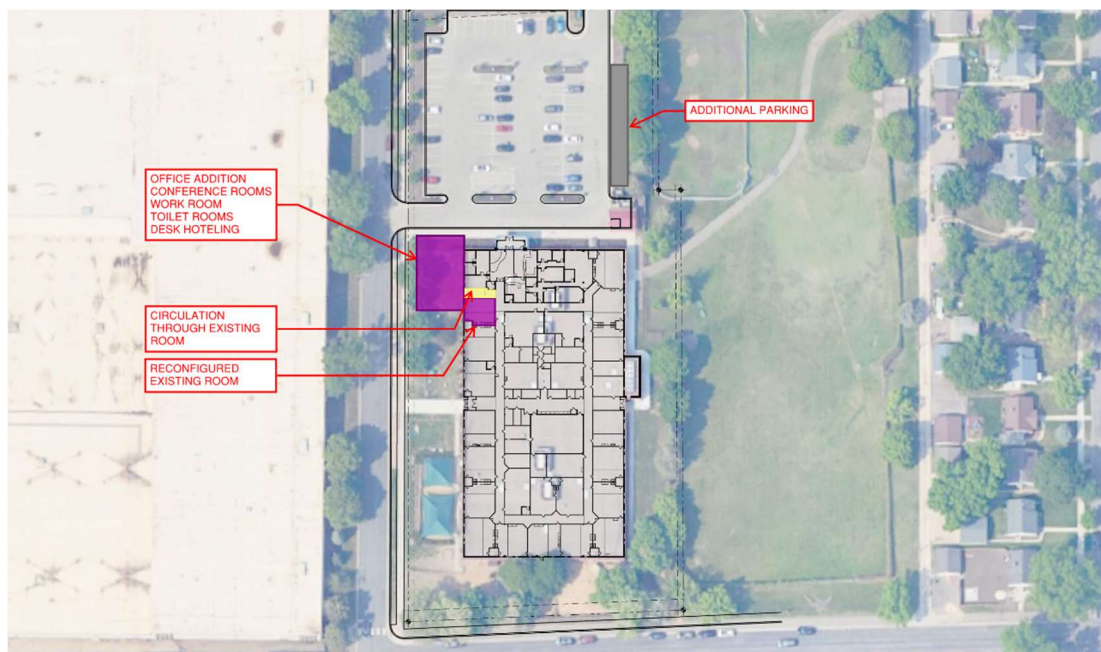

Alice Smith Elementary

Project Description

Programming Improvements

- **Gymnasium Addition (ICC 500 Storm Shelter):** New gym will provide additional programming space and be built as an ICC 500 storm shelter.
- **Safe & Secure Entry, Main Office Addition:** Office and entry addition to create stronger connection for improved safety. Renovate and reconfigure portion of existing office and entry. Includes furniture allowance.
- **New Flexible Furniture:** Allowance to replace outdated furniture with flexible furniture.
- **ADA Restroom Upgrades:** Upgrade outdated restrooms to be ADA compliant. Scope includes update fixtures, finishes and partitions.

Civil & Grounds Improvements

- **West Playground:** Replace the existing playground with new ADA compliant playground equipment. Install new rubber surface fall protection. Construct new underground stormwater retention and infiltration system.

Safety & Security Improvements

- **Security Improvements:** Provide an allowance to address facility wide security improvements including additional interior and exterior security cameras, building and pole mounted exterior surface lights, exit door alarms, interior door segmentation provisions, and a dry fire suppression system in the data room to increase building safety and security.

Proposed Plans

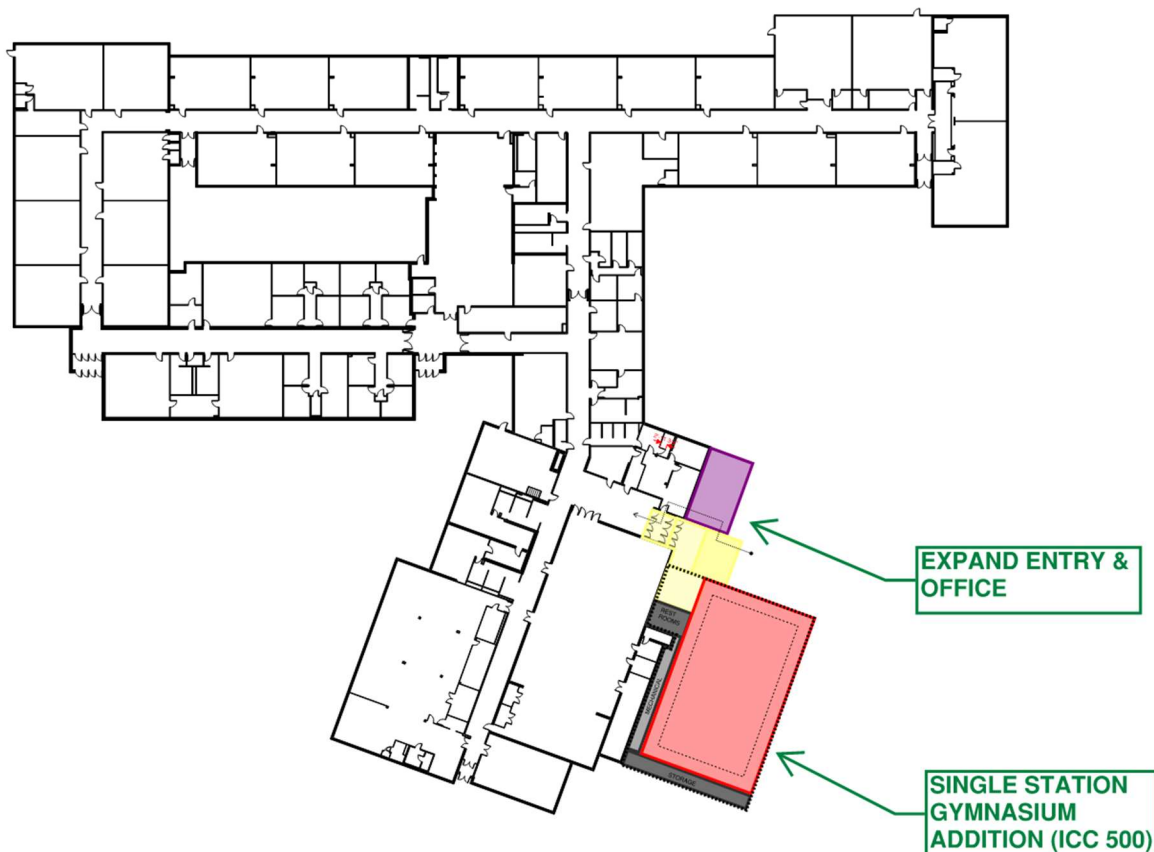

Eisenhower Elementary

Project Description

Programming Improvements

- **Gymnasium Addition (ICC 500 Storm Shelter):** New Gym to be building with dedicated use for scholars. New gym to be built as ICC 500 Storm Shelter.
- **Reconfigure Band & Music Rooms:** Remodel and reconfigure to include additional practice rooms of varied sizes to support current programming needs.
- **ADA Restroom Upgrades:** Upgrade outdated restrooms to be ADA compliant. Scope includes update fixtures, finishes and partitions.
- **Reconfigure Playground:** Reconfiguration and partial relocation of playground to make room for gymnasium addition.

Safety & Security Improvements

- **Security Improvements:** Provide an allowance to address facility wide security improvements including additional interior and exterior security cameras, building and pole mounted exterior surface lights, exit door alarms, interior door segmentation provisions, and a dry fire suppression system in the data room to increase building safety and security.

Proposed Plans

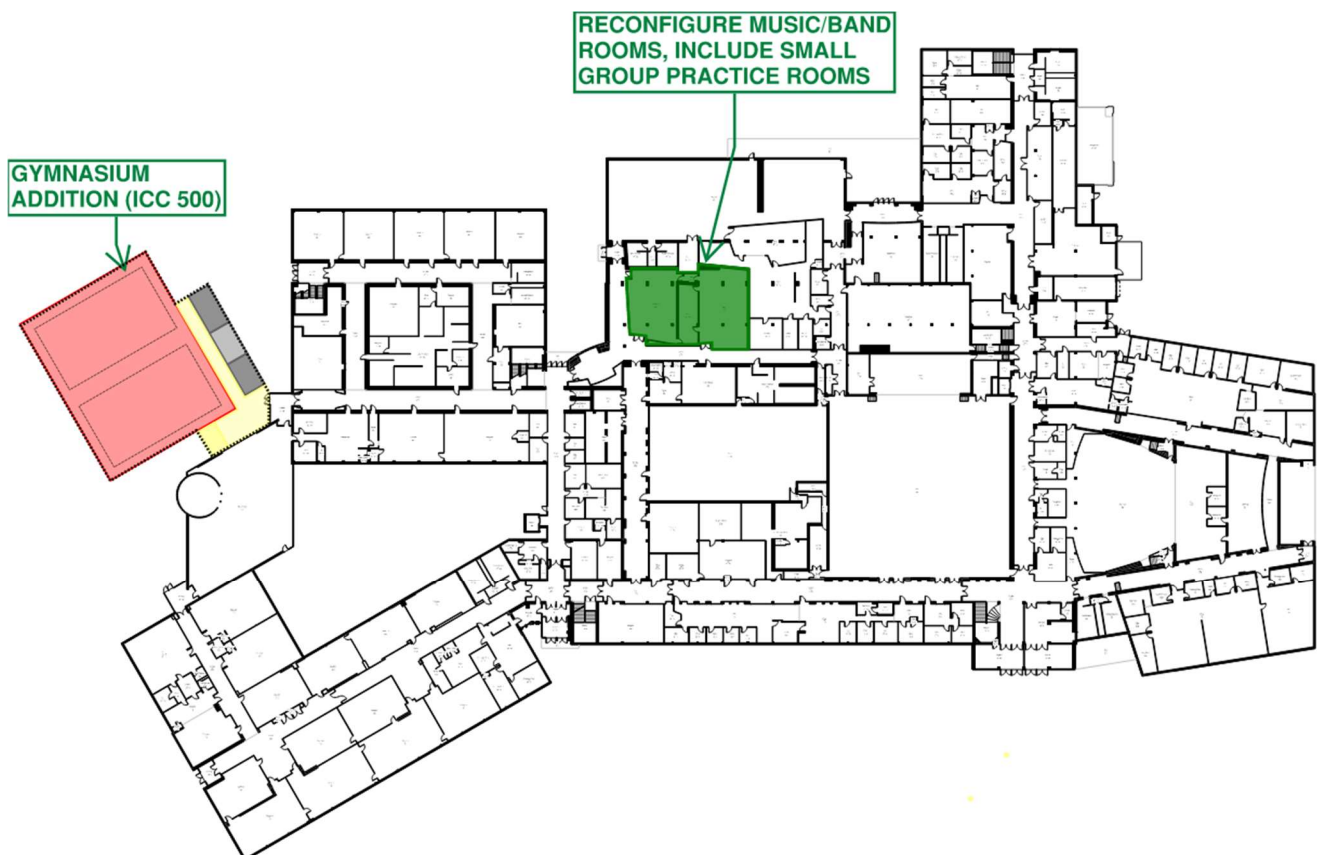

Gatewood Elementary

Project Description

Programming Improvements

- **Outdoor Learning Lab with Restrooms & Storage:** Outdoor learning lab with restrooms, storage, and shade structure to support schools outdoor learning initiative.
- **Reconfigure Reception & Entry to Improve Safety & Security:** Current layout has poor sightlines, remodel and reconfigure to create stronger visual connection from reception to entrance vestibule.

Civil & Grounds Improvements

- **New Sport Court:** Sport court for added outdoor programming.
- **Chain-Link Fence:** 6' chain link fence at back of site from SW to NE corner.

Safety & Security Improvements

- **Security Improvements:** Provide an allowance to address facility wide security improvements including additional interior and exterior security cameras, building and pole mounted exterior surface lights, exit door alarms, locking interior door hardware, interior door segmentation provisions, a dry fire suppression system in the data room, and expanded exterior card reader access to increase building safety and security.

Proposed Plans



Glen Lake Elementary

Project Description

Programming Improvements

- **Music Suite Addition (ICC 500 Storm Shelter):** Addition to support current music programming needs. Addition to be built as ICC 500 storm shelter.
- **Create Collaborative Learning Community:** Remodel existing traditional wing of school into a collaborative, flexible learning community. Space will provide flexible classrooms, collaborative learning commons, and breakout spaces.
- **Remodel into Special Education Suite:** Remodel existing spaces into dedicated special education suite.
- **ADA Restroom Upgrades:** Upgrade outdated restrooms to be ADA compliant. Scope includes update fixtures, finishes and partitions.

Civil & Grounds Improvements

- **South Playground:** Replace the existing playground with new ADA compliant playground equipment. Install new rubber surface fall protection. Construct new underground stormwater retention and infiltration system. Reconstruct the existing wood staircase with a concrete staircase.

Safety & Security Improvements

- **Security Improvements:** Provide an allowance to address facility wide security improvements including additional interior and exterior security cameras, building and pole mounted exterior surface lights, exit door alarms, interior door segmentation provisions, and a dry fire suppression system in the data room to increase building safety and security.

Proposed Plans

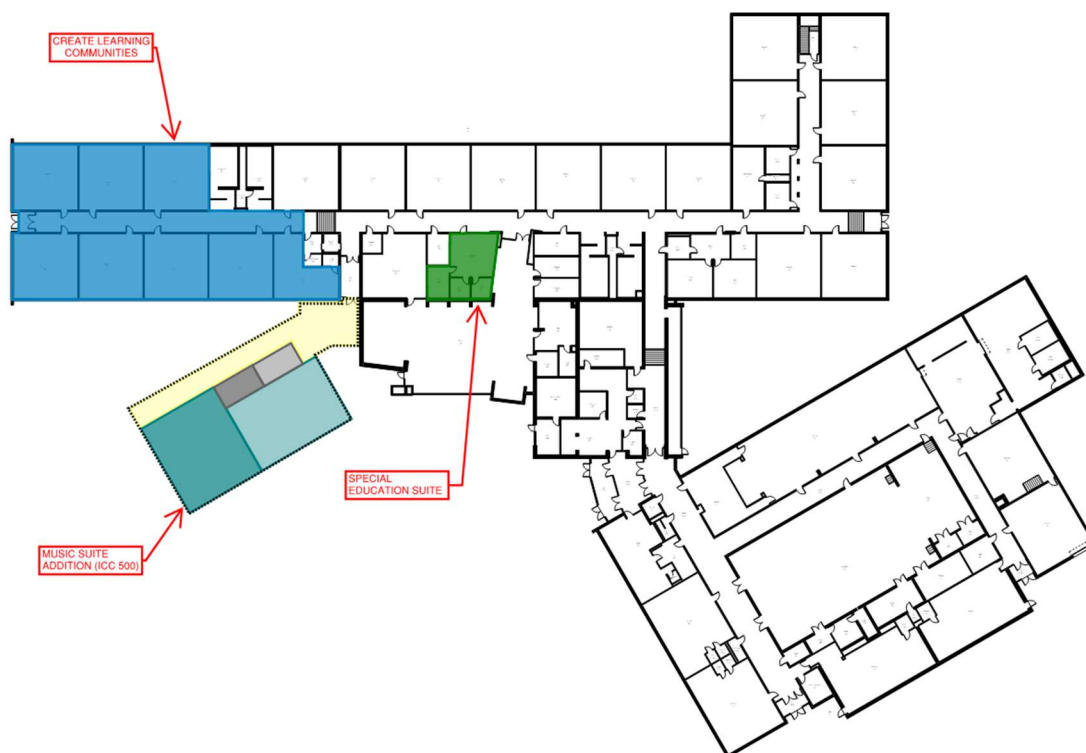

Meadowbrook Elementary

Project Description

Programming Improvements

- **Pathfinder Project:** As the only Pathfinder project composed entirely of renovation, Meadowbrook Elementary exemplifies how authentic inclusivity can be achieved within existing structures through intentional, human-centered design. Prioritizing the needs of students in the Special Education program, this transformation introduced bright, calming, and flexible spaces, shifting from marginal, windowless rooms to a holistically safe environment infused with natural light, sensory-responsive areas, and visible educator support zones. Features like inclusive restrooms, calming rooms, and both indoor and outdoor motor spaces extend psychological safety and dignity to all students. By reimagining an underutilized area into a model learning community, Meadowbrook reflects the district's commitment to love, humility of heart, and optimistic innovation, proving that renovation can be every bit as transformative as new construction.
- **ADA Restroom Upgrades:** Upgrade outdated restrooms to be ADA compliant. Scope includes update fixtures, finishes and partitions.

Civil & Grounds Improvements

- **North & Northeast Playground:** Replace the existing playground with new ADA compliant playground equipment. Install new rubber surface fall protection. Construct new underground stormwater retention and infiltration systems.

Safety & Security Improvements

- **Security Improvements:** Provide an allowance to address facility wide security improvements including additional interior and exterior security cameras, building and pole mounted exterior surface lights, exit door alarms, interior door segmentation provisions, and a dry fire suppression system in the data room to increase building safety and security.

Proposed Plans

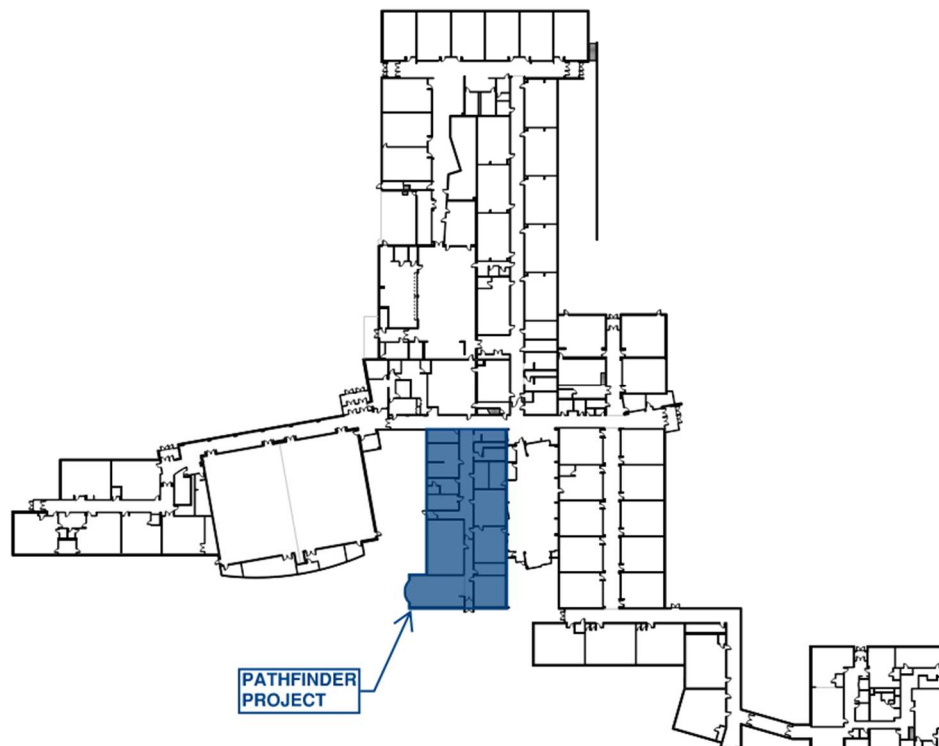

Pathfinder Location | Meadowbrook Elementary



- A** Renovation: 10,800 SF
- B** Landscape / Sitework: 8,000 SF

Floor Plan | Meadowbrook Elementary



Main Commons | Meadowbrook Elementary



The main commons is an enriching environment with many areas for individuals and small groups to find a spot to work.

The teacher collaboration room is to the right of this scene with good visibility into the main commons.

The motor sensory room is in the far corner with access to the outdoors.



L.H. Tanglen Elementary

Project Description

Programming Improvements

- **Main Office Addition:** Addition to provide additional space for main office, reception, and improve connection to secure entry vestibule to provide stronger visual connection to those entering and leaving the building.
- **Café Remodel, Add Exterior Windows:** Remodel cafeteria, expand into storage rooms and add windows at exterior wall.
- **ADA Restroom Upgrades:** Upgrade outdated restrooms to be ADA compliant. Scope includes update fixtures, finishes and partitions.

Safety & Security Improvements

- **Security Improvements:** Provide an allowance to address facility wide security improvements including additional interior and exterior security cameras, building and pole mounted exterior surface lights, exit door alarms, locking interior door hardware, a dry fire suppression system in the data room, and expanded exterior card reader access to increase building safety and security.

Proposed Plans

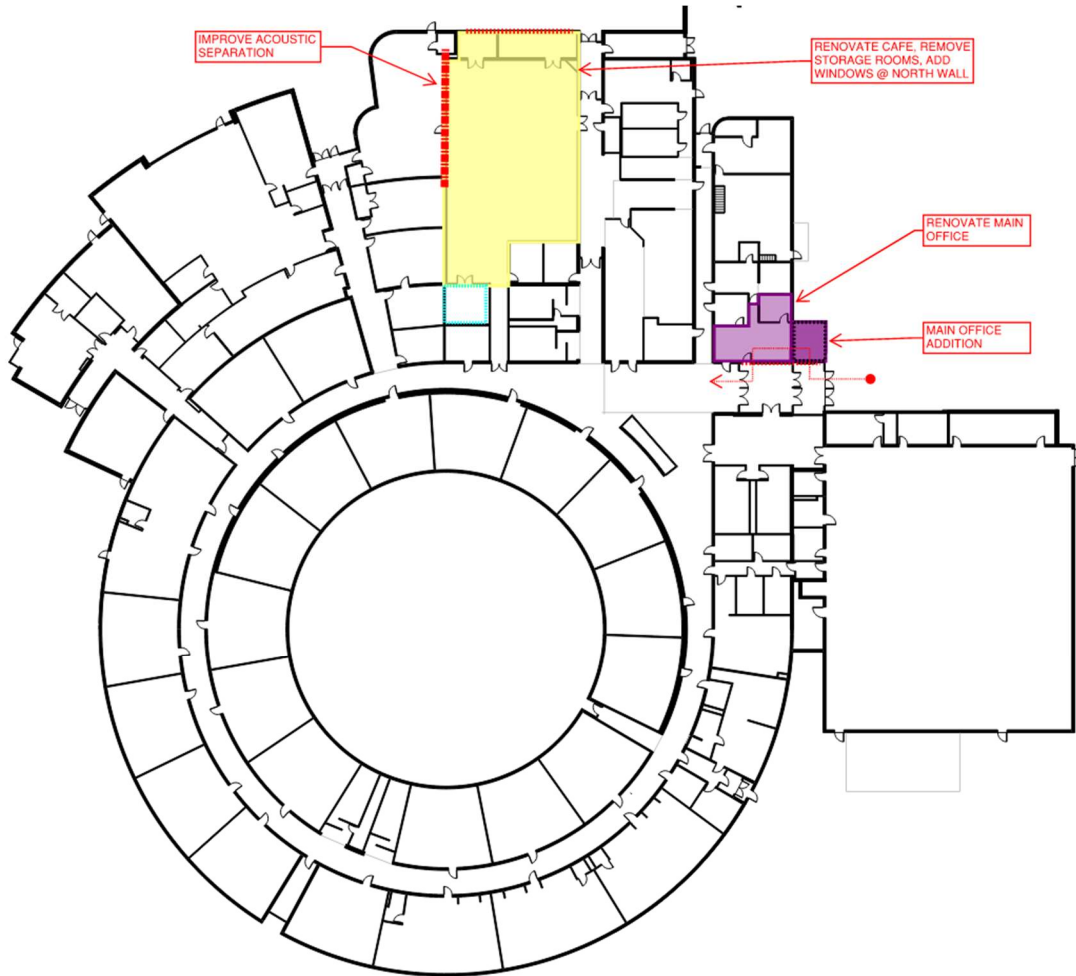

Hopkins North Middle School

Project Description

Programming Improvements

- **Pathfinder Project:** The North Middle School Pathfinder illuminates what it means to create a holistically safe and empowering learning ecosystem for early adolescent students. Designed for the full 6th-grade cohort, this environment breaks away from isolating traditional models and instead fosters agency, inclusivity, and deep belonging. Four diverse outdoor learning spaces, a flexible learning café, and an integrated stage invite students into moments of performance, reflection, movement, and connection, fostering physical, emotional, and intellectual growth. Nest and cave elements, inclusive restrooms, and calming rooms offer the comfort of choice and privacy, while clerestory windows and semi-private commons transform once windowless corridors into vibrant hubs of curiosity and community. Rooted in authentic inclusivity, humility of heart, and a belief that every child deserves to feel seen and inspired, the North Middle School Pathfinder charts a bold, compassionate course for middle school learning.. Additions to be built as ICC 500 Storm Shelter.
- **ADA Restroom Upgrades:** Upgrade outdated restrooms to be ADA compliant. Scope includes update fixtures, finishes and partitions.

Civil & Grounds Improvements

- **New Entrance Drive:** Construct a new entrance intersection at Greenbrier Road. Construct a new perimeter drive lane on the east side of the school. Replace and reconfigure the east baseball and softball fields.

- **New Outdoor Challenge Course:** Construct a new playground with outdoor fitness focus, include ADA compliant equipment.

Safety & Security Improvements

- **Security Improvements:** Provide an allowance to address facility wide security improvements including a video intercom at the main building entry, additional interior and exterior security cameras, building and pole mounted exterior surface lights, exit door alarms, and interior door segmentation provisions to increase building safety and security.

Proposed Plans

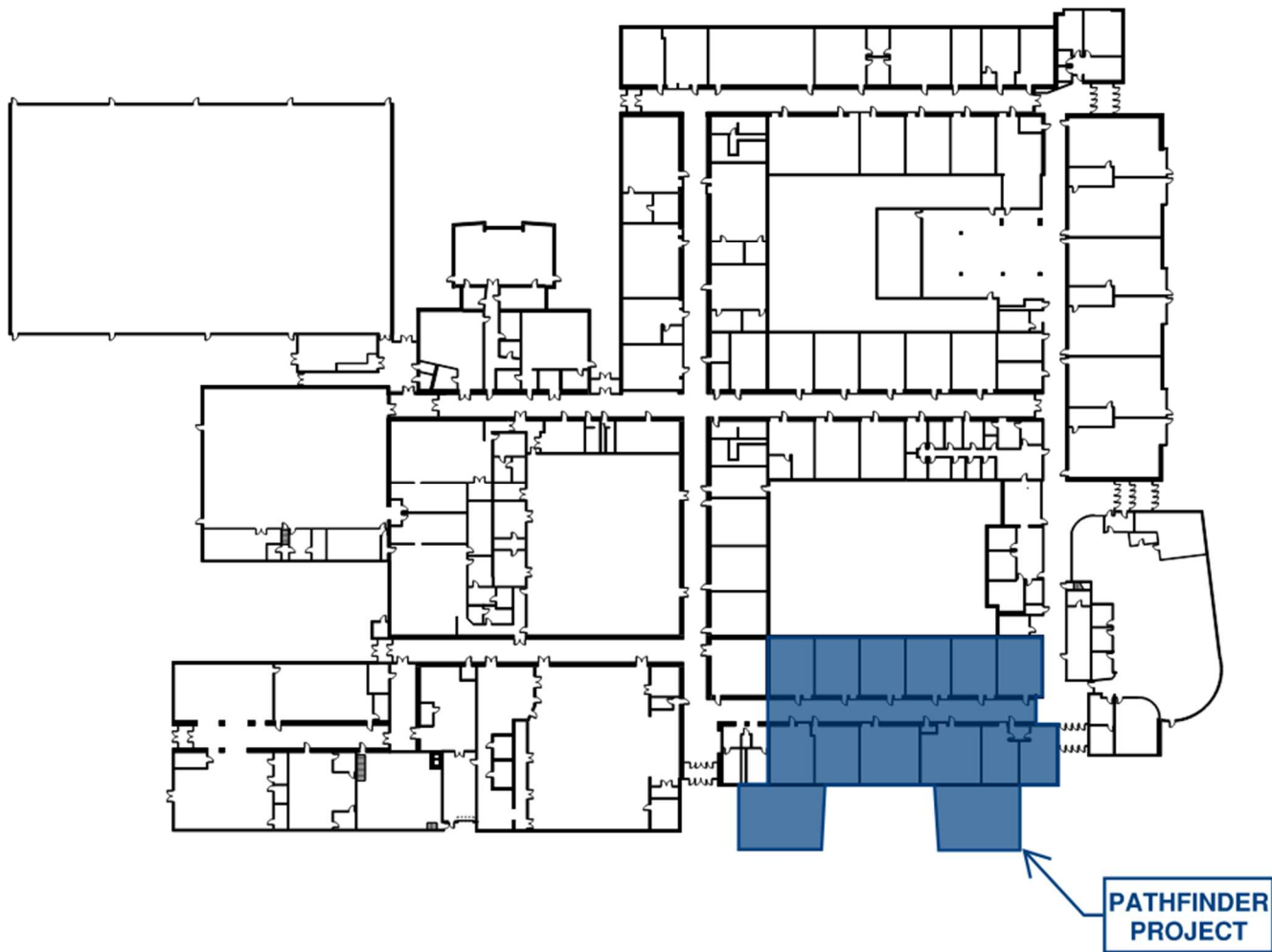

Pathfinder Location | North Middle School

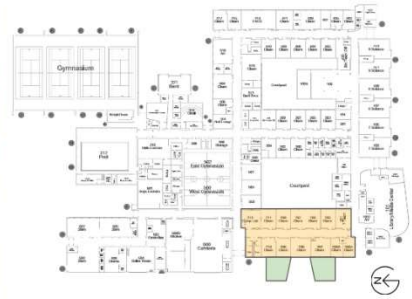

A Renovation: 10,800 SF

B New Construction: 3,000 SF

Floor Plan | North Middle School



Outdoor Pavilion | North Middle School



- 1 Operable Wall to Stage Commons
- 2 Vista into Nest Commons
- 3 Existing Trees Preserved
- 4 Casual Outdoor Seating



Hopkins West Middle School

Project Description

Programming Improvements

- **Pathfinder Project:** The West Middle School Pathfinder embodies an intentionally adventurous spirit rooted in curiosity, connection, and wellness. Serving the entire 8th-grade cohort, this project blends renovation with targeted new construction to craft a learning environment where scholars are empowered to explore, reflect, and collaborate. Key features such as the Active Lab, Project Studio, and flexible commons encourage intellectual risk-taking and authentic problem-solving, aligning directly with Hopkins' values of optimistic innovation and learner agency. Unique spatial experiences like the crow's nest, calming cave spaces, and multi-scaled commons areas cultivate psychological and intellectual safety, while views to the outdoors, strategic ceiling heights, and biophilic features reinforce a sense of openness and vitality. Every element is infused with purpose: to ignite learners' potential while honoring the human need for both adventure and refuge. Addition to be built at ICC 500 Storm Shelter.
- **ADA Restroom Upgrades:** Upgrade outdated restrooms to be ADA compliant. Scope includes update fixtures, finishes and partitions.

Civil & Grounds Improvements

- **Parking Lots:** Reconstruct the existing North and visitor bituminous surfaced parking lots with a new bituminous pavement section. Replace all existing watermain and sanitary sewer utilities. Construct new underground stormwater retention and infiltration systems.
- **New Outdoor Challenge Course:** Construct a new playground with outdoor fitness focus, include ADA compliant equipment.

Safety & Security Improvements

- **Security Improvements:** Provide an allowance to address facility wide security improvements including additional interior and exterior security cameras, exit door alarms, locking interior door hardware, interior door segmentation provisions, and a dry fire suppression system in the data room to increase building safety and security.
-

Proposed Plans

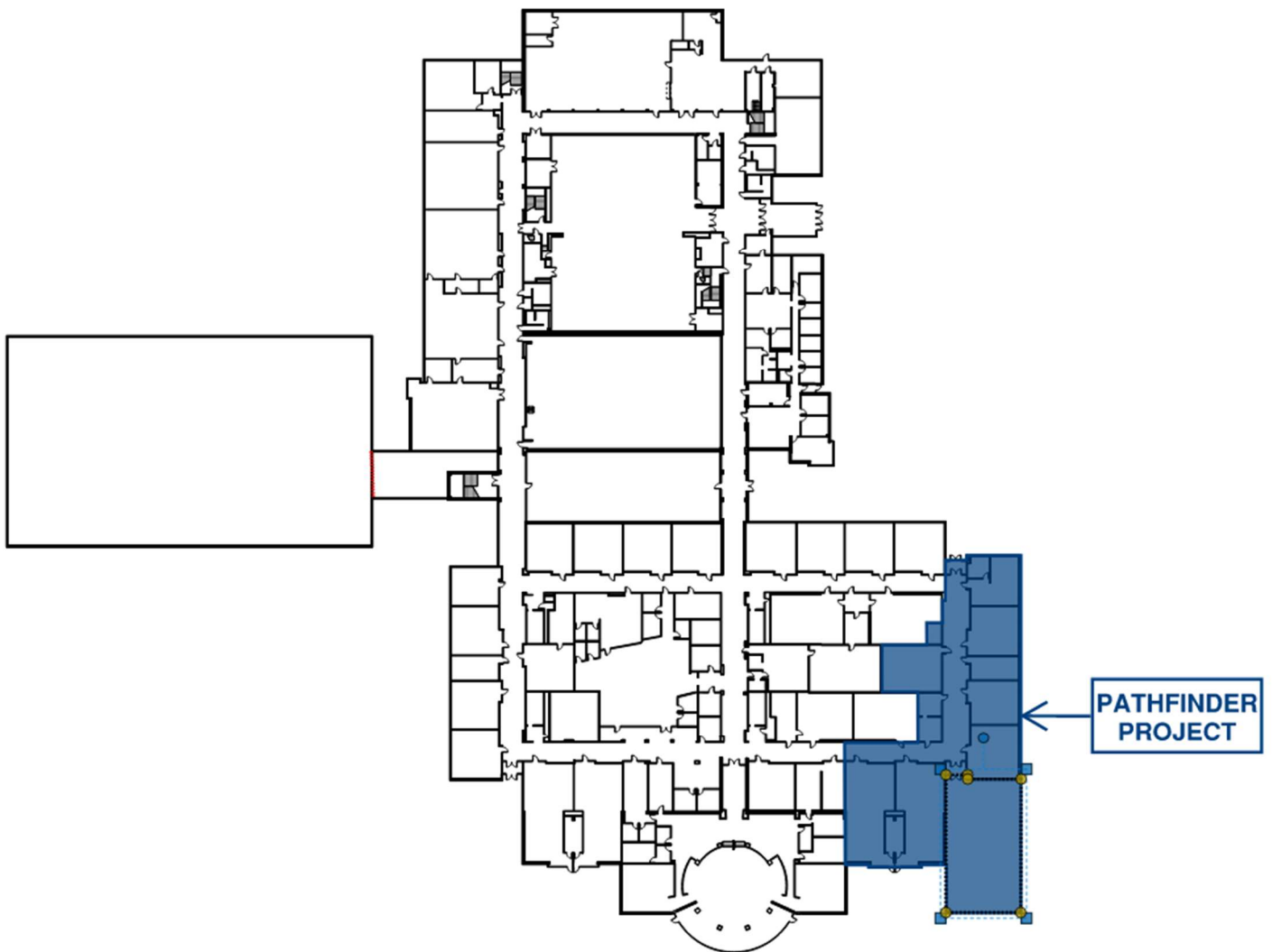

Pathfinder Location | West Middle School

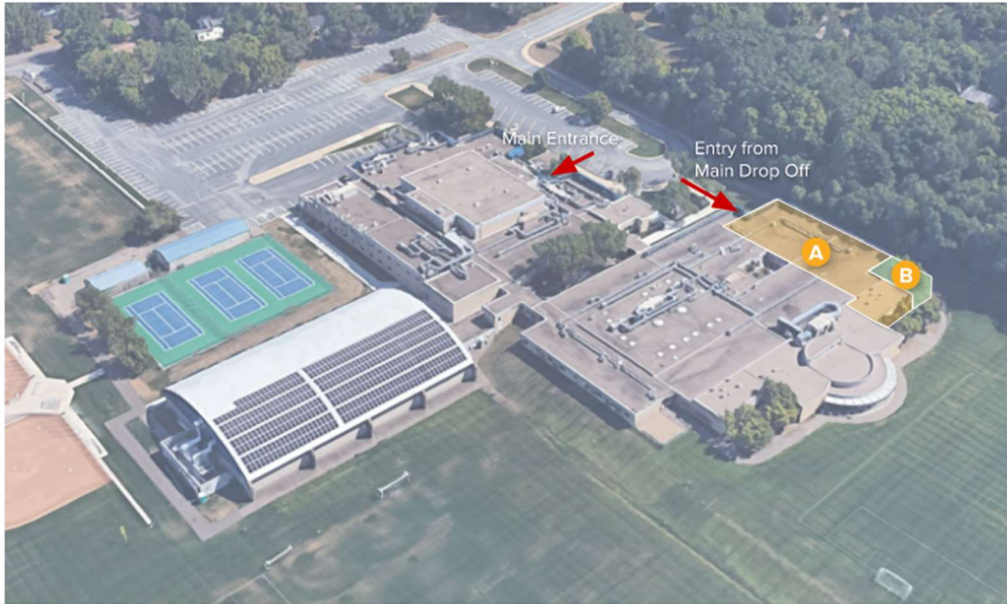

A Renovation: 10,800 SF

B New Construction: 2,900SF

Floor Plan | West Middle School



Flex Commons | West Middle School



- 1 Overhead Door (connects to courtyard)
- 2 Operable Wall (connects to Special Ed Area)
- 3 Operable Wall (to close off commons when desired)
- 4 Cozy Cave Space
- 5 Flooring to Bring Spaces Together



Hopkins High School

Project Description

Programming Improvements

- **Pathfinder Project:** The Hopkins High School Pathfinder signals a bold step forward in creating environments that reflect student voice, foster autonomy, and build meaningful adult-student relationships. Unlike the other four, this project is primarily new construction and serves as both a symbolic and functional anchor for Vision 2031. It features two learning communities, each comprised of a flexible suite of spaces that vary in size, character, and function. These spaces are grounded in physical and intellectual safety, offering diverse opportunities for project-based learning, social connection, and restorative support. Elements like the gathering stair, learning café, restorative studio, and multiple small-group spaces provide students with both choice and structure—an ideal blend for developing agency and confidence. With its corner market, outdoor terraces, and ample natural light, the space becomes a beacon of optimistic innovation, designed not just for instruction but for expression, collaboration, and well-being across the entire school and community. Addition to be built at ICC 500 Storm Shelter.
- **CTE Remodel & Reconfiguration:** Remodel & Reconfiguration of CTE Wing to support current & future programming needs.
- **Safe & Secure Entry Addition & Reconfiguration:** Construct new secure entry vestibule with connection to existing main office. Includes plaza design, signage, and landscaping to create a welcoming entry condition.
- **Music Recording Studio & Digital Media Lab:** Remodel & reconfigure to support music programming, recording, digital media and performance space with new overhead door to commons space.
- **Add Single-User Restrooms Near Cafeteria:** Remodel existing space into single-user restrooms. Current nearest restrooms are not convenient for scholars during dining times, distance creates safety and behavioral concerns.

- **New Multi-Sport Dome:** Enclose existing turf practice field with seasonal multi-sport dome to support current programming needs.
- **ADA Restroom Upgrades:** Upgrade outdated restrooms to be ADA compliant. Scope includes update fixtures, finishes and partitions.

Civil & Grounds Improvements

- **Softball, Soccer Field Lighting:** Install new lights for all synthetic turf fields that currently do not have lights.
- **Stadium Fields New Lighting:** Replace the existing stadium lights. All new lights will be LED.
- **Stadium Fields New Scoreboard:** Install a new stadium LED scoreboard.

Safety & Security Improvements

- **Security Improvements:** Provide an allowance to address facility wide security improvements including additional interior and exterior security cameras, building and pole mounted exterior surface lights, exit door alarms, locking interior door hardware to increase building safety and security.

Proposed Plans

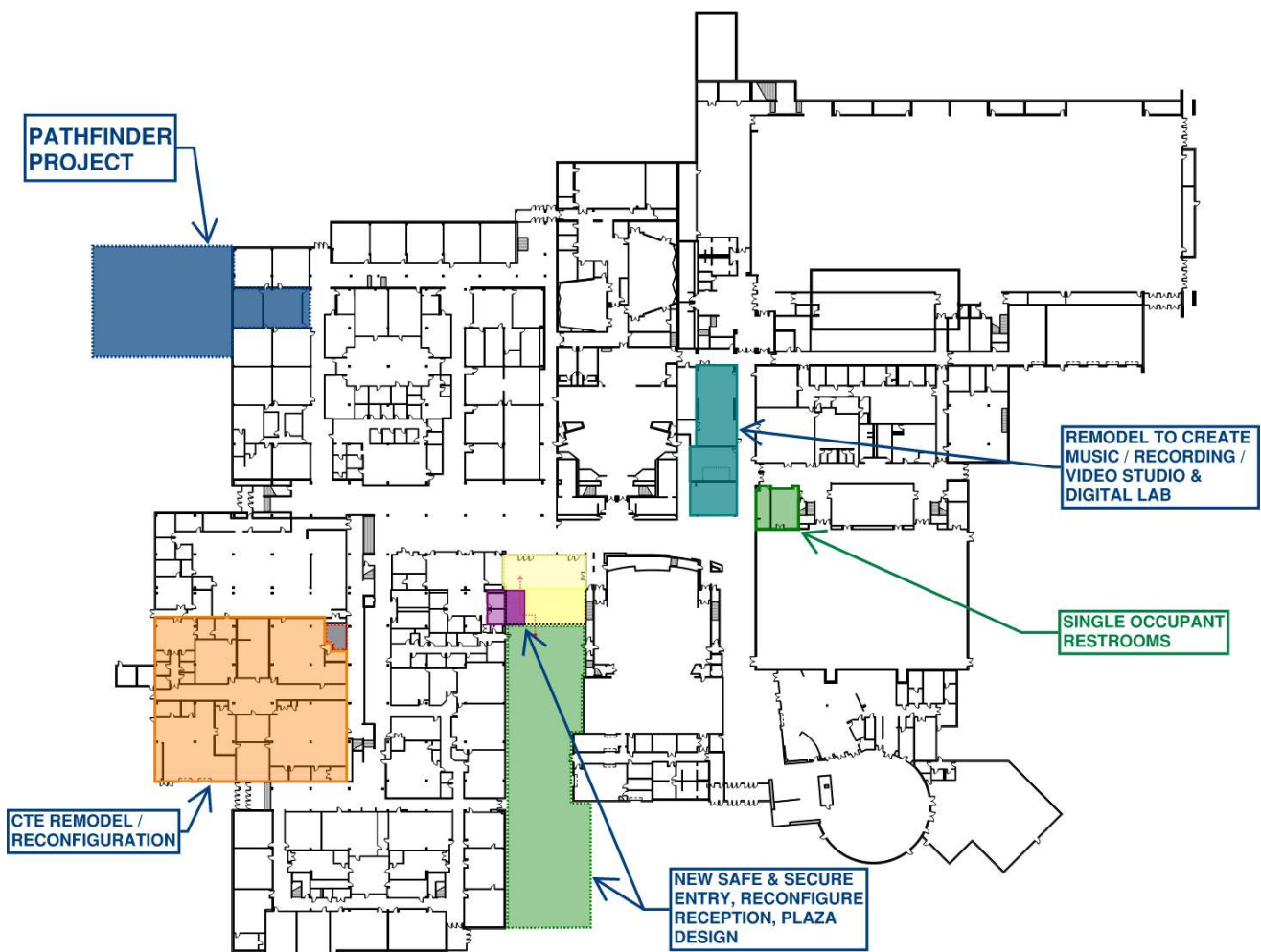

Pathfinder Location | Hopkins High School

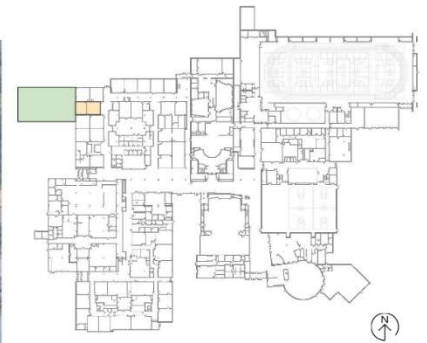

A Renovation: 3,000 SF

B New Construction: 18,500 SF

Ground Floor Plan | Hopkins High School

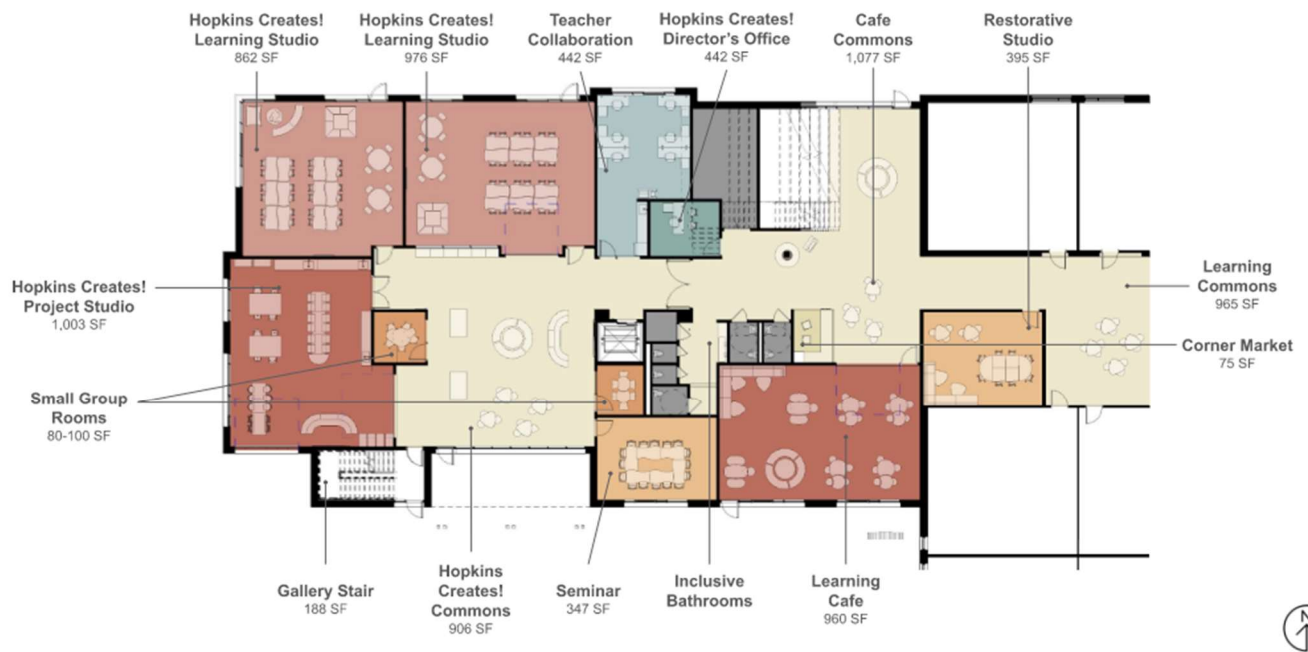

Second Floor Plan | Hopkins High School



Exterior Courtyard | Hopkins High School



A Royal Awakening has a spectacular south-facing courtyard and an accessible roof deck. The overhead doors and the project balcony are elements to make indoor-outdoor connections seamless.

A Vision 2031 Meandering Path will showcase the Hopkins way in this highly visible part of the campus, as this is adjacent to the sport fields.



Civil & Grounds Improvements

- **Concrete, Sidewalks, and Parking Lots:** reconstruct the existing concrete and bituminous pavement sections and add new sidewalks.
- **Watermain and sanitary sewer lines:** install new watermain and sanitary sewer utilities.
- **Stormwater management system:** install new stormwater management systems.
- **Lighting:** Installation of new exterior LED lights

Safety & Security Improvements

- **Security Improvements:** Provide an allowance to address facility wide security improvements including additional interior and exterior security cameras, building and pole mounted exterior surface lights, exit door alarms, locking interior door hardware to increase building safety and security.

Project Budget**Question 1:**

Shall the school board of Independent School District No. 270 (Hopkins Public Schools) be authorized to issue its general obligation school building bonds in an amount not to exceed \$139,375,000 to provide funds for the acquisition and betterment of school sites and facilities, including the construction, acquisition and installation of safety and security improvements; the completion of various infrastructure projects at school district sites and facilities, including renovations for Career and Technical Education, ADA updates, parking lot reconstruction, playgrounds, outdoor learning areas, indoor and outdoor athletic enhancements, and modernization of learning spaces, including special education environments?

Question 1	
Hopkins Public Schools	
Renovations	\$ 21,329,429
Addition	\$ 61,562,884
Technology/FF&E	\$ 4,626,503
Site Improvements	\$ 25,015,911
Soft Costs	\$ 21,182,000
Contingency	\$ 5,658,274
Total	\$ 139,375,000

Question 1	
Hopkins Public Schools	
Programming	\$ 77,809,871
Infrastructure	\$ 28,127,172
Safety and Security	\$ 4,264,010
Activities	\$ 2,333,674
Soft Costs	\$ 21,182,000
Contingency	\$ 5,658,274
Total	\$ 139,375,000

Ballot Question	Building	Short Description	Hard Costs
Question 1	Hopkins HS	ADA Upgrades to meet 20% Requirement	\$1,320,594
Question 1	Hopkins HS	Softball Soccer Fields New Lights	\$719,923
Question 1	Hopkins HS	Stadium Fields New Lights	\$514,715
Question 1	Hopkins HS	Stadium Fields New Scoreboard	\$719,923
Question 1	Hopkins HS	Multisport Dome	\$5,444,934
Question 1	Hopkins HS	Pathfinder Project	\$15,964,117
Question 1	Hopkins HS	Safe & Secure Entry Addition/Reconfiguration	\$1,838,799
Question 1	Hopkins HS	CTE Remodel & Reconfiguration	\$5,338,272
Question 1	Hopkins HS	Music Recording Studio / Digital Media Lab	\$1,441,915
Question 1	Hopkins HS	Add Single-User Restrooms Near Cafeteria	\$375,881
Question 1	Hopkins HS	Pathfinder Storm Shelter	\$1,506,920
Question 1	Hopkins HS	Video Intercom for Entry Allowance	\$5,226
Question 1	Hopkins HS	Interior Security Camera Allowance	\$55,490
Question 1	Hopkins HS	Exterior Security Camera Allowance	\$106,929
Question 1	Hopkins HS	Exterior Surface Mounted Lights Allowance - On Building	\$74,128
Question 1	Hopkins HS	Exterior Surface Mounted Lights Allowance - Pole Lights	\$230,855
Question 1	Hopkins HS	Exit Door Alarm Allowance	\$72,513
Question 1	Hopkins HS	Locking Door Hardware Allowance	\$56,503

Hard Cost Total	\$35,787,636
------------------------	---------------------

Contingency	\$ 1,749,881
Soft Cost	\$ 6,803,333

Grand Total	\$ 44,340,850
--------------------	----------------------

Question 1	
Hopkins High School	
Renovation	\$8,647,538
Addition	\$23,550,493
Technology/FF&E	\$1,635,044
Site Improvements	\$1,954,561
Soft Costs	\$6,803,333
Contingency	\$1,749,881
Total	\$44,340,850

Question 1

Hopkins High School	
Programming	\$27,786,497
Infrastructure	\$5,444,934
Safety and Security	\$601,644
Activities	\$1,954,561
Soft Costs	\$6,803,333
Contingency	\$1,749,881
Total	\$44,340,850

Ballot Question	Building	Short Description	Hard Costs
Question 1	Glen Lake Elem	ADA Upgrades to meet 20% Requirement	\$99,638
Question 1	Glen Lake Elem	South Playground	\$1,547,541
Question 1	Glen Lake Elem	Band & Choir Addition	\$2,981,102
Question 1	Glen Lake Elem	Remodel Existing to Create Learning Communities	\$3,321,179
Question 1	Glen Lake Elem	Remodel into Special Education Suite	\$54,075
Question 1	Glen Lake Elem	Interior Security Camera Allowance	\$27,745
Question 1	Glen Lake Elem	Exterior Security Camera Allowance	\$85,459
Question 1	Glen Lake Elem	Exterior Surface Mounted Lights Allowance - On Building	\$55,490
Question 1	Glen Lake Elem	Exterior Surface Mounted Lights Allowance - Pole Lights	\$92,342
Question 1	Glen Lake Elem	Exit Door Alarm Allowance	\$23,085
Question 1	Glen Lake Elem	Interior Door Segmentation Allowance	\$12,761
Question 1	Glen Lake Elem	Dry Fire Suppression System Allowance	\$24,303

Hard Cost Total	\$ 8,324,720
------------------------	---------------------

Contingency	\$ 413,708
--------------------	-------------------

Soft Cost	\$ 1,557,823
------------------	---------------------

Grand Total	\$ 10,296,250
--------------------	----------------------

Question 1	
Glen Lake Elementary	
Renovation	\$3,615,001
Addition	\$2,838,901
Technology/FF&E	\$323,276
Site Improvements	\$1,547,541
Soft Costs	\$1,557,823
Contingency	\$413,708
Total	\$10,296,250

Question 1	
Glen Lake Elementary	
Programming	\$6,455,994
Infrastructure	\$1,547,541
Safety and Security	\$321,185
Activities	\$0
Soft Costs	\$1,557,823
Contingency	\$413,708
Total	\$10,296,250

Ballot Question	Building	Short Description	Hard Costs
Question 1	Gatewood Elem	North Playground 1	\$1,851,957
Question 1	Gatewood Elem	North Playground 2	\$206,056
Question 1	Gatewood Elem	New Sport Court	\$379,113
Question 1	Gatewood Elem	Outdoor Learning Lab, Restrooms, & Storage	\$908,047
Question 1	Gatewood Elem	Chain-link Fence	\$110,980
Question 1	Gatewood Elem	Reconfigure Reception to Improve Safe & Secure Entry	\$199,291
Question 1	Gatewood Elem	Interior Security Camera Allowance	\$69,256
Question 1	Gatewood Elem	Exterior Security Camera Allowance	\$128,824
Question 1	Gatewood Elem	Exterior Surface Mounted Lights Allowance - On Building	\$29,566
Question 1	Gatewood Elem	Exterior Surface Mounted Lights Allowance - Pole Lights	\$86,677
Question 1	Gatewood Elem	Exit Door Alarm Allowance	\$28,963
Question 1	Gatewood Elem	Locking Door Hardware Allowance	\$12,357
Question 1	Gatewood Elem	Interior Door Segmentation Allowance	\$38,282
Question 1	Gatewood Elem	Dry Fire Suppression System Allowance	\$24,303
Question 1	Gatewood Elem	Card Access Reader Allowance	\$52,048

Hard Cost Total	\$4,125,720
------------------------	--------------------

Contingency	\$ 219,199
Soft Cost	\$ 774,580

Grand Total	\$5,119,500
--------------------	--------------------

Question 1	
Gatewood Elementary	
Renovation	\$605,831
Addition	\$922,024
Technology/FF&E	\$160,739
Site Improvements	\$2,437,126
Soft Costs	\$774,580
Contingency	\$219,199
Total	\$5,119,500

Question 1

Gatewood Elementary	
Programming	\$1,107,338
Infrastructure	\$2,058,013
Safety and Security	\$581,257
Activities	\$379,113
Soft Costs	\$774,580
Contingency	\$219,199
Total	\$5,119,500

Ballot Question	Building	Short Description	Hard Costs
Question 1	Alice Smith	ADA Upgrades to meet 20% Requirement	\$626,156
Question 1	Alice Smith	West Playground	\$2,060,559
Question 1	Alice Smith	Flexible Furniture Allowance	\$230,855
Question 1	Alice Smith	Safe & Secure Entry, Gymnasium Addition	\$3,483,395
Question 1	Alice Smith	Interior Security Camera Allowance	\$27,745
Question 1	Alice Smith	Exterior Security Camera Allowance	\$85,459
Question 1	Alice Smith	Exterior Surface Mounted Lights Allowance - On Building	\$55,490
Question 1	Alice Smith	Exterior Surface Mounted Lights Allowance - Pole Lights	\$46,171
Question 1	Alice Smith	Exit Door Alarm Allowance	\$23,085
Question 1	Alice Smith	Interior Door Segmentation Allowance	\$50,830
Question 1	Alice Smith	Dry Fire Suppression System Allowance	\$24,303

Hard Cost Total	\$6,714,048
------------------------	--------------------

Contingency	\$ 342,468
Soft Cost	\$ 1,257,984

Grand Total	\$ 8,314,500
--------------------	---------------------

Question 1	
Alice Smith	
Renovation	\$880,888
Addition	\$3,266,982
Technology/FF&E	\$478,620
Site Improvements	\$2,060,559
Soft Costs	\$1,257,984
Contingency	\$342,468
Total	\$8,287,500

Question 1

Alice Smith	
Programming	\$4,340,406
Infrastructure	\$2,060,559
Safety and Security	\$313,084
Activities	\$0
Soft Costs	\$1,257,984
Contingency	\$342,468
Total	\$8,314,500

Ballot Question	Building	Short Description	Hard Costs
Question 1	Meadowbrook Elem	ADA Upgrades to meet 20% Requirement	\$129,618
Question 1	Meadowbrook Elem	Northeast Playground	\$2,573,577
Question 1	Meadowbrook Elem	North Playground	\$514,715
Question 1	Meadowbrook Elem	Pathfinder Project	\$6,593,484
Question 1	Meadowbrook Elem	Interior Security Camera Allowance	\$69,256
Question 1	Meadowbrook Elem	Exterior Security Camera Allowance	\$128,824
Question 1	Meadowbrook Elem	Exterior Surface Mounted Lights Allowance - On Building	\$55,490
Question 1	Meadowbrook Elem	Exterior Surface Mounted Lights Allowance - Pole Lights	\$173,353
Question 1	Meadowbrook Elem	Exit Door Alarm Allowance	\$28,963
Question 1	Meadowbrook Elem	Interior Door Segmentation Allowance	\$38,282
Question 1	Meadowbrook Elem	Dry Fire Suppression System Allowance	\$24,303

Hard Cost Total	\$10,329,866
------------------------	---------------------

Contingency	\$ 526,704
Soft Cost	\$ 1,935,430

Grand Total	\$12,792,000
--------------------	---------------------

Question 1	
Meadowbrook Elementary	
Renovation	\$612,145
Addition	\$6,227,792
Technology/FF&E	\$401,637
Site Improvements	\$3,088,292
Soft Costs	\$1,935,430
Contingency	\$526,704
Total	\$12,792,000

Question 1	
Meadowbrook Elementary	
Programming	\$6,723,102
Infrastructure	\$3,088,292
Safety and Security	\$518,472
Activities	\$0
Soft Costs	\$1,935,430
Contingency	\$526,704
Total	\$12,792,000

Ballot Question	Building	Short Description	Hard Costs
Question 1	Tanglen Elem	ADA Upgrades to meet 20% Requirement	\$431,736
Question 1	Tanglen Elem	Main Office Addition	\$292,434
Question 1	Tanglen Elem	Café Remodel, add Exterior Windows	\$1,146,175
Question 1	Tanglen Elem	Interior Security Camera Allowance	\$55,490
Question 1	Tanglen Elem	Exterior Security Camera Allowance	\$106,929
Question 1	Tanglen Elem	Exterior Surface Mounted Lights Allowance - On Building	\$29,566
Question 1	Tanglen Elem	Exterior Surface Mounted Lights Allowance - Pole Lights	\$28,963
Question 1	Tanglen Elem	Exit Door Alarm Allowance	\$28,963
Question 1	Tanglen Elem	Locking Door Hardware Allowance	\$2,471
Question 1	Tanglen Elem	Dry Fire Suppression System Allowance	\$24,303
Question 1	Tanglen Elem	Card Access Reader Allowance	\$52,048

Hard Cost Total	\$2,199,080
------------------------	--------------------

Contingency	\$ 104,971
Soft Cost	\$ 410,749

Grand Total	\$ 2,714,800
--------------------	---------------------

Question 1	
Tanglen Elementary	
Renovation	\$1,832,743
Addition	\$281,099
Technology/FF&E	\$85,238
Site Improvements	\$0
Soft Costs	\$410,749
Contingency	\$104,971
Total	\$2,714,800

Question 1	
Tanglen Elementary	
Programming	\$1,870,345
Infrastructure	\$0
Safety and Security	\$328,735
Activities	\$0
Soft Costs	\$410,749
Contingency	\$104,971
Total	\$2,714,800

Ballot Question	Building	Short Description	Hard Costs
Question 1	Harley	ADA Upgrades to meet 20% Requirement	\$148,256
Question 1	Harley	South Playground	\$1,034,523
Question 1	Harley	West Playground	\$1,034,523
Question 1	Harley	North Parking Lot	\$103,028
Question 1	Harley	Staff Offices Addition	\$1,409,507
Question 1	Harley	Interior Security Camera Allowance	\$13,979
Question 1	Harley	Exterior Security Camera Allowance	\$42,729
Question 1	Harley	Exit Door Alarm Allowance	\$8,668
Question 1	Harley	Locking Door Hardware Allowance	\$12,357
Question 1	Harley	Dry Fire Suppression System Allowance	\$24,303

Hard Cost Total	\$3,831,873
------------------------	--------------------

Contingency	\$ 205,775
Soft Cost	\$ 719,802

Grand Total	\$ 4,757,450
--------------------	---------------------

Question 1	
Harley	
Renovation	\$227,767
Addition	\$1,282,660
Technology/FF&E	\$149,372
Site Improvements	\$2,172,074
Soft Costs	\$719,802
Contingency	\$205,775
Total	\$4,757,450

Question 1	
Harley	
Programming	\$1,557,763
Infrastructure	\$2,172,074
Safety and Security	\$102,036
Activities	\$0
Soft Costs	\$719,802
Contingency	\$205,775
Total	\$4,757,450

Ballot Question	Building	Short Description	Hard Costs
Question 1	District-Wide	District Wide Signage and Branding	\$577,561

Hard Cost Total	\$ 577,561
------------------------	-------------------

Contingency	\$ 27,563
Soft Cost	\$ 107,877

Grand Total	\$ 713,000
--------------------	-------------------

Question 1	
District-Wide	
Renovation	\$577,561
Addition	\$0
Technology/FF&E	\$0
Site Improvements	\$0
Soft Costs	\$107,877
Contingency	\$27,563
Total	\$713,000

Question 1	
District-Wide	
Programming	\$577,561
Infrastructure	\$0
Safety and Security	\$0
Activities	\$0
Soft Costs	\$107,877
Contingency	\$27,563
Total	\$713,000

Ballot Question	Building	Short Description	Hard Costs
Question 1	West Middle School	ADA Upgrades to meet 20% Requirement	\$174,180
Question 1	West Middle School	North Parking Lot	\$2,573,577
Question 1	West Middle School	Visitor Parking Lot	\$1,028,582
Question 1	West Middle School	New Playground Challenge Course	\$1,194,563
Question 1	West Middle School	Pathfinder Project	\$7,751,896
Question 1	West Middle School	Interior Security Camera Allowance	\$20,862
Question 1	West Middle School	Exterior Security Camera Allowance	\$42,729
Question 1	West Middle School	Exit Door Alarm Allowance	\$57,926
Question 1	West Middle School	Locking Door Hardware Allowance	\$29,572
Question 1	West Middle School	Interior Door Segmentation Allowance	\$76,564
Question 1	West Middle School	Dry Fire Suppression System Allowance	\$24,303

Hard Cost Total	\$ 12,974,754
------------------------	----------------------

Contingency	\$ 671,493
Soft Cost	\$ 2,432,753

Grand Total	\$ 16,079,000
--------------------	----------------------

Question 1	
West Middle School	
Renovation	\$399,830
Addition	\$7,273,362
Technology/FF&E	\$504,840
Site Improvements	\$4,796,722
Soft Costs	\$2,432,753
Contingency	\$671,493
Total	\$16,079,000

Question 1	
West Middle School	
Programming	\$7,926,076
Infrastructure	\$4,796,722
Safety and Security	\$251,956
Activities	\$0
Soft Costs	\$2,432,753
Contingency	\$671,493
Total	\$ 16,079,000

Ballot Question	Building	Short Description	Hard Costs
Question 1	Eisenhower Elem	ADA Upgrades to meet 20% Requirement	\$1,121,057
Question 1	Eisenhower Elem	Gym Addition	\$6,342,592
Question 1	Eisenhower Elem	Reconfigure Band & Music Rooms	\$812,462
Question 1	Eisenhower Elem	Interior Security Camera Allowance	\$55,490
Question 1	Eisenhower Elem	Exterior Security Camera Allowance	\$85,459
Question 1	Eisenhower Elem	Exterior Surface Mounted Lights Allowance - On Building	\$11,098
Question 1	Eisenhower Elem	Exterior Surface Mounted Lights Allowance - Pole Lights	\$28,963
Question 1	Eisenhower Elem	Exit Door Alarm Allowance	\$49,216
Question 1	Eisenhower Elem	Locking Door Hardware Allowance	\$24,714
Question 1	Eisenhower Elem	Card Access Reader Allowance	\$88,291

Hard Cost Total	\$8,619,342
------------------------	--------------------

Contingency	\$ 417,361
Soft Cost	\$ 1,610,997

Grand Total	\$10,647,700
--------------------	---------------------

Question 1	
Eisenhower Elementary	
Renovation	\$2,188,443
Addition	\$6,096,587
Technology/FF&E	\$334,311
Site Improvements	\$0
Soft Costs	\$1,610,997
Contingency	\$417,361
Total	\$10,647,700

Question 1	
Eisenhower Elementary	
Programming	\$8,276,111
Infrastructure	\$0
Safety and Security	\$343,230
Activities	\$0
Soft Costs	\$1,610,997
Contingency	\$417,361
Total	\$10,647,700

Ballot Question	Building	Short Description	Hard Costs
Question 1	Bus Depot	Parking Lots	\$3,599,613
Question 1	Bus Depot	Interior Security Camera Allowance	\$34,628
Question 1	Bus Depot	Exterior Security Camera Allowance	\$106,929
Question 1	Bus Depot	Exterior Surface Mounted Lights Allowance - Pole Lights	\$57,926
Question 1	Bus Depot	Card Access Reader Allowance	\$52,048

Hard Cost Total	\$3,851,145
------------------------	--------------------

Contingency	\$ 223,040
Soft Cost	\$ 726,316

Grand Total	\$4,800,500
--------------------	--------------------

Question 1	
Bus Depot	
Renovation	\$251,532
Addition	\$0
Technology/FF&E	\$0
Site Improvements	\$3,599,613
Soft Costs	\$726,316
Contingency	\$223,040
Total	\$4,800,500

Question 1	
Bus Depot	
Programming	\$0
Infrastructure	\$3,599,613
Safety and Security	\$251,532
Activities	\$0
Soft Costs	\$726,316
Contingency	\$223,040
Total	\$4,800,500

Ballot Question	Building	Short Description	Hard Costs
Question 1	Katherine Curren	Kitchen Remodel	\$669,100
Question 1	Katherine Curren	Interior Security Camera Allowance	\$55,490
Question 1	Katherine Curren	Exterior Security Camera Allowance	\$85,459
Question 1	Katherine Curren	Dry Fire Suppression System Allowance	\$24,303

Hard Cost Total	\$834,352
------------------------	------------------

Contingency	\$ 39,809
Soft Cost	\$ 155,839

Grand Total	\$ 1,030,000
--------------------	---------------------

Question 1	
Katherine Curren	
Renovation	\$834,352
Addition	\$0
Technology/FF&E	\$0
Site Improvements	\$0
Soft Costs	\$155,839
Contingency	\$39,809
Total	\$1,030,000

Question 1	
Katherine Curren	
Programming	\$669,100
Infrastructure	\$0
Safety and Security	\$165,252
Activities	\$0
Soft Costs	\$155,839
Contingency	\$39,809
Total	\$1,030,000

Ballot Question	Building	Short Description	Hard Costs
Question 1	Virtual EDU	Improve learning Environment Acoustics	\$115,852

Hard Cost Total	\$115,852
------------------------	------------------

Contingency	\$ 5,513
Soft Cost	\$ 21,635.90

Grand Total	\$ 143,000
--------------------	-------------------

Question 1	
Virtual EDU	
Renovations	\$115,852
Addition	\$0
Technology/FF&E	\$0
Site Improvements	\$0
Soft Costs	\$21,636
Contingency	\$5,513
Total	\$143,000

Question 1	
Virtual EDU	
Programming	\$115,852
Infrastructure	\$0
Safety and Security	\$0
Activities	\$0
Soft Costs	\$21,636
Contingency	\$5,513
Total	\$143,000

Hard Cost Total	\$112,534,726
Contingency	\$5,658,274
Soft Cost	\$21,182,000
Grand Total	\$139,375,000

Meadowbrook Elementary - Pathfinder	
Common Space	\$ 781,029
Educational Space	\$ 1,890,065
Equipment Space	\$ 398,049
MEP (Mechanical, Electrical, Plumbing)	\$ 2,298,184
Office Space	\$ 672,056
Restrooms	\$ 138,179
Site Work	\$ 343,034
Storage	\$ 47,888

Tanglen Elementary- Main Office Addition	
Furniture	\$ 7,268
Office Space	\$ 285,166

Eisenhower - Reconfigure Band & Music Rooms	
Band & Music Room	\$ 687,482
Equipment	\$ 62,490
Furniture	\$ 62,490

West Middle School - Pathfinder Project	
Commons	\$ 1,222,853
Educational Space	\$ 2,382,473
Infrastructure	\$ 626,545
MEP (Mechanical, Electrical, Plumbing)	\$ 2,925,043
Restrooms	\$ 40,977
Site Work	\$ 469,864
Storage	\$ 64,534

Tanglen Elementary - Café Remodel, add Exterior Windows	
Café Remodel	\$ 892,646
Furniture	\$ 115,526
Infrastructure	\$ 138,003

Alice Smith Elementary- Safe & Secure Entry, Gymnasium Addition	
Furniture	\$ 18,784
Gym Space	\$ 2,262,562
Infrastructure	\$ 479,496
MEP (Mechanical, Electrical, Plumbing)	\$ 146,305
Office Space	\$ 314,056
Restrooms	\$ 82,731
Storage	\$ 179,461

Harley - Staff Offices Addition	
Conference Rooms	\$ 341,201
Corridor Space	\$ 39,828
Furniture	\$ 87,864
Infrastructure	\$ 13,571
Office Space	\$ 835,681
Restrooms	\$ 31,491
Storage	\$ 59,871

Eisenhower - Gym Addition	
Gym Space	\$ 5,546,474
MEP (Mechanical, Electrical, Plumbing)	\$ 139,521
Restrooms	\$ 114,023
Secure Entry	\$ 312,008
Site Work	\$ 274,587
Storage	\$ 77,343

Hopkins High School - Pathfinder	
Commons	\$ 941,920
Educational Space	\$ 4,733,311
Equipment	\$ 75,346
Infrastructure	\$ 3,876,653
MEP (Mechanical, Electrical, Plumbing)	\$ 7,059,661
Office Space	\$ 64,725
Restrooms	\$ 239,833
Site work	\$ 585,639
Storage	\$ 68,949

Safe & Secure Entry Addition/Reconfiguration - HS	
Entry Commons	\$ 698,743
Plaza Design	\$ 367,760
Remodel existing offices into Reception	\$ 73,552
Safe & Secure Entry Vestibule	\$ 533,252
Secure Reception	\$ 165,492

CTE Remodel & Reconfiguration - HS	
Circulation Area	\$ 295,131
Classroom - Welding	\$ 152,617
Conference Room and Meeting Area	\$ 488,047
Demolition	\$ 574,586
Engineering/CAD/Design	\$ 80,117
General Construction	\$ 2,599,411
Robotics	\$ 182,863
Staging Area	\$ 215,506
Welding & Wood shop area	\$ 749,994

Music Recording Studio / Digital Media Lab - HS	
Add Overhead door - Renlita	\$ 51,011
Furniture Allowance	\$ 69,757
Recording / Editing Equipment Allowance	\$ 255,054
Recording/Editing Bays	\$ 420,839
Remodel Existing Space, Remove Wall	\$ 645,254

Pathfinder Project - North Middle School	
Commons	\$ 1,848,512
Demolition	\$ 521,530
Educational Space	\$ 3,035,862
Equipment	\$ 36,404
Site Work	\$ 306,835
MEP (Mechanical, Electrical, Plumbing)	\$ 3,518,936
Restrooms	\$ 518,281

Band & Choir Addition - Glen Lake	
Band Room	\$ 827,809
Choir Room	\$ 761,050
Corridor	\$ 892,941
Furniture	\$ 92,376
MEP (Mechanical, Electrical, Plumbing)	\$ 106,814
Restrooms	\$ 213,628
Site Work	\$ 86,484

Remodel Existing to Create Learning Communities - Glen Lake	
Furniture Allowance	\$ 332,118
Grade 1-2 Learning Community	\$ 2,989,061

Capital Project Levy Question:

The school board of Independent School District No. 270 (Hopkins Public Schools) has also proposed to renew the school district's existing capital project levy authorization of 8.7054% times the net tax capacity of the school district, which is scheduled to expire after taxes payable in 2027. The money raised from the capital project levy authorization will provide funds for the acquisition, installation and maintenance of software, curriculum, instructional equipment and improved technology and technology systems in various school district facilities, musical instruments, and the purchase of school-related transportation vehicles. The proposed capital project levy authorization will raise approximately \$15,667,898 for taxes payable in 2028, the first year it is to be levied, and would be authorized for ten years. The estimated total cost of the projects to be funded over that time period is

approximately \$156,678,980. The projects have received a positive Review and Comment from the Commissioner of Education

The following is a summary of the estimated annual budget for the capital project levy.

	Technology	Transportation	Music Instruments	Total
2025-26	\$14,077,898	\$1,140,000	\$450,000	\$15,667,898
2026-27	\$15,667,898			\$15,667,898
2027-28	\$15,667,898			\$15,667,898
2028-29	\$15,667,898			\$15,667,898
2029-30	\$15,667,898			\$15,667,898
2030-31	\$15,667,898			\$15,667,898
2031-32	\$15,667,898			\$15,667,898
2032-33	\$15,667,898			\$15,667,898
2033-34	\$15,667,898			\$15,667,898
2034-35	\$15,667,898			\$15,667,898

As part of the District's ongoing strategic planning process the district continually updates its short and long-term capital plans. The district intends to annually review the need for capital expenditures and make adjustments to the proposed project budget as needed.

Operating Costs

While it's hard to know the exact operational costs that will result from these projects, the district anticipates and is prepared to pay a proportional increase in utilities associated with additional square footage. Current staff at each site, where additional square footage will be added, will be able to take on the day-to-day maintenance with no added cost. The District is confident added operational costs for new spaces will be offset with the ability to collect rental fees through community use. All projects proposed in this referendum will use modern construction materials and designs which will maximize energy efficiencies.

Construction Schedule

With voter approval, design work will begin December 2025 with the anticipated start of construction in the Summer of 2027. The construction will be phased over multiple years and coordinated with respective facilities schedules. Following voter approval, the district will facilitate a transparent prioritization process with its project partners to determine how projects will be phased over a multi-year implementation process based on; constructability, community input, equity and inclusion, cost and funding, and operations and safety. Final completion of all renovations and additions is anticipated by late fall 2029

5. Project Plans for Gender-Neutral Spaces & Privacy Features

As part of Hopkins School District's commitment to equity, inclusion, and student well-being, the district is prioritizing the addition of single-user restrooms across multiple facilities. This initiative directly supports Minnesota's legislative and policy direction, as outlined in the **2023 Minnesota Laws, Chapter 55, Article 8, Section 19**, and reinforced in H.F. 2925, which requires school districts to include plans for gender-neutral restrooms in major construction and remodeling projects.

Single-user restrooms provide:

- Inclusive access for all students.
- Enhanced privacy for students with medical, religious, or personal needs.
- Reduced stigma and anxiety by offering a safe, neutral space for restroom use.
- Compliance with state expectations for gender equity and privacy in school facilities.

By incorporating these restrooms into our facilities plan, the district is proactively addressing the need for safe, respectful, and accessible environments for all students, staff, and visitors. This approach also aligns with the Minnesota Department of Education's emphasis on equity, diversity, and inclusion in school infrastructure planning.

6. Funding Source(s)

Specification of the source of financing the project, including applicable statutory citations; the scheduled date for a bond issue or school board action; a schedule of payments, including debt service equalization aid; and the effect of a bond issue on local property taxes by the property class and valuation.

Section 6 Submittal Content

Required information for the financing section of the Review and Comment document ...

A specification of the source of project financing including:

- a. applicable statutory citations,
- b. the scheduled date for a bond issue or school board action,
- c. a schedule of payments, including debt service equalization aid, and
- d. the effect of a bond issue on local property taxes by property class and valuation.

Hopkins Schools ISD 270 proposes to obtain financing from the sale of General Obligation Bonds, pursuant to Minnesota Statutes Chapter 475. The School District will seek voter approval of two ballot questions on Tuesday, November 4, 2025. The first ballot question would authorize the issuance of up to \$140,000,000 in school building bonds. Underwriter's discount, capitalized interest, and cost of issuance are estimated at \$2,684,020. The difference between the amount requested to be authorized by the voters, plus the estimated interest earnings in the construction fund of \$2,059,740 and less estimated costs of issuing this debt equals \$139,375,720 the amount the District expects to need for construction projects. The second ballot question, previously discussed in Sections 3 and 4, would authorize a renewal of the school district's existing capital project levy authorization of 8.705% times the net tax capacity of the school district, which is scheduled to expire after taxes payable 2027.

Ehlers has prepared the financial schedules which are included in the **Appendix**:

- 1) Estimated sources and uses of funds for the proposed bond issue
- 2) Estimated debt payment structure for the anticipated bond issue, including estimated annual debt service property tax levies after accounting for the 105% levy requirement; the district doesn't qualify for debt service equalization aid
- 3) An analysis of the estimated tax impact on various values of residential homestead and commercial/industrial properties for the proposed bond issue

PRELIMINARY INFORMATION - FOR REVIEW AND COMMENT**Hopkins School District No. 270**

June 23, 2025

Estimated Sources and Uses of Funds

Voter Approved School Building Bonds (Assumes 2 Issues)

	November 4, 2025
Bond Amount	\$140,000,000
Term/Number of Levies	22
Dated Date	
Sources of Funds	
Par Amount	\$140,000,000
Estimated Investment Earnings ¹	2,059,740
Total Sources	\$142,059,740
Uses of Funds	
Allowance for Discount Bidding ²	\$2,100,000
Legal and Fiscal Costs ³	584,020
Net Available for Project Costs	139,375,720
Total Uses	\$142,059,740
Estimated Deposit to Construction Fund	\$137,315,980

1 Estimated investment earnings for each voter approved bond issue is based on an average interest rate of 1.5%, and an average life of 12 months.

2 The allowance for discount bidding is an estimate of the compensation taken by the underwriter who provides the lowest true interest cost as part of the competitive bidding process and purchases the bonds. Ehlers provides independent municipal advisory services as part of the bond sale process and is not an underwriting firm.

3 Includes fees for municipal advisor, bond counsel, rating agency, paying agent and county certificates.

PRELIMINARY INFORMATION - FOR REVIEW AND COMMENT

Hopkins School District No. 270
Preliminary Financing Plan for Future Projects

\$140,000,000 Building Bonds; 22 Year Repayment
November 2025 Election
Future Facilities Maintenance Bonds
Wrapped Around Existing Debt

Future Bond Issues

June 23, 2025

Type of Bond	Amount	Dated	Int. Rate
Facilities Maintenance	\$13,650,000	09/15/25	5.00%
School Building Bond	\$75,000,000	02/01/26	4.50%
Facilities Maintenance	\$19,720,000	11/01/26	5.00%
School Building Bond	\$85,000,000	02/01/28	5.00%
Facilities Maintenance	\$12,480,000	11/01/28	4.50%
Facilities Maintenance	\$7,495,000	11/01/30	4.50%
Facilities Maintenance	\$12,360,000	11/01/32	4.50%
Facilities Maintenance	\$9,270,000	11/01/34	4.50%

Levy Year	Fiscal Year	Est. Tax Capacity Value 1 (\$000)	% Chg	Debt Service Levies - Existing Bonds*			Other Levies			Potential Building Bonds			Facilities Maintenance Funding			Combined Totals					
				Building Bonds	Alt. Fac. / FM Bonds ²	Est. Debt Excess ³	Lease	Capital Project Levy ⁴	Principal	Interest	Excess**	Debt Levy	General Fund Revenue	Principal	Interest	Excess ³	Debt Levy	Total	Tax Rate		
2023	2024	150,134	7.6%	1,520,469	13,528,998	(1,568,413)	13,460,054	8.41	414,468	12,914,797	8,702,327	-	-	-	-	-	35,500,648	22.17			
2024	2025	169,490	5.8%	1,520,382	13,001,790	(968,832)	13,533,240	7.98	414,468	14,990,864	7,875,158	-	-	-	-	-	38,467,807	22.70			
2025	2026	167,410	-1.2%	1,549,157	13,314,565	(587,867)	14,311,556	8.55	414,468	15,545,820	7,442,649	-	(1,006)	-	1,666,219	39,813,220	23.78				
2026	2027	168,247	0.5%	1,529,207	12,999,841	(668,867)	14,863,722	8.83	414,468	15,435,592	6,433,622	-	-	-	646,800	43,040,131	25.58				
2027	2028	169,930	1.0%	1,545,219	13,302,251	(603,807)	14,273,663	8.32	-	15,607,896	5,266,868	-	(148,141)	-	1,356,404	43,904,933	25.58				
2028	2029	171,629	1.0%	1,569,791	13,695,111	(649,320)	14,545,791	8.16	-	15,882,823	4,242,141	-	(88,074)	-	1,995,206	45,298,974	25.58				
2029	2030	173,079	2.2%	3,874,001	9,133,331	(568,351)	12,439,181	7.02	-	16,277,023	7,034,134	-	(89,784)	-	2,446,109	45,753,538	25.58				
2030	2031	178,849	3.2%	5,928,684	7,876,271	(585,339)	13,219,826	7.39	-	16,327,056	7,033,464	-	(110,078)	-	4,426,841	46,213,799	25.58				
2031	2032	180,638	1.0%	5,681,488	8,106,578	(671,232)	13,166,844	7.29	-	16,490,326	7,033,493	-	(199,208)	-	3,696,948	46,672,310	25.58				
2032	2033	182,444	1.0%	5,694,098	8,086,680	(620,463)	13,160,315	7.21	-	16,655,229	7,036,993	-	(166,363)	-	3,516,591	47,141,201	25.58				
2033	2034	184,269	1.0%	-	11,713,800	(620,135)	11,093,665	6.02	-	16,821,782	7,568,991	-	(158,247)	-	3,250,900	47,142,802	25.58				
2034	2035	184,269	0.0%	-	11,241,883	(527,121)	10,714,862	5.81	-	16,990,000	7,644,120	-	(130,750)	-	2,942,141	47,142,802	25.58				
2035	2036	184,269	0.0%	-	5,542,005	(503,889)	5,038,116	2.73	-	16,990,000	6,660,000	-	(580,121)	-	2,588,150	47,142,802	25.58				
2036	2037	184,269	0.0%	-	-	-	-	-	-	16,990,000	6,660,000	-	-	-	2,588,150	47,142,802	25.58				
2037	2038	184,269	0.0%	-	-	-	-	-	-	16,990,000	6,660,000	-	-	-	2,588,150	47,142,802	25.58				
2038	2039	184,269	0.0%	-	-	-	-	-	-	16,990,000	6,660,000	-	-	-	2,588,150	47,142,802	25.58				
2039	2040	184,269	0.0%	-	-	-	-	-	-	16,990,000	6,660,000	-	-	-	2,588,150	47,142,802	25.58				
2040	2041	184,269	0.0%	-	-	-	-	-	-	16,990,000	6,660,000	-	-	-	2,588,150	47,142,802	25.58				
2041	2042	184,269	0.0%	-	-	-	-	-	-	16,990,000	6,660,000	-	-	-	2,588,150	47,142,802	25.58				
2042	2043	184,269	0.0%	-	-	-	-	-	-	16,990,000	6,660,000	-	-	-	2,588,150	47,142,802	25.58				
2043	2044	184,269	0.0%	-	-	-	-	-	-	16,990,000	6,660,000	-	-	-	2,588,150	47,142,802	25.58				
2044	2045	184,269	0.0%	-	-	-	-	-	-	16,990,000	6,660,000	-	-	-	2,588,150	47,142,802	25.58				
2045	2046	184,269	0.0%	-	-	-	-	-	-	16,990,000	6,660,000	-	-	-	2,588,150	47,142,802	25.58				
2046	2047	184,269	0.0%	-	-	-	-	-	-	16,990,000	6,660,000	-	-	-	2,588,150	47,142,802	25.58				
2047	2048	184,269	0.0%	-	-	-	-	-	-	16,990,000	6,660,000	-	-	-	2,588,150	47,142,802	25.58				
2048	2049	184,269	0.0%	-	-	-	-	-	-	16,990,000	6,660,000	-	-	-	2,588,150	47,142,802	25.58				
2049	2050	184,269	0.0%	-	-	-	-	-	-	16,990,000	6,660,000	-	-	-	2,588,150	47,142,802	25.58				
2050	2051	184,269	0.0%	-	-	-	-	-	-	16,990,000	6,660,000	-	-	-	2,588,150	47,142,802	25.58				
2051	2052	184,269	0.0%	-	-	-	-	-	-	16,990,000	6,660,000	-	-	-	2,588,150	47,142,802	25.58				
2052	2053	184,269	0.0%	-	-	-	-	-	-	16,990,000	6,660,000	-	-	-	2,588,150	47,142,802	25.58				
Totals				33,979,642	150,308,917	(8,188,055)	175,100,865	-	2,072,338	493,689,527	140,000,000	114,198,750	(10,451,156)	256,427,531	268,385,330	74,955,000	54,317,540	13,105,223	137,074,425	27,586,990	14.95

1 Tax capacity values include the actual value for taxes payable through 2025. Estimated percentage changes for later years are shown above. For taxes payable 2030, an expiring TIF district will result in an increase in tax capacity.
 2 Tax capacity values include the actual value for taxes payable through 2025. Estimated percentage changes for later years are shown above. For taxes payable 2030, an expiring TIF district will result in an increase in tax capacity.
 3 The debt excess adjustments for taxes payable in 2023 to 2029 are actual amounts. Estimates for future years are based on 4.5% of the prior year's total debt service levy.
 4 Lease levy amounts are for the district's capital leases only.
 5 Assumes that the existing capital project levy would be renewed at the same tax rate prior to expiring.



PRELIMINARY INFORMATION - FOR REVIEW AND COMMENT

Hopkins School District No. 270
Estimated Tax Rates for Capital and Debt Service Levies

\$140,000,000 Building Bonds; 22 Year Repayment
November 2025 Election
Future Facilities Maintenance Bonds
Wrapped Around Existing Debt

Date Prepared: June 23, 2025

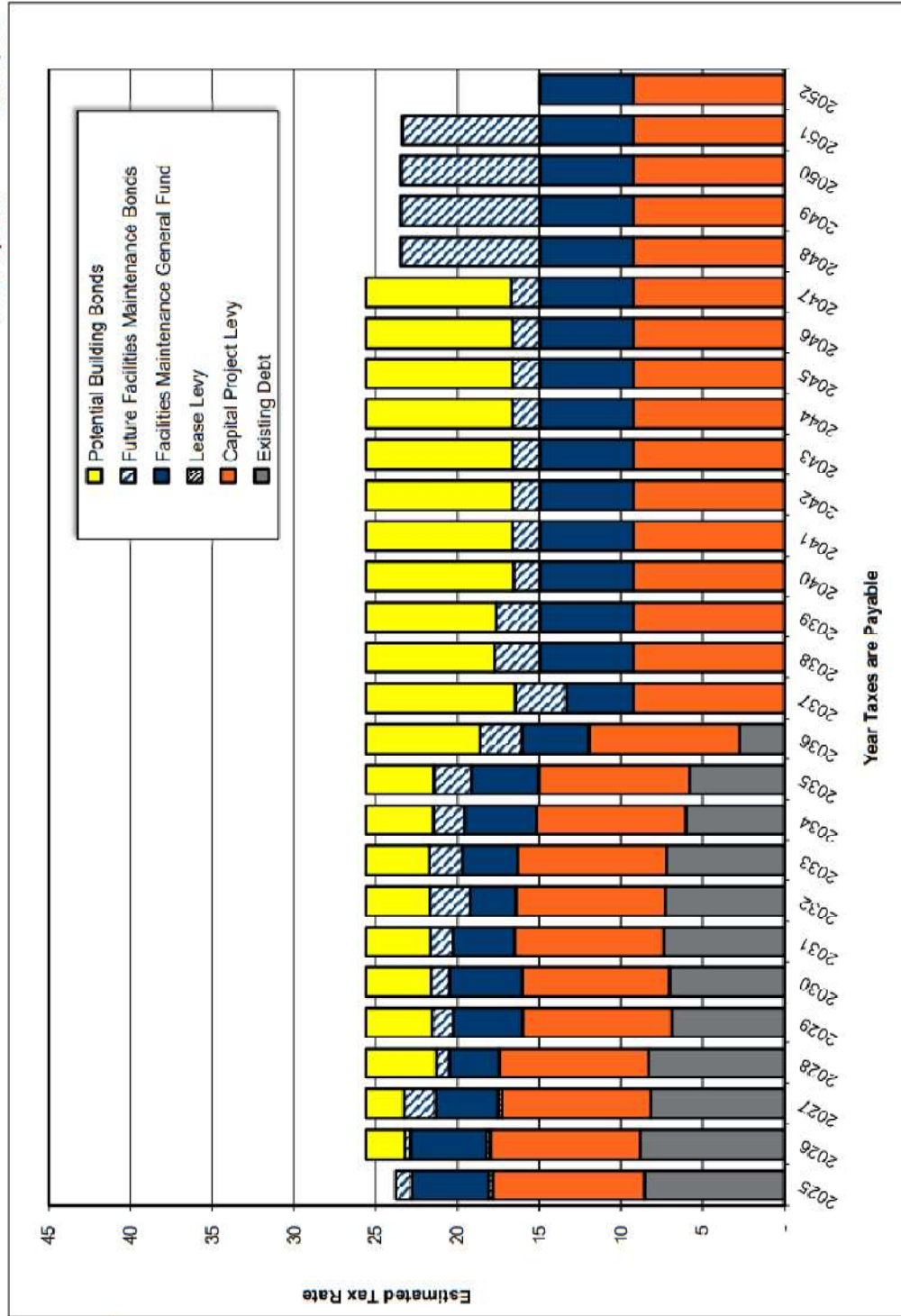

Debt Plan 25c Plan (FY27LTFM and \$7mo).xlsx



PRELIMINARY INFORMATION - FOR REVIEW AND COMMENT

Hopkins Public Schools, ISD 270

Analysis of Tax Impact for Proposed Ballot Questions
November 2025 Election

June 23, 2025

Authorized Bond Amount First Year Taxes Payable Tax Levies Annual Revenue	Question 1	Question 2
	Building Bond	Capital Project Levy Renewal
	\$140,000,000	2028
	2026	2028
	22	10
		\$15,512,770

Type of Property	Estimated Market Value	Estimated Impact on Annual Taxes*	
Residential Homestead	\$100,000	\$11	\$0
	200,000	31	0
	300,000	51	0
	350,000	60	0
	400,000	70	0
	450,000	80	0
	500,000	90	0
	550,000	101	0
	600,000	113	0
	750,000	146	0
	1,000,000	203	0
Commercial/ Industrial #	\$200,000	\$38	\$0
	500,000	108	0
	750,000	166	0
	1,000,000	224	0
	2,000,000	457	0
Apartments & Residential Non-Homestead (2 or more units)	\$150,000	\$34	\$0
	300,000	68	0
	500,000	113	0
	1,000,000	225	0
	2,000,000	451	0

* Estimated tax impact includes principal and interest payments on the new bonds, other capital and debt service levies, and capital project levies only, and do not include tax levies for other purposes. Tax increases shown above are gross increases, not including the impact of the homeowner's Homestead Credit Refund ("Circuit Breaker") program. Owners of homestead property may qualify for a refund, based on their income and total property taxes. This will decrease the net effect of the proposed bond issue for qualifying property owners.

For commercial-industrial property, the estimates above are for property in the City of Hopkins. The tax impact for commercial-industrial property in other municipalities in the school district may be slightly different, due to the varying impact of the Fiscal Disparities program.



7. Certification of Architects and Engineers

As required under section 123B.72, for buildings coming into service after July 1, 2002, a certification that the plans and designs for the extensively renovated or new facility's heating, ventilation, and air conditioning systems will meet or exceed code standards; will provide for the monitoring of outdoor airflow and total airflow of ventilation systems; and will provide an indoor air quality filtration system that meets ASHRAE standard 52.1.



The District's professional services firm, SitelogIQ, Inc., as required under Minnesota Statute 123B.72, hereby certifies all HVAC improvements will meet or exceed code standards. All necessary certifications will be submitted along with proper commissioning documentation that the HVAC systems meet mechanical code standards, airflow monitoring requirements and filtration guidelines as addressed in Minnesota Statute 123B.71 and 123B.72.

I, Roxanne Cortinas, do hereby certify all HVAC improvements will meet or exceed code standards. All necessary certifications will be submitted along with proper commissioning documentation that the HVAC systems meet mechanical code standards, airflow monitoring requirements, and filtration guidelines as addressed in Minnesota Statute 123B.71 and 123B.72.

IAQ will be improved by selecting the proper equipment and by designing the ventilation systems to meet the requirements of ASHRAE 62.1-2007 and Minnesota Code. The requirements of 13-18 cfm/person of outside air for each occupancy category shall be provided.

As experienced Minnesota school architects and engineers, SitelogIQ, Inc. has developed a standard for building systems that addresses concerns regarding IAQ. As such, this project includes an air system approach for the building area which matches the building's occupancy to the required outside ventilation rate to help achieve acceptable IAQ results. These systems will be easily operated and maintained to provide adequate air changes throughout the facilities to meet or exceed the minimum requirements as established by the Minnesota State Department of Education and outlined in their Guidelines for school construction. These projects will also be designed to meet current code calling for 10 cfm/person plus .12 cfm/square foot of outside air in classroom space, as well as other applicable codes and ASHRAE standards. Monitoring of outdoor air and total airflow will be included in the scope of the building automation system.

Sustainability

Both the District and community believe in doing what they can to reduce environmental impact (footprint) through sustainable design. The efforts of our design team are guided by three broad sustainable principles. A good design respects the local context, be it natural or man-made. Knowledge of the context and surroundings should inform the design process and vocabulary of the building(s). The collaboration of the client and our team will ensure that the architecture will be contextual, timeless, and place specific.

Good design and sustainability should work together to result in superior green strategies, technology systems, and architectural design. A building should wear its sustainability not to win awards or to achieve a certificate, but to inspire those who interact with the facility, create a healthier, more productive place, and to be good stewards of the land and real property.

Understanding of the local climate and environment offer clues necessary in designing a facility where passive systems are maximized and reinforced by the building structure and shape. We will apply the latest appropriate conservation measures while incorporating active systems and the latest appropriate technologies available.

Sound Attenuation

The project design will address the sound levels required by the Deputy Commissioner’s annual health and safety funding letter. The implied annexes of the referenced guideline, ANSI *S12.60-2010 American National Standard Acoustical Performance Criteria, Design Requirements, and Guidelines for Schools*, are: Annex C., “Design guidelines for controlling reverberation in classrooms and other learning spaces,” Annex D., “Design guidelines for noise isolation,” and Annex E., “Good architectural practices and procedures to verify conformance to this standard.” Table A in Section 3 of this guideline indicates, for typical school core learning areas, a maximum A-weighted sound level of 35dBA. This guideline is considerably quieter than the 45dBA maximum requirement indicated by the Deputy Commissioner’s annual health and safety funding letter. Increasing levels of attenuation to this requirement will depend on the budgets available and may necessitate involvement of an acoustical consultant. Sound pressure level measurements are taken in each learning space of each project to determine conformance with the requirements of the funding letter. Sound pressure level measurements will be taken in each learning space of each project to assure conformance.

State Fire Code

The District’s professional services firm, SitelogIQ, Inc., as required under Minnesota State Fire Code, hereby certifies all improvements will meet or exceed code standards. All necessary certifications will be submitted along with proper commissioning documentation.

Chapter 326B – Governing Building Codes

The District’s professional services firm, SitelogIQ, Inc., as required under Chapter 326B, hereby certifies all improvements will meet or exceed code standards. All necessary certifications will be submitted along with proper commissioning documentation.

Provision of Infrastructure to Serve School

As the work identified in this submission will occur in existing facilities, no change to the infrastructure that serves the schools is anticipated. Therefore, the local unit of government should not be burdened with cost due to or resulting from this work.

Discussions with planning and permitting staff will occur as projects approach initial start-up. **Although none are anticipated**, any impact on local roads or safety will be addressed in conjunction with that process.

Ballot Language

In preparation for this review and comment and the November 4, 2025, referendum the board approved the following draft ballot language:

Question 1:

Shall the school board of Independent School District No. 270 (Hopkins Public Schools) be authorized to issue its general obligation school building bonds in an amount not to exceed \$140,000,000 to provide funds for the acquisition and betterment of school sites and facilities, including the construction, acquisition and installation of safety and security improvements; the completion of various infrastructure projects at school district sites and facilities, including renovations for Career and Technical Education, ADA updates, parking lot reconstruction, playgrounds, outdoor learning areas, indoor and outdoor athletic enhancements, and modernization of learning spaces, including special education environments?

Question 2:

The school board of Independent School District No. 270 (Hopkins Public Schools) has also proposed to renew the school district's existing capital project levy authorization of 8.7054% times the net tax capacity of the school district, which is scheduled to expire after taxes payable in 2027. The money raised from the capital project levy authorization will provide funds for the acquisition, installation and maintenance of software, curriculum, instructional equipment and improved technology and technology systems in various school district facilities, musical instruments, and the purchase of school-related transportation vehicles. The proposed capital project levy authorization will raise approximately \$15,667,898 for taxes payable in 2028, the first year it is to be levied, and would be authorized for ten years. The estimated total cost of the projects to be funded over that time period is approximately \$156,678,980. The projects have received a positive Review and Comment from the Commissioner of Education

APPENDIX

Review and Comment Submittal
Hopkins Public School District #270
Submission: June, 2025



Appendix Order

- Appendix A: Hopkins Facility Case Study
- Appendix B: 10-Year LTFM FY 2026 and Beyond
- Appendix C: Civil Summary (Parking Lots and Playgrounds)
- Appendix D: Morris Leatherman Survey
- Appendix E: Staff Facility Survey
- Appendix F: Ideation and Listening Sessions Executive Survey
- Appendix G: Pathfinders- Final Design Summary
- Appendix H: Referendum Review Board Meeting