

METHACTON HIGH SCHOOL



PRELIMINARY COST ESTIMATES

	Baseline	Option 1A	Option 1B	Option 2A	Option 2B
Hard Costs					
Interior Renovations	\$ 61,450,200	\$ 61,310,100	\$ 67,051,000	\$ 43,901,900	\$ 43,901,900
Exterior Shell Upgrades	\$ 12,080,000	\$ 12,080,000	\$ 12,080,000	\$ 7,748,000	\$ 7,748,000
Additions - New Construction	\$ -	\$ 9,257,500	\$ 9,257,500	\$ 44,957,500	\$ 49,907,500
Site Improvements	\$ 2,060,000	\$ 4,660,000	\$ 4,660,000	\$ 17,460,000	\$ 17,460,000
Phasing and Modular Classrooms	\$ 5,500,000	\$ 5,500,000	\$ 5,500,000	\$ 2,000,000	\$ 2,000,000
Subtotal Hard Costs	\$ 81,090,200	\$ 92,807,600	\$ 98,548,500	\$ 116,067,400	\$ 121,017,400
Escalation	\$ 7,519,000	\$ 8,606,000	\$ 9,138,000	\$ 10,763,000	\$ 11,222,000
Total Hard Construction Costs	\$ 88,609,200	\$ 101,413,600	\$ 107,686,500	\$ 126,830,400	\$ 132,239,400
Soft Costs					
Fees, Permits, Insurance	\$ 9,064,800	\$ 10,642,100	\$ 11,206,900	\$ 13,029,400	\$ 13,516,200
Data Equipment, Classroom Technology, FF&E	\$ 3,325,000	\$ 3,325,000	\$ 3,325,000	\$ 3,325,000	\$ 3,325,000
Contingency	\$ 8,860,000	\$ 10,142,000	\$ 10,768,000	\$ 12,684,000	\$ 13,224,000
Total Soft Costs	\$ 21,249,800	\$ 24,109,100	\$ 25,299,900	\$ 29,038,400	\$ 30,065,200
Total Project Budget	\$ 109,859,000	\$ 125,522,700	\$ 132,986,400	\$ 155,868,800	\$ 162,304,600

Additional Scope for Consideration	Baseline	Option 1A	Option 1B	Option 2A	Option 2B
Interior Finishes and Casework	\$ 15,869,700	\$ 15,869,700	\$ 15,869,700	\$ 11,140,700	\$ 11,140,700
Parking Lot 8	\$ 2,800,000	\$ 2,800,000	\$ 2,800,000		
Mill Rd Driveway Extension				\$ 2,850,000	\$ 2,850,000
Total Additional Scope for Consideration	\$ 18,669,700	\$ 18,669,700	\$ 18,669,700	\$ 13,990,700	\$ 13,990,700
Total Project Budget with Additional Scope	\$ 128,528,700	\$ 144,192,400	\$ 151,656,100	\$ 169,859,500	\$ 176,295,300

METHACTON HIGH SCHOOL

SITE OPTION 1Z

CONCEPT 1Z			
EXISTING PARKING LOT NO.	PROPOSED PARKING LOT NO.	PARKING SPACES PROVIDED	REVISIONS PROPOSED
1		50	NO
2		21	NO
3		31	NO
4		0	YES
5		323	YES
6		46	NO
7		135	YES
	8	112	
	9	N/A	

PARKING SPACES: NET (+106)

PRIORITY 1 ITEMS ADDRESSED:

- IMPROVE TRAFFIC FLOW TO ELIMINATE CONGESTION & CAR TRAFFIC @ ARRIVAL & DISMISSAL

PRIORITY 2 ITEMS ADDRESSED:

- INCREASE QUANTITY OF PARKING SPACES (+106)

Lot 7 and Site for Natatorium Addition:
\$2,700,000

Included in Options 1A & 1B



Lot 5: \$1,400,000

Included in Baseline, Option 1A, and Option 1B

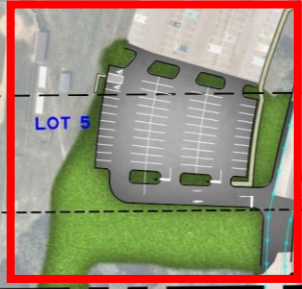

Lot 8: \$2,800,000

Optional for Baseline, Option 1A, and Option 1B

METHACTON HIGH SCHOOL

SITE OPTION 2X *Parking Lots and Internal Roads:* **\$12,000,000**

PRIORITY 1 ITEMS ADDRESSED:
 - IMPROVE TRAFFIC FLOW TO
 ELIMINATE CONGESTION & CAR
 TRAFFIC @ ARRIVAL & DISMISSAL

PRIORITY 2 ITEMS ADDRESSED:
 - INCREASE QUANTITY OF PARKING
 SPACES (+63)

Mill Rd. Extension: **\$2,850,000**

CONCEPT 2X			
EXISTING PARKING LOT NO.	PROPOSED PARKING LOT NO.	PARKING SPACES PROVIDED	REVISIONS PROPOSED
1		50	NO
2		21	NO
3		0	NO
4		0	YES
5		276	YES
6		45	NO
7		120	YES
	8	94	
	9	68	

PARKING SPACES: NET (+63)



METHACTON HIGH SCHOOL

SITE OPTION 2Z

**Parking Lots and Internal Roads:
\$12,000,000**

PRIORITY 1 ITEMS ADDRESSED:
- IMPROVE TRAFFIC FLOW TO
ELIMINATE CONGESTION & CAR
TRAFFIC @ ARRIVAL & DISMISSAL

PRIORITY 2 ITEMS ADDRESSED:
- INCREASE QUANTITY OF PARKING
SPACES (+154)

**Mill Rd. Extension:
\$2,850,000**

CONCEPT 2Z			
EXISTING PARKING LOT NO.	PROPOSED PARKING LOT NO.	PARKING SPACES PROVIDED	REVISIONS PROPOSED
1		50	NO
2		21	NO
3		0	YES
4		0	YES
5		278	YES
6		45	NO
7		127	YES
	8	170	
	9	74	

PARKING SPACES: NET (+154)





PRIORITY GROUP 3

- Relocate Transportation Center Off-Site
- Relocate Central Admin (Farina) Off-Site
- Add Storage Buildings to Replace Existing Trailers
- Separation of Public Spaces from Classroom Spaces
- Addition of Natural Light/Windows
- Update Interior Architectural Finishes
- Provide Indoor Track
- Create School Store Run by Special Education Program
- Reconfigure Nurse/Counseling Spaces with Career Center
- Large Group Instruction Space
- Provide Additional Small Group/Collaboration/Flexible Learning Spaces
- Create Teacher Planning Centers
- Retain Courtyard/Outdoor Learning Spaces
- Wrestling Room

BASELINE ADA SCOPE:

- All non-ADA entry doors (classrooms and toilet rooms) renovated to be code compliant throughout
- Reconfiguration of toilet rooms, showers, lockers to be code compliant

** These items are not a code requirement for all options being considered, but the District has prioritized ADA improvements to be included in the baseline scope.*

- ALL NEW Construction areas and areas of “reconfiguration” are scheduled to be made fully ADA compliant

METHACTON HIGH SCHOOL



Renovations / Additions Feasibility Study Schedule

AUGUST

8/26 Board Meeting

Updates from 8/19 Presentation; Gather Feedback

SEPTEMBER

9/09 Property Committee

General update

9/11 Public Forum

9/16 Board Work Session

Presentation of Final HS Concepts

9/18 Public Forum

9/24 Board Meeting

Present Public Feedback / Gather Board Feedback; Present Projected Budget

OCTOBER

10/14 Property Committee

General Update / Discussion

10/21 Board Work Session

Summary Review & Final Q&A

10/28 Board Meeting

Vote on HS Renovation

METHACTON HIGH SCHOOL



Renovations / Additions Potential Design Schedule

**ASSUMING 10/28 Board Meeting results in a decision to move forward with a concept*

SCHEMATIC DESIGN

NOV – DEC 2025

SD: Confirm building program; finalize locations and sizes of spaces & general scope of work for renovations; begin Township approval process

DESIGN DEVELOPMENT

JAN – JUNE 2026

DD: Meet with end users; design of individual spaces; material selections; continue land development process; MEP & structural system coordination

CONSTRUCTION DOCUMENTS

JULY – NOV 2026

CD: Refine design and create detailed bid documents; Final submissions and land development approvals

BIDDING

DEC 2026 – JAN 2027

CONSTRUCTION

MARCH 2027 – DECEMBER 2029