



EL CAMINO SCIENCE BUILDING - MARCH 2014



Measure J Bond

March 20, 2014

Vol. 1, No. 6

WINTER/SPRING PROJECTS

Bond Program Update

James "Larry" Scott

The Bond Office has successfully closed out the Playground, Path of Travel, Phase One Modular and the El Camino Athletic Field projects. It has been commented that closing out a project can be just as hard as constructing it; nonetheless, we have these completed projects under our belt and we are pressing forward with the current building projects and our upcoming summer projects.

At the February 27, 2014 Board of Trustees' meeting, Chevron representatives presented information on the solar projects in the District after Year 1. The District exceeded their expected energy savings with the District receiving over \$500K from the California Solar Initiative.

The El Camino Science Building is transforming before our eyes. Just a skeleton of a building not too long ago, it has been fleshed out and by Spring Break it will be substantially complete. This building model will be repeated on two other SSFUSD campuses with the same lightning speed.

The Ramp Replacement and Elevator project at Spruce Elementary School is moving along. Despite some snares at the onset, momentum is building to ensure a spring completion date. Elevator equipment is on site. Many thanks for the patience and cooperation of the Spruce Elementary School staff and student body.

With Colt Field completed, Interstate Grading & Paving is turning their attention to the South San Francisco High Field. Crews have been demo'ing and grading since Winter Break; now they are aimed at a full onslaught to finish this pride and joy of Warrior Athletics.

The Design Team is firing projects into DSA as quick as DSA will permit. Turnaround at DSA is quick and mobilization of construction teams is underway. Interim Housing is placed at SSFHS and will soon be placed at Parkway for the onset of these two long term projects.

Summer 2014 projects are getting warmed up. Moving boxes and other activities prove construction is imminent at Spruce, Ponderosa and Westborough. These schools make up Phase Two Modular work. By the end of summer, they will join the other campuses with new state-of-the-art learning environments.



Spruce ES New Elevator Tower – March 2014

EL CAMINO SCIENCE BUILDING DEDICATION

April 15, 2014 - 1:30 p.m. @ ECHS

Check Website for latest news: <http://ssfusd.bond.swinerton.com/>



SSFHS Athletic Field – March 2014

District CM's

In an effort to save every dollar for Measure J Projects, the Bond Office assumed the construction management responsibilities. In November, Salom Samad came on board to tackle the active projects. This month, Kevin Sanders, will join forces to complete the Bond Team. These gentlemen will handle all construction management duties for the remainder of the Measure J projects.



Parkway Heights Counseling Center

Buri Buri Elementary School

Another major keystone Measure J project is the campus replacement at Buri Buri Elementary School. The entire new campus will be rebuilt featuring an innovative Library/Exploratorium combo building, four 6PK classroom buildings, a new Library as well as new playgrounds and baseball fields. Easy access to the campus and community access have been planned into the new campus. This project along with Parkway and SSFHS classroom wing will be in construction for over two years.

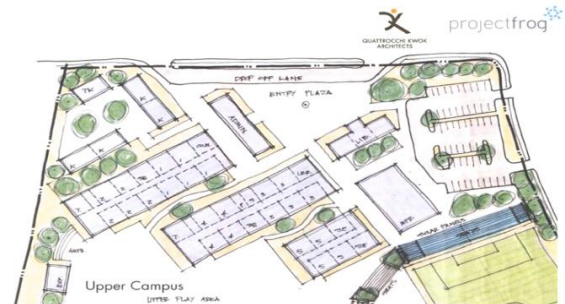

Buri Buri Elementary Campus Replacement Rendering

Martin Modernization

Last, but not least, of the Measure J projects is the modernization of Martin Elementary School which is set to start in summer 2015. In the past year, Martin received a new ADA Path of Travel and three (3) new play structures. Design will begin by the end of the year. Martin is set to receive new modulars and modernization to bring its campus into the 21st century. CAW Architects is on board to design and USS Cal Builders will be doing the construction.



SPRING ACTIVITY



*El Camino High School Science Building *Spruce Ramp & Elevator *SSFHS Athletic Field

DSA SUBMITTALS: Phase 2 - Ponderosa, Spruce, Westborough, Parkway, Buri Buri & SSFHS

