

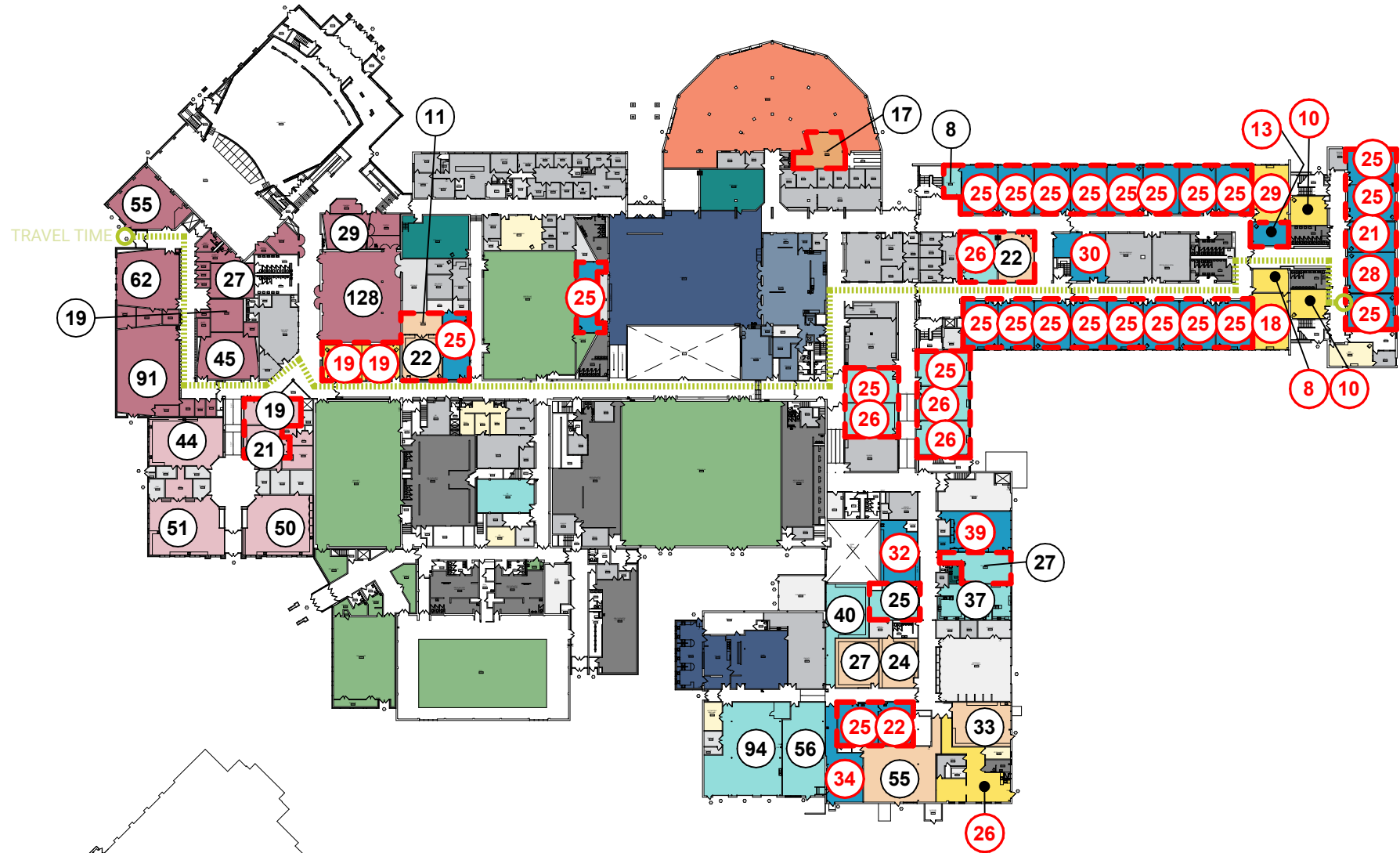

# Larkin High School

1475 Larkin Avenue, Elgin, IL 60123

BUILDING SUMMARY			
Gross SF	371,570	Number of Levels	3
Year Built	1960	Number of Additions	7



LEVEL 1

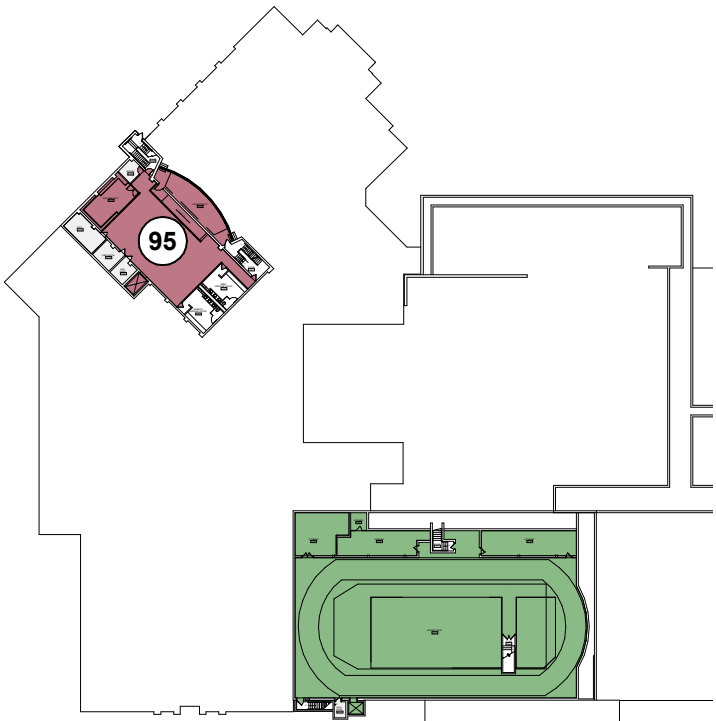

LEVEL 0

Phase 1 Snapshot

FACILITY LOCATION

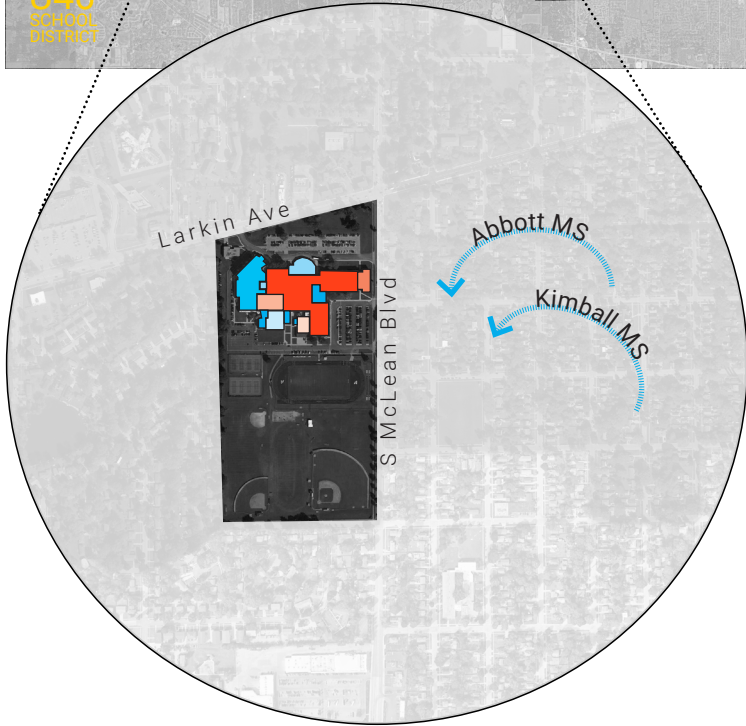
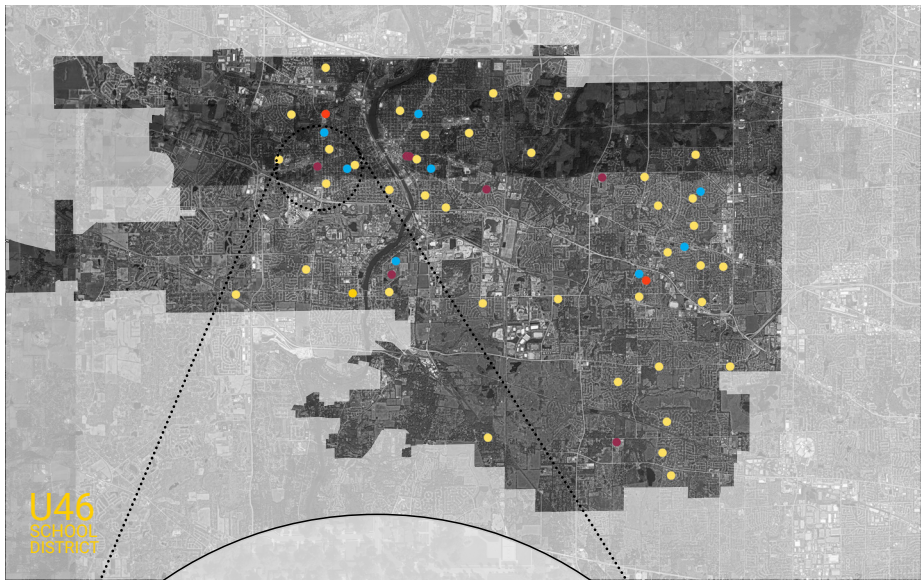

Current  
Acreage:  
**41.89**  
ACRES

Guideline  
Acreage:  
**40.62**  
ACRES

\* Guideline Acreage  
recommended by  
State of Illinois = 5  
acres plus 1 acre per  
every 100 students

- 1960
- 1966
- 1967
- 1974
- 1975
- 1981
- 1997
- 2004

TRAVEL

**7-9 MIN** Furthest approximate travel time from one location to another for an average **High School Student**.

PLAN KEY

- Administration
- Building Support
- Cafe Support
- Commons / Cafeteria
- Core Classroom
- Elective Classroom
- Gym / Fitness
- Kindergarten /ECC
- Learning Center
- Media Lab
- Performance Venue
- Performing Arts Classroom
- Resources
- Science Lab
- Special Education
- Stem / Hands-On Learning
- Restrooms
- Student Support
- Visual Arts
- Travel Path
- Under-sized space
- Room Capacity based on ISBE Guidelines (10)
- Room Capacity based on ISBE Guidelines (not included in Effective Capacity) (10)

January 27, 2021



# Larkin High School

1475 Larkin Avenue, Elgin, IL 60123

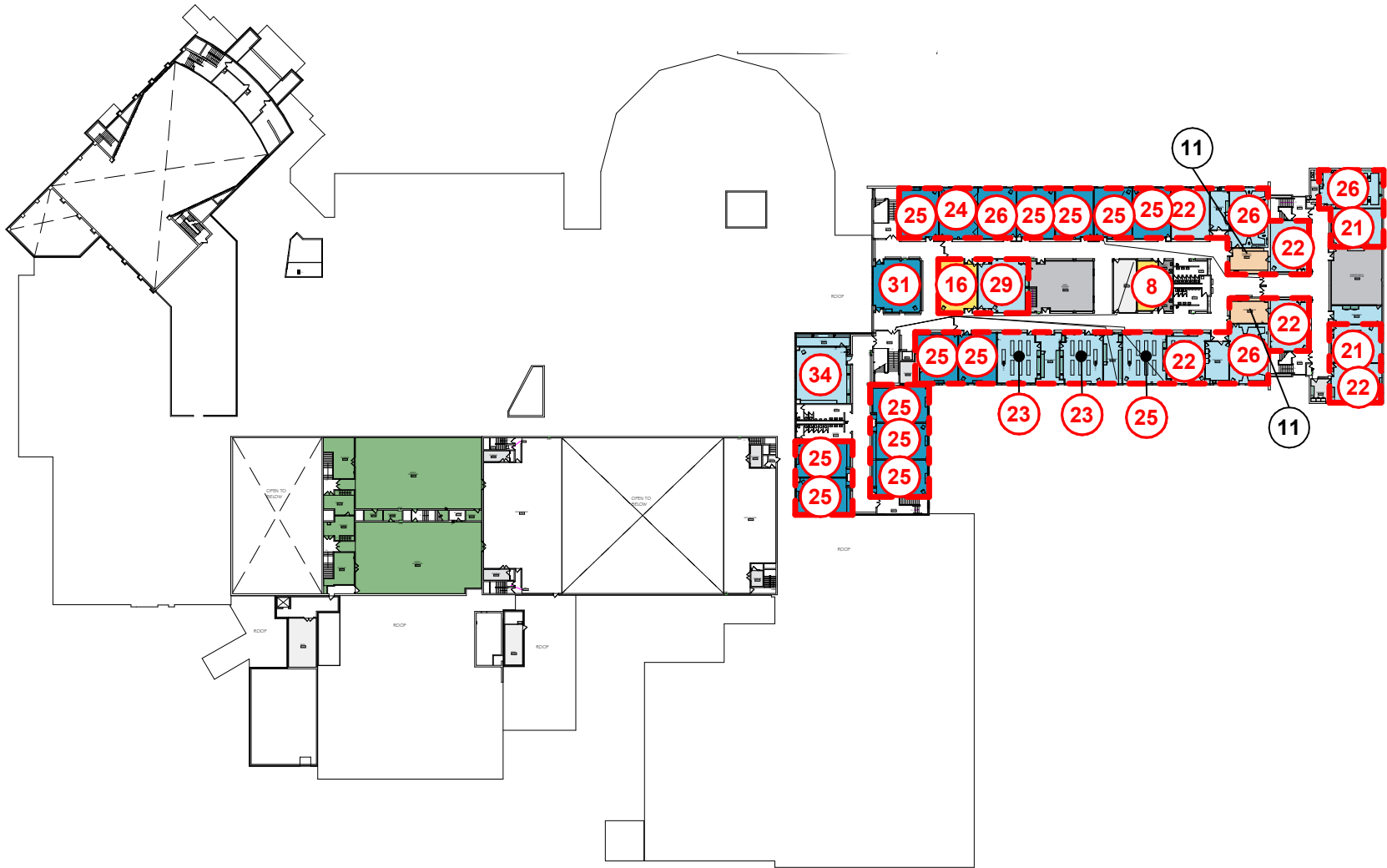

LEVEL 3

ENROLLMENT METRICS

Occupancy**	2680
Effective Capacity	TBD
Total Enrollment	2062

**Occupancy:** the maximum number of people that can be housed in a space in accordance with the building/ fire code

**Effective Capacity:** the amount of students a school can effectively support based on the District's current practices and future vision for teaching and learning. This is calculated based on ISBE's square footage per student guideline. Calculated based on core classrooms, science labs and Special Education spaces.

**Enrollment:** number of students that attended the facility in 2019-2020.

**\*\*NOTE:** Occupancy is NOT the recommended number of students for a space, it is the maximum allowed by code.

AREA COMPARISON

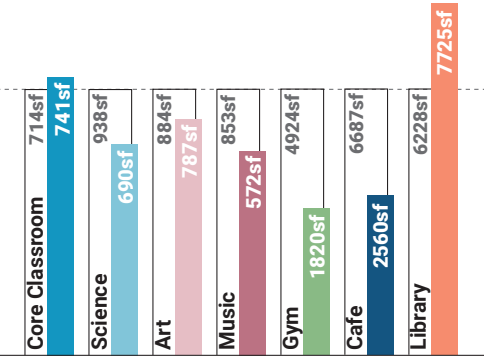

\* This comparison notes the difference between Larkin High School area per student in comparison to the current National average as noted in the 2015 School Construction Report. The master planning process will produce outcomes pertinent to the District as a whole. This is just one metric to compare space.

180 square feet per student : 148 square feet per student  
Larkin High School : 2015 National Low Quartile Number\*

PLAN KEY

- Administration
- Building Support
- Cafe Support
- Commons / Cafeteria
- Core Classroom
- Elective Classroom
- Gym / Fitness
- Kindergarten / ECC
- Learning Center
- Media Lab
- Performance Venue
- Performing Arts Classroom
- Resources
- Science Lab
- Special Education
- Stem / Hands-On Learning
- Restrooms
- Student Support
- Visual Arts
- Travel Path
- Under-sized space
- Room Capacity based on ISBE Guidelines
- Room Capacity based on ISBE Guidelines (not included in Effective Capacity)

<b>Spatial Educational Adequacy(25%)</b>	<b>C</b>	<b>Facility Condition(35%)</b>	<b>C</b>
(Data collected through Staff Survey)	<b>6.4/10</b>	FCI	.21
Physical Features	7.1/10	<b>Water Usage(5%)</b>	<b>B</b>
Environment Supports Variety	7.3/10	Gallons/SF	7.5
Visual Stimulation	5.4/10	<b>Energy Usage(10%)</b>	<b>C</b>
Future Readiness	5.6/10	<b>Total EUI</b>	<b>61.4kBTU/SF/yr</b>
<b>Building Allocation(25%)</b>	<b>B</b>	Electric	24.8kBTU/SF/yr
Gross SF/student	180	Gas	36.6kBTU/SF/yr
Site Acreage/Guideline	103%		
Mobiles in Use/Basement Used	No/Yes		

AGGREGATED FACILITY GRADE B-

Educational Adequacy grades were determined by a survey issued to staff. Square Foot/Student grades were determined by building area and enrollment. Facility grades are determined building assessments. Water grades were determined by comparing utility data to the Commercial Buildings Energy Consumption Survey. Energy grades were deteremined by comparing utility data to the US Dept of Energy's Building Performance Database. Percent in parenthesis indicates weight of category in aggregate facility grade.

Activity mapping is based on survey data (Week in the Life) collected by teachers throughout the district over the course of one week. The teachers provided the learning activity and amount of time spent in that activity. Data was aggregated for the school and is represented by the average percent of time spent in the activity.

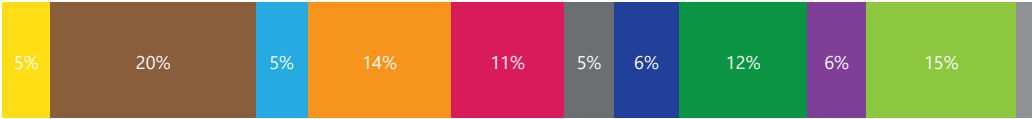

- Creative Brainstorming
- Direct Instruction
- Focused Study
- Group Discussion
- Hands-On Learning
- Housekeeping
- Physical Activities
- Practicing Autonomy
- Presenting or Performing
- Reserach & Reflection
- Transition

What’s a Listening Tour?

Staff surveys (Listening Tours) were sent to each school where faculty gave input about the strengths and weaknesses of the building. The following comments highlight common themes and concerns.

Listening Tour Comments From Staff

- The new library is a great addition and beautifully done.
- The locker rooms need updating. Additionally gym spaces are inadequate and small for the class sizes.
- Music rooms are too small and there are too few practice rooms. The ensemble rooms and storage are too small for class sizes.
- Staff would prefer their own classrooms to create classroom culture. The classrooms across from the gyms and those which back up to the black box are noisy and distracting.
- Teachers like the collaborative nature of the office suite. We can easily work together to meet the needs of the students.

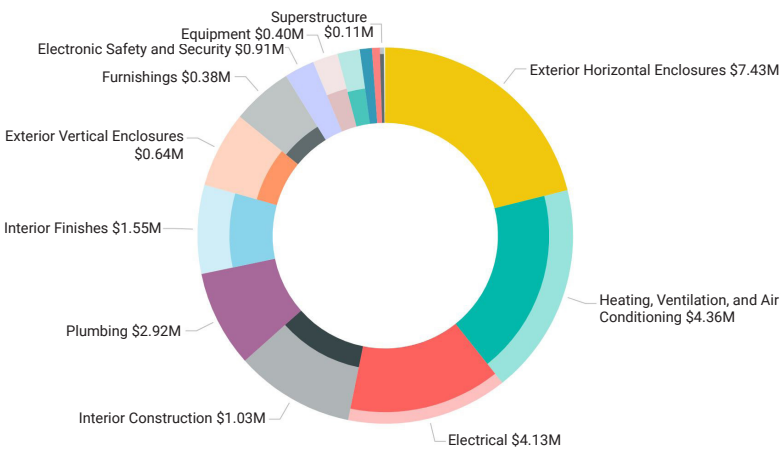

This chart indicates the approximate cost of deferred and anticipated maintenance (in dollars) of items assessed by building system. Highlighted items indicate those items in immediate need, code requirement, poor and fair condition.

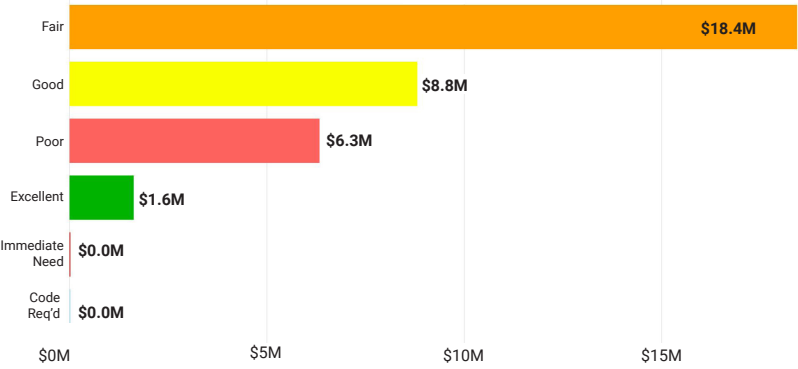

This chart indicates the approximate cost of deferred and anticipated maintenance (in dollars) based on condition of assessed items.

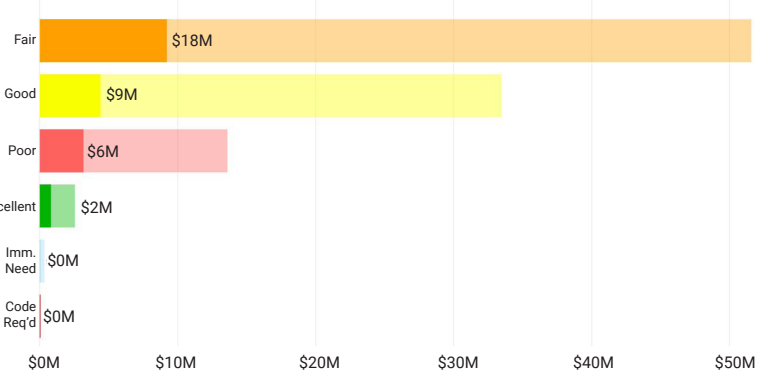

This chart indicates the approximate cost of deferred and anticipated maintenance (in dollars) based on condition of assessed items in relation to the entire cohort of buildings.

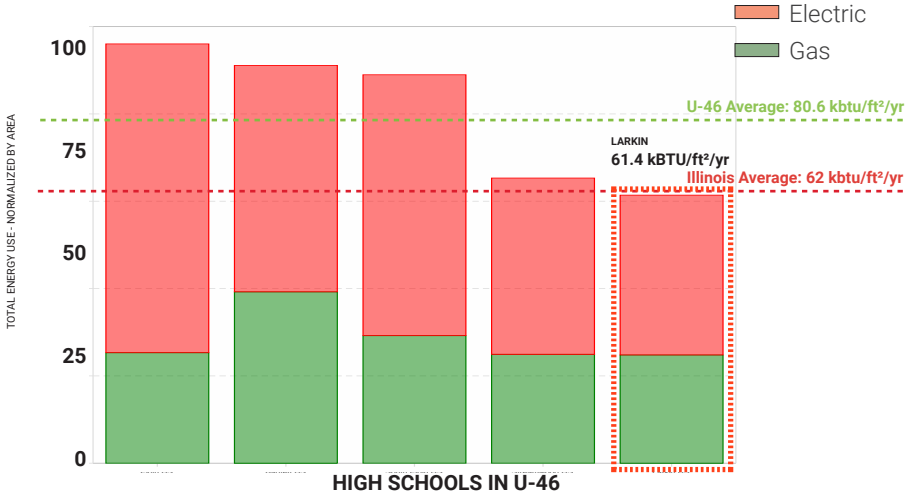

Energy Use Intensity (EUI) is a key metric that expresses a building’s energy use as a function of its size. Generally, a low EUI signifies good energy performance

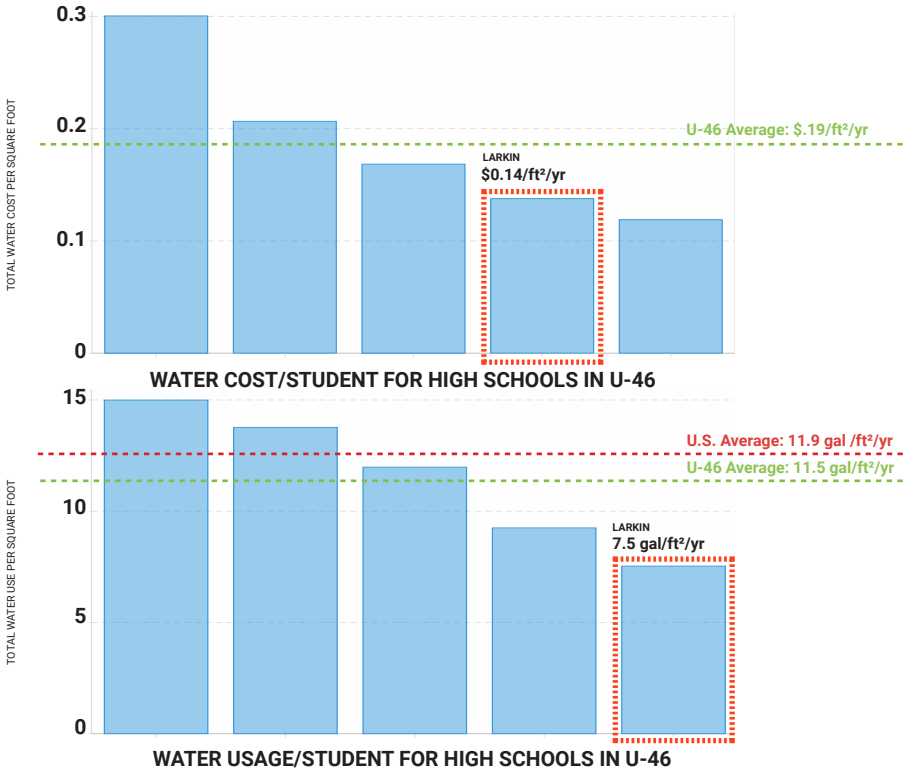

Water usage is a key metric that expresses a school's water use and total cost of water in comparison to the other high schools in the district.

How is this information collected?

The goal of the DLR Group integrated design team is to **collect multiple qualitative and quantitative data points** around the same set of items – for example energy use or learning behavior – **in order to form a holistic picture**. The team collects these data points through the use of utility analysis, expert walkthroughs, focus groups, surveys, and ethnographic observation techniques. The results are validated by cross-checking data points, such as a survey answer and a spot measurement, that should relate to one another.