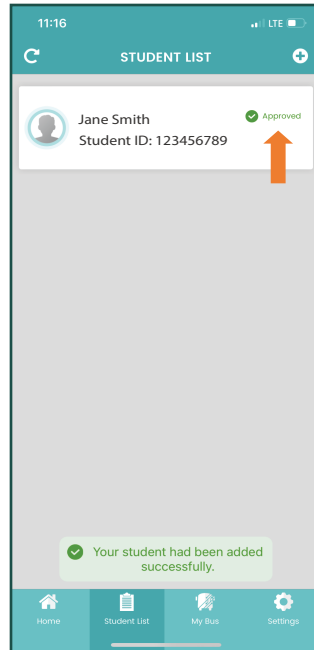
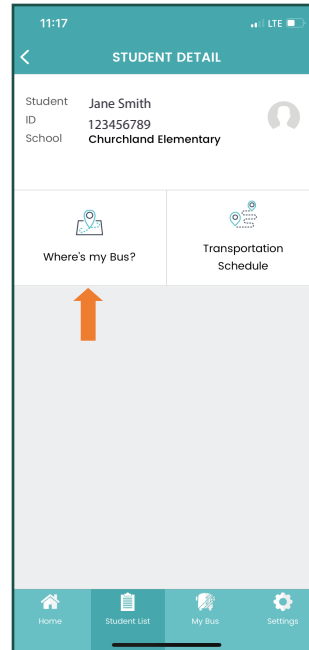

10 Add Student

Enter the data requested, which may include a school district Student Access Request (SAR) code, name, Student ID, and Date of Birth. Then press "Done."

11 Approval

The student will display as **Approved**. If **Pending**, the information you entered did not match. To try again, swipe left on the student's name to delete this request, then ADD STUDENT.

12 Student Detail

When you select the name from the student list, student detail information will appear. To view the bus information, tap on "Where's My Bus".

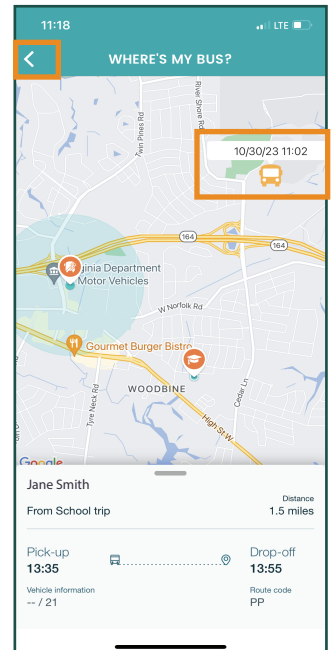
13 Where's my Bus?

The school, upcoming stop, and bus will be shown on the map with trip information below. To go back, select the back arrow. The time stamp shows when this bus last reported a GPS location. The district may restrict if and when the bus location is shown.

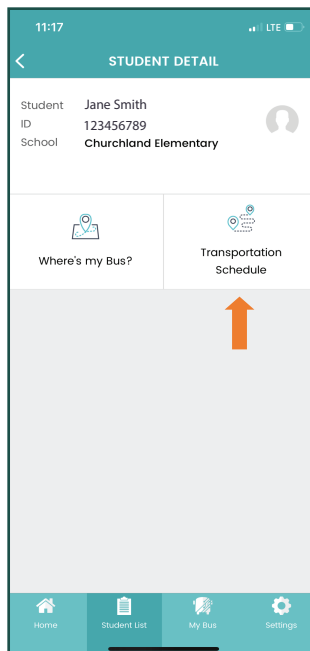
14 Student Details

To see bus stop location and planned times, select "Transportation Schedule"

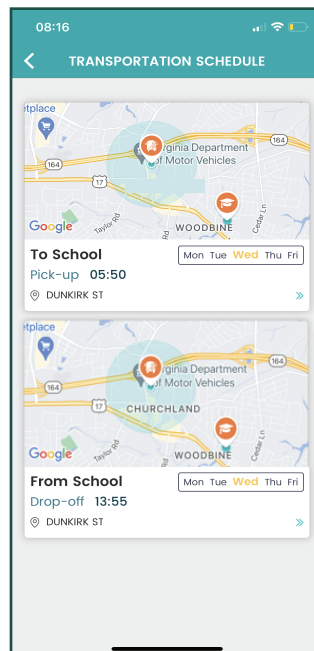
15 Transportation Schedule

When selecting Transportation Schedule, the To-School Pickup time and the From-School dropoff time is shown. Select one of the tiles to see more details.

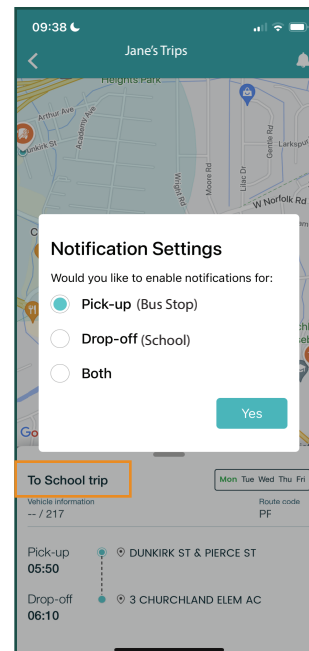
16 Notification Settings To School & From School

You can select when you would like to receive bus arrival notifications. Most parents select "Pick-Up" for the To-School trip and "Drop-Off" for the From-School trip. Some parents choose to receive notifications when the bus is approaching the school for the To-School trip. Note: The "Pick-up" notification at the school for the From-School trip may not be available for your school district.

