



TRAILBLAZER NEWS

A u g u s t 2 0 2 5

MARCUS WHITMAN MIDDLE SCHOOL

6th Grade Orientation

**We will be having 6th Grade Orientation
on Wednesday, August 20th**

Time will be from 9:00 am - 11:00 am

We are so excited to see our 6th Grade Trailblazers WEDNESDAY, AUGUST 20th from 9 - 11 AM at our MW Commons for the 6TH GRAD ORIENTATION. Please bring a water bottle and wear comfortable shoes and clothing. We have our WEB (Where Everyone Belongs) Coordinators, and our WEB Leaders, READY to welcome you to MWMS!

Our WEB Orientation is for incoming 6th grade students **only**; parents and/or siblings do not need to stay. This is an opportunity for students to meet one another and participate in some team building activities as well as learn about our school. Again, we look forward to seeing you on Wednesday August 20th, please be sure to have your student at school by 9:00 am.

PS: If for some reason you are just not able to get your 6th Grade student in for Orientation on August 20th, they will have the opportunity to check the school out at Open House Monday, August 25th from 6:00 - 7:00 PM.



First Day of School

TUESDAY, AUGUST 26TH - 8:10 AM

If your student is a bus rider be sure you check the South Kitsap Website for the bus stop and time. Under "Quick links" the first item is "Bus Routes".



SAVE THE DATE

OPEN HOUSE

MONDAY, AUGUST 25TH
6PM TO 7PM

JOIN US AND:

- RECEIVE YOUR SCHEDULE
- FIND YOUR LOCKER
- PRACTICE THE COMBO LOCK
- MEET YOUR TEACHERS
- MEET OUR NEW PRINCIPAL
- VISIT THE STUDENT STORE
- PURCHASE A SHAVE ICE FROM THE KONA TRUCK

First Day of School: Tuesday, August 26th

**Interpreters available upon request





RESERVA LA FECHA

CASA ABIERTA

LUNES 25 DE AGOSTO DE
18:00 A 19:00 HORAS

ÚNASE A NOSOTROS Y:

- RECIBE TU HORARIO
- ENCUENTRA TU CASILLERO
- PRACTICA LA CERRADURA COMBINADA
- CONOCE A TUS PROFESORES
- CONOZCA A NUESTRO NUEVO DIRECTOR
- VISITA LA TIENDA DE ESTUDIANTES
- COMPRA UN RASPADO DE HIELO EN EL CAMIÓN DE KONA

Primer día de clases: martes 26 de agosto

**Intérpretes disponibles a solicitud.



Welcome back!



The following checklist highlights important steps that will help you navigate Qmlativ - the newest version of our Skyward Student Management System



To-do

1

Sign in to Skyward Qmlativ Family Access

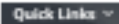
- Navigate to the Qmlativ log in page by following the link in ClassLink or by typing the URL: q.skschools.org
- You will also find a link to Qmlativ on the SKSD website under the Quick Links dropdown menu 
- Use the same username/password combination that you used to access Skyward Family Access
 - Parents who are also employees will use their network username/password to login to Skyward Qmlativ
- **IMPORTANT** Delete or update any bookmarks/shortcuts you've created to navigate to Family Access in the past



2

Explore Skyward Qmlativ Family Access

- Once logged in you'll see your student(s) along the top of the page. Select a student to see their specific information
- Click on the tiles on your home screen to view information regarding Attendance, Grading, Transportation, and more
- Use the **Home** icon to return to your dashboard

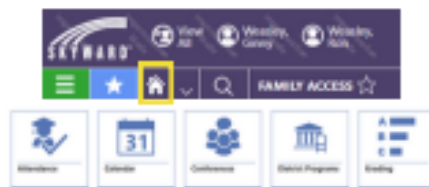

[Need help? Click here*](#)

*Some features shown may not be available for your students/school

3

Skyward Qmlativ Mobile App (optional)

- Qmlativ uses the same app that users downloaded for Skyward SMS (old version of Skyward)
- To use the newest version of the mobile app with Qmlativ, delete the Skyward app then and reinstall it by searching for "Skyward Mobile Access" in your app store
- Follow the prompts to sign in to the newest app version



[Need help? Click here](#)

SOUTH KITSAP
SCHOOL DISTRICT

Information Technology Services • 2889 Hoover Ave, Port Orchard, WA 98366 • (360) 874-7047 • <https://www.skschools.org>



Skyward Qmlativ Mobile App

Qmlativ uses the same mobile app that users downloaded for the previous version of Skyward. The app needs to be removed and then reinstalled in order to pull the most up-to-date version that runs Skyward Qmlativ.

1. If you already have the Skyward Mobile App, **please delete the app from your phone**. Press and hold the Skyward app icon and then select "Remove App" from the menu that appears.

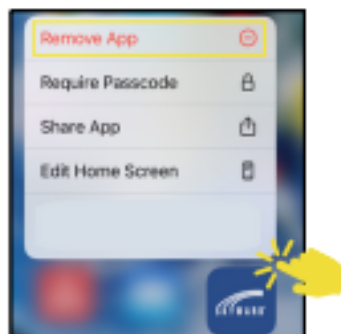

2. Visit your App Store and search for "Skyward Mobile Access", click the button to install.

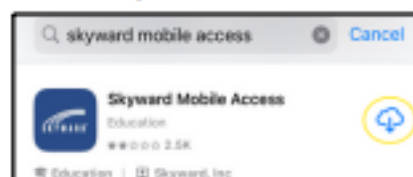

3. Once the Skyward Mobile App has finished installing, log in using the same credentials you've used to login in the past and follow the prompts to finalize adding your account. (Parents who are also employees will use their network username/password to log in).
4. Do you need help with your username/password? Call your school's office for a reset.
5. These brief videos demonstrate the process of installing the app and highlight some cool features:

- [Mobile App - *Family Access](#) *Some features shown may not be available for your students/school
- [Mobile App - Employee Access](#)

Marcus Whitman Middle School
School Supply List for 2025-26

6 notebooks (spiral or composition; at least 2 composition)
4 dozen pencils (#2 or mechanical with lead)
blue/black pens (2 packages)
Binder (1 ½ inch)
Zipper pouch
1 package dividers
Notebook paper (4 packages)
Graph paper notebook
Basic 4 function calculator - not scientific
Highlighters - 3 different colors
Sticky notes - (3x3; 2-3 packages)
Pack of colored pencils
Ruler (something not easy to break)
Package of Glue sticks
Eraser/Eraser tops

Optional: Box of Kleenex

Additional Math Supplies

8th Grade Math:

1 Protractor

1 Scientific Calculator* *we have some classroom sets quantities
are limited so student may want their own

6th Grade Math:

4 black dry erase markers



The first day of school is August 26^h!

Your student will be participating in our Annual Trailblazer Traditions the first 7 days of school and will report to their advisory classes at the start of each day 8/26-9/5. When schedules are available, have your student look for P7 and write down their room number so they can report to their class at 8:10 am each day. The Trailblazer Tradition lessons review our building wide expectations, allow students to connect to others, gives an opportunity to practice using school email, goal set, and much more! Here is the schedule for the first 7 days!

6 TH GRADE	7 TH GRADE	8 TH GRADE
ADV 8:10 8:57 (47 min)	ADV 8:10 8:57 (47 min)	ADV 8:10 8:57 (47 min)
Anmts 9:02 9:08 (6 min)	Anmts 9:02 9:08 (6 min)	Anmts 9:02 9:08 (6 min)
1 9:08 9:55 (47 min)	1 9:08 9:55 (47 min)	1 9:08 9:55 (47 min)
2 10:00 10:47 (47 min)	2 10:00 10:47 (47 min)	2 10:00 10:47 (47 min)
Lunch 10:47 11:17 (30 min)	3 10:52 11:39 (47 min)	3 10:52 11:39 (47 min)
3 11:22 12:09 (47 min)	Lunch 11:39 12:09 (30 min)	4 11:44 12:31 (47 min)
4 12:14 1:01 (47 min)	4 12:14 1:01 (47 min)	Lunch 12:31 1:01 (30 min)
5 1:06 1:53 (47 min)	5 1:06 1:53 (47 min)	5 1:06 1:53 (47 min)
6 1:58 2:45 (47 min)	6 1:58 2:45 (47 min)	6 1:58 2:45 (47 min)

SOUTH KITSAP SCHOOL DISTRICT

Nurturing Growth • Inspiring Achievement • Building Community

Chromebook Agreement & Optional Insurance Information

Student Name:

Asset Tag:

All Marcus Whitman students will be issued a Chromebook with the goals of:

- Increased opportunities for collaboration, communication and creativity
- Increased student engagement in a personalized learning environment
- Improved access to foster acquisition of knowledge and skills

The Chromebook is first and foremost an educational device. It is essential that this agreement be followed to ensure the safe, efficient, and ethical operation of these devices. SKSD retains sole right of possession of the Chromebook and related equipment (AC adapter, power cord and carrying case). There is no expectation of privacy in use or data stored on the district-owned device. The SKSD Acceptable Use policy is in effect.

Handling, Care & Use:

- You are always responsible for your own Chromebook.
- You should never share your personal login information, or let any other student use your Chromebook.
- Make sure you start each school day with a fully charged battery on your Chromebook.
- Handle the Chromebook with great care.
 - Do not throw, slide, drop, toss, etc. the Chromebook.
 - Do not carry or hold the Chromebook in the air by the screen/display.
 - Do not close the device with any items resting on the keyboard.
 - **Do not store items in your case, it is meant to ONLY hold your device.**
 - Always place your Chromebook into its protective case before moving to your next class.
- Your Chromebook should be used for school purposes only (no games, etc.)
- You should not eat or drink near your Chromebook.
- Heavy objects should never be placed or stacked on top of your Chromebook. This includes books, musical instruments, sports equipment, etc.
- Do not write on or decorate (no stickers) your Chromebook.
- Do not remove identification labels or tags placed on your Chromebook by district personnel.
- If your Chromebook is not working properly or needs repair, **please notify Mrs. Chang immediately** and bring it to the library at the first opportunity.

The district offers a Chromebook Protection plan. This plan is designed to alleviate the cost of repairing potential damage to the device. It covers accidental damage, not intentional damage. Damage caused by not following the handling, care and use directions, will result in

South Kitsap School District
Marcus Whitman Middle School
1887 Madrona Drive SE
Port Orchard, WA 98366

(360) 874-6160 Office
(360) 874-6440 Fax
www.skschools.org



SOUTH KITSAP SCHOOL DISTRICT

Nurturing Growth • Inspiring Achievement • Building Community

the full cost to repair/replace damaged items, regardless of the purchase of the Chromebook Protection plan.

The plan in 2025-26 non-refundable cost will be \$30 per student for the current school year only. Students eligible for Free or Reduced-Price lunch will pay \$10 per student. To qualify for this reduced price, make sure you complete a [School Benefits Application](#) and also the [Annual Acknowledgement](#) forms to insure your eligibility, prior to making the purchase. You can purchase at the student store or via [SKSD Web Store](#). Enrollment must be completed within the first 30 days of school or within the first 30 days of new enrollment.

Coverage is as follows:

- The first accidental damage incident in a school year is covered at 100%.
- The second accidental damage incident in a school year is covered at 50%.
- Any additional damage in a school year is the student's responsibility for full cost of repair.
- Lost or stolen devices require a \$100 co-payment, which is refunded if the device is later found or recovered. (Subsequent loss/stolen requires a \$200 co-payment)

Minor Damage:

Please note any minor damage: scratches in the plastic, cracks in the plastic, scuffs on the screen, ink/paint stains, etc. **If there are any cracks in the screen, damaged or missing keys, please bring the device to the library immediately.**

By signing below, you are acknowledging you have read, discussed and understand the information above. If you have any questions, please email or call Mrs. Chang. Email: chang@skschools.org Phone: 360-874-8175

Student Signature

Parent/Guardian Signature

****Please sign and return within a week of receipt.**

South Kitsap School District
Marcus Whitman Middle School
1887 Madrona Drive SE
Port Orchard, WA 98366

(360) 874-6160 Office
(360) 874-6440 Fax
www.skschools.org



Hello Trailblazer Families!

Your student will be issued their school Chromebook on either September 2nd or 3rd, during their Science class. At the time, they will be shown a video about how to care for their device and be given their Chromebook Agreement to take home. Please be sure to check in with them on these days, and take time to read over, fill out and sign the agreement. In the agreement, it talks about the care of the device and the district's optional Chromebook Protection Plan. Below you will find a copy of the blank Chromebook Agreement, with the information about purchasing the optional Chromebook Protection Plan via the Webstore.

Below is the information regarding the system available to help you monitor your child's activities on their school issued accounts. It includes information on how to sign up for a portal account, monitoring activity, and pausing internet access during non-school hours.

<https://docs.google.com/document/d/1jz02XpVLJ5iGF5stn9RMou8cqm64sdjK9Ae62GXQfY0/edit?usp=sharing>

If you have any questions, please feel free to email me at chang@skschools.org.

Take Care,
Carol Chang

ANNUAL Acknowledgement And Updating Skyward Information

At the beginning of each school year there are a few forms that need to be filled out and updated. These forms are available now for you to complete. Ideally we would like these completed by the first day of school so our records are accurate and up to date. Please log in to Skyward and complete these forms.

You will see the boxes below and will need to open each one and update or confirm that all the information is still correct.

Available 8/1/2025	Available 7/30/2025	Available 7/30/2025	Available 6/25/2025
ANNUAL REVIEW AND FORMS Allows One Submission	ADDRESS-CHANGE REQUEST Allows One Submission	ADD/UPDATE EMERGENCY CONTACTS Allows One Submission	UPDATE FAMILY CONTACT INFORMATION Allows One Submission

Fall Sports

Register for participation in sports is all done through Final Forms. You can find a link to Final Forms on your Parent Square access. You can also go to the Marcus Whitman Website and under athletics you can click on Register for sports.

The fall sports are Baseball, Fastpitch, and Track and Field. You will need to complete the registration process before any students are eligible to tryout.

TRACK AND FIELD

Starts Wednesday, September 3rd, 2024

Practices Run from 3pm to 5pm Monday-Thursday

No Practice on Fridays

Athletes should have all paperwork done on Final Forms and a current physical by the first day of practice.

Come prepared with workout clothes, running shoes, snacks and water!

If you have any questions please contact Coach Bates

FASTPITCH

Attention Lady Trailblazers! Fastpitch tryouts start on Sept, 3rd, Sept 4th, and Sept 5th , starting promptly from 3:00pm - 5:00pm on the softball field.

Please make sure to complete your sports physicals BEFORE the first day of tryouts and fill out Final Forms.

Bring plenty of water, dress accordingly, and have your gear ready. Bare minimum gear includes a softball glove and molded cleats. See you on the diamond!

Coach Terrell

BASEBALL

Baseball tryouts will be September 3rd, 4th and 5th. Time will be 3:00—5:30 .

The locker room will be open and available to drop off your sports bags. Be sure you have completed the registration on Final Forms. Everything must be completed before you are able to tryout.

See you on the field

Coach Kenyon

Non-Discrimination Statement

The South Kitsap School District provides equal educational and employment opportunity without regard to race, creed, religion, color, national origin, age, honorably-discharged veteran or military status, sex, sexual orientation – including gender expression or identity, marital status, or the presence of any sensory, mental, or physical disability, the use of a trained dog guide or service animal by a person with a disability. Equal access to activities, facilities and program is provided to the Boy Scouts of America and other designated youth groups. District procedure complies with all applicable state and federal laws.

The Title IX Officer, Section 504 Coordinator, and Gender Inclusivity Officer with the responsibility for monitoring, auditing, and ensuring compliance with this policy are:

Compliance/ADA/Title IX Coordinator:

Will Sarett,

Executive Director of Human Resources

2689 Hoover Avenue SE, Port Orchard, WA 98366

360-874-7071

sarett@skschools.org

Section 504 Coordinator:

Cristin Blaskowitz,

Director of Special Services

2689 Hoover Avenue SE, Port Orchard, WA 98366

360-443-3627,

blaskowitz@skschools.org

Gender Inclusivity Compliance Officer:

Monica Zuber,

Assistant Superintendent for Student Leadership

2689 Hoover Ave SE, Port Orchard, WA 98366

360-874-7003

zuber@skschools.org

