



# Eaglecrest High School

## 2025-2026

5100 South Picadilly St.  
Centennial, Colorado 80015  
720.886.1000

***“AN EXEMPLARY LEARNING COMMUNITY PREPARING  
EACH AND EVERY STUDENT FOR COLLEGE AND CAREER SUCCESS”***

### ***Administration***

Gwen Hansen-Vigil, Principal  
Tanya Bond, Assistant Principal  
Sean Dardis, Assistant Principal  
Kelly Helm, Assistant Principal  
Autumn Sereno, Assistant Principal  
Caitlin Filleman, Campus Administrator  
Melissa Laferrara, Assistant to the Principal, Activities Director  
Michelle Whittet, Assistant to the Principal, Activities Director  
Heather Nelsen, Assistant to the Principal, Athletic Director  
Vince Orlando, Assistant to the Principal, Athletic Director

### ***THIS 2025-2026 STUDENT HANDBOOK BELONGS TO:***

Name: _____	
Address: _____	
Phone #: _____	Email: _____
In case of emergency, please notify:	
Name: _____	Phone #: _____

The information in this book was the best available at press time. Watch for additional information and changes.



powered by  sdi innovations

No part of this publication may be reproduced, stored in a retrieval system, or transmitted in any form without getting prior written permission of the publisher.

© 2025. SDI Innovations. All Rights Reserved.

This product is printed in Korea

2880 OLD US HIGHWAY 231 S, LAFAYETTE IN 47909-2414 • 765.471.8883  
www.schooldatebooks.com • sdi@schooldatebooks.com

# TABLE OF CONTENTS

<b>Welcome</b> .....	<b>3</b>	Credits and Core Class Requirements .....	<b>21</b>
<b>Bell Schedules</b> .....	<b>4</b>	Credits Earned Outside of the Cherry	
<b>A/B Calendar</b> .....	<b>5</b>	Creek School District.....	<b>22</b>
<b>1st Floor Map</b> .....	<b>6</b>	Computer Academy .....	<b>22</b>
<b>2nd Floor Map</b> .....	<b>7</b>	Concurrent Enrollment Courses.....	<b>22</b>
<b>3rd Floor Map</b> .....	<b>8</b>	Final Exams .....	<b>22</b>
<b>Eaglecrest Chants</b> .....	<b>9</b>	Finals Schedule .....	<b>23</b>
Fight Song.....	9	Grading Scale .....	<b>23</b>
What is a Raptor .....	9	Grade Updates.....	<b>23</b>
Raptor Nation.....	9	Grade Weighting .....	<b>23</b>
Countdown.....	9	Graduation Distinctions.....	<b>24</b>
Yell .....	9	Graduation Ceremony Requirements .....	<b>24</b>
Party.....	9	Graduation Competency Requirements for 2025 .....	<b>24</b>
Keep That Raptor Spirit Up.....	9	Minimum Units of Credit Needed to Graduate .....	<b>24</b>
<b>Student Leadership 2025-2026</b> .....	<b>10</b>	Homework.....	<b>25</b>
<b>Student Information</b> .....	<b>10</b>	Honors Diploma .....	<b>25</b>
Eaglecrest High School Positive Behavior, Conduct,		Honor Cord Requirements.....	<b>25</b>
and Discipline.....	<b>10</b>	Independent Study.....	<b>25</b>
Attendance Policies .....	<b>10</b>	Honor Roll.....	<b>25</b>
Student Absence Excusals .....	<b>10</b>	Make-Up Work.....	<b>25</b>
Please Note .....	<b>11</b>	Pass/Fail and Audit Policy.....	<b>26</b>
All Students.....	<b>11</b>	Powerschool .....	<b>26</b>
CCSD Attendance Policy .....	<b>11</b>	Schedule Repairs.....	<b>26</b>
Early Dismissal (Individual).....	<b>11</b>	Summer School .....	<b>26</b>
Excused Absences (Ccsd Board Policy Jh).....	<b>11</b>	Technology.....	<b>26</b>
Teacher/School-Sponsored Advance Notice of Absence.....	<b>12</b>	Test Dates.....	<b>27</b>
Tardy Policy.....	<b>12</b>	Testing Center.....	<b>27</b>
Bicycles and Skateboards.....	<b>12</b>	Textbooks.....	<b>28</b>
Bookkeeping Office and Powerschool Fees/Fines .....	<b>12</b>	Transcripts .....	<b>28</b>
Building Access.....	<b>12</b>	Withdrawal From School.....	<b>28</b>
Building Hours.....	<b>12</b>	<b>Discipline</b> .....	<b>28</b>
Cafeteria .....	<b>12</b>	Discipline.....	<b>28</b>
Closed Campus Policy.....	<b>13</b>	District Discipline Policies .....	<b>28</b>
District Bus Rules.....	<b>13</b>	Notification of Nondiscrimination.....	<b>29</b>
Dress Code .....	<b>14</b>	<b>Activities</b> .....	<b>29</b>
Electronic Devices and Cell Phones.....	<b>15</b>	Involvement is the Key to Your Academic	
Hallway Policies.....	<b>15</b>	Success at Eaglecrest.....	<b>29</b>
ID Cards/Electronic ID Cards.....	<b>16</b>	Forming a New Club .....	<b>29</b>
Illness During School Hours/Medical Emergencies .....	<b>16</b>	Approval of Programs, Events, and Projects .....	<b>30</b>
Library.....	<b>16</b>	Fundraising .....	<b>30</b>
Lockers .....	<b>17</b>	Non-Curriculum Related Student Organizations.....	<b>30</b>
Lost and Found.....	<b>17</b>	Policies Regarding Distribution of Non-Curricular	
Loitering .....	<b>17</b>	Materials and School Related Publications.....	<b>30</b>
Medication.....	<b>17</b>	<b>Athletics</b> .....	<b>31</b>
Messages and Gifts .....	<b>17</b>	Athletic Fees .....	<b>31</b>
Parking.....	<b>18</b>	Athletic Forms.....	<b>31</b>
Pledge of Allegiance (House Bill 03-136).....	<b>19</b>	Centennial League Schools.....	<b>31</b>
Reporting Suspicious Activity/Safe2tell.....	<b>19</b>	Eligibility .....	<b>31</b>
Snow Days and Storm/Emergency Schedule Information.....	<b>19</b>	General Rules.....	<b>31</b>
Video Surveillance Cameras.....	<b>20</b>	Seasonal Sports.....	<b>32</b>
Visitor Policy .....	<b>20</b>	Athletic Code Violations .....	<b>32</b>
<b>Academic Policies</b> .....	<b>21</b>	Disciplinary Procedures and Athletic Sanctions.....	<b>32</b>
Academic Integrity .....	<b>21</b>	<b>Safety Information</b> .....	<b>33</b>
Advanced Placement Grades .....	<b>21</b>	Safety Information.....	<b>33</b>
Artificial Intelligence (Ai) Policy.....	<b>21</b>	School Safety-Codes & Conditions.....	<b>33</b>
Certificate Programs .....	<b>21</b>	Shelter-In-Place Drills .....	<b>33</b>
School Counseling Services .....	<b>21</b>	School Resource Officer.....	<b>33</b>

# WELCOME

Welcome to the 2025-2026 school year at Eaglecrest High School, Home of the Raptors! We look forward to the opportunities and challenges we will face together in pursuing academic excellence.

Eaglecrest High School's goal is to be an exemplary learning community that prepares each student for college success. With that in mind, this student handbook is provided to help you organize your daily academic and extracurricular activities.

The expectations, policies, and procedures contained in this handbook are designed to establish a positive school climate and to promote your success at Eaglecrest High School. It is important that you take the time to familiarize yourself with the information provided in this handbook, as it provides direction and purpose for the students, staff, and parents within the Raptor community.

We look forward to the 2025-2026 school year enthusiastically and wish you a rewarding and productive experience.

Sincerely,



Gwen Hansen-Vigil  
Principal

## SCHOOL COLORS

Red and Black

## MASCOT

Raptor





# EAGLECREST HIGH SCHOOL

## DAILY BELL SCHEDULE

### BLOCK SCHEDULE

CLASS/PERIOD	REGULAR SCHEDULE	WEDNESDAY ADVISORY SCHEDULE
1A   1B	8:20 - 9:54	8:20 - 9:43
ADVISORY	—————	9:50 - 10:30
2A   2B	10:01 - 11:35	10:37 - 12:00
3A   3B	11:42 - 1:49	12:07 - 2:00
4A   4B	1:56 - 3:30	2:07 - 3:30

### LUNCH SCHEDULE

LUNCH/CLASS	REGULAR SCHEDULE	WEDNESDAY ADVISORY SCHEDULE
1ST LUNCH	11:42 - 12:15	12:07 - 12:37
CLASS	12:15 - 1:49	12:37 - 2:00
WEST CLASSROOMS, SOUTH CLASSROOMS		
CLASS	11:42 - 1:16	12:07 - 1:30
2ND LUNCH	1:16 - 1:49	1:30 - 2:00
EAST CLASSROOMS, NORTH CLASSROOMS (PE/HEALTH), MEDIA CLASSROOMS		

Revised 7/25/24



AUGUST 2025						
S	M	T	W	T	F	S
					1	2
3	T	T	T	T	T	9
10			13	14	15	16
17	18	19	20	21	22	23
24	25	26	♣	28	29	30
31						

JANUARY 2026						
S	M	T	W	T	F	S
				X	X	3
4	•	6	7	8	9	10
11	12	13	14	15	16	17
18	X	20	21	22	23	24
25	26	27	28	29	30	31

SEPTEMBER 2025						
S	M	T	W	T	F	S
	X	2	3	4	5	6
7	8	9	10	11	12	13
14	15	16	17	18	•	20
21	22	23	24	25	26	27
28	29	30				

Daily Schedule (M, T, R, F)	
Period 1A/1B	8:20 - 9:54
Period 2A/2B	10:01 - 11:35
Period 3A/3B	11:42 - 1:49
1st Lunch	11:42 - 12:15
2nd Lunch	1:16 - 1:49
Period 4A/4B	1:56 - 3:30

FEBRUARY 2026						
S	M	T	W	T	F	S
1	2	3	4	5	6	7
8	9	10	11	12	13	14
15	X	•	18	19	20	21
22	23	24	25	26	27	28

OCTOBER 2025						
S	M	T	W	T	F	S
			1	2	3	4
5	6	7	CCR	9	10	11
12	X	X	X	X	X	18
19	20	21	22	23	24	25
26	27	28	29	30	31	

Advisory Day Schedule (WED.)	
Period 1A/1B	8:20 - 9:43
ADVISORY	9:50 - 10:30
Period 2A/2B	10:37 - 12:00
Period 3A/3B	12:07 - 2:00
1st Lunch	12:07 - 12:37
2nd Lunch	1:30 - 2:00
Period 4A/4B	2:07 - 3:30

MARCH 2026						
S	M	T	W	T	F	S
1	2	3	4	5	6	7
8	9	10	11	12	13	14
15	X	X	X	X	X	21
22	23	24	25	26	27	28
29	30	31				

NOVEMBER 2025						
S	M	T	W	T	F	S
						1
2	3	4	5	6	7	8
9	10	11	12	13	14	15
16	17	18	19	20	21	22
23	24	25	•	X	X	29
30						

X	No Classes
T	Teacher Work Day (No Classes)
	First/Last day of semester
•	Non-Contact Day (No Classes)
	A-Day Classes, 1A - 4A
	B-Day Classes, 1B - 4B
	Phase-in Days, 8/11 & 8/12
♣	Back-to-School Night, 8/27
CCR	College & Career Readiness Day, 10/8
15	SAT (11), PSAT (10)
16	CMAS (11), PSAT (9)
AP	AP Testing, Week of 5/4 & 5/11
F	Final Exams
♦	Final Exam Make-Up (by appt. only)
GRAD	Graduation, Class of 2026, 5/21

APRIL 2026						
S	M	T	W	T	F	S
			1	2	3	4
5	6	7	8	9	10	11
12	13	14	15	16	17	18
19	20	21	22	23	24	25
26	27	28	29	30		

DECEMBER 2025						
S	M	T	W	T	F	S
	1	2	3	4	5	6
7	8	9	10	11	12	13
14	15	F	F	F	♦	20
21	X	X	X	X	X	27
28	X	X	X			

MAY 2026						
S	M	T	W	T	F	S
					1	2
AP▶	4	5	6	7	8	9
AP▶	11	12	13	14	15	16
17	F	F	F	GRAD	♦	23
24	X	26	27	28	29	30
31						

Sem.1 Finals: 12/16-1A/2A/3A 12/17-4A/1B 12/18-2B/3B/4B

Sem.2 Finals: 5/18-4B/3B/2B 5/19-1B/4A/3A 5/20-2A/1A

**EAGLECREST HIGH SCHOOL (EHS #4)**  
**FIRST FLOOR**  
 5100 S Picadilly St.  
 Centennial, CO 80015  
 720.886.1000

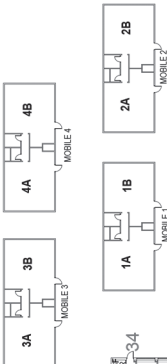
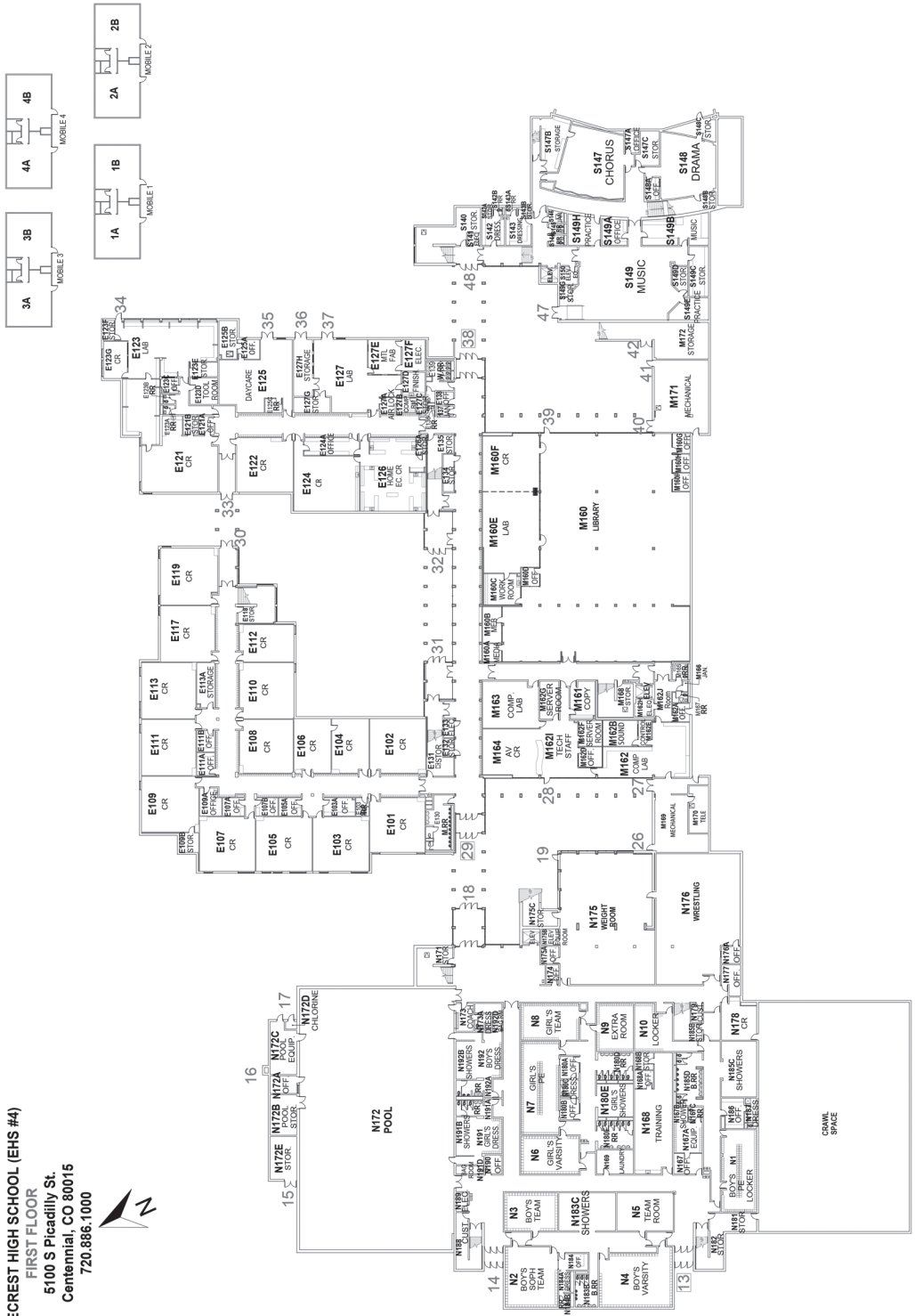

**EAGLECREST HIGH SCHOOL (EHS #4)**  
**SECOND FLOOR**  
 5100 S Picadilly St.  
 Centennial, CO 80016  
 720.886.1000

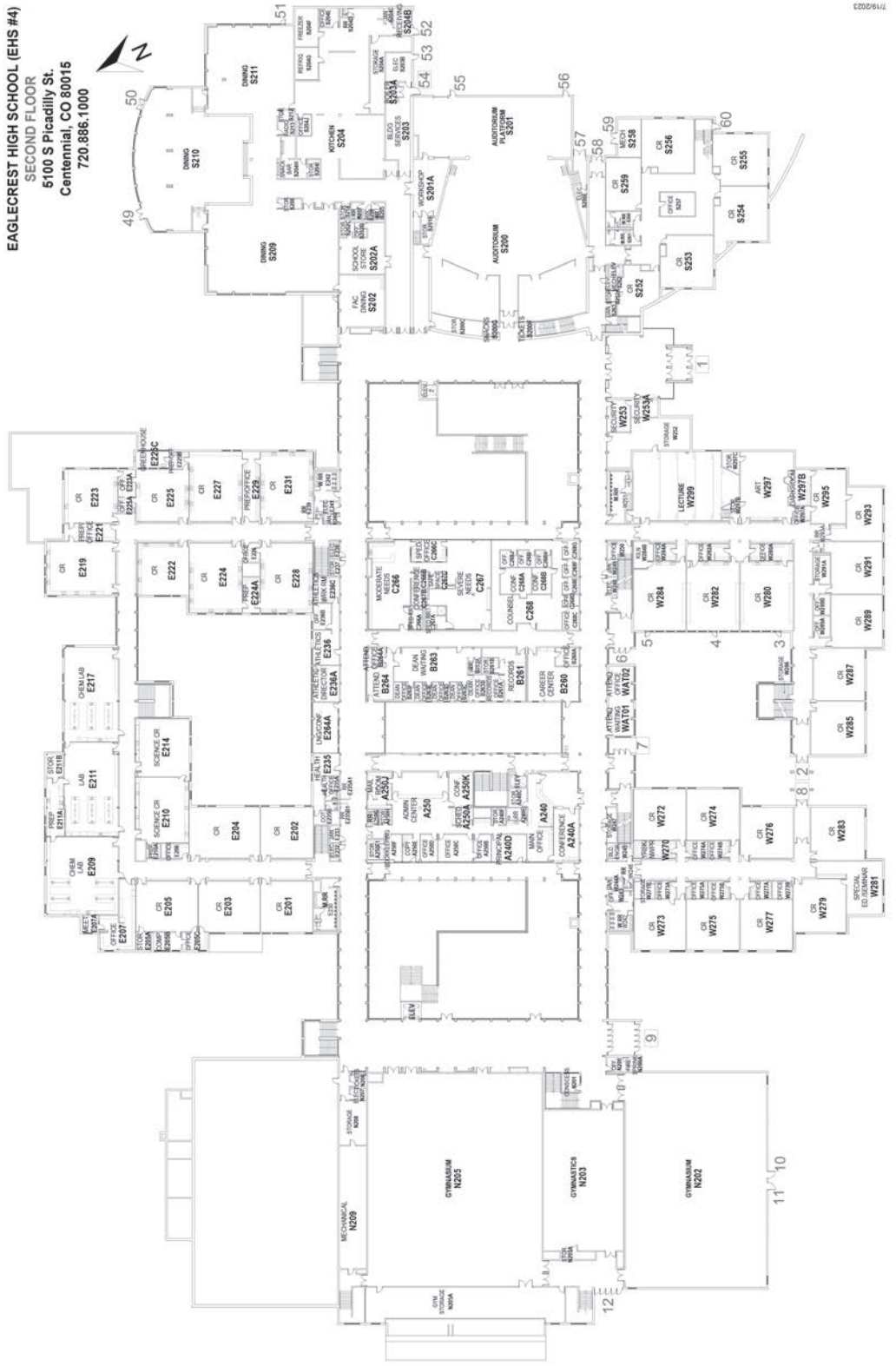

EAGLECREST HIGH SCHOOL (EHS #4)  
 THIRD FLOOR  
 5100 S Picadilly St.  
 Centennial, CO 80015  
 720.866.1000

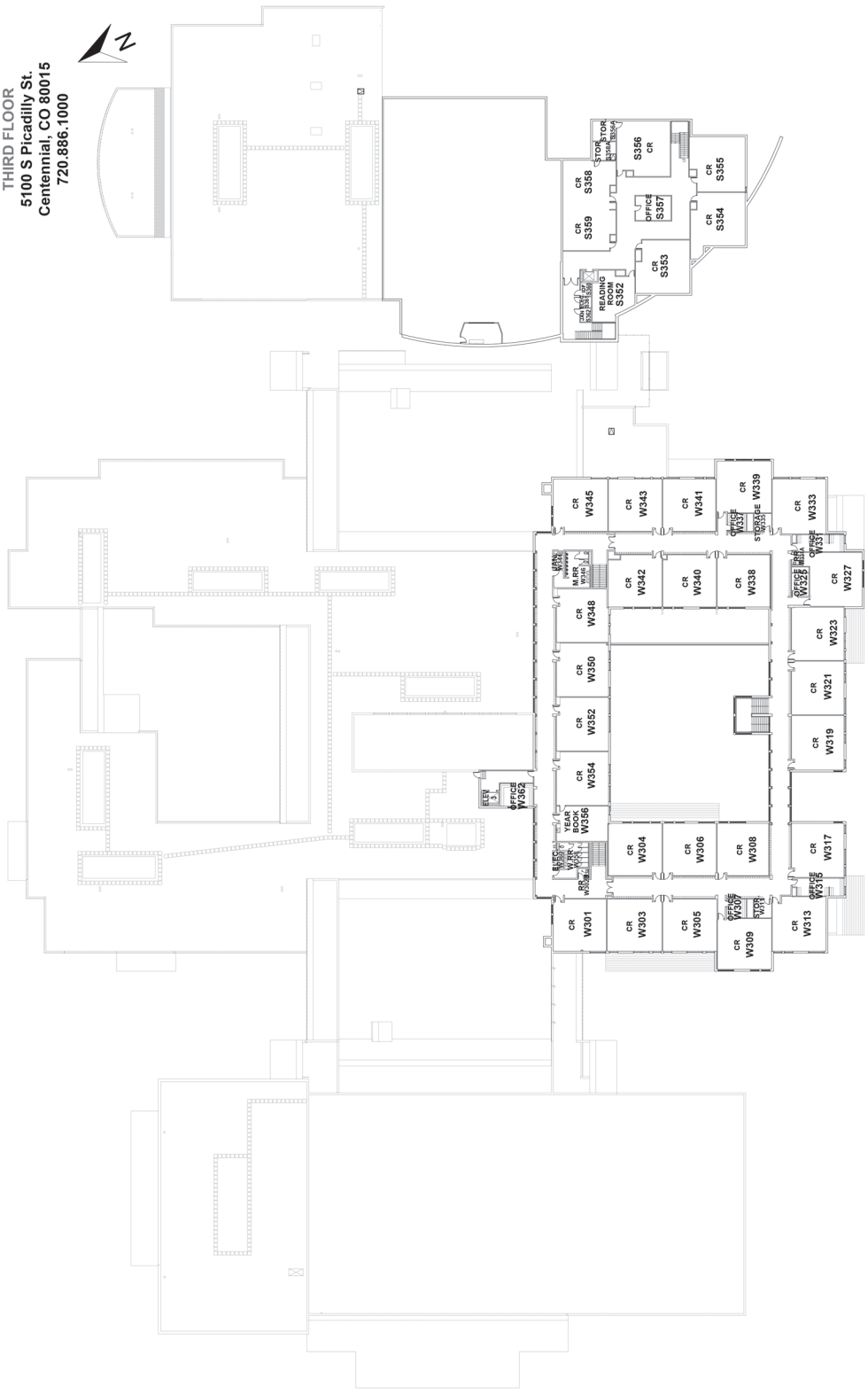

# EAGLECREST CHANTS

## FIGHT SONG

Stand up, stand up and cheer for Eaglecrest  
Fight on Raptors show them we're the best!  
Onward with spirit, pride and loyalty  
Red, black and silver fight for victory.  
At every battle we will conquer all.  
Raptors will rule the sky.  
We will show we're better than the rest.  
So, shout out the battle cry for Eaglecrest!  
Go! Raptors go!

## WHAT IS A RAPTOR?

Chant Leader: Eaglecrest!!!!  
Student Section: What?!!!  
Chant Leader: I said... Eaglecrest!!!  
Student Section: What?!!  
Chant Leader: What is a raptor?!!!  
All: A Raptor is what a Buffalo ain't,  
what a wolf wanna be,  
what a cougar can't,  
what the bears like,  
what the blazers love,  
what you know you can't get enough of  
Whoop x10  
\*Clap twice\*

## RAPTOR NATION

Rap-tor Na-tion  
We are Eaglecrest  
EHS...  
EHS...  
(x2)

## COUNTDOWN

Chant Leader: Hey Raptors!  
Student Section: Say what?  
Chant Leader: Introduce yourselves!  
Student Section: No way!  
Chant Leader: Introduce yourselves!  
Student Section: Okay!  
All: 10, 9, 8,7,6 Eaglecrest don't play no tricks  
5,4,3,2,1 Eaglecrest is number one  
Go Raptors  
Go Raptors  
Go Go  
Go Raptors

## YELL

All  
Y-E-L-L  
Y-E-L-L  
Everybody yell: GO RAPTORS!  
GO RAPTORS!  
Y-E-L-L  
Y-E-L-L  
Everybody yell: GO RAPTORS!  
GO RAPTORS!

## PARTY

Chant Leader: P-A-R-T-Y  
Party, Party's on outside  
Where is the party?  
The party's over here!  
Student Section: P-A-R-T-Y  
Party, Party's on outside  
Where is the party?  
The party's over here (2x)

## KEEP THAT RAPTOR SPIRIT UP

All Keep keep keep it up!  
Keep that Raptor spirit Up!  
Keep keep keep it up!  
Keep that Raptor spirit Up!  
Pump pump pump it up!  
Pump that Raptor spirit Up!  
Pump pump pump it up!  
Pump that Raptor spirit Up!  
Let's go go, let's fight fight, let's win win  
Let's go, fight, win!  
Let's go go, let's fight fight, let's win win  
Let's go, fight, win!

# STUDENT LEADERSHIP 2025-2026

<b>Student Body Officers</b> <b>Student Body President:</b> Luke Forbes <b>Student Body Vice President:</b> Gregory White <b>Director of Community and Culture:</b> Glory-Agnes Adjai <b>Directors of Communications:</b> Eliana Santos and Giselle Zepeda <b>Director of Philanthropy:</b> Cathleen Hagny <b>Secretary:</b> Amy Intriago <b>Senior Class President:</b> Layla Saulsberry <b>Junior Class Presidents:</b> Paige Johnson and Parker Wiley <b>Sophomore Class President:</b> Benjamin Santos	<b>Senior Class of 2026</b> <b>Class Representatives:</b> Maddox Browne, Justin Edwards, Codou Gueye, Kaileia Hill, Evan Hunt, Carlee Jackson, Riwarz Karki, Austin Luper, Khiyon McClorin, Christian Palumbo, Mikayla Reilly <b>Junior Class of 2027</b> <b>Class Representatives:</b> Elizabeth Andrusyszyn, Josiah Asibbey, Robel Eyob, JayAnthony Green, Nahla Henderson, Biram Ndiaye, Keegan Wiezorek, Jenna Winn, Adam Zabadne <b>Sophomore Class of 2028</b> <b>Class Representatives:</b> Asal Ahmed, Kaysan Ali, Piper Brunk, Karissa Diem, Addison Emgarten, Nataliya Jimenez, Molly Mabrey, Sienna Parra, Maxwell Santos, Ruth Taffese
---	--

## STUDENT INFORMATION

### EAGLECREST HIGH SCHOOL POSITIVE BEHAVIOR, CONDUCT, AND DISCIPLINE

Eaglecrest High School seeks to maintain an environment that is conducive to learning, protective of the safety and welfare of students and staff, and free from unnecessary disruption. Students are expected to pursue the educational program and to behave in such a way that their presence does not detract from their own education or the education of others. Students shall treat teachers, administrators, district employees, visitors and fellow students with dignity and respect, and shall behave in such a manner that their presence does not detract from a productive educational environment. The following guidelines are designed to ensure a positive environment. Students are expected to:

- **R**espect: Respect one another as they wish to be respected
- **A**chievement: Achieve to the best of their ability
- **P**ride: Take pride in themselves and their surroundings
- **T**eamwork: Work cooperatively with others
- **O**pportunity: Take advantage of all educational opportunities
- **R**esponsibility: Act responsibly at all times

Students are encouraged to seek out teachers, counselors, administrators, deans or staff members to help them with academic achievement, concerns or any situation that warrants problem solving.

Any student who cannot maintain their behavior and causes a disruption in the classroom, on school grounds, on school vehicles, or at school activities or events shall meet with the student's dean to develop a remedial discipline plan.

Disorderly student behavior will be addressed in a manner that allows others to learn in an atmosphere that is safe, conducive to the learning process, and free from unnecessary disruptions.

Any deviation from acceptable school behavior, which is serious enough to warrant disciplinary action, may result in a student's suspension and/or expulsion from classes in accordance with School Board Policies.

### ATTENDANCE POLICIES

Attendance Phone Numbers: 720-886-1259 (A-L) OR 720-886-1261 (M-Z)

At Eaglecrest, consistent attendance and promptness are an expectation. Accurate contact information that will allow us to reach a parent/guardian during the school day is required. You must update your information online at [www.my.cherrycreekschools.org](http://www.my.cherrycreekschools.org) to update or provide additional phone numbers.

### STUDENT ABSENCE EXCUSALS:

If a student is unable to attend school, a parent or legal guardian must do the following:

Call the Attendance Office or use the attendance form on the Eaglecrest website under the 'Parents' heading at the top of the page, if your child is going to be absent from school due to illness or a doctor's appointment. Your timely contact is essential in our response to excuse absences. When calling or using the attendance form, please leave:

- Student's name and spell out the last name
- Parent/Guardian name
- Phone number where you can be reached (which must match what is in PowerSchool)
- Absences will only be excused if the reason for the absence is specified & approved reason under Board Policy JH Excused Absences.

## **PLEASE NOTE:**

- Parents may not excuse their students from class to do independent classwork/homework or study for an exam. Parents may not excuse a student from a class to meet with a teacher from another class.
- Students who are excused must be off school grounds during an excused absence.
- If a student has 7 or more class period absences for the same course per semester (excused/unexcused), an attendance plan may be put in place for 3 weeks or a doctor's note required for the next quarter.

## **ALL STUDENTS**

Attendance, grades, and behavior can be reviewed at any time by administrators (including deans, the athletic office, & activities director) to determine if students have earned privileges such as attending school dances, attending or participating in sporting events, theatrical performances, field trips or any school-sponsored activity.

It is important for Eaglecrest to have accurate contact information that will allow us to reach a parent/guardian during the school day. To update or provide additional phone numbers, you must update your information online at [www.my.cherrycreekschools.org](http://www.my.cherrycreekschools.org).

## **CCSD ATTENDANCE POLICY:**

- If a student reaches 40 class period absences (excused or unexcused), Cherry Creek School District will send an attendance concern letter directly to families outlining suggestions for attendance support.
- If a student reaches 60 class period absences (excused or unexcused), Cherry Creek School District will send a second attendance letter in which they state that legal or medical documentation is required to excuse future absences.
- Under this policy, absences which have been legally or medically documented will not count toward the total class period absences monitored by the district. Please consider providing doctor's notes at the time of your student's absences for this reason.

## **EARLY DISMISSAL (INDIVIDUAL)**

Call 720-886-1259 (A-L) or 720-886-1261 (M-Z) at least 2 hours prior to dismissal, if possible. If the student is already at school, please call and leave a message on the voice mail.

In the event a student becomes ill at school and needs to go home, they must either:

- Report to the clinic, and the nurse will phone a parent/guardian and obtain permission.
- Have a parent/guardian call and give permission to the Attendance Office with the time the student is leaving.
- Students who leave campus without following the above procedure may be marked Unexcused.

Absences need to be excused within 48 hours. Any request to excuse an absence after 48 requires dean's approval.

In the event of a situation in which the student is supervised temporarily by an adult other than the parents, the parent should notify the Attendance Office in writing, providing the name, address, and phone number of the supervising adult.

## **EXCUSED ABSENCES (CCSD BOARD POLICY JH)**

Legally excused absences are defined by state law and by Cherry Creek School District Policy. A summary outlining excused absences is as follows:

1. A student who is temporarily ill, injured, or whose absence is approved by the administrator of the school of attendance.
2. A student who is absent for an extended period due to physical, mental, or emotional disability.
3. A student to whom a current age and school certificate work permit has been issued pursuant to the "Colorado Youth Employment Opportunity Act of 1971."
4. A student who is in the custody of the court or law enforcement authorities.
5. A student who is pursuing a work-study program under the supervision of a public school.
6. A student who is being instructed at home or under an established system of home study approved by the State Board of Education.

NOTE: According to Colorado State Law, Eaglecrest High School can only accept absences that meet the above criteria.

The district may require suitable proof regarding the above exceptions, including written statements from medical sources. If a student in an out-of-home placement (as that term is defined by C.R.S.22-32-138 (l) (e)), is absent due to court appearances and participation in court-ordered activities, such absences shall be excused. The students' assigned social worker shall verify the student's absence was for a court appearance or court-ordered activity.

*Note: The law requires the local Board of Education to designate an attendance officer for the district to enforce the provisions of the compulsory attendance law, counsel students and parents, investigate the causes of nonattendance, and report findings to the Board.*

## **TEACHER/SCHOOL-SPONSORED ADVANCE NOTICE OF ABSENCE:**

Advisors, activity sponsors, or classroom teachers who have had their field trip approved by their department coordinator and the administrator in charge will complete an Advanced Notice of Absence Form, listing all students who will attend field trip activities. These school-sponsored absences are considered an excused absence.

Attendance, grades, and behavior can be reviewed at any time by administrators (including deans, the athletic office, & activities director) to determine if students have earned privileges such as attending school dances, attending or participating in sporting events, theatrical performances, field trips or any school-sponsored activity.

## **TARDY POLICY**

All students must establish punctual attendance in each class to ensure the maximum learning opportunity each period of each day. In addition to the disruptive nature, students arriving tardy increase the detrimental effect on the learning of other students to an uninterrupted learning environment. Any student arriving tardy to class will receive a 30-minute study hall detention from a tardy station. Students arriving more than 10 minutes late will receive a 60-minute study hall detention. Students who miss their 30-minute detention will be reassigned a 60-minute detention. Students who miss a 60-minute detention will be reassigned a 90-minute detention. If a 90 minute detention is missed, consequences may include Saturday school and in-school suspension in AAIC.

## **BICYCLES AND SKATEBOARDS**

Bicycles must be parked and locked in the bike racks in front of the Administration entrance or on the East side of the building only. Bicycles are not to be parked or secured to fences, poles, or any other object on campus except racks specifically designed for that purpose. The chain or lock securing a bicycle to another object will be cut, and the bicycle will be impounded until the owner agrees to park their bike in the racks provided or agrees not to ride their bike to school. Under no circumstances are bicycles or skateboards to be stored inside the school building during the school day or while participating in extracurricular activities. Students are not to ride bicycles on pedestrian walkways. Failure to comply may result in disciplinary consequences and involvement of the legal authorities. The Aurora City Municipal Code makes it illegal to skateboard on property where "No skateboarding" signs are posted. Skateboards must be secured in lockers in front of the Athletics entrance on the East side of the building.

## **BOOKKEEPING OFFICE AND POWERSCHOOL FEES/FINES**

**Bookkeeping Phone Number 720-886-1025**

**Bookkeeping email: [droets2@cherrycreekschools.org](mailto:droets2@cherrycreekschools.org)**

The Eaglecrest High School bookkeeping office is open for payments during school hours.

- We issue receipts for all payments. Please retain these for proof of payment.
- All fees and fines can be paid online at [cherrycreekschools.org/Eaglecrest](http://cherrycreekschools.org/Eaglecrest).
- Fees and fines are entered into Powerschool during the fourth week of each semester.
- We accept payments of cash, card, or personal checks at the office.
- We accept Visa, Mastercard, Discover, and all debit cards.

## **BUILDING ACCESS**

All exterior doors are kept locked during the school day except for the Main Entrance and Student Entrance (south upper courtyard). Community members and visitors must enter Eaglecrest High School through the South Main doors during the day. All visitors must report to the Security Office upon entering the building. All students shall leave the campus before 3:45pm, unless under the direct supervision of an adult or in a school-sponsored activity. Students should arrange for pick up before 3:40pm.

Breakfast is available for students beginning at 7:45am. Students wishing to have breakfast must access the cafeteria entrance on the east side of the building.

## **BUILDING HOURS**

Eaglecrest is open to students from 8:00 am until 3:45 pm on regularly scheduled school days. The building is open at other times as scheduled by the Activities/Athletics Offices. Unsupervised students are not allowed in the building after 3:45 pm.

## **CAFETERIA**

To provide an acceptable environment where every student may eat their lunch, everyone who uses the school cafeteria must respect the rights of each student body member. The following guidelines govern the use of the cafeteria and its facilities. Violation of these guidelines will be reported to the Dean's Office. Restrictions may be placed on the use of the facility for some time.

The following are not to be considered the only areas of violation but do represent areas of major concern:

1. Students are to follow any request or instruction made or given by any person in legitimate authority, including cafeteria staff, regarding behavior in the cafeteria.
2. Each student is to clean up any food or drink spilled on the table to the best of their ability.

3. Throwing food and/or drink for any reason is considered unacceptable behavior and is grounds for suspension from school and for the automatic restriction of a student's privilege to eat in the cafeteria/courtyard.
4. Food or drink is to be consumed in the cafeteria or south upper/lower courtyard only. No food or drink is to be consumed in the hallways or the front area by the main entrance. Opened food/beverage containers may not be carried through the hallways.
5. The tables in the upper/lower courtyard or other areas that are left messy may become restricted eating areas for students.
6. Complaints about the quality of food and/or service are to be filed with the cafeteria manager, not the personnel hired to serve food.
7. Students eating in the upper/lower courtyards are expected to clean up any food/beverage spilled on the table to the best of their ability. All trash must be placed in a trash can before leaving the area.
8. Students must avoid spills or other damage to the microwaves available for student use. Any damage to school property will be repaired by the district and billed to the appropriate students, in addition to other possible disciplinary consequences for vandalism.

**Prices for the 2025-2026 school year can be found on the school website.**

### **CLOSED CAMPUS POLICY**

The campus is closed to freshmen and sophomore students. Freshmen and sophomores will be given the appropriate disciplinary consequences for violating this rule. Juniors and seniors can leave campus during their resource/study periods. Students are responsible for returning to campus on time for their next scheduled class or obligation. Students are not allowed on other CCSD properties unless they are a student of that school (for example CCIC) or for arranged activities (such as field trips).

### **DISTRICT BUS RULES**

Students are only permitted to ride the bus as designated by the Cherry Creek School District Department of Transportation. The following rules, developed by the District Transportation Department, are enforced on all District vehicles to assure the safety of students. Please refer to Cherry Creek School District Board Policy JICC for more information.

1. You **must** have your Eaglecrest student RFID card to ride a District school bus.
2. Follow the bus driver's directions the first time they are given.
3. Be in your seat whenever the bus door is closed.
4. Keep hands, feet, books, and objects to yourself.
5. No fighting and/or horseplay.
6. No weapons or facsimiles, including laser pointers and pens.
7. No swearing, rude gestures, cruel teasing or put downs.
8. Use classroom voices on the bus.
9. Do not throw anything off the bus or have any part of your body outside of the bus.
10. Do not eat or drink while on the bus.
11. Do not bring anything alive or dangerous (e.g., glass containers, sharp objects) on the bus.
12. No skateboards or roller blades allowed on the bus.

### **INFRACTIONS OF THE RULES WILL RESULT IN DISCIPLINARY ACTIONS WHICH MAY INCLUDE SUSPENSION OF BUS PRIVILEGES.**

District procedures require the administrator or designees to take appropriate disciplinary action (ranging from assigned seating to suspension of bus privileges) depending on the seriousness of the problem. Students are expected to behave appropriately at bus stops as well as on the bus. Students who are picked up or dropped off at other district schools must stay in the designated area and follow all school rules. If parents have any questions about District Bus Rules or disciplinary procedures, they should call their student's Dean, 720-8876-1040, or the District Transportation Department at 720-554-5667.

## **DRESS CODE**

### **Philosophy**

Eaglecrest High School's student dress code supports equitable educational access. This policy is written in a manner that does not perpetuate stereotypes. To ensure effective and equitable enforcement of this dress code, school staff shall enforce the dress code consistently and in a manner that does not lead to marginalization or oppression of any group based on race, sex, gender identity, gender expression, sexual orientation, ethnicity, religion, cultural observance, household income, or body type/size.

### **Values:**

- Allow students to wear religious attire without fear of discipline or discrimination.
- Allow students to wear clothing that expresses their self-identified gender.
- Prevent students from wearing clothing or accessories that interfere with the operation of the school, disrupt the educational process, invade the rights of others, or create a reasonably foreseeable risk of such interference or invasion of rights.
  - Students should dress in such a way that teachers are not burdened with the additional and often uncomfortable topic of dress code enforcement.
  - All students should be able to engage comfortably in the educational environment without fear of or actual unnecessary discipline or body shaming.
  - Student dress code enforcement should not result in unnecessary barriers to school attendance.
  - All students and staff should understand that they are responsible for managing their own personal "distractions" without regulating individual students' clothing/self-expression.
  - Staff will work towards a fair and consistent implementation of this policy.

Eaglecrest High School expects that all students will dress in a way that is appropriate for the school day or for any school-sponsored event. Student dress choices should respect the intent of Eaglecrest High School and the Cherry Creek School District to sustain a community that is inclusive of a diverse range of identities. The primary responsibility for a student's attire resides with the student and their parent(s) or guardian(s). The school district is responsible for seeing that student attire does not interfere with health or safety of any student, that student attire does not contribute to a hostile or intimidating atmosphere for any student, and that dress code enforcement does not reinforce or increase marginalization or oppression of any group based on race, sex, gender identity, gender expression, sexual orientation, ethnicity, religion, cultural observance, household income, or body type/size. Restrictions to the way a student dresses is necessary to support the overall educational goals of the school, thus are explained within this dress code policy. A representation of students, parents, staff, and administration developed the following standards:

#### 1. Basic Principles:

- Certain body parts must be covered for all students at all times. Clothes must be worn in a way such that genitals, buttocks, breasts, nipples, and navels are fully covered with opaque fabric. All items listed in the "must wear" category below must meet this basic principle.
- A reasonable cleanliness of person and apparel is expected as a matter of health and wellness.

#### 2. Students Must Wear:

- A shirt with fabric in the front, back, and on the sides under the arms).
- Pants/jeans or the equivalent (for example, a skirt, sweatpants, leggings, a dress, or shorts) which should be worn at or above the hips.
- Shoes

Courses that include attire as part of the curriculum (for example, professionalism, public speaking, and job readiness) may include assignment-specific dress, but should not focus on covering bodies in a particular way or promoting culturally specific attire. Activity-specific shoe requirements are permitted (for example, athletic shoes for PE).

#### 3. Students Cannot Wear:

- Clothing or accessories that contain violent language or images.
- Clothing or accessories that contain images or language depicting drugs/alcohol or any illegal item or activity.
- Clothing or accessories that contain hate speech, profanity, or pornography.
- Clothing or accessories that contain images or language that create a hostile or intimidating environment based on any protected class or consistently marginalized group.
- Clothing that reveals visible undergarments (visible waistbands and visible straps are allowed as long as this is done in a way that does not violate Section 1 above).
- Swimsuits (except as required in class or athletic practice).
- Accessories that could be considered dangerous or could be used as a weapon.
- Apparel that endangers the student (clothing that poses a risk while participating in classroom activities, such as pottery or science labs, and accessories such as chains, spikes, or jewelry that could be detrimental to the safety and welfare of students, staff, or other persons).
- Items that may be interpreted as representing unauthorized groups (bandanas, logos, symbols, and/or language).

## ELECTRONIC DEVICES AND CELL PHONES

By setting clear guidelines and expectations for cell phone/personal device usage, Eaglecrest High School aims to create a positive and productive academic atmosphere for each and every student. These expectations will promote and support the student learning experience to:

- Minimize Classroom Distractions
- Foster Face-to-Face Communication
- Encourage Active Participation in Students' Learning
- Support Academic Honesty
- Promote Digital Citizenship

Policy Statement: At Eaglecrest High School, we believe in creating a positive learning environment that fosters academic growth, effective communication, and responsible digital citizenship by limiting the use of cell phones/personal devices for non-academic purposes in classrooms. The policy for supporting the appropriate usage of cell phones/personal devices in all academic and non-academic environments (bathrooms) is as follows :

- Students will store and place all cell phones/personal devices in a designated location determined by the classroom teacher
- Cell phones/personal devices can be used when expressly directed by a teacher solely for educational purposes

If a student violates the school's or teacher's expectations, the following process will be followed:

- Teacher follows the communicated classroom expectations and guidelines
- Conversation with student and parent/guardian
- If necessary, refer to the Dean's office

**1st Incident:** When a cell phone/personal device is confiscated, the student can pick up the cell phone/personal device in the Dean's Office. He/she will be assigned a 30-minute academic study period.

**2nd Incident:** When a cell phone/personal device is confiscated, a parent can pick up the electronic device/cell phone in the Dean's Office. The student will be assigned a 90-minute academic study period.

**3rd Incident:** When a cell phone/personal device is confiscated, a parent can pick up the electronic device/cell phone in the Dean's Office. He/ she will be assigned a Saturday School.

**4th incident:** When a cell phone/personal device is confiscated, a parent can pick up the electronic device/ cell phone in the Dean's office. He/ she will be assigned an ISS (AAIC).

**5th Incident and beyond:** Consequences will continue and may include a meeting with all stakeholders to develop a plan for future cell phone us

**NOTE: Eaglecrest High School is not responsible for cell phones/electronic devices that are stolen or lost.**

## HALLWAY POLICIES

The hallways in the academic area need to be quiet and orderly during class hours to enhance the learning environment. Students are to use the hallways as pathways and not a destination. Students are not permitted in the hallways during the No Fly Zone, the first and last 10 minutes of class.

1. Students' behavior and language are to be acceptable and compatible with the desired learning environment. Students must have a hall pass while in the hallways during an academic period.
2. Romantic and physical demonstration of affection such as kissing, are not acceptable hallway behavior.
3. Sitting or standing in the hallways in a way that blocks traffic flow and interferes with academic pursuits in classrooms will not be permitted.
4. Food is to be consumed in the cafeteria and upper/lower courtyards only. Food and drink are prohibited in all of the hallways and classrooms. Only unopened food and drink may be stored in a student's locker and taken to the cafeteria to be eaten.
5. Only clear water bottles/containers with a lid are allowed in the hallways and classrooms.
6. Any open food or drink items will be confiscated and disposed of if found in the hallways or classrooms.
7. Sports equipment will not be permitted in any hallway.
8. Students with a study period will be required to be in the appropriate locations (Library, Café, MPC, Courtyard)

## **ID CARDS/ELECTRONIC ID CARDS**

All students are required to carry a Student Identification Card with them while in the building. The I.D. card will be required to receive the following services:

1. Checking out books in the Library, checking out materials, and using computers
2. Using computers in the Media Productions Center
3. Admission to all regular athletic events
4. Checking in at Tardy Stations
5. Picking up a yearbook
6. Voting in school elections
7. Attending dances
8. Other identified school events
9. Accessing district transportation services (all students must present their student ID to ride a CCSD bus)

Students can access an electronic version of their student ID by downloading the Minga app from the Apple or Google Play Store.

All students must produce their identification cards when requested by faculty, staff, or security personnel. Failure to carry an identification card, refusal to produce the card, or surrendering the card may result in disciplinary action.

The cost of replacement ID cards is \$5, payable to the Bookkeeper. Replacement cards may be obtained in the security office by the main doors during school hours.

## **ILLNESS DURING SCHOOL HOURS/MEDICAL EMERGENCIES**

### **Illness During School Hours**

A registered nurse is on duty during the school day. Services relating to general health problems, acute illness, and emergency first aid are available to all students and employees. Students who become ill during the school day should report to the nurse. The nurse will evaluate the nature of the problem and assist the student in contacting parents/guardians for transportation home if the nurse determines this is the best course of action. If students do not follow this procedure and go home due to illness, their absence will be considered unexcused. Only those people whom parents/guardians have designated may take a student home from school. Parents should ensure that reliable people are listed in PowerSchool. It is a District Policy that a sick student cannot be transported by another student except a sibling.

### **Medical Emergencies**

In the event of a medical emergency, all decisions as to treatment, destination, and hospitals will be made by the Emergency Response Team. It is critical that parents/guardians provide accurate contact information through the district check-in forms process as this is the only means the clinic has to locate parent's/guardian's contact information during a medical emergency. Any changes to contact information must be submitted by the parents/guardians via the online system.

## **LIBRARY**

**Library Phone Number: 720-886-1095**

**Hours: 8:00 AM – 3:45 PM Monday – Friday**

**Library website: <https://bit.ly/EaglecrestLibrary>**

The nationally award-winning Eaglecrest Library is a welcoming academic environment available for students to access before school, after school, and during study periods. Library staff, including certified teacher-librarians, are available to support students in choosing and locating books for pleasure and academic reading, as well as in helping students with all aspects of the research process.

### **Student Resources and Services**

The library has over 10,000 fiction and non-fiction print books and access to over 23,000 eBooks and audiobooks via the CCSD Sora app from OverDrive. We welcome all student requests. Please complete a book request form found at the circulation desk. From our library's website students can access academic research resources through a variety of online databases.

Students must have their Eaglecrest ID to enter the library. Students must have their Eaglecrest ID for book or item checkout. Books are due back to the library four weeks after checkout date, but may be renewed if needed for longer. Students may check out up to five books at a time. Inter-library loan is available; please see a member of the library staff to have books transferred to EHS from other district libraries.

Other resources available for students to use in the library include desktop computers and a student work area that includes a printer/copier/scanner, stapler, and three-hole punch. Students may also check out materials like colored pencils, markers, glue sticks, tape, and scissors from the circulation desk with an ID.

## **LOCKERS**

Lockers are an option made available for student use for the school year. Students accepting usage of the lockers must also accept the related responsibilities, including keeping the assigned locker clean both inside and out and paying for any damage to the locker. The student will be issued a \$25.00 fine if the locker is not cleaned out at the end of the school year. Lockers are school property and are under the control of the Cherry Creek School District. Eaglecrest High School assumes no responsibility for lost or stolen property or money kept in lockers and reserves the right, consistent with state law, to search lockers when necessary to ensure safety and enforce school and District policies.

## **LOST AND FOUND**

Lost and Found items, including ID cards, wallets, keys, jewelry, etc., are taken to the security office at the school's main entrance. Unclaimed items will be donated after two weeks. This will also include items found in lockers of withdrawn students and at the end of the school year after locker cleanout.

## **LOITERING**

Students are not permitted to loiter in the hallways, back/front parking lots, on athletic fields, perimeters of campus, or in cars. Loitering within 1000 yards of the school is not permitted. This area includes the surrounding neighborhoods immediately adjacent to Eaglecrest High School. Any questions regarding appropriate areas should be directed to the deans or security. Students are expected to be on campus only during the time periods designated within their academic/extracurricular activities schedule. Students found loitering in undesignated areas will be assigned disciplinary consequences.

## **MEDICATION**

High School students have the privilege of taking their own medications during the school day.

1. **Students carrying their own medication may bring a one day supply with them each day.** Medications must be carried in the original packaging that identifies the content, dose, and frequency it may be taken. Prescription medication must be in a pharmacy container that includes the name of the medication, dose, time, and student's name. Under no circumstances should students share their medication with other students. If they do so, they will be subject to disciplinary action.
2. **Clinic administration of medication provides for accountability that regular doses are received or allow students who regularly use medication to store it at school so it is available.** A permission form must be completed and signed by the parent and physician before the nurse may administer medication to a student. This is for both prescribed and over-the-counter medication.
3. To be given occasional over-the-counter (OTC) medication in the clinic, the OTC form found on the district check-in forms must be completed and submitted online. We strongly encourage students to bring their own OTC medications (while following the district guidelines). This minimizes interruptions to valuable class instructional time.

## **Controlled Substances**

Please be aware that controlled medications present a greater than usual risk of becoming habit forming or being used illegally. Controlled medications are under the jurisdiction of the Federal Drug Enforcement Agency. Some examples of common controlled medications include: Ritalin, Dexedrine, tranquilizers, muscle relaxants, phenobarbital, and pain medication containing codeine.

## **Homeopathic Medications**

Homeopathic medications are treated as a prescription medication, requiring a physician's authorization as well as permission from the Cherry Creek Medical Advisory Board. Both authorizations must be in place before homeopathic medications can be administered by the school nurse.

**Under no circumstances should students share their medications with other students. They will be subject to disciplinary action.**

## **MESSAGES AND GIFTS**

Only emergency messages will be delivered to a student. An emergency is an accident, illness, or serious family problem. If information about transportation, doctor appointments, house keys, etc., is available after your child leaves for school, please instruct them to check with you during the day for an update. We cannot accept deliveries for students. Items like food delivery services, flowers, balloons, stuffed animals, cookie bouquets, etc., should be sent to the student's home rather than the school. The Main Office staff will not sign for or accept these items. Forgotten items delivered by parents will be kept in the Main Office until the student picks them up.

## **PARKING**

Parking on the EHS campus is restricted to eligible students who:

- Register vehicles for authorized parking on campus. Non-registered vehicles parking on campus or cars in areas other than those designated as student parking are subject to ticketing and towing at the owner's expense.
- Attend a parking meeting in August or view a 10-minute parking video prior to purchasing a parking permit. The parking expectation video can be viewed in the Dean's Office.
- Complete the EHS Parking Application. Include a copy of the following: student's valid driver's license, vehicle registration, and insurance.
- Pay for a parking permit. Permits may be purchased at the Bookkeeping Office **for \$50**. Students take their receipt to the security to obtain your parking permit. Parking permits must be displayed on the vehicle's windshield.
- Do not have outstanding fines. All EHS student fines need to be paid in full to be eligible for parking privileges.
- Are a junior or senior. Parking permits are provided on a first-come, first-served basis. There are a limited number of permits. If there are remaining parking permits, sophomores may be eligible for a permit during second semester.

**Driving and parking on campus is a privilege, not a right.** This privilege can be revoked if the student fails to operate the vehicle per state law and school rules. The privilege of parking on EHS school property is extended in exchange for granting consent to the school administration to search the vehicle without warning when the administration has reason to believe that the items contained in the vehicle threaten the general safety of students and staff. To park a vehicle on school property, consent must be given to seize potentially dangerous items to protect the common good. Even though a student pays a parking fee, the school is not responsible for loss or damage that may occur in the parking lot. The parking fee only allows the student to park on campus.

*The parking lots are off-limits to loitering during school hours. Additionally, students must follow Colorado Law (SB-036/April 2005) pertaining to drivers under 21, including:*

1. *No passengers under age 21, until the driver holds a valid driver's license for at least six months (siblings and passengers with medical emergencies excepted.)*
2. *At most, one passenger under the age of 21 until the driver holds a valid driver's license, for at least one year (siblings and passengers with medical emergencies excepted.)*
3. *No more than one passenger in the front seat of a vehicle driven by a person under 17, and the number of passengers in the seat must not exceed the number of seatbelts. All passengers must wear seatbelts.*

The EHS Security Team will strictly enforce the policies and consequences outlined.

Students who park on the EHS campus must have a valid EHS parking permit.

1. Students must park in the designated student parking spaces **ONLY**. There is no student parking in the faculty and visitor parking areas. Students found parking in the faculty or visitor lot will be assessed fines (described below). Student parking is in the northwest lot in front of the building and the back parking lot outside the bus loop.
2. Students cannot park in handicapped spaces or fire lanes. Socializing in vehicles or the parking lot is not permitted at any time.
3. A \$25 fine will be assessed if the permit is not returned at the end of the school year. The same parking permits will not be used the following school year.
4. The following parking policy will be enforced for those students who do not have a parking permit and park illegally.
  - 1st offense - The vehicle will be ticketed, and a \$30 fine will be assessed to the student. Students can buy a parking permit for an additional \$50.
  - 2nd offense—The vehicle may be booted. The vehicle will be ticketed, and a \$50 fine will be assessed. The fine must be paid before the parking boot is removed. Once the student pays the fine, as long as parking permits are available, the student will be given a parking permit.

The following parking policy will be enforced for those students with a valid parking permit who park illegally or do not abide by the above-stated rules:

- 1st offense: The vehicle will be ticketed, and the student will be assessed a \$30 fine.
- 2nd offense - The vehicle will be ticketed, and an additional \$30 fine will be assessed. The student will meet with the dean and communicate with parents.
- 3rd offense - The vehicle may be booted. The car will be ticketed, a \$50 fine will be assessed. The fine must be paid before the parking boot is removed.
- Additional offenses - The vehicle may be booted and a \$50 fine will be assessed. The fine must be paid before the parking boot is removed.

Students may not park in reserved parking spaces at any time. As noted above, student vehicles will continue to be ticketed, fines assessed, and towed at the owner's expense for any infraction. Don't hesitate to contact the EHS Security office at 720-886-1043 for any questions or concerns.

#### CCSD Board Policy JQ-1

*In order to generate revenue for the improvement and maintenance of parking areas and grounds, parking fees will be assessed at senior high school campuses.*

*The fees will be collected at the time of student registration or shortly thereafter. Parking fees paid by students may be refunded if requested within the timeline set by senior high schools.*

*The number of permits issued at each school campus will be limited to the number of parking spaces available. Each school will establish permit eligibility and priority for its students in accordance with individual parking lot capacities.*

*Parking fee rates will be established by the Board of Education and implemented beginning in the 1993-94 school year*

*Adopted: September 13, 1993, LEGAL REFS: C.R.S.22-32-117 C.R.S. 22-45-104*

Note: Parking fee refunds must be requested from EHS Security within 30 days of purchase. No refund will be given after 30 days.

### **PLEDGE OF ALLEGIANCE (HOUSE BILL 03-136)**

- (2) (a) *"The teacher and students in each classroom in each public high school in the state of Colorado shall recite aloud the Pledge of Allegiance to the flag of the United States of America when the school conducts its daily announcements. If a public high school does not conduct daily announcements, then the teacher and student in each classroom in the public high school shall, on a daily basis, recite aloud the Pledge of Allegiance to the flag of the United States of America."*
- (2) (b) *"Nothing in this subsection (2) shall be construed to require a teacher or a student to recite the Pledge of Allegiance described in paragraph (a) of this subsection (2) if the teacher or student objects to the recitation of the Pledge on religious grounds. A student shall be exempt from reciting the Pledge of Allegiance if a parent or guardian of the student objects in writing to the recitation of the Pledge on any grounds and files the objection with the principal of the school."*
- (2) (c) *"Nothing in this subsection (2) shall be construed to require students and teachers who are not United States citizens and are attending or teaching school in the state of Colorado to recite the Pledge of Allegiance described in paragraph (a) of this subsection."*

**Any student or staff member who chooses not to recite the Pledge will be asked to remain respectful and quiet during the Pledge.**

### **REPORTING SUSPICIOUS ACTIVITY/SAFE2TELL**

Safe2Tell number is 1-877-542-7233

website: [www.safe2tell.org](http://www.safe2tell.org)

The Cherry Creek School District provides an opportunity for students, parents, and community members to provide information regarding the illegal or inappropriate activity occurring at Eaglecrest High School or involving one of our students. The opportunity to remain anonymous exists with each message. All information will be held in confidence. As with all disciplinary investigations at Eaglecrest, the rights of the accused will be upheld.

### **SNOW DAYS AND STORM/EMERGENCY SCHEDULE INFORMATION**

Should inclement weather or emergency situations result in the closing of District schools or in an adjustment to school start or dismissal times, the information will be posted on the District web site, recorded on our hotlines and conveyed to a number of radio and TV stations for broadcasting.

#### **Website**

Any weather-related schedule changes will be posted to a link on the District's website: <http://www.cherrycreekschools.org> by 5:00 am. You may want to bookmark this address for easy access.

#### **School Closure**

When early morning weather and road conditions are deemed hazardous, especially for school bus transportation, the District will announce closure of schools on local radio, television stations, and news websites. Additionally, you may call the District Weather Line at 720-554-4701.

- All activities scheduled in district facilities will be canceled.
- In-district sports events and team practices will be postponed.
- If a league event is scheduled in the district, the event will be postponed.
- If the event is scheduled to be played in another district, the host district determines whether it is postponed.

## **Delayed Start**

When early morning conditions are not deemed serious enough to close school, but are likely to cause delays, school bus pick up times and school start times may be delayed. This information is available on the District Weather Line at 720-554-4701. The delayed start schedule for schools is as follows:

- High Schools: Bus pick-up and school starting times will be delayed by 90 minutes.
- Endeavor: Delayed 90 minutes
- I-Team Ranch: Delayed 90 minutes
- Expulsion: Normal Schedule
- Facility shuttles are cancelled

## **Early Dismissal (School-wide)**

If serious storm conditions or other emergency situations develop during the day, the District will monitor the situations and advise affected schools and the Transportation Service as soon as possible of a decision to dismiss school early. Parents are encouraged to stay tuned to local radio and television stations or watch the EHS website for updated information. Please be sure your contact information is up-to-date in PowerSchool in the event of any ConnectEd messages.

## **Late Dismissal**

In case of dangerous weather warnings or other emergency situations, a school may hold students past their dismissal time for safety reasons.

## **School Closure**

If a snow day or a cancellation occurs, the next school day will resume as the next scheduled block day. All students will report to their first class as scheduled.

Important: Parents are encouraged to formulate plans for their child(ren) in an emergency. Arrangements should be made for their child(ren) to go to a neighbor's house, or have access to their home and directions for contacting a parent. A child will never be released to a person without proper identification and clearance from the school.

## **VIDEO SURVEILLANCE CAMERAS**

USE OF VIDEO CAMERAS TO MONITOR STUDENT BEHAVIOR POLICY (JICA). The Board of Education recognizes the District's continuing responsibility to maintain and improve discipline and to promote the health, welfare, and safety of its staff and students. After having weighted carefully and balanced the rights of privacy of students with the District's duty to promote discipline health, welfare, and safety of staff and students, the Board supports the use of video cameras on its transportation vehicles and in District schools. Video cameras may be used to monitor student behavior in school facilities, on school property and on school vehicles transporting students to and from school. Students in violation of conduct rules shall be subject to disciplinary action in accordance with established Board Policy and regulations governing student conduct and discipline. The District shall comply with all applicable state and federal laws related to video recordings when such recordings are considered for retention as part of the student's behavioral record as determined by the District and in accordance with law. Video surveillance shall be used only to promote the order, safety and security of students, staff and property. Proposed: January 11, 1999 Adopted: February, 8 1999 Effective: February 8, 1999 Legal Refs: 20 U.S.C. 1232g (Family Educational Rights and Privacy Act of 1974) 42 U.S.C. 1201 et seq. Americans with Disabilities Act 34 C.F.R. 99.1 et seq. (regulations)

## **VISITOR POLICY**

Only adult visitors may be on campus during the school day. Visitors must check in with security, show proper identification and indicate the reason for being at school. Visitors must wear a name tag at all times. Out-of-town guests, friends of students, relatives, best friends, etc., cannot visit between the hours of 7:30 am and 3:30 pm. Any unauthorized visitors will be escorted by security to the Security Office, where they will fill out a trespassing notification form and could be issued a trespassing ticket by the Arapahoe County Sheriff's Office. While school is in session, alumni may visit the school during school hours but must schedule appointments with the staff to visit classrooms or offices and follow established visitor check-in procedures.

The school's main entrance is located at the south end of the building. Visitors may park in any available spot at the south end of the parking lot. Security personnel will be available at the office located just inside the entrance to check in visitors. Please remember that you will be asked to provide a driver's license or picture ID when you sign in.

# ACADEMIC POLICIES

## ACADEMIC INTEGRITY

Plagiarism and cheating will result in failure of the assignment and possibly failure of an entire course of work. In addition, the student will receive disciplinary consequences. All incidents will be reported to parents, and disciplinary consequences will be assigned. Please refer to the Cherry Creek School District Discipline Policy JICDA.

- 1st Incident: Conference with teacher, communication with parent/guardian, and consequence which could include an In-School Detention.
- 2nd Incident: Communication with parent/guardian and 2 days OSS.
- 3rd Incident: Communication with parent/guardian and 4 days OSS.

## ADVANCED PLACEMENT GRADES

Advanced Placement grades reflect classroom performance for the entire year. Scores on the Advanced Placement examination reflect test performance only and are not computed into the grade for the course. Grades will not be changed if scores of 4 or 5 are earned on the examination; however, often high scores will earn college credit and an advanced standing as determined by the individual college or university.

## ARTIFICIAL INTELLIGENCE (AI) POLICY

Generative AI tools, if accessed, must be used ethically, responsibly, and intentionally to support student learning, not to bypass it. Accordingly, assignments and assessments must be completed without the assistance of generative AI tools unless explicitly approved by the course instructor. Unapproved use of generative AI tools will be considered academic dishonesty and may result in consequences outlined in the EHS academic policies.

## CERTIFICATE PROGRAMS

- Journalism Arts Certificate Program

The Journalism Arts Certificate is a program unique to Eaglecrest. This program is for students interested in pursuing a career in journalism, photography, public relations, business, graphic design, and more. Students who specialize in this area receive both a Journalism Arts Certificate and an Honors cord by completing a minimum of two honors/AP English courses, Journalism, and 2 years in Yearbook, Newspaper, or Video Broadcast. Students must also take elective courses specific to gaining knowledge and insight useful in a productions class. At the end of the program, students submit an online portfolio. Students also have the ability to participate in summer workshops, state and national conventions, and state and national contests.

- Sci-Tech Certificate Program

The Eaglecrest Sci-Tech program is a college preparatory program for students who will pursue degrees in science, technology, engineering, and/or mathematics (STEM). The program requires students to complete an above average course load which allows the student to specialize in an area of academic interest. In order for a student to complete the overall program requirements, they must also complete an advanced level capstone project that reflects original thought, demonstrates the application of core concepts, demonstrates an understanding of the relationship between core academic STEM areas, and meets the elevated expectations of faculty advisors and professionals from related STEM industries. Upon completion of the program, Sci-Tech students are well prepared to succeed in a variety of post-secondary educational environments.

## SCHOOL COUNSELING SERVICES

The Eaglecrest High School Counseling program, in partnership with other educators, parents/guardians, and community stakeholders, provides intentional, student-centered support to meet the varying academic, post-secondary, and social emotional needs of all students. We collaborate to identify barriers and implement solutions that promote equitable outcomes for students and engage the entire school community. It is our vision that every student will acquire the skills necessary to live a healthy, responsible, and productive life.

## CREDITS AND CORE CLASS REQUIREMENTS

9th grade: 7.25 credits	11th grade: 6.0 credits
10th grade: 7.0 credits	12th grade: 5.5 credits

In addition to the credit requirements for each class all students will be expected to enroll in a minimum of 4 academic core units every year in CCSD. **Seniors are expected to enroll in 4 academic core units or a minimum of 3 AP/IB courses.** Any consideration of a waiver of this expectation will be approved on an individual basis by the principal or administrative designee. Academic Waiver Requests must be submitted on form IKF-1-E.

\*\*Student athletes who have completed a season of athletics may be granted a one-time waiver of 0.5 of the required 1.5 units of physical education. This waiver does not reduce the total number of units required for graduation. Medical/Physical Education Waiver Requests must be made through the Counseling office.

## **CREDITS EARNED OUTSIDE OF THE CHERRY CREEK SCHOOL DISTRICT**

A maximum of 2.0 credits earned outside the Cherry Creek School District can be applied toward graduation. This includes correspondence credit and/or summer school credit earned in another school district. Students wishing to earn credits outside the Cherry Creek School District must have these requests approved by the student's counselor. This policy does NOT apply to transfer students or to students whose class has already graduated. Additional questions should be directed to the Counseling department.

## **COMPUTER ACADEMY**

PLATO Computer Academy is an online computer program that allows students an opportunity to recover credit in a class that the student has previously failed. As this credit retrieval opportunity is a privilege, it is important that students use their time in Computer Academy efficiently or they may be dropped from the program. Students will earn an "S" for Satisfactory or "US" for Unsatisfactory. Computer Academy courses are not NCAA approved. Eaglecrest has limited spots available in this program and offers only certain classes. Students should see their counselor for more information.

## **CONCURRENT ENROLLMENT COURSES**

Approved courses offer college credit through Community College of Aurora, Red Rocks Community College, and Arapahoe Community College. Eaglecrest concurrent enrollment teachers will assist students with the application process. Please see the Eaglecrest Course Guide for more information.

## **FINAL EXAMS**

At the end of each semester, three days are devoted to final exams. All students are expected to take final exams.

No early finals will be given. If a student misses a final exam, a grade of 0 (zero) will be recorded in the gradebook and the semester grade will be calculated. No "Incompletes" will be given. Students will have the opportunity to make-up missed exams.

- At the end of first semester teachers and students should arrange a time to administer the make-up exam to the student.
- At the end of second semester the teacher will give a copy of the make-up final to the Main Office staff. The student needs to call the school to set a time to take the exam. When the student has completed the test, the teacher will grade the exam at their earliest convenience and process a grade change form with the Records Office.



## FINALS SCHEDULE

### 1ST SEMESTER:

#### Tuesday, December 16, 2025

Period 1A 8:20 - 9:50 am  
 Period 2A 10:00 - 11:30 am  
 Period 3A 11:40 am - 1:10 pm

#### Wednesday, December 17, 2025

Period 4A 8:20 - 9:50 am  
 Period 1B 10:00 - 11:30 am

#### Thursday, December 18, 2025

Period 2B 8:20 - 9:50 am  
 Period 3B 10:00 - 11:30 am  
 Period 4B 11:40 am - 1:10 pm

#### Friday, December 19, 2025

Make-up exams by appointment only - no buses

### 2ND SEMESTER:

#### Monday, May 18, 2026

Period 4B 8:20 – 9:50 am  
 Period 3B 10:00 – 11:30 am  
 Period 2B 11:40 am – 1:10 pm

#### Tuesday, May 19, 2026

Period 1B 8:20 – 9:50 am  
 Period 4A 10:00 – 11:30 am  
 Period 3A 10:40 am – 1:10 pm

#### Wednesday, May 20, 2026

Period 2A 8:20 – 9:50 am  
 Period 1A 10:00 – 11:30 am

#### Friday, May 23, 2025

Make-up exams by appointment only - no buses

### GRADING SCALE

A	90 - 100%
B	80 - 89%
C	70 - 79%
D	60 - 69%
F	Below 60%
WP	Withdrawn Passing
WF	Withdrawn Failing
I	Incomplete
S	Satisfactory (Pass)
US	Unsatisfactory (Fail)

Historical grade reports will be mailed home at the end of each semester. At any time throughout the school year, parents and students can check academic progress and attendance history on PowerSchool. Grades will be updated every three weeks on PowerSchool. Please feel free to contact teachers about academic progress in individual classes and counselors to discuss overall academic achievement. If an Incomplete is given, it is considered an 'F' for eligibility and GPA until the Incomplete is changed to a letter grade. The change must occur within 9 weeks. If not, the grade changes to an 'F' permanently.

### GRADE UPDATES

Eaglecrest High School uses the PowerSchool database program. Parents and students have web-based access to their student's grades, attendance, and assignments via a secure password. Late work will be updated as time permits in the teacher's schedule.

### GRADE WEIGHTING

The Cherry Creek School District transcript reflects both weighted and unweighted grade point averages. Weighted grades are given in those courses designated as either Honors or Advanced Placement. The difference between weighted and unweighted grades in terms of grade point value is as follows:

<u>Unweighted</u>	<u>Weighted</u>
A 4 grade points	A 5 grade points
B 3 grade points	B 4 grade points
C 2 grade points	C 3 grade points
D 1 grade point	D 1 grade point
F 0 grade point	F 0 grade point

## **GRADUATION DISTINCTIONS**

Students have multiple opportunities to earn distinctions for graduation. Students who meet the requirements for an Excellence Medal may wear this at the graduation ceremony. Students who meet the requirements for AVID, Sci-Tech, Honors Diploma, and/or who have a cumulative GPA of 3.5 or higher will earn a cord that can be worn at the graduation ceremony. For additional graduation distinctions, please contact the Activities Office.

## **GRADUATION CEREMONY REQUIREMENTS**

In order to participate in the Eaglecrest High School graduation ceremony students must:

1. Complete all graduation requirements.
2. Attend the spring graduation meeting, with a parent/guardian.
3. Attend the required graduation rehearsals.
4. Clear all fees/fines.

Any junior who is considering early graduation must confer with their counselor no later than December of their junior year to start a multi-step formalized process.

Attendance, grades, and behavior can be reviewed at any time by our deans to determine if students have earned privileges such as attending any school dance, sporting event, theatrical performance or any school sponsored activity. Seniors are put on notice that poor attendance, poor grades, and/or poor behavior can adversely affect participation in all senior activities which include, but are not limited to prom, sporting events (home or away), exit assembly, and Graduation.

In pursuit of its mission to ensure that all students reach their learning potential, the Board of Education recognizes that high school shall be generally considered as a 4-year course of study. Therefore, graduation requirements are based on units of credit earned in grades nine through twelve. A unit of credit is defined as the amount of credit given for the successful completion of a course, which meets the required hours of instruction as defined in state law.

In order to prepare students for a successful post-secondary educational and work experience, the Board of Education strongly encourages students to participate in a rigorous academic core curriculum consisting of 4 years of English, 4 years of mathematics, 4 years of science, 4 years of social studies, and at least 2 years of a World Language, as recommended by the Colorado Commission on Higher Education for admission to 4-year public colleges and universities in Colorado.

## **GRADUATION COMPETENCY REQUIREMENTS FOR 2025**

In to the Colorado Department of Education, in addition to the minimum required credits, every student must demonstrate college and career preparedness in both English and mathematics to earn a high school diploma. The Cherry Creek School District offers a menu of options for students to demonstrate their learning and preparation. Students are encouraged to discuss and regularly monitor these options with their family, counselor, and teachers.

Please visit the Cherry Creek School District website for more information: <https://www.cherrycreekschools.org/Page/4122>

## **MINIMUM UNITS OF CREDIT NEEDED TO GRADUATE**

A minimum of 22 units of credit shall be necessary for high school graduation. In addition to the 16.5 required units, all other credits shall be considered as electives and may be selected from the entire curricular offerings. Minimum credit requirements in various areas shall be as follows:

<u>Subject Area</u>	<u>Credits</u>
English*	4.0
Social Studies*	3.0
(U.S. History)	(1.0)
(Government)	(0.5)
Math*	3.0
Science*	3.0
World Language	0.0
Practical/Fine Arts/CTE	1.5
P.E.	1.5
Health	0.5
Electives	5.5
<b><u>Total minimum credits</u></b>	<b><u>22.0</u></b>

\*Academic core subjects

## **HOMEWORK**

CCSD Board Policy IKE states, "It is recognized that all learning cannot be accomplished within the limited amount of time allotted for classroom instruction. Therefore, homework is routinely assigned to students in the Cherry Creek Schools."

Homework is an important part of high school courses. Teachers assign homework for various reasons including reinforcing classroom lessons, checking for understanding of material presented in class, internalizing key concepts with practice and providing opportunities for creativity and preparing for proficiency exams. With Eaglecrest's alternating block schedule, **students are encouraged to complete homework on the night it is assigned.**

## **HONORS DIPLOMA**

The Honors Diploma Program is an individualized program which provides structure and support for high-achieving students to prepare for college success. The program is designed to provide a well-rounded high school experience including Honors and Advanced Placement courses, extra-curricular activities, community service involvement, and extended learning opportunities. The goal of these components is to provide a variety of learning experiences to challenge and engage students during their high school years.

## **HONOR CORD REQUIREMENTS**

Rationale: Eaglecrest offers honors programs and honor societies for students who excel academically and seek an enriched and challenging learning environment. Graduates who fulfill the requirements are eligible to wear honor cords, which are provided by the school and departments. The requirements for graduating with an honor cord are different for each society, and there is a minimum expectation of academic achievement in order to receive an honor cord for graduation. The GPA requirements are to ensure that all graduates receiving an honor cord are truly the definition of "graduating with academic honors."

Cumulative GPA Requirement	Determined by the Honor Society
GPA within the Department Classes Taken During High School	Determined by the Honor Society
Other Requirements	Determined by individual Honor Society, such as enrollment in Honors and Advanced Placement courses

Definitions:

- GPA requirement is a minimum
- Individual Honor Societies may choose a higher GPA for eligibility
- Eligibility is tabulated after 7 semesters of high school: however, no cord will be given to a student who is not in good standing to complete the eighth semester

## **INDEPENDENT STUDY**

A student wishing to pursue a course of study not available in the regular curriculum should see a counselor for specific information. *The process involves a content area teacher and requires administration approval.* Independent Study petition applications are due the third week of the first semester for year-long and first semester courses and the third week of the second semester for second semester courses. NCAA does not accept Independent Study courses for college eligibility.

## **HONOR ROLL**

The Honor Roll will recognize students with GPAs in the following categories each semester:

4.0 & Above      3.75 - 3.99      3.5 - 3.74

## **MAKE-UP WORK**

Assignments are frequently made ahead of time so that when students are absent from school, even for several days, they can keep up with work satisfactorily until they return. In case of a short absence, students can usually call classmates to get their homework assignments. With a block schedule, students are encouraged to see their teachers for make-up work on the day they return, whether the missed classes meet that day or not.

Make-up work should be submitted within a period of time no longer than the time missed from school. For example, if a student has an excused/unexcused absence from a Monday class and learns of the assignment in class on Wednesday, the make-up work is due at the beginning of the next class session, in this case, a Friday. Students or parents can request make-up work for emergency or planned and approved absences of two days or longer by emailing their teachers.

Arrangements to collect homework assignments can be made when a student is absent for 3 or more days. Contact the Counseling Office at 720-886-1175. Parents will be asked for an email address, as much of the work can be sent electronically. Any hardcopy homework collected will be available in the Counseling Office for pick-up the afternoon of the following school day.

## **PASS/FAIL AND AUDIT POLICY**

Eaglecrest High School has a Pass/Fail and Audit policy. Students who believe one of these grading options is best for them should speak with their counselor for more information. Administrative approval is required. Students are responsible for understanding the policies of colleges or universities to which they may apply regarding courses taken Pass/Fail. Student athletes are also responsible for understanding NCAA Eligibility regulations and the Colorado High School Activities Association (CHSAA) regarding courses taken Pass/Fail and their eligibility.

## **POWERSCHOOL**

PowerSchool is a real-time web based student information system. Parents and students have access to grades, attendance records and other school-related information. PowerSchool is available online at [my.cherrycreekschools.org](http://my.cherrycreekschools.org). Students and parents can receive their personalized login information from the Media Productions Center (MPC). A valid picture ID is required.

## **SCHEDULE REPAIRS**

The master schedule is designed based on the requests students make during registration. In the event that a requested course is full or conflicts with another course, alternate requests will be used. Changes will not be made to schedules **unless** one of the following repairs are needed:

1. An incomplete schedule resulting from the closure of a requested course
2. An incomplete schedule that does not include a sufficient number of credits
3. An incomplete schedule that does not include sufficient core classes (4 academic classes or 3 AP courses for seniors only)
4. A schedule that places the student in the wrong level of a course
5. A schedule that doesn't include a course(s) required for graduation (seniors only)

## **SUMMER SCHOOL**

Courses taken for credit after the 9th grade year in an approved summer school program will be recorded on the student's permanent transcript, and grades and credits received will apply toward graduation. Courses taken in the summer prior to 9th grade will appear on the students transcripts, but no credit will be awarded.

## **TECHNOLOGY**

### **Guidelines**

Because electronic information is so volatile and easily reproduced, respect for the work of others is especially important in computer environments. Likewise, respect for and care of computer equipment is essential to provide working access for all. Plagiarism, invasion of privacy, unauthorized access, copyright violations, damaging, modifying or attempting to modify computer files, systems, records, or facilities are grounds for disciplinary action and possible legal action.

The use of the internet at EHS is for the support of curricular goals and objectives. This does not include playing games, downloading music, or engaging in social media or online messaging. Violation of district or school rules may result in loss of computer use privileges.

### **General Information**

Each student is provided with a district-issued computer upon check-in and is expected to bring it to school each day, fully charged. The computer is the student's responsibility as long as they attend Cherry Creek Schools. The student is responsible for any loss or damage to the computer. Information on policies and fines can be found on the district website under Programs and Services > Information Systems and Technology > Student Device FAQ.

Access to electronic network resources is available to students and staff through the use of the Cherry Creek School District Network (CCSD Net). CCSD Net is a Wide Area Network that connects all Cherry Creek Schools and provides access to electronic networked resources including the internet. Access to CCSD Net offers a vast array of educational resources to both students and staff. The goal in providing this service is to promote educational excellence and student achievement in the schools by facilitating resource sharing, innovation, and communication.

The smooth operation of the network relies upon the proper conduct of the users who must adhere to strict guidelines. Basic guidelines are provided here to increase awareness of the responsibilities users assume. If a user violates any of these provisions, their account could be terminated and future access may be denied. Possible disciplinary action may result. If possible criminal activity is discovered, the proper authorities will be notified. Disciplinary action for students will be in accordance with existing discipline policies and may include suspension and/or expulsion. Marking "Yes" on the Internet and Network Resources and Acceptable Use Waiver during online check-in indicates the student and parent/guardian completing check-in have read the terms and conditions carefully, understand(s) their significance, and agree to fully comply with them.

### **Network Information and Etiquette**

Access to network resources, including the Internet, is a privilege requiring student and parent signatures on an Acceptable Use Agreement and provided under the following terms:

## Usage Regulation

1. Use of CCSD Net must be in support of the educational objectives of the Cherry Creek School District. Transmission of any material in violation of any federal or state law or regulation is prohibited. Use for commercial activities is prohibited unless prior written consent from the Cherry Creek School District has been granted.
2. Cherry Creek School District does not represent or warrant that the functions of the system will meet any specific requirements or that it will be error free or uninterrupted; nor shall it be liable for any direct or indirect, incidental, or consequential damages (including lost data and information) sustained or incurred in connection with the use, operation or inability to use the system.
3. CCSD uses Securly for internet safety and web filtering. All internet browsing activity is filtered at home just like at school. Securly is a CIPA (Children's Internet Protection Act) compliant internet filter. The internet filtering is based upon age of the student. It is acknowledged that not all student access to the internet can or will be supervised, however any action by a user that is determined by Cherry Creek School District to constitute an inappropriate use of CCSD Net or to improperly restrict or inhibit other members from using CCSD Net is strictly prohibited and may result in termination of privileges and/or disciplinary action. The user specifically agrees not to access, submit, publish, display or print over CCSD Net any defamatory, inaccurate, abusive, obscene, profane, sexually oriented, threatening, racially offensive or illegal material. The user further agrees to use CCSD Net in accordance with all copyright laws. Copying, saving or redistributing copyrighted material is not allowed and users should assume material is copyrighted unless explicitly noted.
4. Cherry Creek School District does not and cannot control internet content or access thereto, some of which may be deemed offensive by some, therefore the school district shall not be responsible for any material or information accessed on the internet by any user and shall not be responsible for the impact or effect of the information on the user. Use of any information obtained via CCSD Net is at your own risk. Cherry Creek School District specifically denies any responsibility for the accuracy or quality of information obtained through CCSD Net, and it exercises no control whatsoever over the content of the information residing on or passing through the system. Products or services may not be purchased through CCSD Net. Files stored on district servers, electronic mail and use of CCSD Net are not private, and may be subject to inspection and/or monitoring.
5. Vandalism shall result in cancellation of privileges. Vandalism includes any malicious attempt to harm, destroy or alter data on CCSD Net. Any attempt to access restricted data will result in termination of privileges and/or disciplinary action. CCSD Net administrators reserve the right to monitor any and all activity on the system.

## **TEST DATES**

### **PSAT National Merit Scholarship Qualifying Test**

#### Test Date

October 2025 Testing Window is TBA

Registration information for ACT & SAT I or SAT Subject exams are available in the EHS College and Career Center or online at [www.act.org](http://www.act.org) and [www.collegeboard.com](http://www.collegeboard.com), respectively.

## **TESTING CENTER**

The Testing Center is available to students to make-up exams or do exam retakes. It is located in Room S366 in the South Wing. The Testing Center is open daily from 8:30 am – 4:00 pm. Students will be required to show a photo ID to take a test. There are no cell phones, iPods, or any electronic devices allowed in the Testing Center. Any cell phone use or visibility of a cell phone in the Testing Center may result in a "Zero" on the student's exam.



## **TEXTBOOKS**

### **Bookroom Phone Number 720-886-1196**

The Eaglecrest High School Bookroom is open during school lunch hours.

- Textbooks are issued to students and are the responsibility of the student. Students must have a valid EHS ID in order to check out textbooks.
- The student may write their name in the front of the textbook.
- Textbooks are checked out by semester and year. All books are due the day the class concludes and should be returned to the Bookroom in a timely manner.
- Novels may be assigned to individual classes and are the responsibility of the student to be returned to the Bookroom at the completion of the unit.
- If textbooks/novels are not returned at the end of the school year, the full replacement value of the book will be assessed in Powerschool fees. Fees for books will be removed upon return of the book in good condition or the student may pay the replacement value fee on Powerschool.
- If a textbook/novel is returned in poor condition the full replacement value of the book will be assessed in Powerschool fees.

## **TRANSCRIPTS**

Unofficial transcripts will be mailed home at the close of each semester with letter grades used to indicate the quality of level of academic achievement.

To request official school transcripts, complete a Transcript Request Form in the College and Career Center. There is a charge of \$5 for each official transcript request. Unofficial transcripts can also be obtained from the College and Career Center free of charge.

## **WITHDRAWAL FROM SCHOOL**

When a student needs to withdraw from school, the student and parent must initiate this process by contacting the Registrar in the Records Office at 720-886-1190. Please allow at least one to two hours for withdrawing a student because the student will need to go to every class for a withdrawal grade. All textbooks, materials, athletic equipment, technology, and student ID will need to be turned in.

# **DISCIPLINE**

## **DISCIPLINE**

Students are assigned a Dean of Students who will handle discipline or attendance problems. We expect students to share in the responsibility for maintaining a safe, orderly and clean place to learn. Deans are available to provide support to and intervention with students who have specific complaints about behavior problems with other students. Eaglecrest High School personnel will make reasonable attempts to inform parents of a violation of school rules. A parent conference will be necessary for readmission following an out-of-school suspension, depending upon each individual situation and/or the discretion of the dean. Parents may request a conference with their student's dean at any time by calling the dean's office.

## **DISTRICT DISCIPLINE POLICIES**

Please take time to review the following district and school policies in detail and contact your dean with any questions. Full policies can be reviewed at [www.cherrycreekschools.org](http://www.cherrycreekschools.org).

Appropriate consequences including, but not limited to, suspension and/or expulsion will be enforced for every student committing any of the following infractions:

1. Causing or attempting to cause damage to school property or stealing or attempting to steal school property of value.
2. Causing or attempting to cause damage to private property or stealing or attempting to steal private property.
3. Commission of any act which if committed by an adult would be robbery or assault as defined by state law. Expulsion shall be mandatory in accordance with state law except for commission of third degree assault.
4. Violation of criminal law which has an immediate effect on the school or on the general safety or welfare of students or staff.
5. Violation of District policy or building regulations.
6. Violation of the District's policy on dangerous weapons in the schools. Expulsion shall be mandatory for carrying, bringing, using, or possessing a dangerous weapon without the authorization of the school or school district, in accordance with state law.
7. Violation of the District's alcohol use/drug abuse policy. Expulsion shall be mandatory for sale of drugs or controlled substances, in accordance with state law.
8. Violation of the District's policy on smoking, vaping, and use of tobacco.
9. Violation of the District's policy on sexual harassment.

10. Throwing objects, unless part of a supervised school activity, that can cause bodily injury or damage property.
11. Directing profanity, vulgar language, obscene gestures toward other students, school personnel, or visitors to the school.
12. Engaging in verbal abuse, i.e., name calling, ethnic or racial slurs or derogatory statements addressed publicly to others that precipitate disruption of the school program or incite violence.
13. Committing extortion, coercion or, blackmail, i.e., obtaining money or other objects of value from an unwilling person or forcing an individual to act through the use of force or threat of force.
14. Lying or giving false information either verbally or in writing to a school employee.
15. Scholastic dishonesty which includes but is not limited to cheating on a test, plagiarism or unauthorized collaboration with another person, in preparing written work.
16. Continued willful disobedience or open and persistent defiance of proper authority, including deliberate refusal to obey a member of the school staff.
17. Repeated interference with the school's ability to provide educational opportunities to other students.
18. Behavior on or off school property which is detrimental to the welfare, safety, or morals of other students or school personnel.

### **NOTIFICATION OF NONDISCRIMINATION**

Cherry Creek School District No. 5 ("District") does not discriminate on the basis of race, color, national origin, sex, age, sexual orientation, or disability in admission to its programs, services, or activities, in access to them, in treatment of individuals, or in any aspect of their operations. Eaglecrest High School does not discriminate in enrollment or access to any of its available programs. The lack of English language skills shall not be a barrier to admission or participation in District activities and programs. The District also does not discriminate in its hiring or employment practices.

This notice is provided as required by Title VI of the Civil Rights Act of 1964, Section 504 of the Rehabilitation Act of 1973, Title IX of the Education Amendments of 1972, the Age Discrimination Act of 1975, and the Americans with Disabilities Act of 1990. Questions, complaints, or requests for additional information regarding these laws may be forwarded to the designated compliance coordinator, Ms. Stephanie Davies, Equity Compliance Officer and Associate Legal Counsel, 4700 S. Yosemite St., Greenwood Village, CO 80111, telephone 720.554.4471, or directly to the U.S. Department of Education, Office for Civil Rights, Region VIII, Federal Office Building North, 1244 Speer Blvd., Suite 310, Denver, CO 80204.

## **ACTIVITIES**

### **INVOLVEMENT IS THE KEY TO YOUR ACADEMIC SUCCESS AT EAGLECREST**

As an Eaglecrest Raptor you are encouraged to get involved in the numerous clubs and activities that are available for you to pursue your interests, talents, and passions. Eaglecrest's staff currently sponsors 50 clubs.

Research indicates that students who feel a connection to their school and who get involved in extracurricular activities will be more successful academically, as well as, socially. Our clubs and activities promote leadership opportunities, school and community service opportunities, and the ability to make new friendships with peers and adults. Skills, knowledge, and traits for success are developed through involvement in clubs that will enhance students' potential for success throughout their four years of high school and beyond. In addition, college and university admission requirements look for individuals who have developed talents, service, skills, and leadership through involvement in extracurricular clubs and activities.

It is truly amazing to see the dedication of our students and staff who get involved and the difference they make in their own lives and the lives of others. Please stop by the Activities Office or go online to the club information page for a complete list of clubs and contact information

Attendance, grades, and behavior can be reviewed at any time by administrators (including deans, the athletic office, & activities director) to determine if students have earned privileges such as attending school dances, attending or participating in sporting events, theatrical performances, field trips or any school-sponsored activity.

### **FORMING A NEW CLUB**

Because becoming involved and connected to Eaglecrest is so important, there are always opportunities for new clubs to be formed. There will be a limit to how many new clubs can be formed each school year. To start a new club:

1. An Eaglecrest staff member must be willing to sponsor the club.
2. A "New Club Request" form must be filled out by the Eaglecrest staff member and returned to the Activities Office. The Activities Director will then meet with the sponsor and interested students in order to approve the new club. The proposer will meet with the Activities Director and new clubs will be taken into consideration if they meet school and District guidelines. New clubs will be allowed only if their goals/interest are significantly different than clubs that already exist.
3. A form of interested members will need to be completed (a minimum number will be required).
4. The club should meet a minimum of 25 hours during the school year.
5. New clubs will only be allowed to form during Semester 1. Once clubs begin they will go into a trial phase for one semester to be sure the club has enough members to continue.

## **APPROVAL OF PROGRAMS, EVENTS, AND PROJECTS**

The following procedures must be followed in order to put on any school-wide event. All forms must be filled out and returned to the Activities Office at least three weeks prior to an event.

1. The staff member responsible for the event must discuss the event with the Activities Director three weeks prior to the event.
2. If there is a need for security, a Request for Security Form must be filled out by an Eaglecrest staff member. Request for Security forms are available in the Activities Office.
3. A Building Usage Request must be filled out online by an Eaglecrest staff member (please do not ask students to request building space).
4. After the requests have been filled out and submitted to the Activities Office, the Activities Director will advise the sponsor of approval or disapproval of the event.

## **FUNDRAISING**

All fundraising requests must be made through the Activities Office at least two (2) weeks prior to the fundraising event. Please follow the appropriate procedures below:

1. Complete the online fundraising request form.
2. After the fundraising request has been approved by the Activities Director, fill out a Building Usage Request form if use of the building is necessary.
3. Please do not solicit funds directly from staff. An approved flier may be put in staff boxes.
4. If you are selling food, you must first get approval from Food Services and the Activities Director.

## **NON-CURRICULUM RELATED STUDENT ORGANIZATIONS**

Students are permitted to initiate non-curriculum-related organizations. Students may conduct meetings, consistent with Cherry Creek School District Board Policy JJAB, on school premises only during non-instructional time so that meetings do not interfere with the orderly conduct of the educational activities of the school. Meetings of non-curricular student groups must be scheduled, organized, and conducted within the guidelines established by this policy and accompanying regulations. Prior approval must be obtained through the Activities Director for non-curriculum-related organizations and meetings. All necessary information and guidelines are available in the Activities Office.

## **POLICIES REGARDING DISTRIBUTION OF NON-CURRICULAR MATERIALS AND SCHOOL RELATED PUBLICATIONS**

### **Flyers, Ads, and Promotions**

#### **Poster Approval Guidelines**

All posters advertising events/fundraisers/etc. must have the activities approval stamp prior to being displayed anywhere in the building. This includes the hallways, gymnasiums, cafeteria, and classrooms.

#### **Regarding Eaglecrest Sponsored Events**

1. Posters must be neat, professional looking, and have appropriate language.
2. Posters must have proper time, place, location, contact person, and proper spelling.
3. Posters must be removed by the sponsoring group following the event.
4. Posters may not be put on any stairwells, windows, display cases, or painted walls.

#### **Regarding Non-Eaglecrest Sponsored Events**

Any communications not directly related to Eaglecrest sponsored activities must be approved through the Activities Office. Non-school sponsored posters may not be posted in the school without prior approval from the Activities Office.

\*The only non-school sponsored posters that are typically approved are those advertising events of the schools in our feeder area. We do not advertise for private athletic clubs, dance studios, religious institutions, or any other types of private company events.

#### **Approved Poster Locations**

Approved locations within the building for displaying posters, flyers, and other advertisements and promotions are as follows:

1. Approved bulletin boards throughout the building. Do not cover or tape other flyers/posters.

# ATHLETICS

## ATHLETIC FEES

A student is required to pay a \$90 (subject to change) participation fee for **each** season of their competition. This fee is due prior to the beginning of **each** season.

## ATHLETIC FORMS

Athletes must have all forms signed prior to practice. Forms can be obtained online from the EHS home page.

<http://eaglecrest.cherrycreekschools.org> The necessary forms are located on the "Athletics" site at [eaglecrest.ccsdathletics.org](http://eaglecrest.ccsdathletics.org).

### **Forms Include:**

- CCSD Student-Athlete/Parent Concussion
- Responsibility & Acknowledgement Agreement
- Athletic Registration
- Transportation Awareness/Site Management Consent & Release
- Participation Agreement
- Athletic Emergency Information
- CCSD Spectator Code of Conduct

All participants must provide clearance from the bookkeeper's office concerning unpaid fines. This information must be returned to the Athletic Office before an athletic clearance sheet is given to the coach.

## CENTENNIAL LEAGUE SCHOOLS

Arapahoe    Grandview    Cherokee Trail

Overland    Cherry Creek    Smoky Hill

Eaglecrest    Mullen

All sports schedules are available at: [www.centennialleagueco.org](http://www.centennialleagueco.org). Directions to each school are available in the Interscholastic Athletic/Activity Handbook, or online at [www.CHSAA.org](http://www.CHSAA.org).

## ELIGIBILITY

Every athlete will have their academic performance monitored on a weekly basis during the sport(s) season(s). 'D' or 'F' grades will be pulled from PowerSchool by the Athletics Office. If an athlete has two failing grades on Friday, that athlete will be declared ineligible to represent Eaglecrest High School in any interscholastic competition or scrimmage the following week Monday - Saturday. It is mandatory for an athlete with two 'Ds' or one or more 'Fs' to attend Athletic Study Hall. Additional information may be obtained by requesting a copy of the Cherry Creek School District/ CHSAA Handbook from the Athletic Office.

Attendance, grades, and behavior can be reviewed at any time by administrators (including deans, the athletic office, & activities director) to determine if students have earned privileges such as attending school dances, attending or participating in sporting events, theatrical performances, field trips or any school-sponsored activity.

## GENERAL RULES

To be eligible to represent Eaglecrest High School in any interscholastic activity (athletic and/or non-athletic), you must:

1. Be considered by your principal as a representative of your school's standards of conduct and sportsmanship and be an undergraduate of your high school.
2. Be carrying a minimum of five classes. You cannot be failing at the time of participation more than one class.
3. Have carried a minimum of 5 classes and not failed more than the equivalent of one class the previous semester.
4. Be cleared as eligible by the Athletic Office.

NOTE: Make-up work shall NOT be permitted after the close of the semester for the purpose of becoming eligible. A grade of incomplete shall be considered the same as a failure when determining eligibility. Scholastic eligibility may be regained by attending summer school. A student attending summer school must be enrolled in classes from the same academic discipline where the student is deficient. Example: If a student failed math during the school year and is a 1/2 credit shy of eligibility, the student must take a math course in summer school as opposed to a physical education class. Scholastic eligibility may be regained after the regain dates as determined by CHSAA for each sport.

## **SEASONAL SPORTS**

Eaglecrest offers a comprehensive athletic program. Intra-school athletic competition is available in the following sports:

### **Fall**

Boys' Cross Country  
Boys' Golf  
Boys' Soccer  
Boys' Tennis  
Cheerleading  
Football  
Flag Football

Girls' Cross Country  
Girls' Gymnastics (@ CCHS and Overland)  
Girls' Field Hockey (@ SHHS)  
Softball  
Dance  
Girls' Volleyball  
Unified Sports

### **Winter**

Boys' Basketball  
Cheerleading  
Girls' Basketball  
Girls' Wrestling  
Unified Sports

Girls' Swimming  
Dance  
Boys' Wrestling  
Ice Hockey (@ CCHS)  
Unified Basketball

### **Spring**

Baseball  
Boys' Lacrosse  
Boys' Track  
Boys' Swimming (@ SHHS)  
Boys' Volleyball  
Unified Track

Girls' Golf  
Girls' Lacrosse  
Girls' Soccer  
Girls' Tennis  
Girls' Track

## **ATHLETIC CODE VIOLATIONS**

### **(POLICY JJI AND REGULATION JJI-R)**

Students participating in the Cherry Creek School District interscholastic athletic programs will be subject to sanctions for violation of the District's Athletic Code. Consequently, any instance of the following will result in disciplinary action, including, but not limited to, temporary or permanent suspension from interscholastic athletic programs:

1. Use, possession, sale, exchange, or distribution of alcohol, tobacco, marijuana, or other illegal drugs, including, but not limited to, anabolic steroids, counterfeit drugs, or drug paraphernalia.
2. Continued willful disobedience or open and persistent defiance of authority.
3. Willful destruction or defacing of school property.
4. Behavior which is detrimental to the welfare, safety or morals of other people or school personnel.
5. Conviction of any criminal offense in the municipal, county, or district courts other than minor traffic violations.

## **DISCIPLINARY PROCEDURES AND ATHLETIC SANCTIONS**

Students determined to be in violation of any of the foregoing conduct violations shall be subject to appropriate athletic disciplinary sanctions. The determination to impose sanctions and the nature of the sanctions imposed shall be made by the principal or his or her designee. Any student athlete alleged to have violated the Athletic Code will be given notice and due process in accordance with policy JJI and its accompanying regulation, JJI-R. Sanctions which may be imposed include, but are not limited to, the following, depending on severity and circumstances:

1. Consultation with the coach, so they are aware of the violation for disciplinary action.
2. Suspension from participation in a specific number of athletic events.
3. Suspension from the athletic team for the remainder of the season.
4. Denial of the opportunity to obtain school awards in the sport in which the student was participating when the violation of rules occurred (athletic awards require not only participation, but also completion of the season in good standing).
5. Suspension from athletic competition for the remainder of the school year and/or extending into succeeding school years.

# SAFETY INFORMATION

## SAFETY INFORMATION

### Evacuation Drills

Evacuation drill procedures are posted in each classroom and throughout the building. Students are to exit the building in a quiet, orderly manner. Upon leaving the building, students must remain with their class and proceed to the designated area. Students should return to the building in the same manner and route in which they left. Falsifying information or sounding alarms is a severe offense and will result in suspension from school and possible legal action.

## SCHOOL SAFETY-CODES & CONDITIONS

### Normal Conditions

- Normal awareness and security
- Normal supervision and entrances
- Normal educational programs
- Normal dismissal

### Secure Perimeter Conditions

- All students and staff outside the building will be returned to the building
- All exterior doors will be closed and locked
- Access in/out of the building controlled by staff and/or public safety officers and limited to authorized individuals
- Normal educational programs continue as possible
- Police will be on-site to provide additional support and communications as appropriate
- Controlled dismissal is possible

### Lockdown Condition

- No student, parent, or staff access in/out of the building - **NO EXCEPTIONS**
- All students and staff outside the building - taken to a safe location
- All exterior doors closed and locked
- All interior doors closed and locked
- Students and staff in individual classrooms or centralized locations, as appropriate.
- Normal educational programs suspended
- Police on-site to provide additional support and communications as appropriate
- No dismissal

## SHELTER-IN-PLACE DRILLS

Shelter-in-Place drill procedures are posted in each classroom. In the event of a drill or actual severe weather event, proceed in an orderly manner to the designated area. Remember to keep your head down, knees drawn up, and cover the back of your head with your hands.

## SCHOOL RESOURCE OFFICER

As a result of a joint project with the Arapahoe County Sheriff's Office, three School Resource Officers have been assigned to work with the faculty, staff, and community members to ensure a safe school environment. The officers are available during the school day to answer questions and work with students in matters requiring police intervention.

# WHAT ARE YOUR SOURCES OF STRENGTH?

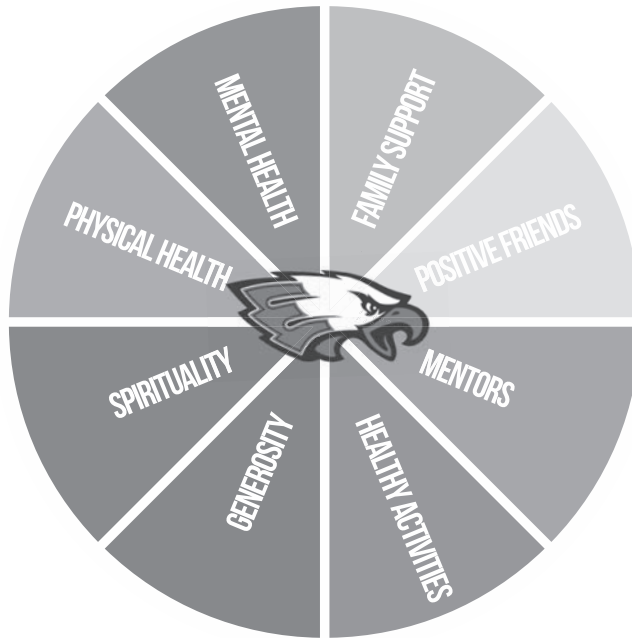

## We Are Sources of Strength

We are a group of diverse **students and adults** from many different corners and cultures of our school and community. We believe that life has ups and downs, that all of us will go through good times and tough times. Our mission is to ensure that during the rough times no one gets so overwhelmed or hopeless that they want to give up.

Our mission is to **spread Hope, Help, and Strength** into every corner of our community.

Our mission is to help students and staff turn to their strengths and their supports that are all around. We are **Connectors** to Help and Strength.

Our mission recognizes that our voice has great power and we use it to **BREAK the SILENCE** when someone is struggling, and to connect them to the help they need and deserve.

We **Spread Hope** by focusing on stories of strength, rather than on stories of trauma. We know our most powerful impact comes from our personal actions, conversations, and messages that use our music, our art, our writing, our activities, our social media, our culture, and our voice. This gives life to our efforts.



# CALENDAR YEARS

## 2025

January	S	M	T	W	T	F	S	February	S	M	T	W	T	F	S	March	S	M	T	W	T	F	S	April	S	M	T	W	T	F	S				
		5	6	7	8	9	10		11		2	3	4	5	6		7	8		2	3	4	5		6	7	8		6	7	8	9	10	11	12
	12	13	14	15	16	17	18		9	10	11	12	13	14	15		9	10	11	12	13	14	15		13	14	15	16	17	18	19				
	19	20	21	22	23	24	25		16	17	18	19	20	21	22		16	17	18	19	20	21	22		20	21	22	23	24	25	26				
26	27	28	29	30	31	23	24	25	26	27	28	23	24	25	26	27	28	29	27	28	29	30													
May	S	M	T	W	T	F	S	June	S	M	T	W	T	F	S	July	S	M	T	W	T	F	S	August	S	M	T	W	T	F	S				
		4	5	6	7	8	9		10		1	2	3	4	5		6	7		1	2	3	4		5		3	4	5	6	7	8	9		
	11	12	13	14	15	16	17		8	9	10	11	12	13	14		13	14	15	16	17	18	19		10	11	12	13	14	15	16				
	18	19	20	21	22	23	24		15	16	17	18	19	20	21		20	21	22	23	24	25	26		17	18	19	20	21	22	23				
25	26	27	28	29	30	31	22	23	24	25	26	27	28	27	28	29	30	31	24	25	26	27	28	29	30										
September	S	M	T	W	T	F	S	October	S	M	T	W	T	F	S	November	S	M	T	W	T	F	S	December	S	M	T	W	T	F	S				
		7	8	9	10	11	12		13		5	6	7	8	9		10	11		2	3	4	5		6	7	8		7	8	9	10	11	12	13
	14	15	16	17	18	19	20		12	13	14	15	16	17	18		9	10	11	12	13	14	15		14	15	16	17	18	19	20				
	21	22	23	24	25	26	27		19	20	21	22	23	24	25		16	17	18	19	20	21	22		21	22	23	24	25	26	27				
28	29	30	26	27	28	29	30	31	26	27	28	29	30	31	23	24	25	26	27	28	29	28	29	30	31										

## 2026

January	S	M	T	W	T	F	S	February	S	M	T	W	T	F	S	March	S	M	T	W	T	F	S	April	S	M	T	W	T	F	S					
		4	5	6	7	8	9		10		1	2	3	4	5		6	7		1	2	3	4		5	6	7		5	6	7	8	9	10	11	
	11	12	13	14	15	16	17		8	9	10	11	12	13	14		8	9	10	11	12	13	14		12	13	14	15	16	17	18					
	18	19	20	21	22	23	24		15	16	17	18	19	20	21		15	16	17	18	19	20	21		19	20	21	22	23	24	25					
25	26	27	28	29	30	31	22	23	24	25	26	27	28	22	23	24	25	26	27	28	29	30	31													
May	S	M	T	W	T	F	S	June	S	M	T	W	T	F	S	July	S	M	T	W	T	F	S	August	S	M	T	W	T	F	S					
		3	4	5	6	7	8		9	10		1	2	3	4		5	6	7		5	6	7		8	9	10	11		2	3	4	5	6	7	8
	11	12	13	14	15	16	17		7	8	9	10	11	12	13		12	13	14	15	16	17	18		9	10	11	12	13	14	15					
	17	18	19	20	21	22	23		14	15	16	17	18	19	20		19	20	21	22	23	24	25		16	17	18	19	20	21	22					
24	25	26	27	28	29	30	21	22	23	24	25	26	27	26	27	28	29	30	31	23	24	25	26	27	28	29										
31	28	29	30																																	
September	S	M	T	W	T	F	S	October	S	M	T	W	T	F	S	November	S	M	T	W	T	F	S	December	S	M	T	W	T	F	S					
		6	7	8	9	10	11		12		4	5	6	7	8		9	10		1	2	3	4		5	6	7		6	7	8	9	10	11	12	
	13	14	15	16	17	18	19		11	12	13	14	15	16	17		8	9	10	11	12	13	14		13	14	15	16	17	18	19					
	20	21	22	23	24	25	26		18	19	20	21	22	23	24		15	16	17	18	19	20	21		20	21	22	23	24	25	26					
27	28	29	30	25	26	27	28	29	30	31	25	26	27	28	29	30	31	22	23	24	25	26	27	28	27	28	29	30	31							

## 2027

January	S	M	T	W	T	F	S	February	S	M	T	W	T	F	S	March	S	M	T	W	T	F	S	April	S	M	T	W	T	F	S						
		3	4	5	6	7	8		9	10		1	2	3	4		5	6	7		7	8	9		10	11	12	13		4	5	6	7	8	9	10	
	11	12	13	14	15	16	17		7	8	9	10	11	12	13		14	15	16	17	18	19	20		11	12	13	14	15	16	17						
	17	18	19	20	21	22	23		14	15	16	17	18	19	20		21	22	23	24	25	26	27		18	19	20	21	22	23	24						
24	25	26	27	28	29	30	21	22	23	24	25	26	27	28	29	30	31	25	26	27	28	29	30														
31																																					
May	S	M	T	W	T	F	S	June	S	M	T	W	T	F	S	July	S	M	T	W	T	F	S	August	S	M	T	W	T	F	S						
		2	3	4	5	6	7		8	9	10		1	2	3		4	5	6	7		4	5		6	7	8	9	10		1	2	3	4	5	6	7
	11	12	13	14	15	16	17		8	9	10	11	12	13	14		11	12	13	14	15	16	17		8	9	10	11	12	13	14						
	18	19	20	21	22	23	24		15	16	17	18	19	20	21		18	19	20	21	22	23	24		15	16	17	18	19	20	21						
25	26	27	28	29	30	31	22	23	24	25	26	27	28	25	26	27	28	29	30	31	22	23	24	25	26	27	28										
30	31																																				
September	S	M	T	W	T	F	S	October	S	M	T	W	T	F	S	November	S	M	T	W	T	F	S	December	S	M	T	W	T	F	S						
		5	6	7	8	9	10		11		3	4	5	6	7		8	9		1	2	3	4		5	6	7		5	6	7	8	9	10	11		
	12	13	14	15	16	17	18		10	11	12	13	14	15	16		7	8	9	10	11	12	13		12	13	14	15	16	17	18						
	19	20	21	22	23	24	25		17	18	19	20	21	22	23		14	15	16	17	18	19	20		19	20	21	22	23	24	25						
26	27	28	29	30	24	25	26	27	28	29	30	31	21	22	23	24	25	26	27	28	29	30															

# JULY 2025

**MONDAY 28**

**TUESDAY 29**

**WEDNESDAY 30**



"The big secret in life is that there is no big secret. Whatever your goal, you can get there if you're willing to work." – Oprah Winfrey

**THURSDAY 31**

**FRIDAY 1**



**SATURDAY 2**

**SUNDAY 3**

# AUGUST 2025

**MONDAY 4**

**TUESDAY 5**

**WEDNESDAY 6**



"If I have ever made any valuable discoveries, it has been owing more to patient attention than to any other talent." – Isaac Newton

**THURSDAY 7**

**FRIDAY 8**



**SATURDAY 9**

**SUNDAY 10**

# AUGUST 2025

**MONDAY 11**

**TUESDAY 12**

**WEDNESDAY 13**



"Learning is not attained by chance. It must be sought for with ardor and attended to with diligence." – Abigail Adams

**THURSDAY 14**

**FRIDAY 15**



**SATURDAY 16**

**SUNDAY 17**

# AUGUST 2025

**MONDAY 18**

**TUESDAY 19**

**WEDNESDAY 20**



"Many of life's failures are people who did not realize how close they were to success when they gave up." – Thomas Edison

**THURSDAY 21**

**FRIDAY 22**



**SATURDAY 23**

**SUNDAY 24**

# AUGUST 2025

**MONDAY 25**

**TUESDAY 26**

**WEDNESDAY 27**



"You can stand tall without standing on someone. You can be a victor without having victims." – Harriet Woods

**THURSDAY 28**

**FRIDAY 29**



**SATURDAY 30**

**SUNDAY 31**

# SEPTEMBER 2025

**MONDAY 1**

*Labor Day*

**TUESDAY 2**



**WEDNESDAY 3**

"Let me tell you the secret that has led me to my goal. My strength lies solely in my tenacity." – Louis Pasteur

**THURSDAY 4**

*Mawlid al-Nabi begins at sundown*

**FRIDAY 5**



**SATURDAY 6**

**SUNDAY 7**

# SEPTEMBER 2025

MONDAY 8

TUESDAY 9

WEDNESDAY 10



"When I dare to be powerful, to use my strength in the service of my vision, then it becomes less and less important whether I am afraid." – Audre Lorde

**THURSDAY 11**

*Patriot Day*

**FRIDAY 12**



**SATURDAY 13**

**SUNDAY 14**

# SEPTEMBER 2025

**MONDAY 15**

**TUESDAY 16**

**WEDNESDAY 17**



"The foolish man seeks happiness in the distance; the wise grows it under his feet." – James Oppenheim

**THURSDAY 18**

**FRIDAY 19**



**SATURDAY 20**

**SUNDAY 21**

# SEPTEMBER 2025

**MONDAY 22**

*First day of autumn  
Rosh Hashanah begins at sundown*

**TUESDAY 23**



**WEDNESDAY 24**

"No person is your friend who demands your silence or denies your right to grow." – Alice Walker

**THURSDAY 25**

**FRIDAY 26**



**SATURDAY 27**

**SUNDAY 28**

# OCTOBER 2025

**MONDAY 29**

**TUESDAY 30**

**WEDNESDAY 1**

*Yom Kippur begins at sundown*



"Our lives improve only when we take chances – and the first and most difficult risk we can take is to be honest with ourselves." – Walter Anderson

**THURSDAY 2**

**FRIDAY 3**



**SATURDAY 4**

**SUNDAY 5**

# OCTOBER 2025

MONDAY 6

TUESDAY 7

WEDNESDAY 8



**THURSDAY 9**

**FRIDAY 10**



**SATURDAY 11**

**SUNDAY 12**

# OCTOBER 2025

**MONDAY 13**

*Columbus Day*

**TUESDAY 14**



**WEDNESDAY 15**

"I think a hero is an ordinary individual who finds strength to persevere and endure in spite of overwhelming obstacles." – Christopher Reeve

**THURSDAY 16**

**FRIDAY 17**



**SATURDAY 18**

**SUNDAY 19**

# OCTOBER 2025

**MONDAY 20**

**TUESDAY 21**

**WEDNESDAY 22**



"You're not obligated to win. You're obligated to keep trying to do the best you can every day." – Marian Wright Edelman

**THURSDAY 23**

**FRIDAY 24**



**SATURDAY 25**

**SUNDAY 26**

# OCTOBER 2025

**MONDAY 27**

**TUESDAY 28**

**WEDNESDAY 29**



"Work while you have the light. You are responsible for the talent that has been entrusted to you." – Henri-Frédéric Amiel

**THURSDAY 30**

**FRIDAY 31**

*Halloween*



**SATURDAY 1**

**SUNDAY 2**

*Standard time begins*

# NOVEMBER 2025

MONDAY 3

TUESDAY 4

*Election Day*

WEDNESDAY 5



"Use what talents you possess: the woods would be very silent if no birds sang there except those that sang best." – Henry van Dyke

**THURSDAY 6**

**FRIDAY 7**



**SATURDAY 8**

**SUNDAY 9**

# NOVEMBER 2025

**MONDAY 10**

**TUESDAY 11**

*Veterans Day*



**WEDNESDAY 12**

"The battles that count aren't the ones for gold medals. The struggles within yourself – that's where it's at." – Jesse Owens

**THURSDAY 13**

**FRIDAY 14**



**SATURDAY 15**

**SUNDAY 16**

# NOVEMBER 2025

MONDAY 17

TUESDAY 18

WEDNESDAY 19



"Success is to be measured not so much by the position that one has reached in life as by the obstacles which he has overcome." – Booker T. Washington

**THURSDAY 20**

**FRIDAY 21**



**SATURDAY 22**

**SUNDAY 23**

# NOVEMBER 2025

**MONDAY 24**

**TUESDAY 25**

**WEDNESDAY 26**



**THURSDAY 27**

*Thanksgiving*

**FRIDAY 28**



**SATURDAY 29**

**SUNDAY 30**

# DECEMBER 2025

MONDAY 1

TUESDAY 2

WEDNESDAY 3



“There is only one corner of the universe you can be certain of improving ... and that’s your own self.” – Aldous Huxley

**THURSDAY 4**

**FRIDAY 5**



**SATURDAY 6**

**SUNDAY 7**

# DECEMBER 2025

MONDAY 8

TUESDAY 9

WEDNESDAY 10



"Dream as if you'll live forever. Live as if you'll die today." – James Dean

**THURSDAY 11**

**FRIDAY 12**



**SATURDAY 13**

**SUNDAY 14**

*Hanukkah begins at sundown*

# DECEMBER 2025

**MONDAY 15**

**TUESDAY 16**

**WEDNESDAY 17**



**THURSDAY 18**

**FRIDAY 19**



**SATURDAY 20**

**SUNDAY 21**

*First day of winter*

# DECEMBER 2025

MONDAY 22

TUESDAY 23

WEDNESDAY 24



**THURSDAY 25**

*Christmas*

**FRIDAY 26**

*Kwanzaa begins*



**SATURDAY 27**

**SUNDAY 28**

# DECEMBER 2025

MONDAY 29

TUESDAY 30

WEDNESDAY 31



"I have discovered in life that there are ways of getting almost anywhere you want to go, if you really want to go." – Langston Hughes

**THURSDAY 1**

*New Year's Day*

**FRIDAY 2**



**SATURDAY 3**

**SUNDAY 4**

# JANUARY 2026

MONDAY 5

TUESDAY 6

WEDNESDAY 7



**THURSDAY 8**

**FRIDAY 9**



**SATURDAY 10**

**SUNDAY 11**

# JANUARY 2026

**MONDAY 12**

**TUESDAY 13**

**WEDNESDAY 14**



“Take the first step in faith. You don’t have to see the whole staircase; just take the first step.” – Martin Luther King Jr.

**THURSDAY 15**

**FRIDAY 16**



**SATURDAY 17**

**SUNDAY 18**

# JANUARY 2026

**MONDAY 19**

*Martin Luther King Jr. Day*

**TUESDAY 20**



**WEDNESDAY 21**

"I try to avoid looking forward or backward, and try to keep looking upward." – Charlotte Brontë

**THURSDAY 22**

**FRIDAY 23**



**SATURDAY 24**

**SUNDAY 25**

# JANUARY 2026

**MONDAY 26**

**TUESDAY 27**

**WEDNESDAY 28**



**THURSDAY 29**

**FRIDAY 30**



**SATURDAY 31**

**SUNDAY 1**

# FEBRUARY 2026

**MONDAY 2**

*Groundhog Day*

**TUESDAY 3**



**WEDNESDAY 4**

"We could never learn to be brave and patient, if there were only joy in the world." – Helen Keller

**THURSDAY 5**

**FRIDAY 6**



**SATURDAY 7**

**SUNDAY 8**

# FEBRUARY 2026

**MONDAY 9**

**TUESDAY 10**

**WEDNESDAY 11**



**THURSDAY 12**

*Lincoln's Birthday*

**FRIDAY 13**



**SATURDAY 14**

*Valentine's Day*

**SUNDAY 15**

# FEBRUARY 2026

**MONDAY 16**

*Presidents' Day*

**TUESDAY 17**

*Lunar New Year  
Ramadan begins at sundown*



**WEDNESDAY 18**

*Ash Wednesday*

"Never mistake knowledge for wisdom. One helps you make a living; the other helps you make a life." – Sandra Carey

**THURSDAY 19**

**FRIDAY 20**



**SATURDAY 21**

**SUNDAY 22**

*Washington's Birthday*

# FEBRUARY 2026

**MONDAY 23**

**TUESDAY 24**

**WEDNESDAY 25**



"Leadership is practiced not so much in words as in attitude and in actions." – Harold Geneen

**THURSDAY 26**

**FRIDAY 27**



**SATURDAY 28**

**SUNDAY 1**

# MARCH 2026

MONDAY 2

TUESDAY 3

WEDNESDAY 4



**THURSDAY 5**

**FRIDAY 6**



**SATURDAY 7**

**SUNDAY 8**

*Daylight saving time begins*

# MARCH 2026

MONDAY 9

TUESDAY 10

WEDNESDAY 11



**THURSDAY 12**

**FRIDAY 13**



**SATURDAY 14**

**SUNDAY 15**

*Laylat al-Qadr begins at sundown*

# MARCH 2026

**MONDAY 16**

**TUESDAY 17**

*St. Patrick's Day*



**WEDNESDAY 18**

**THURSDAY 19**

*Eid al-Fitr begins at sundown*

**FRIDAY 20**

*First day of spring*



**SATURDAY 21**

**SUNDAY 22**

# MARCH 2026

MONDAY 23

TUESDAY 24

WEDNESDAY 25



**THURSDAY 26**

**FRIDAY 27**



**SATURDAY 28**

**SUNDAY 29**

*Palm Sunday*

# APRIL 2026

MONDAY 30

TUESDAY 31

WEDNESDAY 1

*April Fools' Day*  
*Passover begins at sundown*



"Just don't give up trying to do what you really want to do. Where there's love and inspiration, I don't think you can go wrong." – Ella Fitzgerald

**THURSDAY 2**

Lined writing area for Thursday 2.

**FRIDAY 3**

*Good Friday*

Lined writing area for Friday 3, featuring a large, faint watermark of a stylized bird or dragon head.

**SATURDAY 4**

Lined writing area for Saturday 4.

**SUNDAY 5**

*Easter*

Lined writing area for Sunday 5.

# APRIL 2026

MONDAY 6

TUESDAY 7

WEDNESDAY 8



"I am what time, circumstance, and history have made of me, certainly, but I am, also, much more than that. So are we all." – James Baldwin

**THURSDAY 9**

**FRIDAY 10**



**SATURDAY 11**

**SUNDAY 12**

# APRIL 2026

**MONDAY 13**

**TUESDAY 14**

**WEDNESDAY 15**



"People will forget what you said, people will forget what you did, but people will never forget how you made them feel." – Maya Angelou

**THURSDAY 16**

**FRIDAY 17**



**SATURDAY 18**

**SUNDAY 19**

# APRIL 2026

MONDAY 20

TUESDAY 21

WEDNESDAY 22

*Earth Day*



"Minds are like parachutes – they only function when open." – Thomas Dewar

**THURSDAY 23**

**FRIDAY 24**



**SATURDAY 25**

**SUNDAY 26**

# APRIL 2026

MONDAY 27

TUESDAY 28

WEDNESDAY 29



**THURSDAY 30**

**FRIDAY 1**



**SATURDAY 2**

**SUNDAY 3**

# MAY 2026

MONDAY 4

TUESDAY 5

*Cinco de Mayo*



WEDNESDAY 6

"Great things are not done by impulse, but a series of small things brought together." – Vincent van Gogh

**THURSDAY 7**

**FRIDAY 8**



**SATURDAY 9**

**SUNDAY 10**

*Mother's Day*

# MAY 2026

**MONDAY 11**

**TUESDAY 12**

**WEDNESDAY 13**



**THURSDAY 14**

**FRIDAY 15**



**SATURDAY 16**

**SUNDAY 17**

# MAY 2026

MONDAY 18

TUESDAY 19

WEDNESDAY 20



"Snowflakes are one of nature's most fragile things, but just look at what they can do when they stick together." – Vesta Kelly

**THURSDAY 21**

**FRIDAY 22**



**SATURDAY 23**

**SUNDAY 24**

# MAY 2026

**MONDAY 25**

*Memorial Day*

**TUESDAY 26**

*Eid al-Adha begins at sundown*



**WEDNESDAY 27**

"One man can be a crucial ingredient on a team, but one man cannot make a team." – Kareem Abdul-Jabbar

**THURSDAY 28**

**FRIDAY 29**



**SATURDAY 30**

**SUNDAY 31**

# JUNE 2026

★ GOALS

MONDAY	TUESDAY	WEDNESDAY	THURSDAY
1	2	3	4
8	9	10	11
15	16 <i>Muharram begins at sundown</i>	17	18
22	23	24	25
29	30	1	2

FRIDAY	SATURDAY	SUNDAY	NOTES
5	6	7	
12	13	14 <i>Flag Day</i>	
<i>Juneteenth</i> 19	20	21 <i>Father's Day</i> <i>First day of summer</i>	
26	27	28	
3	4	5	

# JULY 2026

★ GOALS

MONDAY	TUESDAY	WEDNESDAY	THURSDAY
29	30	1	2
6	7	8	9
13	14	15	16
20	21	22	23
27	28	29	30



# AUGUST 2026

★ GOALS

MONDAY	TUESDAY	WEDNESDAY	THURSDAY
27	28	29	30
3	4	5	6
10	11	12	13
17	18	19	20
24	25	26	27
31			

*Mawlid al-Nabi begins at sundown*

FRIDAY	SATURDAY	SUNDAY	NOTES
31	1	2	<hr/> <hr/> <hr/> <hr/> <hr/> <hr/> <hr/> <hr/>
7	8	9	<hr/> <hr/> <hr/> <hr/> <hr/> <hr/> <hr/> <hr/>
14	15	16	<hr/> <hr/> <hr/> <hr/> <hr/> <hr/> <hr/> <hr/>
21	22	23	<hr/> <hr/> <hr/> <hr/> <hr/> <hr/> <hr/> <hr/>
28	29	30	<hr/> <hr/> <hr/> <hr/> <hr/> <hr/> <hr/> <hr/>





























