



Friendship Community Group

P.O. Box 9180

Pittsburgh, PA 15224

Updated: June 24, 2025

Pittsburgh Public School Board

341 S. Bellefield Ave, Pittsburgh, PA 15213

Re: Opposition to Proposal to Close Friendship School

Dear Members of the Pittsburgh Public School Board,

On behalf of the Friendship Community Group, we write to express our strong opposition to the proposal to close the Friendship School and transfer its Montessori program.

The Friendship School, which sits in the heart of the Friendship neighborhood, is currently home to the PPS Montessori PreK-5; a thriving, vibrant school program. Built in 1899, the school is an architectural gem designed for quality education and filled with functional beauty and charm that make it an ideal Montessori learning environment. Many of the students walk and bike to school, but families come from across the district to be a part of the highly sought-after learning environment.

In addition to being a beloved learning space, the Friendship School is the beating heart of our community. The historic school and ample grounds provide an essential space for the surrounding neighborhoods to gather, play, recreate and perform civic duties. The beloved play park, built by Friendship Community Group, serves as a public amenity and a testament to the strong community involvement that surrounds the school. **Closing the school would not simply reassign students- it would dismantle a vital institution that supports the health, safety, and vibrancy of the surrounding area.**

It is well documented that school closures inflict deep and lasting harm on communities. They erode social cohesion, reduce civic engagement, weaken neighborhood safety, and depress economic vitality. A 2011 Pew Charitable Trusts study on school closures found that shuttered schools led to higher neighborhood crime, declining property values, and increased blight. Empty school buildings became liabilities—not savings—and many districts failed to realize any meaningful financial gain. Furthermore, selling or repurposing school buildings tends to be extremely difficult and often unsuccessful, therefore making shuttered schools a source of blight and vandalism. ([Pew, 2011](#))

Friendship Community Group envisions a brighter future. One that not only keeps our school open, but invests in its success as a shining star in the district - further enhancing a beloved and highly sought after program for more students in the district, while maintaining a vital community asset and strengthening the East End community of Pittsburgh.

Instead of shuttering the Friendship School, we urge the Board to:

1. **Keep the Montessori program in the Friendship School.** Treat the Friendship School as an asset, investing in its renovation and expansion to enrich—not relocate—the Montessori program.
2. **Explore grants and public–private partnerships** to fund accessibility upgrades and repairs—resources are out there and our community is ready to help. Allow FCG and neighborhood stakeholders to help the district pursue funding sources.
3. **Include the community meaningfully in future planning decisions.** FCG and the Friendship community deserve a seat at the table in determining the building's future. It is essential that PPS commit to maintaining and preserving the Friendship School, and all of its buildings, and include FCG in decisions that would impact the community.

As stewards of our neighborhood, it is the duty of FCG to serve in the best interest of our residents. Likewise, your obligation as members of the School Board is not only to manage budgets, but to make decisions that serve the best interests of your constituents—the families, children, and taxpayers of Pittsburgh. As stewards of the public trust, you are accountable for protecting the infrastructure and institutions that strengthen our neighborhoods and our diverse city.

Enclosed you will find letters from our council members, an assessment of the proposed renovation budget for the school, and a petition signed by 377 school and community stakeholders opposing the closure of the school. Friendship Community Group is invested, organized, and prepared to work alongside you in preserving and strengthening the Friendship School for the continued housing of the Montessori program. We firmly believe that the Friendship School is worth the investment and we hope you will act in the best interest of the students, families, and taxpayers who depend on it.

Sincerely,

Friendship Community Group Board of Directors

Vice President: Gillian McTiernan

Secretary: Nancy Cohen

Treasurer: Steve Morrow

Lee Ann Antol

Aafke Butter

Nikki Coffee

John Eberle

Sheila Grab

Julie Grove

Vince Manetti

Roswell McNutt

Danielle Novick

Megan Palomo

Sierra Weir

President: Ellen DiBiase





CITY OF PITTSBURGH
OFFICE OF CITY COUNCIL – DISTRICT 9
COUNCILMEMBER KHARI MOSLEY

June 18, 2025

Dear Pittsburgh Public School Board,

I am writing to voice my opposition to the proposed closure of the Friendship School and the relocation of its Montessori program. The school serves families who live in my district and provides a community gathering space for many of my constituents. As an active and thriving school, it contributes to the safety and stability of my district and adjacent neighborhoods.

The closure of Friendship School would not only disrupt the lives of students and families—it would also remove a valuable community anchor that supports safe, livable neighborhoods throughout the East End.

Active schools enhance neighborhood safety, vitality and investment. By removing this asset, risks creating a vacant site that invites blight, disinvestment and instability. These are problems that often spread beyond one neighborhood's borders.

I urge the School Board to keep the Friendship School open and invest in it as the resource it is, for students, families, and the broader community.

Respectfully submitted,

A handwritten signature in black ink, appearing to read "Khari Mosley", with a horizontal line extending to the right.

Councilman Khari Mosley
City of Pittsburgh - District 9



PITTSBURGH COUNCIL DISTRICT 7

OFFICE OF DEBORAH L. GROSS



June 18, 2025

To the Members of the Pittsburgh Public School Board,

I am writing to register my opposition to the proposed closure of the Friendship School and the relocation of the Montessori program currently housed there. As a City Councilmember representing the Friendship neighborhood, I am deeply concerned about the negative impact this move would have—not just on students and families, but on the broader health and safety of the neighborhood and surrounding areas.

Schools are the heartbeat of any strong community. They bring structure, connection, safety, and opportunity. When we remove a school, we are not just reassigning children—we are weakening the fabric of a neighborhood. In many cases, the damage is long-term and irreversible.

Research has shown that school closures often lead to increased neighborhood instability, reduced property values, and higher rates of crime and vacancy. Friendship School plays a vital role in maintaining safety and community cohesion. As we know, active schools provide a critical layer of neighborhood protection—not only by triggering residency restrictions for offenders, but also by bringing enhanced policing, traffic safety measures, mandated child welfare oversight, and access to public infrastructure investments that prioritize safe, family-friendly communities.

To close such an institution without a comprehensive, community-led plan for reinvestment and replacement would be a grave mistake.

I urge the Pittsburgh Public School Board to reconsider this proposal and take a broader view of what schools mean to neighborhoods—not just as learning centers, but as hubs of stability and civic life. Your decisions must reflect the best interests of the communities you serve, including the families who have invested in and built their lives around this school.

I stand with the residents of Friendship and the many others across the city who are calling for meaningful engagement, transparency, and long-term thinking. Let us work together to strengthen our public schools—not shutter them.

Sincerely,
city,

A handwritten signature in blue ink, appearing to read "Deborah L. Gross".

Deborah L. Gross

District 7 Pittsburgh City Councilwoman

Research: How School Closures Harm Students and Communities

[Shuttered Public Schools: The Struggle to Bring Old Buildings New Life, Pew Charitable Trust](#)

[Revisiting Research on School Closings: Key Learnings for District and Community Leaders, Research for Action](#)

[The Harm of School Closures Can Last a Lifetime, New Research Shows; Education Week](#)

[The Long Shadow of School Closures: Impacts on Students' Educational and Labor Market Outcomes, Brown University](#)

[Pittsburgh Public Schools is still selling property, Allegheny Institute for Public Policy](#)

[Lights Off: Practice and Impact of Closing Low-Performing Schools: Stanford University](#)

Assessment of Renovation Estimates for Pittsburgh Montessori at Friendship School

Prepared by:

Becky Mingo, Registered Architect

June, 2025

This report examines the renovation cost estimates for Friendship Montessori School as outlined in the 2025 PPS General Fund Budget. Upon reviewing comparable estimates for similar facilities within the same document, there is substantial evidence to suggest that the projected renovation costs for Friendship are significantly inflated. This discrepancy raises questions about the accuracy of the projections and the rationale used to justify potential school closures.

According to the budget, the renovation costs for the Friendship facility total **\$16.57 million** between 2025 and 2027. This includes:

- \$13.5 million for general renovations, elevator installation, and air conditioning
- \$301,300 for building automation controls
- \$130,000 for emergency generator replacement
- \$1.68 million for design and permitting
- \$842,478 in contingency/change orders

This figure is second only to Brashear High School, a significantly larger facility, and vastly exceeds the budget allocated to similarly sized or more complex schools. For comparison:

- **Arsenal**, undergoing HVAC replacement, electrical panel upgrades, and related improvements, is budgeted at **\$4.4 million**, nearly a third of the Friendship allocation.
- **Brookline**, which includes air conditioning installation, emergency generator replacement, and other improvements is projected at **\$3.2 million**.
- **University Prep**, a secondary facility receiving HVAC and mechanical upgrades, is slated for a total of **\$5.76 million** in improvements.*

Additionally, Friendship's architectural and engineering fees alone amount to **\$1.68 million**, a figure disproportionately high compared to similar projects. The uniform annual allocation of \$4.5 million (\$13.5 million in total) for general renovations over three years lacks clarity and appears to be a rough guess rather than based on itemized assessments.

Furthermore, according to the building capacities data on page 334 of the budget, the Linden school can only house a mere 31 additional students over the existing Friendship school.

If we apply the same methodology used in estimating the renovation of Linden, and compare that to industry-standard renovation costs, the projected cost for the Friendship building could be substantially lower - just under **\$5.4 million**.

*Source: 2025 Final General Fund Budget/ Capital Projects Budget

Revised Estimate for Friendship Montessori

| Renovation Element | Estimate |
|--|---|
| Elevator Addition (1,800 sq ft × \$500) | \$900,000 (based on industry estimates) |
| PA System & Emergency Generator Upgrades | \$290,000 |
| Restroom Upgrades | \$290,000 |
| Window Replacement | \$600,000 |
| Air Conditioning (33,177 sq ft × \$100) | \$3,317,700 |
| Total | \$5,397,700 |

This revised projection, based on PPS precedent and square-foot cost metrics, suggests that the current budgeted amount for Friendship is **over three times** the likely actual cost of necessary renovations.*

In comparison, the Linden building renovation costs are estimated at \$5.2 million. Adding on the cost to move from one facility to another (\$12psf at a total of \$400,000) brings the total cost to move the Montessori school to Linden to approximately \$5.6 million.

Therefore, keeping the Montessori program in Friendship could **avoid an estimated \$200,000 in costs.**

Given the discrepancies found in this study, it is reasonable to question whether the estimated renovation costs are being used to justify closure or relocation rather than to support honest investment. The data strongly suggests the need for an independent review to ensure that public funds are allocated fairly and decisions are made transparently.

Before moving forward with any decision regarding the Montessori program’s relocation or the future of the Friendship facility, it is strongly recommended that the district:

- Reassess the cost projections using a third-party estimator;
- Require itemized breakdowns for high-budget renovations;
- Apply consistent cost metrics across facilities of similar size and condition.

*Source: Comparisons from 2025 budget 2025-2031: Colfax 104,223 sf., total construction is 8,920,800 or \$85.59 psf. Liberty 52,057 sf, \$3,169,880 or \$60.89 psf. Brookline 63,171 sq ft, \$3,124,500 or \$49.46psf. Square foot cost metrics derived from industry experts and actual construction costs of comparable institutional improvement projects.

Proposed Improvements: Option A

Friendship School Proposed Elevator Addition

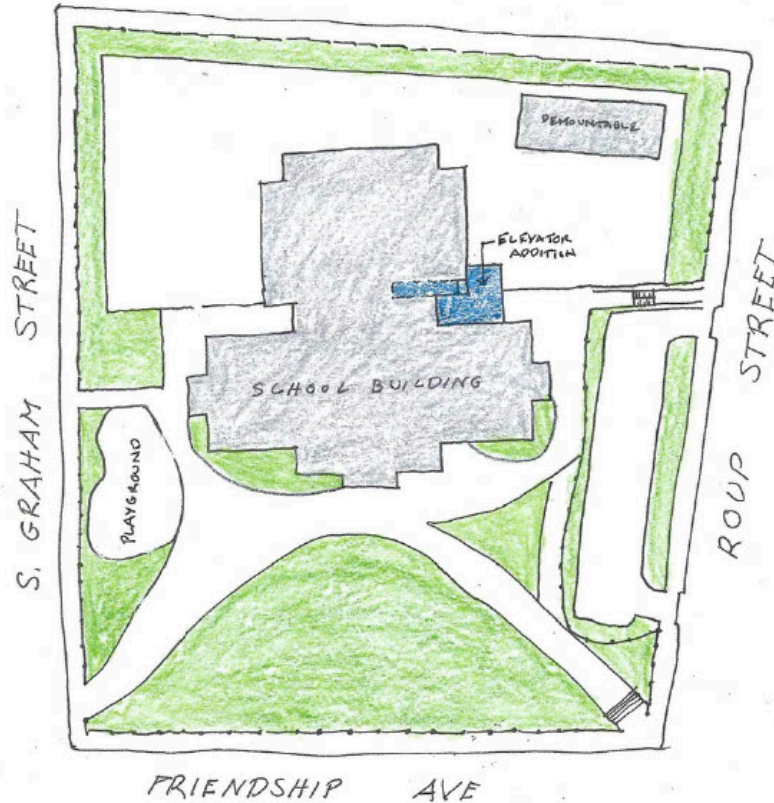

Site Plan - Not to Scale
Friendship Community Group, June 2025

This proposal includes a modest 1,800 sq. ft. elevator addition designed to meet the American with Disabilities Act (ADA) and City of Pittsburgh accessibility compliance standards. The addition provides direct entry from the ground level into either the existing gym or the elevator itself. The elevator would serve the basement, first floor (which will be accessible via a short corridor connecting to the central hallway) and the second floor.

To preserve the integrity of the building's historic facade, the new structure would be set back from the existing exterior walls. Access to the main building would be achieved through existing gym entrances, by modifying the gym facade, or by utilizing current window openings within the historic structure.

Proposed Improvements: Option B

Friendship School Proposed “Double-the-Size” Addition

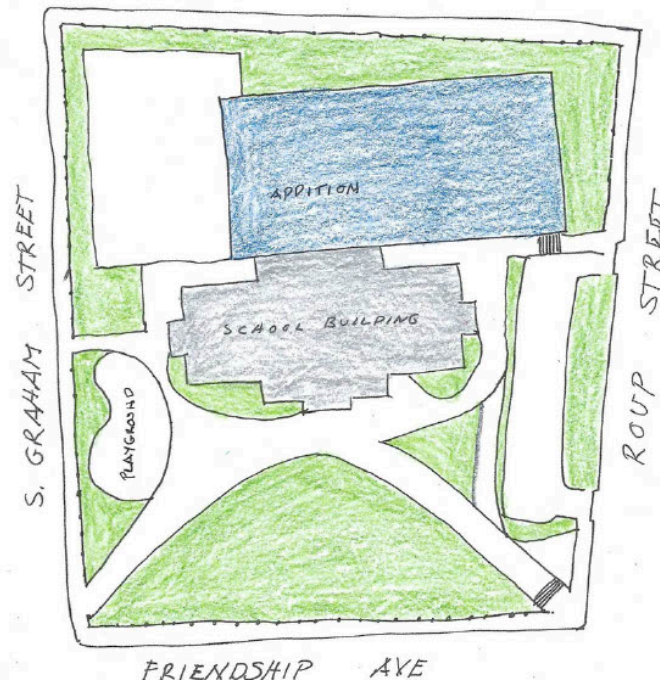

Site Plan - Not to Scale
Friendship Community Group, June 2025

This proposal offers an opportunity to double the size of the existing facility with a large new construction addition to the rear of the historic school. There are two options, both of which include a new gym/performance space. One option is a new two story 44,600 sq. foot building. The second option is to build a 67,700 square foot three story addition. Both of these options would not disturb the historic structure of the existing building as the new addition would only touch the existing building where the current gym is already located.

This proposal presents an opportunity to double the size of the existing facility through a substantial new addition located at the rear of the historic school building. Two design options could be considered, each incorporating a new gymnasium/performance space:

- **Option 1:** A two-story, 44,600 sq. ft. addition
- **Option 2:** A three-story, 67,700 sq. ft. addition

Both options are designed to preserve the historic integrity of the original structure. The new construction would connect only at the site of the existing gym, minimizing impact on the historic facade and architecture. Each addition would include an elevator with the capacity to serve all levels of the existing building, improving accessibility and functionality.

Save The Friendship School Petition



Urge the PPS school board to **vote NO** on the consolidation plan and **keep the Montessori program in the Friendship School.**

Link to Petition:

<https://sign.moveon.org/petitions/save-the-friendship-school-and-grounds>

Why the Friendship Montessori School Matters:

The Friendship School, which sits in the heart of the Friendship neighborhood, is currently home to the PPS Montessori PreK-5 program; a thriving, vibrant school community. Built in 1899, the school is an architectural gem and designated historic landmark. The building, designed for quality education, is filled with functional beauty and charm that makes it an ideal Montessori learning environment. Many of the students walk and bike to school, but families come from across the district to be a part of the highly sought-after Friendship Montessori school community.

Moreover, the school grounds are a vital gathering place, utilized by residents, sports teams, community groups, churches, and more. The beloved play park, built by Friendship Community Group, serves as a public amenity and a testament to the strong community involvement that surrounds the school.

The Case for Preservation:

While we acknowledge that maintaining a historic building poses challenges, we firmly believe that the Friendship School is worth the investment. Closing this school would not only displace a

tight knit family of students but also deprive the community of a vital resource. Instead of viewing it as an expense to cut, let's see it as an opportunity—an opportunity to maintain the vitality of our district and our community.

We urge Pittsburgh Public Schools to explore grant opportunities and engage with potential funders to secure the necessary resources for renovation and accessibility upgrades. The Friendship School can meet the standards for a healthy, equitable school environment while continuing to serve as a cherished community space. Through our network of architects, engineers, attorneys and grant writers, the Friendship Community Group is committed to assisting PPS in any way necessary to achieve this goal.

Join Us in Saving Friendship School!

The Friendship School is not just a school building; it is the beating heart of our neighborhood. Sign this petition to demand that the school board abandon the plan to close the Friendship School and commit to investing in its future!

Together, we can ensure that this iconic landmark continues to serve our community for generations to come.

How it will be delivered

Friendship Community Group will deliver the petition to each school board member and Superintendent Dr. Wayne N. Walters via email and printed copies. FCG is committed to assisting and supporting PPS in any way possible should they choose to seek funding for the necessary renovations to keep the Friendship Montessori school open and accessible to all.

For more information email: info@friendship-pgh.org

Signatures:

The petition collected 377 signatures as of June 24th, 2025. Please find the the signatures on the following pages:

Delivery: Petition delivered to School Board electronically: June 18th, 2025 and June 24th, 2025. Updated signature list delivered to the Board prior to the special hearing on 7/22/25.

Please contact the Friendship Community Group for further dialog. We stand ready to work alongside the PPS board to find an equitable alternative to the school's closure.

Ellen DiBiase, FCG President: president@friendship-pgh.org

Save Friendship Montessori School Petition as of June 24, 2025

| Order Signed | First Name | Last Name | Zip Code |
|--------------|------------|-----------|------------|
| 1 | Megan | Palomo | 15224 |
| 2 | Jennifer | Haven | 15224 |
| 3 | Becky | Mingo | 15206 |
| 4 | Sara | Leitera | 15217-2726 |
| 5 | Kara | Britanik | 15206 |
| 6 | Sara | DeLucia | 15224 |
| 7 | Thomas | Hritz | 15206 |
| 8 | Joe | DeLucia | 15224 |
| 9 | michele | timon | 15206 |
| 10 | Sarah | Hammock | 15206 |
| 11 | Liza | Barley | 15206 |
| 12 | Alex | Wert | 15206 |
| 13 | Mikaela | Kingsley | 15206 |
| 14 | Harmony | Sullivan | 15206 |
| 15 | Laura | Palotie | 15206 |
| 16 | Carson | Loveless | 21201 |
| 17 | Gil | Teixeira | 15206 |
| 18 | Atticus | Ryan | 15224 |
| 19 | Akirah | Wyatt | 15206 |
| 20 | Sarah | Porter | 15232 |
| 21 | Bill | O'Donnell | 15206 |
| 22 | Diana | Ames | 15224 |
| 23 | Kasia | Sudol | 15206 |
| 24 | Heather | Sage | 15201 |
| 25 | Michael | Wendt | 15206 |
| 26 | Debbie | Manetti | 15232 |
| 27 | Gillian | McTiernan | 15224 |
| 28 | Daniel | Holland | 15206 |
| 29 | Danielle | Novick | 15224 |

| | | | |
|----|-------------|------------|-------|
| 30 | Annie | Clough | 15206 |
| 31 | Patrick | Martz | 15224 |
| 32 | Sarah | Elder | 15224 |
| 33 | Victor | Vrabel | 15219 |
| 34 | Kevin | Brown | 15201 |
| 35 | Dami | Adebambo | 15201 |
| 36 | Jeremy | Bustamante | 15224 |
| 37 | Kenneth | Stiles | 15232 |
| 38 | Holly | King | 15224 |
| 39 | judith | Vanderbeck | 15232 |
| 40 | Sarah | Cohen | 15206 |
| 41 | Cierra | Maloney | 15206 |
| 42 | Ryan | Morden | 15206 |
| 43 | Christa | Brown | 13676 |
| 44 | Jennifer | Wilhelm | 15206 |
| 45 | Aaron | Garland | 15224 |
| 46 | Millie | Sass | 15224 |
| 47 | Lucy | Catlin | 15210 |
| 48 | Emily | Lovallo | 15206 |
| 49 | Roswell | McNutt | 15224 |
| 50 | Lowell | Reade | 15232 |
| 51 | Jason | C. | 15224 |
| 52 | Nora | Andrews | 15206 |
| 53 | Julie | Albright | 15206 |
| 54 | Elizabeth | Albright | 15213 |
| 55 | Elizabeth | Ruzanic | 15217 |
| 56 | Owen | Norley | 15232 |
| 57 | Melissa | Sugzdinis | 19355 |
| 58 | James | Malone | 15224 |
| 59 | Gladys | Cantillo | 15224 |
| 60 | Normajeanne | Lee | 60406 |

| | | | |
|----|----------|---------------|------------|
| 61 | Molly | McTiernan | 15147 |
| 62 | Casey | Sciullo | 15139 |
| 63 | Candace | McTiernan | 15139 |
| 64 | Callie | Robinson | 15232 |
| 65 | Felipe | Palomo | 15224 |
| 66 | Joshua | Snoke | 15206 |
| 67 | Michael | George | 15224 |
| 68 | Jonathan | Vander Plaats | 15212 |
| 69 | Emily | George | 15224 |
| 70 | Joel | Lee | 95959 |
| 71 | John | Stullken | 15206 |
| 72 | Michael | Scholar | 15206 |
| 73 | Sara | Stullken | 15206 |
| 74 | Emelia | Stullken | 15143 |
| 75 | Rebecca | sass | 15225 |
| 76 | Matthew | Stullken | 15108 |
| 77 | Jill | Gleeson | 15108 |
| 78 | Julia | Wattick | 15224 |
| 79 | Brian | Gruendl | 15224 |
| 80 | Tayler | Princeau | 94610-4981 |
| 81 | Ellen | DiBiase | 15224 |
| 82 | Natalie | Zubrow | 15232 |
| 83 | Ann | Hilton | 15206 |
| 84 | Lee Ann | Antol | 15232 |
| 85 | Linda | Vacca | 15224 |
| 86 | Oksana | Klueva | 15217 |
| 87 | Jayne | Bower | 15044 |
| 88 | Daniel | Paracat | 15224 |
| 89 | Denise | Mianzo | 15224 |
| 90 | Matthew | Grove | 15232 |
| 91 | Peter | Kraus | 15224 |

| | | | |
|-----|-------------|-------------------|-------|
| 92 | Elizabeth | Malone | 15224 |
| 93 | Emily | Kraus | 15224 |
| 94 | Giancarlo | Dozzi | 15232 |
| 95 | Olivia | Ciotoli | 15224 |
| 96 | Rick | Craven | 15206 |
| 97 | Walika | M | 15206 |
| 98 | Christopher | Baiamonte | 15215 |
| 99 | Courtney | Menanno | 15224 |
| 100 | Joshua | Bowman | 15201 |
| 101 | Lisa | Hurst | 15232 |
| 102 | Kevin | Hurst | 15232 |
| 103 | Abigail | Hazlett | 15206 |
| 104 | Julie | Vender | 15232 |
| 105 | Konrad | Holland | 15206 |
| 106 | David | Wohlwill | 15232 |
| 107 | Diane | Rizzo | 15225 |
| 108 | Valentina | Scholar | 16206 |
| 109 | Brian | Johnson | 15217 |
| 110 | Jessica | Ghilani | 15224 |
| 111 | Nicole | Hasak | 15143 |
| 112 | Nuria | Ballesteros Soria | 15224 |
| 113 | Jamie | Louden | 15201 |
| 114 | Helen | Smith | 15201 |
| 115 | Theres | Payne | 15206 |
| 116 | Hannah | Marvil | 15206 |
| 117 | J | Horst | 15218 |
| 118 | Lindsay | Varhola | 15207 |
| 119 | Tina | S | 15212 |
| 120 | David | Ferguson | 15206 |
| 121 | Sarah | Defeo | 15224 |
| 122 | Ashley | Morgan | 15224 |

| | | | |
|-----|-----------------|--------------|-------|
| 123 | Keith | Payne | 15206 |
| 124 | Craig | Biertempfel | 15224 |
| 125 | Andrea | Kubis | 15201 |
| 126 | Alia | Beaver | 15224 |
| 127 | Christine | Lepird | 15224 |
| 128 | tomasz | machnikowski | 15206 |
| 129 | Hayley | Davis | 15017 |
| 130 | Max | Zubrow | 15232 |
| 131 | Ryan | Beaver | 15224 |
| 132 | Draven | Marino | 15232 |
| 133 | Bryn | Laffey | 15201 |
| 134 | Carla | Coleman | 15206 |
| 135 | David | Laffey | 15201 |
| 136 | Rachael | Mamula | 15206 |
| 137 | Brad | Wyland | 15206 |
| 138 | Sydney | Brown | 51224 |
| 139 | Minette | Vaccariello | 15224 |
| 140 | Katie | Weimer | 15209 |
| 141 | Rachel | Delphia | 15206 |
| 142 | Caileigh | Johnston | 15683 |
| 143 | Beverly michael | Higgins | 15224 |
| 144 | Ingrid | Martinez | 15224 |
| 145 | Christin | Hudson | 15224 |
| 146 | Molly | Gunther | 15216 |
| 147 | Leslie | Petrovich | 15206 |
| 148 | Airicka | C. | 15232 |
| 149 | Samantha | Engelberg | 15232 |
| 150 | Grazia | Curatolo | 15102 |
| 151 | Mayah | E El-Dehaibi | 15217 |
| 152 | Eric | D | 15203 |
| 153 | Christi | Christofano | 15232 |

| | | | |
|-----|-----------|-----------|------------|
| 154 | Chris | Ward | 15224 |
| 155 | Lynnetta | Miller | 15232 |
| 156 | Scott | Engelberg | 15232 |
| 157 | John | Murray | 15214 |
| 158 | Jessica | Collins | 15214 |
| 159 | Emelee | mihalick | 15217 |
| 160 | Greg | Collins | 15024 |
| 161 | Heather | KULBACKI | 15226-2323 |
| 162 | Josephine | Murray | 15206 |
| 163 | Krista | Winslow | 15212 |
| 164 | Joyce | Kubasak | 15120 |
| 165 | Marilyn | Gregory | 15214 |
| 166 | Amanda | Dewalt | 15243 |
| 167 | Amanda | Rotharmel | 15324 |
| 168 | Steven | Seegers | 15232 |
| 169 | Katie | Sebastian | 15205 |
| 170 | Karen | Sloan | 15208 |
| 171 | Bonnie | Dobies | 15209 |
| 172 | Jessica | Pacelli | 15205 |
| 173 | Melissa | Petitto | 15024 |
| 174 | Tamaira | Binion | 15219 |
| 175 | Mary beth | Fazio | 15206 |
| 176 | Bev | Michael | 15224 |
| 177 | Samantha | Ridgeway | 15226 |
| 178 | Sarah | Yazvac | 15234 |
| 179 | Sara | Parisi | 15206 |
| 180 | Abbey | Fedrow | 15201 |
| 181 | Elyse | Thimons | 15239 |
| 182 | Judith | Tucker | 15206 |
| 183 | Angele | Ellis | 15206 |
| 184 | Melissa | Katigbak | 15211 |

| | | | |
|-----|-----------|--------------|------------|
| 185 | Alexandra | Schaefers | 15206 |
| 186 | Brian | Riedel | 15206 |
| 187 | Kurt | Schaefers | 15206 |
| 188 | Lisa | Schaefers | 15215 |
| 189 | Eileen | Schaefers | 15201 |
| 190 | Kayla | Stokes | 15223 |
| 191 | leah | russano | 15116 |
| 192 | Terrell | Grayson | 15206 |
| 193 | Amie | Stokes | 15223 |
| 194 | Klm | Weild | 15206 |
| 195 | Jennifer | Gallagher | 15206 |
| 196 | Nema | G | 15206 |
| 197 | David | Pini | 15201 |
| 198 | David | Brodbeck | 92617-4089 |
| 199 | Marc | Glowczewski | 15206 |
| 200 | Melinda | Eshelman | 15215 |
| 201 | Susan | Tsu | 15235 |
| 202 | Gabrielle | Reznek | 15201 |
| 203 | Joe | Pino | 15227 |
| 204 | Ausar | Stewart | 15217 |
| 205 | Sam | Turich | 15201 |
| 206 | Kristi | Good | 15235 |
| 207 | Giulia | Fanti | 15232 |
| 208 | Danielle | Staresinic | 15201 |
| 209 | Kelly | Iverson | 15201 |
| 210 | Judith | Conte | 15206 |
| 211 | Tiffany | Seidelman | 48133 |
| 212 | Michael | Hilton | 15206 |
| 213 | Lisa | Velten Smith | 15238 |
| 214 | Becky | Paul | 15201 |
| 215 | Anna | Brodbeck | 75224 |

| | | | |
|-----|-----------|-------------------|-------|
| 216 | Hugh | Abe | 15206 |
| 217 | Wakana | Abe | 15206 |
| 218 | Brittany | Miller | 15206 |
| 219 | Raeed | Chowdhury | 15224 |
| 220 | Nameera | Chowdhury | 15201 |
| 221 | Meilani | Erickson | 15226 |
| 222 | Gary | Kline | 15201 |
| 223 | David | Gerritsen | 15206 |
| 224 | Robert | Thomson | 15203 |
| 225 | Nina | Chase | 15201 |
| 226 | Abigail | Anderson | 15223 |
| 227 | Steven | Dang | 15206 |
| 228 | Jeffrey | Dorsey | 15224 |
| 229 | Kat | Marquez | 15206 |
| 230 | Betsy | Yazvac | 15146 |
| 231 | Andrew | Dunn | 15219 |
| 232 | Cynthia | Turich | 15208 |
| 233 | Sophia | Van Gorder | 15206 |
| 234 | Elizabeth | Zimmerman-Clayton | 15201 |
| 235 | Andy | Wolk | 90212 |
| 236 | Lisa | campbell | 15201 |
| 237 | Nicholas | Milasich | 15206 |
| 238 | Travis | Scott | 15206 |
| 239 | Hannah | Glass | 15223 |
| 240 | Tiffany | Ditch | 15215 |
| 241 | Robert | Widmaier | 15232 |
| 242 | Sean | Mahan | 15224 |
| 243 | Elizabeth | Lamitina | 15224 |
| 244 | Dominique | Kelly | 15214 |
| 245 | Nikki | Coffee | 15232 |
| 246 | Ernesto | Bedoy | 15210 |

| | | | |
|-----|--------------|-----------|------------|
| 247 | Vivi | Bedoy | 15210 |
| 248 | Stephanie | Ballard | 15224 |
| 249 | Marie | Henninger | 15211 |
| 250 | Kelly | Rerko | 32811 |
| 251 | Andrew | Smith | 15238 |
| 252 | Amie | Lopus | 15219 |
| 253 | Kizuwanda | Raines | 15206-3494 |
| 254 | jayson | kryla | 2740 |
| 255 | Sarah | Axtell | 15212 |
| 256 | terry | cleary | 90631 |
| 257 | Janice | Grant | 98012 |
| 258 | Licia | Slimon | 15206 |
| 259 | James | Caton | 15206 |
| 260 | Jennifer Joy | Wilson | 15206 |
| 261 | Kavitha | Conti | 15206 |
| 262 | Matthew | Conti | 15206 |
| 263 | Will | Zavala | 15206-3425 |
| 264 | Dutch | MacDonald | 15206 |
| 265 | Lisa | Werner | 15224 |
| 266 | Martha | Terry | 15224 |
| 267 | Elizabeth | Winter | 15206 |
| 268 | John | Werner | 15224 |
| 269 | Linda | Colbaugh | 15101 |
| 270 | Amy | M. | 15241 |
| 271 | fabrizio | rambaldi | 15217 |
| 272 | Danielle | Cazier | 83201 |
| 273 | Joe | Ritacco | 15206 |
| 274 | Daryl | Cross | 15206 |
| 275 | Bayley | Brown | 15208 |
| 276 | Michael | Dolan | 15206 |
| 277 | Shaun | Birch | 15206 |

| | | | |
|-----|--------------|--------------|-------|
| 278 | Katherine | Esterl | 15206 |
| 279 | Susan | Peake | 15206 |
| 280 | Victor | Dubbs | 15206 |
| 281 | Connor | Mitchell | 15211 |
| 282 | Adela | Holland | 15206 |
| 283 | Diane | Hurkmans | 15232 |
| 284 | Eileen | Kraus | 15206 |
| 285 | Rosa | Tapia | 15206 |
| 286 | Mikayla | Bird | 97045 |
| 287 | Ronnie | Cook Zuhlke | 15217 |
| 288 | Brittney | Finley | 15224 |
| 289 | Rita | Porterfield | 15224 |
| 290 | Rebecca | Studer | 15221 |
| 291 | Eileen | Quigley | 15224 |
| 292 | John | Ryan | 15224 |
| 293 | Alessia | Deidda | 15217 |
| 294 | Maria | DeLima | 15224 |
| 295 | Desirae | Corona | 15206 |
| 296 | Devin | Mascilli | 15201 |
| 297 | Deidra | Albanese | 15224 |
| 298 | Nino | Albanese | 15224 |
| 299 | Dilla | Mastrangelo | 15224 |
| 300 | Veronica Rae | Green | 15210 |
| 301 | Chris | Minnerly | 15206 |
| 302 | Julie | Zaichuk-Ryan | 15224 |
| 303 | Walter | Burlack | 15206 |
| 304 | David | Lawrence | 15224 |
| 305 | Isabelle | Moldovan | 15224 |
| 306 | Susan | Nash | 15206 |
| 307 | Gia | Serianni | 15224 |
| 308 | Jourdan | Schmitz | 15206 |

| | | | |
|-----|------------|--------------------|-------|
| 309 | Teddy | Winovich | 15224 |
| 310 | Steven | Winslow | 15212 |
| 311 | Diana | Winovich | 15224 |
| 312 | Morgan | Cottington | 15206 |
| 313 | Nina | Paesano | 15224 |
| 314 | Nicolette | Garcia-Pawlowski | 15224 |
| 315 | Jacqueline | Frost | 15201 |
| 316 | Richard | Frost | 15201 |
| 317 | Jen | Hayes | 15201 |
| 318 | Krystle | Fitzpatrick | 15201 |
| 319 | Alexander | Schwall | 15232 |
| 320 | Eric | Smith | 15201 |
| 321 | Lena | Makaroun | 15206 |
| 322 | Luca | Sbrizzi | 15201 |
| 323 | Jenna | Breitbach-Eldredge | 15201 |
| 324 | Ivy | Breitbach | 15206 |
| 325 | Lesley | Breitbach | 15209 |
| 326 | Daniel | Breitbach | 15209 |
| 327 | Cal | Stonecipher | 15206 |
| 328 | Allison | Grzybek | 15044 |
| 329 | Sheila | Grab | 15224 |
| 330 | Alison | Bartolone | 15201 |
| 331 | Abigail | Harter | 15210 |
| 332 | John | Goray | 15224 |
| 333 | Erica | Pasquali | 15235 |
| 334 | Adrienne | Seapker | 15202 |
| 335 | Sally | Folan | 15221 |
| 336 | Matt | Sundermann | 15201 |
| 337 | Natalie | Gaughan | 15224 |
| 338 | Amanda | Kefal | 15224 |
| 339 | Maggie | Folan | 15218 |

| | | | |
|-----|-----------------|-----------|------------|
| 340 | Cindy | Du | 15224 |
| 341 | Rohith Krishnan | Pillai | 15206 |
| 342 | Jesse | Carpenter | 15224 |
| 343 | Karla | Coello | 8820 |
| 344 | Judith | Faggart | 27573 |
| 345 | David | Stuart | 60644 |
| 346 | Thistle | Elias | 15206 |
| 347 | Sandra | Murray | 15206 |
| 348 | Mary Ellen | Poole | 15224 |
| 349 | Cody | Williams | 92543 |
| 350 | Mary Beth | Cole | 80016 |
| 351 | Lyla | Gideon | 76367 |
| 352 | Lindsey | Hollands | 76209 |
| 353 | Kaylee | Leon | 8533 |
| 354 | Jacob | Tredway | 25507 |
| 355 | Jessi | Cramer | 15224 |
| 356 | Sarah | Hawkinson | 92109 |
| 357 | Kristin | Hughes | 15206 |
| 358 | Penny | Wendell | 94801 |
| 359 | Jessica | Tiberi | 15232 |
| 360 | Hannah | Santone | 15224 |
| 361 | Kimberly | Mangan | 15232 |
| 362 | Michael | Rebinski | 15232 |
| 363 | Maria | Colonna | 15206 |
| 364 | Mary | Levrio | 15224-1704 |
| 365 | Mike | Santone | 15224 |
| 366 | Monica | McElwain | 15116 |
| 367 | susan | spangler | 15232 |
| 368 | Jennifer | Quinio | 15224 |
| 369 | Norman | Beck | 15232 |
| 370 | lauryn | stalter | 15224 |

| | | | |
|-----|-------------|-------------------|-------|
| 371 | Jennifer | Burnau | 15224 |
| 372 | Tara | Durstewitz | 15232 |
| 373 | Michael | Yoder | 15224 |
| 374 | Stefani | Danes | 15224 |
| 375 | Juliana | Geyer | 15232 |
| 376 | Joseph | Mattis | 15206 |
| 377 | Solange | Zavala | 15206 |
| 378 | Larry | Laude | 15224 |
| 379 | Nancy | Martin | 15229 |
| 380 | Kenya | Sero | 18042 |
| 381 | Nicholas | Sero | 15214 |
| 382 | Barbara | Spell | 15214 |
| 383 | Yeonhee | Stanley | 15219 |
| 384 | Andrea | Grebner | 15201 |
| 385 | David | Grebner | 15201 |
| 386 | Lora | Laverty | 27330 |
| 387 | Annie | Conner | 15208 |
| 388 | Laura | Schuck | 15224 |
| 389 | Terra | Ferderber | 15212 |
| 390 | Natalie | Antonucci | 15213 |
| 391 | Rose | Hamilton | 15206 |
| 392 | Andre | Thomas | 60615 |
| 393 | Elizabeth | Zimmerman-Clayton | 15201 |
| 394 | mary | trigo | 15212 |
| 395 | Christopher | Guignon | 15208 |
| 396 | Staci | Offutt | 15206 |
| 397 | Michael | Franklin | 15224 |
| 398 | Anna | Radder | 15224 |
| 399 | Ida | Brockman | 15228 |
| 400 | Sean | Carroll | 15201 |
| 401 | Jessica | Hower | 15206 |

| | | | |
|-----|----------|---------------|-------|
| 402 | Hallie | Pritts | 15226 |
| 403 | Emily | Standridge | 15210 |
| 404 | Ana | Alba | 15206 |
| 405 | Eileen | Kraus-Dobratz | 15206 |
| 406 | Saya | Terada | 15206 |
| 407 | Jessa | Gibboney | 15217 |
| 408 | Karen | Hochberg | 15217 |
| 409 | Jill | Walsh | 15237 |
| 410 | Rhaven | Nelson | 15217 |
| 411 | Karen | Springmeyer | 16055 |
| 412 | Ryan | Wotus | 15143 |
| 413 | Tara | Wotus | 15143 |
| 414 | Ashley | Devine | 15229 |
| 415 | Samantha | Mariani | 15224 |
| 416 | Ginger | Mariani | 15224 |
| 417 | Courtney | Callas | 16055 |
| 418 | Richard | Fredin | 15224 |
| 419 | Robert | Handley | 15224 |
| 420 | Ian | Candy | 15224 |
| 421 | Mary | Klein | 15218 |
| 422 | Ken | Bolden | 15224 |
| 423 | Sarah | Lewis | 15238 |
| 424 | Karla | Tirimacco | 15241 |
| 425 | Kris | Callender | 15243 |
| 426 | Kris | Tirimacco | 15017 |
| 427 | Norman | Brown | 15213 |
| 428 | Jessica | Gumbert | 15201 |
| 429 | Nancy | Cohen | 15224 |
| 430 | michele | morris | 15206 |
| 431 | Fred | Noel | 14224 |
| 432 | Julie | Grove | 15232 |

| | | | |
|-----|------------|----------|-------|
| 433 | Connie | Haller | 15232 |
| 434 | Victoria | Potter | 15224 |
| 435 | Charles | Gianakas | 15232 |
| 436 | Lee | Haller | 15233 |
| 437 | Anne | Gianakas | 15232 |
| 438 | Jennifer | Stein | 15208 |
| 439 | Megan | Shelly | 15232 |
| 440 | Dan | Potter | 15224 |
| 441 | Yuliia | Sergeeva | 15224 |
| 442 | Max | Zubrow | 15232 |
| 443 | David | Zubrow | 15217 |
| 444 | Patrick | Zubrow | 15235 |
| 445 | Anna | Zubrow | 15632 |
| 446 | Molly | Simon | 98107 |
| 447 | Anne Marie | Kuchera | 15206 |
| 448 | Alice | Ceraso | 15221 |
| 449 | Emily | Zubrkw | 15235 |
| 450 | Stephanie | DeLucia | 15206 |
| 451 | Kevin | Bell | 15206 |
| 452 | Laura | Hansen | 15215 |
| 453 | Madeline | Schindel | 15232 |
| 454 | CHARLES | SCHINDEL | 15232 |
| 455 | Susan | Petersen | 15224 |
| 456 | Greta | Hall | 15217 |
| 457 | Priscilla | Gibboney | 15217 |
| 458 | Karen | Cornell | 15208 |
| 459 | Christine | Zubrow | 15235 |
| 460 | Benjamin | Gibboney | 15217 |
| 461 | Beth | Corning | 15224 |
| 462 | Marc | Nieson | 15224 |
| 463 | Art | Gola | 15206 |

| | | | |
|-----|---------|-------|-------|
| 464 | Susan M | Smith | 15224 |
| 465 | Julie | Aiken | 15224 |