



BOLLES PLANNER

2025-26
Middle School
Bartram Campus
SEMESTER 1

BOLLES KEY CALENDAR DATES 2025-26

~2025~

New and All Grade 6 Middle School Orientation/New and All Grade 9 Upper School Orientation/	
Meet Your Teacher Day Lower School.....	August 13
First Day of School.....	August 14
Labor Day, School Closed.....	September 1
Middle and Upper School Quarter 1 End of Interim	September 12
Middle and Upper School Quarter 1 Ends	October 2
Middle School BELONG Day, Alt. Schedule.....	October 8
Upper School SPARK Day, Alt. Schedule	October 9
Lower, Middle and Upper School Conference Days, No Classes.....	October 16 & 17
Fall Break, School Closed	October 20
Middle and Upper School Quarter 2 End of Interim	November 6
Lower School Trimester 1 Ends/ Lower School Writing Day, No Classes/	
Middle and Upper School Classes in Session.....	November 7
Middle, Upper and Lower School Professional Development Day, No Classes	November 21
Thanksgiving Break, School Closed	November 24-28
Upper School Quarter 2 Ends.....	December 12
Upper School Reading Day, No Classes.....	December 15
Middle School, Classes in Session	December 15-16
Middle School Quarter 2 Ends	December 16
Upper School Exams	December 16-19
Middle School Reading Day, No Classes.....	December 17
Middle School Exams	December 18-19
Winter Break, School Closed.....	December 22-31

~2026~

Winter Break, School Closed.....	January 1-2
Professional Development Day, No Classes	January 5
Classes Resume	January 6
Martin Luther King Day, School Closed.....	January 19
Middle and Upper School Quarter 3 End of Interim	February 4
Lower, Middle and Upper School Parent Conference Day, No Classes/	
Lower School End of Trimester 2	February 13
Presidents' Day, School Closed	February 16
Spring Break, School Closed.....	March 9-13
Lower, Middle and Upper School Professional Development Day, No Classes	March 16
Middle and Upper School Quarter 3 End	March 17
Spring Holiday, School Closed.....	April 3 & 6
Middle and Upper School Quarter 4 End of Interim.....	April 17
Last Day of Classes for Middle and Upper School/ Quarter 4 Ends	May 15
Middle and Upper School Exam Week.....	May 18-22
Last Day of Classes for Lower School	May 21
Graduation.....	May 23
Memorial Day, School Closed.....	May 25

NAME: _____ GRADE: _____

STUDENT NUMBER: _____

ADVISOR: _____

BUS #: _____

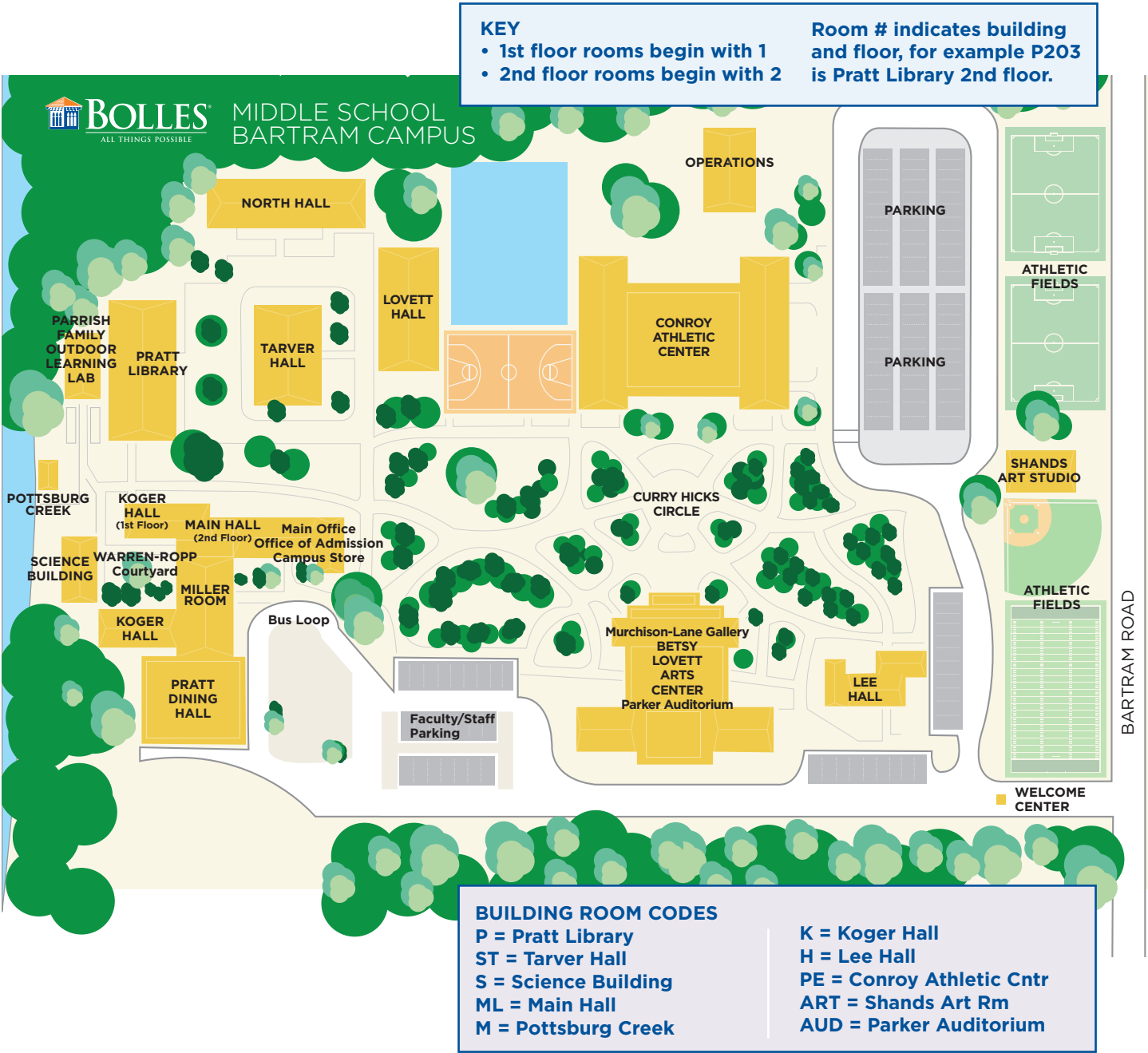

NOTES

Bartram Middle School Campus Expectations

- If you arrive at school before 8 a.m., you are to report directly to the cafeteria.
- Phones and smart watches are to be turned off and put away (in your backpack or locker) from 8 a.m. to 3 p.m. If you need to speak to your parent, you may ask to come to the main office to call them. If your parent needs to speak to you, they should call the front office at (904) 732-5700.
- Devices are to be used for academic purposes only, not gaming, listening to music, or watching videos. Any device usage should be directed by a teacher.
- No student should be in a classroom, the Miller room, gym, auditorium, etc., if there is not a faculty member present for supervision.
- P.E. clothes and locks for your locker are sold in the campus store.
- No gum is allowed on campus.
- No foul language is allowed on campus.
- Clean up after yourself.
- Treat others with kindness and respect.
- Be a person of courage.
- Be a person of integrity.
- Be a person of compassion.

Mindfulness

Everybody gets stressed. When you get stressed or feel overwhelmed, or just need to take a break for your brain, what can you do? Here are a few suggestions:

- Talk to a trusted teacher or friend
- Take a short walk
- Take a minute to think about how you feel



Try this 1-minute exercise that will help calm you and collect your thoughts...

1-minute grounding exercise:

1. Take a seat with your feet on the ground (in a chair, on a bench, etc.).
2. Take a deep breath in. Notice your body as you inhale.
3. Take a long breath out. Notice your body as you exhale.
4. Follow your breath in and out.
5. Rest your mind on your belly or your chest or at your nostrils.
6. Be aware as you breathe in and out.

Middle School Dress Code

Starred items (*) are considered “Regulation,” meaning the clothing is required and must be purchased from the Bolles Lands’ End (www.landsend.com) store or the Bolles campus store. If you are given uniform pieces from a previous student, please ensure they meet the current dress code requirements.

BOTTOMS*: Khaki or navy-blue pants, skorts, and shorts purchased from the Bolles Lands’ End store of an appropriate fit and length. The Bolles logo will be embroidered on all uniform bottoms. Skorts are the “top of the knee” style, unaltered with a Bolles logo at the hem. Belts are required for bottoms with belt loops. Tights or leggings are permitted under skorts. They must be solid, understated colors (white, gray, navy, black, tan). Please allow for growth; skorts and shorts must reach or extend beyond the fingertips when at a normal stance.

SHIRTS*: Oxford button down or polo-style shirts with the Bolles logo purchased from the Bolles Lands’ End store or the campus store. Bolles polo-style team shirts (sports, band, robotics, etc.) are also acceptable. They should be the correct size for the student, not oversized, and always tucked in neatly with the belt/waistband visible.

SWEATERS: Solid color cardigan, V-neck, or crew neck sweaters or sweater vest of the student’s choice. They should be the correct size for the student, not oversized. Options are available from the Bolles Lands’ End store.

SWEATSHIRTS: Bolles School sweatshirts may be worn. They should be the correct size for the student, not oversized.

BELTS: Bottoms (pants, shorts, and skorts) with belt loops must be worn with a belt.

SHOES: Shoes must have a closed toe and heel with a flat heel. Examples – athletic shoes, ballet flats, boat shoes.

OUTERWEAR: In cold weather, students may wear jackets and coats with no large logos, advertising, or denim. Hoodies/sweatshirts are not considered jackets. Options are available from the Bolles Lands’ End store.

ACCESSORIES: Hair and makeup must be neat, and not in a dramatic style or unnatural color. Hair should be well-groomed and out of the eyes. Hats and sunglasses are not permitted. Accessories (jewelry, socks, belts, etc.) must be simple and understated.

DESIGNATED SPIRIT DRESS DAYS: On designated Spirit Days, students may wear a Bolles polo shirt or a Bolles t-shirt, with uniform bottoms or long jeans with no rips, tears, or holes.



Middle School Sports Go Bulldogs!

Coaches will announce start dates in global emails for all winter and spring sports.
Winter sports generally begin in October/November and spring sports in January.

Sport	Coach	Contact
Fall Sports		
Cheerleading	Amanda Kieck	akieck.cheer@gmail.com
Boys' Cross Country	Steven Stam '00	StamS@Bolles.org
Girls' Cross Country	Tony Ryan	RyanT@Bolles.org
Boys' Crew (Fall Season)	Chris Register	RegisterC@Bolles.org
Girls' Crew (Fall Season)	Conny Kirsch	KirschC@Bolles.org
Football	Joey Hudson	HudsonJ@Bolles.org
Boys' Golf	Trey Leonard	LeonardT@Bolles.org
Girls' Golf	Micheal McGrath	McGrathM@Bolles.org
Swimming and Diving	Dale Porter	PorterD@Bolles.org
Volleyball	Natalie Blackwell	BlackwellN@Bolles.org
Winter Sports		
Boys' Basketball	Sean Mullings	MullingsS@Bolles.org
Girls' Basketball	Rachel Freeman	FreemanR@bolles.org
Boys' Soccer	Mike Akabekjan	AkabekjanM@Bolles.org
Girls' Soccer	Abby Lieftring	abbylieftring@gmail.com
Wrestling	Billy Regan	william.regan.01@gmail.com
Weightlifting	Tyler Jump	JumpT@Bolles.org
Spring Sports		
Baseball	Matt Denmark	DenmarkM@Bolles.org
Boys' Crew (Spring Season)	Chris Register	RegisterC@Bolles.org
Girls' Crew (Spring Season)	Conny Kirsch	KirschC@Bolles.org
Boys' Lacrosse	Mark Hoey	HoeyM@Bolles.org
Girls' Lacrosse	Abby Lieftring	LieftringA@Bolles.org
Softball	Joey Hudson	HudsonJ@Bolles.org
Boys' Tennis	Matt Lichtenstein	mlichtenstein@jtcc.org
Girls' Tennis	Francesca Fusinato	fusinatofrancesca@gmail.com
Track and Field	Alicia Henderson	HendersonA@Bolles.org

MAIN CONTACT
Athletic Director — Matt Denmark (DenmarkM@Bolles.org)
Phone: (904) 732-5710

AUGUST 2025



NOTES	MON	TUE
	4	5
	New Faculty/Staff Orientation	New Faculty/Staff Orientation
	11	12
	Faculty/Staff Pre-planning	Faculty/Staff Pre-planning
	C18	D19
	A25	B26

WED	THU	FRI	SAT	SUN
		1	2	3
6	7	8	9	10
Faculty/Staff Pre-planning	Faculty/Staff Pre-planning	Faculty/Staff Pre-planning		
13A14B15			16	17
Middle and Upper School New to Campus Student Orientation	First Day of Classes			
E20F21G22			23	24
C27D28E29			30	31

WEEK OF AUG 4-8, 2025

	Mon	4	Tue	5
8-9 a.m.	New Faculty/Staff Orientation		New Faculty/Staff Orientation	
9-10 a.m.				
10-11 a.m.				
11 a.m.-12 p.m.				
12-1 p.m.				
1-2 p.m.				
2-3 p.m.				
3-4 p.m.				

NOTES:

[illegible]

WEEK OF AUG 11-15, 2025

[illegible]

FIRST DAY OF 2025-26 SCHOOL YEAR

Thu	A	14	Fri	B	15	Saturday
Zero Hour 8-8:30 a.m.			Zero Hour 8-8:30 a.m.			
Advisory 8:30-8:40 a.m.			Advisory 8:30-8:40 a.m.			
1 8:45-9:40 a.m.		1.1	6 8:45-9:40 a.m.		1.1	
2 9:45-10:40 a.m.		1.1	7 9:45-10:40 a.m.		1.1	
Sunday						
Convocation - 10:40-11:10 a.m.			Activities - 10:40-11:10 a.m.			
3 11:10 a.m.-12:05 p.m.		1.1	1 11:10 a.m.-12:05 p.m.		1.2	
Notes						
12:05-12:25 p.m. — Grade 8 Lunch			12:05-12:25 p.m. — Grade 8 Lunch			
12:25-12:40 p.m. — Grade 6 Lunch			12:25-12:40 p.m. — Grade 6 Lunch			
12:40-1 p.m. — Grade 7 Lunch			12:40-1 p.m. — Grade 7 Lunch			
4 1:05-2 p.m.		1.1	2 1:05-2 p.m.		1.2	
5 2:05-3 p.m.		1.1	3 2:05-3 p.m.		1.2	
After School			After School			

WEEK OF AUG 18-22, 2025

Mon	C	18	Tue	D	19	Wed	E	20
Zero Hour 8-8:30 a.m.			Zero Hour 8-8:30 a.m.					
Advisory 8:30–8:40 a.m.			Advisory 8:30–8:40 a.m.					
4 8:45-9:40 a.m.1.2			2 8:45-9:40 a.m.1.3			Late Start Wednesday		
						7 8:55-9:50 a.m.1.3		
5 9:45-10:40 a.m.1.2			3 9:45-10:40 a.m.1.3					
						1 9:55-10:50 a.m.1.4		
Convocation — 10:40-11:10 a.m.			Activities — 10:40-11:10 a.m.					
						Break — 10:50-11:10 a.m.		
6 11:10 a.m.-12:05 p.m.1.2			4 11:10 a.m.-12:05 p.m.1.3			2 11:10 a.m.-12:05 p.m.1.4		
12:05-12:25 p.m. — Grade 8 Lunch			12:05-12:25 p.m. — Grade 8 Lunch			12:05-12:25 p.m. — Grade 8 Lunch		
12:25-12:40 p.m. — Grade 6 Lunch			12:25-12:40 p.m. — Grade 6 Lunch			12:25-12:40 p.m. — Grade 6 Lunch		
12:40-1 p.m. — Grade 7 Lunch			12:40-1 p.m. — Grade 7 Lunch			12:40-1 p.m. — Grade 7 Lunch		
7 1:05–2 p.m.1.2			5 1:05–2 p.m.1.3			3 1:05–2 p.m.1.4		
1 2:05–3 p.m.1.3			6 2:05–3 p.m.1.3			4 2:05–3 p.m.1.4		
After School			After School			After School		

Thu	F	21	Fri	G	22	Saturday
Zero Hour 8-8:30 a.m.			Zero Hour 8-8:30 a.m.			
5 8:30-9:25 a.m. 1.4			Advisory 8:30–8:40 a.m.			
			3 8:45-9:40 a.m. 1.5			
6 9:30-10:25 a.m. 1.4						
			4 9:45-10:40 a.m. 1.5			
Advisory – 10:25-11:05 a.m.						Sunday
			Activities – 10:40-11:10 a.m.			
7 11:10 a.m.-12:05 p.m. 1.4			5 11:10 a.m.-12:05 p.m. 1.5			
12:05-12:25 p.m. — Grade 8 Lunch			12:05-12:25 p.m. — Grade 8 Lunch			
12:25-12:40 p.m. — Grade 6 Lunch			12:25-12:40 p.m. — Grade 6 Lunch			
12:40-1 p.m. — Grade 7 Lunch			12:40-1 p.m. — Grade 7 Lunch			Notes
1 1:05–2 p.m. 1.5			6 1:05–2 p.m. 1.5			
2 2:05–3 p.m. 1.5			7 2:05–3 p.m. 1.5			
After School			After School			

WEEK OF AUG 25-29, 2025

MonA25	TueB26	WedC27
Zero Hour 8-8:30 a.m.	Zero Hour 8-8:30 a.m.	
Advisory 8:30–8:40 a.m.	Advisory 8:30–8:40 a.m.	
1 8:45-9:40 a.m.2.1	6 8:45-9:40 a.m.2.1	Late Start Wednesday
		4 8:55-9:50 a.m.2.2
2 9:45-10:40 a.m.2.1	7 9:45-10:40 a.m.2.1	
		5 9:55-10:50 a.m.2.2
Convocation — 10:40-11:10 a.m.	Activities — 10:40-11:10 a.m.	
		Break — 10:50-11:10 a.m.
3 11:10 a.m.-12:05 p.m.2.1	1 11:10 a.m.-12:05 p.m.2.2	6 11:10 a.m.-12:05 p.m.2.2
12:05-12:25 p.m. — Grade 8 Lunch	12:05-12:25 p.m. — Grade 8 Lunch	12:05-12:25 p.m. — Grade 8 Lunch
12:25-12:40 p.m. — Grade 6 Lunch	12:25-12:40 p.m. — Grade 6 Lunch	12:25-12:40 p.m. — Grade 6 Lunch
12:40-1 p.m. — Grade 7 Lunch	12:40-1 p.m. — Grade 7 Lunch	12:40-1 p.m. — Grade 7 Lunch
4 1:05–2 p.m.2.1	2 1:05–2 p.m.2.2	7 1:05–2 p.m.2.2
5 2:05–3 p.m.2.1	3 2:05–3 p.m.2.2	1 2:05–3 p.m.2.3
After School	After School	After School

ThuD28	FriE29	Saturday
Zero Hour 8-8:30 a.m.	Zero Hour 8-8:30 a.m.	
2 8:30-9:25 a.m.2.3	Advisory 8:30–8:40 a.m.	
	7 8:45-9:40 a.m.2.3	
3 9:30-10:25 a.m.2.3		
	1 9:45-10:40 a.m.2.4	
Advisory – 10:25-11:05 a.m.		
	Activities – 10:40-11:10 a.m.	
4 11:10 a.m.-12:05 p.m.2.3	2 11:10 a.m.-12:05 p.m.2.4	
12:05-12:25 p.m. — Grade 8 Lunch	12:05-12:25 p.m. — Grade 8 Lunch	
12:25-12:40 p.m. — Grade 6 Lunch	12:25-12:40 p.m. — Grade 6 Lunch	
12:40-1 p.m. — Grade 7 Lunch	12:40-1 p.m. — Grade 7 Lunch	
5 1:05–2 p.m.2.3	3 1:05–2 p.m.2.4	
6 2:05–3 p.m.2.3	4 2:05–3 p.m.2.4	
After School	After School	

SEPTEMBER 2025



NOTES	MON	TUE
	1 Labor Day, School Closed	F 2
	C 8	D 9
	A 15	B 16
	F 22 Rosh Hashanah	G 23 Rosh Hashanah No homework assigned No quizzes or tests
	D 29	E 30

WED	THU	FRI	SAT	SUN
G 3	A 4	B 5	6	7
E 10	F 11 Faculty and Student Picture Day	G 12 Quarter 1 End of Interim	13	14
C 17	D 18	E 19	20	21
A 24 Rosh Hashanah No quizzes or tests	B 25	C 26	27	28
1	2	3	4	5

WEEK OF SEP 1-5, 2025

Mon1	TueF2	WedG3
Labor Day, School Closed	Zero Hour 8-8:30 a.m.	
	Advisory 8:30–8:40 a.m.	
	5 8:45-9:40 a.m.2.4	Late Start Wednesday
		3 8:55-9:50 a.m.2.5
	6 9:45-10:40 a.m.2.4	
		4 9:55-10:50 a.m.2.5
	Activities — 10:40-11:10 a.m.	
		Break — 10:50-11:10 a.m.
	7 11:10 a.m.-12:05 p.m.2.4	5 11:10 a.m.-12:05 p.m.2.5
	12:05-12:25 p.m. — Grade 8 Lunch	12:05-12:25 p.m. — Grade 8 Lunch
	12:25-12:40 p.m. — Grade 6 Lunch	12:25-12:40 p.m. — Grade 6 Lunch
	12:40-1 p.m. — Grade 7 Lunch	12:40-1 p.m. — Grade 7 Lunch
	1 1:05–2 p.m.2.5	6 1:05–2 p.m.2.5
	2 2:05–3 p.m.2.5	7 2:05–3 p.m.2.5
	After School	After School

ThuA4	FriB5	Saturday
Zero Hour 8-8:30 a.m.	Zero Hour 8-8:30 a.m.	
1 8:30-9:25 a.m.3.1	Advisory 8:30–8:40 a.m.	
	6 8:45-9:40 a.m.3.1	
2 9:30-10:25 a.m.3.1		Sunday
	7 9:45-10:40 a.m.3.1	
Advisory – 10:25-11:05 a.m.		Notes
	Activities – 10:40-11:10 a.m.	
3 11:10 a.m.-12:05 p.m.3.1	1 11:10 a.m.-12:05 p.m.3.2	
12:05-12:25 p.m. — Grade 8 Lunch	12:05-12:25 p.m. — Grade 8 Lunch	
12:25-12:40 p.m. — Grade 6 Lunch	12:25-12:40 p.m. — Grade 6 Lunch	
12:40-1 p.m. — Grade 7 Lunch	12:40-1 p.m. — Grade 7 Lunch	
4 1:05–2 p.m.3.1	2 1:05–2 p.m.3.2	
5 2:05–3 p.m.3.1	3 2:05–3 p.m.3.2	
After School	After School	

WEEK OF SEP 8-12, 2025

Mon	C	8	Tue	D	9	Wed	E	10
Zero Hour 8-8:30 a.m.			Zero Hour 8-8:30 a.m.					
Advisory 8:30–8:40 a.m.			Advisory 8:30–8:40 a.m.					
4 8:45-9:40 a.m.3.2			2 8:45-9:40 a.m.3.3			Late Start Wednesday		
						7 8:55-9:50 a.m.3.3		
5 9:45-10:40 a.m.3.2			3 9:45-10:40 a.m.3.3					
						1 9:55-10:50 a.m.3.4		
Convocation — 10:40-11:10 a.m.			Activities — 10:40-11:10 a.m.					
						Break — 10:50-11:10 a.m.		
6 11:10 a.m.-12:05 p.m.3.2			4 11:10 a.m.-12:05 p.m.3.3			2 11:10 a.m.-12:05 p.m.3.4		
12:05-12:25 p.m. — Grade 8 Lunch			12:05-12:25 p.m. — Grade 8 Lunch			12:05-12:25 p.m. — Grade 8 Lunch		
12:25-12:40 p.m. — Grade 6 Lunch			12:25-12:40 p.m. — Grade 6 Lunch			12:25-12:40 p.m. — Grade 6 Lunch		
12:40-1 p.m. — Grade 7 Lunch			12:40-1 p.m. — Grade 7 Lunch			12:40-1 p.m. — Grade 7 Lunch		
7 1:05–2 p.m.3.2			5 1:05–2 p.m.3.3			3 1:05–2 p.m.3.4		
1 2:05–3 p.m.3.3			6 2:05–3 p.m.3.3			4 2:05–3 p.m.3.4		
After School			After School			After School		

Faculty and Student, Picture Day

Quarter 1 End of Interim

Thu	F	11	Fri	G	12	Saturday	
Zero Hour 8-8:30 a.m.			Zero Hour 8-8:30 a.m.				
5 8:30-9:25 a.m. 3.4			Advisory 8:30–8:40 a.m.				
			3 8:45-9:40 a.m. 3.5				
6 9:30-10:25 a.m. 3.4							
			4 9:45-10:40 a.m. 3.5				
Advisory – 10:25-11:05 a.m.						Sunday	
			Activities – 10:40-11:10 a.m.				
7 11:10 a.m.-12:05 p.m. 3.4			5 11:10 a.m.-12:05 p.m. 3.5				
12:05-12:25 p.m. — Grade 8 Lunch			12:05-12:25 p.m. — Grade 8 Lunch				Notes
12:25-12:40 p.m. — Grade 6 Lunch			12:25-12:40 p.m. — Grade 6 Lunch				
12:40-1 p.m. — Grade 7 Lunch			12:40-1 p.m. — Grade 7 Lunch				
1 1:05–2 p.m. 3.5			6 1:05–2 p.m. 3.5				
2 2:05–3 p.m. 3.5			7 2:05–3 p.m. 3.5				
After School			After School				

WEEK OF SEP 15-19, 2025

MonA15	TueB16	WedC17
Zero Hour 8-8:30 a.m.	Zero Hour 8-8:30 a.m.	
Advisory 8:30–8:40 a.m.	Advisory 8:30–8:40 a.m.	
1 8:45-9:40 a.m.4.1	6 8:45-9:40 a.m.4.1	Late Start Wednesday
		4 8:55-9:50 a.m.4.2
2 9:45-10:40 a.m.4.1	7 9:45-10:40 a.m.4.1	
		5 9:55-10:50 a.m.4.2
Convocation — 10:40-11:10 a.m.	Activities — 10:40-11:10 a.m.	
		Break — 10:50-11:10 a.m.
3 11:10 a.m.-12:05 p.m.4.1	1 11:10 a.m.-12:05 p.m.4.2	6 11:10 a.m.-12:05 p.m.4.2
12:05-12:25 p.m. — Grade 8 Lunch	12:05-12:25 p.m. — Grade 8 Lunch	12:05-12:25 p.m. — Grade 8 Lunch
12:25-12:40 p.m. — Grade 6 Lunch	12:25-12:40 p.m. — Grade 6 Lunch	12:25-12:40 p.m. — Grade 6 Lunch
12:40-1 p.m. — Grade 7 Lunch	12:40-1 p.m. — Grade 7 Lunch	12:40-1 p.m. — Grade 7 Lunch
4 1:05–2 p.m.4.1	2 1:05–2 p.m.4.2	7 1:05–2 p.m.4.2
5 2:05–3 p.m.4.1	3 2:05–3 p.m.4.2	1 2:05–3 p.m.4.3
After School	After School	After School

ThuD18	FriE19	Saturday
Zero Hour 8-8:30 a.m.	Zero Hour 8-8:30 a.m.	
2 8:30-9:25 a.m.4.3	Advisory 8:30–8:40 a.m.	
	7 8:45-9:40 a.m.4.3	
3 9:30-10:25 a.m.4.3		Sunday
	1 9:45-10:40 a.m.4.4	
Advisory – 10:25-11:05 a.m.		
	Activities – 10:40-11:10 a.m.	
4 11:10 a.m.-12:05 p.m.4.3	2 11:10 a.m.-12:05 p.m.4.4	
		Notes
12:05-12:25 p.m. — Grade 8 Lunch	12:05-12:25 p.m. — Grade 8 Lunch	
12:25-12:40 p.m. — Grade 6 Lunch	12:25-12:40 p.m. — Grade 6 Lunch	
12:40-1 p.m. — Grade 7 Lunch	12:40-1 p.m. — Grade 7 Lunch	
5 1:05–2 p.m.4.3	3 1:05–2 p.m.4.4	
6 2:05–3 p.m.4.3	4 2:05–3 p.m.4.4	
After School	After School	

WEEK OF SEP 22-26, 2025

Rosh Hashanah			Rosh Hashanah			Rosh Hashanah		
No homework assigned, No quizzes or tests			No homework assigned, No quizzes or tests			No quizzes or tests		
Mon	F	22	Tue	G	23	Wed	A	24
Zero Hour 8-8:30 a.m.			Zero Hour 8-8:30 a.m.					
Advisory 8:30–8:40 a.m.			Advisory 8:30–8:40 a.m.					
5 8:45-9:40 a.m. 4.4			3 8:45-9:40 a.m. 4.5			Late Start Wednesday		
						1 8:55-9:50 a.m. 5.1		
6 9:45-10:40 a.m. 4.4			4 9:45-10:40 a.m. 4.5					
						2 9:55-10:50 a.m. 5.1		
Convocation — 10:40-11:10 a.m.			Activities — 10:40-11:10 a.m.					
						Break — 10:50-11:10 a.m.		
7 11:10 a.m.-12:05 p.m. 4.4			5 11:10 a.m.-12:05 p.m. 4.5			3 11:10 a.m.-12:05 p.m. 5.1		
12:05-12:25 p.m. — Grade 8 Lunch			12:05-12:25 p.m. — Grade 8 Lunch			12:05-12:25 p.m. — Grade 8 Lunch		
12:25-12:40 p.m. — Grade 6 Lunch			12:25-12:40 p.m. — Grade 6 Lunch			12:25-12:40 p.m. — Grade 6 Lunch		
12:40-1 p.m. — Grade 7 Lunch			12:40-1 p.m. — Grade 7 Lunch			12:40-1 p.m. — Grade 7 Lunch		
1 1:05–2 p.m. 4.5			6 1:05–2 p.m. 4.5			4 1:05–2 p.m. 5.1		
2 2:05–3 p.m. 4.5			7 2:05–3 p.m. 4.5			5 2:05–3 p.m. 5.1		
After School			After School			After School		

Thu	B	25	Fri	C	26	Saturday
Zero Hour 8-8:30 a.m.			Zero Hour 8-8:30 a.m.			
6 8:30-9:25 a.m. 5.1			Advisory 8:30–8:40 a.m.			
			4 8:45-9:40 a.m. 5.2			
7 9:30-10:25 a.m. 5.1						
			5 9:45-10:40 a.m. 5.2			
						Sunday
Advisory – 10:25-11:05 a.m.						
			Activities – 10:40-11:10 a.m.			
1 11:10 a.m.-12:05 p.m. 5.2			6 11:10 a.m.-12:05 p.m. 5.2			
						Notes
12:05-12:25 p.m. — Grade 8 Lunch			12:05-12:25 p.m. — Grade 8 Lunch			
12:25-12:40 p.m. — Grade 6 Lunch			12:25-12:40 p.m. — Grade 6 Lunch			
12:40-1 p.m. — Grade 7 Lunch			12:40-1 p.m. — Grade 7 Lunch			
2 1:05–2 p.m. 5.2			7 1:05–2 p.m. 5.2			
3 2:05–3 p.m. 5.2			1 2:05–3 p.m. 5.3			
After School			After School			

OCTOBER 2025

NOTES

	MON	TUE
	29	30
	B 6	C 7
	F 13	G 14
		Faculty and Student Picture Retakes Day
	20	B 21
	Fall Break School Closed Diwali	Diwali No quizzes or tests
	F 27	G 28



WED	THU	FRI	SAT	SUN
F 1	G 2	A 3	4	5
Yom Kippur	Yom Kippur No homework assigned No quizzes or tests End Quarter 1	Yom Kippur No quizzes or tests		
8	D 9	E 10	11	12
Late Start Alt Day				
A 15	16	17	18	19
	MS/US Conference Day, No Classes	MS/US Conference Day, No Classes	Diwali	Diwali
C 22	D 23	E 24	25	26
Diwali	Diwali			
A 29	B 30	C 31	1	2

WEEK OF SEPT 29-OCT 3, 2025

Yom Kippur																																			
Mon			D			29			Tue			E			30			Wed			F			1											
Zero Hour 8-8:30 a.m.									Zero Hour 8-8:30 a.m.																										
Advisory 8:30–8:40 a.m.									Advisory 8:30–8:40 a.m.																										
2 8:45-9:40 a.m.									5.3			7 8:45-9:40 a.m.									5.3			Late Start Wednesday											
																								5 8:55-9:50 a.m.									5.4		
3 9:45-10:40 a.m.									5.3			1 9:45-10:40 a.m.									5.4														
																								6 9:55-10:50 a.m.									5.4		
Convocation — 10:40-11:10 a.m.												Activities — 10:40-11:10 a.m.																							
																								Break — 10:50-11:10 a.m.											
4 11:10 a.m.-12:05 p.m.									5.3			2 11:10 a.m.-12:05 p.m.									5.4			7 11:10 a.m.-12:05 p.m.									5.4		
12:05-12:25 p.m. — Grade 8 Lunch												12:05-12:25 p.m. — Grade 8 Lunch												12:05-12:25 p.m. — Grade 8 Lunch											
12:25-12:40 p.m. — Grade 6 Lunch												12:25-12:40 p.m. — Grade 6 Lunch												12:25-12:40 p.m. — Grade 6 Lunch											
12:40-1 p.m. — Grade 7 Lunch												12:40-1 p.m. — Grade 7 Lunch												12:40-1 p.m. — Grade 7 Lunch											
5 1:05–2 p.m.									5.3			3 1:05–2 p.m.									5.4			1 1:05–2 p.m.									5.5		
6 2:05–3 p.m.									5.3			4 2:05–3 p.m.									5.4			2 2:05–3 p.m.									5.5		
After School												After School												After School											

End Quarter 1 Yom Kippur No homework assigned, No quizzes or tests			Yom Kippur No quizzes or tests			
Thu	G	2	Fri	A	3	Saturday
Zero Hour 8-8:30 a.m.			Zero Hour 8-8:30 a.m.			
3 8:30-9:25 a.m. 5.5			Advisory 8:30-8:40 a.m.			
			1 8:45-9:40 a.m. 6.1			
4 9:30-10:25 a.m. 5.5						
			2 9:45-10:40 a.m. 6.1			
Advisory - 10:25-11:05 a.m.						Sunday
			Activities - 10:40-11:10 a.m.			
5 11:10 a.m.-12:05 p.m. 5.5			3 11:10 a.m.-12:05 p.m. 6.1			
12:05-12:25 p.m. — Grade 8 Lunch			12:05-12:25 p.m. — Grade 8 Lunch			
12:25-12:40 p.m. — Grade 6 Lunch			12:25-12:40 p.m. — Grade 6 Lunch			
12:40-1 p.m. — Grade 7 Lunch			12:40-1 p.m. — Grade 7 Lunch			
6 1:05-2 p.m. 5.5			4 1:05-2 p.m. 6.1			Notes
7 2:05-3 p.m. 5.5			5 2:05-3 p.m. 6.1			
After School			After School			

WEEK OF OCT 6-10, 2025

Alt. Schedule											
Mon		B	6	Tue		C	7	Wed		8	
Zero Hour 8-8:30 a.m.				Zero Hour 8-8:30 a.m.							
Advisory 8:30–8:40 a.m.				Advisory 8:30–8:40 a.m.							
6		8:45-9:40 a.m.		6.1		4		8:45-9:40 a.m.		6.2	
								Late Start Wednesday			
								2			8:55-9:35 a.m.
7		9:45-10:40 a.m.		6.1		5		9:45-10:40 a.m.		6.2	
								Break – 10:20-10:30 a.m.			
Convocation — 10:40-11:10 a.m.				Activities — 10:40-11:10 a.m.				4			10:30-11:10 a.m.
1		11:10 a.m.-12:05 p.m.		6.2		6		11:10 a.m.-12:05 p.m.		6.2	
								5			11:15–11:55 a.m.
								11:55 a.m.-12:15 p.m. — Grade 8 Lunch			
12:05-12:25 p.m. — Grade 8 Lunch				12:05-12:25 p.m. — Grade 8 Lunch				12:15-12:30 p.m. — Grade 6 Lunch			
12:25-12:40 p.m. — Grade 6 Lunch				12:25-12:40 p.m. — Grade 6 Lunch				12:30-12:45 p.m. — Grade 7 Lunch			
12:40-1 p.m. — Grade 7 Lunch				12:40-1 p.m. — Grade 7 Lunch							
2		1:05–2 p.m.		6.2		7		1:05–2 p.m.		6.2	
								6			12:50–1:30 p.m.
								7			1:35–2:15 p.m.
3		2:05–3 p.m.		6.2		1		2:05–3 p.m.		6.3	
								1			2:20-3 p.m.
After School				After School				After School			

Thu	D	9	Fri	E	10	Saturday
Zero Hour 8-8:30 a.m.			Zero Hour 8-8:30 a.m.			
Advisory 8:30-8:40 a.m.			Advisory 8:30-8:40 a.m.			
2 8:45-9:40 a.m.		6.3	7 8:45-9:40 a.m.		6.3	
3 9:45-10:40 a.m.		6.3	1 9:45-10:40 a.m.		6.4	
Sunday						
Activities - 10:40-11:10 a.m.			Activities - 10:40-11:10 a.m.			
4 11:10 a.m.-12:05 p.m.		6.3	2 11:10 a.m.-12:05 p.m.		6.4	
Notes						
12:05-12:25 p.m. — Grade 8 Lunch			12:05-12:25 p.m. — Grade 8 Lunch			
12:25-12:40 p.m. — Grade 6 Lunch			12:25-12:40 p.m. — Grade 6 Lunch			
12:40-1 p.m. — Grade 7 Lunch			12:40-1 p.m. — Grade 7 Lunch			
5 1:05-2 p.m.		6.3	3 1:05-2 p.m.		6.4	
6 2:05-3 p.m.		6.3	4 2:05-3 p.m.		6.4	
After School			After School			

WEEK OF OCT 13-17, 2025

Faculty and Student, Picture Retakes Day

Mon	F	13	Tue	G	14	Wed	A	15
Zero Hour 8-8:30 a.m.			Zero Hour 8-8:30 a.m.					
Advisory 8:30–8:40 a.m.			Advisory 8:30–8:40 a.m.					
5 8:45-9:40 a.m. 6.4			3 8:45-9:40 a.m. 6.5			Late Start Wednesday		
						1 8:55-9:50 a.m. 7.1		
6 9:45-10:40 a.m. 6.4			4 9:45-10:40 a.m. 6.5					
						2 9:55-10:50 a.m. 7.1		
Convocation — 10:40-11:10 a.m.			Activities — 10:40-11:10 a.m.					
						Break — 10:50-11:10 a.m.		
7 11:10 a.m.-12:05 p.m. 6.4			5 11:10 a.m.-12:05 p.m. 6.5			3 11:10 a.m.-12:05 p.m. 7.1		
12:05-12:25 p.m. — Grade 8 Lunch			12:05-12:25 p.m. — Grade 8 Lunch			12:05-12:25 p.m. — Grade 8 Lunch		
12:25-12:40 p.m. — Grade 6 Lunch			12:25-12:40 p.m. — Grade 6 Lunch			12:25-12:40 p.m. — Grade 6 Lunch		
12:40-1 p.m. — Grade 7 Lunch			12:40-1 p.m. — Grade 7 Lunch			12:40-1 p.m. — Grade 7 Lunch		
1 1:05-2 p.m. 6.5			6 1:05-2 p.m. 6.5			4 1:05-2 p.m. 7.1		
2 2:05-3 p.m. 6.5			7 2:05-3 p.m. 6.5			5 2:05-3 p.m. 7.1		
After School			After School			After School		

[illegible]

WEEK OF OCT 20-24, 2025

Diwali
No quizzes or tests

Mon20	TueB21	WedC22
Labor Day, School Closed	Zero Hour 8-8:30 a.m.	
	Advisory 8:30-8:40 a.m.	
	6 8:45-9:40 a.m.7.1	Late Start Wednesday
		4 8:55-9:50 a.m.7.2
	7 9:45-10:40 a.m.7.1	
		5 9:55-10:50 a.m.7.2
	Activities — 10:40-11:10 a.m.	
		Break — 10:50-11:10 a.m.
	1 11:10 a.m.-12:05 p.m.7.2	6 11:10 a.m.-12:05 p.m.7.2
	12:05-12:25 p.m. — Grade 8 Lunch	12:05-12:25 p.m. — Grade 8 Lunch
	12:25-12:40 p.m. — Grade 6 Lunch	12:25-12:40 p.m. — Grade 6 Lunch
	12:40-1 p.m. — Grade 7 Lunch	12:40-1 p.m. — Grade 7 Lunch
	2 1:05-2 p.m.7.2	7 1:05-2 p.m.7.2
	3 2:05-3 p.m.7.2	1 2:05-3 p.m.7.3
	After School	After School

ThuD23	FriE24	Saturday
Zero Hour 8-8:30 a.m.	Zero Hour 8-8:30 a.m.	
2 8:30-9:25 a.m.7.3	Advisory 8:30-8:40 a.m.	
	7 8:45-9:40 a.m.7.3	
		Sunday
3 9:30-10:25 a.m.7.3		
	1 9:45-10:40 a.m.7.4	
Advisory - 10:25-11:05 a.m.		Notes
	Activities - 10:40-11:10 a.m.	
4 11:10 a.m.-12:05 p.m.7.3	2 11:10 a.m.-12:05 p.m.7.4	
12:05-12:25 p.m. — Grade 8 Lunch	12:05-12:25 p.m. — Grade 8 Lunch	
12:25-12:40 p.m. — Grade 6 Lunch	12:25-12:40 p.m. — Grade 6 Lunch	
12:40-1 p.m. — Grade 7 Lunch	12:40-1 p.m. — Grade 7 Lunch	
5 1:05-2 p.m.7.3	3 1:05-2 p.m.7.4	
6 2:05-3 p.m.7.3	4 2:05-3 p.m.7.4	
After School	After School	

WEEK OF OCT 27-31, 2025

Mon	F	27	Tue	G	28	Wed	A	29
Zero Hour 8-8:30 a.m.			Zero Hour 8-8:30 a.m.					
Advisory 8:30–8:40 a.m.			Advisory 8:30–8:40 a.m.					
5 8:45-9:40 a.m.7.4			3 8:45-9:40 a.m.7.5			Late Start Wednesday		
						1 8:55-9:50 a.m.8.1		
6 9:45-10:40 a.m.7.4			4 9:45-10:40 a.m.7.5					
						2 9:55-10:50 a.m.8.1		
Convocation — 10:40-11:10 a.m.			Activities — 10:40-11:10 a.m.					
						Break — 10:50-11:10 a.m.		
7 11:10 a.m.-12:05 p.m.7.4			5 11:10 a.m.-12:05 p.m.7.5			3 11:10 a.m.-12:05 p.m.8.1		
12:05-12:25 p.m. — Grade 8 Lunch			12:05-12:25 p.m. — Grade 8 Lunch			12:05-12:25 p.m. — Grade 8 Lunch		
12:25-12:40 p.m. — Grade 6 Lunch			12:25-12:40 p.m. — Grade 6 Lunch			12:25-12:40 p.m. — Grade 6 Lunch		
12:40-1 p.m. — Grade 7 Lunch			12:40-1 p.m. — Grade 7 Lunch			12:40-1 p.m. — Grade 7 Lunch		
1 1:05–2 p.m.7.5			6 1:05–2 p.m.7.5			4 1:05–2 p.m.8.1		
2 2:05–3 p.m.7.5			7 2:05–3 p.m.7.5			5 2:05–3 p.m.8.1		
After School			After School			After School		

Thu	B	30	Fri	C	31	Saturday
Zero Hour 8-8:30 a.m.			Zero Hour 8-8:30 a.m.			
6 8:30-9:25 a.m. 8.1			Advisory 8:30–8:40 a.m.			
			4 8:45-9:40 a.m. 8.2			
7 9:30-10:25 a.m. 8.1						
			5 9:45-10:40 a.m. 8.2			
						Sunday
Advisory – 10:25-11:05 a.m.						
			Activities – 10:40-11:10 a.m.			
1 11:10 a.m.-12:05 p.m. 8.2			6 11:10 a.m.-12:05 p.m. 8.2			Notes
12:05-12:25 p.m. — Grade 8 Lunch			12:05-12:25 p.m. — Grade 8 Lunch			
12:25-12:40 p.m. — Grade 6 Lunch			12:25-12:40 p.m. — Grade 6 Lunch			
12:40-1 p.m. — Grade 7 Lunch			12:40-1 p.m. — Grade 7 Lunch			
2 1:05–2 p.m. 8.2			7 1:05–2 p.m. 8.2			
3 2:05–3 p.m. 8.2			1 2:05–3 p.m. 8.3			
After School			After School			

NOVEMBER 2025



NOTES	MON	TUE
	27	28
	D 3	E 4
	B 10	C 11
	G 17	A 18
		Grandparents' Day Altered Schedule
	24	25
	Thanksgiving Break	Thanksgiving Break

WED	THU	FRI	SAT	SUN
29	30	31	1	2
F 5	G 6	A 7	8	9
	Quarter 2 End of Interim			
D 12	E 13	F 14	15	16
B 19	C 20	21	22	23
		Professional Development Day, No Classes		
26	27	28	29	30
Thanksgiving Break	Thanksgiving Break	Thanksgiving Break		

WEEK OF NOV 3-7, 2025

Mon	D	3	Tue	E	4	Wed	F	5
Zero Hour 8-8:30 a.m.			Zero Hour 8-8:30 a.m.					
Advisory 8:30–8:40 a.m.			Advisory 8:30–8:40 a.m.					
2 8:45-9:40 a.m. 8.3			7 8:45-9:40 a.m. 8.3			Late Start Wednesday		
						5 8:55-9:50 a.m. 8.4		
3 9:45-10:40 a.m. 8.3			1 9:45-10:40 a.m. 8.4					
						6 9:55-10:50 a.m. 8.4		
Convocation — 10:40-11:10 a.m.			Activities — 10:40-11:10 a.m.					
						Break — 10:50-11:10 a.m.		
4 11:10 a.m.-12:05 p.m. 8.3			2 11:10 a.m.-12:05 p.m. 8.4			7 11:10 a.m.-12:05 p.m. 8.4		
12:05-12:25 p.m. — Grade 8 Lunch			12:05-12:25 p.m. — Grade 8 Lunch			12:05-12:25 p.m. — Grade 8 Lunch		
12:25-12:40 p.m. — Grade 6 Lunch			12:25-12:40 p.m. — Grade 6 Lunch			12:25-12:40 p.m. — Grade 6 Lunch		
12:40-1 p.m. — Grade 7 Lunch			12:40-1 p.m. — Grade 7 Lunch			12:40-1 p.m. — Grade 7 Lunch		
5 1:05–2 p.m. 8.3			3 1:05–2 p.m. 8.4			1 1:05–2 p.m. 8.5		
6 2:05–3 p.m. 8.3			4 2:05–3 p.m. 8.4			2 2:05–3 p.m. 8.5		
After School			After School			After School		

Quarter 2 End of Interim

Thu	G	6	Fri	A	7	Saturday	
Zero Hour 8-8:30 a.m.			Zero Hour 8-8:30 a.m.				
3 8:30-9:25 a.m. 8.5			Advisory 8:30–8:40 a.m.				
			1 8:45-9:40 a.m. 9.1				
4 9:30-10:25 a.m. 8.5							
			2 9:45-10:40 a.m. 9.1				
Advisory – 10:25-11:05 a.m.						Sunday	
			Activities – 10:40-11:10 a.m.				
5 11:10 a.m.-12:05 p.m. 8.5			3 11:10 a.m.-12:05 p.m. 9.1				
12:05-12:25 p.m. — Grade 8 Lunch			12:05-12:25 p.m. — Grade 8 Lunch				Notes
12:25-12:40 p.m. — Grade 6 Lunch			12:25-12:40 p.m. — Grade 6 Lunch				
12:40-1 p.m. — Grade 7 Lunch			12:40-1 p.m. — Grade 7 Lunch				
6 1:05–2 p.m. 8.5			4 1:05–2 p.m. 9.1				
7 2:05–3 p.m. 8.5			5 2:05–3 p.m. 9.1				
After School			After School				

WEEK OF NOV 10-14, 2025

Mon	B	10	Tue	C	11	Wed	D	12
Zero Hour 8-8:30 a.m.			Zero Hour 8-8:30 a.m.					
Advisory 8:30–8:40 a.m.			Advisory 8:30–8:40 a.m.					
6 8:45-9:40 a.m. 9.1			4 8:45-9:40 a.m. 9.2			Late Start Wednesday		
						2 8:55-9:50 a.m. 9.3		
7 9:45-10:40 a.m. 9.1			5 9:45-10:40 a.m. 9.2					
						3 9:55-10:50 a.m. 9.3		
Convocation — 10:40-11:10 a.m.			Activities — 10:40-11:10 a.m.					
						Break — 10:50-11:10 a.m.		
1 11:10 a.m.-12:05 p.m. 9.2			6 11:10 a.m.-12:05 p.m. 9.2			4 11:10 a.m.-12:05 p.m. 9.3		
12:05-12:25 p.m. — Grade 8 Lunch			12:05-12:25 p.m. — Grade 8 Lunch			12:05-12:25 p.m. — Grade 8 Lunch		
12:25-12:40 p.m. — Grade 6 Lunch			12:25-12:40 p.m. — Grade 6 Lunch			12:25-12:40 p.m. — Grade 6 Lunch		
12:40-1 p.m. — Grade 7 Lunch			12:40-1 p.m. — Grade 7 Lunch			12:40-1 p.m. — Grade 7 Lunch		
2 1:05–2 p.m. 9.2			7 1:05–2 p.m. 9.2			5 1:05–2 p.m. 9.3		
3 2:05–3 p.m. 9.2			1 2:05–3 p.m. 9.3			6 2:05–3 p.m. 9.3		
After School			After School			After School		

Thu	E	13	Fri	F	14	Saturday
Zero Hour 8-8:30 a.m.			Zero Hour 8-8:30 a.m.			
7 8:30-9:25 a.m. 9.3			Advisory 8:30–8:40 a.m.			
			5 8:45-9:40 a.m. 9.4			
1 9:30-10:25 a.m. 9.4						
			6 9:45-10:40 a.m. 9.4			
Advisory – 10:25-11:05 a.m.						Sunday
			Activities – 10:40-11:10 a.m.			
2 11:10 a.m.-12:05 p.m. 9.4			7 11:10 a.m.-12:05 p.m. 9.4			
12:05-12:25 p.m. — Grade 8 Lunch			12:05-12:25 p.m. — Grade 8 Lunch			Notes
12:25-12:40 p.m. — Grade 6 Lunch			12:25-12:40 p.m. — Grade 6 Lunch			
12:40-1 p.m. — Grade 7 Lunch			12:40-1 p.m. — Grade 7 Lunch			
3 1:05–2 p.m. 9.4			1 1:05–2 p.m. 9.5			
4 2:05–3 p.m. 9.4			2 2:05–3 p.m. 9.5			
After School			After School			

WEEK OF NOV 17-21, 2025

Grandparents’ Day, **Alt. Schedule**

Mon	G	17	Tue	A	18	Wed	B	19
Zero Hour 8-8:30 a.m.			Zero Hour 8-8:30 a.m.					
Advisory 8:30–8:40 a.m.			1 8:30-9:25 a.m. 10.1					
3 8:45-9:40 a.m. 9.5						Late Start Wednesday		
						6 8:55-9:50 a.m. 10.1		
			2 9:30-10:25 a.m. 10.1					
4 9:45-10:40 a.m. 9.5								
						7 9:55-10:50 a.m. 10.1		
			Advisory — 10:30-10:55 a.m.					
Convocation — 10:40-11:10 a.m.								
			3 10:55-11:45 a.m. 10.1			Break — 10:50-11:10 a.m.		
5 11:10 a.m.-12:05 p.m. 9.5						1 11:10 a.m.-12:05 p.m. 10.2		
			11:45 a.m.-12:05 p.m. — Grade 8 Lunch					
12:05-12:25 p.m. — Grade 8 Lunch			12:05-12:20 p.m. — Grade 6 Lunch			12:05-12:25 p.m. — Grade 8 Lunch		
12:25-12:40 p.m. — Grade 6 Lunch			12:20-12:40 p.m. — Grade 7 Lunch			12:25-12:40 p.m. — Grade 6 Lunch		
12:40-1 p.m. — Grade 7 Lunch			4 12:40–1:30 p.m. 10.1			12:40-1 p.m. — Grade 7 Lunch		
6 1:05–2 p.m. 9.5						2 1:05–2 p.m. 10.2		
			5 1:35–2:25 p.m. 10.1					
7 2:05–3 p.m. 9.5						3 2:05–3 p.m. 10.2		
			Grandparents’ Day 2:25–3 p.m.					
After School			After School			After School		

Thu	C	20	Fri	21	Saturday
Zero Hour 8-8:30 a.m.			Professional Development Day, No classes		
4	8:30-9:25 a.m.	10.2	Thanksgiving break begins		
5	9:30-10:25 a.m.	10.2			
Advisory - 10:25-11:05 a.m.					Sunday
6	11:10 a.m.-12:05 p.m.	10.2			
12:05-12:25 p.m. — Grade 8 Lunch					Notes
12:25-12:40 p.m. — Grade 6 Lunch					
12:40-1 p.m. — Grade 7 Lunch					
7	1:05-2 p.m.	10.2			
1	2:05-3 p.m.	10.3			
After School					

DECEMBER 2025



NOTES	MON	TUE
	D 1	E 2
	Classes Resume After Thanksgiving Break	
	B 8	C 9
	G 15	16
	Middle School Regular School Day (G Day)	Middle School Regular School Day (Full Rotation) End Quarter 2/Semester 1
	22	23
	Winter Break	Winter Break
	29	30
	Winter Break	Winter Break

WED	THU	FRI	SAT	SUN
F 3	G 4	A 5	6	7
D 10	E 11	F 12	13	14
17	18	19	20	21
Reading Day for Middle School, No Classes	Middle School Exams	Middle School Exams		
24	25	26	27	28
Winter Break Christmas	Winter Break	Winter Break		
31	1	2	3	4
Winter Break New Year's Day	Winter Break	Winter Break		

WEEK OF DEC 1-5, 2025

Mon	D	1	Tue	E	2	Wed	F	3
Zero Hour 8-8:30 a.m.			Zero Hour 8-8:30 a.m.					
Advisory 8:30–8:40 a.m.			Advisory 8:30–8:40 a.m.					
2 8:45-9:40 a.m. 10.3			7 8:45-9:40 a.m. 10.3			Late Start Wednesday		
						5 8:55-9:50 a.m. 10.4		
3 9:45-10:40 a.m. 10.3			1 9:45-10:40 a.m. 10.4					
						6 9:55-10:50 a.m. 10.4		
Convocation — 10:40-11:10 a.m.			Activities — 10:40-11:10 a.m.					
						Break — 10:50-11:10 a.m.		
4 11:10 a.m.-12:05 p.m. 10.3			2 11:10 a.m.-12:05 p.m. 10.4			7 11:10 a.m.-12:05 p.m. 10.4		
12:05-12:25 p.m. — Grade 8 Lunch			12:05-12:25 p.m. — Grade 8 Lunch			12:05-12:25 p.m. — Grade 8 Lunch		
12:25-12:40 p.m. — Grade 6 Lunch			12:25-12:40 p.m. — Grade 6 Lunch			12:25-12:40 p.m. — Grade 6 Lunch		
12:40-1 p.m. — Grade 7 Lunch			12:40-1 p.m. — Grade 7 Lunch			12:40-1 p.m. — Grade 7 Lunch		
5 1:05–2 p.m. 10.3			3 1:05–2 p.m. 10.4			1 1:05–2 p.m. 10.5		
6 2:05–3 p.m. 10.3			4 2:05–3 p.m. 10.4			2 2:05–3 p.m. 10.5		
After School			After School			After School		

Thu	G	4	Fri	A	5	Saturday
Zero Hour 8-8:30 a.m.			Zero Hour 8-8:30 a.m.			
3 8:30-9:25 a.m. 10.5			Advisory 8:30–8:40 a.m.			
			1 8:45-9:40 a.m. 11.1			
4 9:30-10:25 a.m. 10.5						
			2 9:45-10:40 a.m. 11.1			
						Sunday
Advisory – 10:25-11:05 a.m.						
			Activities – 10:40-11:10 a.m.			
5 11:10 a.m.-12:05 p.m. 10.5			3 11:10 a.m.-12:05 p.m. 11.1			
						Notes
12:05-12:25 p.m. — Grade 8 Lunch			12:05-12:25 p.m. — Grade 8 Lunch			
12:25-12:40 p.m. — Grade 6 Lunch			12:25-12:40 p.m. — Grade 6 Lunch			
12:40-1 p.m. — Grade 7 Lunch			12:40-1 p.m. — Grade 7 Lunch			
6 1:05–2 p.m. 10.5			4 1:05–2 p.m. 11.1			
7 2:05–3 p.m. 10.5			5 2:05–3 p.m. 11.1			
After School			After School			

WEEK OF DEC 8-12, 2025

Mon	B	8	Tue	C	9	Wed	D	10
Zero Hour 8-8:30 a.m.			Zero Hour 8-8:30 a.m.					
Advisory 8:30–8:40 a.m.			Advisory 8:30–8:40 a.m.					
6 8:45-9:40 a.m. 11.1			4 8:45-9:40 a.m. 11.2			Late Start Wednesday		
						2 8:55-9:50 a.m. 11.3		
7 9:45-10:40 a.m. 11.1			5 9:45-10:40 a.m. 11.2					
						3 9:55-10:50 a.m. 11.3		
Convocation — 10:40-11:10 a.m.			Activities — 10:40-11:10 a.m.					
						Break — 10:50-11:10 a.m.		
1 11:10 a.m.-12:05 p.m. 11.2			6 11:10 a.m.-12:05 p.m. 11.2			4 11:10 a.m.-12:05 p.m. 11.3		
12:05-12:25 p.m. — Grade 8 Lunch			12:05-12:25 p.m. — Grade 8 Lunch			12:05-12:25 p.m. — Grade 8 Lunch		
12:25-12:40 p.m. — Grade 6 Lunch			12:25-12:40 p.m. — Grade 6 Lunch			12:25-12:40 p.m. — Grade 6 Lunch		
12:40-1 p.m. — Grade 7 Lunch			12:40-1 p.m. — Grade 7 Lunch			12:40-1 p.m. — Grade 7 Lunch		
2 1:05-2 p.m. 11.2			7 1:05-2 p.m. 11.2			5 1:05-2 p.m. 11.3		
3 2:05-3 p.m. 11.2			1 2:05-3 p.m. 11.3			6 2:05-3 p.m. 11.3		
After School			After School			After School		

Thu	E	11	Fri	F	12	Saturday
Zero Hour 8-8:30 a.m.			Zero Hour 8-8:30 a.m.			
7 8:30-9:25 a.m. 11.3			Advisory 8:30–8:40 a.m.			
			5 8:45-9:40 a.m. 11.4			
1 9:30-10:25 a.m. 11.4						
			6 9:45-10:40 a.m. 11.4			
Advisory – 10:25-11:05 a.m.						Sunday
			Activities – 10:40-11:10 a.m.			
2 11:10 a.m.-12:05 p.m. 11.4			7 11:10 a.m.-12:05 p.m. 11.4			
12:05-12:25 p.m. — Grade 8 Lunch			12:05-12:25 p.m. — Grade 8 Lunch			
12:25-12:40 p.m. — Grade 6 Lunch			12:25-12:40 p.m. — Grade 6 Lunch			
12:40-1 p.m. — Grade 7 Lunch			12:40-1 p.m. — Grade 7 Lunch			Notes
3 1:05–2 p.m. 11.4			1 1:05–2 p.m. 11.5			
4 2:05–3 p.m. 11.4			2 2:05–3 p.m. 11.5			
After School			After School			

WEEK OF DEC 15-19, 2025

End Quarter 2

Alt. Schedule

Mon	G	15	Tue	16	Wed	17
Zero Hour 8-8:30 a.m.			Zero Hour 8-8:30 a.m.		Reading Day, No Classes	
Advisory 8:30–8:40 a.m.			Advisory 8:30–8:50 a.m.			
3 8:45-9:40 a.m. 11.5			1 8:55-9:35 a.m.			
			2 9:40–10:20 a.m.			
4 9:45-10:40 a.m. 11.5						
			Break 10:20-10:30 a.m.			
			3 10:30-11:10 a.m.			
Convocation — 10:40-11:10 a.m.						
5 11:10 a.m.-12:05 p.m. 11.5						
			4 11:15-11:55 a.m.			
12:05-12:25 p.m. — Grade 8 Lunch			Lunch — Gr.7 (11:55-12:15), Gr.6 (12:15-12:30), Gr.8 (12:30-12:45)			
12:25-12:40 p.m. — Grade 6 Lunch			5 12:50-1:30 p.m.			
12:40-1 p.m. — Grade 7 Lunch						
6 1:05–2 p.m. 11.5						
			6 1:35–2:15 p.m.			
7 2:05–3 p.m. 11.5						
			7 2:20–3 p.m.			
After School			After School			

[illegible]



MISSION STATEMENT

The Bolles School prepares students for college and life by inspiring excellence, courage, integrity and compassion in an academic community dedicated to nurturing mind, body and soul.

THE BOLLES WAY

Pursuing excellence through courage, integrity and compassion.

HONOR CODE

**I will maintain my self-respect and respect others.
I will not lie, cheat, steal or tolerate those who do.**

CORE VALUES

EXCELLENCE | COURAGE | INTEGRITY | COMPASSION

ATHLETIC MOTTO

HUMBLE IN VICTORY, GRACIOUS IN DEFEAT