

Construction Plans

For

Irmo Elementary

Playground Drainage Improvements

Prepared For
District 5 of Lexington and Richland Counties
Contact: Steve Kane
Address: 1020 Dutch Fork Rd. Irmo, SC 29063
Telephone: (803) 476-8151
Email: skane@lexrich5.org

by:
Chao & Associates, Inc.
Consulting Engineers

C & A #: 390590C-21



Chao & Associates, Inc.
 Civil - Structural - Survey
 7 Clusters Court
 Columbia, SC 29210
 Voice: (803) 772-8420
 Fax: (803) 772-9120
 Email: consult@chaoinc.com

DRAWING INDEX

- C1.0 - Existing Conditions / Demolition Plan
- C2.0 - Drainage & Paving Improvements
- C3.0 - Grading & Storm Drainage Plan
- C3.1 - Storm Drainage Profiles
- C3.2 - Erosion Control Plan
- C4.0 - Miscellaneous Details
- C4.1 - Miscellaneous Details
- C4.2 - Miscellaneous Details

Owner
 School District 5 of Richland
 and Lexington Counties
 Steve Kane
 1020 Dutch Fork Rd.
 Irmo, SC 29063

Location Map

Location Map
 Not to Scale

7401 Gibbes St, Irmo, SC 29063
 TMS 001920-04-001



State of South Carolina
 Scale: 1" = 30 Miles

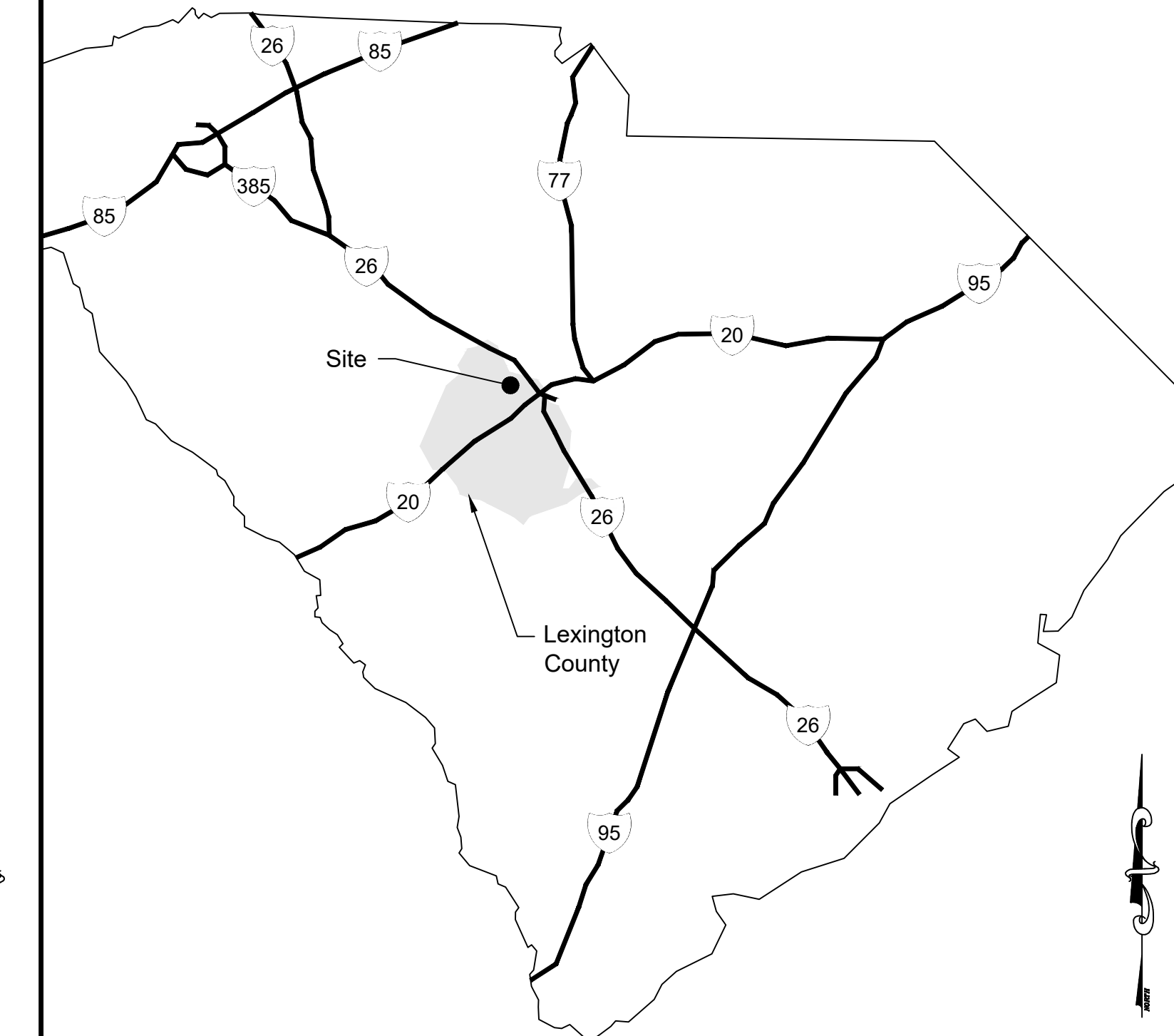

LEGEND	
	Fire hydrant
	Junction box (JB)
	Drop inlet (DI)
	Yard inlet (YI)
	Existing storm drain pipe
	Concrete sidewalk
	Roof Drain
	Directional Runoff
	Saw Cut and Replace
	Silt Fence
	Proposed RCP

Note: All runoff to flow to storm drainage inlets

CP NAIL & CAP
N:818927.01
E:1944054.32
EL.=336.74 MSL

- Construction notes:**
- Topographic survey performed by Chao and Associates. Survey is referenced horizontally to SCSPCS and the vertical datum is NAVD88.
 - Contractor shall verify all existing field conditions and utilities prior to beginning work.
 - Provide silt fence and/or other erosion control devices, as may be required, to control soil erosion during construction. All disturbed areas shall be cleaned, graded and stabilized with grassing immediately after completion of construction in the area.
 - Prior to any digging the contractor is required to contact 811 72 hrs prior to commencing construction.
 - Contractor to repair any damage done to existing pavement, fencing, etc... due to construction entirely at his/her expense.
 - Contractor must take necessary action to minimize the tracking of mud onto the paved roadway from construction areas. Contractor to daily remove mud/silt from pavement as required.
 - All materials, installation, and workmanship shall meet or exceed the minimum standards of Lexington County.
 - All excavation is unclassified. Excess material is to be removed from the site and disposed of in a legal manner.
 - New concrete shall be installed flush with the existing concrete and slope of new concrete shall not exceed 2%.

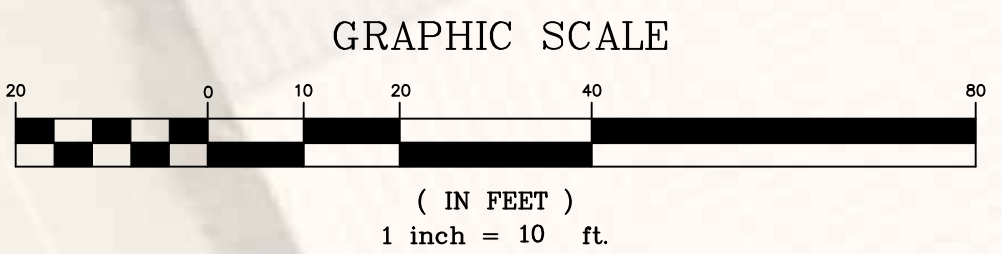

The utilities are shown for the contractor's convenience only. There may be other utilities not shown on these Plans. The Engineer assumes no responsibility to verify the locations shown and it shall be the contractor's responsibility to verify the locations of all utilities within the limits of the work. All damage made to existing utilities by the contractor shall be the sole responsibility of the contractor.

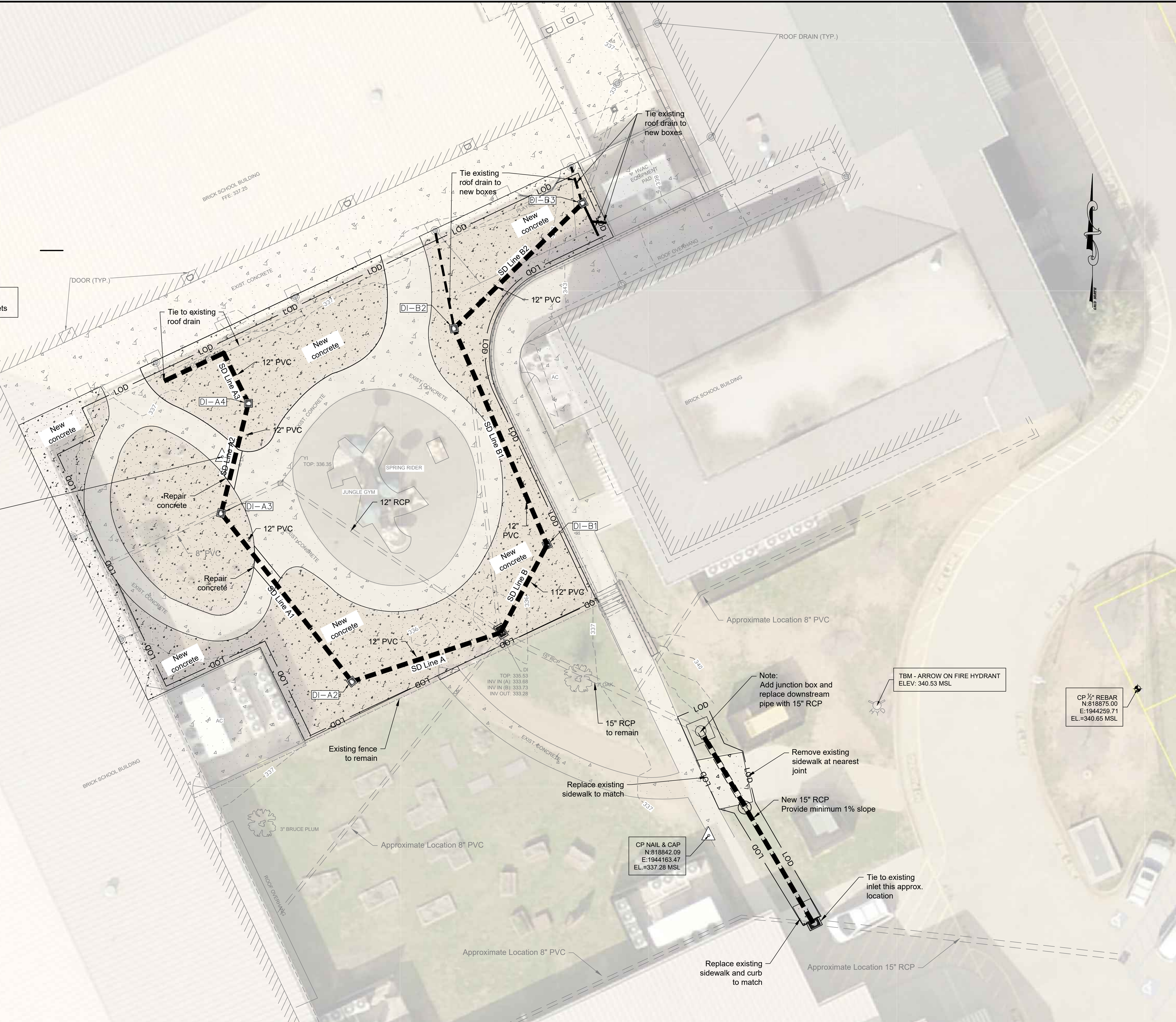

CP NAIL & CAP
N:818842.09
E:1944163.47
EL.=337.28 MSL

TBM - ARROW ON FIRE HYDRANT
ELEV: 340.53 MSL

CP 1/2\"/>



Chao & Associates, Inc.
Civil - Structural - Survey
7 Clusters Court
Columbia, SC 29210
Voice: (803) 772-8420
Fax: (803) 772-9120
Email: consult@chaoinc.com

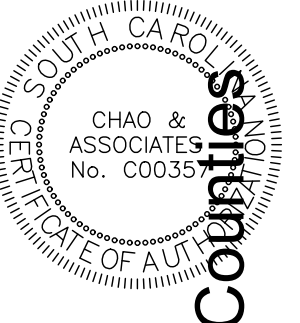

Drainage & Paving Improvements
Irmo Elementary
Playground Drainage Improvements
District 5 of Lexington and Richland Counties
Irmo, SC

Drawn: JKN Checked: GAL
Revised:
Project No.: 390590C
File: 390590C R1.dwg

C2.0
Sheet Number
January 11, 2024
Date

LEGEND	
	Fire hydrant
	Junction box (JB)
	Drop inlet (DI)
	Yard inlet (YI)
	Existing storm drain pipe
	Concrete sidewalk
	Roof Drain
	Directional Runoff
	Saw Cut and Replace
	Silt Fence
	Proposed RCP

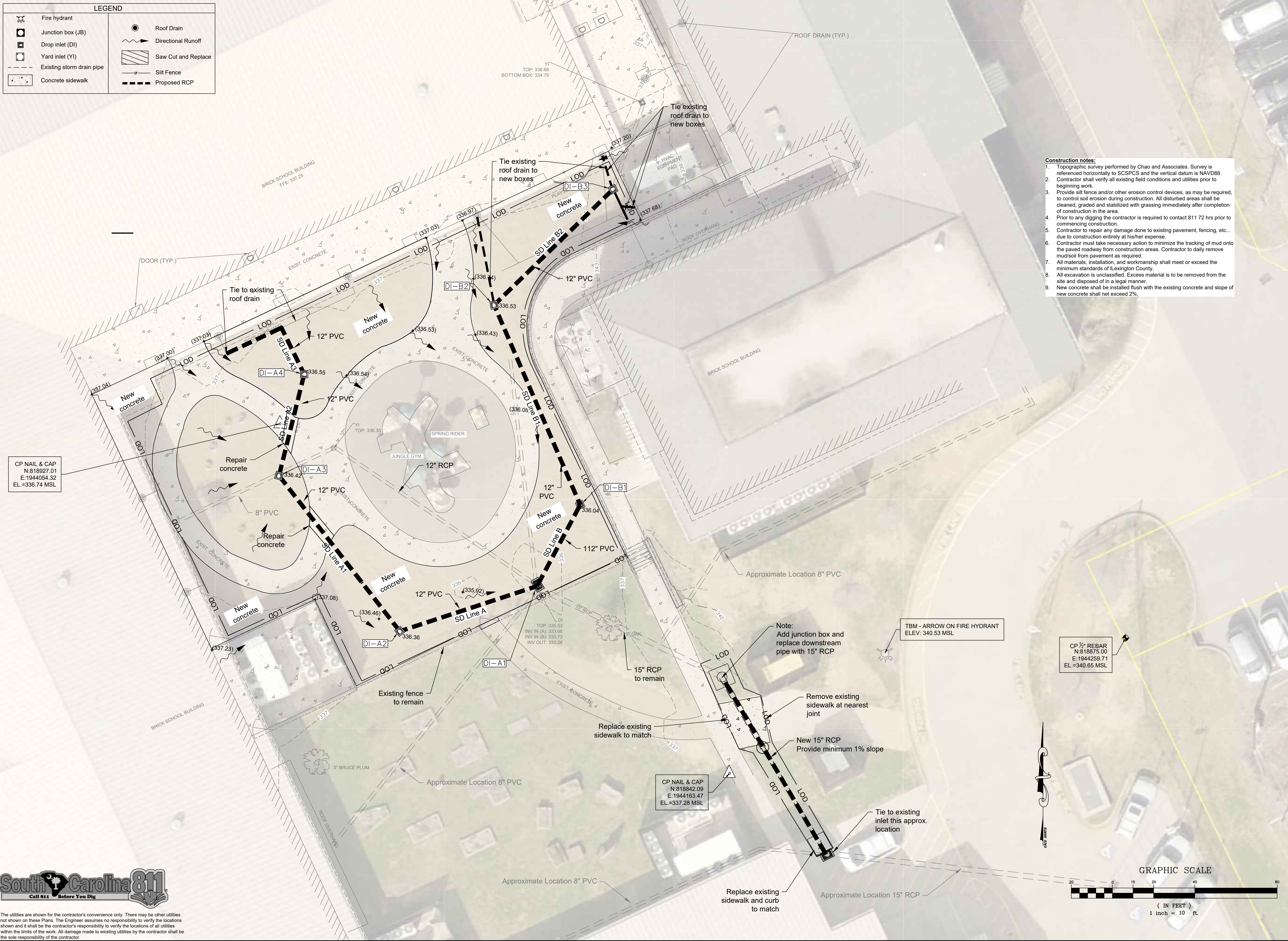

- Construction notes:**
1. Topographic survey performed by Chao and Associates. Survey is referenced horizontally to SCSPCS and the vertical datum is NAVD88.
 2. Contractor shall verify all existing field conditions and utilities prior to beginning work.
 3. Provide silt fence and/or other erosion control devices, as may be required, to control soil erosion during construction. All disturbed areas shall be cleaned, graded and stabilized with grassing immediately after completion of construction in the area.
 4. Prior to any digging the contractor is required to contact 811 72 hrs prior to commencing construction.
 5. Contractor to repair any damage done to existing pavement, fencing, etc... due to construction entirely at his/her expense.
 6. Contractor must take necessary action to minimize the tracking of mud onto the paved roadway from construction areas. Contractor to daily remove mud/soil from pavement as required.
 7. All materials, installation, and workmanship shall meet or exceed the minimum standards of Lexington County.
 8. All excavation is unclassified. Excess material is to be removed from the site and disposed of in a legal manner.
 9. New concrete shall be installed flush with the existing concrete and slope of new concrete shall not exceed 2%.

CP NAIL & CAP
N:818927.01
E:1944054.32
EL.=336.74 MSL

CP NAIL & CAP
N:818842.09
E:1944163.47
EL.=337.28 MSL

CP 1/2" REBAR
N:818875.00
E:1944259.71
EL.=340.65 MSL

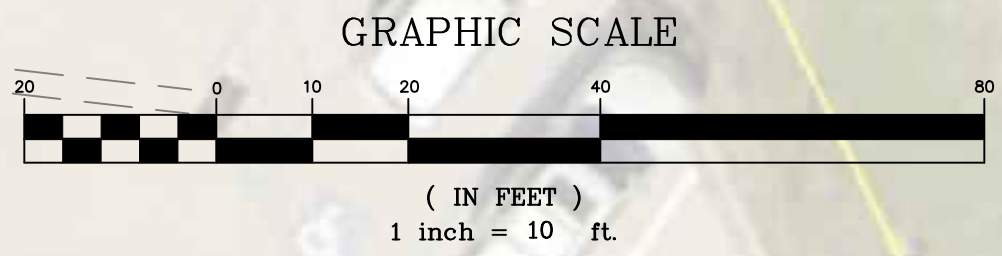

The utilities are shown for the contractor's convenience only. There may be other utilities not shown on these Plans. The Engineer assumes no responsibility to verify the locations shown and it shall be the contractor's responsibility to verify the locations of all utilities within the limits of the work. All damage made to existing utilities by the contractor shall be the sole responsibility of the contractor.

THESE DOCUMENTS AND THE INFORMATION CONTAINED HEREIN ARE THE PROPERTY OF CHAO & ASSOCIATES, INC. AND MAY NOT BE USED FOR ANY PURPOSE WITHOUT THE WRITTEN PERMISSION OF CHAO & ASSOCIATES, INC.



Chao & Associates, Inc.
Civil - Structural - Survey
7 Clusters Court
Columbia, SC 29210
Voice: (803) 772-8420
Fax: (803) 772-9120
Email: consult@chaoinc.com

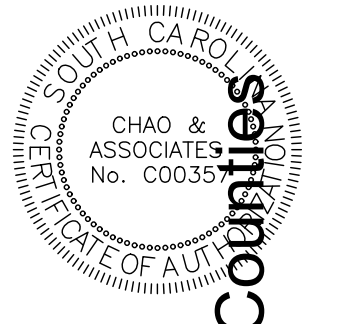

Grading & Storm Drainage Plan
Irmo Elementary
Playground Drainage Improvements
District 5 of Lexington and Richland Counties
Irmo, SC

Drawn: JKN Checked: GAL
Revised:
Project No.: 390590C
File: 390590C R1.dwg

C3.0
Sheet Number
January 11, 2024
Date

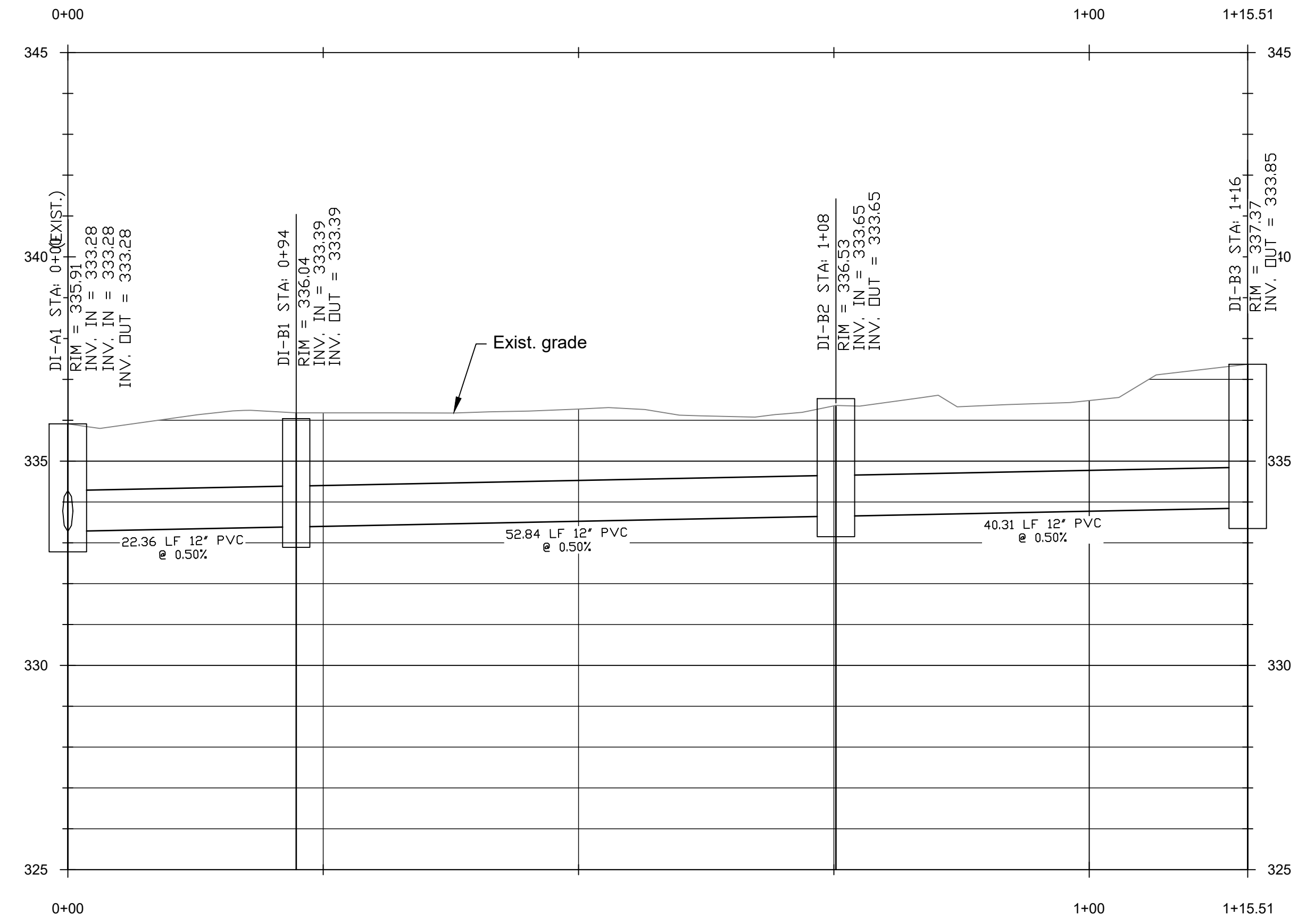
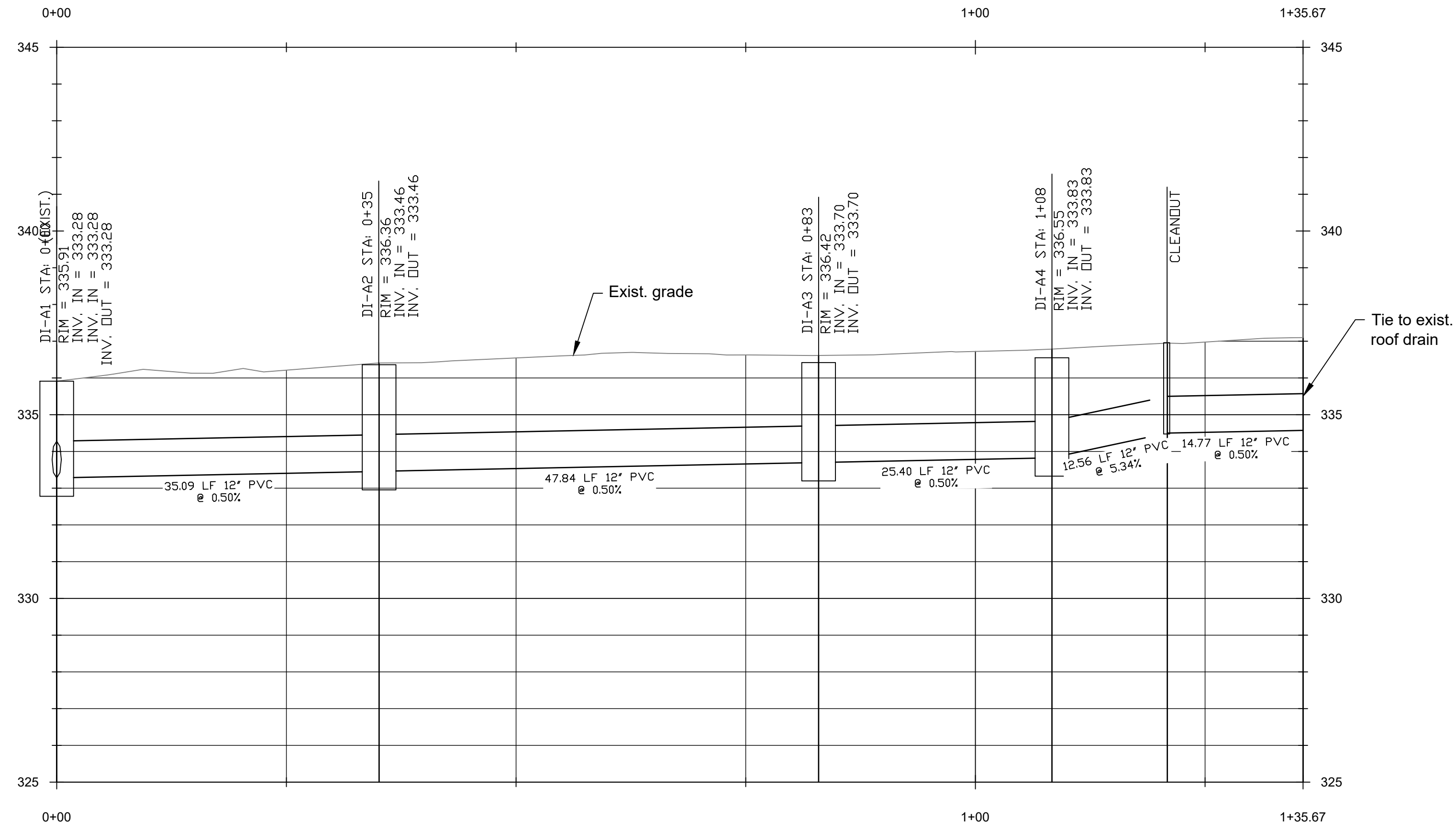

Chao & Associates, Inc.

Civil - Structural - Survey
 7 Clusters Court
 Columbia, SC 29210
 Voice: (803) 772-8420
 Fax: (803) 772-9120
 Email: consult@chaoinc.com

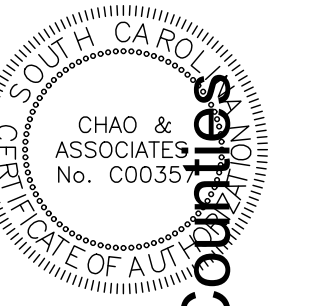

Storm Drainage Profiles
 Irmo Elementary
 Playground Drainage Improvements
 District 5 of Lexington and Richland Counties
 Irmo, SC

Drawn: JKN
 Checked: GAL

Revised:

File: 390590C R1.dwg Project No.: 390590C

C3.1
 Sheet Number
 January 11, 2024
 Date

LEGEND	
	Fire hydrant
	Junction box (JB)
	Drop inlet (DI)
	Yard inlet (YI)
	Existing storm drain pipe
	Concrete sidewalk
	Roof Drain
	Directional Runoff
	Saw Cut and Replace
	Silt Fence
	Proposed RCP

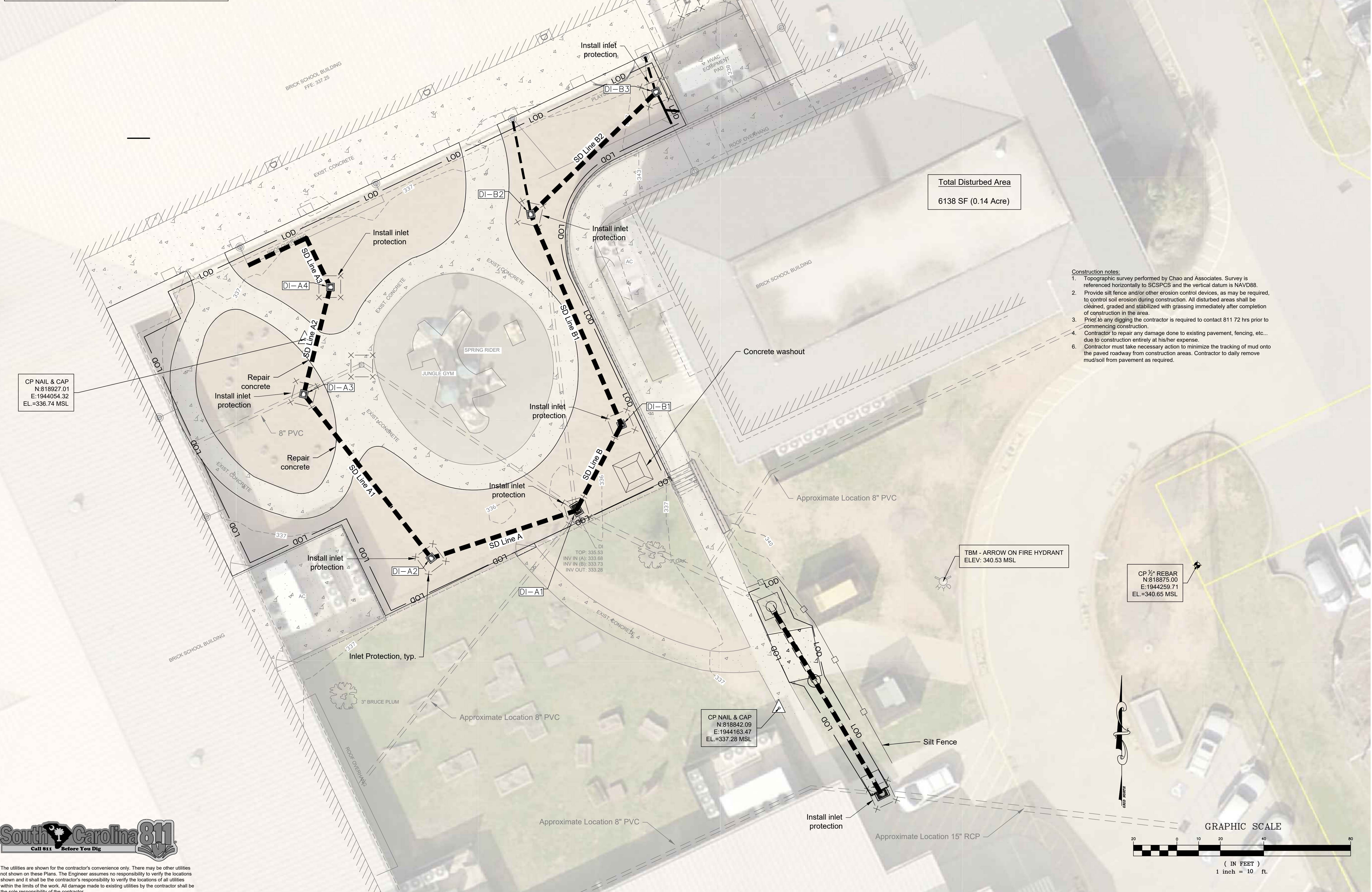

Total Disturbed Area
6138 SF (0.14 Acre)

- Construction notes:
1. Topographic survey performed by Chao and Associates. Survey is referenced horizontally to SCSPCS and the vertical datum is NAVD88.
 2. Provide silt fence and/or other erosion control devices, as may be required, to control soil erosion during construction. All disturbed areas shall be cleaned, graded and stabilized with grassing immediately after completion of construction in the area.
 3. Prior to any digging the contractor is required to contact 811 72 hrs prior to commencing construction.
 4. Contractor to repair any damage done to existing pavement, fencing, etc... due to construction entirely at his/her expense.
 5. Contractor must take necessary action to minimize the tracking of mud onto the paved roadway from construction areas. Contractor to daily remove mud/soil from pavement as required.



Chao & Associates, Inc.
Civil - Structural - Survey
7 Clusters Court
Columbia, SC 29210
Voice: (803) 772-8420
Fax: (803) 772-9120
Email: consult@chaoinc.com

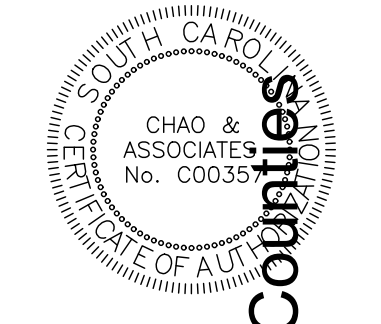

Erosion Control Plan
Irmo Elementary
Playground Drainage Improvements
District 5 of Lexington and Richland Counties
Irmo, SC

Drawn: JKN Checked: GAL
Revised:
Project No.: 390590C
File: 390590C R1.dwg



The utilities are shown for the contractor's convenience only. There may be other utilities not shown on these Plans. The Engineer assumes no responsibility to verify the locations shown and it shall be the contractor's responsibility to verify the locations of all utilities within the limits of the work. All damage made to existing utilities by the contractor shall be the sole responsibility of the contractor.

Construction Notes:

- Boundary and topographic information provided by Chao and Associates, Inc.
- Proposed contours & proposed spot elevations represent finished grade. Contractor shall establish all finished grades.
- All elevations are referenced to mean sea level (MSL) datum.
- Contractor is to coordinate with school to identify existing utilities. Contractor shall verify all existing field conditions and utilities prior to beginning work and notify the engineer if any differing site conditions are noted.
- Contractor is required to contact Palmetto Utility Protection Service (811) three days prior to any digging or commencing construction.
- Provide silt fence and other erosion control devices, as may be required, to control soil erosion during construction. All disturbed areas shall be cleaned, graded and stabilized with grassing immediately after completion of construction in the area.
- Hydroseed shall be installed in all areas disturbed by construction that are not intended to be covered by impervious material, unless otherwise indicated.
- All areas to be seeded, sodded, or landscaped shall be brought to finish grade using minimum of 4" of topsoil. Contractor shall furnish additional topsoil as required to achieve minimum depth.
- If necessary, slopes which exceed (8) vertical feet or 3:1 slopes should be stabilized with an approved turf reinforcing mat in addition to hydroseeding. It may be necessary to install temporary slope drains during construction. Temporary berms may be needed daily until slope is brought to grade.
- Contractor shall take necessary action to minimize the tracking of mud onto the paved roadway from construction areas. Contractor to daily remove mud/soil from pavement as required.
- All erosion control devices shall be properly maintained during all phases of construction until the completion of all construction activities and all disturbed areas have been stabilized. Additional control devices may be required during construction in order to control erosion and/or offsite sedimentation. All temporary control devices shall be removed only after construction is complete and the site is stabilized to the satisfaction of Richland County.
- Contractor shall abide by all provisions of the applicable county storm drainage and erosion control ordinances as well as the South Carolina Sediment Reduction Act.
- Contractor to clear existing culverts/pipes, catch basins and ditches along frontage and downstream as necessary to achieve positive drainage.
- Contractor to saw cut existing asphalt for smooth joint not aligned with wheel path.

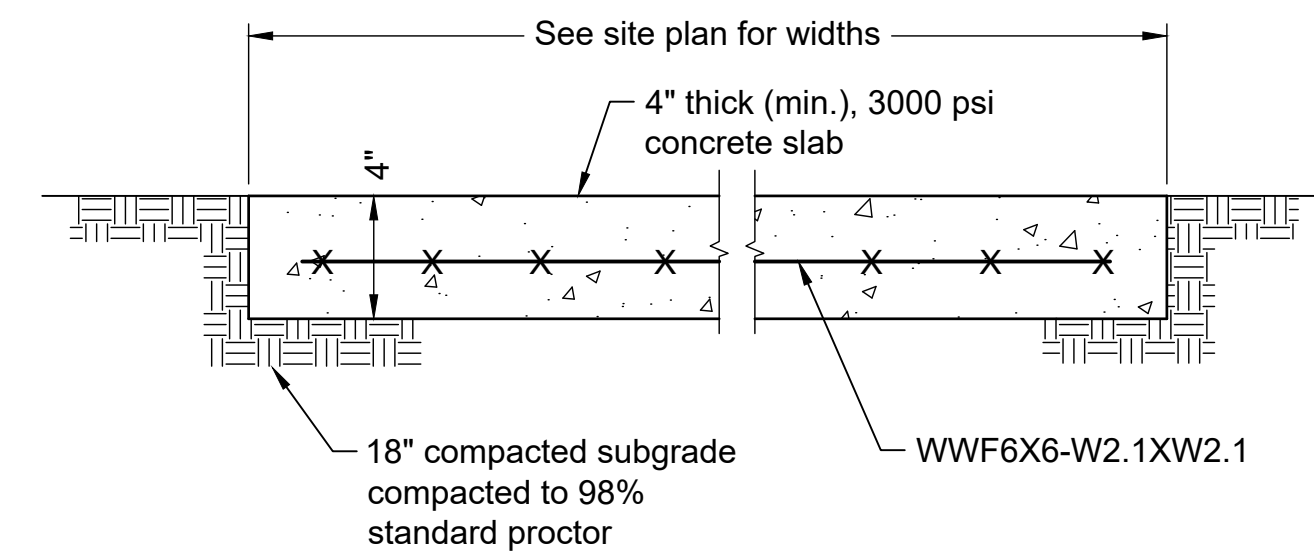

Typical Concrete Sidewalk Section
Not to Scale

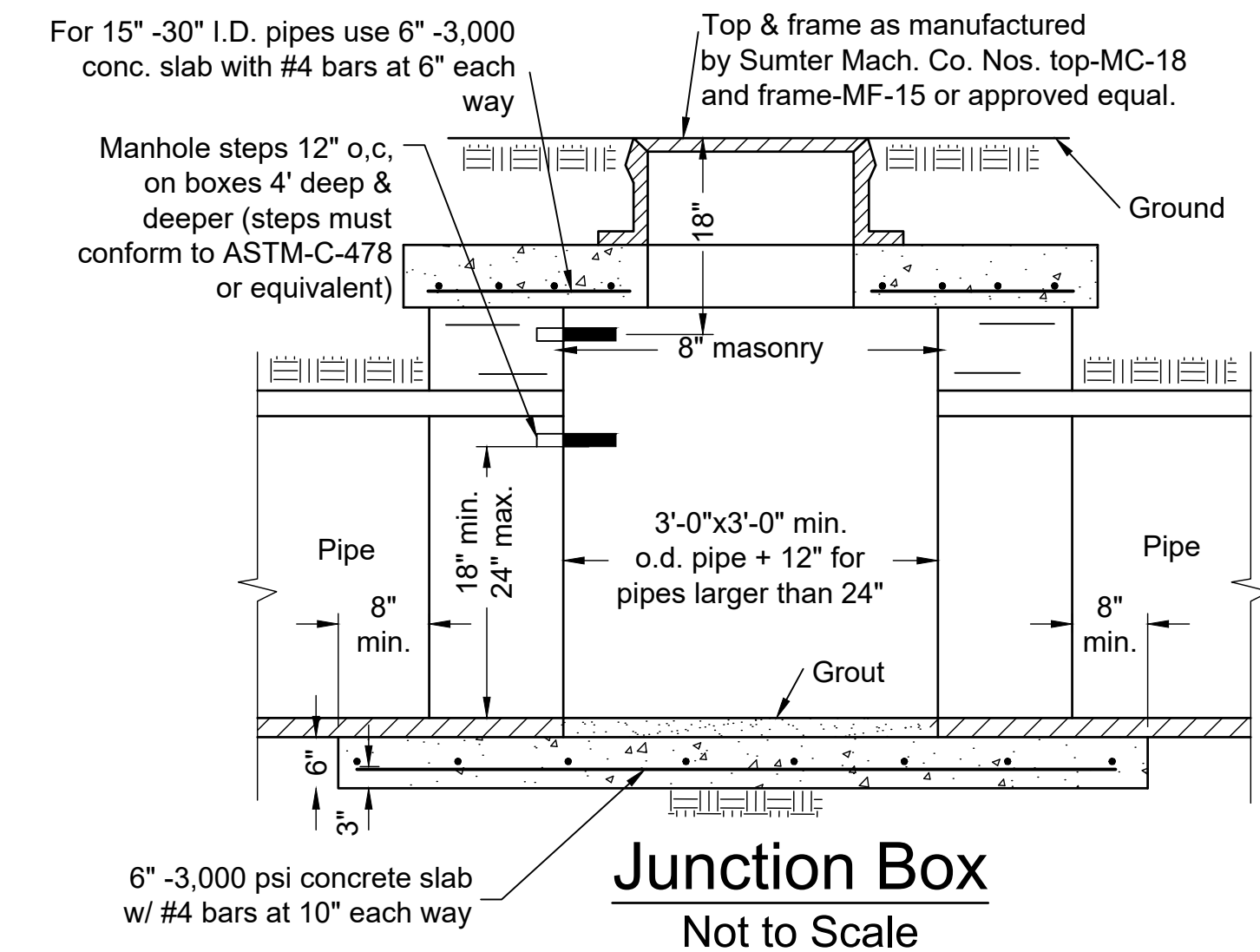

Junction Box
Not to Scale

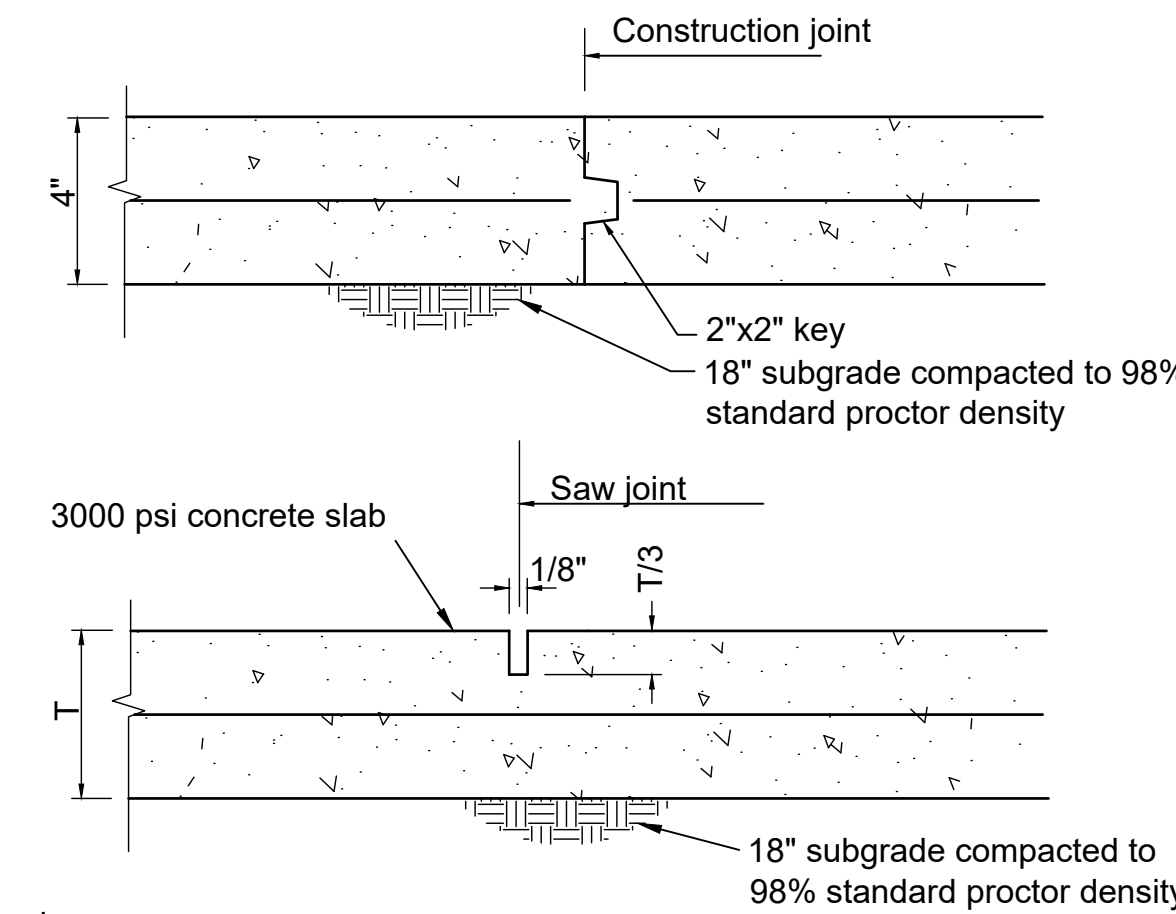

Control Joint Details
Not to Scale

Note:
See site plan
for location &
type of joints.

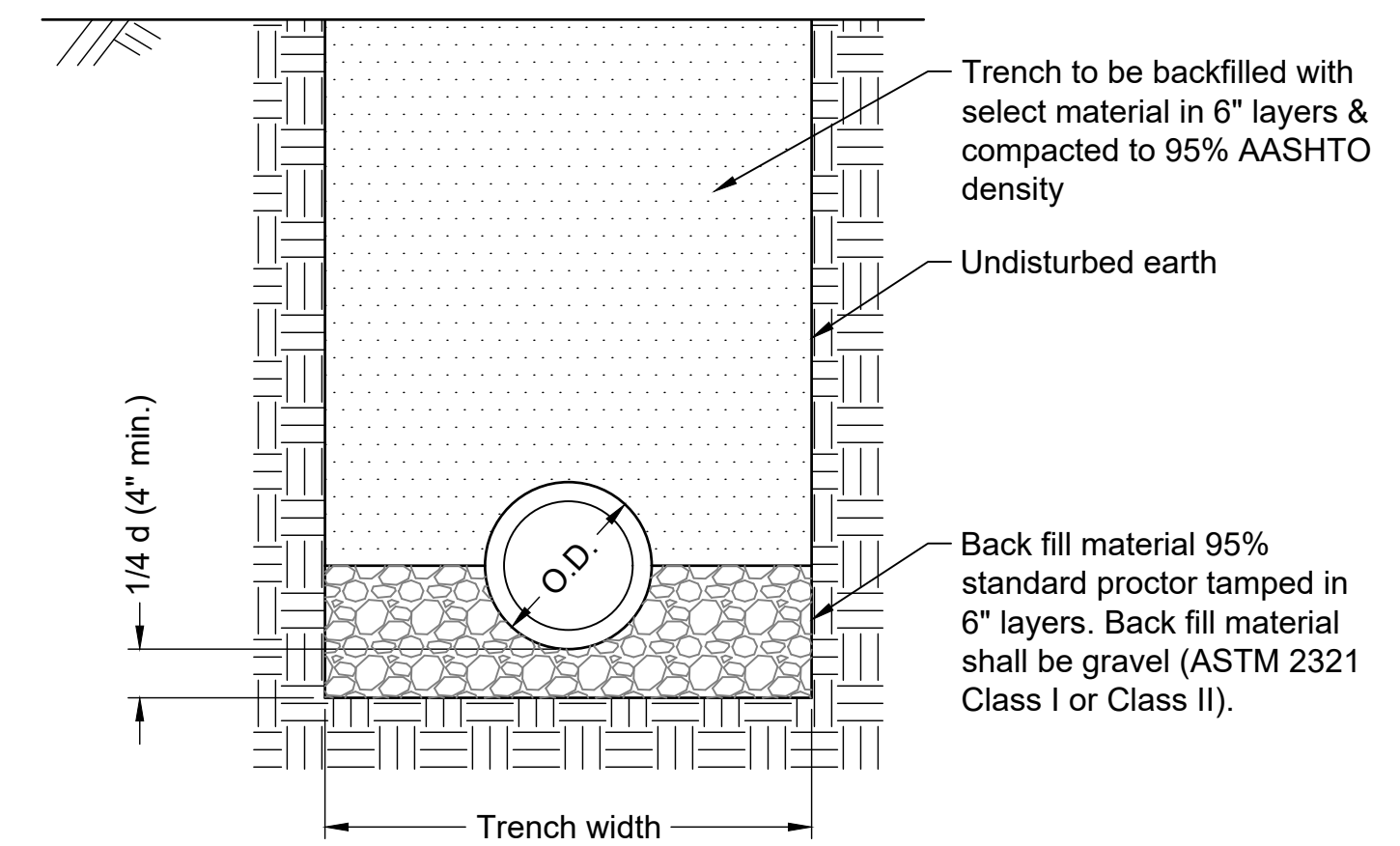

Pipe size I.D.	6" thru 10"	12"	15"	18"	21"	24"
Trench width*	2'-6"	2'-8"	2'-10"	3'-8"	3'-8"	4'-0"
Trench width with bracing	3'-2"	3'-4"	3'-6"	3'-10"	4'-4"	4'-8"

* Trench width dimension are from the inside of the sheeting and bracing and at and below the top of the pipe.

Standard Bedding Details
for PVC Pipe
Not to Scale



Chao & Associates, Inc.
Civil - Structural - Survey
7 Clusters Court
Columbia, SC 29210
Voice: (803) 772-8420
Fax: (803) 772-9120
Email: consult@chaoinc.com

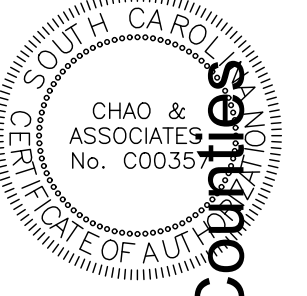

Miscellaneous Details
Irmo Elementary
Playground Drainage Improvements
District 5 of Lexington and Richland Counties
Irmo, SC

Drawn: JKN
Checked: GAL
Revised:
Project No.: 390590C
File: 390590C R1.dwg

C4.0
Sheet Number
January 11, 2024
Date

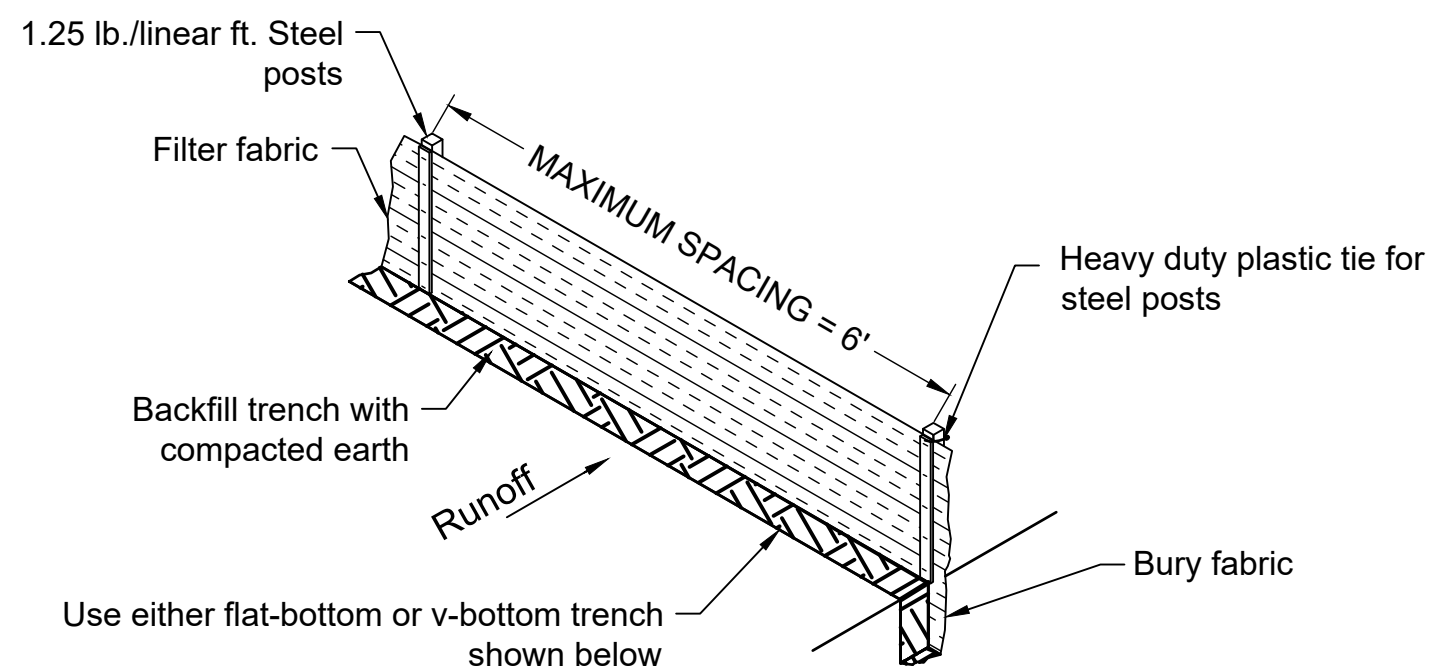

Silt Fence Installation

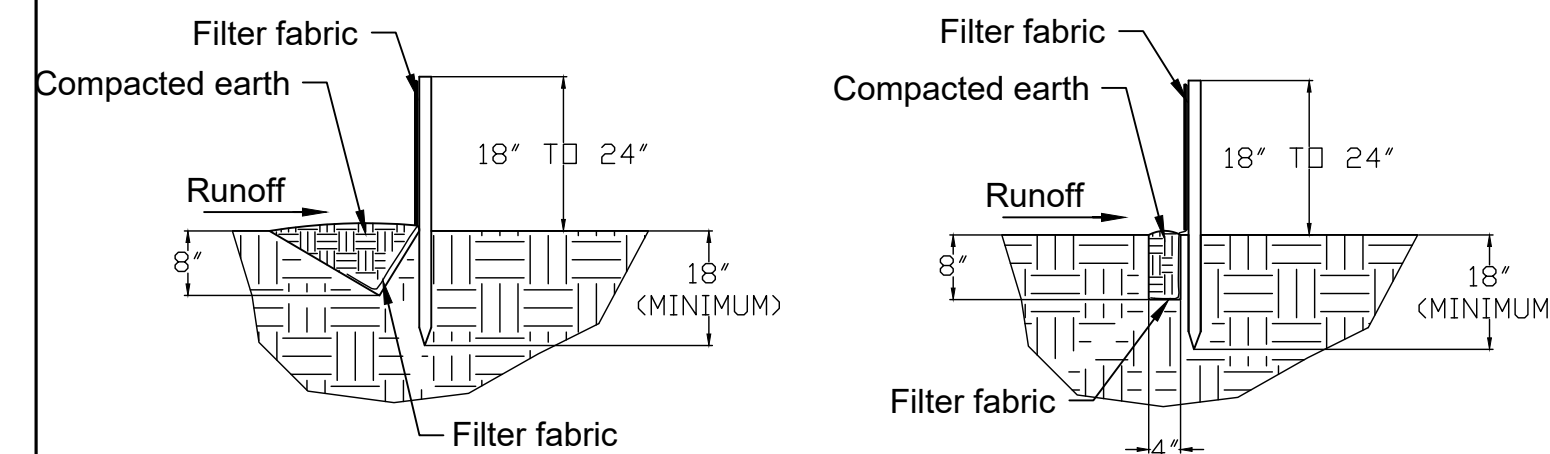

V-shaped Trench Detail

Flat-bottom Trench Detail

Note:
contractor shall remove sediment accumulated along the fence when it reaches 1/3 the height of the fence

Silt Fence Construction

Not To Scale

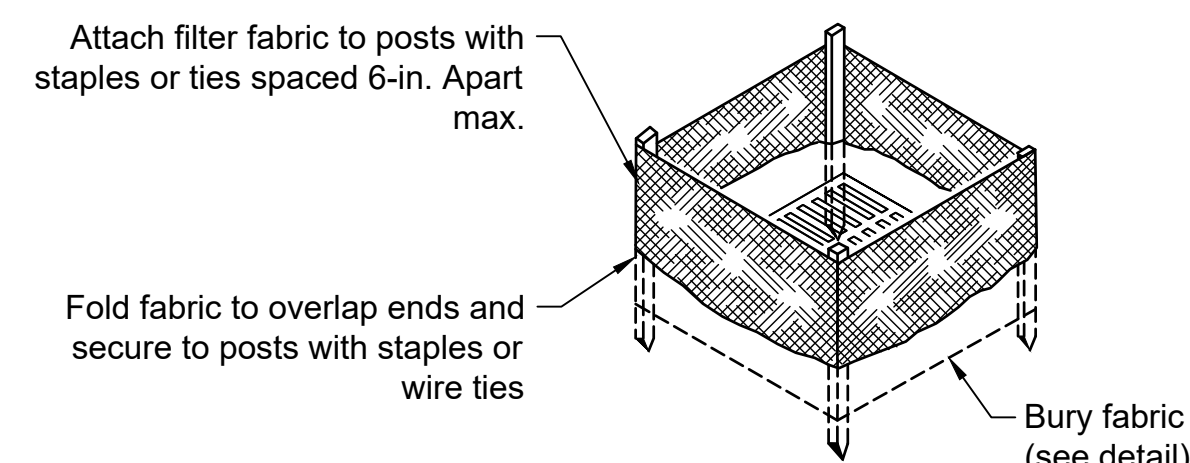

Filter Fabric Installation Detail

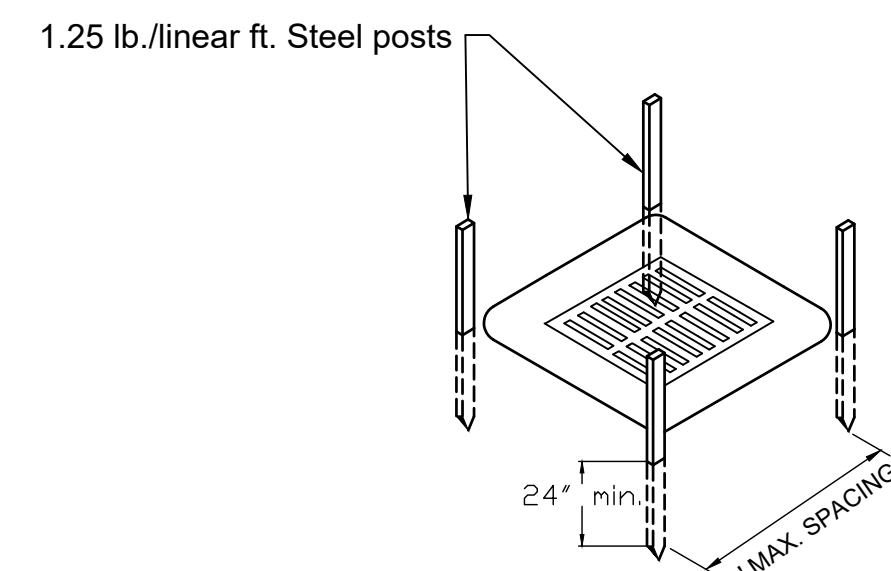

Post Installation Detail

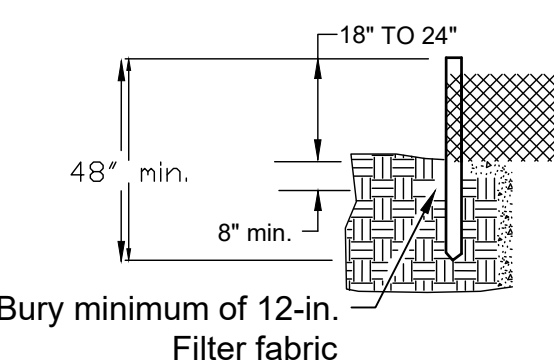

Filter Fabric Burial Detail

Note:
Contractor shall remove sediment accumulated along the fence when it reaches 1/3 the height of the fence

Filter Fabric Inlet Protection Detail

Not To Scale

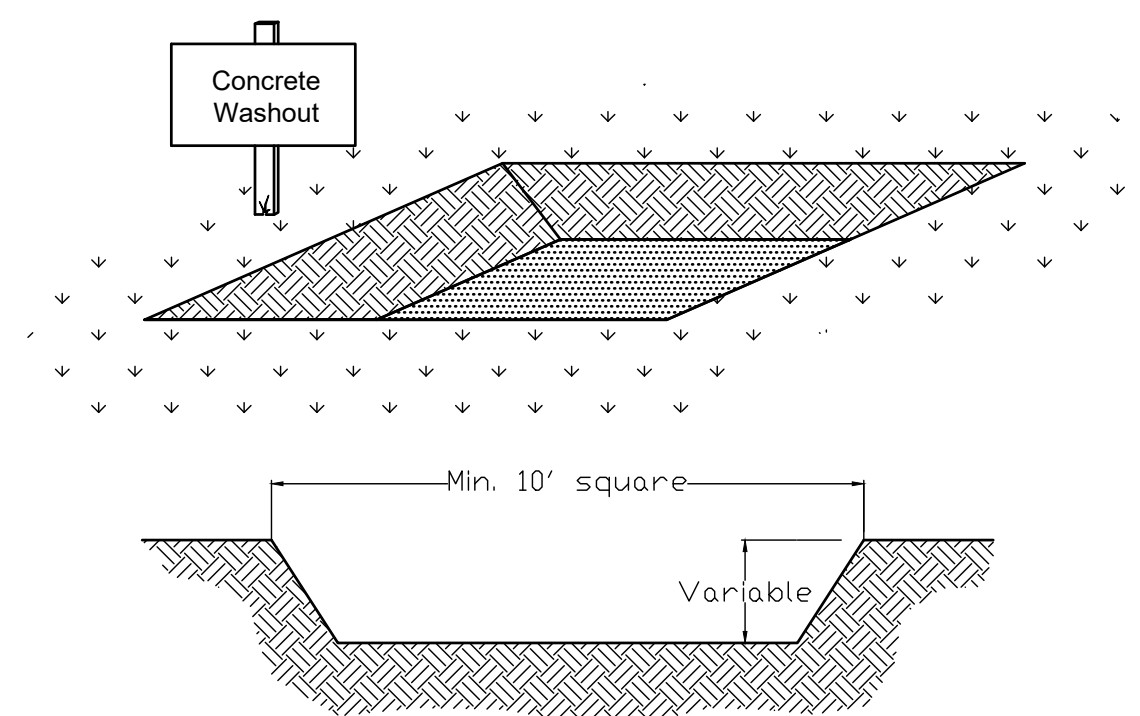

Concrete Washout Area

Not To Scale

Standard Notes

- If necessary, slopes, which exceed eight (8) vertical feet should be stabilized with synthetic or vegetative mats, in addition to hydroseeding. It may be necessary to install temporary slope drains during construction. Temporary berms may be needed until the slope is brought to grade.
- Stabilization measures shall be initiated as soon as practicable in portions of the site where construction activities have temporarily or permanently ceased, but in no case more than fourteen (14) days after work has ceased, except as stated below.
 - Where stabilization by the 14th day is precluded by snow cover or frozen ground conditions stabilization measures must be initiated as soon as practicable.
 - Where construction activity on a portion of the Site is temporarily ceased, and earth-disturbing activities will be resumed within 14 days, temporary stabilization measures do not have to be initiated on that portion of the Site.
- All sediment and erosion control devices shall be inspected once every calendar week. If periodic inspection or other information indicates that a BMP has been inappropriately or incorrectly installed, the Permittee must address the necessary replacement or modification required to correct the BMP within 48 hours of identification.
- Provide silt fence and/or other control devices, as may be required, to control soil erosion during utility construction. All disturbed areas shall be cleaned, graded, and stabilized with grassing immediately after the utility installation. Fill, cover, and temporary seeding at the end of each day are recommended. If water is encountered while trenching, the water should be filtered to remove any sediments before being pumped back into any waters of the State.
- All erosion control devices shall be properly maintained during all phases of construction until the completion of all construction activities and all disturbed areas have been stabilized. Additional control devices may be required during construction in order to control erosion and/or offsite sedimentation. All temporary control devices shall be removed once construction is complete and the site is stabilized.
- The contractor must take necessary action to minimize the tracking of mud onto paved roadway(s) from construction areas and the generation of dust. The contractor shall daily remove mud/soil from pavement, as may be required.
- Residential subdivisions require erosion control features for infrastructure as well as for individual lot construction. Individual property owners shall follow these Plans during construction or obtain approval of an individual Plan in accordance with S.C. Reg. 72-300 et seq. and SCR100000.
- Temporary diversion berms and/or ditches will be provided as needed during construction to protect work areas from upslope runoff and/or to divert sediment-laden water to appropriate traps or stable outlets.
- All waters of the State (WoS), including wetlands, are to be flagged or otherwise clearly marked in the field. A double row of silt fence is to be installed in all areas where a 50-foot buffer can't be maintained between the disturbed area and all WoS. A 10-foot buffer should be maintained between the last row of silt fence and all WoS.
- Litter, construction debris, oils, fuels, and building products with significant potential for impact (such as stockpiles of freshly treated lumber) and construction chemicals that could be exposed to storm water must be prevented from becoming a pollutant source in storm water discharges.
- A copy of the SWPPP, inspections records, and rainfall data must be retained at the construction site or a nearby location easily accessible during normal business hours, from the date of commencement of construction activities to the date that final stabilization is reached.
- Initiate stabilization measures on any exposed steep slope (3H:1V or greater) where land-disturbing activities have permanently or temporarily ceased, and will not resume for a period of 7 calendar days.
- Minimize soil compaction and, unless infeasible, preserve topsoil.
- Minimize the discharge of pollutants from equipment and vehicle washing, wheel wash water, and other wash waters. Wash waters must be treated in a sediment basin or alternative control that provides equivalent or better treatment prior to discharge.
- Minimize the discharge of pollutants from dewatering of trenches and excavated areas. These discharges are to be routed through appropriate BMPs (sediment basin, filter bag, etc.).
- The following discharges from sites are prohibited:
 - Wastewater from washout of concrete, unless managed by an appropriate control;
 - Wastewater from washout and cleanout of stucco, paint, form release oils, curing compounds and other construction materials;
 - Fuels, oils, or other pollutants used in vehicle and equipment operation and maintenance; and
 - Soaps or solvents used in vehicle and equipment washing.
- After construction activities begin, inspections must be conducted at a minimum of at least once every calendar week and must be conducted until final stabilization is reached on all areas of the construction site.
- If existing BMPs need to be modified or if additional BMPs are necessary to comply with the requirements of this permit and/or SC's Water Quality Standards, implementation must be completed before the next storm event whenever practicable. If implementation before the next storm event is impracticable, the situation must be documented in the SWPPP and alternative BMPs must be implemented as soon as reasonably possible.
- A Pre-Construction Conference must be held for each construction site with an approved On-Site SWPPP prior to the implementation of construction activities. For non-linear projects that disturb 10 acres or more this conference must be held on-site unless the Department has approved otherwise.

Note:
gravel mat shall be installed at all construction traffic access points

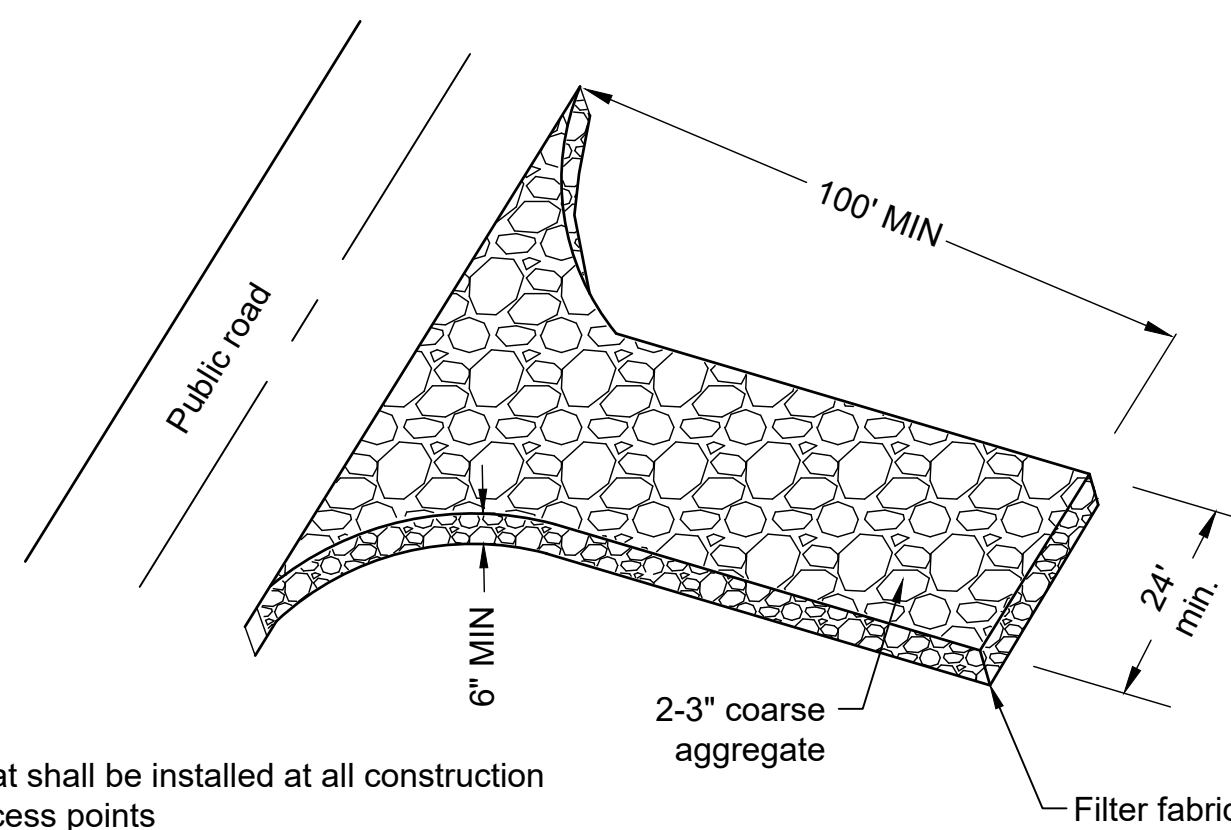

Temporary Gravel Construction Entrance/exit

Not To Scale

Permanent Seeding Update

Species	Lbs/Ac	Jan	Feb	Mar	Apr	May	Jun	Jul	Aug	Sep	Oct	Nov	Dec
Bahiagrass (Alone)	40												
Bahiagrass (Mix)	30												
Bermuda Grass (Hulled) (Alone)	8-12												
Bermuda Grass (Hulled) (Mix)	46												
Fescue, Tall (KY31) Alone	40												
Fescue, Tall (KY31) mix	20												
Sericea Lespedeza (Scarified) Alone or Mix (inoculate with EL Inoculant)	40												
Ladino Clover (mix only) Inoculate with AB Inoculant	2												

For Steep Slopes / Cut Slopes

Weeping Lovegrass (Alone)	4												
Weeping Lovegrass (Mix)	2												
Crownvetch (Mix) (Inoculate with Type M Inoculant)	8-10												

Temporary Seeding - Upstate

Species	Lbs./ac	Jan	Feb	Mar	Apr	May	Jun	Jul	Aug	Sep	Oct	Nov	Dec
Browntop Millet (Alone)	40												
Browntop Millet (Mix)	10												
Rye Grain (Alone)	56												
Rye Grain (Mix)	10												
Rye Grain (Alone)	50												
Rye Grain (Mix)	8												

For Steep Slopes / Cut Slopes

Weeping Lovegrass (Alone)	4												
Weeping Lovegrass (Mix)	2												

Construction Sequence

- Receive NPDES coverage from DHEC.
- Pre-construction meeting.
- Notify City of Columbia at least 48 hours before construction begins.
- Notify DHEC EQC regional office or OCRM office 48 hours prior to beginning land disturbing activities.
- Installation of construction entrances.
- Clearing and grubbing only as necessary for installation of perimeter controls.
- Installation of perimeter controls.
- Clearing and grubbing only in area of basins / traps / ponds.
- Installation of basins / traps / ponds.
- Clearing and grubbing of site or demolition.
- Rough grading.
- Installation of storm drain system and placement of inlet protection as each inlet is installed.
- Fine grading, paving, etc.
- Permanent stabilization.
- Clean-out of detention basins that were used as sediment control structures and regrading of detention pond bottoms.
- Removal of temporary sediment and erosion control measures after entire area draining to the structure is finally stabilized.
- Submit to DHEC the notice of termination once the site reaches final stabilization.

Applicant's Certification:
"I (we) hereby certify that all clearing, grading, construction and/or development will be done pursuant to this Plan and I (we) are responsible for the land disturbance and related maintenance thereof. City of Columbia & SCDHEC authorities will be allowed to enter the project site for the purpose of on-site inspections."

Owner / Person Financially Responsible _____ Date _____

Designer's Certification:
"I hereby certify that this Plan is designed to contain soil on the property concerned to the maximum extent, to provide for the protection of the property and the proposed improvements thereon from the effects of flooding, to provide for the control of the runoff from the property, and that all provisions for sediment control and storm drainage are in accordance with the stormwater management and sediment control ordinance for the City of Columbia & SCDHEC"

Signature _____ Date _____

S.C. Registration Number: 11378
Registered Professional Engineer



Chao & Associates, Inc.
Civil - Structural - Survey
7 Clusters Court
Columbia, SC 29210
Voice: (803) 772-8420
Fax: (803) 772-9120
Email: consult@chaoinc.com

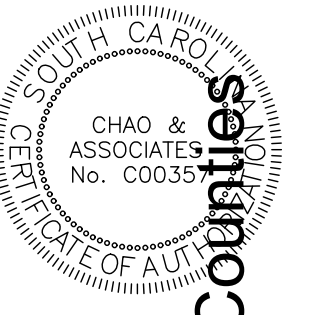

Miscellaneous Details
Irmo Elementary
Playground Drainage Improvements
District 5 of Lexington and Richland Counties
Irmo, SC

Drawn: JKN
Checked: GAL
Revised:
Project No.: 390590C
File: 390590C R1.dwg

C4.1
Sheet Number
January 11, 2024
Date

WHEN ARE INLINE DRAINS USED?

- 2708AG __X
- 2710AG __X
- 2712AG __X
- 2715AG __X
- 2718AG __X
- 2724AG __X
- 2730AG __X

TYPICAL INSTALLATIONS

TYPICAL INSTALLATION OF NYLOPLAST DRAIN BASIN AND INLINE DRAIN

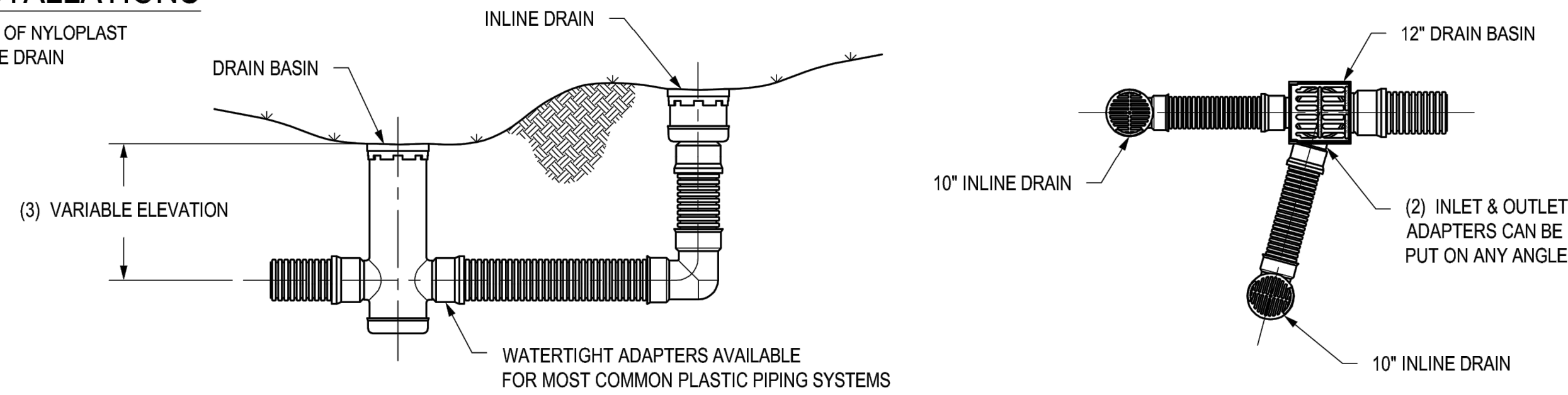

WHEN ARE DRAIN BASINS USED?

- 2808AG __X
- 2810AG __X
- 2812AG __X
- 2815AG __X
- 2818AG __X
- 2824AG __X
- 2830AG __X
- 2836AG __X

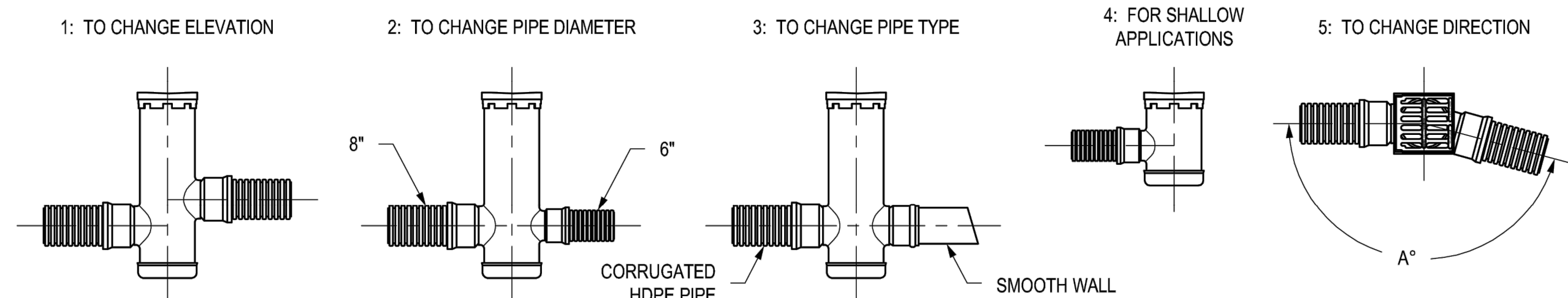

- 1 - STRUCTURES & ADAPTERS AVAILABLE IN SIZES 8" - 36"
- 2 - ADAPTERS CAN BE MOUNTED ON ANY ANGLE UP TO 360°. TO DETERMINE MINIMUM ANGLE BETWEEN ADAPTERS SEE DRAWING NO. 7001-110-012
- 3 - DRAIN BASIN TO BE CUSTOM MANUFACTURED ACCORDING TO PLAN DETAILS SEE DRAWING NO. 7001-110-065
- 4 - REDUCING CONES DOWN TO 30" DIAMETER WILL BE REQUIRED FOR 36" DRAIN BASINS.

THIS PRINT DISCLOSES SUBJECT MATTER IN WHICH NYLOPLAST HAS PROPRIETARY RIGHTS. THE RECEIPT OR POSSESSION OF THIS PRINT DOES NOT CONFER, TRANSFER, OR LICENSE THE USE OF THE DESIGN OR TECHNICAL INFORMATION SHOWN HEREIN. REPRODUCTION OF THIS PRINT OR ANY INFORMATION CONTAINED HEREIN, OR MANUFACTURE OF ANY ARTICLE HEREFROM, FOR THE DISCLOSURE TO OTHERS IS FORBIDDEN, EXCEPT BY SPECIFIC WRITTEN PERMISSION FROM NYLOPLAST. ©2013 NYLOPLAST

DRAWN BY	AWA	MATERIAL	
DATE	8-10-00		
REVISED BY	NMH	PROJECT NO./NAME	
DATE	11-2-18		
DWG SIZE	A	SCALE	1:40 SHEET 1 OF 1

ADS
Nyloplast

3130 VERONA AVE
BUFORD, GA 30518
PHN (770) 932-2443
FAX (770) 932-2490
www.nyloplast-us.com

TITLE
8 IN - 36 IN TYPICAL INSTALLATION OPTIONS

DWG NO. 7001-110-042 **REV** E

NYLOPLAST DRAIN BASIN WITH PEDESTRIAN GRATE

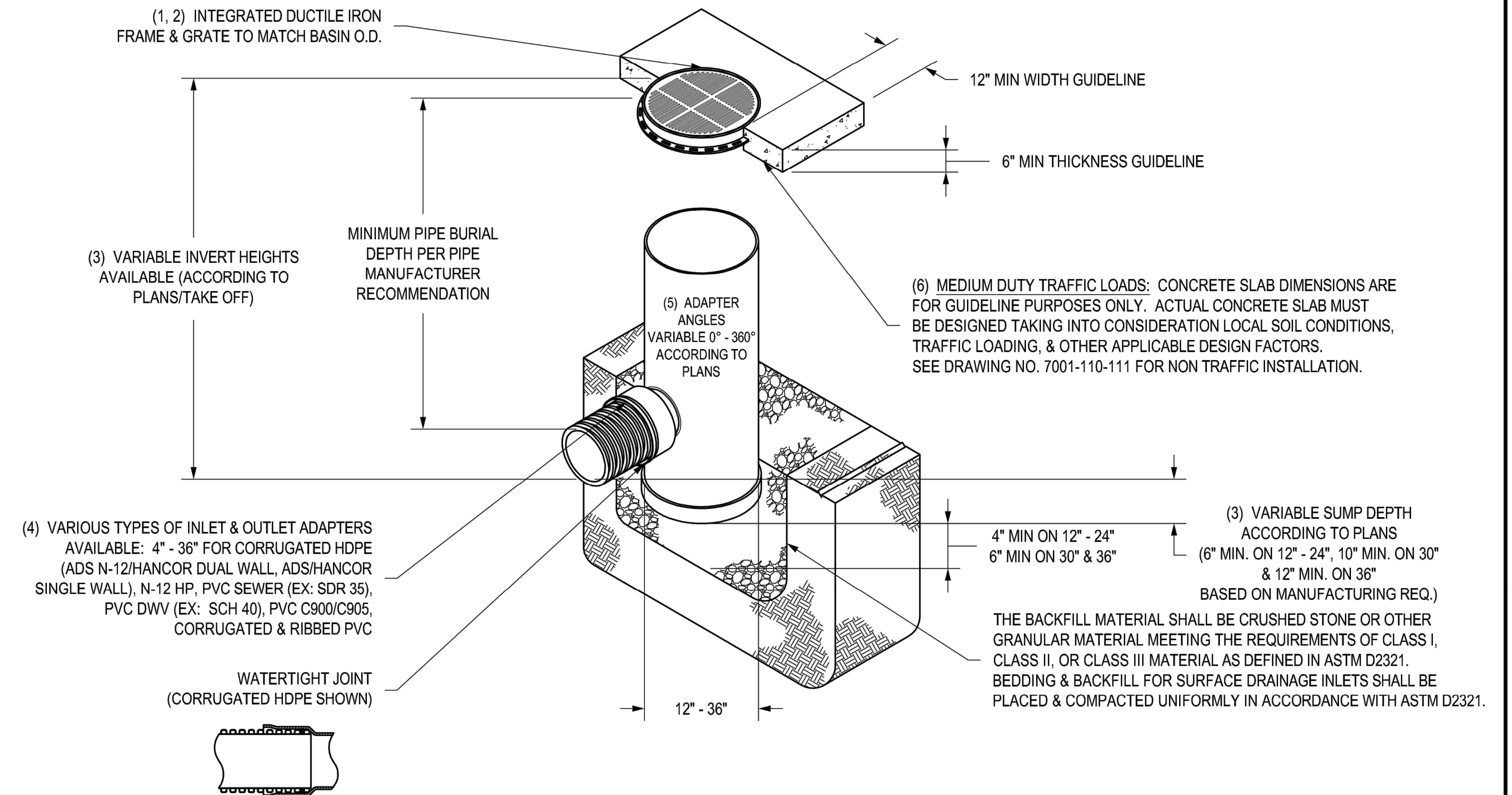

- 1 - 12" - 30" PEDESTRIAN GRATES SHALL BE DUCTILE IRON PER ASTM A536 GRADE 70-50-05.
- 2 - 12" - 30" FRAMES SHALL BE DUCTILE IRON PER ASTM A536 GRADE 70-50-05.
- 3 - DRAIN BASIN TO BE CUSTOM MANUFACTURED ACCORDING TO PLAN DETAILS. RISERS ARE NEEDED FOR BASINS OVER 84" DUE TO SHIPPING RESTRICTIONS. SEE DRAWING NO. 7001-110-065.
- 4 - DRAINAGE CONNECTION STUB JOINT TIGHTNESS SHALL CONFORM TO ASTM D3212 FOR CORRUGATED HDPE (ADS N-12/HANCOR DUAL WALL), N-12 HP, & PVC SEWER (4" - 36").
- 5 - ADAPTERS CAN BE MOUNTED 0° TO 360°. TO DETERMINE MINIMUM ANGLE BETWEEN ADAPTERS SEE DRAWING NO. 7001-110-012.
- 6 - 12" - 24" PEDESTRIAN GRATES SHALL MEET H-10 LOAD RATING. 30" PEDESTRIAN GRATE SHALL MEET H-20 LOAD RATING (SEE DRAWING NO. 7001-110-144 FOR H-20 TRAFFIC LOAD GUIDELINES).

THIS PRINT DISCLOSES SUBJECT MATTER IN WHICH NYLOPLAST HAS PROPRIETARY RIGHTS. THE RECEIPT OR POSSESSION OF THIS PRINT DOES NOT CONFER, TRANSFER, OR LICENSE THE USE OF THE DESIGN OR TECHNICAL INFORMATION SHOWN HEREIN. REPRODUCTION OF THIS PRINT OR ANY INFORMATION CONTAINED HEREIN, OR MANUFACTURE OF ANY ARTICLE HEREFROM, FOR THE DISCLOSURE TO OTHERS IS FORBIDDEN, EXCEPT BY SPECIFIC WRITTEN PERMISSION FROM NYLOPLAST. ©2013 NYLOPLAST

DRAWN BY	EBC	MATERIAL	PVC
DATE	4-20-07		
REVISED BY	NMH	PROJECT NO./NAME	
DATE	06-12-18		
DWG SIZE	A	SCALE	1:40 SHEET 1 OF 1

ADS
Nyloplast

3130 VERONA AVE
BUFORD, GA 30518
PHN (770) 932-2443
FAX (770) 932-2490
www.nyloplast-us.com

TITLE
DRAIN BASIN WITH PEDESTRIAN GRATE
QUICK SPEC INSTALLATION DETAIL

DWG NO. 7001-110-283 **REV** E



Chao & Associates, Inc.
Civil - Structural - Survey
7 Clusters Court
Columbia, SC 29210
Voice: (803) 772-8420
Fax: (803) 772-9120
Email: consult@chaoinc.com

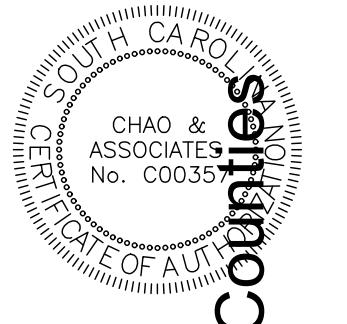

Miscellaneous Details
Irmo Elementary
Playground Drainage Improvements
District 5 of Lexington and Richland Counties
Irmo, SC

Drawn: JKN
Checked: GAL
Revised:
Project No.: 390590C
File: 390590C R1.dwg

C4.2
Sheet Number
January 11, 2024
Date