

**Districtwide Lead in Drinking Water
Sampling and Remediation Plan for 2023-2025 Compliance.**

Glen Cove CSD

April 2025

Enviroscience Project #26198



A Mainline Company

2150 Smithtown Ave., Suite 3, Ronkonkoma, NY 11779

T: 631.580.3191 • **F:** 631.580.3195 • **W:** envirohealth.org

DISTRICTWIDE LEAD IN DRINKING WATER SAMPLING AND REMEDIATION PLAN

2023-2025

APRIL 2025

ENVIROSCIENCE PROJECT #26198

Prepared for: GLEN COVE CSD
150 Dosoris Lane
Glen Cove, NY 11542

Prepared by: ENVIROSCIENCE CONSULTANTS, LLC
2150 Smithtown Avenue
Ronkonkoma, New York 11779
(631) 580-3191

Project Manager: *Pam Chadderton*

TABLE OF CONTENTS

<u>Section</u>	<u>Title</u>
1.0	Executive Summary
2.0	Sampling Methodology
3.0	Initial Results

Appendices

Appendix A	Connolly Elementary School
Appendix B	Deasy Elementary School
Appendix C	Gribbin Elementary School
Appendix D	Landing Elementary School
Appendix E	R. M. Finley Middle School
Appendix F	Glen Cove High School and Administration

1.0 EXECUTIVE SUMMARY

The Glen Cove CSD has developed their Lead in Drinking Water Sampling and Remediation Plan for the 2023-2025 compliance period, as required by the New York State Department of Health (Public Health Law Sections 1370-a and 1110, Subpart 67-4 Lead Testing in School Drinking Water).

In accordance with the regulation, this Lead Remediation Plan is prepared to identify locations deemed as Applicable Drinking Water Sources and report first draw sample results, to mitigate locations where sample results exceed 5 parts per billion, to identify locations deemed as Non-Applicable Water Sources, communicate this designation to building occupants, and to develop strategies for monitoring locations deemed Non-Applicable Water Sources to insure building occupants do not consume water from these locations.

The following locations within the Glen Cove CSD buildings have been deemed Applicable Drinking Water Sources by the administration:

- 1) Water fountains and bottle filling stations;
- 2) Kitchen water faucets and pot fillers used in food preparation;
- 3) Ice machines
- 4) Home Economics classroom sinks
- 5) Elementary Classroom Bathroom sinks
- 6) Nurse's Office and Faculty Room sinks

First draw samples were collected from each of these locations within the district and analyzed by a New York State Department of Health ELAP certified laboratory. The chains of custody are available upon request. For results at or below 5 ppb, no further action is required until 2025. For locations above 5 ppb, options include: second and third draw sample collection to determine source of lead, designation of the location as Non-applicable Water Source, or permanent removal of the fixture from the location. In either case, the result was communicated by Enviroscience Consultants, and the fixture was shut off by the district immediately upon receipt of results.

The following locations within the Glen Cove CSD buildings were deemed Non-Applicable Water Sources by the administration:

- 1) Science Laboratory sinks
- 2) Art Room sinks
- 3) Technical Classroom sinks
- 4) Other Classroom sinks
- 5) Other Bathroom sinks
- 6) Outside spigots
- 7) Custodial Closet sinks
- 8) Mixed Valve sinks (or hot only)

In these cases, the Glen Cove CSD staff have placed signs adjacent to the fixture to notify occupants that the water is not intended for consumption. To further support this protocol, the following management of the locations is required:

- 1) Science Laboratory sinks - communicate in writing with students that these locations are for science experiments and hand washing only, not for consumption. This is most easily accomplished by including this language in the laboratory safety paperwork distributed to students at the beginning of the school year. This program should be monitored by the respective science teachers, and any deficiencies reported for assessment and revision, if necessary, by the Facilities Department.
- 2) Art Room sinks - communicate in writing to students that these locations are for cleaning of art supplies and hand washing only, not for consumption. This is most easily accomplished by including this language in the course paperwork distributed to students at the beginning of the school year. This program should be monitored by the respective art teachers, and any deficiencies reported for assessment and revision, if necessary, by the Facilities Department.
- 3) Technical Classroom sinks - classrooms in this category often include wood shop or auto mechanics classrooms, where students are to hand wash after bathroom usage or activities as part of a regular hygiene program. This program should be monitored by teachers and staff to ensure consumption is not taking place, and any deficiencies reported for assessment and revision, if necessary, by the Facilities Department.

- 4) Other classroom sinks - classrooms in this category often include elementary classrooms, where students are to hand wash after bathroom usage or activities as part of a regular hygiene program. This program should be monitored by teachers and staff to ensure consumption is not taking place, and any deficiencies reported for assessment and revision, if necessary, by the Facilities Department.
- 5) Bathroom sinks - in intermediate buildings, signage should be sufficient for communicating the concept of hand washing only. In elementary schools, personal hygiene should be integrated into curriculum to ensure students understand bathroom sinks are for hand washing only, and not consumption. Further, show what the signage looks like in bathrooms, so they learn to recognize its meaning. This program should be monitored by teachers and staff to ensure consumption is not taking place, and any deficiencies reported for assessment and revision, if necessary, by the Facilities Department.
- 6) Outside spigots - all-weather signage will be installed at each location. Further, spigots will have a special key maintained by the custodial staff to ensure that non-authorized persons do not fill sports coolers or use hoses for consumption. This program should be monitored by custodial staff to ensure consumption is not taking place, and any deficiencies reported for assessment and revision, if necessary, by the Facilities Department.
- 7) Custodial Closet sinks - these locations should be accessed by custodial personnel only and locked when not in use. Access to others should be restricted. This program should be monitored by custodial staff to ensure consumption is not taking place, and any deficiencies reported for assessment and revision, if necessary, by the Facilities Department.
- 8) Mixed Valve sinks (or hot only) – per Public Health Law Sections 1370-a and 1110, Subpart 67-4 Lead Testing in School Drinking Water mixed valve or hot water only sources are not required to be sampled. Signage is required for these sources. Signage should be sufficient for communicating the concept of hand washing only. In elementary schools, personal hygiene should be integrated into curriculum to ensure students understand bathroom sinks are for hand washing only, and not consumption. Further, show what the signage looks like, so they learn to recognize its meaning. This program should be monitored by teachers and staff to ensure consumption is not

taking place, and any deficiencies reported for assessment and revision, if necessary, by the Facilities Department.

All locations deemed non-applicable, but do not have signs, should be taken offline until signs have been posted. Signs are suggested to have pictures that instruct for handwashing only, do not drink.

2.0 SAMPLING METHODOLOGY

In accordance with the regulation, Enviroscience Consultants, LLC performed initial water sampling at the Glen Cove CSD buildings on April 23, 24 & 25, 2025. Samples were collected in wide-mouth 250 milliliter containers and were collected in the morning hours before the facilities opened. The water sources were not used for at least 8 hours and not more than 18 hours prior to sampling. Unique source numbers and designations were assigned to each source location. Unique sample identification numbers were assigned to each sample taken. The key to fixture type codes, source designations, and the sampling location schematics are shown below.

Code Key for Lead in Water			
Fixture Type Codes			
BF	Bottle Filler	SK	Sink
HB	Hose Bib	SL	Supply Line
IM	Ice Machine	SP	Spigot
OS	Other Source	SPY	Spray
PF	Pot Filler	SS	Slop Sink
		V	Valve
		WC	Water Cooler
		WF	Water Fountain
Source Designations			
App	Applicable	N/A	Non-applicable

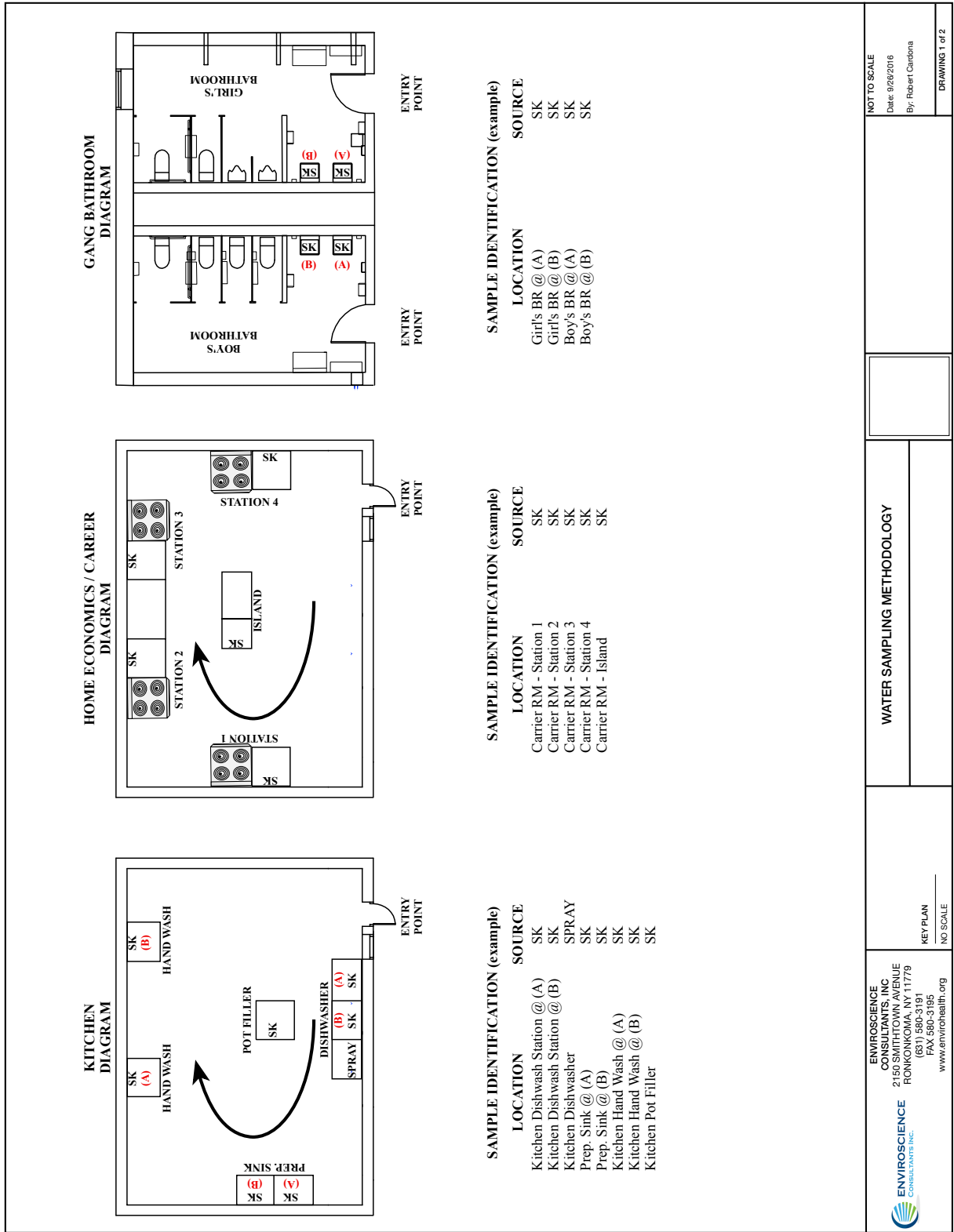

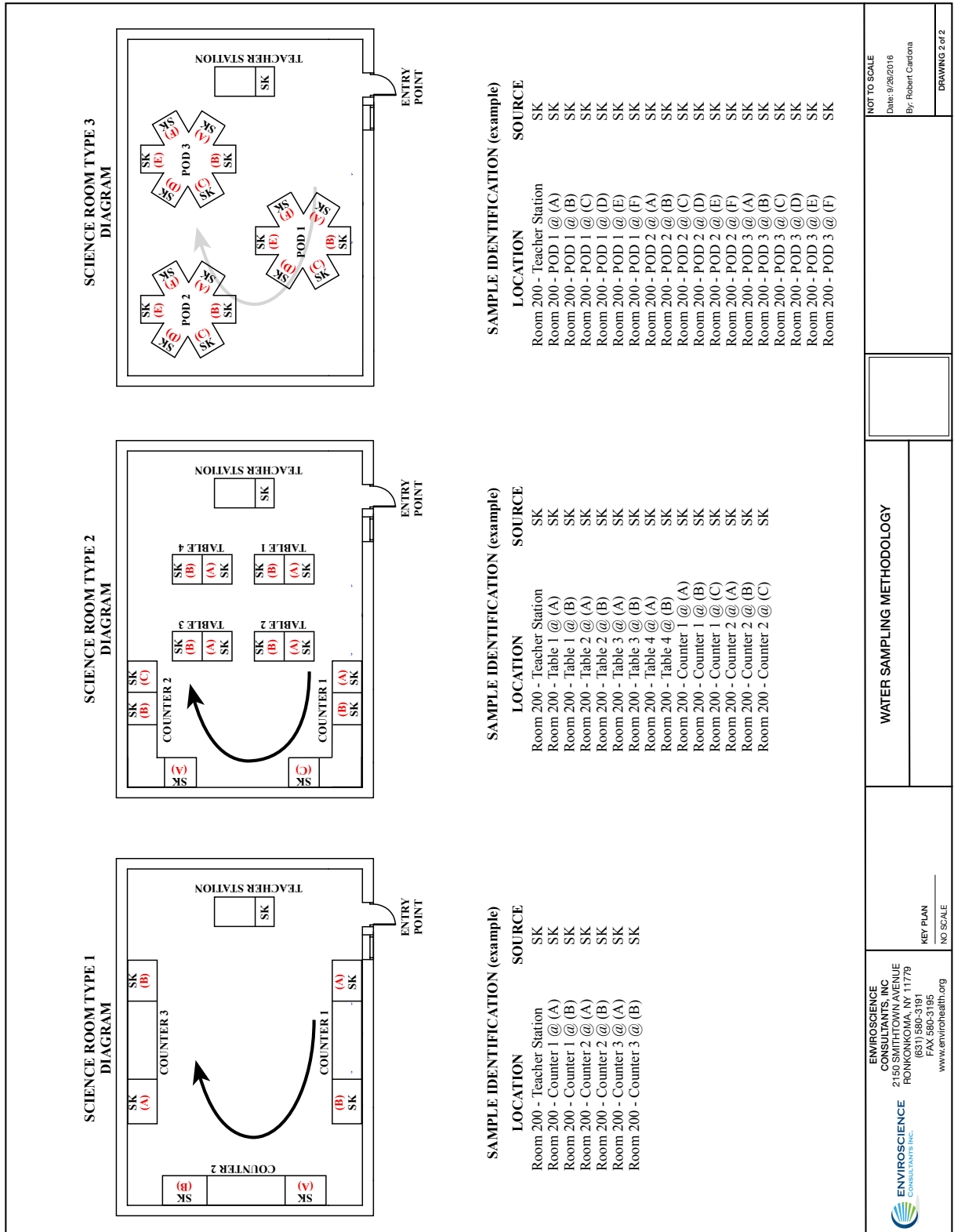

WATER SAMPLING METHODOLOGY	NOT TO SCALE Date: 9/26/2016 By: Robert Castano	DRAWING 2 of 2
 ENVIROSCIENCE CONSULTANTS, INC 2150 SMITHTOWN AVENUE RONKONKOMA, NY 11779 (631) 580-3181 FAX 580-3185 www.envirohealth.org	KEY PLAN NO SCALE	

3.0 Initial Results

All water source locations in each of the school buildings were assessed. Water source locations identified as drinking water sources were considered Applicable, and first draw samples were collected. Water source locations identified as non-drinking water sources were considered non-applicable and these locations were documented.

The results of the initial sampling and the use of signs warning against water use at non-applicable sources is documented in the School Water Outlet Inventory for each building.

All elevated locations should be taken off line until the remediation is completed. Any other drinking water sources in these buildings that were not functional at the time of initial sampling and have not been tested should be tested before returning to service. All locations deemed non-applicable, but do not have signs, should be taken offline until signs have been posted. Signs are suggested to have pictures that instruct for handwashing only, do not drink.

The following is a summary of results in parts per billion (ppb) of locations in the Glen Cove CSD where sample results were found above 5 ppb:

Connolly Elementary School			
SAMPLE LOCATION	RESULT	SAMPLE DATE	REMARKS
Faculty Room Sink	13.0	4/24/25	sign posted
Kitchen Potfiller	10	4/25/25	removed from service; pending remediation

Deasy Elementary School			
SAMPLE LOCATION	RESULT	SAMPLE DATE	REMARKS
No Exceedances			

Gribbin Elementary School			
SAMPLE LOCATION	RESULT	SAMPLE DATE	REMARKS
Faculty Room Sink	9.0	4/25/25	sign posted

Landing Elementary School			
SAMPLE LOCATION	RESULT	SAMPLE DATE	REMARKS
Faculty Room Sink Faucet	16.0	4/24/25	sign posted
Faculty Room Sink Spray	8.0	4/24/25	sign posted

R. M. Finley Middle School			
SAMPLE LOCATION	RESULT	SAMPLE DATE	REMARKS
Kitchen left prep sink by ovens	14.0	4/23/25	removed from service; pending remediation
Kitchen right prep sink by freezer	18.0	4/23/25	removed from service; pending remediation
Kitchen potfiller left	8.0	4/23/25	removed from service; pending remediation
Kitchen potfiller right	10	4/23/25	removed from service; pending remediation
Kitchen potfiller on stove	10	5/1/25	removed from service; pending remediation

Glen Cove High School and Administration

SAMPLE LOCATION	RESULT	SAMPLE DATE	REMARKS
Kitchen 2-Bay-food prep sink	233.0	4/23/2025	removed from service; pending remediation
Kitchen Island-food prep sink	27.0	4/23/2025	removed from service; pending remediation
Kitchen Potfiller right	10.0	4/23/2025	removed from service; pending remediation
Kitchen Steamer	74.0	4/23/2025	removed from service; pending remediation
Kitchen Coffee Maker supply line	18.0	4/23/2025	removed from service; pending remediation
Nurse's Office 100A sink	107.0	4/23/2025	removed from service; pending remediation
Faculty Room 213 sink	10.0	4/23/2025	sign posted
Library Office sink	9.0	4/23/2025	sign posted
Thayer House-Kitchen sink	8.0	4/23/2025	sign posted

Appendix A
Connolly Elementary School

Fixture #	Sample Location	Fixture Type	App or N/A	Latest 1 st Draw Results (ppb)	Latest 1st Draw Sampling Date	15 Second Draw Results (ppb)	60 Second Draw Results (ppb)	Flush Sampling Date	Remarks
0001-01	Kitchen Custodial Closet	SS	N/A		4/24/2025				Sign
0001-02	Kitchen Bathroom	SK	N/A		4/24/2025				Sign
0001-03	Kitchen Potfiller	PF	App	19.0	5/1/2025	1.0	2.0	5/1/2025	Removed From Service; Pending Remediation
0001-04	Kitchen 2-Bay Left	SK	App	10.0	4/25/2025				Removed From Service; Pending Remediation
0001-04	Kitchen 2-Bay Left	SK	App	3.0	4/25/2025				-
0001-05	Kitchen 2-Bay Right	SK	App	2.0	4/25/2025				-
0001-06	Kitchen Handwash	SK	N/A		4/24/2025				Sign
0001-07	Kitchen Spray	SPY	App	2.0	4/25/2025				-
0002-01	Cafeteria	BF	App	1.0	4/24/2025				-
0002-02	Cafeteria	WF	App	1.0	4/24/2025				-
0003-01	Custodial Closet BY Room 117	SS	N/A		4/24/2025				Sign
0004-01	Room 100 Bathroom	SK	N/A		4/24/2025				Mixed Valve; Sign
0005-01	Room 101	SK	N/A		4/24/2025				Mixed Valve; Sign
0005-02	Room 101	WF	N/A		4/24/2025				Removed From Service
0005-03	Room 101 Bathroom	SK	N/A		4/24/2025				Mixed Valve; Sign
0006-01	Room 107	SK	N/A		4/24/2025				Mixed Valve; Sign
0006-02	Room 107	WF	N/A		4/24/2025				Removed From Service
0006-03	Room 107 Bathroom	SK	N/A		4/24/2025				Mixed Valve; Sign
0007-01	Room 109 (Left)	SK	N/A		4/24/2025				Mixed Valve; Sign

Fixture #	Sample Location	Fixture Type	App or N/A	Latest 1 st Draw Results (ppb)	Latest 1st Draw Sampling Date	15 Second Draw Results (ppb)	60 Second Draw Results (ppb)	Flush Sampling Date	Remarks
0007-02	Room 109 (Left Middle)	SK	N/A		4/24/2025				Mixed Valve; Sign
0007-03	Room 109 (Right Middle)	SK	N/A		4/24/2025				Mixed Valve; Sign
0007-04	Room 109 (Right)	SK	N/A		4/24/2025				Mixed Valve; Sign
1001-01	Room 222	SK	N/A		4/24/2025				Mixed Valve; Sign
1002-01	Room 220	SK	N/A		4/24/2025				Mixed Valve; Sign
1003-01	Room 218	SK	N/A		4/24/2025				Mixed Valve; Sign
1004-01	Room 216	SK	N/A		4/24/2025				Mixed Valve; Sign
1005-01	Library Room 214	SK	N/A		4/24/2025				Mixed Valve; Sign
1006-01	Room 210 Bathroom	SK	N/A		4/24/2025				Mixed Valve; Sign
1007-01	Room 208	SK	N/A		4/24/2025				Mixed Valve; Sign
1008-01	Room 206	SK	N/A		4/24/2025				Mixed Valve; Sign
1009-01	Room 204 Bathroom	SK	N/A		4/24/2025				Mixed Valve; Sign
1009-02	Room 202	SK	N/A		4/24/2025				Mixed Valve; Sign
1010-01	Room 200 Bathroom	SK	N/A		4/24/2025				Mixed Valve; Sign
1011-01	Room 201 Bathroom	SK	N/A		4/24/2025				Mixed Valve; Sign
1012-01	Room 101A/203	SK	N/A		4/24/2025				Mixed Valve; Sign
1012-02	Room 101B/205 Bathroom	SK	N/A		4/24/2025				Mixed Valve; Sign
1013-01	Room 207	SK	N/A		4/24/2025				Mixed Valve; Sign
1014-01	Room 209	SK	N/A		4/24/2025				Mixed Valve; Sign

Fixture #	Sample Location	Fixture Type	App or N/A	Latest 1 st Draw Results (ppb)	Latest 1 st Draw Sampling Date	15 Second Draw Results (ppb)	60 Second Draw Results (ppb)	Flush Sampling Date	Remarks
1015-01	Room 211	SK	N/A		4/24/2025				Mixed Valve; Sign
1016-01	Custodial Closet by Main Entrance	SS	N/A		4/24/2025				Sign
1017-01	Faculty Room	SK	App	13.0	4/24/2025				Sign Posted
1018-01	Women's Bathroom by Faculty Room	SK	N/A		4/24/2025				Mixed Valve; Sign
1019-01	Hall by Gym	BF	App	<1.0	4/24/2025				-
1019-02	Hall by Gym	WF	App	<1.0	4/24/2025				-
1020-01	Men's Bathroom by Gym	SK	N/A		4/24/2025				Mixed Valve; Sign
1021-01	Room 225	SK	N/A		4/24/2025				Mixed Valve; Sign
1022-01	Girl's Bathroom by Room 225 (Left)	SK	N/A		4/24/2025				Mixed Valve; Sign
1022-02	Girl's Bathroom by Room 225 (Middle)	SK	N/A		4/24/2025				Mixed Valve; Sign
1022-03	Girl's Bathroom by Room 225 (Right)	SK	N/A		4/24/2025				Mixed Valve; Sign
1023-01	Boy's Bathroom by Room 225 Custodial Closet	SS	N/A		4/24/2025				Sign
1023-02	Boy's Bathroom by Room 225 (Left)	SK	N/A		4/24/2025				Mixed Valve; Sign
1023-03	Boy's Bathroom by Room 225 (Middle)	SK	N/A		4/24/2025				Mixed Valve; Sign
1023-04	Boy's Bathroom by Room 225 (Right)	SK	N/A		4/24/2025				Mixed Valve; Sign
1024-01	Room 227	SK	N/A		4/24/2025				Mixed Valve; Sign
1025-01	Room 229	SK	N/A		4/24/2025				Mixed Valve; Sign
2001-01	Nurse's Office	SK	N/A		4/24/2025				Mixed Valve; Sign
2001-02	Nurse's Office	BF	App	<1.0	4/24/2025				-

Fixture #	Sample Location	Fixture Type	App or N/A	Latest 1 st Draw Results (ppb)	Latest 1st Draw Sampling Date	15 Second Draw Results (ppb)	60 Second Draw Results (ppb)	Flush Sampling Date	Remarks
2001-03	Nurse's Office Bathroom	SK	N/A		4/24/2025				Mixed Valve; Sign
2001-04	Nurse's Office Custodial Closet	SS	N/A		4/24/2025				Sign

Laboratory Report

NYE Report #: 2501736-33089

April 28, 2025

Project Manager
Enviroscience Consultants, Inc.
2150 Smithtown Avenue
Ronkonkoma, NY 11779

Project: Glen Cove School District; Connolly Elementary School

Dear Project Manager,

Enclosed is the Laboratory Analytical Report for potable water sample(s) received on April 24, 2025. New York Environmental analyzed the samples on April 25, 2025 for Lead (Pb) by EPA Method 200.9 Rev. 2.2.

If there are any questions regarding the analyses, please feel free to contact us at your convenience. New York Environmental is a NELAP accredited laboratory. Attached reported results meet the requirements of the NELAP standards unless otherwise noted.

Samples' analytical results relate only to the samples tested, in the condition received by the laboratory. This report shall not be reproduced except in its entirety without written approval of the laboratory.

We sincerely thank you for your business, and look forward to being of service for your future environmental testing needs.

Sincerely,

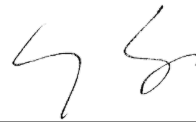

Li Tsang, Laboratory Director

Date Collected:	24 Apr 2025
Date Received:	24 Apr 2025
Date Analyzed:	25 Apr 2025

Analytical Method:	EPA 200.9 Rev. 2.2
Analyte, Matrix:	Lead, Potable Water

Lab ID	CID	Sample Location/Description	LOQ	Result	Units	Flag
250424M004	1	Cafeteria-BF, Initial	0.001	<0.001	mg/L	
250424M005	2	Cafeteria-WF, Initial	0.001	<0.001	mg/L	
250424M006	3	Faculty Room-SK, Initial	0.001	0.013	mg/L	H
250424M007	4	Hall By Gym-BF, Initial	0.001	<0.001	mg/L	
250424M008	5	Hall By Gym-WF, Initial	0.001	<0.001	mg/L	
250424M009	6	Nurse's Office-BF, Initial	0.001	<0.001	mg/L	

Comment:

CID: Client ID LOQ: Limit of Quantitation

H: Sample result exceeds applicable regulatory limit.

Laboratory Report

NYE Report #: 2501819-33127

April 28, 2025

Project Manager
Enviroscience Consultants, Inc.
2150 Smithtown Avenue
Ronkonkoma, NY 11779

Project: Glen Cove School District; Connolly Elementary School

Dear Project Manager,

Enclosed is the Laboratory Analytical Report for potable water sample(s) received on April 25, 2025. New York Environmental analyzed the samples on April 28, 2025 for Lead (Pb) by EPA Method 200.9 Rev. 2.2.

If there are any questions regarding the analyses, please feel free to contact us at your convenience. New York Environmental is a NELAP accredited laboratory. Attached reported results meet the requirements of the NELAP standards unless otherwise noted.

Samples' analytical results relate only to the samples tested, in the condition received by the laboratory. This report shall not be reproduced except in its entirety without written approval of the laboratory.

We sincerely thank you for your business, and look forward to being of service for your future environmental testing needs.

Sincerely,



Li Tsang, Laboratory Director

Date Collected:	25 Apr 2025
Date Received:	25 Apr 2025
Date Analyzed:	28 Apr 2025

Analytical Method:	EPA 200.9 Rev. 2.2
Analyte, Matrix:	Lead, Potable Water

<u>Lab ID</u>	<u>CID</u>	<u>Sample Location/Description</u>	<u>LOQ</u>	<u>Result</u>	<u>Units</u>	<u>Flag</u>
250425Q029	1	Kitchen Potfiller-PF, Initial	0.001	0.010	mg/L	H
250425Q030	2	Kitchen 2-Bay - Left-SK, Initial	0.001	0.003	mg/L	
250425Q031	3	Kitchen 2-Bay - Right-SK, Initial	0.001	0.002	mg/L	
250425Q032	4	Kitchen Spray-SPY, Initial	0.001	0.002	mg/L	

Comment:

CID: Client ID LOQ: Limit of Quantitation

H: Sample result exceeds applicable regulatory limit.

Laboratory Report

NYE Report #: 2501902-33183

May 5, 2025

Project Manager
Enviroscience Consultants, Inc.
2150 Smithtown Avenue
Ronkonkoma, NY 11779

Project: Glen Cove School District; Connelly Elementary School

Dear Project Manager,

Enclosed is the Laboratory Analytical Report for potable water sample(s) received on May 01, 2025. New York Environmental analyzed the samples on May 02, 2025 for Lead (Pb) by EPA Method 200.9 Rev. 2.2.

If there are any questions regarding the analyses, please feel free to contact us at your convenience. New York Environmental is a NELAP accredited laboratory. Attached reported results meet the requirements of the NELAP standards unless otherwise noted.

Samples' analytical results relate only to the samples tested, in the condition received by the laboratory. This report shall not be reproduced except in its entirety without written approval of the laboratory.

We sincerely thank you for your business, and look forward to being of service for your future environmental testing needs.

Sincerely,



Li Tsang, Laboratory Director

Date Collected:	01 May 2025
Date Received:	01 May 2025
Date Analyzed:	02 May 2025

Analytical Method:	EPA 200.9 Rev. 2.2
Analyte, Matrix:	Lead, Potable Water

<u>Lab ID</u>	<u>CID</u>	<u>Sample Location/Description</u>	<u>LOQ</u>	<u>Result</u>	<u>Units</u>	<u>Flag</u>
250501J019	1A	Kitchen Potfiller - PF, Initial	0.001	0.019	mg/L	H
250501J020	1B	Kitchen Potfiller - PF, 15 Second Draw	0.001	0.001	mg/L	
250501J021	1C	Kitchen Potfiller - PF, 60 Second Draw	0.001	0.002	mg/L	

Comment:

CID: Client ID LOQ: Limit of Quantitation

H: Sample result exceeds applicable regulatory limit.

Appendix B
Deasy Elementary School

Fixture #	Sample Location	Fixture Type	App or N/A	Latest 1 st Draw Results (ppb)	Latest 1st Draw Sampling Date	15 Second Draw Results (ppb)	60 Second Draw Results (ppb)	Flush Sampling Date	Remarks
1001-1	Principal Office Bathroom	SK	N/A		4/23/2025	-	-	-	Sign
1002-1	1st Floor Hallway by Stairwell 'A'	BF	App	<1.0	4/23/2025	-	-	-	-
1022-2	1st Floor Hallway by Stairwell 'A'	WF	App	<1.0	4/23/2025	-	-	-	-
1003-1	1st Floor Boys Bathroom by Stairwell 'A' @ A	SK	N/A		4/23/2025	-	-	-	Mixed Valve; Sign
1003-2	1st Floor Boys Bathroom by Stairwell 'A' @ B	SK	N/A		4/23/2025	-	-	-	Mixed Valve; Sign
1003-3	1st Floor Boys Bathroom by Stairwell 'A' @ C	SK	N/A		4/23/2025	-	-	-	Mixed Valve; Sign
1004-1	1st Floor Janitor Closet in Boys Bathroom by Stairwell 'A'	SS	N/A		4/23/2025	-	-	-	Sign
1005-1	1st Floor Hallway by Stairwell 'B'	BF	App	<1.0	4/23/2025	-	-	-	-
1005-2	1st Floor Hallway by Stairwell "B"	WF	App	<1.0	4/23/2025	-	-	-	-
1006-1	1st Floor Girls Bathroom by Stairwell 'B' @ A	SK	N/A		4/23/2025	-	-	-	Mixed Valve; Sign
1006-2	1st Floor Girls Bathroom by Stairwell 'B' @ B	SK	N/A		4/23/2025	-	-	-	Mixed Valve; Sign
1006-3	1st Floor Girls Bathroom by Stairwell 'B' @ C	SK	N/A		4/23/2025	-	-	-	Mixed Valve; Sign
1007-1	Unisex Bathroom by Room 104	SK	N/A		4/23/2025	-	-	-	Removed From Service
1008-1	Unisex Bathroom by Room 105	SK	N/A		4/23/2025	-	-	-	Removed From Service
2001-1	2nd Floor Girls Bathroom by Stairwell 'B' @ A	SK	N/A		4/23/2025	-	-	-	Mixed Valve; Sign
2001-2	2nd Floor Girls Bathroom by Stairwell 'B' @ B	SK	N/A		4/23/2025	-	-	-	Mixed Valve; Sign
2001-3	2nd Floor Girls Bathroom by Stairwell 'B' @ C	SK	N/A		4/23/2025	-	-	-	Mixed Valve; Sign
2002-1	2nd Floor Hallway by Stairwell 'B'	BF	App	<1.0	4/23/2025	-	-	-	-
2003-2	2nd Floor Hallway by Stairwell 'B'	WF	App	<1.0	4/23/2025	-	-	-	-
2003-1	2nd Floor Hallway by Stairwell 'A'	WF	App	<1.0	4/23/2025	-	-	-	-

Fixture #	Sample Location	Fixture Type	App or N/A	Latest 1 st Draw Results (ppb)	Latest 1st Draw Sampling Date	15 Second Draw Results (ppb)	60 Second Draw Results (ppb)	Flush Sampling Date	Remarks
2003-2	2nd Floor Hallway by Stairwell 'A'	BF	App	<1.0	4/23/2025	-	-	-	-
2004-1	Nurses Office Bathroom	SK	N/A		4/23/2025	-	-	-	Bottle Water Provided; Sign
2005-1	2nd Floor Boys Bathroom by Stairwell 'A' @ A	SK	N/A		4/23/2025	-	-	-	Mixed Valve; Sign
2005-2	2nd Floor Boys Bathroom by Stairwell 'A' @ B	SK	N/A		4/23/2025	-	-	-	Mixed Valve; Sign
2005-3	2nd Floor Boys Bathroom by Stairwell 'A' @ C	SK	N/A		4/23/2025	-	-	-	Mixed Valve; Sign
2006-1	2nd Floor Janitor Closet in Boys Bathroom by Stairwell 'A'	SS	N/A		4/23/2025	-	-	-	Sign
0001-1	Faculty Lounge	SK	N/A		4/23/2025	-	-	-	Sign
0002-1	Faculty Lounge Bathroom	SK	N/A		4/23/2025	-	-	-	Mixed Valve; Sign
0003-1	Basement Hallway by Stairwell 'A'	BF	App	<1.0	4/23/2025	-	-	-	-
0003-2	Basement Hallway by Stairwell 'A'	WF	App	<1.0	4/23/2025	-	-	-	-
0004-1	Basement Men Bathroom by Stairwell 'A' @ A	SK	N/A		4/23/2025	-	-	-	Mixed Valve; Sign
0004-2	Basement Men Bathroom by Stairwell 'A' @ B	SK	N/A		4/23/2025	-	-	-	Mixed Valve; Sign
0005-1	Basement Women Bathroom by Stairwell 'A' @ A	SK	N/A		4/23/2025	-	-	-	Mixed Valve; Sign
0005-2	Basement Women Bathroom by Stairwell 'A' @ B	SK	N/A		4/23/2025	-	-	-	Sign
0006-1	Basement Hallway by Stairwell 'B'	BF	App	<1.0	4/23/2025	-	-	-	-
0006-2	Basement Hallway by Stairwell 'B'	WF	App	<1.0	4/23/2025	-	-	-	-
0007-1	Basement Mechanical Equipment Room	SS	N/A		4/23/2025	-	-	-	Sign

Laboratory Report

NYE Report #: 2501817-33125

April 28, 2025

Project Manager
Enviroscience Consultants, Inc.
2150 Smithtown Avenue
Ronkonkoma, NY 11779

Project: Glen Cove School District; Deasy Elementary School

Dear Project Manager,

Enclosed is the Laboratory Analytical Report for potable water sample(s) received on April 25, 2025. New York Environmental analyzed the samples on April 28, 2025 for Lead (Pb) by EPA Method 200.9 Rev. 2.2.

If there are any questions regarding the analyses, please feel free to contact us at your convenience. New York Environmental is a NELAP accredited laboratory. Attached reported results meet the requirements of the NELAP standards unless otherwise noted.

Samples' analytical results relate only to the samples tested, in the condition received by the laboratory. This report shall not be reproduced except in its entirety without written approval of the laboratory.

We sincerely thank you for your business, and look forward to being of service for your future environmental testing needs.

Sincerely,



Li Tsang, Laboratory Director

Date Collected:	23 Apr 2025
Date Received:	25 Apr 2025
Date Analyzed:	28 Apr 2025

Analytical Method:	EPA 200.9 Rev. 2.2
Analyte, Matrix:	Lead, Potable Water

Lab ID	CID	Sample Location/Description	LOQ	Result	Units	Flag
250425Q007	1	1st Floor Hallway by Stairwell "A"-BF, Initial	0.001	<0.001	mg/L	
250425Q008	2	1st Floor Hallway by Stairwell "A"-WF, Initial	0.001	<0.001	mg/L	
250425Q009	3	1st Floor Hallway by Stairwell "B"-BF, Initial	0.001	<0.001	mg/L	
250425Q010	4	1st Floor Hallway by Stairwell "B"-WF, Initial	0.001	<0.001	mg/L	
250425Q011	5	2nd Floor Hallway by Stairwell "B"-BF, Initial	0.001	<0.001	mg/L	
250425Q012	6	2nd Floor Hallway by Stairwell "B"-WF, Initial	0.001	<0.001	mg/L	
250425Q013	7	2nd Floor Hallway by Stairwell "A"-WF, Initial	0.001	<0.001	mg/L	
250425Q014	8	2nd Floor Hallway by Stairwell "A"-BF, Initial	0.001	<0.001	mg/L	
250425Q015	9	Basement Hallway by Stairwell "A"-BF, Initial	0.001	<0.001	mg/L	
250425Q016	10	Basement Hallway by Stairwell "A"-WF, Initial	0.001	<0.001	mg/L	
250425Q017	11	Basement Hallway by Stairwell "B"-BF, Initial	0.001	<0.001	mg/L	
250425Q018	12	Basement Hallway by Stairwell "B"-WF, Initial	0.001	<0.001	mg/L	

Comment:

CID: Client ID LOQ: Limit of Quantitation

Appendix C
Gribbin Elementary School

Fixture #	Sample Location	Fixture Type	App or N/A	Latest 1 st Draw Results (ppb)	Latest 1st Draw Sampling Date	15 Second Draw Results (ppb)	60 Second Draw Results (ppb)	Flush Sampling Date	Remarks
1001-1	Kitchen	SK	App	3.0	4/25/2025				-
1001-2	Kitchen Bathroom	SK	N/A		4/25/2025				Sign
1001-3	Kichen Dishwash 3-Bay Left	SK	App		4/25/2025				Sign
1001-4	Kichen Dishwash 3-Bay Right	SK	App		4/25/2025				Sign
1002-1	Boiler Room	SS	N/A		4/25/2025				Sign
1003-1	Custodial Office Bathroom	SK	N/A		4/25/2025				Sign
1004-1	Nurse's Office	SK	N/A		4/25/2025				Mixed Valve; Sign
1004-2	Nurse's Office Bathroom	SK	N/A		4/25/2025				Mixed Valve; Sign
1005-1	Custodial Closet by Nurse's Office	SS	N/A		4/25/2025				Sign
1006-1	Speech Room 005	SK	N/A		4/25/2025				Sign
1006-2	Speech Room 005	WF	N/A		4/25/2025				Removed From Service
1007-1	Womens Bathroom by Gymnasium	SK	N/A		4/25/2025				Sign
1008-1	Hallway by Faculty Lounge	WF	App	<1.0	4/25/2025				-
1008-2	Hallway by Faculty Lounge	BF	App	<1.0	4/25/2025				-
1009-1	Mens Bathroom by Faculty Lounge	SK	N/A		4/25/2025				Sign
1010-1	Faculty Lounge	SK	App	9.0	4/25/2025				Sign Posted
1010-2	Faculty Lounge	BF	App	2.0	4/25/2025				Sign
1011-1	Art Room by Faculty	SK	N/A		4/25/2025				Sign

Fixture #	Sample Location	Fixture Type	App or N/A	Latest 1 st Draw Results (ppb)	Latest 1st Draw Sampling Date	15 Second Draw Results (ppb)	60 Second Draw Results (ppb)	Flush Sampling Date	Remarks
1011-2	Art Room by Faculty	WF	N/A		4/25/2025				Removed From Service
1012-1	Room 20	SK	N/A		4/25/2025				Mixed Valve; Sign
1012-2	Room 20	WF	N/A		4/25/2025				Removed From Service
1013-1	Room 19	SK	N/A		4/25/2025				Mixed Valve; Sign
1013-2	Room 19	WF	N/A		4/25/2025				Removed From Service
1014-1	Room 18	SK	N/A		4/25/2025				Mixed Valve; Sign
1014-2	Room 18	WF	N/A		4/25/2025				Removed From Service
1015-1	Room 17	SK	N/A		4/25/2025				Mixed Valve; Sign
1015-2	Room 17	WF	N/A		4/25/2025				Removed From Service
1016-1	Room 16	SK	N/A		4/25/2025				Mixed Valve; Sign
1016-2	Room 16	WF	N/A		4/25/2025				Removed From Service
1017-1	Hallway by Room 10	WF	App	<1.0	4/25/2025				-
1017-2	Hallway by Room 10	BF	App	<1.0	4/25/2025				-
1018-1	Room 15	SK	N/A		4/25/2025				Mixed Valve; Sign
1018-2	Room 15	WF	N/A		4/25/2025				Removed From Service; Sign
1019-1	Room 14	SK	N/A		4/25/2025				Mixed Valve; Sign
1019-2	Room 14	WF	N/A		4/25/2025				Removed From Service; Sign
1020-1	Room 13	SK	N/A		4/25/2025				Mixed Valve; Sign

Fixture #	Sample Location	Fixture Type	App or N/A	Latest 1 st Draw Results (ppb)	Latest 1st Draw Sampling Date	15 Second Draw Results (ppb)	60 Second Draw Results (ppb)	Flush Sampling Date	Remarks
1020-2	Room 13	WF	N/A		4/25/2025				Removed From Service; Sign
1021-1	Room 12	SK	N/A		4/25/2025				Mixed Valve; Sign
1021-2	Room 12	WF	N/A		4/25/2025				Removed From Service; Sign
1022-1	Room 11	SK	N/A		4/25/2025				Mixed Valve; Sign
1022-2	Room 11	WF	N/A		4/25/2025				Removed From Service; Sign
1023-1	Room 10	SK	N/A		4/25/2025				Mixed Valve; Sign
1023-2	Room 10	WF	N/A		4/25/2025				Removed From Service; Sign
2001-1	Room 110	SK	N/A		4/25/2025				Mixed Valve; Sign
2001-2	Room 110	WF	N/A		4/25/2025				Removed From Service; Sign
2002-1	Room 111	SK	N/A		4/25/2025				Mixed Valve; Sign
2002-2	Room 111	WF	N/A		4/25/2025				Removed From Service; Sign
2003-1	Custodial Closet Across From Room 116	SS	N/A		4/25/2025				Sign
2004-1	Room 112	SK	N/A		4/25/2025				Mixed Valve; Sign
2004-2	Room 112	WF	N/A		4/25/2025				Removed From Service; Sign
2005-1	Room 113	SK	N/A		4/25/2025				Mixed Valve; Sign
2005-2	Room 113	WF	N/A		4/25/2025				Removed From Service; Sign
2006-1	Room 114	SK	N/A		4/25/2025				Mixed Valve; Sign
2006-2	Room 114	WF	N/A		4/25/2025				Removed From Service; Sign

Fixture #	Sample Location	Fixture Type	App or N/A	Latest 1 st Draw Results (ppb)	Latest 1st Draw Sampling Date	15 Second Draw Results (ppb)	60 Second Draw Results (ppb)	Flush Sampling Date	Remarks
2007-1	Room 115	SK	N/A		4/25/2025				Mixed Valve; Sign
2007-2	Room 115	WF	N/A		4/25/2025				Removed From Service; Sign
2008-1	Room 116	SK	N/A		4/25/2025				Mixed Valve; Sign
2008-2	Room 116	WF	N/A		4/25/2025				Removed From Service; Sign
2009-1	Hallway by Room 111	WF	App	<1.0	4/25/2025				-
2009-2	Hallway by Room 111	BF	App	<1.0	4/25/2025				-
2010-1	Room 117	SK	N/A		4/25/2025				Mixed Valve; Sign
2010-2	Room 117	WF	N/A		4/25/2025				Removed From Service; Sign
3001-1	Portable Nurse's Office	SK	App	3.0	4/25/2025				-
3001-2	Portable Nurse's Office	BF	App		4/25/2025				Non-Functional
3001-3	Portable Nurse's Office Bathroom	SK	N/A		4/25/2025				Sign
3001-4	Portable Nurse's Office Storage Closet	SS	N/A		4/25/2025				Sign

Laboratory Report

NYE Report #: 2501818-33126

April 28, 2025

Project Manager
Enviroscience Consultants, Inc.
2150 Smithtown Avenue
Ronkonkoma, NY 11779

Project: Glen Cove School District; Gribbin Elementary School

Dear Project Manager,

Enclosed is the Laboratory Analytical Report for potable water sample(s) received on April 25, 2025. New York Environmental analyzed the samples on April 28, 2025 for Lead (Pb) by EPA Method 200.9 Rev. 2.2.

If there are any questions regarding the analyses, please feel free to contact us at your convenience. New York Environmental is a NELAP accredited laboratory. Attached reported results meet the requirements of the NELAP standards unless otherwise noted.

Samples' analytical results relate only to the samples tested, in the condition received by the laboratory. This report shall not be reproduced except in its entirety without written approval of the laboratory.

We sincerely thank you for your business, and look forward to being of service for your future environmental testing needs.

Sincerely,



Li Tsang, Laboratory Director

Date Collected:	25 Apr 2025
Date Received:	25 Apr 2025
Date Analyzed:	28 Apr 2025

Analytical Method:	EPA 200.9 Rev. 2.2
Analyte, Matrix:	Lead, Potable Water

Lab ID	CID	Sample Location/Description	LOQ	Result	Units	Flag
250425Q019	1	Faculty Lounge-SK, Initial	0.001	0.009	mg/L	H
250425Q020	2	Faculty Lounge-SPY, Initial	0.001	0.002	mg/L	
250425Q021	3	Kitchen-SK, Initial	0.001	0.003	mg/L	
250425Q022	4	Hallway By Faculty Lounge-BF, Initial	0.001	<0.001	mg/L	
250425Q023	5	Hallway By Faculty Lounge-WF, Initial	0.001	<0.001	mg/L	
250425Q024	6	Hallway by Room 10-BF, Initial	0.001	<0.001	mg/L	
250425Q025	7	Hallway by Room 10-WF, Initial	0.001	<0.001	mg/L	
250425Q026	8	Hallway by Room 111-BF, Initial	0.001	<0.001	mg/L	
250425Q027	9	Hallway by Room 111-WF, Initial	0.001	<0.001	mg/L	
250425Q028	10	Portable Nurse's Office -SK, Initial	0.001	0.003	mg/L	

Comment:

CID: Client ID LOQ: Limit of Quantitation

H: Sample result exceeds applicable regulatory limit.

Appendix D
Landing Elementary School

Fixture #	Sample Location	Fixture Type	App or N/A	Latest 1 st Draw Results (ppb)	Latest 1st Draw Sampling Date	15 Second Draw Results (ppb)	60 Second Draw Results (ppb)	Flush Sampling Date	Remarks
0001-1	Room 005 Bathroom	SK	N/A		4/24/2025	-	-	-	Mixed Valve; Sign
0002-1	Room 002 Bathroom	SK	N/A		4/24/2025	-	-	-	Mixed Valve; Sign
0003-1	Boiler Room	SS	N/A		4/24/2025	-	-	-	Sign
0004-1	Art Room 001-2 Bay Unit Left	SK	N/A		4/24/2025	-	-	-	Mixed Valve; Sign
0004-2	Art Room 001-2 Bay Unit Right	SK	N/A		4/24/2025	-	-	-	Mixed Valve; Sign
1001-1	Kitchen-Handwash	SK	N/A		4/24/2025	-	-	-	Mixed Valve; Sign
1001-2	By Serving Line	BF	App	<1.0	3/3/2025	-	-	-	-
1001-3	By Serving Line	WF	App	<1.0	3/3/2025	-	-	-	-
1002-1	STEM Room 120-2 Bay Unit Left	SK	N/A		4/24/2025	-	-	-	Mixed Valve; Sign
1002-2	STEM Room 120-2 Bay Unit Right	SK	N/A		4/24/2025	-	-	-	Sign
1003-1	Room 114	SK	N/A		4/24/2025	-	-	-	Mixed Valve; Sign
1004-1	Faculty Bathroom by Room 119	SK	N/A		4/24/2025	-	-	-	Mixed Valve; Sign
1005-1	Room 115 Bathroom	SK	N/A		4/24/2025	-	-	-	Mixed Valve; Sign
1006-1	Room 116	SK	N/A		4/24/2025	-	-	-	Mixed Valve; Sign
1007-1	Room 119	SK	N/A		4/24/2025	-	-	-	Mixed Valve; Sign
1008-1	Custodial Closet by Custodial Office	SS	N/A		4/24/2025	-	-	-	Sign
1009-1	Girl's Bathroom by Custodial Office Left	SK	N/A		4/24/2025	-	-	-	Mixed Valve; Sign
1009-2	Girl's Bathroom by Custodial Office Right	SK	N/A		4/24/2025	-	-	-	Mixed Valve; Sign

Fixture #	Sample Location	Fixture Type	App or N/A	Latest 1 st Draw Results (ppb)	Latest 1st Draw Sampling Date	15 Second Draw Results (ppb)	60 Second Draw Results (ppb)	Flush Sampling Date	Remarks
1010-1	Hallway by First Floor Girl's Bathroom	BF	App	<1.0	4/24/2025	-	-	-	-
1010-2	Hallway by First Floor Girl's Bathroom	WF	App	<1.0	4/24/2025	-	-	-	-
1011-1	Principal's Office Bathroom	SK	N/A		4/24/2025	-	-	-	Mixed Valve; Sign
1012-1	Hallway by Room 104	BF	App	<1.0	4/24/2025	-	-	-	-
1012-2	Hallway by Room 104	WF	App	<1.0	4/24/2025	-	-	-	-
1013-1	Old Nurse's Bathroom	SK	N/A		4/24/2025	-	-	-	Mixed Valve; Sign
1014-1	Boy's Bathroom by Room 106 Left	SK	N/A		4/24/2025	-	-	-	Mixed Valve; Sign
1014-2	Boy's Bathroom by Room 106 Right	SK	N/A		4/24/2025	-	-	-	Mixed Valve; Sign
1015-1	Custodial Closet by Room 106	SS	N/A		4/24/2025	-	-	-	Sign
1016-1	Hallway by Room 114	BF	App	<1.0	4/24/2025	-	-	-	-
1016-2	Hallway by Room 114	WF	App	<1.0	2/24/2025	-	-	-	-
2001-1	Boy's Bathroom by Room 206 Left	SK	N/A		4/24/2025	-	-	-	Mixed Valve; Sign
2001-2	Boy's Bathroom by Room 206 Right	SK	N/A		4/24/2025	-	-	-	Mixed Valve; Sign
2002-1	Custodial Closet by Room 206	SS	N/A		4/24/2025	-	-	-	Sign
2003-1	Hallway by Room 206	BF	App	<1.0	4/24/2025	-	-	-	-
2003-2	Hallway by Room 206	WF	App	<1.0	4/24/2025	-	-	-	-
2004-1	Room 207	SK	N/A		4/24/2025	-	-	-	Mixed Valve; Sign
2005-1	Room 204	SK	N/A		4/24/2025	-	-	-	Mixed Valve; Sign

Fixture #	Sample Location	Fixture Type	App or N/A	Latest 1 st Draw Results (ppb)	Latest 1st Draw Sampling Date	15 Second Draw Results (ppb)	60 Second Draw Results (ppb)	Flush Sampling Date	Remarks
2006-1	Faculty Room 203 Bathroom	SK	N/A		4/24/2025	-	-	-	Mixed Valve; Sign
2006-2	Faculty Room 203 Kitchenette	SK	App	16.0	4/24/2025				Sign Posted
2006-3	Faculty Room 203 Kitchenette	SPY	App	8.0	4/24/4025				Sign Posted
2007-1	Girl's Bathroom by Room 202 Left	SK	N/A		4/24/2025	-	-	-	Mixed Valve; Sign
2007-2	Girl's Bathroom by Room 202 Right	SK	N/A		4/24/2025	-	-	-	Mixed Valve; Sign
2007-3	Girl's Bathroom Custodial Closet	SS	N/A		4/24/2025	-	-	-	Sign
2008-1	Hallway by Room 202	BF	App	<1.0	4/24/2025	-	-	-	-
2008-2	Hallway by Room 202	WF	App	<1.0	4/24/2025	-	-	-	-
3001-1	Portable - Nurse's Office	SK	N/A		4/24/2025	-	-	-	Mixed Valve; Sign
3001-2	Portable - Nurse's Office	BF	App	<1.0	4/24/2025	-	-	-	-
3001-3	Portable - Nurse's Office Bathroom	SK	N/A		4/24/2025	-	-	-	Mixed Valve; Sign
3001-4	Portable - Nurse's Office Custodial Closet	SK	N/A		4/24/2025	-	-	-	Sign

Laboratory Report

NYE Report #: 2500777-32505

March 4, 2025

Project Manager
Enviroscience Consultants, Inc.
2150 Smithtown Avenue
Ronkonkoma, NY 11779

Project: Glen Cove City School District; Landing Elementary School

Dear Project Manager,

Enclosed is the Laboratory Analytical Report for potable water sample(s) received on March 03, 2025. New York Environmental analyzed the samples on March 04, 2025 for Lead (Pb) by EPA Method 200.9 Rev. 2.2.

If there are any questions regarding the analyses, please feel free to contact us at your convenience. New York Environmental is a NELAP accredited laboratory. Attached reported results meet the requirements of the NELAP standards unless otherwise noted.

Samples' analytical results relate only to the samples tested, in the condition received by the laboratory. This report shall not be reproduced except in its entirety without written approval of the laboratory.

We sincerely thank you for your business, and look forward to being of service for your future environmental testing needs.

Sincerely,



Li Tsang, Laboratory Director

Date Collected:	03 Mar 2025
Date Received:	03 Mar 2025
Date Analyzed:	04 Mar 2025

Analytical Method:	EPA 200.9 Rev. 2.2
Analyte, Matrix:	Lead, Potable Water

<u>Lab ID</u>	<u>CID</u>	<u>Sample Location/Description</u>	<u>LOQ</u>	<u>Result</u>	<u>Units</u>	<u>Flag</u>
250303J001	1	By Serving Line - BF, Initial	0.001	<0.001	mg/L	
250303J002	2	By Serving Line - WF, Initial	0.001	<0.001	mg/L	

Comment:

CID: Client ID LOQ: Limit of Quantitation

Laboratory Report

NYE Report #: 2501820-33128

April 28, 2025

Project Manager
Enviroscience Consultants, Inc.
2150 Smithtown Avenue
Ronkonkoma, NY 11779

Project: Glen Cove School District; Landing Elementary School

Dear Project Manager,

Enclosed is the Laboratory Analytical Report for potable water sample(s) received on April 25, 2025. New York Environmental analyzed the samples on April 28, 2025 for Lead (Pb) by EPA Method 200.9 Rev. 2.2.

If there are any questions regarding the analyses, please feel free to contact us at your convenience. New York Environmental is a NELAP accredited laboratory. Attached reported results meet the requirements of the NELAP standards unless otherwise noted.

Samples' analytical results relate only to the samples tested, in the condition received by the laboratory. This report shall not be reproduced except in its entirety without written approval of the laboratory.

We sincerely thank you for your business, and look forward to being of service for your future environmental testing needs.

Sincerely,

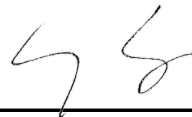

Li Tsang, Laboratory Director

Date Collected:	24 Apr 2025
Date Received:	25 Apr 2025
Date Analyzed:	28 Apr 2025

Analytical Method:	EPA 200.9 Rev. 2.2
Analyte, Matrix:	Lead, Potable Water

Lab ID	CID	Sample Location/Description	LOQ	Result	Units	Flag
250425Q033	1	Hallway by Room 114-BF, Initial	0.001	<0.001	mg/L	
250425Q034	2	Hallway by Room 114-WF, Initial	0.001	<0.001	mg/L	
250425Q035	3	Hallway By First Floor Girl's Bathroom-BF, Initial	0.001	<0.001	mg/L	
250425Q036	4	Hallway By First Floor Girl's Bathroom-WF, Initial	0.001	<0.001	mg/L	
250425Q037	5	Hallway by Room 104-BF, Initial	0.001	<0.001	mg/L	
250425Q038	6	Hallway by Room 104-WF, Initial	0.001	<0.001	mg/L	
250425Q039	7	Hallway By Room 206-BF, Initial	0.001	<0.001	mg/L	
250425Q040	8	Hallway By Room 206-WF, Initial	0.001	<0.001	mg/L	
250425Q041	9	Faculty Room 203 Kitchenette-SK, Initial	0.001	0.016	mg/L	H
250425Q042	10	Faculty Room 203 Kitchenette-SPY, Initial	0.001	0.008	mg/L	H
250425Q043	11	Hallway by Room 202-BF, Initial	0.001	<0.001	mg/L	
250425Q044	12	Hallway by Room 202-WF, Initial	0.001	<0.001	mg/L	
250425Q045	13	Portable - Nurses Office-BF, Initial	0.001	<0.001	mg/L	

Comment:

CID: Client ID LOQ: Limit of Quantitation

H: Sample result exceeds applicable regulatory limit.

Appendix E

R. M. Finley Middle School

Fixture #	Sample Location	Fixture Type	App or N/A	Latest 1 st Draw Results (ppb)	Latest 1 st Draw Sampling Date	15 Second Draw Results (ppb)	60 Second Draw Results (ppb)	Flush Sampling Date	Remarks
0001-1	Lower Level Auditorium Dressing Room-East	SK	N/A		4/23/2025				Sign
0001-2	Lower Level Auditorium Dressing Room-East Bathroom	SK	N/A		4/23/2025				Sign
0002-1	Lower Level Auditorium Dressing Room-West	SK	N/A		4/23/2025				Sign
0002-2	Lower Level Auditorium Dressing Room-West Bathroom	SK	N/A		4/23/2025				Sign
1001-1	Kitchen-Dishwash-2 Bay Unit-Left	SK	N/A		4/23/2025				Sign
1001-2	Kitchen-Dishwash-2 Bay Unit-Right	SK	N/A		4/23/2025				Sign
1001-3	Kitchen-Handwash	SK	N/A		4/23/2025				Mixed Valve; Sign
1001-4	Kitchen-2 Bay Unit-Left	SK	N/A		4/23/2025				Sign
1001-5	Kitchen-2 Bay Unit-Right	SK	N/A		4/23/2025				Sign
1001-6	Kitchen-Single Unit-Dishwash	SK	N/A		4/23/2025				Sign
1001-7	Kitchen-Custodial Closet	SS	N/A		4/23/2025				Sign
1001-8	Kitchen-Bathroom	SK	N/A		4/23/2025				Sign
1001-9	Kitchen-Left Prep by Oven	SK	App	24.0	5/1/2025	4.0	3.0	5/1/2025	Removed From Service; Pending Remediation
				14.0	4/23/2025	-	-	-	Removed From Service; Pending Remediation
1001-10	Kitchen-Right Prep by Freezer	SK	App	38.0	5/1/2025	5.0	3.0	5/1/2025	Removed From Service; Pending Remediation
				18.0	4/23/2025	-	-	-	Removed From Service; Pending Remediation
1001-11	Kitchen-Pot Filler-Left	PF	App	4.0	5/1/2025	-	-	-	Aerator Cleaned; Remediaton Complete
				8.0	4/23/2025	-	-	-	Removed From Service; Pending Remediation
1001-12	Kitchen-Pot Filler-Right	PF	App	2.0	5/1/2025	-	-	-	Aerator Cleaned; Remediaton Complete
				10.0	4/23/2025	-	-	-	Removed From Service; Pending Remediation

Fixture #	Sample Location	Fixture Type	App or N/A	Latest 1 st Draw Results (ppb)	Latest 1st Draw Sampling Date	15 Second Draw Results (ppb)	60 Second Draw Results (ppb)	Flush Sampling Date	Remarks
1001-13	Serving Area-Left (Closest to Kitchen)	SK	N/A		4/23/2025				Sign
1001-14	Serving Area-Right (Closest to Dishwash Area)	SK	N/A		4/23/2025				Sign
1001-15	Kitchen Potfiller on Stove	SK	App	10.0	5/1/2025	<1.0	<1.0	5/1/2025	Removed From Service; Pending Remediation
1001-16	Kitchen Prep by Slicer	SK	App	2.0	5/2/2025				
1002-1	Cafeteria by Kitchen	BF	App	<1.0	4/23/2025				-
1002-2	Cafeteria by Kitchen	WF	App	<1.0	4/23/2025				-
1003-1	Cafeteria by Faculty Room	BF	App	<1.0	4/23/2025				-
1003-2	Cafeteria by Faculty Room	WF	App	<1.0	4/23/2025				-
1004-1	Vestibule to Faculty Room	SK	N/A		4/23/2025				Sign
1005-1	Women's Bathroom by Faculty Room	SK	N/A		4/23/2025				Mixed Valve; Sign
1006-1	Men's Bathroom by Faculty Room	SK	N/A		4/23/2025				Mixed Valve; Sign
1007-1	Custodial Closet in Cafeteria	SS	N/A		4/23/2025				Sign
1008-1	Teacher's Association Office Bathroom	SK	N/A		4/23/2025				Sign
1009-1	Girl's Bathroom in Cafeteria	SK	N/A		4/23/2025				Mixed Valve; Sign
1010-1	Boy's Bathroom in Cafeteria	SK	N/A		4/23/2025				Sign
1011-1	Lower Gym	WF	App		4/23/2025				Non-functional; Sampling Required
1012-1	Lower Gym-Storage	SS	N/A		4/23/2025				Sign
1013-2	Women's Bathroom by Room 502-Middle	SK	N/A		4/23/2025				Mixed Valve; Sign
1013-3	Women's Bathroom by Room 502-Right	SK	N/A		4/23/2025				Mixed Valve; Sign
1014-1	Custodial Closet by Room 502	SS	N/A		4/23/2025				Sign

Fixture #	Sample Location	Fixture Type	App or N/A	Latest 1 st Draw Results (ppb)	Latest 1st Draw Sampling Date	15 Second Draw Results (ppb)	60 Second Draw Results (ppb)	Flush Sampling Date	Remarks
1015-1	Men's Bathroom by Room 502-Left	SK	N/A		4/23/2025				Mixed Valve; Sign
1015-2	Men's Bathroom by Room 502-Right	SK	N/A		4/23/2025				Mixed Valve; Sign
1016-1	Hallway by Room 502	BF	App	<1.0	4/23/2025				-
1016-2	Hallway by Room 502	WF	App	<1.0	4/23/2025				-
1017-1	Room 502-Science Room	SK	N/A		4/23/2025				Sign
1018-1	Hallway by Room 504	WF	App		4/23/2025				Non-functional; Sampling Required
1019-1	Hallway by Room 307-Left	WF	App	<1.0	4/23/2025				-
1019-2	Hallway by Room 307-Right	BF	App	<1.0	4/23/2025				-
1019-3	Hallway by Room 307-Right	WF	App	<1.0	4/23/2025				-
1020-1	Boy's Bathroom by Room 307-Left	SK	N/A		4/23/2025				Mixed Valve; Sign
1020-2	Boy's Bathroom by Room 307-Left Middle	SK	N/A		4/23/2025				Mixed Valve; Sign
1020-3	Boy's Bathroom by Room 307-Right Middle	SK	N/A		4/23/2025				Mixed Valve; Sign
1020-4	Boy's Bathroom by Room 307-Right	SK	N/A		4/23/2025				Mixed Valve; Sign
1021-1	Custodial Closet by Room 307	SS	N/A		4/23/2025				Sign
1022-1	Girl's Bathroom by Room 307-Left	SK	N/A		4/23/2025				Mixed Valve; Sign
1022-2	Girl's Bathroom by Room 307-Left Middle	SK	N/A		4/23/2025				Mixed Valve; Sign
1022-3	Girl's Bathroom by Room 307-Right Middle	SK	N/A		4/23/2025				Mixed Valve; Sign
1022-4	Girl's Bathroom by Room 307-Right	SK	N/A		4/23/2025				Mixed Valve; Sign
1023-1	Cafeteria Handwash @ A	SK	N/A		4/23/2025				Mixed Valve; Sign
1023-2	Cafeteria Handwash @ B	SK	N/A		4/23/2025				Mixed Valve; Sign

Fixture #	Sample Location	Fixture Type	App or N/A	Latest 1 st Draw Results (ppb)	Latest 1st Draw Sampling Date	15 Second Draw Results (ppb)	60 Second Draw Results (ppb)	Flush Sampling Date	Remarks
1023-3	Cafeteria Handwash @ C	SK	N/A		4/23/2025				Mixed Valve; Sign
1024-1	Room 303-Teacher's Station	SK	N/A		4/23/2025				Sign
1025-1	Room 304-Teacher's Station	SK	N/A		4/23/2025				Sign
1025-2	Room 304-Counter @A	SK	N/A		4/23/2025				Sign
1025-3	Room 304-Counter @B	SK	N/A		4/23/2025				Sign
1025-4	Room 304-Counter @C	SK	N/A		4/23/2025				Sign
1025-5	Room 304-Prep	SK	N/A		4/23/2025				Sign
1026-1	Room 305-Teacher's Station	SK	N/A		4/23/2025				Sign
1026-2	Room 305-Counter @A	SK	N/A		4/23/2025				Sign
1026-3	Room 305-Counter @B	SK	N/A		4/23/2025				Sign
1026-4	Room 305-Counter @C	SK	N/A		4/23/2025				Sign
1026-5	Room 305-Prep	SK	N/A		4/23/2025				Sign
1027-1	Room 306-Teacher's Station	SK	N/A		4/23/2025				Sign
1028-1	Hallway by Room 119-near Security	BF	App	<1.0	4/23/2025				-
1028-2	Hallway by Room 119-near Security	WF	App	<1.0	4/23/2025				-
1029-1	Girl's Bathroom by Room 117-Left	SK	N/A		4/23/2025				Mixed Valve; Sign
1029-2	Girl's Bathroom by Room 117-Middle	SK	N/A		4/23/2025				Mixed Valve; Sign
1030-1	Hallway by Room 114	WF	App		4/23/2025				Non-functional; Sampling Required
1031-1	Room 114-2 Bay Unit 1 -Left	SK	N/A		4/23/2025				Sign
1031-2	Room 114-2 Bay Unit 1 -Right	SK	N/A		4/23/2025				Sign

Fixture #	Sample Location	Fixture Type	App or N/A	Latest 1 st Draw Results (ppb)	Latest 1st Draw Sampling Date	15 Second Draw Results (ppb)	60 Second Draw Results (ppb)	Flush Sampling Date	Remarks
1031-3	Room 114-2 Bay Unit 2 -Left	SK	N/A		4/23/2025				Sign
1031-4	Room 114-2 Bay Unit 2 -Right	SK	N/A		4/23/2025				Sign
1032-1	Room 115-Life Skills-Left	SK	App	2.0	4/23/2025				-
1032-2	Room 115-Life Skills-Right	SK	App	2.0	4/23/2025				-
1033-1	Room 114B-Counter	SK	N/A		4/23/2025				Sign
1033-2	Room 114B-Single Unit-Left	SK	N/A		4/23/2025				Sign
1033-3	Room 114B-Single Unit-Right	SK	N/A		4/23/2025				Sign
1034-1	Home & Career @ A Handwash	SK	N/A		4/23/2025				Sign
1034-2	Home & Career @ B Dishwash	SK	N/A		4/23/2025				Sign
1034-3	Home & Career @ C	SK	App	<1.0	4/23/2025				-
1034-4	Home & Career @ C	OS	App	<1.0	4/23/2025				-
1034-5	Home & Career @ D	SK	App	2.0	4/23/2025				-
1035-1	Room 113-Tech Room-2 Bay Unit-Left	SK	N/A		4/23/2025				Sign
1035-2	Room 113-Tech Room-2 Bay Unit-Right	SK	N/A		4/23/2025				Sign
1036-1	Hallway by Main Office	BF	App	<1.0	4/23/2025				-
1036-2	Hallway by Main Office	WF	App	<1.0	4/23/2025				-
1037-1	Men's Bathroom by Room 110-Left	SK	N/A		4/23/2025				Mixed Valve; Sign
1037-2	Men's Bathroom by Room 110-Middle	SK	N/A		4/23/2025				Mixed Valve; Sign
1037-3	Men's Bathroom by Room 110-Right	SK	N/A		4/23/2025				Mixed Valve; Sign
1038-1	Room 101	SK	N/A		4/23/2025				Sign

Fixture #	Sample Location	Fixture Type	App or N/A	Latest 1 st Draw Results (ppb)	Latest 1 st Draw Sampling Date	15 Second Draw Results (ppb)	60 Second Draw Results (ppb)	Flush Sampling Date	Remarks
1039-1	Garage by Room 103	SS	N/A		4/23/2025				Sign
1040-1	Custodial Closet by Room 101	SS	N/A		4/23/2025				Sign
1041-1	Main Office Bathroom	SK	N/A		4/23/2025				Mixed Valve; Sign
1042-1	Principal's Office Bathroom	SK	N/A		4/23/2025				Mixed Valve; Sign
1043-1	Assistant Principal's Office Bathroom	SK	N/A		4/23/2025				Mixed Valve; Sign
1044-1	Room 116-Nurse's Office	SK	App	<1.0	4/23/2025				-
1044-2	Room 116-Nurse's Office Bathroom	SK	N/A		4/23/2025				Mixed Valve; Sign
1045-1	Custodial Closet by Room 121	SS	N/A		4/23/2025				Sign
1046-1	Women's Bathroom by Main Lobby-Left	SK	N/A		4/23/2025				Mixed Valve; Sign
1046-2	Women's Bathroom by Main Lobby-Right	SK	N/A		4/23/2025				Mixed Valve; Sign
1047-1	Men's Bathroom by Main Lobby-Left	SK	N/A		4/23/2025				Mixed Valve; Sign
1047-2	Men's Bathroom by Main Lobby-Right	SK	N/A		4/23/2025				Mixed Valve; Sign
1048-1	Custodial Closet by Main Lobby	SS	N/A		4/23/2025				Sign
1049-1	Room 126-Band Room	SK	N/A		4/23/2025				Sign
1050-1	Hallway by Auditorium	BF	App	<1.0	4/23/2025				-
1050-2	Hallway by Auditorium	WF	App	<1.0	4/23/2025				-
1051-1	Special Education Dept. Boys Bathroom @ A	SK	N/A		4/23/2025				Mixed Valve; Sign
1051-2	Special Education Dept. Boys Bathroom @ B	SK	N/A		4/23/2025				Mixed Valve; Sign
1051-3	Special Education Dept. Boys Bathroom @ C	SK	N/A		4/23/2025				Mixed Valve; Sign
1052-1	Special Education Dept. Custodial Closet	SS	N/A		4/23/2025				Sign

Fixture #	Sample Location	Fixture Type	App or N/A	Latest 1 st Draw Results (ppb)	Latest 1 st Draw Sampling Date	15 Second Draw Results (ppb)	60 Second Draw Results (ppb)	Flush Sampling Date	Remarks
1053-1	Special Education Dept. Hallway	BF	App	<1.0	4/23/2025				-
1053-2	Special Education Dept. Hallway	WF	App	<1.0	4/23/2025				-
1054-1	Special Education Dept. Girls Bathroom @ A	SK	N/A		4/23/2025				Mixed Valve; Sign
1054-2	Special Education Dept. Girls Bathroom @ B	SK	N/A		4/23/2025				Mixed Valve; Sign
1054-3	Special Education Dept. Girls Bathroom @ C	SK	N/A		4/23/2025				Mixed Valve; Sign
2001-1	Upper Gym	BF	App	<1.0	4/23/2025				-
2001-2	Upper Gym	WF	App	<1.0	4/23/2025				-
2002-1	Upper Gym-Custodial Closet	IM	N/A		4/23/2025				Sign
2002-2	Upper Gym-Custodial Closet	SS	N/A		4/23/2025				Sign
2003-1	Girl's Locker Room Office Bathroom	SK	N/A		4/23/2025				Mixed Valve; Sign
2003-1	Girl's Locker Room	BF	App	<1.0	4/23/2025				-
2003-2	Girl's Locker Room	WF	App	<1.0	4/23/2025				-
2003-3	Girl's Locker Room Bathroom-Left	SK	N/A		4/23/2025				Sign
2003-4	Girl's Locker Room Bathroom-Middle	SK	N/A		4/23/2025				Mixed Valve; Sign
2003-5	Girl's Locker Room Bathroom-Right	SK	N/A		4/23/2025				Sign
2004-1	Boy's Locker Room Office Bathroom	SK	N/A		4/23/2025				Mixed Valve; Sign
2004-2	Boy's Locker Room	BF	App	<1.0	4/23/2025				-
2004-3	Boy's Locker Room	WF	App	<1.0	4/23/2025				-
2004-4	Boy's Locker Room Bathroom-Left	SK	N/A		4/23/2025				Sign
2004-5	Boy's Locker Room Bathroom-Middle	SK	N/A		4/23/2025				Sign

Fixture #	Sample Location	Fixture Type	App or N/A	Latest 1 st Draw Results (ppb)	Latest 1st Draw Sampling Date	15 Second Draw Results (ppb)	60 Second Draw Results (ppb)	Flush Sampling Date	Remarks
2004-6	Boy's Locker Room Bathroom-Right	SK	N/A		4/23/2025				Mixed Valve; Sign
2005-1	Girl's Bathroom by Room 604-Left	SK	N/A		4/23/2025				Mixed Valve; Sign
2005-2	Girl's Bathroom by Room 604-Middle	SK	N/A		4/23/2025				Mixed Valve; Sign
2005-3	Girl's Bathroom by Room 604-Right	SK	N/A		4/23/2025				Mixed Valve; Sign
2006-1	Custodial Closet by Room 604	SS	N/A		4/23/2025				Sign
2007-1	Boy's Bathroom by Room 604-Left	SK	N/A		4/23/2025				Mixed Valve; Sign
2007-2	Boy's Bathroom by Room 604-Right	SK	N/A		4/23/2025				Mixed Valve; Sign
2008-1	Hallway by Room 604-Left	WF	App		4/23/2025				Non-functional; Sampling Required
2009-1	Hallway by Room 604-Right	BF	App	<1.0	4/23/2025				-
2009-2	Hallway by Room 604-Right	WF	App	<1.0	4/23/2025				-
2010-1	Room 608	SK	N/A		4/23/2025				-
2011-1	Hallway by Room 407	BF	App	<1.0	4/23/2025				-
2011-2	Hallway by Room 407	WF	App	<1.0	4/23/2025				-
2012-1	Boy's Bathroom by Room 407-Left	SK	N/A		4/23/2025				Under Renovation
2012-2	Boy's Bathroom by Room 407-Left Middle	SK	N/A		4/23/2025				Under Renovation
2012-4	Boy's Bathroom by Room 407-Right	SK	N/A		4/23/2025				Under Renovation
2013-1	Custodial Closet by Room 407	SS	N/A		4/23/2025				Under Renovation
2014-1	Girl's Bathroom by Room 407-Left	SK	N/A		4/23/2025				Under Renovation
2014-2	Girl's Bathroom by Room 407-Left Middle	SK	N/A		4/23/2025				Under Renovation
2014-3	Girl's Bathroom by Room 407-Right Middle	SK	N/A		4/23/2025				Under Renovation

Fixture #	Sample Location	Fixture Type	App or N/A	Latest 1 st Draw Results (ppb)	Latest 1st Draw Sampling Date	15 Second Draw Results (ppb)	60 Second Draw Results (ppb)	Flush Sampling Date	Remarks
2014-4	Girl's Bathroom by Room 407-Right	SK	N/A		4/23/2025				Under Renovation
2016-1	Room 404-Teacher's Station	SK	N/A		4/23/2025				Sign
2016-2	Room 404-Counter @A	SK	N/A		4/23/2025				Sign
2016-3	Room 404-Counter @B	SK	N/A		4/23/2025				Sign
2016-4	Room 404-Counter @C	SK	N/A		4/23/2025				Sign
2016-5	Room 404-Prep Room	SK	N/A		4/23/2025				Sign
2017-1	Room 405-Teacher's Station	SK	N/A		4/23/2025				Sign
2017-2	Room 405-Counter @A	SK	N/A		4/23/2025				Sign
2017-3	Room 405-Counter @B	SK	N/A		4/23/2025				Sign
2017-4	Room 405-Counter @C	SK	N/A		4/23/2025				Sign
2017-5	Room 405-Prep Room	SK	N/A		4/23/2025				Sign
2018-1	Hallway by Room 213	BF	App	<1.0	4/23/2025				-
2018-2	Hallway by Room 213	WF	App	<1.0	4/23/2025				-
2019-1	Room 211B	SK	N/A		4/23/2025				Sign
2020-1	Boy's Bathroom by Room 211A-Left	SK	N/A		4/23/2025				Mixed Valve; Sign
2020-2	Boy's Bathroom by Room 211A-Right	SK	N/A		4/23/2025				Mixed Valve; Sign
2021-1	Girl's Bathroom by Room 209-Left	SK	N/A		4/23/2025				Mixed Valve; Sign
2021-2	Girl's Bathroom by Room 209-Middle	SK	N/A		4/23/2025				Mixed Valve; Sign
2021-3	Girl's Bathroom by Room 209-Right	SK	N/A		4/23/2025				Mixed Valve; Sign
2022-1	Custodial Closet by Room 209	SS	N/A		4/23/2025				Sign

Fixture #	Sample Location	Fixture Type	App or N/A	Latest 1 st Draw Results (ppb)	Latest 1st Draw Sampling Date	15 Second Draw Results (ppb)	60 Second Draw Results (ppb)	Flush Sampling Date	Remarks
2023-1	Hallway by Room 201	BF	App	<1.0	4/23/2025				-
2023-2	Hallway by Room 202	WF	App	<1.0	4/23/2025				-
2024-1	Room 202-Counter @A	SK	N/A		4/23/2025				Sign
2024-2	Room 202-Counter @B	SK	N/A		4/23/2025				Sign
2024-3	Room 202-Counter @C	SK	N/A		4/23/2025				Sign
2025-1	Faculty Lounge	SK	App	4.0	4/23/2025				-
2025-2	Faculty Lounge Bathroom	SK	N/A		4/23/2025				Mixed Valve; Sign
2026-1	Room 220 Bathroom	SK	N/A		4/23/2025				Mixed Valve; Sign
2027-1	Custodial Closet by Room 221	SS	N/A		4/23/2025				Sign
2028-1	Unisex Bathroom by Room 221-Left	SK	N/A		4/23/2025				Mixed Valve; Sign
2028-2	Unisex Bathroom by Room 221-Middle	SK	N/A		4/23/2025				Mixed Valve; Sign
2028-3	Unisex Bathroom by Room 221-Right	SK	N/A		4/23/2025				Mixed Valve; Sign
2029-1	Room 218	SK	N/A		4/23/2025				Sign

Laboratory Report

NYE Report #: 2501726-33083

April 28, 2025

Project Manager
Enviroscience Consultants, Inc.
2150 Smithtown Avenue
Ronkonkoma, NY 11779

Project: Glen Cove School District; RM Finley Middle School

Dear Project Manager,

Enclosed is the Laboratory Analytical Report for potable water sample(s) received on April 24, 2025. New York Environmental analyzed the samples on April 25, 2025 for Lead (Pb) by EPA Method 200.9 Rev. 2.2.

If there are any questions regarding the analyses, please feel free to contact us at your convenience. New York Environmental is a NELAP accredited laboratory. Attached reported results meet the requirements of the NELAP standards unless otherwise noted.

Samples' analytical results relate only to the samples tested, in the condition received by the laboratory. This report shall not be reproduced except in its entirety without written approval of the laboratory.

We sincerely thank you for your business, and look forward to being of service for your future environmental testing needs.

Sincerely,



Li Tsang, Laboratory Director

Date Collected:	23 Apr 2025
Date Received:	24 Apr 2025
Date Analyzed:	25 Apr 2025

Analytical Method:	EPA 200.9 Rev. 2.2
Analyte, Matrix:	Lead, Potable Water

Lab ID	CID	Sample Location/Description	LOQ	Result	Units	Flag
250424L001	1	Kitchen-Left Prep by Oven-SK, Initial	0.001	0.014	mg/L	H
250424L002	2	Kitchen-Right Prep by Freezer-SK, Initial	0.001	0.018	mg/L	H
250424L003	3	Kitchen-Pot Filler-Left-PF, Initial	0.001	0.008	mg/L	H
250424L004	4	Kitchen-Pot Filler-Right-PF, Initial	0.001	0.010	mg/L	H
250424L005	5	Cafeteria by Kitchen-BF, Initial	0.001	<0.001	mg/L	
250424L006	6	Cafeteria by Kitchen-WF, Initial	0.001	<0.001	mg/L	
250424L007	7	Cafeteria by Faculty Room-BF, Initial	0.001	<0.001	mg/L	
250424L008	8	Cafeteria by Faculty Room-WF, Initial	0.001	<0.001	mg/L	
250424L009	9	Hallway by Room 502-BF, Initial	0.001	<0.001	mg/L	
250424L010	10	Hallway by Room 502-WF, Initial	0.001	<0.001	mg/L	
250424L011	11	Hallway by Room 307-Left-WF, Initial	0.001	<0.001	mg/L	
250424L012	12	Hallway by Room 307-Right-BF, Initial	0.001	<0.001	mg/L	
250424L013	13	Hallway by Room 307-Right-WF, Initial	0.001	<0.001	mg/L	
250424L014	14	Hallway by Room 119-near Security-BF, Initial	0.001	<0.001	mg/L	
250424L015	15	Hallway by Room 119-near Security-WF, Initial	0.001	<0.001	mg/L	
250424L016	16	Room 115-Life Skills-Left-SK, Initial	0.001	0.002	mg/L	
250424L017	17	Room 115-Life Skills-Right-SK, Initial	0.001	0.002	mg/L	
250424L018	18	Home & Career @ C-SK, Initial	0.001	<0.001	mg/L	
250424L019	19	Home & Career @ C- water filter-OS, Initial	0.001	<0.001	mg/L	
250424L020	20	Home & Career @D-SK, Initial	0.001	0.002	mg/L	
250424L021	21	Hallway by Main Office-BF, Initial	0.001	<0.001	mg/L	
250424L022	22	Hallway by Main Office-WF, Initial	0.001	<0.001	mg/L	
250424L023	23	Room 116-Nurse's Office-SK, Initial	0.001	<0.001	mg/L	
250424L024	24	Hallway by Auditorium-BF, Initial	0.001	<0.001	mg/L	
250424L025	25	Hallway by Auditorium-WF, Initial	0.001	<0.001	mg/L	
250424L026	26	Upper Gym-BF, Initial	0.001	<0.001	mg/L	



Date Collected:	23 Apr 2025
Date Received:	24 Apr 2025
Date Analyzed:	25 Apr 2025

Analytical Method:	EPA 200.9 Rev. 2.2
Analyte, Matrix:	Lead, Potable Water

Lab ID	CID	Sample Location/Description	LOQ	Result	Units	Flag
250424L027	27	Upper Gym-WF, Initial	0.001	<0.001	mg/L	
250424L028	28	Girl's Locker Room-BF, Initial	0.001	<0.001	mg/L	
250424L029	29	Girl's Locker Room-WF, Initial	0.001	<0.001	mg/L	
250424L030	30	Boy's Locker Room -BF, Initial	0.001	<0.001	mg/L	
250424L031	31	Boy's Locker Room -WF, Initial	0.001	<0.001	mg/L	
250424L032	32	Hallway by Room 604-Right-BF, Initial	0.001	<0.001	mg/L	
250424L033	33	Hallway by Room 604-Right-WF, Initial	0.001	<0.001	mg/L	
250424L034	34	Hallway by Room 407-BF, Initial	0.001	<0.001	mg/L	
250424L035	35	Hallway by Room 407-WF, Initial	0.001	<0.001	mg/L	
250424L036	36	Hallway by Room 213-BF, Initial	0.001	<0.001	mg/L	
250424L037	37	Hallway by Room 213-WF, Initial	0.001	<0.001	mg/L	
250424L038	38	Hallway by Room 201-BF, Initial	0.001	<0.001	mg/L	
250424L039	39	Hallway by Room 202-WF, Initial	0.001	<0.001	mg/L	
250424L040	40	Faculty Lounge-SK, Initial	0.001	0.004	mg/L	
250424L041	41	Hallway of Special Education Department-BF, Initial	0.001	<0.001	mg/L	
250424L042	42	Hallway of Special Education Department-WF, Initial	0.001	<0.001	mg/L	

Comment:

CID: Client ID LOQ: Limit of Quantitation

H: Sample result exceeds applicable regulatory limit.



Laboratory Report

NYE Report #: 2501903-33184

May 5, 2025

Project Manager
Enviroscience Consultants, Inc.
2150 Smithtown Avenue
Ronkonkoma, NY 11779

Project: Glen Cove School District; RM Finley Middle School

Dear Project Manager,

Enclosed is the Laboratory Analytical Report for potable water sample(s) received on May 01, 2025. New York Environmental analyzed the samples on May 02, 2025 for Lead (Pb) by EPA Method 200.9 Rev. 2.2.

If there are any questions regarding the analyses, please feel free to contact us at your convenience. New York Environmental is a NELAP accredited laboratory. Attached reported results meet the requirements of the NELAP standards unless otherwise noted.

Samples' analytical results relate only to the samples tested, in the condition received by the laboratory. This report shall not be reproduced except in its entirety without written approval of the laboratory.

We sincerely thank you for your business, and look forward to being of service for your future environmental testing needs.

Sincerely,



Li Tsang, Laboratory Director

Date Collected:	01 May 2025
Date Received:	01 May 2025
Date Analyzed:	02 May 2025

Analytical Method:	EPA 200.9 Rev. 2.2
Analyte, Matrix:	Lead, Potable Water

Lab ID	CID	Sample Location/Description	LOQ	Result	Units	Flag
250501J022	1A	Kitchen - Left Prep by Oven-SK, Initial	0.001	0.024	mg/L	H
250501J023	1B	Kitchen - Left Prep by Oven-SK, 15 Second Draw	0.001	0.004	mg/L	
250501J024	1C	Kitchen - Left Prep by Oven-SK, 60 Second Draw	0.001	0.003	mg/L	
250501J025	2A	Kitchen - Right Prep by Freezer-SK, Initial	0.001	0.038	mg/L	H
250501J026	2B	Kitchen - Right Prep by Freezer-SK, 15 Second Draw	0.001	0.005	mg/L	
250501J027	2C	Kitchen - Right Prep by Freezer-SK, 60 Second Draw	0.001	0.003	mg/L	
250501J028	3A	Kitchen - Potfiller - Left-PF, Initial	0.001	0.004	mg/L	
250501J029	3B	Kitchen - Potfiller - Left-PF, 15 Second Draw	0.001	NA	mg/L	
250501J030	3C	Kitchen - Potfiller - Left-PF, 60 Second Draw	0.001	NA	mg/L	
250501J031	4A	Kitchen - Potfiller - Right-PF, Initial	0.001	0.002	mg/L	
250501J032	4B	Kitchen - Potfiller - Right-PF, 15 Second Draw	0.001	NA	mg/L	
250501J033	4C	Kitchen - Potfiller - Right-PF, 60 Second Draw	0.001	NA	mg/L	
250501J034	5A	Kitchen - Potfiller on Stove-PF, Initial	0.001	0.010	mg/L	H
250501J035	5B	Kitchen - Potfiller on Stove-PF, 15 Second Draw	0.001	<0.001	mg/L	
250501J036	5C	Kitchen - Potfiller on Stove-PF, 60 Second Draw	0.001	<0.001	mg/L	

Comment:

CID: Client ID LOQ: Limit of Quantitation

NA: Sample not analyzed per customer request.

H: Sample result exceeds applicable regulatory limit.



Laboratory Report

NYE Report #: 2501949-33226

May 6, 2025

Project Manager
Enviroscience Consultants, Inc.
2150 Smithtown Avenue
Ronkonkoma, NY 11779

Project: Glen Cove Ufsd; Rm Finley Middle School

Dear Project Manager,

Enclosed is the Laboratory Analytical Report for potable water sample(s) received on May 02, 2025. New York Environmental analyzed the samples on May 06, 2025 for Lead (Pb) by EPA Method 200.9 Rev. 2.2.

If there are any questions regarding the analyses, please feel free to contact us at your convenience. New York Environmental is a NELAP accredited laboratory. Attached reported results meet the requirements of the NELAP standards unless otherwise noted.

Samples' analytical results relate only to the samples tested, in the condition received by the laboratory. This report shall not be reproduced except in its entirety without written approval of the laboratory.

We sincerely thank you for your business, and look forward to being of service for your future environmental testing needs.

Sincerely,



Li Tsang, Laboratory Director

Date Collected:	02 May 2025
Date Received:	02 May 2025
Date Analyzed:	06 May 2025

Analytical Method:	EPA 200.9 Rev. 2.2
Analyte, Matrix:	Lead, Potable Water

<u>Lab ID</u>	<u>CID</u>	<u>Sample Location/Description</u>	<u>LOQ</u>	<u>Result</u>	<u>Units</u>	<u>Flag</u>
250502P011	1A	Prep SK by Slicer Opp, Kettles 'A' - SK, Initial	0.001	0.002	mg/L	
250502P012	1B	Prep SK by Slicer Opp, Kettles 'B' - SK, 15 Second Draw	0.001	NA	mg/L	
250502P013	1C	Prep SK by Slicer Opp, Kettles 'C' - SK, 60 Second Draw	0.001	NA	mg/L	

Comment:

CID: Client ID LOQ: Limit of Quantitation

NA: Sample not analyzed per customer request.

Appendix F
Glen Cove High School and Administration

Fixture #	Sample Location	Fixture Type	App or N/A	Latest 1 st Draw Results (ppb)	Latest 1st Draw Sampling Date	15 Second Draw Results (ppb)	60 Second Draw Results (ppb)	Flush Sampling Date	Remarks
1001-01	Kitchen Bathroom	SK	N/A		4/23/2025	-	-	-	Sign
1001-02	Kitchen 2-Bay-Food Prep	SK	App	172.0	5/1/2025	10.0	5.0	5/1/2025	Removed From Service; Pending Remediation
				233.0	4/23/2025				Removed From Service; Pending Remediation
1001-03	Kitchen	IM	App	3.0	4/23/2025	-	-	-	-
1001-04	Kitchen by Dishwash	SK	N/A		4/23/2025	-	-	-	Sign
1001-05	Kitchen Dishwash	SPY	N/A		4/23/2025	-	-	-	Sign
1001-06	Kitchen Dishwash Machine	OS	N/A		4/23/2025	-	-	-	Sign
1001-07	Kitchen Handwash	SK	N/A		4/23/2025	-	-	-	Sign
1001-08	Kitchen 3-Bay Dishwash Left	SK	N/A		4/23/2025	-	-	-	Sign
1001-09	Kitchen 2-Bay Dishwash Right	SK	N/A		4/23/2025	-	-	-	Sign
1001-10	Kitchen Island-Food Prep	SK	App	16.0	5/1/2025	3.0	2.0	5/1/2025	Removed From Service; Pending Remediation
				27.0	4/23/2025				Removed From Service; Pending Remediation
1001-11	Kitchen Potfiller Right	PF/SPY	App	3.0	5/1/2025	-	-	-	Aerator Cleaned; Remediation Complete
				10.0	4/23/2025				Removed From Service; Pending Remediation
1001-12	Kitchen Potfiller Left	PF	App	3.0	5/1/2025	-	-	-	
				2.0	4/23/2025	-	-	-	
1001-13	Kitchen Steamer	SPY	App	94.0	5/1/2025	4.0	1.0	5/1/2025	Removed From Service; Pending Remediation
				74.0	4/23/2025				Removed From Service; Pending Remediation
1001-14	Kitchen Coffee Maker Supply Line	OS	App	13.0	5/1/2025	3.0	2.0	5/1/2025	Removed From Service; Pending Remediation
				18.0	4/23/2025				Removed From Service; Pending Remediation

Fixture #	Sample Location	Fixture Type	App or N/A	Latest 1 st Draw Results (ppb)	Latest 1st Draw Sampling Date	15 Second Draw Results (ppb)	60 Second Draw Results (ppb)	Flush Sampling Date	Remarks
1002-01	Boy's Bathroom 156 by Cafeteria 2	SK	N/A		4/23/2025	-	-	-	Mixed Valve; Sign
1003-01	Custodial Locker Room	IM	App		4/23/2025				Non-Functional; Sampling Required
1003-02	Custodial Locker Room	SS	App	5.0	4/23/2025	-	-	-	-
1004-01	Girl's Bathroom 159 by Cafeteria 2 Left	SK	N/A		4/23/2025	-	-	-	Mixed Valve; Sign
1004-02	Girl's Bathroom 159 by Cafeteria 2 Right	SK	N/A		4/23/2025	-	-	-	Mixed Valve; Sign
1005-1	Hall by Gym	BF	App	<1.0	4/23/2025	-	-	-	-
1005-02	Hall by Gym	WF	App	<1.0	4/23/2025	-	-	-	-
1006-01	Boy's Locker Room 160 Left	WF	App	<1.0	4/23/2025	-	-	-	-
1006-02	Boy's Locker Room 160 Right	WF	App	<1.0	4/23/2025	-	-	-	-
1006-03	Boy's Locker Room Bathroom 160 Left	SK	N/A		4/23/2025	-	-	-	Mixed Valve; Sign
1006-04	Boy's Locker Room Bathroom 160 Middle	SK	N/A		4/23/2025	-	-	-	Mixed Valve; Sign
1006-05	Boy's Locker Room Bathroom 160 Right	SK	N/A		4/23/2025	-	-	-	Mixed Valve; Sign
1006-06	Boy's Locker Room Coach's Office Bathroom	SK	N/A		4/23/2025	-	-	-	Mixed Valve; Sign
1006-07	Boy's Locker Room Custodial Closet	SS	N/A		4/23/2025	-	-	-	Mixed Valve; Sign
1007-1	Rear Boy's Locker Room	BF	App	<1.0	4/23/2025	-	-	-	-
1007-02	Rear Boy's Locker Room	WF	App	<1.0	4/23/2025	-	-	-	-
1008-01	Girl's Locker Room 170 Left	BF	App	<1.0	4/23/2025	-	-	-	-
1008-02	Girl's Locker Room 170 Left	WF	App	<1.0	4/23/2025	-	-	-	-
1008-03	Girl's Locker Room 170 Right	WF	App	5.0	4/23/2025	-	-	-	-
1008-04	Girl's Locker Room 170 Bathroom Left	SK	N/A		4/23/2025	-	-	-	Sign

Fixture #	Sample Location	Fixture Type	App or N/A	Latest 1 st Draw Results (ppb)	Latest 1st Draw Sampling Date	15 Second Draw Results (ppb)	60 Second Draw Results (ppb)	Flush Sampling Date	Remarks
1008-05	Girl's Locker Room 170 Bathroom Right	SK	N/A		4/23/2025	-	-	-	Sign
1008-06	Girl's Locker Room	BF	App	<1.0	4/23/2025	-	-	-	-
1008-07	Girl's Locker Room	WF	App	<1.0	4/23/2025	-	-	-	-
1008-08	Trainer's Room	SK	N/A		4/23/2025	-	-	-	Mixed Valve; Sign
1009-01	Girl's Coach's Bathroom	SK	N/A		4/23/2025	-	-	-	Mixed Valve; Sign
1010-01	Hall by Storage 132B	BF	App	<1.0	4/23/2025	-	-	-	-
1010-02	Hall by Storage 132B	WF	App	<1.0	4/23/2025	-	-	-	-
1011-01	Art Room 132 Unit 1 Left	SK	N/A		4/23/2025	-	-	-	Sign
1011-02	Art Room 132 Unit 1 Middle	SK	N/A		4/23/2025	-	-	-	Sign
1011-03	Art Room 132 Unit 1 Right	SK	N/A		4/23/2025	-	-	-	Sign
1011-04	Art Room 132 Unit 2 Left	SK	N/A		4/23/2025	-	-	-	Sign
1011-05	Art Room 132 Unit 2 Middle	SK	N/A		4/23/2025	-	-	-	Sign
1011-06	Art Room 132 Unit 2 Right	SK	N/A		4/23/2025	-	-	-	Sign
1012-01	Art Room 134 Unit 1 Left	SK	N/A		4/23/2025	-	-	-	Sign
1012-02	Art Room 134 Unit 1 Middle	SK	N/A		4/23/2025	-	-	-	Sign
1012-03	Art Room 134 Unit 1 Right	SK	N/A		4/23/2025	-	-	-	Sign
1012-04	Art Room 134 Unit 2 Left	SK	N/A		4/23/2025	-	-	-	Sign
1012-05	Art Room 134 Unit 2 Middle	SK	N/A		4/23/2025	-	-	-	Sign
1012-06	Art Room 134 Unit 2 Right	SK	N/A		4/23/2025	-	-	-	Sign
1013-01	Art Room 143 Counter Left	SK	N/A		4/23/2025	-	-	-	Sign

Fixture #	Sample Location	Fixture Type	App or N/A	Latest 1 st Draw Results (ppb)	Latest 1st Draw Sampling Date	15 Second Draw Results (ppb)	60 Second Draw Results (ppb)	Flush Sampling Date	Remarks
1013-02	Art Room 143 Counter Right	SK	N/A		4/23/2025	-	-	-	Sign
1014-01	Faculty Bathroom 134B Left	SK	N/A		4/23/2025	-	-	-	Mixed Valve; Sign
1014-02	Faculty Bathroom 134B Right	SK	N/A		4/23/2025	-	-	-	Mixed Valve; Sign
1015-01	Women's Faculty Bathroom 134A Left	SK	N/A		4/23/2025	-	-	-	Mixed Valve; Sign
1015-02	Women's Faculty Bathroom 134A Right	SK	N/A		4/23/2025	-	-	-	Mixed Valve; Sign
1016-01	Room 138 Unit Left	SK	N/A		4/23/2025	-	-	-	Sign
1016-02	Room 138 Unit Right	SK	N/A		4/23/2025	-	-	-	Sign
1017-01	Custodial Closet 152	SS	N/A		4/23/2025	-	-	-	Sign
1018-01	Bathroom 152B	SK	N/A		4/23/2025	-	-	-	Sign
1019-01	Hall by Main Office	BF	App	<1.0	4/23/2025	-	-	-	-
1019-02	Hall by Main Office	WF	App	<1.0	4/23/2025	-	-	-	-
1020-01	Main Office Bathroom	SK	N/A		4/23/2025	-	-	-	Mixed Valve; Sign
1020-02	Main Office Women's Bathroom	SK	N/A		4/23/2025	-	-	-	Mixed Valve; Sign
1021-01	Hall by Room 103	BF	App	<1.0	4/23/2025	-	-	-	-
1021-02	Hall by Room 103	WF	App	<1.0	4/23/2025	-	-	-	-
1022-01	Men's Faculty Bathroom by Room 100A	SK	N/A		4/23/2025	-	-	-	Mixed Valve; Sign
1023-01	Girl's Bathroom by Room 100A Unit	SK	N/A		4/23/2025	-	-	-	Mixed Valve; Sign
1024-01	Women's Faculty Bathroom by Room 100B	SK	N/A		4/23/2025	-	-	-	Mixed Valve; Sign
1025-01	Boy's Bathroom by Room 100B Unit	SK	N/A		4/23/2025	-	-	-	Mixed Valve; Sign
1026-01	Nurse's Office 100A	SK	App	<1.0	4/23/2025	-	-	-	Aerator Cleaned; Remediation Complete

Fixture #	Sample Location	Fixture Type	App or N/A	Latest 1 st Draw Results (ppb)	Latest 1st Draw Sampling Date	15 Second Draw Results (ppb)	60 Second Draw Results (ppb)	Flush Sampling Date	Remarks
1026-01	Nurse's Office 100A	SK	App	107.0	4/23/2025				Removed From Service; Pending Remediation
1026-02	Nurse's Office 100A Bathroom	SK	N/A		4/23/2025	-	-	-	Mixed Valve; Sign
1026-03	Nurse's Office Ice Machine	IM	App	2.0	5/2/2025				
1027-01	Custodial Closet 119B	SS	N/A		4/23/2025	-	-	-	Sign
1028-01	Hall by Room 123	BF	App	1.0	4/23/2025	-	-	-	-
1028-02	Hall by Room 123	WF	App	<1.0	4/23/2025	-	-	-	-
1029-01	Room 130 Left	SK	N/A		4/23/2025	-	-	-	Sign
1029-02	Room 130 Right	SK	N/A		4/23/2025	-	-	-	Sign
1030-01	Boy's Bathroom 130A by Room 131 (Left)	SK	N/A		4/23/2025	-	-	-	Mixed Valve; Sign
1030-02	Boy's Bathroom 130A by Room 131 (Right)	SK	N/A		4/23/2025	-	-	-	Mixed Valve; Sign
1031-01	Custodial Closet 130B	SS	N/A		4/23/2025	-	-	-	Sign
1032-01	Girl's Bathroom 130C Left	SK	N/A		4/23/2025	-	-	-	Mixed Valve; Sign
1032-02	Girl's Bathroom 130C Left Middle	SK	N/A		4/23/2025	-	-	-	Mixed Valve; Sign
1032-03	Girl's Bathroom 130C Right Middle	SK	N/A		4/23/2025	-	-	-	Mixed Valve; Sign
1032-04	Girl's Bathroom 130C Right	SK	N/A		4/23/2025	-	-	-	Mixed Valve; Sign
1033-01	Hall by Room 139 Orchestra	BF	App	<1.0	4/23/2025	-	-	-	-
1033-02	Hall by Room 139 Orchestra	WF	App	<1.0	4/23/2025	-	-	-	-
2001-01	Hall by Room 202	BF	App	<1.0	4/23/2025	-	-	-	-
2001-02	Hall by Room 202	WF	App	<1.0	4/23/2025	-	-	-	-
2002-01	Custodial Closet 204A	SS	N/A		4/23/2025	-	-	-	Sign

Fixture #	Sample Location	Fixture Type	App or N/A	Latest 1 st Draw Results (ppb)	Latest 1st Draw Sampling Date	15 Second Draw Results (ppb)	60 Second Draw Results (ppb)	Flush Sampling Date	Remarks
2003-01	Men's Faculty Bathroom by Faculty Room 213A Left	SK	N/A		4/23/2025	-	-	-	Mixed Valve; Sign
2003-02	Men's Faculty Bathroom by Faculty Room 213A Right	SK	N/A		4/23/2025	-	-	-	Mixed Valve; Sign
2004-01	Women's Faculty Bathroom by Faculty Room 213A Left	SK	N/A		4/23/2025	-	-	-	Mixed Valve; Sign
2004-02	Women's Faculty Bathroom by Faculty Room 213A Right	SK	N/A		4/23/2025	-	-	-	Mixed Valve; Sign
2005-01	Faculty Room 213A	SK	App	10.0	4/23/2025				Sign Posted
2006-01	Custodial Closet 219B	SS	N/A		4/23/2025	-	-	-	Sign
2007-01	Room 220 Teacher's Station	SK	N/A		4/23/2025	-	-	-	Sign
2007-02	Room 220 Counter 1 @ A	SK	N/A		4/23/2025	-	-	-	Sign
2007-03	Room 220 Counter 1 @ B	SK	N/A		4/23/2025	-	-	-	Sign
2007-04	Room 220 Counter 1 @ C	SK	N/A		4/23/2025	-	-	-	Sign
2007-05	Room 220 Counter 1 @ A	SK	N/A		4/23/2025	-	-	-	Sign
2007-06	Room 220 Counter 1 @ B	SK	N/A		4/23/2025	-	-	-	Sign
2007-07	Room 220 Counter 1 @ C	SK	N/A		4/23/2025	-	-	-	Sign
2007-08	Room 220 Counter 3	SK	N/A		4/23/2025	-	-	-	Sign
2008-01	Room 221 Teacher's Station	SK	N/A		4/23/2025	-	-	-	Sign
2008-02	Room 221 Counter 1 @ A	SK	N/A		4/23/2025	-	-	-	Sign
2008-03	Room 221 Counter 1 @ B	SK	N/A		4/23/2025	-	-	-	Sign
2008-04	Room 221 Counter 1 @ C	SK	N/A		4/23/2025	-	-	-	Sign
2009-01	Room 222 Teacher's Station	SK	N/A		4/23/2025	-	-	-	Sign
2009-02	Room 222 Counter	SK	N/A		4/23/2025	-	-	-	Sign

Fixture #	Sample Location	Fixture Type	App or N/A	Latest 1 st Draw Results (ppb)	Latest 1st Draw Sampling Date	15 Second Draw Results (ppb)	60 Second Draw Results (ppb)	Flush Sampling Date	Remarks
2009-03	Room 222 Pod 1 @ A	SK	N/A		4/23/2025	-	-	-	Sign
2009-04	Room 222 Pod 1 @ B	SK	N/A		4/23/2025	-	-	-	Sign
2009-05	Room 222 Pod 2 @ A	SK	N/A		4/23/2025	-	-	-	Sign
2009-06	Room 222 Pod 2 @ B	SK	N/A		4/23/2025	-	-	-	Sign
2009-07	Room 222 Pod 3 @ A	SK	N/A		4/23/2025	-	-	-	Sign
2009-08	Room 222 Pod 3 @ B	SK	N/A		4/23/2025	-	-	-	Sign
2009-09	Room 222 Prep Room	SK	N/A		4/23/2025	-	-	-	Sign
2010-01	Room 223 Teacher's Station	SK	N/A		4/23/2025	-	-	-	Sign
2010-02	Room 223 Counter 1 @ A	SK	N/A		4/23/2025	-	-	-	Sign
2010-03	Room 223 Counter 1 @ B	SK	N/A		4/23/2025	-	-	-	Sign
2010-04	Room 223 Counter 1 @ C	SK	N/A		4/23/2025	-	-	-	Sign
2011-01	Room 225	SS	N/A		4/23/2025	-	-	-	Sign
2011-02	Room 224	SS	N/A		4/23/2025	-	-	-	Sign
2012-01	Hall by Room 224	BF	App	<1.0	4/23/2025	-	-	-	-
2012-02	Hall by Room 224	WF	App	<1.0	4/23/2025	-	-	-	-
2013-01	Room 225 Teacher's Station	SK	N/A		4/23/2025	-	-	-	Sign
2013-02	Room 225 Counter	SK	N/A		4/23/2025	-	-	-	Sign
2013-03	Room 225 Pod 1 @ A	SK	N/A		4/23/2025	-	-	-	Sign
2013-04	Room 225 Pod 1 @ B	SK	N/A		4/23/2025	-	-	-	Sign
2013-05	Room 225 Pod 2 @ A	SK	N/A		4/23/2025	-	-	-	Sign

Fixture #	Sample Location	Fixture Type	App or N/A	Latest 1 st Draw Results (ppb)	Latest 1st Draw Sampling Date	15 Second Draw Results (ppb)	60 Second Draw Results (ppb)	Flush Sampling Date	Remarks
2013-06	Room 225 Pod 2 @ B	SK	N/A		4/23/2025	-	-	-	Sign
2013-07	Room 225 Pod 3 @ A	SK	N/A		4/23/2025	-	-	-	Sign
2013-08	Room 225 Pod 3 @ B	SK	N/A		4/23/2025	-	-	-	Sign
2014-01	Room 226 Teacher's Station	SK	N/A		4/23/2025	-	-	-	Sign
2014-02	Room 226 Counter 1	SK	N/A		4/23/2025	-	-	-	Sign
2014-03	Room 226 Counter 2	SK	N/A		4/23/2025	-	-	-	Sign
2014-04	Room 226 Counter 3 @ A	SK	N/A		4/23/2025	-	-	-	Sign
2014-05	Room 226 Counter 3 @ B	SK	N/A		4/23/2025	-	-	-	Sign
2015-02	Room 227 Pod 1 @ A	SK	N/A		4/23/2025	-	-	-	Sign
2015-03	Room 227 Pod 1 @ B	SK	N/A		4/23/2025	-	-	-	Sign
2015-04	Room 227 Pod 2 @ A	SK	N/A		4/23/2025	-	-	-	Sign
2015-05	Room 227 Pod 2 @ B	SK	N/A		4/23/2025	-	-	-	Sign
2015-06	Room 227 Pod 3 @ A	SK	N/A		4/23/2025	-	-	-	Sign
2015-07	Room 227 Pod 3 @ B	SK	N/A		4/23/2025	-	-	-	Sign
2015-08	Room 227 Pod 4 @ A	SK	N/A		4/23/2025	-	-	-	Sign
2015-09	Room 227 Pod 4 @ B	SK	N/A		4/23/2025	-	-	-	Sign
2015-10	Room 227 Pod 5 @ A	SK	N/A		4/23/2025	-	-	-	Sign
2015-11	Room 227 Pod 5 @ B	SK	N/A		4/23/2025	-	-	-	Sign
2015-12	Room 227 Pod 6 @ A	SK	N/A		4/23/2025	-	-	-	Sign
2015-13	Room 227 Pod 6 @ B	SK	N/A		4/23/2025	-	-	-	Sign

Fixture #	Sample Location	Fixture Type	App or N/A	Latest 1 st Draw Results (ppb)	Latest 1st Draw Sampling Date	15 Second Draw Results (ppb)	60 Second Draw Results (ppb)	Flush Sampling Date	Remarks
2015-14	Prep Room 227 / 229	SK	N/A		4/23/2025	-	-	-	Sign
2016-01	Room 229 Teacher's Station	SK	N/A		4/23/2025	-	-	-	Sign
2016-02	Room 229 Counter	SK	N/A		4/23/2025	-	-	-	Sign
2016-03	Room 229 Pod 1 @ A	SK	N/A		4/23/2025	-	-	-	Sign
2016-04	Room 229 Pod 1 @ B	SK	N/A		4/23/2025	-	-	-	Sign
2016-05	Room 229 Pod 2 @ A	SK	N/A		4/23/2025	-	-	-	Sign
2016-06	Room 229 Pod 2 @ B	SK	N/A		4/23/2025	-	-	-	Sign
2016-07	Room 229 Pod 3 @ A	SK	N/A		4/23/2025	-	-	-	Sign
2016-08	Room 229 Pod 3 @ B	SK	N/A		4/23/2025	-	-	-	Sign
2016-09	Room 229 Pod 4 @ A	SK	N/A		4/23/2025	-	-	-	Sign
2016-10	Room 229 Pod 4 @ B	SK	N/A		4/23/2025	-	-	-	Sign
2017-01	Room 228A Fumehood	SK	N/A		4/23/2025	-	-	-	Sign
2017-02	Room 228A Counter 1	SK	N/A		4/23/2025	-	-	-	Sign
2017-03	Room 228A Counter 2	SK	N/A		4/23/2025	-	-	-	Sign
2018-01	Room 226 Teacher's Station	SK	N/A		4/23/2025	-	-	-	Sign
2018-02	Room 226 Counter 1 @ A	SK	N/A		4/23/2025	-	-	-	Sign
2018-03	Room 226 Counter 1 @ B	SK	N/A		4/23/2025	-	-	-	Sign
2018-04	Room 226 Counter 2	SK	N/A		4/23/2025	-	-	-	Sign
2018-05	Room 226 Counter 3 @ A	SK	N/A		4/23/2025	-	-	-	Sign
2018-06	Room 226 Counter 3 @ B	SK	N/A		4/23/2025	-	-	-	Sign

Fixture #	Sample Location	Fixture Type	App or N/A	Latest 1 st Draw Results (ppb)	Latest 1st Draw Sampling Date	15 Second Draw Results (ppb)	60 Second Draw Results (ppb)	Flush Sampling Date	Remarks
2019-01	Room 230	SK	N/A		4/23/2025	-	-	-	Sign
2020-01	Room 231 Teacher's Station	SK	N/A		4/23/2025	-	-	-	Sign
2020-02	Room 231 Counter @ A	SK	N/A		4/23/2025	-	-	-	Sign
2020-03	Room 231 Counter @ B	SK	N/A		4/23/2025	-	-	-	Sign
2020-04	Room 231 Prep Room	SK	N/A		4/23/2025	-	-	-	Sign
2021-01	Room 232	SS	N/A		4/23/2025	-	-	-	Removed From Service
2022-01	Custodial Closet 232B	SS	N/A		4/23/2025	-	-	-	Sign
2023-01	Hall by Room 234	BF	App	<1.0	4/23/2025	-	-	-	-
2023-02	Hall by Room 234	WF	App	<1.0	4/23/2025	-	-	-	-
2024-01	Library Office	SK	App	9.0	4/23/2025				Sign Posted
2025-01	Bathroom by Room 232 (Left)	SK	N/A		4/23/2025	-	-	-	Mixed Valve; Sign
2025-02	Bathroom by Room 232 (Middle)	SK	N/A		4/23/2025	-	-	-	Mixed Valve; Sign
2025-03	Bathroom by Room 232 (Right)	SK	N/A		4/23/2025	-	-	-	Mixed Valve; Sign
2026-01	Thayer House - Men's Bathroom	SK	N/A		4/23/2025				Sign
2026-02	Thayer House - Women's Bathroom	SK	N/A		4/23/2025				Sign
2026-03	Thayer House - Kitchen	SK	App	8.0	4/23/2025				Sign Posted
2026-04	Thayer House - Kitchen spigot	OS	App	<1.0	4/23/2025	-	-	-	-
2026-05	Thayer House - Superintendent's Bathroom	SK	N/A		4/23/2025	-	-	-	Sign
2026-06	Thayer House - Assistant Superintendent's Bathroom	SK	N/A		4/23/2025	-	-	-	Sign
2026-07	Thayer House - Attic Bathroom	SK	N/A		4/23/2025	-	-	-	Sign

Fixture #	Sample Location	Fixture Type	App or N/A	Latest 1 st Draw Results (ppb)	Latest 1st Draw Sampling Date	15 Second Draw Results (ppb)	60 Second Draw Results (ppb)	Flush Sampling Date	Remarks
2027-01	Carriage House - 1st Floor Bathroom	SK	N/A		4/23/2025	-	-	-	Mixed Valve; Sign
2027-02	Carriage House - 2nd Floor Bathroom	SK	N/A		4/23/2025	-	-	-	Mixed Valve; Sign
2028-01	Tennis Courts Office Bathroom	SK	N/A		4/23/2025				Sign
2028-02	Tennis Courts Women's Bathroom	SK	N/A		4/23/2025				0
2028-03	Tennis Courts Men's Bathroom	SK	N/A		4/23/2025				0
2028-04	Tennis Court	WF	App		4/23/2025				Off for winter; sampling required when returning to service
2029-01	Booster Club Kitchen	SK	App	5.0	4/23/2025	-	-	-	-
2029-02	Booster Club Boy's Bathroom	SK	N/A		4/23/2025	-	-	-	Sign
2029-03	Booster Club Girl's Bathroom	SK	N/A		4/23/2025	-	-	-	Sign

Laboratory Report

NYE Report #: 2501724-33081

April 28, 2025

Project Manager
Enviroscience Consultants, Inc.
2150 Smithtown Avenue
Ronkonkoma, NY 11779

Project: Glen Cove School District; Glen Cove High School

Dear Project Manager,

Enclosed is the Laboratory Analytical Report for potable water sample(s) received on April 24, 2025. New York Environmental analyzed the samples on April 25, 2025 for Lead (Pb) by EPA Method 200.9 Rev. 2.2.

If there are any questions regarding the analyses, please feel free to contact us at your convenience. New York Environmental is a NELAP accredited laboratory. Attached reported results meet the requirements of the NELAP standards unless otherwise noted.

Samples' analytical results relate only to the samples tested, in the condition received by the laboratory. This report shall not be reproduced except in its entirety without written approval of the laboratory.

We sincerely thank you for your business, and look forward to being of service for your future environmental testing needs.

Sincerely,



Li Tsang, Laboratory Director

Date Collected:	23 Apr 2025
Date Received:	24 Apr 2025
Date Analyzed:	25 Apr 2025

Analytical Method:	EPA 200.9 Rev. 2.2
Analyte, Matrix:	Lead, Potable Water

Lab ID	CID	Sample Location/Description	LOQ	Result	Units	Flag
250424K158	1	Kitchen 2-Bay-Food Prep-SK, Initial	0.001	0.233	mg/L	E,H
250424K159	2	Kitchen-IM, Initial	0.001	0.003	mg/L	
250424K160	3	Kitchen Island-Food Prep-SK, Initial	0.001	0.027	mg/L	H
250424K161	4	Kitchen Potfiller Right-PF/SPY, Initial	0.001	0.010	mg/L	H
250424K162	5	Kitchen Potfiller Left-PF, Initial	0.001	0.002	mg/L	
250424K163	6	Kitchen Steamer-SPY, Initial	0.001	0.074	mg/L	E,H
250424K164	7	Kitchen Coffee Maker Supply Line-OS, Initial	0.001	0.018	mg/L	H
250424K165	8	Hall by Gym-BF, Initial	0.001	<0.001	mg/L	
250424K166	9	Hall by Gym-WF, Initial	0.001	<0.001	mg/L	
250424K167	10	Custodial Locker Room-SS, Initial	0.001	0.005	mg/L	
250424K168	11	Boy's Locker Room 160 Left-WF, Initial	0.001	<0.001	mg/L	
250424K169	12	Boy's Locker Room 160 Right -BF, Initial	0.001	<0.001	mg/L	
250424K170	13	Boy's Locker Room 160 Right -WF, Initial	0.001	<0.001	mg/L	
250424K171	14	Rear Boy's Locker Room-BF, Initial	0.001	<0.001	mg/L	
250424K172	15	Rear Boy's Locker Room-WF, Initial	0.001	<0.001	mg/L	
250424K173	16	Girl's Locker Room 170 Left-BF, Initial	0.001	<0.001	mg/L	
250424K174	17	Girl's Locker Room 170 left-WF, Initial	0.001	<0.001	mg/L	
250424K175	18	Girl's Locker Room 170 right-WF, Initial	0.001	0.005	mg/L	
250424K176	19	Girl's Locker Room -BF, Initial	0.001	<0.001	mg/L	
250424K177	20	Girl's Locker Room -WF, Initial	0.001	<0.001	mg/L	
250424K178	21	Hall by Storage 132B-BF, Initial	0.001	<0.001	mg/L	
250424K179	22	Hall by Storage 132B-WF, Initial	0.001	<0.001	mg/L	
250424K180	23	Hall by Room 139 Orchestra-BF, Initial	0.001	<0.001	mg/L	
250424K181	24	Hall by Room 139 Orchestra-WF, Initial	0.001	<0.001	mg/L	
250424K182	25	Hall by Main Office-BF, Initial	0.001	<0.001	mg/L	
250424K183	26	Hall by Main Office-WF, Initial	0.001	<0.001	mg/L	



Date Collected:	23 Apr 2025
Date Received:	24 Apr 2025
Date Analyzed:	25 Apr 2025

Analytical Method:	EPA 200.9 Rev. 2.2
Analyte, Matrix:	Lead, Potable Water

Lab ID	CID	Sample Location/Description	LOQ	Result	Units	Flag
250424K184	27	Hall by Room 103-BF, Initial	0.001	<0.001	mg/L	
250424K185	28	Hall by Room 103-WF, Initial	0.001	<0.001	mg/L	
250424K186	29	Nurse's Office 100A-SK, Initial	0.001	0.107	mg/L	E,H
250424K187	30	Hall by Room 123-BF, Initial	0.001	0.001	mg/L	
250424K188	31	Hall by Room 123-WF, Initial	0.001	<0.001	mg/L	
250424K189	32	Hall by Room 202-BF, Initial	0.001	<0.001	mg/L	
250424K190	33	Hall by Room 202-WF, Initial	0.001	<0.001	mg/L	
250424K191	34	Faculty Room 213A-SK, Initial	0.001	0.010	mg/L	H
250424K192	35	Hall by Room 224-BF, Initial	0.001	<0.001	mg/L	
250424K193	36	Hall by Room 224-WF, Initial	0.001	<0.001	mg/L	
250424K194	37	Hall by Room 234-BF, Initial	0.001	<0.001	mg/L	
250424K195	38	Hall by Room 234-WF, Initial	0.001	<0.001	mg/L	
250424K196	39	Library Office-SK, Initial	0.001	0.009	mg/L	H
250424K197	40	Thayer House - Kitchen-SK, Initial	0.001	0.008	mg/L	H
250424K198	41	Thayer House - Kitchen spigot-OS, Initial	0.001	<0.001	mg/L	
250424K199	42	Booster Club Kitchen-SK, Initial	0.001	0.005	mg/L	

Comment:

CID: Client ID LOQ: Limit of Quantitation

E: Sample result exceeds instrument calibration, value is estimated.

H: Sample result exceeds applicable regulatory limit.



Laboratory Report (Revised)

NYE Report #: 2501901-33182R

May 5, 2025

Project Manager
Enviroscience Consultants, Inc.
2150 Smithtown Avenue
Ronkonkoma, NY 11779

Project: Glen Cove School District; Glen Cove High School

Dear Project Manager,

Enclosed is the Laboratory Analytical Report for potable water sample(s) received on May 01, 2025. New York Environmental analyzed the samples on May 02, 2025 for Lead (Pb) by EPA Method 200.9 Rev. 2.2.

If there are any questions regarding the analyses, please feel free to contact us at your convenience. New York Environmental is a NELAP accredited laboratory. Attached reported results meet the requirements of the NELAP standards unless otherwise noted.

Samples' analytical results relate only to the samples tested, in the condition received by the laboratory. This report shall not be reproduced except in its entirety without written approval of the laboratory.

We sincerely thank you for your business, and look forward to being of service for your future environmental testing needs.

Sincerely,



Li Tsang, Laboratory Director

Date Collected:	01 May 2025
Date Received:	01 May 2025
Date Analyzed:	02 May 2025

Analytical Method:	EPA 200.9 Rev. 2.2
Analyte, Matrix:	Lead, Potable Water

Lab ID	CID	Sample Location/Description	LOQ	Result	Units	Flag
250501J001	1A	Kitchen - 2 Bay - Food Prep - SK, Initial	0.001	0.172	mg/L	E,H
250501J002	1B	Kitchen - 2 Bay - Food Prep - SK, 15 Second Draw	0.001	0.010	mg/L	H
250501J003	1C	Kitchen - 2 Bay - Food Prep - SK, 60 Second Draw	0.001	0.005	mg/L	
250501J004	2A	Kitchen Island - Food Prep - SK, Initial	0.001	0.016	mg/L	H
250501J005	2B	Kitchen Island - Food Prep - SK, 15 Second Draw	0.001	0.003	mg/L	
250501J006	2C	Kitchen Island - Food Prep - SK, 60 Second Draw	0.001	0.002	mg/L	
250501J007	3A	Kitchen Pot Filler - Right - PF, Initial	0.001	0.004	mg/L	
250501J008	3B	Kitchen Pot Filler - Right - PF, 15 Second Draw	0.001	NA	mg/L	
250501J009	3C	Kitchen Pot Filler - Right - PF, 60 Second Draw	0.001	NA	mg/L	
250501J010	4A	Kitchen Pot Filler - Left - PF, Initial	0.001	0.003	mg/L	
250501J011	4B	Kitchen Pot Filler - Left - PF, 15 Second Draw	0.001	NA	mg/L	
250501J012	4C	Kitchen Pot Filler - Left - PF, 60 Second Draw	0.001	NA	mg/L	
250501J013	5A	Kitchen Coffee Maker Supply Line - OS, Initial	0.001	0.013	mg/L	H
250501J014	5B	Kitchen Coffee Maker Supply Line - OS, 15 Second Draw	0.001	0.003	mg/L	
250501J015	5C	Kitchen Coffee Maker Supply Line - OS, 60 Second Draw	0.001	0.002	mg/L	
250501J016	6A	Kitchen Steamer - SPY, Initial	0.001	0.094	mg/L	E,H
250501J017	6B	Kitchen Steamer - SPY, 15 Second Draw	0.001	0.004	mg/L	
250501J018	6C	Kitchen Steamer - SPY, 60 Second Draw	0.001	0.001	mg/L	

Comment:

CID: Client ID LOQ: Limit of Quantitation

NA: Sample not analyzed per customer request.

E: Sample result exceeds instrument calibration, value is estimated.

H: Sample result exceeds applicable regulatory limit.

Revision History:

Report revised on 5/5/2025, replaces report generated on 5/5/2025 at 10:27am.

- Result for Lab ID 250501J009 removed



Laboratory Report

NYE Report #: 2501948-33225

May 6, 2025

Project Manager
Enviroscience Consultants, Inc.
2150 Smithtown Avenue
Ronkonkoma, NY 11779

Project: Glen Cove Ufsd; Glen Cove Hs

Dear Project Manager,

Enclosed is the Laboratory Analytical Report for potable water sample(s) received on May 02, 2025. New York Environmental analyzed the samples on May 06, 2025 for Lead (Pb) by EPA Method 200.9 Rev. 2.2.

If there are any questions regarding the analyses, please feel free to contact us at your convenience. New York Environmental is a NELAP accredited laboratory. Attached reported results meet the requirements of the NELAP standards unless otherwise noted.

Samples' analytical results relate only to the samples tested, in the condition received by the laboratory. This report shall not be reproduced except in its entirety without written approval of the laboratory.

We sincerely thank you for your business, and look forward to being of service for your future environmental testing needs.

Sincerely,

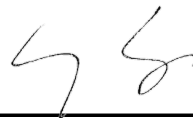

Li Tsang, Laboratory Director

Date Collected:	02 May 2025
Date Received:	02 May 2025
Date Analyzed:	06 May 2025

Analytical Method:	EPA 200.9 Rev. 2.2
Analyte, Matrix:	Lead, Potable Water

<u>Lab ID</u>	<u>CID</u>	<u>Sample Location/Description</u>	<u>LOQ</u>	<u>Result</u>	<u>Units</u>	<u>Flag</u>
250502P007	1	Nurse Off - SK, Initial	0.001	<0.001	mg/L	
250502P008	2	Nurse Off - SK, 15 Second Flush	0.001	NA	mg/L	
250502P009	3	Nurse Off - SK, 60 Second Flush	0.001	NA	mg/L	
250502P010	4	Nurse Off Ice Machine - IM, Initial	0.001	0.001	mg/L	

Comment:

CID: Client ID LOQ: Limit of Quantitation

NA: Sample not analyzed per customer request.