



Santa Barbara Unified
Every child, every chance, every day.

2025 DISTRICT FACILITIES

SANTA BARBARA UNIFIED SCHOOL DISTRICT

SANTA BARBARA, CALIFORNIA

APRIL 22, 2025

2024-2025 SANTA BARBARA UNIFIED SCHOOL DISTRICT

Administration

Dr. Hilda Maldonado - Superintendent
Steve Venz - Chief Operations Officer - Operations and Accountability
Kim Hernandez - Assistant Superintendent - Business Services
Dr. John Becchio - Assistant Superintendent - Human Resources
Shakenya Edison - Assistant Superintendent - Student and Family Services
Dr. Lynne Sheffield - Assistant Superintendent - Education Services

Principals

Ms. Kelly Fresch - Adams Elementary School
Mr. Gabriel Sandoval - Cleveland Elementary School
Ms. Casie Killgore - Franklin Elementary School
Ms. Veronica Binkley - Harding University Partnership School
Ms. Daisy Estrada Ochoa - McKinley Elementary School
Mr. Brian Naughton - Monroe Elementary School
Ms. Valerie Galindo - Roosevelt Elementary School
Ms. Suzette McCormick - Santa Barbara Community Academy
Ms. Arielle Curry - Washington Elementary School

Principals

Ms. Clanci Chiu Merritt - Goleta Valley Junior High School
Ms. Jennifer Foster - La Colina Junior High School
Mr. Bradley Brock - La Cumbre Junior High School
Mr. Daniel Dupont - Santa Barbara Junior High School

Mr. Carlos Cohen - Alta Vista Alternative High School
Mr. Bill Woodard - Dos Pueblos High School
Mr. Carlos Cohen - La Cuesta Continuation High School
Mr. Dare Holdren - San Marcos High School
Mr. Fred Razo - Santa Barbara High School

Board Members

Gabe Escobedo - President
William Banning - Vice President
Rose Munoz - Clerk
Sunita Beall - Board Member
Celeste Kafri - Board Member

SANTA BARBARA UNIFIED SCHOOL DISTRICT

INTRODUCTION

The vibrant history of the Santa Barbara Unified School District began in 1866 when the district was established. Taking root in the heart of the central-coast city of Santa Barbara, California, and covering an area of about 54.8 acres, it has been the educational heartbeat of the city for over a century and a half. The district caters to the learning needs of Santa Barbara's youth with a combination of 4 preschools, 9 elementary schools, 4 junior high schools, and 4 senior high schools.

The Santa Barbara Unified School District (SBUSD) focuses on educating and serving “Every Child, Every Chance, Every Day.”



Dr. Hilda Maldonado - Superintendent



FACILITIES MASTER PLAN

PART 1: EDUCATIONAL FACILITIES NEEDS

1.1 OVERVIEW

In June 2023, SBUSD launched a Facilities Condition Assessment (FCA) to support the development of a Facilities Master Plan (FMP). The purpose of the FCA was to evaluate the current state of our school facilities, identify infrastructure needs, and anticipate future requirements to support our educational goals over the next 10 years.

Completed by February 2024, the FCA provided a comprehensive review of all school sites, highlighting long-term infrastructure needs. The findings from the FCA informed the creation of a detailed FMP for each campus. Each plan outlines specific facility improvements and recommends projects that will support the educational and developmental goals of every student in every school.

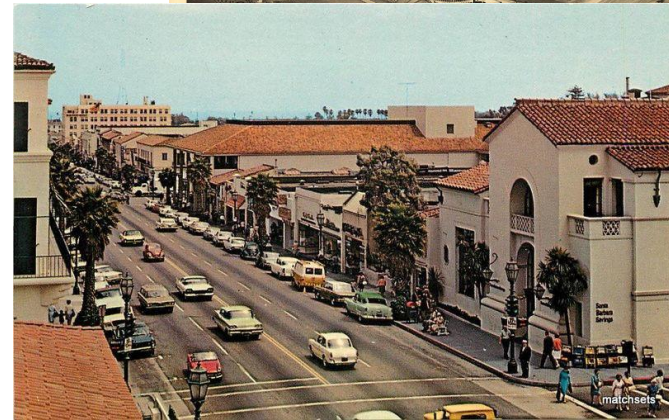
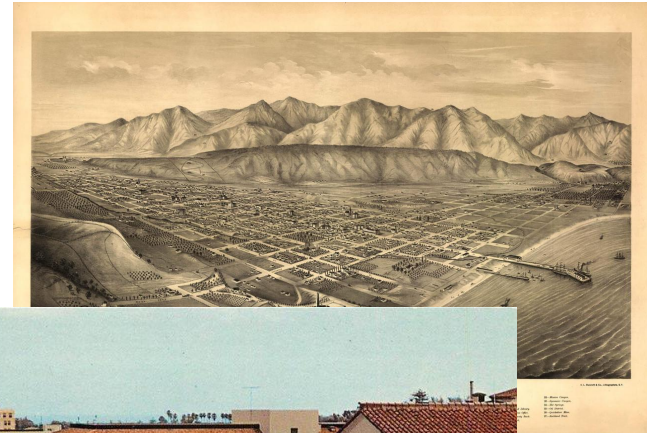

1.2 STUDENT POPULATION

2024 -2025 STUDENT ENROLLMENT

Santa Barbara, California, has a diverse population with a significant Hispanic or Latino presence and a well-educated community. The city boasts a high median household income, though a portion of residents still experience poverty. Below is a breakdown of the student enrollment.

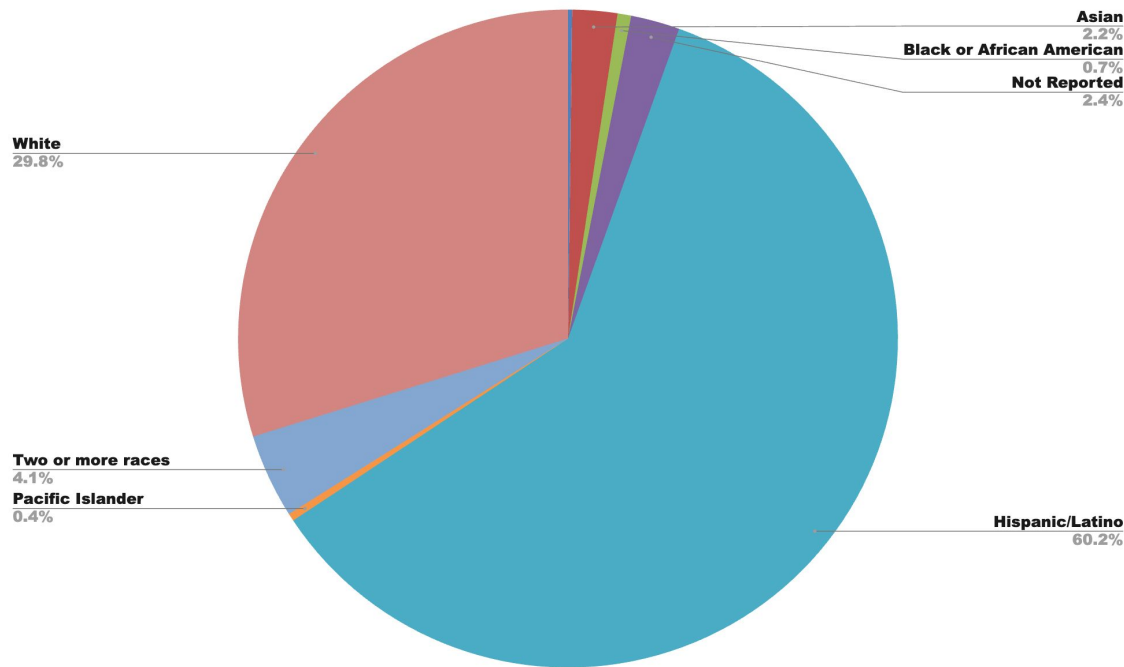

Total Student Enrollment	11,812
African American / Black	79
American Indian or Alaska Native	24
Asian	260
Hispanic or Latino	7,111
Not Reported	283
Pacific Islander	44
Two or More Races	489
White	3,522

1.2 STUDENT POPULATION

2024- 2025 UNDUPLICATED STUDENT ENROLLMENT BY GROUP

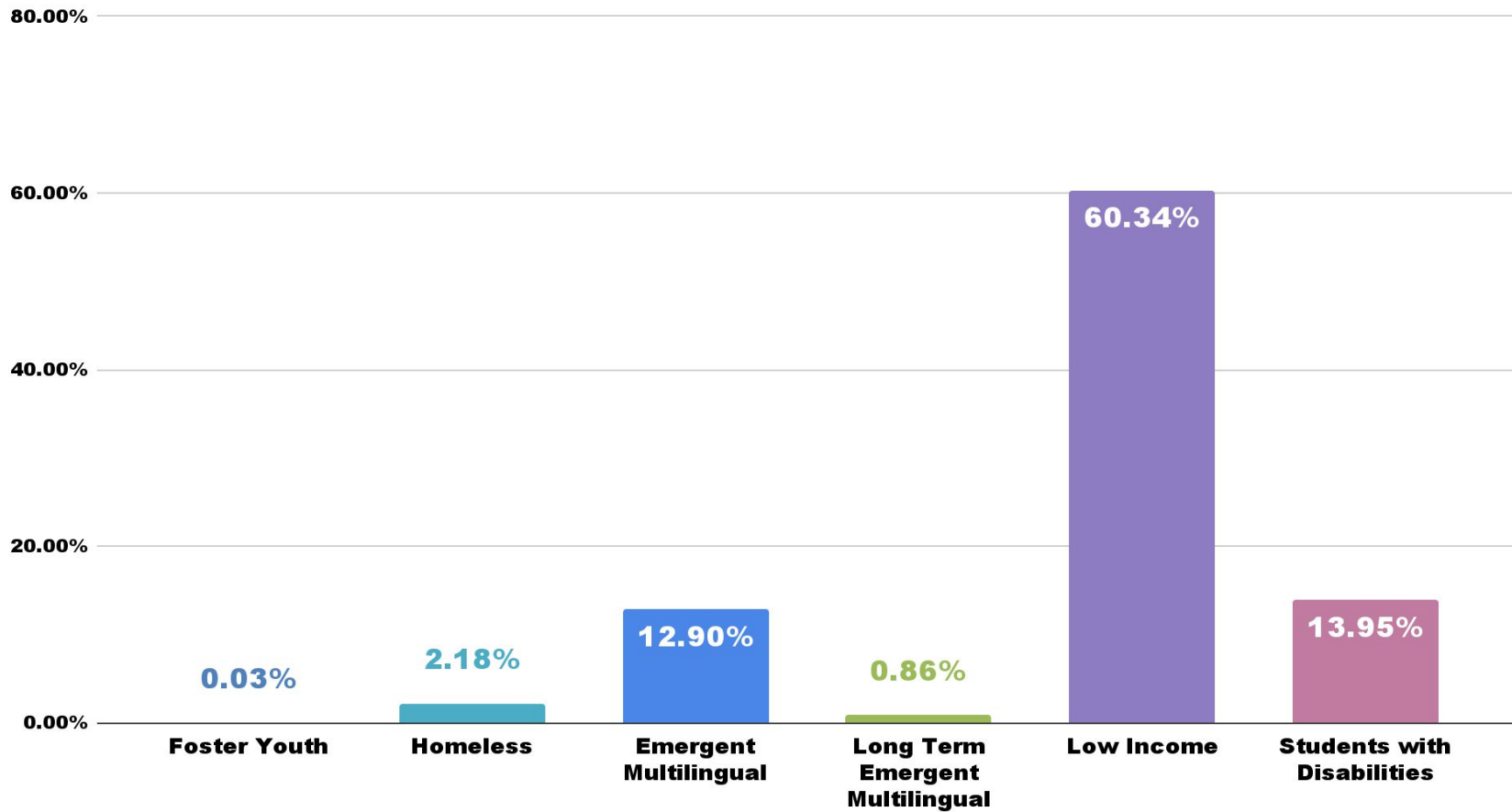

1.3 STUDENT ENROLLMENT

DISTRICTWIDE

Over the past ten years, enrollment across the district has decreased. Due to this trend, the five-year facilities master plan will focus on maintenance, modernization, and utilization of existing facilities.

SB Unified Annual Student Enrollment

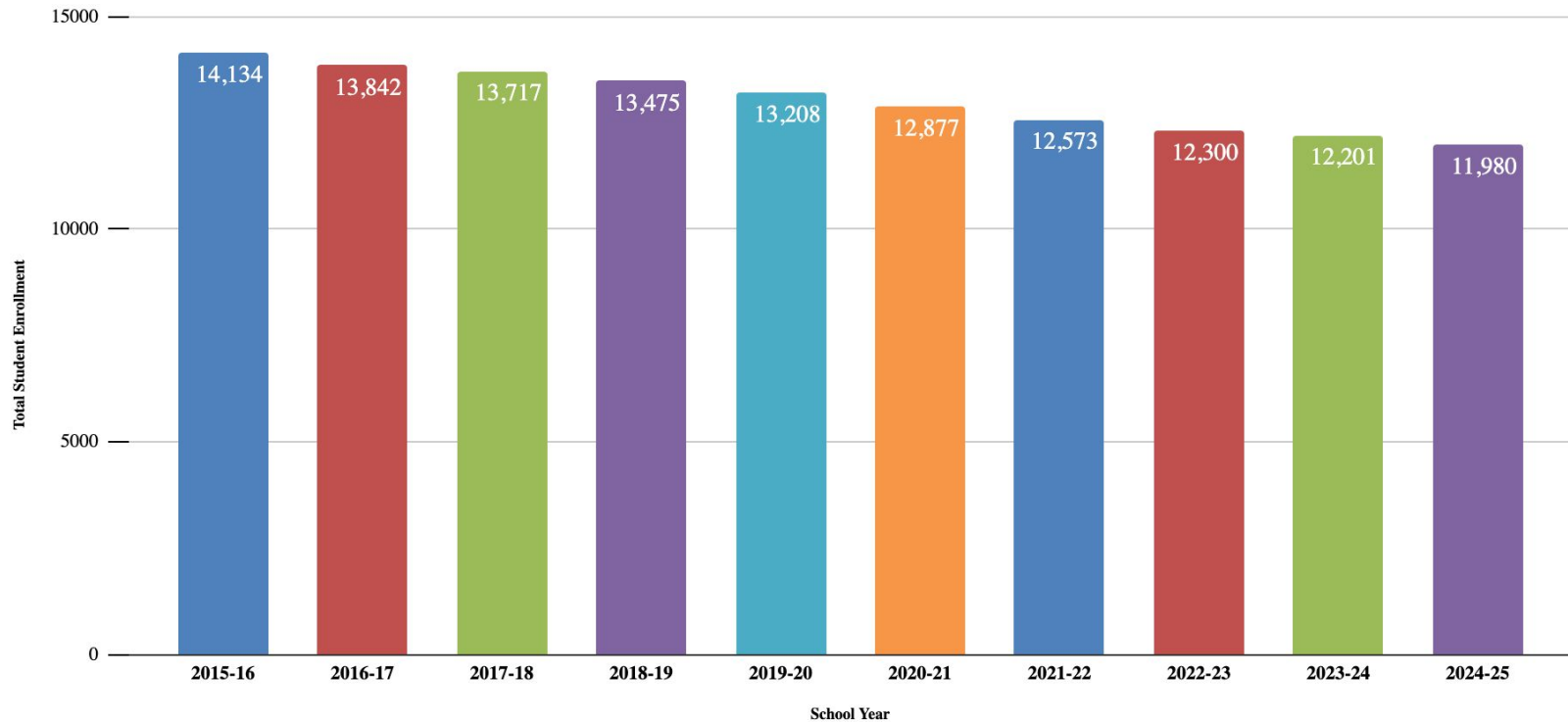

1.4 EDUCATIONAL TRANSITION

Over the past decade, the district has evolved its educational programs and instructional models to better align with state standards, workforce needs, and student support services. These changes have directly influenced facility planning and modernization efforts.

- Facilities were adapted to support Science, Technology, Engineering, the Arts and Mathematics (STEAM) and project-based learning, requiring modernized labs and multi-use instructional areas.
- To align with workforce demands, the district has expanded Career and Technical Education (CTE) offerings in fields such as health sciences, engineering, and digital media.
- Many schools required renovations or new facilities to accommodate specialized hands-on learning environments.
- The shift to distance learning during COVID-19 accelerated the need for flexible and technology-enabled learning spaces.

These changes have shaped the district’s current and future facilities planning priorities. As educational programs continue to evolve, facilities must remain adaptable to meet 21st-century learning needs, accessibility requirements, and student well-being goals.

1.5 EDUCATIONAL NEEDS

ACADEMICS: LEARNER - CENTERED SPACES

Connecting to the learning needs of each student at the heart of instructional decisions to ensure readiness for post-secondary experiences.

- **Play-based Learning** - Students will have opportunities to choose and explore learning experiences, leaning into their curiosity and interests to deepen engagement.
- **Joy of Learning** - The joy of learning is encouraged by creating spaces that allow for choice in seating and location, spaces that are light-filled, colorful and are where students want to be.
- **Hands-on Learning** - Students retain knowledge more effectively through active analysis, creation and physical problem-solving.
- **Research** - Students have the needed tools and environment to research, analyze and reflect upon learned knowledge to apply to the inquiry-based topic they have chosen.
- **Specialized Curriculum** - Classroom labs are designed around the specific requirements of Career and Technical Education (CTE) or Visual and Performing Arts (VAPA) to maximize learning opportunities and increase student engagement.
- **Flexible Spaces** - Emphasis on providing academic spaces that create dynamic learning environments to support both mental and physical needs.

1.5 EDUCATIONAL NEEDS

SOCIAL-EMOTIONAL, WELLBEING, CULTURE AND CLIMATE: NURTURING SPACES

Providing positive, safe, and inclusive environments that promote and support all learners.

- **Warm & Inviting** - Spaces within the school are visually comfortable, welcoming and enjoyable places to be.
- **Places to Connect with Others** - Socialization and connectedness to others are important components of emotional health and well-being. Spaces within and outside the school should encourage conversation and interaction.
- **Physical Health** - Physical activity increases emotional and mental health. Appropriate facilities are provided that support physical education curriculum and encourage active lifestyles for long term health.
- **Safe & Secure** - Environment that supports student learning and well-being.
- **Personalize Space and Display** - Student work is visible throughout the school, demonstrating knowledge and encouraging pride in one's learning.
- **Educator and Staff Support Environments** - Opportunities for staff to connect with peers, reflect, or restore are provided.

1.6 FMP ALIGNMENT WITH LCAP GOALS

SBUSD Facilities Master Plan is designed to create learning environments that directly support student engagement, attendance, and well-being by addressing chronic absenteeism and suspension rates. By aligning our facility improvements with the district's LCAP goals, we will ensure that our schools provide learner-centered, nurturing, and dynamic spaces that foster academic success, social-emotional growth, and community connection.

Learner-Centered Spaces to Support Academic Success

Students are more likely to attend and engage in school when they feel connected to their learning environment. Our plan prioritizes flexible, interactive, and play-based learning spaces that encourage curiosity and hands-on experiences. By designing classrooms with varied seating options, natural light, and technology-enhanced areas, we create spaces where students feel motivated and excited to learn. Dedicated STEAM, Career & Technical Education (CTE), and Visual & Performing Arts (VAPA) classrooms and spaces will provide specialized environments that increase engagement by aligning with students' interests and career pathways. Additionally, we will ensure that research and collaboration areas are well-equipped with modern tools and technology, allowing students to develop inquiry-based learning skills that prepare them for post-secondary success.

Social-Emotional Wellbeing & School Climate

A welcoming, safe, and inclusive school environment is essential for student engagement and reducing absenteeism. We will focus on warm and inviting spaces that encourage positive social interactions, including calm and restorative areas where students can take a break and manage stress. The inclusion of wellness rooms, counseling spaces, and peer connection areas will help support students' mental and emotional health. Outdoor spaces will also be enhanced to encourage movement, physical activity, and recreation, which are proven to reduce stress and improve overall well-being.

Safe & Secure Campuses to Support Attendance

Students and families must feel confident in the safety and security of school facilities. Our plan includes secure entry points, improved lighting, and modernized emergency systems to ensure a safe learning environment.



FACILITIES MASTER PLAN

PART 2: EDUCATIONAL FACILITIES

2.1 EVALUATION PROCEDURES

2023-2024 FACILITIES CONDITION ASSESSMENT OVERVIEW

The **Facilities Condition Assessment (FCA)** was conducted to evaluate the current state of our facilities and determine the necessary investments and maintenance priorities.

Key Objectives of the FCA:

- Identify the extent and nature of required investments and overdue maintenance.
- Establish priorities for addressing critical facility issues.
- Provide a structured process and tools for future planning and facility improvements.
- Develop a phased strategy for reinvestment, ensuring a prioritized approach to enhancements.

Impact & Decision-Making:

- The FCA serves as a data-driven foundation for making well-informed facility investment decisions.
- It supports the development of a comprehensive reinvestment strategy for modernization and new construction projects.

Strategic Alignment & Financial Responsibility:

- Modernization spending must align with the educational priorities and program direction of the Santa Barbara Unified School District.
- Given increasing financial pressures on educational institutions, facility expenditure decisions will depend on each site's enrollments numbers and will be focused on essential building needs.

2.1 EVALUATION PROCEDURES

FACILITIES CONDITION ASSESSMENT SCOPE

The 2023-24 Facilities Condition Assessment evaluated elementary and secondary schools, along with the District Office, covering approximately 2,428,564 gross square feet (GSF).

- The primary objectives of the assessment were to:
 - Identify facility needs and their approximate costs.
 - Prioritize modernization requirements.
- The evaluation included thorough facility inspections conducted by maintenance staff.
- Following the assessments, solutions and cost estimates were developed for each identified deficiency.
- Multiple follow-up meetings and collaborative efforts enhanced the report's content.
- The project involved various trades, including electrical, mechanical, plumbing, and building envelope.
- Each proposed project was assigned a priority ranking based on its assessment score.
- Estimated costs for corrective actions or replacements were based on industry standards for similar buildings.



2.1 EVALUATION PROCEDURES

FACILITIES CONDITION ASSESSMENT PRIORITIES

THE ASSESSMENT HIGHLIGHTED NEEDS IN THE FOLLOWING PRIORITY CATEGORIES:

- 1** **Urgent or Critical Fixes (One Year)** Projects that address facility conditions impacting the safety and well-being of students and staff.
- 2** **Potential Critical Issues (Two Years)** Systems needing attention to prevent foreseeable deterioration or potential downtime and associated costs if left unattended.
- 3** **Necessary in Three to Nine Years** Systems indicating that their expected useful life is expiring.
- 4** **Necessary in Ten or More Years** Systems or items nearing or exceeding 10 years of use and will require future attention.

2.2 DEFINITIONS

New Construction

- Construction that increases the building SF of the campus.
- Construction of stand-alone buildings, shade structures, or other major structures not otherwise listed in Site Improvements.
- Expansion of existing buildings.

Modernization

- Renovation and upgrades to improve safety, accessibility, energy efficiency, and functionality.
- Heating, ventilation, and air conditioning (HVAC) system upgrades for better air quality, energy efficiency, and temperature control.
- Electrical and plumbing improvements to meet current standards and future demands.
- Technology enhancements, including updated wiring, smart boards, and digital learning tools.
- Structural reinforcements to ensure buildings meet safety codes and withstand environmental conditions.
- Restructuring or repurposing existing facilities to align with evolving educational needs.
 - Converting traditional classrooms into open-concept or collaborative learning spaces.
 - Modifying spaces for specialized programs such as STEM, vocational training, or arts education.
 - Repurposing buildings for alternative uses, such as community centers or administrative offices.

2.2 DEFINITIONS

Site Work

- Enhancements and modifications to improve safety, accessibility, and overall infrastructure.
- Landscaping improvements, including tree planting, irrigation systems, and green spaces.
- Paving and resurfacing of sidewalks, pathways, and roadways for improved access.
- Installation or upgrading of fencing and security features for campus safety.
- Drainage improvements to prevent flooding and water damage.
- Parking lot upgrades for better traffic flow, additional capacity, and ADA compliance.
- Playground installations and outdoor learning spaces to support student recreation and engagement.



2.3 COMPLETED CONSTRUCTION PROJECTS (2017 - 2025)

Site	Project	Funding Source	Additional Funding Source	Year Completed	Total Project Cost
Adams	Hillside Repair	Measure J	N/A	2018	\$310,664.75
Adams	Playground Pavement Rehabilitation	Measure J	N/A	2019	\$1,077,907.34
Adams	New classrooms and Site Improvements	Measure J	N/A	2023	\$5,911,159.00
Adams	Playground Pavement Rehabilitation	Measure J	N/A	2019	\$1,077,907.34
Adams	MPR Renovation	Measure J	N/A	2024	\$2,117,861.00
Cleveland	MPR Renovation	Measure J	N/A	2019	\$862,286.00
Cleveland	Walkway Replacement	Measure J	N/A	2017	\$1,091,780.30
Cleveland	Portable Replacement	Measure J	N/A	2024	\$4,673,222.27
District Office	HVAC & 2nd Floor Office Renovation	State Funding \$2,423,145	Developer Fees \$218,995 RRM \$87,814	2020	\$2,729,954.00
District wide	Launch Solar Panel Project (Soft Costs only, including feasibility studies, SAGE services, DSA Inspection, and other costs to launch project)	Measure I - \$376,908.55 Measure J - \$305,615.00	Deferred Maintenance \$376,908.55	2020	\$1,259,275.30
District Wide	WIFI Upgrades	Measure J \$346,993.58 Measure I \$472882.75	N/A	2024	\$819,876.33

2.3 COMPLETED CONSTRUCTION PROJECTS (2017 - 2025)

Site	Project	Funding Source	Additional Funding Source	Year Completed	Total Project Cost
District Wide	Digital Firewall Upgrade at All Schools	Measure I \$476,728.07 Measure J \$181,736.12	Federal E-Rate \$351,186.56	2024	\$1,009,650.75
DPHS	Baseball Field backstops and ADA	Measure I	N/A	2020	\$1,057,226.10
DPHS	Classroom Storefront Window Replacement	Measure I	N/A	2020	\$2,824,767.42
DPHS	Intercom and PA Replacement	Measure I	N/A	2021	\$341,047.10
DPHS	Sand Volleyball and Donor Plaza	Measure I	N/A	2016	\$607,146.35
DPHS	Student Parking Lot Rehabilitation	Measure I	N/A	2019	\$990,623.24
DPHS	Electrical Infrastructure Upgrade	Measure I	N/A	2024	\$2,375,729.30
DPHS	LED Lighting	SoCal Revolving Savings Fund (No-Interest Loan)	N/A	2025	\$529,046.00
DPHS	Turf and Track Replacement	Measure I	N/A	2019	\$2,756,336.39
Franklin	Covered Walkway Roofing Replacement	Measure J	N/A	2022	\$679,445.31
GVHS, SMHS	Heat Pump Water Heater	SoCal \$443,386.13	RRM \$ 59,999.00	2025	\$503,385.13

2.3 COMPLETED CONSTRUCTION PROJECTS (2017 - 2025)

Site	Project	Funding Source	Additional Funding Source	Year Completed	Total Project Cost
GVJHS	Intercom and PA Replacement	Measure I	N/A	2021	\$236,024.29
GVJHS	Roofing Replacement	Measure I	N/A	2022	\$3,327,570.93
GVJHS	New Classrooms and Site Improvements	Measure I	N/A	2025	\$4,840,218.74
GVJHS	Parking Lot & Playground Renovation	Measure I	N/A	2017	\$1,111,204.00
GVJHS	Sewer Drains	State Funding	N/A	2023	\$107,205.00
Harding	MPR Renovation	Measure J	N/A	2018	\$974,611.23
Harding	New Duplex Classrooms	Measure J	N/A	2023	\$2,513,179.51
La Colina	Roofing Replacement	Measure I	N/A	2022	\$415,659.00
La Colina	Portable Replacements (Demolition)	Measure I	N/A	2023	\$165,000.00
La Colina	500s and 600s Roofing Replacement	Measure I	N/A	2023	\$2,947,782.46
La Cuesta	Shade Structure	Measure I	N/A	2018	\$89,962.89
La Cumbre	Playground Asphalt Renovation	Measure I	N/A	2019	\$602,272.13
La Cumbre	LED Lighting	Developer Fees	N/A	2023	\$183,864.01
Las Flores	Preschool Classroom Installation	Measure J	N/A	2018	\$494,715.64

2.3 COMPLETED CONSTRUCTION PROJECTS (2017 - 2025)

Site	Project	Funding Source	Additional Funding Source	Year Completed	Total Project Cost
McKinley	Fire Alarm Replacement	Measure J	N/A	2018	\$375,000.00
McKinley	Heating system	Measure J	N/A	2019	\$2,119,130.38
McKinley	2nd floor Maker Space/Elevator	Measure J	N/A	2021	\$2,658,013.39
Monroe	New classrooms and Site Improvements	Measure J	N/A	2023	\$4,715,138.20
Monroe	LED Lighting	Developer Fees	N/A	2023	\$170,507.00
Peabody Charter	Interim Housing	Measure J	N/A	2022	\$537,462.00
Peabody Charter	Heating system	Measure J	N/A	2020	\$1,790,943.25
Peabody Charter	Portable Replacement	Measure J	N/A	2024	\$6,411,897.44
Roosevelt	MPR Renovation	Measure J	N/A	2018	\$1,200,005.03
SB Charter	Boiler Replacement	Measure J	N/A	2020	\$1,790,943.25
SBCA/La Cumbre	Makerspace	Measure J	N/A	2024	\$2,054,833.49
SBCA	Play Structure Replacement	Developer Fees	N/A	2023	\$151,114.71
SBHS	Baseball Driveway Apron	Measure I	N/A	2024	\$37,800.00
SBHS	Heating system replacement	Measure I	N/A	2020	\$7,164,266.56
SBHS	Window replacement/rehabilitation	Measure I	N/A	2023	\$2,057,773.16

2.3 COMPLETED CONSTRUCTION PROJECTS (2017 - 2025)

Site	Project	Funding Source	Additional Funding Source	Year Completed	Total Project Cost
SBHS	Peabody Stadium	Measure Q \$14,891,389 Measure I \$12,096,646	Developer Fees \$1,304,055 SBHS Foundation \$4,750,999 State Matching Funds \$6,520,310	2020	\$39,563,399.00
SBHS	60-70-80 Wing HVAC	Measure I	N/A	2025	\$4,258,782.29
SBHS	70's Wing Water Remediation	SISC \$747,811.42	State Funding \$296,349.70	2025	\$1,004,161.12
SBHS	ADA Restroom upgrades	Measure I	N/A	2020	\$575,792.42
SBHS	Baseball Site Improvements	Measure I	N/A	2025	\$301,276.04
SBHS	New VADA Building	Measure I \$3,303,012.60	SBHS Friends of VADA \$2,229,067.40 State Funding \$2,165,084	2024	\$7,697,164.00
SBJHS	Locker room, MPR, Kitchen	Measure I	N/A	2021	\$23,996,961.72
SBJHS	Restroom Upgrades (Phase I)	Measure I	N/A	2024	\$278,193.81
SBJHS	LED Lighting	Developer Fees	N/A	2024	\$128,680.00

2.3 COMPLETED CONSTRUCTION PROJECTS (2017 - 2025)

Site	Project	Funding Source	Additional Funding Source	Year Completed	Total Project Cost
SMHS	ADA Restroom Upgrades, Phase 1	Measure I	N/A	2019	\$1,448,488.64
SMHS	ADA Restroom Upgrades, Phase 2	Measure I	N/A	2021	\$635,818.42
SMHS	Baseball Backstop Upgrade	Measure I	N/A	2020	\$1,936,015.00
SMHS	Baseball Backstop Upgrade	Measure I	N/A	2020	\$1,936,015.00
SMHS	I Wing Roofing Rehabilitation	Measure I	N/A	2019	\$669,136.72
SMHS	Pool Deck Replacement	Measure I	N/A	2019	\$778,525.04
SMHS	Pool Boilers	SoCal OBF \$241,873.29	Grant \$7,500 RRM \$24,091.29	2024	\$273,464.58
SMHS	LED Field Lighting	Developer Fees	N/A	2024	\$223,825.00
SMHS	Drainage Project	Measure I	N/A	2024	\$182,800.00
SMHS	LED Lighting	SoCal Revolving Savings Fund (No-Interest Loan)	N/A	2025	\$445,522.00
Washington	MPR Renovation	Measure J	N/A	2019	\$841,040.35
Washington	Water/Gas/Sewer Replacement Project	Measure J	N/A	2018	\$1,066,952.00
Washington	Roofing Replacement	Measure J	N/A	2023	\$3,621,170.20

2.4 CURRENT PROJECTS

Site	Project	Fund	Additional Funding Source	Total Projected Cost
Adams	Portable 23	Measure J	N/A	\$60,000.00
Adams	Sewer Lines	Developer Fees	N/A	\$260,000.00
Adams, DPHS, Franklin, GVJHS, La Colina, La Cumbre, SBHS	Heat Pump Water Heater	SoCal Grant	N/A	\$59,999
Armory	Renovation for Educational Purpose	Measure I	TBD	TBD
Cleveland, Franklin, Harding, SBCA, SBJHS	HVAC Upgrade and Replacement	CalSHAPE Grant \$6,000,000	State Funding \$136,975	\$6,136,975.00
District Wide	CalSHAPE HVAC Controls	CalSHAPE	N/A	\$1,360,602.00
District Wide	HVAC Controls Upgrade	Solar Contingency \$1,198,000	CalShape \$311,600	\$1,509,600.00
District Wide	Window Safety Project - Film Covering	TBD	N/A	\$750,949.58
District Wide	Window Safety Project - Shades	TBD	N/A	\$346,312.60

2.4 CURRENT PROJECTS

Site	Project	Fund	Additional Funding Source	Total Projected Cost
DPHS	CTE East and West Pavilion	Measure I \$6,086,356	DPEAF \$7,604,628	\$13,690,984.00
Harding, GVJHS, La Cumbre, DPHS	Walk-in Freezer Replacement	CA Kitchen Infrastructure Training Grant	N/A	TBD
La Colina	Damaged Switchboard Electrical Replacement	State Funding	N/A	\$218,009.00
McKinley	Outdoor Classroom	ELP Grant	N/A	TBD
SBHS	Infant Center Shade	Developer Fees	N/A	TBD
SBJHS	Folklorico Dance Room	Arts Block Grant	N/A	TBD
SBJHS	Dust Collector	Developer Fees	N/A	TBD
SMHS	Wellness Center (Portables Replacement)	Measure I \$5,517,673	Royal Pride Foundation \$4,736,327	\$10,254,000

2.5 PENDING PROJECTS

Site	Project	Fund	Status	Expenses up to Date	Type	Site Priority
DPHS	Roof Upgrades	Measure I	In Design	\$622.50	Modernization	2
Harding	Roofing Replacement	Measure J	DSA Approved	\$113,828.00	Modernization	1
La Cumbre	Roof Upgrades	Measure I	In DSA	\$59,701.00	Modernization	1
La Cumbre	Window Replacement/Rehabilitation	Measure I	Design Complete	\$95,338.19	Modernization	1
SBHS	Science Classroom Upgrades	Measure I	Design Complete	\$103,263.17	Modernization	3
SBHS	Roof Upgrades	Measure I	In Design	N/A	Modernization	3
SBJHS	Window Replacement/Rehabilitation	Measure I	Scoping & Estimating	N/A	Modernization	3
SBJHS	Restroom Upgrades Phase II	Measure I	Remodel 5 restrooms	\$40,422.50	Modernization	3
SBJHS	Roofing Replacement	Measure I	DSA Approved Ready to Bid	\$107,590.00	Modernization	2



FACILITIES MASTER PLAN

PART 3: DEVELOPMENT

3.1 DISTRICT MASTER PLAN VISION AND MISSION

The Facilities Master Plan (FMP) is a strategic roadmap that guides the district’s decisions regarding school facilities over a five-year period. It ensures that investments in maintenance, modernization, and new construction align with the district’s educational goals, enrollment projections, and community needs. The plan serves as a framework for prioritizing projects based on available resources while also advocating for additional funding to support long-term improvements.

The FMP is designed to be a living document, reflecting changing needs and adapting to new challenges while maintaining a focus on providing safe, equitable, and future-ready learning environments for all students.



3.2 SPECIFIC GOALS FOR A FACILITIES MASTER PLAN

The development and implementation of the Facilities Master Plan were guided by the following objectives:

- **Ensure Safe and Well-Maintained Schools** – Address critical maintenance needs through a detailed facilities condition assessment.
- **Student Access to Quality Learning Environments** – Prioritize improvements that ensure all students have access to modern, well-equipped spaces.
- **Enhance Accessibility and Inclusivity** – Ensure compliance with ADA standards and improve campus accessibility for all users.
- **Plan for Growth and Enrollment Trends** – Use enrollment data and projections to determine future capacity needs or shifts in usage due to reduced enrollment.
- **Modernize Facilities for 21st-Century Learning** – Upgrade classrooms and infrastructure to support evolving educational programs and technology.
- **Engage School Community in Decision-Making** – Gather input from educational partners, including students, staff, and families, to shape the plan's priorities.
- **Maximize Available Resources** – Strategically allocate remaining bond funds and identify additional funding sources for future projects.



3.3 EDUCATIONAL PARTNERS ENGAGEMENT MEETINGS

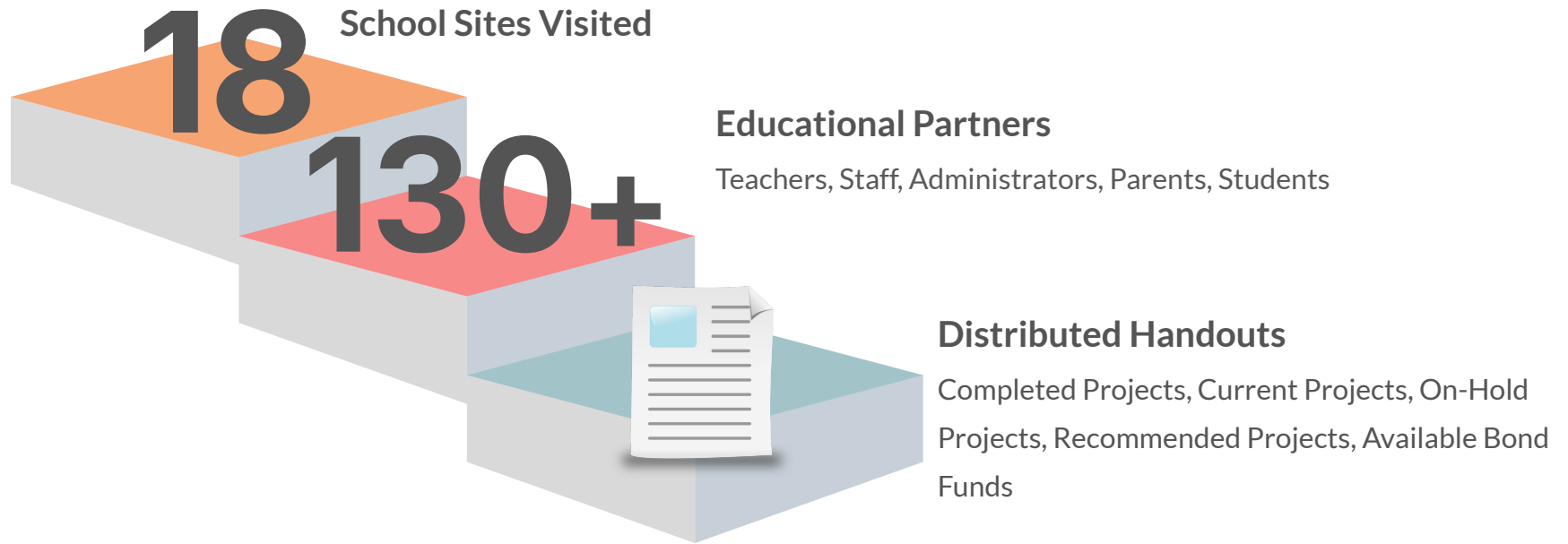

The meetings aimed to gather diverse feedback from all stakeholder groups, ensuring the recommended project list aligns with each school community's priorities. Parents appreciated the opportunity to influence decisions affecting their children's well-being, while many students shared their insights directly with the Master Planning Team.

3.4 KEY OBSERVATIONS AND TRENDS

The meetings revealed several key trends in the recommendations from participants. The most commonly expressed priorities included:

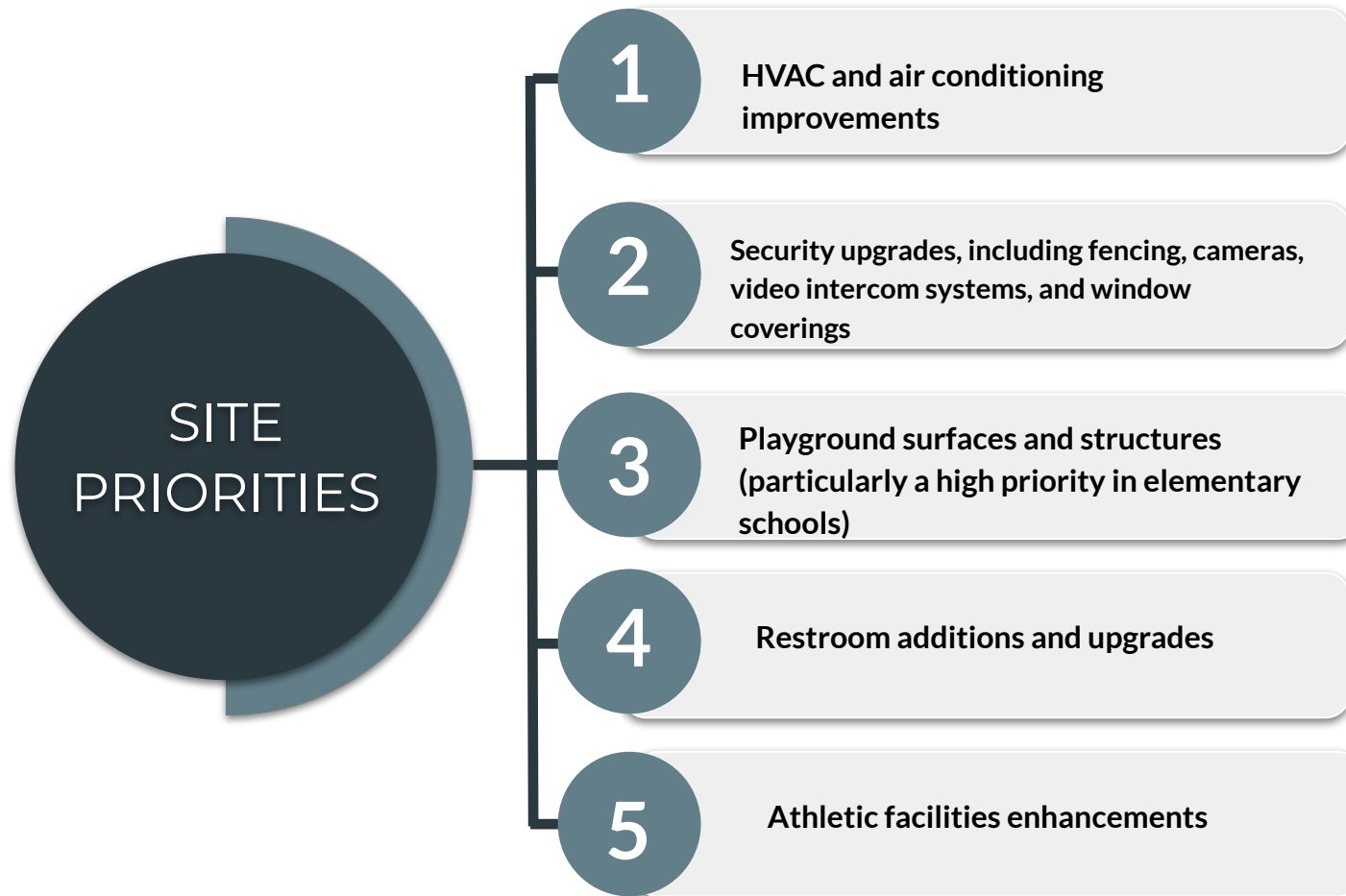



PART 4: SCHOOLS

OVERVIEW - MAP - RECOMMENDATIONS

4.1 FACILITIES CONDITION ASSESSMENT (FCA) PRIORITIES

THE FCA ASSESSMENT HIGHLIGHTED NEEDS IN THE FOLLOWING PRIORITY CATEGORIES:

- 1** **Urgent or Critical Fixes (One Year)** Projects that address facility conditions impacting the safety and well-being of students and staff.
- 2** **Potential Critical Issues (Two Years)** Systems needing attention to prevent foreseeable deterioration or potential downtime and associated costs if left unattended.
- 3** **Necessary in Three to Nine Years** Systems indicating that their expected useful life is expiring.
- 4** **Necessary in Ten or More Years** Systems or items nearing or exceeding 10 years of use and will require future attention.

4.1 BUILDING OVERVIEW

ADAMS ELEMENTARY SCHOOL

2701 Las Positas Rd, Santa Barbara, CA 93105

Information:

Year Built	1954
Gross Square Feet	62,373
Grade Levels	TK-6
Enrollment	469
Total No. Modular Units	8
Total No. Classrooms	26



Adams Elementary School Annual Enrollment

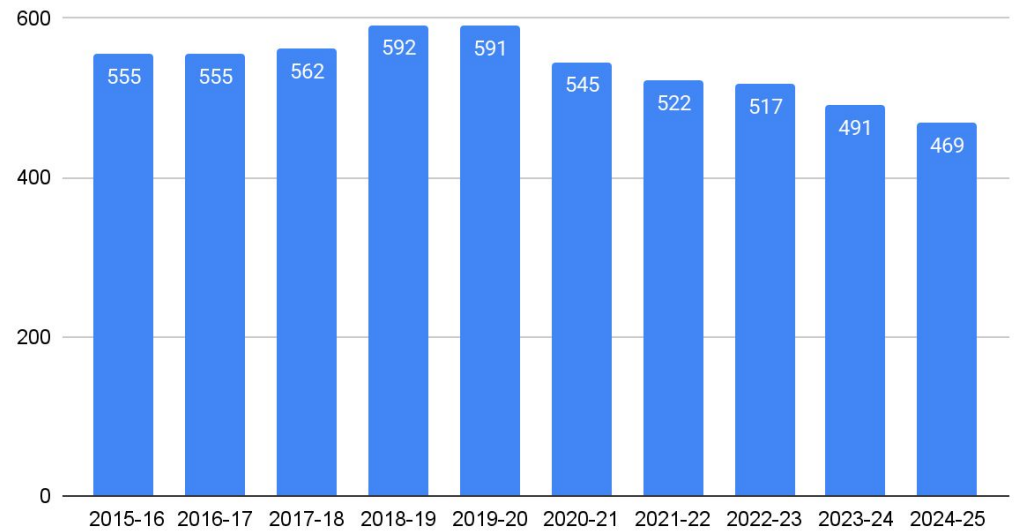

4.1 SITE MAP

ADAMS ELEMENTARY SCHOOL

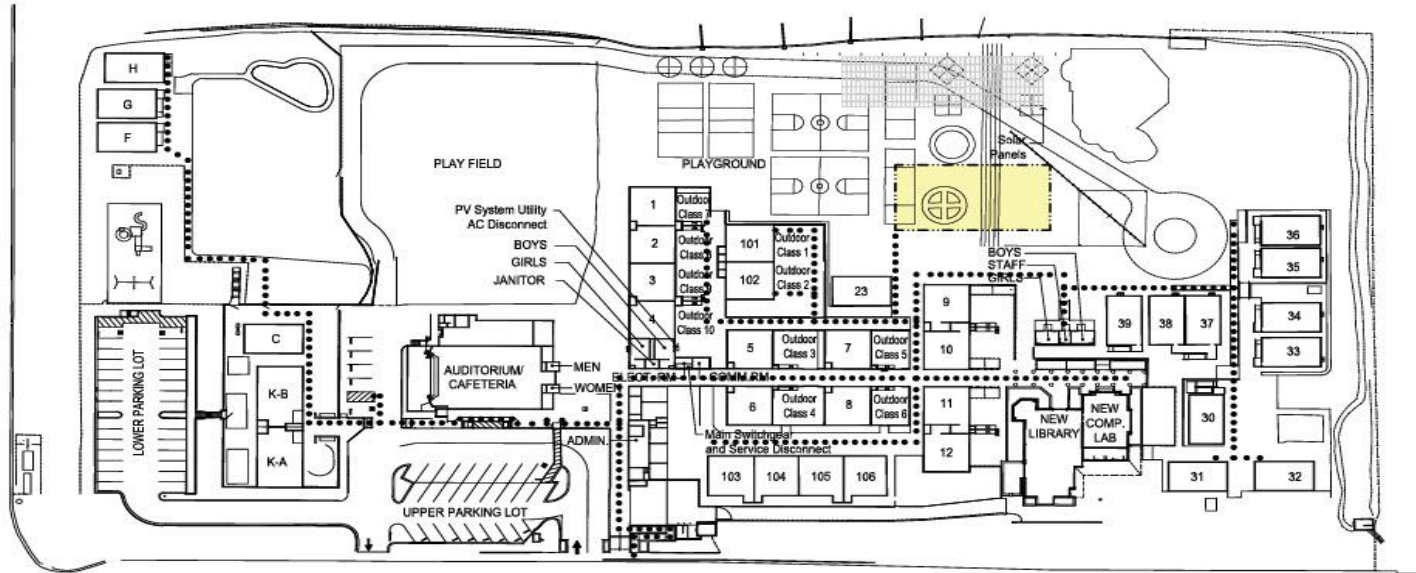

ADAMS ELEMENTARY SCHOOL CAMPUS MAP

2701 LAS POSITAS ROAD, SANTA BARBARA, CA 93105
 TELEPHONE: (805) 563 2515
 UPDATED: JUNE 01, 2024

LEGEND

- ADA PATH OF TRAVEL
- AREA OF REFUGE

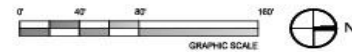

Santa Barbara Unified
 Every child, every chance, every day.

4.1 RECOMMENDED PROJECTS

ADAMS ELEMENTARY SCHOOL

2701 Las Positas Rd, Santa Barbara, CA 93105

Source	Site	Project	Description/Comments	Type	Site Priority	FCA Priority
Facilities Condition Assessment (FCA)	Adams	Electrical Panels	Replace sub panels and breakers throughout campus.	Modernization		2
Facilities Condition Assessment (FCA)	Adams	Electrical Wiring	Replace underground wiring and conduit.	Modernization		2
Facilities Condition Assessment (FCA)	Adams	HVAC System	Replace furnaces and thermostats.	Modernization		4
Facilities Condition Assessment (FCA)	Adams	Sewage System upgrade Sewer and Lift Stations and Sewer Drains Lines	Upgrade sewage grinder system	Modernization		1
Facilities Condition Assessment (FCA)	Adams	Wing 5 Roofing Replacement	Wing 5 roof needs replacement	Modernization		3
Facilities Condition Assessment (FCA)	Adams	Ventilation System Upgrades	Need to replace all ductwork due to insulation is starting to deteriorate.	Modernization		4
Facilities Condition Assessment (FCA)	Adams	Roofing Replacement	All portables roofing needs to be replaced.	Modernization		3
School Feedback	Adams	Renovate Space behind Cafeteria	Place stadium seating to enhance space and make it more usable	Modernization	3	
School Feedback	Adams	Kinder Portables	Kinder portables are in bad shape, repair or replace	Modernization	3	
School Feedback	Adams	Air Conditioning	Over half of classrooms do not yet have AC	Modernization	1	
School Feedback	Adams	Additional Restroom for adults	82 Staff and only 2 restrooms, only 1 ADA	Modernization	1	
School Feedback	Adams	Security enhancements	Gates, Check-in, Alarm, etc	Modernization	1	
School Feedback	Adams	Earl Warren Concrete Issue	Create Direct Access from Earl Warren	Site Work	2	
School Feedback	Adams	Replace Playground Structure	Install new structures, one for upper class kids	Site Work	3	

4.1 BUILDING OVERVIEW

CLEVELAND ELEMENTARY SCHOOL

123 Alameda Padre Serra, Santa Barbara, California 93103

Information:

Year Built	1958
Gross Square Feet	38,014
Grade Levels	TK-6
Enrollment	254
Total No. Modular Units	22
Total No. Classrooms	1



Cleveland Elementary School Annual Enrollment

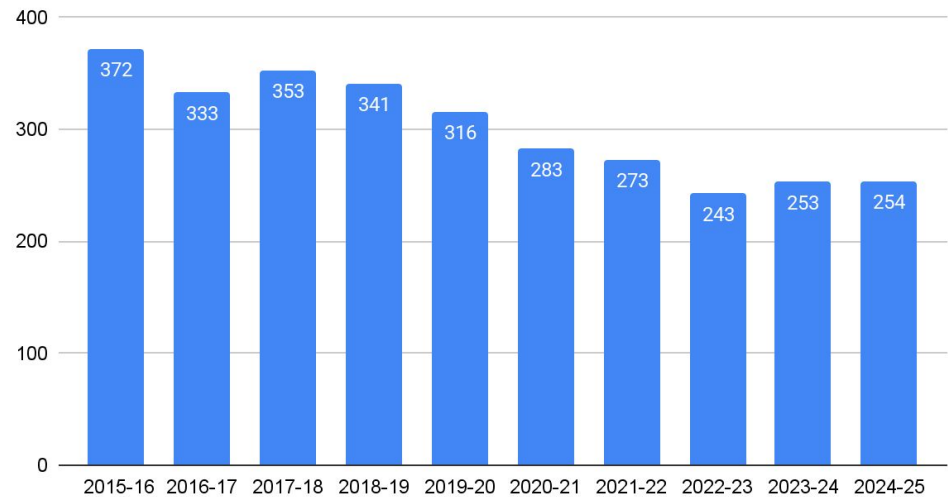

4.1 SITE MAP

CLEVELAND ELEMENTARY SCHOOL

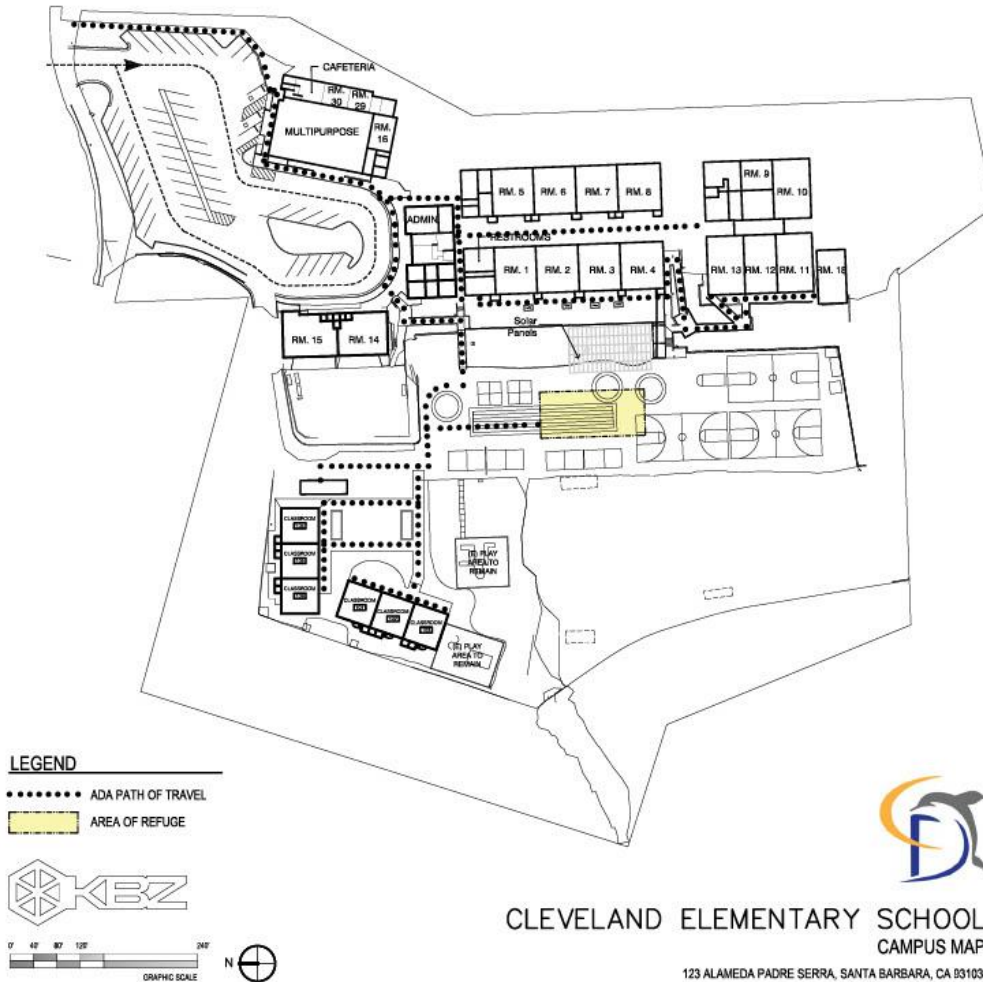

CLEVELAND ELEMENTARY SCHOOL
CAMPUS MAP

123 ALAMEDA PADRE SERRA, SANTA BARBARA, CA 93103
TELEPHONE: (805) 363-8873
UPDATED: JUNE 01, 2024

4.1 RECOMMENDED PROJECTS

CLEVELAND ELEMENTARY SCHOOL

123 Alameda Padre Serra, Santa Barbara, California 93103

Source	Site	Project	Description/Comments	Type	Site Priority	FCA Priority
Facilities Condition Assessment (FCA)	Cleveland	HVAC System	Replace 15 furnaces and thermostats in all classrooms and admin building.	Modernization		2
Facilities Condition Assessment (FCA)	Cleveland	Outlets and Switches	Replace outlets throughout campus.	Modernization		4
Facilities Condition Assessment (FCA)	Cleveland	Underground Wiring	Replace underground wiring throughout campus.	Modernization		4
Facilities Condition Assessment (FCA)	Cleveland	Water Line	Replace main water line from city hook to main building.	Modernization		4
Facilities Condition Assessment (FCA)	Cleveland	Ventilation System Upgrades	The Ductwork and vents will need replacements in classroom and admin building.	Modernization		4
School Feedback	Cleveland	Renovation of Library	Remove wall between Library and Makerspace, add pillars and raise ceiling	Modernization	4	
School Feedback	Cleveland	Recondition Field	Fill gopher holes and improve drainage	Site Work	1	
School Feedback	Cleveland	Resurface Playground	Cracking paint around play area	Site Work	3	
School Feedback	Cleveland	Perimeter Fencing	Prevent trespassing and students accessing parking lot when unsupervised	Site Work	1	

4.1 RECOMMENDED PROJECTS

CLEVELAND ELEMENTARY SCHOOL

123 Alameda Padre Serra, Santa Barbara, California 93103

Source	Site	Project	Description/Comments	Type	Site Priority	FCA Priority
School Feedback	Cleveland	Classroom flooring replacement	Classrooms	Modernization	3	
School Feedback	Cleveland	Sewer Lines	Backing up, below buildings and portables, roots are damaging lines	Modernization	2	
School Feedback	Cleveland	Safety Enhancement	Add more cameras for better visibility in and around parking area	Site Work	2	
School Feedback	Cleveland	Playground	Enhance accessibility for special education kids, or build a new area at Special Ed class	Site Work	1	
School Feedback	Cleveland	Air Conditioning	Common Request at all schools for Classrooms	Modernization	1	

4.1 BUILDING OVERVIEW

FRANKLIN ELEMENTARY SCHOOL

1111 East Mason Street, Santa Barbara, California 93103

Information:

Year Built	1957
Gross Square Feet	79,444
Grade Levels	PreK-6
Enrollment	424
Total No. Modular Units	0
Total No. Classrooms	30



Franklin Elementary School Annual Enrollment

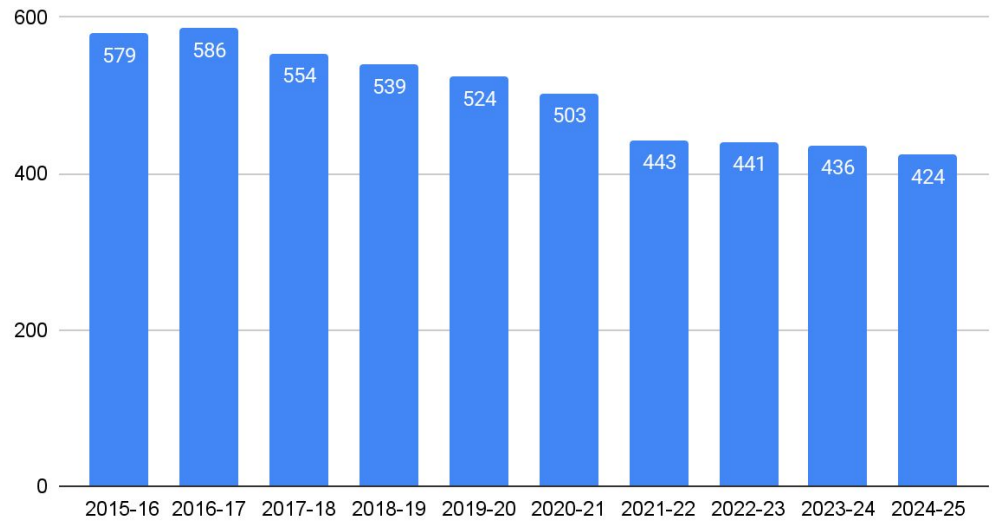

4.1 SITE MAP

FRANKLIN ELEMENTARY SCHOOL

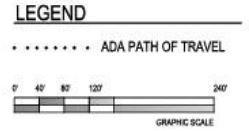
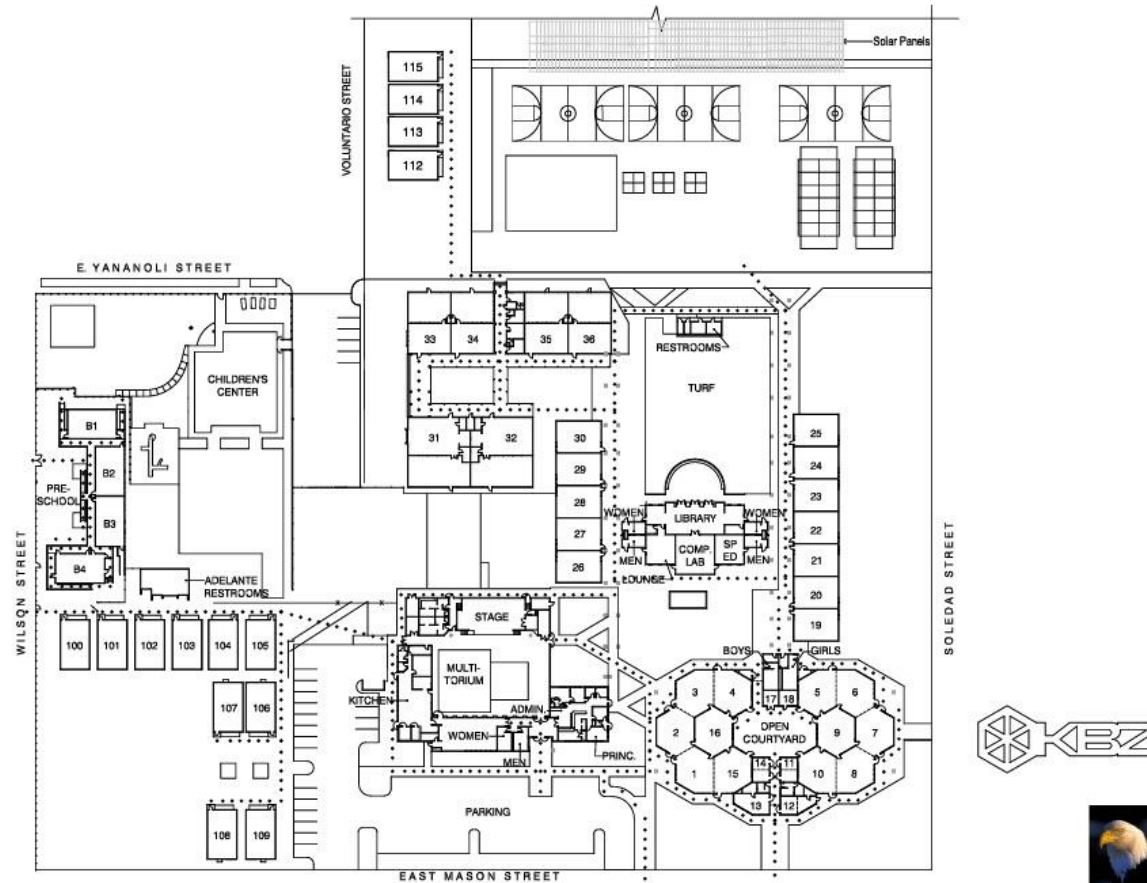

FRANKLIN ELEMENTARY SCHOOL CAMPUS MAP

1111 EAST MASON STREET, SANTA BARBARA, CA 93105
 TELEPHONE: (805) 963 4283
 UPDATED: JUNE 01, 2024



4.1 RECOMMENDED PROJECTS

FRANKLIN ELEMENTARY SCHOOL

1111 East Mason Street, Santa Barbara, California 93103

Source	Site	Project	Description/Comments	Type	Site Priority	FCA Priority
Facilities Condition Assessment (FCA)	Franklin	Flooring	Replace damaged and end-of-lifespan carpet in classrooms 1-16.	Modernization		2
Facilities Condition Assessment (FCA)	Franklin	Flooring	Replace flooring and end-of-lifespan carpet in classrooms 31-33. Requires abatement.	Modernization		3
Facilities Condition Assessment (FCA)	Franklin	Underground Wiring	Replace 40 year old wiring in main building.	Modernization		4
Facilities Condition Assessment (FCA)	Franklin	Water line	Replace galvanized water line from library to kinder, 30 wing, and subschool water supply to entire building.	Modernization		3
Facilities Condition Assessment (FCA)	Franklin	Playground	Pour in place surface needs to be replaced	Modernization		1
School Feedback	Franklin	Outlets and Switches	Replace outlets in all classrooms.	Modernization		4
School Feedback	Franklin	Playground	Surface, age-appropriate structures, blacktop, redesign. Adelante, community, and many programs use it	Site Work	1	
School Feedback	Franklin	Paint blacktop	Playground redesign and repair	Modernization	2	
School Feedback	Franklin	Driveway redesign	Long, one-way driveway for safety, need architect and approval from DSA	Site Work	3	

4.1 BUILDING OVERVIEW

HARDING UNIVERSITY PARTNERSHIP SCHOOL

1625 Robbins Street, Santa Barbara, California 93101

Information:

Year Built	1928
Gross Square Feet	50,814
Grade Levels	PreK-6
Enrollment	364
Total No. Modular Units	1
Total No. Classrooms	28



Harding University Partnership School Annual Enrollment

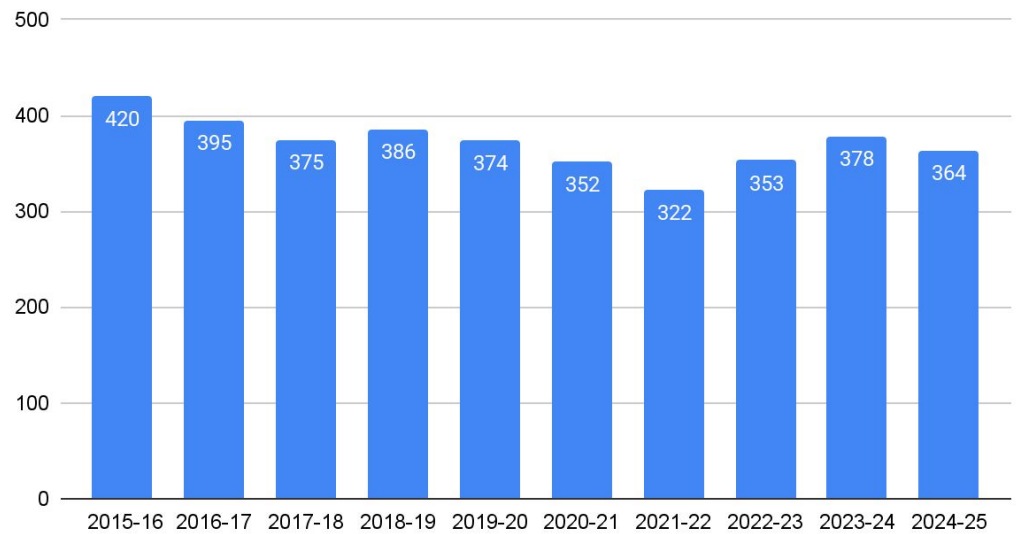

4.1 SITE MAP

HARDING UNIVERSITY PARTNERSHIP SCHOOL

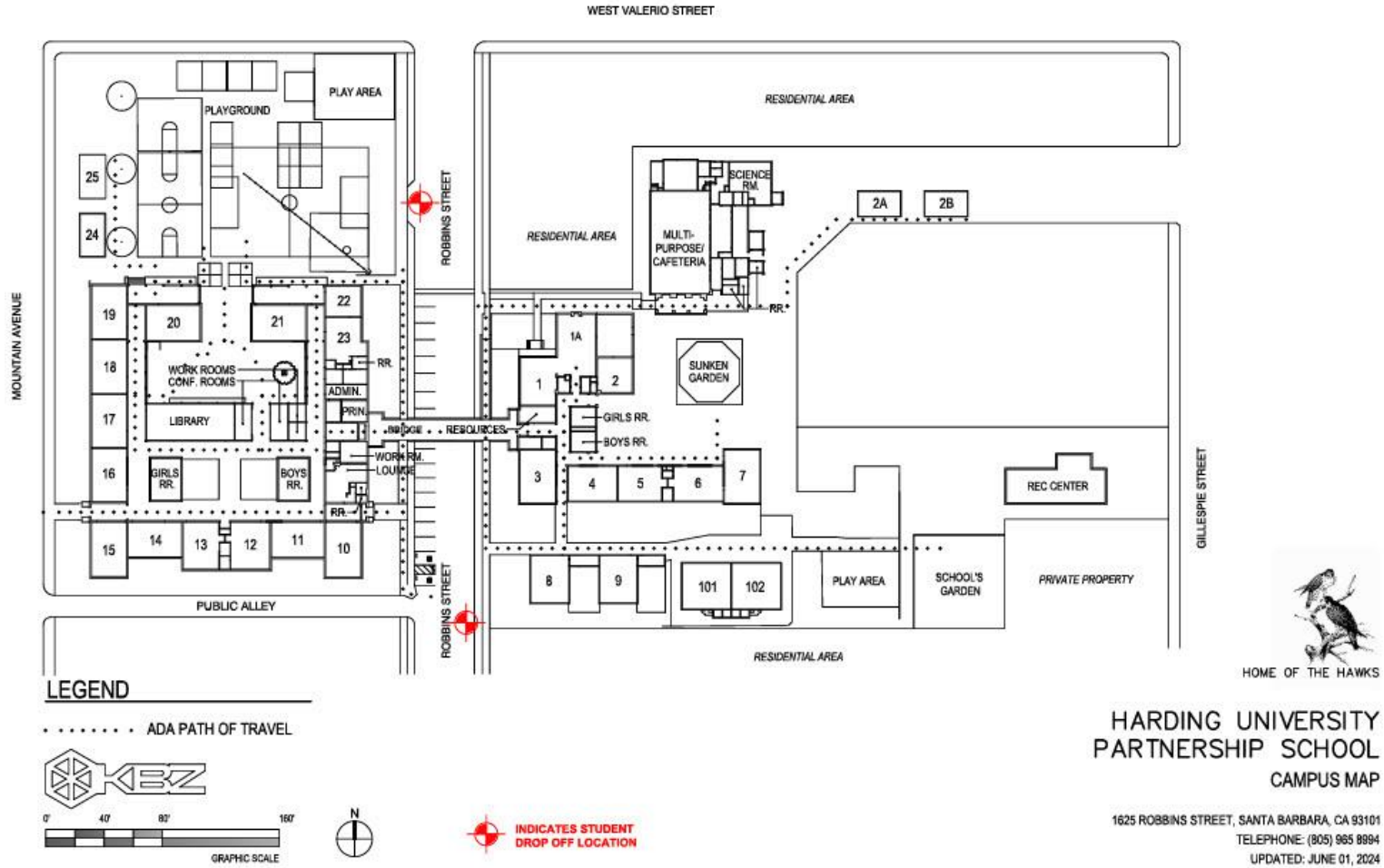

4.1 RECOMMENDED PROJECTS

HARDING UNIVERSITY PARTNERSHIP SCHOOL

1625 Robbins Street, Santa Barbara, California 93101

Source	Site	Project	Description/Comments	Type	Site Priority	FCA Priority
Facilities Condition Assessment (FCA)	Harding	Electrical Panels	Upgrade main panel, subpanel, and breakers in main building.	Modernization		3
Facilities Condition Assessment (FCA)	Harding	Flooring	Replace damaged and end-of-lifespan carpet in portable buildings.	Modernization		3
Facilities Condition Assessment (FCA)	Harding	HVAC System	Replace furnaces and thermostats in all classrooms.	Modernization		2
Facilities Condition Assessment (FCA)	Harding	Roofing Replacement	Replace truss and fascia outside rooms 8,9.	Modernization		3
Facilities Condition Assessment (FCA)	Harding	Underground wiring	Replace aged underground wiring from main office to lounge due to electrical issues.	Modernization		3
Facilities Condition Assessment (FCA)	Harding	Ventilation System Upgrades	Replace ductwork and vents in all classrooms.	Modernization		3

4.1 RECOMMENDED PROJECTS

HARDING UNIVERSITY PARTNERSHIP SCHOOL

1625 Robbins Street, Santa Barbara, California 93101

Source	Site	Project	Description/Comments	Type	Site Priority	FCA Priority
School Feedback	Harding	Demolish old CRC, and. build a new building	UCSB is raising money to fund this project	New Construction	4	
School Feedback	Harding	Portable replacement	There is a big issue and the flooring is falling apart, portables on the mountain side need to be replaced with a kinder building, ideally with a bathroom	New Construction	4	
School Feedback	Harding	New Classrooms	New TK with Bathroom (duplicate with above)	New Construction	4	
School Feedback	Harding	HVAC System	Install Air Conditioning	Modernization	3	
School Feedback	Harding	Move small tree	Roots Growing into girls bathroom outside principal's office	Site Work	3	
School Feedback	Harding	Marquees	Install New Marquee	Modernization	2	
School Feedback	Harding	Playground / Field redesign	Add basketball, handball pickleball, or volleyball on half of field, which gets muddy and isn't stimulating for the kids	Site Work	4	
School Feedback	Harding	TK Playground	Need to repair the turf at playground	Site Work	1	
School Feedback	Harding	Outdoor lighting	Outside room 15, outside MPR, in side alley, the school gets very dark	Site Work	1	
School Feedback	Harding	Safety Enhancement	Add perimeter fencing	Site Work	4	
School Feedback	Harding	New Building	Near Portable 24 construct new building for 6th grade	New Construction	4	

4.1 BUILDING OVERVIEW

MCKINLEY ELEMENTARY SCHOOL

350 Loma Alta Drive, Santa Barbara, California 93109

Information:

Year Built	1932
Gross Square Feet	65,333
Grade Levels	PreK-6
Enrollment	293
Total No. Modular Units	11
Total No. Classrooms	18



McKinley Elementary School Annual Enrollment

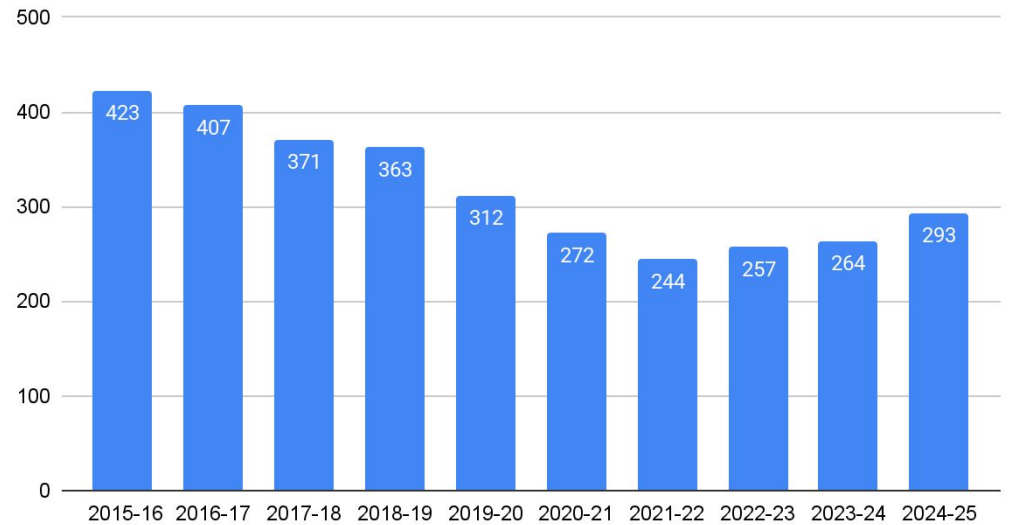

4.1 SITE MAP

MCKINLEY ELEMENTARY SCHOOL

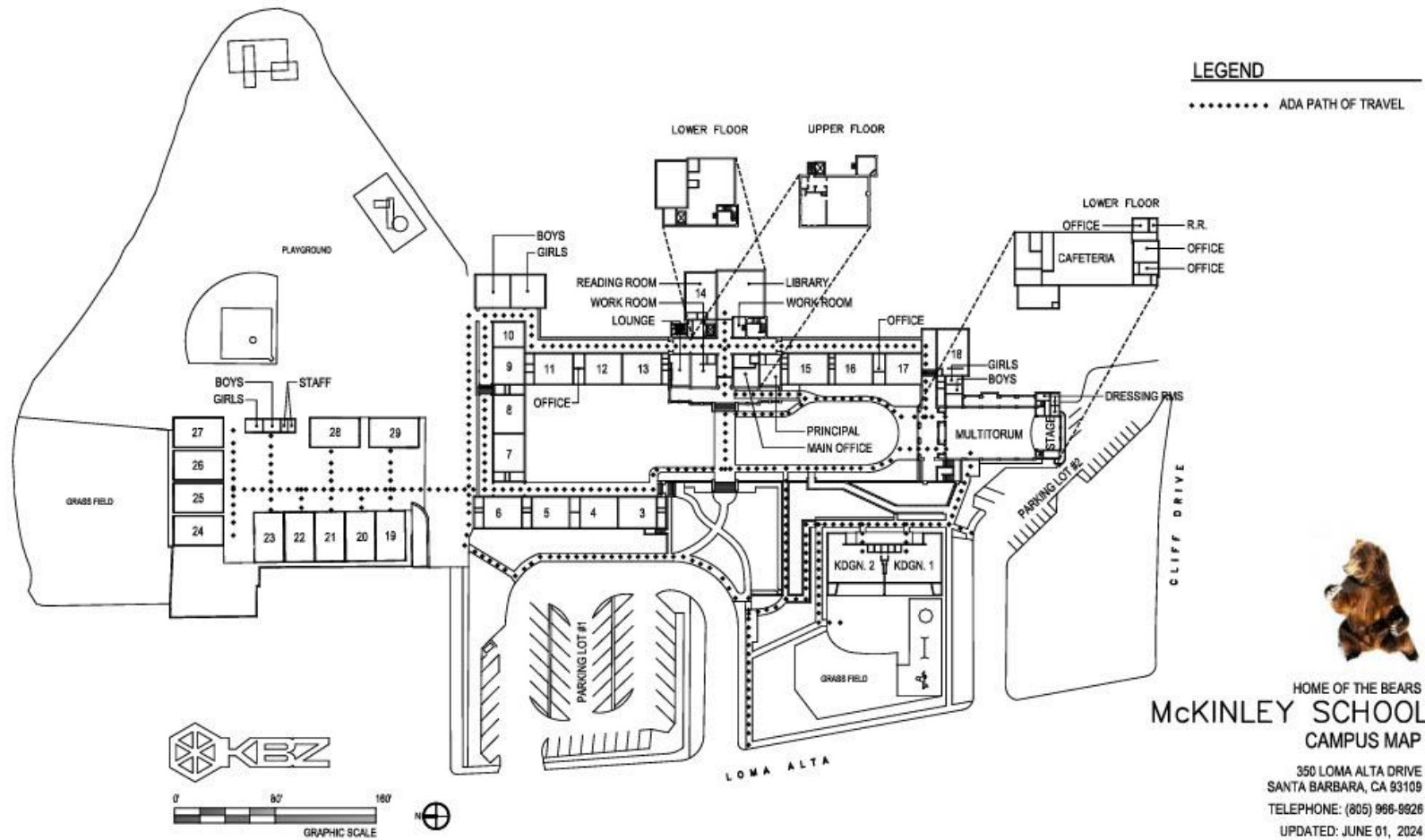

HOME OF THE BEARS
McKINLEY SCHOOL
 CAMPUS MAP

350 LOMA ALTA DRIVE
 SANTA BARBARA, CA 93109
 TELEPHONE: (805) 966-9926
 UPDATED: JUNE 01, 2024

4.1 RECOMMENDED PROJECTS

MCKINLEY ELEMENTARY SCHOOL

350 Loma Alta Drive, Santa Barbara, California 93109

Source	Site	Project	Description/Comments	Type	Site Priority	FCA Priority
Facilities Condition Assessment (FCA)	McKinley	Flooring	Replace flooring in portable restrooms.	Modernization		1
Facilities Condition Assessment (FCA)	McKinley	Flooring	Replace carpet in portable classrooms.	Modernization		2
Facilities Condition Assessment (FCA)	McKinley	Interior Walls	Upgrade boys and girls restrooms from floor to partition near room 10.	Modernization		1
Facilities Condition Assessment (FCA)	McKinley	Sewage System	Replace drain line to kinder building.	Modernization		2
Facilities Condition Assessment (FCA)	McKinley	Playground surfaces	Replace playground surfaces	Site Work		1
Facilities Condition Assessment (FCA)	McKinley	Roofing Replacement	Classrooms 19-29 roofs are in need of repair and replacing - TBD	Modernization		3
Facilities Condition Assessment (FCA)	McKinley	Electrical and Lighting upgrade	Panels, breakers, wiring, exterior lights	Modernization		4
Facilities Condition Assessment (FCA)	McKinley	Demolish 11 portables and build 6-8 classrooms	TBD - Review student population total	New Construction		4

4.1 RECOMMENDED PROJECTS

MCKINLEY ELEMENTARY SCHOOL

350 Loma Alta Drive, Santa Barbara, California 93109

Source	Site	Project	Description/Comments	Type	Site Priority	FCA Priority
School Feedback	McKinley	Windows	Replace all windows in main building.	Modernization	3	
School Feedback	McKinley	Portable bathroom replacement	The restroom is unsafe to use due to deterioration of floors, walls and fixtures, currently closed	New Construction	3	
School Feedback	McKinley	Intercom System / Bells	The oldest system in the District, needs replacement	Modernization	1	
School Feedback	McKinley	Roof replacements or portable replacement	19-29 portables, enrollment is growing	New Construction	3	
School Feedback	McKinley	Playground	Asphalt as well as around the structure, around the TK, the school raised 200k and needs 400k. TK playground is P1, Understructure is 1 or 2, under swings is 3 or 4	Site Work	1	
School Feedback	McKinley	Fencing	Entrance to cafeteria is really close to parking lot and kids could run off	Site Work	1	

4.1 BUILDING OVERVIEW

MONROE ELEMENTARY SCHOOL

431 Flora Vista Drive, Santa Barbara, California 93109

Information:

Year Built	1958
Gross Square Feet	53,578
Grade Levels	TK-6
Enrollment	315
Total No. Modular Units	4
Total No. Classrooms	25



Monroe Elementary School Annual Enrollment

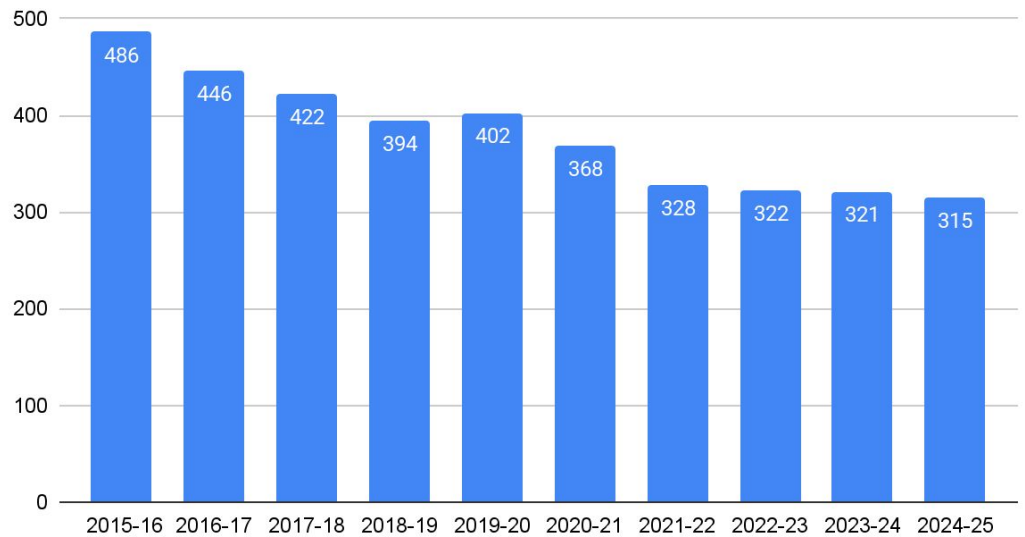

4.1 SITE MAP

MONROE ELEMENTARY SCHOOL

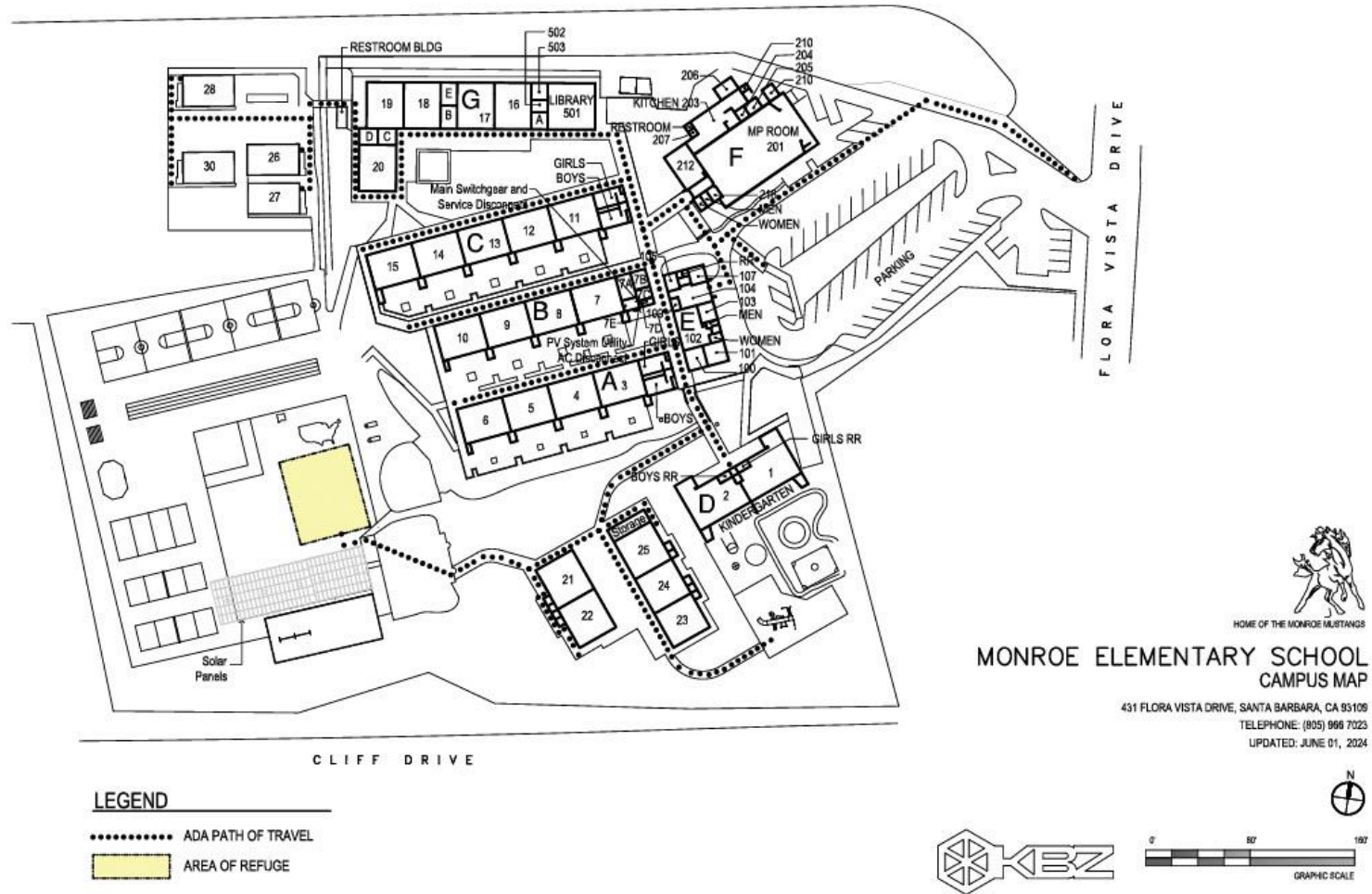

4.1 RECOMMENDED PROJECTS

MONROE ELEMENTARY SCHOOL

431 Flora Vista Drive, Santa Barbara, California 93109

Source	Site	Project	Description/Comments	Type	Site Priority	FCA Priority
Facilities Condition Assessment (FCA)	Monroe	HVAC System	Upgrade HVAC in 2 TK/K classrooms.	Modernization		3
Facilities Condition Assessment (FCA)	Monroe	HVAC System	Replace furnaces and thermostats in multipurpose room. Heating system nearing the end of useful life.	Modernization		4
Facilities Condition Assessment (FCA)	Monroe	Electrical Upgrade	Underground wiring still the original throughout campus.	Modernization		4
Facilities Condition Assessment (FCA)	Monroe	Ventilation System Upgrade	Ductwork needs replacing in all classrooms	Modernization		4
Facilities Condition Assessment (FCA)	Monroe	Sewage System Upgrade	Sewer Drain Lines, entire campus	Modernization		3
Facilities Condition Assessment (FCA)	Monroe	Library Modernization	New Library building, or remodel current space	Modernization		4
School Feedback	Monroe	TK room with bathroom	Increase safety for TK students, who currently walk down the hallway to use the bathroom	New Construction	1	
School Feedback	Monroe	Electronic Marquee	New Marquee	Modernization	2	
School Feedback	Monroe	ADA Access for playground	New play structures, fence by cliff drive for safety, replace ball walls, a temporary solution was discussed	Site Work	1	

4.1 BUILDING OVERVIEW

ROOSEVELT ELEMENTARY SCHOOL

1990 Laguna Street, Santa Barbara, California 93101

Information:

Year Built	2000
Gross Square Feet	50,982
Grade Levels	TK-6
Enrollment	463
Total No. Modular Units	0
Total No. Classrooms	28



Roosevelt Elementary School Annual Enrollment

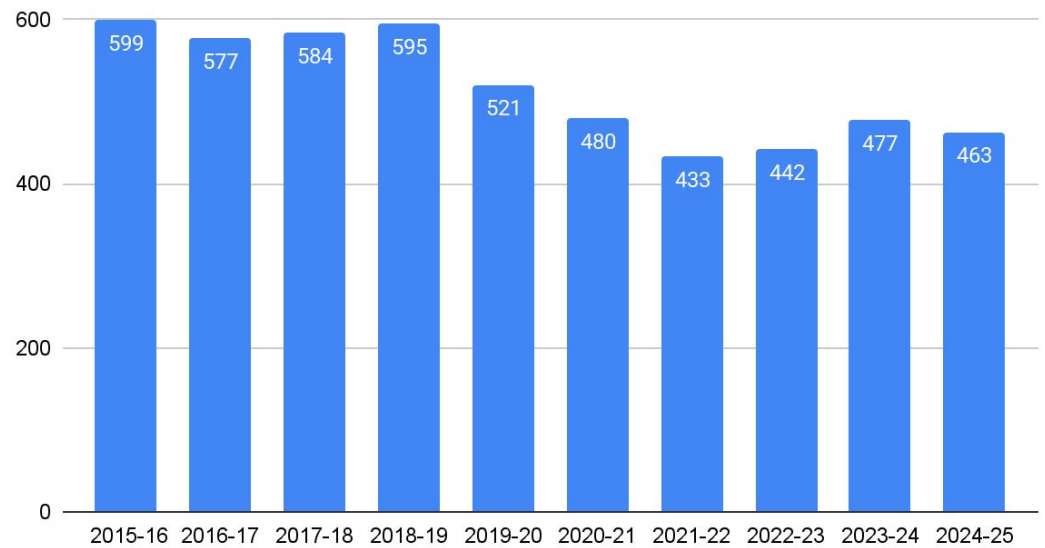

4.1 SITE MAP

ROOSEVELT ELEMENTARY SCHOOL

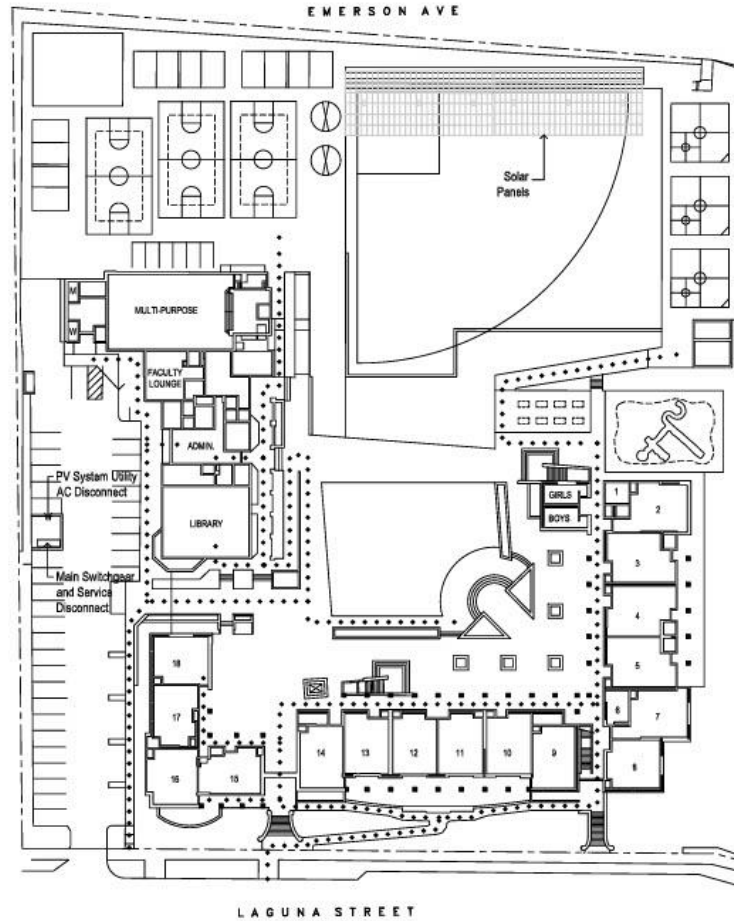

LEGEND

..... ADA PATH OF TRAVEL

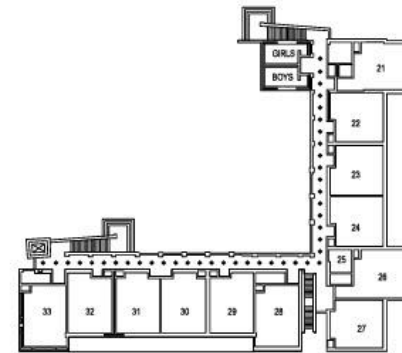

SECOND FLOOR

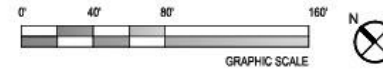

ROOSEVELT ELEMENTARY SCHOOL

CAMPUS MAP

1990 LAGUNA STREET, SANTA BARBARA, CA 93101

TELEPHONE: (805) 563 2062

UPDATED: JUNE 01, 2024



Santa Barbara Unified
Every child, every chance, every day.

4.1 RECOMMENDED PROJECTS

ROOSEVELT ELEMENTARY SCHOOL

1990 Laguna Street, Santa Barbara, California 93101

Source	Site	Project	Description/Comments	Type	Site Priority	FCA Priority
Facilities Condition Assessment (FCA)	Roosevelt	Playgrounds	Both playgrounds' Surfaces and Equipment need replacement	Site Work		1
Facilities Condition Assessment (FCA)	Roosevelt	Windows Replacement	Replace top floor classrooms windows	Modernization		3
School Feedback	Roosevelt	Space for track and field	Student Request	Site Work	4	
School Feedback	Roosevelt	Playground redesign and ADA upgrade	New structures for all abilities, swings, whale wall to climbing wall, including kinder, renovate handball walls, create new play spaces	Site Work	1	
School Feedback	Roosevelt	Security enhancement	Video intercom system for front office	Modernization	1	
School Feedback	Roosevelt	Replace broken umbrellas at tables	Part of group feedback list	Site Work	3	
School Feedback	Roosevelt	Landscape laguna	Complete phase 2 of the landscaping project on Laguna street	Site Work	2	
School Feedback	Roosevelt	Library upgrade	Redesign to include a modern learning areas within	Modernization	4	
School Feedback	Roosevelt	Shade structure and picnic tables	Install a shade structure and picnic tables	Site Work	3	

4.1 RECOMMENDED PROJECT

ROOSEVELT ELEMENTARY SCHOOL

1990 Laguna Street, Santa Barbara, California 93101

Source	Site	Project	Description/Comments	Type	Site Priority	FCA Priority
School Feedback	Roosevelt	More access for drop off and pick up	New request	Site Work	4	
School Feedback	Roosevelt	Upgrade field to turf	Install artificial turf in green area	Site Work	2	
School Feedback	Roosevelt	Digital Marquee	New Marquee	Modernization	4	
School Feedback	Roosevelt	Separate space for PE	PE is happening during recess and making half the space inaccessible to students who need to play. THIS is a part of the playground redesign project	Site Work	4	
School Feedback	Roosevelt	Rubberized Track for bikes	Install rubber track for bikes	Site Work	3	
School Feedback	Roosevelt	Cracks in outdoor whale wall	Hydrostatic pressures created cracks in the sloping whale wall, need to repair and repaint	Site Work	1	

4.1 BUILDING OVERVIEW

SANTA BARBARA COMMUNITY ACADEMY

850 Portesuello Avenue, Santa Barbara, California 93101

Information:

Year Built	1980
Gross Square Feet	21,136
Grade Levels	TK-6
Enrollment	221
Total No. Modular Units	2
Total No. Classrooms	11



Santa Barbara Community Academy Annual Enrollment

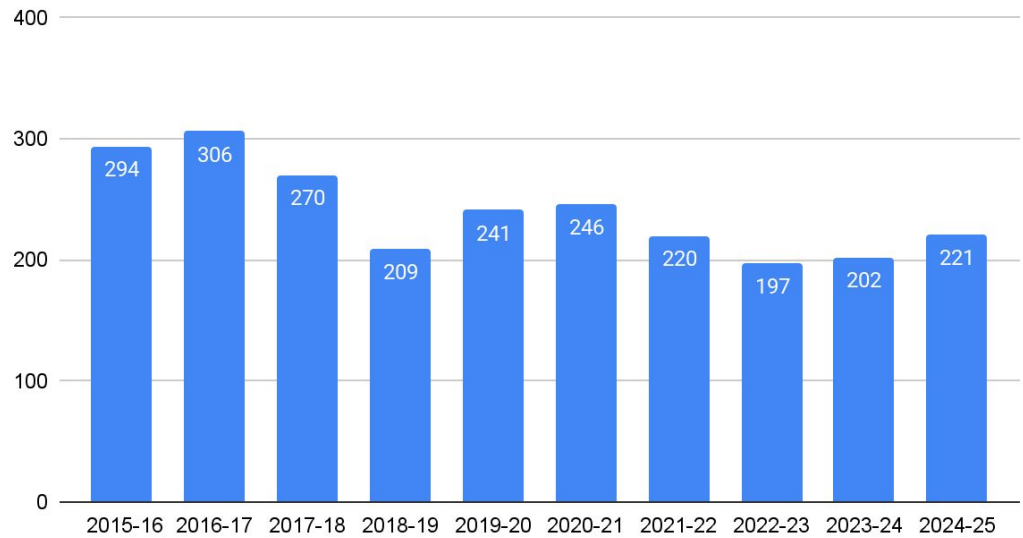

4.1 SITE MAP

SANTA BARBARA COMMUNITY ACADEMY



SANTA BARBARA COMMUNITY ACADEMY CAMPUS MAP

720A, SANTA BARBARA STREET, SANTA BARBARA, CA 93109
TELEPHONE: (805) 884 5902

4.1 RECOMMENDED PROJECTS

SANTA BARBARA COMMUNITY ACADEMY

850 Portesuello Avenue, Santa Barbara, California 93101

Source	Site	Project	Description/Comments	Type	Site Priority	FCA Priority
Facilities Condition Assessment (FCA)	SBCA	Administration Building Roofing Replacement	Admin Building roof needs replacing.	Modernization		3
Facilities Condition Assessment (FCA)	SBCA	Electrical Upgrade	Main panels	Modernization		4
School Feedback	SBCA	New restrooms	Inadequate number of restrooms in the building	Modernization	3	
School Feedback	SBCA	Wifi Enhancement	Add new fiber-optic line and wireless access points	Modernization	1	
School Feedback	SBCA	Holes in Playground	Several holes around the new playground may create a tripping hazard	Site Work	1	
School Feedback	SBCA	Flooring	Replace flooring in all classrooms and hallways. Requires abatement.	Modernization	3	

4.1 BUILDING OVERVIEW

WASHINGTON ELEMENTARY SCHOOL

290 Lighthouse, Santa Barbara, California 93109

Information:

Year Built	1953
Gross Square Feet	46,538
Grade Levels	TK-6
Enrollment	476
Total No. Modular Units	14
Total No. Classrooms	15



Washington Elementary School Annual Enrollment

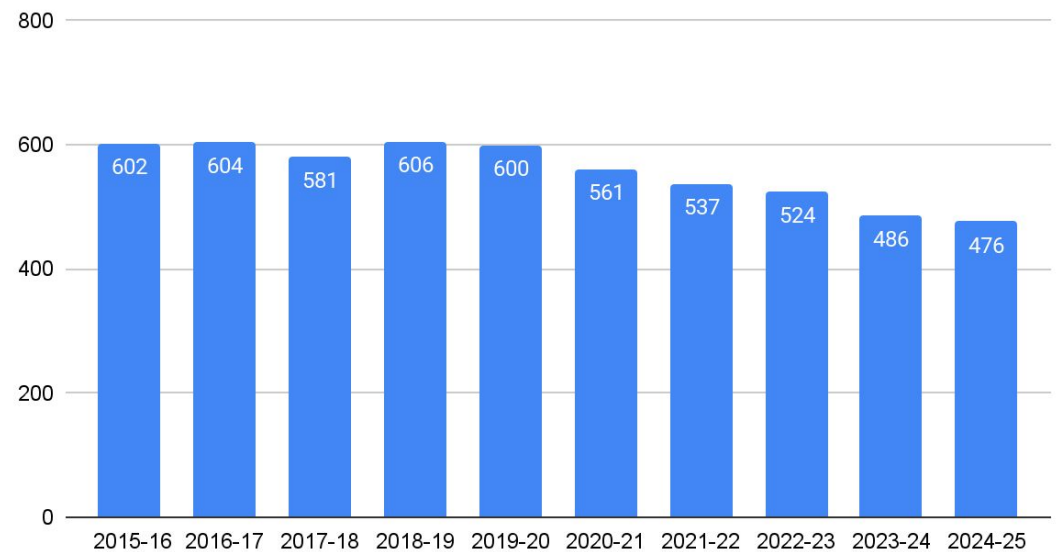

4.1 SITE MAP

WASHINGTON ELEMENTARY SCHOOL

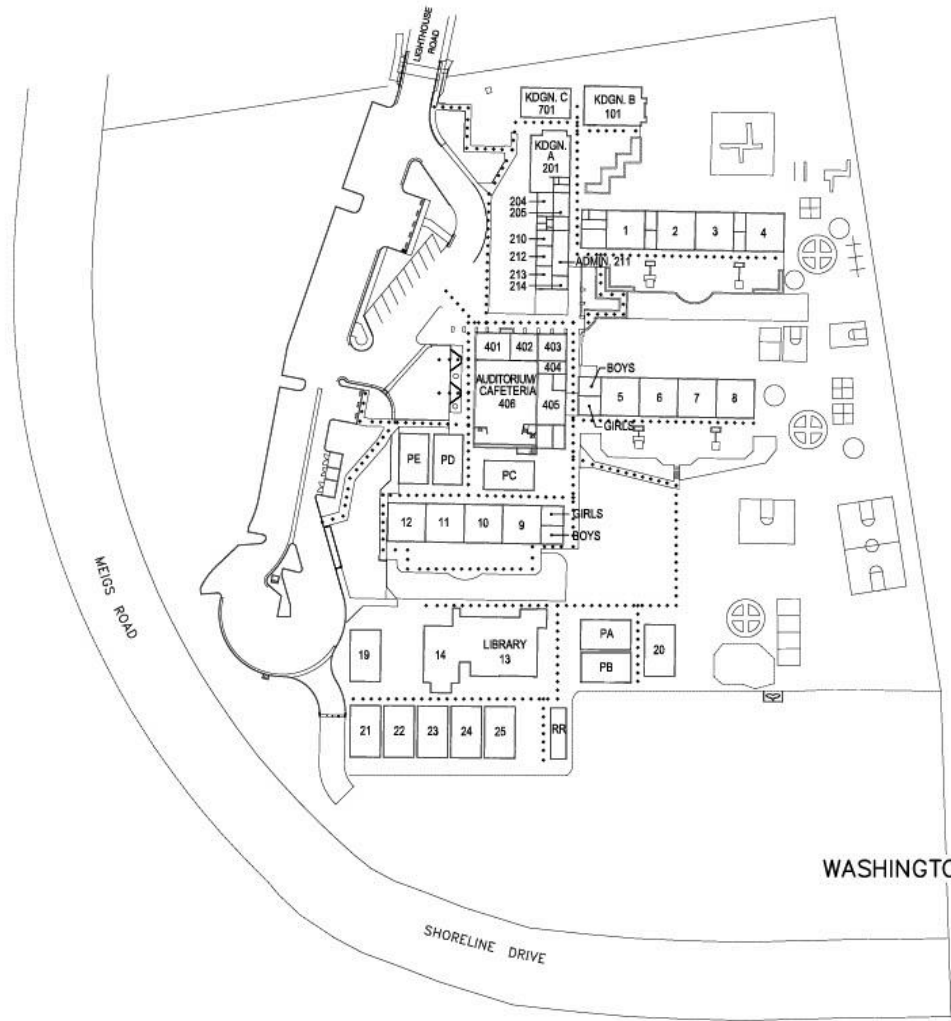

LEGEND

..... ADA PATH OF TRAVEL

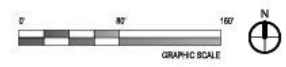
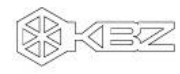

WASHINGTON ELEMENTARY SCHOOL
 INTERIM CAMPUS MAP
 280 LIGHTHOUSE ROAD, SANTA BARBARA, CA 93109
 TELEPHONE: (805) 965-6653
 UPDATED: JUNE 01, 2024

4.1 RECOMMENDED PROJECTS

WASHINGTON ELEMENTARY SCHOOL

290 Lighthouse, Santa Barbara, California 93109

Source	Site	Project	Description/Comments	Type	Site Priority	FCA Priority
Facilities Condition Assessment (FCA)	Washington	Exterior walls	Paint exterior walls throughout campus.	Modernization		4
Facilities Condition Assessment (FCA)	Washington	HVAC System	Replace furnaces and thermostats in classrooms.	Modernization		4
Facilities Condition Assessment (FCA)	Washington	Sewage System	Replace sewer line for staff room.	Modernization		3
Facilities Condition Assessment (FCA)	Washington	Playground	Replace Playground Surface	Site Work		1
Facilities Condition Assessment (FCA)	Washington	Repair or Replace Roofs	Rooms 19-25, PA, PB, PD, PE	Modernization		2
Facilities Condition Assessment (FCA)	Washington	Electrical Upgrades	Panels to each wing will need to be upgraded very limited	Modernization		4
Facilities Condition Assessment (FCA)	Washington	Ventilation System Upgrades	All duct work is original	Modernization		3

4.1 RECOMMENDED PROJECTS

WASHINGTON ELEMENTARY SCHOOL

290 Lighthouse, Santa Barbara, California 93109

Source	Site	Project	Description/Comments	Type	Site Priority	FCA Priority
School Feedback	Washington	Portable replacement	They are in bad condition, would be nice to get new buildings	New Construction	4	
School Feedback	Washington	Repavement of Playground	Not ADA, needs stairs in place of the slopes that are there, maybe put surface where the blacktop is	Modernization	1	
School Feedback	Washington	Air Conditioning	Parents are requesting air conditioning in all classrooms	Modernization	1	
School Feedback	Washington	Wheelable backdrop for plays	Install a backdrop for performances	Modernization	4	
School Feedback	Washington	Relocate garden	Near 6th grade classrooms, create an outdoor classroom space with seating and stumps	Site Work	3	
School Feedback	Washington	Safety Enhancement	Install new fence and gate for secure passage of kids from the kinder classroom	Site Work		
School Feedback	Washington	New Track	Around Perimeter of Field	Modernization	4	
School Feedback	Washington	Window Replacement	More energy efficient windows, the slats don't close all the way	Modernization	3	
School Feedback	Washington	Add two portables	TK is expanding, special education teachers are currently sharing a room	New Construction	2	
School Feedback	Washington	Repurposing Intervention Room	Divide it into 2 rooms to use for the 2 special ed teachers	Modernization	2	

4.1 BUILDING OVERVIEW

GOLETA VALLEY JUNIOR HIGH SCHOOL

2100 Stow Canyon Road, Santa Barbara, California 93117

Information:

Year Built	1964
Gross Square Feet	134,138
Grade Levels	7-8
Enrollment	731
Total No. Modular Units	4
Total No. Classrooms	40



Goleta Valley Junior High Annual Enrollment

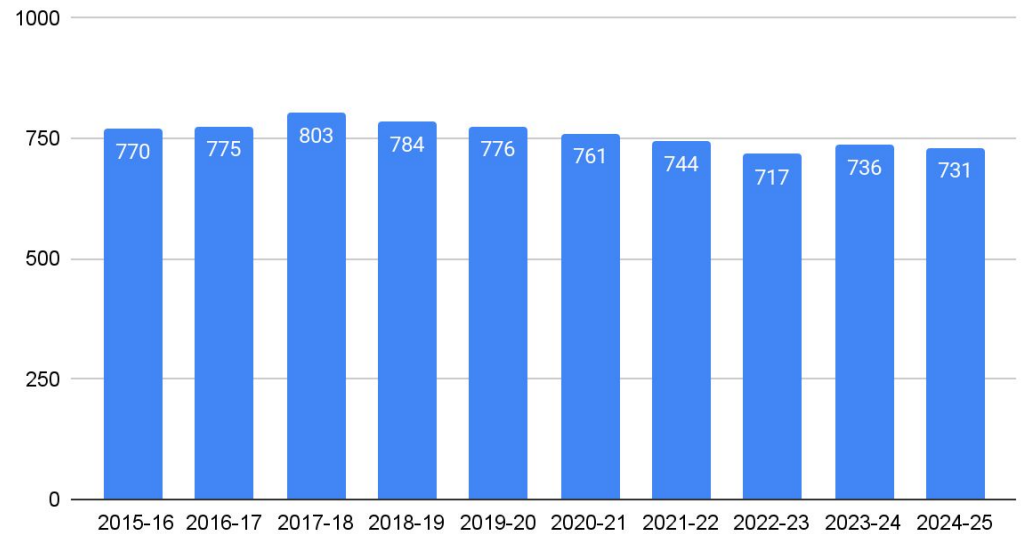

4.1 SITE MAP

GOLETA VALLEY JUNIOR HIGH SCHOOL

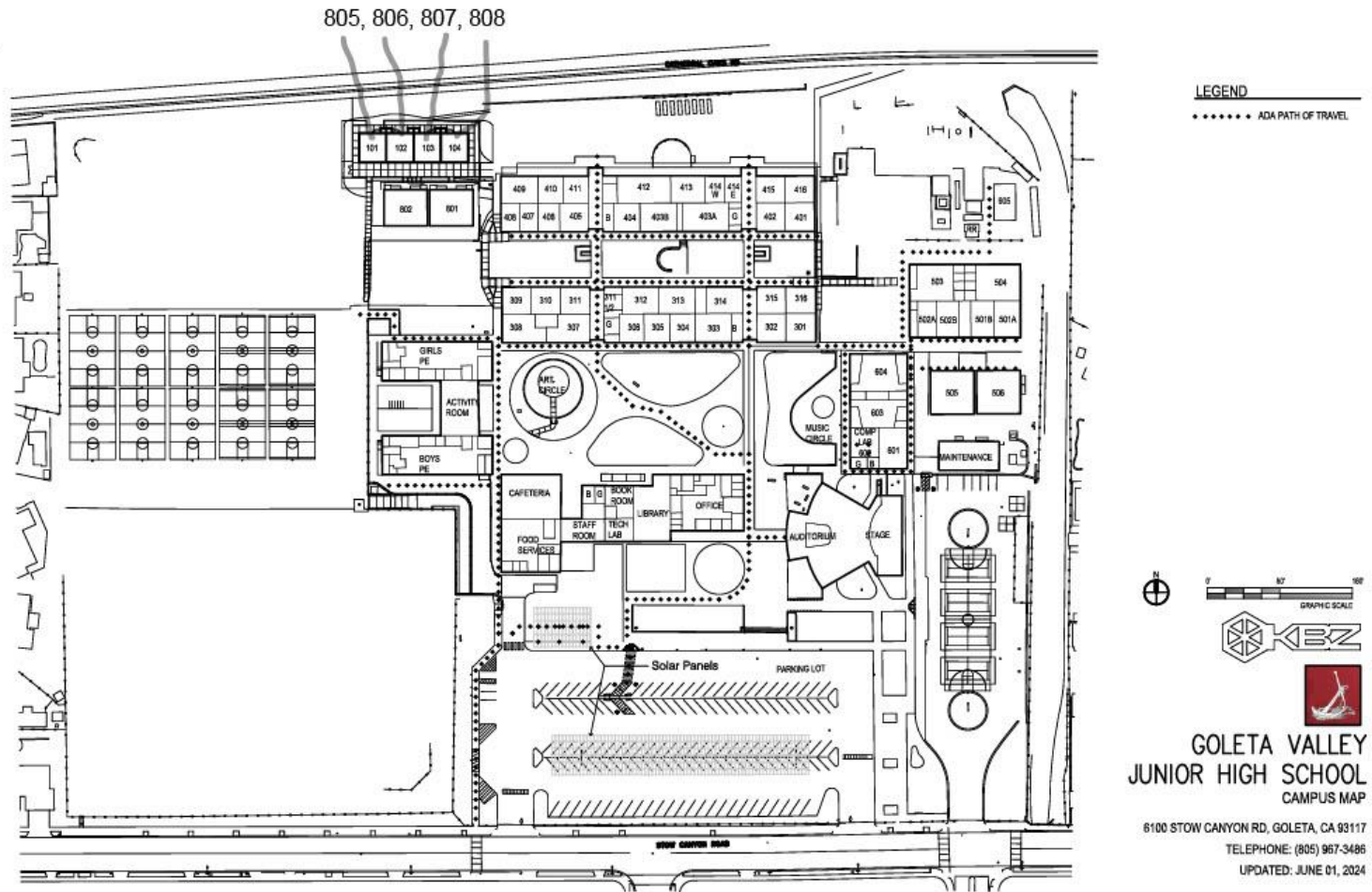

4.1 RECOMMENDED PROJECTS

Source	Site	Project	Description/Comments	Type	Site Priority	FCA Priority
Facilities Condition Assessment (FCA)	GVJHS	Exterior Doors	Replace 300 400 breezeway doors.	Modernization		3
Facilities Condition Assessment (FCA)	GVJHS	Sewage System	Replace sewer drain lines between the 300 and 400 buildings.	Modernization		3
Facilities Condition Assessment (FCA)	GVJHS	Underground plumbing	Entire campus Underground Infrastructure is over 60 years old and is galvanized.	Modernization		2
Facilities Condition Assessment (FCA)	GVJHS	Underground Wiring	Address underground wiring throughout campus	Modernization		4
Facilities Condition Assessment (FCA)	GVJHS & SBCS	Sewage System	Install grease trap or interceptor for drain lines.	Modernization		4
School Feedback	GVJHS	Create accessible path by installing a ramp	In room 604 to allow people of all abilities to access instruments (will need to meet with the teacher to better understand the situation)	Modernization	3	
School Feedback	GVJHS	Improve Wifi	Add Wireless Access Points	Modernization	3	
School Feedback	GVJHS	Security Enhancement	Window Coverings	Modernization	1	
School Feedback	GVJHS	Site improvement	By room 301, the pathway needs an overhang for rainy days	Site Work	4	
School Feedback	GVJHS	Cracks in floors	Throughout 300 building, admin building, and library, caused by a geological issue	Modernization	2	
School Feedback	GVJHS	Field Lighting	Need adequate field lighting, grounds are underutilized because of this.	Site Work	1	
School Feedback	GVJHS	400 Wing Bathroom	Add an additional Stall, according to head custodian	Modernization	3	
School Feedback	GVJHS	Building Replacement	Build the phase 2 New Special Education Building	New Construction		4

4.1 BUILDING OVERVIEW

LA COLINA JUNIOR HIGH SCHOOL

4025 Foothill Road, Santa Barbara, California 93110

Information:

Year Built	1959
Gross Square Feet	129,701
Grade Levels	7-8
Enrollment	832
Total No. Modular Units	2
Total No. Classrooms	35



La Colina Junior High School Annual Enrollment

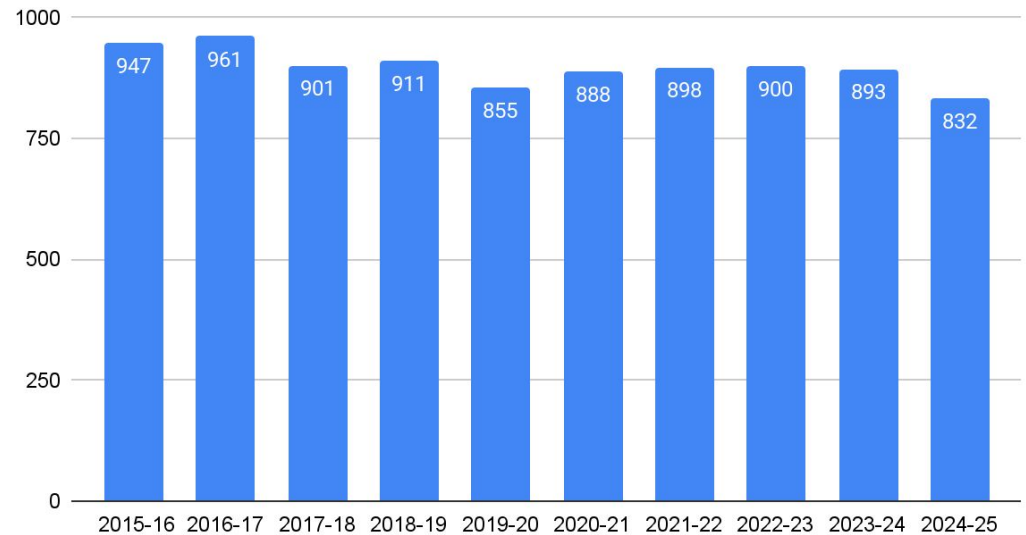

4.1 RECOMMENDED PROJECTS

Source	Site	Project	Description/Comments	Type	Site Priority	FCA Priority
Facilities Condition Assessment (FCA)	La Colina	Exterior Doors	Replace 300 400 breezeway doors and door jams.	Modernization		3
Facilities Condition Assessment (FCA)	La Colina	Administration Building Sewer Lines	The sewage lines need to be replaced	Modernization		2
Facilities Condition Assessment (FCA)	La Colina	Sewer Drain Lines Upgrade	Entire campus sewer lines eventually will need to be replaced.	Modernization		3
Facilities Condition Assessment (FCA)	La Colina	Underground Wiring	Underground wiring electrical upgrades	Modernization		2
Facilities Condition Assessment (FCA)	La Colina	Activity Roofing	Replace roof - On the list with Robert Robles	Modernization		2
School Feedback	La Colina	Theater Renovation	Full Remodel of the space	Modernization	4	
School Feedback	La Colina	HVAC System	Install Air Conditioning	Modernization	2	
School Feedback	La Colina	New Gym	Extension to the existing building, in the cutout space behind the activity room	New Construction	3	
School Feedback	La Colina	Cafeteria Remodel	It is completely original	Modernization	3	
School Feedback	La Colina	Create more sitting areas outdoors	Tables and shade structures, a trellis and benches outside activity room area	Site Work	4	
School Feedback	La Colina	Space use change	Install benches	Modernization	4	
School Feedback	La Colina	Landscaping drainage	Rethink the outdoor area to mitigate mud issue.	Site Work	4	
School Feedback	La Colina	Repave and Repaint Basketball area	Suggestion from leadership class	Site Work	3	
School Feedback	La Colina	Security Enhancement	Window coverings, cameras, video intercom system	Modernization	1	
School Feedback	La Colina	Furniture Modernization	Furniture replacement request for entire school	Modernization	3	
School Feedback	La Colina	Library Air Conditioning	Use as a cooling center	Modernization	3	

4.1 BUILDING OVERVIEW

LA CUMBRE JUNIOR HIGH SCHOOL

2255 Modoc Road, Santa Barbara, California 93101

Information:

Year Built	1928
Gross Square Feet	117,788
Grade Levels	7-8
Enrollment	426
Total No. Modular Units	0
Total No. Classrooms	37



La Cumbre Junior High School Annual Enrollment

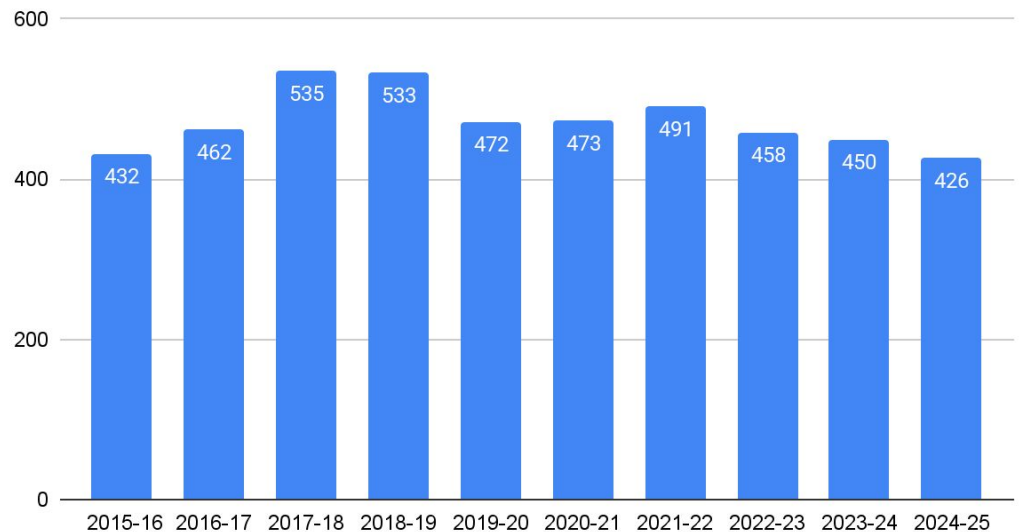

4.1 SITE MAP

LA CUMBRE JUNIOR HIGH SCHOOL

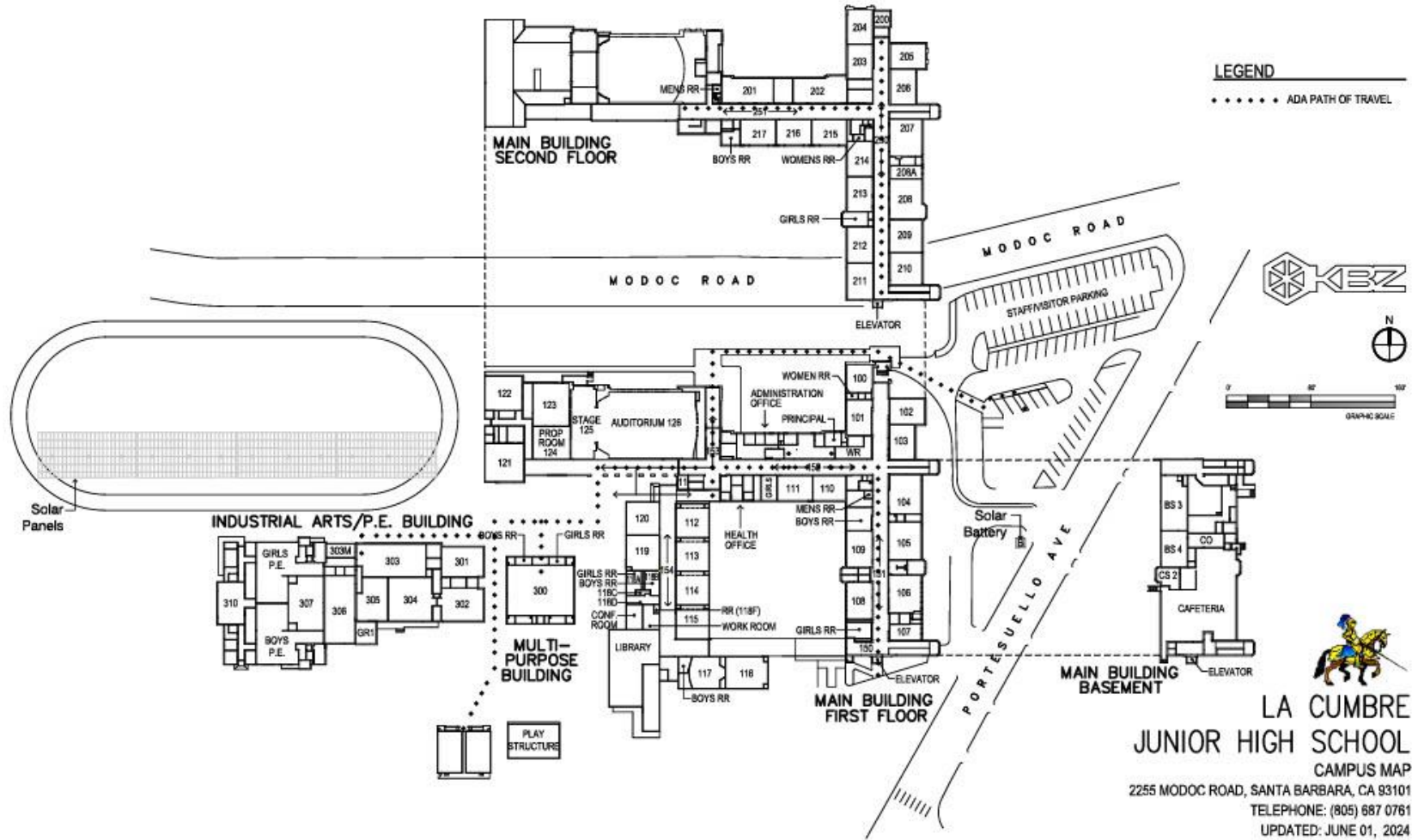

LA CUMBRE JUNIOR HIGH SCHOOL
 CAMPUS MAP
 2255 MODOC ROAD, SANTA BARBARA, CA 93101
 TELEPHONE: (805) 687 0761
 UPDATED: JUNE 01, 2024

4.1 RECOMMENDED PROJECTS

LA CUMBRE JUNIOR HIGH SCHOOL

2255 Modoc Road, Santa Barbara, California 93101

Source	Site	Project	Description/Comments	Type	Site Priority	FCA Priority
Facilities Condition Assessment (FCA)	La Cumbre	Electrical Upgrade	Upgrade main panel in hallway.	Modernization		3
Facilities Condition Assessment (FCA)	La Cumbre	Flooring	Replace flooring in main building.	Modernization		4
Facilities Condition Assessment (FCA)	La Cumbre	Plumbing System	Upgrade partial plumbing infrastructure under the industrial room.	Modernization		1
Facilities Condition Assessment (FCA)	La Cumbre	Sewer Drain Lines Upgrade	Upgrade sewage system	Modernization		1
Facilities Condition Assessment (FCA)	La Cumbre	Parapet Wall Main Building Repair	Waterproofing project	Modernization		3
Facilities Condition Assessment (FCA)	La Cumbre	Cafeteria Upgrades	Major remodel	Modernization		3
School Feedback	La Cumbre	Cafeteria Remodel	The dining room remodel is overdue	Modernization	1	
School Feedback	La Cumbre	Kitchen	Replace floors, walls, grease interceptor and hoods per the Health Department requirements	Modernization	1	
School Feedback	La Cumbre	Room 203 and woodshop	Roofing upgrade	Modernization	1	

4.1 RECOMMENDED PROJECTS

LA CUMBRE JUNIOR HIGH SCHOOL

2255 Modoc Road, Santa Barbara, California 93101

Source	Site	Project	Description/Comments	Type	Site Priority	FCA Priority
School Feedback	La Cumbre	Air Conditioning	HVAC upgrade	Modernization	3	
School Feedback	La Cumbre	Tech lab renovation	Create a manufacturing lab with metal shop	Modernization	2	
School Feedback	La Cumbre	Enhance Security	Video intercom system, maybe a key card system for doors	Modernization	1	
School Feedback	La Cumbre	Cafeteria roof	Consistent leaks during rains	Modernization	1	
School Feedback	La Cumbre	Perimeter Fence	Add sections of fencing in a few areas around the courtyard	Site Work	3	
School Feedback	La Cumbre	Taller Fence around field	Unsafe height because the kids jump over it (check notes for specifics)	Site Work	1	
School Feedback	La Cumbre	Shade structure	Install shade structure over lunch area to	Site Work	3	
School Feedback	La Cumbre	Band room renovation	Full remodel of the space	Modernization	3	
School Feedback	La Cumbre	Theater sound and lighting	Upgrade of sound and light systems	Modernization	1	

4.1 BUILDING OVERVIEW

SANTA BARBARA JUNIOR HIGH SCHOOL

721 East Cota Street, Santa Barbara, California 93103

Information:

Year Built	1932
Gross Square Feet	170,589
Grade Levels	7-8
Enrollment	512
Total No. Modular Units	0
Total No. Classrooms	40



Santa Barbara Junior High School Annual Enrollment

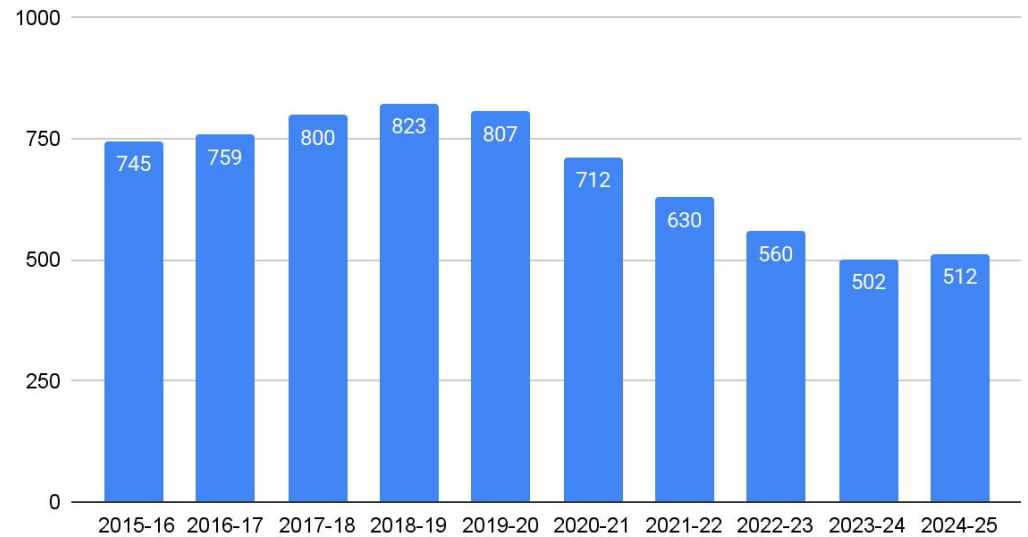

4.1 SITE MAP

SANTA BARBARA JUNIOR HIGH SCHOOL

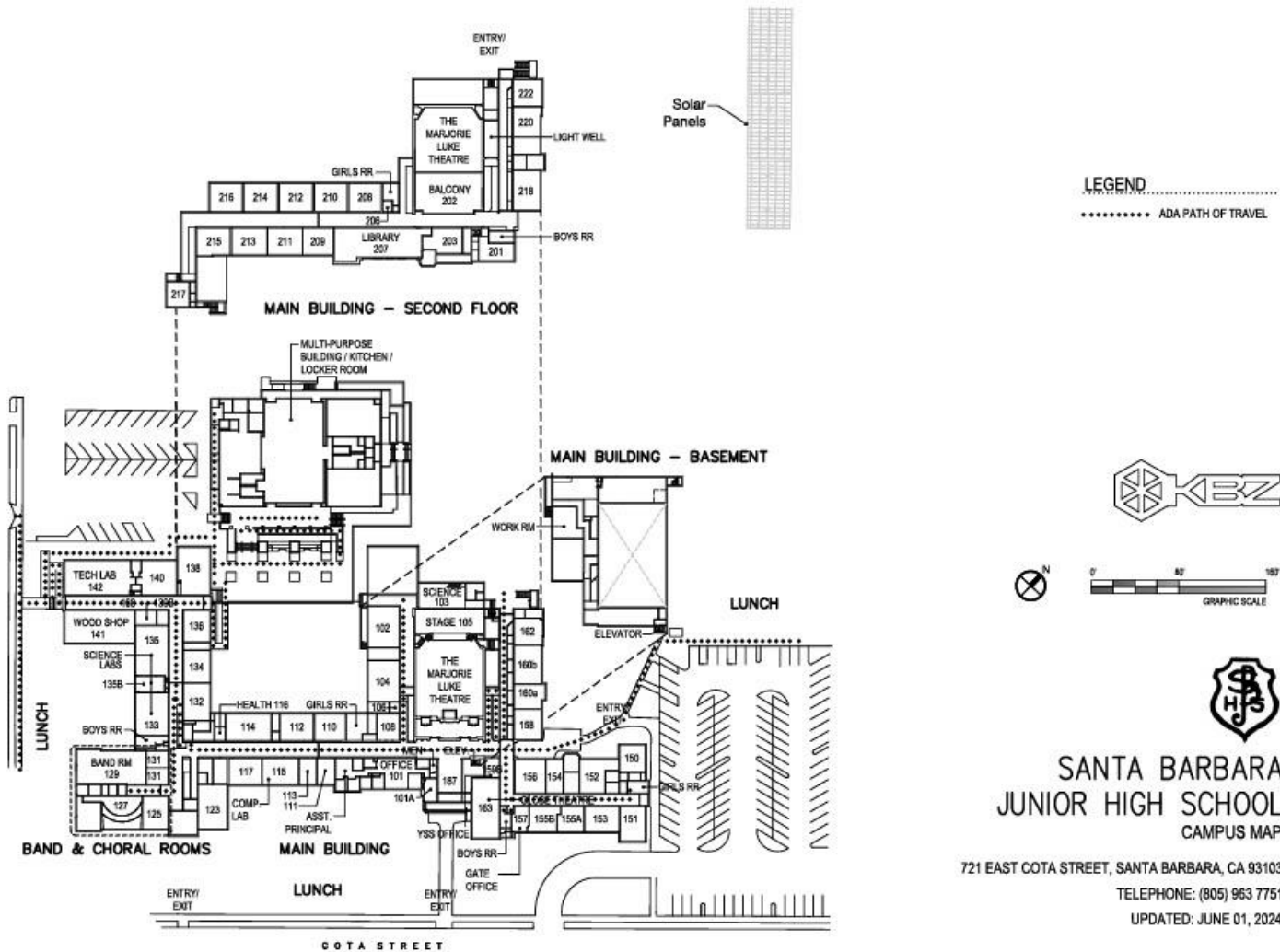

4.1 RECOMMENDED PROJECTS

SANTA BARBARA JUNIOR HIGH SCHOOL

721 East Cota Street, Santa Barbara, California 93103

Source	Site	Project	Description/Comments	Type	Site Priority	FCA Priority
Facilities Condition Assessment (FCA)	SBJHS	Exterior walls	Paint exterior walls throughout campus.	Modernization		4
Facilities Condition Assessment (FCA)	SBJHS	Sewer Drain Lines	Globe restroom sewer line runs to lawn area needs replacing.	Modernization		3
Facilities Condition Assessment (FCA)	SBJHS	Electrical Upgrades	Upgrade all panels	Modernization		4
Facilities Condition Assessment (FCA)	SBJHS	Flooring Upgrades	The main building needs flooring.	Modernization		4
Facilities Condition Assessment (FCA)	SBJHS	Restroom Upgrades	Remodel 5 restrooms	Modernization		4
School Feedback	SBJHS	Railing outside MPR	Install railing or bushes on ledge outside of MPR	Site Work	3	
School Feedback	SBJHS	Electrical upgrade in the Luke	Need an upgrade in Luke Theater	Modernization	3	

4.1 BUILDING OVERVIEW

DOS PUEBLOS HIGH SCHOOL

7266 Alameda Avenue, Santa Barbara, California 93117

Information:

Year Built	1966
Gross Square Feet	386,038
Grade Levels	9-12
Enrollment	2,149
Total No. Modular Units	3
Total No. Classrooms	86



Dos Pueblos High School Annual Enrollment

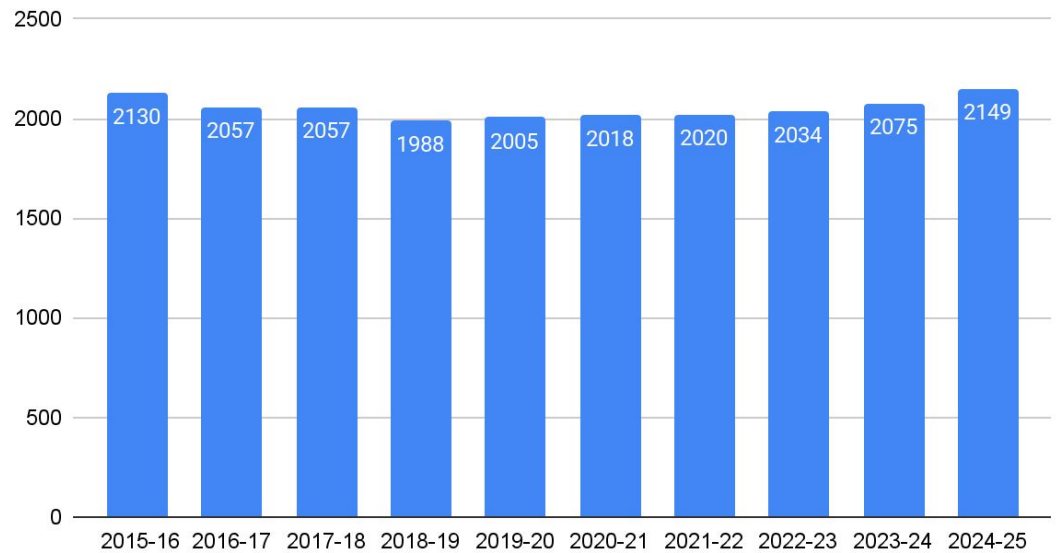

4.1 SITE MAP

DOS PUEBLOS HIGH SCHOOL

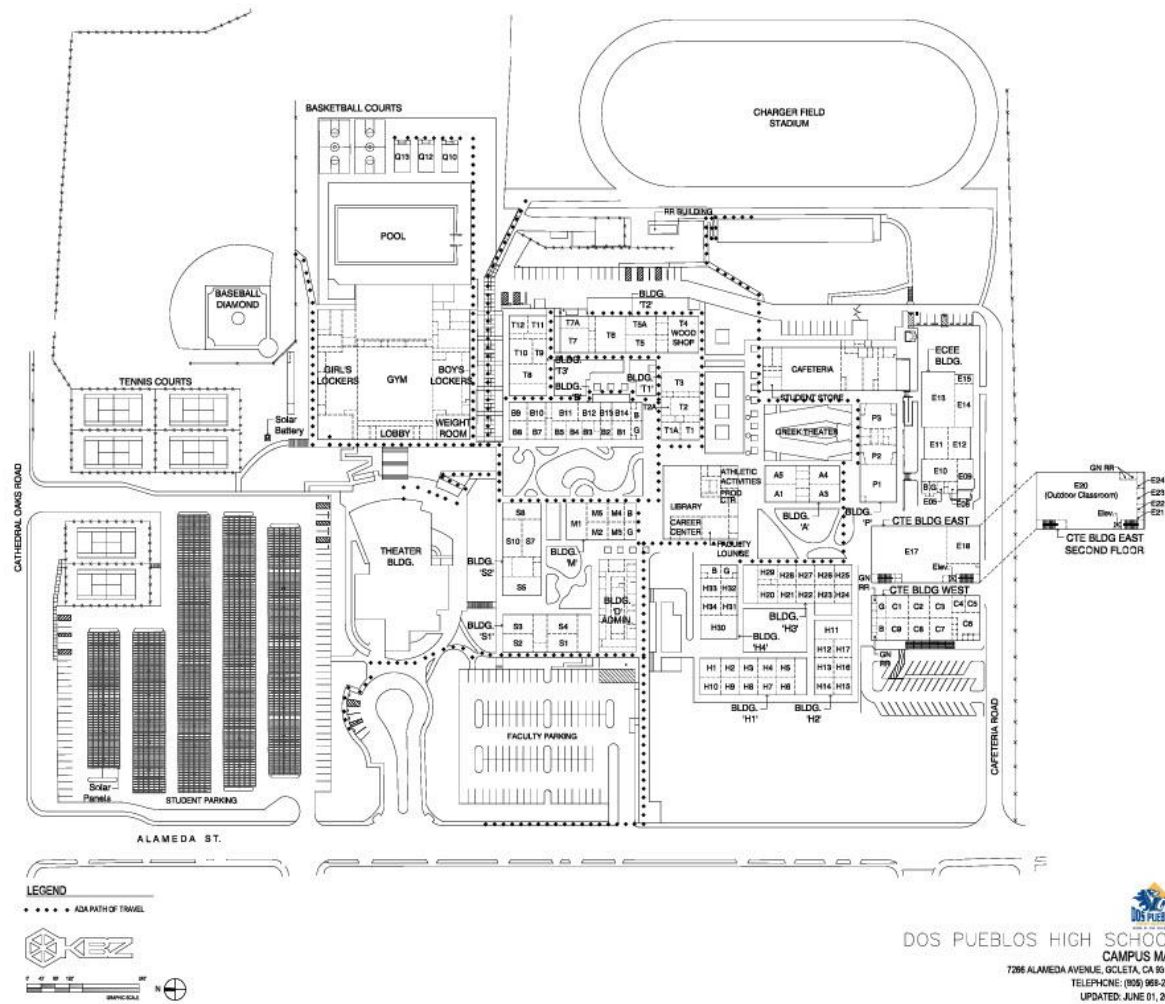

4.1 RECOMMENDED PROJECTS

DOS PUEBLOS HIGH SCHOOL

7266 Alameda Avenue, Santa Barbara, California 93117

Source	Site	Project	Description/Comments	Type	Site Priority	FCA Priority
Facilities Condition Assessment (FCA)	DPHS	Ventilation System Upgrades	Upgrade exposed ductwork and rusted seams in EPAC HVAC system	Modernization		4
Facilities Condition Assessment (FCA)	DPHS	New Stadium Restrooms	Inadequate restroom facilities by the stadium	Modernization		3
Facilities Condition Assessment (FCA)	DPHS	Stadium Lighting	New LED lights	Modernization		3
Facilities Condition Assessment (FCA)	DPHS	Gym HVAC	Add AC	Modernization		4
Facilities Condition Assessment (FCA)	DPHS	PressBox	Need Stadium press box, currently in progress	Modernization		2
Facilities Condition Assessment (FCA)	DPHS	Cafeteria and Kitchen Upgrades	Remodel	Modernization		3
Facilities Condition Assessment (FCA)	DPHS	Girls and Boys Locker Room Roof	New Roofing	Modernization		2
Facilities Condition Assessment (FCA)	DPHS	Tennis Court Replacement	Sinking soil under the tennis courts	Modernization		4

4.1 RECOMMENDED PROJECTS

DOS PUEBLOS HIGH SCHOOL

7266 Alameda Avenue, Santa Barbara, California 93117

Source	Site	Project	Description/Comments	Type	Site Priority	FCA Priority
School Feedback	DPHS	Boys Bathroom Modifications	Improve accessibility and functionality of boy's restroom	Modernization	3	
School Feedback	DPHS	2 Portable Classrooms	DP currently has 2150 students and enrollment continues to grow. We are using every single classroom space on campus and have teachers who share classrooms. Two portable classrooms installed in this area addresses two big needs.	New Construction	1	
School Feedback	DPHS	Pressbox	Install new press box	Modernization	1	
School Feedback	DPHS	Main Office Layout Remodel		Modernization	3	
School Feedback	DPHS	Theater Upgrade	Curtains, lighting and sound system	Modernization	2	
School Feedback	DPHS	Security Enhancement	Install Inside camera system and alarm for C building (separate from school cameras)	Modernization	1	
School Feedback	DPHS	H Wing Umbrellas	Outdoor Area	Site Work	4	
School Feedback	DPHS	Softball Backstops	The softball backstops and fence are almost 30 years old and in need of replacing, or at least "stretching" as per the term in the chain link fencing world.	Site Work	3	

4.1 RECOMMENDED PROJECTS

DOS PUEBLOS HIGH SCHOOL

7266 Alameda Avenue, Santa Barbara, California 93117

Source	Site	Project	Description/Comments	Type	Site Priority	FCA Priority
School Feedback	DPHS	Pave Lower Lot	The dirt lot used for parking at the softball fields creates ongoing accessibility issues, particularly for individuals with disabilities. Its unpaved surface makes it difficult to navigate, posing challenges for ADA compliance. Additionally, limited parking availability continues to be a problem for facility users.	Site Work	4	
School Feedback	DPHS	Gravel Paths	Add gravel on paths that get muddy to prevent kids tracking in mud, near S wing, M wing and Kelly Savio's class	Site Work	1	
School Feedback	DPHS	Basketball Scoreboard	Replace basketball scoreboard	Modernization	4	
School Feedback	DPHS	Cafeteria and Kitchen Floor	Bill: The tile in the cafeteria is original to the school from the 60s. Asbestos removal and replacing tile with laminate similar to SBHS would be ideal for this space used by the entire school community.	Modernization	2	
School Feedback	DPHS	Gym Floor	Floor is original to the school; at some point it will need to be replaced as it's really 'creaky' though we do our best to maintain.	Modernization	2	

4.1 RECOMMENDED PROJECTS

DOS PUEBLOS HIGH SCHOOL

7266 Alameda Avenue, Santa Barbara, California 93117

Source	Site	Project	Description/Comments	Type	Site Priority	FCA Priority
School Feedback	DPHS	Automated ADA push-button entrance system	Automatically Open doors the admin building, gym, EPAC, cafeteria, library, classrooms b7 b6 b9 b10 t7	Modernization	4	
School Feedback	DPHS	Furniture Modernization	Having completed approx 60 classrooms, we have 20 classrooms still in line for classroom furniture modernization.	Modernization	4	
School Feedback	DPHS	Safety Enhancement	Window Coverings	Modernization	1	
School Feedback	DPHS	Add Perimeter Fencing	Along Alameda to secure campus more	Site Work	4	
School Feedback	DPHS	Additional Staff Restrooms	There are currently 4 staff restrooms and 150 staff.	New Construction	2	
School Feedback	DPHS	HVAC System	Upgrade HVAC system to add Air Conditioning	Modernization	4	
School Feedback	DPHS	Stadium Restrooms	The stadium facility currently only has one portable restroom facility with limited stalls creating log jams and frustration during big events (the line for restrooms snakes out of the door -especially for women's restroom.	New Construction	2	
School Feedback	DPHS	Repurpose T5 & T6	Repurpose the custodial room as a classroom, but then we need another space for custodians. It would be better for the custodians to have a place to meet, get the traffic contained over there.	Modernization	3	
School Feedback	DPHS	Turf replacement	New Turf for Stadium	Site Work	4	
School Feedback	DPHS	Art Room Tiles	Replace Art room floors	Modernization	3	

4.1 BUILDING OVERVIEW

LA CUESTA CONTINUATION HIGH SCHOOL

710 Santa Barbara Street, Santa Barbara, California 93101

Information:

Year Built	2000
Gross Square Feet	16,100
Grade Levels	9-12
Enrollment	77
Total No. Modular Units	0
Total No. Classrooms	11



La Cuesta Continuation High School Annual Enrollment

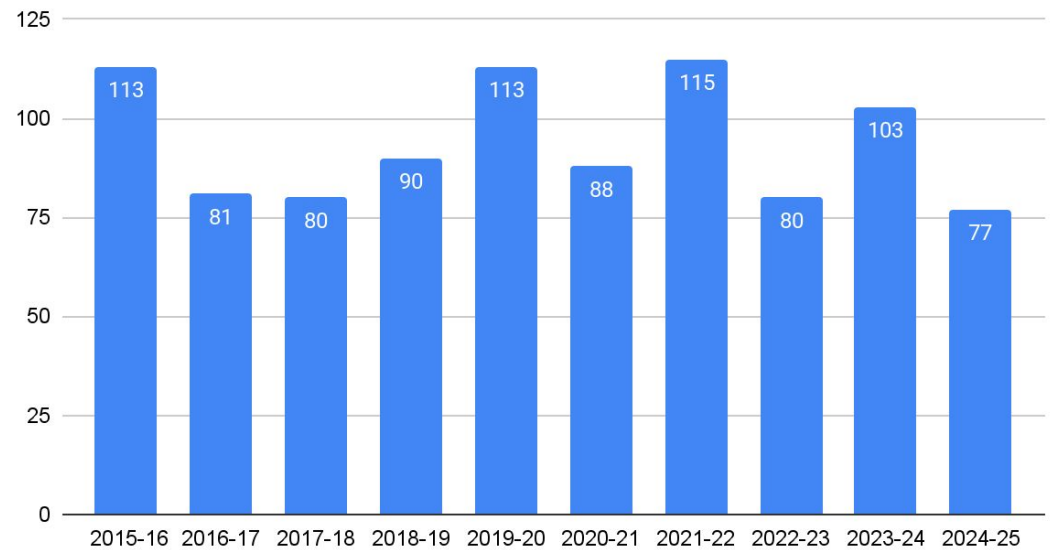

4.1 SITE MAP

LA CUESTA CONTINUATION HIGH SCHOOL

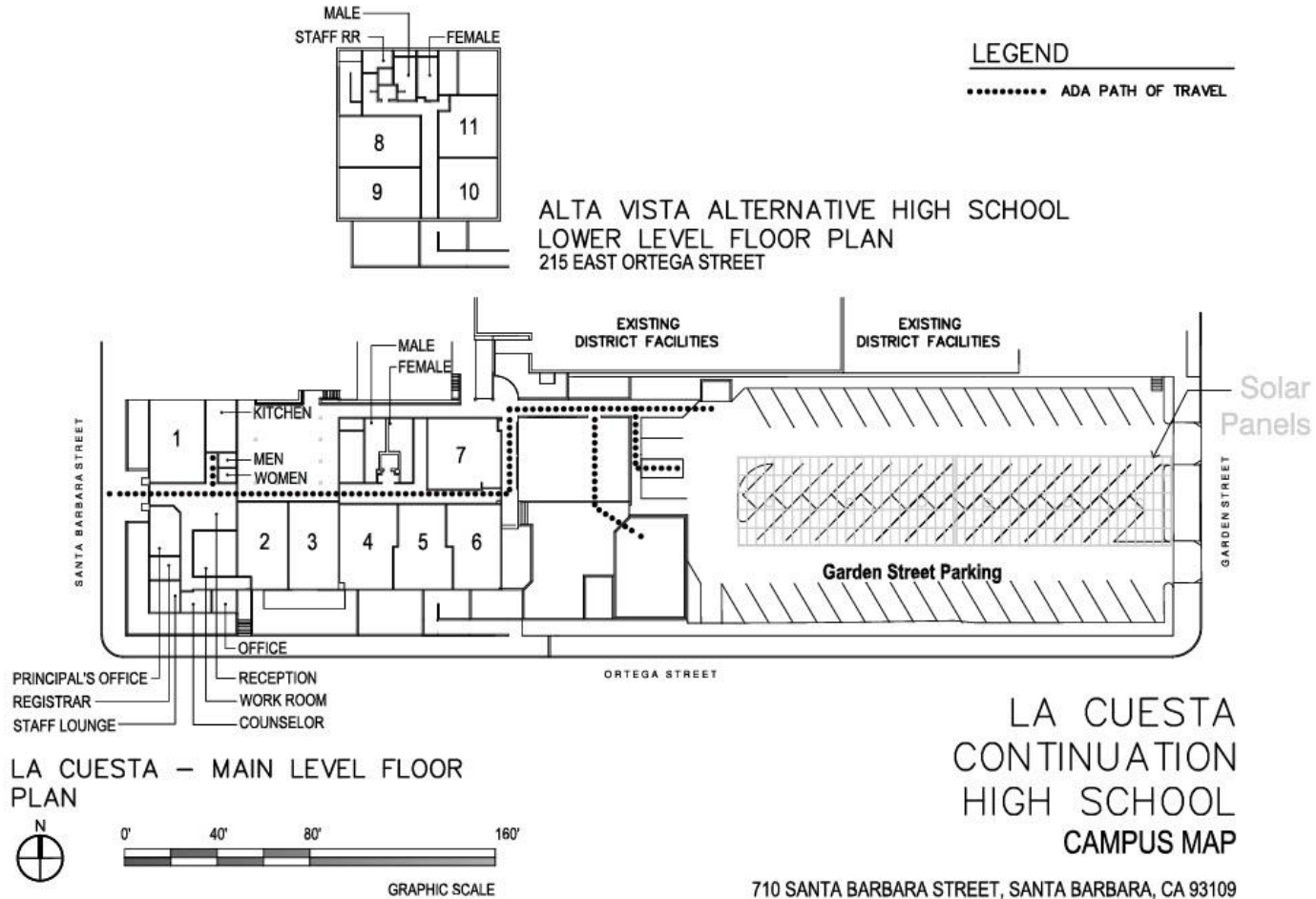

4.1 RECOMMENDED PROJECTS

LA CUESTA CONTINUATION HIGH SCHOOL

710 Santa Barbara Street, Santa Barbara, California 93101

Source	Site	Project	Description/Comments	Type	Site Priority	FCA Priority
School Feedback	DO / La Cuesta	Flooring	Replace tiles in district office quad, would require removing some concrete.	Modernization		2
School Feedback	La Cuesta	Air Conditioning	Special Ed and Quetzal, priority since the kids are learning to adjust to new surroundings and need to have comfortable temperatures in the classrooms	Modernization	1	
School Feedback	La Cuesta	Infrastructure for Recording Studio	New sound recording equipment	Modernization		
School Feedback	La Cuesta	Outdoor Learning Space	Create a presentable space to replace the current tents	Site Work	3	
School Feedback	La Cuesta	Intercom/PA System	Alta Vista School Site	Modernization	1	
School Feedback	La Cuesta	Electrical Upgrade	Makerspace	Modernization	3	

4.1 BUILDING OVERVIEW

ALTA VISTA ALTERNATIVE HIGH SCHOOL

215 E Ortega Street, Santa Barbara, California 93101

Information:

Year Built	2000
Gross Square Feet	1,920
Grade Levels	9-12
Enrollment	119
Total No. Modular Units	0
Total No. Classrooms	4



Alta Vista Alternative High School Annual Enrollment

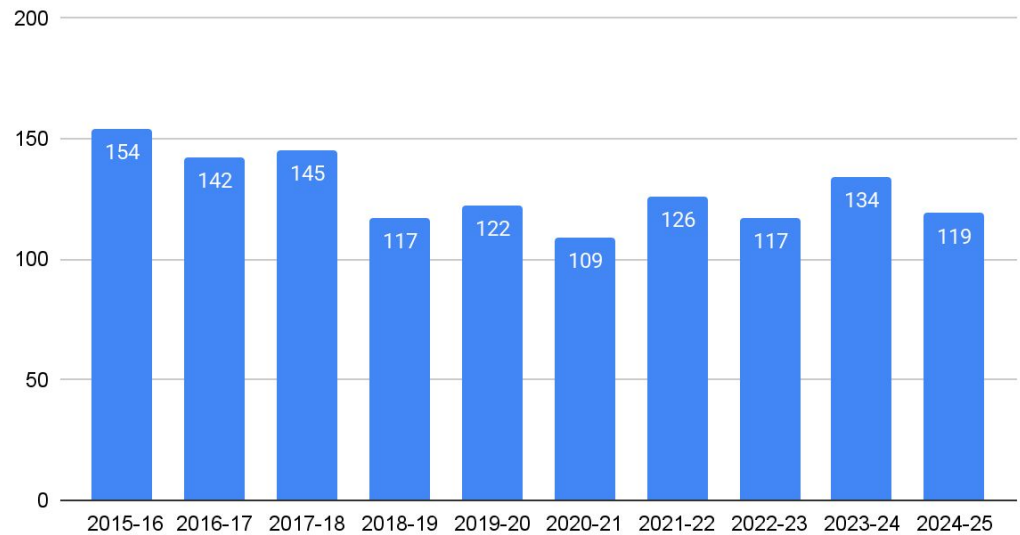

4.1 BUILDING OVERVIEW

SAN MARCOS HIGH SCHOOL

4750 Hollister Avenue, Santa Barbara, California 93110

Information:

Year Built	1958
Gross Square Feet	367,044
Grade Levels	9-12
Enrollment	1926
Total No. Modular Units	13
Total No. Classrooms	70



San Marcos High School Annual Enrollment

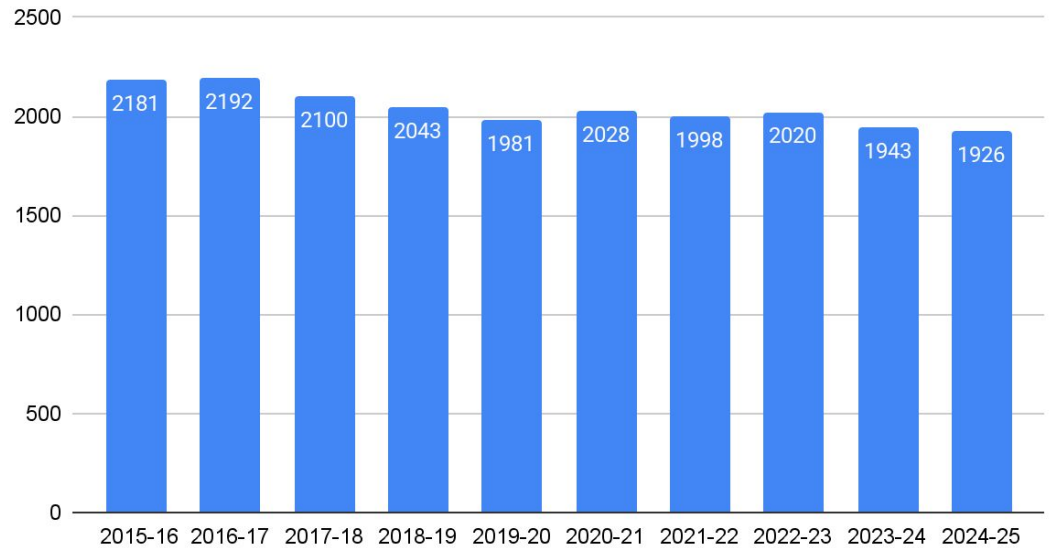

4.1 SITE MAP

SAN MARCOS HIGH SCHOOL

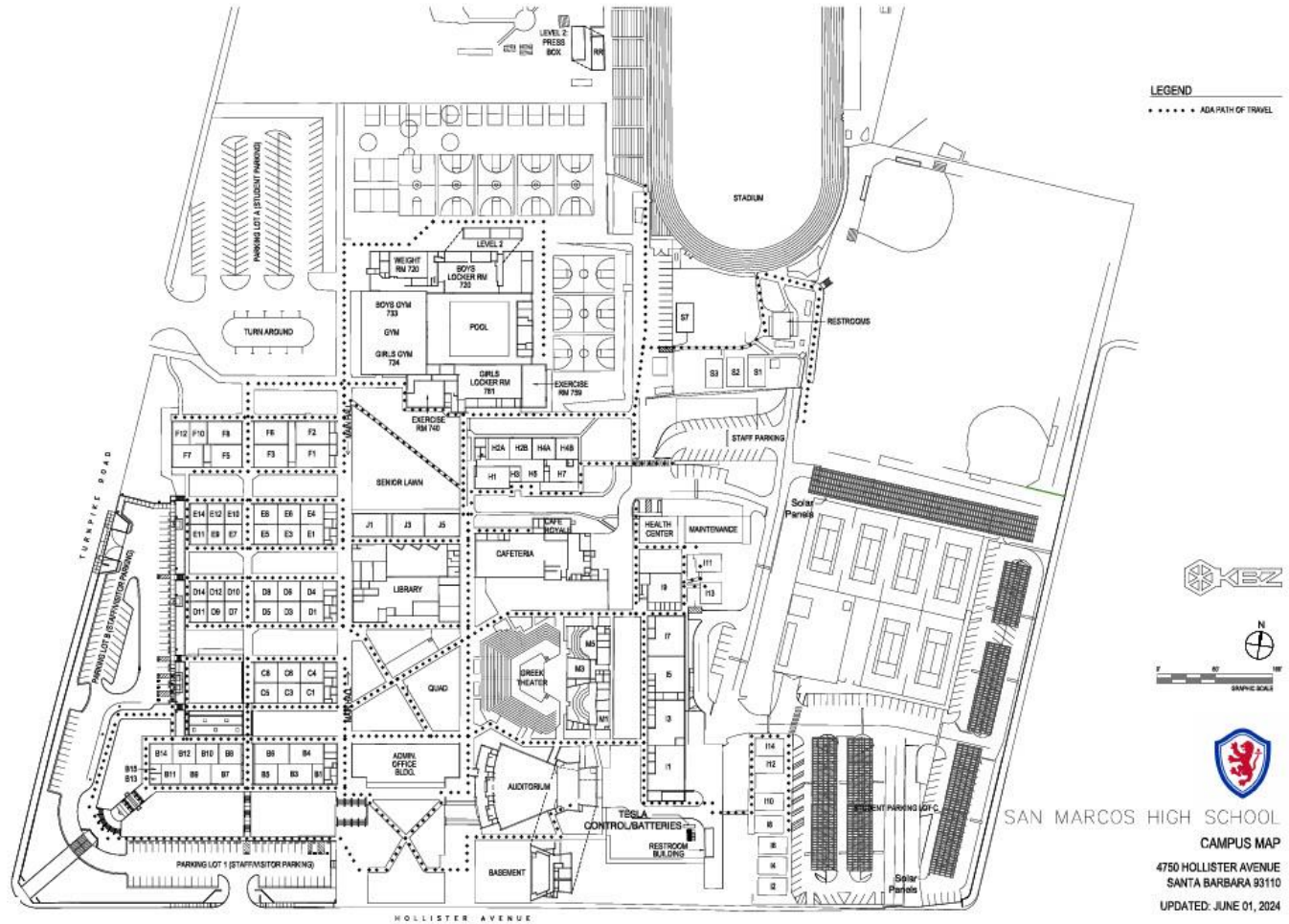

4.1 RECOMMENDED PROJECTS

SAN MARCOS HIGH SCHOOL

4750 Hollister Avenue, Santa Barbara, California 93110

Source	Site	Project	Description/Comments	Type	Site Priority	FCA Priority
Facilities Condition Assessment (FCA)	SMHS	Exterior walls	Paint exterior walls throughout campus.	Modernization		3
Facilities Condition Assessment (FCA)	SMHS	HVAC System	Replace furnaces and thermostats in H-wing.	Modernization		3
Facilities Condition Assessment (FCA)	SMHS	Roofing Replacement	Main building, B Wing, Ewing, and F-wing Roof needs attending to.	Modernization		1
Facilities Condition Assessment (FCA)	SMHS	Roofing Replacement	H-wing roofing need roof replace	Modernization		1
Facilities Condition Assessment (FCA)	SMHS	Roofing Replacement	M-Wing roof need to be replaced	Modernization		1
Facilities Condition Assessment (FCA)	SMHS	Girls Restroom Renovation, plumbing, flooring walls and fixtures	The girls restrooms needs a full upgrade and it is closed off as of now, due to not ADA and missing toilets as they are obsolete.	Modernization		3
Facilities Condition Assessment (FCA)	SMHS	Modernization	Girls and Boys Locker room building (roof) needs replacing	Modernization		3
Facilities Condition Assessment (FCA)	SMHS	Modernization	MPR and Kitchen Upgrades	Modernization		3
Facilities Condition Assessment (FCA)	SMHS	Modernization	Student Parking Lot New Asphalt	Modernization		3
Facilities Condition Assessment (FCA)	SMHS	Electrical Upgrades	Each wing will need upgrading	Modernization		4
Facilities Condition Assessment (FCA)	SMHS	Flooring Upgrades	K-Wing Portables flooring needs replacing.	Modernization		4

4.1 RECOMMENDED PROJECTS

SAN MARCOS HIGH SCHOOL

4750 Hollister Avenue, Santa Barbara, California 93110

Source	Site	Project	Description/Comments	Type	Site Priority	FCA Priority
Facilities Condition Assessment (FCA)	SMHS	Underground Wiring	Underground wiring in throughout the campus will need to be replaced.	Modernization		4
Facilities Condition Assessment (FCA)	SMHS	Stadium Turf Replacement	New Turf	Modernization		2
Facilities Condition Assessment (FCA)	SMHS	I- Wing Covered Walkway Replacement	Repair the damaged T&G substraigh alone with the leaking roof material	Modernization		3
Facilities Condition Assessment (FCA)	SMHS	Pressbox Roof Replacement	Press box roof is in bad shape and shows signs of leaking	Modernization		3
School Feedback	SMHS	Add a 2nd story to the M wing	Need more classroom space. Would be better than re-roofing M wing and might not need elevator because of current design.	New Construction		4
School Feedback	SMHS	Complete C Wing	Add permanent classrooms to the Turnpike side of the C wing	New Construction		4
School Feedback	SMHS	Replace portables with permanent buildings	I Wing portables have now been in current location for 20 years.	New Construction		4
School Feedback	SMHS	New building for Hospitality pathway	Need a new two story building to house culinary, Entrepreneurship Academy	New Construction		4

4.1 RECOMMENDED PROJECTS

SAN MARCOS HIGH SCHOOL

4750 Hollister Avenue, Santa Barbara, California 93110

Source	Site	Project	Description/Comments	Type	Site Priority	FCA Priority
School Feedback	SMHS	New Pool	Despite having the best aquatics program in the county, our water polo teams are unable to host CIF home games because our pool is not up to CIF standards. We also lack a diving board. The other two high schools have 40 and 50 meter pools. our is 25 x 25.	New Construction	4	
School Feedback	SMHS	Roof Replacement	B-Wing, D-Wing, E- Wing and F-Wing roofs	Modernization	1	
School Feedback	SMHS	Roof Replacement	H-Wing Roof	Modernization	1	
School Feedback	SMHS	Roof Replacement	M-Wing roof	Modernization	1	
School Feedback	SMHS	"C-Lot" Parking area	Main student parking lot by the tennis courts is in abismal shape and needs to be repaved and striped.	Site Work	1	
School Feedback	SMHS	Gymnasium AC	Install Air Conditioning	Modernization	1	
School Feedback	SMHS	Track and Field	Resurfacing of the track	Site Work	1	
School Feedback	SMHS	Cafeteria- Full Remodel with upgraded plumbing and electrical components	Cafeteria and kitchen needs to be completely modernized and remodeled	Modernization	3	
School Feedback	SMHS	Electrical Upgrades and Underground Wiring	Campus-wide wiring and panels upgrade	Modernization	4	
School Feedback	SMHS	Pressbox replacement	New Building	New Construction	4	

4.1 RECOMMENDED PROJECTS

SAN MARCOS HIGH SCHOOL

4750 Hollister Avenue, Santa Barbara, California 93110

Source	Site	Project	Description/Comments	Type	Site Priority	FCA Priority
School Feedback	SMHS	Girls Restroom renovation, plumbing, flooring, walls, and fixtures	upgrade and it is closed off as of now, due to not ADA and missing toilets as they are obsolete.	Modernization	3	
School Feedback	SMHS	Athletic Improvements- roof	Girls and Boys locker room roofs need replacing. We should probably combine this with the pool project and go without locker rooms for a year.	Modernization	3	
School Feedback	SMHS	Resurface the path	The path to the stadium has deteriorated over time	Site Work	1	
School Feedback	SMHS	Carpet and painting in library	New Carpet and Paint	Modernization	3	
School Feedback	SMHS	Safety request for lower field	Lower field needs fencing, new irrigation, netting to protect neighborhood from softballs. School has a plan and funding for fencing.	Site Work	1	
School Feedback	SMHS	I- Wing Covered Walkway Replacement	Repair the damaged T&G substrata along with the leaking roof material	Modernization	3	
School Feedback	SMHS	Library Space Upgrade	Install glass doors to create a classroom in the adjacent space	Modernization	4	
School Feedback	SMHS	Turf on the upper blacktop	Need to alleviate field usage problems with more area to practice. Lacrosse was added several years ago to an already crowded field of sports.	Modernization	4	

4.1 BUILDING OVERVIEW

SANTA BARBARA HIGH SCHOOL

700 East Anapamu Street, Santa Barbara, California 93103

Information:

Year Built	1924
Gross Square Feet	469,369
Grade Levels	9-12
Enrollment	1924
Total No. Modular Units	3
Total No. Classrooms	90



Santa Barbara High School Annual Enrollment

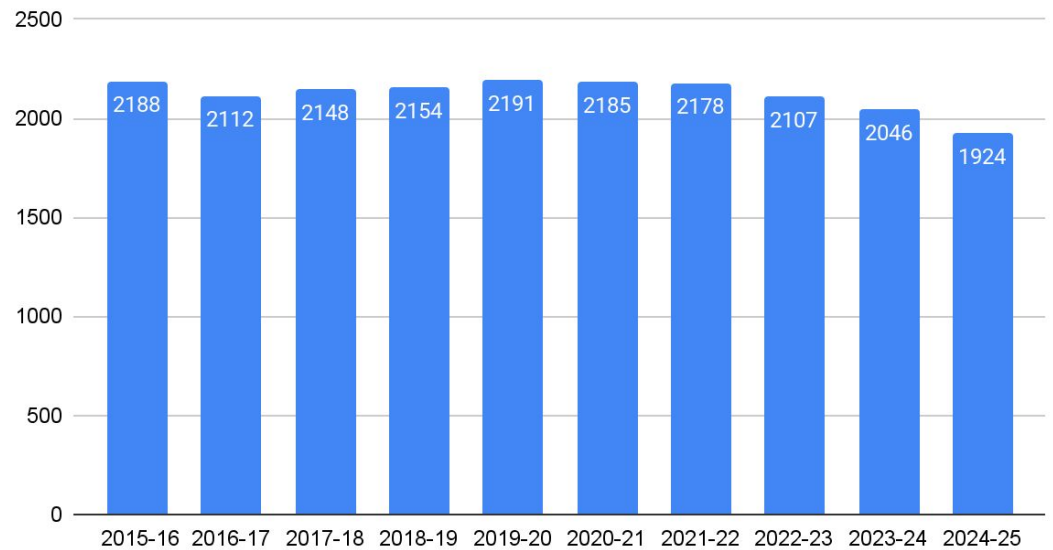

4.1 SITE MAP

SANTA BARBARA HIGH SCHOOL

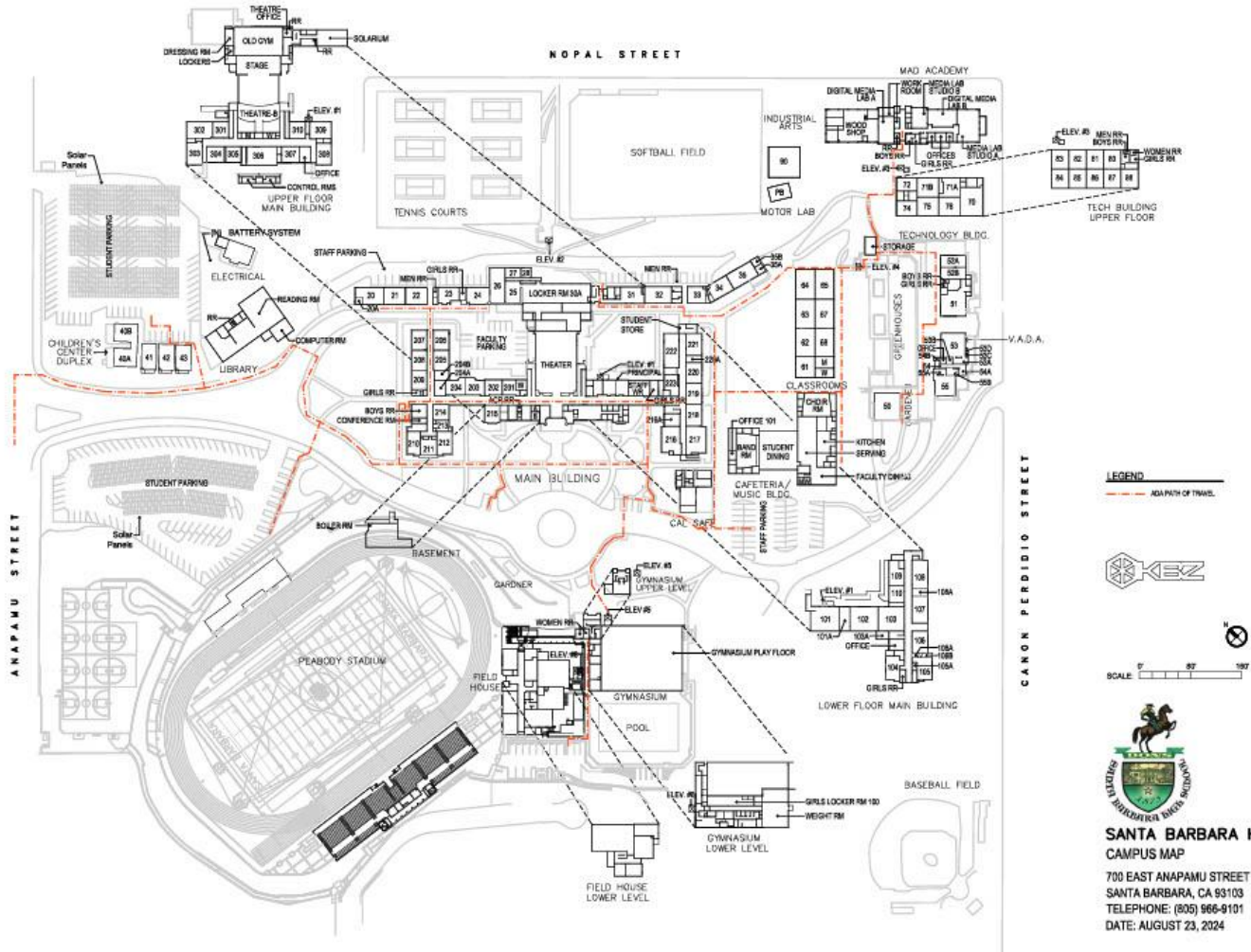

4.1 RECOMMENDED PROJECTS

SANTA BARBARA HIGH SCHOOL

700 East Anapamu Street, Santa Barbara, California 93103

Source	Site	Project	Description/Comments	Type	Site Priority	FCA Priority
Facilities Condition Assessment (FCA)	SBHS	Plumbing Upgrade	30 wing needs repiping.	Modernization		2
Facilities Condition Assessment (FCA)	SBHS	Plumbing Upgrade	Field house needs supply water line replaced; Main issue is sewage line is leaking	Modernization		1
Facilities Condition Assessment (FCA)	SBHS	Floor Replacement Main Buildings	New flooring on all levels	Modernization		2
Facilities Condition Assessment (FCA)	SBHS	Galvanized Pipe Replacement	Main hallway boiler room to North entrance	Modernization		2
Facilities Condition Assessment (FCA)	SBHS	Electrical Upgrades	Replace all subpanels throughout campus	Modernization		3
Facilities Condition Assessment (FCA)	SBHS	Roofing Replacement	Main building, Field house, Gym building, dance studio, and walkways are in need of roof replacement	Modernization		3
Facilities Condition Assessment (FCA)	SBHS	Science Lab Upgrades	New science lab within existing footprint	Modernization		3
Facilities Condition Assessment (FCA)	SBHS	Theater Renovation	Carpet, seating, electrical, paint, woodwork, panels, sound system, stage, backstage	Modernization		3
Facilities Condition Assessment (FCA)	SBHS	Gym HVAC	Install AC	Modernization		4
Facilities Condition Assessment (FCA)	SBHS	Sand Volleyball Courts	Requested by SBHS donors	Modernization		4

4.1 RECOMMENDED PROJECTS

SANTA BARBARA HIGH SCHOOL

700 East Anapamu Street, Santa Barbara, California 93103

Source	Site	Project	Description/Comments	Type	Site Priority	FCA Priority
School Feedback	SBHS	Library Renovation	Library Foundation is raising money for the project, MOU is needed.	Modernization	3	
School Feedback	SBHS	Staff Restrooms	Additional staff restrooms are needed	New Construction	4	
School Feedback	SBHS	Air Conditioning	Can't function for months out of the year, priority should be third floor and sun facing windows on on the main building.	Modernization	3	
School Feedback	SBHS	Demolition of Groundskeeping building near VADA and new construction of faculty and staff lounge building	Rebuild as a multi story building with a community space for teachers to be able to meet during lunch. Ties into the culinary art space next door, there are not enough spots for students requesting culinary instruction	New Construction	4	
School Feedback	SBHS	Install new Bike Racks	Throughout Campus	Site Work	4	
School Feedback	SBHS	Safety enhancement	Install cameras in outdoor areas	Site Work	1	
School Feedback	SBHS	Campus Lighting	Add outdoor lights	Site Work	4	
School Feedback	SBHS	Photography Darkroom	Repurpose existing space	Modernization	4	
School Feedback	SBHS	Building for AVID program	From cost based list	New Construction	4	

4.1 RECOMMENDED PROJECTS

SANTA BARBARA HIGH SCHOOL

700 East Anapamu Street, Santa Barbara, California 93103

Source	Site	Project	Description/Comments	Type	Site Priority	FCA Priority
School Feedback	SBHS	Build New Study Center	Addition to Library	New Construction	4	
School Feedback	SBHS	Remodel of 50's wing	From SBHS Facilities Committee	Modernization	4	
School Feedback	SBHS	Replacement of Final 3 Portables	From SBHS Facilities Committee	Modernization		
School Feedback	SBHS	Replacement of Childcare Center Portable	Need new permanent building	New Construction		
School Feedback	SBHS	Completion of Under Stadium Rooms	Reduced scope from Stadium Projects	Modernization	4	
School Feedback	SBHS	Relocate science lab or dance studio, noise pollution in the science lab from dance studio	Keep science lab in the 100s or 200s where the science classrooms are, move the dance studio	Modernization	4	
School Feedback	SBHS	Parking Lots	Resurface and restripe all parking lots and campus roads	Site Work	1	
School Feedback	SBHS	Science Lab Station Replacements	Replace science lab stations in existing physics and chemistry lab	Modernization	3	
School Feedback	SBHS	Theater	Full Renovation	Modernization	3	
School Feedback	SBHS	Pathways	Expanded walking and biking infrastructure	Site Work	4	

4.1 RECOMMENDED PROJECTS

SANTA BARBARA HIGH SCHOOL

700 East Anapamu Street, Santa Barbara, California 93103

Source	Site	Project	Description/Comments	Type	Site Priority	FCA Priority
School Feedback	SBHS	Bathroom Upgrades	All Bathrooms	Modernization	4	
School Feedback	SBHS	Main Building Floor Replacement	From SBHS Facilities Committee	Modernization	3	
School Feedback	SBHS	Remodel Automotive Space	From SBHS Facilities Committee	Modernization	4	
School Feedback	SBHS	Remodel Culinary Kitchen	From SBHS Facilities Committee	Modernization	3	
School Feedback	SBHS	Additional Restroom	By Baseball Field	New Construction	3	
School Feedback	SBHS	Window Replacements	Phase 2 of replacements	Modernization	3	
School Feedback	SBHS	Gym HVAC	Install Air Conditioning	Modernization	3	
School Feedback	SBHS	Field House Roof Replacement	Leaky roof	Modernization	2	
School Feedback	SBHS	EV Charging Stations	Add electrical vehicle charging stations	Modernization	3	
School Feedback	SBHS	Improve wifi in Cafeteria	Add Wireless Access Points	Modernization	2	
School Feedback	SBHS	Additional benches / picnic tables	Improve outdoor areas	Site Work	2	
School Feedback	SBHS	Equipment upgrade in culinary program	Replacement of Outdated and Broken Culinary Equipment	Modernization	4	
School Feedback	SBHS	Library outdoor project	Improve outdoor areas, new tables and benches	Site Work	3	
School Feedback	SBHS	Campus beautification project	Add more trees throughout campus	Site Work	4	
School Feedback	SBHS	Theater Cage Area for Building sets	Repurpose existing space for building theater sets	Modernization	2	

4.1 RECOMMENDED PROJECTS

SANTA BARBARA HIGH SCHOOL

700 East Anapamu Street, Santa Barbara, California 93103

Source	Site	Project	Description/Comments	Type	Site Priority	FCA Priority
School Feedback	SBHS	Replacement of Floor in College and Career Center	Flooring upgrade	Modernization	3	
School Feedback	SBHS	Outdoor classroom space	Create outdoor learning spaces	Site Work	2	
School Feedback	SBHS	Sand Volleyball Courts	Install new Sand Court for Volleyball	Site Work	2	
School Feedback	SBHS	Theater	Sound and Lighting are in progress	Modernization	1	
School Feedback	SBHS	Dance Studio Improvements	Move dance studio to a larger space	Modernization	3	
School Feedback	SBHS	New Anapamu Marquee	From SBHS Facilities Committee	Modernization	3	
School Feedback	SBHS	Shade Structure	Install a shade structure over quad concrete pad outside of cafeteria	Site Work	3	
School Feedback	SBHS	Shade	Structure or Permanent Umbrellas Near VADA	Site Work	3	
School Feedback	SBHS	Additional Locker Rooms and Restrooms	Build new locker rooms	New Construction	3	
School Feedback	SBHS	Deformed lanes in the stadium track	Lanes 7 and 8	Site Work	1	

4.1 BUILDING OVERVIEW

DISTRICT OFFICE

720 Santa Barbara Street, Santa Barbara, California 93101

Information:

Year Built	1965
Gross Square Feet	51,420
Grade Levels	7-8
Enrollment	512
Total No. Modular Units	0
Total No. Classrooms	



4.1 SITE MAP

DISTRICT OFFICE



SECOND LEVEL FLOOR PLAN

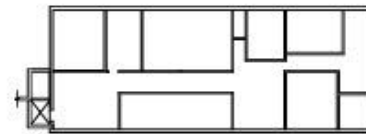

BASEMENT FLOOR PLAN

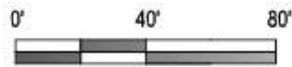

GRAPHIC SCALE



SANTA BARBARA SCHOOL DISTRICT OFFICE MAP

720 SANTA BARBARA STREET, SANTA BARBARA, CA 93101
 TELEPHONE: (805) 963-4338
 UPDATED: JUNE 01, 2024



FACILITIES MASTER PLAN

PART 5: ANNUAL EVALUATION PLAN

5.1 ANNUAL PERIODIC REVIEW

ANNUAL REVIEW

The district will conduct a regular review of the Facilities Master Plan (FMP) to track project progress, monitor enrollment trends, and evaluate emerging facility needs. The review will focus on:

- Completion of planned maintenance projects.
- Updates on capital projects funded by existing bond measures.
- Enrollment trends requiring adjustments in planning and priorities
- Unforeseen infrastructure needs (e.g., major repairs, renovations, or capacity upgrades).
- Emerging funding sources (e.g., new bond measures, grants, external funding).

Whenever the plan is amended, it will be documented, reviewed, and approved by the school board to ensure transparency and alignment with district goals.



5.2 BUDGET

DEVELOPER FEES

\$3,955,685.00

MEASURE J (ELEMENTARY)

\$9,381,339.00



MEASURE I (SECONDARY)

\$23,446,814.00

STATE FUNDING

\$7,063,316.00



5.3 Acknowledgements

The 2025 District Facilities Master Plan was developed and produced by the following staff from Santa Barbara Unified School District.

Administration

Steve Venez - Chief Operations Officer
Marina Verdian - Director, Facilities and Modernization
Jose Jimenez - Maintenance & Operations Manager
Rafael Donato - Custodial Manager

Facilities and Modernization

Brett Coulter - Project Manager
Lucia Gonzalez-Medina - Project Manager
Desmond Ho - Project Manager / Operations and Sustainability
Ernesto Magana Ortiz - Planning Specialist
Avery Wood - Construction Documents Technician

Maintenance and Operations

Vanesa Rodriguez - Administrative Secretary III
Desiree Leaks - Secretary
John Wightman - Electro/Mechanical Foreperson
Matthew Corral - Senior Electrician
Benjamin Rodriguez - Electrician
Hermees Garcia-Mares - Electrician
Jared Jentzsch - Electrician
Owen Teeters - Electrician
Omar Solis - Senior HVAC Mechanic
Mikel Beltran - HVAC Mechanic
Jerry Sandoval - HVAC Mechanic
Andrew Gerbec - Senior Plumber
Efrain Galindo - Plumber
Ernesto Galindo - Plumber
Jaime Garcia - Plumber

5.3 Acknowledgements

The 2025 District Facilities Master Plan was developed and produced by the following staff from Santa Barbara Unified School District.

Maintenance and Operations (continued)

Jorge Hernandez - Fire Alarm Low Voltage Technician
Steve Thompson - Low Voltage Systems Technician
Dave Feldhaus - Swimming Pool Operator
Enrique Perez - Light Construction Foreperson
Francisco Camarillo - Senior Carp
Adam Barrios - Carpenter
Salvador Guerrero - Carpenter
Alejandro Carmona - Carpenter
Jesus Rodriguez - Carpenter
Alan Delgado - Locksmith
Salvador Camarillo - Locksmith
Sergio Solis - Senior Painter
Alexander Garcia - Painter
Mark Unzueta - Painter
Alex Meza - Painter
Enrique Mercado - Painter
Moises Martinez - Painter
Zachary Gertz - Welder

Grounds

Chon Benitez - Grounds Foreperson
Jesus Beltran - Gardener
Chris Olmedo - Gardener
Jose Martinez Romero - Gardener
Ricardo Obispo - Gardener
Luis Garcia - Irrigation Technician
Fernando Martinez - Equipment Operator
Gustavo Martinez - Equipment Operator
Sal Ortega - Mechanic
Margarito Perez - Equipment Operator