



A New Mexico Public Charter School

The ASK Academy

21st Century Design Thinking

**The ASK Academy
Governing Council Meeting
In-Person & Zoom**

4550 Sundt Road NE, Rio Rancho, NM

Open Session

May 16, 2024

6:30pm

Agenda

- | | | | |
|------|---|----------------------|-----------|
| I. | Call to Order | Michael Smith, Chair | 6:30-6:35 |
| II. | Establishment of Quorum | | |
| III. | Pledge of Allegiance | | |
| IV. | Recognition of Mary Lou Lopez | | 6:35-6:45 |
| V. | Public Comment | | 6:45-6:50 |
| | a. SY24-25 Budget Input | | |
| VI. | Consent Agenda | Michael Smith, Chair | 6:50-6:55 |
| | a. Approve Minutes of April 18, 2024 | | |
| | b. Monthly Financial Report | | |
| | c. Operational Maintenance BAR 520-000-2324-0050-M | | |
| | d. Operational Maintenance BAR 520-000-2324-0051-M | | |
| | e. Activities Increase BAR 520-000-2324-0052-I | | |
| | f. Near Peer Maintenance BAR 520-000-2324-0053-M | | |
| | g. State CTE Maintenance BAR 520-000-2324-0054-M | | |
| | h. Junior Bill Maintenance BAR 520-000-2324-0055-M | | |
| | i. Junior Bill Transfer BAR 520-000-2324-0056-T | | |
| | j. Operational Fee Increase BAR 520-000-2324-0057-I | | |
| | k. Account Summary Reports | | |
| VII. | Reports, Discussion and Possible Action | | 6:55-7:20 |
| | a. Chair Update | Michael Smith, Chair | |
| | b. CEO Update | Edward Garcia, CEO | |
| | c. 24-25 Budget Approval | | |
| | d. 24-25 Salary Schedule Approval | | |
| | e. 24-25 School Calendar Approval(s) | | |
| | f. Federal Grant Approvals | | |
| | i. Title I | | |
| | ii. IDEA-B | | |
| | iii. Title II | | |
| | iv. Title IV | | |
| | v. Carl Perkins | | |

VIII.	Closed Session: Pursuant to NMSA § 10-15-1(H)(2) Discussion Subject to Limited Personnel Matters – Director Evaluation and Possible Action Following	7:20-7:30
IX.	Announcements a. Next Governing Council Meeting is June 20, 2024 (Elections)	7:30
XI.	Adjournment	7:30

The public is welcome to attend the open meeting. If you would like to speak during Public Comment, please email Patrick Kelly at pkelly@theaskacademy.org to be added to the list by 5:00 pm, April 17th, 2024. You will be given 3 minutes to speak.

If you are an individual with a disability who is in need of a reader, amplifier, qualified sign language interpreter, or any other form of auxiliary aid or service to attend or participate in the hearing or meeting, please contact Stephany Munoz at 505.891.0757 at least one (1) week prior to the meeting or as soon as possible. Public documents, including the agenda and minutes, can be provided in various accessible formats. Please contact Stephany Munoz at 505.891.0757 if a summary or other type of accessible format is needed.

Patrick Kelly is inviting you to a scheduled Zoom meeting.

Topic: Governing Council Meeting
Time: May 16, 2024 06:30 PM Mountain Time (US and Canada)

Join Zoom Meeting
<https://zoom.us/j/94051270207?pwd=VnU4RGJwT0hHaEhKNEQxUWJ2YitUZz09>

Meeting ID: 940 5127 0207
Passcode: **Z2i0BY**

One tap mobile
+17193594580,,94051270207#,,,,*599589# US
+12532050468,,94051270207#,,,,*599589# US

Dial by your location

- +1 719 359 4580 US
- +1 253 205 0468 US
- +1 253 215 8782 US (Tacoma)
- +1 346 248 7799 US (Houston)
- +1 669 444 9171 US
- +1 669 900 6833 US (San Jose)
- +1 564 217 2000 US
- +1 646 931 3860 US
- +1 689 278 1000 US
- +1 929 436 2866 US (New York)
- +1 301 715 8592 US (Washington DC)
- +1 305 224 1968 US
- +1 309 205 3325 US
- +1 312 626 6799 US (Chicago)
- +1 360 209 5623 US
- +1 386 347 5053 US
- +1 507 473 4847 US

Meeting ID: 940 5127 0207

Passcode: 599589

Find your local number: <https://zoom.us/j/94051270207>



A New Mexico Public Charter School

The ASK Academy

21st Century Design Thinking

**The ASK Academy
Governing Council Meeting
In-Person & Zoom**

4550 Sundt Road NE, Rio Rancho, NM

Open Session

April 18, 2024

6:30pm

Minutes

<i>Attendance:</i>		
Present	Board Members	Title
X	Michael Smith	Chair
	Dr. Jeanne Forrester	Vice Chair
	Gary Feger	Secretary
X	Lindsey Bomke	Director and Finance Committee
X	Tonya Ross	Director and Finance Committee
X	Alex Price	Director
X	Dr. Mistie Williamson	Director
ASK Academy Members		
X	Ed Garcia	Chief Executive Officer
X	Patrick Kelly	Chief Financial Officer
X	Cheryl Kemnitz	Parent Support Committee
X	Nevelyn Headrick	Engineering & Design Pathway Lead Project Manager, TSA Sponsor
X	Emma Sandusky	TSA Scholar
X	Giavanna Almanzar	TSA Scholar
X	Keivan Wright	TSA Scholar
X	Lauren Kerns	TSA Scholar
X	Logan Vigil	TSA Scholar
X	Joshua Sandusky	TSA Scholar

I. Call to Order

Chair Smith calls the meeting to order at 6:30 pm.

Michael Smith, Chair

II. Establishment of Quorum

Roll call and introductions are done. Quorum is established.

III. Pledge of Allegiance

IV. Meet the Scholar/Project Manager

Nevelyn Headrick, Project Manager

Ms. Headrick reports the TSA team (Student Technology Association) qualified for Nationals at the recent state competition. Every member of the team qualified in at least one event. Scholar Emma Sandusky, who is co-president of the ASK TSA, presents a PowerPoint on the evolution of TSA. Scholar Giavanna Almanzar presents the winning TSA video as well. Scholars discuss their projects and experiences.

Chair Smith congratulates the scholars and thanks them for their time.

V. Public Comment - No public comment.

VI. Consent Agenda

Michael Smith, Chair

Chair Smith calls for motion to approve the consent agenda. Director Bomke motions and Director Price seconds. No discussion. Vote is unanimous to approve the consent agenda.

- a. **Approve Minutes of March 21, 2024**
- b. **Monthly Financial Report**
- c. **Junior Bill Maintenance BAR 520-000-2324-0043-M**
- d. **Capital Outlay Maintenance BAR 520-000-2324-0044-M**
- e. **SB-9 Maintenance BAR 520-000-2324-0045-M**
- f. **SB-9 Maintenance BAR 520-000-2324-0046-M**
- g. **Operational Increase BAR 520-000-2324-0047-I**
- h. **Operational Increase BAR 520-000-2324-0048-I**
- i. **Activities Increase BAR 520-000-2324-0049-I**
- j. **Account Summary Reports**

VII. Reports, Discussion and Possible Action

a. Chair Update

Michael Smith, Chair

- Board elections are coming up in June 2024. All leadership positions are open for election. Please let Chair Smith know if you have any nominations.
- Chair Smith has been speaking with two possible board candidates to fill Director Price's chair. He will be having a one on one visit with both of them soon.

b. CEO Update

Edward Garcia, CEO

Celebrations:

- The Middle School Science Fair was hosted on Thursday, 4/11/24. This was a great event, well attended by the public. It was great to see our community come together to judge these unique projects.
- On Tuesday, 4/9/24, our 7th Graders went on a field trip to El Rancho de Los Golondrinas in Santa Fe. Our 8th Graders have their field trip scheduled for Top Golf later this month. Our 6th Graders are heading to an Isotopes game in May.
- I would like to celebrate the County of Bernalillo, who donated construction supplies for our Earth Ship Green House. Ms. Griffin and her 6th Grade Green Architecture classes are building a green house, and we are excited to see the outcomes.
- Congratulations to our Middle School HOSA team that received honorable mention at this weekend's competition. Four scholars received 4 gold medals, 1 scholar received silver, and 1 scholar received bronze.
- The entire High School HOSA team has qualified for Nationals.

Operations Update:

- The ASK Academy is still conducting interviews for our open Math and Science position, as well as our High School Principal position.
- The ASK Academy has added an addition counselor to our staff for next year. I want to thank Rep. Harper for helping us gather the funds to fill this position for the next two years.

- The ASK Academy is currently developing a school calendar for 2024-25 school year. At the time of writing this, we are still waiting to see if any specific actions are being taken by our partners that would allow us to continue the 154-day calendar.

Finance Update:

- We are still developing next year's budget and are looking forward to continue working with our Finance Committee to develop a budget meets the needs of the Academy.
- The SY25 Budget, Calendar(s) and Salary Schedule will be on the agenda for the May Board meeting with our budget documents due to PED on May 24th.
- 6th Grade Building renovations are still in the initial design phase. A proposed final plan is expected to be delivered next week which will incorporate the new classroom having access to interior hallways.
- Discussions regarding the refinance of the existing bond on the main building will begin in late May/early June. The admin team is excited to see what options may be available.

Academic Update:

- State testing has resumed this week.
- 8th grade promotion ceremony is Friday May 10th at 10:00 am.
- Graduation ceremony for the class of 2024 is Friday May 17th at the National Hispanic Cultural Center at 10:00 am.

VIII. Announcements

- a. Next Governing Council Meeting is May 16, 2024 at 6:30 pm.**

- XI. Adjournment** – Chair Smith adjourns the meeting at 7:15 pm.

BUDGET AND FORECAST

Income & Variance Axis

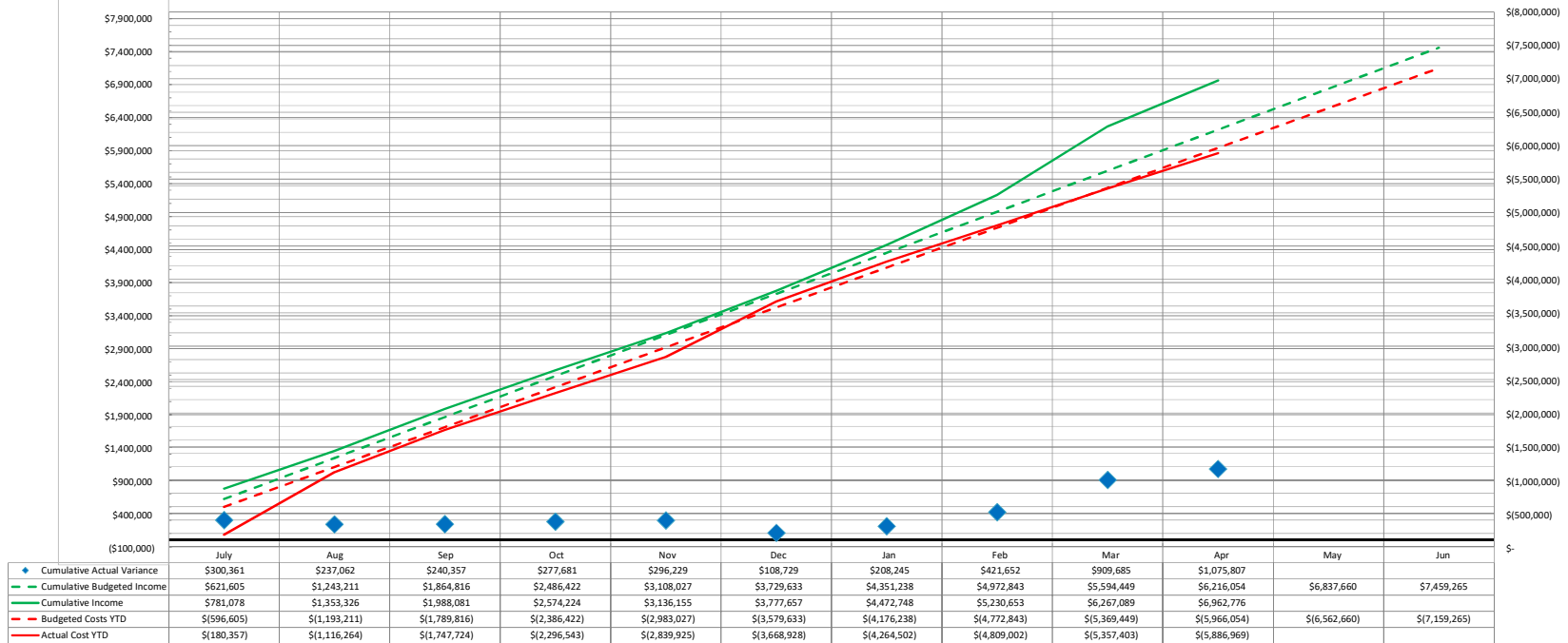

ASK ACADEMY BUDGETING AND FORECASTING WORKSHEET FY2024

BUDGETS	YTD Total	July	Aug	Sep	Oct	Nov	Dec	Jan	Feb	Mar	Apr	May	Jun
Monthly Budgeted Income	\$ 7,459,265	\$ 621,605	\$ 621,605	\$ 621,605	\$ 621,605	\$ 621,605	\$ 621,605	\$ 621,605	\$ 621,605	\$ 621,605	\$ 621,605	\$ 621,605	\$ 621,605
Monthly Budgeted Costs	\$ (7,159,265)	\$ (596,605)	\$ (596,605)	\$ (596,605)	\$ (596,605)	\$ (596,605)	\$ (596,605)	\$ (596,605)	\$ (596,605)	\$ (596,605)	\$ (596,605)	\$ (596,605)	\$ (596,605)
Monthly Budget Variance	\$ 300,000	\$ 25,000	\$ 25,000	\$ 25,000	\$ 25,000	\$ 25,000	\$ 25,000	\$ 25,000	\$ 25,000	\$ 25,000	\$ 25,000	\$ 25,000	\$ 25,000
Cumulative Budgeted Income		\$ 621,605	\$ 1,243,211	\$ 1,864,816	\$ 2,486,422	\$ 3,108,027	\$ 3,729,633	\$ 4,351,238	\$ 4,972,843	\$ 5,594,449	\$ 6,216,054	\$ 6,837,660	\$ 7,459,265
Cumulative Budgeted Costs		\$ (596,605)	\$ (1,193,211)	\$ (1,789,816)	\$ (2,386,422)	\$ (2,983,027)	\$ (3,579,633)	\$ (4,176,238)	\$ (4,772,843)	\$ (5,369,449)	\$ (5,966,054)	\$ (6,562,660)	\$ (7,159,265)
Cumulative Budget Variance		\$ 25,000	\$ 50,000	\$ 75,000	\$ 100,000	\$ 125,000	\$ 150,000	\$ 175,000	\$ 200,000	\$ 225,000	\$ 250,000	\$ 275,000	\$ 300,000
ACTUALS													
Monthly Income	\$ 6,962,776	\$ 781,078	\$ 572,248	\$ 634,755	\$ 586,143	\$ 561,931	\$ 641,502	\$ 695,091	\$ 757,906	\$ 1,036,435	\$ 695,687		
Cumulative Income		\$ 781,078	\$ 1,353,326	\$ 1,988,081	\$ 2,574,224	\$ 3,136,155	\$ 3,777,657	\$ 4,472,748	\$ 5,230,653	\$ 6,267,089	\$ 6,962,776	\$ 6,962,776	\$ 6,962,776
Monthly Costs	\$ (5,886,969)	\$ (480,718)	\$ (635,546)	\$ (631,460)	\$ (548,819)	\$ (543,382)	\$ (829,003)	\$ (595,574)	\$ (544,499)	\$ (548,402)	\$ (529,565)		
Cumulative Cost		\$ (480,718)	\$ (1,116,264)	\$ (1,747,724)	\$ (2,296,543)	\$ (2,839,925)	\$ (3,668,928)	\$ (4,264,502)	\$ (4,809,002)	\$ (5,357,403)	\$ (5,886,969)	\$ (5,886,969)	\$ (5,886,969)
Monthly Variance	\$ 1,075,807	\$ 300,361	\$ (63,298)	\$ 3,295	\$ 37,324	\$ 18,548	\$ (187,501)	\$ 99,517	\$ 213,407	\$ 488,033	\$ 166,122	\$ -	\$ -
Cumulative Actual Variance		\$ 300,361	\$ 237,062	\$ 240,357	\$ 277,681	\$ 296,229	\$ 108,729	\$ 208,245	\$ 421,652	\$ 909,685	\$ 1,075,807	\$ 1,075,807	\$ 1,075,807
MONTHLY VARIANCES													
Monthly Income Variance	\$ (496,489)	\$ 159,472.71	\$ (49,357.66)	\$ 13,149.53	\$ (35,462.16)	\$ (59,674.86)	\$ 19,896.61	\$ 73,485.54	\$ 136,300.42	\$ 414,829.62	\$ 74,081.67	\$ (621,605.42)	\$ (621,605.42)
Cumulative Income Variance		\$ 159,472.71	\$ 110,115.06	\$ 123,264.59	\$ 87,802.43	\$ 28,127.58	\$ 48,024.19	\$ 121,509.73	\$ 257,810.16	\$ 672,639.78	\$ 746,721.45	\$ 125,116.04	\$ (496,489.38)
Monthly Cost Variance	\$ 1,272,296	\$ 115,887.88	\$ (38,940.78)	\$ (34,854.99)	\$ 47,786.43	\$ 53,223.15	\$ (232,397.25)	\$ 1,031.11	\$ 52,106.23	\$ 48,203.59	\$ 67,040.03	\$ 596,605.42	\$ 596,605.42
Cumulative Cost Variance		\$ 115,887.88	\$ 76,947.09	\$ 42,092.10	\$ 89,878.53	\$ 143,101.67	\$ (89,295.58)	\$ (88,264.47)	\$ (36,158.25)	\$ 12,045.34	\$ 79,085.37	\$ 675,690.78	\$ 1,272,296.20
YEAR TO DATE VARIANCES													
Budgeted Income YTD		\$ 621,605	\$ 1,243,211	\$ 1,864,816	\$ 2,486,422	\$ 3,108,027	\$ 3,729,633	\$ 4,351,238	\$ 4,972,843	\$ 5,594,449	\$ 6,216,054	\$ 6,837,660	\$ 7,459,265
Actual Income YTD		\$ 781,078	\$ 1,353,326	\$ 1,988,081	\$ 2,574,224	\$ 3,136,155	\$ 3,777,657	\$ 4,472,748	\$ 5,230,653	\$ 6,267,089	\$ 6,962,776		
% Total YTD Income Received		10%	18%	27%	35%	42%	51%	60%	70%	84%	93%		
% Total YTD Income Variance		26%	9%	7%	4%	1%	1%	3%	5%	12%	12%		
Budgeted Costs YTD		\$ (596,605)	\$ (1,193,211)	\$ (1,789,816)	\$ (2,386,422)	\$ (2,983,027)	\$ (3,579,633)	\$ (4,176,238)	\$ (4,772,843)	\$ (5,369,449)	\$ (5,966,054)	\$ (6,562,660)	\$ (7,159,265)
Actual Cost YTD		\$ (180,357)	\$ (1,116,264)	\$ (1,747,724)	\$ (2,296,543)	\$ (2,839,925)	\$ (3,668,928)	\$ (4,264,502)	\$ (4,809,002)	\$ (5,357,403)	\$ (5,886,969)	\$ (5,886,969)	\$ (5,886,969)
% Total YTD Costs Incurred		3%	16%	24%	32%	40%	51%	60%	67%	75%	82%	82%	82%
% Total YTD Cost Variance		-70%	-6%	-2%	-4%	-5%	2%	2%	1%	0%	-1%	-10%	-18%
YEAR END PROJECTIONS													
Projected Income Variance	\$ 1,913,672.56	\$ 660,690.34	\$ 493,058.36	\$ 263,407.30	\$ 67,506.18	\$ 96,048.38	\$ 208,302.40	\$ 386,715.24	\$ 896,853.04	\$ 896,065.74	\$ 136,490.22	\$ (496,489.38)	
Projected Cost Variance	\$ (2,164,283)	\$ (38,474)	\$ (14,031)	\$ (22,470)	\$ (28,620)	\$ 14,883	\$ 12,609	\$ 4,520	\$ (1,338)	\$ (7,909)	\$ (61,426)	\$ (106,025)	
Year End Projected Net Variance	\$ (250,611)	\$ 622,217	\$ 479,028	\$ 240,938	\$ 38,886	\$ 110,931	\$ 220,912	\$ 391,235	\$ 895,515	\$ 888,157	\$ 75,064	\$ (602,514)	

Must submit backup for all BARs, except transfers of funds for SEG or direct grants

STATE OF NEW MEXICO
PUBLIC EDUCATION DEPARTMENT
300 Don Gaspar Santa Fe, NM 87501-2786
Budget Adjustment Request

Doc. ID: 520-000-2324-0050-M
Fund Type: General Fund / Capital Outlay / Debt Service
Adjustment Type: Maintenance

Fiscal Year: 2023-2024

Entity Name: The Ask Academy

Adjustment Changes Intent/Scope of Program Yes or No?: No

Contact: Patrick Kelly, Business Manager

Total Approved Budget (Flowthrough):

Phone: 505-350-4724

Email: pkelly@theaskacademy.org

FLOWTHROUGH ONLY	Budget Period: 2023-07-01	To: 2024-06-30
A. Approved Carryover:		
B. Total Current Year Allocation:		
D. Total Funding Available:		

Fund	Function	Object	Program	Location	Job Class	Present Budget	Adj Amt Exp	Adj Budget	ADD'L FTE
11000 Operational	1000 Instruction	56113 Software	4020 Alternative and At-Risk Programs	520001 The ASK Academy-Admin Office	0000 No Job Class	\$27,157	(\$15,000)	\$12,157	
11000 Operational	1000 Instruction	51300 Additional Compensation	0000 No Program	520001 The ASK Academy-Admin Office	1611 Substitutes-Sick Leave		\$5,779	\$5,779	
11000 Operational	1000 Instruction	52311 Health and Medical Premiums	1010 Regular Education (PreK-12) Programs	520001 The ASK Academy-Admin Office	1411 Teachers-Grades 1-12	\$221,008	\$2,721	\$223,729	
11000 Operational	1000 Instruction	55915 Other Contract Services	1010 Regular Education (PreK-12) Programs	520001 The ASK Academy-Admin Office	0000 No Job Class	\$8,891	\$2,000	\$10,891	
11000 Operational	1000 Instruction	56118 General Supplies and Materials	1010 Regular Education (PreK-12) Programs	520001 The ASK Academy-Admin Office	0000 No Job Class	\$19,030	\$4,500	\$23,530	
Sub Total							\$0		
Indirect Cost									
DOC. TOTAL							\$0		

Justification:

Maintenance BAR to clean up accounts for year end.

Compliance with Sections 10-15-1 and 22-8-12, NMSA, 1978 Compilation:

A. The requested budget/changes were authorized at a scheduled Board of Education or Governance Council meeting open to the public on:

B. Justification for the transfer: Explanation such as "underbudgeted", "insufficient budget", or "needed to close out Project" ARE NOT ACCEPTABLE. Attach additional sheets if necessary.

ALL TRANSFER BARS MUST NET OUT TO ZERO ON THE DOC. TOTAL LINE.

Must submit backup for all BARs,
except transfers of funds for SEG or
direct grants

STATE OF NEW MEXICO
PUBLIC EDUCATION DEPARTMENT
300 Don Gaspar Santa Fe, NM 87501-2786
Budget Adjustment Request

Doc. ID: 520-000-2324-0051-M
Fund Type: General Fund / Capital
Outlay / Debt Service
Adjustment Type: Maintenance

Fiscal Year: 2023-2024

Entity Name: The Ask Academy

Adjustment Changes Intent/Scope of Program Yes or No?: No

Contact: Patrick Kelly, Business Manager

Total Approved Budget (Flowthrough):

Phone: 505-350-4724

Email: pkelly@theaskacademy.org

FLOWTHROUGH ONLY	Budget Period: 2023-07-01	To: 2024-06-30
A. Approved Carryover:		
B. Total Current Year Allocation:		
D. Total Funding Available:		

Fund	Function	Object	Program	Location	Job Class	Present Budget	Adj Amt Exp	Adj Budget	ADD'L FTE
11000 Operational	2100 Support Services-Students	53212 Speech Therapists - Contracted	2000 Special Programs	520001 The ASK Academy-Admin Office	0000 No Job Class	\$60,000	(\$8,500)	\$51,500	
11000 Operational	2300 Support Services-General Administration	53413 Legal	0000 No Program	520001 The ASK Academy-Admin Office	0000 No Job Class	\$27,461	(\$5,000)	\$22,461	
11000 Operational	2600 Operation & Maintenance of Plant	51100 Salaries Expense	0000 No Program	520001 The ASK Academy-Admin Office	1614 Maintenance		\$8,700	\$8,700	
11000 Operational	2600 Operation & Maintenance of Plant	52111 Educational Retirement	0000 No Program	520001 The ASK Academy-Admin Office	1614 Maintenance		\$1,579	\$1,579	
11000 Operational	2600 Operation & Maintenance of Plant	52112 ERA - Retiree Health	0000 No Program	520001 The ASK Academy-Admin Office	1614 Maintenance		\$174	\$174	
11000 Operational	2600 Operation & Maintenance of Plant	52210 FICA Payments	0000 No Program	520001 The ASK Academy-Admin Office	1614 Maintenance		\$516	\$516	
11000 Operational	2600 Operation & Maintenance of Plant	52220 Medicare Payments	0000 No Program	520001 The ASK Academy-Admin Office	1614 Maintenance		\$121	\$121	
11000 Operational	2600 Operation & Maintenance of Plant	52311 Health and Medical Premiums	0000 No Program	520001 The ASK Academy-Admin Office	1614 Maintenance		\$1,791	\$1,791	
11000 Operational	2600 Operation & Maintenance of Plant	52313 Dental	0000 No Program	520001 The ASK Academy-Admin Office	1614 Maintenance		\$619	\$619	
Sub Total							\$0		
Indirect Cost									
DOC. TOTAL							\$0		

Justification:

Maintenance BAR to clean up accounts for year end.

Compliance with Sections 10-15-1 and 22-8-12, NMSA, 1978 Compilation:

A. The requested budget/changes were authorized at a scheduled Board of Education or Governance Council meeting open to the public on:

B. Justification for the transfer: Explanation such as "underbudgeted", "insufficient budget", or "needed to close out Project" ARE NOT ACCEPTABLE. Attach additional sheets if necessary.

ALL TRANSFER BARS MUST NET OUT TO ZERO ON THE DOC. TOTAL LINE.

Must submit backup for all BARs, except transfers of funds for SEG or direct grants

STATE OF NEW MEXICO
PUBLIC EDUCATION DEPARTMENT
 300 Don Gaspar Santa Fe, NM 87501-2786
Budget Adjustment Request

Doc. ID: 520-000-2324-0052-1
Fund Type: General Fund / Capital Outlay / Debt Service
Adjustment Type: Increase

Fiscal Year: 2023-2024

Entity Name: The Ask Academy

Adjustment Changes Intent/Scope of Program Yes or No?: No

Contact: Patrick Kelly, Business Manager

Total Approved Budget (Flowthrough):

Phone: 505-350-4724

Email: pkelly@theaskacademy.org

FLOWTHROUGH ONLY	Budget Period: 2023-07-01	To: 2024-06-30
A. Approved Carryover:		
B. Total Current Year Allocation:		
D. Total Funding Available:		

Revenue 23000.0000.41701 \$10,091

Fund	Function	Object	Program	Location	Job Class	Present Budget	Adj Amt Exp	Adj Budget	ADD'L FTE
23000 Non-Instructional Support	1000 Instruction	55817 Student Travel	9000 Co-Curricular and Extra-Curricular Activities	520001 The ASK Academy-Admin Office	0000 No Job Class	\$1,210	\$6,091	\$7,301	
23000 Non-Instructional Support	1000 Instruction	56118 General Supplies and Materials	1010 Regular Education (PreK-12) Programs	520001 The ASK Academy-Admin Office	0000 No Job Class	\$88,283	\$4,000	\$92,283	
Sub Total							\$10,091		
Indirect Cost									
DOC. TOTAL							\$10,091		

Justification:

Increase to add funds due to club activity.

Compliance with Sections 10-15-1 and 22-8-12, NMSA, 1978 Compilation:

A. The requested budget/changes were authorized at a scheduled Board of Education or Governance Council meeting open to the public on:

B. Justification for the transfer: Explanation such as "underbudgeted", "insufficient budget", or "needed to close out Project" ARE NOT ACCEPTABLE. Attach additional sheets if necessary.

ALL TRANSFER BARS MUST NET OUT TO ZERO ON THE DOC. TOTAL LINE.

Must submit backup for all BARs, except transfers of funds for SEG or direct grants

STATE OF NEW MEXICO
PUBLIC EDUCATION DEPARTMENT
300 Don Gaspar Santa Fe, NM 87501-2786
Budget Adjustment Request

Doc. ID: 520-000-2324-0053-M
Fund Type: Flowthrough
Adjustment Type: Maintenance

Fiscal Year: 2023-2024

Entity Name: The Ask Academy

Adjustment Changes Intent/Scope of Program Yes or No?: No

Contact: Patrick Kelly, Business Manager

Total Approved Budget (Flowthrough): 40,777

Phone: 505-350-4724

Email: pkelly@theaskacademy.org

FLOWTHROUGH ONLY	
Budget Period: 07/01/2023	To: 06/30/2024
A. Approved Carryover:	
B. Total Current Year Allocation: 40,777	
D. Total Funding Available: 40,777	

Fund	Function	Object	Program	Location	Job Class	Present Budget	Adj Amt Exp	Adj Budget	ADD'L FTE
24333 ESSER 3/Near Peer Tutoring	1000 Instruction	51100 Salaries Expense	1010 Regular Education (PreK-12) Programs	520001 The ASK Academy- Admin Office	1711 Instructional Assistants - Grades 1-12	\$20,000	(\$8,000)	\$12,000	
24333 ESSER 3/Near Peer Tutoring	1000 Instruction	56118 General Supplies and Materials	1010 Regular Education (PreK-12) Programs	520001 The ASK Academy- Admin Office	0000 No Job Class	\$8,678	\$8,000	\$16,678	
Sub Total							\$0		
Indirect Cost									
DOC. TOTAL							\$0		

Justification:

Move funds to clean up for year end.

Compliance with Sections 10-15-1 and 22-8-12, NMSA, 1978 Compilation:

A. The requested budget/changes were authorized at a scheduled Board of Education or Governance Council meeting open to the public on:

B. Justification for the transfer: Explanation such as "underbudgeted", "insufficient budget", or "needed to close out Project" ARE NOT ACCEPTABLE. Attach additional sheets if necessary.

ALL TRANSFER BARS MUST NET OUT TO ZERO ON THE DOC. TOTAL LINE.

Must submit backup for all BARs, except transfers of funds for SEG or direct grants

STATE OF NEW MEXICO
PUBLIC EDUCATION DEPARTMENT
300 Don Gaspar Santa Fe, NM 87501-2786
Budget Adjustment Request

Doc. ID: 520-000-2324-0054-M
Fund Type: Flowthrough
Adjustment Type: Maintenance

Fiscal Year: 2023-2024

Entity Name: The Ask Academy

Adjustment Changes Intent/Scope of Program Yes or No?: No

Contact: Patrick Kelly, Business Manager

Total Approved Budget (Flowthrough): 97,561

Phone: 505-350-4724

Email: pkelly@theaskacademy.org

FLOWTHROUGH ONLY	
Budget Period: 07/01/2023	To: 06/30/2024
A. Approved Carryover:	
B. Total Current Year Allocation: 97,561	
D. Total Funding Available: 97,561	

Fund	Function	Object	Program	Location	Job Class	Present Budget	Adj Amt Exp	Adj Budget	ADD'L FTE
27502 Career Technical Education Program (Pilot)	1000 Instruction	57331 Fixed Assets (more than \$5,000)	1010 Regular Education (PreK-12) Programs	520001 The ASK Academy- Admin Office	0000 No Job Class	\$16,835	(\$16,835)		
27502 Career Technical Education Program (Pilot)	1000 Instruction	55817 Student Travel	1010 Regular Education (PreK-12) Programs	520001 The ASK Academy- Admin Office	0000 No Job Class	\$3,000	\$16,835	\$19,835	
Sub Total							\$0		
Indirect Cost									
DOC. TOTAL							\$0		

Justification:

Move funds for TSA Trip.

Compliance with Sections 10-15-1 and 22-8-12, NMSA, 1978 Compilation:

A. The requested budget/changes were authorized at a scheduled Board of Education or Governance Council meeting open to the public on:

B. Justification for the transfer: Explanation such as "underbudgeted", "insufficient budget", or "needed to close out Project" ARE NOT ACCEPTABLE. Attach additional sheets if necessary.

ALL TRANSFER BARS MUST NET OUT TO ZERO ON THE DOC. TOTAL LINE.

Must submit backup for all BARs,
except transfers of funds for SEG or
direct grants

STATE OF NEW MEXICO
PUBLIC EDUCATION DEPARTMENT
300 Don Gaspar Santa Fe, NM 87501-2786
Budget Adjustment Request

Doc. ID: 520-000-2324-0055-M
Fund Type: Flowthrough
Adjustment Type: Maintenance

Fiscal Year: 2023-2024

Entity Name: The Ask Academy

Adjustment Changes Intent/Scope of Program Yes or No?: No

Contact: Patrick Kelly, Business Manager

Total Approved Budget (Flowthrough): 290,000

Phone: 505-350-4724

Email: pkelly@theaskacademy.org

FLOWTHROUGH ONLY	
Budget Period: 07/01/2023	To: 06/30/2024
A. Approved Carryover:	
B. Total Current Year Allocation: 290,000	
D. Total Funding Available: 290,000	

Fund	Function	Object	Program	Location	Job Class	Present Budget	Adj Amt Exp	Adj Budget	ADD'L FTE
27572 CTE Junior Bill SB192 reg 2023 ASK 290k	1000 Instruction	57331 Fixed Assets (more than \$5,000)	1010 Regular Education (PreK-12) Programs	520001 The ASK Academy- Admin Office	0000 No Job Class	\$16,650	(\$16,650)		
27572 CTE Junior Bill SB192 reg 2023 ASK 290k	1000 Instruction	56119 Supply Assets (\$5,000 or less).	1010 Regular Education (PreK-12) Programs	520001 The ASK Academy- Admin Office	0000 No Job Class	\$13,350	\$16,650	\$30,000	
Sub Total							\$0		
Indirect Cost									
DOC. TOTAL							\$0		

Justification:

Move funds for year end closeout.

Compliance with Sections 10-15-1 and 22-8-12, NMSA, 1978 Compilation:

A. The requested budget/changes were authorized at a scheduled Board of Education or Governance Council meeting open to the public on:

B. Justification for the transfer: Explanation such as "underbudgeted", "insufficient budget", or "needed to close out Project" ARE NOT ACCEPTABLE. Attach additional sheets if necessary.

ALL TRANSFER BARS MUST NET OUT TO ZERO ON THE DOC. TOTAL LINE.

Must submit backup for all BARs, except transfers of funds for SEG or direct grants

STATE OF NEW MEXICO
PUBLIC EDUCATION DEPARTMENT
300 Don Gaspar Santa Fe, NM 87501-2786
Budget Adjustment Request

Doc. ID: 520-000-2324-0056-T

Fund Type: Flowthrough

Adjustment Type: Transfer

Fiscal Year: 2023-2024

Entity Name: The Ask Academy

Adjustment Changes Intent/Scope of Program Yes or No?: No

Contact: Patrick Kelly, Business Manager

Total Approved Budget (Flowthrough): 290,000

Phone: 505-350-4724

Email: pkelly@theaskacademy.org

FLOWTHROUGH ONLY	
Budget Period: 07/01/2023	To: 06/30/2024
A. Approved Carryover:	
B. Total Current Year Allocation: 290,000	
D. Total Funding Available: 290,000	

Fund	Function	Object	Program	Location	Job Class	Present Budget	Adj Amt Exp	Adj Budget	ADD'L FTE
27572 CTE Junior Bill SB192 reg 2023 ASK 290k	2500 Central Services	51300 Additional Compensation	0000 No Program	520001 The ASK Academy- Admin Office	1220 Business Office Support	\$7,535	(\$125)	\$7,410	
27572 CTE Junior Bill SB192 reg 2023 ASK 290k	1000 Instruction	56118 General Supplies and Materials	1010 Regular Education (PreK-12) Programs	520001 The ASK Academy- Admin Office	0000 No Job Class	\$99,000	\$125	\$99,125	
Sub Total							\$0		
Indirect Cost									
DOC. TOTAL							\$0		

Justification:

Year End Adjustments

Compliance with Sections 10-15-1 and 22-8-12, NMSA, 1978 Compilation:

A. The requested budget/changes were authorized at a scheduled Board of Education or Governance Council meeting open to the public on:

B. Justification for the transfer: Explanation such as "underbudgeted", "insufficient budget", or "needed to close out Project" ARE NOT ACCEPTABLE. Attach additional sheets if necessary.

ALL TRANSFER BARS MUST NET OUT TO ZERO ON THE DOC. TOTAL LINE.

Must submit backup for all BARs, except transfers of funds for SEG or direct grants

STATE OF NEW MEXICO
PUBLIC EDUCATION DEPARTMENT
 300 Don Gaspar Santa Fe, NM 87501-2786
Budget Adjustment Request

Doc. ID: 520-000-2324-0057-1
Fund Type: General Fund / Capital Outlay / Debt Service
Adjustment Type: Increase

Fiscal Year: 2023-2024

Entity Name: The Ask Academy

Adjustment Changes Intent/Scope of Program Yes or No?: No

Contact: Patrick Kelly, Business Manager

Total Approved Budget (Flowthrough):

Phone: 505-350-4724

Email: pkelly@theaskacademy.org

FLOWTHROUGH ONLY	Budget Period: 2023-07-01	To: 2024-06-30
A. Approved Carryover:		
B. Total Current Year Allocation:		
D. Total Funding Available:		

Revenue 11000.0000.41702 \$4,756

Fund	Function	Object	Program	Location	Job Class	Present Budget	Adj Amt Exp	Adj Budget	ADD'L FTE
11000 Operational	1000 Instruction	56118 General Supplies and Materials	1010 Regular Education (PreK-12) Programs	520001 The ASK Academy-Admin Office	0000 No Job Class	\$19,030	\$4,756	\$23,786	
Sub Total							\$4,756		
Indirect Cost									
DOC. TOTAL							\$4,756		

Justification:

Increase due to year end fees receipts.

Compliance with Sections 10-15-1 and 22-8-12, NMSA, 1978 Compilation:

A. The requested budget/changes were authorized at a scheduled Board of Education or Governance Council meeting open to the public on:

B. Justification for the transfer: Explanation such as "underbudgeted", "insufficient budget", or "needed to close out Project" ARE NOT ACCEPTABLE. Attach additional sheets if necessary.

ALL TRANSFER BARS MUST NET OUT TO ZERO ON THE DOC. TOTAL LINE.

The ASK Academy

Financial Summary Report - April 2024

<u>Revenue</u>	Budget (YTD)	Actual (YTD)	Available (YTD)
Total	\$ 9,861,513.29	\$ 6,962,775.62	\$ 2,898,737.67

<u>Expenditure</u>	Budget (YTD)	Actual (YTD)	Encumbrance (YTD)	Available (YTD)
Fund 11000- Operational	\$ 7,483,944.20	\$ 4,429,408.97	\$ 1,442,496.62	\$ 1,612,038.61
Fund 23000- Non-Instructional Support	\$ 142,643.00	\$ 75,464.21	\$ 25,635.87	\$ 41,542.92
Fund 24101- Title I	\$ 98,324.00	\$ 71,454.52	\$ 18,370.17	\$ 8,499.31
Fund 24106- IDEA-B	\$ 215,385.17	\$ 125,790.67	\$ 28,612.83	\$ 60,981.67
Fund 24154- Title II	\$ 29,869.74	\$ 20,084.00	\$ 3,406.26	\$ 6,379.48
Fund 24174- Carl Perkins	\$ 6,279.00	\$ -	\$ -	\$ 6,279.00
Fund 24189- Student Achievement Title IV	\$ 10,029.28	\$ 7,968.05	\$ 1,984.99	\$ 76.24
Fund 24190- CSI Grant	\$ 21,250.00	\$ 21,250.00	\$ -	\$ -
Fund 24330- ARP, ESSER III	\$ 29,033.32	\$ 29,033.32	\$ -	\$ -
Fund 24333- Near Peer Tutoring	\$ 40,777.59	\$ 16,173.61	\$ 21,165.56	\$ 3,438.42
Fund 26107- R9 Ed Fellow	\$ 329,700.00	\$ 127,559.81	\$ 37,176.08	\$ 164,964.11
Fund 26207- CNM Foundation	\$ 137.00	\$ -	\$ -	\$ 137.00
Fund 27107- GOB Library	\$ 15,091.00	\$ 8,060.00	\$ 615.00	\$ 6,416.00
Fund 27109- Instructional Materials	\$ 8,398.12	\$ -	\$ -	\$ 8,398.12
Fund 27502- CTE Grant	\$ 97,561.00	\$ 56,856.18	\$ 7,285.05	\$ 33,419.77
Fund 27588 - Stay In School Grant	\$ 180,000.00	\$ 599.00	\$ 350.00	\$ 179,051.00
Fund 28211- COVID-19 Testing Direct	\$ 290,000.00	\$ 114,040.50	\$ 61,689.14	\$ 114,270.36
Fund 31200- Lease Assistance Grant	\$ 497,516.00	\$ 387,259.64	\$ 110,256.36	\$ -
Fund 31400- Special Capital Outlay	\$ 1,401,308.00	\$ 141,601.92	\$ -	\$ 1,259,706.08
Fund 31701- SB-9 Local	\$ 436,435.52	\$ 193,871.22	\$ 62,211.00	\$ 180,353.30
Fund 31703- SB-9 State Match	\$ 60,493.18	\$ 60,493.18	\$ -	\$ 0.00
Total	\$ 11,394,175.12	\$ 5,886,968.80	\$ 1,821,254.93	\$ 3,685,951.39

<u>Check Register Report</u>	Deposit	Withdrawal
ASK- Checking	\$ 696,689.17	\$ 529,779.05

<u>Outstanding PO's</u>	PO Amount	Invoiced Amount	Printed Checks	Remaining
All Open PO's	\$ 1,282,143.50	\$ 762,233.31	\$ 759,036.97	\$ 523,106.53

Reconciled Bank Balance \$ 2,225,528.58

Outstanding RFRs: Amount Date Submitted

\$ -

The ASK Academy
Account Summary Report- Revenues

Cycle: FY2024; Begin Date: 07/01/2023; End Date: 04/30/2024; Account Type: Revenue; Subtotal Elements: Fund,Function; Account Expression:
 ([Fund] >= "11000"); Subtotal By Account Type: No

Description	Budget (YTD)	Actual (YTD)	Available (YTD)
11000-Fees - Educational	\$ 12,905.00	\$ 17,861.48	\$ (4,956.48)
11000-Fees - Field Trip	\$ 1,900.00	\$ 4,140.25	\$ (2,240.25)
11000-Donations	\$ 1,000.00	\$ 1,000.00	\$ -
11000-Refund of Prior Year's Expenditures	\$ 1,000.00	\$ 664.62	\$ 335.38
11000-State Equalization Guarantee	\$ 6,240,708.66	\$ 5,202,626.46	\$ 1,038,082.20
11000-E-Rate	\$ -	\$ 3,585.30	\$ (3,585.30)
23000-Fees - Activities	\$ 1,000.00	\$ 628.83	\$ 371.17
23000-Fees - Activities - PSC	\$ 41,500.00	\$ 46,351.13	\$ (4,851.13)
23000-Fees - Activities - Clubs	\$ 32,500.00	\$ 55,001.15	\$ (22,501.15)
24101-Restricted Grants - Federal Flow-through	\$ 98,324.00	\$ 90,434.52	\$ 7,889.48
24106-Restricted Grants - Federal Flow-through	\$ 215,385.17	\$ 115,233.77	\$ 100,151.40
24154-Restricted Grants - Federal Flow-through	\$ 29,869.74	\$ 20,084.00	\$ 9,785.74
24174-Restricted Grants - Federal Flow-through	\$ 6,279.00	\$ -	\$ 6,279.00
24189-Restricted Grants - Federal Flow-through	\$ 10,029.28	\$ 9,658.50	\$ 370.78
24190-Restricted Grants - Federal Flow-through	\$ 21,250.00	\$ 21,250.00	\$ -
24308-Restricted Grants - Federal Flow-through	\$ -	\$ 6,416.10	\$ (6,416.10)
24330-Restricted Grants - Federal Flow-through	\$ 29,033.32	\$ 61,791.06	\$ (32,757.74)
24333-Restricted Grants - Federal Flow-through	\$ 40,777.59	\$ 40,078.21	\$ 699.38
24346-Restricted Grants - Federal Flow-through	\$ -	\$ 16,107.00	\$ (16,107.00)
24349-Restricted Grants - Federal Flow-through	\$ -	\$ 2,888.00	\$ (2,888.00)
26107-Inter-Governmental- Contract Rev/REC	\$ 329,700.00	\$ 95,214.89	\$ 234,485.11
27107-Library Bond	\$ 15,091.00	\$ 8,060.00	\$ 7,031.00
27109-Instructional Materials	\$ 8,398.12	\$ 8,398.12	\$ -
27400-2022 Junior Bill Award	\$ -	\$ 214,234.75	\$ (214,234.75)
27502-State Direct Grants	\$ 97,561.00	\$ 52,818.86	\$ 44,742.14
27572-2023 Junior Bill Award	\$ 290,000.00	\$ 110,586.03	\$ 179,413.97
27588-Stay In School Grant	\$ 180,000.00	\$ -	\$ 180,000.00
28211-State Direct Grants	\$ -	\$ 9,139.81	\$ (9,139.81)
31200-PSCOC Awards	\$ 497,516.00	\$ 373,137.00	\$ 124,379.00
31400-Legislative Appropriations	\$ 1,401,308.00	\$ 152,293.71	\$ 1,249,014.29
31701-Ad Valorem Taxes - School District	\$ 203,590.00	\$ 135,773.66	\$ 67,816.34
31703-SB-9 State Match	\$ 54,887.41	\$ 87,318.41	\$ (32,431.00)
Total	\$ 9,861,513.29	\$ 6,962,775.62	\$ 2,898,737.67

The ASK Academy
Account Summary Report- Expenditures

Cycle: FY2024; Begin Date: 07/01/2023; End Date: 04/30/2024; Account Type: Expenditure; Subtotal Elements: Fund,Function; Account Expression: ((Fund) >= "11000"); Subtotal By Account Type: No; Include Unposted Transactions: No;

Description	Budget (YTD)	Actual (YTD)	Encumbrance (YTD)	Available (YTD)
Instruction-Salaries Expense-Substitutes	\$ 18,000.00	\$ 14,486.03	\$ 6,689.61	\$ (3,175.64)
Instruction-Salaries Expense-Teachers	\$ 2,023,945.00	\$ 1,431,056.43	\$ 515,395.45	\$ 77,493.12
Instruction-Salaries Expense-Special Ed Teachers	\$ 120,808.00	\$ 85,208.42	\$ 29,691.59	\$ 5,907.99
Instruction-Salaries Expense-Gifted Teachers	\$ 60,696.00	\$ 44,354.74	\$ 16,341.26	\$ -
Instruction-Salaries Expense-At-Risk Teachers	\$ 122,775.00	\$ 89,719.71	\$ 33,054.69	\$ 0.60
Instruction-Additional Compensation	\$ -	\$ 5,275.00	\$ 4,873.86	\$ (10,148.86)
Instruction-Additional Compensation	\$ 24,863.00	\$ 17,291.90	\$ 5,470.61	\$ 2,100.49
Instruction-Additional Compensation	\$ 25,000.00	\$ 12,500.00	\$ 10,000.00	\$ 2,500.00
Instruction-Additional Compensation	\$ 10,000.00	\$ 5,000.00	\$ 5,000.00	\$ -
Instruction-Additional Compensation	\$ 11,363.00	\$ 7,841.90	\$ 3,520.61	\$ 0.49
Instruction-Employee Benefits	\$ 956,453.00	\$ 699,334.27	\$ 231,876.25	\$ 25,242.48
Instruction-Professional Development	\$ 3,000.00	\$ -	\$ -	\$ 3,000.00
Instruction-Other Charges	\$ 4,857.00	\$ 2,297.92	\$ -	\$ 2,559.08
Instruction-Other Charges	\$ 938,974.91	\$ -	\$ -	\$ 938,974.91
Instruction-Student Travel	\$ 6,091.00	\$ 4,618.89	\$ 1,385.36	\$ 86.75
Instruction-Employee Travel - Teachers	\$ 263.00	\$ -	\$ -	\$ 263.00
Instruction-Other Contract Services	\$ 8,891.00	\$ 2,494.06	\$ 9,550.00	\$ (3,153.06)
Instruction-Instructional Materials	\$ 92,161.00	\$ 91,232.93	\$ 1,346.87	\$ (418.80)
Instruction-Other Textbooks	\$ -	\$ 149.75	\$ -	\$ (149.75)
Instruction-Software	\$ 12,212.00	\$ 10,280.00	\$ -	\$ 1,932.00
Instruction-Software (At-Risk)	\$ 27,157.00	\$ -	\$ -	\$ 27,157.00
Instruction-General Supplies and Materials	\$ 18,030.00	\$ 13,844.49	\$ 229.00	\$ 3,956.51
Instruction-General Supplies and Materials	\$ 1,000.00	\$ 1,223.37	\$ -	\$ (223.37)
Instruction-"Supply Assets (\$5,000 or Less)	\$ 4,000.00	\$ -	\$ -	\$ 4,000.00
Function 1000 - Instruction	\$ 4,490,539.91	\$ 2,538,209.81	\$ 874,425.16	\$ 1,077,904.94
Support Services-Students-Salaries Expense- Health Assistant	\$ 27,000.00	\$ 19,730.74	\$ 7,269.26	\$ -
Support Services-Students-Salaries Expense- Special Education Director	\$ 90,720.00	\$ 73,273.83	\$ 17,446.17	\$ -
Support Services-Students-Salaries Expense- Social Worker	\$ 68,040.00	\$ 49,721.48	\$ 18,318.52	\$ -
Support Services-Students-Salaries Expense- Academic Dean	\$ 19,739.00	\$ 15,942.99	\$ 3,796.01	\$ -
Support Services-Students-Salaries Expense- Inst. Coach	\$ 85,298.00	\$ 68,894.49	\$ 16,403.51	\$ -
Support Services-Students-Salaries Expense- Counselor	\$ 75,600.00	\$ 55,246.11	\$ 20,353.89	\$ -
Support Services-Students-Additional Compensation- Special Education Director	\$ -	\$ 1,250.00	\$ 1,250.00	\$ (2,500.00)
Support Services-Students-Employee Benefits	\$ 151,258.00	\$ 118,834.92	\$ 34,744.29	\$ (2,321.21)
Support Services-Students-Speech Therapists - Contracted	\$ 60,000.00	\$ 35,920.50	\$ 13,511.25	\$ 10,568.25
Support Services-Students-Occupational Therapists - Contracted	\$ 25,000.00	\$ 16,804.73	\$ 6,191.04	\$ 2,004.23
Support Services-Students-Specialists - Contracted	\$ 95,768.00	\$ 45,387.45	\$ 41,698.12	\$ 8,682.43
Support Services-Students-Professional Development	\$ 1,879.00	\$ -	\$ 175.00	\$ 1,704.00
Support Services-Students-Other Professional/Technical Services	\$ 30,771.00	\$ 27,655.19	\$ 14,440.10	\$ (11,324.29)
Support Services-Students-Employee Travel - Non-Teachers	\$ 2,325.00	\$ 381.19	\$ 1,943.81	\$ -
Support Services-Students-Other Contract Services	\$ 1,300.00	\$ -	\$ 1,300.00	\$ -
Support Services-Students-Software	\$ 6,000.00	\$ 4,853.67	\$ -	\$ 1,146.33
Support Services-Students-General Supplies and Materials	\$ 4,277.00	\$ 2,745.13	\$ 542.04	\$ 989.83
Support Services-Students-General Supplies and Materials	\$ -	\$ 414.26	\$ -	\$ (414.26)
Support Services-Students-Supply Assets	\$ 6,000.00	\$ 8,892.46	\$ -	\$ (2,892.46)
Function 2100 - Support Services-Students	\$ 750,975.00	\$ 545,949.14	\$ 199,383.01	\$ 5,642.85
Support Services-Professional Development	\$ 5,800.00	\$ 5,146.00	\$ 799.00	\$ (145.00)
Support Services-Instruction-General Supplies and Materials	\$ 20,664.00	\$ 226.67	\$ 19,273.33	\$ 1,164.00
Function 2200 - Support Services-Instruction	\$ 26,464.00	\$ 5,372.67	\$ 20,072.33	\$ 1,019.00
Support Services-General Administration-Salaries Expense- CEO	\$ 127,440.00	\$ 102,932.34	\$ 24,507.66	\$ -
Support Services-General Administration-Employee Benefits	\$ 37,297.00	\$ 30,440.92	\$ 6,855.08	\$ 1.00
Support Services-General Administration-Professional Employee Training and Development Services	\$ 725.00	\$ 725.00	\$ -	\$ -

The ASK Academy
Account Summary Report- Expenditures

Cycle: FY2024; Begin Date: 07/01/2023; End Date: 04/30/2024; Account Type: Expenditure; Subtotal Elements: Fund,Function; Account Expression: ((Fund) >= "11000") ; Subtotal By Account Type: No; Include Unposted Transactions: No;

Description	Budget (YTD)	Actual (YTD)	Encumbrance (YTD)	Available (YTD)
Support Services-General Administration-Auditing	\$ 20,000.00	\$ 17,805.22	\$ 2,194.78	\$ -
Support Services-General Administration-Legal	\$ 27,461.00	\$ 12,327.53	\$ 2,791.74	\$ 12,341.73
Support Services-General Administration-Other Charges	\$ 2,970.00	\$ -	\$ -	\$ 2,970.00
Support Services-General Administration-Advertising	\$ 40,000.00	\$ 44,402.60	\$ 2,647.40	\$ (7,050.00)
Support Services-General Administration-Board Training	\$ 7,609.00	\$ 1,500.00	\$ -	\$ 6,109.00
Support Services-General Administration-Other Contract Services	\$ 20,296.00	\$ 8,927.13	\$ 4,587.50	\$ 6,781.37
Support Services-General Administration-General Supplies and Materials	\$ 4,765.00	\$ 520.30	\$ -	\$ 4,244.70
Function 2300 - Support Services-General Administration	\$ 288,563.00	\$ 219,581.04	\$ 43,584.16	\$ 25,397.80
Support Services-School Administration-Salaries Expense- Principals	\$ 229,460.00	\$ 185,333.19	\$ 44,126.81	\$ -
Support Services-School Administration-Salaries Expense- Secretarial/Clerical/Technical Assistants	\$ 122,322.00	\$ 98,798.70	\$ 23,523.30	\$ -
Support Services-School Administration-Additional Compensation	\$ 5,000.00	\$ 4,038.51	\$ 961.49	\$ -
Support Services-School Administration-Employee Benefits	\$ 143,398.75	\$ 114,276.54	\$ 28,231.46	\$ 890.75
Support Services-School Administration-Professional Development	\$ 2,621.00	\$ 1,750.00	\$ -	\$ 871.00
Support Services-School Administration-Other Charges	\$ 1,957.00	\$ 1,450.00	\$ 300.00	\$ 207.00
Support Services-School Administration-Renting Land and Buildings	\$ 2,370.00	\$ 2,370.00	\$ -	\$ -
Support Services-School Administration-Computers and Equipment	\$ 21,399.54	\$ 16,428.60	\$ 3,269.94	\$ 1,701.00
Support Services-School Administration-Employee Travel - Non-Teachers	\$ 1,668.00	\$ -	\$ -	\$ 1,668.00
Support Services-School Administration-Other Contract Services	\$ 8,767.00	\$ 4,172.16	\$ 3,349.38	\$ 1,245.46
Support Services-School Administration-Software	\$ 20,865.00	\$ 20,114.60	\$ -	\$ 750.40
Support Services-School Administration-General Supplies and Materials	\$ 31,079.00	\$ 19,516.70	\$ 5,030.76	\$ 6,531.54
Support Services-School Administration-Supply Assets	\$ 5,211.00	\$ 4,415.95	\$ -	\$ 795.05
Function 2400 - Support Services-School Administration	\$ 596,118.29	\$ 472,664.95	\$ 108,793.14	\$ 14,660.20
Central Services-Salaries Expense- CFO	\$ 124,200.00	\$ 100,315.32	\$ 23,884.68	\$ -
Central Services-Employee Benefits	\$ 52,491.00	\$ 42,110.96	\$ 10,496.33	\$ (116.29)
Central Services-Professional Development	\$ 2,615.00	\$ 2,615.00	\$ -	\$ -
Central Services-Other Professional/Technical Services	\$ 2,484.00	\$ -	\$ 2,000.00	\$ 484.00
Central Services-Other Charges	\$ 8,274.00	\$ 7,279.01	\$ 1,397.00	\$ (402.01)
Central Services-Advertising	\$ 1,661.00	\$ -	\$ -	\$ 1,661.00
Central Services-Other Contract Services	\$ 98,450.00	\$ 76,486.60	\$ 20,963.40	\$ 1,000.00
Central Services-Software	\$ 20,761.00	\$ 20,588.86	\$ -	\$ 172.14
Central Services-General Supplies and Materials	\$ 10,000.00	\$ 6,235.27	\$ 333.72	\$ 3,431.01
Function 2500 - Central Services	\$ 320,936.00	\$ 255,631.02	\$ 59,075.13	\$ 6,229.85
Operation & Maintenance of Plant-Salaries Expense-Facility Manager	\$ -	\$ -	\$ 8,699.85	\$ (8,699.85)
Operation & Maintenance of Plant-Employee Benefits	\$ -	\$ 5.76	\$ 4,361.24	\$ (4,367.00)
Operation & Maintenance of Plant-Other Charges	\$ 986.00	\$ 25.00	\$ -	\$ 961.00
Operation & Maintenance of Plant-Maintenance & Repair Furniture/Fixtures/Equipment	\$ 672.00	\$ -	\$ -	\$ 672.00
Operation & Maintenance of Plant-Maintenance & Repair - Buildings And Grounds	\$ 9,737.00	\$ 3,779.35	\$ -	\$ 5,957.65
Operation & Maintenance of Plant-Maintenance & Repair Vehicles	\$ -	\$ 2,014.31	\$ 485.69	\$ (2,500.00)
Operation & Maintenance of Plant-Electricity	\$ 75,000.00	\$ 33,056.01	\$ 27,621.89	\$ 14,322.10
Operation & Maintenance of Plant-Natural Gas (Buildings)	\$ 7,783.00	\$ 3,255.03	\$ 2,691.33	\$ 1,836.64
Operation & Maintenance of Plant-Water/Sewage	\$ 19,803.00	\$ 5,482.92	\$ 4,405.63	\$ 9,914.45
Operation & Maintenance of Plant-Communication Services	\$ 28,785.00	\$ 19,392.29	\$ 8,607.71	\$ 785.00
Operation & Maintenance of Plant-Rental - Equipment and Vehicles	\$ 4,890.00	\$ 1,634.97	\$ -	\$ 3,255.03
Operation & Maintenance of Plant-Property/Liability Insurance	\$ 43,316.00	\$ 47,846.75	\$ -	\$ (4,530.75)
Operation & Maintenance of Plant-Other Contract Services	\$ 221,110.00	\$ 140,390.26	\$ 71,955.91	\$ 8,763.83
Operation & Maintenance of Plant-General Supplies and Materials	\$ 27,500.00	\$ 24,873.77	\$ 5,130.79	\$ (2,504.56)
Operation & Maintenance of Plant-Supply Assets	\$ 4,456.00	\$ 1,201.08	\$ 3,203.65	\$ 51.27
Operation & Maintenance of Plant-"Fixed Assets (More Than \$5,000)"	\$ 5,000.00	\$ -	\$ -	\$ 5,000.00
Function 2600 - Operation & Maintenance of Plant	\$ 449,038.00	\$ 282,957.50	\$ 137,163.69	\$ 28,916.81
Capital Outlay-Rentals - Lease to Purchase	\$ 561,310.00	\$ 109,042.84	\$ -	\$ 452,267.16

The ASK Academy
Account Summary Report- Expenditures

Cycle: FY2024; Begin Date: 07/01/2023; End Date: 04/30/2024; Account Type: Expenditure; Subtotal Elements: Fund,Function; Account Expression: ((Fund) >= "11000") ; Subtotal By Account Type: No; Include Unposted Transactions: No;

Description	Budget (YTD)	Actual (YTD)	Encumbrance (YTD)	Available (YTD)
Function 4000 - Capital Outlay	\$ 561,310.00	\$ 109,042.84	\$ -	\$ 452,267.16
Fund 11000 - Operational	\$ 7,483,944.20	\$ 4,429,408.97	\$ 1,442,496.62	\$ 1,612,038.61
<u>Non-Instructional Support</u>				
Instruction-General Supplies and Materials	\$ 13,034.71	\$ 1,123.68	\$ 487.08	\$ 11,423.95
Instruction-General Supplies and Materials- PSC	\$ 53,304.26	\$ 33,823.00	\$ 11,925.48	\$ 7,555.78
Instruction-General Supplies and Materials- Clubs	\$ 76,304.03	\$ 40,517.53	\$ 13,223.31	\$ 22,563.19
Function 1000 - Instruction	\$ 142,643.00	\$ 75,464.21	\$ 25,635.87	\$ 41,542.92
Fund 23000 - Non-Instructional Support	\$ 142,643.00	\$ 75,464.21	\$ 25,635.87	\$ 41,542.92
<u>Title I</u>				
Support Services-Students-Salaries Expense - Academic Dean	\$ 60,143.00	\$ 48,577.20	\$ 11,566.01	\$ (0.21)
Support Services-Students-Employee Benefits	\$ 27,981.00	\$ 21,467.53	\$ 5,884.35	\$ 629.12
Support Services-Other Charges	\$ 10,200.00	\$ 1,409.79	\$ 919.81	\$ 7,870.40
Function 2100 - Support Services-Students	\$ 98,324.00	\$ 71,454.52	\$ 18,370.17	\$ 8,499.31
Fund 24101 - Title I - IASA	\$ 98,324.00	\$ 71,454.52	\$ 18,370.17	\$ 8,499.31
<u>IDEA-B</u>				
Support Services-Students-Salaries Expense - Asst Special Ed Coordinator	\$ 84,823.00	\$ 68,510.82	\$ 16,312.18	\$ -
Support Services-Students-Additional Compensation - Asst Special Ed Coordinator	\$ 14,363.00	\$ 8,812.10	\$ 3,050.41	\$ 2,500.49
Support Services-Students-Employee Benefits	\$ 43,774.00	\$ 32,980.84	\$ 9,250.24	\$ 1,542.92
Support Services-Students-Specialists - Contracted	\$ 72,425.17	\$ 15,486.91	\$ -	\$ 56,938.26
Function 2100 - Support Services-Students	\$ 215,385.17	\$ 125,790.67	\$ 28,612.83	\$ 60,981.67
Fund 24106 - Entitlement IDEA-B	\$ 215,385.17	\$ 125,790.67	\$ 28,612.83	\$ 60,981.67
<u>Title II</u>				
Instruction-Additional Compensation- Teachers-Grades 1-12	\$ 6,000.00	\$ 3,000.00	\$ 3,000.00	\$ -
Instruction-Employee Benefits	\$ 1,668.00	\$ 834.00	\$ 406.26	\$ 427.74
Instruction-Professional Development	\$ 22,201.74	\$ 16,250.00	\$ -	\$ 5,951.74
Function 1000 - Instruction	\$ 29,869.74	\$ 20,084.00	\$ 3,406.26	\$ 6,379.48
Fund 24154 - Title II	\$ 29,869.74	\$ 20,084.00	\$ 3,406.26	\$ 6,379.48
<u>Carl Perkins</u>				
Instruction-Other Charges	\$ 6,279.00	\$ -	\$ -	\$ 6,279.00
Function 1000 - Instruction	\$ 6,279.00	\$ -	\$ -	\$ 6,279.00
Fund 24174 - Carl Perkins	\$ 6,279.00	\$ -	\$ -	\$ 6,279.00
<u>Title IV</u>				
Support Services-Students-Salaries Expense- Academic Dean	\$ 6,842.00	\$ 5,526.15	\$ 1,315.64	\$ 0.21
Support Services-Students- Employee Benefits	\$ 3,187.28	\$ 2,441.90	\$ 669.35	\$ 76.03
Function 2100 - Support Services-Students	\$ 10,029.28	\$ 7,968.05	\$ 1,984.99	\$ 76.24
Fund 24189 - Title IV Student Support and Academic Achievement	\$ 10,029.28	\$ 7,968.05	\$ 1,984.99	\$ 76.24
<u>CSI Grant</u>				
Support Services-Students-Software	\$ 21,250.00	\$ 21,250.00	\$ -	\$ -
Function 2100 - Support Services	\$ 21,250.00	\$ 21,250.00	\$ -	\$ -
Fund 24190 - CSI Grant	\$ 21,250.00	\$ 21,250.00	\$ -	\$ -

The ASK Academy
Account Summary Report- Expenditures

Cycle: FY2024; Begin Date: 07/01/2023; End Date: 04/30/2024; Account Type: Expenditure; Subtotal Elements: Fund,Function; Account Expression: ([Fund] >= "11000") ; Subtotal By Account Type: No; Include Unposted Transactions: No;

Description	Budget (YTD)	Actual (YTD)	Encumbrance (YTD)	Available (YTD)
<u>ARP, ESSER III</u>				
Instruction-Salaries Expense- Substitutes	\$ 26,583.97	\$ 26,583.97	\$ -	\$ -
Instruction-Employee Benefits	\$ 2,449.35	\$ 2,449.35	\$ -	\$ -
Function 1000 - Instruction	\$ 29,033.32	\$ 29,033.32	\$ -	\$ -
Fund 24330 - ARP, ESSER III	\$ 29,033.32	\$ 29,033.32	\$ -	\$ -
<u>Near Peer Tutoring</u>				
Instruction-Salaries Expense- Teachers-Grades 1-12	\$ -	\$ 3,025.00	\$ 1,064.10	\$ (4,089.10)
Instruction-Salaries Expense- Peer Tutors	\$ 20,000.00	\$ 10,387.50	\$ 17,733.52	\$ (8,121.02)
Instruction-Additional Compensation- Teachers-Grades 1-12	\$ 7,500.00	\$ -	\$ -	\$ 7,500.00
Instruction-Employee Benefits	\$ 3,700.00	\$ 1,738.15	\$ 2,367.94	\$ (406.09)
Instruction-Software	\$ 900.00	\$ 900.00	\$ -	\$ -
Instruction-General Supplies and Materials	\$ 8,677.59	\$ 122.96	\$ -	\$ 8,554.63
Function 1000 - Instruction	\$ 40,777.59	\$ 16,173.61	\$ 21,165.56	\$ 3,438.42
Fund 24333 - Near Peer Tutoring	\$ 40,777.59	\$ 16,173.61	\$ 21,165.56	\$ 3,438.42
<u>R9 Ed Fellow</u>				
Instruction-Salaries Expense- Student Teachers	\$ 228,738.00	\$ 86,601.90	\$ 26,976.85	\$ 115,159.25
Instruction-Additional Compensation- Mentors	\$ 7,000.00	\$ 2,000.00	\$ -	\$ 5,000.00
Instruction-Additional Compensation- Student Teachers	\$ 14,000.00	\$ 4,000.00	\$ -	\$ 10,000.00
Instruction-Employee Benefits	\$ 78,142.00	\$ 34,957.91	\$ 10,199.23	\$ 32,984.86
Instruction-Other Charges	\$ 1,820.00	\$ -	\$ -	\$ 1,820.00
Function 1000 - Instruction	\$ 329,700.00	\$ 127,559.81	\$ 37,176.08	\$ 164,964.11
Fund 26107- R9 Ed Fellow	\$ 329,700.00	\$ 127,559.81	\$ 37,176.08	\$ 164,964.11
<u>CNM Foundation</u>				
Instruction-General Supplies and Materials	\$ 137.00	\$ -	\$ -	\$ 137.00
Function 1000 - Instruction	\$ 137.00	\$ -	\$ -	\$ 137.00
Fund 26207- CNM Foundation	\$ 137.00	\$ -	\$ -	\$ 137.00
<u>GO Bond Student Library Fund</u>				
Support Services-Instruction-Library And Audio-Visual	\$ 15,091.00	\$ 8,060.00	\$ 615.00	\$ 6,416.00
Function 1000 - Instruction	\$ 15,091.00	\$ 8,060.00	\$ 615.00	\$ 6,416.00
Fund 27107- GO Bond Student Library Fund	\$ 15,091.00	\$ 8,060.00	\$ 615.00	\$ 6,416.00
<u>Instructional Materials</u>				
Instruction-Instructional Materials Online Digital	\$ 8,398.12	\$ -	\$ -	\$ 8,398.12
Function 1000 - Instruction	\$ 8,398.12	\$ -	\$ -	\$ 8,398.12
Fund 27109- Instructional Materials	\$ 8,398.12	\$ -	\$ -	\$ 8,398.12
<u>CTE Grant</u>				
Instruction-Salary Expense - Teachers	\$ 17,109.00	\$ 12,371.38	\$ 4,732.89	\$ 4.73
Instruction-Employee Benefits	\$ 5,133.00	\$ 4,374.61	\$ 1,697.18	\$ (938.79)
Instruction-Other Professional/Technical Services	\$ 3,000.00	\$ 1,690.00	\$ 775.00	\$ 535.00
Instruction-Other Charges	\$ 900.00	\$ 1,160.00	\$ -	\$ (260.00)
Instruction-Student Travel	\$ 3,000.00	\$ 478.58	\$ -	\$ 2,521.42
Instruction-General Supplies and Materials	\$ 51,584.00	\$ 36,781.61	\$ 79.98	\$ 14,722.41

The ASK Academy
Account Summary Report- Expenditures

Cycle: FY2024; Begin Date: 07/01/2023; End Date: 04/30/2024; Account Type: Expenditure; Subtotal Elements: Fund,Function; Account Expression: ((Fund) >= "11000") ; Subtotal By Account Type: No; Include Unposted Transactions: No;

Description	Budget (YTD)	Actual (YTD)	Encumbrance (YTD)	Available (YTD)
Instruction-"Fixed Assets (More Than \$5,000)"	\$ 16,835.00	\$ -	\$ -	\$ 16,835.00
Subtotal of Element: [Function] 1000 - Instruction	\$ 97,561.00	\$ 56,856.18	\$ 7,285.05	\$ 33,419.77
Fund 27502 - CTE Grant	\$ 97,561.00	\$ 56,856.18	\$ 7,285.05	\$ 33,419.77
Junior Bill - NMAIA				
Instruction-Other Professional/Technical Services	\$ 101,000.00	\$ 39,883.53	\$ 25,270.53	\$ 35,845.94
Instruction-Student Travel	\$ 40,000.00	\$ 1,720.42	\$ 28,074.18	\$ 10,205.40
Instruction-Other Travel -Non-Employees	\$ 10,000.00	\$ 2,160.81	\$ 4,419.43	\$ 3,419.76
Instruction-Other Contract Services	\$ 10,000.00	\$ 4,813.73	\$ -	\$ 5,186.27
Instruction-General Supplies and Materials	\$ 99,000.00	\$ 52,112.24	\$ 3,925.00	\$ 42,962.76
Instruction-Supply Assets	\$ 13,349.77	\$ 13,349.77	\$ -	\$ -
Instruction-Fixed Assets	\$ 16,650.23	\$ -	\$ -	\$ 16,650.23
Subtotal of Element: [Function] 1000 - Instruction	\$ 290,000.00	\$ 114,040.50	\$ 61,689.14	\$ 114,270.36
Fund 27572 - Junior Bill - NMAIA	\$ 290,000.00	\$ 114,040.50	\$ 61,689.14	\$ 114,270.36
Stay In School Grant				
Instruction-Professional Development	\$ 90,000.00	\$ 599.00	\$ -	\$ 89,401.00
Instruction-General Supplies and Materials	\$ 90,000.00	\$ -	\$ 350.00	\$ 89,650.00
Function 1000 - Instruction	\$ 180,000.00	\$ 599.00	\$ 350.00	\$ 179,051.00
Fund 27588 - Stay In School Grant	\$ 180,000.00	\$ 599.00	\$ 350.00	\$ 179,051.00
PSCOC				
Capital Outlay-Lease to Purchase	\$ 497,516.00	\$ 387,259.64	\$ 110,256.36	\$ -
Function 4000 - Capital Outlay	\$ 497,516.00	\$ 387,259.64	\$ 110,256.36	\$ -
Fund 31200 - Special Capital Outlay-State	\$ 497,516.00	\$ 387,259.64	\$ 110,256.36	\$ -
Special Capital Outlay				
Capital Outlay-Construction Services	\$ 851,308.00	\$ -	\$ -	\$ 851,308.00
Capital Outlay-Software	\$ -	\$ 7,596.00	\$ -	\$ (7,596.00)
Capital Outlay-Supply Assets	\$ 350,000.00	\$ 22,427.69	\$ -	\$ 327,572.31
Capital Outlay-"Fixed Assets (More Than \$5,000)"	\$ 200,000.00	\$ 111,578.23	\$ -	\$ 88,421.77
Function 4000 - Capital Outlay	\$ 1,401,308.00	\$ 141,601.92	\$ -	\$ 1,259,706.08
Fund 31400 - Special Capital Outlay-State	\$ 1,401,308.00	\$ 141,601.92	\$ -	\$ 1,259,706.08
Capital Improvements SB-9 Local				
Support Services-General Administration-County Tax Collection Costs	\$ 2,036.00	\$ 1,344.30	\$ -	\$ 691.70
Function 2300 - Support Services-General Administration	\$ 2,036.00	\$ 1,344.30	\$ -	\$ 691.70
Capital Outlay-Construction Services	\$ 211.52	\$ 5,187.49	\$ 59,400.00	\$ (64,375.97)
Capital Outlay-Rentals - Lease to Purchase	\$ 375,000.00	\$ 54,979.32	\$ -	\$ 320,020.68
Capital Outlay-Software	\$ -	\$ 5,605.58	\$ -	\$ (5,605.58)
Capital Outlay-General Supplies and Materials	\$ 3,500.00	\$ 11,496.86	\$ -	\$ (7,996.86)
Capital Outlay-Supply Assets	\$ 40,688.00	\$ 71,198.42	\$ 2,811.00	\$ (33,321.42)
Capital Outlay-"Fixed Assets (More Than \$5,000)"	\$ 15,000.00	\$ 44,059.25	\$ -	\$ (29,059.25)
Function 4000 - Capital Outlay	\$ 434,399.52	\$ 192,526.92	\$ 62,211.00	\$ 179,661.60
Fund 31701 - Capital Improvements SB-9 LOCAL	\$ 436,435.52	\$ 193,871.22	\$ 62,211.00	\$ 180,353.30

The ASK Academy
Account Summary Report- Expenditures

Cycle: FY2024; Begin Date: 07/01/2023; End Date: 04/30/2024; Account Type: Expenditure; Subtotal Elements: Fund,Function; Account Expression: ([Fund] >= "11000") ; Subtotal By Account Type: No; Include Unposted Transactions: No;

Description	Budget (YTD)	Actual (YTD)	Encumbrance (YTD)	Available (YTD)
<u>SB-9 State Match</u>				
Capital Outlay-Construction Services	\$ 3,758.00	\$ 3,757.99	\$ -	\$ 0.01
Capital Outlay-Software	\$ -	\$ 11,534.59	\$ -	\$ (11,534.59)
Capital Outlay-Supply Assets	\$ 51,284.18	\$ 39,750.00	\$ -	\$ 11,534.18
Capital Outlay-"Fixed Assets (More Than \$5,000)"	\$ 5,451.00	\$ 5,450.60	\$ -	\$ 0.40
Function 4000 - Capital Outlay	\$ 60,493.18	\$ 60,493.18	\$ -	\$ 0.00
Fund 31703 - SB-9 State Match	\$ 60,493.18	\$ 60,493.18	\$ -	\$ 0.00
	\$ 11,394,175.12	\$ 5,886,968.80	\$ 1,821,254.93	\$ 3,685,951.39

**The ASK Academy
Check Register Report**

Bank: [All]; Bank Account: [All]; Begin Date: 04/01/2024; End Date: 04/30/2024; Status: Non-Void;

Bank	Account Number
Wells Fargo Bank	

Date	Number	Type	Payee/From	Deposit	Withdrawal
4/1/2024		AP Warrant	De Lage Laden Financial Services, Inc.		\$ 1,645.31
4/1/2024	04-01	Cash Receipt	PayPal - HOSA, AP Exam, Senior cap & gown	\$ 633.48	
4/1/2024	12437	AP Warrant	ACES		\$ 6,734.38
4/1/2024	12438	AP Warrant	AJF ENTERPRISES INC		\$ 564.05
4/1/2024	12439	AP Warrant	Amazon Card Services		\$ 325.44
4/1/2024	12440	AP Warrant	Cooperative Educational Services		\$ 4,054.84
4/1/2024	12441	AP Warrant	Charter School Nursing Services		\$ 1,933.88
4/1/2024	12442	AP Warrant	Document Solution Inc		\$ 2,443.94
4/1/2024	12443	AP Warrant	IXL Learning		\$ 1,080.00
4/1/2024	12444	AP Warrant	LSG & Associates, Inc.		\$ 7,007.00
4/1/2024	12445	AP Warrant	NASSP		\$ 301.49
4/1/2024	12446	AP Warrant	NM Association of School Business Officials		\$ 450.00
4/1/2024	12447	AP Warrant	Otis Elevator Company		\$ 179.22
4/1/2024	12448	AP Warrant	The ASK Academy Foundation		\$ 9,928.18
4/1/2024	12449	AP Warrant	Waste Management of New Mexico		\$ 706.67
4/1/2024	12450	AP Warrant	Zia Graphics		\$ 125.00
4/2/2024	04-03	Cash Receipt	Cap and Gown	\$ 55.00	
4/2/2024	04-04	Cash Receipt	Junior Bill - 2/29/24	\$ 10,158.33	
4/2/2024	04-05	Cash Receipt	Lease Assistance - 3rd Qtr (Main Bldg)	\$ 101,134.50	
4/3/2024		Payroll Liability Check	Wells Fargo		\$ 87,993.64
4/3/2024	04-02	Cash Receipt	6th & 7th grade field trip, TSA, HS Dance, Denim Day club	\$ 695.96	
4/3/2024	04-06	Cash Receipt	Cap and Gown	\$ 55.00	
4/3/2024	04-07	Cash Receipt	Senior cap & gown, 6th & 7th grade field trip, HOSA, TSA	\$ 505.00	
4/4/2024	04-08	Cash Receipt	PayPal - TSA, AP exam fees	\$ 628.62	
4/4/2024	04-09	Cash Receipt	6/7 grade field trip, HOSA , AP exams, TSA, PSC pizza day	\$ 1,841.00	
4/4/2024	12451	AP Warrant	Alisha Noble		\$ 250.00
4/4/2024	12452	AP Warrant	Amazon Card Services		\$ 833.35
4/4/2024	12453	AP Warrant	Cheryl Kemnitz		\$ 460.36
4/4/2024	12454	AP Warrant	Dion's Pizza		\$ 667.00
4/4/2024	12455	AP Warrant	Matthews Fox		\$ 208.26
4/4/2024	12456	AP Warrant	Shawn Dancy		\$ 30.00
4/4/2024	12457	AP Warrant	Sparklight		\$ 619.10
4/4/2024	12458	AP Warrant	Turbo Threads		\$ 34.95
4/4/2024	12459	AP Warrant	Unite Private Networks, LLC		\$ 670.14
4/5/2024		Payroll Liability Check	EFTPS		\$ 27,235.23
4/5/2024	04-10	Cash Receipt	Title IV - 3/31/24	\$ 775.04	
4/5/2024	04-11	Cash Receipt	Junior Bill - 1/31/24	\$ 18,701.40	
4/5/2024	04-12	Cash Receipt	IDEA-B 3/31/24	\$ 10,559.20	
4/5/2024	04-13	Cash Receipt	AP Test, Cap/Gown, Prom Tickets, PSC Pizza 04.04.24 and Talent Show	\$ 830.20	
4/5/2024	04-14	Cash Receipt	6/7 field trip, Theater club	\$ 410.25	
4/5/2024	12436	Paycheck	Weeks, Zachary A		\$ 41.56
4/8/2024	04-15	Cash Receipt	Paypal - AP exams, TSA	\$ 248.35	
4/8/2024	12460	AP Warrant	United Supermarkets, LLC		\$ 86.06
4/8/2024	12461	AP Warrant	Brady Industries Inc.		\$ 928.30
4/8/2024	12462	AP Warrant	C. Dayne Williams		\$ 1,808.02
4/8/2024	12463	AP Warrant	John Betz II		\$ 30.00
4/8/2024	12464	AP Warrant	Jon Joyce		\$ 30.00
4/8/2024	12465	AP Warrant	Kathleen Montoya Potter		\$ 30.00
4/8/2024	12466	AP Warrant	NM Activities Association		\$ 325.00
4/8/2024	12467	AP Warrant	Nuanez, Michelle		\$ 287.75
4/8/2024	12468	AP Warrant	Stephanie Bieniewski		\$ 85.34
4/8/2024	12469	AP Warrant	Griffin & Associates Marketing, Inc		\$ 5,874.49
4/9/2024	04-16	Cash Receipt	Cap and Gown	\$ 165.00	
4/9/2024	04-17	Cash Receipt	6/7 field trip, HS Dance Prom, Senior cap & gown, AP exams, HOSA, Denim day	\$ 1,338.00	

**The ASK Academy
Check Register Report**

Bank: [All]; Bank Account: [All]; Begin Date: 04/01/2024; End Date: 04/30/2024; Status: Non-Void;

Bank	Account Number
Wells Fargo Bank	

Date	Number	Type	Payee/From	Deposit	Withdrawal
4/10/2024		AP Warrant	Wells Fargo Merchant Services, LLC		\$ 137.15
4/10/2024	04-18	Cash Receipt	SEG - April 2024	\$ 519,041.10	
4/10/2024	04-19	Cash Receipt	Prom Tickets	\$ 70.00	
4/10/2024	12470	AP Warrant	United Supermarkets, LLC		\$ 86.73
4/10/2024	12471	AP Warrant	City of Rio Rancho Water and Wastewater		\$ 594.37
4/10/2024	12472	AP Warrant	El Rancho de Las Golondrinas		\$ 264.00
4/10/2024	12473	AP Warrant	Herrera Coaches Inc		\$ 4,230.89
4/10/2024	12474	AP Warrant	NM Gas Co.		\$ 308.67
4/10/2024	12475	AP Warrant	PNM		\$ 2,378.11
4/10/2024	12476	AP Warrant	Vanguard Cleaning Systems of NM		\$ 4,766.53
4/11/2024	04-20	Cash Receipt	Title I - 3/31/24	\$ 6,976.99	
4/11/2024	04-21	Cash Receipt	CTE - 3/31/24	\$ 2,901.02	
4/11/2024	04-22	Cash Receipt	Prom Tickets	\$ 105.00	
4/11/2024	04-23	Cash Receipt	TSA. Senior cap & gown, 6/7 grade field trip, AP	\$ 2,554.01	
4/12/2024	04-24	Cash Receipt	PayPal - AP exams, TSA	\$ 219.24	
4/12/2024	04-25	Cash Receipt	PSC Pizza Sales 04.11.24 and AP Test Fees	\$ 602.10	
4/15/2024		AP Warrant	The ASK Academy Foundation		\$ 45,200.00
4/15/2024	04-26	Cash Receipt	SB9 - SandCo - March 2024	\$ 2,549.65	
4/15/2024	12481	AP Warrant	ACES		\$ 4,359.42
4/15/2024	12482	AP Warrant	AJF ENTERPRISES INC		\$ 1,556.77
4/15/2024	12483	AP Warrant	Amazon Card Services		\$ 1,733.75
4/15/2024	12484	AP Warrant	Cheryl Kemnitz		\$ 259.59
4/15/2024	12485	AP Warrant	Daniel Preciado		\$ 59.00
4/15/2024	12486	AP Warrant	Harmon, Jennifer		\$ 500.00
4/15/2024	12487	AP Warrant	Jennifer M. Pena		\$ 841.59
4/15/2024	12488	AP Warrant	Lorraine Pratt		\$ 30.00
4/15/2024	12489	AP Warrant	Michael Chavez		\$ 3,329.47
4/15/2024	12490	AP Warrant	Miciele Johnson		\$ 30.00
4/15/2024	12491	AP Warrant	Mousavi, Bahador		\$ 788.73
4/15/2024	12492	AP Warrant	NM HOSA		\$ 1,195.00
4/15/2024	12493	AP Warrant	Owens, Melissa		\$ 2,014.31
4/15/2024	12494	AP Warrant	Shayna Dorsey		\$ 30.00
4/15/2024	12495	AP Warrant	Sherwin Williams		\$ 200.00
4/15/2024	12496	AP Warrant	Stephanie Bieniewski		\$ 85.34
4/15/2024	12497	AP Warrant	Teachers Pay Teachers (Teacher Synergy LLC)		\$ 72.98
4/15/2024	12498	AP Warrant	Wolfe, Allison		\$ 500.00
4/16/2024	04-27	Cash Receipt	MS field trips, AP exams, HS dance prom, Denim day club	\$ 723.00	
4/17/2024		Payroll Liability Check	Wells Fargo		\$ 91,251.55
4/17/2024	04-28	Cash Receipt	Prom Tickets	\$ 105.30	
4/17/2024	04-29	Cash Receipt	PayPal - AP exams, Prom Tickets	\$ 162.98	
4/18/2024	04-30	Cash Receipt	Prom Tickets, AP Fees, Cap and Gown and PSC Drinks	\$ 403.30	
4/18/2024	04-31	Cash Receipt	HS dance prom, MS field trips	\$ 825.00	
4/18/2024	12499	AP Warrant	Cheryl Walker		\$ 334.25
4/18/2024	12500	AP Warrant	Complete Music Inc.		\$ 642.60
4/18/2024	12501	AP Warrant	Albuquerque Isotopes Baseball Club		\$ 837.00
4/18/2024	12502	AP Warrant	Dion's Pizza		\$ 713.00
4/18/2024	12503	AP Warrant	Drury Inn & Suites		\$ 2,915.44
4/18/2024	12504	AP Warrant	Horizons of New Mexico		\$ 82.68
4/18/2024	12505	AP Warrant	Nevelyn Headrick		\$ 1,123.41
4/18/2024	12506	AP Warrant	Sandia Office Supply		\$ 2,929.03
4/18/2024	12507	AP Warrant	Village of Corrales		\$ 200.00
4/19/2024		Payroll Liability Check	EFTPS		\$ 27,948.93
4/19/2024	04-32	Cash Receipt	AP Test, Cap and Gown, Prom Tickets	\$ 223.00	
4/19/2024	04-33	Cash Receipt	E-Rate Reimbursement	\$ 3,585.30	
4/19/2024	12477	Paycheck	Herrera, Nathan		\$ 110.82
4/19/2024	12478	Paycheck	Joyce, Julia C		\$ 69.26
4/19/2024	12479	Paycheck	Pape, Anastasia M		\$ 83.11
4/19/2024	12480	Paycheck	Weeks, Zachary A		\$ 55.41

**The ASK Academy
Check Register Report**

Bank: [All]; Bank Account: [All]; Begin Date: 04/01/2024; End Date: 04/30/2024; Status: Non-Void;

Bank	Account Number
Wells Fargo Bank	

Date	Number	Type	Payee/From	Deposit	Withdrawal
4/22/2024	04-34	Cash Receipt	Prom Tickets	\$ 181.50	
4/23/2024	12508	Payroll Liability Check	Aspire Financial Services		\$ 100.00
4/23/2024	12509	Payroll Liability Check	Security Benefit		\$ 650.00
4/23/2024	12510	Payroll Liability Check	Voya ReliaStar		\$ 250.00
4/23/2024	12511	AP Warrant	Cooperative Educational Services		\$ 4,114.25
4/23/2024	12512	AP Warrant	NM HOSA		\$ 500.00
4/23/2024	12513	AP Warrant	Patrick Kelly		\$ 146.26
4/23/2024	12514	AP Warrant	Pioneer ACE Hardware		\$ 825.98
4/24/2024		Payroll Liability Check	NM Department of Taxation and Revenue		\$ 7,197.76
4/24/2024		Payroll Liability Check	NM Educational Retirement Board		\$ 77,951.98
4/24/2024		Payroll Liability Check	NM Retiree Health Care Authority		\$ 8,106.65
4/24/2024	04-35	Cash Receipt	HS dance prom, MS field trip, AP exam	\$ 288.00	
4/24/2024	04-36	Cash Receipt	Paypal - AP exam, senior cap & gown	\$ 525.80	
4/24/2024	04-37	Cash Receipt	Denim day club, HS dance prom, AP exams	\$ 1,547.00	
4/25/2024		AP Warrant	De Lage Laden Financial Services, Inc.		\$ 1,645.31
4/25/2024	04-38	Cash Receipt	Senior cap & gown, AP exam, PSC pizza day	\$ 1,370.00	
4/25/2024	12515	AP Warrant	ADT Commercial		\$ 108.04
4/25/2024	12516	AP Warrant	United Supermarkets, LLC		\$ 301.68
4/25/2024	12517	AP Warrant	Audrey Lujan Gantz		\$ 30.00
4/25/2024	12518	AP Warrant	Bernalillo County PROS Department		\$ 100.00
4/25/2024	12519	AP Warrant	Cheryl Kemnitz		\$ 451.89
4/25/2024	12520	AP Warrant	Dion's Pizza		\$ 736.00
4/25/2024	12521	AP Warrant	JustAwardMedals.com		\$ 325.16
4/25/2024	12522	AP Warrant	Leslie Betz		\$ 30.00
4/25/2024	12523	AP Warrant	Pioneer ACE Hardware		\$ 173.91
4/25/2024	12524	AP Warrant	Sally Melodia		\$ 30.00
4/25/2024	12525	AP Warrant	Sandia Office Supply		\$ 376.12
4/25/2024	12526	AP Warrant	Sherwin Williams		\$ 164.75
4/25/2024	12527	AP Warrant	Tony Flores		\$ 30.00
4/26/2024	04-39	Cash Receipt	PSC Pizza Sales 04.25.24 and Cap/Gown	\$ 401.70	
4/29/2024		Payroll Liability Check	Insight Financial Services, Inc.		\$ 722.57
4/30/2024		Payroll Liability Check	NMPسيا		\$ 53,853.90
4/30/2024	04-40	Cash Receipt	MS field trip, Senior cap & gown, AP exams, Health Rocks, box top donation, NHS sports fest	\$ 2,593.85	
Sub Total				\$696,689.17	\$529,779.05
Grand Total				\$696,689.17	\$529,779.05

The ASK Academy
Outstanding Purchase Orders Report

Accounting Cycle: FY2024; PO Type: [All]; Vendor: [All]; Purchase Order: [All]; Account Expression: [All]; Include Tax and Shipping: No; Include Closed POs: No; Show Detail: No;

PO Number	Type	Vendor Name	Date Issued	PO Amount	Invoiced Amount	Printed Checks	Remaining Encumbrance	Notes
ASK230337-1	Regular	Becky Worthylake	4/28/2023	\$ 59.00	\$ -	\$ -	\$ 59.00	
ASK230436	Regular	ACES	6/26/2023	\$ 2,811.00	\$ -	\$ -	\$ 2,811.00	
ASK240001-1	Regular	PNM	3/27/2024	\$ 30,000.00	\$ 5,347.84	\$ 2,378.11	\$ 27,621.89	
ASK240003	Regular	Action Security Iron Inc.	7/1/2023	\$ 2,500.00	\$ 601.63	\$ 601.63	\$ 1,898.37	
ASK240004	Regular	All Power Electric	7/1/2023	\$ 2,500.00	\$ -	\$ -	\$ 2,500.00	
ASK240005-1	Regular	Brady Industries Inc.	3/27/2024	\$ 4,000.00	\$ 2,408.80	\$ 2,408.80	\$ 1,591.20	
ASK240006-2	Regular	C. Dayne Williams	9/15/2023	\$ 22,995.77	\$ 19,579.82	\$ 19,579.82	\$ 3,415.95	
ASK240007-2	Regular	CNM	1/1/2024	\$ 4,000.00	\$ 3,181.50	\$ 3,181.50	\$ 818.50	
ASK240008-1	Regular	Charter School Nursing Services	2/9/2024	\$ 20,000.00	\$ 7,574.35	\$ 7,574.35	\$ 12,425.65	
ASK240009	Regular	ACES	7/1/2023	\$ 56,500.00	\$ 40,564.30	\$ 40,564.30	\$ 15,935.70	
ASK240010-1	Regular	City of Rio Rancho Water and Wastewater	3/27/2024	\$ 5,000.00	\$ 594.37	\$ 594.37	\$ 4,405.63	
ASK240011	Regular	CliftonLarsonAllen, LLP	7/1/2023	\$ 20,000.00	\$ 17,805.22	\$ 17,805.22	\$ 2,194.78	
ASK240012	Regular	Cognia	7/1/2023	\$ 6,500.00	\$ 1,200.00	\$ 1,200.00	\$ 5,300.00	
ASK240013	Regular	College Board	7/1/2023	\$ 14,000.00	\$ 226.67	\$ 226.67	\$ 13,773.33	
ASK240014	Regular	De Lage Laden Financial Services, Inc.	7/1/2023	\$ 21,619.64	\$ 17,223.90	\$ 17,145.00	\$ 4,474.64	
ASK240015-2	Regular	LSG & Associates, Inc.	9/15/2023	\$ 59,431.75	\$ 41,406.75	\$ 41,406.75	\$ 18,025.00	
ASK240016	Regular	Horizons of New Mexico	7/1/2023	\$ 1,500.00	\$ 675.39	\$ 675.39	\$ 824.61	
ASK240019	Regular	Otis Elevator Company	7/1/2023	\$ 4,400.00	\$ 1,892.20	\$ 1,892.20	\$ 2,507.80	
ASK240024	Regular	Johnson Controls Fire Protection LP	7/2/2023	\$ 7,500.00	\$ -	\$ -	\$ 7,500.00	
ASK240025-1	Regular	Matthews Fox	3/27/2024	\$ 3,000.00	\$ 208.26	\$ 208.26	\$ 2,791.74	
ASK240027-1	Regular	Pioneer ACE Hardware	2/9/2024	\$ 1,000.00	\$ 525.61	\$ 525.61	\$ 474.39	
ASK240028	Regular	ACES	7/2/2023	\$ 81,000.00	\$ 67,316.44	\$ 67,316.44	\$ 13,683.56	
ASK240029	Regular	Poweron Technology Services	7/2/2023	\$ 10,000.00	\$ 9,435.00	\$ 9,435.00	\$ 565.00	
ASK240030	Regular	Preventive Pest Control	7/2/2023	\$ 5,200.00	\$ 446.46	\$ 446.46	\$ 4,753.54	
ASK240032-1	Regular	Michael Chavez	10/12/2023	\$ 4,400.00	\$ -	\$ -	\$ 4,400.00	
ASK240033-1	Regular	Romero Consulting, LLC	10/12/2023	\$ 4,400.00	\$ 4,307.50	\$ 4,307.50	\$ 92.50	
ASK240034-1	Regular	SG Consulting Services, LLC	10/12/2023	\$ 4,400.00	\$ 4,305.00	\$ 4,305.00	\$ 95.00	
ASK240035-1	Regular	The ASK Academy Foundation	1/7/2024	\$ 330,769.08	\$ 230,440.90	\$ 230,440.90	\$ 100,328.18	
ASK240036	Regular	Sparklight	7/2/2023	\$ 8,000.00	\$ 6,810.13	\$ 6,810.13	\$ 1,189.87	
ASK240037	Regular	Unite Private Networks, LLC	7/2/2023	\$ 20,000.00	\$ 13,871.40	\$ 13,871.40	\$ 6,128.60	
ASK240038	Regular	Vanguard Cleaning Systems of NM	7/2/2023	\$ 70,000.00	\$ 52,970.46	\$ 52,970.46	\$ 17,029.54	
ASK240039	Regular	Waste Management of New Mexico	7/2/2023	\$ 10,000.00	\$ 7,536.68	\$ 7,536.68	\$ 2,463.32	
ASK240040	Regular	AJF ENTERPRISES INC	7/2/2023	\$ 30,000.00	\$ 28,053.03	\$ 28,053.03	\$ 1,946.97	
ASK240042	Regular	Wisconsin Center for Education Research	7/2/2023	\$ 500.00	\$ -	\$ -	\$ 500.00	
ASK240043-3	Regular	Cooperative Educational Services	9/15/2023	\$ 75,722.67	\$ 51,203.04	\$ 51,203.04	\$ 24,519.63	
ASK240044-2	Regular	Document Solution Inc	3/22/2024	\$ 6,000.00	\$ 2,443.94	\$ 2,443.94	\$ 3,556.06	
ASK240045	Regular	ADT Commercial	7/2/2023	\$ 3,000.00	\$ 1,057.49	\$ 1,057.49	\$ 1,942.51	
ASK240046	Regular	Sherwin Williams	7/2/2023	\$ 1,000.00	\$ 743.88	\$ 743.88	\$ 256.12	
ASK240048-1	Regular	NM Gas Co.	3/27/2024	\$ 3,000.00	\$ 436.49	\$ 436.49	\$ 2,563.51	
ASK240056-4	Regular	Cheryl Kennnitz	4/25/2024	\$ 3,000.00	\$ 1,113.51	\$ 1,113.51	\$ 1,886.49	
ASK240059-2	Regular	Nicole Jimenez	3/1/2024	\$ 1,000.00	\$ 972.16	\$ 972.16	\$ 27.84	
ASK240060	Regular	Shideh Parisa Wright	7/12/2023	\$ 2,000.00	\$ 1,386.30	\$ 1,420.00	\$ 580.00	
ASK240064-1	Regular	Johnson Controls Fire Protection LP	7/25/2023	\$ 4,400.00	\$ 3,893.32	\$ 3,893.32	\$ 506.68	
ASK240086	Regular	Douglas Bryan	7/25/2023	\$ 25.00	\$ -	\$ -	\$ 25.00	
ASK240095-1	Regular	Patrick Kelly	9/28/2023	\$ 2,000.00	\$ 1,080.19	\$ 1,080.19	\$ 919.81	
ASK240097	Regular	West Mesa Lock & Safe	8/1/2023	\$ 300.00	\$ 94.17	\$ 94.17	\$ 205.83	
ASK240110	Regular	ACES	8/8/2023	\$ 6,000.00	\$ -	\$ -	\$ 6,000.00	
ASK240112-2	Regular	United Supermarkets, LLC	3/6/2024	\$ 300.00	\$ -	\$ -	\$ 300.00	
ASK240125-1	Regular	Dion's Pizza	2/9/2024	\$ 12,000.00	\$ 6,808.00	\$ 6,808.00	\$ 5,192.00	
ASK240126	Regular	Shayna Dorsey	8/15/2023	\$ 59.00	\$ -	\$ -	\$ 59.00	
ASK240127	Regular	Hamilton Dorsey	8/15/2023	\$ 59.00	\$ -	\$ -	\$ 59.00	
ASK240132	Regular	Galarza, Cecilia	8/17/2023	\$ 1,300.00	\$ -	\$ -	\$ 1,300.00	
ASK240145-2	Regular	Davis, Ford	10/6/2023	\$ 2,200.00	\$ -	\$ -	\$ 2,200.00	
ASK240166	Regular	Rachel Matthew Development	9/6/2023	\$ 59,400.00	\$ -	\$ -	\$ 59,400.00	
ASK240175	Regular	Lavendr	9/12/2023	\$ 32,550.00	\$ 31,840.13	\$ 31,840.13	\$ 709.87	
ASK240187	Regular	Scott Allan Mosman	9/21/2023	\$ 59.00	\$ -	\$ -	\$ 59.00	
ASK240201	Regular	Michael Chavez	9/26/2023	\$ 3,600.00	\$ 3,329.47	\$ 3,329.47	\$ 270.53	
ASK240206	Regular	Becky Worthylake	9/27/2023	\$ 125.00	\$ 35.00	\$ 35.00	\$ 90.00	
ASK240209	Regular	Wells Fargo Merchant Services, LLC	9/28/2023	\$ 3,223.75	\$ 2,590.68	\$ 2,590.68	\$ 633.07	
ASK240223	Regular	Jocelyn Benavides	10/12/2023	\$ 1,000.00	\$ 457.96	\$ 457.96	\$ 542.04	
ASK240238	Regular	HOSA, Inc	10/18/2023	\$ 250.00	\$ -	\$ -	\$ 250.00	
ASK240244	Regular	ADT Commercial	10/23/2023	\$ 2,000.00	\$ 80.58	\$ 80.58	\$ 1,919.42	
ASK240260	Regular	Gorospe, George	11/2/2023	\$ 25,000.00	\$ 12,500.00	\$ 12,500.00	\$ 12,500.00	
ASK240261	Regular	Davis, Ford	11/2/2023	\$ 15,000.00	\$ 7,500.00	\$ 7,500.00	\$ 7,500.00	
ASK240262	Regular	Fisher-Ves, Ann	11/2/2023	\$ 10,000.00	\$ 5,000.00	\$ 5,000.00	\$ 5,000.00	
ASK240276	Regular	ACES	11/13/2023	\$ 646.00	\$ -	\$ -	\$ 646.00	
ASK240290	Regular	Rafael Bango	11/20/2023	\$ 30.00	\$ -	\$ -	\$ 30.00	
ASK240295	Regular	Giselle Bango	11/20/2023	\$ 30.00	\$ -	\$ -	\$ 30.00	
ASK240299-1	Regular	United Supermarkets, LLC	3/5/2024	\$ 300.00	\$ 219.35	\$ 219.35	\$ 80.65	

The ASK Academy
Outstanding Purchase Orders Report

Accounting Cycle: FY2024; PO Type: [All]; Vendor: [All]; Purchase Order: [All]; Account Expression: [All]; Include Tax and Shipping: No; Include Closed POs: No; Show Detail: No;

PO Number	Type	Vendor Name	Date Issued	PO Amount	Invoiced Amount	Printed Checks	Remaining Encumbrance	Notes
ASK240310	Regular	United Supermarkets, LLC	11/30/2023	\$ 150.00	\$ 80.89	\$ 81.00	\$ 69.00	
ASK240313-1	Regular	ACES	12/1/2023	\$ 589.26	\$ -	\$ -	\$ 589.26	
ASK240319	Regular	SWAMTA	12/5/2023	\$ 175.00	\$ -	\$ -	\$ 175.00	
ASK240326	Regular	ACES	12/7/2023	\$ 3,428.65	\$ -	\$ -	\$ 3,428.65	
ASK240327	Regular	Davis, Ford	12/7/2023	\$ 1,400.00	\$ -	\$ -	\$ 1,400.00	
ASK240330-1	Regular	Mark's Plumbing & Heating	5/6/2024	\$ 2,500.00	\$ 1,402.70	\$ 1,402.70	\$ 1,097.30	
ASK240351	Regular	Carl Madsen	12/20/2023	\$ 30.00	\$ -	\$ -	\$ 30.00	
ASK240363	Regular	Griffin & Associates Marketing, Inc	1/11/2024	\$ 13,500.00	\$ 12,562.47	\$ 12,562.47	\$ 937.53	
ASK240364-1	Regular	Jennifer M. Pena	1/11/2024	\$ 5,049.54	\$ 2,524.77	\$ 2,524.77	\$ 2,524.77	
ASK240368	Regular	Lavendr	1/12/2024	\$ 1,000.00	\$ -	\$ -	\$ 1,000.00	
ASK240378	Regular	Zia Graphics	1/12/2024	\$ 1,127.50	\$ 1,102.50	\$ 1,102.50	\$ 25.00	
ASK240388	Regular	Mark Maese	1/18/2024	\$ 30.00	\$ -	\$ -	\$ 30.00	
ASK240394	Regular	Michael Smith	1/19/2024	\$ 59.00	\$ -	\$ -	\$ 59.00	
ASK240395	Regular	Jeanne Forrester	1/19/2024	\$ 59.00	\$ -	\$ -	\$ 59.00	
ASK240396	Regular	Gary Feger	1/19/2024	\$ 59.00	\$ -	\$ -	\$ 59.00	
ASK240397	Regular	Tonya Ross	1/19/2024	\$ 59.00	\$ -	\$ -	\$ 59.00	
ASK240398	Regular	Alexander Price	1/19/2024	\$ 59.00	\$ -	\$ -	\$ 59.00	
ASK240399	Regular	Davis, Ford	1/19/2024	\$ 815.06	\$ -	\$ -	\$ 815.06	
ASK240403	Regular	The Vigil Group, LLC	1/22/2024	\$ 2,000.00	\$ -	\$ -	\$ 2,000.00	
ASK240416	Regular	James Gallegos	1/24/2024	\$ 59.00	\$ -	\$ -	\$ 59.00	
ASK240418	Regular	Stephanie Bieniewski	1/24/2024	\$ 1,200.00	\$ 777.40	\$ 692.06	\$ 507.94	
ASK240422	Regular	Dion's Pizza	1/26/2024	\$ 250.00	\$ -	\$ -	\$ 250.00	
ASK240423	Regular	Davis, Ford	1/26/2024	\$ 650.00	\$ -	\$ -	\$ 650.00	
ASK240424-1	Regular	Sallah, Katherine	2/13/2024	\$ 8,410.00	\$ 78.61	\$ 78.61	\$ 8,331.39	
ASK240425	Regular	Early College High School	1/26/2024	\$ 8,410.00	\$ 1,044.72	\$ 1,103.52	\$ 7,306.48	
ASK240426	Regular	Santa Teresa High School	1/26/2024	\$ 8,410.00	\$ -	\$ -	\$ 8,410.00	
ASK240427-1	Regular	Greer, Gretchen	2/12/2024	\$ 8,129.50	\$ 717.02	\$ 1,098.82	\$ 7,030.68	
ASK240435	Regular	Kathleen Larese	1/30/2024	\$ 30.00	\$ -	\$ -	\$ 30.00	
ASK240436	Regular	Newsela, Inc.	1/31/2024	\$ 8,675.00	\$ 8,060.00	\$ 8,060.00	\$ 615.00	
ASK240447	Regular	Douglas Bryan	2/6/2024	\$ 300.00	\$ -	\$ -	\$ 300.00	
ASK240448	Regular	Herff Jones	2/6/2024	\$ 985.50	\$ -	\$ -	\$ 985.50	
ASK240450	Regular	Sasha Rojo	2/6/2024	\$ 30.00	\$ -	\$ -	\$ 30.00	
ASK240451	Regular	Nathan Lerner	2/6/2024	\$ 30.00	\$ -	\$ -	\$ 30.00	
ASK240452	Regular	Garrett Schmilte	2/6/2024	\$ 30.00	\$ -	\$ -	\$ 30.00	
ASK240461-2	Regular	United Supermarkets, LLC	3/6/2024	\$ 250.00	\$ 61.72	\$ 61.72	\$ 188.28	
ASK240465	Regular	Rebecca Lucero	2/13/2024	\$ 30.00	\$ -	\$ -	\$ 30.00	
ASK240467	Regular	Samantha Vollmar	2/13/2024	\$ 200.00	\$ -	\$ -	\$ 200.00	
ASK240470	Regular	Ernesto Coca	2/13/2024	\$ 30.00	\$ -	\$ -	\$ 30.00	
ASK240478	Regular	zLabs, Inc	2/21/2024	\$ 350.00	\$ 218.75	\$ 218.75	\$ 131.25	
ASK240490	Regular	Brown, Roberta	2/28/2024	\$ 2,325.00	\$ 381.19	\$ 381.19	\$ 1,943.81	
ASK240491	Regular	Kiley Spurlock	2/29/2024	\$ 30.00	\$ -	\$ -	\$ 30.00	
ASK240499	Regular	Amazon Card Services	3/4/2024	\$ 91.98	\$ -	\$ -	\$ 91.98	
ASK240502	Regular	Herrera Coaches Inc	3/6/2024	\$ 3,806.82	\$ -	\$ -	\$ 3,806.82	
ASK240504	Regular	Campus Specialties - Herff Jones	3/6/2024	\$ 2,707.50	\$ -	\$ -	\$ 2,707.50	
ASK240505	Regular	United Supermarkets, LLC	3/6/2024	\$ 300.00	\$ 181.92	\$ 181.92	\$ 118.08	
ASK240507-1	Regular	Amazon Card Services	3/13/2024	\$ 161.47	\$ 161.47	\$ 159.86	\$ 1.61	
ASK240508	Regular	Dana Jensen	3/12/2024	\$ 30.00	\$ -	\$ -	\$ 30.00	
ASK240513	Regular	NM Technology Student Association	3/13/2024	\$ 750.00	\$ -	\$ -	\$ 750.00	
ASK240514	Regular	Village of Corrales	3/13/2024	\$ 500.00	\$ 200.00	\$ 200.00	\$ 300.00	
ASK240515	Regular	Michele Kristensen	3/15/2024	\$ 1,000.00	\$ -	\$ -	\$ 1,000.00	
ASK240526	Regular	Guru Niyam Seyl	4/1/2024	\$ 30.00	\$ -	\$ -	\$ 30.00	
ASK240528	Regular	Owens, Melissa	4/1/2024	\$ 2,500.00	\$ 2,014.31	\$ 2,014.31	\$ 485.69	
ASK240529	Regular	United Supermarkets, LLC	4/1/2024	\$ 150.00	\$ 144.27	\$ 144.27	\$ 5.73	
ASK240531-1	Regular	United Supermarkets, LLC	4/23/2024	\$ 100.00	\$ 64.82	\$ 64.82	\$ 35.18	
ASK240533	Regular	Cheryl Walker	4/2/2024	\$ 200.00	\$ -	\$ -	\$ 200.00	
ASK240537	Regular	HOSA, Inc	4/2/2024	\$ 25.00	\$ -	\$ -	\$ 25.00	
ASK240548	Regular	Amazon Card Services	4/5/2024	\$ 260.00	\$ 252.03	\$ 252.03	\$ 7.97	
ASK240550	Regular	Nuanez, Michelle	4/5/2024	\$ 304.80	\$ 287.75	\$ 287.75	\$ 17.05	
ASK240554	Regular	Alisha Medina	4/9/2024	\$ 30.00	\$ -	\$ -	\$ 30.00	
ASK240556	Regular	Mary Ann Nelson	4/9/2024	\$ 30.00	\$ -	\$ -	\$ 30.00	
ASK240560	Regular	United Supermarkets, LLC	4/10/2024	\$ 350.00	\$ 265.79	\$ 265.79	\$ 84.21	
ASK240567	Regular	Brittany Clark	4/15/2024	\$ 30.00	\$ -	\$ -	\$ 30.00	
ASK240568	Regular	Cheryl Walker	4/15/2024	\$ 750.00	\$ 334.25	\$ 334.25	\$ 415.75	
ASK240570	Regular	Pioneer ACE Hardware	4/17/2024	\$ 1,000.00	\$ 796.00	\$ 796.00	\$ 204.00	
ASK240571-1	Regular	That Trophy Shop	4/30/2024	\$ 254.15	\$ -	\$ -	\$ 254.15	
ASK240575	Regular	Hanah Hanes	4/18/2024	\$ 300.00	\$ 281.49	\$ 281.49	\$ 18.51	
ASK240576-1	Regular	Amazon Card Services	4/18/2024	\$ 950.00	\$ 925.12	\$ 925.12	\$ 24.88	
ASK240578	Regular	Michael Margolis	4/18/2024	\$ 59.00	\$ -	\$ -	\$ 59.00	
ASK240581	Regular	Campus Specialties - Herff Jones	4/22/2024	\$ 119.95	\$ -	\$ -	\$ 119.95	

The ASK Academy
Outstanding Purchase Orders Report

Accounting Cycle: FY2024; PO Type: [All]; Vendor: [All]; Purchase Order: [All]; Account Expression: [All]; Include Tax and Shipping: No; Include Closed POs: No; Show Detail: No;

PO Number	Type	Vendor Name	Date Issued	PO Amount	Invoiced Amount	Printed Checks	Remaining Encumbrance	Notes
ASK240582	Regular	Hanah Hanes	4/22/2024	\$ 50.00	\$ -	\$ -	\$ 50.00	
ASK240584	Dollar	College Board	4/24/2024	\$ 799.00	\$ -	\$ -	\$ 799.00	
ASK240587	Regular	Amazon Card Services	4/25/2024	\$ 899.10	\$ -	\$ -	\$ 899.10	
ASK240591-1	Regular	Barrett, Bill	5/7/2024	\$ 79.00	\$ -	\$ -	\$ 79.00	
ASK240593	Regular	Joe's Pasta House	4/29/2024	\$ 600.00	\$ -	\$ -	\$ 600.00	
ASK240595	Regular	Project Lead the Way, Inc.	5/1/2024	\$ 500.00	\$ -	\$ -	\$ 500.00	
ASK240597	Regular	Amazon Card Services	5/1/2024	\$ 215.04	\$ -	\$ -	\$ 215.04	
ASK240598	Regular	Amazon Card Services	5/1/2024	\$ 154.08	\$ -	\$ -	\$ 154.08	
ASK240599	Regular	Project Lead the Way, Inc.	5/1/2024	\$ 6,350.00	\$ 5,400.00	\$ 5,400.00	\$ 950.00	
ASK240600	Regular	Dion's Pizza	5/2/2024	\$ 500.00	\$ -	\$ -	\$ 500.00	
ASK240601	Regular	Davis, Ford	5/2/2024	\$ 200.00	\$ -	\$ -	\$ 200.00	
ASK240602	Regular	LA Services LLC	5/2/2024	\$ 1,874.84	\$ -	\$ -	\$ 1,874.84	
ASK240603	Regular	Smith, Bonnie	5/2/2024	\$ 100.00	\$ 80.91	\$ 80.91	\$ 19.09	
ASK240604	Regular	Amazon Card Services	5/2/2024	\$ 305.87	\$ -	\$ -	\$ 305.87	
ASK240605	Regular	Central New Mexico Community College	5/2/2024	\$ 1,000.00	\$ -	\$ -	\$ 1,000.00	
ASK240606	Regular	William Cervantes Enterprises, Inc.	5/3/2024	\$ 24,000.00	\$ -	\$ -	\$ 24,000.00	
ASK240607	Regular	United Supermarkets, LLC	5/5/2024	\$ 72.00	\$ -	\$ -	\$ 72.00	
ASK240609	Regular	New Mexico Air Filter, Inc.	5/6/2024	\$ 298.82	\$ -	\$ -	\$ 298.82	
ASK240610	Regular	Amazon Card Services	5/7/2024	\$ 608.84	\$ -	\$ -	\$ 608.84	
ASK240611	Regular	Joe's Pasta House	5/7/2024	\$ 500.17	\$ 500.17	\$ -	\$ 500.17	
ASK240612	Regular	Alea Trafton	5/7/2024	\$ 59.00	\$ -	\$ -	\$ 59.00	
ASK240615-1	Regular	Amazon Card Services	5/9/2024	\$ 19.81	\$ -	\$ -	\$ 19.81	
ASK240616	Regular	Zia Signs LLC	5/10/2024	\$ 35.00	\$ 35.00	\$ -	\$ 35.00	
ASK240617	Regular	Amazon Card Services	5/10/2024	\$ 562.59	\$ -	\$ -	\$ 562.59	
ASK240618	Regular	United Supermarkets, LLC	5/10/2024	\$ 100.00	\$ -	\$ -	\$ 100.00	
Sub Total				\$ 1,282,143.50	\$ 762,233.31	\$ 759,036.97	\$ 523,106.53	

BANK RECONCILIATION

School: **The ASK Academy**
Bank: **Wells Fargo**
Account Description: **Main Checking Account**
Statement Date: **April 30, 2024**

Beginning balance per bank:	\$	2,118,736.76
Cleared transactions:	\$	(526,838.69)
Deposits and credits:	\$	696,689.17
Other bank adjustments		
Ending balance per bank	\$	<u>2,288,587.24</u>
Plus: Outstanding Deposits		
Plus: Cleared items prior to entry		
Less: Outstanding checks	\$	(63,058.66)
Expected Balance per GL	\$	<u>2,225,528.58</u>

The ASK Academy
Outstanding Checks Report

Accounting Cycle: FY2024; Bank: Wells Fargo Bank - ; Bank Account: Main Bank Acct; Statement Date: 02/29/2024; Include Unposted Transactions: No;

Last Reconciled	Beginning Balance	Statement Date
3/31/2024	\$ (60,118.30)	04/30/2024

Date	Source Document	Item Number	Description	Withdrawal
6/1/2023	APV23-102	11681	Carol Donlin	\$ 150.00
8/14/2023	AP24-008	11822	Thomas Donlin	\$ 59.00
10/10/2023	AP24-024	11982	Becky Worthylake	\$ 35.00
12/7/2023	AP24-040	12117	Robotics Education & Competition Foundation	\$ 225.00
1/12/2024	PVM24-091	12199	Minnesota Child Support Payment Center	\$ 261.50
2/9/2024	AP24-055	12303	UNM World Affairs Delegation	\$ 740.00
2/12/2024	AP24-056	12307	Christina Evaro-Maese	\$ 30.00
2/20/2024	AP24-060	12338	Jessica Del Curto	\$ 100.00
4/15/2024	AP24-074	12494	Shayna Dorsey	\$ 30.00
4/18/2024	AP24-075	12500	Complete Music Inc.	\$ 642.60
4/18/2024	AP24-075	12501	Albuquerque Isotopes Baseball Club	\$ 837.00
4/18/2024	AP24-075	12504	Horizons of New Mexico	\$ 82.68
4/18/2024	AP24-075	12505	Nevelyn Headrick	\$ 1,123.41
4/19/2024	PR24-21	12478	Joyce, Julia C	\$ 69.26
4/25/2024	AP24-077		De Lage Laden Financial Services, Inc.	\$ 1,645.31
4/25/2024	AP24-077	12515	ADT Commercial	\$ 108.04
4/25/2024	AP24-077	12516	United Supermarkets, LLC	\$ 301.68
4/25/2024	AP24-077	12517	Audrey Lujan Gantz	\$ 30.00
4/25/2024	AP24-077	12518	Bernalillo County PROS Department	\$ 100.00
4/25/2024	AP24-077	12519	Cheryl Kemnitz	\$ 451.89
4/25/2024	AP24-077	12520	Dion's Pizza	\$ 736.00
4/25/2024	AP24-077	12521	JustAwardMedals.com	\$ 325.16
4/25/2024	AP24-077	12522	Leslie Betz	\$ 30.00
4/25/2024	AP24-077	12523	Pioneer ACE Hardware	\$ 173.91
4/25/2024	AP24-077	12524	Sally Melodia	\$ 30.00
4/25/2024	AP24-077	12526	Sherwin Williams	\$ 164.75
4/29/2024	PVM24-142		Insight Financial Services, Inc.	\$ 722.57
4/30/2024	PVM24-143		NMPSIA	\$ 53,853.90

Sub Total		\$ 63,058.66
------------------	--	---------------------

The ASK Academy May 2024 Board Report

Presented by Edward Garcia, CEO

Contact Information: 505-891-0757 EXT 301, egarcia@theaskacademy.org

Celebrations:

- On Friday, 5/10/24, The ASK Academy hosted our 8th Grade Promotion Ceremony. The weather was beautiful and we had a great turn out from our community. I would like to thank Ms. Vollmar for all of hard work in planning the event, our Parent Support Committee for their support, all of our project managers for attending, and Rep. Harper for being our guest speaker.
- During the month of April, our 6th Graders attended their field trip to Isotopes Park. It was a very exciting game with the Topes winning in the bottom of the 9th. Our 8th Graders attended their field trip to Top Golf. From what I understand the Project Managers and chaperones dominated the competition.
- The month of May is a time of celebration especially for our Seniors. I wanted to congratulate them on the completion of high school, and I look forward to seeing them cross the stage at graduation on Friday, 5/17/24.
- I wanted to celebrate the hard work from our high school scholars. With our AP testing window drawing to a close, many have put in many hours preparing for these difficult exams. I would like to thank New Mexico Highlands University for allowing us the use of their facility for testing.

- Our TSA Team is booked and ready for competition in Orlando! We wish them the best of luck in when the competition begins in June.
- The US News and World Report has released their school rankings for high schools across the country. The ASK Academy finished in the top 3% across the nation ranked 570 out 17,655 schools. We finished in the top 1% for the state, ranked 4th out 221 schools. We finished in the top 3% in the National Charter School Ranking, ranked 103 out of 3,022.

Operations Update:

- The ASK Academy is fully staffed for the 2024-25 school year.
- We have floor plans completed for the expansion of the 6th Grade Academy and we will be able to share them during this Governing Council Meeting.

Finance Update:

- We will be presenting our 2024-25 Budget along with calendar(s), salary schedule and Federal Grant Budget Applications. Our CFO will present in detail following this report.
- CFO completed and submitted the grant for the Next Gen CTE funding for next year. Grant is expected to be over \$107,000 to support our PLTW classes as well as our VEX, TSA and HOSA programs.

Academic Update:

- AP Testing is almost complete, and we are excited to see the results in July.
- Final Exams for the entire Academy begin the week of 5/20/24.



SY24-25 Budget

THE ASK ACADEMY
May 2024



OVERVIEW

The following pages will give an overview of The ASK Academy's budget for the 2024-2025 school year. Historical insurance increases, employee raises and a decreased enrollment during the 23-24 school year have greatly affected the proposed budget.

The school's administration is presenting a budget that is tighter than prior years, but maintains the school's quality programs and existing staffing numbers while being sustainable for years to come.

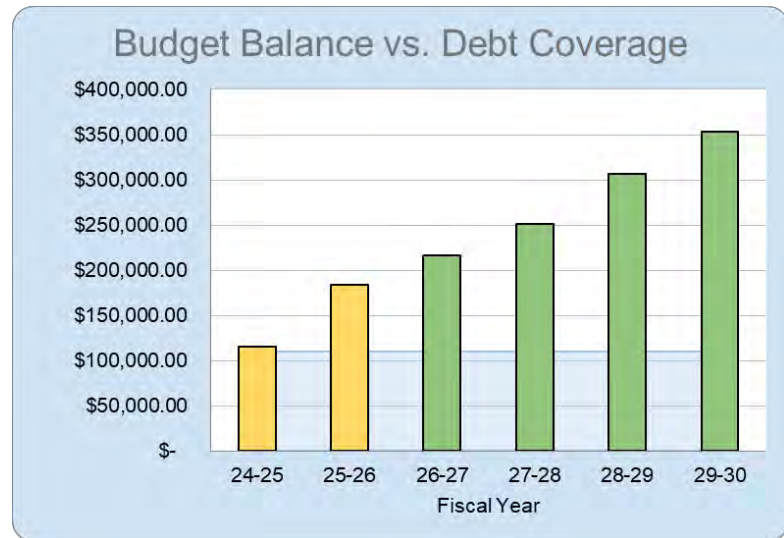

Insurance Increases

The ASK Academy will see unprecedented increases to both medical and liability insurance.

[Medical insurance premiums](#) will see at 15.53% increase costing the school approximately \$64,000 and liability increasing by 44.6% with a cost of \$39,500.

3% Employee Raises

The ASK Academy is complying with the state requirement of a 3% pay increase for all employees. This is an approximate \$116,000 increase to the budget. [Salary Schedule](#)

Sustainable Budget

Due to decreased enrollment from SY23-24, the school will receive \$91,482 less in SEG funds in 24-25 than the current year. This decrease, along with the increases in employee costs affects the school by about \$311,000.

In 2023-2024, the school is anticipating close to a one-half million dollar operational surplus from new SEG dollars, which will allow the budget to absorb these losses while still maintaining our debt coverage ratio in our bond agreement for the upcoming school year.

The chart above shows the projected budget balance for each of next six years. This 24-25 budget is projecting \$115,377, which is about \$5,000 over our minimum to cover the ratio. Although this is not a very large cushion, any growth in the student population will increase revenue without any personnel expenses needed. The chart projects revenue based on 10 additional scholars per year starting in 2025-26 increasing enrollment to 640 in 2029-30.

Value Statement:

Financial Integrity ensures Sustainability and Drives Growth



BUDGET ASSUMPTIONS

- 590 Scholars on 40th Day
 - Any growth will generate more revenue without expenses
- Maintains existing staff positions – 52.5 FTE
 - Salaries and Benefits are approximately 76% of budget
- Does not include Social Emotional Junior Bill
 - \$80,000 (no fund # yet)
- Loss of all COVID Funding
- Unit Value increase of 3.22%
- Minimum 3% raise to all staff members
- 4 staff members moving to higher license level
- SEG funding \$6,149,227 – decrease of ~\$91K
- Federal Programs maintaining existing revenue numbers



ACCURACY

Detailed expense review to determine expected costs for next year and beyond.



REVIEW

Budget projections are vetted by Admin Team to ensure reliability



Growth

Budget has been developed with the majority of expenses covered for up to 640 scholars

BUDGET DETAIL

Revenue	
Ad Valorem Taxes - SB9	\$ 200,000.00
School Fees	\$ 19,200.00
Clubs Activites	\$ 101,982.00
Local Total	\$ 321,182.00
SEG	\$ 6,149,227.00
Next Gen CTE	\$ 25,282.00
PSFA	\$ 468,625.00
Ed Fellows	\$ 93,232.00
GOB Library	\$ 7,031.00
Legislative Appropriations	\$ 2,200,014.00
State Total	\$ 8,943,411.00
Title I	\$ 59,836.00
IDEA-B	\$ 144,041.00
Title II	\$ 17,146.00
Title IV	\$ 10,000.00
Perkins	\$ 92,682.00
Federal Total	\$ 323,705.00
Grand Total	\$ 9,588,298.00

Expenses	
Salaries	\$ 3,734,839
Retirement	\$ 743,503
Taxes	\$ 258,340
Insurance	\$ 541,738
Salaries and Benefits	\$ 5,278,419
Special Ed Therapists	\$ 124,024
Other Charges	\$ 4,954
Field Trips	\$ 6,269
Instructional Materials	\$ 87,050
Student Software	\$ 34,627
Classroom Supplies	\$ 18,689
Contracted Services	\$ 33,000
Software	\$ 6,120
Supplies and Materials	\$ 4,351
Professsional Development	\$ 6,067
Testing Supplies	\$ 14,439
Student Support	\$ 339,590

Professional Development	\$	5,831
Auditing	\$	18,161
Legal	\$	16,482
Memberships & Other Charges	\$	11,035
Advertising	\$	18,013
Board Training	\$	1,530
IT, NOVA & Other Services	\$	116,283
Supplies and Materials	\$	34,643
Software	\$	41,517
Copier and Event Rentals	\$	20,285
Administration	\$	283,780
Other Charges	\$	411
Maintenance & Repair	\$	4,452
Electricity	\$	42,015
Natural Gas (Buildings)	\$	4,035
Water/Sewage	\$	6,695
Communication Services	\$	24,793
Renting Land and Buildings - MAIN	\$	551,352
Renting Land and Buildings - 6th	\$	109,959
Rental - Equipment and Vehicles	\$	5,136
Property/Liability Insurance	\$	128,084
Other Contract Services	\$	124,150
General Supplies and Materials	\$	32,016
Supply Assets	\$	1,645
'Fixed Assets (More Than \$5,000)'	\$	5,100
Administration	\$	1,039,842
Computer/Testing/Misc Fees	\$	19,200
Club/Activity Expenses	\$	101,982
Ed Fellows Program	\$	93,232
GOB Library Supplies	\$	7,031
Capital Outlay Projects	\$	2,200,014
Title II Training and Stipends	\$	17,146
State CTE Program Stipends and Supplies	\$	92,682
Other Expenses	\$	2,531,287
Grand Total	\$	9,472,919
Balance	\$	115,379



4 Day School Week

The ASK Academy is seeking approval for our typical 4 Day School Week Calendar which allows for Fridays to be set aside for our scholar intensive support program and professional development.

5 Day School Week

Should the PED not allow our 4 Day calendar, we will be submitting a 5 Day Week alternative. This calendar would have the scholars on campus for 180 days with Fridays being a 4.5 hour day, still allowing for professional development.



Federal Program Budgets

- IDEA-B
 - Used for Salaries/Benefits for Assistant Special Ed Director
- Title I
 - Used for part of Academic Dean's salary/benefits
- Title II
 - Used for PLC Lead Stipends and for PBL Training
- Carl Perkins
 - Used for PLTW Training and Fees along with TSA, VEX and HOSEA Memberships
- Title IV
 - Used for part of Academic Dean's salary/benefits

2024-2025 School Calendar (4 Day Week - Preferred)

July 2024						
Su	M	Tu	W	Th	F	Sa
	1	2	3	4	5	6
7	8	9	10	11	12	13
14	15	16	17	18	19	20
21	22	23	24	25	26	27
28	29	30	31			
						5

August 2024						
Su	M	Tu	W	Th	F	Sa
				1	2	3
4	5	6	7	8	9	10
11	12	13	14	15	16	17
18	19	20	21	22	23	24
25	26	27	28	29	30	31
					17	2.5

September 2024						
Su	M	Tu	W	Th	F	Sa
1	2	3	4	5	6	7
8	9	10	11	12	13	14
15	16	17	18	19	20	21
22	23	24	25	26	27	28
29	30					
					17	1.5

October 2024						
Su	M	Tu	W	Th	F	Sa
		1	2	3	4	5
6	7	8	9	10	11	12
13	14	15	16	17	18	19
20	21	22	23	24	25	26
27	28	29	30	31		
					19	1.5

November 2024						
Su	M	Tu	W	Th	F	Sa
					1	2
3	4	5	6	7	8	9
10	11	12	13	14	15	16
17	18	19	20	21	22	23
24	25	26	27	28	29	30
					14	1

December 2024						
Su	M	Tu	W	Th	F	Sa
1	2	3	4	5	6	7
8	9	10	11	12	13	14
15	16	17	18	19	20	21
22	23	24	25	26	27	28
29	30	31				
					12	1.5

January 2025						
Su	M	Tu	W	Th	F	Sa
			1	2	3	4
5	6	7	8	9	10	11
12	13	14	15	16	17	18
19	20	21	22	23	24	25
26	27	28	29	30	31	
					15	1.5

February 2025						
Su	M	Tu	W	Th	F	Sa
						1
2	3	4	5	6	7	8
9	10	11	12	13	14	15
16	17	18	19	20	21	22
23	24	25	26	27	28	
					16	1.5

March 2025						
Su	M	Tu	W	Th	F	Sa
						1
2	3	4	5	6	7	8
9	10	11	12	13	14	15
16	17	18	19	20	21	22
23	24	25	26	27	28	29
30	31				13	1.5

April 2025						
Su	M	Tu	W	Th	F	Sa
		1	2	3	4	5
6	7	8	9	10	11	12
13	14	15	16	17	18	19
20	21	22	23	24	25	26
27	28	29	30			
					18	2

May 2025						
Su	M	Tu	W	Th	F	Sa
				1	2	3
4	5	6	7	8	9	10
11	12	13	14	15	16	17
18	19	20	21	22	23	24
25	26	27	28	29	30	31
					13	2

June 2025						
Su	M	Tu	W	Th	F	Sa
1	2	3	4	5	6	7
8	9	10	11	12	13	14
15	16	17	18	19	20	21
22	23	24	25	26	27	28
29	30					

2024-2025 School Calendar (5 Day Week - Alternative to 4 Day Week)

July 2024						
Su	M	Tu	W	Th	F	Sa
	1	2	3	4	5	6
7	8	9	10	11	12	13
14	15	16	17	18	19	20
21	22	23	24	25	26	27
28	29	30	31			

August 2024						
Su	M	Tu	W	Th	F	Sa
				1	2	3
4	5	6	7	8	9	10
11	12	13	14	15	16	17
18	19	20	21	22	23	24
25	26	27	28	29	30	31
				19	3	

September 2024						
Su	M	Tu	W	Th	F	Sa
1	2	3	4	5	6	7
8	9	10	11	12	13	14
15	16	17	18	19	20	21
22	23	24	25	26	27	28
29	30					
					20	4

October 2024						
Su	M	Tu	W	Th	F	Sa
		1	2	3	4	5
6	7	8	9	10	11	12
13	14	15	16	17	18	19
20	21	22	23	24	25	26
27	28	29	30	31		
					20	5

November 2024						
Su	M	Tu	W	Th	F	Sa
					1	2
3	4	5	6	7	8	9
10	11	12	13	14	15	16
17	18	19	20	21	22	23
24	25	26	27	28	29	30
					16	4

December 2024						
Su	M	Tu	W	Th	F	Sa
1	2	3	4	5	6	7
8	9	10	11	12	13	14
15	16	17	18	19	20	21
22	23	24	25	26	27	28
29	30	31				
					15	3

January 2025						
Su	M	Tu	W	Th	F	Sa
			1	2	3	4
5	6	7	8	9	10	11
12	13	14	15	16	17	18
19	20	21	22	23	24	25
26	27	28	29	30	31	
					18	4

February 2025						
Su	M	Tu	W	Th	F	Sa
						1
2	3	4	5	6	7	8
9	10	11	12	13	14	15
16	17	18	19	20	21	22
23	24	25	26	27	28	
					19	4

March 2025						
Su	M	Tu	W	Th	F	Sa
						1
2	3	4	5	6	7	8
9	10	11	12	13	14	15
16	17	18	19	20	21	22
23	24	25	26	27	28	29
30	31				16	5

April 2025						
Su	M	Tu	W	Th	F	Sa
		1	2	3	4	5
6	7	8	9	10	11	12
13	14	15	16	17	18	19
20	21	22	23	24	25	26
27	28	29	30			
					20	2

May 2025						
Su	M	Tu	W	Th	F	Sa
				1	2	3
4	5	6	7	8	9	10
11	12	13	14	15	16	17
18	19	20	21	22	23	24
25	26	27	28	29	30	31
					17	4

June 2025						
Su	M	Tu	W	Th	F	Sa
1	2	3	4	5	6	7
8	9	10	11	12	13	14
15	16	17	18	19	20	21
22	23	24	25	26	27	28
29	30					

The ASK Academy
 LEVEL I BEGINNING TEACHER & CERTIFIED
 LEVEL II PROFESSIONAL AND LEVEL III MASTER TEACHER SALARY SCHEDULE

2024-2025 Salary Schedule

Steps	BA			NBCT			BA + 45 or MA			MA+15			MA+ 45 or Ph d		
	Level I	Level II	Level III	Level I	Level II	Level III	Level I	Level II	Level III	Level I	Level II	Level III	Level I	Level II	Level III
Exp 0	55,398	66,522	77,646	55,509	66,633	77,757	55,620	66,744	77,868	55,731	66,855	77,979	55,842	66,966	78,090
Exp 1	55,509	66,633	77,757	55,620	66,744	77,868	55,731	66,855	77,979	55,842	66,966	78,090	55,954	67,078	78,202
Exp 2	55,620	66,744	77,868	55,731	66,855	77,979	55,842	66,966	78,090	55,954	67,078	78,202	56,065	67,189	78,313
Exp 3	55,731	66,855	77,979	55,842	66,966	78,090	55,954	67,078	78,202	56,065	67,189	78,313	56,176	67,300	78,424
Exp 4	55,842	66,966	78,090	55,954	67,078	78,202	56,065	67,189	78,313	56,176	67,300	78,424	56,287	67,411	78,535
Exp 5	55,954	67,078	78,202	56,065	67,189	78,313	56,176	67,300	78,424	56,287	67,411	78,535	56,399	67,523	78,647
Exp 6	56,065	67,189	78,313	56,176	67,300	78,424	56,287	67,411	78,535	56,399	67,523	78,647	56,510	67,634	78,758
Exp 7	56,176	67,300	78,424	56,287	67,411	78,535	56,399	67,523	78,647	56,510	67,634	78,758	56,621	67,745	78,869
Exp 8	56,287	67,411	78,535	56,399	67,523	78,647	56,510	67,634	78,758	56,621	67,745	78,869	56,732	67,856	78,980
Exp 9	56,399	67,523	78,647	56,510	67,634	78,758	56,621	67,745	78,869	56,732	67,856	78,980	56,844	67,968	79,092
Exp 10	56,510	67,634	78,758	56,621	67,745	78,869	56,732	67,856	78,980	56,844	67,968	79,092	56,955	68,079	79,203
Exp 11	56,621	67,745	78,869	56,732	67,856	78,980	56,844	67,968	79,092	56,955	68,079	79,203	57,066	68,190	79,314
Exp 12	56,732	67,856	78,980	56,844	67,968	79,092	56,955	68,079	79,203	57,066	68,190	79,314	57,177	68,301	79,425
Exp 13	56,844	67,968	79,092	56,955	68,079	79,203	57,066	68,190	79,314	57,177	68,301	79,425	57,289	68,413	79,537
Exp 14	56,955	68,079	79,203	57,066	68,190	79,314	57,177	68,301	79,425	57,289	68,413	79,537	57,400	68,524	79,648
Exp 15	57,066	68,190	79,314	57,177	68,301	79,425	57,289	68,413	79,537	57,400	68,524	79,648	57,511	68,635	79,759
Exp 16	57,177	68,301	79,425	57,289	68,413	79,537	57,400	68,524	79,648	57,511	68,635	79,759	57,622	68,746	79,870
Exp 17	57,289	68,413	79,537	57,400	68,524	79,648	57,511	68,635	79,759	57,622	68,746	79,870	57,734	68,858	79,982
Exp 18	57,400	68,524	79,648	57,511	68,635	79,759	57,622	68,746	79,870	57,734	68,858	79,982	57,845	68,969	80,093
Exp 19	57,511	68,635	79,759	57,622	68,746	79,870	57,734	68,858	79,982	57,845	68,969	80,093	57,956	69,080	80,204
Exp 20	57,622	68,746	79,870	57,734	68,858	79,982	57,845	68,969	80,093	57,956	69,080	80,204	58,067	69,191	80,315
Exp 21	57,734	68,858	79,982	57,845	68,969	80,093	57,956	69,080	80,204	58,067	69,191	80,315	58,179	69,303	80,427
Exp 22	57,845	68,969	80,093	57,956	69,080	80,204	58,067	69,191	80,315	58,179	69,303	80,427	58,290	69,414	80,538
Exp 23	57,956	69,080	80,204	58,067	69,191	80,315	58,179	69,303	80,427	58,290	69,414	80,538	58,401	69,525	80,649
Exp 24	58,067	69,191	80,315	58,179	69,303	80,427	58,290	69,414	80,538	58,401	69,525	80,649	58,512	69,636	80,760
Exp 25	58,179	69,303	80,427	58,290	69,414	80,538	58,401	69,525	80,649	58,512	69,636	80,760	58,623	69,747	80,871
Exp 26	58,290	69,414	80,538	58,401	69,525	80,649	58,512	69,636	80,760	58,623	69,747	80,871	58,735	69,859	80,983
Exp 27	58,401	69,525	80,649	58,512	69,636	80,760	58,623	69,747	80,871	58,735	69,859	80,983	58,846	69,970	81,094
Exp 28	58,512	69,636	80,760	58,623	69,747	80,871	58,735	69,859	80,983	58,846	69,970	81,094	58,957	70,081	81,205
Exp 29	58,623	69,747	80,871	58,735	69,859	80,983	58,846	69,970	81,094	58,957	70,081	81,205	59,068	70,192	81,316
Exp 30	58,735	69,859	80,983	58,846	69,970	81,094	58,957	70,081	81,205	59,068	70,192	81,316	59,180	70,304	81,428

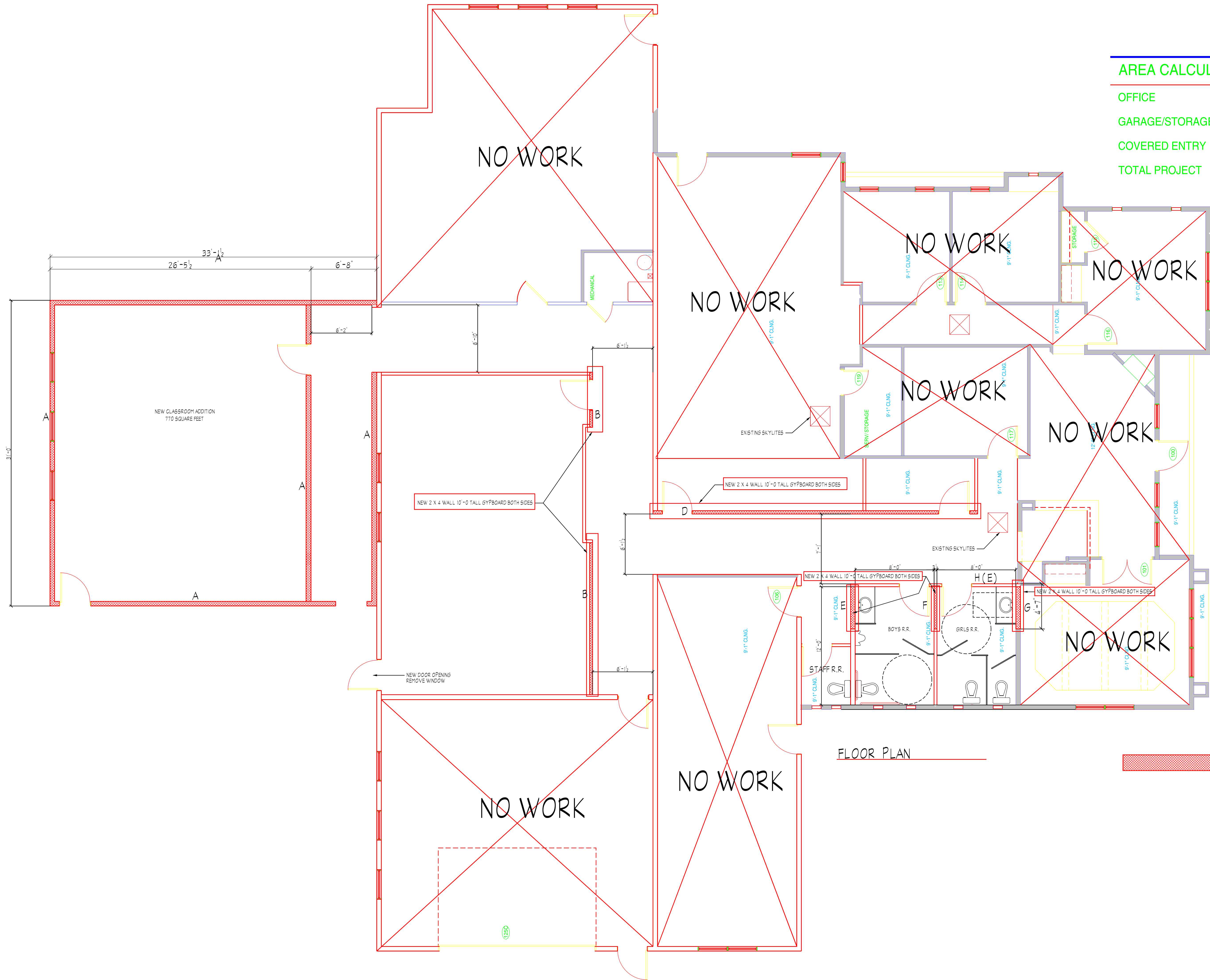

AREA CALCULATIONS	
OFFICE	3007.98 SF
GARAGE/STORAGE/MECH.	1991.67 SF
COVERED ENTRY	71.17 SF
TOTAL PROJECT	5070.81 SF

REVISIONS	BY

FLOOR PLAN

DRAWN: WCE	CHECKED: WCE
SCALE: 1/4" = 1'-0"	
JOB NO.:	
SHEET A1	
OF	SHEETS