

Name: _____ Date: _____

Rising 5th Grade Summer Math Packet

Section A Multiple-Choice Questions

- 1 Which numbers make the comparison true?
_____ $>$ 97,240
Choose the **two** correct answers.
- (A) 97,420 (B) 94,270
(C) 97,402 (D) 97,204
(E) 92,740
- 2 Which of the following pairs of numbers have 4 as a common factor?
Choose the **two** correct answers.
- (A) 6 and 9 (B) 8 and 12
(C) 9 and 15 (D) 12 and 28
(E) 24 and 35
- 3 Which problem can be solved by finding $\frac{2}{5} \times 10$?
- (A) Maya has 10 packets of juice. Each packet contains $\frac{2}{5}$ liter of juice. Find the total amount of juice Maya has.
- (B) Sean has $\frac{2}{5}$ of a bottle of paint. He buys 10 more bottles of paint. How many bottles of paint does he have now?
- (C) A teacher has 10 meters of string. She uses $\frac{2}{5}$ of it to tie some packages. Find the length of string she has left.
- (D) A tank contains 10 liters of water. $\frac{2}{5}$ liter of water is drained out. Find the amount of water left in the tank.

- 4 Zane uses the digits 2, 1, 7, and 8 once to form the smallest number with 2 decimal places.

Which digit is in the hundredths place?

- (A) 0
- (B) 2
- (C) 7
- (D) 8

- 5 What is 1 foot 5 inches in inches?

- (A) 6 inches
- (B) 12 inches
- (C) 15 inches
- (D) 17 inches

- 6 What is the missing number?

$$20 + 3 + 0.05 = \underline{\hspace{2cm}}$$

- (A) 2.35
- (B) 20.35
- (C) 23.05
- (D) 23.5

- 7 Nicole took 1 hour 20 minutes to complete her homework. She finished at 1532. What time did she start?

☐ A 4:32 P.M.
☐ B 4:52 P.M.
☐ C 2:12 P.M.
☐ D 2:42 P.M.

- 8 Which comparisons are correct?
Choose the **two** correct answers.

☐ A 6 meters = 600 centimeters
☐ B 2 miles > 3,650 yards
☐ C 3 feet > 40 inches
☐ D 2 yards > 4 feet
☐ E 1 yard < 30 inches

- 9 What is the length of a side of a square with area 16 square feet?

☐ A 4 feet
☐ B 16 feet
☐ C 32 feet
☐ D 64 feet

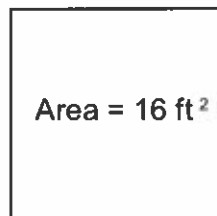

- 10 The length of a rectangle is 9 yards. Its perimeter is 42 yards. What is the area of the rectangle?

- (A) 108 square yards
- (B) 216 square yards
- (C) 297 square yards
- (D) 378 square yards

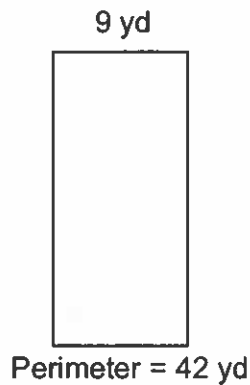

- 11 What is the perimeter of the figure?

- (A) 40 meters
- (B) 50 meters
- (C) 56 meters
- (D) 68 meters

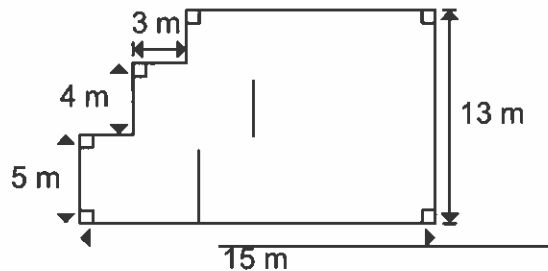

- 12 Kimberly had a rectangular piece of paper. She folded two of the corners as shown. What is the area of the paper before the corners were folded?

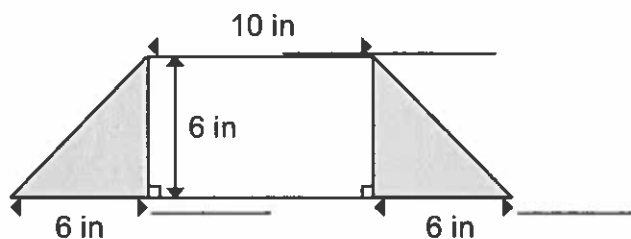

- (A) 60 square inches
- (B) 96 square inches
- (C) 132 square inches
- (D) 192 square inches

- 13 Which of the following shows an angle between a $\frac{1}{4}$ -turn and a $\frac{1}{2}$ -turn?

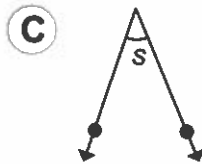
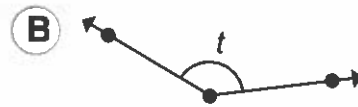
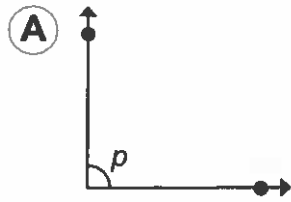

- 14 Which statement about the figure is **not** true?

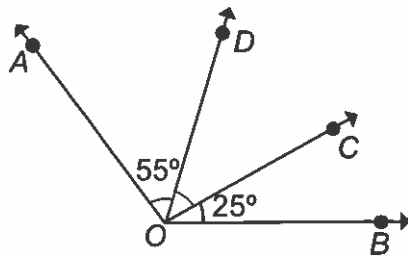

- (A) $\angle AOB$ is greater than a straight angle.
 (B) $\angle AOB = \angle COD + \angle COB + \angle AOD$.
 (C) $\angle COD$ is less than a $\frac{1}{4}$ -turn.
 (D) The sum of $\angle COB$ and $\angle AOD$ is less than 90° .

- 15 Which of the following are right triangles? Use a protractor to help you. Choose the **two** correct answers.

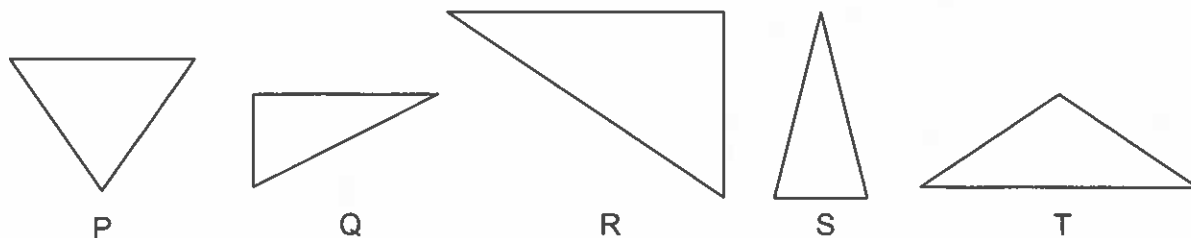

- (A) P
- (B) Q
- (C) R
- (D) S
- (E) T

- 16 Dominic wants to sort the figures into two groups, with three figures in each group. In what ways can he sort them?

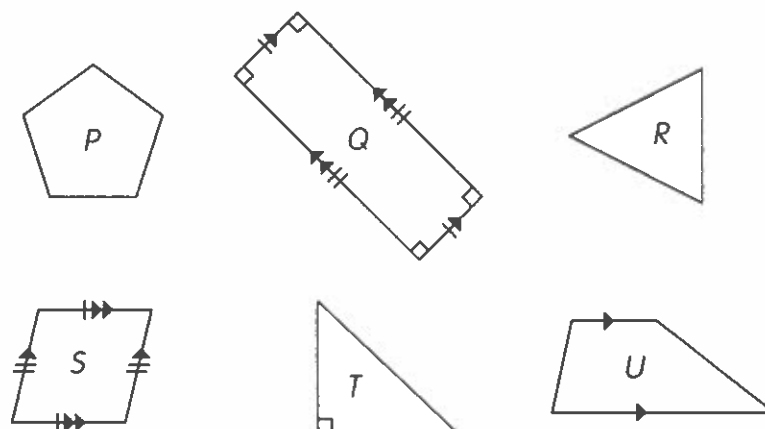

Choose the **two** correct answers.

- (A) Triangles and Quadrilaterals
- (B) Quadrilaterals and Non-quadrilaterals
- (C) Polygons with at least one pair of parallel sides and Polygons with no parallel sides
- (D) Polygons with one right angle and Polygons with no right angles
- (E) Polygons with 2 pairs of equal sides and Polygons with no equal sides

- 17 This question has two parts.
The line graph shows the amount of water in a tank over a week.

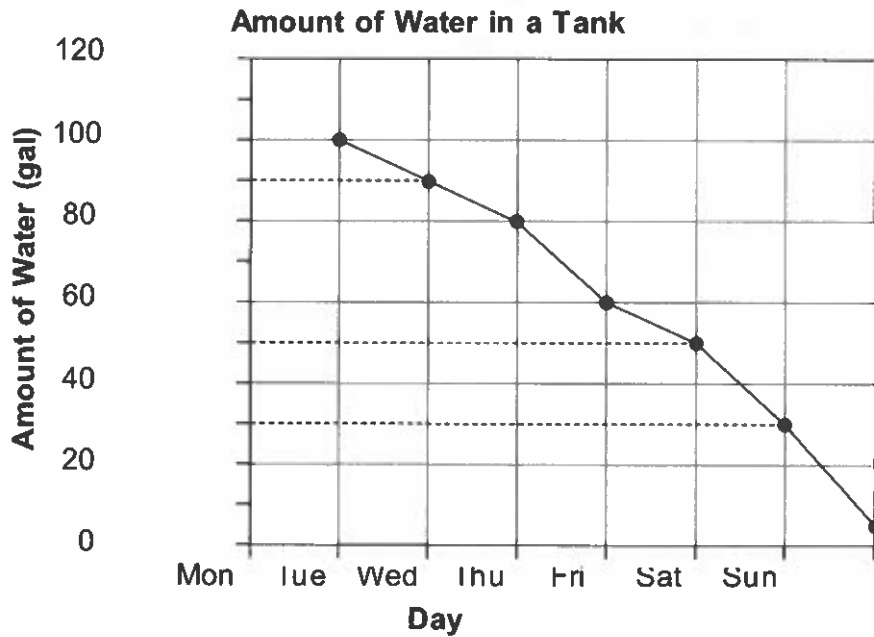

Part A

How much water was in the tank on Friday?

- ☐ A 100 gallons
- ☐ B 90 gallons
- ☐ C 50 gallons
- ☐ D 30 gallons

Part B

How much water was used between Wednesday and Thursday?

- ☐ A 5 gallons
- ☐ B 10 gallons
- ☐ C 15 gallons
- ☐ D 20 gallons

- 18 This question has two parts.
The ages of the children in a camp are shown in the table below.

Ages of Children		Number of Children
	5	6
	6	7
	7	?
	8	9
	9	8

Part A

How many children in the camp are 8 years old?

- (A) 6
- (B) 7
- (C) 8
- (D) 9

Part B

The number of children attending the camp is 40 when rounded to the nearest 10. What is the greatest possible number of children who are 7 years old?

- (A) 10
- (B) 13
- (C) 14
- (D) 15

Section B Short Answer Questions

19 $100,563 - 70,009 =$

Write your answer in the answer grid.

•	•	•	•	•	•
0	0	0	0	0	0
1	1	1	1	1	1
2	2	2	2	2	2
3	3	3	3	3	3
4	4	4	4	4	4
5	5	5	5	5	5
6	6	6	6	6	6
7	7	7	7	7	7
8	8	8	8	8	8
9	9	9	9	9	9

20 $2,718 \div 9 =$

Write your answer in the answer grid.

•	•	•	•	•	•
0	0	0	0	0	0
1	1	1	1	1	1
2	2	2	2	2	2
3	3	3	3	3	3
4	4	4	4	4	4
5	5	5	5	5	5
6	6	6	6	6	6
7	7	7	7	7	7
8	8	8	8	8	8
9	9	9	9	9	9

21 $467 \times 23 =$

Write your answer in the answer grid.

⊙	⊙	⊙	⊙	⊙	⊙
0	0	0	0	0	0
1	1	1	1	1	1
2	2	2	2	2	2
3	3	3	3	3	3
4	4	4	4	4	4
5	5	5	5	5	5
6	6	6	6	6	6
7	7	7	7	7	7
8	8	8	8	8	8
9	9	9	9	9	9

22 What is the missing number?

$$\frac{3}{12} = \frac{1}{\quad}$$

Write your answer in the answer grid.

⊙	⊙	⊙	⊙	⊙	⊙
0	0	0	0	0	0
1	1	1	1	1	1
2	2	2	2	2	2
3	3	3	3	3	3
4	4	4	4	4	4
5	5	5	5	5	5
6	6	6	6	6	6
7	7	7	7	7	7
8	8	8	8	8	8
9	9	9	9	9	9

- 23 Express $6\frac{2}{5}$ as an improper fraction.

Show your work and write your answer in the space below.

- 24 8 years ago, Mr. Martin was 3 times as old as his son. The sum of their ages now is 64 years. How old is Mr Martin now?

Show your work and write your answer in the space below.

- 25 Ms. Jones gives her class the following expression with some clues.

$$\boxed{}\frac{\boxed{}}{8} - \boxed{}\frac{\boxed{}}{8}$$

Clues:

- A There are two mixed numbers in simplest form.
- B The digits 3, 4, 5, and 7 are used only once.
- C The difference between the two mixed numbers must be the smallest possible difference.

Find the smallest possible difference between the mixed numbers.

Show your work and write your answer in the space below.

- 26 Find the value of $3 \times 2\frac{7}{2}$.

Show your work and write your answer as a mixed number in simplest form in the space below.

- 27 Look for a pattern. What is the missing decimal?

6.43 6.33 6.23 6.13 _____ 5.93

Write your answer in the answer grid.

•	•	•	•	•	•
0	0	0	0	0	0
1	1	1	1	1	1
2	2	2	2	2	2
3	3	3	3	3	3
4	4	4	4	4	4
5	5	5	5	5	5
6	6	6	6	6	6
7	7	7	7	7	7
8	8	8	8	8	8
9	9	9	9	9	9

- 28 Ms. Hall buys $8\frac{2}{7}$ feet of ribbon. She uses $3\frac{6}{7}$ feet of it to make hair ties.

She needs $4\frac{5}{7}$ feet of ribbon to make headbands.

Does Ms. Hall have enough ribbon left for the headbands? Explain.

Show your work and write your answer in the space below.

- 29 Matthew has 84 more stamps than Sophie. How many stamps must Matthew give Sophie so that Sophie will have 20 more stamps than Matthew?

Show your work and write your answer in the space below.

- 30 Draw a line segment perpendicular to the given line segment through point A .



- 31 Draw a line segment parallel to the given line segment through point B .

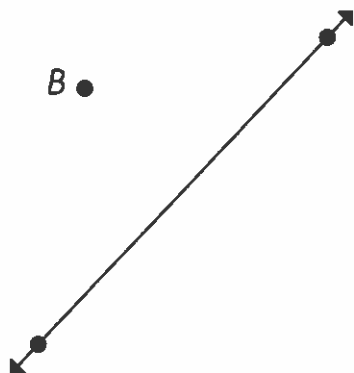

- 32 The measure of $\angle YOZ$ is 160° . Draw and label the angle.

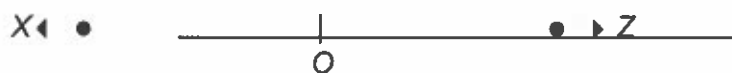

- 33 What are the measures of $\angle r$ and $\angle s$? Use a protractor to help you. Write each answer in the blank.

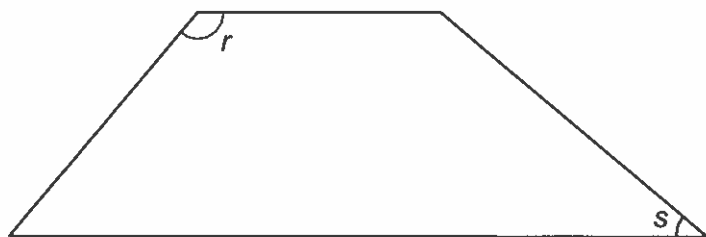

$m\angle r =$ _____

$m\angle s =$ _____

- 34 The dotted line in the figure below is a line of symmetry. Shade the correct squares to make a symmetric pattern.

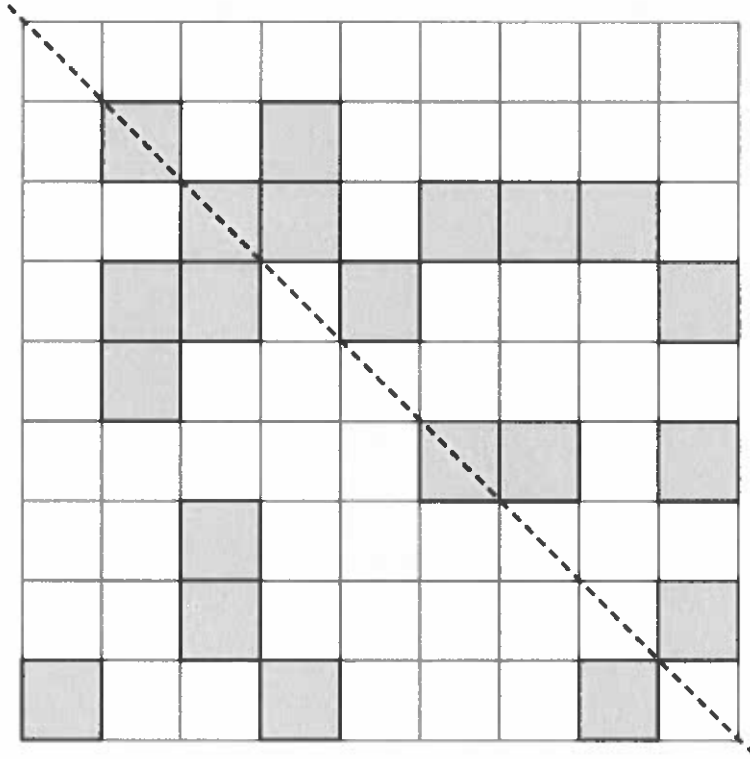

- 35 A lawn surrounds 2 square ponds measuring 4 meters by 4 meters as shown.

Sara says that the area of the lawn is 78 square meters because $13 \times 6 = 78$.

How should Sara correct her mistake? Explain.

Show your work and write your answer in the space below.

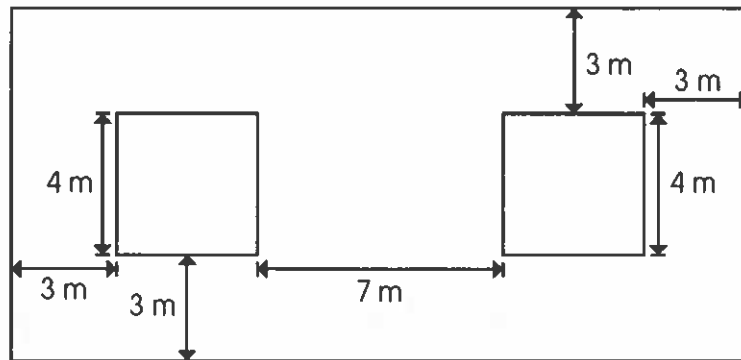

- 36 $EFGH$ is a rectangle. Find the measure of $\angle f$.

Show your work and write your answer in the space below.

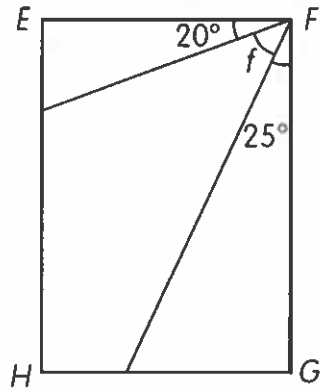

- 37 The table shows the number of packets of fruit juice sold by different stores. Some data is missing. Justin says that Store D sold the least number of packets of fruit juice for each of the three types of juice. Is Justin correct? Explain.

Write your answers in the table and space below.

Store	Apple Juice	Orange Juice	Pear Juice	Total Number
A	26		15	60
B	26	15	14	55
C		6	12	
D	13			39
Total	91	48		198

- 38 Josiah is thinking of a number. When the number is subtracted from both the numerator and denominator of $\frac{9}{15}$, the fraction becomes $\frac{2}{5}$.

What number is Josiah thinking of?

Show your work and write your answer in the space below.

Section C Constructed Response (39 to 43 : 4 points each)

- 39 Alex's watch is 15 minutes slow. He wants to be on time for a basketball game at 1930. Alex needs 25 minutes to get ready. Then, he needs to take a bus from his house to the stadium. The bus journey takes 55 minutes. What time will be shown on Alex's watch when he begins to get ready for the game?

Write your answer and your work or explanation in the space below.

- 40 James had 674 stickers. He had twice as many stickers as Chris. Ella had 3 times as many stickers as Chris. Rachel said that Ella had 2,022 stickers.

- Explain Rachel's mistake.
- What should the correct answer be?

After Ella gave Chris some stickers, they had an equal number of stickers. How many stickers did Ella give Chris?

Write your answer and your work or explanation in the space below.

- 41 Anna has 2 identical rectangular pieces of paper. She places one on top of the other as shown.

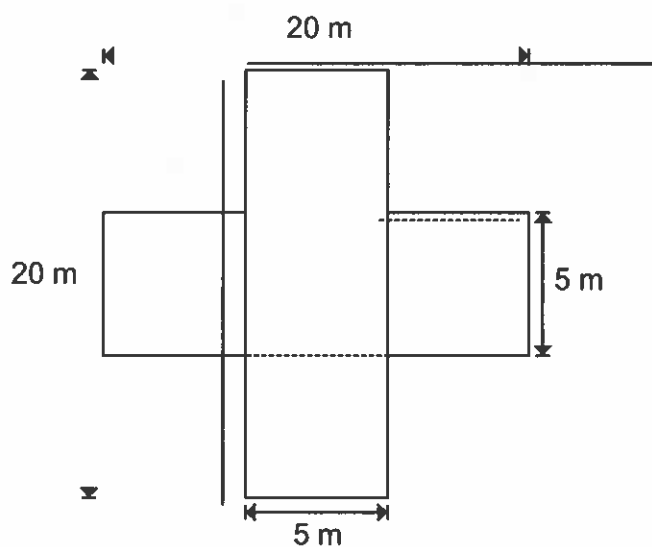

Anna finds the area of the figure as shown.

$$20 \times 5 = 100$$

$$100 \times 2 = 200$$

The area of the figure is 200 m^2 .

- Explain Anna's mistake.
- What should the correct answer be?
- Explain how you arrived at your answer.

Write your answer and your work or explanation in the space below.

- 42 The line graph shows the number of visitors to a roller coaster park each month, over six months.

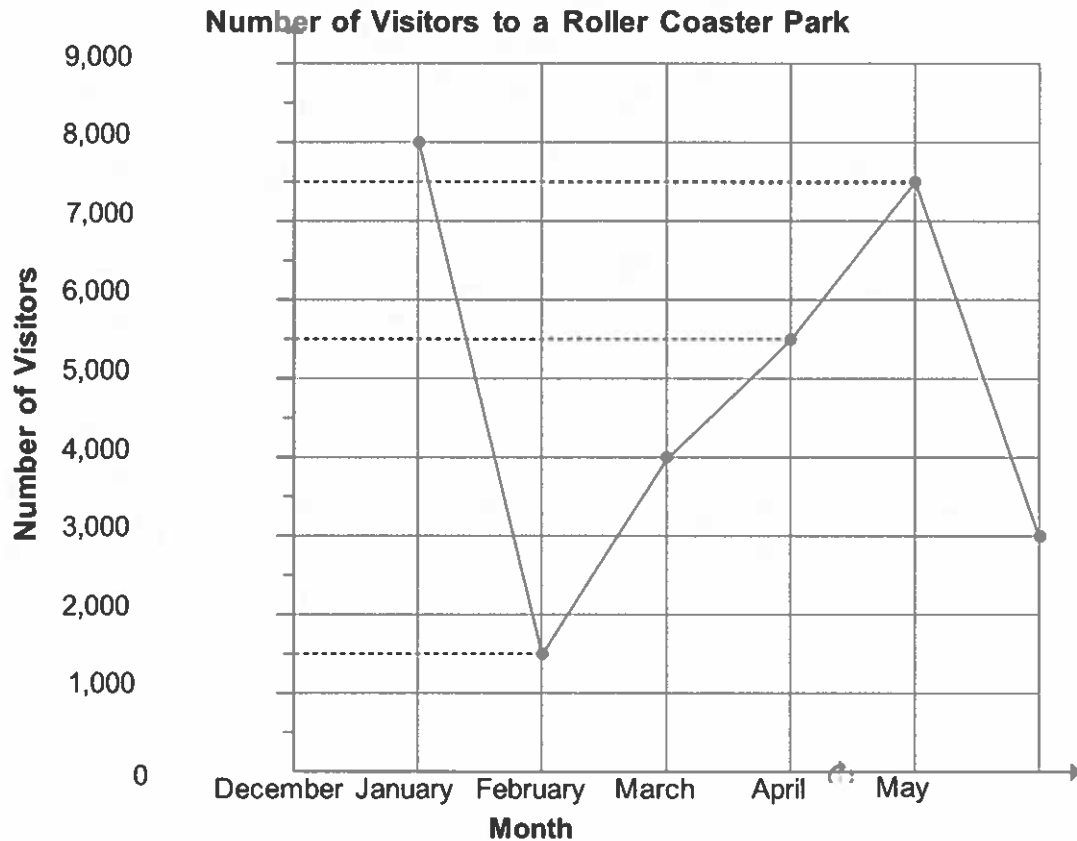

- Which month had the least number of visitors?
- From the graph, Ava says that the greatest increase in the number of visitors was between January and February. Is Ava correct?
- Explain how you arrived at your answer.

Write your answers and your work or explanation in the space below.

43. Luis is making muffins. A recipe calls for $\frac{3}{10}$ kilogram of flour and $\frac{7}{100}$ kilogram of sugar.

Does Luis use more flour or more sugar?

- How much flour and sugar does Luis use in all? Write your answer as a decimal.
- Explain how you arrived at your answers.

Write your answers and your work or explanation in the space below.

IXL Recommendations:

* These are not mandatory

*Put the 3-digit code at the end Into the IXL search box for skill to pull up.

- ☐ Add and subtract numbers up to five digits CFX
- ☐

IXL Recommendations:

*** These are not mandatory**

***Put the 3-digit code at the end Into the IXL search box for skill to pull up.**

- ☐ Add and subtract numbers up to five digits CFX
- ☐ Rounding: up to thousands place Z7U
- ☐ N.4 Multi-step word problems EA9
- ☐
- ☐ BB.6 Interpret line graphs 36B
- ☐ P.6 Identify equivalent fractions GSG
- ☐ X.7 Convert decimals to fractions and mixed numbers DBF
- ☐ AA.4 Add and subtract money amounts 3Y6
- ☐ Complementary and supplementary angles: find the missing measure BBB
- ☐ Square angles: find the missing measure 9R6
- ☐ Conversion tables: metric units of length 73K
- ☐ HH.9 Area and perimeter: word problems LTP