

THE TIME HAS COME!

Please join us
JUNE 8

We invite you to a 'Groundbreaking'
worship service on June 8 at 10:30 AM.

The service will begin in the south parking area
before moving into the sanctuary.

Reception in Green Hall will follow the service.



GROUND BREAKING

St. James 
EPISCOPAL CHURCH
& SCHOOL

The Building Process Begins!

St. James is finally breaking ground on a new and exciting era for our church and school community! Over the next year or so, parishioners and parents will see signs of growth all around, and we are eager to meet these signs with hope and God-given patience!

Although the physical signs of construction are only just beginning, the Church and vestry have been busy working behind the scenes coordinating plans, financing, and a budget for the project.

The Building Committee, WAV Architects, and Witherington Construction have been working on the value engineering process of our expansion for months. This collaborative effort prioritizes the needs of the church and school while controlling costs.

During the January parish meeting, an alternative to the multipurpose building was presented, which included a pavilion and minimally covered walkway. The vestry requested continuing to price both options.

In mid-May, the team reviewed the completed architectural drawings and the guaranteed maximum price and discovered a significant price reduction. The revised pricing was presented to the Vestry in May. With the price decrease, St. James could proceed with the full construction of the multipurpose building, a covered drop area, and a new school entrance.

The multipurpose building will feature a stage, athletic courts, and ample space for parish meals and programs. Please review the renderings for a comprehensive understanding of the scope.

We are thrilled to add a long overdue second entrance off Section Street. It will connect to the existing parking meadow and serve as the construction entrance and exit. Once complete, it will provide access to the new covered entrance of our multipurpose building and school. New parking spaces will be built in front of the building, replacing the current wooded area and shed.

During construction, parts of the St. James parking lot will be inaccessible. We've improved the North parking area near the church, adding 12 or more spots. In the coming months, we'll provide directional signage, volunteer traffic control, and help in the parking lot on Sunday mornings. Be sure to watch emails, Anchor Lines, and Sunday church announcements for updates.

As our community adjusts to the many challenges and thrills that come with construction over the next year, let us all have grace and patience as we remain hopeful for the next chapter of St. James Church and School!

A note from the Finance Office

We officially kicked off our capital campaign, Growing Faithfully, on June 9th, 2024, with Commitment Sunday. At this kickoff we received pledges of \$3.4 million for the campaign and actual contributions of just over \$800,000. It was a great kickoff! Since then, our commitments have totaled \$5 million, with a current cash balance of \$1.9 million.

After numerous iterations of value engineering with our Architect, Contractor and Building Committee, we have been able to reduce the project cost to \$6,835,688. This will include a completed multi-purpose building including a small stage, athletic facilities for volleyball, basketball and pickleball, as well as gathering space for more than 200 people. It is anticipated we will need to borrow \$3.5 million for construction financing. Upon completion, we should be able to convert to a long-term mortgage of around \$1.6 million.

As we approach the first anniversary of our campaign, over 60 families have fulfilled their pledges. For those of you who pledged an annual amount, the due date for your second installment is approaching. For those that pledged either one-time or as possible, we ask that you consider making a contribution towards your pledge concurrent with our ground breaking. We encourage everyone to consider increasing your pledge or making an additional payment. All contributions are very welcome!

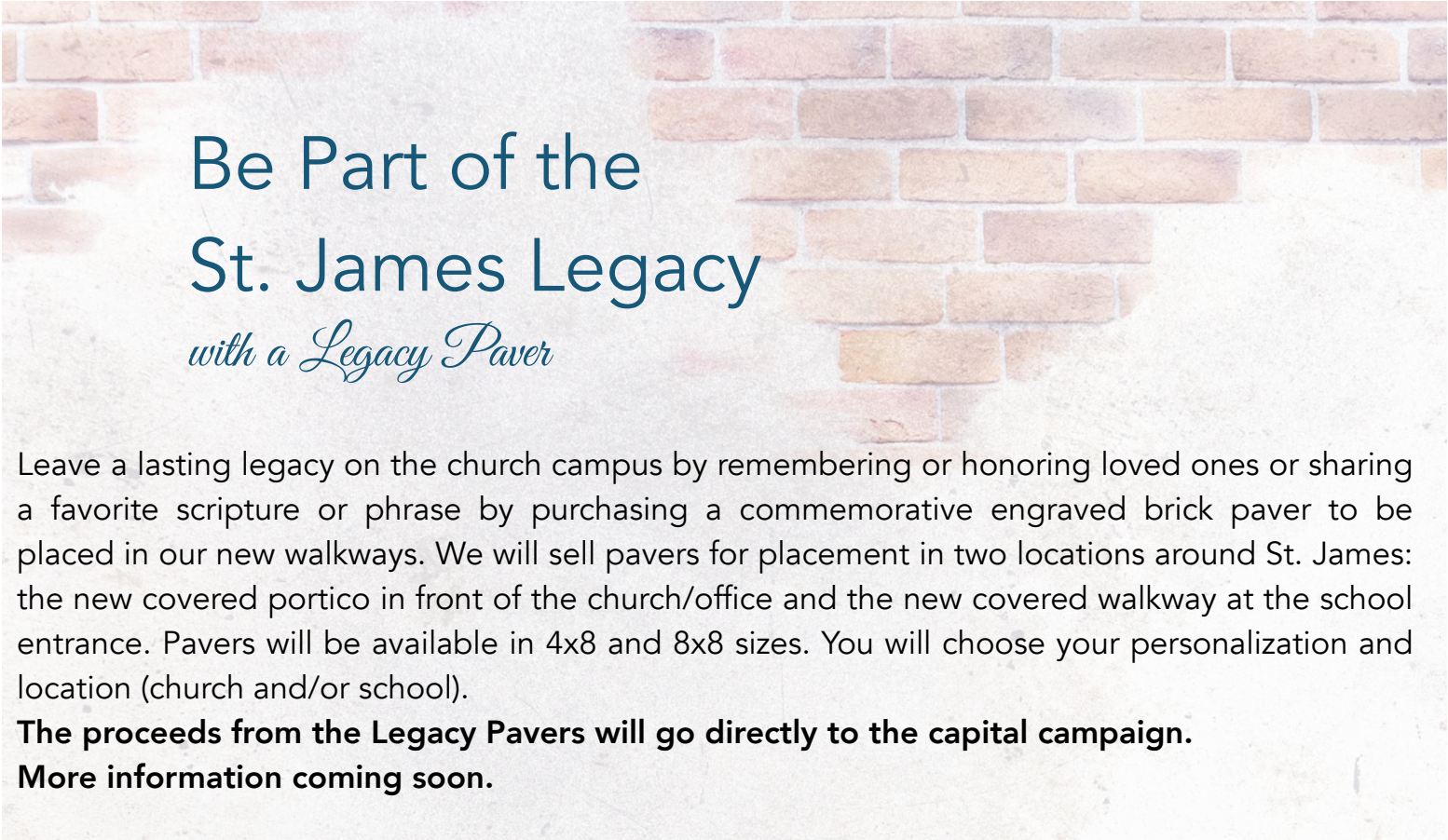

Be Part of the St. James Legacy

with a Legacy Paver

Leave a lasting legacy on the church campus by remembering or honoring loved ones or sharing a favorite scripture or phrase by purchasing a commemorative engraved brick paver to be placed in our new walkways. We will sell pavers for placement in two locations around St. James: the new covered portico in front of the church/office and the new covered walkway at the school entrance. Pavers will be available in 4x8 and 8x8 sizes. You will choose your personalization and location (church and/or school).

**The proceeds from the Legacy Pavers will go directly to the capital campaign.
More information coming soon.**

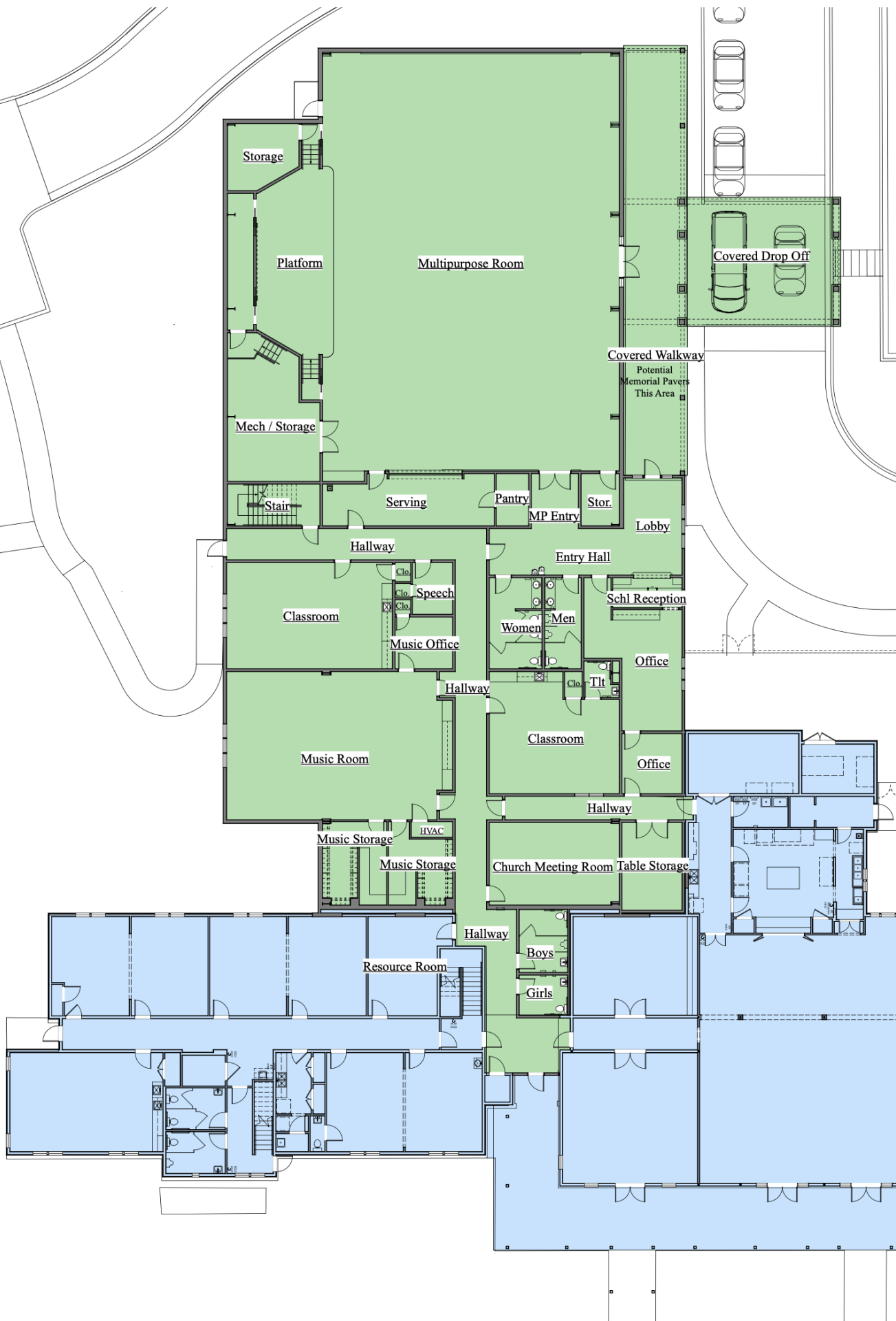

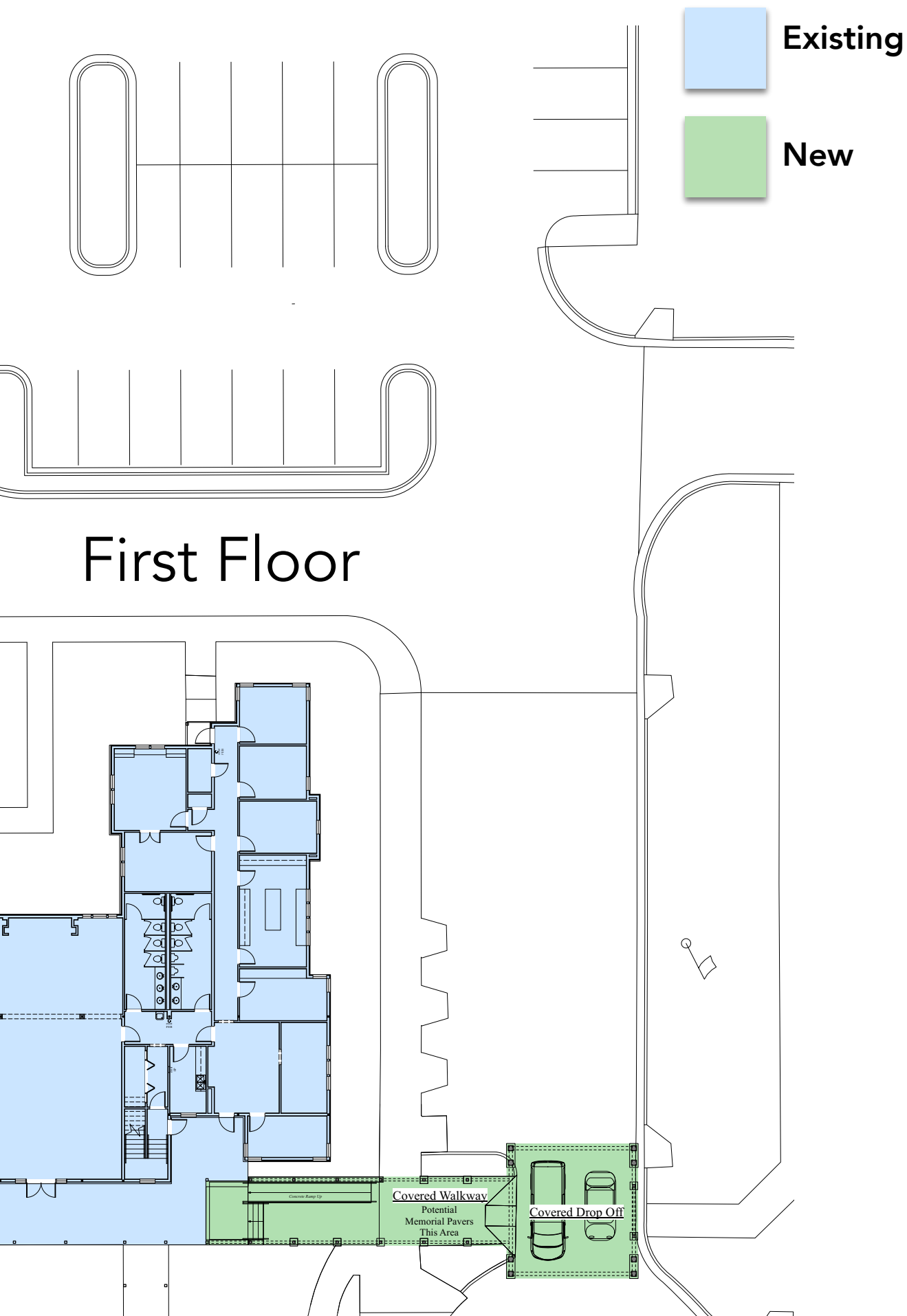

Growing



New front entrance covered drop off.
Will include a handicapped accessible ramp.



New entrance to multipurpose building and school.

Faithfully



New parking area and multipurpose building.

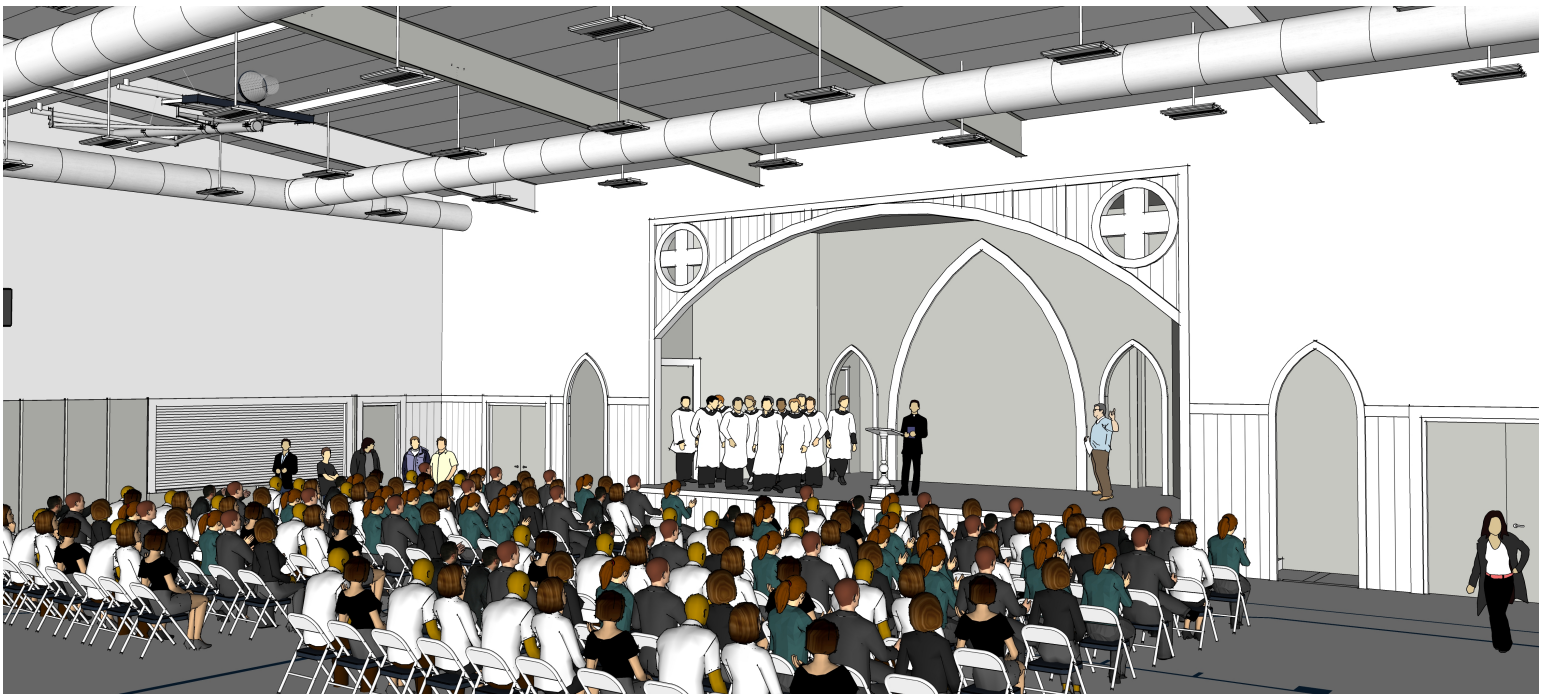

Multipurpose Building.



We are a community anchored in Christ,
seeking God, sharing His love and serving
others.

860 North Section Street
Fairhope, AL 36532
251- 928-2912 phone
www.stjamesfairhope.org

RETURN SERVICE REQUESTED

Parish Office Hours

Monday - Thursday
8:30 AM - 5:00 PM

Friday ~ CLOSED

NON-PROFIT ORG.
U.S. POSTAGE PAID
Permit # 16
Fairhope, AL



Please join us
JUNE 8
for a
GROUND

BREAKING

Worship Service
at 10:30 AM

St. James
EPISCOPAL CHURCH
& SCHOOL