



MIDDLE SCHOOL STUDY UPDATE

April 8, 2025



I. Intro to Presentation

II. Previous Concept Overview

III. New Middle School at South Concepts

IV. Evaluation of Concepts

V. Location Evaluation & Comparison

VI. Next Steps



Agenda

Middle School Study Goals

- **A New Middle School for 1,400 to 1,700 Students**
- **Two Concepts for a Middle School at North or South**
 - Additions & Renovations
 - Like-New building
- **100% New Middle School *initially* developed for comparison**
- **Explore Potential for a New Middle School on South Site**
 - CAMS South remains in operation until complete
 - Location / Proximity to High School Campus
 - Site upgrades to support High School



Additions & Renovations at CAMS North



Additions & Renovations at CAMS South

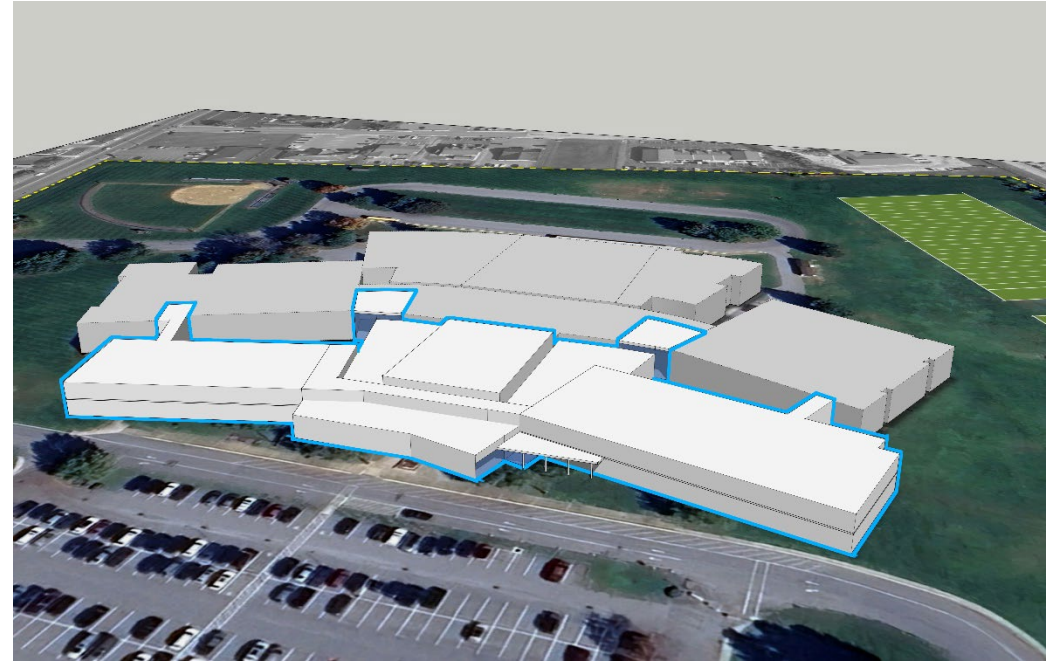

Previous Concept Overview

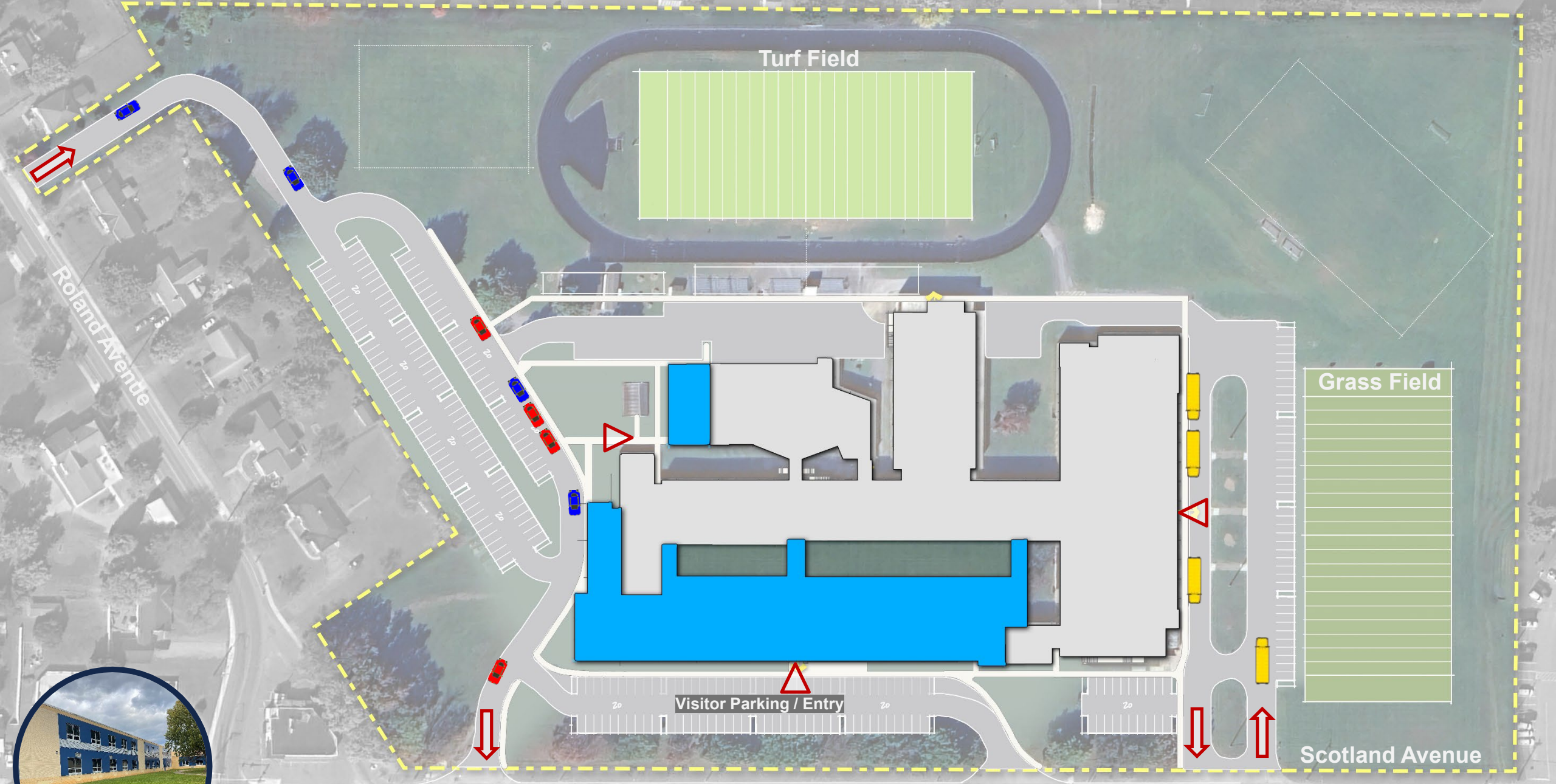

CAMS North

Proposed Site Plan

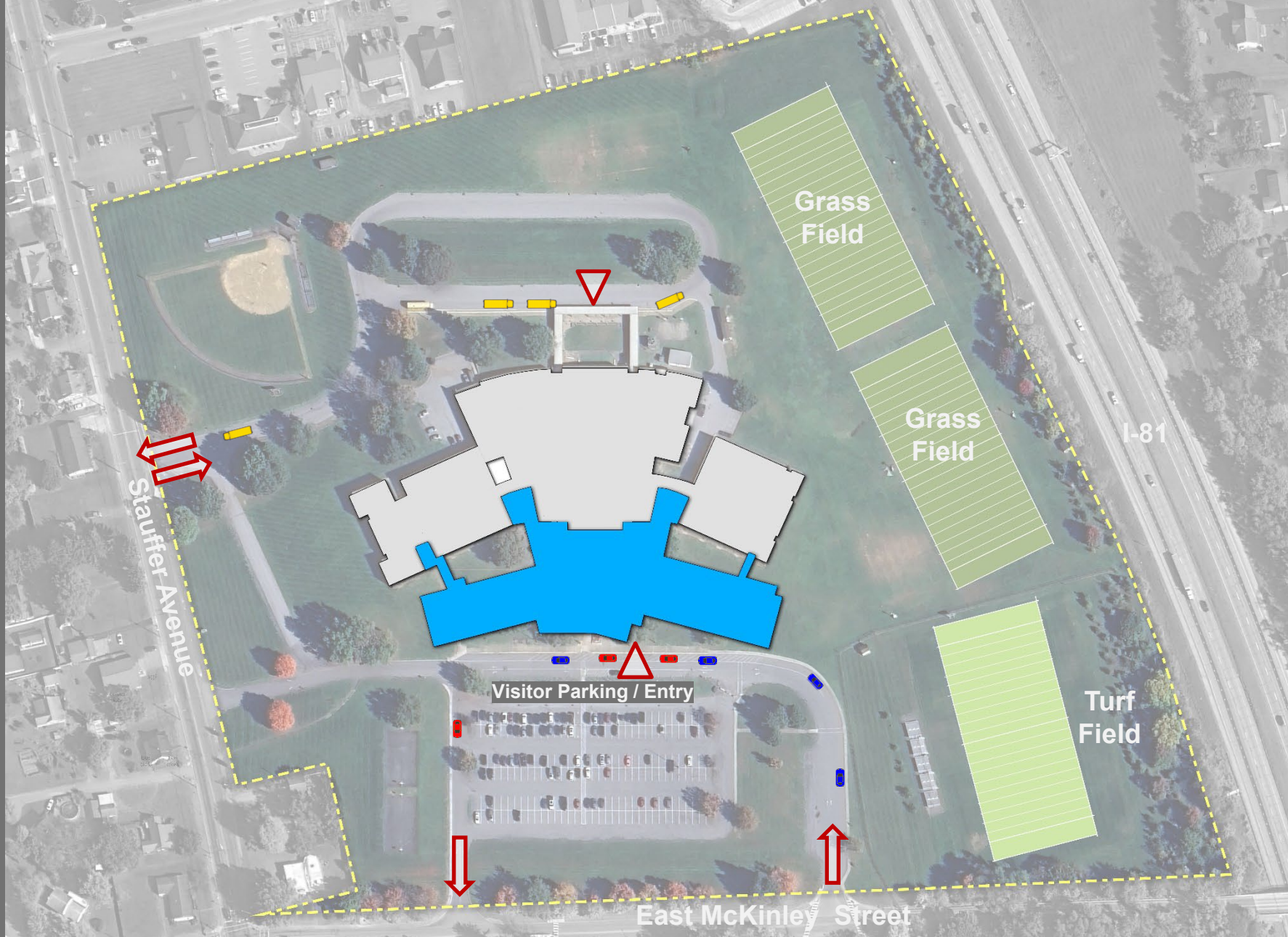

CAMS South

Proposed Site Plan



Concept Comparison

North

South

New

1.	Architectural Square Foot	259,910	261,405	260,000
2.	Program Square Foot	165,660	171,178	178,605
3.	Total Square Foot per Student	180.6	181.6	186.15
4.	Educational Environment	+	=	+
5.	Project Phasing	+	◎	+
6.	Site: Size & Features	◎	+	+
7.	Location compared to High School	=	+	+ =
8.	Minimize Major Renovations	+	=	+
9.	Building Longevity	◎	=	+
10.	Operational Expenses	◎	◎	+
11.	Budget	+	◎	=
12.	Estimated Total Project Cost	\$79M – \$91M	\$87M - \$99M	\$111M - \$127M



Concept Evaluation Matrix

Concept Comparison

North

South

New

1.	Architectural Square Foot	259,910	261,405	260,000
2.	Program Square Foot	165,660	171,178	178,605
3.	Total Square Foot per Student	180.6	181.6	186.15
4.	Educational Environment	+	=	+
5.	Project Phasing	+	◎	+
6.	Site: Size & Features	◎	+	+
7.	Location compared to High School	=	+	+ =
8.	Minimize Major Renovations	+	=	+
9.	Building Longevity	◎	=	+
10.	Operational Expenses	◎	◎	+
11.	Budget	+	◎	=
12.	Estimated Total Project Cost	\$79M – \$91M	\$87M - \$99M	\$111M - \$127M



Concept Evaluation Matrix

Concept A

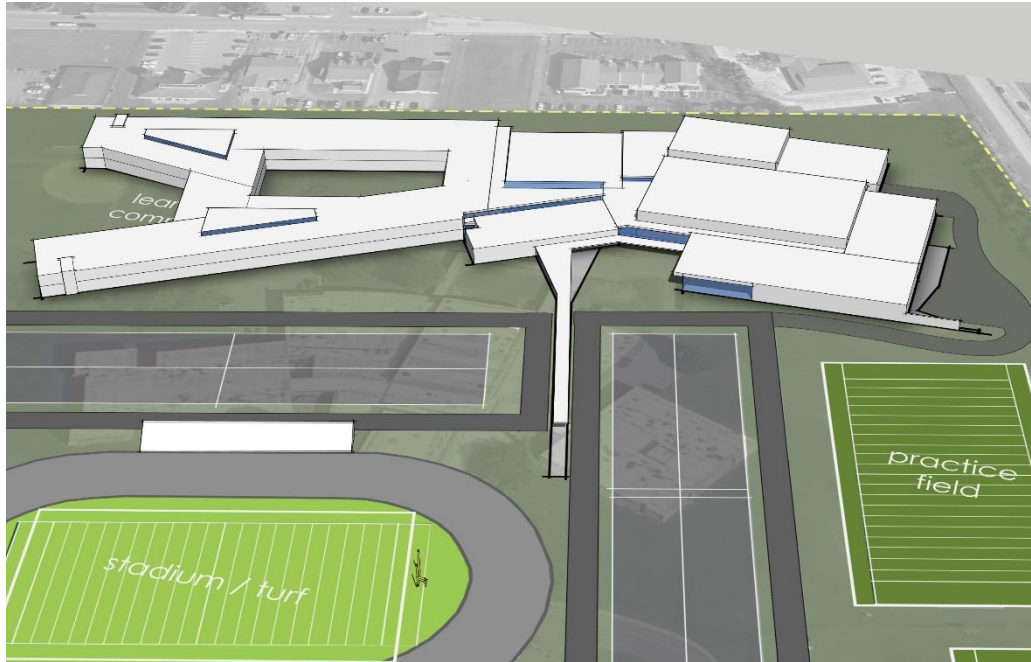

Concept B



NEW Middle School at CAMS South: Concepts



CAMS South

EXISTING Site Plan

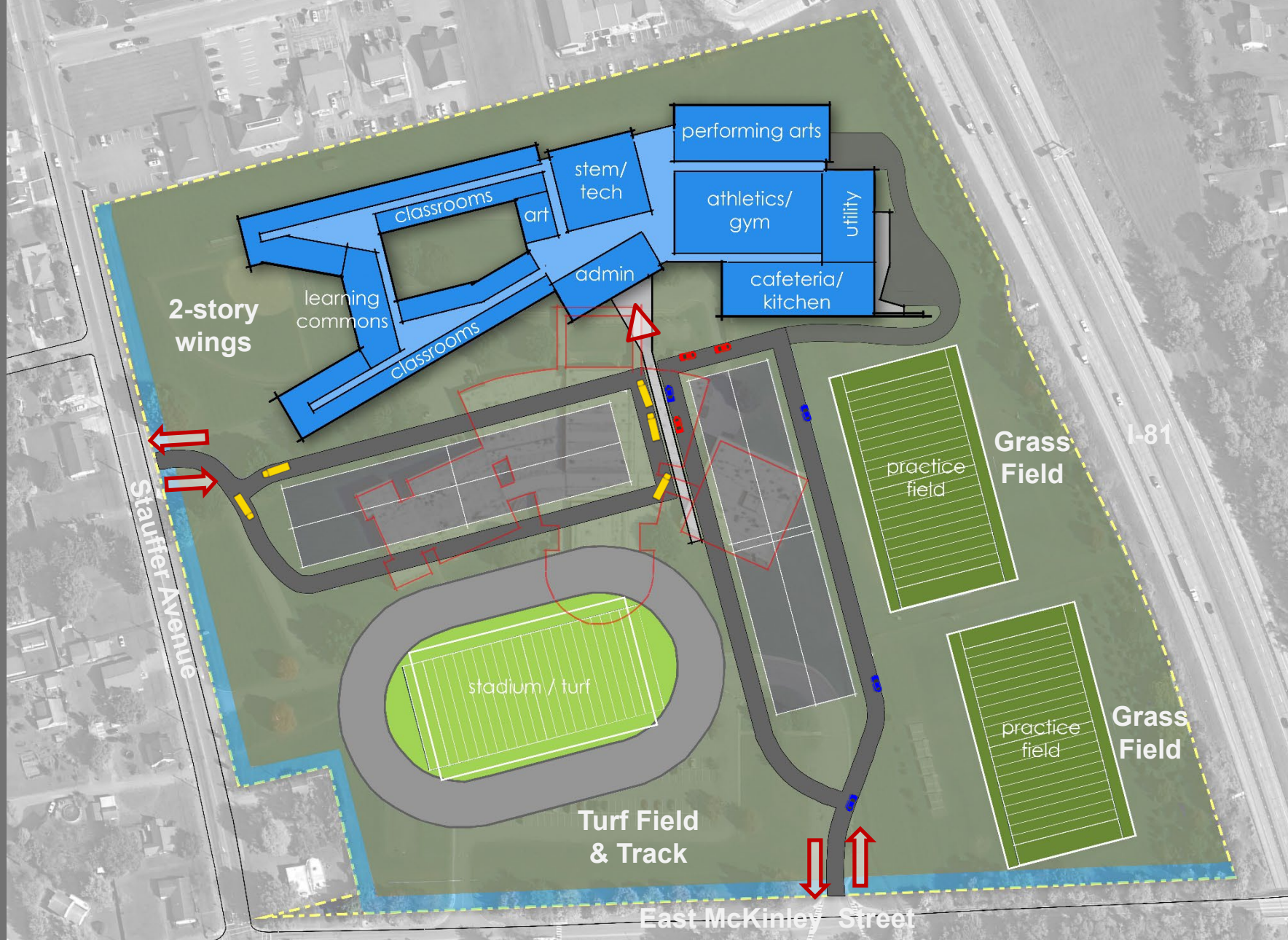

Concept A

Proposed Site Plan



CAMS South

EXISTING Site Plan

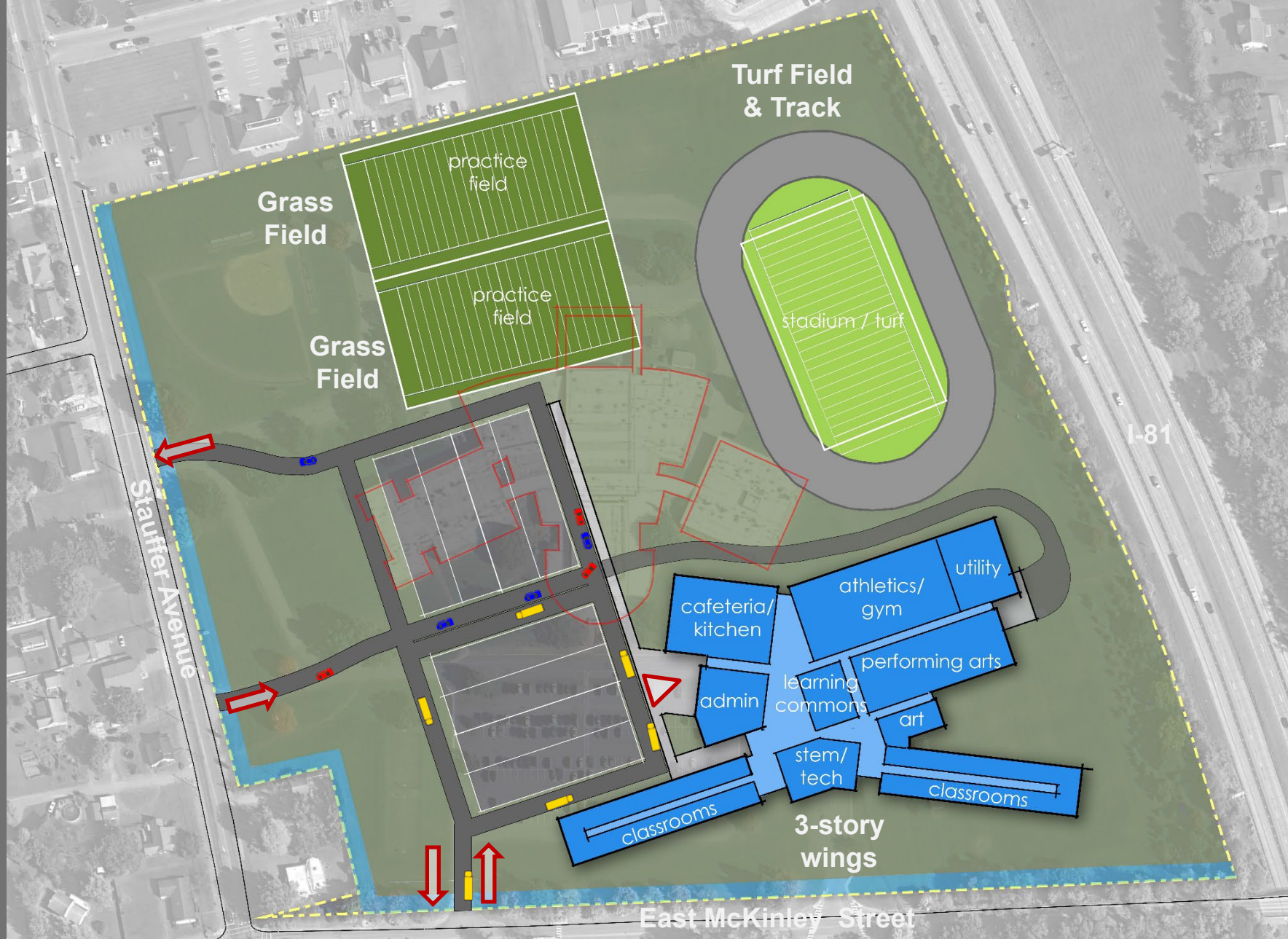

Concept B

Proposed Site Plan

Concept A

- **2-Story Classroom Wings**
- **Larger building footprint**
- **Vehicle circulation similar to existing**
- **Turf field & track at front of site**

Concept B

- **3-Story Classroom Wings**
- **Smaller building footprint**
- **Re-oriens vehicle circulation**
- **Turf field & track at back of site**



Location Comparison

North Site

South Site

Educational Location: CASHS

Transportation - (Secondary run)

Athletics: CASHS proximity

Project Phasing

Site: Acreage

Location within Boro (Central)

Access to Memorial Park

Future Building Expansion

Convenience for Families

Operational Efficiency



Next Steps

- Respond to board & administration feedback
- Develop administration recommendation
- Continue with athletics & operations study
 - Incorporate options into overall master plan

Potential Project Timeline

- Begin Design: May 2025
- Bidding: Fall 2026
- Start Construction: Spring 2027

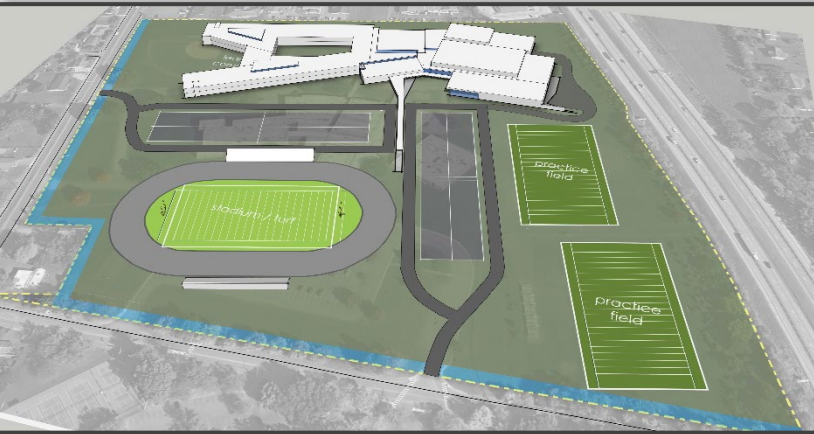



THANK YOU