

1

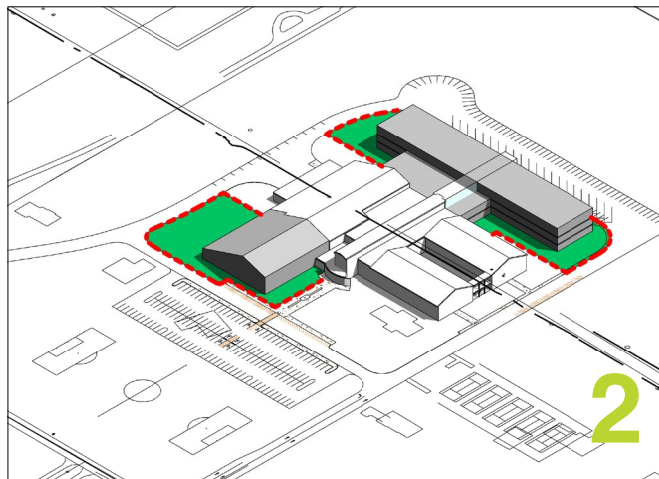

2

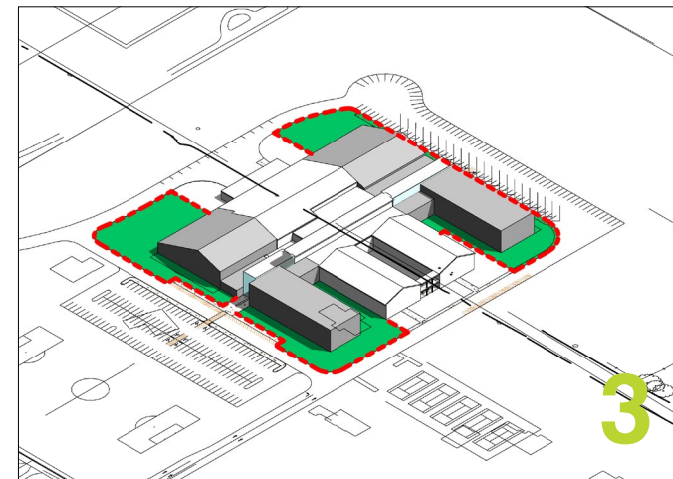

3

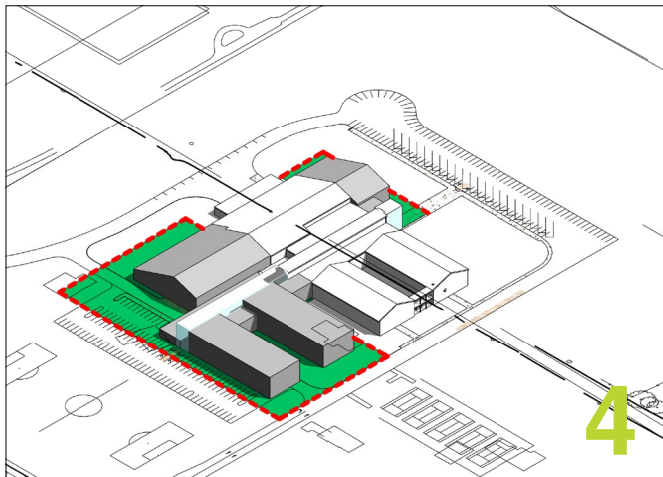

4

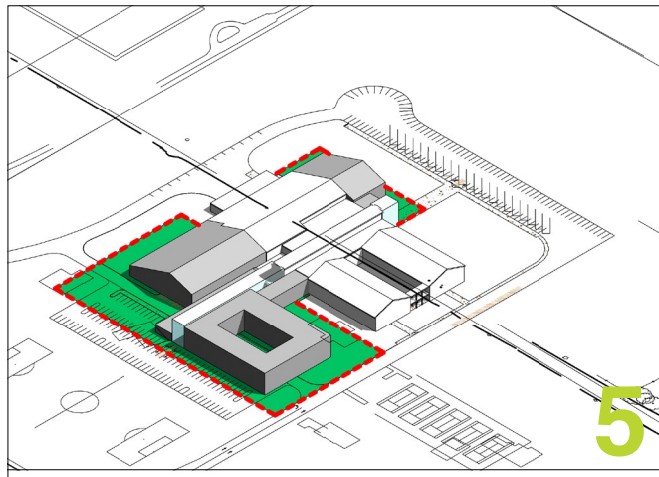

5

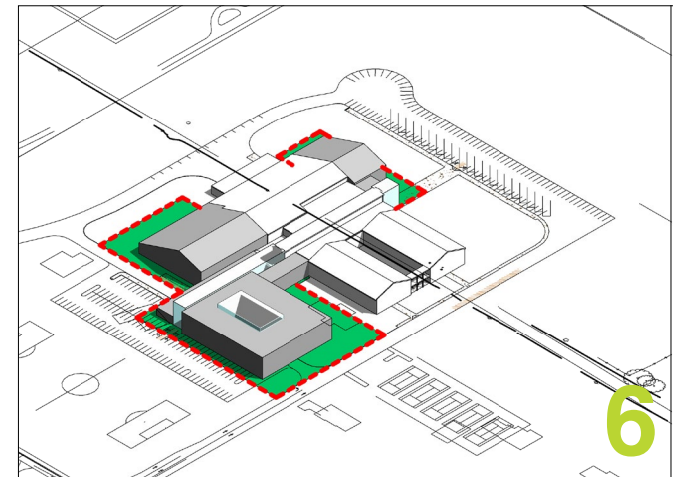

6

	Site/ Parking / Stormwater (Spaces)	Site Disturbance (Square Feet)	Foundation (Square Feet)	Roof (Square Feet)	Separation Walls (Square Feet)	Exterior Walls (Square Feet)	Logistics (Site)	MEP (Site)	Potential Savings
1	0	199,421	83,135	83,135	19,041	68,967			
6	-100	134,095	64,250	64,250	11,367	47,345			
Reduction	-100	65,326	18,885	18,885	7,674	21,622			
Cost Savings	-\$400,000	\$326,630	\$472,125	\$566,550	\$613,920	\$972,990	\$500,000	\$25,000	\$3,077,215

massing studies - Plains Jr