

EXISTING BASEMENT AREA:	2,867 NSF
EXISTING FIRST FLOOR AREA:	58,700 NSF
TOTAL EXISTING AREA:	61,567 NSF
SPACE STANDARD - 533 STUDENTS:	74,909 NSF
PROPOSED BASEMENT AREA:	2,867 NSF
PROPOSED FIRST FLOOR AREA:	72,019 NSF
TOTAL PROPOSED AREA:	74,886 NSF

DEPARTMENT LEGEND	
	ACADEMIC CORE PROGRAMS
	SPECIAL EDUCATION PROGRAMS
	STUDENT SUPPORT
	PHYSICAL EDUCATION PROGRAMS
	FOOD SERVICES
	ARTS AND HUMANITIES PROGRAMS
	LIBRARY / MEDIA CENTER
	ADMINISTRATIVE & SUPPORT SPACES
	BUILDING SERVICES & CORE AREA
	CIRCULATION

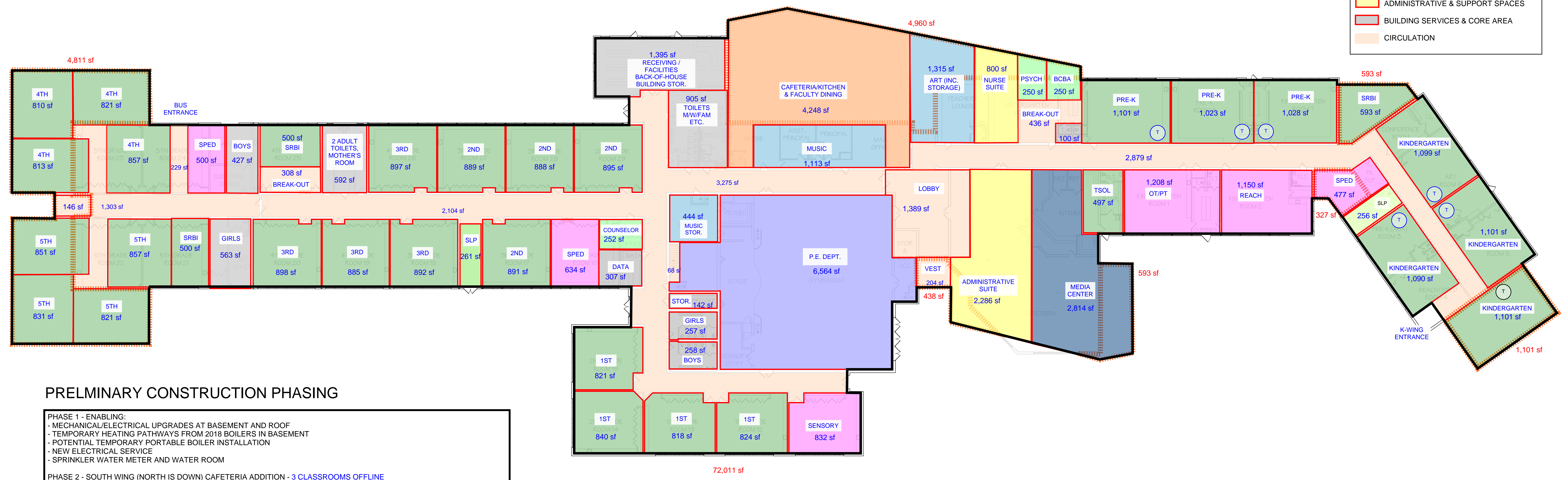
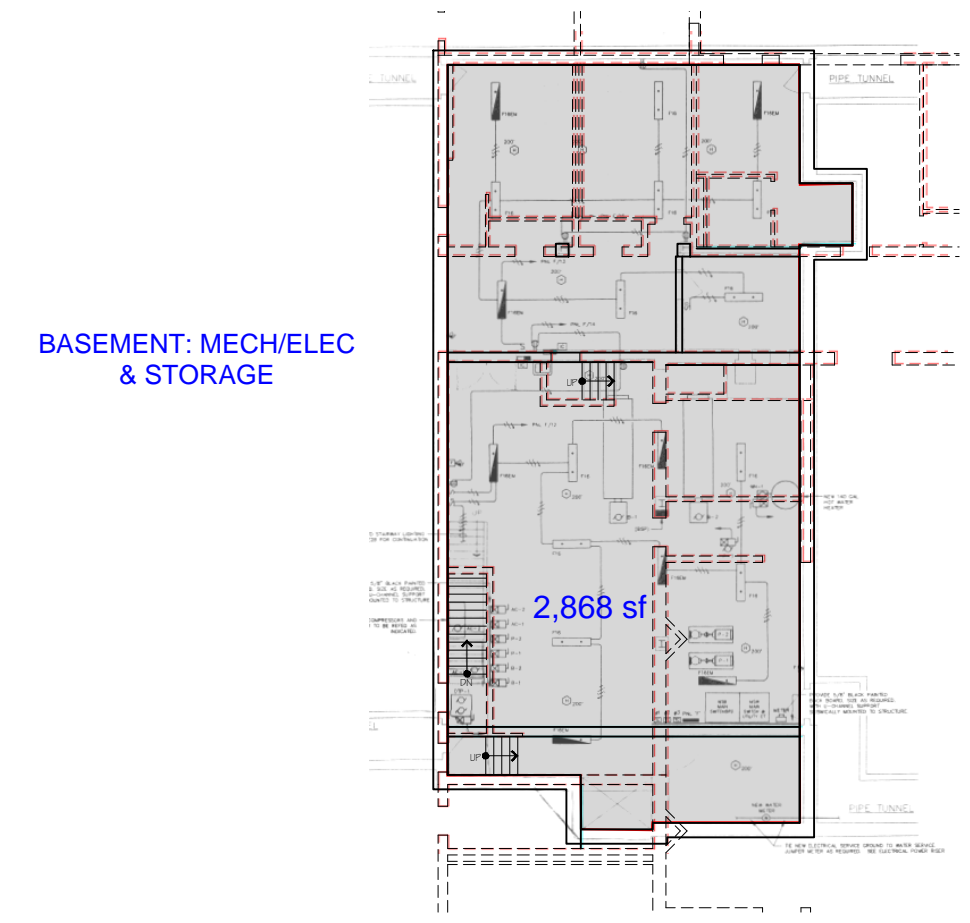

PRELIMINARY CONSTRUCTION PHASING

- PHASE 1 - ENABLING:**
- MECHANICAL/ELECTRICAL UPGRADES AT BASEMENT AND ROOF
 - TEMPORARY HEATING PATHWAYS FROM 2018 BOILERS IN BASEMENT
 - POTENTIAL TEMPORARY PORTABLE BOILER INSTALLATION
 - NEW ELECTRICAL SERVICE
 - SPRINKLER WATER METER AND WATER ROOM
- PHASE 2 - SOUTH WING (NORTH IS DOWN) CAFETERIA ADDITION - 3 CLASSROOMS OFFLINE**
- RELOCATE MAIN OFFICE TO 1ST GRADE ROOMS 11 & 12 NEAR DOOR
 - RELOCATE TEACHERS LOUNGE, KINDERGARDEN ROOM 10 & FIRST GRADE ROOMS 11 & 12 TO TEMPORARY SPACE
 - DEVELOP EGRESS AND CONNECTION BETWEEN K WING AND UPPER GRADE WING
- PHASE 3 - PRE-K / K-WING ADDITIONS AND UPGRADES - 10 CLASSROOMS OFFLINE**
- RELOCATE REMAINDER OF PRE-K / K (SIX CLASSROOMS) AND REACH (ONE CLASSROOM) TO TEMPORARY SPACE
 - ART AND MUSIC ARE RELOCATED OR IN A CART
- PHASE 4 - ENTRANCE, ADMIN & MEDIA CENTER - 10 CLASSROOMS OFFLINE**
- CAFETERIA, MUSIC, ART, NURSE, PSYCH, BREAKOUT COMPLETE
 - ADMIN AND MEDIA CENTER CONSTRUCTED; LOBBY AND ENTRANCE RECONFIGURED
- PHASE 5 - UPPER GRADE ADDITION - 11 CLASSROOMS OFFLINE**
- WITH COMPLETION OF PREVIOUS PHASES, K, PRE-K AND REACH RETURN TO PERMANENT LOCATIONS.
 - UPGRADE OF FIRST GRADE WING. 1ST GRADE ROOM 13 AND 2ND GRADE ROOMS 14 & 15 MOVE TO TEMPORARY SPACE
 - ENTIRE 5TH GRADE AND TWO 4TH GRADE CLASSROOMS MOVE TO PORTABLES OR WITHIN BUILDING
- PHASE 6 - RENOVATION / RECONFIGURATION OF REMAINING SPACES - 8 CLASSROOMS OFFLINE**
- CONSIDER SUMMER WORK TO UPGRADE CORRIDORS AND GYMNASIUM
 - WITH COMPLETION OF PHASE 5, 13 CLASSROOMS (SENSORY, 1ST GRADE, 4TH GRADE, 5TH GRADE)
 - 2ND & 3RD GRADE MOVE TO TEMPORARY SPACE
- COMPLETION - ALL SPACES ACTIVE**
- OFFLINE CLASSROOMS LISTED ARE MINIMUMS
 OFFICES AND RESOURCE CLASSROOM RELOCATIONS MAY INCREASE NEED FOR TEMPORARY SPACE
 DESIRE TO KEEP GRADE LEVELS TOGETHER MAY INCREASE NEED FOR TEMPORARY SPACE

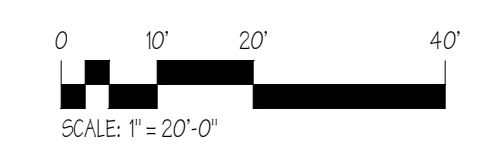

ANTINOZZI ASSOCIATES
 ARCHITECTURE + INTERIORS

