

WHITE PLAINS CITY SCHOOL DISTRICT  
5 Homeside Lane  
White Plains, NY 10605

**BID #F2025-09**  
**Repair/Replace Existing Fencing or Install New Fencing**

**ADDENDUM #1**

The following questions were received from bidders with the response highlighted in yellow:

1. What type of high security fencing is required (lengths, widths, and specific type, Item no-22)?

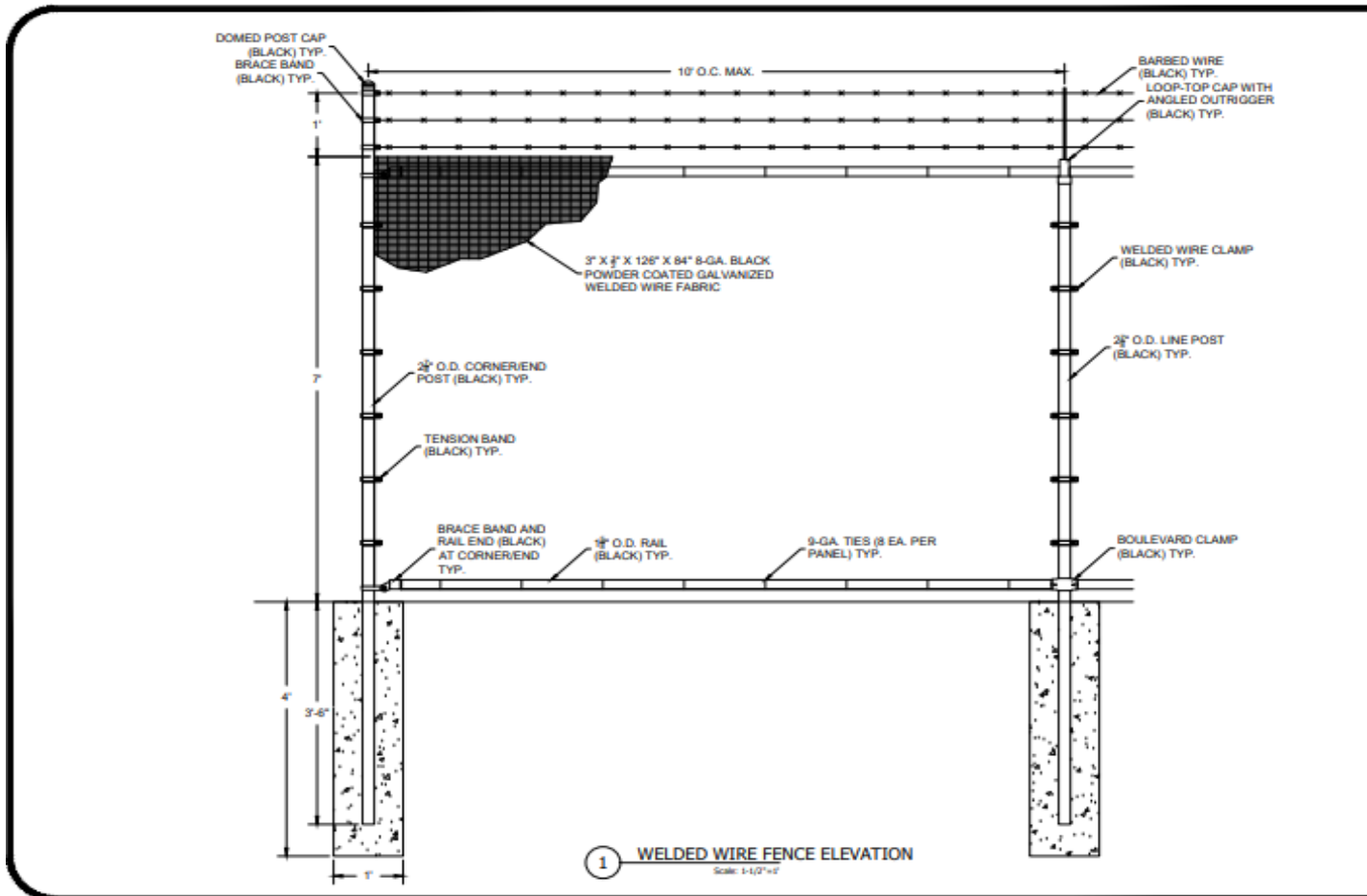

2. For the high security fencing gate, do you prefer a sliding gate or swing gate or which type? Additionally, could you provide the required measurements (Item no-23)? **Swing gate – 7 ft H X 6 ft W.**
3. What is the required height for the hedge-type fence (Item no-28)? **6 ft.**

4. For the 2-hole concrete line and corner posts, should they be above ground, or are there any specific specifications for this (Item no-34 to 39)? **Same details under notes in pg. 34**
5. On page 4, number 9 towards the top of the page states that performance and payment bonds as stipulated in item #39 of the specifications are waived. On page 19 item #39 states that they are required. Which is it? **Pg 4 Item #9-Waived. Page 19 is the bond specifications and is not applicable. In this instance the bonds are not required and waived but there is a bid security of \$500.00 to be submitted with your bid submission.**
6. On page 4 it states that bidders must also provide 3 years of audited financial statements. Is this to be provided if we are the lowest bidder, or must it be submitted with our bid? **Submit together with bid.**
7. On the bid sheet, #19 is asking for a linear foot price for pedestrian guide rail. It refers you to Note 11 on page 42. Number 11 on page 42 talks about an hourly rate. Are we bidding an hourly rate for this item or are we including installation of material also? **Hourly rate.**
8. On the bid sheet, #20 asks for a price for a backstop. It refers you to #6 on page 42. There is no information as to the height of the backstop, what type of mesh, how many horizontal rails, does it have a hood? Etc. Can you please clarify?

**Backstops will meet High school regulation for Baseball and Softball**

- **Baseball**
  - 20 ft H post , 4in Sch 40, Rails every 6 ft
  - Side panels – (2) 10 ft wide section on each
  - Back panels – (3) 11 ft wide sections
  - Fabric 6 gauge – 2 in mesh -black coated
- **Softball**
  - Post
    - (2) front - 14.5 ft, 4 in Sch 40
    - (2) mid - 12 ft, 4 in Sch 40
    - (2) back corners - 10 ft, 4 in Sch 40
  - Rails (2 wings, each wing)
    - (3) top.mid, bottom - Horizontal (20 ft) divided in 10 ft sections
    - (1) Angle (25 ft) – one length
  - Back panel – (1) 10 ft wide sections
    - (3) top.mid, bottom - Horizontal (10 ft)
  - Canopy – support arms to be welded
    - 4 rails left to right
    - 3 rails back to front
  - Fabric 6 gauge – 2 in mesh -black coated
  - Note
    - 30 ft opening
    - 15 ft from home plate each to each side

9. It seems that page #42 does not coincide with many items on the bid sheet. I'm not really sure what to do. Also, items 40, 41 and 42 have no estimated quantities listed. Items 41 and 42 ask for post 5" and 6" standard. What kind of posts is that Steel? Wood? Square? Round? Galvanized?
- a. Item 40. Square concrete post
  - b. Items 40 & 41 Bollards Round steel. Factory powder coated - Safety yellow- 48" H
  - c. Price per unit

If you have any questions regarding this addendum, please email me at: [tonirusso@wpcsd.k12.ny.us](mailto:tonirusso@wpcsd.k12.ny.us)

Thank you,

*Toni Russo*

Toni Russo

Purchasing Supervisor

**White Plains Public Schools**

5 Homeside Lane

White Plains, NY 10605