

ADDENDUM #5

Date: 02/28/2025

Project: 2025 Roofing Project for the
Merrillville Community School corporation
6701 Delaware Street
Merrillville, Indiana 46410
Architect's Project #24066

To: Prospective Bidders

This addendum forms a part of the Bid Documents and modifies the original Bid Documents dated 02-03-2025 as noted below. Acknowledge receipt of this addendum in the space on the Bid Form. Failure to do so may subject bidder to disqualification.

GENERAL

1. Bid Due date shall be rescheduled for Monday March 10th 2pm

SPECIFICATIONS

2. Remove and discard the Bid Form in the project manual and replace it with the attached **Revised Bid Form #2**

DRAWINGS

3. See attached Revised Drawing Sheet A 3.1.1 – Partial Roof Plan – MHS – Area A – This plan shows clouded and tagged revisions dated 02-28-2025
4. See attached Revised Drawing Sheet A 3.1.2 – Partial Roof Plan – MHS – Area B – This plan shows clouded and tagged revisions dated 02-28-2025
5. See attached Drawing Sheet A 3.1.4 – Roof Detail Plan – MHS - dated 02-28-2025. This drawing is being issued in its entirety.

Attached to Addendum #5

- **Revised Bid Form #2**
- Revised Drawing Sheet A 3.1.1 – Partial Roof Plan – MHS – Area A
- Revised Drawing Sheet A 3.1.2 – Partial Roof Plan – MHS – Area B
- Drawing Sheet A 3.1.4 – Roof Detail Plan – MHS

END OF ADDENDUM #5

SECTION 00 4100

REVISED BID FORM #2

To: Merrillville Community School Corporation
6701 Delaware Street
Merrillville, Indiana 46410

Submitted By: _____
(Company Name)

The undersigned, having familiarized themselves with the local conditions affecting the cost of the work and the Bid Documents, including the Project Manual and Construction Documents on file in the Office of the Architect, hereby propose to perform everything required to be performed and to provide and furnish all of the labor and materials, necessary tools, expendable equipment, and all utility and transportation services necessary to complete in a workmanlike manner all of the work in connection with the 2025 Roofing Projects for the Merrillville Community School Corporation 6701 Delaware Street Merrillville, Indiana 46410, all in accordance with the Bid Documents as prepared by the Architect CSK Architects, P.C., 6919 W. Lincoln Highway, Crown Point, Indiana 46307, including Addenda ____, ____, ____, ____ issued thereto for the sum stated below in accordance with the category designations listed:

BASE BID #1 – Reroofing – Merrillville High School – 30 Year Warranty

To include any and all work associated with the Reroofing – Merrillville High School – 30 Year Warranty all in accordance with the Bid Documents as Base Bid #1.

\$ _____

BASE BID #2 – Reroofing – Wood Elementary School

To include any and all work associated with the Reroofing – Wood Elementary School all in accordance with the Bid Documents as Base Bid #2.

\$ _____

BASE BID #3 – Reroofing – Miller Elementary School

To include any and all work associated with the Reroofing – Miller Elementary School all in accordance with the Bid Documents as Base Bid #3.

\$ _____

BASE BID #4 – Reroofing Combination Bid – Base Bids #2 & #3

To include any and all work associated with the Reroofing Combination Bid Base Bids #2 & #3 all in accordance with the Bid Documents as Base Bid #3.

\$ _____

ALTERNATE BID #1 – Reroofing – Merrillville High School – 30 Year Warranty

To include any and all work associated with providing new roofing in lieu of rehabilitating the existing roof in certain areas of the Project all in accordance with the Bid Documents as called for as Alternate Bid #1. State the amount to be added to or to be deducted from Base Bid #1.

\$ _____

ALTERNATE BID #2 – Reroofing – Merrillville High School – Installation of New Ladders

To include any and all work associated with the installation of the wall mounted ladders as detailed on the drawings all in accordance with the Bid Documents as called for as Alternate Bid #2.

\$ _____

ALTERNATE BID #3 – Reroofing – Merrillville High School – Removal of Abounded Equipment

To include any and all work associated with the removal of the abounded equipment & repairs for the roof as such indicated on the drawings all in accordance with the Bid Documents as called for as Alternate Bid #3.

\$ _____

UNIT PRICE #1 – Metal Roof Deck Replacement

Unit price per square foot to replace the existing metal deck in kind with 1 1/2" thick 22 gauge painted metal deck for Base Bid #1.

\$ _____ /Square Foot

UNIT PRICE #2 – Removal and Replacement of Additional Wet Areas of Roofing

State the unit price per square foot for the removal and replacement of additional wet areas of roofing with in-kind roofing and the fluid applied roofing for Base Bid #1.

\$ _____ /Square Foot

UNIT PRICE #3 – To Omit the Specified Removal and Replacement of Additional Wet Areas of Roofing

State the unit price per square foot to omit the specified removal and replacement of additional wet areas of roofing with in-kind roofing and the fluid applied roofing for Base Bid #1.

\$ _____ /Square Foot

UNIT PRICE #4 – TO REPLACE AN EXISTING ROOF DRAIN

State the unit price per square foot to replace an existing roof drain for Base Bid #1.

\$ _____ /Roof Drain

UNIT PRICE #5 – TO REPLACE AN EXISTING ROOF DRAIN DOME

State the unit price per square foot to replace an existing roof drain dome for Base Bid #1.

\$ _____ /Roof Drain Dome

In submitting this proposal, it is understood that the right is reserved by the Owner to reject any and all bids. It is agreed that this bid may not be withdrawn for a period of sixty (60) days from the opening thereof.

If awarded all of the work in either Combination Bid the undersigned agrees to substantially complete the work in ____ consecutive calendar days.

THIS BID PROPOSAL MUST BE ACCOMPANIED BY ALL REQUIRED BID DOCUMENTS AS SPECIFIED IN THE PROJECT MANUAL AND LISTED IN SECTION 00 11 53 BID AND POST BID SUBMISSION REQUIREMENTS.

Date: _____

Firm Name: _____

By: _____

Title: _____

Official Address: _____

END OF SECTION

X:\Merrillville Schools\24066 2025 Reroofing MHS & Shingles\Drawings\A300 Roof Plan - High School.dwg

AREA A: TOTAL ROOF AREA - 64,604 SQFT

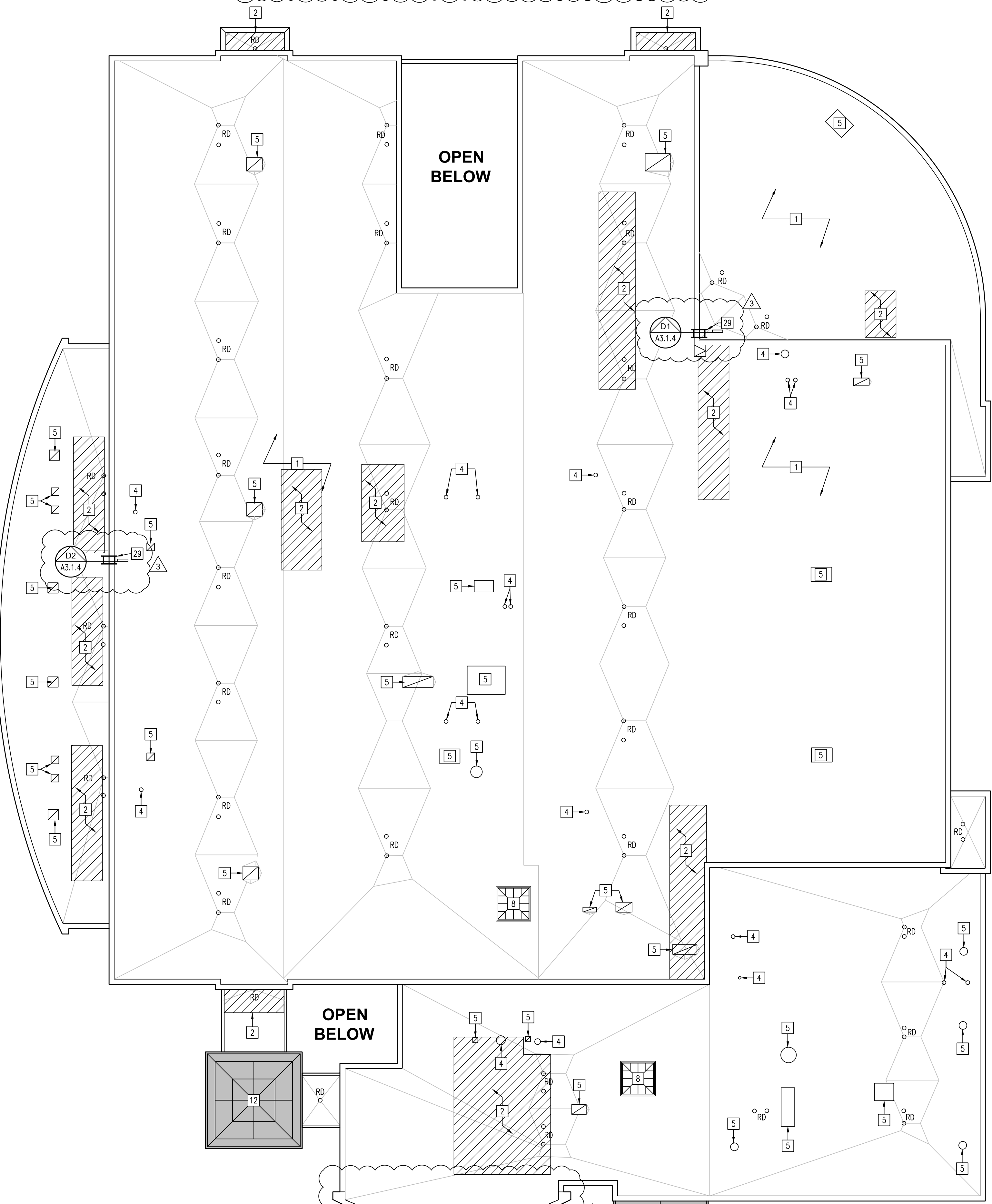

PARTIAL ROOF PLAN
AREA 'A'
SCALE: 1/16" = 1'-0"

GENERAL ROOFING NOTES:

1. THE BIDDERS ARE REQUIRED TO VISIT THE SITE AND TO VERIFY ALL EXISTING CONDITIONS.
2. THE SCOPE OF THE PROJECT INCLUDES REMOVING EXISTING ROOFING MATERIALS AS CALLED FOR BELOW.
3. ALL NEW ROOF DRAINS WILL BE EQUIPPED WITH ELECTRONIC ROOF DRAIN SENSORS.
4. THE SCOPE OF THE PROJECT REQUIRES ALL EXISTING ROOF AREAS THAT ARE CALLED TO RECEIVE THE REINFORCED FLUID-APPLIED ROOF MEMBRANE/REHABILITATION SYSTEM MUST BE CLEANED PER THE SPECIFICATIONS
5. ALL EXISTING SHEET METAL ROOF EDGES/COPINGS AT EXTERIOR MASONRY WALLS SHALL BE REUSED EXCEPT AS NOTED.
6. THE SCOPE OF THE PROJECT INCLUDES INSTALLING NEW CODE COMPLIANT WARRANTABLE ROOF SYSTEM
7. CONTRACTORS SHALL REFER TO TREMCO'S ROOF DIAGNOSTIC SURVEYS IN THE PROJECT MANUAL FOR EACH SCHOOL PREPARED FOR THE MERRILLVILLE COMMUNITY SCHOOLS FOR THE FOLLOWING:
 - A. EXISTING ROOFING MATERIAL MAKE-UP AND THICKNESSES.
 - B. AREAS OF THE ROOF THAT HAS WET INSULATION AND REQUIRE FULL DEPTH REMOVAL, REPLACEMENT AND REINFORCED FLUID-APPLIED ROOF MEMBRANE/REHABILITATION SYSTEM
 - C. AREAS OF THE ROOFS THAT REQUIRED A FULL DEPTH REMOVAL AND AN ENTIRELY NEW ROOF.
8. THE ROOF CORE SAMPLES LOCATION ASSOCIATED WITH TREMCO REPORT ARE MARKED ON THE HIGH SCHOOL'S ROOF PLANS AS:
9. PROVIDE CAULKING FOR WALL/REGLET FLASHING AT ALL LOCATION WITHIN AREA OF WORK FOR WOOD ELEMENTARY SCHOOL.

ROOF LEGEND

- ASPHALT FIBERGLASS SHINGLE
- ICE DAM PROTECTION (OVERLAPPING EACH ROW 6" MIN.)
- RIDGE VENT
- RIDGE CAP SHINGLES

KEYED ROOFING NOTES:

- 1 EXISTING ROOF SHALL RECEIVE THE REINFORCED FLUID-APPLIED ROOF MEMBRANE/REHABILITATION SYSTEM. BASE BID #1: SHALL BE THE 30 YEAR WARRANTY REHABILITATION SYSTEM.
- 2 REMOVE EXISTING ROOFING AND WET INSULATION DOWN TO THE EXISTING DECK, REPLACE INSULATION IN KIND AND INSTALL LIQUID APPLIED ROOF REHABILITATION SYSTEM PER KEY NOTE #1.
- 3 REMOVE EXISTING SHINGLES & DRIP EDGE, & INSTALL NEW ASPHALT FIBERGLASS SINGLES, UNDERLAYMENT, & ICE DAM PROTECTION ON ROOF SHEATHING. INSTALL NEW METAL DRIP EDGE & PROVIDE WALL FLASHING WHERE ROOF ENDS INTO A WALL - TO MATCH EXISTING.
- 4 EXISTING CONDUIT, PIPE, OR VENTS. PROVIDE NEW FLASHING.
- 5 EXISTING CURB SHALL REMAIN PROVIDE NEW FLASHING
- 6 EXISTING METAL FLUE SHALL REMAIN PROVIDE NEW FLASHING.
- 7 EXISTING ROOF ACCESS LADDER. PROVIDE TEXTURE COATING OR A MATT/SHEET AT THE TOP & BOTTOMS OF THE EXISTING LADDERS THAT ARE WITHIN THE PROJECT AREAS
- 8 EXISTING SKYLIGHT - SHALL REMAIN & PROVIDE NEW FLASHING.
- 9 INSTALL NEW RIDGE CAP SHINGLES
- 10 INSTALL NEW SHINGLE RIDGE VENT
- 11 EXISTING GUTTERS & DOWNSPOUTS SHALL REMAIN.
- 12 EXISTING METAL ROOF SHALL REMAIN.
- 13 EXISTING MASONRY CHIMNEY SHALL REMAIN. PROVIDE FLASHING AT BASE.
- 14 REMOVE ABANDON BUILDING WEATHER VANE COMPLETELY.
- 15 PROVIDE NEW CAST IRON BASKETS COVERS FOR THE EXISTING DRAIN.
- 16 EXISTING ROOF HATCH.
- 17 REMOVE EXISTING SHINGLES, PLYWOOD SHEATHING, & WET INSULATION DOWN TO THE EXISTING ROOF DECK. INSTALL NEW ROOF STRUCTURE REFER TO PARTIAL ROOF PLAN INDICATED BY DETAIL MARKER & INSTALL NEW SHINGLES ROOF SYSTEM PER KEY NOTE #3.
- 18 ALTERNATE BID #1 HIGH SCHOOL ONLY: REMOVE EXISTING ROOFING SYSTEM. INSTALL A NEW 1/2" DENSDECK ON EXISTING INSULATION AND INSTALL NEW 30 YEAR WARRANTY RHINO BOND PVC ROOFING; PVC ROOF SHALL BE TEXTURE GRAY. FASTEN ROOF SYSTEM DOWN TO EXISTING METAL DECKING.
- 19 REMOVE, SALVAGE & REINSTALL EXISTING GUTTER.
- 20 REMOVE EXISTING ROOF, & SHEATHING & INSTALL NEW ROOF PER KEY NOTE #3 AND INSTALL NEW SHEATHING MATCH EXISTING.
- 21 EXISTING METAL COPING - REMOVE EXISTING CAULKING AT SEAMS AND INSTALL NEW EPDM PATCH ON ALL SEAMS.
- 22 REMOVE EPDM MEMBRANE & INSTALL NEW FLASHING - REFER TO DETAIL D1 ON SHEET A 3.3.1
- 23 REMOVE & INSTALL NEW CAP FLASHING - MATCH EXISTING COLOR
- 24 REMOVE EXISTING ALUMINUM PANEL SIDING & INSTALL NEW - REFER TO ELEVATION ON SHEET A-3.3.1.
- 25 ROOF MEMBRANE ATTACHED TO THE PARAPET WALL SHALL BE REMOVED AND RE-ADHERED TO THE WALL TO REMOVE AIR BUBBLES.
- 26 EXISTING MECHANICAL CURB SHALL REMAIN. REMOVE EXISTING DAMAGED MECHANICAL HOOD & INSTALL NEW - SIZES NOTED ON DRAWINGS VERIFY IN FIELD.
- 27 EXISTING COPPING SHALL BE REFASTEN TOGETHER WITH ALUMINUM RWETS.
- 28 EXISTING MECHANICAL STRUCTURAL SHALL REMAIN. EXISTING ROOF ONTOP OF STRUCTURE SHALL RECEIVE THE REINFORCED FLUID-APPLIED ROOF MEMBRANE/REHABILITATION SYSTEM. BASE BID #1: SHALL BE THE 30 YEAR WARRANTY REHABILITATION SYSTEM.
- 29 ALTERNATE BID #2: INSTALL NEW WALL MOUNTED ROOF ACCESS LADDER. PROVIDE TEXTURE COATING OR A MATT/SHEET AT THE TOP & BOTTOMS OF THE NEW LADDERS.
- 30 ALTERNATE BID #3: REMOVE ABANDONED DUST COLLECTOR & CURB COMPLETELY. INSTALL NEW METAL DECKING OVER OPENING. METAL DECKING WILL NEED TO SPAN FROM TRUSS TO TRUSS ROUGHLY ±48" O.C. V.I.F. INSTALL NEW INSULATION TO MATCH EXISTING & NEW ROOF MEMBRANE.
- 31 ALTERNATE BID #3: REMOVE EXISTING EXHAUST STACK COMPLETELY. INSTALL NEW METAL DECKING OVER OPENING. METAL DECKING WILL NEED TO SPAN FROM TRUSS TO TRUSS ROUGHLY ±48" O.C. V.I.F. INSTALL NEW INSULATION TO MATCH EXISTING & NEW ROOF MEMBRANE.

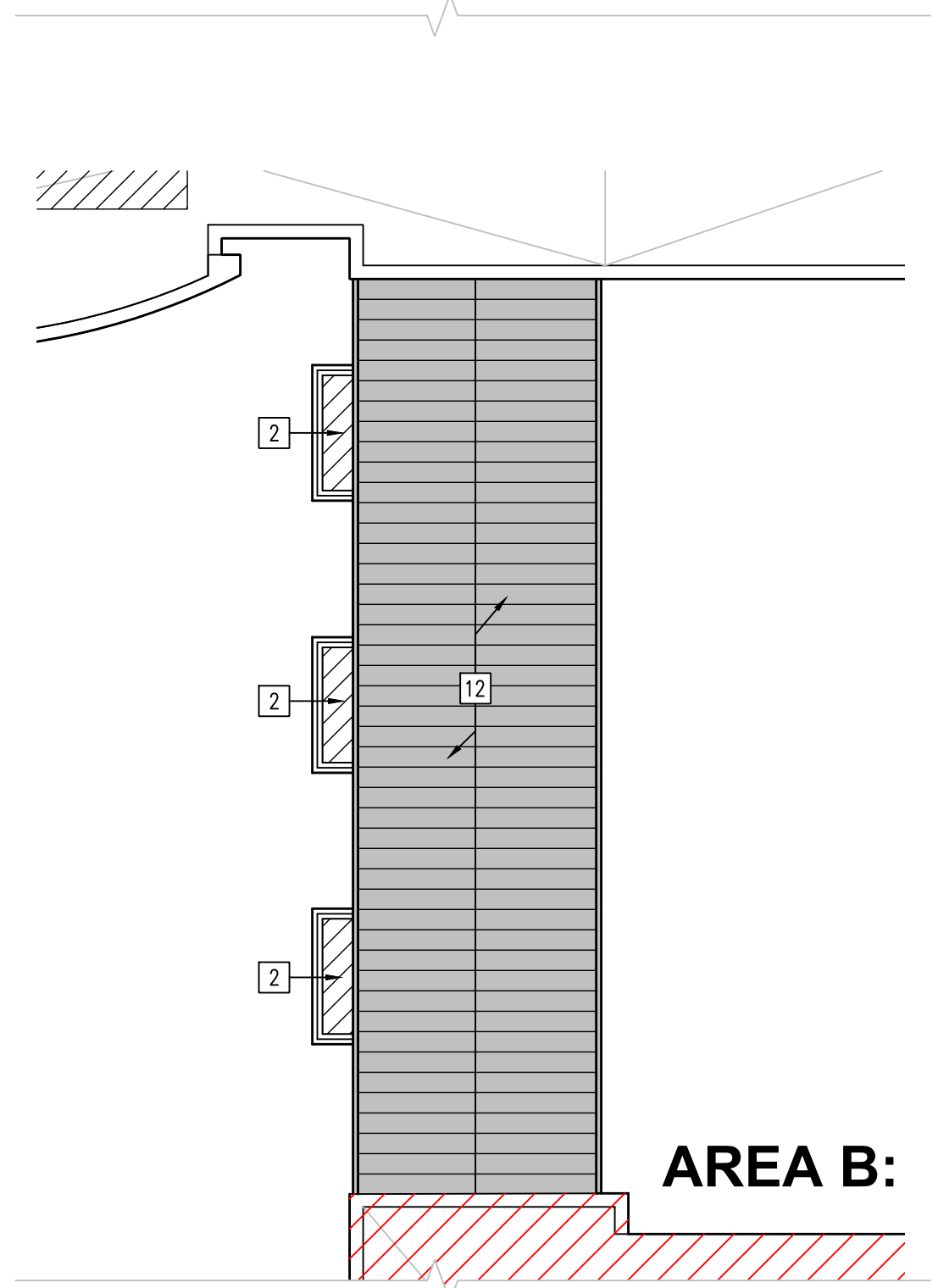

AREA B:

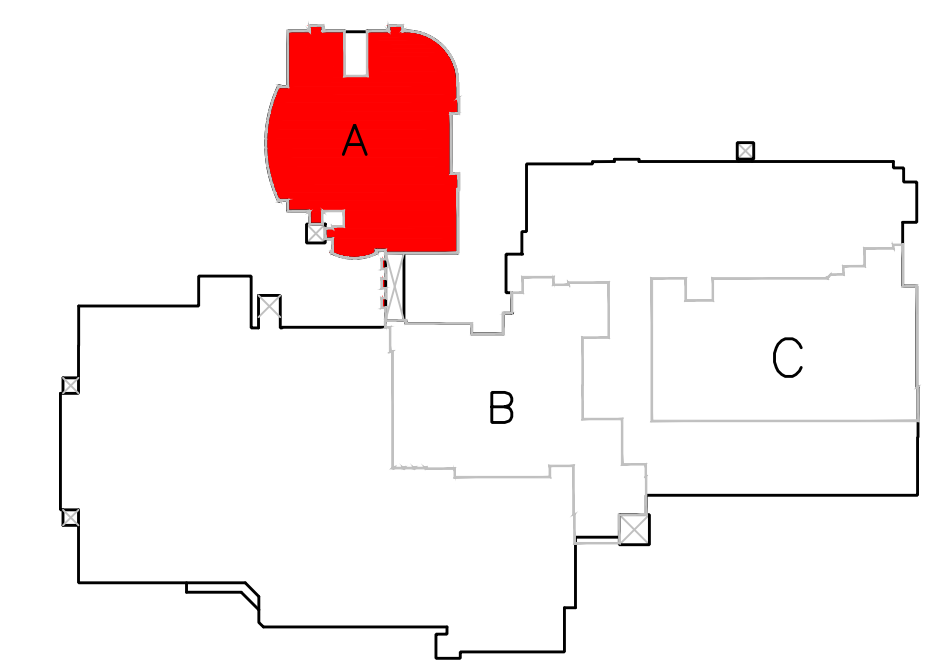

ROOF KEY PLAN
MERRILLVILLE HIGH SCHOOL SCALE: NTS

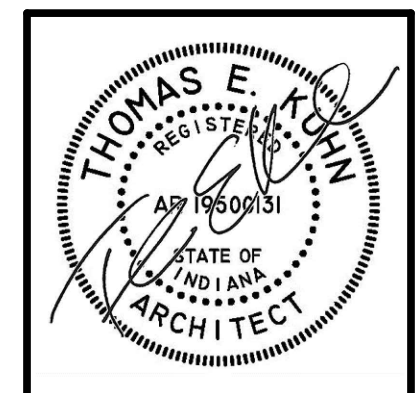

DATE
02/03/2025
02/05/2025 - ADD #1
02/14/2025 - ADD #3
02/28/2025 - ADD #5

2025 MERRILLVILLE ROOFING PROJECT FOR THE
MERRILLVILLE COMMUNITY SCHOOL CORPORATION
6701 DELAWARE STREET
MERRILLVILLE, INDIANA 46410

CSK ARCHITECTS, P.C.
THOMAS E. KUHN, AIA, CSI, ALA - SCOTT GOODWIN AIA, ALA, LEED AP - JEREMY S. GILBERT CSI
6919 W. LINCOLN HIGHWAY
CROWN POINT, IN 46307
www.cskarchitects.com
219-322-5950

24066

SHEET
A
3.1.1

MERRILLVILLE HIGH SCHOOL

X:\Merrillville Schools\24066 2025 Reroofing MHS & Shingles\Drawings\A300 Roof Plan - High School.dwg

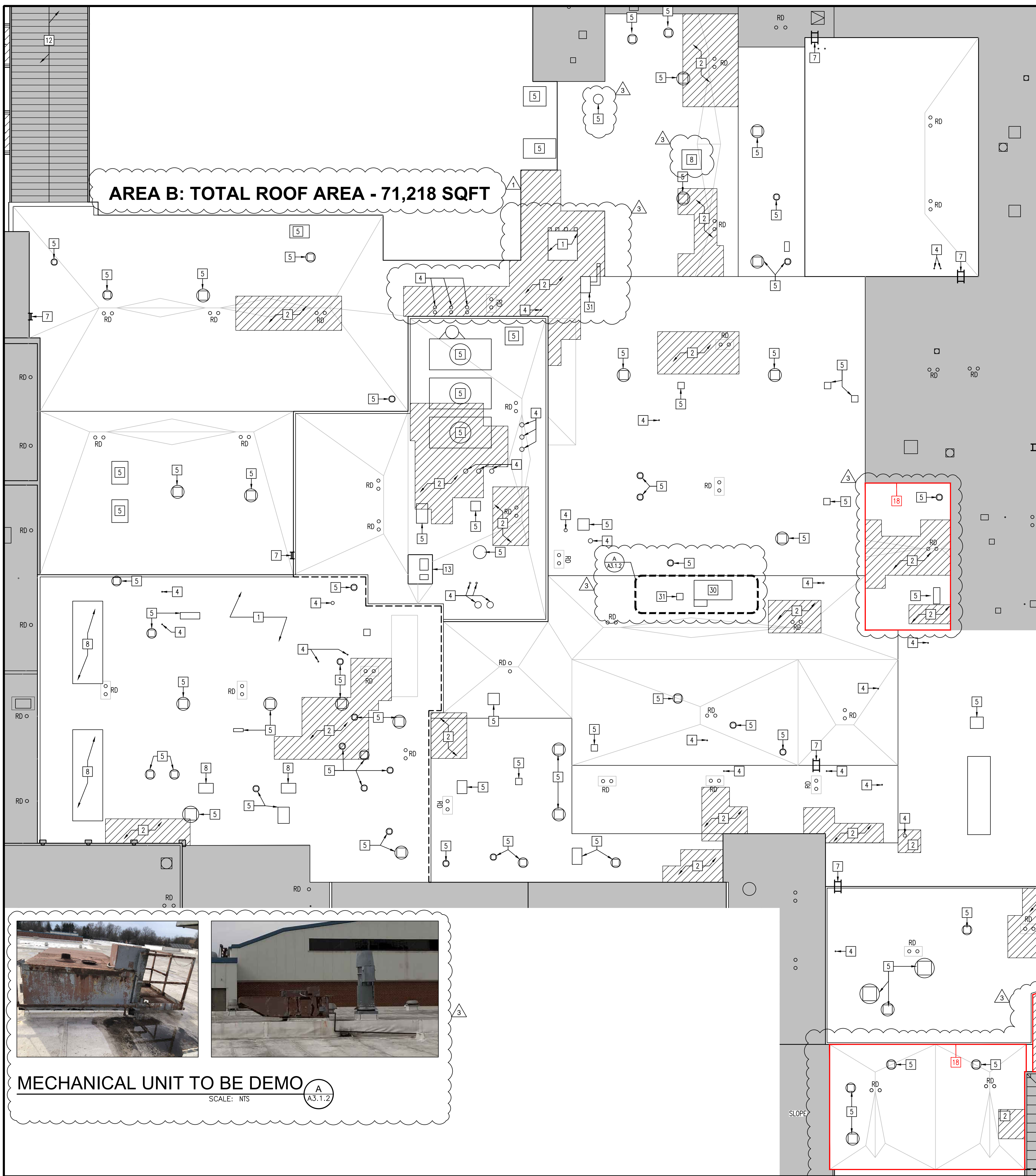

AREA B: TOTAL ROOF AREA - 71,218 SQFT

GENERAL ROOFING NOTES:

- 1. THE BIDDERS ARE REQUIRED TO VISIT THE SITE AND TO VERIFY ALL EXISTING CONDITIONS.
2. THE SCOPE OF THE PROJECT INCLUDES REMOVING EXISTING ROOFING MATERIALS AS CALLED FOR BELOW.
3. ALL NEW ROOF DRAINS WILL BE EQUIPPED WITH ELECTRONIC ROOF DRAIN SENSORS.
4. THE SCOPE OF THE PROJECT REQUIRES ALL EXISTING ROOF AREAS THAT ARE CALLED TO RECEIVE THE REINFORCED FLUID-APPLIED ROOF MEMBRANE/REHABILITATION SYSTEM MUST BE CLEANED PER THE SPECIFICATIONS
5. ALL EXISTING SHEET METAL ROOF EDGES/COPINGS AT EXTERIOR MASONRY WALLS SHALL BE REUSED EXCEPT AS NOTED.
6. THE SCOPE OF THE PROJECT INCLUDES INSTALLING NEW CODE COMPLIANT WARRANTABLE ROOF SYSTEM
7. CONTRACTORS SHALL REFER TO TREMCO'S ROOF DIAGNOSTIC SURVEYS IN THE PROJECT MANUAL FOR EACH SCHOOL PREPARED FOR THE MERRILLVILLE COMMUNITY SCHOOLS FOR THE FOLLOWING:
A. EXISTING ROOFING MATERIAL MAKE-UP AND THICKNESSES.
B. AREAS OF THE ROOF THAT HAS WET INSULATION AND REQUIRE FULL DEPTH REMOVAL, REPLACEMENT AND REINFORCED FLUID-APPLIED ROOF MEMBRANE/REHABILITATION SYSTEM
C. AREAS OF THE ROOFS THAT REQUIRED A FULL DEPTH REMOVAL AND AN ENTIRELY NEW ROOF.
8. THE ROOF CORE SAMPLES LOCATION ASSOCIATED WITH TREMCO REPORT ARE MARKED ON THE HIGH SCHOOL'S ROOF PLANS AS:
9. PROVIDE CAULKING FOR WALL/REGLET FLASHING AT ALL LOCATION WITHIN AREA OF WORK FOR WOOD ELEMENTARY SCHOOL.

ROOF LEGEND

- ASPHALT FIBERGLASS SHINGLE
ICE DAM PROTECTION (OVERLAPPING EACH ROW 6" MIN.)
RIDGE VENT
RIDGE CAP SHINGLES

PARTIAL ROOF PLAN AREA 'B'

SCALE: 1/16" = 1'-0"

KEYED ROOFING NOTES:

- 1 EXISTING ROOF SHALL RECEIVE THE REINFORCED FLUID-APPLIED ROOF MEMBRANE/REHABILITATION SYSTEM. BASE BID #1: SHALL BE THE 30 YEAR WARRANTY REHABILITATION SYSTEM.
2 REMOVE EXISTING ROOFING AND WET INSULATION DOWN TO THE EXISTING DECK, REPLACE INSULATION IN KIND AND INSTALL LIQUID APPLIED ROOF REHABILITATION SYSTEM PER KEY NOTE #1.
3 REMOVE EXISTING SHINGLES & DRIP EDGE, & INSTALL NEW ASPHALT FIBERGLASS SINGLES, UNDERLAYMENT, & ICE DAM PROTECTION ON ROOF SHEATHING. INSTALL NEW METAL DRIP EDGE & PROVIDE WALL FLASHING WHERE ROOF ENDS INTO A WALL - TO MATCH EXISTING.
4 EXISTING CONDUIT, PIPE, OR VENTS. PROVIDE NEW FLASHING.
5 EXISTING CURB SHALL REMAIN PROVIDE NEW FLASHING
6 EXISTING METAL FLUE SHALL REMAIN PROVIDE NEW FLASHING.
7 EXISTING ROOF ACCESS LADDER. PROVIDE TEXTURE COATING OR A MATT/SHEET AT THE TOP & BOTTOMS OF THE EXISTING LADDERS THAT ARE WITHIN THE PROJECT AREAS
8 EXISTING STYKLIGHT - SHALL REMAIN & PROVIDE NEW FLASHING.
9 INSTALL NEW RIDGE CAP SHINGLES
10 INSTALL NEW SHINGLE RIDGE VENT
11 EXISTING GUTTERS & DOWNSPOUTS SHALL REMAIN.
12 EXISTING METAL ROOF SHALL REMAIN.
13 EXISTING MASONRY CHIMNEY SHALL REMAIN. PROVIDE FLASHING AT BASE.
14 REMOVE ABANDON BUILDING WEATHER VANE COMPLETELY.
15 PROVIDE NEW CAST IRON BASKETS COVERS FOR THE EXISTING DRAIN.
16 EXISTING ROOF HATCH.
17 REMOVE EXISTING SHINGLES, PLYWOOD SHEATHING, & WET INSULATION DOWN TO THE EXISTING ROOF DECK. INSTALL NEW ROOF STRUCTURE REFER TO PARTIAL ROOF PLAN INDICATED BY DETAIL MARKER & INSTALL NEW SHINGLES ROOF SYSTEM PER KEY NOTE #3.
18 ALTERNATE BID #1 HIGH SCHOOL ONLY: REMOVE EXISTING ROOFING SYSTEM. INSTALL A NEW 3/4" DENSDECK ON EXISTING INSULATION AND INSTALL NEW 30 YEAR WARRANTY RHINO BOND PVC ROOFING; PVC ROOF SHALL BE TEXTURE GRAY. FASTEN ROOF SYSTEM DOWN TO EXISTING METAL DECKING.
19 REMOVE, SALVAGE & REINSTALL EXISTING GUTTER.
20 REMOVE EXISTING ROOF, & SHEATHING & INSTALL NEW ROOF PER KEY NOTE #3 AND INSTALL NEW SHEATHING MATCH EXISTING
21 EXISTING METAL COPING - REMOVE EXISTING CAULKING AT SEAMS AND INSTALL NEW EPDM PATCH ON ALL SEAMS.
22 REMOVE EPDM MEMBRANE & INSTALL NEW FLASHING - REFER TO DETAIL D1 ON SHEET A 3.3.1
23 REMOVE & INSTALL NEW CAP FLASHING - MATCH EXISTING COLOR
24 REMOVE EXISTING ALUMINUM PANEL SIDING & INSTALL NEW - REFER TO ELEVATION 6M SHEET A 3.2.1.
25 ROOF MEMBRANE ATTACHED TO THE PARAPET WALL SHALL BE REMOVED AND RE-ADHERED TO THE WALL TO REMOVE AIR BUBBLES.
26 EXISTING MECHANICAL CURB SHALL REMAIN. REMOVE EXISTING DAMAGED MECHANICAL HOOD & INSTALL NEW - SIZES NOTED ON DRAWINGS VERIFY IN FIELD.
27 EXISTING COPPING SHALL BE REFASTEN TOGETHER WITH ALUMINUM RIVETS.
28 EXISTING MECHANICAL STRUCTURAL SHALL REMAIN. EXISTING ROOF ONTOP OF STRUCTURE SHALL RECEIVE THE REINFORCED FLUID-APPLIED ROOF MEMBRANE/REHABILITATION SYSTEM. BASE BID #1: SHALL BE THE 30 YEAR WARRANTY REHABILITATION SYSTEM.
29 ALTERNATE BID #2: INSTALL NEW WALL MOUNTED ROOF ACCESS LADDER. PROVIDE TEXTURE COATING OR A MATT/SHEET AT THE TOP & BOTTOMS OF THE NEW LADDERS.
30 ALTERNATE BID #3: REMOVE ABANDONED DUST COLLECTOR & CURB COMPLETELY. INSTALL NEW METAL DECKING OVER OPENING. METAL DECKING WILL NEED TO SPAN FROM TRUSS TO TRUSS ROUGHLY +/-48" O.C. V.I.F. INSTALL NEW INSULATION TO MATCH EXISTING & NEW ROOF MEMBRANE.
31 ALTERNATE BID #3: REMOVE EXISTING EXHAUST STACK COMPLETELY. INSTALL NEW METAL DECKING OVER OPENING. METAL DECKING WILL NEED TO SPAN FROM TRUSS TO TRUSS ROUGHLY +/-48" O.C. V.I.F. INSTALL NEW INSULATION TO MATCH EXISTING & NEW ROOF MEMBRANE.

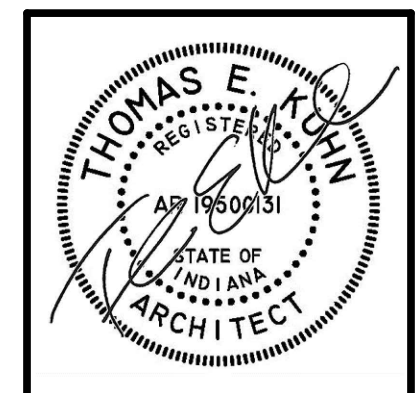

DATE 02/03/2025
02/05/2025 - ADD #1
02/14/2025 - ADD #3
02/28/2025 - ADD #5

2025 MERRILLVILLE ROOFING PROJECT FOR THE MERRILLVILLE COMMUNITY SCHOOL CORPORATION
6701 DELAWARE STREET
MERRILLVILLE, INDIANA 46410

CSK ARCHITECTS, P.C.
THOMAS E. KUHN, AIA, CSI, AIA, ALA - SCOTT GOODWIN AIA, ALA, LEED AP - JEREMY S. GILBERT CSI
6919 W. LINCOLN HIGHWAY
CROWN POINT, IN 46307
www.cskarchitects.com
219-322-5950



MECHANICAL UNIT TO BE DEMO
SCALE: NTS

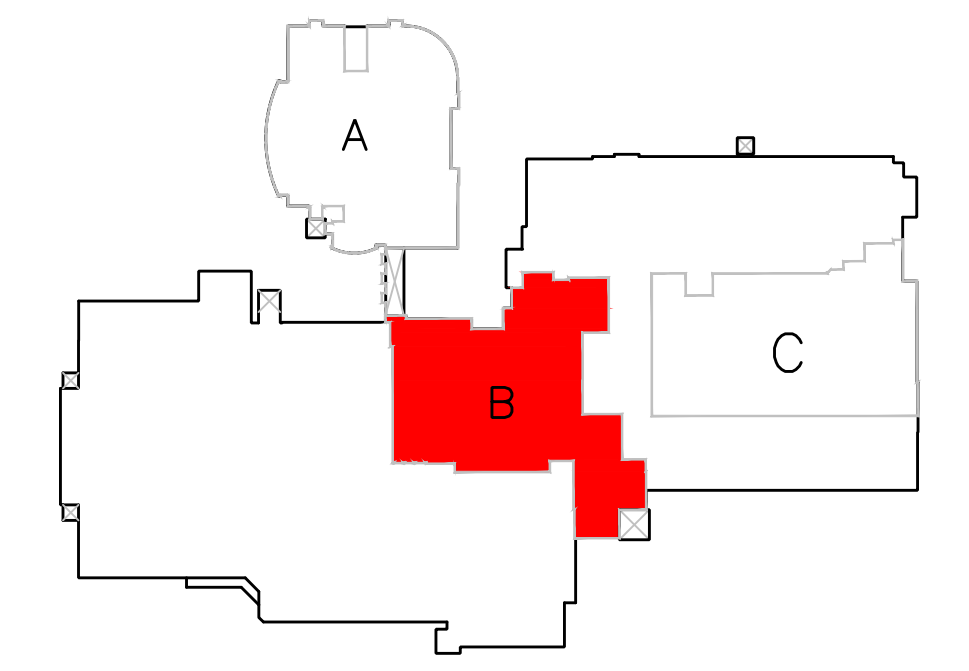

ROOF KEY PLAN
MERRILLVILLE HIGH SCHOOL SCALE: NTS

24066

SHEET A 3.1.2

MERRILLVILLE HIGH SCHOOL

X:\Merrillville Schools\24066 2025 Reroofing MHS & Shingles\Drawings\A300 Roof Plan - High School.dwg

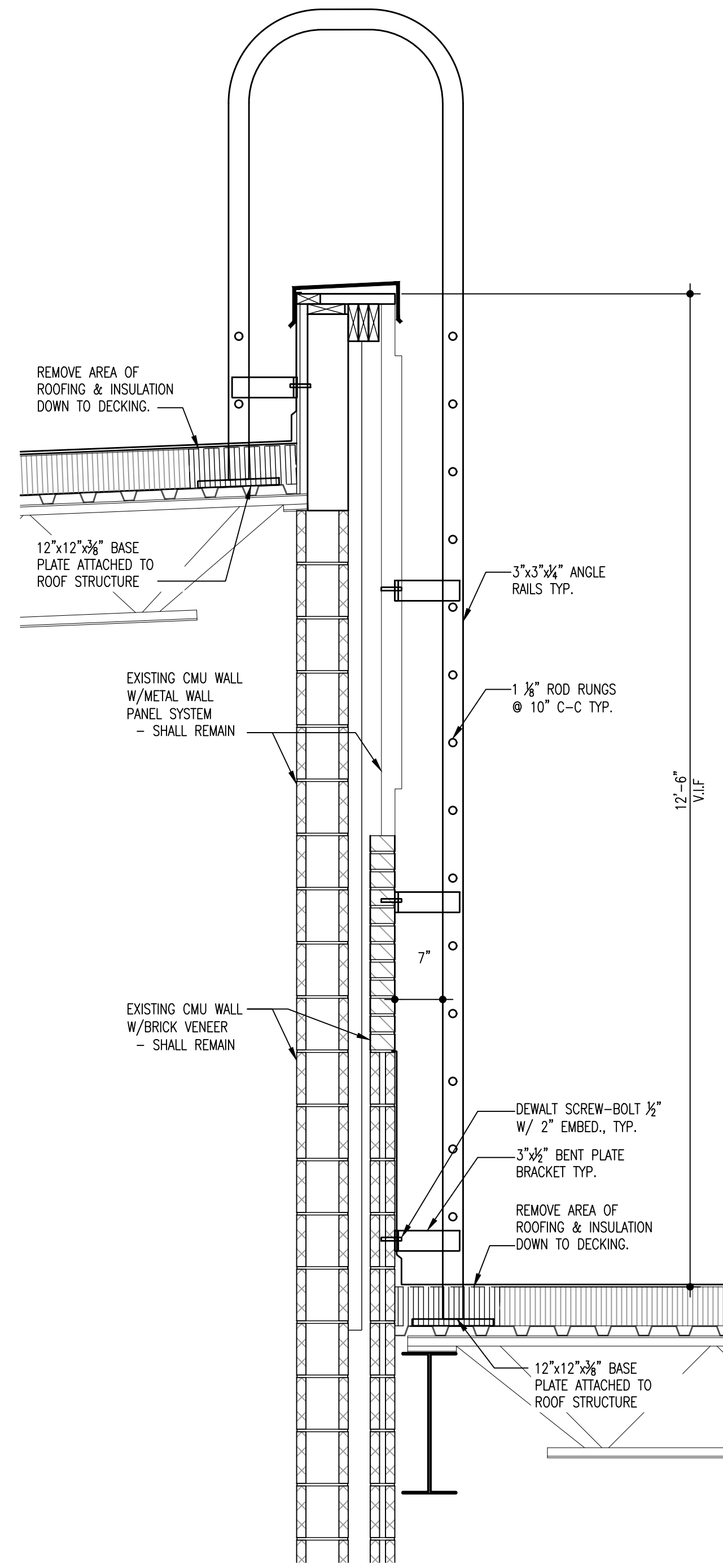

LADDER DETAIL

SCALE: 3/4" = 1'-0"

1
A3.1.1

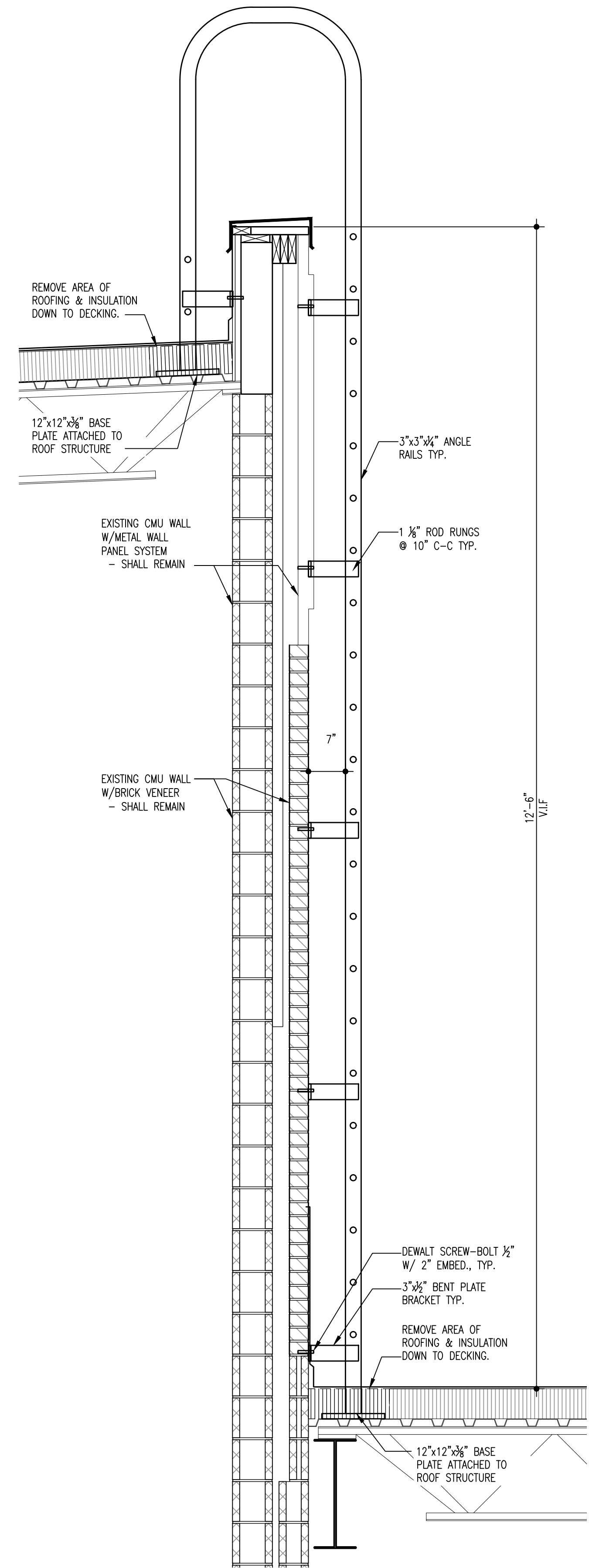

LADDER DETAIL

SCALE: 3/4" = 1'-0"

2
A3.1.1

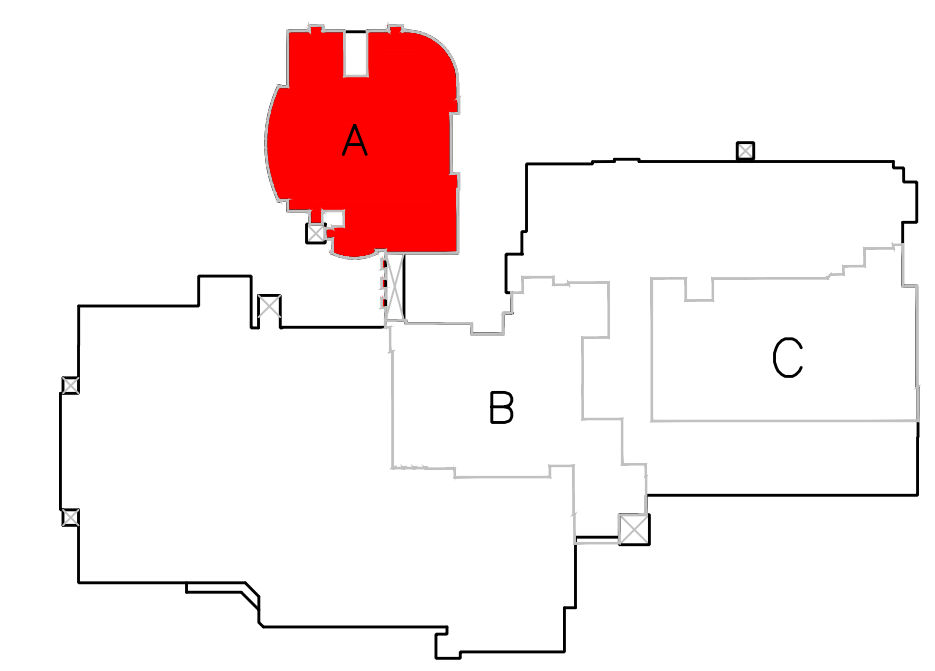

ROOF KEY PLAN

MERRILLVILLE HIGH SCHOOL SCALE: NTS

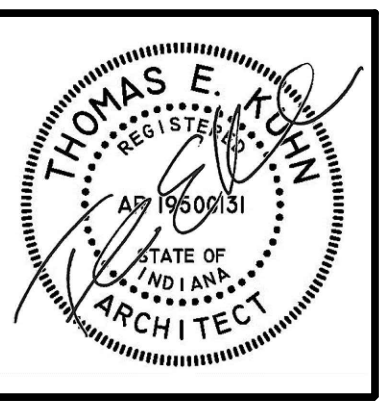
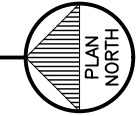

DATE
 02/03/2025
 02/05/2025 - ADD #1
 02/14/2025 - ADD #3
 02/28/2025 - ADD #5

2025 MERRILLVILLE ROOFING PROJECT FOR THE
 MERRILLVILLE COMMUNITY SCHOOL CORPORATION
 6701 DELAWARE STREET
 MERRILLVILLE, INDIANA 46410

CSK ARCHITECTS, P.C.
 THOMAS E. KUHN, AIA, CSI, AIA - SCOTT GOODWIN AIA, AIA, LEED AP - JEREMY S. GILBERT CSI
 6919 W. LINCOLN HIGHWAY
 CROWN POINT, IN 46307
 219-322-5950
 www.cskarchitects.com

24066

SHEET
A
3.1.1

MERRILLVILLE HIGH SCHOOL