

J.C. Broderick & Associates, Inc.

Environmental / Construction Consulting & Testing



January 16, 2025

Mr. Severino Fasulo
Syosset Central School District
99 Pell Lane
Syosset, New York 11791

Re: Perform Professional Consulting and Environmental Sampling and Testing for Radon in Air at:

**Site: Baylis Elementary School
580 Woodbury Road
Plainview, New York 11803
Site Visits: December 16 & 19, 2024**

JCB#: 24-59116

Dear Mr. Fasulo:

J.C. Broderick and Associates, Inc. (JCB) was retained by the Syosset Central School District (SCSD) to perform environmental sampling for indoor radon gas within the above referenced school building. The radon sampling was performed by experienced JCB representatives on the above referenced dates following the American National Standards Institute (ANSI)/American Association of Radon Scientists and Technologists (AARST) *Protocol for Conducting Measurements of Radon and Radon Decay Products in Multifamily, School, Commercial and Mixed-Use Buildings* MA-MFLB-2023, effective date December 1, 2023, guidance document. The site visits consisted of the following:

- Collection of radon in air samples from 42 locations within occupied rooms in contact with the ground at the above referenced school building.
- Submission of designated samples to an independent New York State Department of Health (NYSDOH) Environmental Laboratory Approval Program (ELAP) certified laboratory for radon in air analysis.
- Review and compare the laboratory results to the ANSI/AARST *Protocol for Conducting Measurements of Radon and Radon Decay Products in Multifamily, School, Commercial and Mixed-Use Buildings* MA-MFLB-2023, effective date December 1, 2023.

Summary of Sample Collection, Field Screening and Sample Submission

The following section summarizes the environmental sampling performed. Please refer to attachments located at the end of this report for additional details.

- On December 16, 2024, a total of 50 short-term radon test kits were deployed in 42 strategic occupied spaces located throughout the above referenced school building. The test kits remained within the given space for a period of three (3) days. A select number of samples served as a duplicate or remained closed as a field blank for QA/QC compliance.

January 16, 2025

Mr. Severino Fasulo of Syosset CSD

Perform Professional Consulting and Environmental Sampling and Testing for Radon in Air at:

Baylis Elementary School

580 Woodbury Rd., Plainview, NY 11803

Site Visits: December 16 & 19, 2024

JCB#: 24-59116

- The area around each test kit location was field screened for the presence of total volatile organic compounds utilizing a MiniRAE 3000 Portable photo-ionization detector (PID). Technical data pertaining to the MiniRAE 3000 Portable PID is available upon request.
- On December 19, 2024, a total of 50 short-term radon test kits were retrieved, sealed and assigned individual identification numbers. Chain of custody documents were prepared, and the samples were then delivered to an independent New York State Department of Health (NYSDOH) Environmental Laboratory Approval Program (ELAP) accredited radon laboratory for analysis. Prior to sample retrieval, temperature and humidity were recorded utilizing a OXV Thermo-Hygrometer meter.

Quality Assurance and Quality Control (QA/QC) Procedures

To ensure that measurement results are reliable, JCB performed duplicate and laboratory blank sampling in eight (8) selected spaces. JCB representatives maintained a radon sampling chain of custody used to track samples from sampling point to analysis which summarized the following:

- Sample identification;
- Test Kit ID number;
- Device ID number;
- Sampling beginning date and time;
- Sampling ending date and time;
- Temperature, °F;
- Humidity, %.

Summary of Laboratory Analysis

Please refer to the tables located in Attachment #1 for a summary of submitted samples and laboratory analysis results.

- The laboratory analytical results for the radon in air samples were reviewed and compared to the ANSI/AARST Protocol for Conducting Measurements of Radon and Radon Decay Products in Multifamily, School, Commercial and Mixed-Use Buildings MA-MFLB-2023, effective date December 1, 2023, which establishes a radon in air action concentration level of 4.0 pCi/L.
 - The laboratory analysis results from the Radon in Air samples submitted **did not** reveal any elevated concentrations of radon exceeding 4.0 pCi/L, the referenced action level. The highest recorded radon concentration was in space 2035 at a concentration of 1.6 pCi/L, well below the 4.0 pCi/L action level.
- EMSL Analytical Inc. (EMSL) of Cinnaminson, New Jersey provided laboratory analytical services. Copies of EMSL's NYSDOH certifications are available upon request.

January 16, 2025

Mr. Severino Fasulo of Syosset CSD

Perform Professional Consulting and Environmental Sampling and Testing for Radon in Air at:

Baylis Elementary School

580 Woodbury Rd., Plainview, NY 11803

Site Visits: December 16 & 19, 2024

JCB#: 24-59116

Conclusions and Recommendations

Based upon the results of the laboratory analysis, the USEPA decision matrix does not recommend any additional investigation pertaining to radon in air associated with the above referenced school building.

The ANSI/AARST guidance document recommends that responsible care requires repeating initial testing procedures for all building(s) at least every 5 years and in conjunction with any sale of a building.

Radon testing should also be conducted when any of the following circumstances occur:

- a new addition is constructed or alterations for building reconfiguration or rehabilitation occur;
- a ground contact area not previously tested is occupied, or a building is newly occupied;
- heating or cooling systems are significantly altered, resulting in changes to air pressures or pressure relationships;
- ventilation is significantly altered by extensive weatherization, changes to mechanical systems or comparable procedures;
- significant openings to soil occur due to:
 - groundwater or slab surface water control systems that are altered or added (e.g., sumps, perimeter drain tile, shower/tub retrofits, etc.) or,
 - natural settlement causing major cracks to develop;
- earthquakes or construction blasting, fracking or formation of sink holes nearby; or
- a mitigation system is altered, modified, or repaired.

Should testing indicate concentrations that meet or exceed the action level, conduct evaluations, corrections and further testing until radon concentrations have been mitigated to below the action level.

However, to monitor for possible changes in indoor quality, JCB does recommend that the current annual testing schedule for radon in air within the school building continue.

Please refer to the attached laboratory reports to be included in the District's Radon Measurement Plan.

1. Tables
2. Figures
3. Field Photograph Logs
4. Laboratory Analysis Reports

If there are any questions or if more information is needed, please feel free to contact our office.

Sincerely,

J. C. Broderick & Associates, Inc.



Steven Muller, P.G.

Director, Subsurface Division

Attachment #1 Tables

Table 1. Summary of Radon Samples Submitted for Laboratory Analysis

Sample ID#	AHERA Space ID	Sample Start Date	Sample End Date	Description of Sample	Analysis Method
575311	2005	12/16/2025	12/19/2025	File Cabinet	Radon in Air
575472 (Dup)		12/16/2025	12/19/2025		Radon in Air
575344	2007	12/16/2025	12/19/2025	File Cabinet	Radon in Air
575248	2006	12/16/2025	12/19/2025	Cabinet	Radon in Air
575228	2008	12/16/2025	12/19/2025	Cabinet	Not Tested
575195B (B)		12/16/2025	12/19/2025		Not Tested
575357	2009	12/16/2025	12/19/2025	Cabinet	Radon in Air
575310	2011	12/16/2025	12/19/2025	File Cabinet	Radon in Air
575275	2010	12/16/2025	12/19/2025	Cabinet	Radon in Air
575287	2012	12/16/2025	12/19/2025	Bookshelf	Radon in Air
575326	2013	12/16/2025	12/19/2025	Speaker	Radon in Air
575196	2015	12/16/2025	12/19/2025	Bookshelf	Radon in Air
575355	2020	12/16/2025	12/19/2025	Cabinet	Radon in Air
575281	2021	12/16/2025	12/19/2025	Shelf	Radon in Air
575259	2022	12/16/2025	12/19/2025	Electrical Box	Radon in Air
575431	2026	12/16/2025	12/19/2025	Speaker	Radon in Air
575451 (Dup)		12/16/2025	12/19/2025		Radon in Air
575401	2029	12/16/2025	12/19/2025	Speaker	Radon in Air
575229B (B)		12/16/2025	12/19/2025		Radon in Air
575426	2032	12/16/2025	12/19/2025	Speaker	Radon in Air
575367	2035	12/16/2025	12/19/2025	Bookshelf	Radon in Air
575352	B6	12/16/2025	12/19/2025	Cabinet	Radon in Air
575320B (B)		12/16/2025	12/19/2025		Radon in Air
575413	B9	12/16/2025	12/19/2025	Bookshelf	Radon in Air
575243	2038	12/16/2025	12/19/2025	Bookshelf	Radon in Air
275366	2041	12/16/2025	12/19/2025	Vending Machine	Radon in Air
575399	2044	12/16/2025	12/19/2025	Bookshelf	Radon in Air
575339	1055	12/16/2025	12/19/2025	Cabinet	Radon in Air
575215B (B)		12/16/2025	12/19/2025		Radon in Air
575233	2050	12/16/2025	12/19/2025	Cabinet	Radon in Air
575179	2053	12/16/2025	12/19/2025	Cabinet	Radon in Air
575340	2046	12/16/2025	12/19/2025	Bookshelf	Radon in Air
575266	2047	12/16/2025	12/19/2025	TV Stand	Radon in Air
575338	2048	12/16/2025	12/19/2025	Bookshelf	Radon in Air
575395	2049	12/16/2025	12/19/2025	Bookshelf	Radon in Air
575393	2049A	12/16/2025	12/19/2025	Bookshelf	Radon in Air
575246 (Dup)		12/16/2025	12/19/2025		Radon in Air
575270	2077	12/16/2025	12/19/2025	Shelf	Radon in Air
575154B (B)		12/16/2025	12/19/2025		Radon in Air
575252	2061	12/16/2025	12/19/2025	Speaker	Radon in Air
575234	2063	12/16/2025	12/19/2025	Speaker	Radon in Air
575172	2065	12/16/2025	12/19/2025	Cabinet	Radon in Air
575130	2068	12/16/2025	12/19/2025	Speaker	Radon in Air
575220	C7	12/16/2025	12/19/2025	File Cabinet	Radon in Air
575237	C9	12/16/2025	12/19/2025	File Cabinet	Radon in Air
575095	C10	12/16/2025	12/19/2025	Cabinet	Radon in Air
575225	C12	12/16/2025	12/19/2025	Cabinet	Radon in Air
575184	2070	12/16/2025	12/19/2025	Cabinet	Radon in Air
575361	2071	12/16/2025	12/19/2025	Cabinet	Radon in Air
575170	2073	12/16/2025	12/19/2025	Speaker	Radon in Air

Notes:

B = Blank

Dup = Duplicate

Table 2. Summary of Radon Laboratory Results

AHERA Space ID	12/16/25-12/19/25 (pCi/L)	2/6/24-2/9/24 (pCi/L)	1/10/23 - 1/13/23 (pCi/L)
2005	0.5	0.80	0.70
2005 (Dup)	0.9	0.50	0.90
2007	0.5	0.80	0.60
2008	0.8	Not Retrived	0.70
2008 (B)	0.1	Not Retrived	-0.10
2006	0.6	0.70	0.90
2009	0.5	0.60	0.20
2011	0.9	0.50	0.70
2010	0.4	0.30	0.40
2012	0.6	0.60	0.70
2013	0.9	0.70	0.60
2015	0.6	0.40	0.60
2020	0.5	0.60	0.80
2021	0.6	0.50	0.70
2022	1	0.60	0.70
2026	0.8	0.60	0.70
2026 (Dup)	0.7	0.50	1.50
2029	1.1	0.70	1.00
2029 (B)	0.3	-0.10	0.00
2032	0.9	0.30	1.10
2035	1.6	0.40	1.10
B6	0.4	0.60	1.00
B6 (B)	0.2	-0.10	Not Sampled
B9	0.7	0.20	0.50
2038	0.9	0.80	0.70
2041	0.4	0.50	0.80
2044	0.6	0.40	0.90
1055	0.8	0.70	0.30
1055 (B)	0.1	0.10	0.20
2050	0.7	1.00	0.90
2053	0.6	0.80	0.40
2046	0.4	0.50	0.90
2047	0.8	0.60	0.80
2048	0.5	0.50	0.60
2049	0.6	0.10	1.00
2049A	0.5	0.90	0.60
2049A (Dup)	0.6	0.40	0.40
2077	0.6	0.80	0.50
2077 (B)	0.1	0.40	0.60
2061	0.7	0.60	0.70
2063	0.7	0.50	0.70
2065	0.9	0.80	0.50
2068	0.5	0.50	1.00
C7	1.2	1.00	1.50
C9	1.1	0.60	1.10
C10	0.9	1.10	1.60
C12	0.3	0.50	0.80
2070	0.7	0.80	0.50
2071	0.7	0.40	0.60
2073	0.9	0.70	0.50

Notes:

B = Blank

Dup = Duplicate

Attachment #2

Figures

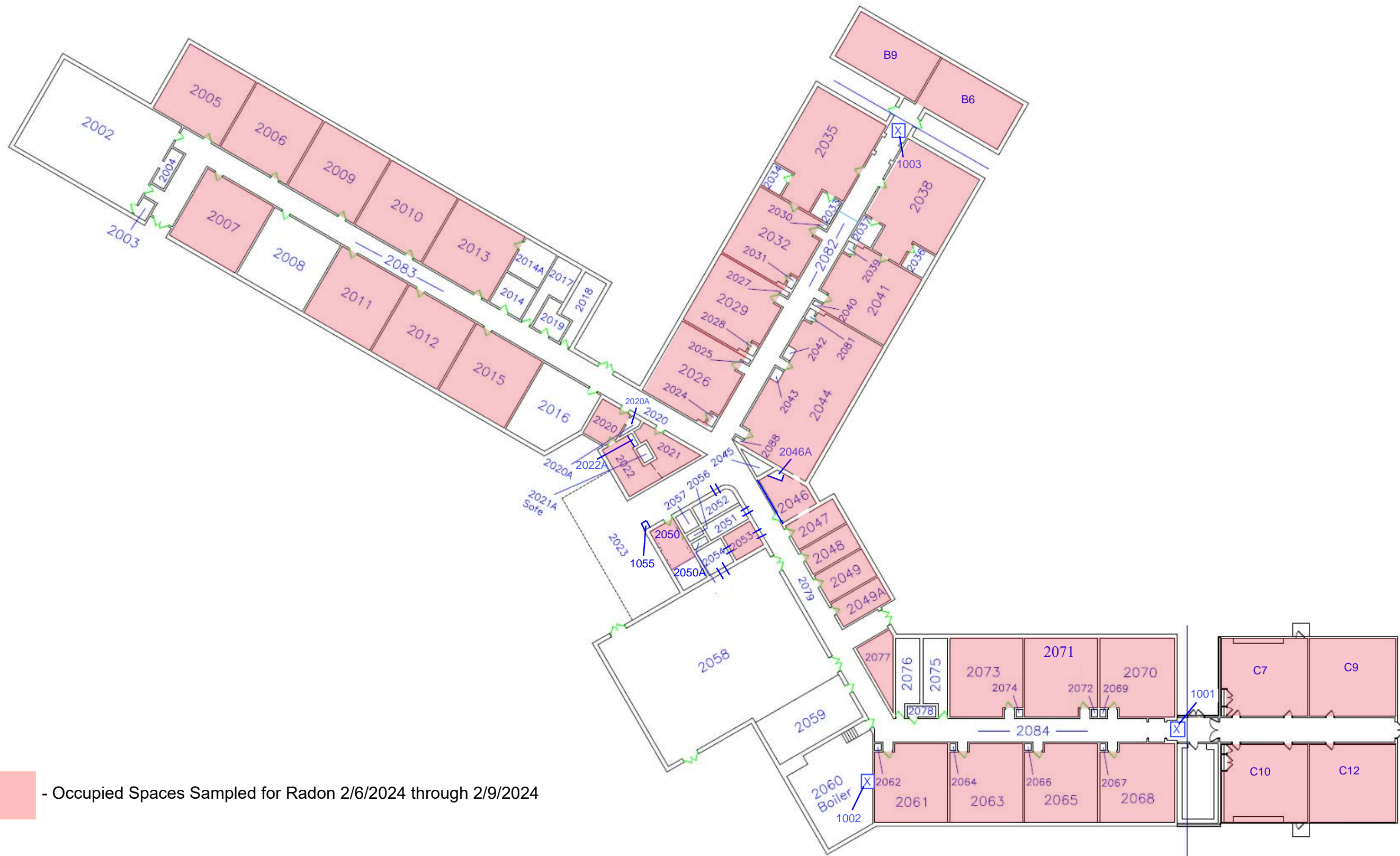

- Occupied Spaces Sampled for Radon 2/6/2024 through 2/9/2024



J.C. Broderick & Associates
 Environmental Consulting & Testing
 1775 Expressway Dr. North
 Hauppauge, New York 11788
 Phone: 631.584.5492 Fax: 631.584.5913

JCB #: 23-55371
SYOSSET CENTRAL SCHOOL DISTRICT
 Baylis Elementary School
 580 Woodbury Road, Plainview, NY 11803

Attachment #3
Field Photograph Logs

Typical Radon Sample

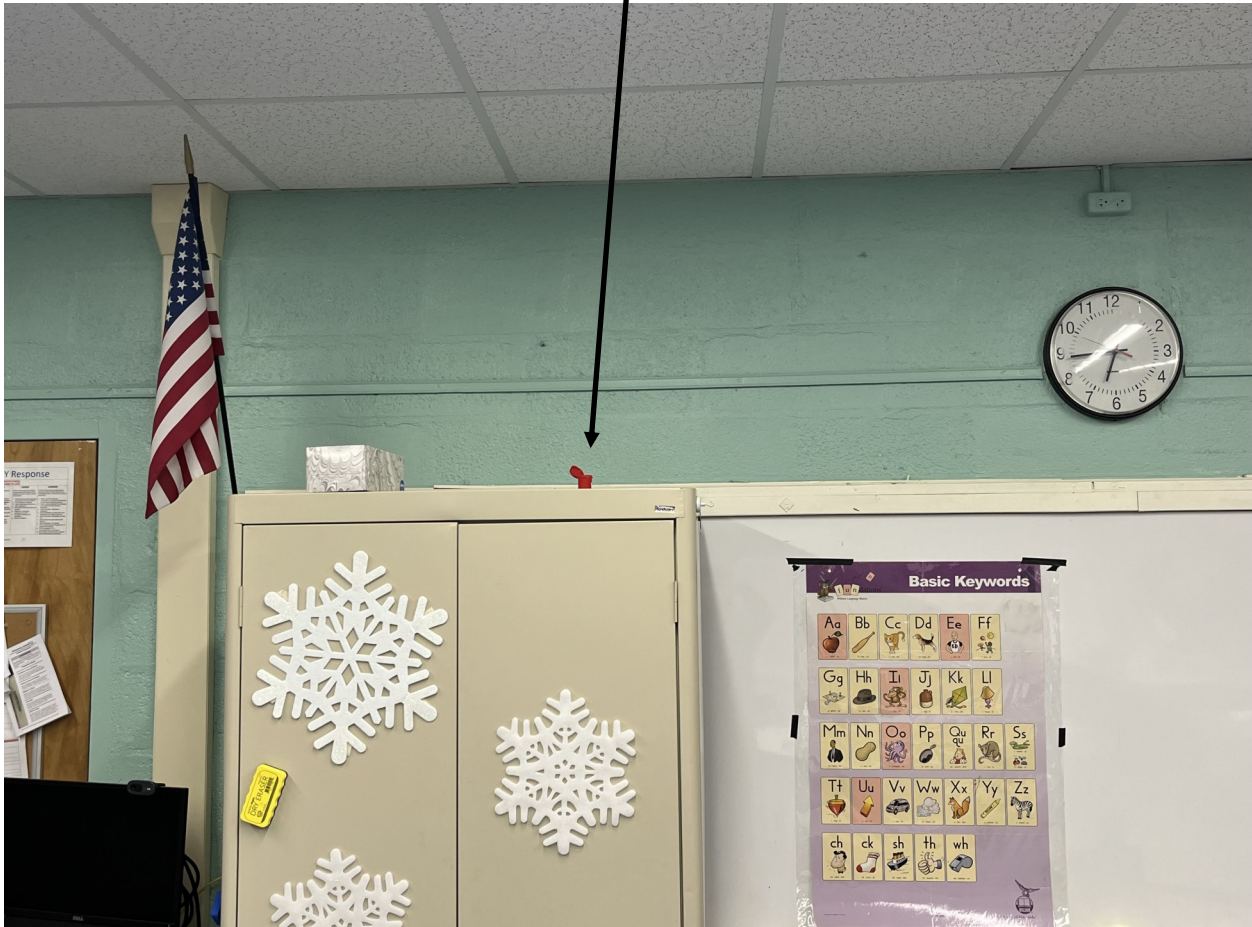

Field Photograph Log

Indoor Radon Investigation at:

**Baylis Elementary School
580 Woodbury Road
Plainview, New York 11803**

Photo No. 01

JCB#: 24-59116

Typical Radon Sample with Blank



Field Photograph Log

Indoor Radon Investigation at:

**Baylis Elementary School
580 Woodbury Road
Plainview, New York 11803**

Photo No. 02

JCB#: 24-59116

Typical Radon Sample with Duplicate



Field Photograph Log

Indoor Radon Investigation at:

**Baylis Elementary School
580 Woodbury Road
Plainview, New York 11803**

Photo No. 03

JCB#: 24-59116

Attachment #4
Laboratory Analysis Reports



EMSL Analytical, Inc.

200 Route 130 North, Cinnaminson, NJ 08077
Phone/Fax: (800) 220-3675 / (856) 786-0327
<http://www.EMSL.com> cinnaminsonradonlab@emsl.com

EMSL Order: 382500074
CustomerID: JCBR50
CustomerPO: 24-59116
ProjectID:

Attn: **Steven Muller**
J.C. Broderick & Associates
1775 Expressway Drive North, Suite 1
Hauppauge, NY 11788

Phone: (631) 584-5492
Fax:
Received: 12/23/2024 03:59 PM
Analysis Date: 12/25/2024
Collected: 12/16/2024

Project: REF # 38-89 / Baylis Elementary School / 24-59116

Test Site: **Baylis Elementary School**
580 Woodbury Rd
Plainview, NY 11803

Test Report: Radon in Air Test Results

Liquid Scintillation ID	Location	Radon Activity (pCi/L)	Start	Stop	Temperature F	Humidity %	Sample Type
575311 382500074-0001	2005	0.5	12/16/2024 6:38:00 AM	12/19/2024 3:48:00 PM	69	26	Customer
Sample Notes:							
575472 382500074-0002	2005	0.9	12/16/2024 6:38:00 AM	12/19/2024 3:48:00 PM	69	26	Duplicate
Sample Notes: Duplicate's Customer Sample:382500074-0001 Duplicate RPD = 57.1%							
575344 382500074-0003	2007	0.5	12/16/2024 6:43:00 AM	12/19/2024 3:49:00 PM	70	25	Customer
Sample Notes:							
575248 382500074-0004	2006	0.6	12/16/2024 6:43:00 AM	12/19/2024 3:50:00 PM	71	25	Customer
Sample Notes:							
575228 382500074-0005	2008	0.8	12/16/2024 6:44:00 AM	12/19/2024 3:50:00 PM	71	24	Customer
Sample Notes:							
575195B 382500074-0006	2008	0.1	12/16/2024 6:44:00 AM	12/19/2024 3:50:00 PM	71	24	Blank
Sample Notes:							
575357 382500074-0007	2009	0.5	12/16/2024 6:45:00 AM	12/19/2024 3:51:00 PM	70	24	Customer
Sample Notes:							
575310 382500074-0008	2011	0.9	12/16/2024 6:45:00 AM	12/19/2024 3:52:00 PM	70	25	Customer
Sample Notes:							
575275 382500074-0009	2010	0.4	12/16/2024 6:46:00 AM	12/19/2024 3:52:00 PM	70	25	Customer
Sample Notes:							
575287 382500074-0010	2012	0.6	12/16/2024 6:46:00 AM	12/19/2024 3:53:00 PM	70	23	Customer
Sample Notes:							



EMSL Analytical, Inc.

200 Route 130 North, Cinnaminson, NJ 08077

Phone/Fax: (800) 220-3675 / (856) 786-0327

<http://www.EMSL.com>

cinnaminsonradonlab@emsl.com

EMSL Order:	382500074
CustomerID:	JCBR50
CustomerPO:	24-59116
ProjectID:	

Test Report: Radon in Air Test Results

Liquid Scintillation ID	Location	Radon Activity (pCi/L)	Start	Stop	Temperature F	Humidity %	Sample Type
575326 382500074-0011	2013	0.9	12/16/2024 6:47:00 AM	12/19/2024 3:54:00 PM	70	25	Customer
Sample Notes:							
575196 382500074-0012	2015	0.6	12/16/2024 6:48:00 AM	12/19/2024 3:54:00 PM	71	24	Customer
Sample Notes:							
575355 382500074-0013	2020	0.5	12/16/2024 6:49:00 AM	12/19/2024 4:11:00 PM	72	22	Customer
Sample Notes:							
575281 382500074-0014	2021	0.6	12/16/2024 6:50:00 AM	12/19/2024 3:57:00 PM	73	22	Customer
Sample Notes:							
575259 382500074-0015	2022	1	12/16/2024 6:51:00 AM	12/19/2024 3:56:00 PM	72	22	Customer
Sample Notes:							
575431 382500074-0016	2026	0.8	12/16/2024 6:53:00 AM	12/19/2024 4:01:00 PM	71	20	Customer
Sample Notes:							
575451 382500074-0017	2026	0.7	12/16/2024 6:53:00 AM	12/19/2024 4:01:00 PM	71	20	Duplicate
Sample Notes: Duplicate's Customer Sample:382500074-0016 Duplicate RPD = 13.3%							
575401 382500074-0018	2029	1.1	12/16/2024 6:54:00 AM	12/19/2024 4:04:00 PM	72	18	Customer
Sample Notes:							
575229B 382500074-0019	2029	0.3	12/16/2024 6:54:00 AM	12/19/2024 4:04:00 PM	72	18	Blank
Sample Notes:							
575426 382500074-0020	2032	0.9	12/16/2024 6:55:00 AM	12/19/2024 4:05:00 PM	73	20	Customer
Sample Notes:							
575367 382500074-0021	2035	1.6	12/16/2024 6:56:00 AM	12/19/2024 4:05:00 PM	73	18	Customer
Sample Notes:							
575352 382500074-0022	B6	0.4	12/16/2024 6:57:00 AM	12/19/2024 4:06:00 PM	72	26	Customer
Sample Notes:							
575320B 382500074-0023	B6	0.2	12/16/2024 6:57:00 AM	12/19/2024 4:06:00 PM	72	26	Blank
Sample Notes:							

Please visit www.radontestinglab.com



EMSL Analytical, Inc.

200 Route 130 North, Cinnaminson, NJ 08077

Phone/Fax: (800) 220-3675 / (856) 786-0327

<http://www.EMSL.com>

cinnaminsonradonlab@emsl.com

EMSL Order:	382500074
CustomerID:	JCBR50
CustomerPO:	24-59116
ProjectID:	

Test Report: Radon in Air Test Results

Liquid Scintillation ID	Location	Radon Activity (pCi/L)	Start	Stop	Temperature F	Humidity %	Sample Type
575413 382500074-0024	B9	0.7	12/16/2024 6:58:00 AM	12/19/2024 4:07:00 PM	71	25	Customer
Sample Notes:							
575243 382500074-0025	203B	0.9	12/16/2024 6:58:00 AM	12/19/2024 4:08:00 PM	72	19	Customer
Sample Notes:							
275366 382500074-0026	2041	0.4	12/16/2024 6:59:00 AM	12/19/2024 4:08:00 PM	73	18	Customer
Sample Notes:							
575399 382500074-0027	2044	0.6	12/16/2024 7:00:00 AM	12/19/2024 4:09:00 PM	72	21	Customer
Sample Notes:							
575340 382500074-0028	2046	0.4	12/16/2024 7:02:00 AM	12/19/2024 4:10:00 PM	71	21	Customer
Sample Notes:							
575266 382500074-0029	2047	0.8	12/16/2024 7:03:00 AM	12/19/2024 4:12:00 PM	73	17	Customer
Sample Notes:							
575338 382500074-0030	2048	0.5	12/16/2024 7:03:00 AM	12/19/2024 4:12:00 PM	72	19	Customer
Sample Notes:							
575395 382500074-0031	2049	0.6	12/16/2024 7:03:00 AM	12/19/2024 4:13:00 PM	73	19	Customer
Sample Notes:							
575393 382500074-0032	2049A	0.5	12/16/2024 7:04:00 AM	12/19/2024 4:14:00 PM	73	16	Customer
Sample Notes:							
575246 382500074-0033	2049A	0.6	12/16/2024 7:04:00 AM	12/19/2024 4:14:00 PM	73	16	Duplicate
Sample Notes: Duplicate's Customer Sample:382500074-0032 Duplicate RPD = 18.2%							
575233 382500074-0034	2050	0.7	12/16/2024 7:07:00 AM	12/19/2024 4:00:00 PM	74	19	Customer
Sample Notes:							
575215B 382500074-0035	1055	0.1	12/16/2024 7:08:00 AM	12/19/2024 4:00:00 PM	73	20	Blank
Sample Notes:							
575339 382500074-0036	1055	0.8	12/16/2024 7:08:00 AM	12/19/2024 4:00:00 PM	73	20	Customer
Sample Notes:							

Please visit www.radontestinglab.com



EMSL Analytical, Inc.

200 Route 130 North, Cinnaminson, NJ 08077

Phone/Fax: (800) 220-3675 / (856) 786-0327

<http://www.EMSL.com>

cinnaminsonradonlab@emsl.com

EMSL Order:	382500074
CustomerID:	JCBR50
CustomerPO:	24-59116
ProjectID:	

Test Report: Radon in Air Test Results

Liquid Scintillation ID	Location	Radon Activity (pCi/L)	Start	Stop	Temperature F	Humidity %	Sample Type
575179 382500074-0037	2053	0.6	12/16/2024 7:09:00 AM	12/19/2024 4:16:00 PM	73	19	Customer
Sample Notes:							
575154B 382500074-0038	2077	0.1	12/16/2024 7:10:00 AM	12/19/2024 4:17:00 PM	74	22	Blank
Sample Notes:							
575270 382500074-0039	2077	0.6	12/16/2024 7:10:00 AM	12/19/2024 4:17:00 PM	74	22	Customer
Sample Notes:							
575252 382500074-0040	2061	0.7	12/16/2024 7:12:00 AM	12/19/2024 4:18:00 PM	73	19	Customer
Sample Notes:							
575234 382500074-0041	2063	0.7	12/16/2024 7:13:00 AM	12/19/2024 4:18:00 PM	72	19	Customer
Sample Notes:							
575172 382500074-0042	2065	0.9	12/16/2024 7:13:00 AM	12/19/2024 4:19:00 PM	72	19	Customer
Sample Notes:							
575130 382500074-0043	2068	0.5	12/16/2024 7:14:00 AM	12/19/2024 4:19:00 PM	72	18	Customer
Sample Notes:							
575220 382500074-0044	C7	1.2	12/16/2024 7:16:00 AM	12/19/2024 4:20:00 PM	73	30	Customer
Sample Notes:							
575237 382500074-0045	C9	1.1	12/16/2024 7:17:00 AM	12/19/2024 4:21:00 PM	70	28	Customer
Sample Notes:							
575095 382500074-0046	C10	0.9	12/16/2024 7:18:00 AM	12/19/2024 4:22:00 PM	70	32	Customer
Sample Notes:							
575225 382500074-0047	C12	0.3	12/16/2024 7:19:00 AM	12/19/2024 4:23:00 PM	71	27	Customer
Sample Notes:							
575184 382500074-0048	2070	0.7	12/16/2024 7:20:00 AM	12/19/2024 4:23:00 PM	70	19	Customer
Sample Notes:							
575361 382500074-0049	2071	0.7	12/16/2024 7:20:00 AM	12/19/2024 4:24:00 PM	70	21	Customer
Sample Notes:							

Please visit www.radontestinglab.com



EMSL Analytical, Inc.

200 Route 130 North, Cinnaminson, NJ 08077

Phone/Fax: (800) 220-3675 / (856) 786-0327

<http://www.EMSL.com>

cinnaminsonradonlab@emsl.com

EMSL Order:	382500074
CustomerID:	JCBR50
CustomerPO:	24-59116
ProjectID:	

Test Report: Radon in Air Test Results

Liquid Scintillation ID	Location	Radon Activity (pCi/L)	Start	Stop	Temperature F	Humidity %	Sample Type
575170	2073	0.9	12/16/2024	12/19/2024	70	20	Customer
382500074-0050			7:21:00 AM	4:24:00 PM			

Sample Notes:

Report Notes

The United States Environmental Protection Agency (EPA) has established a radon action level of 4.0pCi/L. EPA recommends mitigation of a structure if the confirmed radon level is equal to or greater than 4.0pCi/L.

The radon tests were performed using liquid scintillation radon detectors and counted on a liquid scintillation counter following EPA Method # 402-R-92-004 testing protocol for Radon in Air testing. EPA recommends retesting every two years.

Please contact EMSL Analytical, Inc. or your State Health Department for further information.

All procedures used for generating this report are in complete accordance with the current EPA protocols for the analysis of Radon in Air.

Analyst(s)

Jeanel Zoll (50)

Dominic Gehret, Radiochemistry Laboratory Manager, 10872

In no event shall EMSL be liable for indirect, special, consequential, or incidental damages, including, but not limited to, damages for loss of profit or goodwill regardless of the negligence (either sole or concurrent) of EMSL and whether EMSL has been informed of the possibility of such damages, arising out of or in connection with EMSL's services thereunder or the delivery, use, reliance upon or interpretation of test results by client or any third party. We accept no legal responsibility for the purposes for which the client uses the test results. In no event shall EMSL be liable to a client or any third party, whether based upon theories of tort, contract or any other legal or equitable theory, in excess of the amount paid to EMSL by client thereunder. The test results meets all NELAC requirements unless otherwise specified.

Samples analyzed by EMSL Analytical, Inc. Cinnaminson, NJ FL RB2034/R2687,IL RNL2008202,IN RTL00935,IA RNLAB10005,KS KS-LB-0005/KS-MS-0482,ME SPC202,MN RL-0005,NE 474/RMB-1083,NJ 03036/MEB92525/MES13910,NY 10872,OH RL39,OK D9952,PA 2573/3393/68-00367,RI RMB-108/RI00179,WV RL000220,NRSB-ARL6006,NRPP

Initial report from 01/15/2025 17:33:24



Radon Testing Chain of Custody

EMSL Order Number / Lab Use Only

382500074

EMSL Analytical, Inc.
200 Route 130 North
Cinnaminson, NJ 08030

(800) 220-3675

RadLab@emsl.com

If Bill-To is the same as Report-To leave this section blank. Third-party billing requires written authorization.

Customer Information	Customer ID: JCBR50		Billing Information	Billing ID:	
	Company Name: J.C. Broderick & Associates, Inc.			Company Name: J.C. Broderick & Associates, Inc.	
	Contact Name: Steven Muller			Billing Contact: Steven Muller	
	Street Address: 1775 Express Drive North			Street Address: 1775 Express Drive North	
	City, State, Zip: Hauppauge, NY, 11788	Country: USA		City, State, Zip: Hauppauge, NY, 11788	Country: USA
	Phone: (631) 584-5492			Phone: (631) 584-5492	
Email(s) for Report: smuller@jcbroderick.com			Email(s) for Invoice: smuller@jcbroderick.com		

Project Information		
Project Name/No: Baylis Elementary School / 24-59116		Purchase Order:
EMSL LIMS Project ID: <small>(If applicable, EMSL will provide)</small>	US State where samples collected: NY	State of Connecticut (CT) must select project location: <input type="checkbox"/> Commercial (Taxable) <input type="checkbox"/> Residential (Non-Taxable)
Technician Name: Steven Muller	Technician Cert#:	Technician Signature:

Property Tested Information

1) Radon Test being conducted for the purpose of: Real Estate Transaction Homeowner Other

2) Test Conditions Observed: Closed House Open House

3) Building Type: Residential Commercial Daycare/School

4) Building Foundation: Basement Crawlspace Slab on Grade Other

5) If School Testing, please enter School Code:

6) Is this a Post Mitigation Test? YES NO

Box Number	Device Number	Location / Floor	Exposure Period Beginning Date and Time	Exposure Period Ending Date and Time	Temperature °F	Humidity %
0	S	2005	12/16/24 638	12/19/24 1548	69.4	26.3
0	D	2005	12/16/24 638	12/19/24 1548	69.4	26.3
0	S	2007	12/16/24 643	12/19/24 1549	70.3	25.4
0	S	2006	12/16/24 643	12/19/24 1550	70.5	25.1
0	S	2008	12/16/24 644	12/19/24 1550	70.5	24.4
0	B	2008	12/16/24 644	12/19/24 1550	70.5	24.4
0	S	2009	12/16/24 645	12/19/24 1551	69.6	23.9
0	S	2011	12/16/24 645	12/19/24 1552	70.1	24.9
0	S	2010	12/16/24 646	12/19/24 1552	70.1	25.4
0	S	2012	12/16/24 646	12/19/24 1553	70.1	23.4
0	S	2013	12/16/24 647	12/19/24 1554	70.3	25.4
0	S	2015	12/16/24 648	12/19/24 1554	70.8	24.4
0	S	2020	12/16/24 649	12/19/24 1611	71.6	21.5

*Comments/Special Instructions:

NH 2 day TBT

Client Sample #(s): Total # of Samples: 150

Method of Shipment: Sample Condition Upon Receipt:

Relinquished by: COAD/JCB	Date/Time: 12/20/24 13:15	Received by: Alvin...	Date/Time: 12/20/24 1:14pm
Relinquished by:	Date/Time:	Received by: Joan...	Date/Time: 12/23/24 15:59PM

Controlled Document - COC-56 Radon R2 04/15/2021 AGREE TO ELECTRONIC SIGNATURE (By checking, I consent to signing this Chain of Custody document by electronic signature.)



EMSL ANALYTICAL, INC.
TESTING LABS • PRODUCTS • TRAINING

Radon Testing Chain of Custody

EMSL Order Number / Lab Use Only

382500074

RECEIVED
EMSL ANALYTICAL, INC.
200 Route 130 North
Cinnaminson, NJ 08077
Carle P...
DEC 20 2024 PM 01:15
(800) 220-3675
RadLab@emsl.com

Additional Pages of the Chain of Custody are only necessary if needed for additional sample information

Box Number	Device Number	Location	Exposure Period Beginning Date and Time	Exposure Period Ending Date and Time	Temperature °F	Humidity %
S	575281	2021	12/16/24 650	12/19/24 1557	72.8	21.6
S	575259	2022	12/16/24 651	12/19/24 1556	71.9	21.7
S	575431	2028	12/16/24 653	12/19/24 1601	71.2	19.7
D	575451	2028	12/16/24 653	12/19/24 1601	71.2	19.7
S	575401	2029	12/16/24 654	12/19/24 1604	71.9	17.5
B	575229	2029	12/16/24 654	12/19/24 1604	71.9	17.5
S	575426	2032	12/16/24 655	12/19/24 1605	72.6	19.7
S	575367	2035	12/16/24 656	12/19/24 1605	72.8	17.6
S	575352	B6	12/16/24 657	12/19/24 1606	71.6	25.5
B	575320	B6	12/16/24 657	12/19/24 1606	71.6	25.5
S	575413	B9	12/16/24 658	12/19/24 1607	70.8	24.6
S	575243	2038	12/16/24 658	12/19/24 1608	71.7	18.5
S	575366	2041	12/16/24 659	12/19/24 1608	72.8	17.6
S	575399	2044	12/16/24 700	12/19/24 1609	71.6	20.5
S	575340	2046	12/16/24 702	12/19/24 1610	70.7	21.2
S	575266	2047	12/16/24 703	12/19/24 1612	72.8	17.4
S	575338	2048	12/16/24 703	12/19/24 1612	72.3	19.3
S	575395	2049	12/16/24 703	12/19/24 1613	73.0	18.8
S	575393	2049A	12/16/24 704	12/19/24 1614	73.4	15.7
D	575246	2049A	12/16/24 704	12/19/24 1614	73.4	15.7
S	575233	2050	12/16/24 707	12/19/24 1600	73.7	18.6
B	575215	2055	12/16/24 708	12/19/24 1600	73.4	19.8
S	575339	2055	12/16/24 708	12/19/24 1600	73.4	19.8
S	575179	2053	12/16/24 709	12/19/24 1606	73.0	19.3
B	575154	2077	12/16/24 710	12/19/24 1617	73.5	21.6
S	575270	2077	12/16/24 710	12/19/24 1617	73.5	21.6

*Comments/Special Instructions:

Relinquished by: <u>Coolidge / SCB</u>	Date/Time: <u>12/20/24 13:15</u>	Received by: <u>Amundson / Amundson</u>	Date/Time: <u>12/20/24 1:14pm</u>
Relinquished by:	Date/Time:	Received by:	Date/Time:

Controlled Document - CCC-56 Radon R2 04/15/2021

AGREE TO ELECTRONIC SIGNATURE (By checking, I consent to signing this Chain of Custody document by electronic signature.)

