

December 12, 2024

Will Wenzloff
 Hillsboro School District
 4901 SE Witch Hazel Road
 Hillsboro, Oregon 97123

Via e-mail: wenzlofw@hsd.or.k12.us

Regarding: Drinking Water Sampling Report
 Walnut Street Transportation Center
 1220 SW Walnut Street
 Hillsboro, OR 97123
 PBS Project 23440.191 / 0001

Dear Mr. Wenzloff:

On June 1, 2024, PBS Engineering and Environmental LLC (PBS) performed drinking water sampling at the Hillsboro School District Walnut Street Transportation Center in Hillsboro, Oregon. The testing was requested by Hillsboro School District as part of their efforts to ensure that concentrations of lead in drinking water at the building remain below the Oregon Department of Education (ODE) action level of 15 parts per billion (ppb).

Ten samples were delivered under chain of custody to Apex Laboratories in Tigard, Oregon for lead analysis. All samples analyzed below 15 ppb of lead. The following table lists the results of the analysis.

Fixture Number	Sample Number	Location / Room No.	Results (ppb)
001	22390003-001WB24A	Shop - water bottle filler	ND
002	22390003-002DW24A	Shop – drinking fountain	ND
003	22390003-003BF24A	Womens restroom – left to right (1)	ND
004	22390003-004BF24A	Womens restroom – left to right (2)	ND
005	22390003-005BF24A	Womens restroom – left to right (3)	ND
006	22390003-006BF24A	Mens restroom – left	0.388
007	22390003-007BF24A	Mens restroom – right	ND
008	22390003-008BF24A	Accessible restroom	ND
009	22390003-009SF24A	Break room – kitchenette sink faucet	ND
010	22390003-010IM24A	Break room – ice machine / drinking water dispenser	ND

ND = no lead detected

Please refer to the attached sample location drawings and laboratory analytical report for additional details. The laboratory analytical results are reported in micrograms per liter (µg/L), a unit of measure that is equivalent to ppb.

Sampling methodology and the interpretation of laboratory results were based on the Environmental Protection Agency guidance document titled *3Ts for Reducing Lead in Drinking Water in Schools*. Following this guideline, PBS collected first draw samples from each test location. First draw samples consist of the first 250 milliliters (mL) of water drawn from a fixture after the water has been sitting stagnant for at least 8 hours. The 3Ts' sampling protocol specifying 250-mL samples is designed to maximize the likelihood that the highest concentrations of lead in water used for consumption are identified.

Please feel free to contact me at 503.515.4726 or voeller@pbsusa.com with any questions or comments.

Sincerely,

Dale Voeller, CHMM, CSP
Senior Project Manager

Attachments: Sample Location Drawings
Laboratory Analytical Report

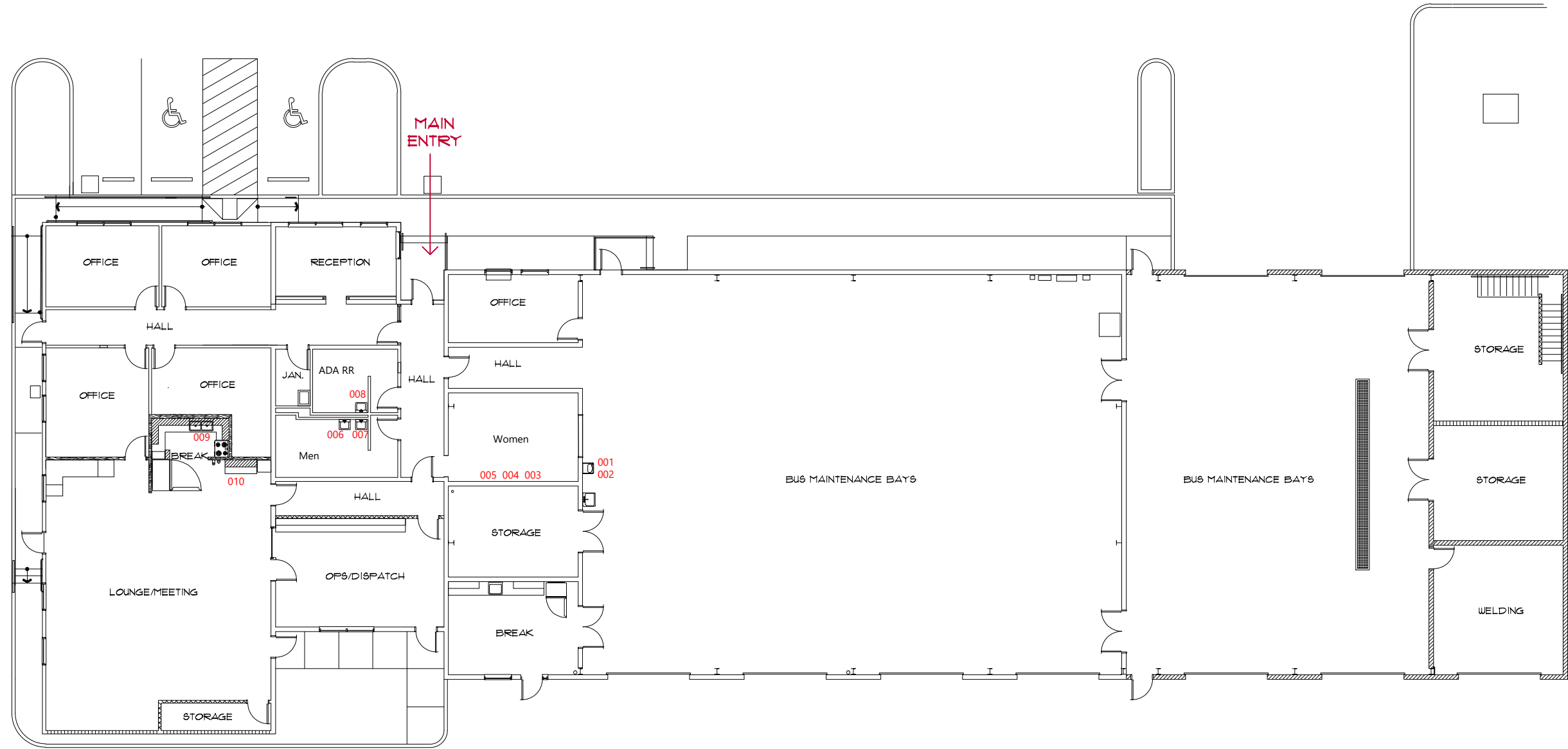



ANALYTICAL REPORT

Apex Laboratories, LLC
6700 S.W. Sandburg Street
Tigard, OR 97223
503-718-2323
ORELAP ID: OR100062

Thursday, June 13, 2024

Dale Voeller
PBS Engineering and Environmental
4412 S Corbett Ave
Portland, OR 97239

RE: A4F0785 - Hillsboro School District - Walnut Street Transportation Center/23440.191

Thank you for using Apex Laboratories. We greatly appreciate your business and strive to provide the highest quality services to the environmental industry.

Enclosed are the results of analyses for work order A4F0785, which was received by the laboratory on 6/3/2024 at 10:31:00AM.

If you have any questions concerning this report or the services we offer, please feel free to contact me by email at: jwoodcock@apex-labs.com, or by phone at 503-718-2323.

Please note: All samples will be disposed of within 30 days of sample receipt, unless prior arrangements have been made.

Cooler Receipt Information		
<u>Acceptable Receipt Temperature is less than, or equal to, 6 degC (not frozen), or received on ice the same day as sampling.</u>		
(See Cooler Receipt Form for details)		
Default Cooler	1.6	degC

This Final Report is the official version of the data results for this sample submission, unless superseded by a subsequent, labeled amended report.

All other deliverables derived from this data, including Electronic Data Deliverables (EDDs), CLP-like forms, client requested summary sheets, and all other products are considered secondary to this report.



Apex Laboratories

The results in this report apply to the samples analyzed in accordance with the chain of custody document(s) and updated by any subsequent written communications. This analytical report must be reproduced in its entirety.

Jason Woodcock, Project Manager



ANALYTICAL REPORT

Apex Laboratories, LLC

6700 S.W. Sandburg Street
Tigard, OR 97223
503-718-2323
ORELAP ID: OR100062

<u>PBS Engineering and Environmental</u> 4412 S Corbett Ave Portland, OR 97239	Project: <u>Hillsboro School District</u> Project Number: Walnut Street Transportati Project Manager: Dale Voeller	Report ID: A4F0785 - 06 13 24 1224
---	---	---

ANALYTICAL REPORT FOR SAMPLES

SAMPLE INFORMATION

Client Sample ID	Laboratory ID	Matrix	Date Sampled	Date Received
22390003-001WB24A	A4F0785-01	Drinking Water	06/01/24 00:00	06/03/24 10:31
22390003-002DW24A	A4F0785-02	Drinking Water	06/01/24 00:00	06/03/24 10:31
22390003-003BF24A	A4F0785-03	Drinking Water	06/01/24 00:00	06/03/24 10:31
22390003-004BF24A	A4F0785-04	Drinking Water	06/01/24 00:00	06/03/24 10:31
22390003-005BF24A	A4F0785-05	Drinking Water	06/01/24 00:00	06/03/24 10:31
22390003-006BF24A	A4F0785-06	Drinking Water	06/01/24 00:00	06/03/24 10:31
22390003-007BF24A	A4F0785-07	Drinking Water	06/01/24 00:00	06/03/24 10:31
22390003-008BF24A	A4F0785-08	Drinking Water	06/01/24 00:00	06/03/24 10:31
22390003-009SF24A	A4F0785-09	Drinking Water	06/01/24 00:00	06/03/24 10:31
22390003-010IM24A	A4F0785-10	Drinking Water	06/01/24 00:00	06/03/24 10:31

Apex Laboratories

The results in this report apply to the samples analyzed in accordance with the chain of custody document(s) and updated by any subsequent written communications. This analytical report must be reproduced in its entirety.

Jason Woodcock, Project Manager



ANALYTICAL REPORT

Apex Laboratories, LLC

6700 S.W. Sandburg Street
Tigard, OR 97223
503-718-2323
ORELAP ID: OR100062

PBS Engineering and Environmental 4412 S Corbett Ave Portland, OR 97239	Project: Hillsboro School District Project Number: Walnut Street Transportatic Project Manager: Dale Voeller	Report ID: A4F0785 - 06 13 24 1224
--	---	---

ANALYTICAL SAMPLE RESULTS

Total Metals in Drinking Water by EPA 200.8 (ICPMS)

Analyte	Sample Result	Detection Limit	Reporting Limit	Units	Dilution	Date Analyzed	Method Ref.	Notes
22390003-001WB24A (A4F0785-01)				Matrix: Drinking Water				
<u>Batch: 24F0210</u>								
Lead	ND	---	0.200	ug/L	1	06/11/24 16:41	EPA 200.8	
22390003-002DW24A (A4F0785-02)				Matrix: Drinking Water				
<u>Batch: 24F0210</u>								
Lead	ND	---	0.200	ug/L	1	06/11/24 16:43	EPA 200.8	
22390003-003BF24A (A4F0785-03)				Matrix: Drinking Water				
<u>Batch: 24F0210</u>								
Lead	ND	---	0.200	ug/L	1	06/11/24 16:44	EPA 200.8	
22390003-004BF24A (A4F0785-04)				Matrix: Drinking Water				
<u>Batch: 24F0210</u>								
Lead	ND	---	0.200	ug/L	1	06/11/24 16:46	EPA 200.8	
22390003-005BF24A (A4F0785-05)				Matrix: Drinking Water				
<u>Batch: 24F0210</u>								
Lead	ND	---	0.200	ug/L	1	06/11/24 16:48	EPA 200.8	
22390003-006BF24A (A4F0785-06)				Matrix: Drinking Water				
<u>Batch: 24F0210</u>								
Lead	0.388	---	0.200	ug/L	1	06/11/24 16:49	EPA 200.8	
22390003-007BF24A (A4F0785-07)				Matrix: Drinking Water				
<u>Batch: 24F0210</u>								
Lead	ND	---	0.200	ug/L	1	06/11/24 16:51	EPA 200.8	
22390003-008BF24A (A4F0785-08)				Matrix: Drinking Water				
<u>Batch: 24F0210</u>								
Lead	ND	---	0.200	ug/L	1	06/11/24 16:53	EPA 200.8	
22390003-009SF24A (A4F0785-09)				Matrix: Drinking Water				
<u>Batch: 24F0210</u>								
Lead	ND	---	0.200	ug/L	1	06/11/24 16:54	EPA 200.8	

Apex Laboratories

The results in this report apply to the samples analyzed in accordance with the chain of custody document(s) and updated by any subsequent written communications. This analytical report must be reproduced in its entirety.

Jason Woodcock, Project Manager



ANALYTICAL REPORT

Apex Laboratories, LLC

6700 S.W. Sandburg Street
Tigard, OR 97223
503-718-2323
ORELAP ID: OR100062

<u>PBS Engineering and Environmental</u> 4412 S Corbett Ave Portland, OR 97239	Project: <u>Hillsboro School District</u> Project Number: Walnut Street Transportatic Project Manager: Dale Voeller	Report ID: A4F0785 - 06 13 24 1224
---	--	---

ANALYTICAL SAMPLE RESULTS

Total Metals in Drinking Water by EPA 200.8 (ICPMS)

Analyte	Sample Result	Detection Limit	Reporting Limit	Units	Dilution	Date Analyzed	Method Ref.	Notes
22390003-010IM24A (A4F0785-10)				Matrix: Drinking Water				
<u>Batch: 24F0210</u>								
Lead	ND	---	0.200	ug/L	1	06/11/24 16:59	EPA 200.8	

Apex Laboratories

The results in this report apply to the samples analyzed in accordance with the chain of custody document(s) and updated by any subsequent written communications. This analytical report must be reproduced in its entirety.

Jason Woodcock, Project Manager



ANALYTICAL REPORT

Apex Laboratories, LLC

6700 S.W. Sandburg Street
Tigard, OR 97223
503-718-2323
ORELAP ID: OR100062

PBS Engineering and Environmental 4412 S Corbett Ave Portland, OR 97239	Project: Hillsboro School District Project Number: Walnut Street Transportatic Project Manager: Dale Voeller	Report ID: A4F0785 - 06 13 24 1224
--	---	---

QUALITY CONTROL (QC) SAMPLE RESULTS

Total Metals in Drinking Water by EPA 200.8 (ICPMS)

Analyte	Result	Detection Limit	Reporting Limit	Units	Dilution	Spike Amount	Source Result	% REC	% REC Limits	RPD	RPD Limit	Notes
Batch 24F0210 - EPA 200.8 Direct Analysis						Drinking Water						
Blank (24F0210-BLK1)		Prepared: 06/06/24 14:00 Analyzed: 06/11/24 16:19										
<u>EPA 200.8</u>												
Lead	ND	---	0.200	ug/L	1	---	---	---	---	---	---	---
LCS (24F0210-BS1)		Prepared: 06/06/24 14:00 Analyzed: 06/11/24 16:21										
<u>EPA 200.8</u>												
Lead	15.0	---	0.201	ug/L	1	15.0	---	100	85 - 115%	---	---	---

No Client related Batch QC samples analyzed for this batch. See notes page for more information.

Apex Laboratories

The results in this report apply to the samples analyzed in accordance with the chain of custody document(s) and updated by any subsequent written communications. This analytical report must be reproduced in its entirety.

Jason Woodcock, Project Manager



ANALYTICAL REPORT

Apex Laboratories, LLC

6700 S.W. Sandburg Street
Tigard, OR 97223
503-718-2323
ORELAP ID: OR100062

<u>PBS Engineering and Environmental</u> 4412 S Corbett Ave Portland, OR 97239	Project: <u>Hillsboro School District</u> Project Number: Walnut Street Transportatic Project Manager: Dale Voeller	Report ID: A4F0785 - 06 13 24 1224
---	--	---

SAMPLE PREPARATION INFORMATION

Total Metals in Drinking Water by EPA 200.8 (ICPMS)

Prep: EPA 200.8 Direct Analysis

Lab Number	Matrix	Method	Sampled	Prepared	Sample Initial/Final	Default Initial/Final	RL Prep Factor
<u>Batch: 24F0210</u>							
A4F0785-01	Drinking Water	EPA 200.8	06/01/24 00:00	06/06/24 14:00	10mL/10mL	10mL/10mL	1.00
A4F0785-02	Drinking Water	EPA 200.8	06/01/24 00:00	06/06/24 14:00	10mL/10mL	10mL/10mL	1.00
A4F0785-03	Drinking Water	EPA 200.8	06/01/24 00:00	06/06/24 14:00	10mL/10mL	10mL/10mL	1.00
A4F0785-04	Drinking Water	EPA 200.8	06/01/24 00:00	06/06/24 14:00	10mL/10mL	10mL/10mL	1.00
A4F0785-05	Drinking Water	EPA 200.8	06/01/24 00:00	06/06/24 14:00	10mL/10mL	10mL/10mL	1.00
A4F0785-06	Drinking Water	EPA 200.8	06/01/24 00:00	06/06/24 14:00	10mL/10mL	10mL/10mL	1.00
A4F0785-07	Drinking Water	EPA 200.8	06/01/24 00:00	06/06/24 14:00	10mL/10mL	10mL/10mL	1.00
A4F0785-08	Drinking Water	EPA 200.8	06/01/24 00:00	06/06/24 14:00	10mL/10mL	10mL/10mL	1.00
A4F0785-09	Drinking Water	EPA 200.8	06/01/24 00:00	06/06/24 14:00	10mL/10mL	10mL/10mL	1.00
A4F0785-10	Drinking Water	EPA 200.8	06/01/24 00:00	06/06/24 14:00	10mL/10mL	10mL/10mL	1.00

Apex Laboratories

The results in this report apply to the samples analyzed in accordance with the chain of custody document(s) and updated by any subsequent written communications. This analytical report must be reproduced in its entirety.

Jason Woodcock, Project Manager



ANALYTICAL REPORT

Apex Laboratories, LLC

6700 S.W. Sandburg Street
Tigard, OR 97223
503-718-2323
ORELAP ID: OR100062

<u>PBS Engineering and Environmental</u> 4412 S Corbett Ave Portland, OR 97239	Project: <u>Hillsboro School District</u> Project Number: Walnut Street Transportatic Project Manager: Dale Voeller	<u>Report ID:</u> A4F0785 - 06 13 24 1224
---	--	---

QUALIFIER DEFINITIONS

Client Sample and Quality Control (QC) Sample Qualifier Definitions:

There are No Qualifiers on Sample or QC Data for this report

Apex Laboratories

The results in this report apply to the samples analyzed in accordance with the chain of custody document(s) and updated by any subsequent written communications. This analytical report must be reproduced in its entirety.

Jason Woodcock, Project Manager



ANALYTICAL REPORT

Apex Laboratories, LLC

6700 S.W. Sandburg Street
Tigard, OR 97223
503-718-2323
ORELAP ID: OR100062

<u>PBS Engineering and Environmental</u> 4412 S Corbett Ave Portland, OR 97239	Project: <u>Hillsboro School District</u> Project Number: Walnut Street Transportati Project Manager: Dale Voeller	Report ID: A4F0785 - 06 13 24 1224
---	---	---

REPORTING NOTES AND CONVENTIONS:

Abbreviations:

- DET Analyte DETECTED at or above the detection or reporting limit.
- ND Analyte NOT DETECTED at or above the detection or reporting limit.
- NR Result Not Reported.
- RPD Relative Percent Difference. RPDs for Matrix Spikes and Matrix Spike Duplicates are based on concentration, not recovery.

Detection Limits: Limit of Detection (LOD)

Limits of Detection (LODs) are normally set at a level of one half the validated Limit of Quantitation (LOQ).
If no value is listed ('----'), then the data has not been evaluated below the Reporting Limit.

Reporting Limits: Limit of Quantitation (LOQ)

Validated Limits of Quantitation (LOQs) are reported as the Reporting Limits for all analyses where the LOQ, MRL, PQL or CRL are requested. The LOQ represents a level at or above the low point of the calibration curve, that has been validated according to Apex Laboratories' comprehensive LOQ policies and procedures.

Reporting Conventions:

- Basis: Results for soil samples are generally reported on a 100% dry weight basis.
The Result Basis is listed following the units as " dry", " wet", or " " (blank) designation.
- " dry" Sample results and Reporting Limits are reported on a dry weight basis. (i.e. "ug/kg dry")
See Percent Solids section for details of dry weight analysis.
- " wet" Sample results and Reporting Limits for this analysis are normally dry weight corrected, but have not been modified in this case.
- " " Results without 'wet' or 'dry' designation are not normally dry weight corrected. These results are considered 'As Received'.

QC Source:

In cases where there is insufficient sample provided for Sample Duplicates and/or Matrix Spikes, a Lab Control Sample Duplicate (LCS Dup) may be analyzed to demonstrate accuracy and precision of the extraction batch.

Non-Client Batch QC Samples (Duplicates and Matrix Spike/Duplicates) are not included in this report. Please request a Full QC report if this data is required.

Miscellaneous Notes:

- " --- " QC results are not applicable. For example, % Recoveries for Blanks and Duplicates, % RPD for Blanks, Blank Spikes and Matrix Spikes, etc.
- " *** " Used to indicate a possible discrepancy with the Sample and Sample Duplicate results when the %RPD is not available. In this case, either the Sample or the Sample Duplicate has a reportable result for this analyte, while the other is Non Detect (ND).

Blanks:

Standard practice is to evaluate the results from Blank QC Samples down to a level equal to one half of the Reporting Limit (RL).
 Blank results for gravimetric analyses are evaluated to the Reporting Level, not to half of the Reporting Level.
 -For Blank hits falling between ½ the RL and the RL (J flagged hits), the associated sample and QC data will receive a 'B-02' qualifier.
 -For Blank hits above the RL, the associated sample and QC data will receive a 'B' qualifier, per Apex Laboratories' Blank Policy.

Apex Laboratories

The results in this report apply to the samples analyzed in accordance with the chain of custody document(s) and updated by any subsequent written communications. This analytical report must be reproduced in its entirety.

Jason Woodcock, Project Manager



ANALYTICAL REPORT

Apex Laboratories, LLC

6700 S.W. Sandburg Street
Tigard, OR 97223
503-718-2323
ORELAP ID: OR100062

<u>PBS Engineering and Environmental</u> 4412 S Corbett Ave Portland, OR 97239	Project: <u>Hillsboro School District</u> Project Number: Walnut Street Transportati Project Manager: Dale Voeller	Report ID: A4F0785 - 06 13 24 1224
---	---	---

REPORTING NOTES AND CONVENTIONS (Cont.):

Blanks (Cont.):

Sample results flagged with a 'B' or 'B-02' qualifier are potentially biased high if the sample results are less than ten times the level found in the blank for inorganic analyses, or less than five times the level found in the blank for organic analyses. 'B' and 'B-02' qualifications are only applied to sample results detected above the Reporting Level.

Preparation Notes:

Mixed Matrix Samples:

Water Samples:

Water samples containing significant amounts of sediment are decanted or separated prior to extraction, and only the water portion analyzed, unless otherwise directed by the client.

Soil and Sediment Samples:

Soil and Sediment samples containing significant amounts of water are decanted prior to extraction, and only the solid portion analyzed, unless otherwise directed by the client.

Sampling and Preservation Notes:

Certain regulatory programs, such as National Pollutant Discharge Elimination System (NPDES), require that activities such as sample filtration (for dissolved metals, orthophosphate, hexavalent chromium, etc.) and testing of short hold analytes (pH, Dissolved Oxygen, etc.) be performed in the field (on-site) within a short time window. In addition, sample matrix spikes are required for some analyses, and sufficient volume must be provided, and billable site specific QC requested, if this is required. All regulatory permits should be reviewed to ensure that these requirements are being met.

Data users should be aware of which regulations pertain to the samples they submit for testing. If related sample collection activities are not approved for a particular regulatory program, results should be considered estimates. Apex Laboratories will qualify these analytes according to the most stringent requirements, however results for samples that are for non-regulatory purposes may be acceptable.

Samples that have been filtered and preserved at Apex Laboratories per client request are listed in the preparation section of the report with the date and time of filtration listed.

Apex Laboratories maintains detailed records on sample receipt, including client label verification, cooler temperature, sample preservation, hold time compliance and field filtration. Data is qualified as necessary, and the lack of qualification indicates compliance with required parameters.

Benzofluoranthene Isomer Reporting:

Due to coelutions present on the analytical column, the results reported for Benzo(b+j)fluoranthene(s) represent the concentration of both the Benzo(b)fluoranthene and Benzo(j)fluoranthene isomers. Calibration, validation and accreditation are based on the Benzo(b)fluoranthene isomer.

Apex Laboratories

The results in this report apply to the samples analyzed in accordance with the chain of custody document(s) and updated by any subsequent written communications. This analytical report must be reproduced in its entirety.

Jason Woodcock, Project Manager



ANALYTICAL REPORT

Apex Laboratories, LLC
6700 S.W. Sandburg Street
Tigard, OR 97223
503-718-2323
ORELAP ID: OR100062

Table with 3 columns: Client (PBS Engineering and Environmental), Project (Hillsboro School District), and Report ID (A4F0785 - 06 13 24 1224).

LABORATORY ACCREDITATION INFORMATION

ORELAP Certification ID: OR100062 (Primary Accreditation)
EPA ID: OR01039

All methods and analytes reported from work performed at Apex Laboratories are included on Apex Laboratories' ORELAP Scope of Certification, with the exception of any analyte(s) listed below:

Apex Laboratories

Table header with columns: Matrix, Analysis, TNI_ID, Analyte, TNI_ID, Accreditation

All reported analytes are included in Apex Laboratories' current ORELAP scope.

Secondary Accreditations

Apex Laboratories also maintains reciprocal accreditation with non-TNI states (Washington DOE), as well as other state specific accreditations not listed here.

Subcontract Laboratory Accreditations

Subcontracted data falls outside of Apex Laboratories' Scope of Accreditation. Please see the Subcontract Laboratory report for full details, or contact your Project Manager for more information.

Field Testing Parameters

Results for Field Tested data are provided by the client or sampler, and fall outside of Apex Laboratories' Scope of Accreditation.

Apex Laboratories

Handwritten signature of Jason Woodcock

The results in this report apply to the samples analyzed in accordance with the chain of custody document(s) and updated by any subsequent written communications. This analytical report must be reproduced in its entirety.

Jason Woodcock, Project Manager



ANALYTICAL REPORT

Apex Laboratories, LLC

6700 S.W. Sandburg Street
Tigard, OR 97223
503-718-2323
ORELAP ID: OR100062

PBS Engineering and Environmental
4412 S Corbett Ave
Portland, OR 97239
Project: Hillsboro School District
Project Number: Walnut Street Transportati
Project Manager: Dale Voeller
Report ID:
A4F0785 - 06 13 24 1224

A4F0785

Lead in Drinking Water Testing Program

Date Collected: 06/01/2024
School Name: Walnut Street Transportation Center - Round 1
Building: Main Building
Analysis Requested: Lead (Pb) in Drinking Water
Email Results To: voeller@pbsusa.com
Turnaround Time: 10-day

Table with 3 columns: Fixture Number, Sample Number, Room / Location. Rows 1-20 listing various fixtures and their locations like Shop - water bottle filler, Womens restroom, Mens restroom, etc.

Relinquished By/Signature: [Signature] Date/Time: 6/1/24
Received By/Signature: [Signature] Date/Time: 6/3/24 10:31

Apex Laboratories

[Signature]

Jason Woodcock, Project Manager

The results in this report apply to the samples analyzed in accordance with the chain of custody document(s) and updated by any subsequent written communications. This analytical report must be reproduced in its entirety.



ANALYTICAL REPORT

Apex Laboratories, LLC

6700 S.W. Sandburg Street
Tigard, OR 97223
503-718-2323
ORELAP ID: OR100062

PBS Engineering and Environmental 4412 S Corbett Ave Portland, OR 97239	Project: Hillsboro School District Project Number: Walnut Street Transportati Project Manager: Dale Voeller	Report ID: A4F0785 - 06 13 24 1224
--	--	--

APEX LABS COOLER RECEIPT FORM

Client: PBS Element WO#: A4E0785

Project/Project #: Walnut Street Transportation Center - Round 1
23446.191/0001

Delivery Info:

Date/time received: 4/3/24 @ 1031 By: RK

Delivered by: Apex Client ESS FedEx UPS Radio Morgan SDS Evergreen Other

From USDA Regulated Origin? Yes No

Cooler Inspection Date/time inspected: 4/3/24 @ 1141 By: JS

Chain of Custody included? Yes No

Signed/dated by client? Yes No

Contains USDA Reg. Soils? Yes No Unsure (email RegSoils)

	Cooler #1	Cooler #2	Cooler #3	Cooler #4	Cooler #5	Cooler #6	Cooler #7
Temperature (°C)	<u>1.6</u>						
Custody seals? (Y/N)	<u>N</u>						
Received on ice? (Y/N)	<u>Y</u>						
Temp. blanks? (Y/N)	<u>N</u>						
Ice type: (Gel/Real/Other)	<u>Real</u>						
Condition (In/Out):	<u>In</u>						

Cooler out of temp? (Y/N) Possible reason why: (N)

Green dots applied to out of temperature samples? Yes No

Out of temperature samples form initiated? Yes No

Sample Inspection: Date/time inspected: 6/3/24 @ 11:57 By: LN

All samples intact? Yes No Comments: _____

Bottle labels/COCs agree? Yes No Comments: no time listed on COC

COC/container discrepancies form initiated? Yes No

Containers/volumes received appropriate for analysis? Yes No Comments: _____

Do VOA vials have visible headspace? Yes No NA

Comments: _____

Water samples: pH checked: Yes No NA pH appropriate? Yes No NA pH ID: A235172

Comments: _____

Comments: _____

Labeled by: WAB

Witness: LN

Cooler Inspected by: JS

Form Y-003 R-02

Apex Laboratories

The results in this report apply to the samples analyzed in accordance with the chain of custody document(s) and updated by any subsequent written communications. This analytical report must be reproduced in its entirety.

Jason Woodcock, Project Manager