

FRANKLIN HIGH SCHOOL

ENGINEERING PLANS

31000 JOY RD.

LIVONIA, MI 48150

NTH PROJECT NO. 23001951-03

PERMITTING	
PERMIT TYPE	INFORMATION
CITY OF LIVONIA SOIL EROSION AND SEDIMENT CONTROL (SESC)	SEND THREE SETS OF PLANS, SIGNED AND SEALED, TO CITY OF LIVONIA DEPARTMENT OF ENGINEERING WITH APPLICATION AND FEE CHECK

NOTE:
CONTRACTOR IS RESPONSIBLE FOR
ALL PERMITTING FEES ASSOCIATED
WITH THIS PROJECT

LIST OF ABBREVIATIONS

AT	CENTERLINE	FM	FORCEMAN	PT	POINT
°	DEGREE OR DEGREES	FNDN	FOUNDATION	POT	POINT OF TANGENCY
Ø	DIAMETER	FO	FIBER OPTIC	PVC	POLYVINYL CHLORIDE
°	FOOT, FEET	FT	FOOT OR FEET	PVM	PAVEMENT
"	INCH, INCHES	FTG	FOOTING	PZ	PNEUMATIC PIEZOMETER
#	NUMBER OR POUND	G		R	RADIUS
±	PLUS OR MINUS	GA	GAUGE	RCP	REINFORCED CONCRETE PIPE
A		GALV	GALVANIZED	RD	ROAD
AB	ANCHOR BOLT	GMP	GROUND MONITORING POINT	REINF	REINFORCED/REINFORCEMENT
AC	ACRE(S)	GB	GRADE BEAM	REQD	REQUIRED
APPROX.	APPROXIMATE	GP	GUSSET PLATE	R.O.W.	RIGHT OF WAY
ARCH	ARCHITECTURAL	GS	GROUND SURFACE	RR	RAILROAD
ASPH	ASPHALT	GR	GRADE	RTNG	RETAINING
ASTM	AMERICAN STANDARDS AND TESTING MATERIALS	GV	GATE VALVE		
AVG	AVERAGE	GW&W	GATE VALVE AND WELL		
		GW	GATE WELL	S	
B		H		S	SOUTH
B	BOTTOM	H	HIGH/HORIZONTAL	SAN	SANITARY
BIT	BITUMINOUS	HCL	HYDRAULIC GRADE LINE	SB	SOIL BORING
BLDG	BUILDING	HOR	HORIZONTAL	SC	SHEAR CONNECTOR/SHEAR CONNECTION
BM	BENCHMARK	HP	HIGH PRESSURE	SCH	SCHEDULE
B.O.	BLOW OFF	HT	HEIGHT	SE	SOUTHEAST
BOF	BOTTOM OF FOUNDATION	I		SEC	SECTION
BP	BASE PLATE	I	INCLINOMETER	SESC	SOIL EROSION AND SEDIMENT CONTROL
BRG	BEARING	ID	INNER DIAMETER	SF	SQUARE FOOT
BRKT	BRACKET	I.E.	INVERT ELEVATION	SHT	SHEET
BSMT	BASEMENT	IN	INCH(ES)	SIM	SIMILAR
BW	BOTTOM OF WALL	INV	INVERT	SPA	SPACE/SPACING
C		J		SL	SPlice LENGTH
CB	CATCH BASIN	JST	JOIST	SOG	SLAB ON GRADE
C-C	CENTER TO CENTER	JT	JOINT	SQ	SQUARE
CF	CUBIC FEET			SS	STAINLESS STEEL
CFS	CUBIC FEET PER SECOND	L		SSP	STEEL SHEET PILE
CI	CAST IRON	L	LENGTH/LONG	STA	STATION
CIP	CAST-IN-PLACE	LBS	POUNDS	STD	STANDARD
CJ	CONTROL JOINT	LF	LINEAR FEET	STIFF	STIFFENER
CLR	CLEAR	LVL	LEVEL	STL	STEEL
CMP	CORRUGATED METAL PIPE			STM	STORM
CMU	CONCRETE MASONRY UNIT	M		STRUC	STRUCTURAL
CNJ	CONSTRUCTION JOINT	m	METER	SUP	SUPPORT
CO	CLEAN OUT	MAS	MASONRY	SW	SOUTHWEST
COL	COLUMN	MATL	MATERIAL	S/W	SIDEWALK
CONC	CONCRETE	MAX	MAXIMUM	SWM	STORMWATER MANAGEMENT
CONT	CONTINUOUS	MDOT	MICHIGAN DEPARTMENT OF TRANSPORTATION	SY	SQUARE YARDS
CONST	CONSTRUCTION	MECH	MECHANICAL	T	
COV	COVER	MH	MANHOLE	T	TOP
CP	CAP PLATE	MJ	MECHANICAL JOINT	TB	TEST BORING
CSO	COMBINED SEWER OUTFALL	MTD	MANUFACTURED TREATMENT DEVICE	T&B	TOP AND BOTTOM
CTV	CABLE TELEVISION	MTL	METAL	TC	TOP OF CONCRETE
D		MIN	MINIMUM	TEMP	TEMPORARY
DET	DETAIL	mm	MILLIMETER	THK	THICK OR THICKNESS
DI	DUCTILE IRON	MW	MONITORING WELL	TP	TURNING POINT
DIA	DIAMETER			TO	TOP OF
DIAG	DIAGONAL	N		TOF	TOP OF FOUNDATION
DIM	DIMENSION	N	NORTH	TOPO	TOPOGRAPHIC
DIP	DUCTILE IRON PIPE	NB	NORTHBOUND	TOS	TOP OF STEEL
DWG	DRAWING	NE	NORTHEAST	TOW	TOP OF WALL
DWL	DOWELS	NIC	NOT IN CONTRACT	TYP	TYPICAL
		NO	NUMBER	TW	TOP OF WALL
		NTS	NOT TO SCALE	TYP.	TYPICAL
E		NW	NORTHWEST	U	
E	EAST			UNO	UNLESS NOTED OTHERWISE
EA	EACH	O		V	
EGL	ENERGY GRADE LINE	O.C.	ON CENTER	V	VERTICAL
EJ	EXPANSION JOINT	O.D.	OUTERDIAMETER	VCP	VITREOUS CLAY PIPE
EJW	EAST JORDAN IRON WORKS	OPNG	OPENING	VERT	VERTICAL
EL	ELEVATION	OPP	OPPOSITE	VIF	VERIFY IN FIELD
ELEC	ELECTRICAL	P		W	
ENG	ENGINEERED	PC	POINT OF CURVATURE	W	WEST
EX	EXISTING	PERM	PERMANENT	W/	WITH
EXCAV	EXCAVATE(D)	PL	PLATE	WD	WIDE
EXP	EXPANSION	P/L	PROPERTY LINE	WM	WATERMAIN
F		POB	POINT OF BEGINNING	WWF	WELDED WIRE FABRIC
FF	FINISH FLOOR	POE	POINT OF ENDING		
FG	FINISHED GRADE	PR	PROPOSED	Y	
FH	FIRE HYDRANT	PSF	POUNDS PER SQUARE FOOT	YR	YEAR
FL	FLOOR	PSI	POUNDS PER SQUARE INCH		

OWNER:
Livonia Public Schools
15125 Farmington Road
Livonia, Michigan 48154

Contact: Harry Lau
Phone: 734-812-8537

ENGINEER:
NTH Consultants, LTD.
41780 Six Mile Road, Suite 200
Northville, Michigan 48168

Contact: David R. Lutz, P.E.
Phone: 248-662-2750

PROJECT DESCRIPTION:

LIVONIA PUBLIC SCHOOLS 2025 PAVING PROGRAM- FRANKLIN HIGH SCHOOL
CONSISTS OF PAVEMENT IMPROVEMENT AT FRANKLIN HIGH SCHOOL,
INCLUDING FULL-DEPTH PAVEMENT REMOVAL AND GRADING. THE PROJECT
SCOPE INCLUDES, BUT IS NOT LIMITED TO:

- 76,600 SQUARE FEET OF FULL DEPTH REMOVAL & REPLACEMENT (STANDARD DUTY ASPHALT)
- EXCAVATION AND REPLACEMENT OF SUBGRADE SOIL WITH COMPACTED STONE FILL TO A MAXIMUM DEPTH OF 18-INCHES BELOW THE BOTTOM OF THE PAVEMENT PROFILE, FOR A MAXIMUM OF 800 SQUARE-FEET OF THE FULL-DEPTH ASPHALT REPLACEMENT AREA.

Sheet List	
C-100	COVER SHEET
C-101	TOPOGRAPHIC SURVEY (BY OTHERS)
C-102	SOIL EROSION AND SEDIMENTATION CONTROL PLAN
C-103	SOIL EROSION AND SEDIMENTATION CONTROL STANDARD DETAILS
C-104	DEMOLITION PLAN
C-105	PROPOSED SITE AND GRADING PLAN

NOTES

1. TOPOGRAPHIC SURVEY WAS PERFORMED BY KEM-TEC & ASSOCIATES ON DECEMBER 2, 2016.
2. LOCATION OF UTILITIES OR OTHER STRUCTURES SHOWN ON PLANS ARE TAKEN FROM SURVEY OF RECORD. THE ENGINEER SHALL NOT BE RESPONSIBLE FOR ANY OMISSIONS OR VARIATIONS. THE CONTRACTOR SHALL CONTACT MISS DIG A MINIMUM OF THREE WORKING DAYS PRIOR TO BEGINNING CONSTRUCTION IN THE AREA OF WORK AND SHALL VERIFY ALL UNDERGROUND UTILITIES ON-SITE, PRIOR TO CONSTRUCTION.
3. FULL-DEPTH REMOVAL IS DEFINED AS REMOVING 100 PERCENT OF THE BITUMINOUS CONCRETE AND BASE WHERE NECESSARY TO ACHIEVE THE REQUIRED DESIGN PROFILE, AND PROOF ROLLING THE EXISTING AGGREGATE BASE OR SUBBASE. IF THE AGGREGATE BASE IS SOUND, INSTALL NEW BITUMINOUS CONCRETE PROFILE AS SPECIFIED (HEAVY-DUTY OR STANDARD-DUTY PROFILE). IF AGGREGATE BASE YIELDS UNDER PROOF ROLLING LOAD, AT THE DIRECTION OF THE OWNERS ENGINEER, REMOVE AGGREGATE BASE AND EXPOSE SUBGRADE SOILS. PROOF ROLL; IF THEY YIELD UNDER LOAD, REMOVE UP TO 18-INCHES OF SUBGRADE AND BACKFILL WITH COMPACTED STONE IN LIFTS NO GREATER THAN 6-INCHES. INSTALL NEW PAVEMENT OVER THE STONE (AGGREGATE BASE AND BITUMINOUS CONCRETE SECTION) AT DIRECTION OF THIRD PARTY TESTING FIRM.
4. THE CONTRACTOR SHALL AVOID DAMAGE TO THE EXISTING PAVEMENTS DESIGNATED TO REMAIN. ANY PAVEMENT DAMAGE THAT OCCURS AS A RESULT OF THE CONTRACTOR'S OPERATIONS SHALL BE REPAIRED BY THE CONTRACTOR AT NO ADDITIONAL COST TO THE OWNER.
5. CONTRACTOR TO INSPECT ALL MANHOLE STRUCTURES DURING CONSTRUCTION AND INFORM THE OWNER OF ANY STRUCTURES IN POOR CONDITION.
6. CONTRACTOR SHALL NOTIFY THE CITY OF LIVONIA'S ENGINEERING DEPARTMENT 48 HOURS PRIOR TO ANY WORK IN THE RIGHT-OF-WAY. INSPECTION AND APPROVAL IS REQUIRED AFTER SETTLING FORMS, BUT PRIOR TO POURING CONCRETE, WITHIN THE CITY'S RIGHT-OF-WAY.

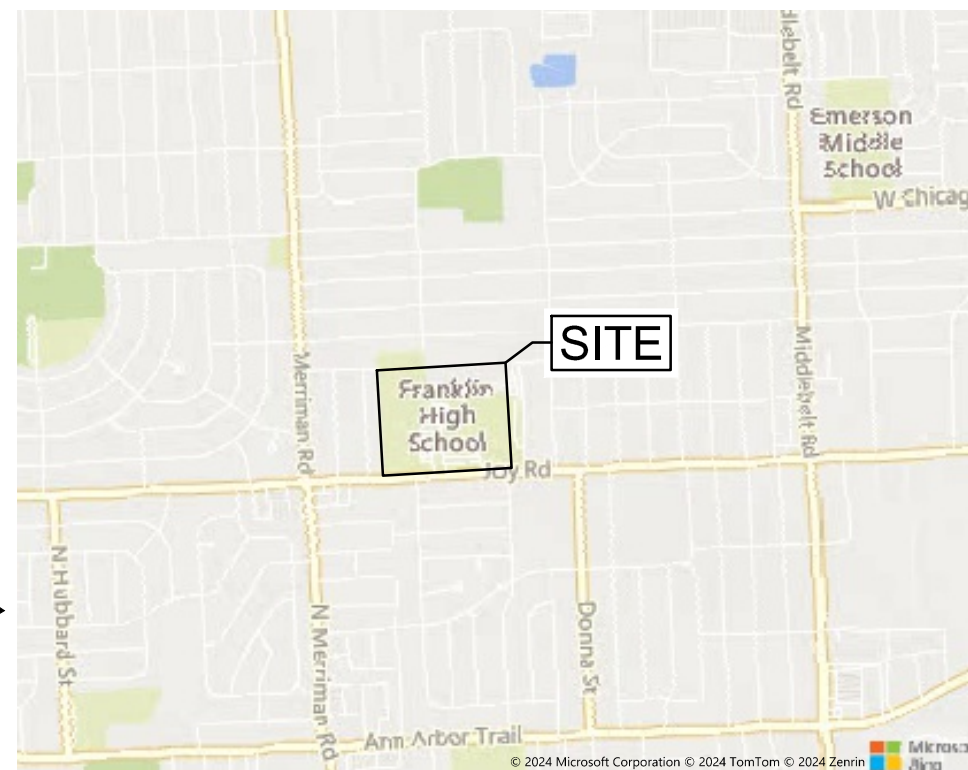
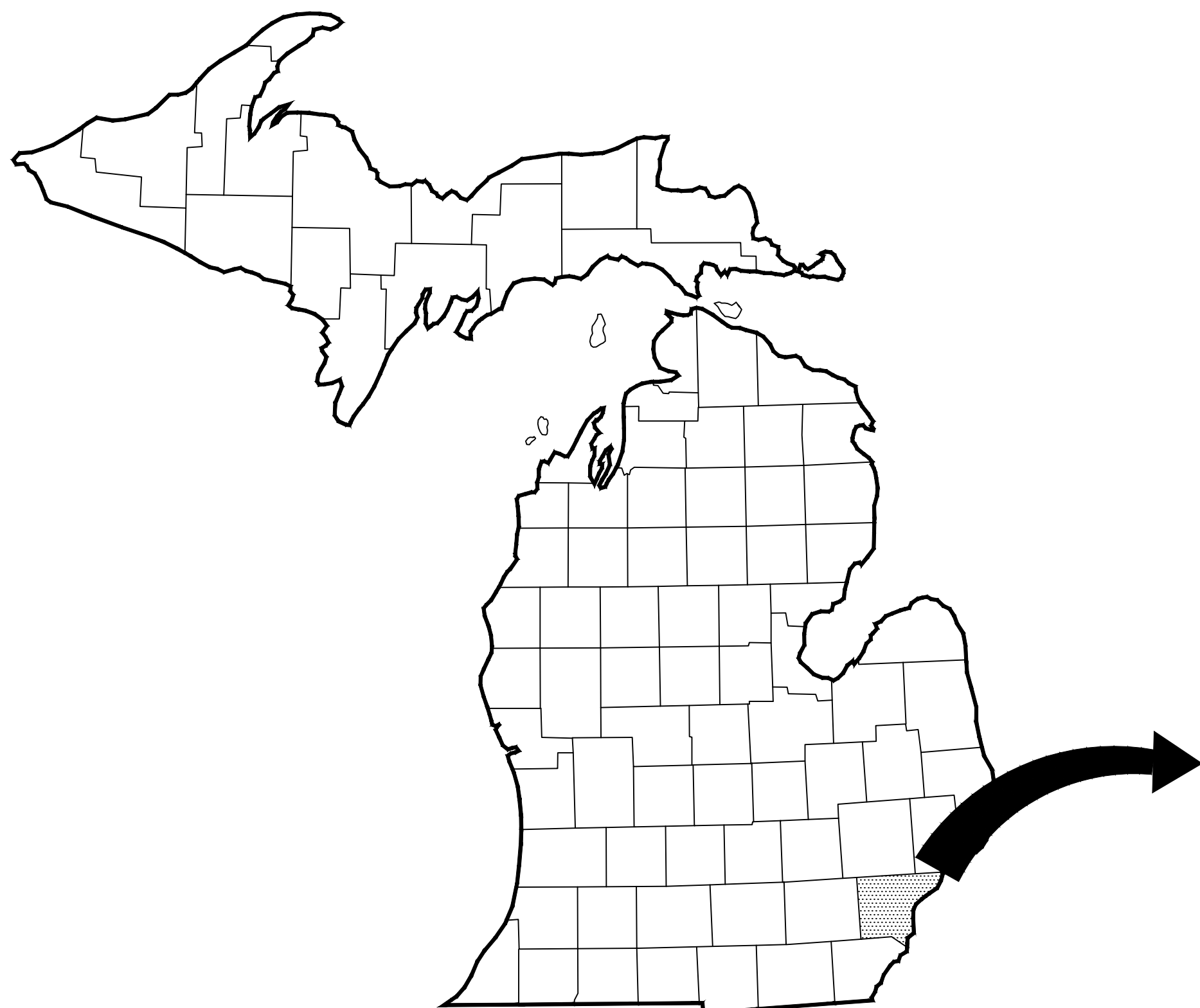

LOCATION MAP
NO SCALE

BULLETIN NO. 1

BID ALTERNATE



NTH Consultants, Ltd.

Infrastructure Engineering
Environmental Services
Facilities Engineering

www.nthconsultants.com

Northville, MI Lansing, M
Detroit, MI Grand Rapids, M
Livonia, MI (Laboratory)



SEAL/STAMP:



REVISION BLOCK	
REV	DATE: DESCRIPTION
	2025-02-13: REVISIONS TO SIGNAGE PER PRE-BID WALKTHROUGH COMMENTS

SUBMITTAL LOG	
DATE	PACKAGE NAME

PROJECT NAME

LIVONIA PUBLIC SCHOOLS
2025 PAVING PROGRAM -
FRANKLIN HIGH SCHOOL

PROJECT LOCATION

31000 JOY ROAD
LIVONIA, MICHIGAN 48150

DESIGNED BY: KBH	NTH PROJECT NO.: 23001951
DRAWN BY: KBH	SHEET SIZE: ARCH D (24"x36")
CHECKED BY: DRL	DATE: 2/13/2025

CAD FILE NAME:
23001951-02-COV

SHEET TITLE:
COVER SHEET

SHEET NUMBER:

C-100

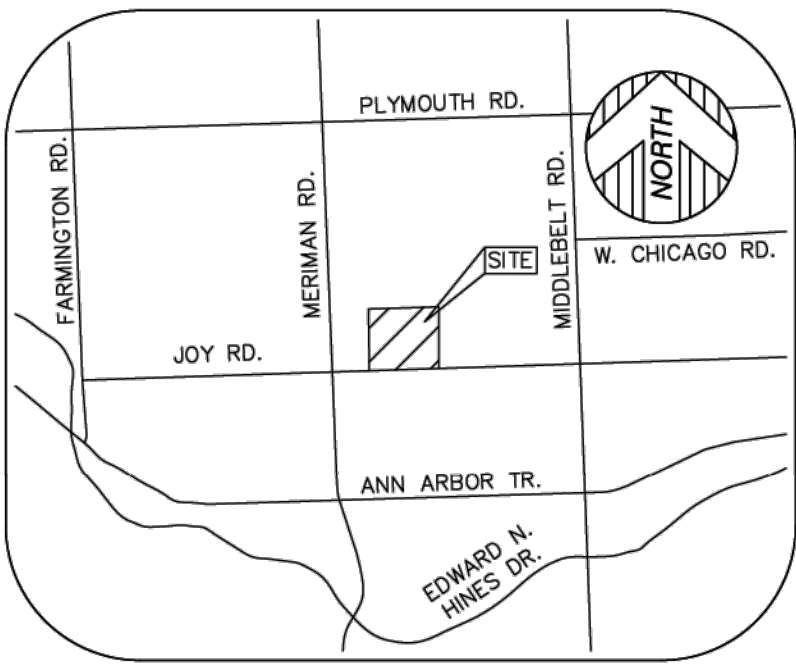

VICINITY MAP
(NOT TO SCALE)

PARKING

HANDICAP PARKING = 0 STALLS
STANDARD PARKING = 285 STALLS
SHOWN

BENCHMARK

SITE BENCHMARK #1
CHISELED "X" ON BOLT OF L.P. BASE,
±63' W OF W E/CURB ISLAND
ELEVATION = 637.09' (NAVD 88)

SITE BENCHMARK #2
CHISELED "X" ON E BASE OF L.P.
±33' NE OF SE CORNER OF CONCESSIONS BLDG
±192' N OF N EDGE OF JOY RD
ELEVATION = 636.74' (NAVD 88)

SURVEYOR'S NOTE

THE UNDERGROUND UTILITIES SHOWN HAVE BEEN LOCATED FROM FIELD SURVEY INFORMATION AND EXISTING DRAWINGS. THE SURVEYOR MAKES NO GUARANTEES THAT THE UNDERGROUND UTILITIES SHOWN COMPRISE ALL SUCH UTILITIES IN THE AREA, EITHER IN SERVICE OR ABANDONED. THE SURVEYOR FURTHER DOES NOT WARRANT THAT THE UNDERGROUND UTILITIES SHOWN ARE IN THE EXACT LOCATION INDICATED ALTHOUGH HE DOES CERTIFY THAT THEY ARE LOCATED AS ACCURATELY AS POSSIBLE FROM INFORMATION AVAILABLE. THE SURVEYOR HAS NOT PHYSICALLY LOCATED THE UNDERGROUND UTILITIES OTHER THAN THE STRUCTURE INVENTORY SHOWN HEREON.

LEGEND

- W WATER LINE
- G GAS LINE
- E ELECTRIC LINE
- ★ LIGHTPOST/LAMP POST
- PARKING
- EDGE OF CONCRETE (CONC.)
- EDGE OF ASPHALT (ASPH.)
- ASPHALT

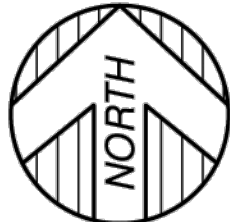
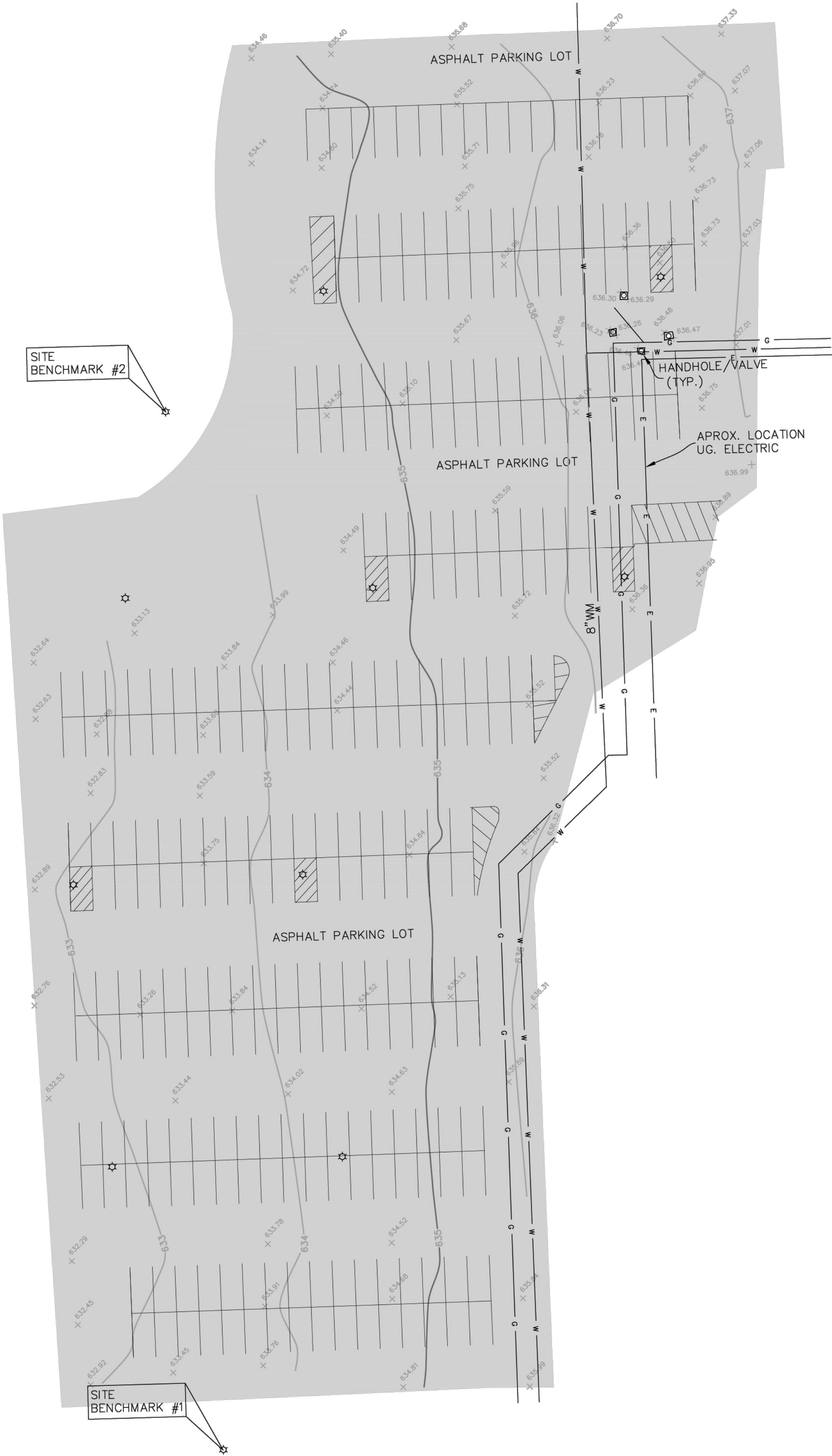

GRAPHIC SCALE

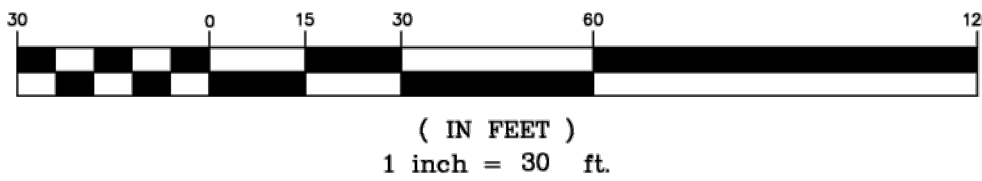

PROPERTY DESCRIPTION

LAND SITUATED IN THE CITY OF LIVONIA, COUNTY OF WAYNE, STATE OF MICHIGAN, AND DESCRIBED AS FOLLOWS:

PART OF THE SOUTHWEST 1/4 OF SECTION 35, TOWN 1 SOUTH, RANGE 9 EAST, DESCRIBED AS: BEGINNING AT A POINT ON THE SOUTH LINE OF SAID SECTION 35, SOUTH 89 DEGREES, 51 MINUTES, 30 SECONDS EAST 830 FEET FROM THE SOUTHWEST CORNER OF SECTION 35, TOWN 1 SOUTH, RANGE 9 EAST; THENCE RUNNING INTO THE NEXT 3 COURSES AND DISTANT ALONG THE EAST SIDE OF MERRI-JOY SUBDIVISION, AS RECORDED IN LIBER 76, PAGE 9; DUE NORTH 1197.93 FEET; THENCE NORTH 89 DEGREES, 51 MINUTES, 00 SECONDS WEST 19.00 FEET; THENCE DUE NORTH 120 FEET; THENCE ALONG THE SOUTH LINE OF GRANDON WOODS SUBDIVISION, AS RECORDED IN LIBER 73, PAGE 8, OF PLATS, SOUTH 89 DEGREES, 51 MINUTES, 00 SECONDS EAST 1141.76 FEET; THENCE SOUTH 0 DEGREES, 16 MINUTES, 27 SECONDS WEST 1317.77 FEET; THENCE ALONG SOUTH LINE OF SECTION 35 AND CENTER LINE OF JOY ROAD, NORTH 89 DEGREES, 51 MINUTES, 30 SECONDS WEST 1116.45 FEET TO THE POINT OF BEGINNING. EXCEPT THE EAST 30 FEET THEREOF AND EXCEPT THE SOUTH 60 FEET THEREOF.

THE WEST 10 ACRES OF THE EAST 20 ACRES OF THE SOUTH 1/2 OF THE SOUTHWEST 1/4 OF SECTION 35, DESCRIBED AS: BEGINNING AT A POINT ON THE SOUTH LINE OF SECTION 35, BEGINNING SOUTH 88 DEGREES, 17 MINUTES, 50 SECONDS WEST 330.48 FEET FROM THE SOUTH 1/4 CORNER OF SECTION 35; THENCE SOUTH 88 DEGREES, 17 MINUTES, 50 SECONDS WEST ALONG THE SOUTH LINE OF SECTION 35, 330.48 FEET TO A POINT; THENCE NORTH 1 DEGREE, 32 MINUTES, 10 SECONDS WEST 1318.10 FEET TO A POINT; THENCE NORTH 88 DEGREES, 17 MINUTES, 50 SECONDS EAST 330.48 FEET TO A POINT; THENCE SOUTH 1 DEGREE, 32 MINUTES, 10 SECONDS EAST 1318.10 FEET TO THE POINT OF BEGINNING. EXCEPT THE EAST 30 FEET THEREOF AND EXCEPT THE SOUTH 60 FEET THEREOF.

TITLE REPORT NOTE

A CURRENT TITLE POLICY HAS NOT BEEN FURNISHED AT TIME OF SURVEY, THEREFORE EASEMENTS AND/OR ENCUMBRANCES AFFECTING SUBJECT PARCEL MAY NOT BE SHOWN.

SURVEYOR'S CERTIFICATION

I HEREBY CERTIFY THAT I HAVE SURVEYED THE PROPERTY HEREIN DESCRIBED. THE ELEVATIONS SHOWN HEREON ARE BASED ON A FIELD SURVEY AND THE DRAWING HEREON DELINEATED IS A CORRECT REPRESENTATION OF THE SAME.

Anthony T. Sycko, Jr., P.S.
Professional Surveyor
Michigan License No. 47976
22556 GRATIOT AVE., EASTPOINTE, MI 48021
TSycko@kemttec-survey.com



PARTIAL TOPOGRAPHIC SURVEY

PREPARED FOR: LIVONIA PUBLIC SCHOOLS
31000 JOY RD, LIVONIA, MICHIGAN,
PART OF SECTION 35,
TOWN 1 SOUTH, RANGE 9 EAST

PROFESSIONAL ENGINEERING
SURVEYING & ENVIRONMENTAL
SERVICES
A GROUP OF COMPANIES
KEM-TEC
Eastpointe
(800) 285-7222
Detroit
(313) 758-0877
Ann Arbor
(734) 994-0888
Grand Blanc
(800) 694-0001
www.kemttecgroupofcompanies.com

DATE	BY	REVISION	DESCRIPTION
12/05/24	RDM		
12/05/24	ATS		
DECEMBER 05, 2024			
17-00058			

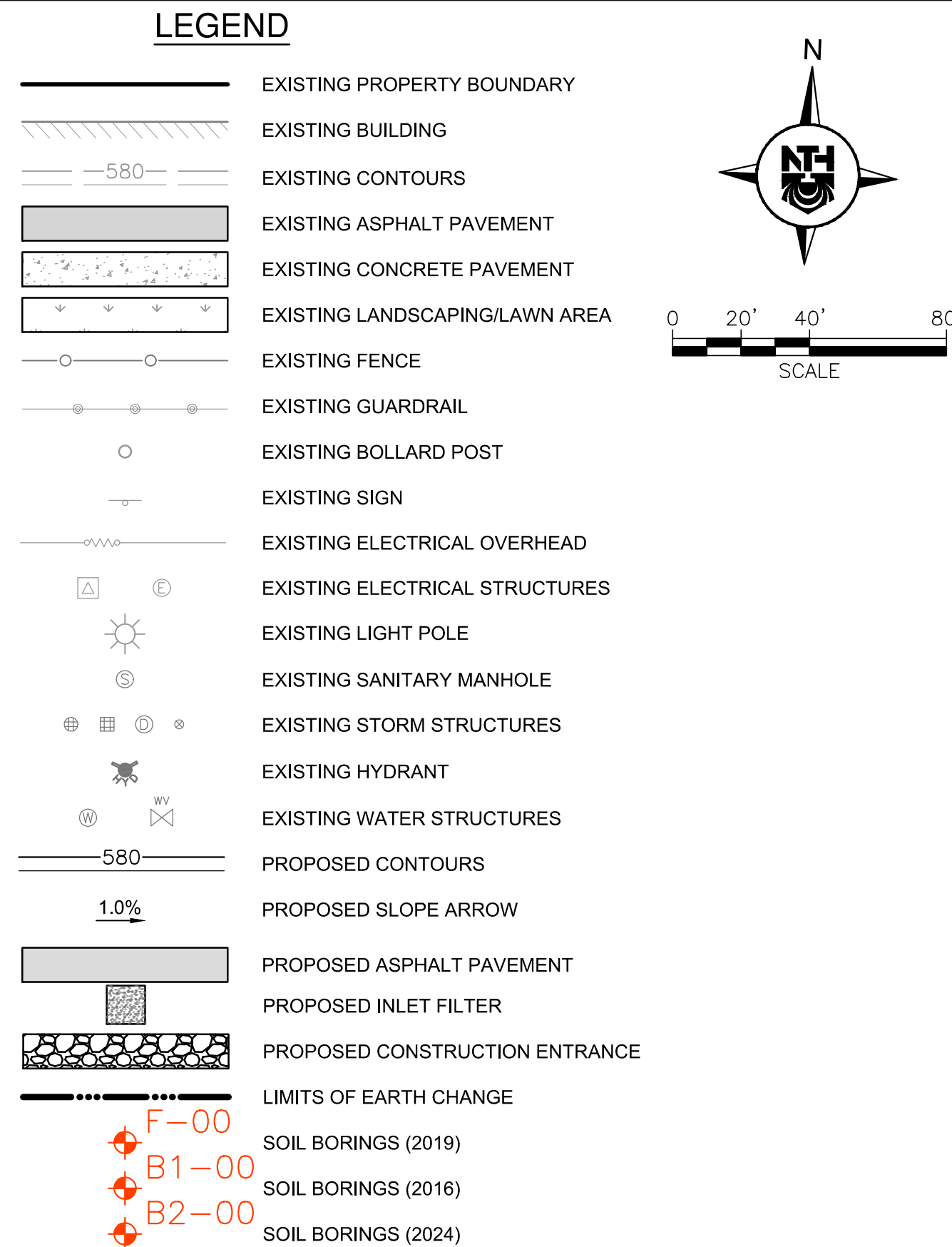
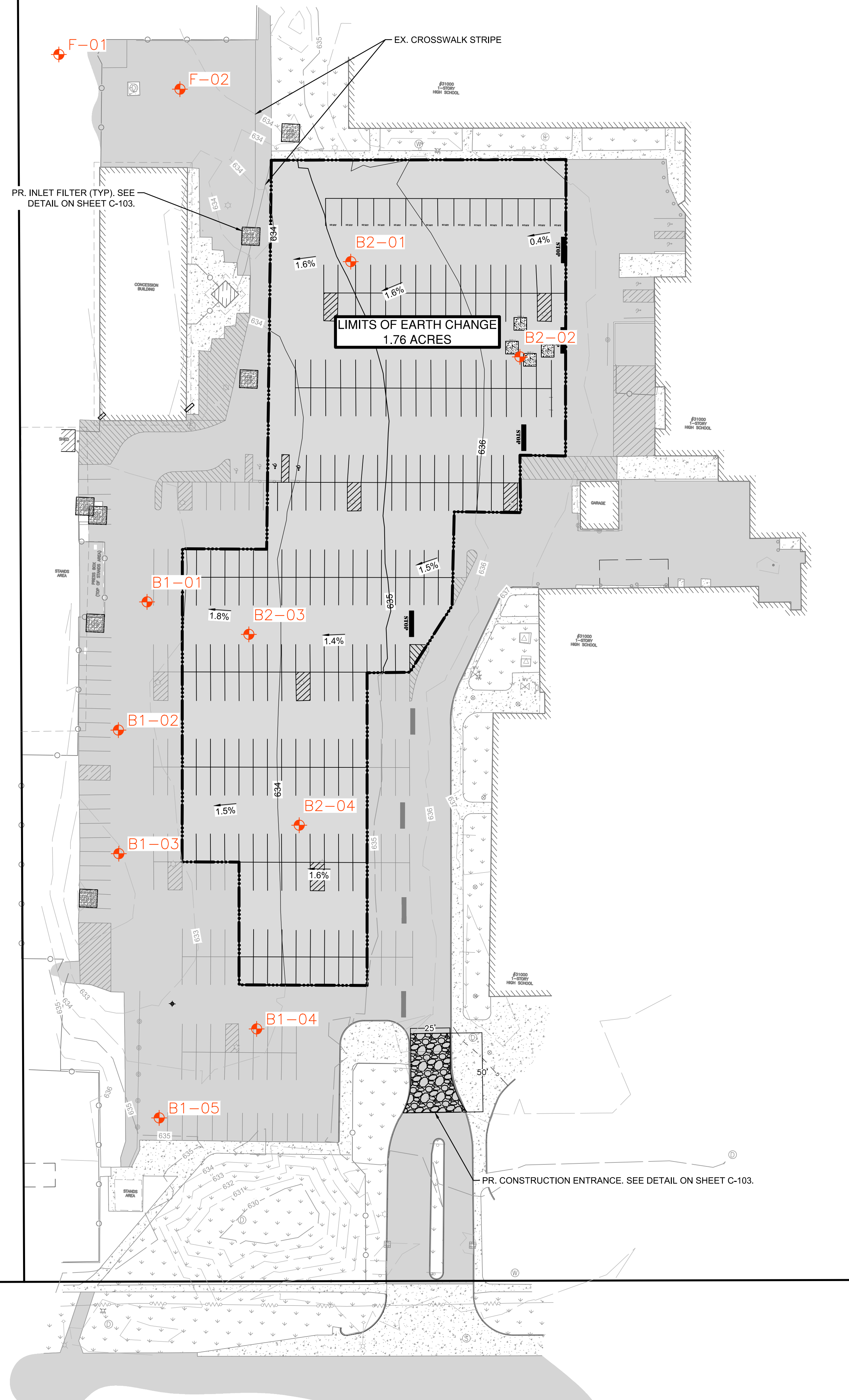

C-102



-

CITY OF LIVONIA
Department of Public Works, Engineering Division
333000 Civic Center Drive
Livonia, Michigan 48154
(734) 466-2570, (734) 466-2195 Fax

SOIL EROSION & SEDIMENTATION CONTROL

1

JOB No.	REV.	DATE	DATE: 1/23/2003
	REVISIONS:		SHEET 1 OF 1
	2/2007	CADD: dl	
	2/2007	Check Dam Responsibility Note	
	3/2013	Check Dam Detail Added	
			ENG: tz
			PM:
			TECH:
			Soil Erosion Detail dwg
			FRM:



NTH Consultants, Ltd.

Infrastructure Engineering
Environmental Services
Facilities Engineering

www.nthconsultants.com

Northville, MI Lansing, MI
Detroit, MI Grand Rapids, MI
Livonia, MI (Laboratory)



3 WORKING DAYS

BEFORE YOU DIG CALL MISS DIG®

1-800-482-7171

For free location of public utility lines.
ALTERNATE NUMBER (811)
COLOR CODES FOR UTILITY LOCATING:

Yellow	OIL & GAS	Blue	WATER
Orange	PHONE & CATV	Brown	STORM DRAIN
Red	ELECTRIC	Green	SEWER
		Pink	SURVEYING

IF YOU ARE GOING TO WORK NEAR OVERHEAD WIRES... CALL MISS DIG



SEAL/STAMP:



REVISION BLOCK	
REV	DATE: DESCRIPTION
	2025-02-13: REVISIONS TO SIGNAGE PER PRE-BID WALKTHROUGH
	COMMENTS

SUBMITTAL LOG	
DATE	PACKAGE NAME

PROJECT NAME:
LIVONIA PUBLIC SCHOOLS
2025 PAVING PROGRAM -
FRANKLIN HIGH SCHOOL

PROJECT LOCATION:
31000 JOY ROAD
LIVONIA, MICHIGAN 48150

DESIGNED BY: KBH	NTH PROJECT NO.: 23001951
DRAWN BY: KBH	SHEET SIZE: ARCH D (24"x36")
CHECKED BY: DRL	DATE: 2/13/2025

SHEET TITLE:

SOIL EROSION AND
SEDIMENTATION CONTROL
STANDARD DETAILS

SHEET NUMBER:

C-103

J:\2023\23001951\production\set\1\pave\pave.dwg Plot Date: 2/13/2025 3:22 PM by Kaito Houston

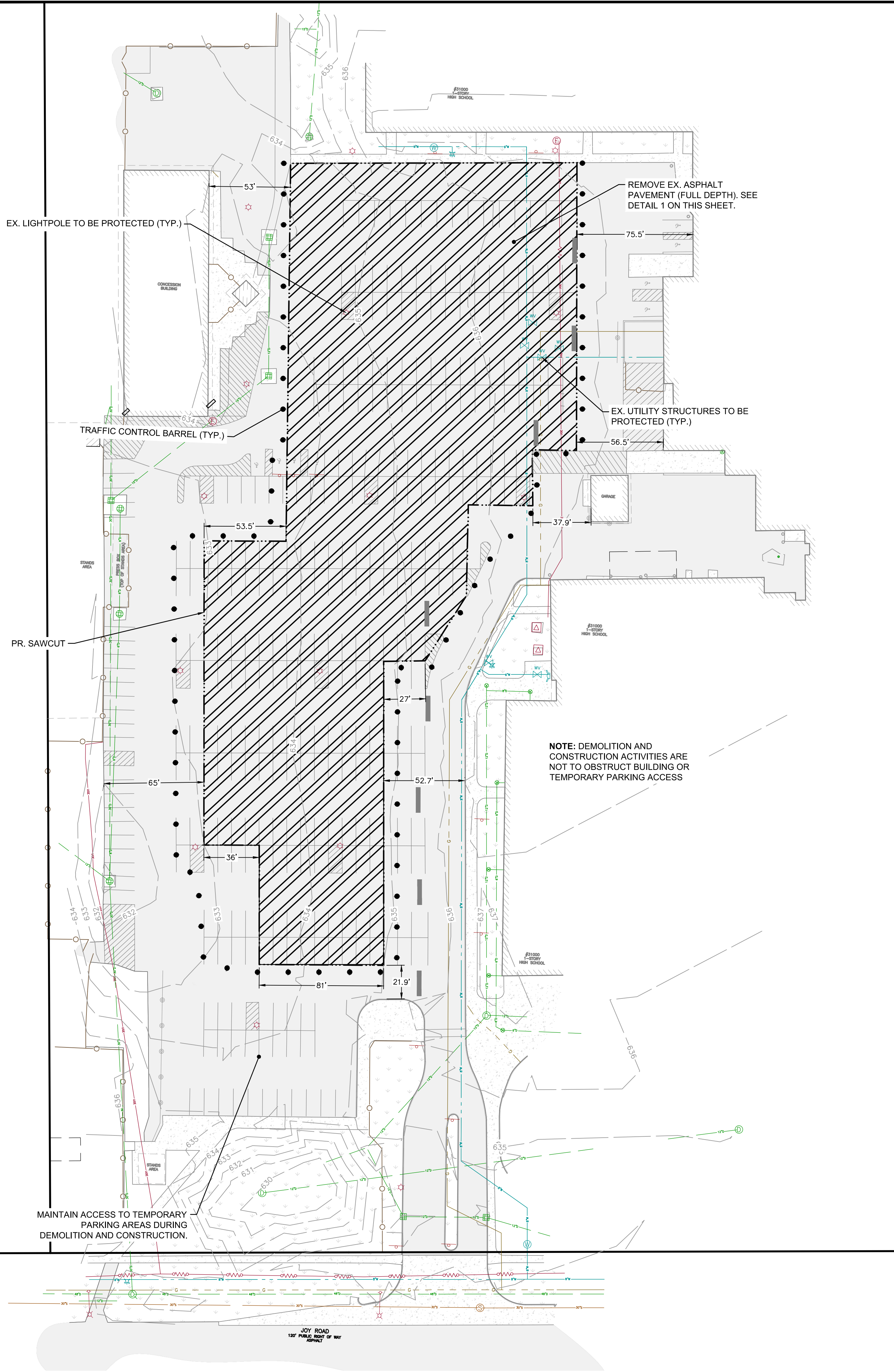

LEGEND

- EXISTING PROPERTY BOUNDARY
- EXISTING BUILDING
- EXISTING CONTOURS
- EXISTING ASPHALT PAVEMENT
- EXISTING CONCRETE PAVEMENT
- EXISTING LANDSCAPING/LAWN AREA
- EXISTING FENCE
- EXISTING GUARDRAIL
- EXISTING BOLLARD POST
- EXISTING SIGN
- EXISTING ELECTRICAL OVERHEAD
- EXISTING ELECTRICAL UNDERGROUND
- EXISTING ELECTRICAL STRUCTURES
- EXISTING LIGHT POLE
- EXISTING GAS UNDERGROUND
- EXISTING SANITARY SEWER
- EXISTING SANITARY MANHOLE
- EXISTING STORM SEWER
- EXISTING STORM STRUCTURES
- EXISTING TELEPHONE UNDERGROUND
- EXISTING WATER MAIN
- EXISTING HYDRANT
- EXISTING WATER STRUCTURES
- PROPOSED FULL DEPTH ASPHALT REMOVAL
- SAWCUT
- TRAFFIC CONTROL BARREL

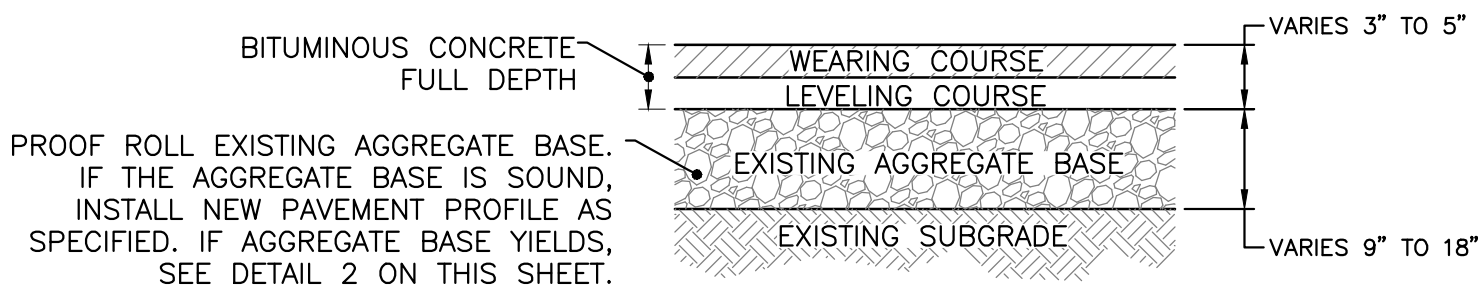
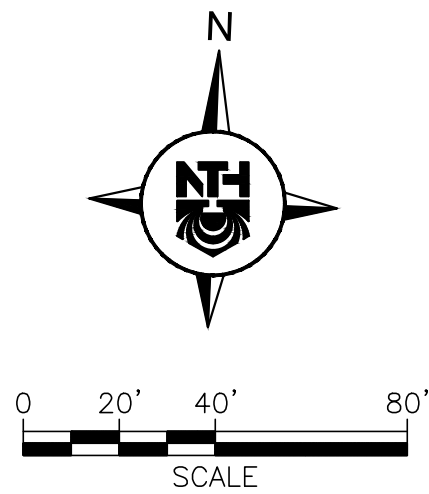

1 FULL DEPTH ASPHALT REMOVAL DETAIL NOT TO SCALE

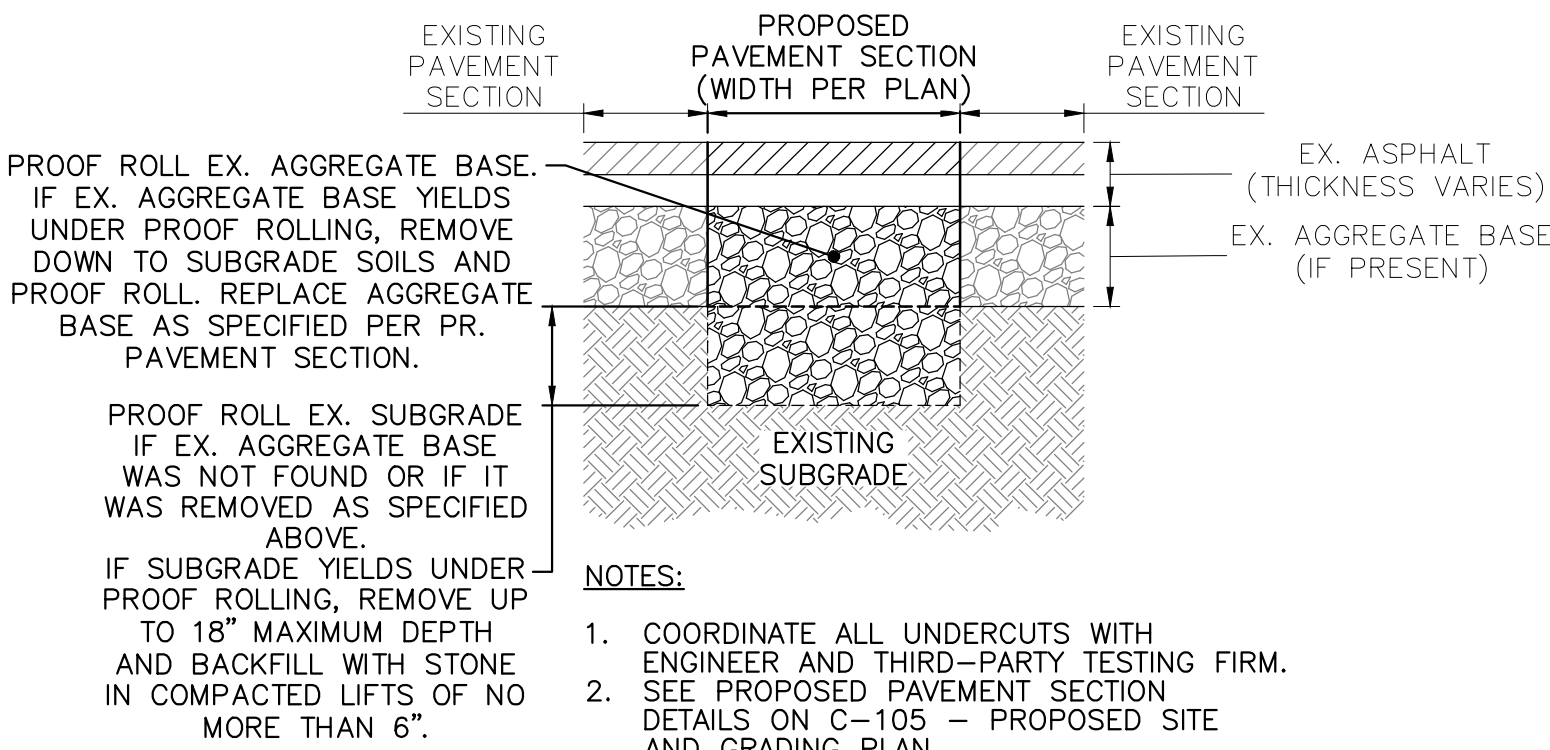

2 UNDERCUT DETAIL NOT TO SCALE

DEMOLITION NOTES

- LANDSCAPING SHALL NOT BE REMOVED UNLESS SPECIFIED ON PLANS. CONTRACTOR SHALL PROTECT AS NECESSARY DURING DURATION OF CONSTRUCTION.
- LOCATION OF UTILITIES OR OTHER STRUCTURES SHOWN ON PLANS ARE TAKEN FROM SURVEY OF RECORD. THE ENGINEER SHALL NOT BE RESPONSIBLE FOR ANY OMISSIONS OR VARIATIONS. THE CONTRACTOR SHALL CONTACT MISS DIG A MINIMUM OF THREE WORKING DAYS PRIOR TO BEGINNING CONSTRUCTION IN THE AREA OF WORK AND SHALL VERIFY ALL UNDERGROUND UTILITIES ON -SITE, PRIOR TO CONSTRUCTION.
- UTILITIES AND ASSOCIATED STRUCTURES SHALL NOT BE REMOVED UNLESS SPECIFIED ON PLANS. CONTRACTOR SHALL FIELD VERIFY AND PROTECT ALL EXISTING UTILITY STRUCTURES AND SEWERAGE DURING THE DURATION OF CONSTRUCTION. PROVIDE FOR TEMPORARY BYPASS OF SEWERAGE AS REQUIRED TO FACILITATE CONSTRUCTION.
- ALL STORM AND SANITARY SEWERAGE AND ASSOCIATED STRUCTURES SHALL BE CLEANED AND OPERABLE PRIOR TO CONSTRUCTION AND AGAIN AFTER CONSTRUCTION IS COMPLETE. CONTRACTOR SHALL PROVIDE A LETTER DETAILING THAT ALL STORM AND SANITARY STRUCTURES AND SEWERS HAVE BEEN CLEANED AND ARE FREE FLOWING.
- ALL EXISTING ASPHALT TO BE REMOVED SHALL BE MILLED AND TRANSPORTED OFF-SITE TO LOCATIONS SUITABLE FOR PROPER DISPOSAL IN ACCORDANCE WITH ALL APPLICABLE ENVIRONMENTAL REGULATIONS.
- ALL EXCESS MATERIALS ARE TO BE REMOVED FROM THE SITE AND DISPOSED OF IN COMPLIANCE WITH APPLICABLE ENVIRONMENTAL REGULATIONS.
- ALL EXISTING SIGNAGE SHALL BE PROTECTED UNLESS OTHERWISE INDICATED ON PLANS.
- AT LEAST ONE ENTRY AND EXIT TO PARKING LOTS TO REMAIN OPEN DURING CONSTRUCTION AT ALL TIMES.

BULLETIN NO. 1

BID ALTERNATE

NTH Consultants, Ltd.
Infrastructure Engineering
Environmental Services
Facilities Engineering
www.nthconsultants.com

Northville, MI Lansing, MI
Detroit, MI Grand Rapids, MI
Livonia, MI (Laboratory)

3 WORKING DAYS
BEFORE YOU DIG
CALL MISS DIG
1-800-482-7171
For the location of public utility lines.
ALTERNATE NUMBER (811)
YOUR CODES FOR UTILITY LOCATING:

Yellow	Oil & Gas	Blue	Water
Orange	Phone & Cable	Green	Storm Drain
Red	Electric	Brown	Sewer
		Pink	Survey

IF YOU ARE GOING TO WORK NEAR OVERHEAD WIRES - CALL MISS DIG

SEAL/STAMP:

KEY MAP: NORTH ARROW:

REVISION BLOCK	
REV	DATE: DESCRIPTION
1	2025-02-13: REVISIONS TO SIGNAGE PER PRE-BID WALKTHROUGH COMMENTS

SUBMITTAL LOG	
DATE	PACKAGE NAME

PROJECT NAME:
**LIVONIA PUBLIC SCHOOLS
2025 PAVING PROGRAM -
FRANKLIN HIGH SCHOOL**

PROJECT LOCATION:
**31000 JOY ROAD
LIVONIA, MICHIGAN 48150**

DESIGNED BY: KBH	NTH PROJECT NO.: 23001951
DRAWN BY: KBH	SHEET SIZE: ARCH D (24"x36")
CHECKED BY: DRL	DATE: 2/13/2025

CAD FILE NAME:
23001951-02-DEMO

SHEET TITLE:
DEMOLITION PLAN

SHEET NUMBER:
C-104

3/2023/23001951/production Phase 2/1/2023 3:22 PM by Metro Houston

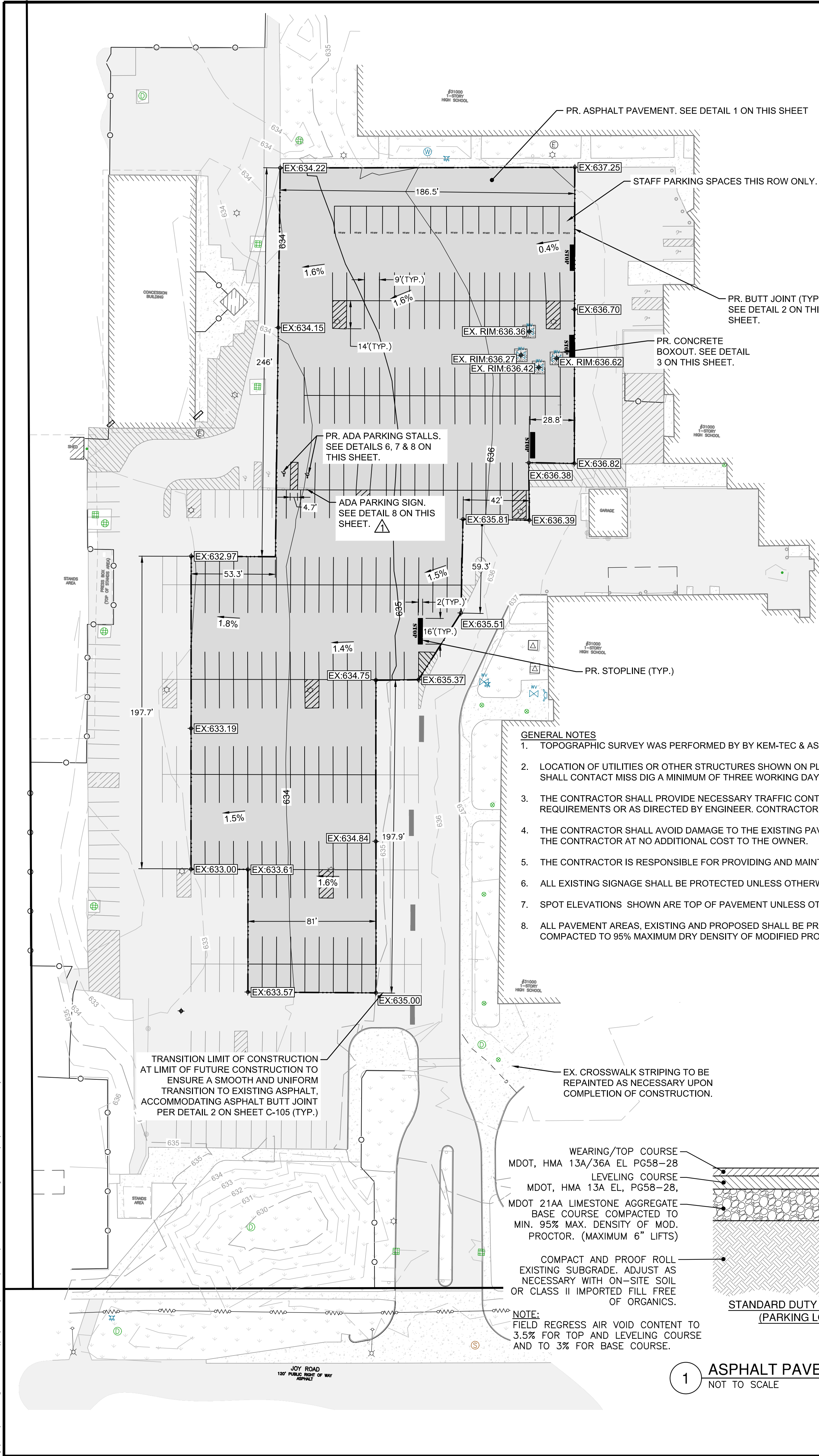

- LEGEND**
- EXISTING PROPERTY BOUNDARY
 - EXISTING BUILDING
 - EXISTING CONTOURS
 - EXISTING ASPHALT PAVEMENT
 - EXISTING CONCRETE PAVEMENT
 - EXISTING LANDSCAPING/LAWN AREA
 - EXISTING FENCE
 - EXISTING GUARDRAIL
 - EXISTING BOLLARD POST
 - EXISTING SIGN
 - EXISTING ELECTRICAL OVERHEAD
 - EXISTING ELECTRICAL STRUCTURES
 - EXISTING LIGHT POLE
 - EXISTING SANITARY MANHOLE
 - EXISTING STORM STRUCTURES
 - EXISTING HYDRANT
 - EXISTING WATER STRUCTURES
 - PROPOSED CONTOURS
 - PROPOSED SLOPE ARROW
 - PROPOSED SPOT ELEVATION
 - EXISTING SPOT ELEVATION
 - EXISTING RIM SPOT ELEVATION
 - PROPOSED ASPHALT PAVEMENT

PAVEMENT MARKING TABLE			
MARKING	PAINT SPEC	SIZE	COATS/COLOR
PARKING STRIPES	SECTION 32 1723.13	4"	2/WHITE
ADA PARKING STRIPES		4"	2/BLUE
ADA BUFFER STRIPING		4"x24" CENTER TO CENTER SPACING	2/BLUE
STOP/YIELD LINE		24"	2/WHITE
LETTERING		12" WIDTH X 18" TALL, 4" SPACING BETWEEN NUMBERS	2/WHITE

GENERAL NOTES

- TOPOGRAPHIC SURVEY WAS PERFORMED BY BY KEM-TEC & ASSOCIATES ON DECEMBER 2, 2016.
- LOCATION OF UTILITIES OR OTHER STRUCTURES SHOWN ON PLANS ARE TAKEN FROM SURVEY OF RECORD. THE ENGINEER SHALL NOT BE RESPONSIBLE FOR ANY OMISSIONS OR VARIATIONS. THE CONTRACTOR SHALL CONTACT MISS DIG A MINIMUM OF THREE WORKING DAYS PRIOR TO BEGINNING CONSTRUCTION IN THE AREA OF WORK AND SHALL VERIFY ALL UNDERGROUND UTILITIES ON-SITE, PRIOR TO CONSTRUCTION.
- THE CONTRACTOR SHALL PROVIDE NECESSARY TRAFFIC CONTROL AND SIGNAGE TO MAINTAIN ACCESS TO AND WITHIN PROPERTY THROUGHOUT CONSTRUCTION IN ACCORDANCE WITH LOCAL, COUNTY AND STATE REQUIREMENTS OR AS DIRECTED BY ENGINEER. CONTRACTOR SHALL PROVIDE APPROPRIATE BARRICADES AROUND WORK AREAS FOR PEDESTRIAN AND VEHICULAR SAFETY.
- THE CONTRACTOR SHALL AVOID DAMAGE TO THE EXISTING PAVEMENTS DESIGNATED TO REMAIN. ANY PAVEMENT DAMAGE THAT OCCURS AS A RESULT OF THE CONTRACTOR'S OPERATIONS SHALL BE REPAIRED BY THE CONTRACTOR AT NO ADDITIONAL COST TO THE OWNER.
- THE CONTRACTOR IS RESPONSIBLE FOR PROVIDING AND MAINTAINING ALL NECESSARY CONSTRUCTION STAKING AND GRADE AND ALIGNMENT CONTROLS.
- ALL EXISTING SIGNAGE SHALL BE PROTECTED UNLESS OTHERWISE INDICATED ON PLANS.
- SPOT ELEVATIONS SHOWN ARE TOP OF PAVEMENT UNLESS OTHERWISE INDICATED.
- ALL PAVEMENT AREAS, EXISTING AND PROPOSED SHALL BE PROOF ROLLED WITH A FULLY LOADED TANDEM DUMP TRUCK PRIOR TO PAVING. ANY UNSTABLE SUBGRADE SHALL BE REMOVED AND REPLACED WITH FILL COMPACTED TO 95% MAXIMUM DRY DENSITY OF MODIFIED PROCTOR.

1 ASPHALT PAVEMENT DETAIL
NOT TO SCALE

8 HANDICAPPED PARKING SIGN
NOT TO SCALE

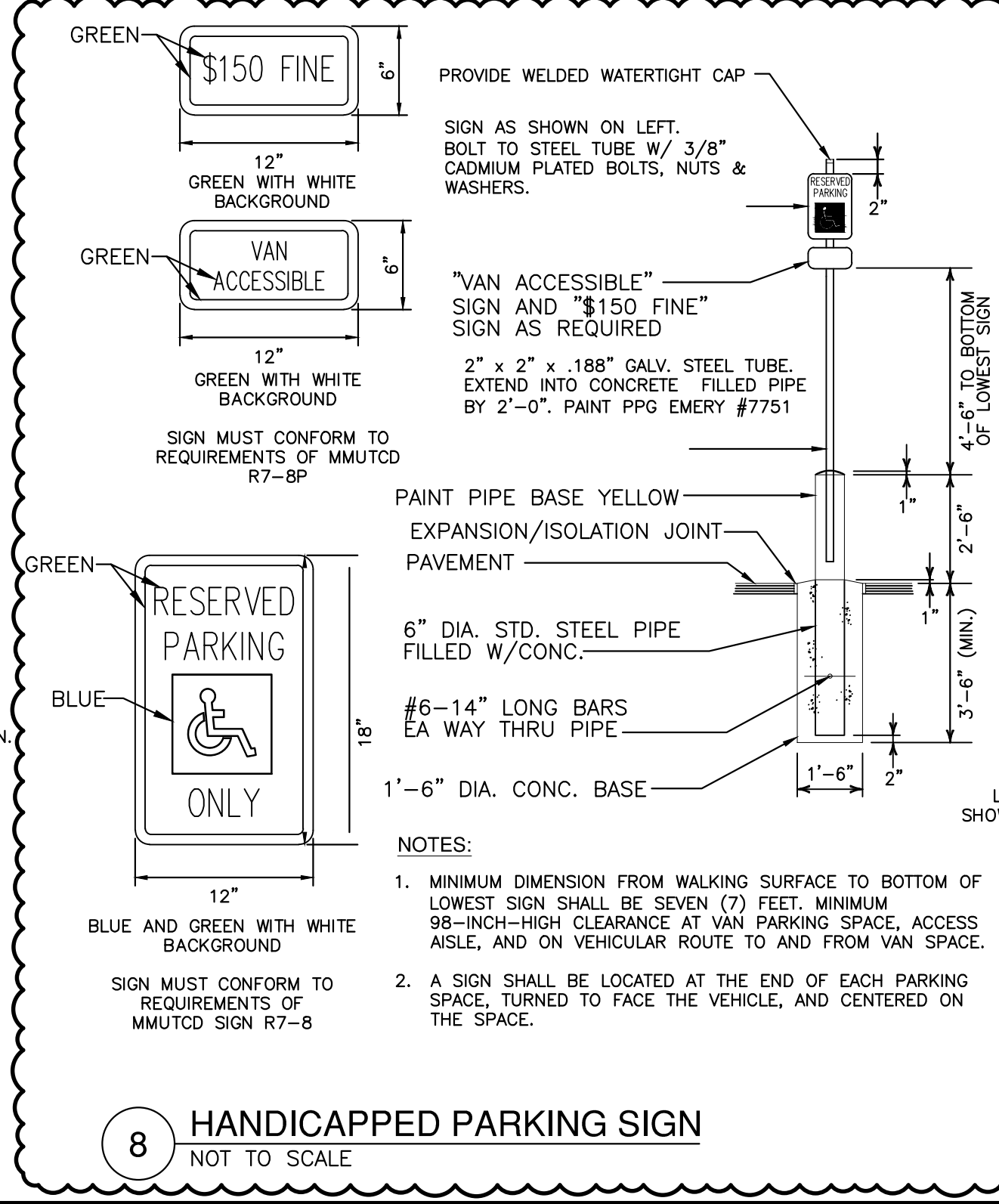

NOTES

- BOXOUT SHOULD BE CONSTRUCTED PARALLEL TO THE EXISTING TRAFFIC FLOW DIRECTION. ADD UNDERDRAIN IF NONE PRESENT.
- HOT-POURED SEALANT SHALL BE PLACED AROUND OUTSIDE OF CATCH BASIN/MANHOLE RIM AND EXTENTS OF CONCRETE FOR EX. AND PR. CONCRETE BOXOUTS.

5 CONCRETE BOXOUT
NOT TO SCALE

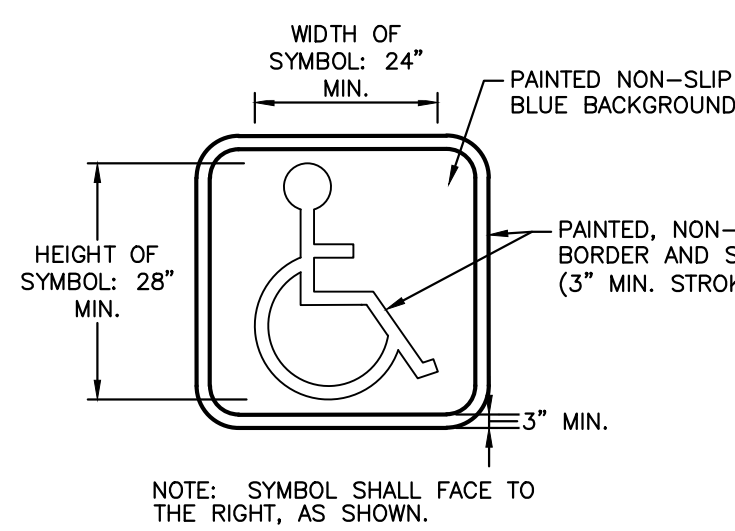

6 ACCESSIBLE PARKING SPACE MARKING SYMBOL
NOT TO SCALE

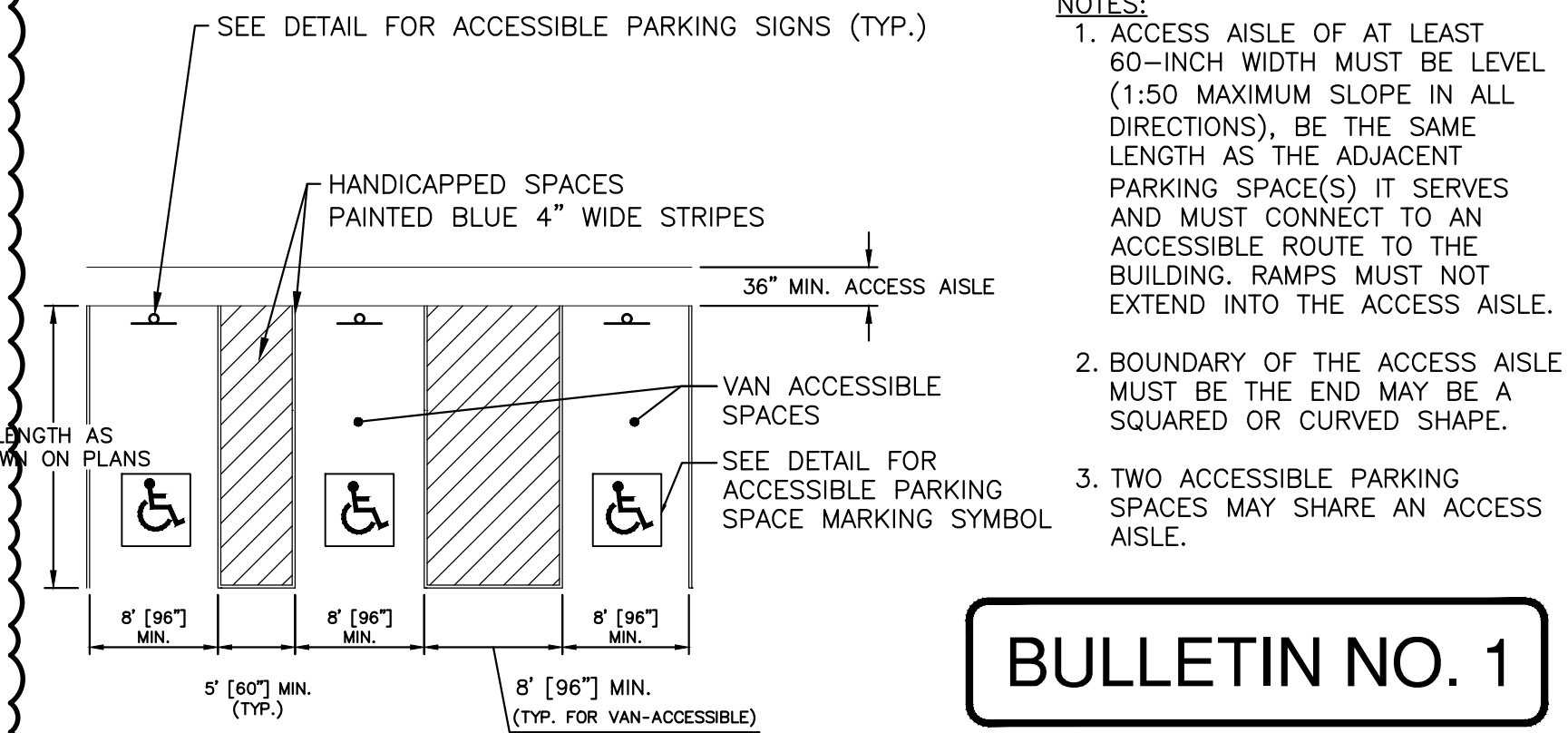

BULLETIN NO. 1

BID ALTERNATE

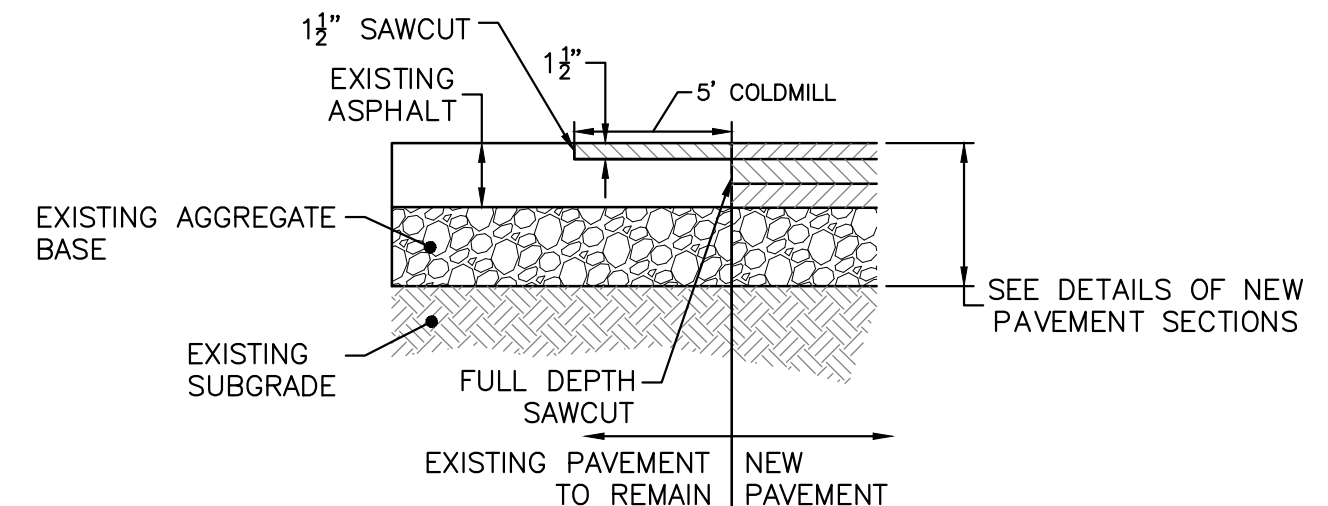
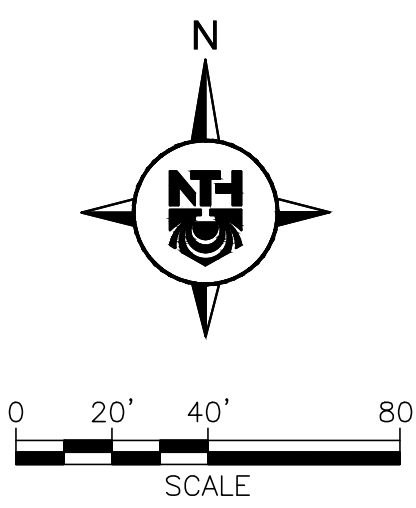

2 BUTT JOINT
NOT TO SCALE

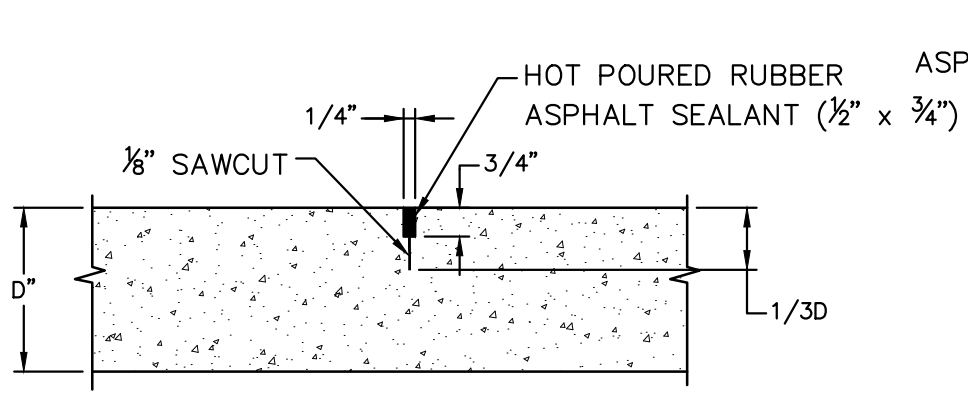

3 SAWCUT CONTROL JOINT
NOT TO SCALE

4 ISOLATION JOINT-STRUCTURE
NOT TO SCALE

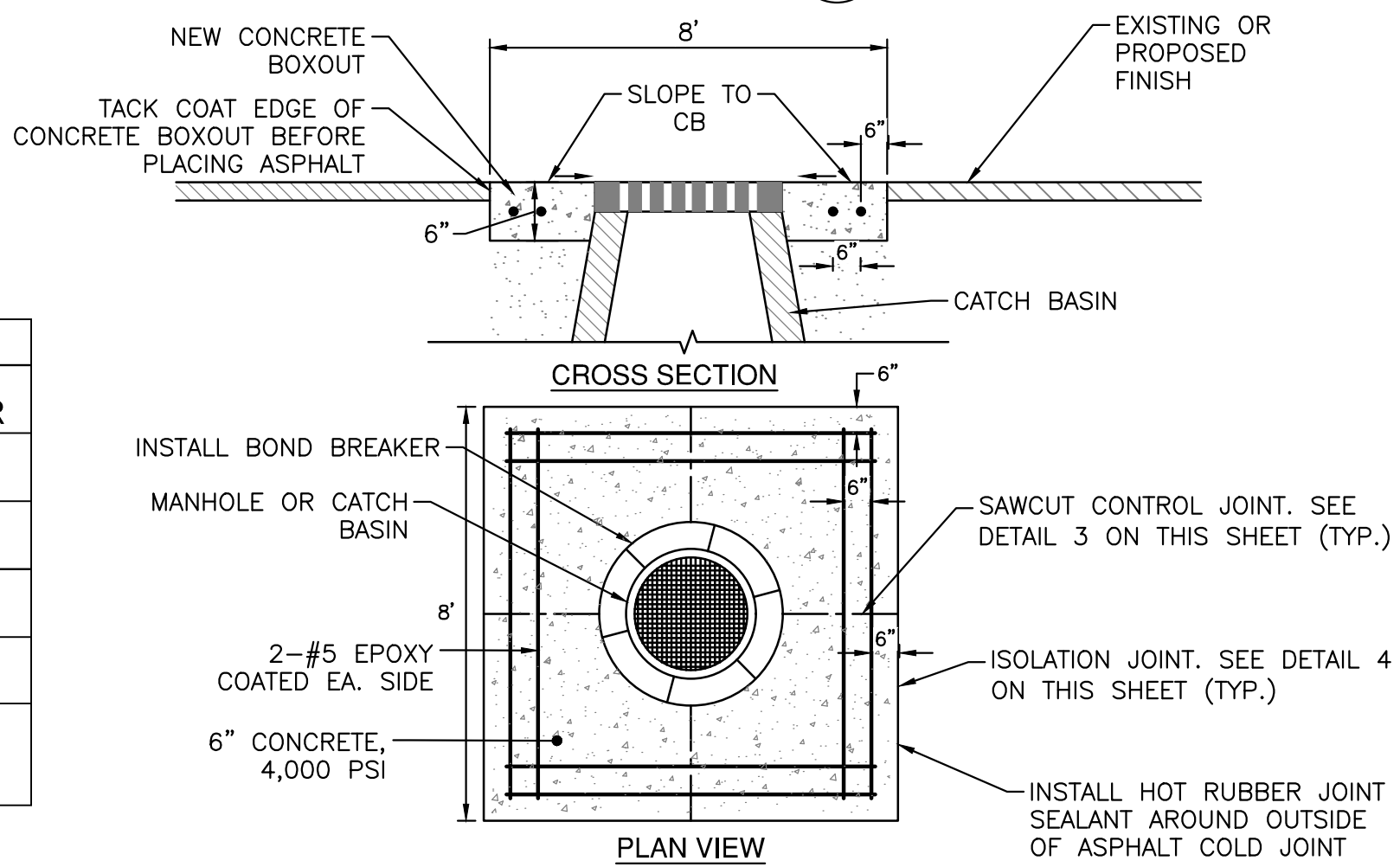

NTH Consultants, Ltd.
Infrastructure Engineering
Environmental Services
Facilities Engineering
www.nthconsultants.com

Northville, MI
Detroit, MI
Lansing, MI
Grand Rapids, MI
Livonia, MI (Laboratory)

BEFORE YOU DIG
CALL MISS DIG
1-800-482-7171
For the location of public utility lines.
ALTERNATE NUMBER (811)
YOUR CODES FOR UTILITY LOCATING:
Yellow Digging Ref. Blue Water Drain
Red Electric Green Sewer
Pink Gas
If you are going to work near overhead wires - call MISS DIG.



SEAL/STAMP:



REVISION BLOCK	
REV	DATE: DESCRIPTION
1	2025-02-13: REVISIONS TO SIGNAGE PER PRE-BID WALKTHROUGH COMMENTS

SUBMITTAL LOG	
DATE	PACKAGE NAME

PROJECT NAME:
**LIVONIA PUBLIC SCHOOLS
2025 PAVING PROGRAM -
FRANKLIN HIGH SCHOOL**

PROJECT LOCATION: 31000 JOY ROAD LIVONIA, MICHIGAN 48150	
DESIGNED BY: KBH	NTH PROJECT NO.: 23001951
DRAWN BY: KBH	SHEET SIZE: ARCH D (24"x36")
CHECKED BY: DRL	DATE: 2/13/2025
CAD FILE NAME: 23001951-02-SITE	

SHEET TITLE:
**PROPOSED SITE AND
GRADING PLAN**

SHEET NUMBER:
C-105