



## MEETING MINUTES – DAT #1

PROJECT	BVSD Fairview High School	MEETING DATE	2025.01.15
ATTACHMENTS	Sign-In Sheet PowerPoint Presentation		
BY	Chris Cole, MOA ARCHITECTURE	LOCATION	Fairview High School

### PARTICIPANTS

Kasia Bulkowski, MOA  
 Ashley Trunnell, MOA  
 Jordan Taylor Miller, MOA  
 Chris Cole, MOA  
 Karly Geist, MOA  
 Carol Henry, DC  
 Matt Lewandowski, A&P  
 Logan Dickerman, A&P  
 Christoph Konradi, BVSD BOND  
 Kris Stoppenhagen, BVSD BOND  
 Mick Port, BVSD  
 TJ Strasser, FVHS  
 Tim Gesell, FVHS  
 Andrew Freaney, FVHS  
 Scarlet Chopin, FVHS  
 Rebecca Kaplan, FVHS  
 Will Rosenbaum, FVHS  
 Mike Hollenbach, FVHS  
 Liz Barcheck, FVHS

### CONTACT INFO

kbulkowski@moaarch.com  
 atrunnell@moaarch.com  
 jmiller@moaarch.com  
 ccole@moaarch.com  
 kgeist@moaarch.com  
 carolh@dcla.net  
 mlewandowski@a-p.com  
 ldickerman@a-p.com  
 christoph.konradi@bvsd.org  
 kris.stoppenhagen@bvsd.org  
 mick.port@bvsd.org  
 theodore.strasser@bvsd.org  
 tgessel@bvsd.org  
 andrew.freaney@bvsd.org  
 scarlet.chopin@bvsd.org  
 rebecca.caplan@bvsd.org  
 william.rosenbaum@bvsd.org  
 michael.hollenbach@BVSD.org  
 elizabeth.barcheck@BVSD.org

#### 1. Introductions

- a. MOA & all DAT members introduced themselves.

#### 2. Design Advisory Team (DAT)

- a. MOA reviewed the purpose and norms of the Design Advisory Team.

#### 3. Design Process

- a. Schematic Design (SD), Design Development (DD) and Construction Documents (CD) design phases and milestone dates were reviewed.

#### 4. Design & Construction Schedule

- a. Design and Construction schedule with DAT meeting dates were reviewed.

## 5. Project Scope

- a. BVSD bond scope list was reviewed, the DAT will primarily focus on exterior improvements, interior improvements, science wing improvements, and CTE renovations.

## 6. Exterior Improvements

- a. Exterior improvements were reviewed as part of the VFA bond scope list.
  - i. Drainage and debris improvements southwest adjacent to the tennis courts.
  - ii. Dugout upgrades at the softball field.
  - iii. Chain link fence replacement at outfield, south field (MOA verify).
  - iv. Track and turf replacement.
  - v. Lighting at staff parking lot.

## 7. Interior Improvements

- a. Areas of more recent renovations in the school were reviewed, in 2010 and 2017.
- b. Potential areas of improvement were reviewed in the main corridors, student commons, science wing, and CTE.
  - i. CORRIDOR REFRESH
    - Door replacement, carpet replacement, and paint refresh were reviewed with the group as part of the VFA bond scope list.
  - ii. STUDENT COMMONS
    - Potential ideas for flooring replacement, lighting upgrades, and graphics/branding were presented with the following commentary from the DAT.
      - Presentations occur in the student commons and the lighting needs to be replaced.
      - Natural light is desired.
      - Light bulb maintenance is a challenge due to ceiling height.
      - Red walls are not desirable 'cave-like'.
      - New wall murals are scheduled to be installed by the school (MOA verify what and where).
      - Missed opportunity for student collaboration and lounge space for students; students need another space during an off hour and the student commons could serve that.
      - Student Commons serves as a cafeteria and needs to be easily cleanable and quickly set up. Furniture must be mobile.
      - Poms practice and banquettes take place in the student commons.
      - Lockers aren't repairable; 43 lockers are not being used because parts are unavailable and the school feels like lockers will be at their end of life before the next bond cycle (MOA to provide options).
      - Need more electrical outlets along ramps for cleaning. Existing outlets area covered and not usable.
      - Senior balcony is highlighted.
      - The school would prefer a hard surface material on the ramp areas over carpet due to friction when rolling mobile carts.

iii. SCIENCE WING

- Potential ideas for flooring replacement, casework replacement, ADA updates, and lighting upgrades were presented with the following commentary from the DAT.
  - Convert a room into a chemistry lab; they only have (2) rooms now but have (3) chemistry labs. A new Chem lab needs gas piped in, lab tables, and additional sink stations. Current chem labs are 422 and 421. This is the biggest request from the science department. The two rooms 408 and 411 are in the worst condition.
  - Chem lab equipment is stored, but not chemicals. Chem lab storage is sufficient.
  - Most of the science rooms are multipurpose, so adding a Chem lab and displacing another science teacher will be overcome
  - Lighting is a concern in all science labs
  - There are issues with sinks, leaking, and clogging.
  - There is no gas detection system in place.
  - Upper-level students need gas connections for curriculum.
  - Some rooms could cap gas connections because of non-use.
  - Need more power drops.

iv. CTE

- Potential ideas for new AI Lab space in the Lab 225 area, Senior Lounge 116 area, and Student Center 1115 area were presented with the following commentary from the DAT:
  - Of the three locations discussed, the group is to keep those in mind. CTE Lab 225 area and adjacent rooms is an appealing spaces because of its size. They don't want to highlight AI, because eventually, they feel it will be all over the building. They like that it's within the math department.
  - i. The school asked all teachers what they know and can teach about AI, but will be discussing it as a school in February.
  - The student center and senior lounge areas are not desired as a CTE space due to current use.
  - Want to maintain the tradition of the Senior Balcony.

v. PLANNING FOR A FUTURE AI

- Brainstorming for what immersive technology and AI could look like at the school in the future was discussed with the following commentary from the DAT.
  - Collaborative space, collaborative design, workspace stations are desired.
  - The group wants to take the AI CTE slides to their Feb staff meeting.

- o DAT would like AI not to be siloed into a space and prefers AI presence throughout the school.
- o Want to be ahead of the curve and how to utilize the technology.
- o Don't want AI to detract from other CTE pathways.
- o Spaces in the Library could be used to support AI, but the space is it's outdated.
- o CU Atlas Building for Applied AI Sciences is a good reference. (MOA to schedule a visit).
- o The space needs to be multi-functional with other departments (photography, theater filming, building for engineering classrooms).
- o The AI courses and AI in the curriculum (slides) most align with where the school sees the immediate future of AI.
- o School has collaboration with CU Boulder for dual enrollment.

vi. ADDITIONAL COMMENTARY FROM THE DAT

- The library carpet and furniture need to be replaced.
- The library does not have an appropriate A/V system.
- A few of the windows in the library are leaking.
- The existing CCTV security system is believed to have adequate camera coverage.

vii. MOA ACTION ITEMS

- Review with the school planned locations of wall murals in the commons area.
- Provide locker options and size at the next DAT meeting.
- Verify with the athletic director the extent of chain-link fence replacement.
- Are there any known issues with acoustics in the student commons area?
- *Have a focused discussion on individual science room needs at the next DAT*
  - o *Categorize into safety / ADA, functions, and aesthetics*
- Walk the science wing with a science DAT representative.
- MOA to schedule visit to CU Atlas building for Applied AI Sciences
- Map of finishes to reviewed at next meeting.

8. NEXT DAT MEETING

- a. The next DAT meeting is scheduled for January 29<sup>th</sup>, 2025, at 2:00 pm.

END OF MEETING MINUTES

MOA ARCHITECTURE will rely on these items as the approved record of matters discussed and conclusions reached during this meeting unless the author receives written notice to the contrary within five (5) calendar days of the issue date of these meeting minutes.



01/15/2025

Sign in sheet

Name	Department	Email
CHRISTOPHER K	BVSD BOND	-
Ross Sutter	FHS AP	ross.sutter@bvsd.org
Carol Henry	Design Concepts	carolh@dclinet
KASIA BULKOWSKI	MOA ARCHITECTURE	kbulkowski@moaarch.com
Logan Dickerman	AP Construction	ldickerman@a-p.com
CHRIS COLE	MOA	ccole@moaarch.com
TJ Strasser	FHS CTE Teacher	theodine.strasser@bvsd.org
Math Lewandowski	AP Construction	mLewandowski@a-p.com
Tim Gesell	FHS Teacher	tgesell@bvsd.org
Andrew Feeney	Science	andrew.feeney@bvsd.org
Scarlet Chapin	Principal	scarlet.chapin@bvsd.org
Parent Proxy	Parent	SAC member
Rebecca Kaplan	Library	Rebecca.kaplan@bvsd.org
Will Rosenbom	CUSTODIAL	Will
Mick Port	Capital District	
Mike Hollenbach	FHS Teacher	michael.hollenbach@bvsd.org
AZHUEP TRUNNELL	MOA ARCHITECTURE	atrunnell@moaarch.com
KARUP GEIST		





# FAIRVIEW HIGH SCHOOL

## DAT #1

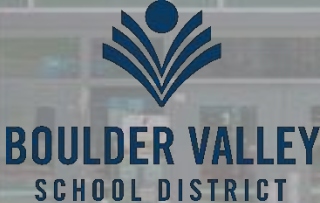

# AGENDA

1. INTRODUCTIONS
2. WHAT IS A DAT?
3. DESIGN PROCESS & SCOPE OF THE PROJECT
4. EXERCISES – VISIONING & PLANNING FOR THE FUTURE
5. WHAT'S NEXT? FUTURE DATES





# INTRODUCTIONS

## MOA ARCHITECTURE TEAM



JACK  
MOUSSEAU



KASIA  
BULKOWSKI



ASHLEY  
TRUNNELL



JT MILLER



CHRIS COLE



**BOULDER VALLEY**  
SCHOOL DISTRICT

**FAIRVIEW HIGH SCHOOL**

*Imagine the Possibilities*

# DESIGN ADVISORY TEAM RESPONSIBILITIES



**BOULDER VALLEY**  
SCHOOL DISTRICT

**FAIRVIEW HIGH SCHOOL**

*Imagine the Possibilities*

# SO, WHAT IS A D.A.T.

- THE D.A.T. (DESIGN ADVISORY TEAM) IS A COLLABORATIVE DECISION-MAKING PROCESS.
- THE D.A.T. MEMBERSHIP REPRESENTS THE INTERESTS OF THE COMMUNITY, THE SCHOOL, AND THE DISTRICT.
- THE D.A.T. PARTICIPANTS WORK WITH THE DESIGN TEAM MEMBERS TO UNDERSTAND AND DEFINE THE SPECIFIC SCOPE OF WORK BASED ON THE GENERAL SCOPE OUTLINED BY THE DISTRICT ASSET MANAGEMENT PLAN.
- THE D.A.T. IDENTIFIES FUNCTIONAL FACILITY PROBLEMS, REVIEWS DESIGN SOLUTIONS, AND PRIORITIZES SPECIFIC ITEMS OF WORK TO BE ACCOMPLISHED WITHIN THE SCOPE, SCHEDULE, AND BUDGET.



# DAT NORMS

- BE ON TIME
- ACTIVELY LISTEN
- STAY ON TOPIC AND WITH THE AGENDA
- AVOID ELECTRONIC DISRUPTIONS (CELL PHONES, COMPUTERS, EMAIL)
- BEHAVE IN A PROFESSIONAL MANNER – MODEL WHAT WE WANT FROM OUR STUDENTS
- PROVIDE CONSTRUCTIVE FEEDBACK
- MEMBERS AGREE TO LOOK BEYOND THEIR OWN ISSUES, AGENDAS, OR INTEREST AREAS TO SEE THE “BIG PICTURE”.
- EACH D.A.T. MEMBER IS VALUED, AND THE DIVERSITY OF OPINIONS STRENGTHENS THE PROCESS.
- THOUGHTFULLY CONSIDER VARIOUS POINTS OF VIEW



# DESIGN PROCESS & PROJECT SCOPE



**BOULDER VALLEY**  
SCHOOL DISTRICT

**FAIRVIEW HIGH SCHOOL**

*Imagine the Possibilities*

# DESIGN PROCESS

- **SCHEMATIC DESIGN (SD) Complete February 14th**

SIMPLE DRAWINGS TO ILLUSTRATE DESIGN IDEAS

OUTLINE SPECIFICATIONS INCLUDING WRITTEN DESCRIPTION OF BUILDING SYSTEMS

- **DESIGN DEVELOPMENT (DD) Complete May 15th**

DRAWINGS TO DESCRIBE OVERALL DESIGN IDEAS

ONLY SELECT DETAILS AT THIS LEVEL OF DESIGN

BUILDING SYSTEMS ARE DESCRIBED IN DRAWINGS

PROJECT MANUAL INCLUDING SPECIFICATIONS AND COST ESTIMATES

PROJECT PHASING DEFINED IF ANY

\*THE D.A.T. ROLE IS ESSENTIALLY COMPLETE AT THE CONCLUSION OF THIS PHASE.

- **CONSTRUCTION DOCUMENTS (CD) Complete September 12th**

INSTRUCTIONS FOR THE CONTRACTOR

INCLUDES ALL DETAILS NEEDED FOR CONSTRUCTION

INCLUDES SPECIFICATIONS



# Fairview High School Design & Construction Schedule

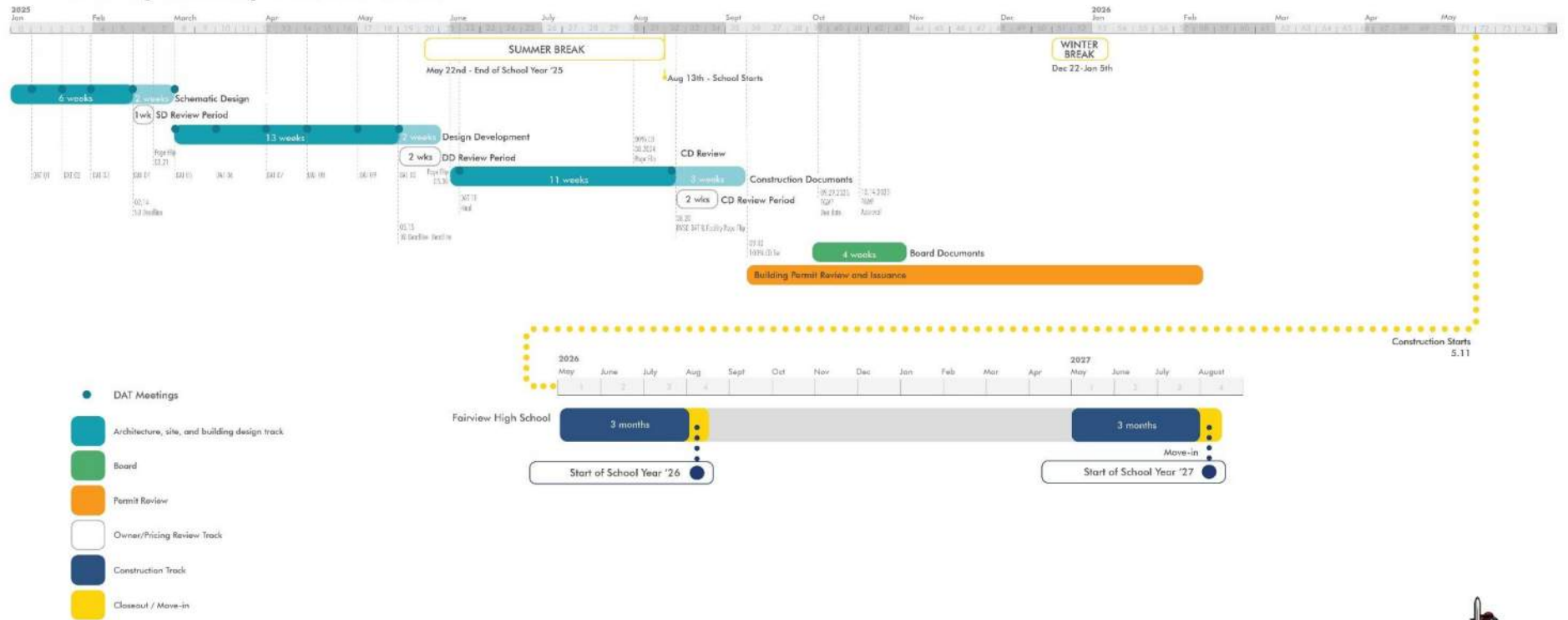

Preliminary Project Schedule, Subject to Change

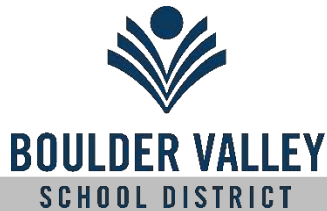

# FAIRVIEW HIGH SCHOOL

Imagine the Possibilities



# Fairview High School Design & Construction Schedule

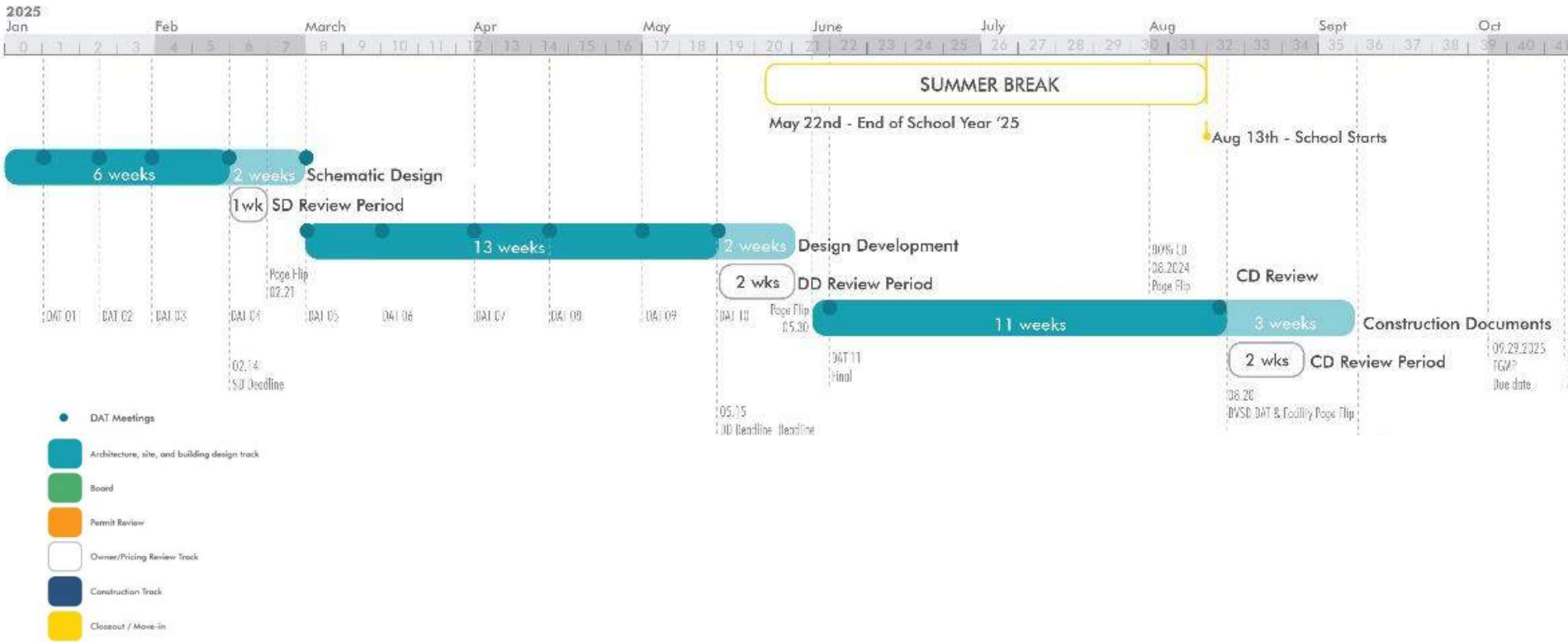

# PAST RENOVATIONS

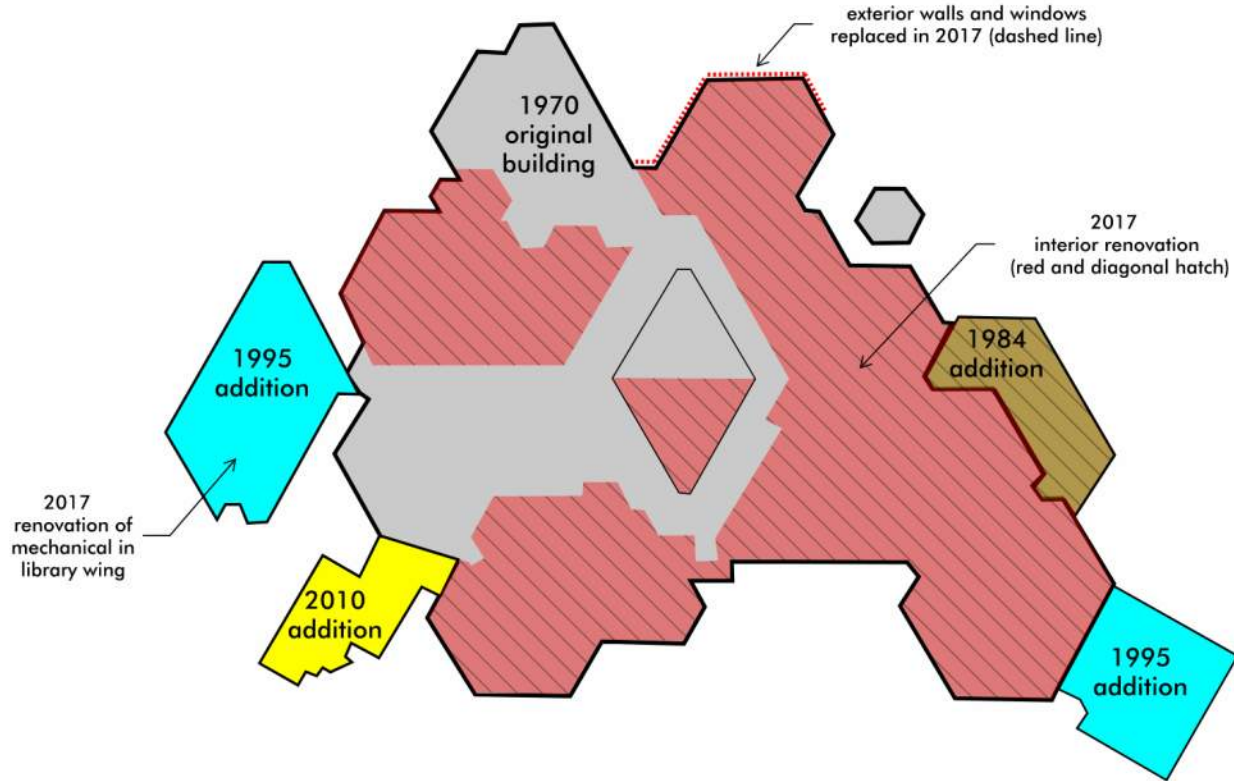

# FULL PROJECT SCOPE

2024.11.20

BVSD FAIRVIEW HIGH SCHOOL USER ENGAGEMENT GROUPS



		SCHOOL LEADERSHIP	FACILITIES DEPARTMENT	SCHOOL MAINTENANCE	CTE & SCIENCE DISCIPLINE REPRESENTATIVE	ATHLETICS/BAND WORKING GROUP	INTERIOR IMPROVEMENTS WORKING GROUP
<b>FACILITY RENEWAL</b>	49%	X	X	X			
<b>DESIGN ADVISORY TEAM/FOCUS GROUPS</b>							
Athletics/Band Improvements	1%	X	X	X		X	
Interior Improvements*	12%	X	X	X	X		X
CTE/Science	38%	X	X		X		
	100%						

FACILITY RENEWAL SCOPE includes Building Envelope, Systems, Safety/Code Improvements, Infrastructure and Site items and can be coordinated with Facilities, School Maintenance Staff and School Leadership.

CTE/SCIENCE GROUP may include representatives from each CTE and Science discipline, Facilities and School Leadership

ATHLETICS/BAND WORKING GROUP will convene 1-3 meetings with representatives from Athletics, Facilities, School Maintenance, and School Leadership.

\*INTERIOR IMPROVEMENTS can be presented to DAT or a working group at schools discretion

<b>Building Envelope</b>		20%
BUR (Built-Up Roofing) with Gravel Renewal GYMS & 400 WING	17.8%	
Aluminum Windows - 1971 Renewal	2.6%	
<b>Building Systems</b>		9%
Distribution Systems - Gymnasium Air Handling Units Need Repositioning	0.5%	
Distribution Systems - HVAC for Commons Lower Level Needs Improvement	0.3%	
HVAC: Replace Obsolete Fire / Smoke Dampers	0.4%	
Low Tension Service and Dist. - Electrical Outlets Not Observed Near HVAC Equipment	0.1%	
Main Distribution Panelboard - 200A 480Y/277V 3 phase - LCC1 Renewal	0.2%	
Packaged Rooftop Unit - Aaon - RTU-904 Renewal	0.9%	
Packaged Rooftop Unit - York - RTU-201 Renewal	0.9%	
Plumbing: Install Emergency Gas Shutoff Valve	0.0%	
Sinks - Laundry - Pod 500 Renewal	0.0%	
Water Heater - Gas - State Renewal	0.4%	
hvac controls	1.3%	
Emergency Battery Pack Light Units Renewal	1.8%	
LAN & VoIP System - 2008 Renewal	2.0%	
<b>Safety/Code</b>		13%
ADA - Plumbing: Replace Sink in Special Ed Room	0.1%	
ADA - Restroom Fixtures - Corrections Needed - Rooms 905/906	0.0%	
Fire Alarm System - Head End Control Equipment - Addressable Renewal	0.4%	
Fire Alarm System - Initiating & Alarm Devices - Addressable Renewal	4.5%	
Public Address System Renewal	7.6%	
<b>Infrastructure/Site</b>		7%
Fencing - Damaged Steel Fencing	0.1%	
Fencing - Wood Finish Deteriorated	0.2%	
Landscaping - Sprinkler System - Commercial Renewal	3.2%	
Painted Finish or Sealer on Concrete Renewal	0.4%	
Parking Lot - Asphalt Deterioration - Alligator Cracking	0.1%	
Parking Lot - Asphalt Deterioration - Longitudinal Linear and Transverse Cracking	0.2%	
Pedestrian Paving - Damaged Walkway	0.1%	
Swale on South End of Building Renewal	2.5%	
<b>Athletic/Band Improvements</b>		1%
Scoreboard - Interior - Single-Sided - South Gym 902 Renewal	0.3%	
Sound System - South Gym 902 Renewal	0.2%	
Scoreboard - Exterior - Single-Sided - Softball Field - Small Renewal	0.2%	
<b>Interior finish improvements</b>		12%
Carpeting - Tile Renewal - Commons & Corridors	4.4%	
Interior Carpet Replacement	6.5%	
VCT - 1971 Renewal	1.6%	
<b>Science Wing Improvements</b>		17%
Laboratory Casework Renewal	4.2%	
Renovation of Science Wing Rooms	12.5%	
<b>Career &amp; Technical Education Improvements</b>		22%
CTE Renovations	21.5%	
<b>TOTAL</b>	100%	100%

# DAT SCOPE



## Exterior Improvements

- Track & turf improvements
- Tennis court improvements
- Dugout upgrades

## Interior Improvements

- Carpet Upgrade
- Door replacement
- Paint Refresh
- Graphics

## Science Wing Renovation

- Classroom Renovations

## Areas of Impact

- Student Commons

## CTE

- Graphics & Branding
- AI Pathway



**BOULDER VALLEY**  
SCHOOL DISTRICT

# FAIRVIEW HIGH SCHOOL

*Imagine the Possibilities*

**EXTERIOR**  
**IMPROVEMENTS SCOPE**  
**POTENTIAL AREAS OF IMPACT**



**BOULDER VALLEY**  
SCHOOL DISTRICT

**FAIRVIEW HIGH SCHOOL**

*Imagine the Possibilities*





Drainage & debris improvements

Dugout upgrades

Track & turf replacement



**BOULDER VALLEY**  
SCHOOL DISTRICT

# FAIRVIEW HIGH SCHOOL

*Imagine the Possibilities*

# INTERIOR IMPROVEMENTS SCOPE

POTENTIAL AREAS OF IMPACT



**BOULDER VALLEY**  
SCHOOL DISTRICT

**FAIRVIEW HIGH SCHOOL**

*Imagine the Possibilities*



# Corridor Refresh

- Door replacement
- Carpet replacement



# Student Commons

## IDEAS

- Flooring replacement
- Lighting updates
- Graphic / Branding Opportunities



**STUDENT COMMONS and MAIN CORRIDOR**

approx. 15,565 SF



**BOULDER VALLEY**  
SCHOOL DISTRICT

**FAIRVIEW HIGH SCHOOL**

*Imagine the Possibilities*



# SCIENCE WING RENOVATIONS



**BOULDER VALLEY**  
SCHOOL DISTRICT

**FAIRVIEW HIGH SCHOOL**

*Imagine the Possibilities*

# Science Wing Renovation

## Interior Improvements

### IDEAS

- Flooring replacement
- Casework replacement
- ADA updates
- Lighting updates

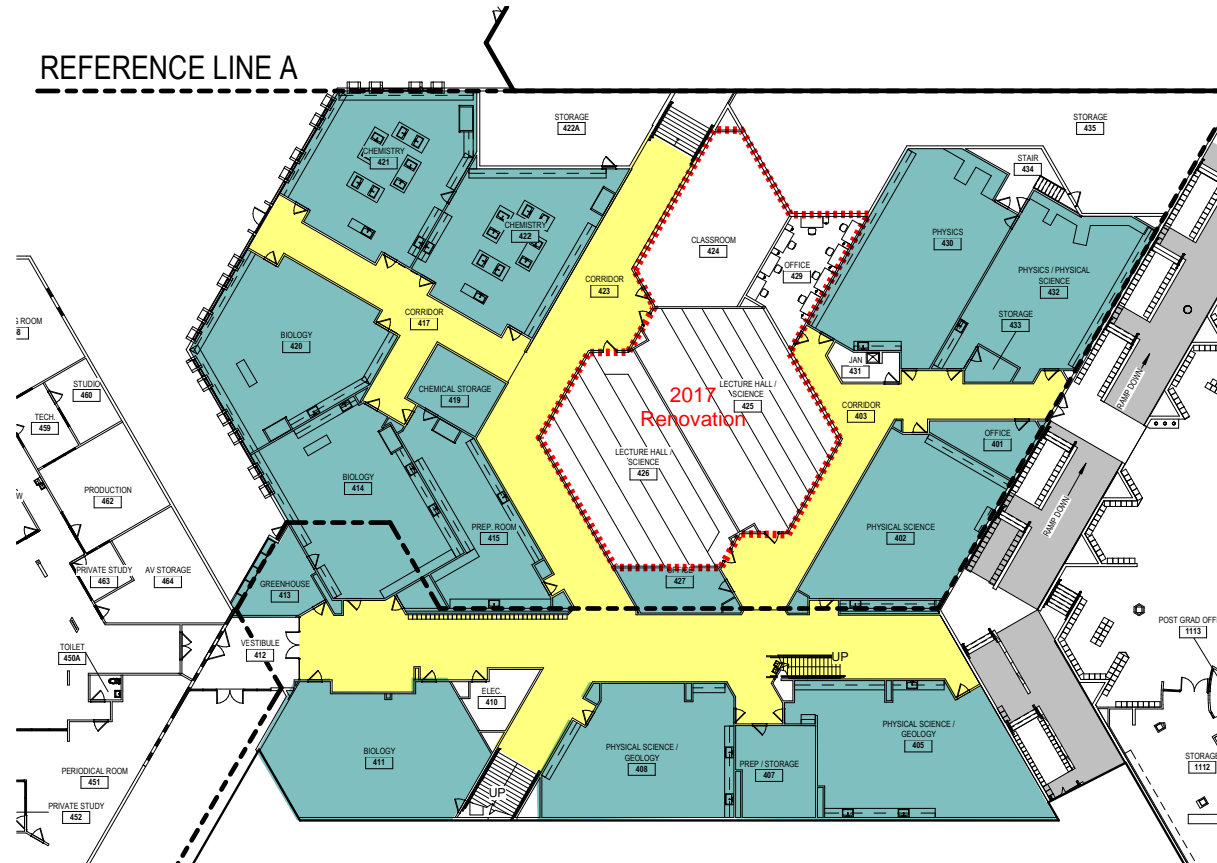

**BOULDER VALLEY**  
SCHOOL DISTRICT

**FAIRVIEW HIGH SCHOOL**

*Imagine the Possibilities*



# CTE & AI IMPROVEMENT SCOPE

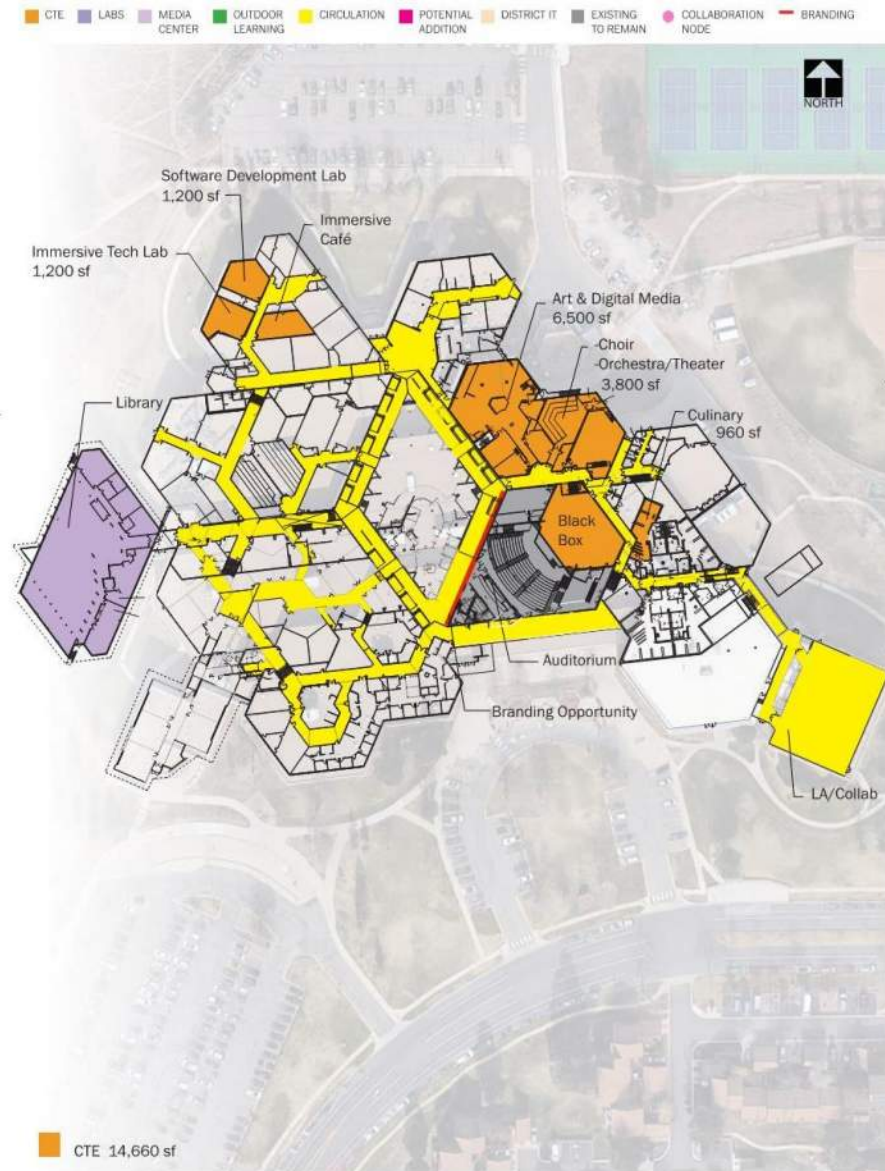

# CTE AI

## POTENTIAL NEW AI LAB SPACE

### CLASSROOM LAB 225

approx. 1,205 SF

CLASSROOM 228

OFFICE 224

WORKROOM 226

OFFICE 227

approx. 1,943 Total SF

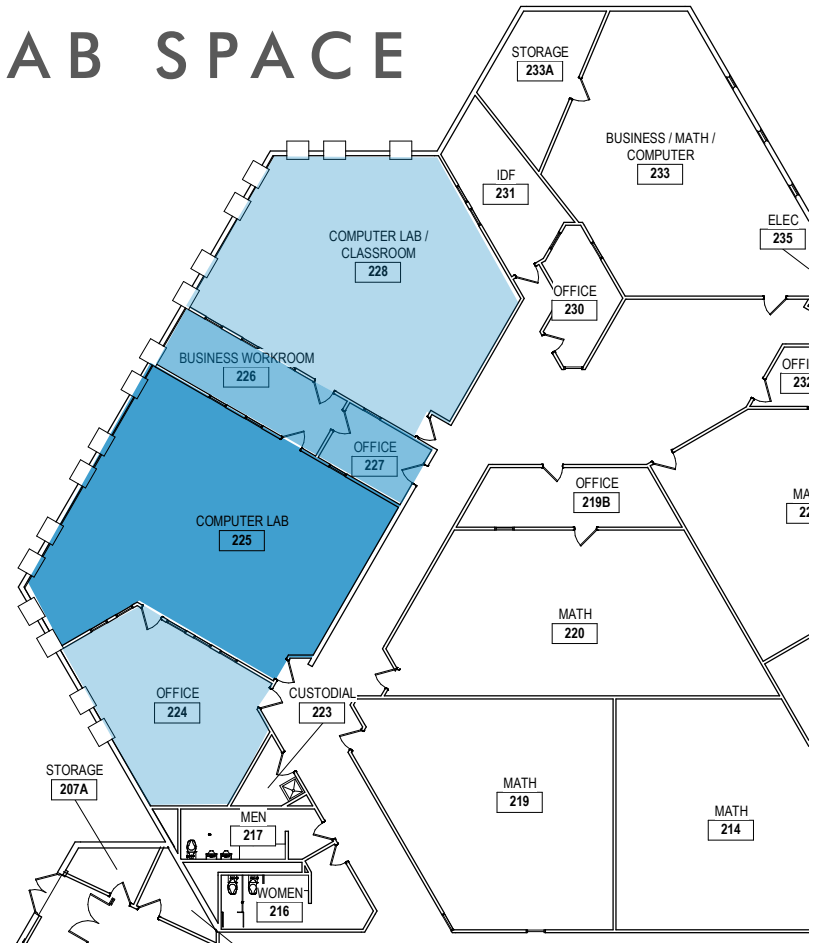

OPTION A



**BOULDER VALLEY**  
SCHOOL DISTRICT

# FAIRVIEW HIGH SCHOOL

*Imagine the Possibilities*



# CTE AI

## POTENTIAL NEW AI LAB SPACE

SENIORS LOUNGE 1106

SECURITY 1109

COPY ROOM 1108

STORAGE 1110

TREASURER 1107

approx. 1,843 Total SF

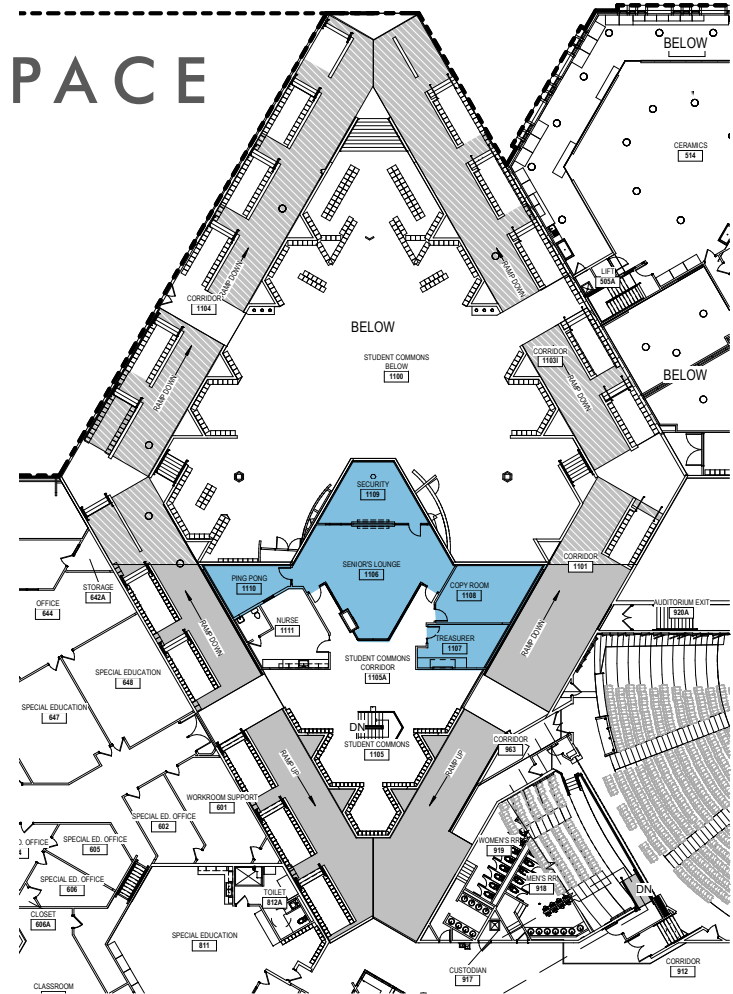

OPTION B

# FAIRVIEW HIGH SCHOOL

*Imagine the Possibilities*



**BOULDER VALLEY**  
SCHOOL DISTRICT

# CTE AI

## POTENTIAL NEW AI LAB SPACE

**STUDENT CENTER 1115**

STORAGE 1112

TEACHER LOUNGE 1121

OFFICES 1116, 1117, 1118, 1119

approx. 3,898 Total SF

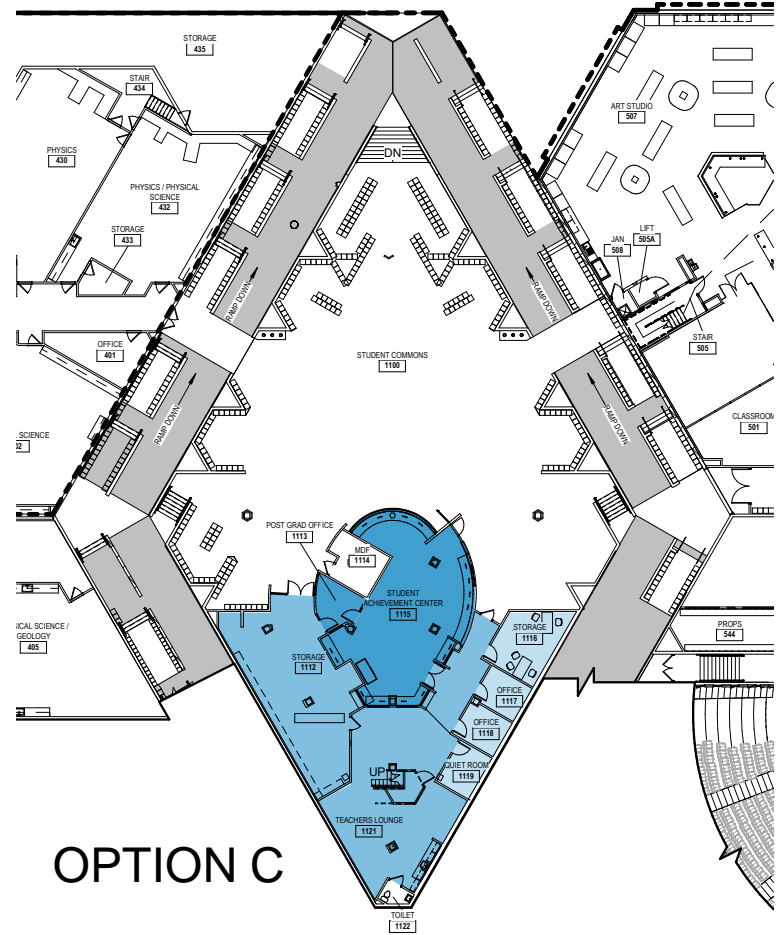

OPTION C



**BOULDER VALLEY**  
SCHOOL DISTRICT

# FAIRVIEW HIGH SCHOOL

*Imagine the Possibilities*

**EXERCISE  
PLANNING FOR A  
FUTURE-AI**



**BOULDER VALLEY**  
SCHOOL DISTRICT

**FAIRVIEW HIGH SCHOOL**

*Imagine the Possibilities*

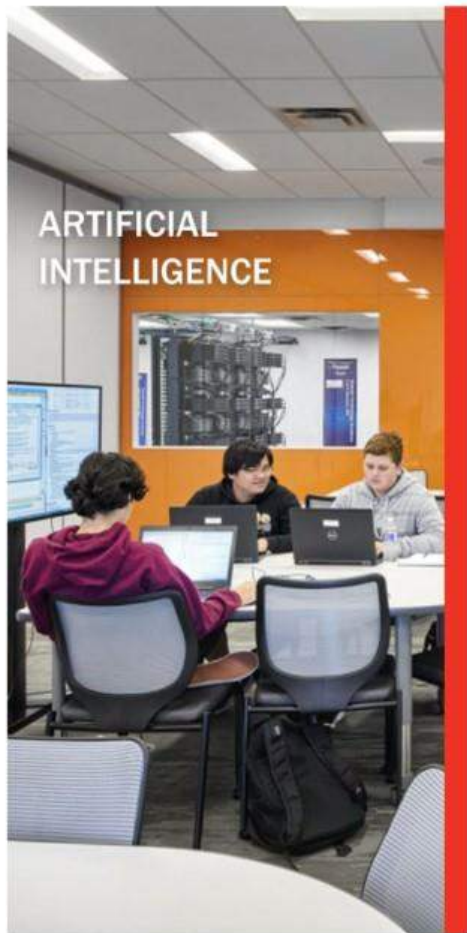

**CAREERS**

- ★ Big Data Engineer
- ★ Business Intelligence
- ★ Developer
- ★ Data Scientist
- ★ Machine Learning Engineer
- ★ Research Scientist
- ★ AI Data Analyst
- ★ Product Manager
- ★ AI Engineer
- ★ Robotics Engineer
- ★ NLP engineer
- ★ UX Developer
- ★ Researcher
- ★ Data Mining

**INDUSTRY CERTIFICATIONS**

- IBM Applied AI Professional Certificate
- IBM AI Engineering Professional Certificate
- Google IT Automation with Python Professional Certificate
- AIBiz (Foundational Training Certifications)



**CAREERS**

- ★ Augmented Reality (AR) Designer and Developer,
- ★ Virtual Reality (VR) Designer and Developer,
- ★ Software Engineer,
- ★ Design Artist,
- ★ Animator,
- ★ Sound Artist,
- ★ AI Engineer

**INDUSTRY CERTIFICATIONS**

- Unity VR Developer Certification
- Professional Certificate in AR/VR Development and 3D Graphics
- Certified AR Expert
- Certified VR Expert
- Professional Certificate in Unreal Engine Foundations
- Adobe Certified Professional: Graphic Design & Illustrations Using Adobe Illustrator (Ai),
- Adobe Certified Professional: Visual Effects & Motion Graphics Using Adobe After Effects (Ae),
- Adobe Certified Professional: Multiplatform Animation Using Adobe Animate (An),
- Adobe Certified Professional: Print & Digital Media Publication Using Adobe InDesign (Id),
- Adobe Certified Professional: Visual Design Using Photoshop (Ps),
- Adobe Certified Professional: Digital Video Using Premiere Pro (Pr)



**CAREERS**

- ★ Script Development
- ★ Production Planning
- ★ Art Design and Shooting
- ★ Directing
- ★ Filming
- ★ Post-Production
- ★ Distribution/Marketing

**INDUSTRY CERTIFICATIONS**

- Digital Media Video Production Certificate
- Certificate of Achievement (ACH), Digital Film making

# PLANNING FOR THE FUTURE

- If you could change one thing about your current CTE or computer lab/science space – what would it be?
- What does incorporating ai into Fairview HS look like to you?
- How much visibility are we trying to achieve for this program?
- Are current courses or programs in place to support ai?
  - Virtual Reality / Augmented Reality / Artificial Intelligence



# PLANNING FOR THE FUTURE

- What works really well in your current space or program that you do not want to change?
- What are the goals for integrating AI into CTE programs?
  - Are current CTE courses adapting AI programs?
  - Are new courses being developed?
  - Are new technologies and/or equipment being introduced?
  - How is AI Expanding Beyond CTE Scope?



# CASE STUDIES

What are other schools  
doing right now?



**BOULDER VALLEY**  
SCHOOL DISTRICT

**FAIRVIEW HIGH SCHOOL**

*Imagine the Possibilities*





# AI COURSES

[AI CTE program out of Georgia](#). In 2022, the district opened an AI-themed high school and created a three-course AI CTE pathway that incorporates AI “literacy” and “core” AI skills into the curriculum.

The first course: Foundations of AI, introduces students to programming, data science, math, and ethical reasoning skills.

The second course: AI Concepts, teaches students about the history of AI, current AI research, and the societal and ethical impacts of AI.

The third course: AI Applications, teaches students to design and test AI-powered solutions.

While this pathway is for students who want to dive deeper into AI-focused studies, an elementary and middle school feeder program has started piloting AI-ready learning embedded courses to develop the necessary skills for deeper student engagement at the high school level.







# CTE WITH AI

Starting next fall, some Baltimore County Public Schools students will have the option to partake in an artificial intelligence program as part of the system's career and technical education options.

The new program, called Computer and Information Sciences Artificial Intelligence will be available at George Washington Carver Center for Arts & Technology, Sollers Point Technical High School and Western School of Technology and Environmental Science.

Our Artificial Intelligence Program will be offered as a magnet program of study to balance out the computer science programs that will be in every high school. "Adding AI ensures that computer science is available to all students in BCPS."



HiTech instructor Peter Hyun gives instructions to a humanoid robot named Alexa while teaching students at the Howard County Library System's first youth STEM conference about artificial intelligence.



# AI in Curriculum

Today, Anaheim's career pathways start at grade seven and continue through high school. While in high school, students take dual credit courses at Cypress College.

Focusing on three essential drivers

21st century skills (soft skills)

Technical skills (hard skills)

Cultivation of student voice and purpose (experience skills)

Anaheim is preparing students for an AI-fueled future. They are training students to serve as **cybersecurity experts** and **data scientists**; to orchestrate teams of **AI-enabled robotic chefs** in commercial kitchens; or launch startups that use AI to transform **healthcare delivery**.



AI Is Changing the Workforce. At This District, It's Changing the Curriculum Too.



**BOULDER VALLEY**  
SCHOOL DISTRICT

# FAIRVIEW HIGH SCHOOL

*Imagine the Possibilities*

NOW IMAGINE...



**BOULDER VALLEY**  
SCHOOL DISTRICT

**FAIRVIEW HIGH SCHOOL**

*Imagine the Possibilities*



**BOULDER VALLEY**  
SCHOOL DISTRICT

**FAIRVIEW HIGH SCHOOL**

*Imagine the Possibilities*





**BOULDER VALLEY**  
SCHOOL DISTRICT

**FAIRVIEW HIGH SCHOOL**

*Imagine the Possibilities*





**BOULDER VALLEY**  
SCHOOL DISTRICT

**FAIRVIEW HIGH SCHOOL**

*Imagine the Possibilities*



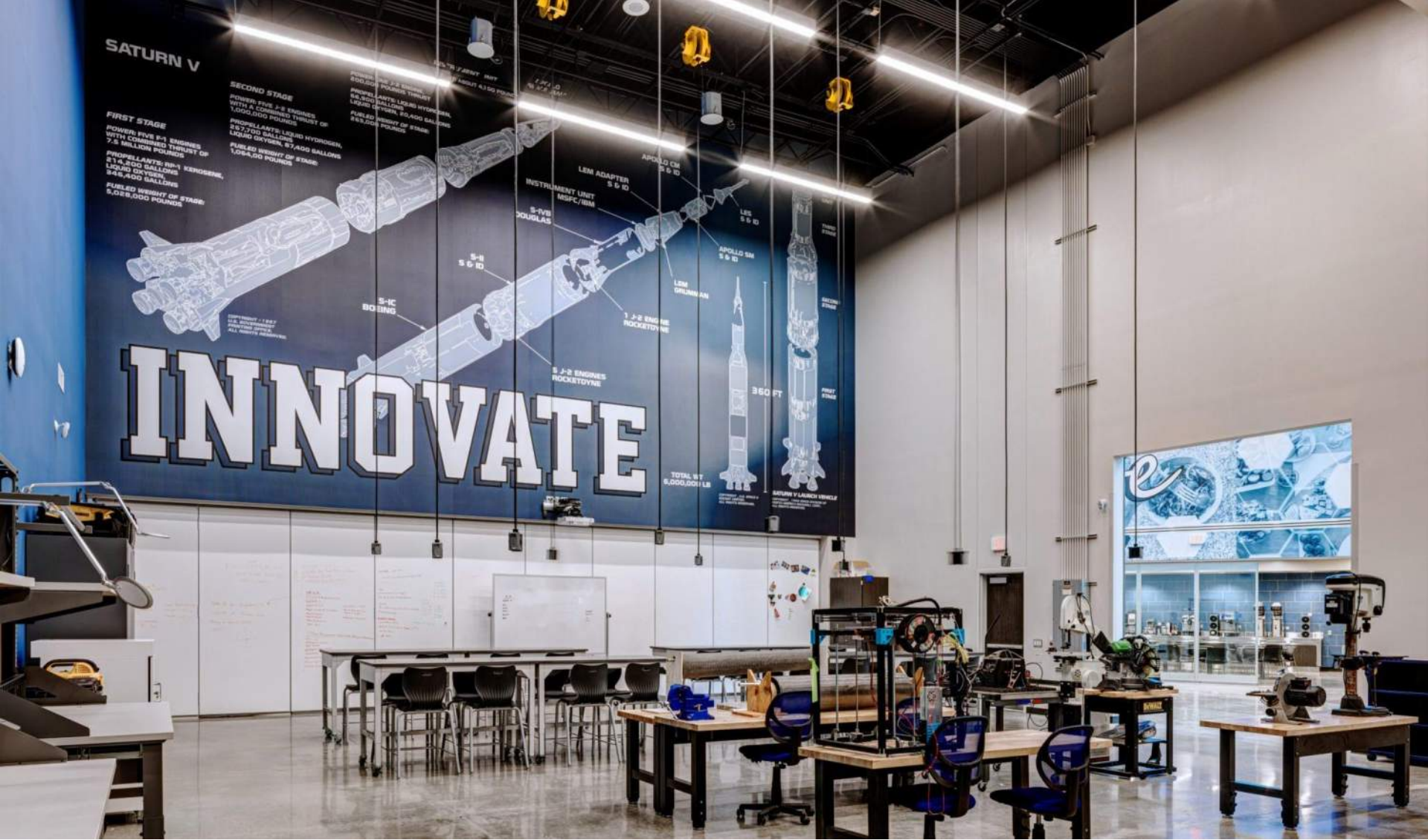

**BOULDER VALLEY**  
SCHOOL DISTRICT

**FAIRVIEW HIGH SCHOOL**

*Imagine the Possibilities*



**BOULDER VALLEY**  
SCHOOL DISTRICT

**FAIRVIEW HIGH SCHOOL**

*Imagine the Possibilities*





**BOULDER VALLEY**  
SCHOOL DISTRICT

**FAIRVIEW HIGH SCHOOL**

*Imagine the Possibilities*







**BOULDER VALLEY**  
SCHOOL DISTRICT

**FAIRVIEW HIGH SCHOOL**

*Imagine the Possibilities*





**BOULDER VALLEY**  
SCHOOL DISTRICT

**FAIRVIEW HIGH SCHOOL**

*Imagine the Possibilities*





**BOULDER VALLEY**  
SCHOOL DISTRICT

**FAIRVIEW HIGH SCHOOL**

*Imagine the Possibilities*

THOUGHTS?

LIKES AND DISLIKES

MUST HAVES?



**BOULDER VALLEY**  
SCHOOL DISTRICT

**FAIRVIEW HIGH SCHOOL**

*Imagine the Possibilities*

# THANK YOU!



MOA ARCHITECTURE

Next Steps

DAT 2 – January 29th



**BOULDER VALLEY**  
SCHOOL DISTRICT

**FAIRVIEW HIGH SCHOOL**

*Imagine the Possibilities*