



OUR ABOUT SCHOOL

Mary E. Britton Middle School
BRITTON.FCPS.NET
[@MEBRITTONMIDDLE](https://www.instagram.com/MEBRITTONMIDDLE)



WELCOME FUTURE BEARS

- We can't wait to meet you!
- You're about to embark on an amazing adventure!
- Get ready to join The Bear family!

MEET YOUR ADMIN TEAM



MRS. EMBRY
Counselor
6th grade and 8th grade



MS. KOOP
Assistant Principal
8th grade



MR. HOSKINS
Principal
6th grade



MRS. BROMAGEN
Assistant Principal
7th grade



MRS. KISER
Accounts Specialist



MR. JOHNSON
Counselor
7th grade and 8th grade



REGISTRATION & ENROLLMENT

- For families who are not currently enrolled in FCPS
- District personnel on-hand to begin the process if you choose
- Tonight is step one- online enrollment
- Additional info will be needed
- If you want to decide later, you will have other opportunities



Legacy of Mary E. Britton

Physician, Educator, Suffragist, Journalist, Civil Rights Leader



First African-American to teach white students at Berea College



Advocated for better teaching practices in African-American schools



Argued for women's rights and spoke out against many bills that prohibited women's rights



Created Colored Orphan Industrial Home that provided food, shelter, education and training to destitute orphans and elderly, homeless women until 1988



First African-American female doctor in Kentucky



Vision for our School

Our vision needs to honor the legacy of Mary E. Britton



Medical and health science focus

Agscience and medical science will be cornerstones of our CTE program



Equitable access

Ensure all MEB students leave 8th grade with at least one high school credit



Civic engagement

Teach our students to be community leaders



School pride

Make our school a place where kids want to be everyday. We will focus on empathy with accountability



WHAT MAKES MEB SPECIAL?

- Large collaborative spaces to encourage student innovation
- State-of-the-art agriculture science lab
- Fully equipped medical science lab
- Visual and digital art spaces
- Energy efficient and environmentally conscious
- Largest middle school in Kentucky



SAMPLE CLASSROOM



6th Grade Classrooms



AGRISCIENCE LAB

AG ROOM

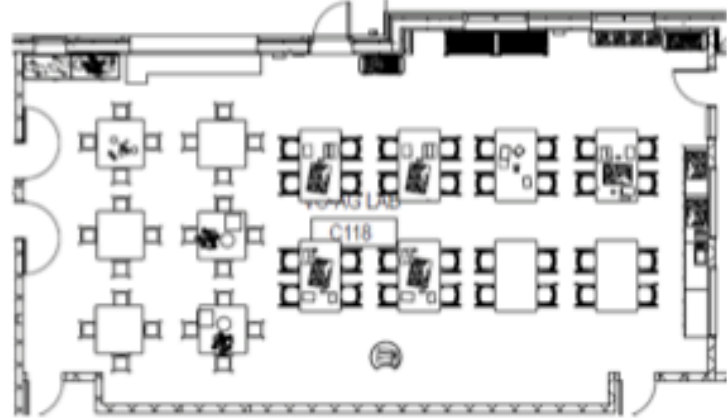

FLEX USE ROOMS

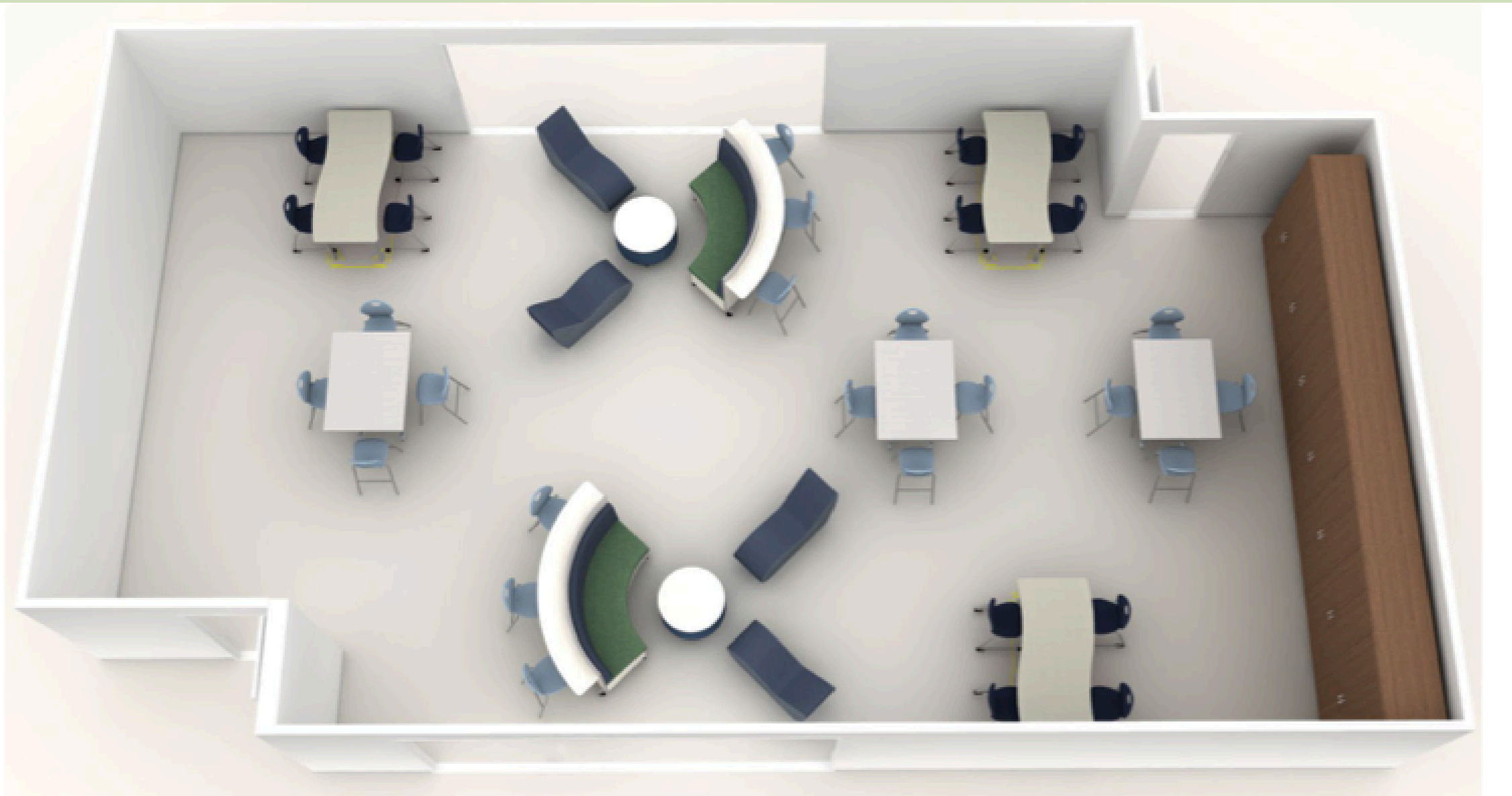

Flex Spaces



CAFETERIA

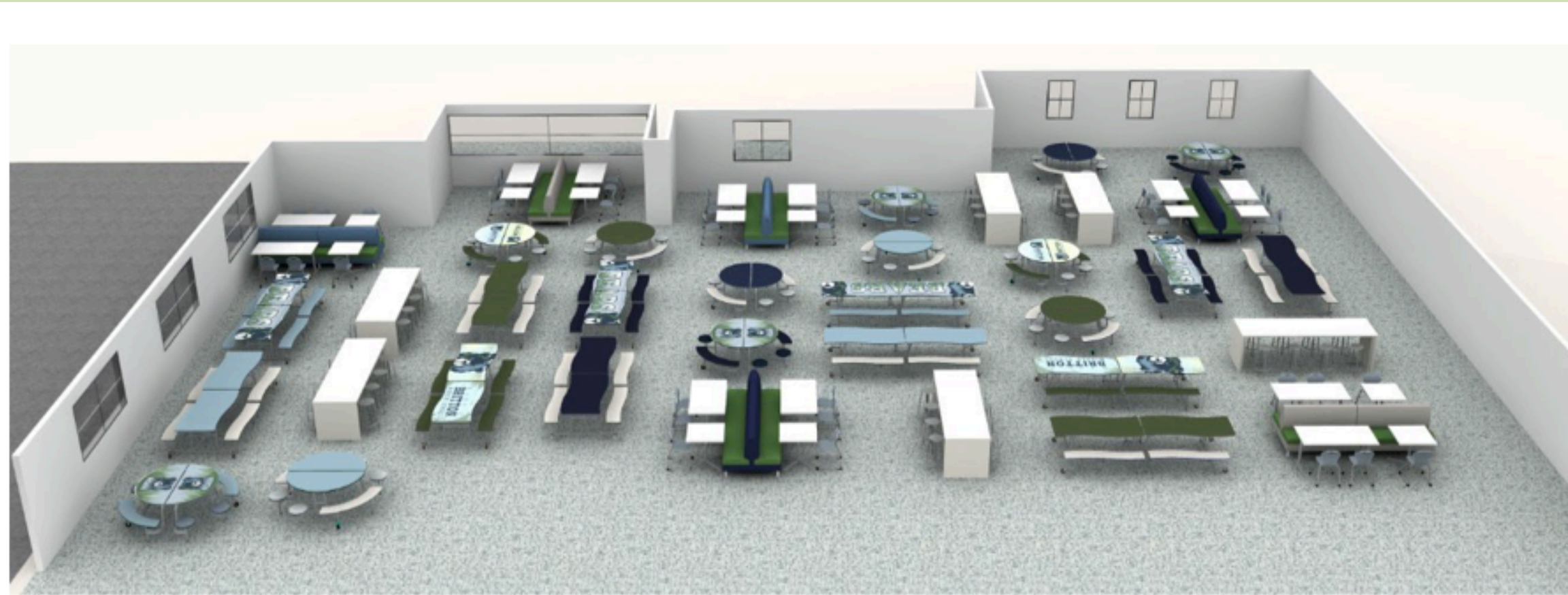

Cafeteria



CAFETERIA

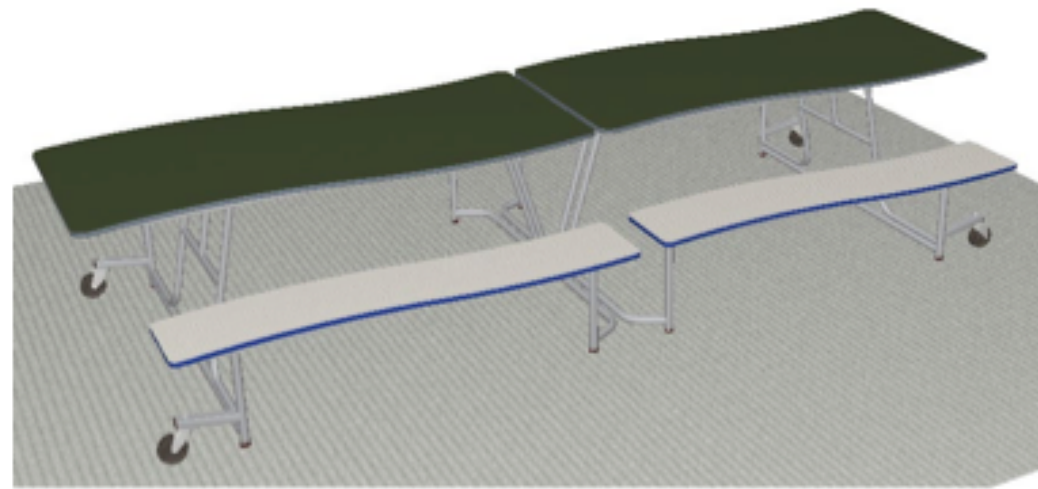
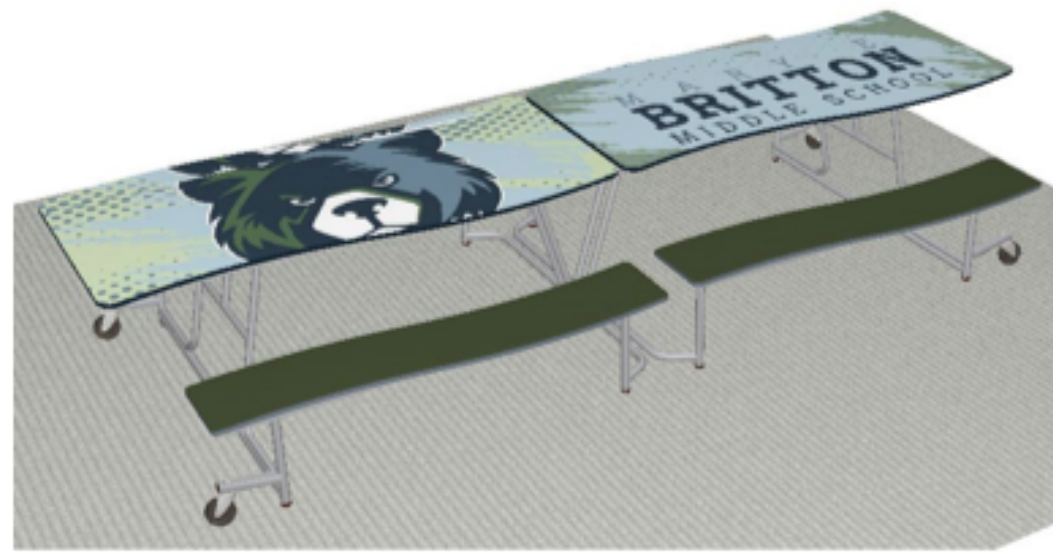

CAFETERIA

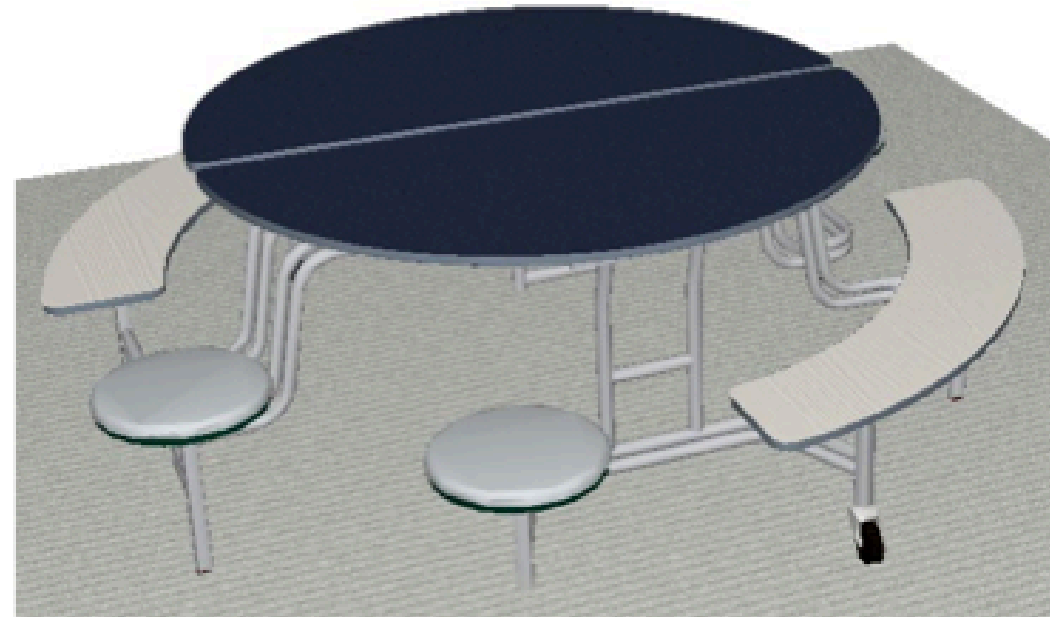
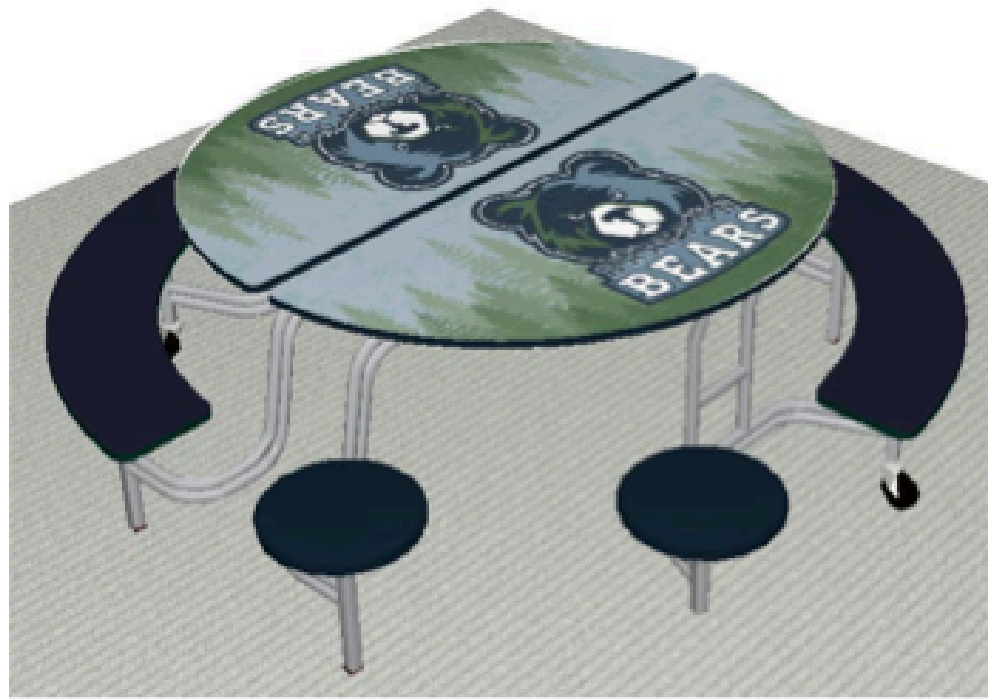

LIBRARY MEDIA CENTER

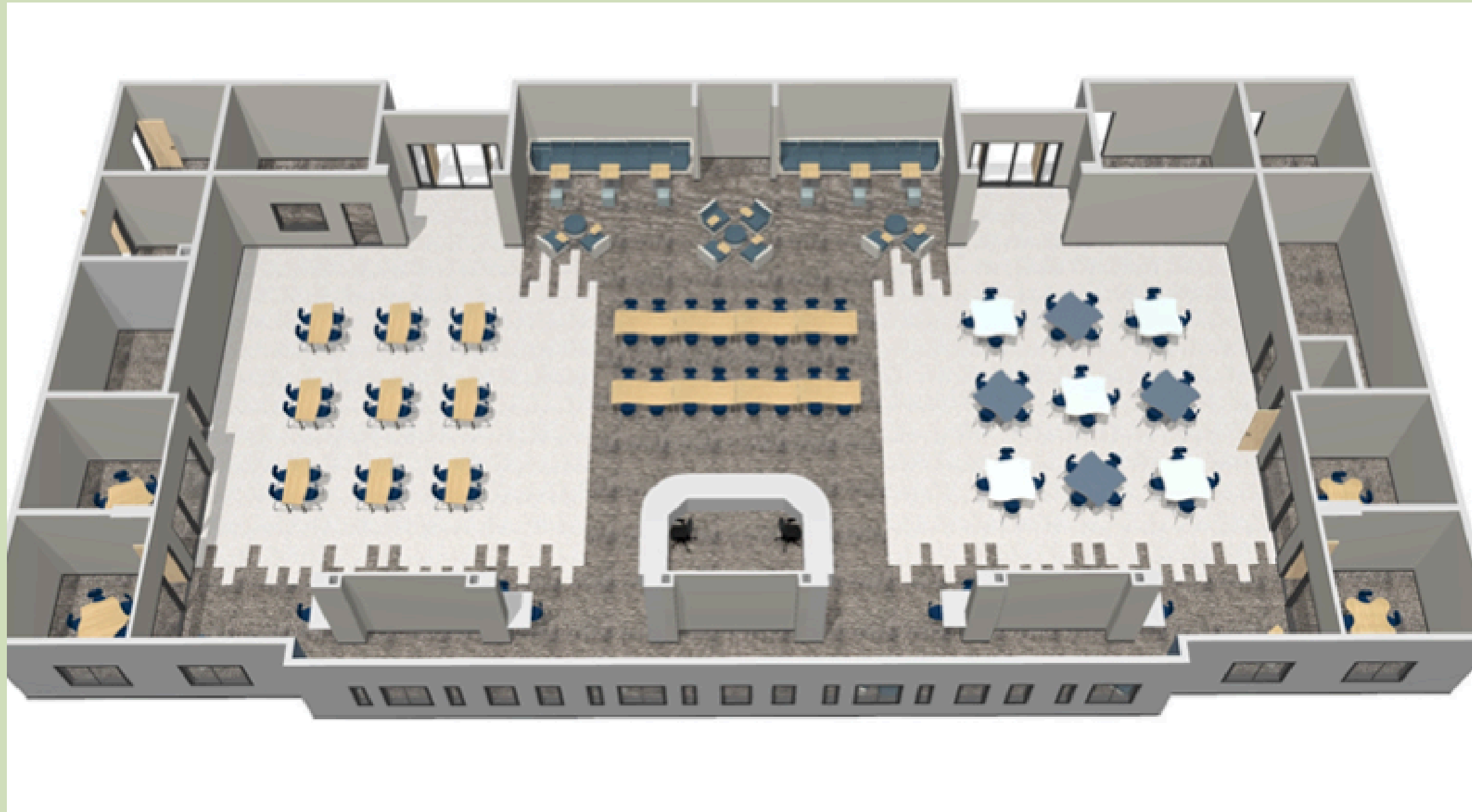

LIBRARY MEDIA CENTER



LIBRARY MEDIA CENTER



LIBRARY MEDIA CENTER



LIBRARY MEDIA CENTER



CAREER & TECHNICAL EDUCATION

EXCITING PROGRAMS AND OPPORTUNITIES

WHETHER YOU'RE INTO SCIENCE, HISTORY, ART, OR SPORTS, WE HAVE SOMETHING FOR YOU!

OUR TEACHERS ARE HERE TO HELP YOU EXPLORE YOUR PASSIONS AND DISCOVER NEW INTERESTS.



Agriculture Science



Health and Medical Science



Family and Consumer Science



Physical Education

FUTURE OFFERINGS MAY INCLUDE:

- BUSINESS & MARKETING/FINANCIAL LITERACY
- CODING AND ROBOTICS
- DIGITAL LITERACY



ARTS AND HUMANITIES

EXCITING PROGRAMS AND OPPORTUNITIES

WHETHER YOU'RE INTO SCIENCE, HISTORY, ART, OR SPORTS, WE HAVE SOMETHING FOR YOU!

OUR TEACHERS ARE HERE TO HELP YOU EXPLORE YOUR PASSIONS AND DISCOVER NEW INTERESTS."



Band



Chorus

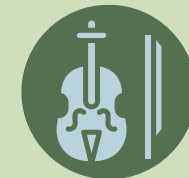

Orchestra



Spanish



Visual and Digital Art

FUTURE OFFERINGS MAY INCLUDE:

- DRAMA/THEATRE
- CREATIVE WRITING/JOURNALISM
- ADDITIONAL FOREIGN LANGUAGES



HIGH SCHOOL CREDITS

Students will have the opportunity to earn the following school credits



Agriculture science



Algebra 1



English 1



Family and consumer science



Geometry



P.E./Health



Principles of health science



Spanish 1



Spanish 2



SPORTS AND CLUBS
GET INVOLVED

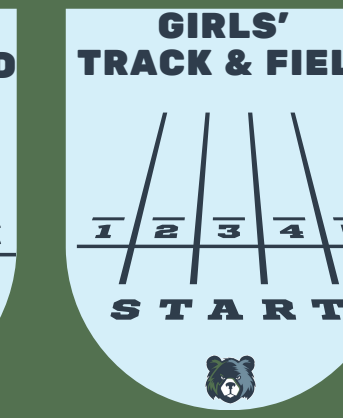
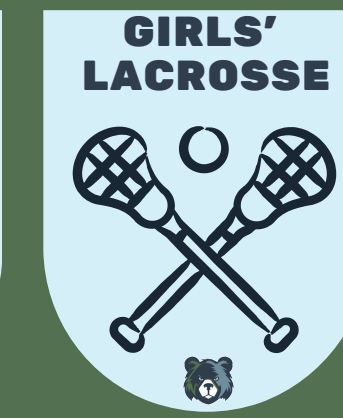

SPORTS AND CLUBS
GET INVOLVED

ACADEMIC TEAM



ART CLUB





BAND



BETA CLUB



CHORUS



FFA



JAZZ BAND



KYA/KUNA



MATHCOUNTS



ORCHESTRA



STLP



YEARBOOK



BEAR NECESSITIES FOR SUCCESS



BE CURIOUS

Embrace learning every day with enthusiasm and an open mind.



BE KIND

Foster a positive environment by showing kindness and respect to everyone.



BE BOLD

Take initiative and lead with confidence in all your endeavors.



BE RESPONSIBLE

Act with integrity and take ownership of your actions and choices.





WHAT TO EXPECT

- Schedules will be mailed in May
- “Simulation camps” will be held in June or July
- Team letters and supply lists will be mailed in late June/early July
- Transition week for students in late July or early August
- Bussing information available August 1
- Britton Bash in August
- First day of school on August 13, 2025!



STAY IN THE LOOP!

JOIN US ON SOCIAL MEDIA



[@MEBRITTONMIDDLE](#)



[@MEBRITTONMIDDLE](#)



[BRITTON.FCPS.NET](#)

EMAIL
DAVID.HOSKINS@FAYETTE.KYSCHOOLS.US
WITH ANY QUESTIONS OR CONCERNS



**WHAT QUESTIONS
MIGHT YOU HAVE?**



PLEASE COMPLETE
THE GOOGLE FORM



bit.ly/3Wjr6VT



209
DAYS
TO GO!

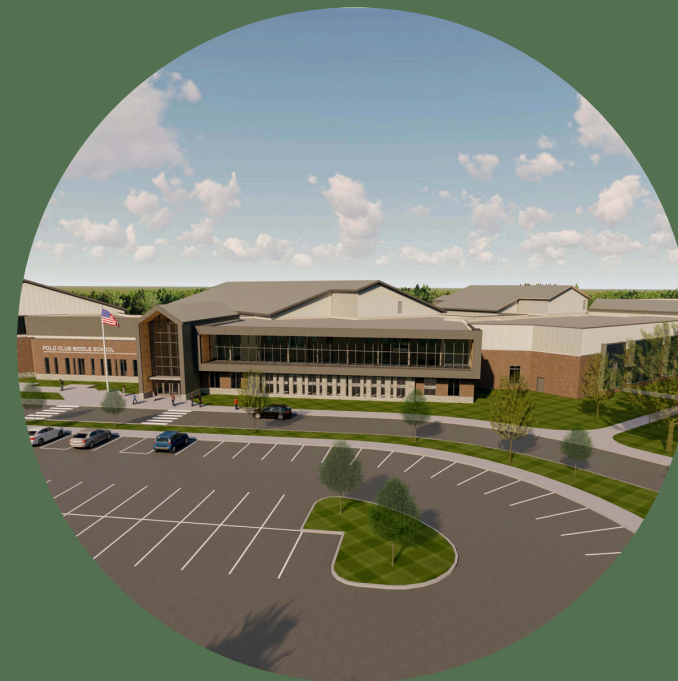

**COUNTDOWN
IS ON!**

AUGUST IS RIGHT AROUND THE CORNER!
GET READY TO BECOME A BRITTON BEAR!



RESTROOMS



RESTROOMS



RESTROOMS

- **Single stall restrooms**
- **Student restroom areas will be designated male or female (not mixed)**
- **Stall doors remain open 10 degrees unless locked from the inside**
- **There are family restrooms in the gym that will be open for games or family events only**

