

Islander Middle School Addition

Mercer Island School District

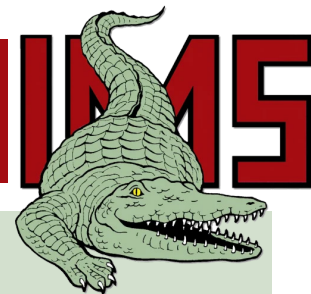

Completing the Vision

The proposed project will reunite the campus under one roof, completing the IMS campus improvements our community began in 2014 to replace aging structures with a cohesive, modern building designed to improve teaching and learning conditions for all.

Addressing student and educator needs creates meaningful impact, upholds our legacy of excellence, and aligns with the high academic standards we hold ourselves to. Co-designed with the IMS learning community, this project is the outcome of rigorous exploration, evaluation and collaboration, designed to enhance safety, access, academic opportunities and meet diverse needs; rounding out the 2016 program spaces to provide transformational opportunities, a positive student experience, and wellbeing in a community-focused environment.



Collaborative Learning Environment

Unifying IMS “One Building, One Home”—

Today, Islander Middle School consists of three separate buildings, one from the original 1958 build, one from the 2000 renovation, and a new addition from 2016. The 2016 addition replaced a section of the 1958 building and was built with the idea in mind of an eventual second addition to the campus to replace the two older buildings still on the site. This project is that second phase of work; a 62,000 square foot addition that will fully replace the remaining aging facilities, leverage cost efficiencies of infrastructure built in 2016 and, when complete, meet the comprehensive needs of approximately 1,000 students and their educators, now and into the future.



Agile & Flexible Learning Spaces

This project will complete the programmatic needs and provide and an additional 18 core instruction classrooms—designed with flexibility to benefit all disciplines, including students special needs; 10 science labs plus a shared STEAM fabrication studio; a drama and choir rehearsal studio; an art studio; and a new main office and learning commons (library). With no modifications, the existing office will become Counseling, paired with Family & Youth Support Services. And with minor modifications, library easily converts to core classrooms.



Dynamic Labs for Creative Innovation

Project Timeline—

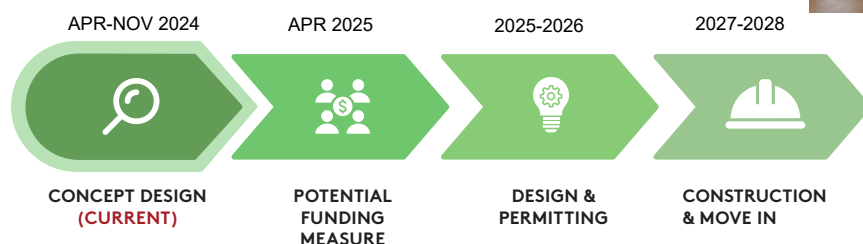

Last update 1/30/25 CPM

Mercer Island School District is considering a funding measure in April 2025 to support the project. If approved, the new school facility will open in Fall 2028.



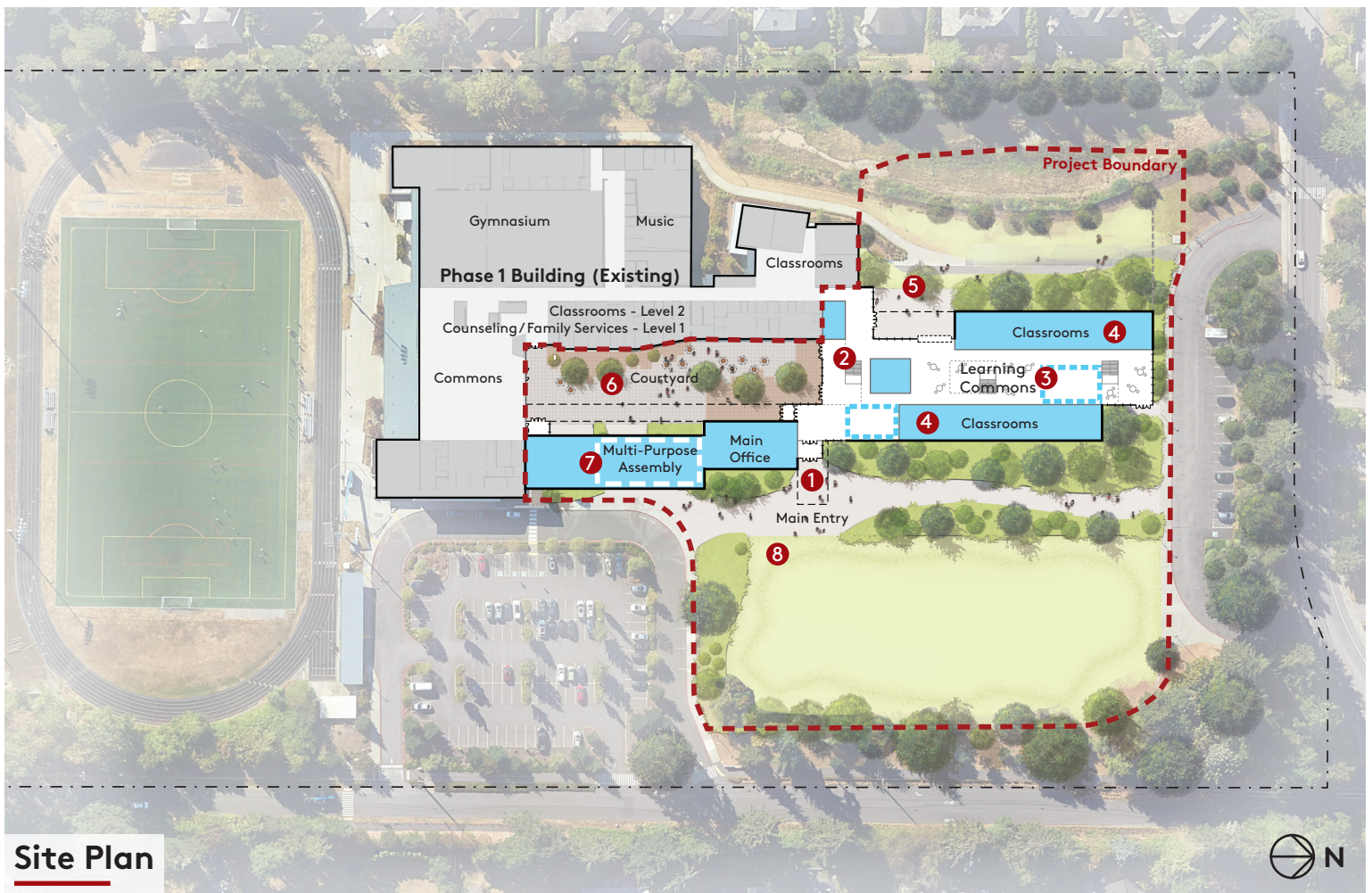

Site Plan

Project Highlights—

1. Centralized Building Entry

The project is designed to improve student flow and connectivity by strategically engaging with the existing building. The IMS community will be welcomed through a centralized, secure entry between the existing bus and parent drop-off areas to increase equitable access, accessibility and safety; and, alongside the main office, is centered in the school environment to foster belonging and facilitate efficient supervision and operations.

2. Connected Core

At the heart of the new addition, collaborative programs interconnect existing and new learning spaces to establish a common heart of the school that promotes a sense of community and establishes multiple pathways to increase accessibility and efficiently circulate across the school.

3. Learning Commons

A dynamic and flexible shared learning space designed to enhance collaboration and creativity among students and educators grounds the educational environment. This vibrant space provides diverse academic resources, encourages personalized passions and interest, allowing students to explore ideas, develop critical thinking skills, and connect with one another; and educators to develop emerging programs that embrace innovation with creativity, flexibility and offer students agency through provocation.

4. Agile & Adaptable Learning

(19) New classrooms and (8) labs across all disciplines, including STEM, Science, Art, and Robotics will feature flexible, agile, and adaptable environments that empowers students to engage in hands-on activities, explore interdisciplinary connections, and support a culture of interdisciplinary exploration.

5. Expanded Learning

Interior spaces are strategically connected to sheltered, exterior areas that both protect during inclement weather, and expand the imagination; interconnecting students, curriculum and the natural environment to expand learning opportunities and increase well-being.

6. Protected Courtyard

The building shape provides a new, secure, internal courtyard at the heart of the school to provide supervisable and secure connection between all spaces, and facilitates the opportunity for fluid, safe access the outdoors for students to socialize.

7. Performing Arts

To expand the thriving performing arts program, the addition sites purpose-built space for drama and choir in a flexible rehearsal studio, allowing both programs to expand as young performers work in small groups and ensembles. The space itself is designed to also support informal performances in an intimate setting. And strategically holds space for future potential enhancements:
(Alternate) Multi-Purpose Assembly and Performance Venue sized to support District wide and community use.

8. Sustainability Woven Throughout

Planning aligns environmental stewardship with fiscal responsibility. The addition will reduce energy usage with an airtight and thermally insulated exterior and efficient HVAC systems that provide healthy ventilation to occupants. It will be equipped to be support expansion of the solar panel (PV) array and electric vehicle charging. Consideration for additional low-carbon strategies like added PV and Mass Timber are being considered.