



VISION 2030

ONE CAMPUS, ONE PARKLAND

Faculty and PTO Meetings Winter 2025 - Update v.2

Feasibility Recommendation

Final Decision Points

- Prioritize Students *First*
 - Safety
 - Continued Growth and Success in Three Pillars
 - Academics
 - Arts
 - Athletics
- *Fiscal* Responsibility
- Planning *Long-Term*
- *Community* minded



Parkland School District

*Educating for Success, Inspiring
Excellence*

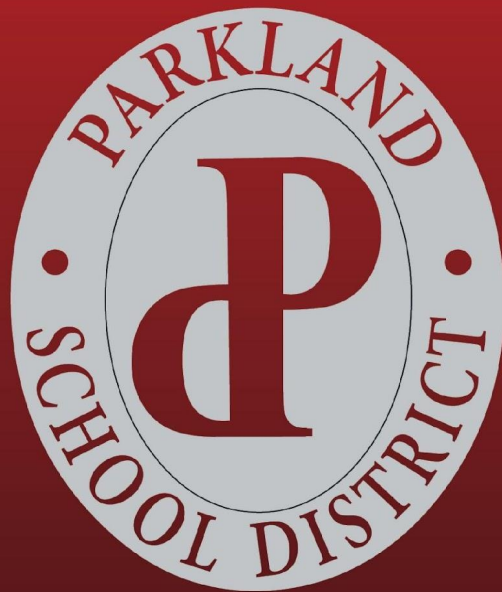

VISION 2030

VISION 2030

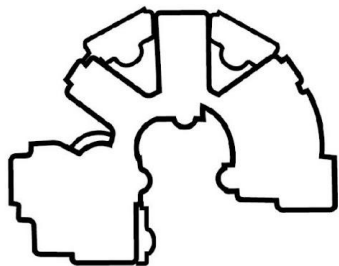

PARKLAND HIGH SCHOOL
RENOVATIONS & ADDITIONS

1



TRANSPORTATION
NEW SITE W/MAINTENANCE

2

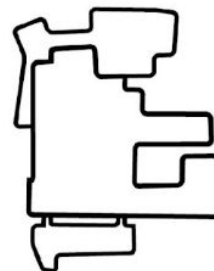

MIDDLE SCHOOL
RENOVATIONS & ADDITIONS

3



ATHLETICS
NEW COMPLEX & UPGRADES

4

VISION 2030

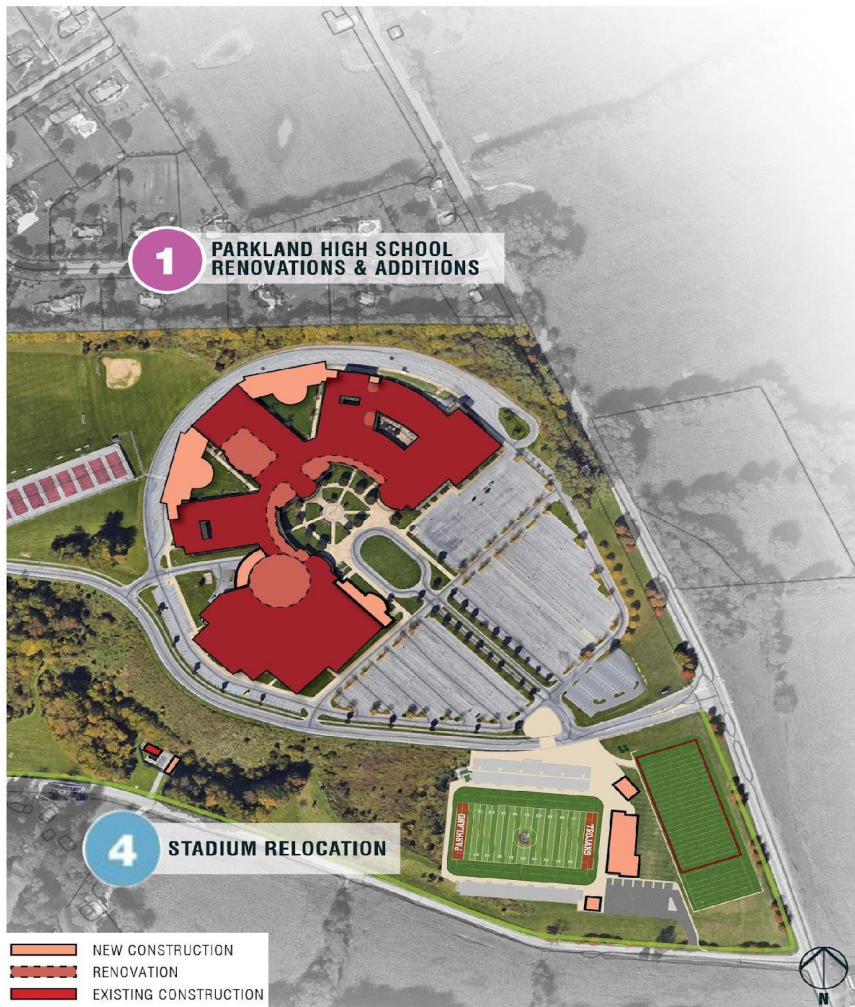

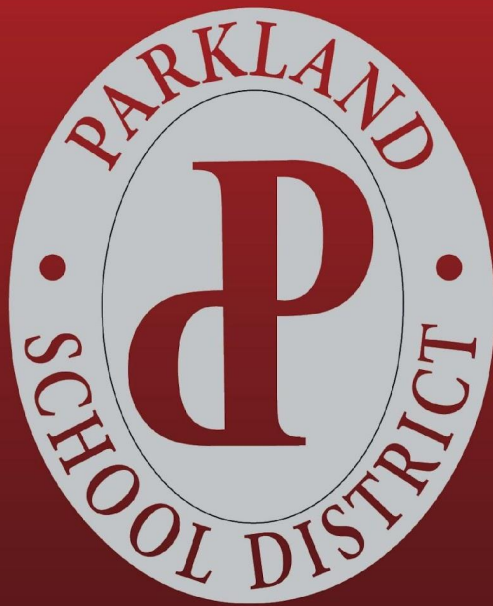

PARKLAND HIGH SCHOOL

OVERVIEW & UPDATES

PROJECT SCOPE

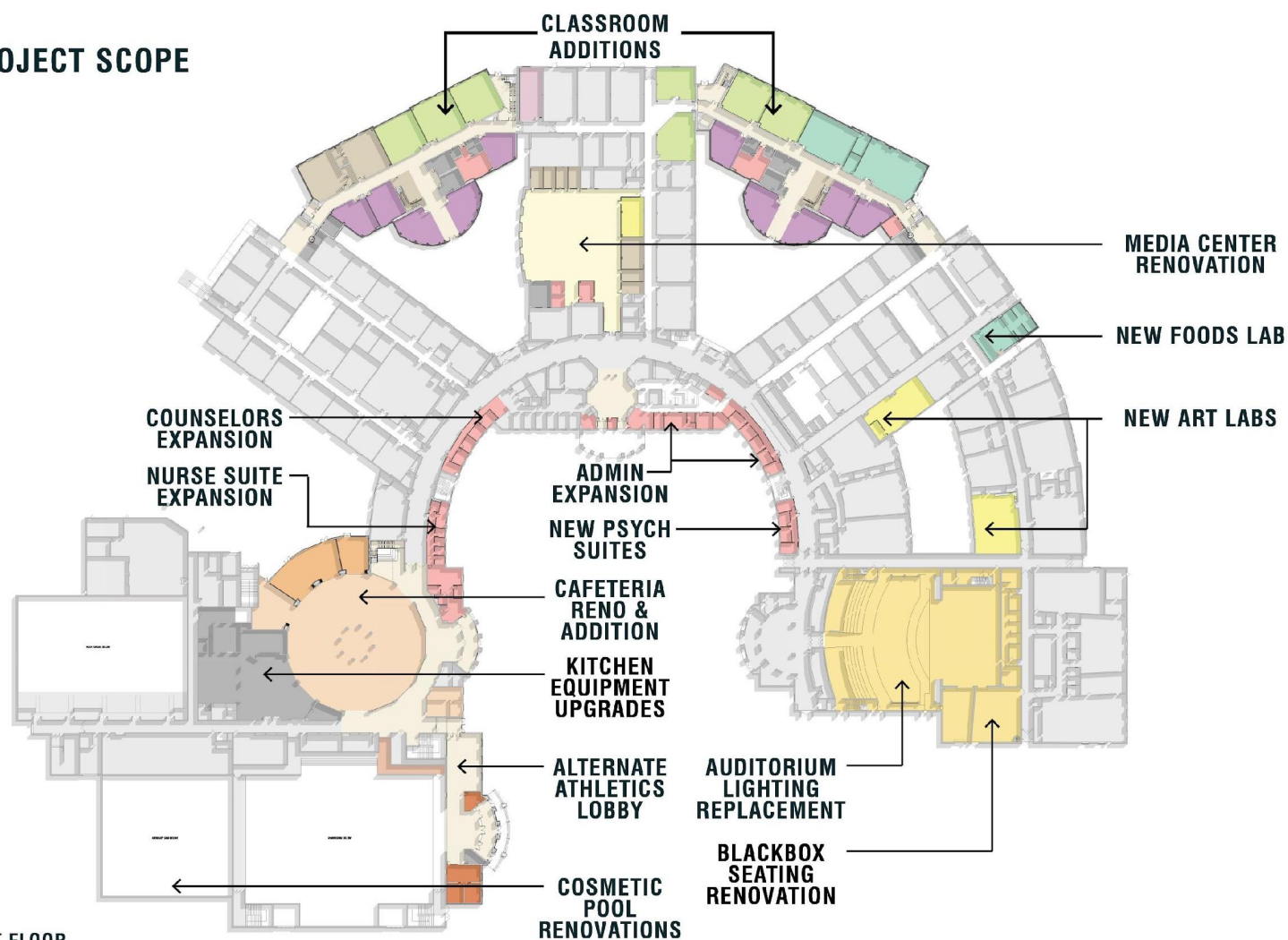

FIRST FLOOR

HS OVERVIEW | ACADEMICS



TYPICAL SCIENCE CLASSROOM VIEW



OPEN SGI/STAIR IN NEW ACADEMIC ADDITIONS



KEY PLAN

HS OVERVIEW | ADMINISTRATION



CURRENT HALLWAY VIEW INTO LOCKER BAYS



PROPOSED MAIN CORRIDOR

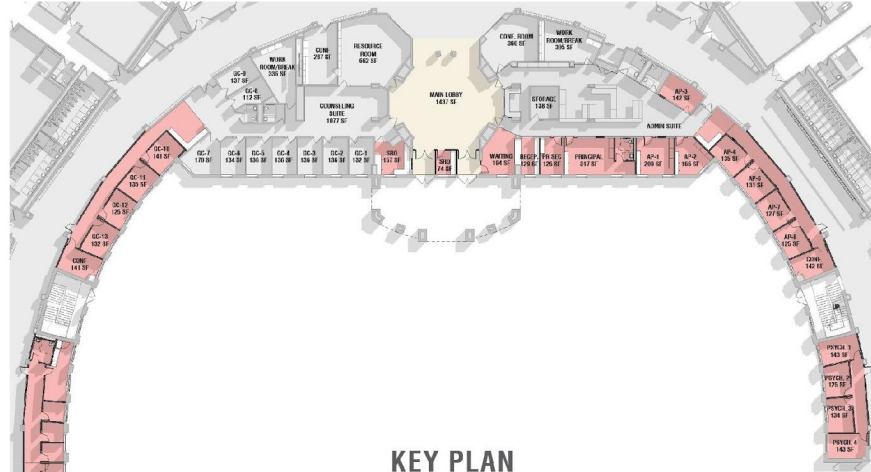

KEY PLAN

HS OVERVIEW | MEDIA CENTER

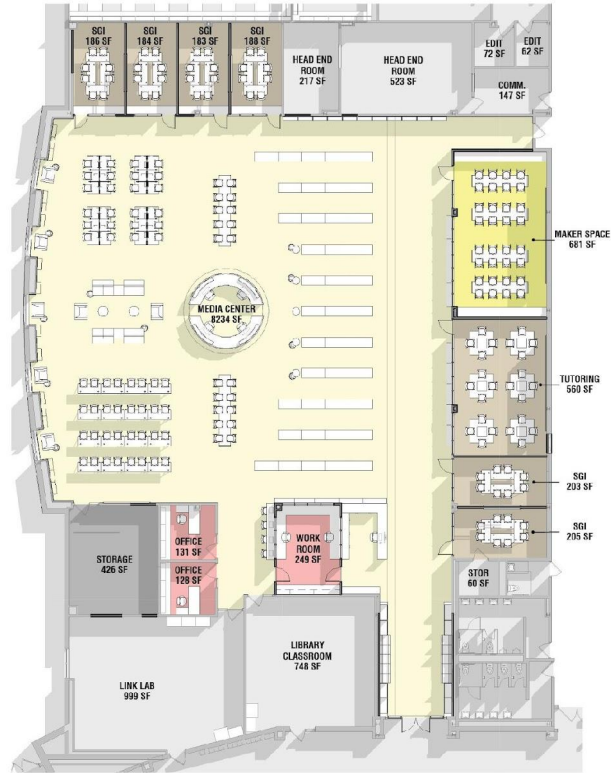

KEY PLAN



MEDIA CENTER OVERVIEW



MEDIA CENTER OVERVIEW

HS OVERVIEW | CAFETERIA

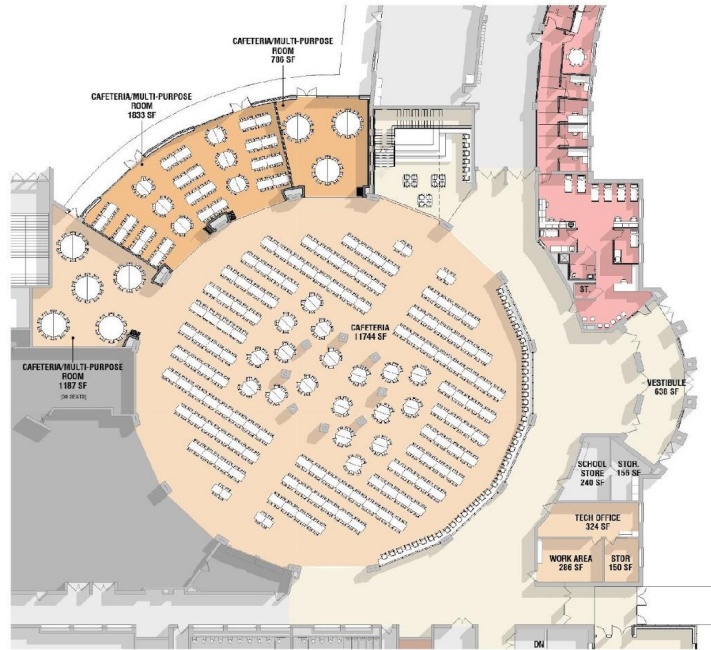

KEY PLAN

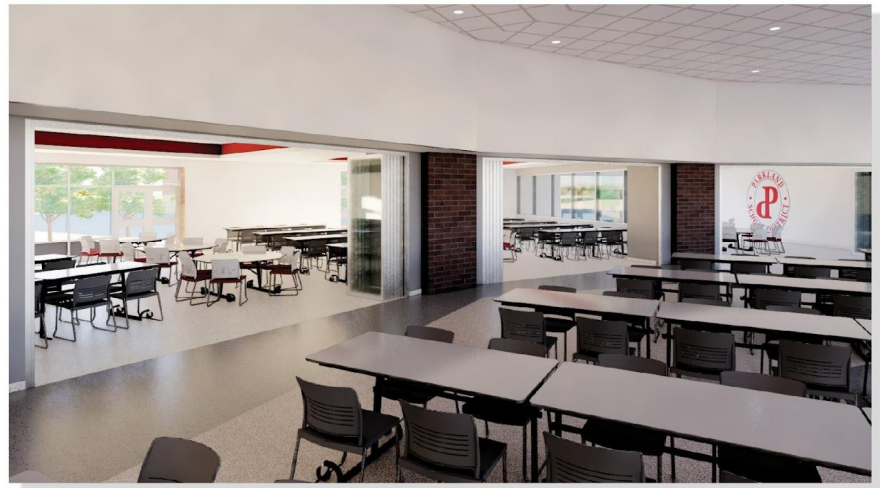

CAFETERIA/MULTI-PURPOSE ROOM ADDITIONS



NEW STAIR TO CONNECT 2ND FLOOR DIRECTLY TO CAFETERIA

HS OVERVIEW | ATHLETICS

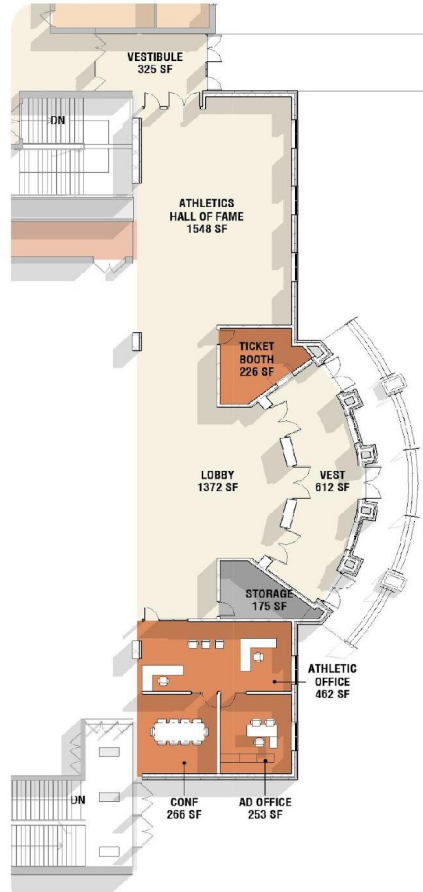

KEY PLAN



EXTERIOR VIEW OF ATHLETICS LOBBY ADDITION



ATHLETICS LOBBY VIEW LOOKING INTO GYMNASIUM

HS OVERVIEW | EXTERIOR VIEW KEY PLAN

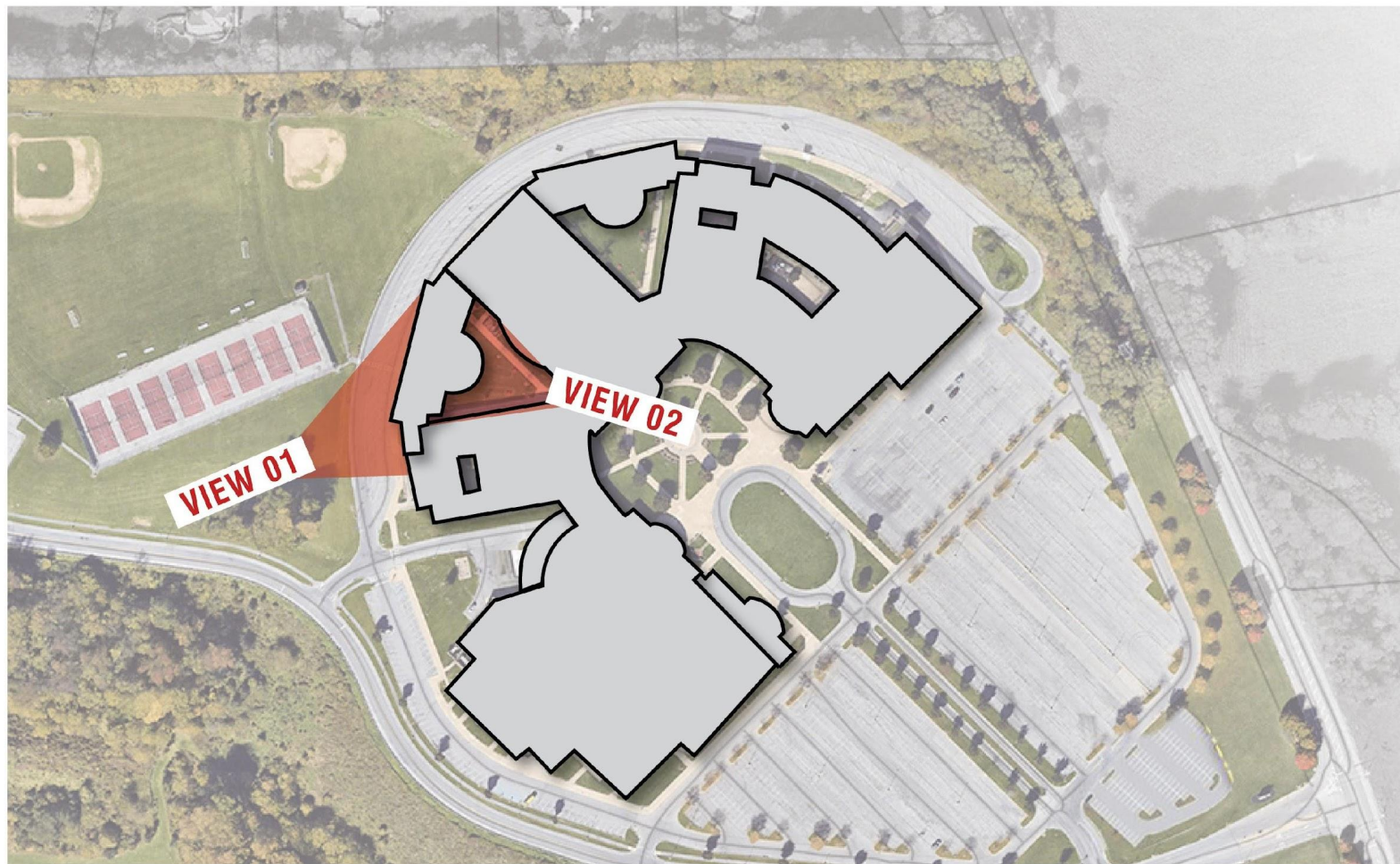

HS OVERVIEW | EXTERIOR VIEW 01



EXTERIOR VIEW FROM BUS LOOP



EXTERIOR VIEW FROM BUS LOOP

HIGH SCHOOL | TIMELINE

* VISION 2030 UPDATE EVERY OTHER BOARD MEETING STARTING SEPTEMBER 2024
THROUGH END OF THE PROJECT

* BOARD ACTION
* VISION 2030 UPDATES
* ACT 34 REQUIREMENTS

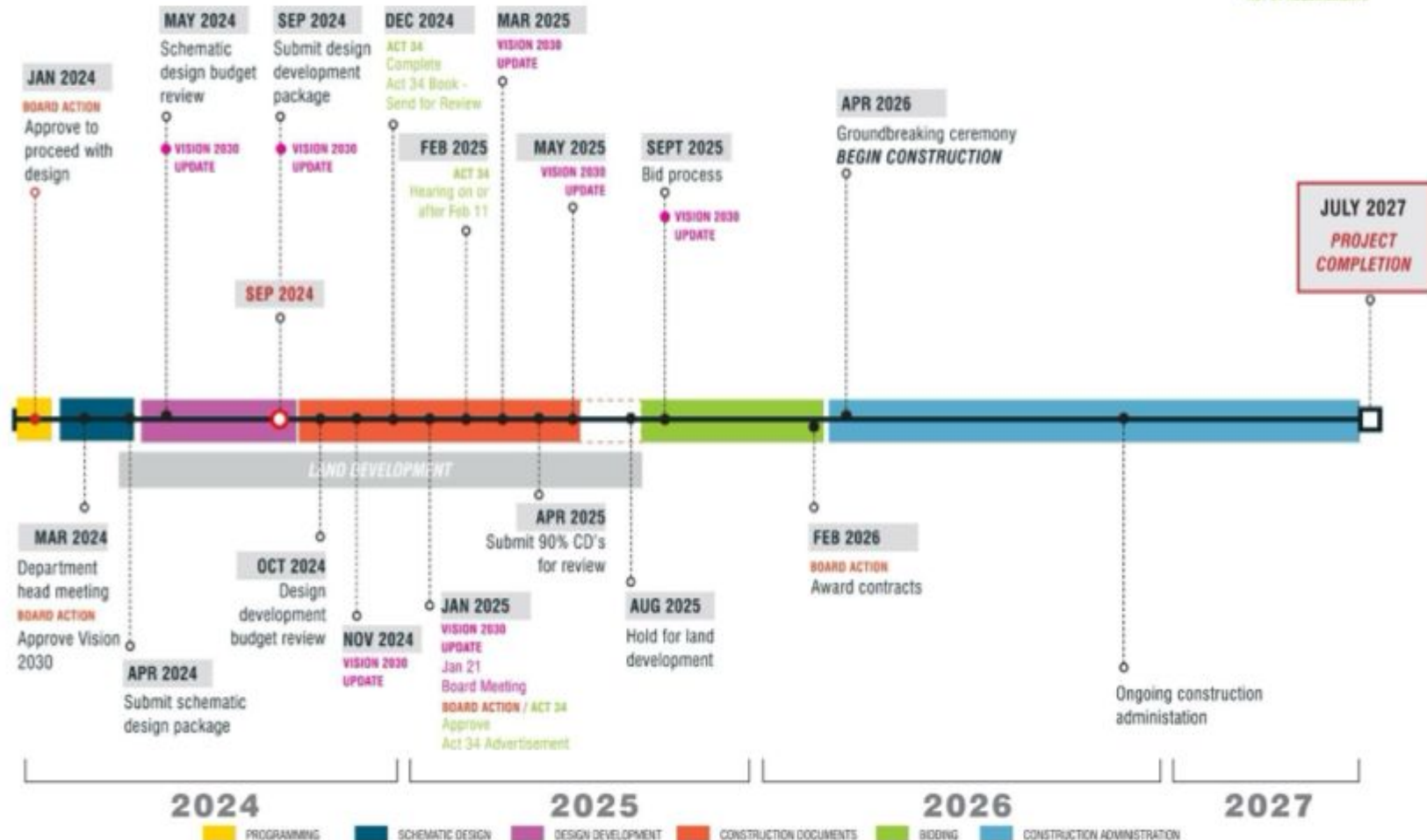

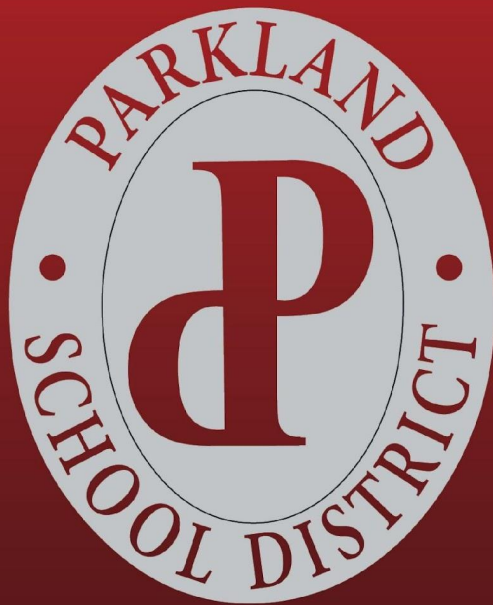

OREFIELD MIDDLE SCHOOL SITE UPGRADES: TRANSPORTATION

TRANSPORTATION CENTER | OPTION 1B



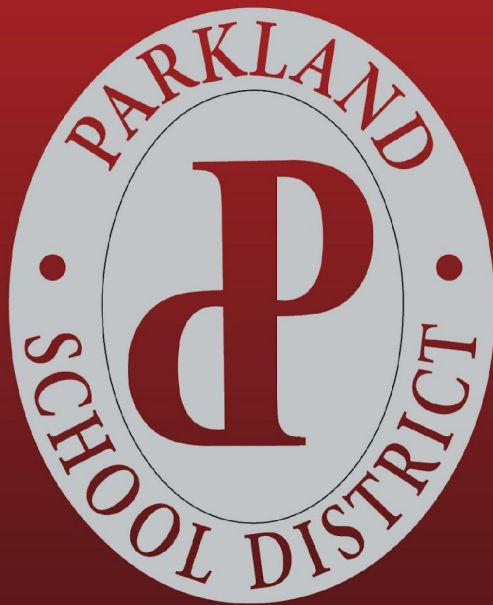

OREFIELD MIDDLE SCHOOL ADDITION AND RENOVATION

OREFIELD MIDDLE SCHOOL | SITE CONCEPT

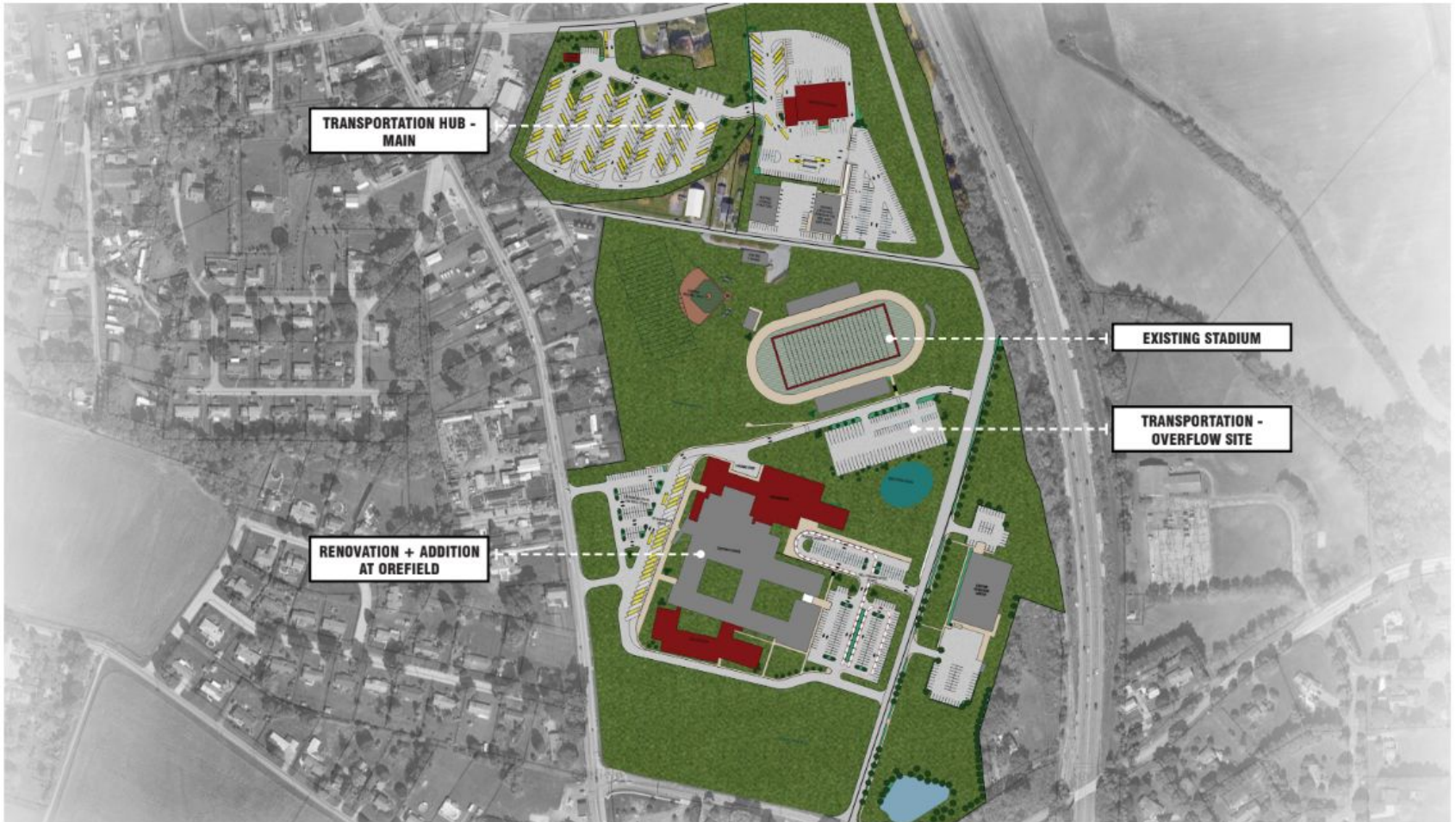

OREFIELD MIDDLE SCHOOL | SITE CONCEPT

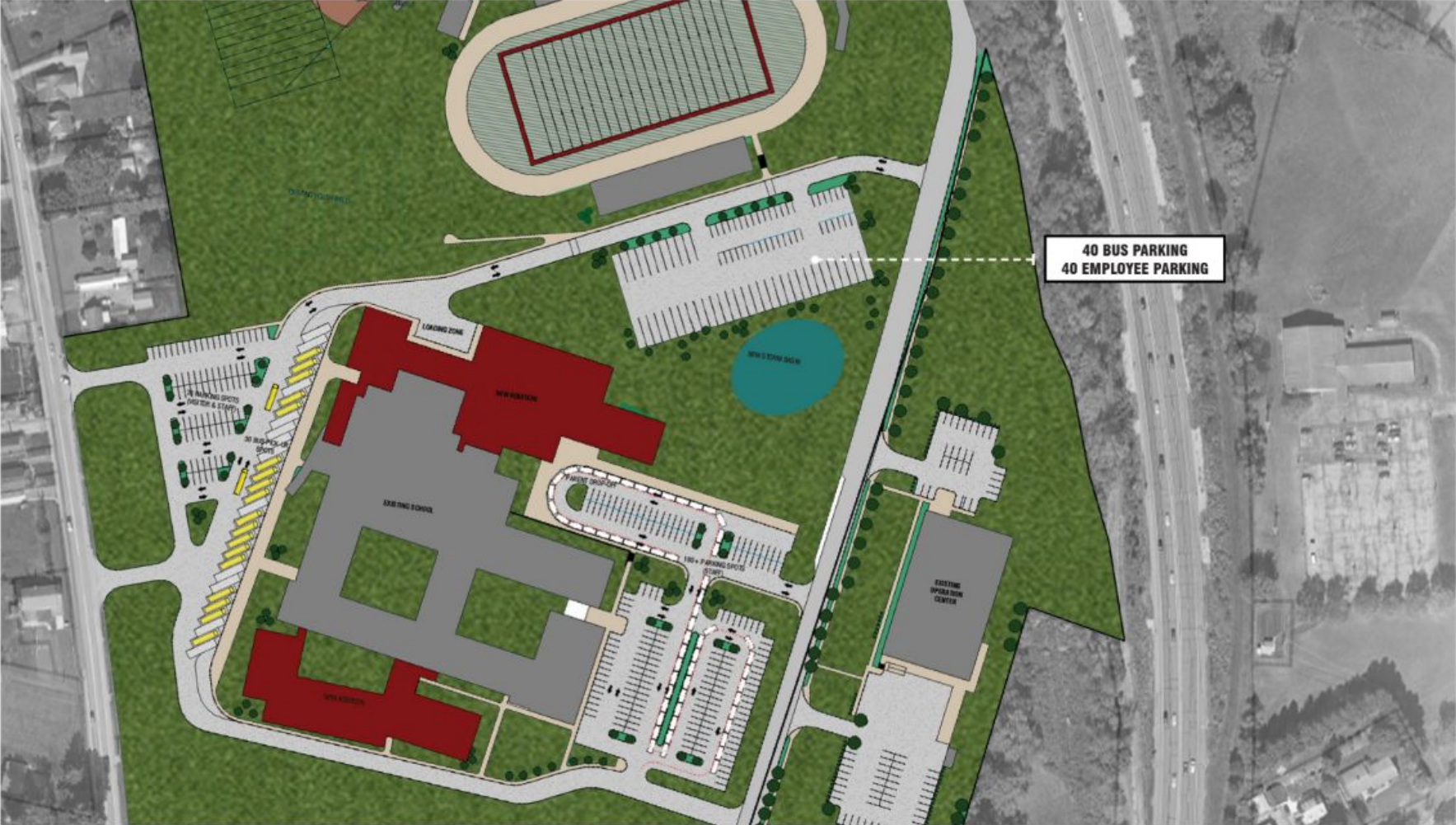

BUILDING SUMMARY:

DEMOLITION – 38,500 SF (INCLUDES
MAINTENANCE GARAGE)

EXISTING TO REMAIN – 159,972 SF

ADDITION – 100,000 SF

TOTAL BUILDING – 259,972 SF

CAPACITY – 1,600 STUDENTS

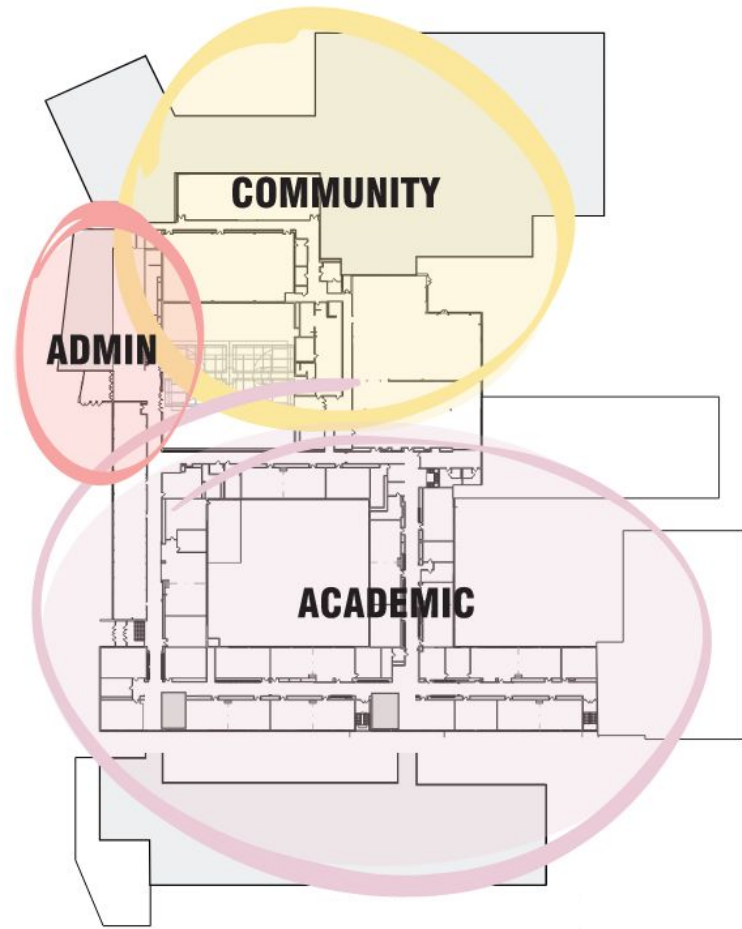



NEW MULTIPURPOSE COMPLEX AND UPGRADES

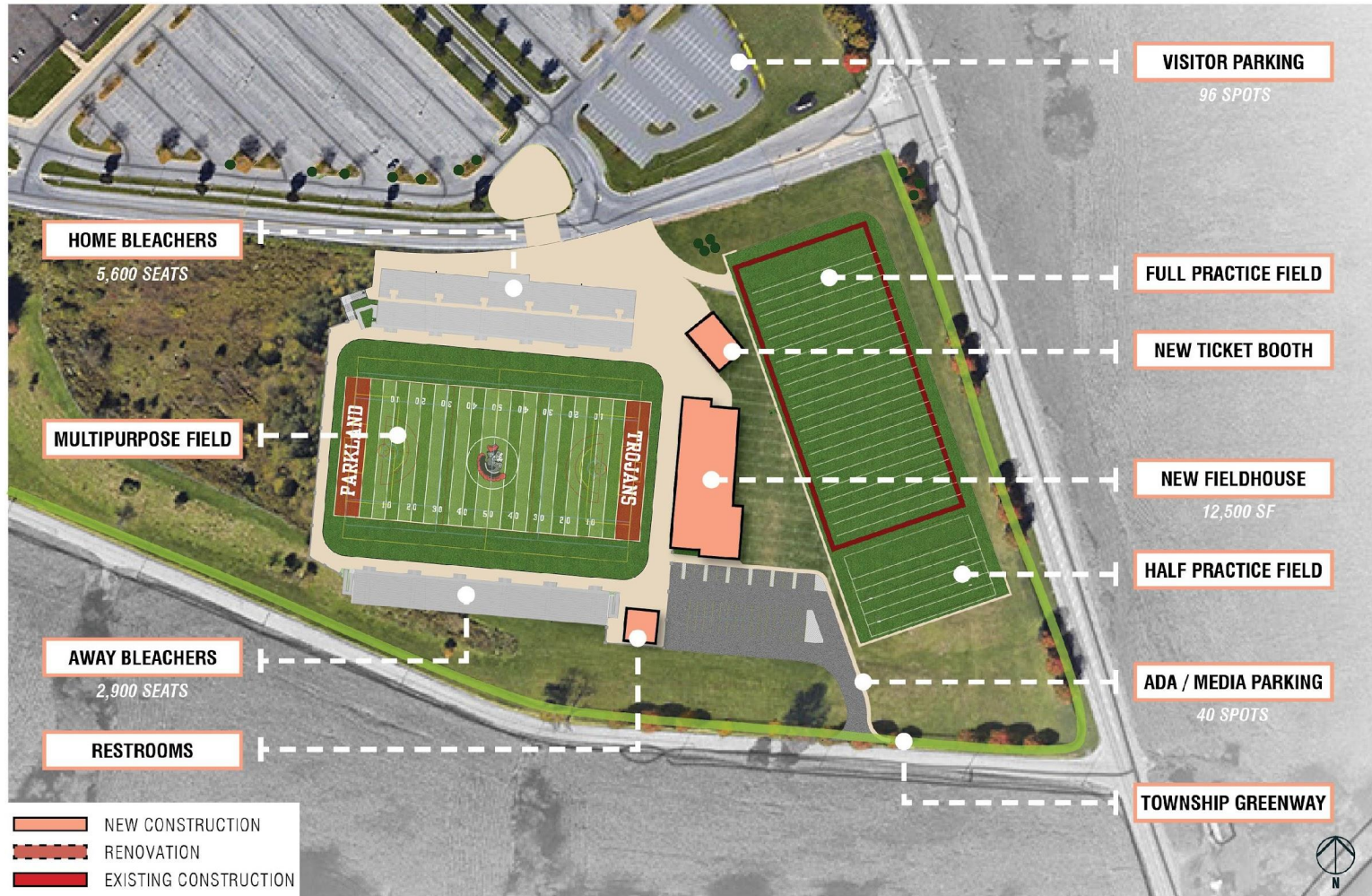

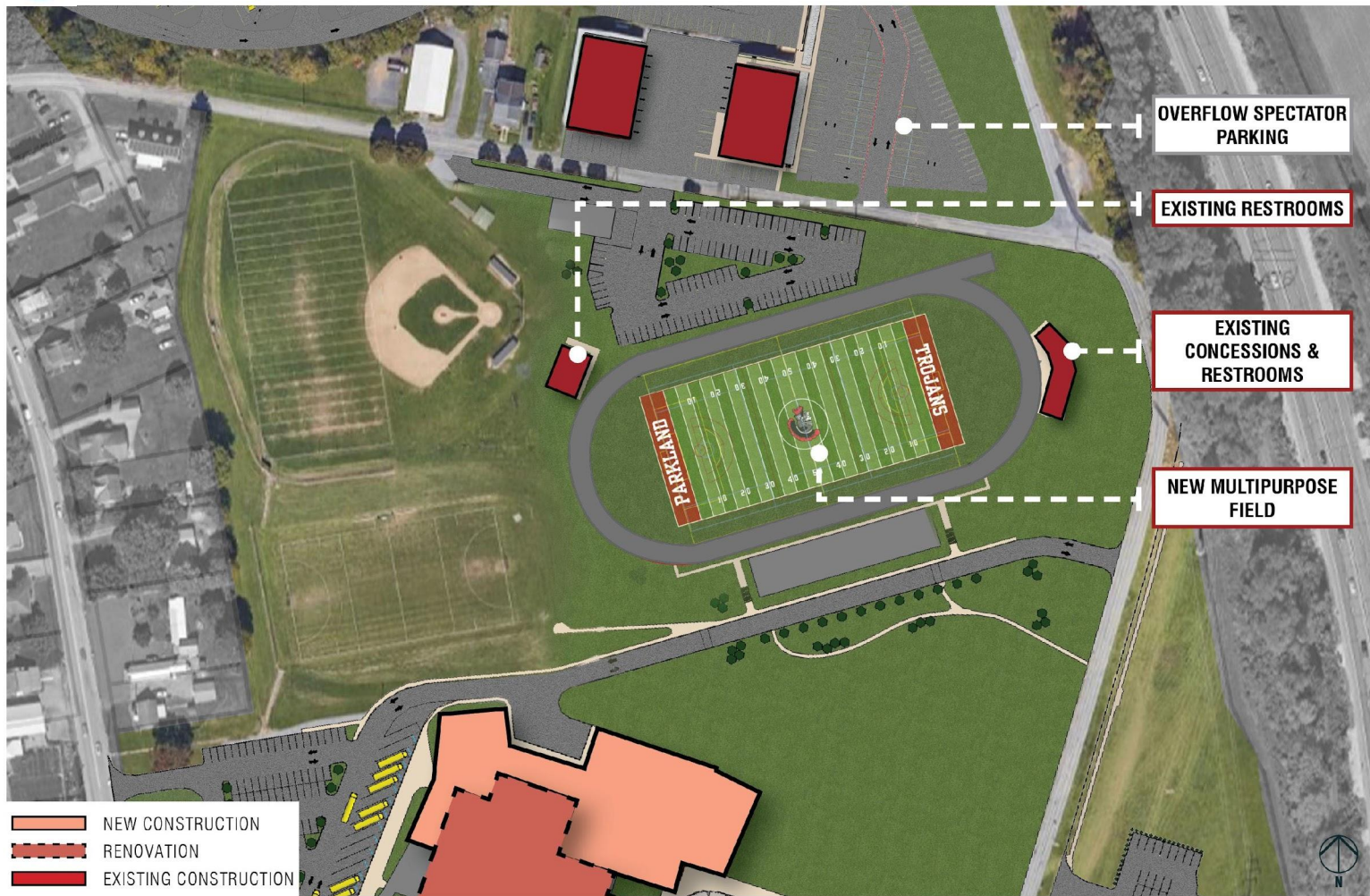

VISION 2030 | OVERVIEW OF TIMELINE

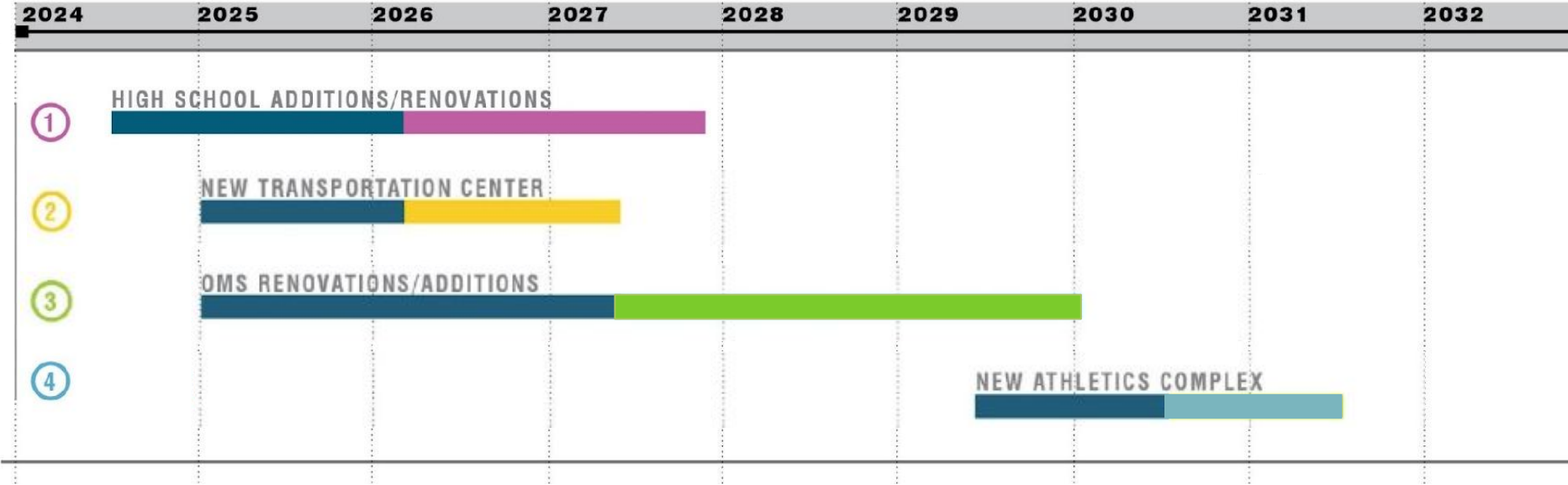



QUESTIONS?