

Merced City School District

**6th Grade Realignment
Boundary Adjustments**

Community Meeting #3
January 22, 2025



The Fundamental Questions

- Why do we have to consider a change?
- What is being proposed?
- Who might be affected?
- Where are they going?
- When will it happen?
- How will this plan work?



The Fundamental Questions – Why?

Elementary School	Capacity	Current Enrollment	Percent of Capacity
Rivera ES	813	917	112.8
Franklin	579	602	104.0
Peterson	667	690	103.4
Muir	594	613	103.2
Burbank	700	716	102.3
Fremont	570	578	101.4
Chenoweth	740	722	97.6
Stefani	664	641	96.5
Stowell	541	501	92.6
Givens	635	579	91.2
Wright	593	527	88.9
Gracey	623	509	81.7
Reyes	680	540	79.4
Sheehy	633	481	76.0



The Fundamental Questions – Why?

The Rivera Dilemma

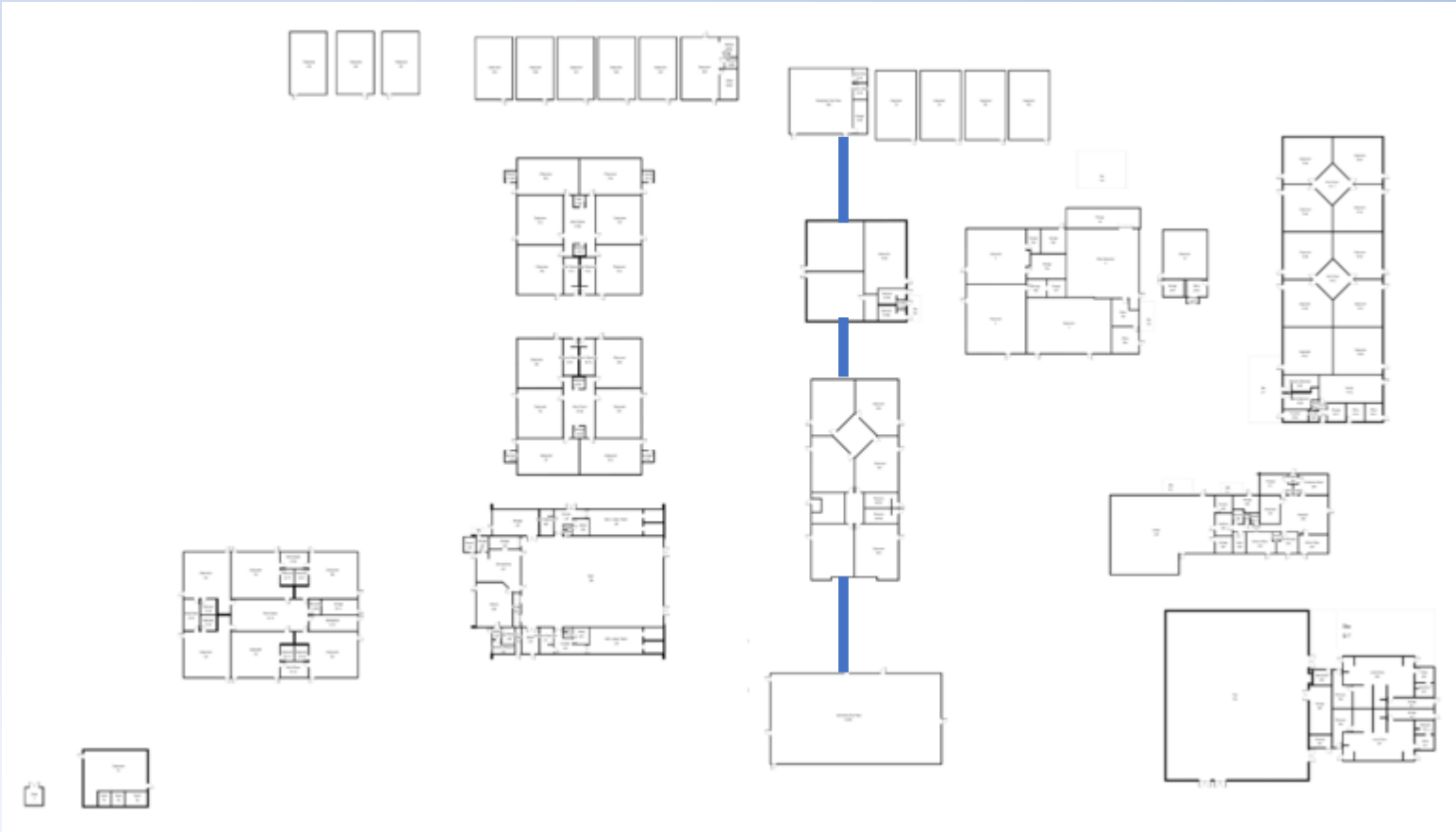

	Rivera ES	Rivera MS	Total
Current	917	608	1,525
Capacity	813	704	1,517

On a “shared” campus, the total population is greater than the combined capacity for students.

The Fundamental Questions – Why?

The Franklin/Stefani Dilemma



FRANKLIN ELEMENTARY SCHOOL

Watch Us Soar



STEFANI ELEMENTARY SCHOOL

Empowering our students today to be the future leaders of tomorrow!

	Franklin	Stefani	Total
Current	602	641	1,243
Capacity	579	664	1,243

These campuses share a boundary, but share students based on grade level.

The Fundamental Questions – Why?

Building Projections

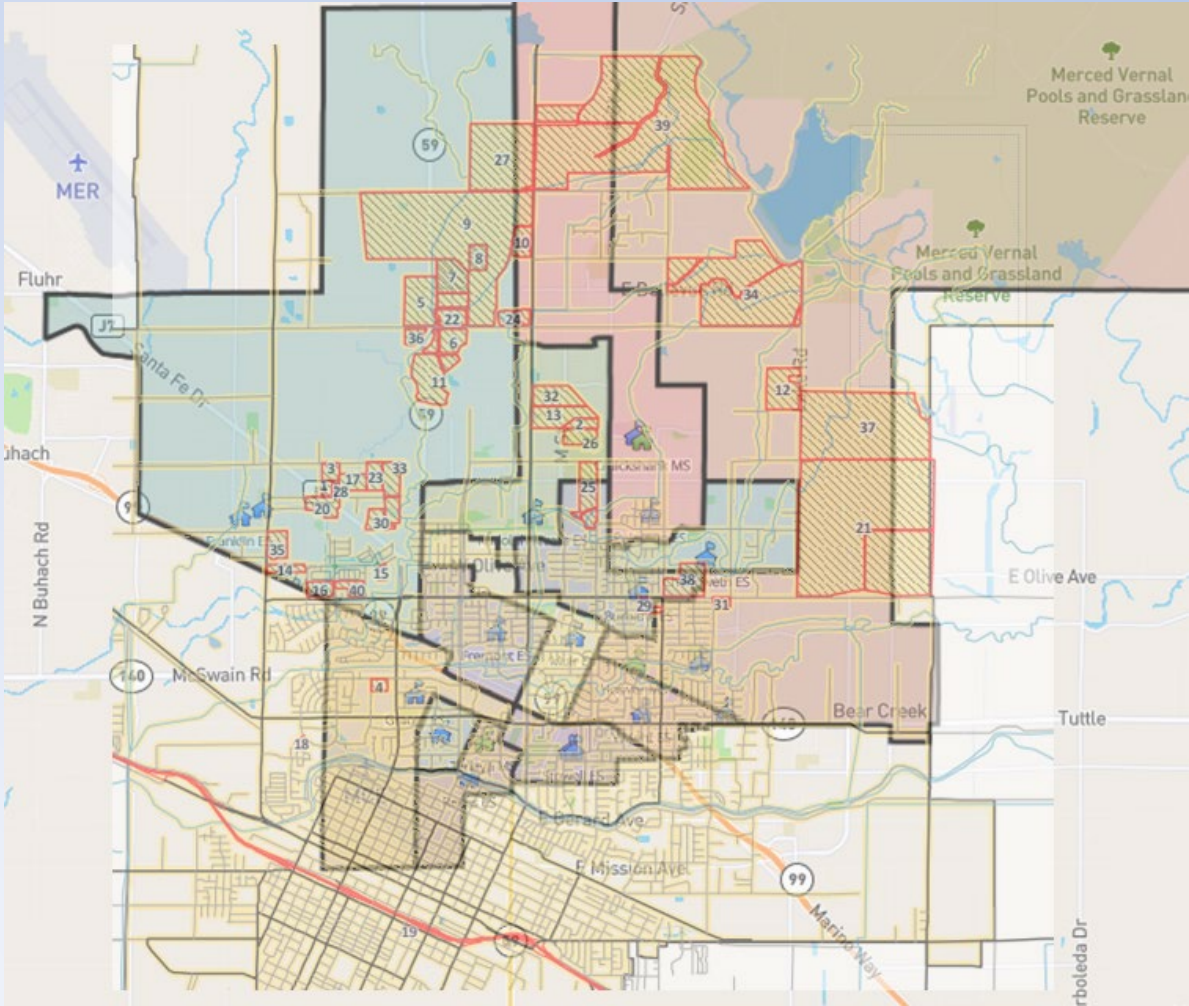

Total Units	23,839
Projected within 6 years	1,983
TK-6 Students (projected)*	498
Middle School (projected)*	139
* = 6 year projection	

Most impacted boundaries in the next 6 years are:

Elementary Schools:

- Peterson: 871 homes
- Franklin/Stefani: 852 homes

Middle Schools:

- Cruickshank: 1,433 homes
- Rivera Middle School: 415 homes

The Fundamental Questions – Why?

Building Projections and Impact

Elementary School	Capacity	Current Enrollment	New Construction	6 Year Total
Rivera ES: 115%	813	917	19	936
Franklin: 122%	579	602	107	709
Peterson: 136%	667	690	219	909
Muir	594	613	-	613
Burbank	700	716	-	716
Fremont: 105%	570	578	21	599
Chenoweth	740	722	-	722
Stefani: 112%	664	641	107	748
Stowell	541	501	-	501
Givens	635	579	13	594
Wright	593	527	-	527
Gracey	623	509	-	509
Reyes	680	540	-	540
Sheehy	633	481	-	481

The Fundamental Questions – What?

2 Theoretical Options:

- Build a New School
- Boundary Adjustments

Build a New School?:

- District Owns 3 Properties
- Approximately \$40M Price Tag
- State typically splits the cost 50/50, but our overall enrollment projections don't show that we need more classrooms, just realignment, so our eligibility for new construction is less than \$7M.
- District would have to fund the vast majority of the project, over \$33M.
- Without proof of increasing enrollment, no increased revenue to support operations of a new school.

Boundary Adjustments?:

- Schools are over capacity in North Merced, and under capacity in the South.
- Inconvenient to many
- Logistics
 - Families
 - District

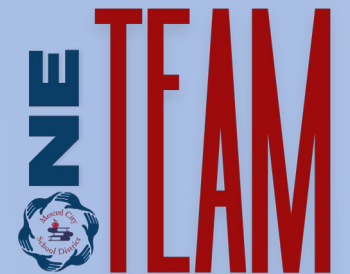

The Fundamental Questions – What?

New School vs. Boundary Adjustments

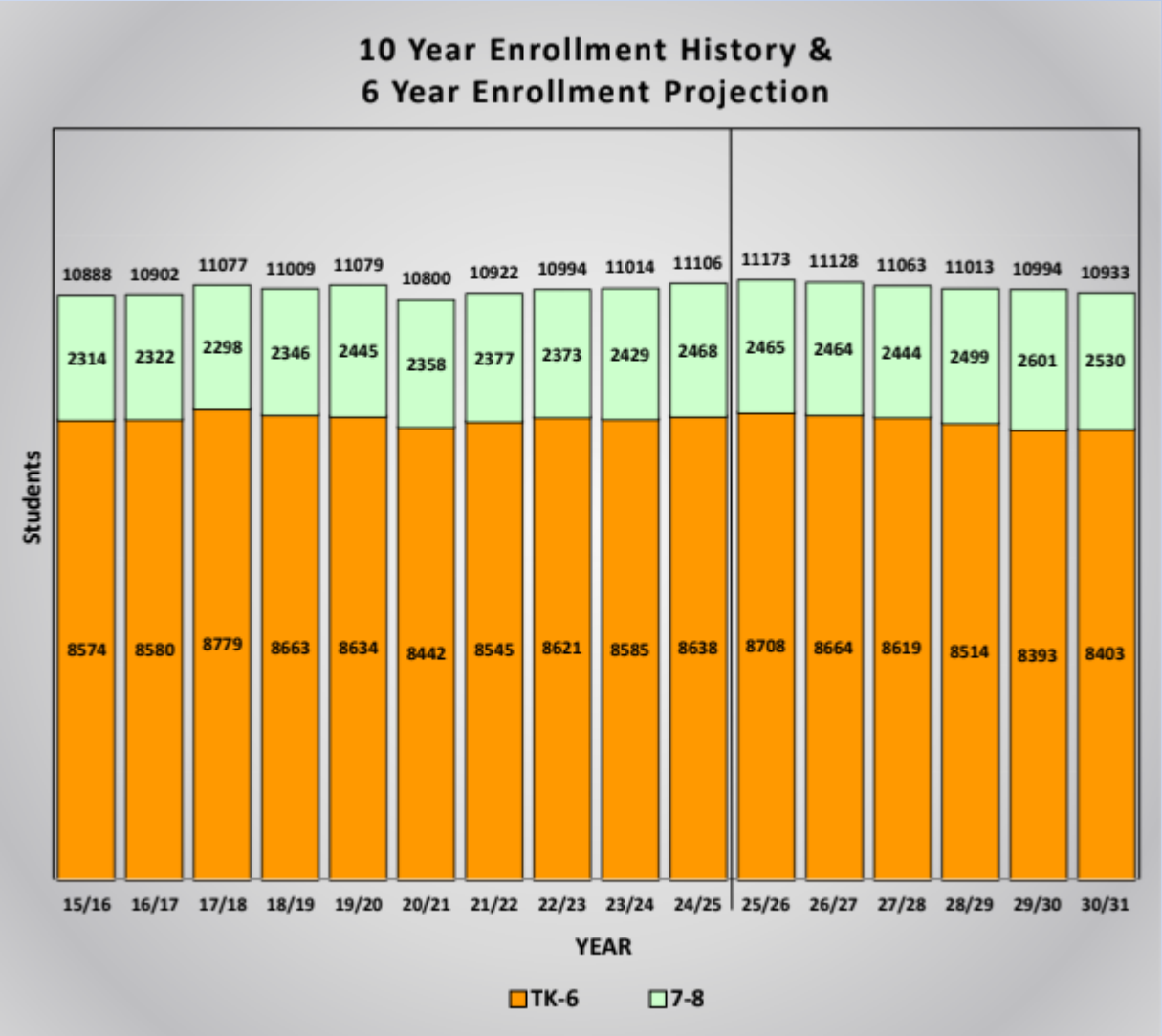

Demographic Study – November 2024

- Overall Student Population does not indicate the growth needed for State Funding to assist with a new school in MCSD.
- If the District were to build a new school, it would be done with minimal State assistance.
- Attendance determines the District’s revenue. With enrollment not going up, we would have to operate a new school with no additional funding.

What about our new Bond?

- Measure O brings \$80M to MCSD for facilities.
- Using these to build a new school would reduce the improvements at existing campuses, many of which are eligible for State assistance.
- MCSD has identified over \$800M of needed improvements at current sites.
- Does not cover staff costs to run a new school.

The Fundamental Questions – What?

New School vs. Boundary Adjustments

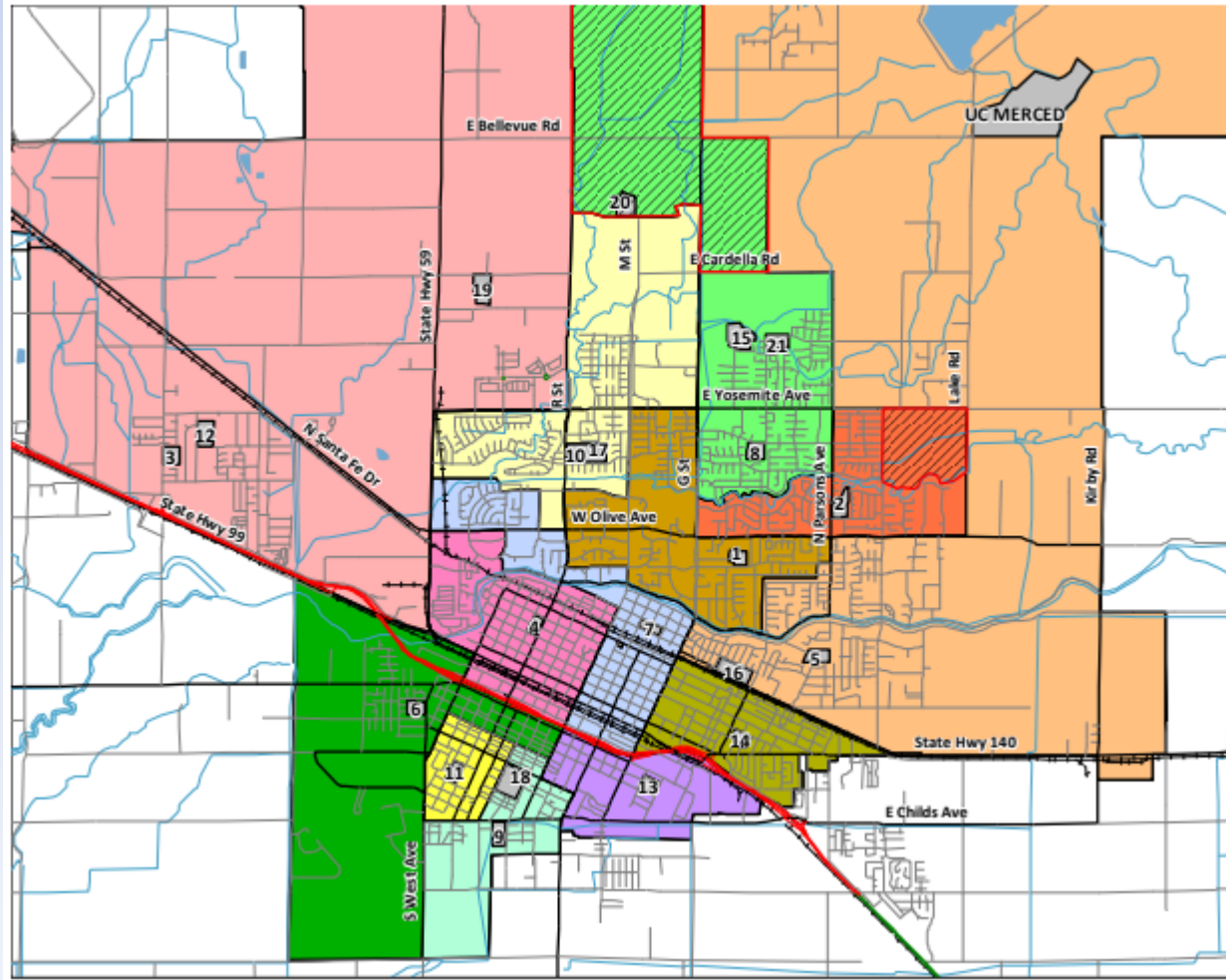

Current Boundary Map

MCSD Leadership determined Boundary Adjustments were needed to address this in the most efficient and effective way possible.

MCSD Established a committee to address overcrowding:

- Superintendent
- Assistant Superintendent – Educational Services
- Chief Business Officer
- Director of Facilities
- Director of Maintenance, Operations, and Transportation
- Director of Special Education
- Middle School Principals
- Elementary School Principals
- Staff Labor Union Presidents
- Community Members (recently added)

The Fundamental Questions – What?

Boundary Adjustments

	Committee	Staff Forum	Board	Community
September	X			
October	2X	X	X	
November	X	X	X	
December	X		X	X
January	X		X	2X

Board Action is coming January 28th/February 11th

The Fundamental Questions – Who, Where and When?

Scenario 1A – Cookie Cutter

Elementary School Boundary Adjustments for Fall 2025

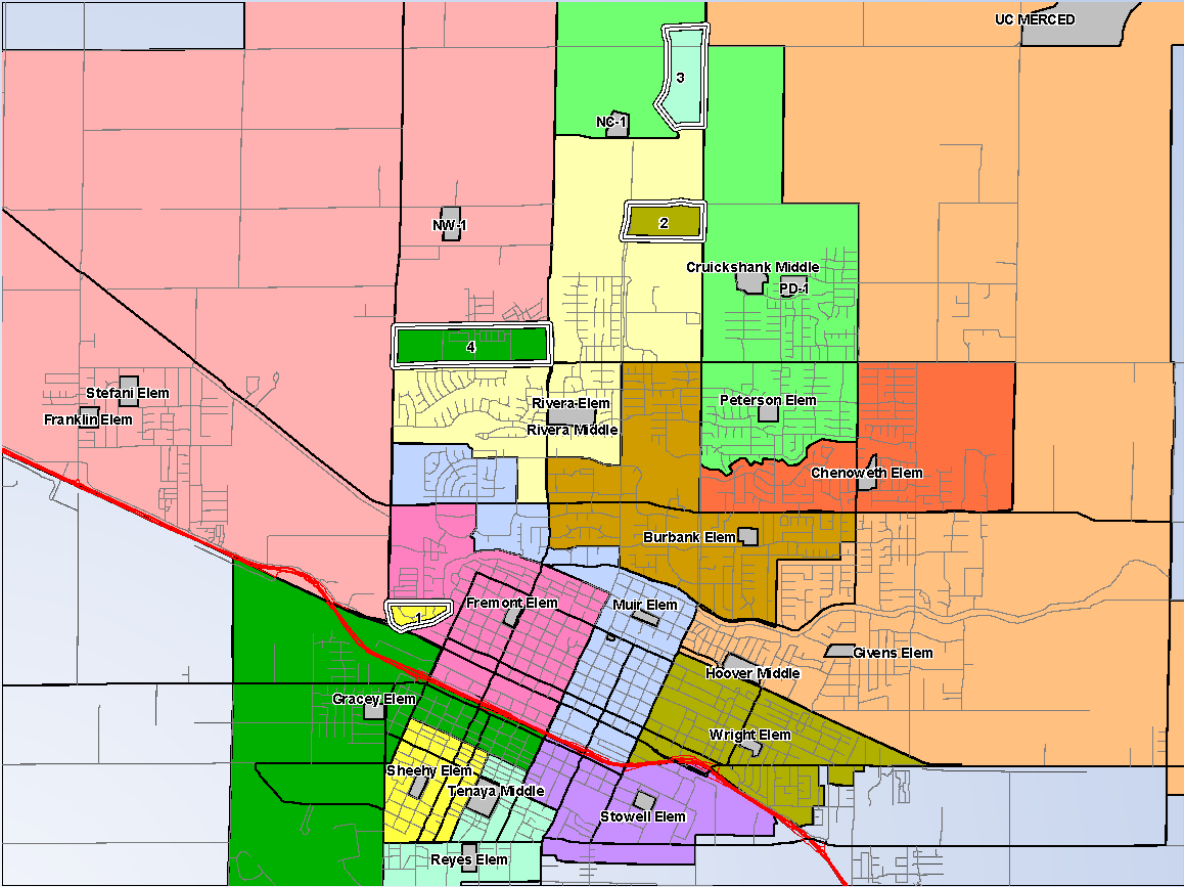

School Facility Utilization with Portables								
	Net	Net CR	2024/25	2025/26	2026/27	2030/31	2024/25	2030/31
Elementary Schools	Classrooms	Capacity	Current Enrollment	Projected Enrollment	Projected Enrollment	Projected Enrollment	Current Utilization	Projected Utilization
Burbank Elem	27	700	716	711	708	657	102.3%	93.9%
Chenoweth Elem	28	740	722	749	736	715	97.6%	96.6%
Franklin Elem	27	579	602	550	544	559	104.0%	96.5%
Fremont Elem	22	570	578	543	553	544	101.4%	95.4%
Givens Elem	24	635	579	556	551	499	91.2%	78.6%
Gracey Elem	24	623	509	609	623	673	81.7%	108.0%
Muir Elem	23	594	613	612	591	567	103.2%	95.5%
Peterson Elem	25	667	690	645	661	702	103.4%	105.2%
Reyes Elem	26	680	540	620	635	625	79.4%	91.9%
Rivera Elem	31	813	917	875	880	882	112.8%	108.5%
Sheehy Elem	24	633	481	546	527	476	76.0%	75.2%
Stefani Elem	22	664	641	624	630	609	96.5%	91.7%
Stowell Elem	23	541	501	490	471	458	92.6%	84.7%
Wright Elem	23	593	527	586	572	538	88.9%	90.7%
Sub-Totals	349	9,032	8,616	8,716	8,682	8,504	95.4%	94.2%
Middle Schools								
Cruickshank Middle	31	992	624	609	646	794	62.9%	80.0%
Hoover Middle	25	800	629	664	692	635	78.6%	79.4%
Rivera Middle	22	704	608	614	609	634	86.4%	90.1%
Tenaya Middle	33	1,056	607	578	517	467	57.5%	44.2%
Sub-Totals	111	3,552	2,468	2,465	2,464	2,530	69.5%	71.2%

The Fundamental Questions – Who, Where and When?

Scenario 1A – Cookie Cutter

Elementary School Boundary Adjustments for Fall 2025

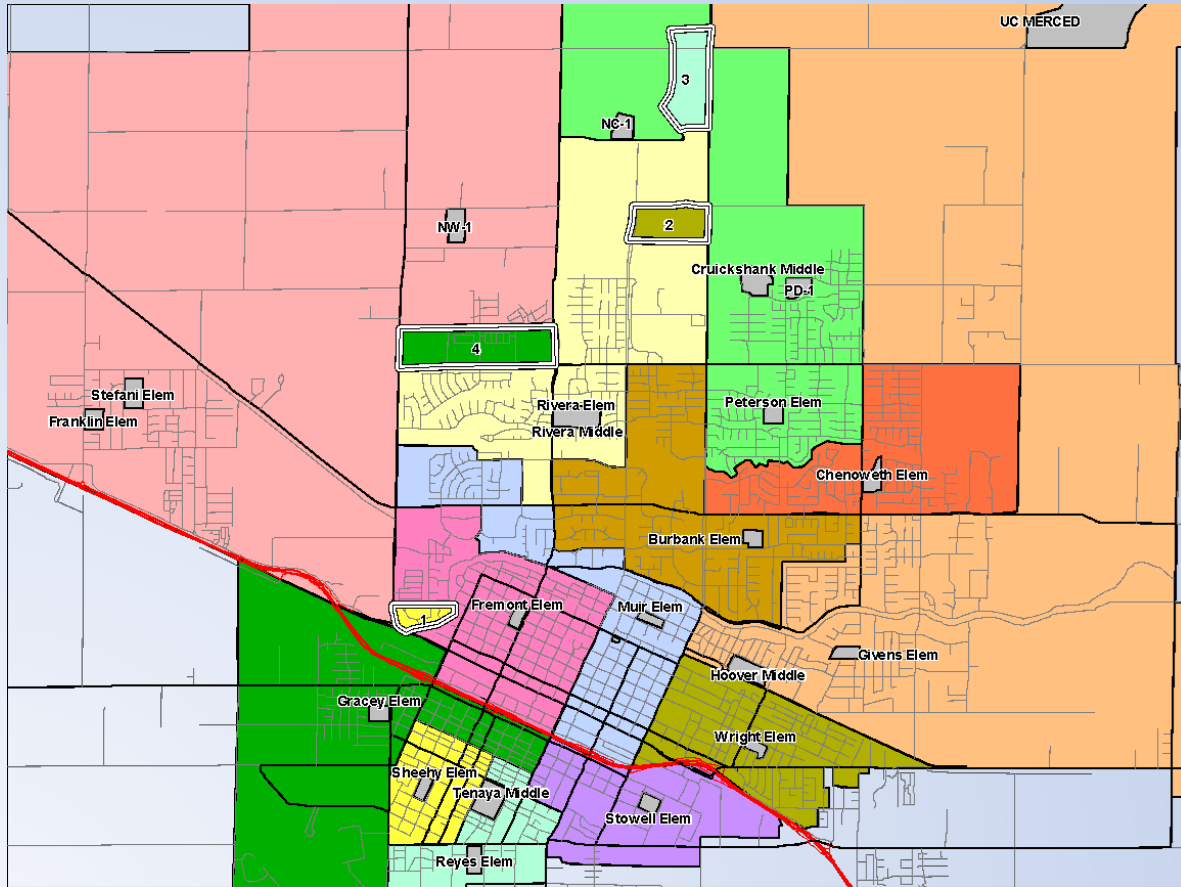

Pros:

- Minimal Student Impact (Approximately 300)

Cons:

- Long bus rides past many other schools for impacted students
- Partial/Short term Fix – 3 Schools will still be over capacity in year 1
- Boundary Adjustments would be needed again in the very near future

Not well received by MCSD Committee, Board of Trustees, Staff, or Community.

The Fundamental Questions – Who, Where and When?

Scenario 1B – Larger Scale

Elementary School Boundary Adjustments

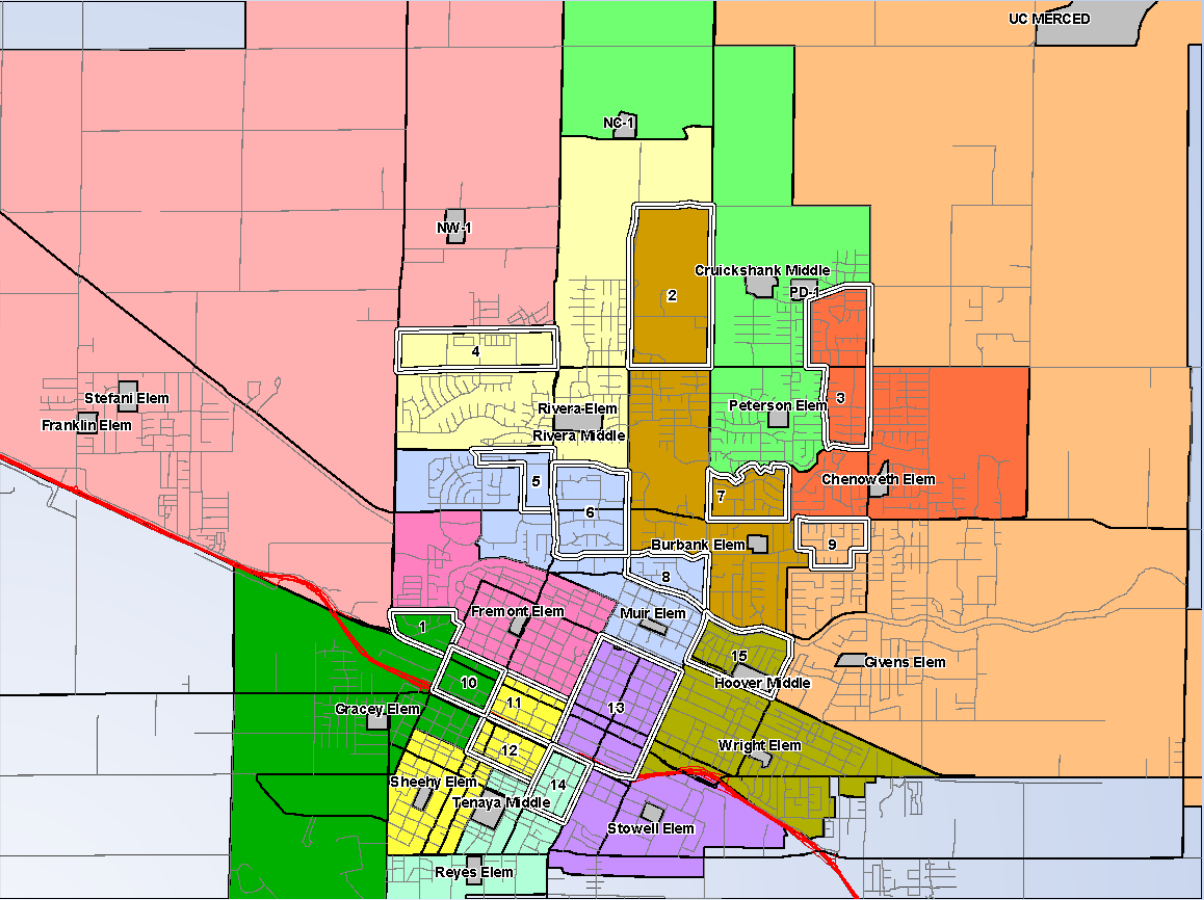

School Facility Utilization								
with Portables			2024/25	2025/26	2026/27	2030/31	2024/25	2030/31
	Net	Net CR	Current	Projected	Projected	Projected	Current	Projected
Elementary Schools	Classrooms	Capacity	Enrollment	Enrollment	Enrollment	Enrollment	Utilization	Utilization
Burbank Elem	27	698	716	687	678	621	102.6%	89.0%
Chenoweth Elem	28	730	722	763	753	755	98.9%	103.4%
Franklin Elem	27	579	602	550	544	559	104.0%	96.5%
Fremont Elem	22	570	578	520	526	513	101.4%	90.0%
Givens Elem	24	624	579	607	611	551	92.8%	88.3%
Gracey Elem	24	621	509	502	519	518	82.0%	83.4%
Muir Elem	23	594	613	647	628	635	103.2%	106.9%
Peterson Elem	25	667	690	591	618	661	103.4%	99.1%
Reyes Elem	26	680	540	651	651	642	79.4%	94.4%
Rivera Elem	31	813	917	907	919	944	112.8%	116.1%
Sheehy Elem	24	644	481	565	538	479	74.7%	74.4%
Stefani Elem	22	664	641	624	630	609	96.5%	91.7%
Stowell Elem	23	437	501	527	505	463	114.6%	105.9%
Wright Elem	23	593	527	572	552	511	88.9%	86.2%
Sub-Totals	349	8,914	8,616	8,713	8,672	8,461	96.7%	94.9%
Middle Schools								
Cruickshank Middle	31	992	624	609	646	794	62.9%	80.0%
Hoover Middle	25	800	629	664	692	635	78.6%	79.4%
Rivera Middle	22	704	608	614	609	634	86.4%	90.1%
Tenaya Middle	33	1,056	607	578	517	467	57.5%	44.2%
Sub-Totals	111	3,552	2,468	2,465	2,464	2,530	69.5%	71.2%

The Fundamental Questions – Who, Where and When?

Scenario 1B – Larger Scale Elementary School Boundary Adjustments

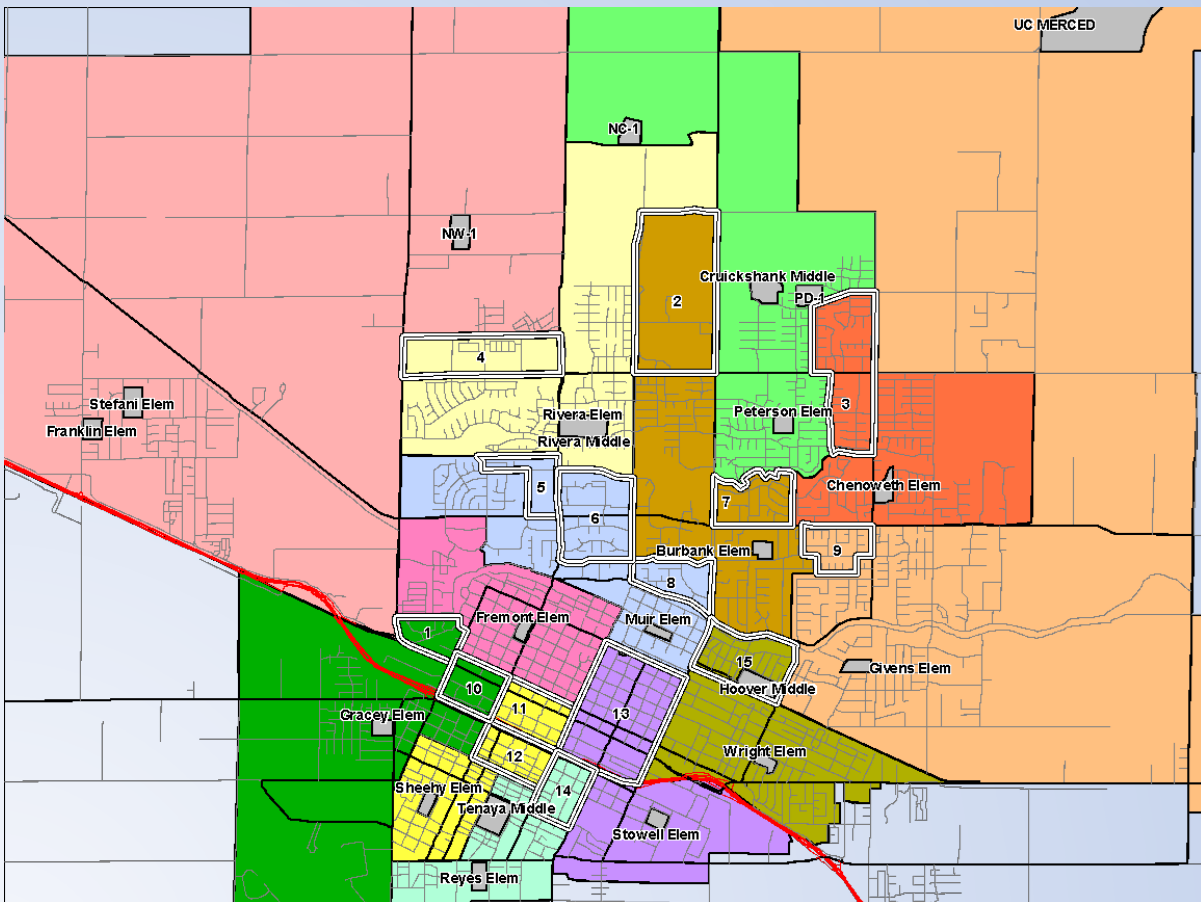

Pros:

- Shorter Bus Rides for eligible students compared to Scenario 1A

Cons:

- 1,200 impacted students
- Partial/Short Term Fix – 4 Schools would still be over capacity in the first year
- We would need to revisit boundary adjustments sooner rather than later

It became obvious that we needed to take a more aggressive approach to resolve the problem and the possibility of moving 6th Grade to Middle Schools became a strong option.

The Fundamental Questions – Who, Where and When?

Scenario 2 – “Rip the Band Aid Off”

Elementary and Middle School Boundary Adjustments and 6th Grade to Middle Schools for Next Year

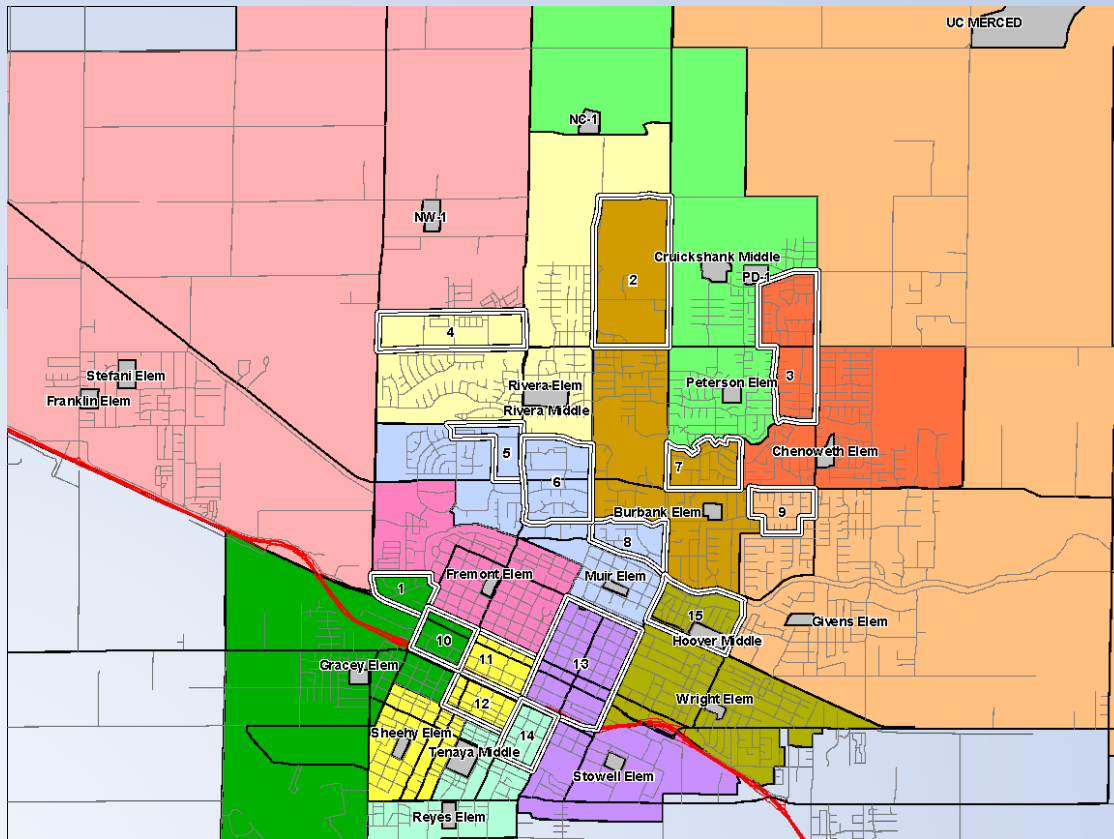

Scenario 2 Elementary School Map

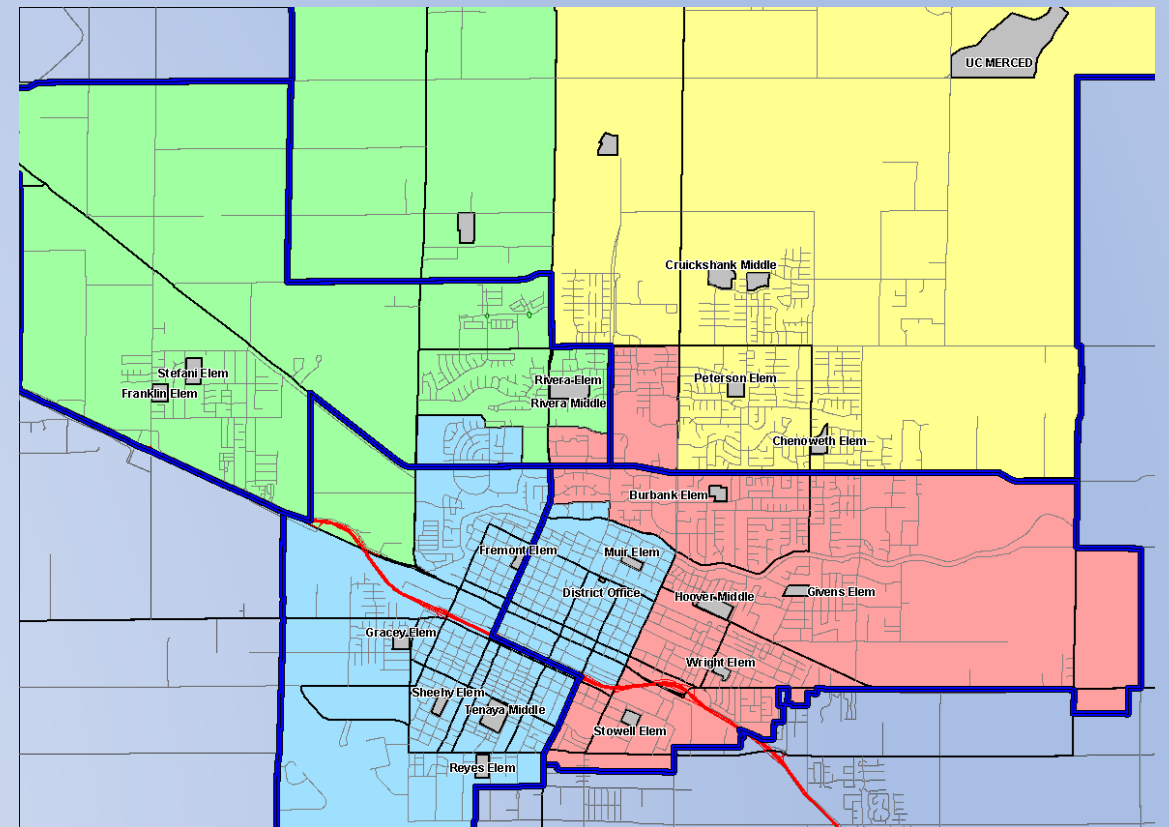

Scenario 2 Middle School Map

The Fundamental Questions – Who, Where and When?

Scenario 2 – “Rip the Band Aid Off”

Elementary and Middle School Boundary Adjustments and 6th Grade to Middle Schools for Next Year

School Facility Utilization

with Portables

	Net	Net CR	2024/25	2025/26	2026/27	2030/31	2024/25	2030/31
	Classrooms	Capacity	Current Enrollment	Projected Enrollment	Projected Enrollment	Projected Enrollment	Current Utilization	Projected Utilization
Elementary Schools								
Burbank Elem	27	700	716	619	613	574	102.3%	82.0%
Chenoweth Elem	28	719	722	626	631	599	100.4%	83.3%
Franklin Elem	27	633	602	546	545	554	95.1%	87.5%
Fremont Elem	22	552	578	537	549	539	104.7%	97.6%
Givens Elem	24	610	579	493	481	445	94.9%	73.0%
Gracey Elem	24	612	509	450	442	427	83.2%	69.8%
Muir Elem	23	577	613	508	500	476	106.2%	82.5%
Peterson Elem	25	643	690	628	652	682	107.3%	106.1%
Reyes Elem	26	681	540	470	454	437	79.3%	64.2%
Rivera Elem	31	788	917	811	821	777	116.4%	98.6%
Sheehy Elem	24	620	481	395	382	343	77.6%	55.3%
Stefani Elem	22	632	641	557	577	567	101.4%	89.7%
Stowell Elem	23	449	501	414	407	398	111.6%	88.6%
Wright Elem	23	593	527	429	414	393	88.9%	66.3%
Sub-Totals	349	8,809	8,616	7,483	7,468	7,211	97.8%	81.9%
Middle Schools								
Cruickshank Middle	31	992	624	809	793	951	62.9%	95.9%
Hoover Middle	25	800	629	873	845	750	78.6%	93.8%
Rivera Middle	22	704	608	825	780	869	86.4%	123.4%
Tenaya Middle	33	1,056	607	1,019	1,084	1,002	57.5%	94.9%
Sub-Totals	111	3,552	2,468	3,526	3,502	3,572	69.5%	100.6%

Pros:

- Immediate Relief at 13/14 Elementary Schools
- Shorter Bus Rides

Cons:

- Not a long term fix
- Short time to adjust for 6th Grade Move
- Rivera Impact: Combined Enrollment increases
- RMS: 123% capacity in 5 years
- Unbalanced classrooms: Elementary schools would vary in attendance from 811 to 395

Feedback:

- On the right track, but still had work to do.
- Not enough time to prepare for 6th grade at MS
- Neighborhood conflicts

The Fundamental Questions – Who, Where and When?

Scenario 3 – Phased Approach

Elementary Boundary Adjustments Next Year

6th Grade to Middle Schools with Boundary Adjustments for Fall 2026

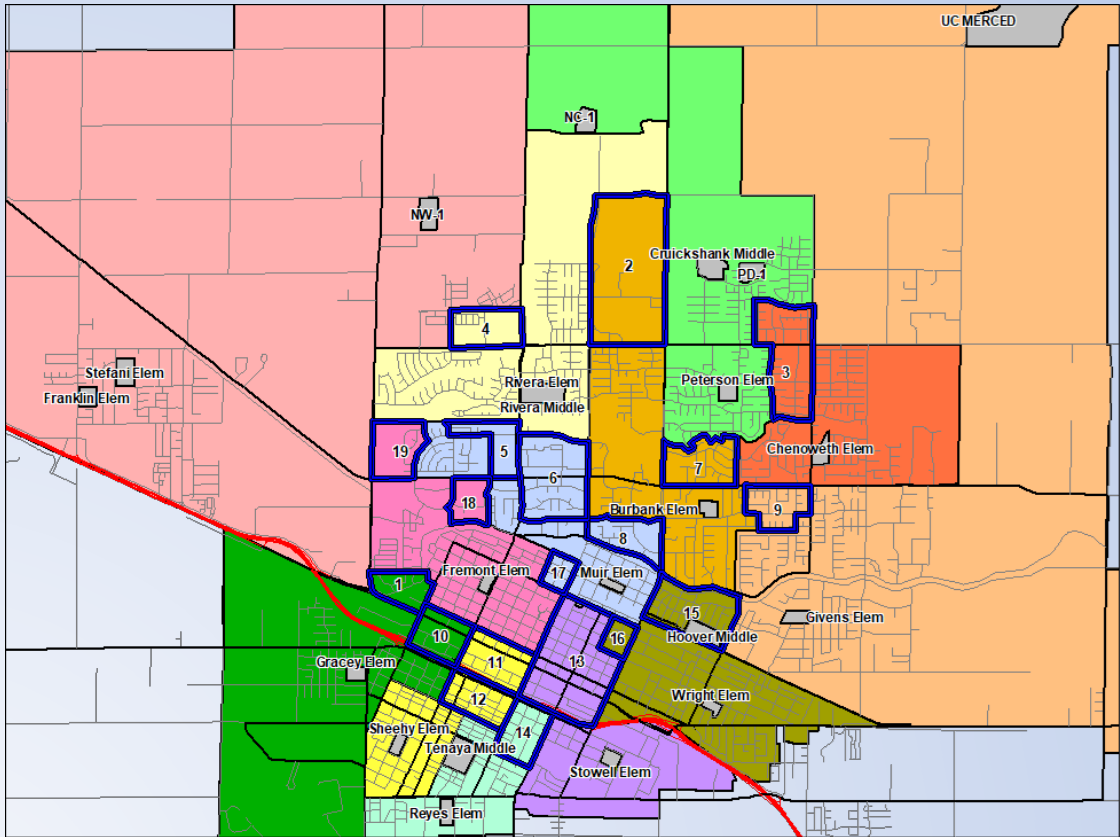

Scenario 3 Elementary School Map

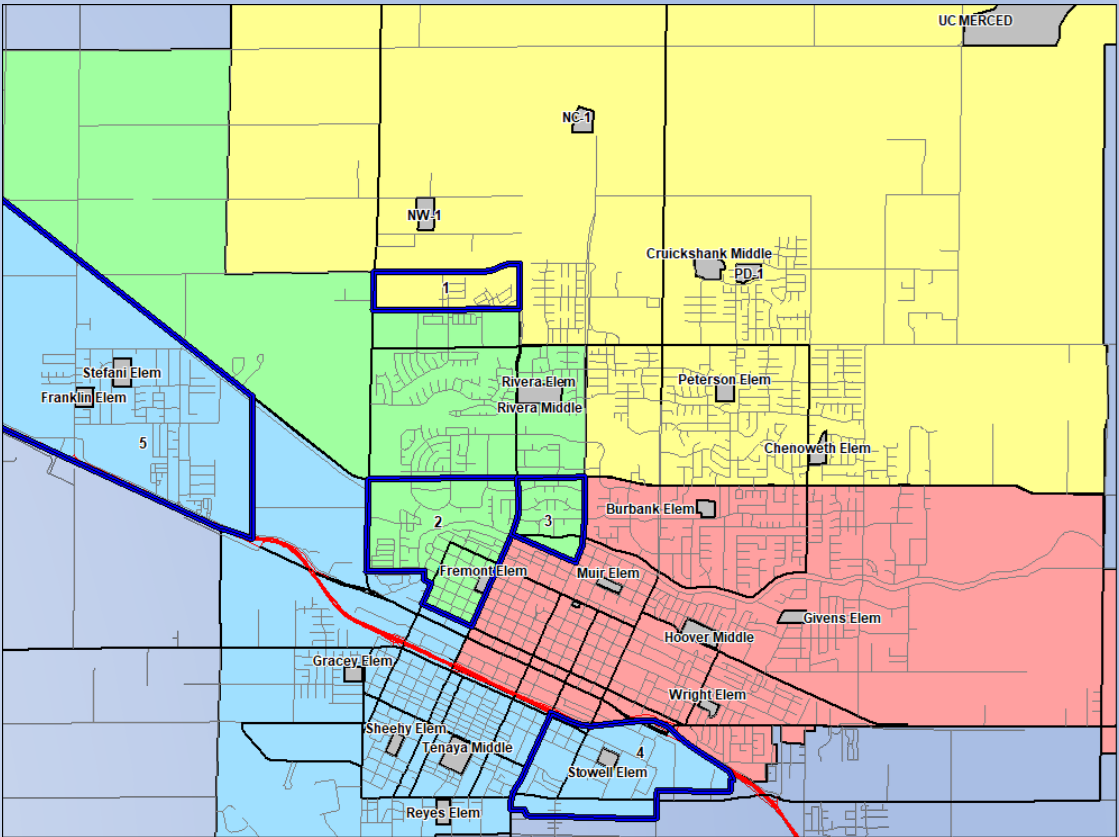

Scenario 3 Middle School Map

The Fundamental Questions – Who, Where and When?

Scenario 3 – Phased Approach

Elementary Boundary Adjustments Next Year

6th Grade to Middle Schools with Boundary Adjustments for Fall 2026

School Facility Utilization with Portables								
	Net	Net CR	2024/25	2025/26	2026/27	2030/31	2024/25	2030/31
Elementary Schools	Classrooms	Capacity	Current Enrollment	Projected Enrollment	Projected Enrollment	Projected Enrollment	Current Utilization	Projected Utilization
Burbank Elem	27	698	716	687	573	542	102.6%	77.7%
Chenoweth Elem	28	740	722	736	629	617	97.6%	83.4%
Franklin Elem	27	581	602	574	522	550	103.6%	94.7%
Fremont Elem	22	568	578	556	484	469	101.8%	82.6%
Givens Elem	24	624	579	607	531	493	92.8%	79.0%
Gracey Elem	24	621	509	502	464	457	82.0%	73.6%
Muir Elem	23	594	613	612	508	512	103.2%	86.2%
Peterson Elem	25	667	690	618	548	589	103.4%	88.3%
Reyes Elem	26	680	540	651	554	558	79.4%	82.1%
Rivera Elem	31	813	917	857	748	752	112.8%	92.5%
Sheehy Elem	24	644	481	565	462	427	74.7%	66.3%
Stefani Elem	22	664	641	651	544	531	96.5%	80.0%
Stowell Elem	23	529	501	504	424	421	94.7%	79.6%
Wright Elem	23	593	527	602	499	482	88.9%	81.3%
Sub-Totals	349	9,016	8,616	8,722	7,490	7,400	95.6%	82.1%
Middle Schools								
Cruickshank Middle	39	1,248	624	609	1,073	1,283	50.0%	102.8%
Hoover Middle	25	800	629	664	852	766	78.6%	95.8%
Rivera Middle	22	704	608	614	607	662	86.4%	94.0%
Tenaya Middle	33	1,056	607	578	1,132	1,042	57.5%	98.7%
Sub-Totals	119	3,808	2,468	2,465	3,664	3,753	64.8%	98.6%

Pros:

- All Elementary Schools under capacity in 26/27
- Middle Schools within capacity
- Adjusts for potential neighborhood conflicts
- Rivera Impact: Both campuses are within limits
- Shorter Bus Rides
- No projected need for additional adjustments within 5 years
- Allows for smooth transition of CDS and Pupil Services from Cruickshank Campus

Cons:

- 3 Elementary schools over capacity in 25/26
- Unbalanced Middle Schools – will need additional support providers.

This is the recommended Scenario from the Committee for the Board of Trustees to adopt.

The Fundamental Questions – Who, Where and When?

Scenario 4 – Phased Approach

6th Grade to Middle School and Middle School Boundary Adjustments for Next Year
Elementary Boundary Adjustments for Fall 2026

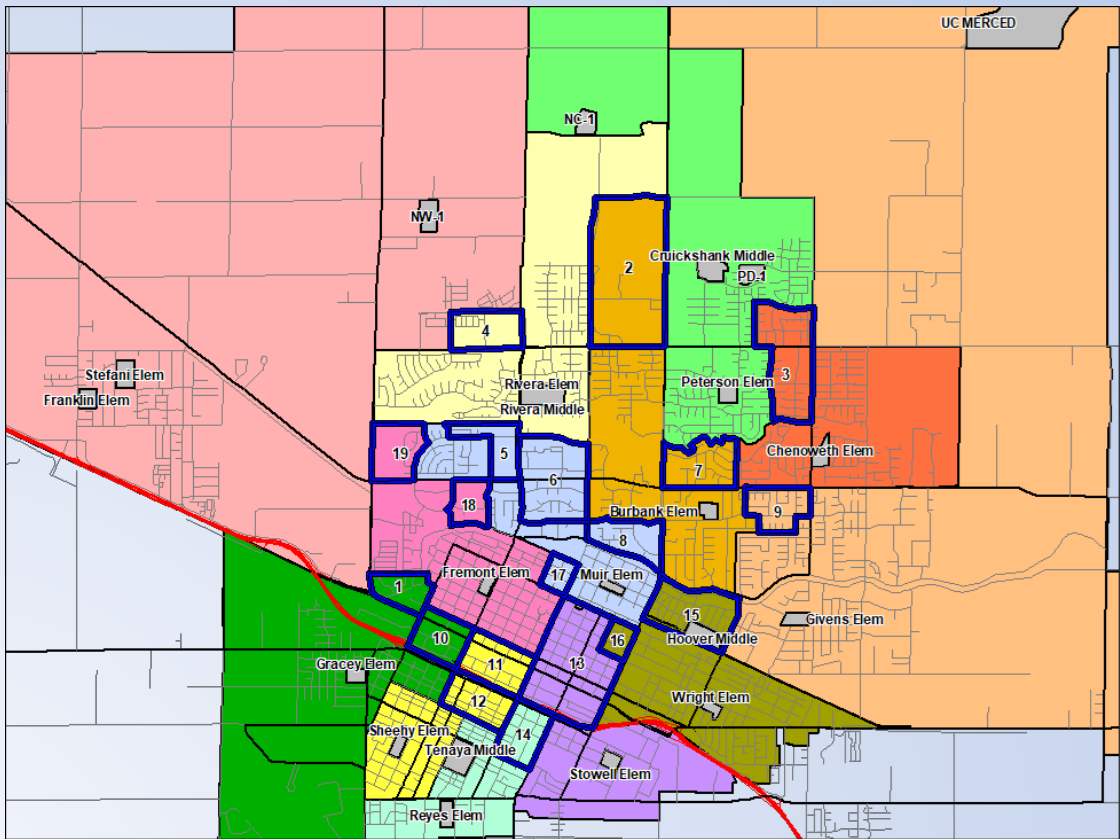

Scenario 4 Elementary School Map

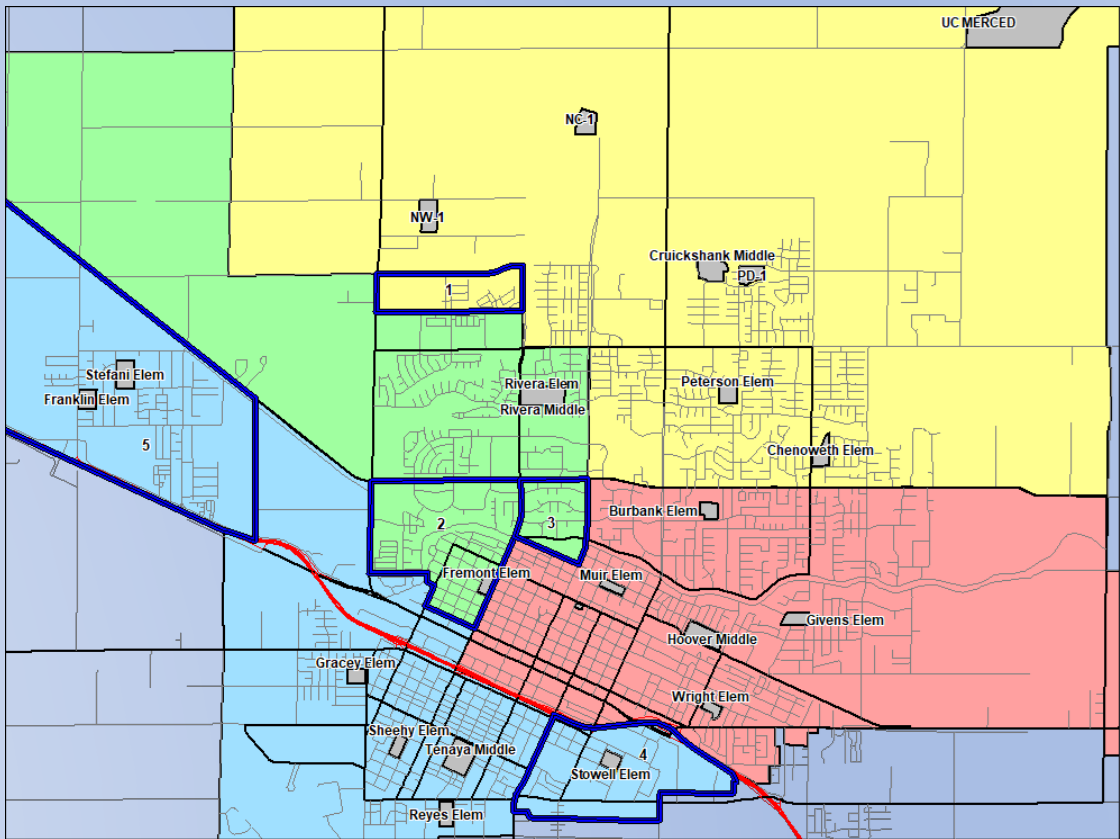

Scenario 4 Middle School Map

The Fundamental Questions – Who, Where and When?

Scenario 4 – Phased Approach

6th Grade to Middle School and Middle School Boundary Adjustments for Next Year
Elementary Boundary Adjustments for Fall 2026

Uses the same maps and achieves the same long term results as Phase 3,
but limits the time for preparations needed to move 6th Grade Students

Pros:

- All Elementary Schools under capacity in 26/27
- Middle Schools within capacity
- Adjusts for potential neighborhood conflicts
- Rivera Impact: Both campuses are within limits
- Shorter Bus Rides
- No projected need for additional adjustments within 5 years

Cons:

- 3 Elementary schools over capacity in 25/26
- Unbalanced Middle Schools – will need additional support providers.
- Less time to prepare for 6th Grade movement, including a rushed approach to relocating CDS and Pupil Services from Cruickshank's campus.

The Fundamental Questions – Who, Where and When?

Scenario Summary

Scenario #	Action	Implementation Date
Scenario 1	District Wide Boundary Adjustments 6 th Grade Stays at Elementary Schools	2025/2026
Scenario 2	District Wide Boundary Adjustments 6 th Grade Moves to Middle Schools*	2025/2026
Scenario 3	Phase 1: Elementary Boundary Changes Phase 2: 6 th Grade Moves to Middle School*	2025/2026 2026/2027
Scenario 4	Phase 1: 6 th Grade Moves to Middle School* Phase 2: Elementary Boundary Changes	2025/2026 2026/2027
* = Middle School Boundary Adjustments when 6 th Grade moves		

The Fundamental Questions – How?

Impacts

Families:

- New Schools
- New Start/End Times
- New Routines
- How will it work with my job?

MCSD:

- Transportation Services
- Human Resources
- Classrooms/Facilities
- Afterschool Programs

Please understand you are not in this alone. We will continue to have community meetings as we transition to whichever scenario is selected to keep all stakeholders informed throughout the process.

Thank you for being here!

Questions / Comments

