



School Safety and Culture

John Heiderscheidt
Director of School Safety and Culture



Purpose

The purpose of this presentation is to update the Board of Education on the following:

1. Aspiration and Measurement
2. Security at School
3. Community Partners
4. Staff Training
5. Safe and Nurturing Environments

Aspiration 1:

We will educate the whole student by providing an enriched, high quality experience that empowers all graduates to be competitive members of the global society

- ▶ **Priority 2:** We will coordinate our efforts to provide a nurturing and safe learning experience and a flexible approach in meeting the academic, social, and emotional needs of each student.
 - **Metric**
 - Increase the percentage of students who feel safe at school.
 - **Definition**
 - Increase annually by 4 scale points the 5Essentials score of students who report they feel safe at school.
 - 2015-16 was 37. 2016-17 goal is 41. 2017-18 goal is 45.
 - **Source**
 - 5Essentials

Electronic Access Control

- ▶ Electronic Access Control and Key FOBs
- ▶ Completed at all schools and buildings
 - Over 5,000 key FOBs
 - 1,300 FOBs issued this school year

Camera at entrances



Key FOB for all staff



Visitor Entrance Intercom to front office



Staff entrance



School Security Check

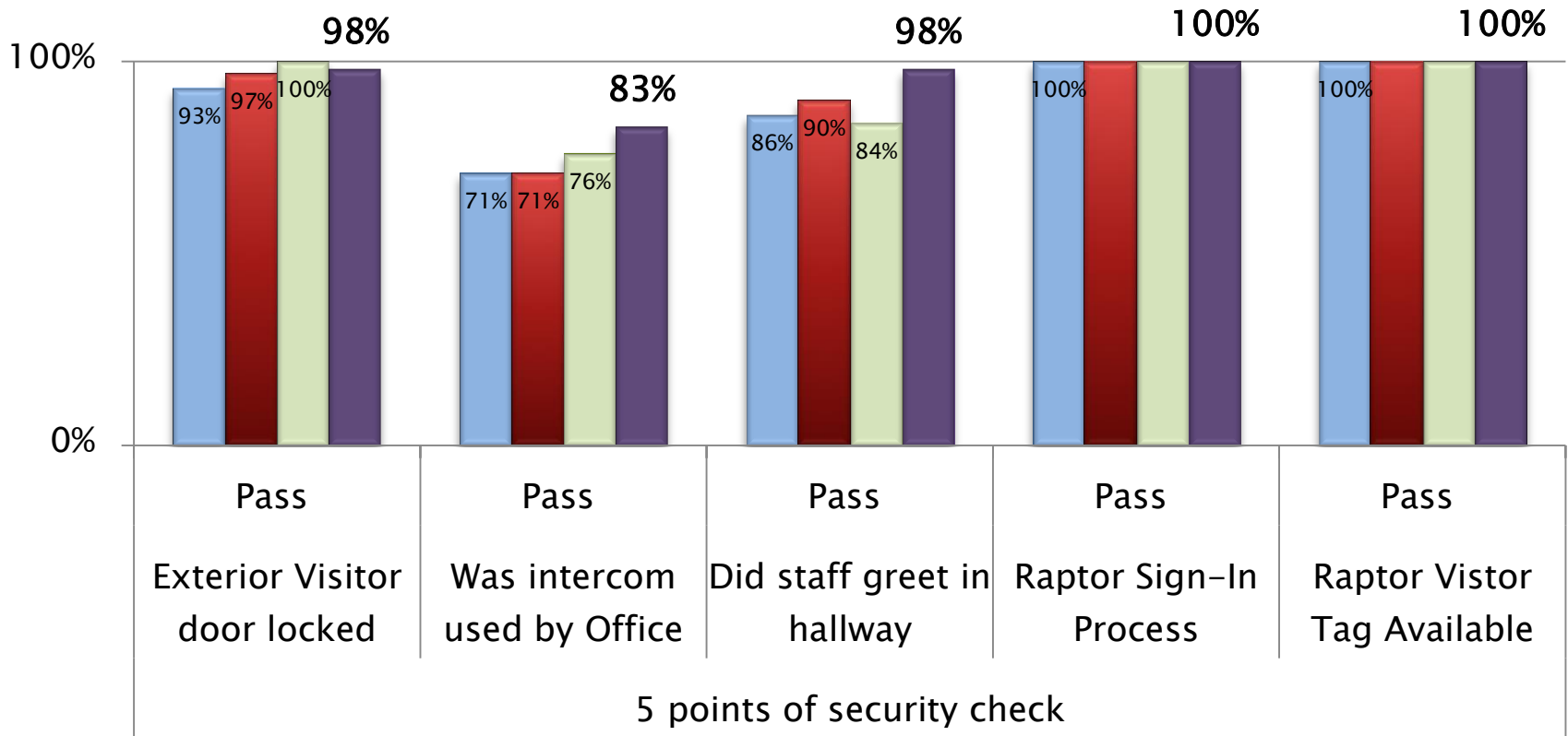

5/14/2014

1/1/2015

1/16/2016

9/14/2016

Visitor Management System

- ▶ Scans any ID
- ▶ No ID – use name and date of birth
- ▶ Prints an ID with picture and date
- ▶ Scans sex offender registration files
- ▶ Private alerts capable



Over 42,000 visitors served since August 2016



Lockdown Locks

All classrooms, offices and single staff bathrooms

- ▶ Phase 1 – elementary schools – completed in Dec. 2016
- ▶ Phase 2 – middle schools – completed Feb. 2017
- ▶ Phase 3 – high schools – pending
- ▶ Phase 4 – administration and operations – pending

Hallway lock



Inside room



Inside room



Inside room



Lockdown Locks - Bathrooms

- ▶ Single staff bathrooms
 - Always forced closed
 - Always locked
 - Privacy – once inside
 - Key needed to lock
 - Displays 'Occupied'
 - Other staff cannot enter
 - Override key

Hallway View



Inside room view



Classroom Action Guide and Map

- ▶ All classrooms
- ▶ Main office areas
- ▶ 5 safety responses
- ▶ Maps
 - Fire evaluation – Red
 - Severe Weather – Blue
 - Shaded area – Safer
 - Room number

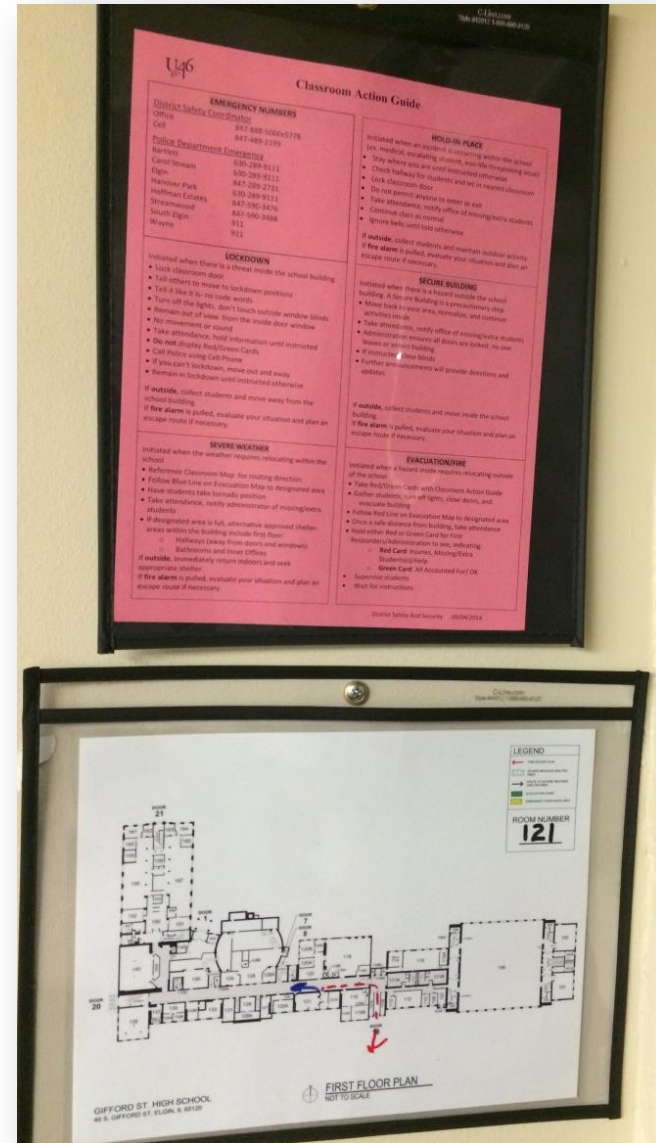



Community Partners in Safety

- ▶ **School Safety Advisory Task Force**
 - Debrief incidents
 - Table top scenarios
 - Review safety, security, and emergency procedures
- ▶ **ACE Trauma Informed Care A-Team**
 - Develop a trauma informed care training plan for teachers and school staff
- ▶ **Bartlett Volunteer Fire Association**
 - Grant awarded to pilot our digital radio system with base unit radios in school offices

School Safety Drill Act

Annual School Safety Drills and Training

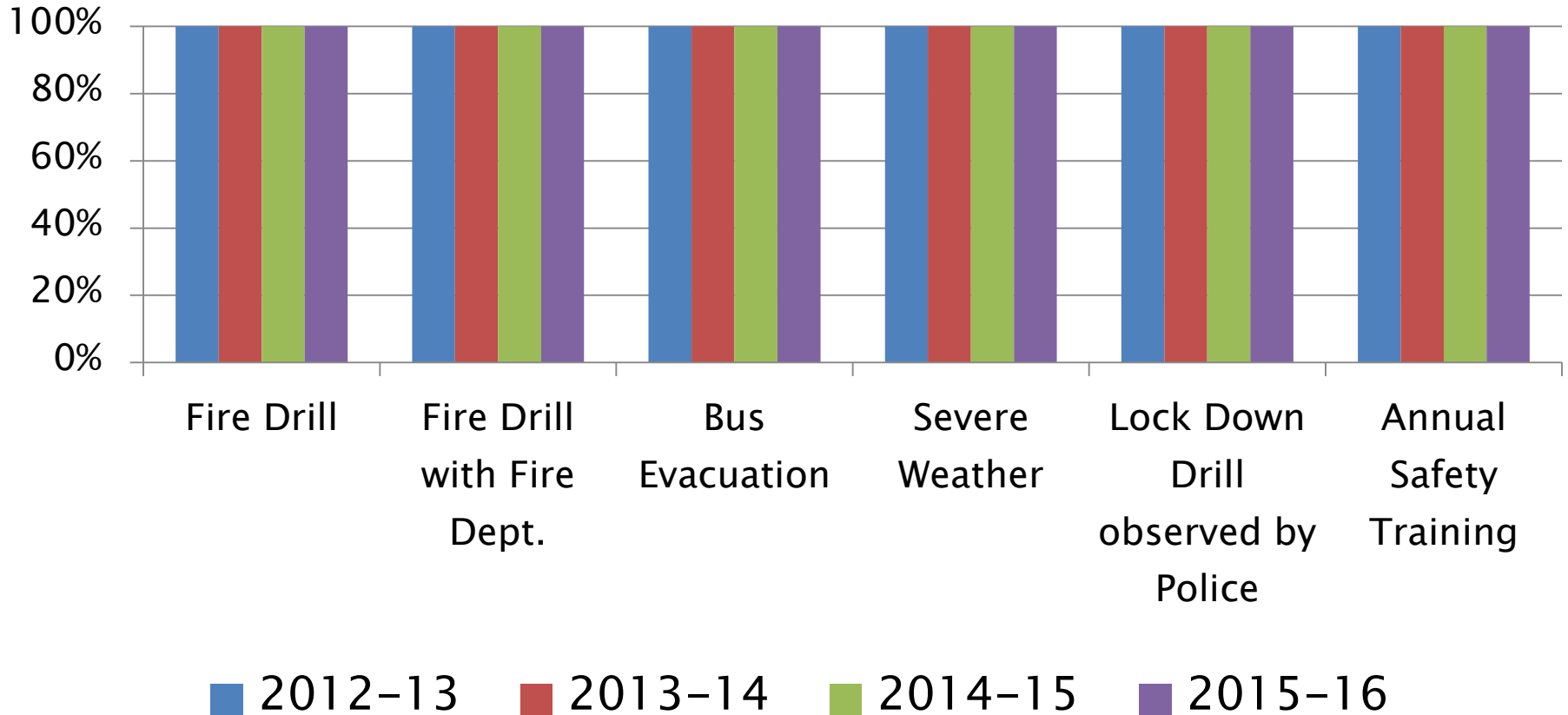

Drill completion required annually by October 15

Professional Development

▶ **Safety and Crisis Management Training:**

- Conducted annually at each school during a staff meeting
- Facilitated scenarios to strengthen staff action steps:
 - Escalating student – prevention and de-escalation strategies
 - Active threat inside – lockdown
 - Outside situation – secure building
 - Inside situation – hold in place
 - Students fighting – how to manage a fight in school

CPI Trained Employees

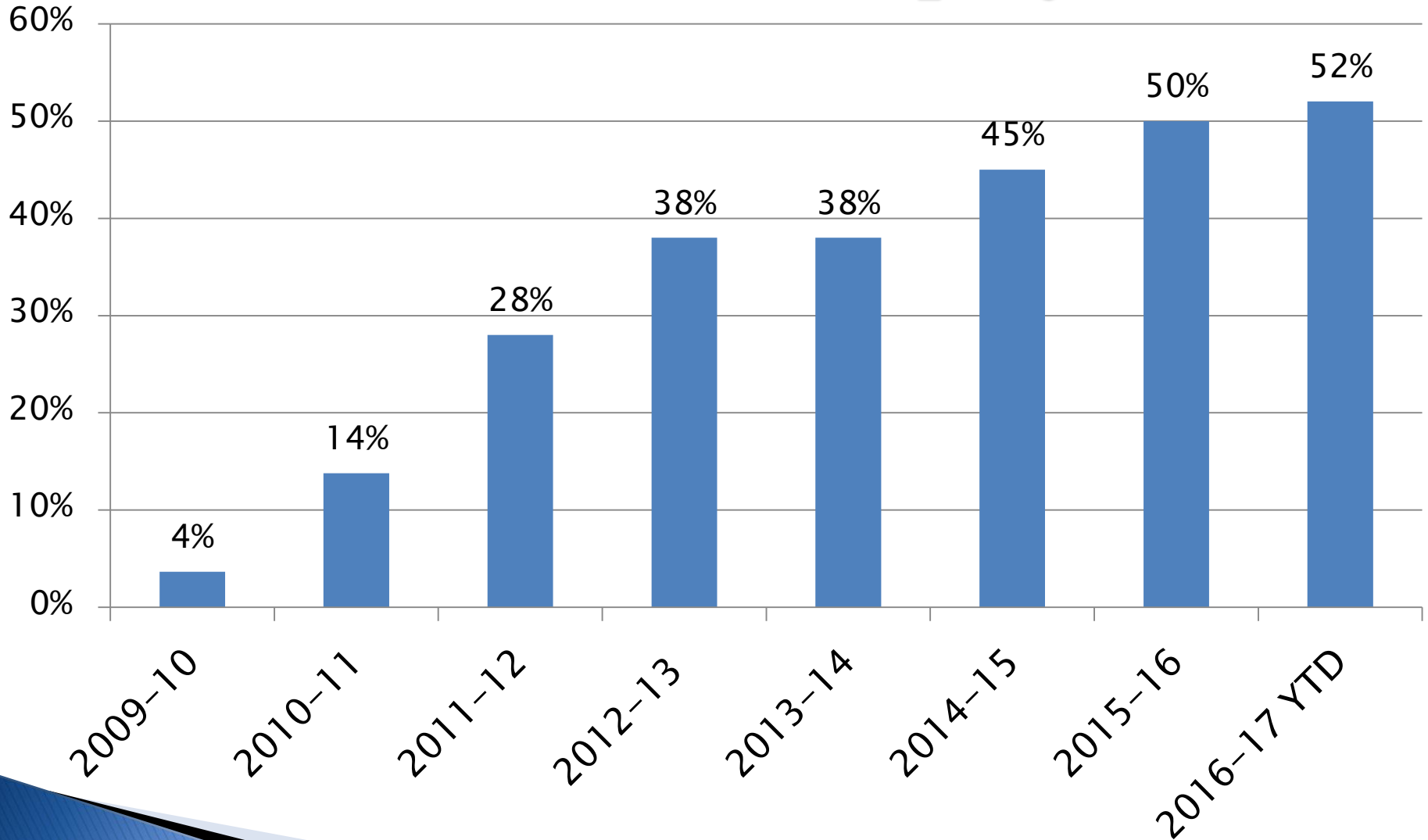

Safe and Nurturing Environments

District Safety collaborates with the Coordinator of Student Discipline, Coordinator of Multi-Tiered Systems of Support (MTSS), Principals, Assistant Principals, Deans, School Resource Officers and Dean's Assistants to continuously improve safe school environments.

Student Code of Conduct Revisions:

- ▶ Separated from the Student Handbook
- ▶ [Posted online](#)
- ▶ Includes IL Discipline Reform Public Act 456
- ▶ Rights and responsibilities for students, parents and staff
- ▶ Transparency, clarity, consistency
- ▶ Reviewed annually by administrators, teachers, support staff, parents, community

Unique Students Out-of-School Suspended 2015-16

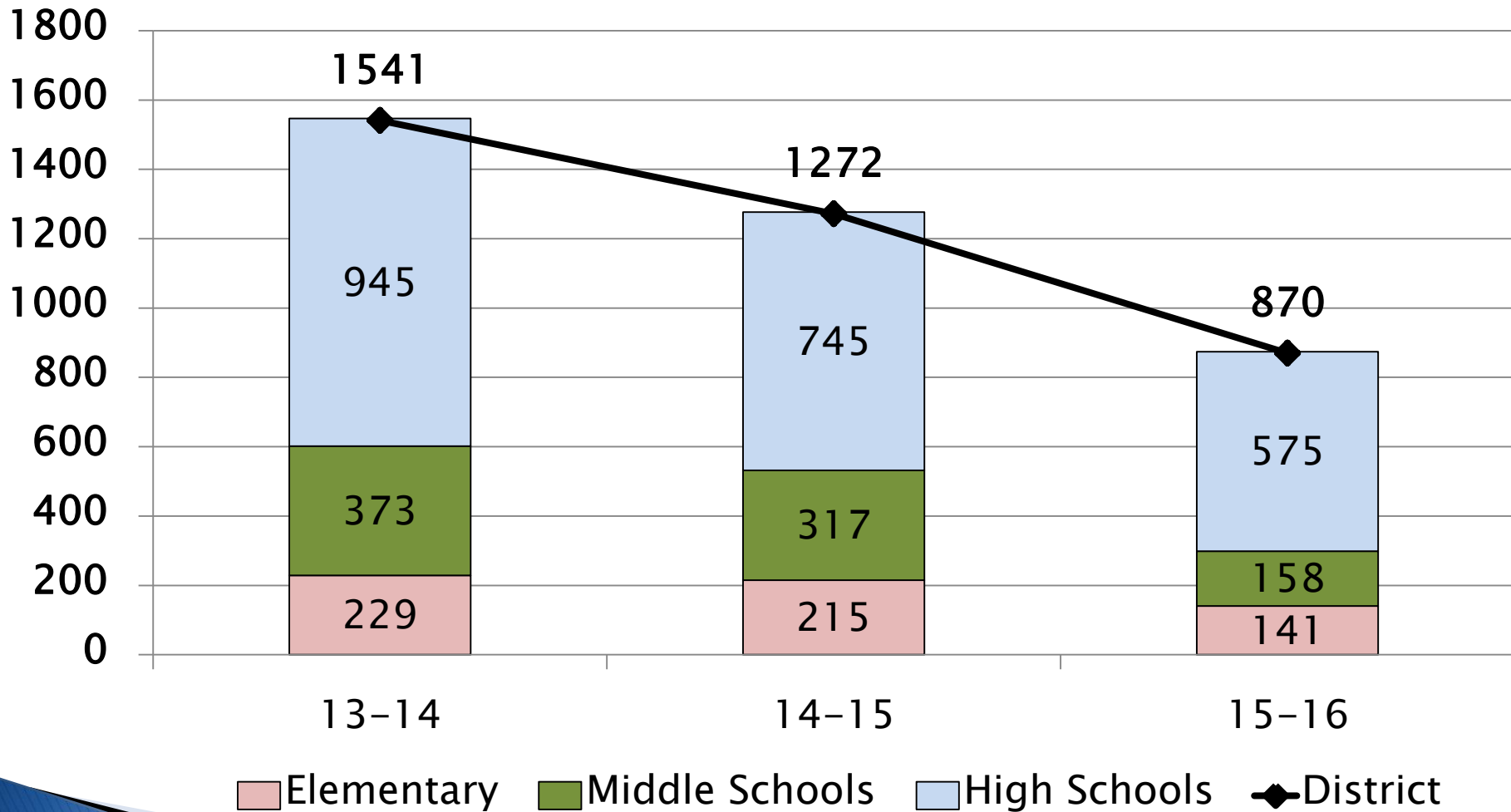

Next Steps:

- ▶ Lockdown locks
 - Completion of Phase 2 – Middle Schools
 - Next year – Phase 3 and 4
- ▶ Visitor/Volunteer Management System
 - Private alerts
- ▶ Safety Measurement – 5Essential baseline data
 - Develop an action plan to increase student feelings of being safe in school.
 - Report updated results to the Board of Education
- ▶ Training and Resources
 - Develop a series of training and awareness video resources for staff and families on safety topics
 - lockdown, secure building, hold in place, evacuation

