

BID DOCUMENTS

LOVELAND MIDDLE SCHOOL AHU REPLACEMENT

LOVELAND CITY SCHOOL DISTRICT

801 S Lebanon Rd., Loveland, OH 45140

ELECTRICAL OVERALL PARTIAL ELECTRICAL PLAN

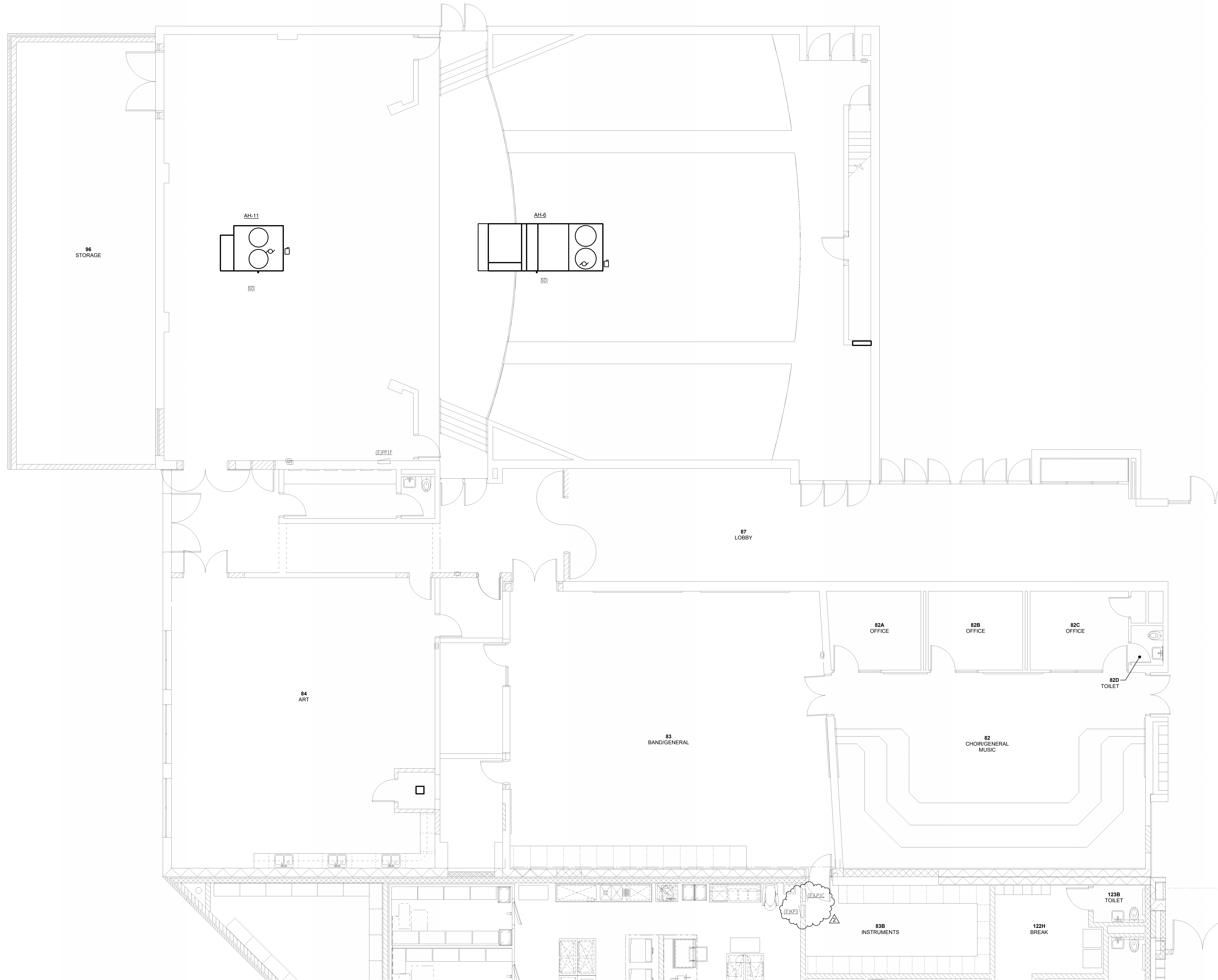

1 ELECTRICAL - PARTIAL OVERALL PLAN
E-102 3/16" = 1'-0"

CLIENT/CMTA JOB #:	OLMS23
DATE:	12/11/2024
DRAWN:	JJS
CHECKED:	JBM

REVISIONS	
2	ADDENDUM 01 01/17/2025

E-102

C:\Users\james.messner\Documents\LOVELAND_MID_AHU_23_24.dwg
 12/11/2024 8:50:54 AM