

Sonoma County has 40 school districts providing K-12 education: 31 elementary districts, 3 high school districts, and 6 unified districts. Elementary districts "feed" into high school or unified districts as indicated below. Unified districts provide kindergarten through twelfth grade education for the students living within their boundaries.

**ELEMENTARY & HIGH SCHOOL DISTRICTS**

**Healdsburg Unified**

- Alexander Valley Union
  - West Side Union
- Petaluma Joint Union High**
- Cinnabar
  - Dunham
  - Liberty
  - Old Adobe Union
  - Petaluma City Elementary
  - Two Rock Union
  - Waugh
  - Wilmar Union

**Santa Rosa**

- Bellevue Union
- Bennett Valley Union
- Kenwood
- Mark West Union
- Piner-Olivet Union
- Rincon Valley Union
- Roseland
- Santa Rosa City Elementary
- Wright

**West Sonoma County Union**

- Forestville Union
- Fort Ross
- Gravenstein Union
- Guerneville
- Harmony Union
- Monte Rio Union
- Montgomery
- Oak Grove Union
- Sebastopol Union
- Twin Hills Union

**UNIFIED**

- Cloverdale Unified
- Cotati-Rohnert Park
- Geyserville Unified
- Healdsburg Unified
- Sonoma Valley Unified
- Windsor Unified

**Note:** Horicon and Kashia feed into an out-of-county district, Point Arena Joint Union High in Mendocino County.

**TWO COUNTY DISTRICTS**

- Calistoga Unified (Napa County)
- Laguna Joint (Marin County)
- Shoreline Unified (Marin County)
- Union Joint (Marin County)

**JUNIOR COLLEGE DISTRICT**

- Sonoma County Junior College

**LEGEND**

- 1 Trustee Area Number (2012)
- Trustee Area Boundary (2012)
- Elementary School District
- High School District
- High School District & Trustee Area
- Alternative School
- Elementary School
- Middle School
- High School
- Independent Study



Amie Carter, Ed.D.  
SONOMA COUNTY SUPERINTENDENT OF SCHOOLS

**TRUSTEE AREA MAP**

BOUNDARIES ADJUSTED PER THE U.S. CENSUS OF 2020 AND ADOPTED IN 2023

This Map was compiled and prepared by me in July, 2022 and is based upon the maps of the school districts on file in the office of the Sonoma County Office of Education and information from the Sonoma County GIS. This map is intended for a visual reference. The true position of the school district lines depicted are controlled by the legal descriptions on file in said office.

The Trustee Area lines were adopted February 7, 2022 by the Sonoma County Committee on School District Organization, Resolution No. 21-22-01

Background base map is U.S.G.S. San Francisco Bay Region Sheets 1 & 2 1970 1:125,000 Scale.

Signed: \_\_\_\_\_ Date: \_\_\_\_\_

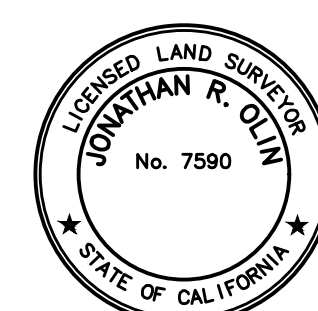

CIVIL ENGINEERS • URBAN PLANNERS • LAND SURVEYORS • LANDSCAPE ARCHITECTS  
15 THIRD STREET, SANTA ROSA, CA 95401  
TEL (707) 542-6451 FAX (707) 542-5212

SAN PABLO BAY