

ADDENDUM NO. 1

January 9, 2025

Madison Primary Site Improvements Project OAKLAND UNIFIED SCHOOL DISTRICT

OUSD PROJECT NUMBER 24165

Oakland Unified School District
Facilities Planning & Management
955 High Street, Oakland, CA 94601

The following changes, additions, modifications and corrections hereinafter set forth shall apply to the Bid Documents for the project and shall be made a part thereof and subject to all the requirements thereof, as if originally specified and/or shown.

Addendum No 1

**The Bid Due date will be the same:
Wednesday January 22nd, 2025 @ 2:00 p.m.**

Dear Bidders,

Please take note of the following amendments to the original document:

This project is not subject to PLA and LBU requirements.

Revised Scope of Work:

1. Remove existing play structures and their footings, along with the safety surfacing, covering an area of approximately 8,500 square feet.
2. Remove existing (6) basketball hoop poles (include footings). Include patching back. Ensure the restored surface blends seamlessly with the existing surroundings.
3. Remove existing chain link fencing currently used for storage. Include removal of posts and footings. Approx. 60 linear foot in length. Include patching back. Ensure the restored surface blends seamlessly with the existing surroundings. Also include removal of (8) bike racks and its footings.
4. Remove existing baseball back stop and its footings.
5. Remove (9) metal benches and its footings.
6. Remove existing asphalt pavement and replace in kind. Approx. 57,000 sqft. Total.
 - a. 6" asphalt layer (35,000 sqft)
 - b. 4" asphalt layer (22,000 sqft)
7. Remove existing turf field and replace with new. Approx. 11,000 sqft.
 - a. Includes but not limited to:
 1. Removal and disposal of existing turf
 2. Removal and disposal of existing drain mat
 3. Fine grade existing base and any minor base repair
 4. Install new pad (ProPlay drainage/shock pad)
 5. Replace existing turf with new and infill with sand infill system approx. 4 lb. of sand per sqft.
 6. Apply new striping

7. Existing garden enhancements
 - a. Remove existing (18) 8'x4'x4' planter boxes.
 - b. Remove existing 4" layer of mulch/dirt.
 - c. Remove existing drip system lateral pipes and submain line.
 - d. Install new drip irrigation system for new (8) planter boxes 8'x4'x4'. New planter boxes by others.
 - e. Install new 8' high privacy screen at the exterior perimeter fencing. Approx. 250 linear foot long.
8. New Playground with Poured-In-Place (PIP) Play Matting Surface
 - a. Furnish and install new poured-in-place (PIP) matting. Approx. 5,500 sqft
 1. Product: TotTurf TPV Supreme, 3.5" total thickness.
 2. PIP must contain 50% color with (3) color options as part of the design. Color choices and design must be coordinated with OUSD.
 - b. Current detail as a reference.

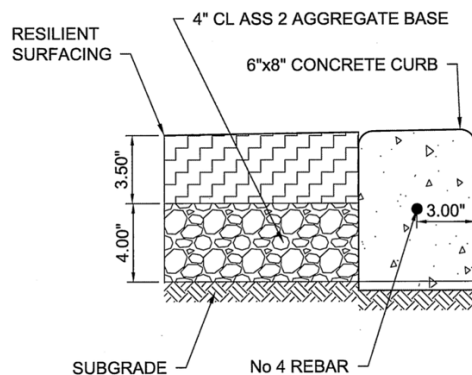

8
C-7
RESILIENT SURFACING
 SCALE: N.T.S.

- 1.
9. Install new 8' high privacy screen at the exterior perimeter fencing near Madison Park. Approx. 500 linear foot long.
10. Apply a double layer of seal coating near play structure. Approx. 5,500 sqft. Include any prep work required (clean cracks at the existing asphalt surface of debris, pressure wash, and crack seal).
11. Wall surface preparations to receive mural(s). Approx. 11,000 sqft surface. This includes the following: Pressure wash surface, wall patching, apply primer, apply top/main coat.
12. Apply seal coating once mural work is complete. Approx. 11,000 sqft surface.
13. Tree installation (outside of nature area space)
 - a. Install (46) new trees, each 10ft in height, with a box size of 36 inches. Each tree must be securely staked to ensure stability. Install a 4-inch metal edging in a 5-foot diameter around each tree.
 - b. Furnish and install new irrigation and drainage systems for trees. Include trenching and re-pavement.
14. Nature Area
 - a. Remove existing 4" asphalt layer. Approx. 8,000 sqft. Excavate and dispose 3" of soil underneath asphalt layer.
 - b. Install (20) new trees, each 10ft in height, with a box size of 36 inches. Each tree must be securely staked to ensure stability. Install a 4-inch metal edging in a 5-foot diameter around each tree.
 - c. Furnish and install new ½" irrigation & 3" french drainage systems. Approx. 800 linear feet for each system.
 - d. Install 5' wide DG pathway. Approx. 300 linear feet long.

Note: Excavate a hole measuring 4 feet wide by 4 feet long by 4 feet deep for each tree. Remove and properly dispose of the excavated soil. After planting each tree, backfill the hole with a mixture of soil and compost to promote healthy growth. This is typical for all tree planting locations.

Add Alternates:

- a. N/A.
Please utilize the updated bid form.

Inclusions:

1. Area of work must be fenced off to ensure a safe working environment on site. Materials should also be staged within a fenced area.
2. The contractor is responsible for unloading trees, which will be furnished by Others, from the transportation trucks upon arrival at the site. Once unloaded, the contractor must carefully stage the trees within the designated areas of the school yard to prepare for planting. Trees must be hand watered until the irrigation system is fully operational.
3. Materials and debris generated during construction must be hauled off site after the work is completed.
4. Must provide your own dumpster.
5. Site must be scrubbed, and pressure washed after the completion of contractor's work. Newly installed play structure(s) must be wiped down.
6. Post-work inspections will be coordinated with a firm provided by OUSD.
7. Deliveries must be coordinated with OUSD.
8. Include furnishing and installation of (2) root watering systems (RWS) for each tree. Reference: https://store.rainbird.com/rwsb1401-rain-bird-rws-root-watering-system-36-in-tube-0-25-gpm-bubbler-4-in-grate.html?utm_source=google&utm_medium=cpc&utm_campaign=RainBirdPLA&utm_term=%7Bkeyword%7D .
9. Privacy screen product: <https://www.homedepot.com/p/COLOURTREE-8-ft-x-200-ft-Green-Privacy-Fence-Screen-HDPE-Mesh-Windscreen-with-Reinforced-Grommets-for-Garden-Fence-Custom-Size-8x200fs-1/314384926>
10. 14-Gauge Black Steel Landscape Edging product: <https://www.homedepot.com/p/Colmet-8-ft-x-4-in-14-Gauge-Black-Steel-Landscape-Edging-5-Pack-AS814-4BK5/316791193>

Reference documents:

1. School Yard Diagram.
2. Project Schedule.

Please Note: Site underground utilities scanning and topographic survey and soil characterization report will be issued to Contractor prior to start of work.

RECEIPT OF THIS ADDENDUM MUST BE ACKNOWLEDGED ON
THE FORM OF PROPOSAL

End of Addendum No. 1

BID FORM
DOCUMENT 00 31 01

OAKLAND UNIFIED SCHOOL DISTRICT
Facilities Planning and Management
High Street, Oakland, CA 94601

Dear Board Members:

The undersigned, doing business under the firm name of _____, hereby proposes and agrees to enter into a contract, with the Oakland Unified School District (“Owner”), to furnish any and all labor, materials, applicable taxes, equipment and services for the completion of Work as described hereinafter and in the Contract Documents as **Madison Primary Site Improvements, located at 470 El Paseo Dr., Oakland, CA 94603, (the “Contract”)**, The following scope of work will be as follows: The contractor will demolish existing play structures, safety surfacing, basketball hoop poles, and chain-link fencing, and enhance the garden with new planter boxes, mulch, and an upgraded drip irrigation system. Safety surfacing tiles and drainage systems will be installed. New play structure installed by others. Additional work includes installing privacy screens, preparing walls for murals, tree planting with irrigation and drainage, and upgrades to the nature area with a decomposed granite pathway, and pavement replacement and turf field upgrades. Work will follow strict safety standards and coordination with OUSD. See further details in the specifications.

The Contract Documents were prepared by OUSD, 955 High Street, Oakland, 510-535-7044.

Bid Amount (Base Bid):

The undersigned proposes to furnish such labor, materials, applicable taxes, equipment and services for the amount of:

_____ Dollars	\$ _____
<i>Bid Amount Without Contingency Allowance</i>	
One Hundred Eighty Thousand _____ Dollars	\$180,000 _____
<i>Total of Allowances (see Section IV of Agreement)</i>	
_____ Dollars	\$ _____
<i>Total Base Bid Amount</i>	

<p>By submitting this bid, bidder acknowledges and agrees that the Total Base Bid Amount accounts for any and all allowances.</p>	
--	--

Miscellaneous:

The low bid shall be determined as described in the Notice to Bidders.

The undersigned certifies to the best of its knowledge and belief that it and its officials are not presently debarred, suspended, proposed for debarment, declared ineligible, or voluntarily excluded from covered transactions by any Federal department or agency according to Federal Acquisition Regulation Subpart 9.4, and by signing this contract certifies that this vendor does not appear on the Excluded Parties List. <https://www.sam.gov/portal/public/SAM>

The undersigned shall, within ten (10) days after the date of such mailing, faxing, or delivering of a Notice of Award or prior to the commencement of the Work, whichever is earlier, execute and deliver an agreement in the form of agreement present in these Contract Documents and give Performance and Payment Bonds in accordance with the Instructions to Bidders.

The undersigned declares that it has read and understands the Contract Documents, including but not limited to the Notice to Bidders, the Instructions to Bidders, the Agreement, the General Conditions, the Drawings, the Specifications, and any Special Conditions.

The undersigned hereby designates as the office to which such Notice of Award of Contract may be mailed, faxed, or delivered:

Our Public Liability and Property Damage Insurance is placed with:

Our Workers' Compensation Insurance is placed with:

Circular letters, bulletins, addenda, etc., bound with the specifications or issued during the time of bidding are included in the bid, and, in Completing the Contract, they are to become a part thereof.

The receipt of the following addenda to the specifications is acknowledged:

Addendum No. _____ Date _____ Addendum No. _____ Date _____

{SR799810}2

Addendum No. _____ Date _____
Addendum No. _____ Date _____

Addendum No. _____ Date _____
Addendum No. _____ Date _____

This bid may be withdrawn in writing at any time prior to the scheduled time for the opening of bids, including any authorized postponement thereof.

A bidder shall not submit this bid form unless the bidder's California contractor's license number appears clearly on it, the license expiration date and class are stated, and the bid form contains a statement that the representations made therein are made under penalty of perjury. Any bid submitted by a contractor who is not licensed pursuant to Business and Professions Code section 7028.15 shall be considered nonresponsive and shall be rejected. Any bid not containing the above information may be considered nonresponsive and may be rejected.

Proof of Bidder's registration per Labor Code §1725.5 must be submitted with this bid form.

NOTE: This bid form must give the full business address of the bidder and be signed by bidder with bidder's usual signature. Partnerships must furnish the full name of all partners and must be signed in the partnership name by a general partner with authority to bind the partnership in such matters, followed by the signature and designation of the person signing. The name of the person signing shall also be typed or printed below the signature. Corporations must sign with the legal name of the corporation, followed by the name of the state of incorporation and by the signature and designation of the chairman of the board, president or any vice president, and then followed by a second signature by the secretary, assistant secretary, the chief financial officer or assistant treasurer. All persons signing must be authorized to bind the corporation in the matter. The name of each person signing shall also be typed or printed below the signature. Satisfactory evidence of the authority of the officers signing on behalf of a corporation shall be furnished with the bid.

The undersigned declares under penalty of perjury under the laws of the State of California that the representations made in this bid are true and correct.

Name of Company as Licensed in California: _____

Business Address: _____

Telephone Number: _____

California Contractor License No.: _____

Class and Expiration Date: _____

Public Works Contractor Registration No.: _____

State of Incorporation, if Applicable: _____

INDIVIDUAL:

Dated: _____, 20__

{SR799810}3

(Name)

PARTNERSHIP:

Evidence of authority to bind partnership is attached.

Dated: _____, 20__

(Name)

General Partner

CORPORATION:

Evidence of authority to bind corporation is attached.

Dated: _____, 20__

(Name)

(Chairman, Pres., or Vice-Pres.)

(Name)

(Secretary, Asst. Secretary, CFO, or Asst. Treasurer)

{SR799810}4

Madison Park Academy Primary

470 El Paseo Dr
Oakland, CA 94603

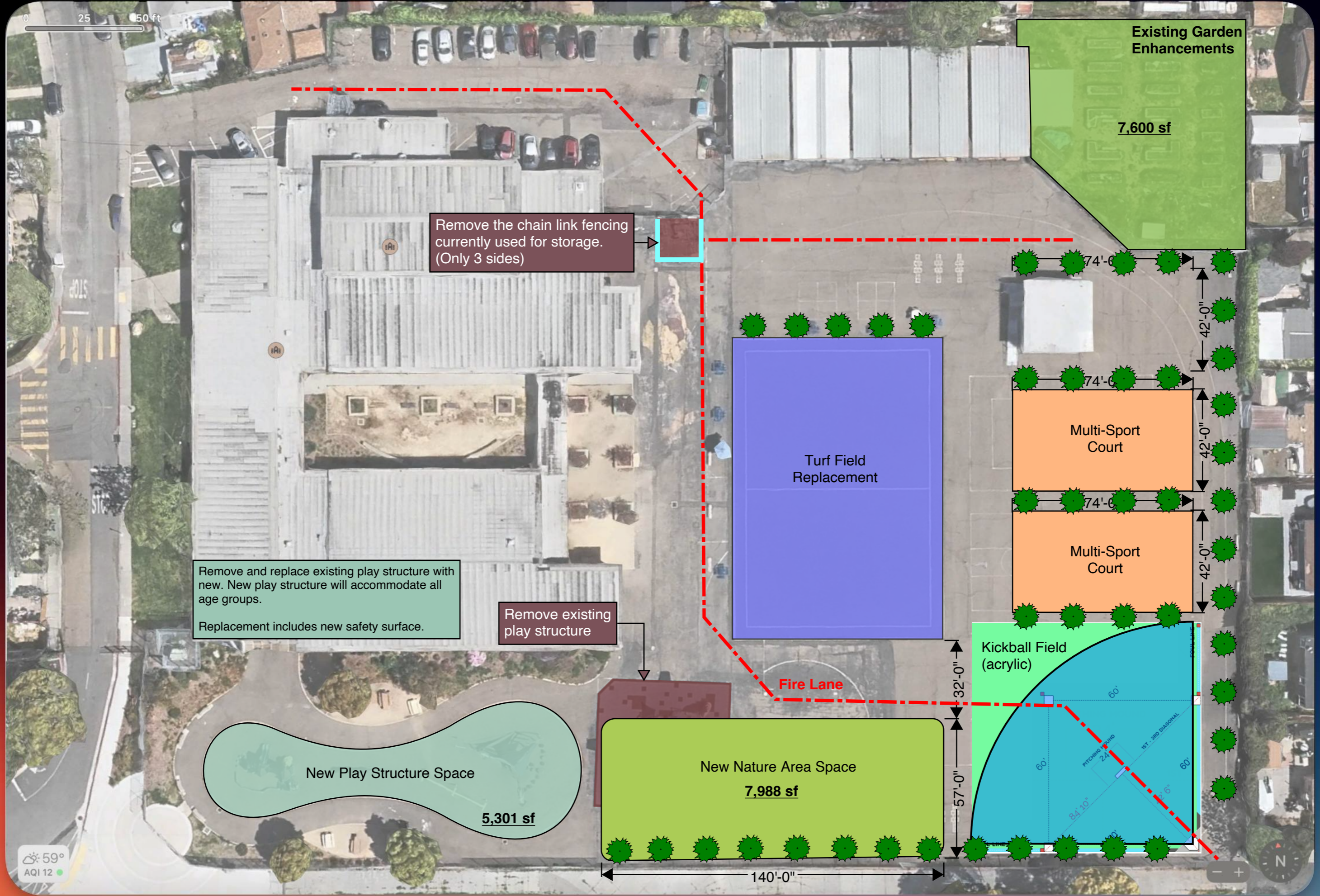

Madison Park Academy Primary Schedule

	!	!!	Milestones	Task Name	Responsible
1	<input checked="" type="checkbox"/>	<input type="checkbox"/>		Phase 1 Construction (3/17/2025 - 4/9/2025)	
2	<input type="checkbox"/>	<input type="checkbox"/>		3/17/2025 - Site mobilization and fencing setup	Contractor
3	<input type="checkbox"/>	<input type="checkbox"/>		Demo existing play structures, safety surfacing, asphalt, basketball hoop poles, baseball back plate, metal benches, garden beds, etc.	Contractor
4	<input type="checkbox"/>	<input type="checkbox"/>		Prep surface to receive safety surface play matting	Contractor
5	<input type="checkbox"/>	<input type="checkbox"/>		Asphalt removal and replacement.	Contractor
6	<input type="checkbox"/>	<input type="checkbox"/>		Turf field removal and replacement.	Contractor
7	<input type="checkbox"/>	<input type="checkbox"/>		Wall surface preparations to receive mural(s)	Contractor
8	<input type="checkbox"/>	<input type="checkbox"/>		Nature Area prep work (includes irrigation, drainage, etc.)	Contractor
9	<input type="checkbox"/>	<input type="checkbox"/>		Garden enhancements (includes removal of mulch/dirt, install new drip system, etc.)	Contractor
10	<input type="checkbox"/>	<input type="checkbox"/>		Install new trees (metal edging, irrigation, drainage, etc.)	Contractor
11	<input type="checkbox"/>	<input type="checkbox"/>		Install new privacy screen	Contractor
12	<input type="checkbox"/>	<input type="checkbox"/>		Install new DG surface	Contractor
13	<input type="checkbox"/>	<input type="checkbox"/>		Install new seal coating	Contractor
14	<input checked="" type="checkbox"/>	<input type="checkbox"/>		Phase 2 Construction (4/28/2025 - 5/9/2025)	
15	<input type="checkbox"/>	<input type="checkbox"/>		Install new SofSurfaces play matting	Contractor
16	<input type="checkbox"/>	<input type="checkbox"/>		Apply seal coating over Mural work	Contractor
17	<input type="checkbox"/>	<input type="checkbox"/>		Play structure inspection (for reference)	Contractor
18	<input type="checkbox"/>	<input type="checkbox"/>		Punchlist	Contractor
19	<input type="checkbox"/>	<input type="checkbox"/>		Site demobilization and yard pressure washing	Contractor