



# Bristol Warren Regional School District RIDE Necessity of School Construction

---



PMA Consultants

PERKINS —  
EASTMAN

SCHOOL BUILDING COMMITTEE | 12.05.2024

# AGENDA

## AGENDA

- I. OPEN MEETING
- II. PUBLIC COMMENTS
- III. DISCUSSION AND/OR POSSIBLE ACTION
  - A. Approval of 10/31/24 Meeting Minutes - VOTE
  - B. General Project Update
  - C. Design Update
    - 1. Perkins Design Memo
    - 2. Site Update
      - a) Hugh Cole Playground
      - b) MHHS- Updated Field Layout
    - 3. Rooms Data Sheet Update
  - D. Project Schedule / Next Steps
- I. ADJOURNMENT



# GENERAL PROJECT UPDATE

---



PMA Consultants

PERKINS —  
EASTMAN

# STAGE III PROGRESS UPDATE

- 11Oct24 - Warren TRC Meeting
- 11Oct24 - Security Meeting
- 17Oct24 - AE/OPM Coordination Meeting
- 24Oct24 - AE/OPM Coordination Meeting
- 28Oct24 - User Group Meetings (Admin and CTE)
- 28Oct24 - School Committee (KMS Chevron Approval)
- 28Oct24 - Warren Planning Board

Last SBC meeting

- 31Oct24 - School Building Committee
- 31Oct24 - Test Well Drilling 10/31 (Geothermal & Irrigation)
- 31Oct24 - AE/OPM Coordination Meeting
- 03Nov24 - AE/OPM Coordination Meeting
- 14Nov24 - AE/OPM Coordination Meeting
- 18Nov24 - RIDE DD Check-In Meeting
- 18Nov24 - School Committee
- 20Nov24 - Special Ed User Group Meeting
- 21Nov24 - AE/OPM Coordination Meeting
- 22Nov24 - CTE Equipment User Group Meeting
- 22Nov24 - Hydrant Flow Tests in Warren
- 28Nov24 - AE/OPM Coordination Meeting

Upcoming

- 05Dec24 - AE/OPM Coordination Meeting
- 05Dec24 - School Building Committee (6:00PM)
- 06Dec24 - DD Estimate Sets Due
- 16Dec24 - School Committee
- 23Jan25 - SBC Meeting (Approval of 60% CD's and VE)
- 30Jan25 - Bristol TRC Meeting



# MHHS Logistics Plan Update

---



PMA Consultants

PERKINS —  
EASTMAN



# MHHS SITE LOGISTICS PHASE 1 [DRAFT]

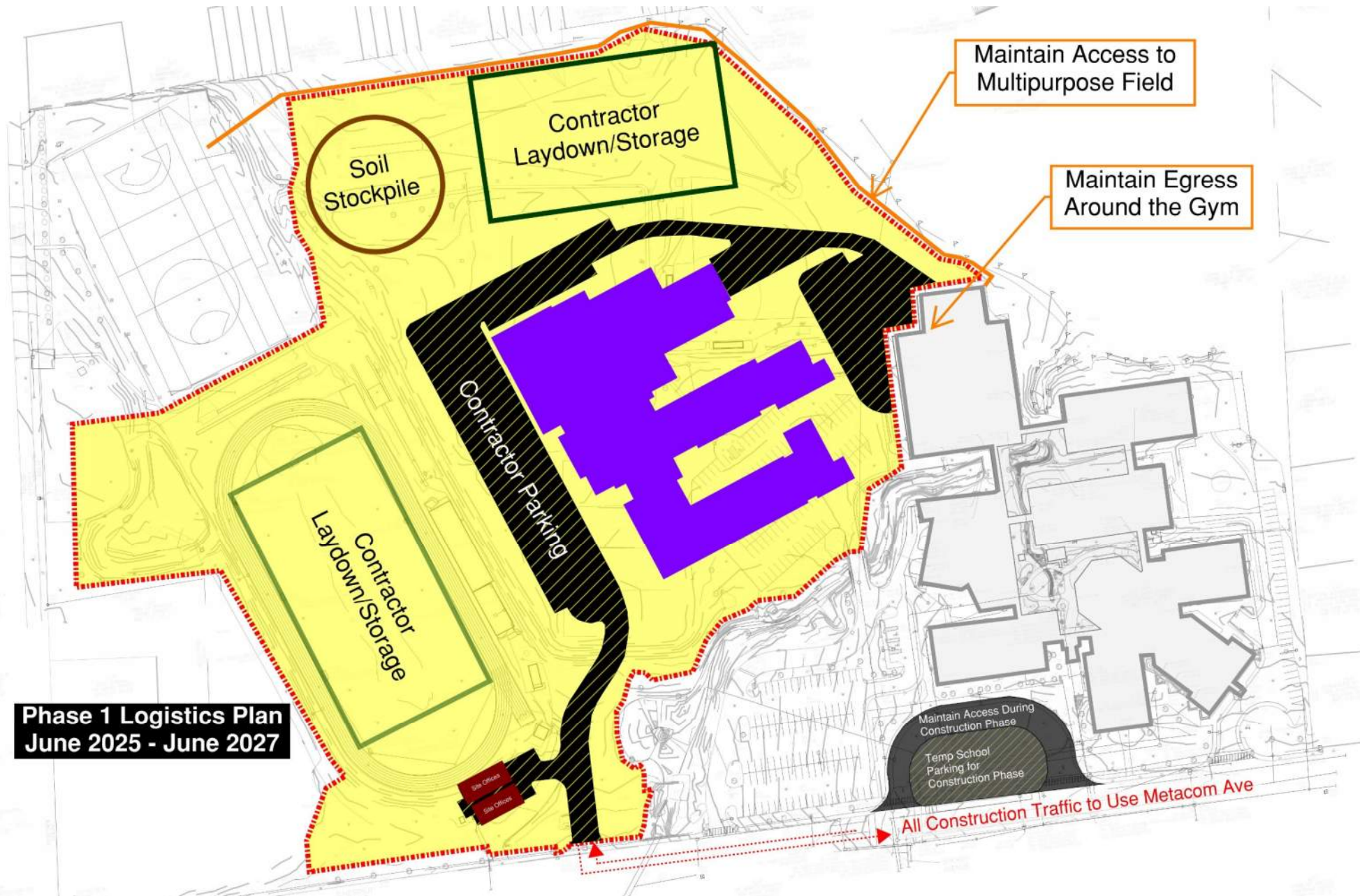

# MHHS SITE LOGISTICS PHASE 2A [DRAFT]

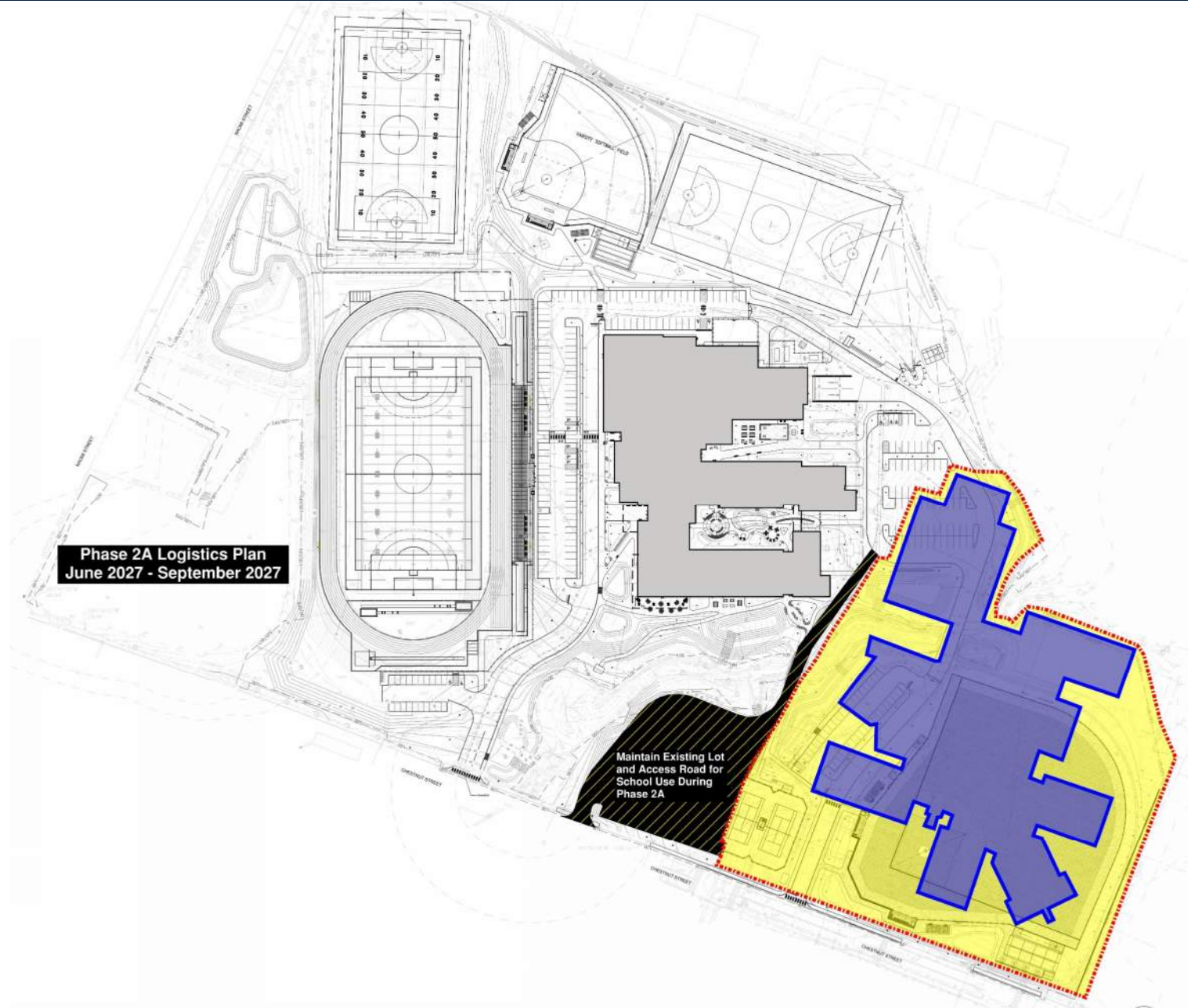



# MHHS SITE LOGISTICS PHASE 2B [DRAFT]

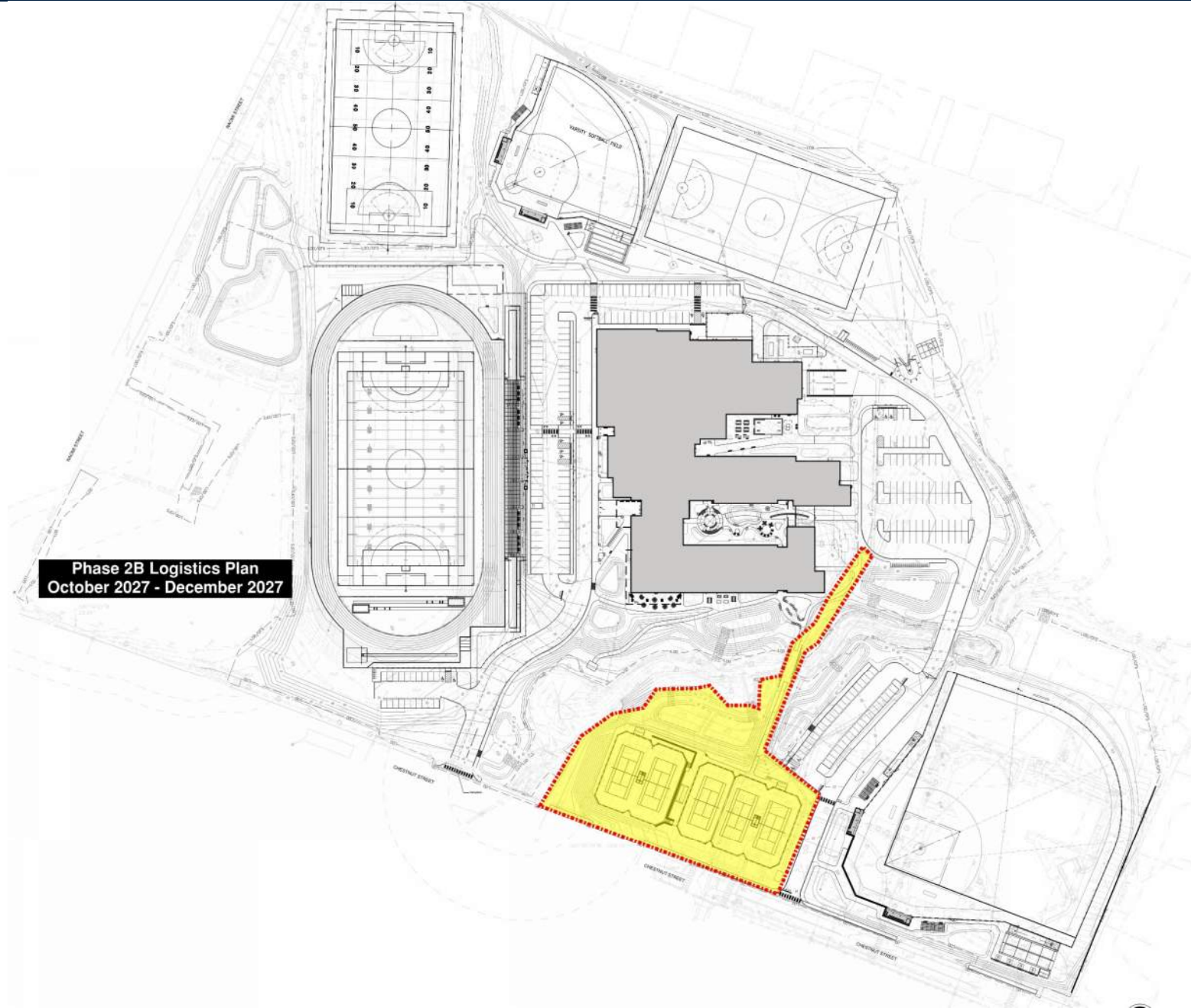



# DESIGN UPDATE

---



PMA Consultants

PERKINS —  
EASTMAN

# BWRSD WORK PLAN

## Bristol Warren Regional School District

Project # 0099110.00			
CONSTRUCTION DOCUMENTS			
	07/29/24	12/23/24	
SBC DD Page Turn with Owner		08/08/24	
SBC meeting - Exterior Finishes and Turf Field presentation		09/19/24	
SBC meeting - Interior Finishes and Systems		10/31/24	
<b>SBC meeting</b>		<b>12/5/2024 at 6:00pm</b>	
<b>SBC meeting - Approve 60% CD Budget</b>		<b>01/23/25</b>	
<b>SBC meeting - CD Update prior to Bidding</b>		<b>02/27/25</b>	
SC Meetings		09/09/24	
SC Meetings		09/23/24	
SC Meetings		10/28/24	
SC Meetings		11/18/24	
<b>SC Meetings</b>		<b>12/16/24</b>	
<b>SC Meetings</b>		<b>01/27/25</b>	
Neighborhood Meeting		09/16/24	BWRSD to confirm date
Signage Meeting at MHHS - entry sign		09/15/24	
MHHS Final User Meetings	09/23/24	09/24/24	MHHS to send a schedule
Program and Plan Review with Michelle and Ana		9/30/2024 at 3:00	
Select Follow up User Meetings		10/28 and 10/29	
Meet with MHHS students to review history of school		09/24/24	Need a group of students to meet
<b>Follow up meeting with Students to collect images of MHHS</b>		<b>Late January</b>	
Special Education User Meetings		11/20/2024 at 2:00	
<b>Meeting with Bristol Building Inspector</b>		<b>December</b>	
Fire Department and Building Inspector Review - Warren		9/3/24 at 1:00	
Fire Department and Building Inspector Review - Bristol		9/3/24 at 10:30	
Security Meeting with Cloud based system		08/20/24	
Security System Review Meeting with SRO and BPD		10/11/24	
<b>Integrated Design Team Meeting - Commissioning?</b>		<b>TBD</b>	<b>Commissioning Agent</b>
Permitting			
	07/01/24	03/01/25	
Warren review meeting with Fire Chief		6/20/2024 at 10:30	in person
Submit Bristol Masterplan Application		08/05/25	
Warren Permit Application Meeting		7/31/2024 at 1:00	
Submit Warren Permit Application		08/12/24	
Bristol TRC Meeting		8/28/24 at 10:00	
Warren TRC Meeting		10/11/24	
Bristol Planning Board Master plan Review		9/12/24 at 6:00	
Bristol TRC Meeting - review before 10/10 hearing		10/02/24	
Bristol Masterplan Hearing - Continued		10/10/24	
Warrant Planning Board Review		10/28/24	
RIDEM submission for MHHS		<b>12/15/24</b>	<b>Refer to PARE/LEC</b>
Bristol Planning Board Submission		<b>01/09/25</b>	
Bristol Planning Board TRC		<b>1/30/25 at 10:00</b>	
Bristol Planning Board Hearing		<b>02/13/25</b>	
Warren Planning Board and CRMC Submission		<b>01/09/25</b>	
Warren Planning Board TRC		<b>TBD</b>	
Warren Planning Board Hearing		<b>02/24/25</b>	
CRMC Submissions for KMS and HC		08/06/24	Drawings sent to CRMC on 8/6/24
CRMC Review Meeting		8/27/24 at 10:00	
RIDEM Approval		<b>TBD</b>	
CRMC Approval		<b>TBD</b>	
Carry over items - Investigation work			
	07/01/24	11/25/24	
Geoenvironmental - soil from tank at high school		09/23/24	Soil Removal
Geoenvironmental - soil from tank at high school		09/13/24	Additional Soil Removal
Test pits at KMS and HC		11/17/24	
Geothermal test wells		10/28/24	
Surveys		09/19/24	revised on 11/1/24
Survey Stamped Drawings		<b>TBD</b>	a few final edits are being worked on
Additional Survey scope of east side of KMS		09/05/24	
Incentive - RIBE		<b>TBD</b>	Send DD set
Historic Documentation Site wall		08/02/24	

## Bristol Warren Regional School District

Project # 0099110.00			
Design Schedule			
Historic Documentation Draft		11/01/24	
Historic Documentation Comments due from client		11/22/24	
Historic Documentation Draft to RIHPHC		12/06/24	
<b>Historic Documentation to RIHPHC - Final</b>		<b>02/01/25</b>	
Traffic Summary for new		Ongoing	Bryant to send summary for MHHS and KMS
<b>Crack Monitoring at KMS</b>		<b>Ongoing</b>	<b>RIK to visit monthly</b>
<b>Hugh Cole Condensation report</b>		<b>Ongoing</b>	
KMS Hydrant		11/20/25	
HC Hydrant tests		11/20/25	
Hugh Cole condensation issue		07/29/24	Site visit
Hugh Cole review Fire Suppression system with WFD		07/29/24	Site visit
Construction Documents Drawings			
	07/22/24	01/31/25	
<b>Consultant Coordination Meetings</b>			
<b>Structure and MEP Coordination - RSE/CMTA</b>		<b>Friday's at 10:00</b>	
<b>Site Coordination - Pare/Traverse</b>		<b>Thursday's at 2:00</b>	
<b>Lighting Coordination - HLB</b>		<b>Wednesday at 4:00</b>	<b>next lighting review meeting TBD</b>
Technology review of Audio Enhancement system		8/23/24 at 11:00	
Acoustics Coordination - CT		DD report received	
AV and Theater Coordination - CT		8/22/2024 at 11:00	
Kitchen Coordination - CM		8/22/2024 at 9:30	
Code Review Meeting with JS		8/16/2024 at 9:00	
Lighting Control Review		9/5/2024 at 3:00	
Kitchen Coordination Meeting		10/07/24	
Spec Review meeting - Kalin		10/8/2024 at 10:00	
<b>Spec - Front End Coordination</b>		<b>TBD</b>	
<b>Security Coordination - PP and CMTA</b>		<b>TBD</b>	
Hardware Coordination		8/20/2024 at 2:00	Send drawings to Assa Abloy on 9/3
<b>Hardware spec review</b>		<b>TBD</b>	
RIK Envelop review comments		09/25/24	Details sent to RIK on 9/13
Bldg. Envelop Review		10/1/24 at 2:00	
FF&E and MEP coordination		<b>TBD</b>	
Technology Review Meeting		<b>TBD</b>	
60% Construction Document Set			
	07/22/24	11/01/24	
<b>Check Set Due</b>		<b>10/09/24</b>	
<b>Final comments to Consultants</b>		<b>11/07/24</b>	
60% CD Drawings progress to PE from all Consultants except Civil and Landscape		11/15/24	
60% CD QA/QC Review - PE	11/15/24	11/29/24	
<b>60% CD Drawings/specs due to PE</b>		<b>12/06/24</b>	
<b>60% CD Due to Estimator</b>		<b>12/09/24</b>	
Cost Estimate			
	12/09/24	01/10/25	
Estimating		01/15/25	
Receive and Review Estimate from Cost Estimator	01/10/25	<b>01/17/25</b>	
Reconcile Cost Estimate - Value Engineering - MEETING		01/22/25	
Final Reconciliation - Revised Estimate Due		<b>01/23/25</b>	
Approval of 60%CD Scope and Budget		01/27/25	
Compile and Submit 60%CD Pkg to Owner and RIDE		02/10/25	
RIDE Review Period			
	01/27/25	02/10/25	
Review final comments from RIDE		<b>TBD</b>	
RIDE 60% CD Review Meeting		<b>TBD</b>	
CD check set due for final coordination		02/21/25	
Final Drawing Review	02/24/25	03/05/25	<b>TBD Based on Permitting Approval</b>
Final Redlines to Consultants		03/05/25	<b>TBD Based on Permitting Approval</b>
<b>Bid Documents Due</b>		<b>03/14/25</b>	<b>TBD Based on Permitting Approval</b>
<b>Compile and Submit CD Drawings</b>	03/17/25	03/28/25	
BIDDING			
	03/31/25	05/09/25	TBD Based on Permitting Approval
Contractor Pre-qual			
Addendum		04/11/25	TBD
Final Question			
Bids Due			
Construction to Begin			



# DESIGN MEMO UPDATE

---



PMA Consultants

PERKINS —  
EASTMAN

# DESIGN MEMO UPDATE



Perkins Eastman  
Architects DPC

## MEMO

### Mt Hope High School- Design Approach

November 7, 2024

#### Overview

To support the growth and functionality of the program, the design aims to balance the programmatic needs within our budget. This includes incorporating an integrated design that supports an expanding Career and Technical Education (CTE) program, as well as expanding and improving field spaces to foster increased participation.

#### Key Focus Areas

##### 1. Safety, Sustainability, and Wellness

- The design integrates a fully ADA accessible environment through universal design principles.
- A high-performing building envelope and hurricane-resistant glass will enhance resilience and energy efficiency.
- Daylighting will be prioritized with taller windows, allowing natural light to penetrate deeply into classrooms.
- A secure entry vestibule will be included, utilizing resistant glazing to reinforce safety.
- Courtyards will be incorporated to offer secure, outdoor learning spaces.

##### 2. Exterior Materials & Massing

- A timeless, durable brick façade is selected to ensure longevity and ease of maintenance.
- Softer Neutral material colors have been chosen to reflect the field stone and weathered shingle look typical of the outlying areas of Bristol and Warren communities.
- The building's organization is designed for simplicity and efficiency, enhancing operational ease and flexibility.

##### 3. Site Planning

- The building will be strategically located at a high point in the center of the site to maximize accessibility and facilitate drainage.
- To respect the surrounding area and minimize impact on neighboring areas, the building's profile will be kept low.
- A comprehensive stormwater & flood plain management system will improve the site's ecology and provide protection for neighboring properties.
- A new "loop" driveway will be added to improve access, visibility and safety.

#### Conclusion

This approach supports our goal of creating a high-quality, accessible, and sustainable facility that addresses both immediate and long-term needs. With a focus on safety, efficient design, and mindful site planning, we aim to enhance both functionality and community impact and provide a welcoming and accommodating school for generations to come.



# DESIGN MEMO – KEY POINTS

## Safety, Sustainability, and Wellness

- The design integrates a fully ADA accessible environment through universal design principles.
- A high-performing building envelope and hurricane-resistant glass will enhance resilience and energy efficiency.
- Daylighting will be prioritized with taller windows, allowing natural light to penetrate deeply into classrooms.
- A secure entry vestibule will be included, utilizing resistant glazing to reinforce safety.
- Courtyards will be incorporated to offer secure, outdoor learning spaces.

## Exterior Materials & Massing

- A timeless, durable brick façade is selected to ensure longevity and ease of maintenance.
- Softer Neutral material colors have been chosen to reflect the field stone and weathered shingle look typical of the outlying areas of Bristol and Warren communities.
- The building's organization is designed for simplicity and efficiency, enhancing operational ease and flexibility.



## Site Planning

- The building will be strategically located at a high point in the center of the site to maximize accessibility and facilitate drainage.
- To respect the surrounding area and minimize impact on neighboring areas, the building's profile will be kept low.
- A comprehensive stormwater & flood plain management system will improve the site's ecology and provide protection for neighboring properties.
- A new “loop” driveway will be added to improve access, visibility and safety.

# SITE UPDATE

---



PMA Consultants

EST. 1971

PERKINS —  
EASTMAN



# MHHS- PREVIOUS FIELD LAYOUT

NOT INCLUDED IN -PURPOSE  
-ONE TENNIS COURT

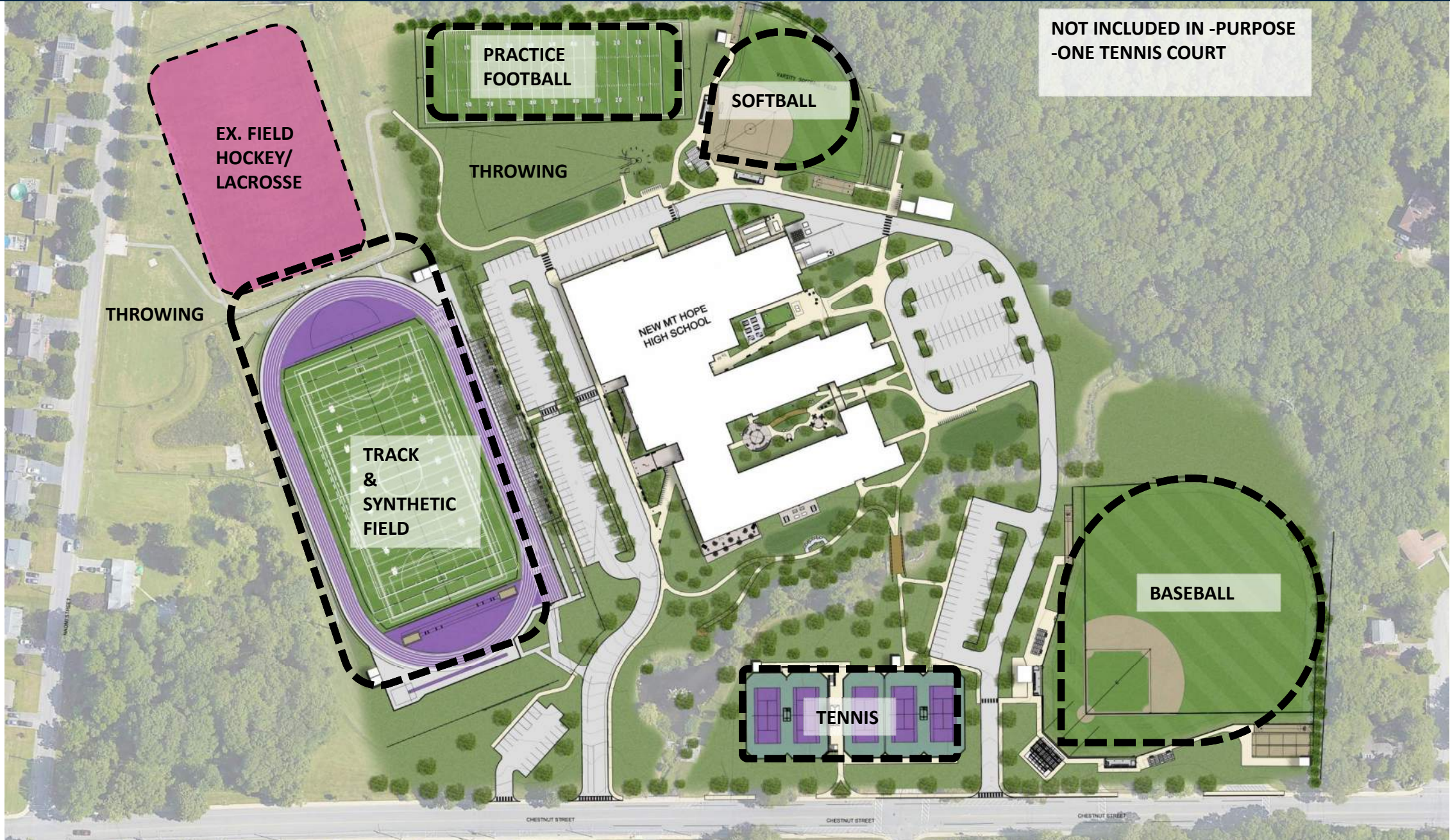



# MHHS- UPDATED FIELD LAYOUT

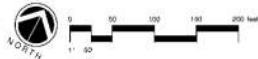
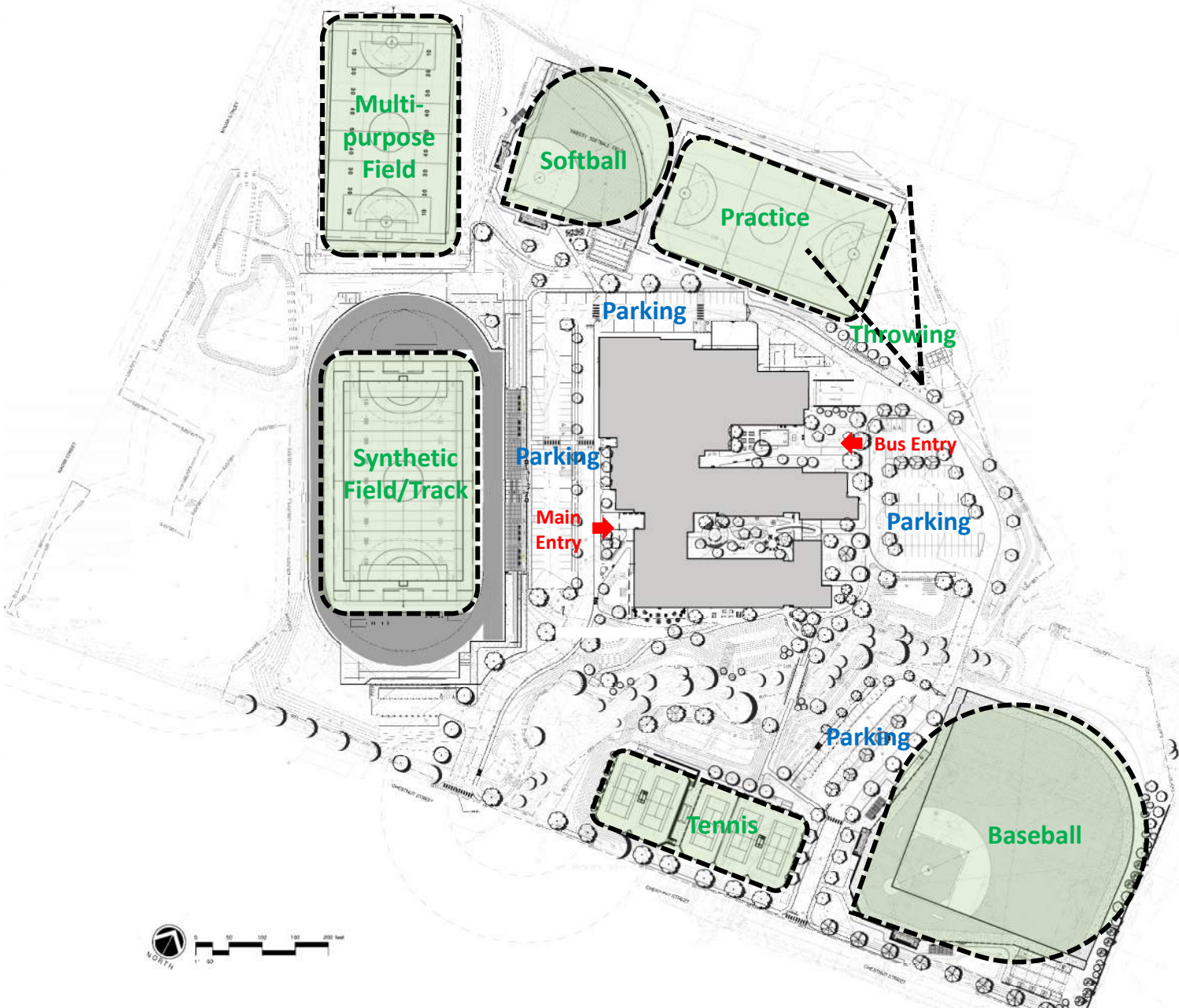



# HUGH COLE PLAYGROUND/LOOP ROAD UPDATE

New Asphalt 25,550SF @ \$6.15/SF: \$195K (carried in budget at DD)  
New Play Structure/Surfacing: \$100K (not in DD budget)

Mill & Overlay 26,850SF @ \$3.55/SF: \$118K  
Keep Existing Play Structure: \$0

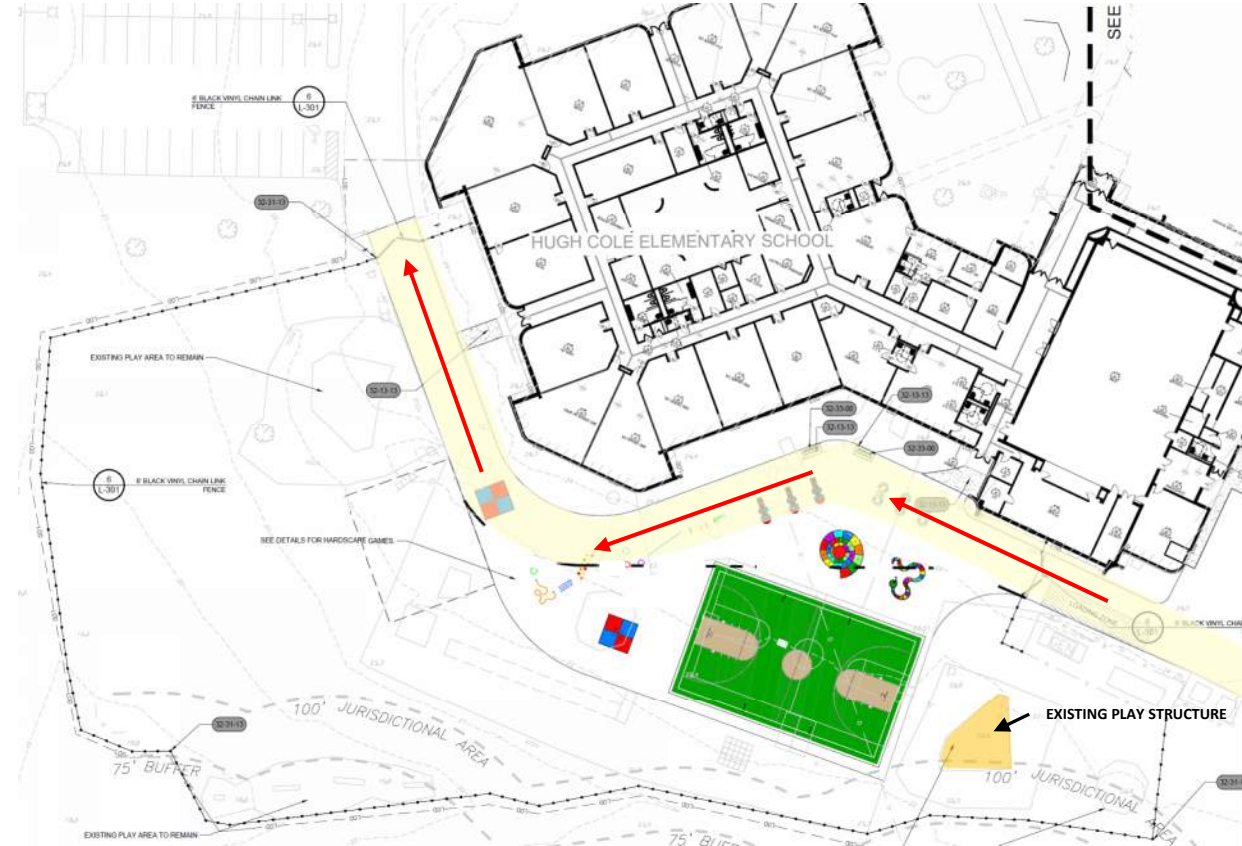
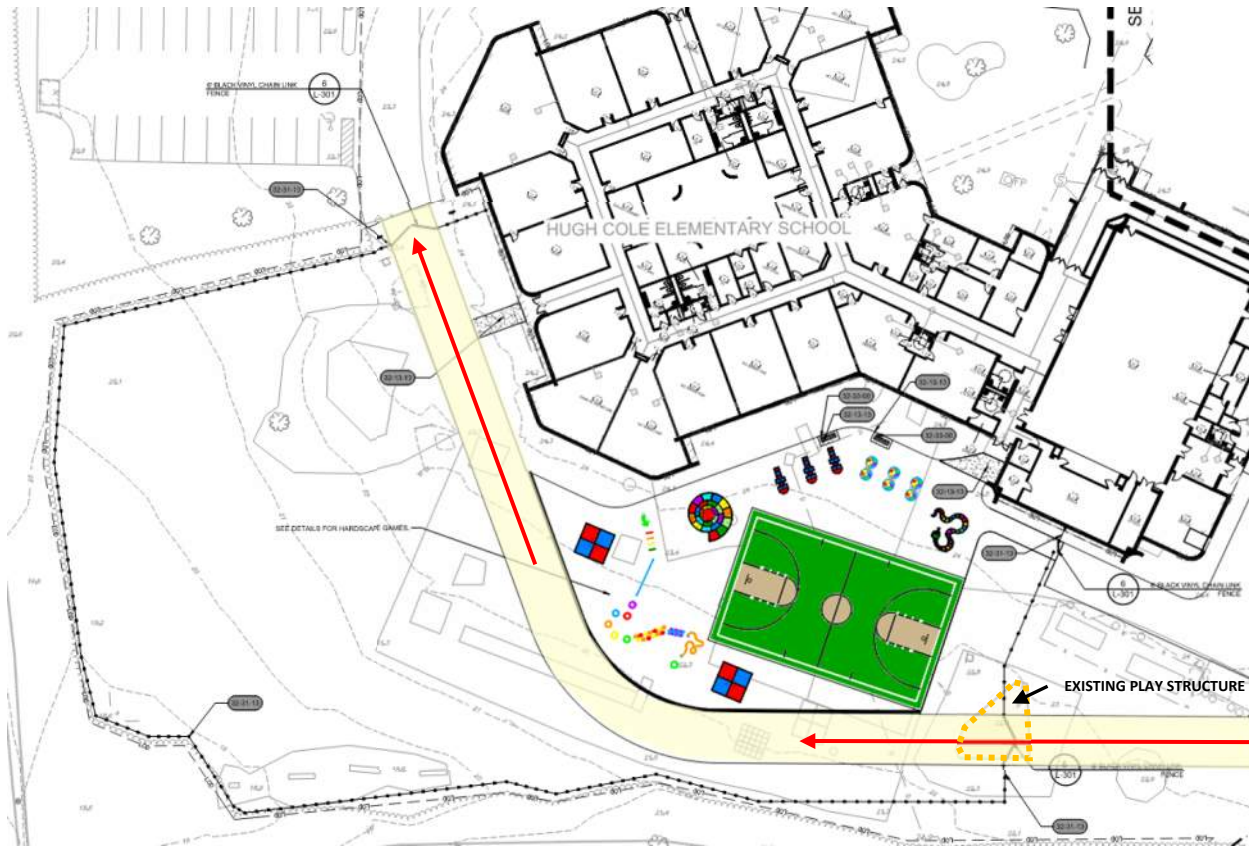

Cost Impact at CD60: +\$100K (new play structure/surfacing)

Cost Impact at CD60: -\$77K

**\*VOTE\***



# ROOM DATA SHEET UPDATE

---



PMA Consultants

PERKINS —  
EASTMAN



# ROOM DATA SHEETS

## MT. HOPE HIGH SCHOOL

### CORE CLASSROOM

6/10/24

#### Classroom (Typ.)

##### FUNCTIONAL CRITERIA

Description: 9th, 10th, 11th, 12th grades primary teaching space

Area:  
Quantity: -  
Occupants: 26

##### LOCATION/ ORIENTATION CRITERIA

Users: Students, Teachers/ Staff  
Adjacencies: Flexible Learning, Science, Breakout Space, Sp. Ed.  
Orientation: North/ South  
Views: Silver Creek, Cafe Courtyard

##### TECHNICAL CRITERIA

Floor/ Base:  
Walls:  
Ceilings:  
  
Doors: Solid core with wood finish and 3' wide side light glass and roller shade.  
  
Windows: Aluminum clad frames, double pane glazing with operable panes/ screens and mesh rolldown shade.  
  
Lighting: Pendant LEDs with dimmers and zoned.  
  
Plumb/ Fire: strobe alarm, sprinkler system  
  
Power: Convenience Outlets

##### FUNCTIONAL CRITERIA

Data/ Com: Wireless AP, Classroom Wall VOIP, Classroom Interactive Display

Security:  
Acoustical:  
Mechanical:

##### FIXTURES FURNISHINGS

Casework: Tall cabinet w/ Teacher wardrobe, sliding whiteboard unit w/ storage behind and

Storage:

CLASSROOM - FRESHMAN A 109		
SCIE E	Family and Type	Type Mark
1	EQ-01 CHARGING STORAGE: EQ-01 CHARGING STORAGE	
2	Tack Board: 48" x 48"	TB-4.10
DIVISION 10		
2	Marker Board, Bulletin: Marker Board 6' - MB-6.10	MB-6.10
1	Marker Board, Bulletin: Marker Board 8' - MB-8.10	MB-8.10
DIVISION 12		
1	06_4020.2 Typical Classroom Casework Assy 1: 06_4020.2 Typical Classroom Casework Assy 1	
2	cw_01_Base_1Dwr_2Door: 3'-0"W x 3'-0"H x 2'-0"D	
1	cw_01_Base_2Dwr: 3'-0"W x 3'-0"H x 2'-0"D	
1	cw_02_Wall_Markboard Sliding Doors: 9'-0"Wx4'-0"Hx2'-0"D	
3	cw_03_Tall_Wardrobe1: 3'-0"W x 7'-0"H x 2'-0"D SHELVES & ROD	

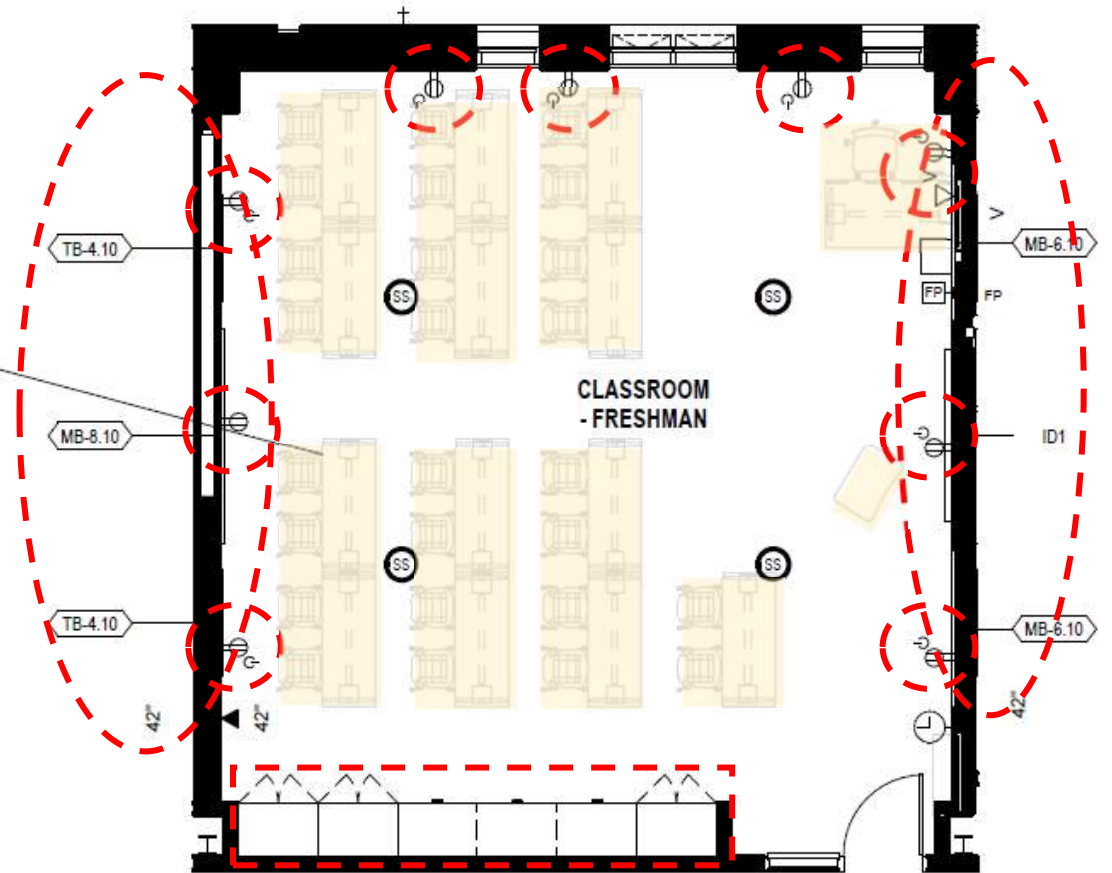

# ROOM DATA SHEETS

## MT. HOPE HIGH SCHOOL

### SCIENCE - WING A FIRST FLOOR

11/20/24

#### Science Classroom

##### FUNCTIONAL CRITERIA

Description: 9th grade primary teaching space

Area:  
Quantity: -  
Occupants: 26

##### LOCATION/ ORIENTATION CRITERIA

Users: Students, Teachers/ Staff  
Adjacencies: Classroom, Career Center, Planning center, ELL/MLL  
Orientation: South  
Views: Silver Creek, Outdoor Learning Space

##### TECHNICAL CRITERIA

Floor/ Base:  
Walls:  
Ceilings:

Doors: Solid core with wood finish and 3' wide side light glass and roller shade.

Windows: Aluminum clad frames, double pane glazing with operable panes/ screens and mesh rollout shade.

Lighting:

Plumb/ Fire: strobe alarm, sprinkler system

Power: Convenience Outlets

##### FUNCTIONAL CRITERIA

Data/ Com: Wireless AP, Classroom Wall VOIP, Classroom Interactive Display

Security:  
Acoustical:  
Mechanical:

##### FIXTURES FURNISHINGS

Casework:

#### FRESHMAN BIOLOGY LAB:

- 6 STUDENT SINKS
- OVERHEAD POWER
- 1 DEMO SINK
- 1 EYE WASH
- EXTERIOR DOOR TO OUTDOOR PLANTERS (IN LIEU OF GREENHOUSE)

#### PREP ROOM:

- 2 SINKS
- 1 DISHWASHER
- 1 ACID STORAGE (UNDERCOUNTER, VENTED)
- 1 CHEMICAL STORAGE (UNDERCOUNTER)
- 1 EYE WASH
- 1 REFRIGERATOR (36"W, FULL HEIGHT)

#### QUESTIONS

- STERILIZATION MACHINE?
- GOGGLE STORAGE NOT NEEDED?

FRESHMAN BIOLOGY A102		
SCIENCE	Family and Type	Type Mark
DIVISION 10		
2	Marker Board, Bulletin: Marker Board 4' - MB-4.11	MB-4.11
1	Marker Board, Bulletin: Marker Board 8' MB-8.11	MB-8.11
DIVISION 12		
2	cw_00_Countertop: 2'-1" D x 1" T Epoxy	
3	cw_01_Base_1Dwr_2Door: 3'-0"W x 2'-9"H x 2'-0"D	
3	cw_02_Wall_2Door: 3'-0"W x 2'-6"H x 1'-0"D	
3	cw_03_Tail_Storage: 3'-0" W x 7'-0" H x 2'-0"D SHELIVING	
2	cw_03_Tail_Wardrobet: 3'-0"W x 7'-0"H x 2'-0"D SHELVES & ROD	
1	cw_06_Science_Demo-sm: Science Demo 2'6" x 3'6"	
1	cw_06_Science_PegBoard: Drip Peg Board	

PREP ROOM A 107		
Count	Family and Type	Type Mark
DIVISION 10		
2	cw_06_Science_FlamAcid: Corrosive Cabinet	
DIVISION 11		
1	Dishwasher_UH_PE: 24"	
2	Refrigerator-Stainless_Steel_Door: RZ11M7074SA	
DIVISION 12		
2	Counter Top-L Shaped w Sink Hole_UH_PE: 24' Depth	
1	cw_00_Countertop: 2'-1" D x 1" T Epoxy	
1	cw_00_Countertop: 2'-1" D x 1" T Epoxy Resin	
9	cw_01_Base_1Dwr_2Door: 3'-0"W x 2'-9"H x 2'-0"D	
3	cw_02_Wall_2Door: 3'-0"W x 2'-6"H x 1'-0"D	
1	cw_06_Science_PegBoard: Drip Peg Board	

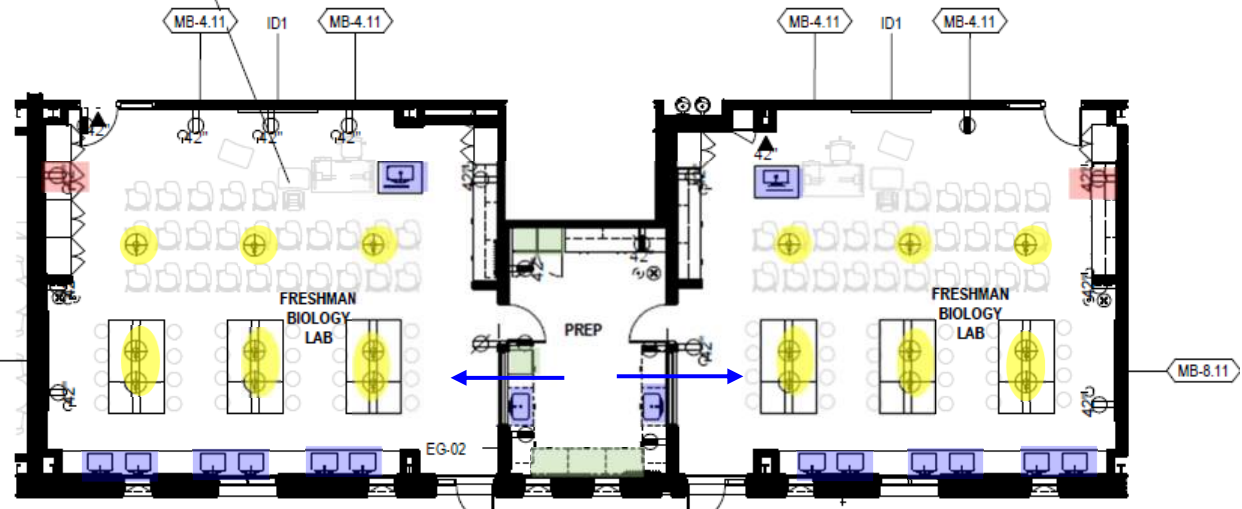



# ROOM DATA SHEETS

## MT. HOPE HIGH SCHOOL

### SPECIAL ED

6/10/24

#### Special Education

##### FUNCTIONAL CRITERIA

Description: 10th, 11th, 12th grades primary teaching space

Area:  
Quantity: -  
Occupants: 8

##### LOCATION/ ORIENTATION CRITERIA

Users: Students, Teachers/ Staff  
Adjacencies: Classroom

Orientation: South  
Views:

##### TECHNICAL CRITERIA

Floor/ Base:  
Walls:  
Ceilings:

Doors: Solid core with wood finish and 3' wide side light glass and roller shade.

Windows: Aluminum clad frames, double pane glazing with operable panes/ screens and mesh rolldown shade.

Lighting: Pendant LEDs with dimmers and zoned.

Plumb/ Fire: strobe alarm, sprinkler system

Power: Convenience Outlets

##### FUNCTIONAL CRITERIA

Data/ Com: Wireless AP, Admin Desk VOIP, Admin Desktop, Classroom Interactive Display

Security:  
Acoustical:  
Mechanical:

##### FIXTURES FURNISHINGS

Casework:

Storage:

LIFE SKILLS B122		
SCIE	Family and Type	Type Mark
E		
1	Microwave shelf_UH_PE: 24" W x 14 1/4" H x 15" D	
18	Pull Handle: Standard	HW1
3	Upper Cabinet_Double_UH_PE: 24" Wide_40" High_15"D	
3	Upper Cabinet_Double_UH_PE: 30" Wide_40" High_15"D	
1	EQ-33 RANGE GLASS COOKTOP: EQ-33 RANGE GLASS COOKTOP	
1	Range02_UH_PE: 30x26	
1	Washer-Front_Load_UH_PE: 24" with Pedestal	
DIVISION 10		
1	Soap_Dispenser-Deck_Mounted-Bohrick-SureFlo_B-84x_Series: B-840	
DIVISION 11		
1	A-APPL-Microwave_UH_PE: 12 1/4"H x 20"W x 16 1/2"D	
1	Dishwasher_UH_PE: 24"	
1	Dryer-Front_Load_UH_PE: 24"	
1	Hood-Wall_UH_PE: 36"	
1	Refrig-24_UH_PE: MC Cut Sheet Dims	
DIVISION 12		
2	ow_00_Countertop: 2'-1" D x 1" T	
DIVISION 12 - 12_3216 MANUFACTURED WOOD-VENEER-FACED CASEWORK		
2	Base Cabinet_Double with Drawer_UH_PE1: 24" Wide	

CLASS TRANSITION B117		
SCIE	Family and Type	Type Mark
E		
1	COUNTERTOP 25" - USE THIS ONE: 25" Depth	
1	Tack Board: 48" x 48" - TB-4.11	TB-4.11
DIVISION 10		
2	Marker Board, Bulletin: Marker Board 6' - MB-6.11	MB-6.11
1	Marker Board, Bulletin: Marker Board 8' MB-8.11	MB-8.11
DIVISION 12		
2	ow_03_Tail_Storage: 3'-0" W x 7'-0" H x 2'-0"D SHELIVING	
2	ow_03_Tail_Wardrobe1: 3'-0"W x 7'-0"H x 2'-0"D SHELVES & ROD	
CLASS INTENSIVE B123		
SCIE		
E		
1	COUNTERTOP 25" - USE THIS ONE: 25" Depth	
1	Tack Board: 48" x 48" - TB-4.11	TB-4.11
DIVISION 10		
2	Marker Board, Bulletin: Marker Board 6' - MB-6.11	MB-6.11
1	Marker Board, Bulletin: Marker Board 8' MB-8.11	MB-8.11
DIVISION 12		
4	ow_03_Tail_Storage: 3'-0" W x 7'-0" H x 2'-0"D SHELIVING	

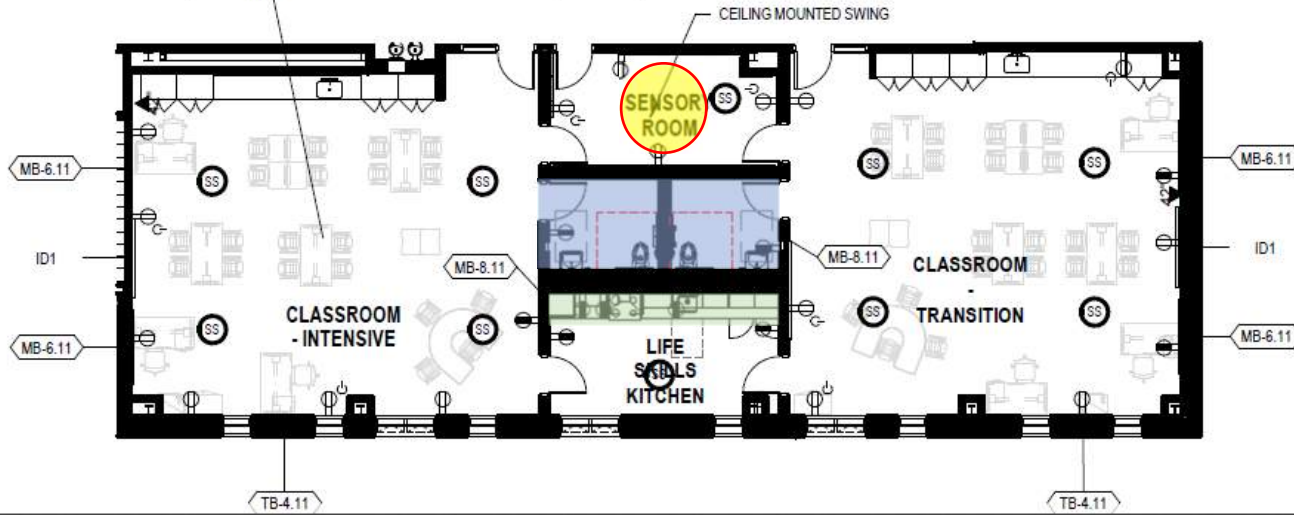

# ROOM DATA SHEETS

## MT. HOPE HIGH SCHOOL

### BAND ROOM

9/23/24

#### Band Room

##### FUNCTIONAL CRITERIA

Description: 9th, 10th, 11th, 12th grades

Area:

Quantity: -  
Occupants: 26

##### LOCATION/ ORIENTATION CRITERIA

Users: Students, Teachers/ Staff  
Adjacencies: Entry Vestibule,  
Chorus Room,  
Auditorium  
Orientation: West  
Views: Track & Field

##### TECHNICAL CRITERIA

Floor/ Base:  
Walls:  
Ceilings:

Doors: Solid core with wood finish  
and 3' wide side light glass  
and roller shade.

Windows: Aluminum clad frames,  
double pane glazing with  
operable panes/ screens  
and mesh rolldown shade.

Lighting:

Plumb/ Fire: strobe alarm, sprinkler system

Power: Convenience Outlets

##### FUNCTIONAL CRITERIA

Data/ Com: Wireless AP,  
Classroom Wall VOIP,  
Classroom Interactive Display,  
CTA AV Scope

Security:  
Acoustical:  
Mechanical:

##### FIXTURES FURNISHINGS

Casework:

Storage:

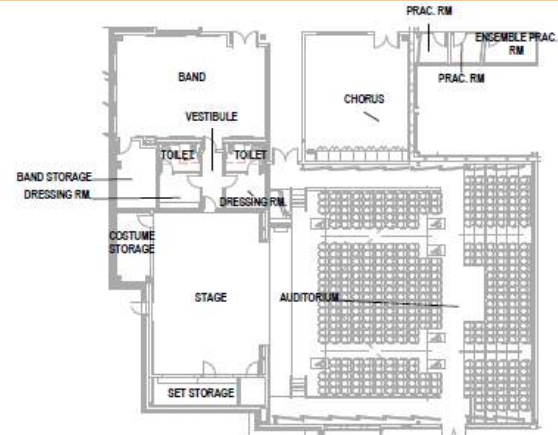

BAND ROOM E105		
SCIEN	Family and Type	Type Mark
1	COUNTERTOP 25" - USE THIS ONE: 25" Depth	
1	Modesty Panel: Modesty Panel	
1	Upper Cabinet-Double 03_WH_PE: 36"	
25	Panels_RPG-Acoustical-Systems_Formeddiffusor-T-Barrel: Formeddiffusor T Barrel - 2' x 4' x 7"	
16	Panels_RPG-Acoustical-Systems_Hi-Impact-Absorb or 3': Hi-Impact Absorbtor - 2"	
51	Panels_RPG-Acoustical-Systems_Hi-Impact-Absorb or 4x12": Hi-Impact Absorbtor - 2"	
138	Ceiling-Baffle-Turf_Design-WEDGE-Single: Individual Panel	
138	Ceiling-Baffle-Turf_Design-WEDGE-System- single panel : Standard Depth Panel 5'	

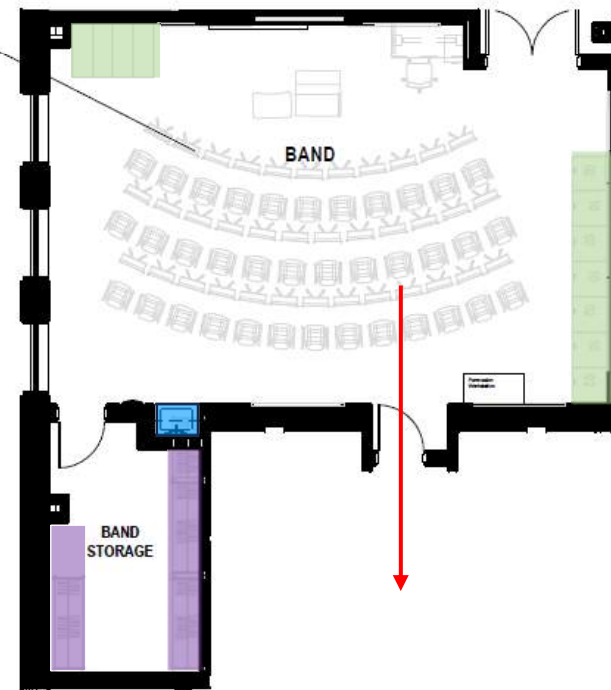



# ROOM DATA SHEETS

## MT. HOPE HIGH SCHOOL

### CTE TECH ENGINEERING LAB

11/26/24

#### Tech/Engineering

##### FUNCTIONAL CRITERIA

Description: 10th, 11th, 12th grades  
primary teaching space

Area:  
Quantity: -  
Occupants: 26

##### LOCATION/ ORIENTATION CRITERIA

Users: Students, Teachers/ Staff  
Adjacencies: Auditorium,  
School store  
Science Classroom  
Orientation: North  
Views:

##### TECHNICAL CRITERIA

Floor/ Base:  
Walls:  
Ceilings:

Doors: Solid core with wood finish  
and 3' wide side light glass  
and roller shade.

Windows: Aluminum clad frames,  
double pane glazing with  
operable panes/ screens  
and mesh rolldown shade.

Lighting:

Plumb/ Fire: strobe alarm, sprinkler system

Power: Convenience Outlets

##### FUNCTIONAL CRITERIA

Data/ Com: Wireless AP,  
Classroom Wall VOIP,  
Teacher Laptop  
Classroom Interactive Display

Security:  
Acoustical:  
Mechanical:

##### FIXTURES FURNISHINGS

Casework:

Storage:

- TECH LAB:**
- 2 COMPRESSED AIR TURRETS
  - 2 CNC MACHINE (LARGE)
  - 6 3D PRINTERS
  - 2 LASER CUTTER/ENGRAVER
  - 1 VACUUM FORMER (DESKTOP)
  - 1 PLOTTER
  - 1 CHARGING CART/BUILT-IN
  - 26 STUDENT DESKTOP COMPUTERS

OVERHEAD POWER REELS  
(DRY LAB - NO PLUMBING)

TECH LAB B102		
SCIENE	Family and Type	Type Mark
26	Chair-Stool-KI-600Series: INVALID TYPE - Load Family with Type Catalog	
1	Chair-Task-Armless: Armless	
1	Classroom-Lectern-KI-Ruckus-Adjustable: Classroom-Lectern-KI-Ruckus-Adjustable	
6	Classroom-Storage-KI-Ruckus-Worktable: INVALID TYPE - Load Family with Type Catalog	
1	Storage-KI-U-Series-Pedestal-Mobile: Storage-KI-U-Series-Pedestal-Mobile	
1	Table-Fixed-KI-Pirouette-Rectangular-Training: INVALID TYPE - Load Family with Type Catalog	
6	EQ-3A 3D PRINTER: EQ-3A 3D PRINTER	EQ-3A
2	EQ-20 CNC MILL: EQ-20 CNC MILL	EQ-20
2	EQ-21 LASER ENGRAVER: EQ-21 LASER ENGRAVER	EQ-21
26	EQ_PC: Desktop computer	
DIVISION 10		
2	Marker Board, Bulletin: Marker Board 6' - MB-6.10	MB-6.10
DIVISION 11		
1	EQ_3D PRINTER_ULITMAKER: EQ_3D PRINTER_ULITMAKER	EQ-19-DF
1	EQ_LASER CUTTER: EQ_LASER CUTTER	EQ-22-DF
1	EQ_VACUUM FORMER: EQ_VACUUM FORMER	
DIVISION 12		
1	06_4020 2 Typical Classroom Casework Assy 1: 06_4020 2 Typical Classroom Casework Assy 1	
1	cw_00_Countertop: 2'-7" D Epoxy - USE THIS ONE EPOXY	
2	cw_01_Base_1Dwr_2Door: 3'-0"W x 3'-0"H x 2'-0"D	
1	cw_01_Base_2Dwr: 3'-0"W x 3'-0"H x 2'-0"D	
4	cw_02_Wall_Markboard Sliding Doors: 9'-0"Wx4'-0"Hx2'-0"D	
3	cw_03_Tall_Wardrobe: 3'-0"W x 7'-0"H x 2'-0"D SHELVES & ROD	

VIEWS IN

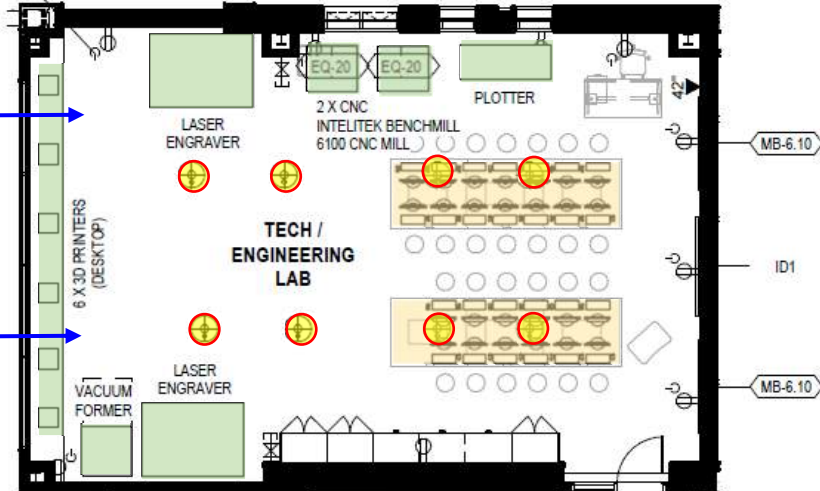

## MT. HOPE HIGH SCHOOL

### NURSE

#### Nurse

##### FUNCTIONAL CRITERIA

Description: Support space

Area:

Quantity: -

Occupants:

##### LOCATION/ ORIENTATION CRITERIA

Users: Students, Teachers/ Staff

Adjacencies: Toilet, Admin

Orientation: East

Views: Outdoor Learning Courtyard

##### TECHNICAL CRITERIA

Floor/ Base:

Walls:

Ceilings:

Doors: Solid core with wood finish and 3' wide side light glass and roller shade.

Windows:

Lighting:

Plumb/ Fire: strobe alarm, sprinkler system

Power: Convenience Outlets

##### FUNCTIONAL CRITERIA

Data/ Com:

Security:

Acoustical:

Mechanical:

##### FIXTURES FURNISHINGS

Casework:

Storage:

NURSE STORAGE D102B		
Count	Family and Type	Type Mark
Casework		
1	cw_00_Countertop: 2'-1" D x 1" T	
Specialty Equipment		
1	IceMachineDispenserNuggetCountertop4817057_UH_HC: 4817-057	
1	Printer, Copier, Fax Combination_UH_PE: M1840	
1	Refrig-Undercounter_UH_PE: SKRF24B	

PATIENT CARE ROOM		
Count	Family and Type	Type Mark
Furniture		
3	Keilhauer_Ruben_Tables: Keilhauer_Ruben_Tables	
3	Med-RestCot: 72x27	
Specialty Equipment		
3	Shower Curtain_UH_PE: K-1408	
1	Soap Dispenser - Surface Mounted: B-2111	TA-15

NURSE OFFICE		
Count	Family and Type	Type Mark
Casework		
1	cw_00_Countertop: 2'-1" D x 1" T	
3	Upper Cabinet-Double 03_WH_PE: 36"	
Furniture		
1	Chair-Task-Arms: Arms	
1	Desk-1Ped-Full-LPed: D72x30	
1	ExamChairMidmark626_UH_HC: 626-001	
1	Storage-BC: 36x12-2high	
3	Storage-LF: 42x18-4high	





# ROOM DATA SHEETS

## MT. HOPE HIGH SCHOOL

### GUIDANCE AND SP. ED. OFFICE

6/10/24

#### Guidance and Sp. Ed. Offices

**FUNCTIONAL CRITERIA**

Description: Support space

Area:

Quantity: -  
Occupants: 15

**LOCATION/ ORIENTATION CRITERIA**

Users: Students, Teachers/ Staff  
Adjacencies: Career Center, Community Health, Admin  
Orientation: West  
Views: Track & Field

**TECHNICAL CRITERIA**

Floor/ Base:  
Walls:  
Ceilings:  
Doors: Solid core with wood finish and 3' wide side light glass and roller shade.  
Windows: Aluminum clad frames, double pane glazing with operable panes/ screens and mesh rollout shade.  
Lighting:  
Plumb/ Fire: strobe alarm, sprinkler system  
Power: Convenience Outlets

**FUNCTIONAL CRITERIA**

Data/ Com:

Security:  
Acoustical:  
Mechanical:

**FIXTURES FURNISHINGS**

Casework:

Storage:

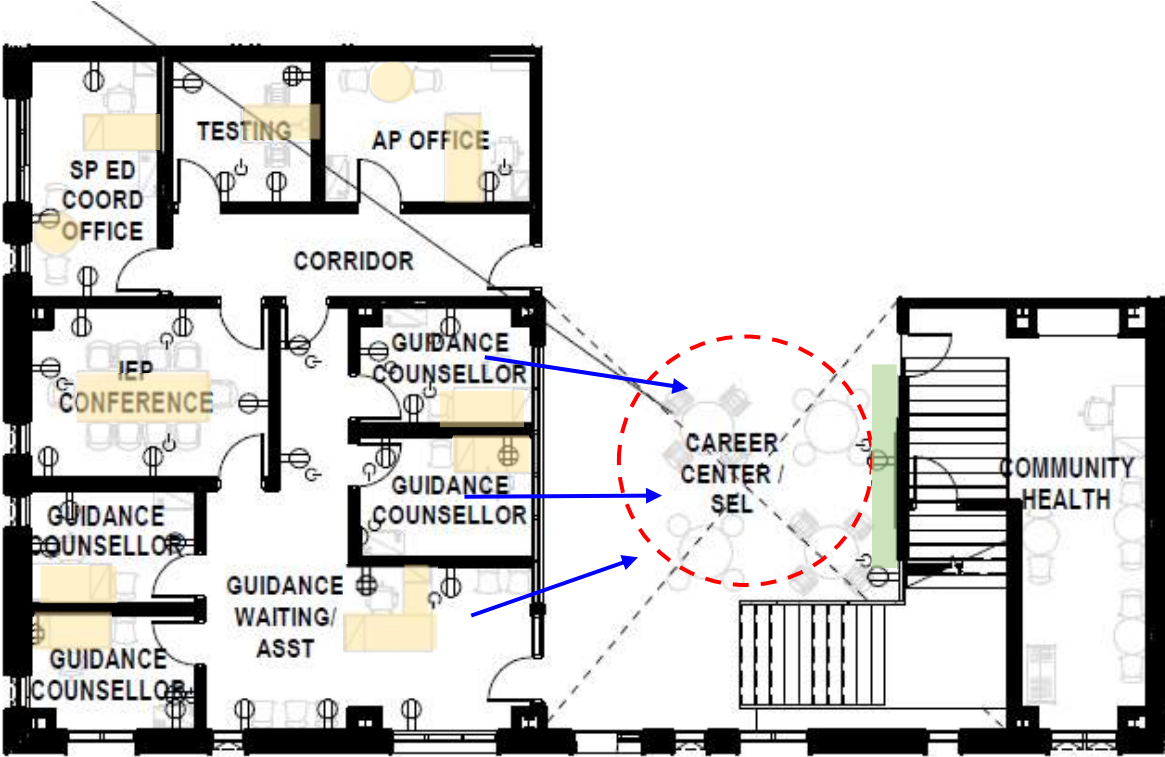

# BUDGET UPDATE

---



PMA Consultants

PERKINS —  
EASTMAN



# PROJECT CASHFLOW

## BWRSD Cashflow Projection - Stage III (SD) - \$186M TPB

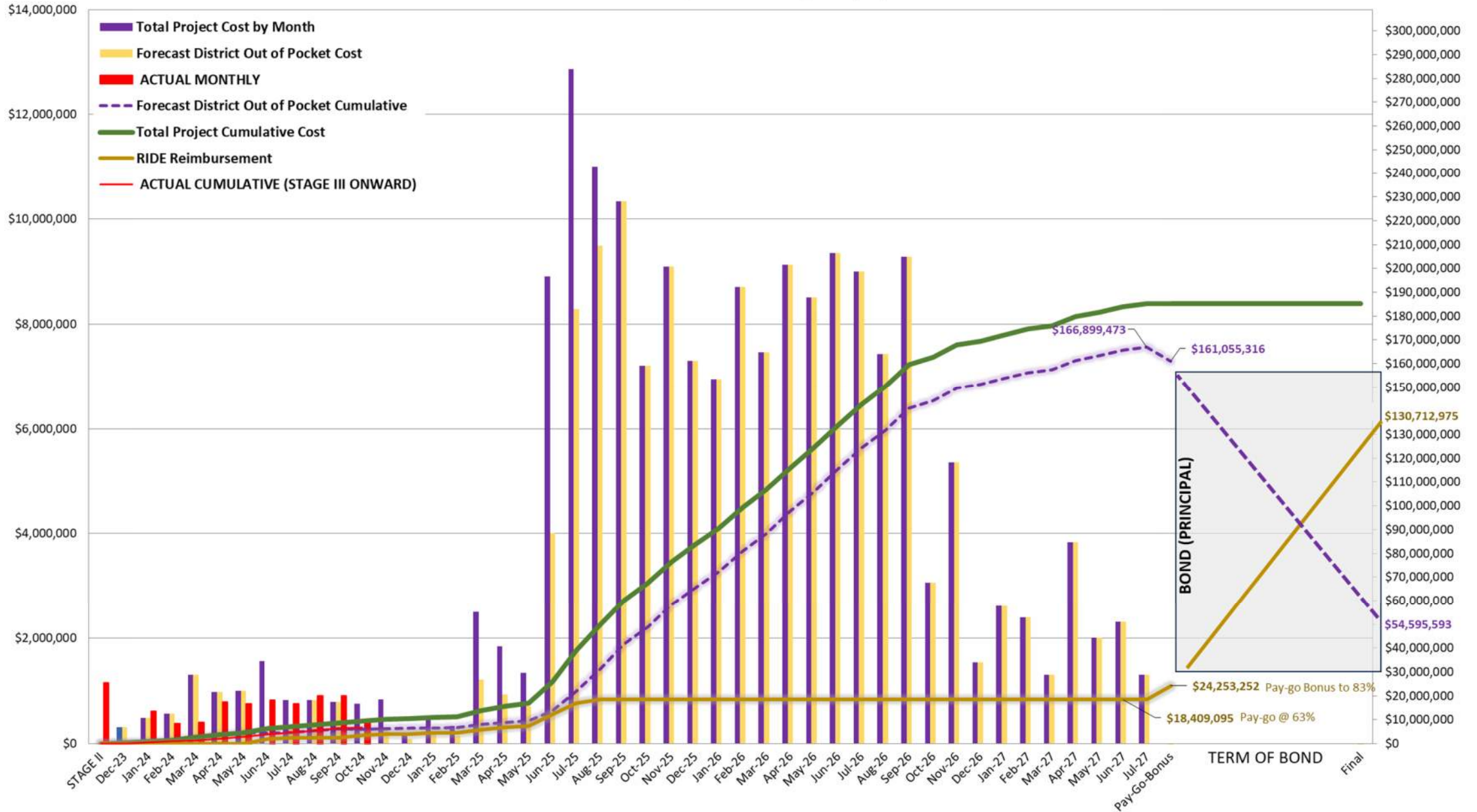

# PROJECT SCHEDULE / NEXT STEPS

---



**PMA Consultants**  
EST. 1971

**PERKINS —  
EASTMAN**



# NEXT STEPS

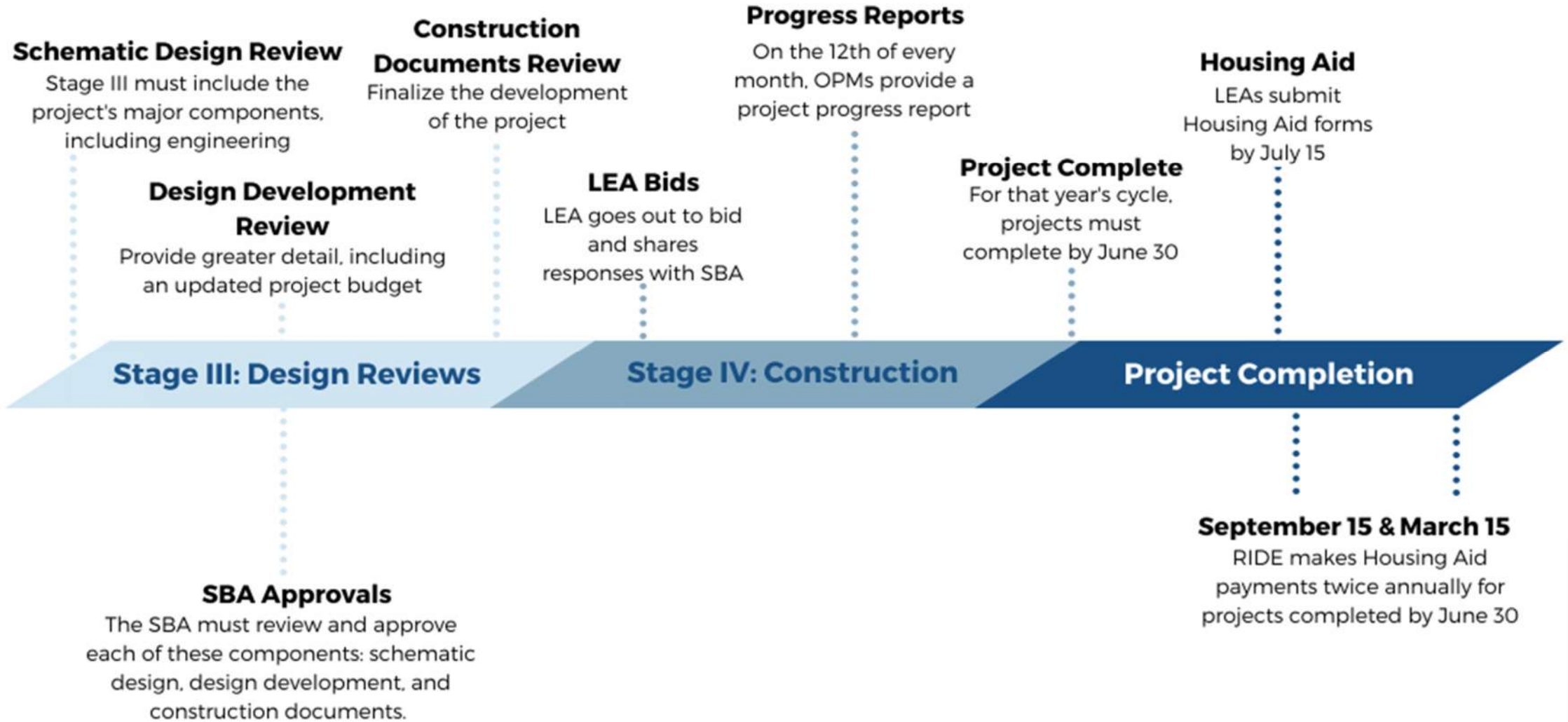



**PMA Consultants**

**PERKINS —  
EASTMAN**

MT HOPE  
HIGH SCHOOL

**QUESTIONS? | THANK YOU!**