

**STRONG** to serve.

In the fall of 2011, the SCLA General Board unanimously approved a capital campaign to enable the school's ministry to pursue its master site plan. The intent is to ensure that the school remains viable and strong for generations to come.

**PHASE 1  
THE DORMITORY**



**PHASE 2  
FINE ARTS SPACES AND  
ENTRANCE SECURITY**



**PHASE 3A  
TEKTŌN BUILDING**

In order to complete Phase 3, we will need to make room for the new practice gymnasium by removing the former girls' dormitory and relocating existing classroom and storage space. We are blessed with an existing north-end building that can be repurposed for such use. This existing building will be renovated to include space for Career and Technical Education classrooms and work areas, an athletic space for wrestling, a permanent concessions stand, restrooms, and storage space.

**EST COMPLETION SUMMER 2025**

**PHASE 3B  
PRACTICE GYMNASIUM**

SCLA's current indoor athletic space is inadequate for demand. The number of activities requiring practice and/or game space, and the students participating in these activities, has outgrown the current facilities. A second gym will provide the space needed for teams and clubs and ensure that all students have opportunities to engage in extracurricular activities.

**HELP US REACH OUR GOAL OF \$2.15 MILLION**

Space gained:

- **Career and Technical Education classroom and work space:**  
4,600 sq ft
- **Multipurpose sports room\*:**  
3,100 sq ft
- **General and seasonal storage:**  
3,500 sq ft
- **Dedicated concessions area with storage**
- **4 unisex, single-occupant restrooms**

\*The sports room can be used when the main gym is set for other events, can hold 2 regulation-size wrestling mats, and can be used for baseball and softball practice areas

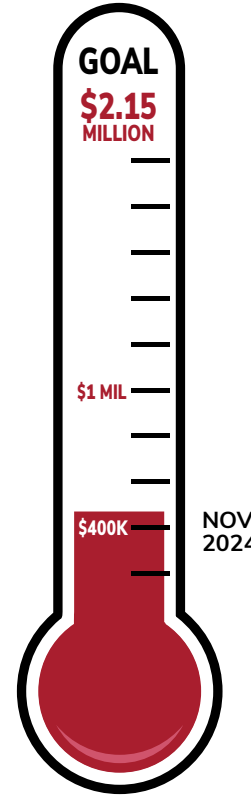

SUGGESTED GIVING AMOUNTS		
Gift Amount	# of Gifts Needed	Total
\$200,000	1	\$200,000
\$100,000	3	\$300,000
\$50,000	10	\$500,000
\$20,000	20	\$400,000
\$10,000	20	\$200,000
\$5,000	30	\$150,000
\$2,500	80	\$200,000
\$1,000	100	\$100,000
\$500	200	\$100,000

Give online at [www.StCroixLutheran.org/giving](http://www.StCroixLutheran.org/giving)

*Commit to the Lord whatever you do, and he will establish your plans.*

Proverbs 16:3

*Thank you!*



1200 Oakdale Avenue  
West St. Paul, MN 55118

Email: [Info@StCroixLutheran.org](mailto:Info@StCroixLutheran.org)  
Phone: (651) 455-1521



**BUILDING FOR  
TOMORROW**



**STRONG** to serve.

[www.StCroixLutheran.org/giving](http://www.StCroixLutheran.org/giving)

# TEKTŌN BUILDING



The Ancient Greek noun *tektōn* is a common term for an artisan or craftsman, in particular a carpenter, woodworker, or builder. The term *tektōn* is used in the Gospels to describe Jesus and his father Joseph, signifying their trade, and it is related to the modern word “technology”. We have chosen to call this repurposed building the Tektōn Building to honor our Lord and Savior, the builder of all things. The building will house an expanded Career and Technical Education (CTE) classroom and work areas, along with athletic practice rooms and storage space.



# BUILDING FOR TOMORROW

On Tuesday, October 22, 2024, the SCLA General Board unanimously approved the *Strong to Serve* Phase 3a project. This project is a stepping stone for the completion of SCLA’s 12-year-old *Strong to Serve* capital campaign (ending with the completion of a practice gymnasium) and involves repurposing an unused building, formerly a dormitory, as classroom, athletic practice, and storage space. Through November 2024, we have secured \$410,000 in cash and commitments toward the \$2.15M project.

When completed, Phase 3a of the project will provide purpose-built classroom and workshop space for our expanding Career and Technical Education (CTE) courses, designed to equip students with skills for careers in fields like healthcare, technology, skilled trades, and engineering.

The renovation will also provide wrestling and other practice space, a dedicated concessions area, restrooms with outside access, and general storage space.

With this step, SCLA is advancing its mission to build stronger futures for our students and community.

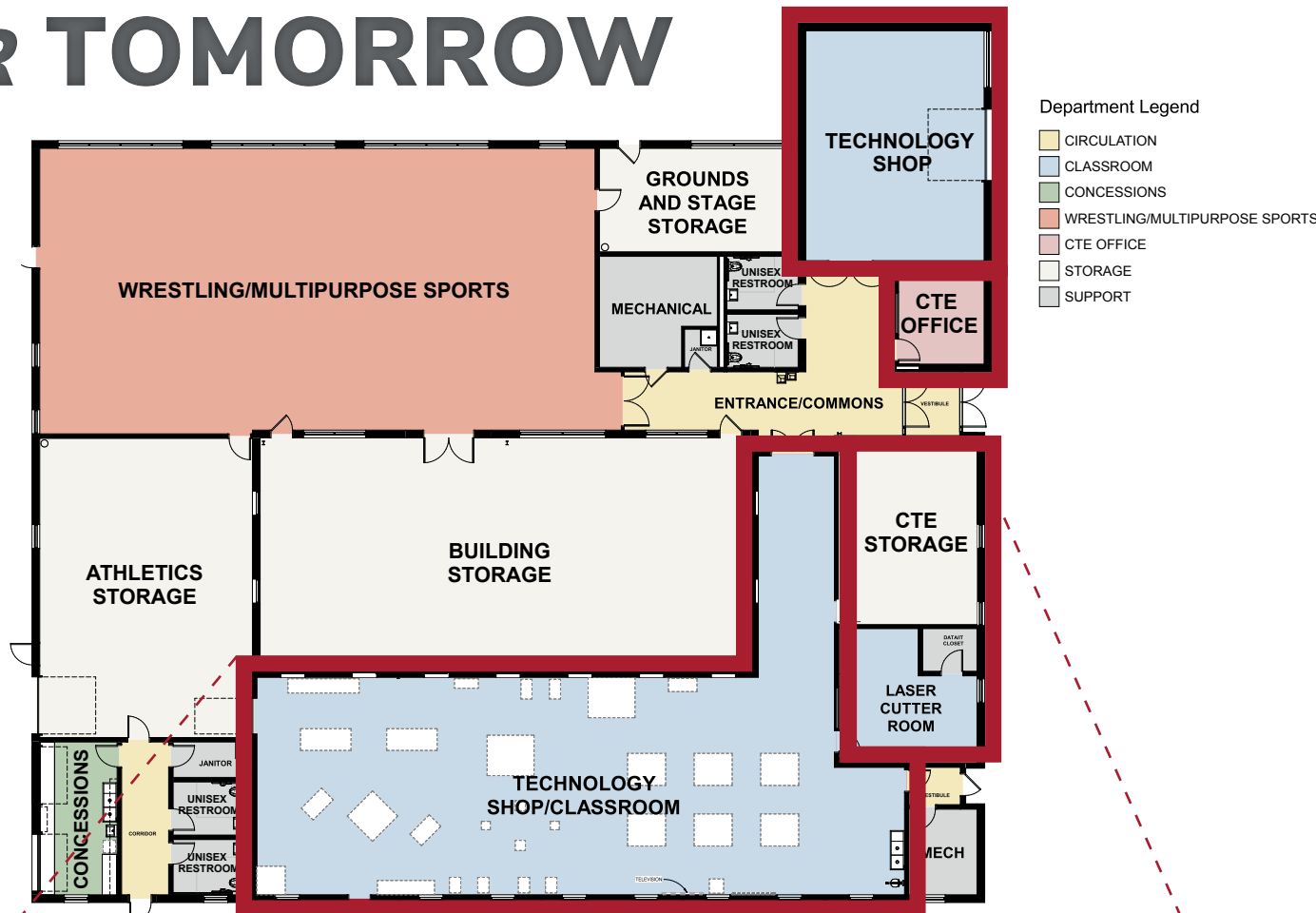

## PHASE 3a CAREER AND TECHNOLOGY EDUCATION (CTE) CLASSROOM



The above photo is an artist rendering of the classroom. The final building may look different.

*“God continues to bless SCLA by providing an opportunity for all students to explore and pursue their interests. It’s exciting to imagine the potential impact this program will have for SCLA students interested in entering the trades.”*



**Paul Wehing**  
Retired SCLA instructor who envisioned the Career and Technology Education program and taught the first classes starting in 2011



*“...without the applied technology class, I wouldn’t have been inclined to look more into the trades...this class is a huge confidence- and character-building opportunity.”*



**Cael Degener**  
SCLA Class of 2021, now an HVAC technician

**STRONG** to serve.