

Merced City School District

Boundary Adjustments 6th Grade Relocation

December 17, 2024



Engagement and Planning

Partner Input

- MCSD Board Facilities Sub-Committee
- MCSD Boundary Adjustment Committee
- MCSD Staff
- MCSD Student Advisory Committee
- MCSD Parent/Community

Decision Process

- MCSD Boundary Adjustment Committee collect and synthesize input, propose recommendations and timeline to MCSD School Board
- MCSD School Board decision on boundary adjustment map and timeline



What has been done so far?

2023-2024 School Year	2024-2025 School Year
<p>October 10, 2023 – Educational Specifications and Building Standards</p> <p>December 2023 – Facility assessments and Principal surveys</p> <p>February 2024 – Student surveys and data analyzation</p> <p>March 2024 – Facilities Master Plan Draft #1 developed</p> <p>April 2024 – Community polling</p> <p>April 2024 – Community outreach</p> <p>May 2024 – District Facilities Committee Meeting</p>	<p>June 2024 - Board Workshop (Special Board Meeting)</p> <p>June 2024 - Facilities Master Plan adopted by Board of Trustees</p> <p>June 2024 - Governing Board consideration of November 2024 Bond Measure</p> <p>Boundary Adjustment Committee Meetings:</p> <p>September 26, October 9 and 23, November 13, December 13</p> <p>Staff Meetings:</p> <p>October 23, November 13</p> <p>Community Outreach Meeting - December 3</p>



What has been done so far?

	Committee	Staff Forum	Board	Community
September	X			
October	XX	X	Update	
November	X	X	Workshop	
December	X		Tonight	X

Scenarios and Timelines

Scenario #1

District-wide boundary adjustments, keeping 6th Grade at elementary campuses.

Implemented for 2025-2026 School Year



Scenario #1 – Map Option #1 (Cookie Cutter)

District-wide boundary adjustments, keeping 6th Grade at Elementary campuses.

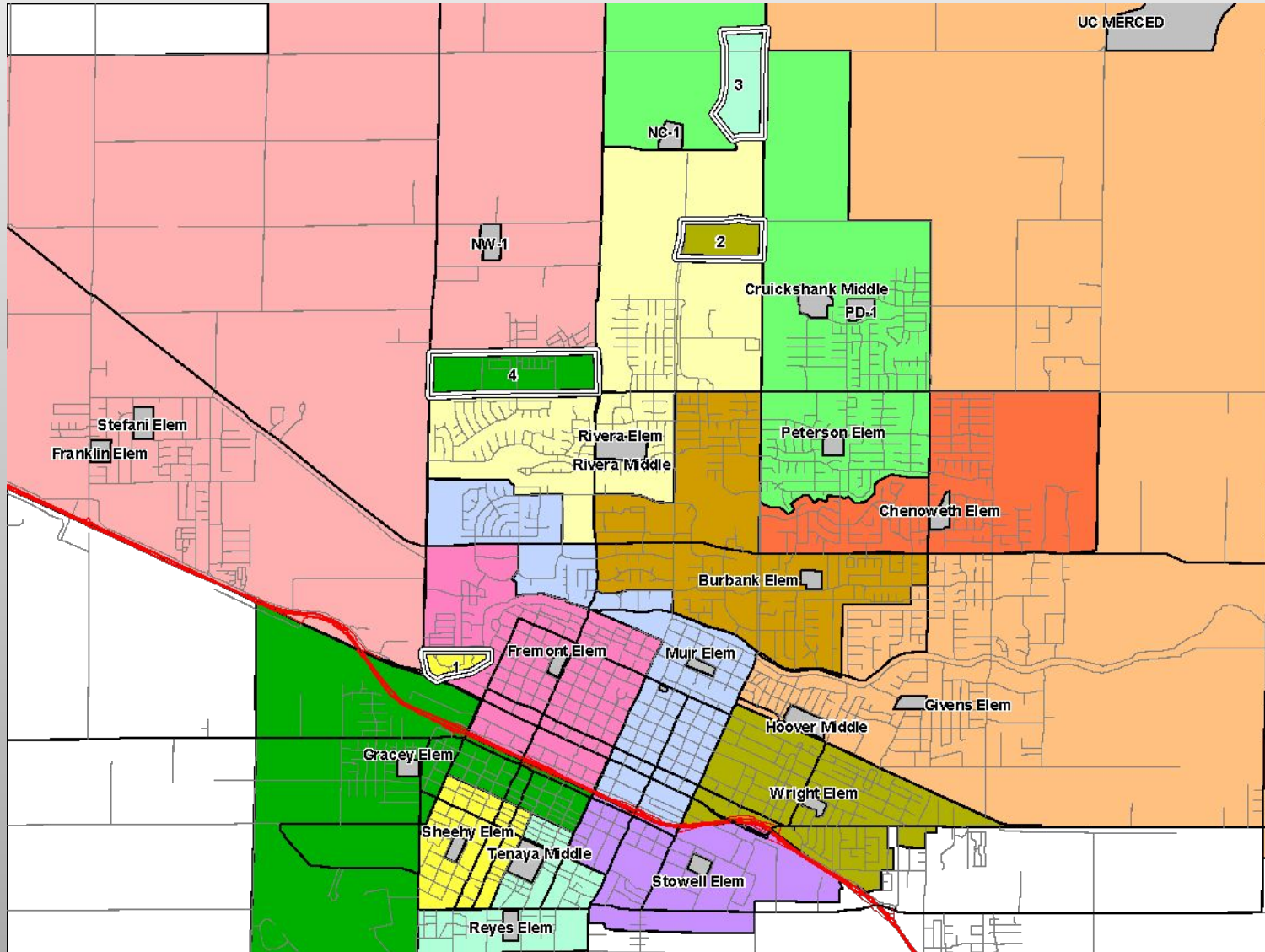

Student Impacts

Area 1: 72 students

Shift from Fremont to Sheehy

Area 2: 66 students

Shift from Rivera to Wright

Area 3: 75 students

Shift from Peterson to Reyes

Area 4: 85 students

Shift from Franklin/Stefani to Gracey

Total Impacts = 298 students

Proposed by SchoolWorks to move students from areas outside the walking distance to their current schools, since bus services are already provided to them.

Scenario #1 – Map Option #1 (Cookie Cutter)

District-wide boundary adjustments, keeping 6th Grade at Elementary campuses.

School Facility Utilization with Portables								
	Net	Net CR	2024/25	2025/26	2026/27	2030/31	2024/25	2030/31
Elementary Schools	Classrooms	Capacity	Current Enrollment	Projected Enrollment	Projected Enrollment	Projected Enrollment	Current Utilization	Projected Utilization
Burbank Elem	27	700	716	711	708	657	102.3%	93.9%
Chenoweth Elem	28	740	722	749	736	715	97.6%	96.6%
Franklin Elem	27	579	602	550	544	559	104.0%	96.5%
Fremont Elem	22	570	578	543	553	544	101.4%	95.4%
Givens Elem	24	635	579	556	551	499	91.2%	78.6%
Gracey Elem	24	623	509	609	623	673	81.7%	108.0%
Muir Elem	23	594	613	612	591	567	103.2%	95.5%
Peterson Elem	25	667	690	645	661	702	103.4%	105.2%
Reyes Elem	26	680	540	620	635	625	79.4%	91.9%
Rivera Elem	31	813	917	875	880	882	112.8%	108.5%
Sheehy Elem	24	633	481	546	527	476	76.0%	75.2%
Stefani Elem	22	664	641	624	630	609	96.5%	91.7%
Stowell Elem	23	541	501	490	471	458	92.6%	84.7%
Wright Elem	23	593	527	586	572	538	88.9%	90.7%
Sub-Totals	349	9,032	8,616	8,716	8,682	8,504	95.4%	94.2%
Middle Schools								
Cruickshank Middle	31	992	624	609	646	794	62.9%	80.0%
Hoover Middle	25	800	629	664	692	635	78.6%	79.4%
Rivera Middle	22	704	608	614	609	634	86.4%	90.1%
Tenaya Middle	33	1,056	607	578	517	467	57.5%	44.2%
Sub-Totals	111	3,552	2,468	2,465	2,464	2,530	69.5%	71.2%

Student Impacts

Area 1: 72 students

Shift from Fremont to Sheehy

Area 2: 66 students

Shift from Rivera to Wright

Area 3: 75 students

Shift from Peterson to Reyes

Area 4: 85 students

Shift from Franklin/Stefani to Gracey

Total Impacts = 298 students

Proposed by SchoolWorks to move students from areas outside the walking distance to their current schools, so bus services are already provided to them.

Scenario #1 – Map Option #2 (Larger Scale)

District-wide boundary adjustments, keeping 6th Grade at Elementary campuses.

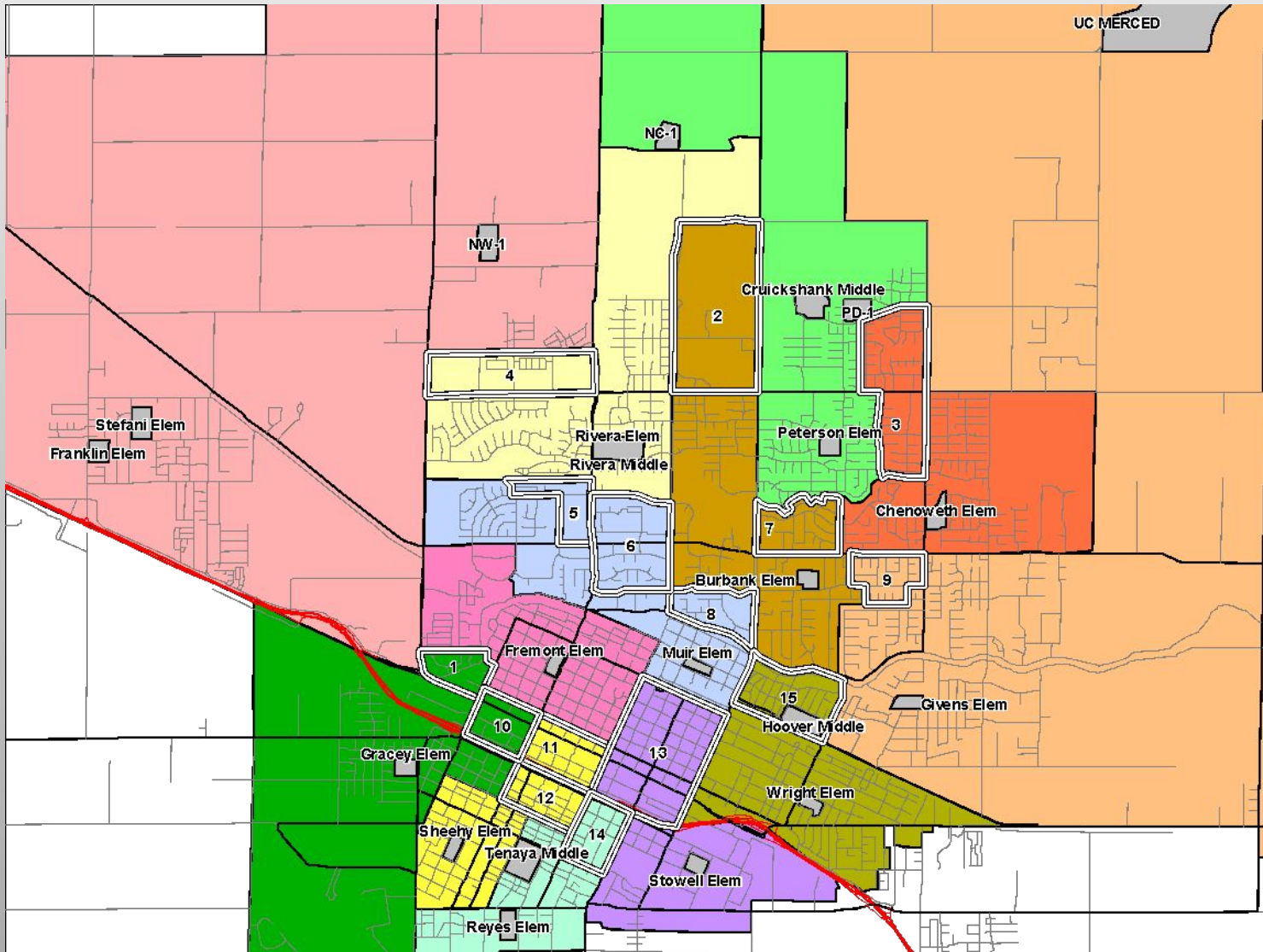

Student Impacts

Area 1: 75 from Fremont to Gracey
Area 2: 66 from Rivera to Burbank
Area 3: 131 from Peterson to Chenoweth
Area 4: 85 from Franklin/Stefani to Rivera
Area 5: 75 from Rivera to Muir
Area 6: 56 from Burbank to Muir
Area 7: 132 from Chenoweth to Burbank
Area 8: 52 from Burbank to Muir
Area 9: 119 from Burbank to Givens
Area 10: 5 from Fremont to Gracey
Area 11: 12 from Fremont to Sheehy
Area 12: 85 from Gracey to Sheehy
Area 13: 155 from Muir to Stowell
Area 14: 117 from Stowell to Reyes
Area 15: 65 from Givens to Wright
Total Impacts = 1,230 students

Requested by MCSD Boundary Adjustment Committee to keep students closer to home than Map Option #1

Scenario #1 – Map Option #2 (Larger Scale)

District-wide boundary adjustments, keeping 6th Grade at Elementary campuses.

School Facility Utilization with Portables

			2024/25	2025/26	2026/27	2030/31	2024/25	2030/31
	Net	Net CR	Current	Projected	Projected	Projected	Current	Projected
<u>Elementary Schools</u>	<u>Classrooms</u>	<u>Capacity</u>	<u>Enrollment</u>	<u>Enrollment</u>	<u>Enrollment</u>	<u>Enrollment</u>	<u>Utilization</u>	<u>Utilization</u>
Burbank Elem	27	698	716	687	678	621	102.6%	89.0%
Chenoweth Elem	28	730	722	763	753	755	98.9%	103.4%
Franklin Elem	27	579	602	550	544	559	104.0%	96.5%
Fremont Elem	22	570	578	520	526	513	101.4%	90.0%
Givens Elem	24	624	579	607	611	551	92.8%	88.3%
Gracey Elem	24	621	509	502	519	518	82.0%	83.4%
Muir Elem	23	594	613	647	628	635	103.2%	106.9%
Peterson Elem	25	667	690	591	618	661	103.4%	99.1%
Reyes Elem	26	680	540	651	651	642	79.4%	94.4%
Rivera Elem	31	813	917	907	919	944	112.8%	116.1%
Sheehy Elem	24	644	481	565	538	479	74.7%	74.4%
Stefani Elem	22	664	641	624	630	609	96.5%	91.7%
Stowell Elem	23	437	501	527	505	463	114.6%	105.9%
Wright Elem	23	593	527	572	552	511	88.9%	86.2%
Sub-Totals	349	8,914	8,616	8,713	8,672	8,461	96.7%	94.9%
<u>Middle Schools</u>								
Cruickshank Middle	31	992	624	609	646	794	62.9%	80.0%
Hoover Middle	25	800	629	664	692	635	78.6%	79.4%
Rivera Middle	22	704	608	614	609	634	86.4%	90.1%
Tenaya Middle	33	1,056	607	578	517	467	57.5%	44.2%
Sub-Totals	111	3,552	2,468	2,465	2,464	2,530	69.5%	71.2%

Student Impacts

- Area 1: 75 from Fremont to Gracey
- Area 2: 66 from Rivera to Burbank
- Area 3: 131 from Peterson to Chenoweth
- Area 4: 85 from Franklin/Stefani to Rivera
- Area 5: 75 from Rivera to Muir
- Area 6: 56 from Burbank to Muir
- Area 7: 132 from Chenoweth to Burbank
- Area 8: 52 from Burbank to Muir
- Area 9: 119 from Burbank to Givens
- Area 10: 5 from Fremont to Gracey
- Area 11: 12 from Fremont to Sheehy
- Area 12: 85 from Gracey to Sheehy
- Area 13: 155 from Muir to Stowell
- Area 14: 117 from Stowell to Reyes
- Area 15: 65 from Givens to Wright

Total Impacts = 1,230 students

Requested by MCSD Boundary Adjustment Committee to keep students closer to home than Map Option #1

Scenarios and Timelines

Scenario #2

District-wide boundary adjustments and move 6th Grade to
Middle Schools.

Implemented for 2025/2026 School Year



Scenario #2 – Full Data Still being collected

District-wide boundary adjustments, move 6th Grade to Middle Schools both in 25/26

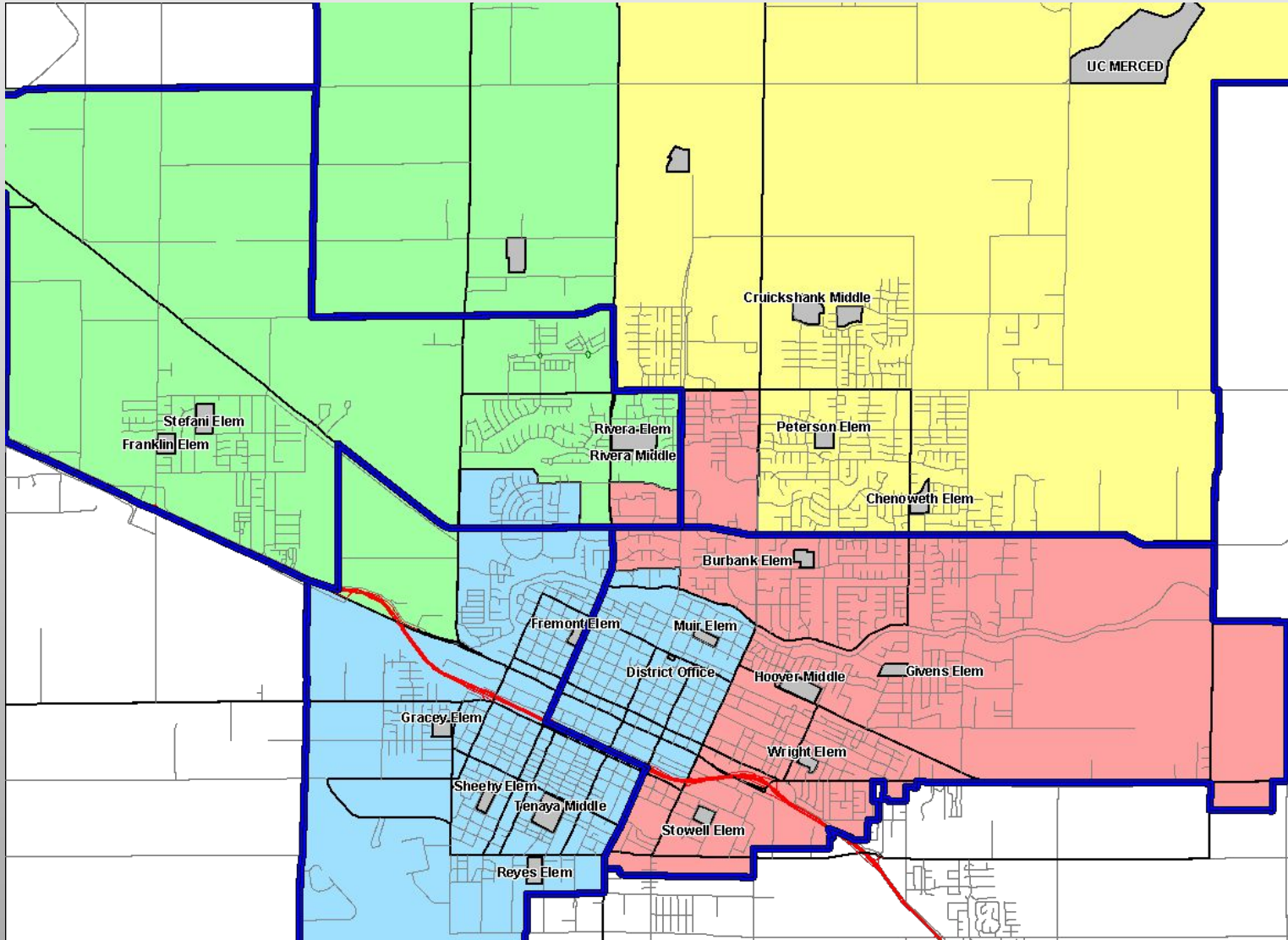

Student Impacts

Relocates 6th Grade to Middle Schools
(approximately 1200 students)

Boundary Adjustments result in approximately 312
current 7th Grade Students being relocated for 8th
Grade.

Blue Lines are current Middle School
Boundaries, and colored areas are
proposed new boundary lines.

Scenario #2 – Full Data Still being collected

District-wide boundary adjustments, move 6th Grade to Middle Schools

School Facility Utilization with Portables

			2024/25	2025/26	2026/27	2030/31	2024/25	2030/31
	Net	Net CR	Current	Projected	Projected	Projected	Current	Projected
<u>Elementary Schools</u>	<u>Classrooms</u>	<u>Capacity</u>	<u>Enrollment</u>	<u>Enrollment</u>	<u>Enrollment</u>	<u>Enrollment</u>	<u>Utilization</u>	<u>Utilization</u>
Burbank Elem	27	700	716	619	613	574	102.3%	82.0%
Chenoweth Elem	28	719	722	626	631	599	100.4%	83.3%
Franklin Elem	27	633	602	546	545	554	95.1%	87.5%
Fremont Elem	22	552	578	537	549	539	104.7%	97.6%
Givens Elem	24	610	579	493	481	445	94.9%	73.0%
Gracey Elem	24	612	509	450	442	427	83.2%	69.8%
Muir Elem	23	577	613	508	500	476	106.2%	82.5%
Peterson Elem	25	643	690	628	652	682	107.3%	106.1%
Reyes Elem	26	681	540	470	454	437	79.3%	64.2%
Rivera Elem	31	788	917	811	821	777	116.4%	98.6%
Sheehy Elem	24	620	481	395	382	343	77.6%	55.3%
Stefani Elem	22	632	641	557	577	567	101.4%	89.7%
Stowell Elem	23	449	501	414	407	398	111.6%	88.6%
Wright Elem	23	593	527	429	414	393	88.9%	66.3%
Sub-Totals	349	8,809	8,616	7,483	7,468	7,211	97.8%	81.9%
<u>Middle Schools</u>								
Cruikshank Middle	31	992	624	809	793	951	62.9%	95.9%
Hoover Middle	25	800	629	873	845	750	78.6%	93.8%
Rivera Middle	22	704	608	825	780	869	86.4%	123.4%
Tenaya Middle	33	1,056	607	1,019	1,084	1,002	57.5%	94.9%
Sub-Totals	111	3,552	2,468	3,526	3,502	3,572	69.5%	100.6%

Student Impacts

Relocates 6th Grade to Middle Schools
(approximately 1200 students)

Boundary Adjustments result in approximately 312
current 7th Grade Students being relocated for 8th
Grade.

Blue Lines are current Middle School
Boundaries, and colored areas are
proposed new boundary lines.

Scenarios and Timelines

Scenario #3

Phase 1 – Adjust Elementary School Boundaries 2025 / 2026
Phase 2 – Move 6th Grade Students to Middle Schools 2026/2027

Implemented over the next 2 school years



Scenario #3

Phased Approach: 25/26 - Elementary Boundaries, 26/27 – Move 6th Grade

School Facility Utilization with Portables

			2024/25	2025/26	2026/27	2030/31	2024/25	2030/31
	Net	Net CR	Current	Projected	Projected	Projected	Current	Projected
<u>Elementary Schools</u>	<u>Classrooms</u>	<u>Capacity</u>	<u>Enrollment</u>	<u>Enrollment</u>	<u>Enrollment</u>	<u>Enrollment</u>	<u>Utilization</u>	<u>Utilization</u>
Burbank Elem	27	698	716	687	573	538	102.6%	77.1%
Chenoweth Elem	28	730	722	763	646	629	98.9%	86.2%
Franklin Elem	27	579	602	550	499	513	104.0%	88.6%
Fremont Elem	22	570	578	520	455	445	101.4%	78.1%
Givens Elem	24	624	579	607	531	489	92.8%	78.4%
Gracey Elem	24	621	509	502	464	451	82.0%	72.6%
Muir Elem	23	594	613	647	537	536	103.2%	90.2%
Peterson Elem	25	667	690	591	535	558	103.4%	83.7%
Reyes Elem	26	680	540	651	554	553	79.4%	81.3%
Rivera Elem	31	813	917	907	794	779	112.8%	95.8%
Sheehy Elem	24	644	481	565	462	421	74.7%	65.4%
Stefani Elem	22	664	641	624	518	495	96.5%	74.5%
Stowell Elem	23	437	501	527	439	405	114.6%	92.7%
Wright Elem	23	593	527	572	472	451	88.9%	76.1%
Sub-Totals	349	8,914	8,616	8,713	7,479	7,263	96.7%	81.5%
<u>Middle Schools</u>								
Cruickshank Middle	31	992	624	609	793	951	62.9%	95.9%
Hoover Middle	25	800	629	664	845	750	78.6%	93.8%
Rivera Middle	22	704	608	614	780	869	86.4%	123.4%
Tenaya Middle	33	1,056	607	578	1,084	1,002	57.5%	94.9%
Sub-Totals	111	3,552	2,468	2,465	3,502	3,572	69.5%	100.6%

Scenarios and Timelines

Scenario #4

Phase 1 - Move 6th Grade Students to Middle Schools 2025 / 2026

Phase 2 - Adjust Elementary School Boundaries 2026 / 2027

Implemented over the next 2 school years



Scenario #4

Phased Approach: 25/26 – Move 6th Grade, 26/27 – Elementary Boundary Adjustments

School Facility Utilization with Portables								
			2024/25	2025/26	2026/27	2030/31	2024/25	2030/31
<u>Elementary Schools</u>	<u>Net</u>	<u>Net CR</u>	<u>Current</u>	<u>Projected</u>	<u>Projected</u>	<u>Projected</u>	<u>Current</u>	<u>Projected</u>
	<u>Classrooms</u>	<u>Capacity</u>	<u>Enrollment</u>	<u>Enrollment</u>	<u>Enrollment</u>	<u>Enrollment</u>	<u>Utilization</u>	<u>Utilization</u>
Burbank Elem	27	698	716	619	573	538	102.6%	77.1%
Chenoweth Elem	28	730	722	626	646	629	98.9%	86.2%
Franklin Elem	27	579	602	546	499	513	104.0%	88.6%
Fremont Elem	22	570	578	537	455	445	101.4%	78.1%
Givens Elem	24	624	579	493	531	489	92.8%	78.4%
Gracey Elem	24	621	509	450	464	451	82.0%	72.6%
Muir Elem	23	594	613	508	537	536	103.2%	90.2%
Peterson Elem	25	667	690	628	535	558	103.4%	83.7%
Reyes Elem	26	680	540	470	554	553	79.4%	81.3%
Rivera Elem	31	813	917	811	794	779	112.8%	95.8%
Sheehy Elem	24	644	481	395	462	421	74.7%	65.4%
Stefani Elem	22	664	641	557	518	495	96.5%	74.5%
Stowell Elem	23	437	501	414	439	405	114.6%	92.7%
Wright Elem	23	593	527	429	472	451	88.9%	76.1%
Sub-Totals	349	8,914	8,616	7,483	7,479	7,263	96.7%	81.5%
<u>Middle Schools</u>								
Cruickshank Middle	31	992	624	809	793	951	62.9%	95.9%
Hoover Middle	25	800	629	873	845	750	78.6%	93.8%
Rivera Middle	22	704	608	825	780	869	86.4%	123.4%
Tenaya Middle	33	1,056	607	1,019	1,084	1,002	57.5%	94.9%
Sub-Totals	111	3,552	2,468	3,526	3,502	3,572	69.5%	100.6%

Building Projections

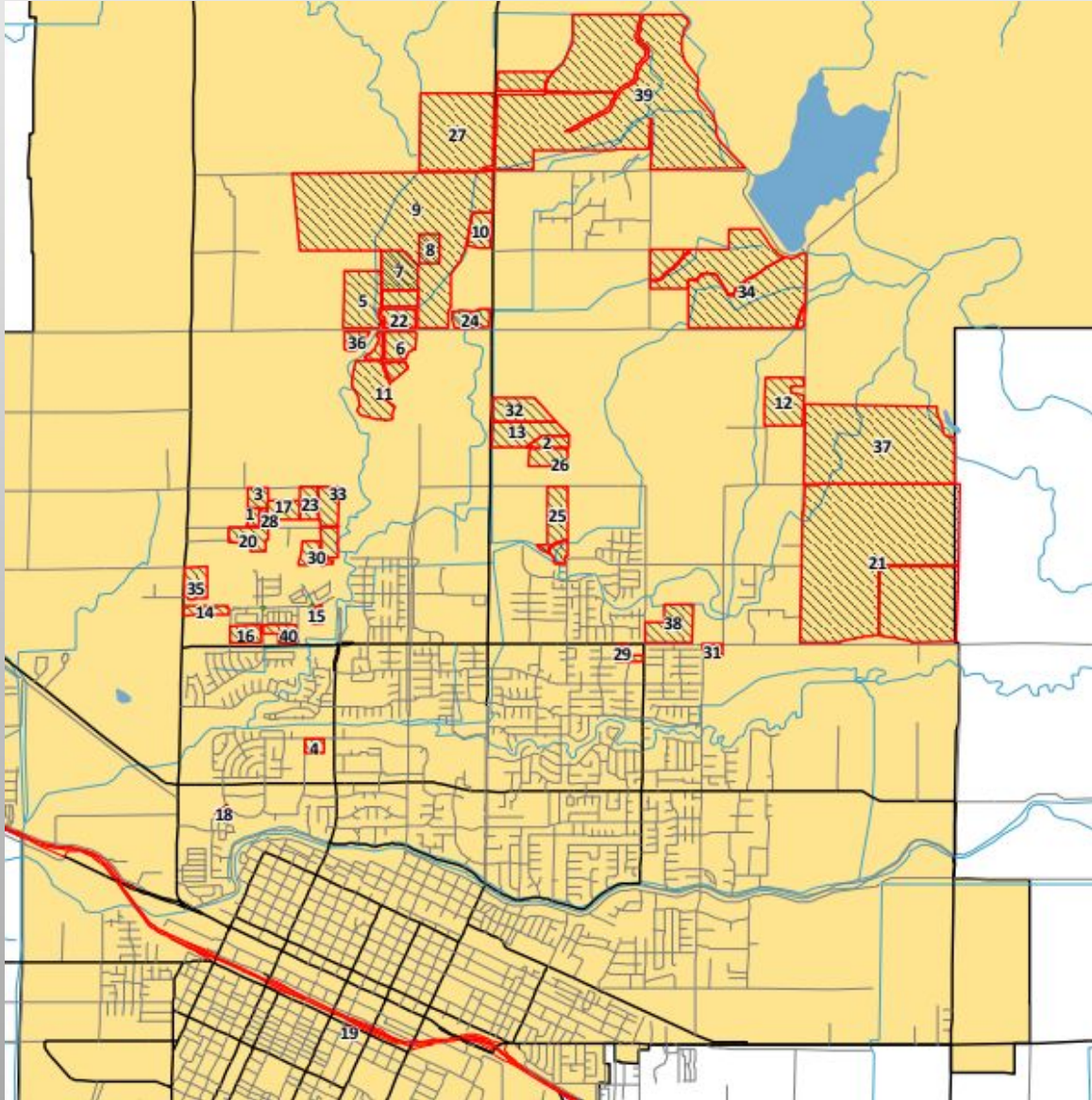

Total Units	23,839
Projected within 6 years	1,983
TK-6 Students (projected)*	498
Middle School (projected)*	139
* = projected within 6 years	



Building Projections

Merced City School District New Development Construction Housing Units per Year							
<u>School</u>	<u>25/26</u> <u>Year 1</u>	<u>26/27</u> <u>Year 2</u>	<u>27/28</u> <u>Year 3</u>	<u>28/29</u> <u>Year 4</u>	<u>29/30</u> <u>Year 5</u>	<u>30/31</u> <u>Year 6</u>	<u>Totals</u>
Burbank Elem	0	0	0	0	0	0	0
Chenoweth Elem	0	0	0	0	0	0	0
Franklin Elem	162	67	86	162	175	200	852
Fremont Elem	60	25	0	0	0	0	85
Givens Elem	0	0	0	0	0	50	50
Gracey Elem	0	0	0	0	0	0	0
Muir Elem	0	0	0	0	0	0	0
Peterson Elem	101	104	169	201	191	105	871
Reyes Elem	0	0	0	0	0	0	0
Rivera Elem	0	0	0	0	25	50	75
Sheehy Elem	0	0	0	0	0	0	0
Stefani Elem	162	67	86	162	175	200	852
Stowell Elem	0	0	25	25	0	0	50
Wright Elem	0	0	0	0	0	0	0
Elementary Totals	323	196	280	388	391	405	1,983
Cruickshank Middle	168	151	255	313	316	230	1,433
Hoover Middle	0	0	0	0	0	0	0
Rivera Middle	95	20	0	50	75	175	415
Tenaya Middle	60	25	25	25	0	0	135
Middle Totals	323	196	280	388	391	405	1,983

Note:

Demographers show housing developments impacting Franklin and Stefani boundaries, however they did not add both figures into the total, as they share the same boundaries.



Rivera - Area of Concern

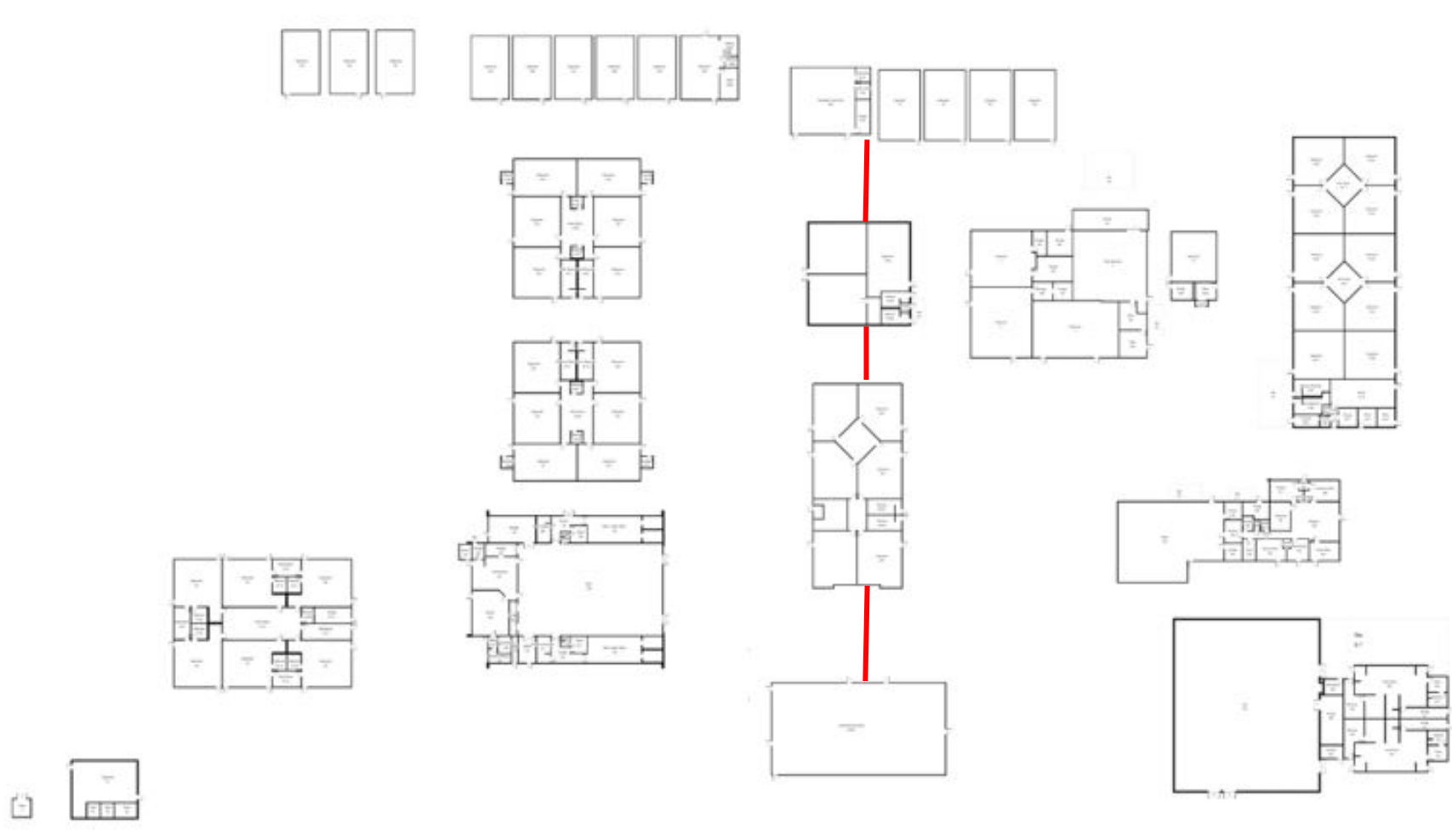

Additional information and mapping options have been requested from our demographer.

Every Scenario still has the projected enrollment of these campuses to be over the combined capacity.



Thank you to our team and stakeholders for their help in getting us to this point. The work is not done.

Questions?

